

Unit Information

120 volts - 1500 watts

Dual heater system for brewing and keep warm at optimal temperatures

Boil dry protection with auto reset

WARING
COMMERCIAL
 55 Cup Coffee Urn
WCU55

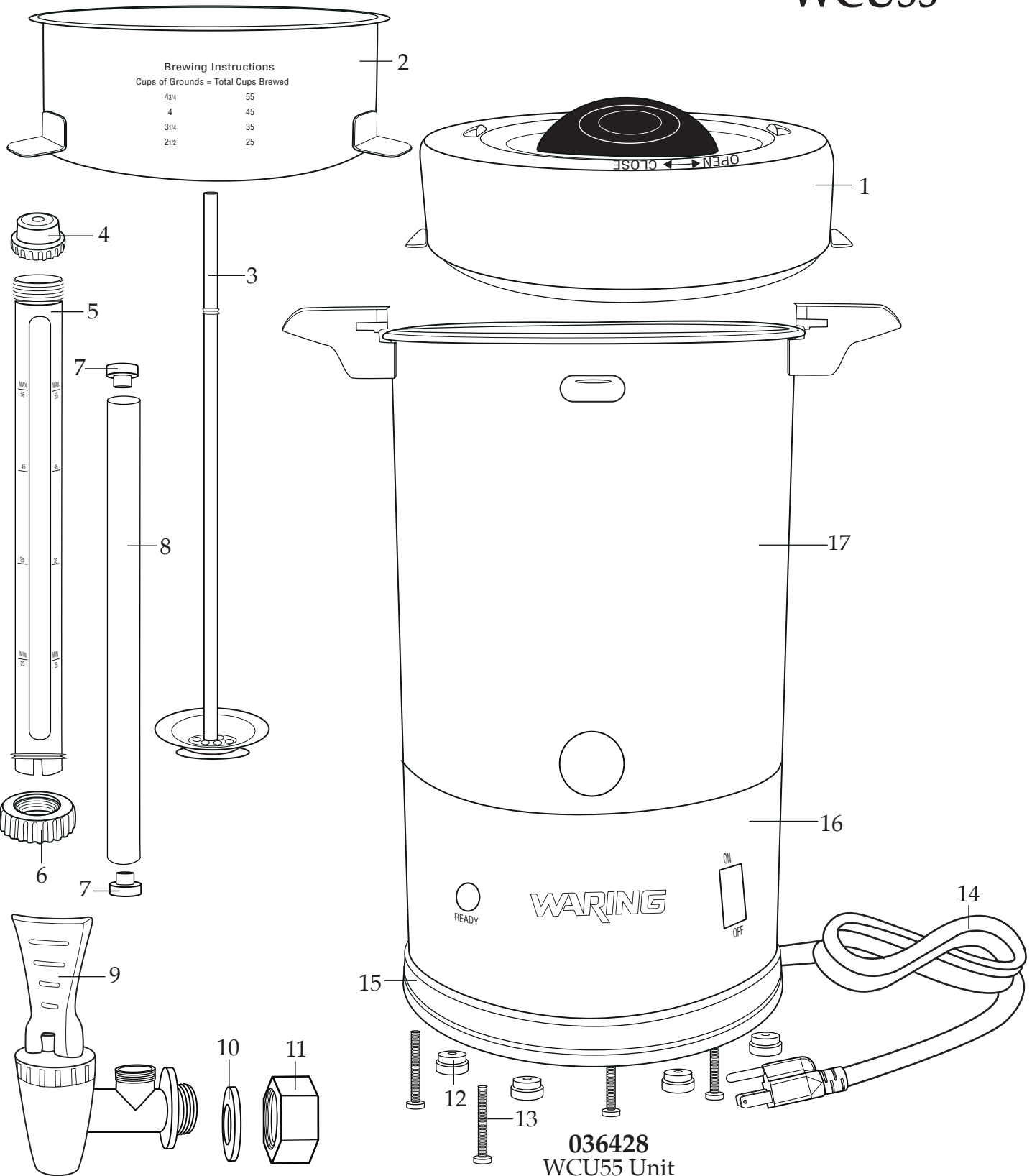

036428
 WCU55 Unit

WARING COMMERCIAL WCU55

Internal Components

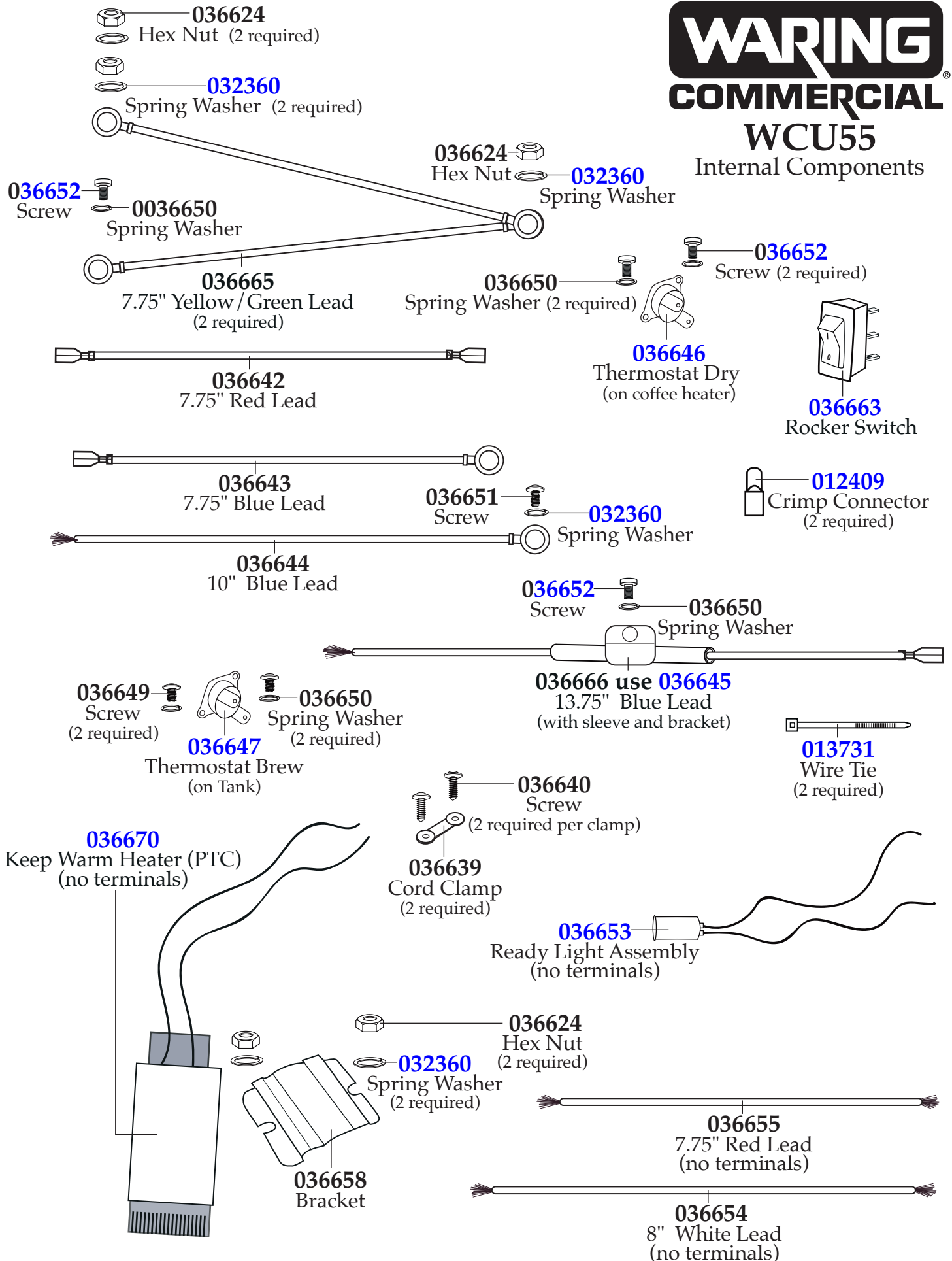

| Illustration# | Part# | Description |
|----------------------|--------------|--|
| 1 | 036423 | Cover |
| 2 | 036424 | Coffee Basket |
| 3 | 036425 | Percolator Tube |
| 4 | 036413 | Water Gauge Cover |
| 5 | 036426 | Water Gauge Tube |
| 6 | 036422 | Water Gauge Tube Collar |
| 7 | 036415 | Glass Tube Seal (2 required) |
| 8 | 036427 | Glass Tube |
| 9 | 036417 | Spigot |
| 10 | 036418 | Spigot Seal |
| 11 | 036419 | Spigot Nut |
| 12 | 036420 | Feet (4 required) |
| 13 | 036635 | Screw (3 required) |
| 14 | 036638 | Cord |
| 15 | 036667 | Tank Base |
| 16 | 036668 | Tank Skirt |
| 17 | 036669 | Tank (comes with coffee heater, handles and sight glass bracket) |

Note: Use Thermal Grease with Thermostat (dry),
Thermostat (brew) and Keep Warm Heater.