

## Unit Information

Limited 3 Year Motor Warranty  
Two Year Parts & Labor

60Hz

12 Amps

3 HP Motor

30,000+ RPM's

One Piece Dishwasher Safe  
Removable Jar Pad

# WARING COMMERCIAL

## MX1050

## MX1050 B

## MX1050S

## MX1050S B

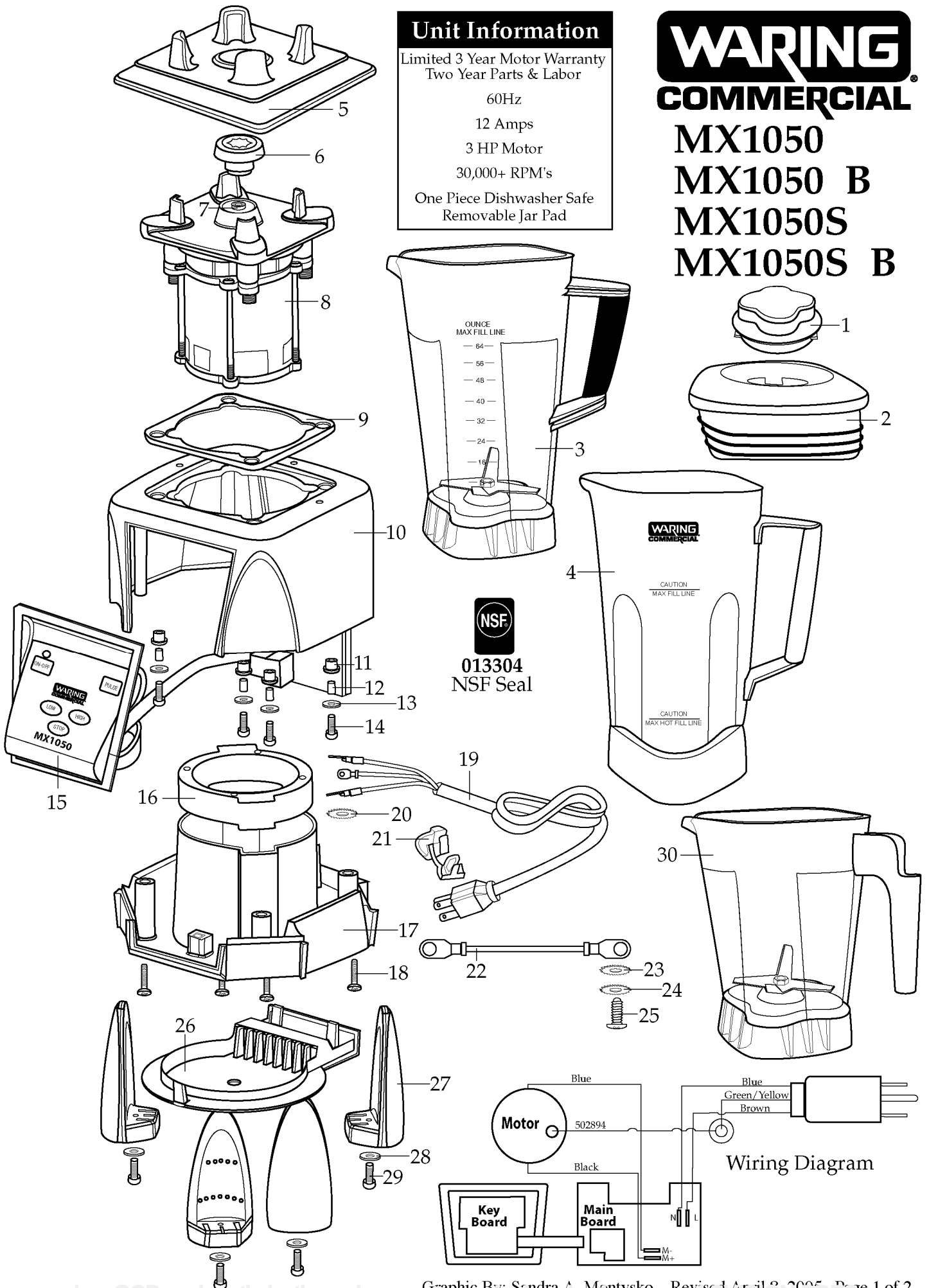

**Catalog**

MX1050

MX1050 B (*current production*)

MX1050S

MX1050S B (*current production*)**Model**

MXEPGY6

MXEPGYS6



<b>Illustration #</b>	<b>Part #</b>	<b>Description</b>
1	026425	Jar Lid Cover
2	026424	Jar Lid
3	503005	Jar with Blending Assy. /64 oz. polycarbonate
4	503009	Jar with Blending Assy. /64 oz. stainless steel
5	026442	Jar Pad
6	027377	Drive Clutch
7	027279	Motor Shaft Spacer
8	026926	Motor with Dampening Plate
9	026437	Dampening Plate Gasket
10	026426-07	Top Housing
11	026439	Dampening Plate Bushing 4 Req.'d
12	026453	Dampening Plate Sleeve 4 Req.'d
13	026459	Washer 4 Req.'d
14	026455	Screw 4 Req.'d
15	027660	Control Panel Assembly ( <i>current production</i> )
	026930	Control Panel Assembly ( <i>older units</i> )
16	026441	Motor Baffle
17	026427-07-x	Bottom Housing
18	012505	Screw 4 Req.'d
19	026925	Cord
20	002943	Lock Washer 2 Req.'d /ground to hsg.
21	007556	Strain Relief
22	502894	Lead Assy. /green-yellow
23	018013	Lock Washer /ground to motor
24	027161	Lock Washer /ground-lead ( <i>current production</i> )
25	027693	Screw /ground-lead ( <i>current production</i> )
	007558	Screw /ground-lead ( <i>older units</i> )
26	026429-07	Bottom Housing Cover
27	026430	Corner Post 4 Req.'d
28	026459	Washer 4 Req.'d
29	012505	Screw 4 Req.'d
30	503010	Jar with Blending Assy. /32 oz. polycarbonate