

# Unit Information

4.3 Amps  
 1/2 HP  
 1795 RPM's (no load)  
 2 1/2 Quart Work Bowl

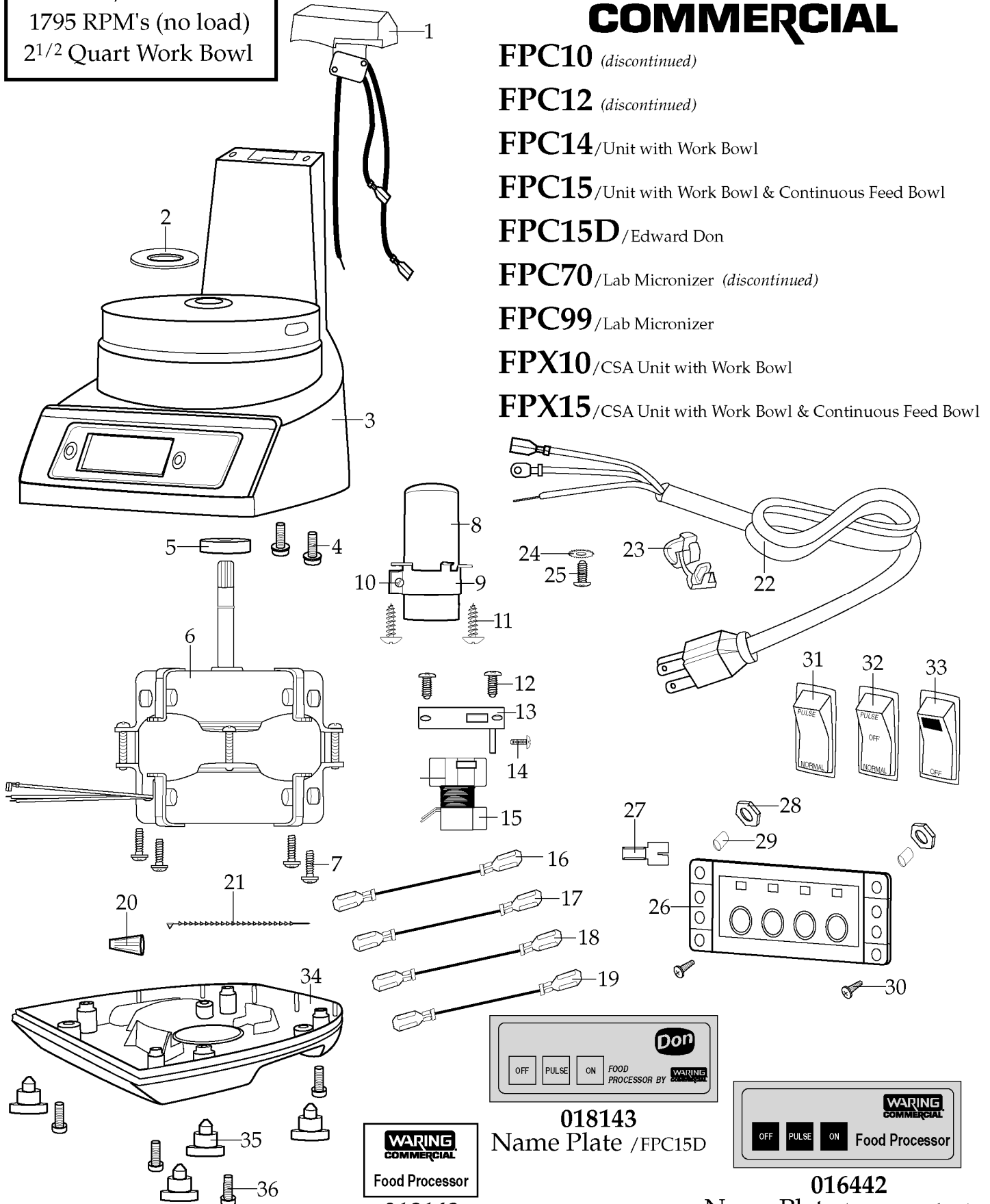

**FPC10** (discontinued)

**FPC12** (discontinued)

**FPC14**/Unit with Work Bowl

**FPC15**/Unit with Work Bowl & Continuous Feed Bowl

**FPC15D**/Edward Don

**FPC70**/Lab Micronizer (discontinued)

**FPC99**/Lab Micronizer

**FPX10**/CSA Unit with Work Bowl

**FPX15**/CSA Unit with Work Bowl & Continuous Feed Bowl

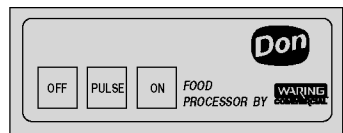
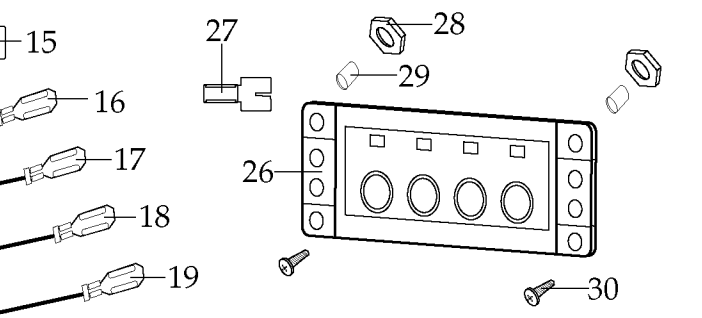
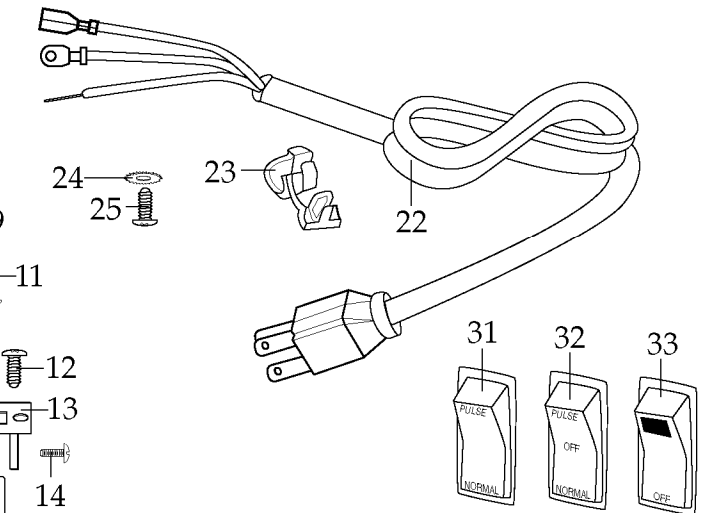

**018143**  
 Name Plate /FPC15D



**016442**  
 Name Plate (current production)



**018143**  
 Name Plate *limited availability*

FPC10  
 FPC12  
 FPC14/15  
 FPC15D  
 FPC70  
 FPC99  
 FPX10/15

31FP58  
 31FP83  
 31FP85/86  
 31FP85 or 32FP15  
 31FP93  
 31FP93 or 32FP12  
 31FP91 or 32FP13

**Waring Factory Service Center**  
 314 Ella T. Grasso Ave.  
 Torrington, CT 06790  
 Tele. 1-800-269-6640  
 Fax 860-496-9017  
 www.waringproducts.com

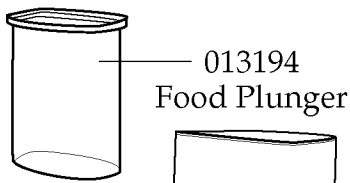

013194  
 Food Plunger



012971  
 Funnel

012957  
 Slicing Guide

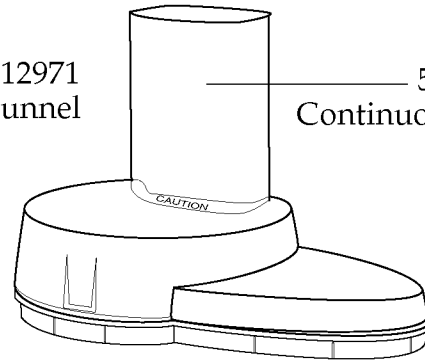

500880  
 Continuous Feed Cover

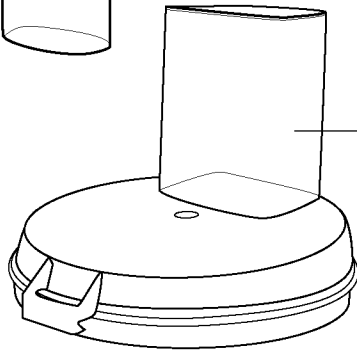

500721  
 Cover

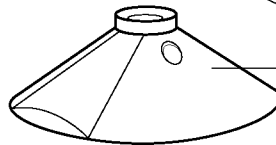

014412  
 Ejector Disc

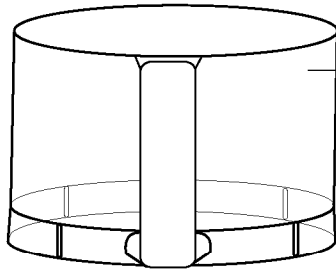

502587  
 Chamber  
 w/gray handle

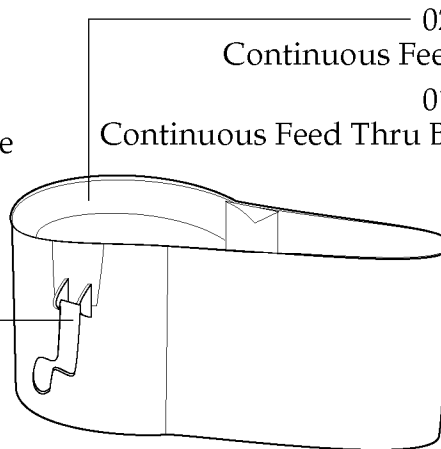

025318  
 Continuous Feed Thru Bowl /gray

016444  
 Continuous Feed Thru Bowl /white *limited availability*

009416  
 Spring Clip 2 Req.'d

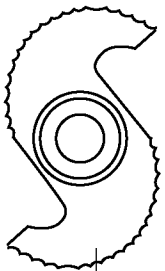

500600  
 Main Cutter

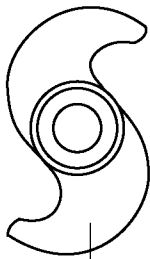

500498  
 Mixer Blade

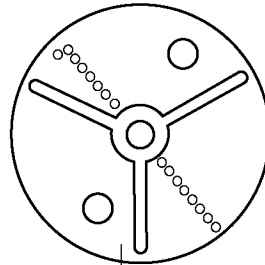

500624  
 Fine Shredder 1/8"

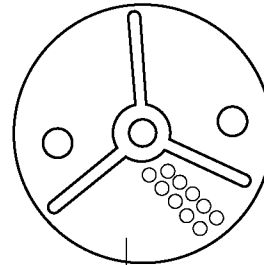

500621  
 Medium Shredder 5/16"

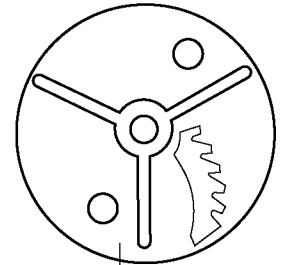

500623  
 French Fry 3/8"

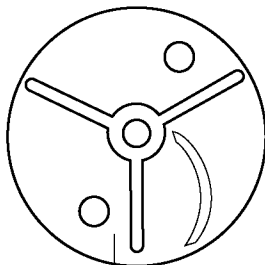

500620  
 Thin Slicer 1/16"

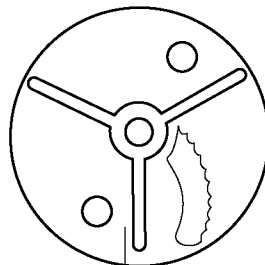

501446  
 Medium Slicer 1/8"

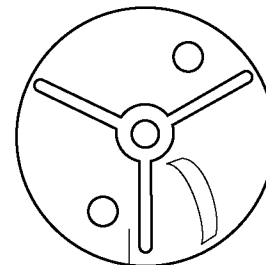

500619  
 Thick Slicer 1/4"

**Catalog**

FPC10  
 FPC12  
 FPC14/15  
 FPC15D  
 FPC70  
 FPC99  
 FPX10/15

**Model**

31FP58  
 31FP83  
 31FP85/86  
 31FP85 or 32FP15  
 31FP93  
 31FP93 or 32FP12  
 31FP91 or 32FP13



<b>Illustration #</b>	<b>Part #</b>	<b>Description</b>
1	502588	Cap & Switch Assy. /gray
	501532	Cap & Switch Assy. /white <i>limited availability</i>
2	013926	Fiber Washer /motor shaft
3	025315	Top Housing /gray
	016440	Top Housing /white <i>limited availability</i>
4	012398	Sems 2 Req.'d /cap switch to top hsg.
5	013927	Seal ( <i>current production</i> )
6	028022	Motor ( <i>current production</i> )
	014700	Motor ( <i>older units</i> )
7	012419	Sems 4 Req.'d /motor to hsg.
8	012390	Capacitor
9	012391	Mounting Clamp
10	013230	Screw
	013236	Hex Nut (not shown)
11	001843	Screw 2 Req.'d
12	001843	Screw 2 Req.'d
13	017284	Plated Bracket
14	013270	Screw
15	013275	Relay
16	500399	Lead /violet
17	501543	Lead /black
18	501544	Lead /white
19	501547	Lead /violet
20	009051	Wire Nut 2 Req.'d
21	011165	Tie
22	501545	Cord Set
23	007556	Strain Relief
24	002943	Washer /ground
25	013270	Screw /ground

## Catalog

FPC10  
FPC12  
FPC14/15  
FPC15D  
FPC70  
FPC99  
FPX10/15

## Model

31FP58  
31FP83  
31FP85/86  
31FP85 or 32FP15  
31FP93  
31FP93 or 32FP12  
31FP91 or 32FP13



## Illustration #

## Part #

## Description

26	016439	Tap Touch Switch
27	016454	Terminal /switch
28	002881	Keyp Nut 2 Req.'d
29	016734	Spacer 2 Req.'d
30	016446	Screw 2 Req.'d
31	014199	Rocker Switch /normal-pulse <i>limited availability</i>
32	013362	Rocker Switch /on-off-pulse <i>limited availability</i>
33	014217	Rocker Switch /off-light <i>limited availability</i>
34	025316	Bottom Housing /gray
	016441	Bottom Housing /white <i>limited availability</i>
35	012979	Foot 4 Req.'d
36	012394	Screw 4 Req.'d

## Items for Older Units

013406 - Baffle /FPX10, FPX15 (not shown)

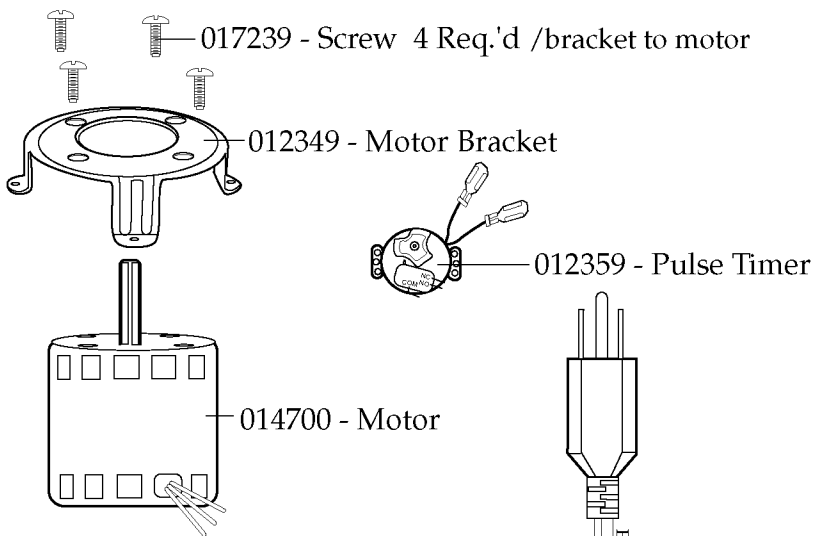

## Leads use with Rocker Switches

- 500419 - black
- 500420 - red
- 500421 - white
- 500422 - blue
- 500423 - black
- 500424 - brown

## Leads on Cap/Switch Assy.

- 500396 - violet
- 500397 - red
- 500398 - yellow

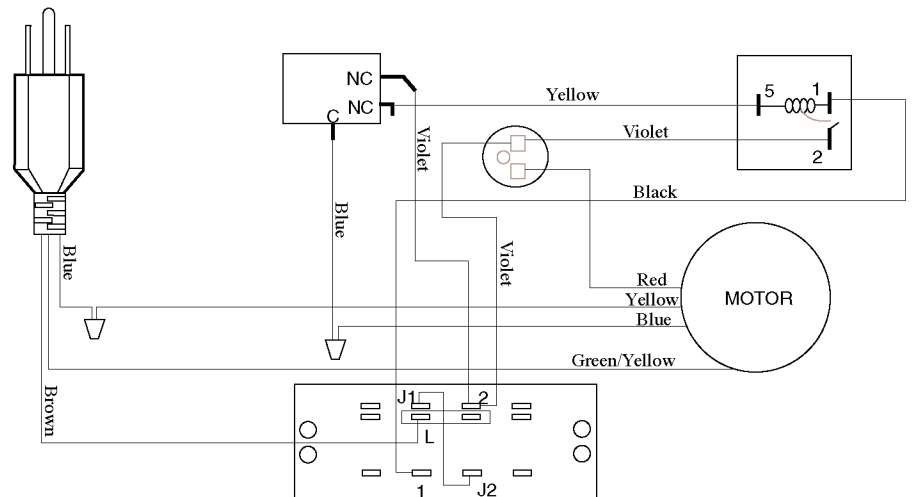

## Wiring Diagram