



Outperform every day.™

# Operator's Manual

## INC-80 AND INC-80S18 CUP DISPENSER



Thank you for purchasing this Vollrath product. Before operating the equipment, read and familiarize yourself with the following operating and safety instructions. **SAVE THESE INSTRUCTIONS FOR FUTURE REFERENCE.** Save the original box and packaging. Use this packaging to ship the equipment if repairs are needed.

### DIMENSIONS

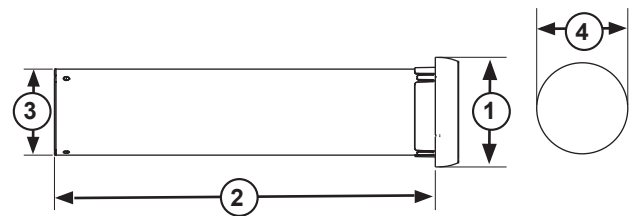

Model	Dimension			
	1	2	3	4*
INC-80	6-5/8"	23-1/8"	5-1/4"	5-1/2"
INC-80S18	(16.8 cm)	(58.7 cm)	(13.3 cm)	(13.9 cm)
		18-1/8"		
		(46 cm)		

\*Mounting hole diameter

### TOOLS NEEDED

- Medium size Phillips head screwdriver
- Hole saw
- Drill and 1/8" drill bit
- Included parts: 3 #8 x 1" screws, 3 additional gaskets for dispensing different diameter cups, parts bag for horizontal mounting

### IN-COUNTER (VERTICAL) INSTALLATION

1. Determine installation location.
2. Use a hole saw to cut a 5-1/2" (13.9 cm) hole in the countertop.
3. Remove the bezel/gasket from the dispenser.

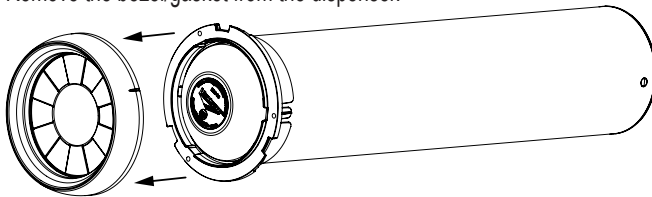

4. Place dispenser in cutout hole.
5. Mark the three flange mounting holes with a center punch.
6. Drill three 1/8" holes.

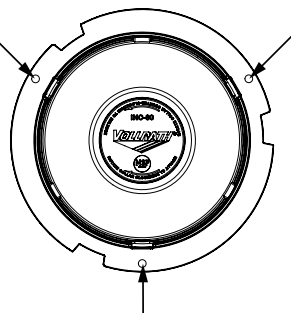

7. Secure dispenser into counter with included #8 x 1" screws.
8. Dispenser ships with medium size gasket installed. To change gasket to fit a different cup size, see "Change the Cup Size" on page 2.
9. Re-install the bezel (with gasket) onto tube.
  - Align the three tabs on the bezel with the notches on the flange or use the lines on the bezel to align the bezel with the flange.
  - Rotate clockwise until you feel and hear a click, securing the assembly together.

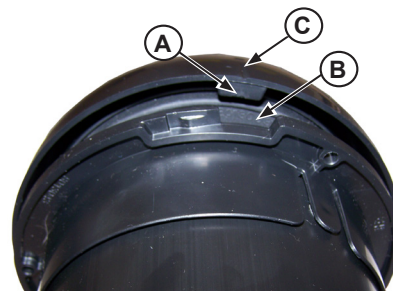

- (A) Tab
- (B) Notch
- (C) Alignment line

## CABINET (HORIZONTAL) INSTALLATION

### Install the Dispenser.

Follow the procedure for In-Counter (Vertical) Mounting.

### Secure the Back of the Dispenser to the Cabinet

Vollrath recommends supporting the back end of the dispenser. If the included hardware will not work for your installation, a bracket (not included) could also be used.

1. Remove the three clips securing the bottom plug to the tube. Use pliers to squeeze the tabs and push out.

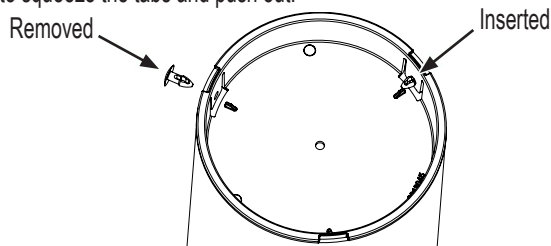

2. Remove the bottom plug, spring, and push plate from the tube.

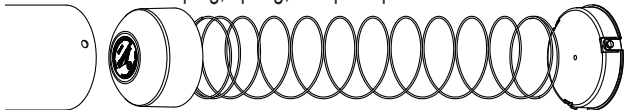

3. Remove the hardware from the bag of parts.
4. Drill or punch out the dimpled hole in the bottom plug.
5. Insert the included #10-24 x 1-3/4" Phillips head screw through the hole in the bottom plug. Secure with the included square nut.

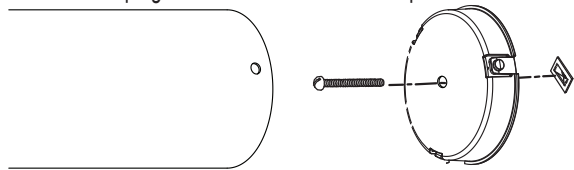

**NOTICE:** The screw must extend approximately 9/16" (14.2 mm) past the cabinet. Depending on installation, a longer screw may be required.

6. Insert the pusher plate and spring into the tube.
7. Insert the bottom plug into the tube, aligning the holes in the tube with the tabs on the bottom plug.
8. Insert the clips so the larger portion of the clip retains the clip in the hole.
9. Attach the back of the dispenser to the cabinet with the included washer and hex nut.

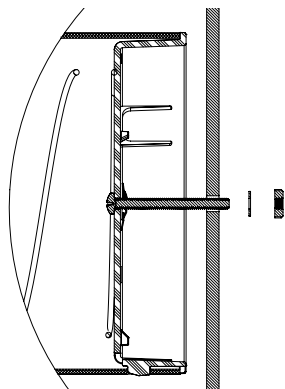

## LOAD THE DISPENSER

1. Remove the cups from the wrapping.
2. Gently push the cups into installed dispenser, with the bottom of the cups facing out.

## CHANGE THE CUP SIZE

1. Remove the cups from dispenser.
2. Remove the bezel and gasket.
3. Install a gasket that matches the lip diameter of the cup.

Cup Lip Diameter	Gasket	Part Number
2-1/4 - 3-1/8" (5.7 -7.9 cm)	Small	8013052
3 - 3-5/8" (7.6 -9.2 cm)	Medium*	8013053
3 1/2 - 4 1/4" (8.9-10.8 cm)	Medium /Large	8013063
4-1/8 - 4-3/4" (10.4 -12.1 cm)	Large	8013054

\* Comes installed on dispenser.

4. Verify the gasket fully seats in the bezel groove and is secured by the five tabs on the bezel.

**NOTICE:** Do NOT cut or trim gaskets.

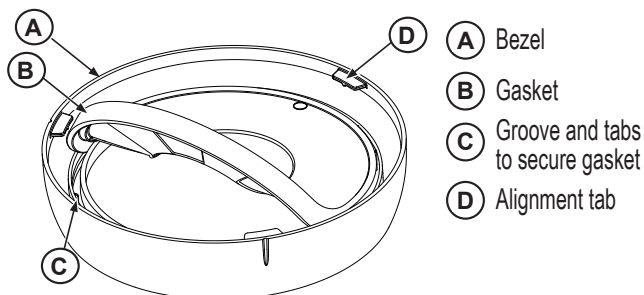

5. Install the bezel with gasket onto the tube.
  - Align the three tabs on the bezel with the notches on the flange.
  - Rotate clockwise until you feel and hear a click, securing the assembly together.

## CLEAN THE DISPENSER

1. Remove the bezel and gasket from the tube.
2. Clean the bezel and gasket in hot soapy water or dishwasher. Let parts dry thoroughly.
3. If needed, remove the tube for cleaning. See the installation instructions.
4. Wipe tube clean with hot soapy water or non-toxic cleanser. Allow to dry.
5. Assemble dispenser in reverse order of removal.

### Repair

Please see [Vollrath.com](http://Vollrath.com) for replacement parts and technical support.

### Warranty

The Vollrath Company LLC warrants the products it manufactures or distributes against defects in materials and workmanship for a period of one year, except as specifically described in our full warranty statement. For complete warranty information, product registration and new product announcement, visit [www.vollrath.com](http://www.vollrath.com).



The Vollrath Company L.L.C.  
1236 North 18th Street  
Sheboygan, WI 53081-3201 U.S.A.  
[www.vollrath.com](http://www.vollrath.com)

Main | Phone: 800.628.0830 Fax: 800.752.5620  
Technical Services | Phone: 800.628.0832 Fax: 920-459-5462  
Canada Service | Phone: 800.695.8560