



T&S BRASS AND BRONZE WORKS, INC.

2 Saddleback Cove / P.O. Box 1088
Travelers Rest, SC 29690

Model No.

PG-35AV-VH06

Item No.

Travelers Rest, SC: 800-476-4103 • Simi Valley, CA: 800-423-0150 • Fax: 864-834-3518 • www.tsbrass.com

This Space for Architect/Engineer Approval

Job Name _____ Date _____

Model Specified _____ Quantity _____

Customer/Wholesaler _____

Contractor _____

Architect/Engineer _____



PG-35AV
Aluminum Spray
Valve



B-KF
Deck Flange

3/4-14 UN
Female Inlet

Mounting Surface

Seal Washer

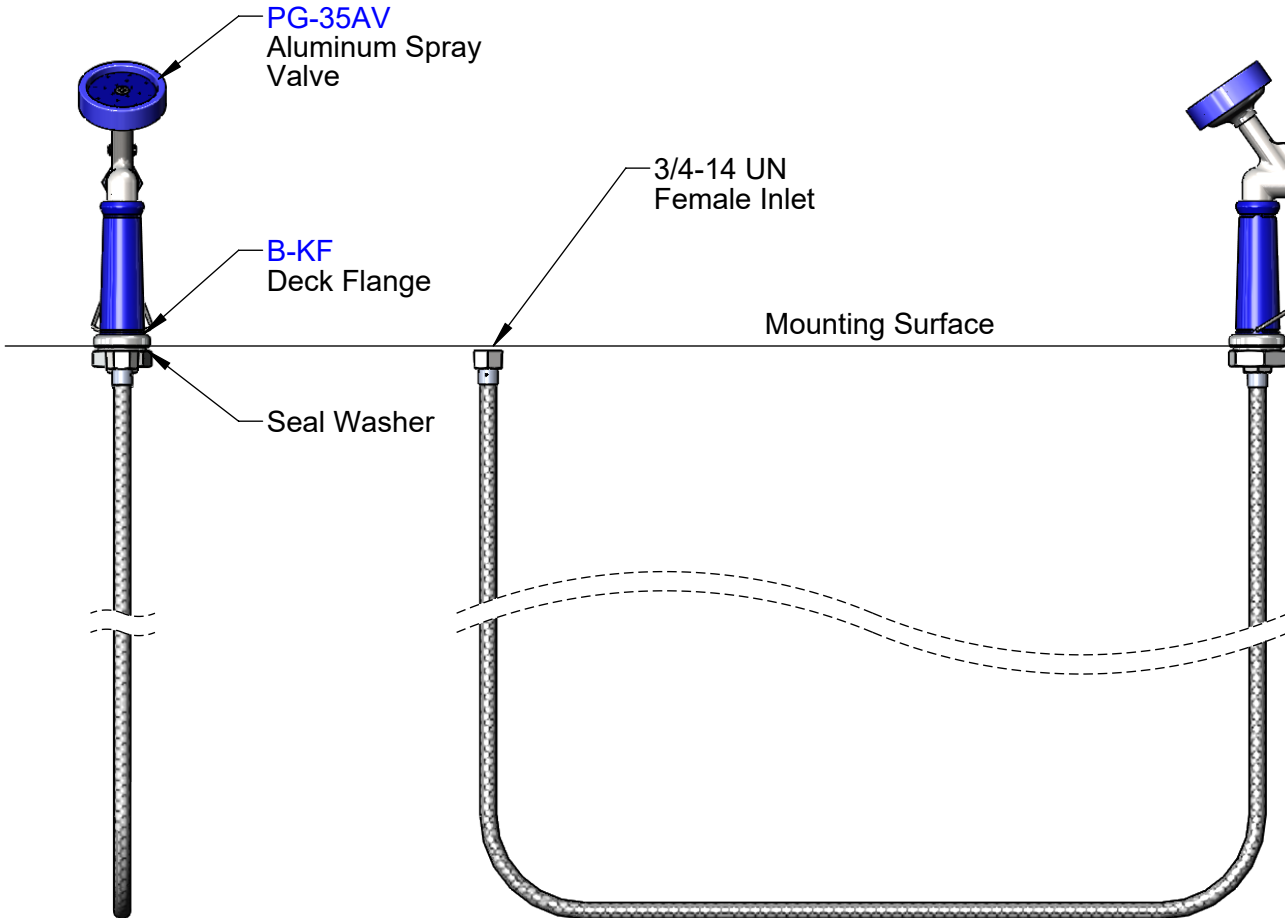

1/8" NPT x 3/4-14 UN
Male Thread Adapter
(Included)



1/4" NPT x 3/4-14 UN
Male Thread Adapter
(Included)

Rough-In Requirement:
Deck Flange: (1) $\text{Ø } 1 \frac{9}{16}$ " [40mm] Mounting Hole

Product Specifications:
Aluminum Spray Valve, 7' Vinyl Hose, Protective Deck Flange & (2) Adapters

Product Compliance:
NSF 61 Exempt (Non-Potable)



T&S BRASS AND BRONZE WORKS, INC.

2 Saddleback Cove / P.O. Box 1088
Travelers Rest, SC 29690

Model No.

PG-35AV-VH06

Item No.

Travelers Rest, SC: 800-476-4103 • Simi Valley, CA: 800-423-0150 • Fax: 864-834-3518 • www.tsbrass.com

ITEM NO.	SALES NO.	DESCRIPTION
1	PG-35AV	Aluminum Angled Spray Valve
2	B-KF	Protective Flange
3	172A	Adapter, 1/4" NPT Male x 3/4-14 UN Male
4	010476-45	#27 Washer
5	PG-0078-VH	78" Vinyl Hose
6	000542-25	Adapter, 1/8" NPT Male x 3/4-14 UN Male

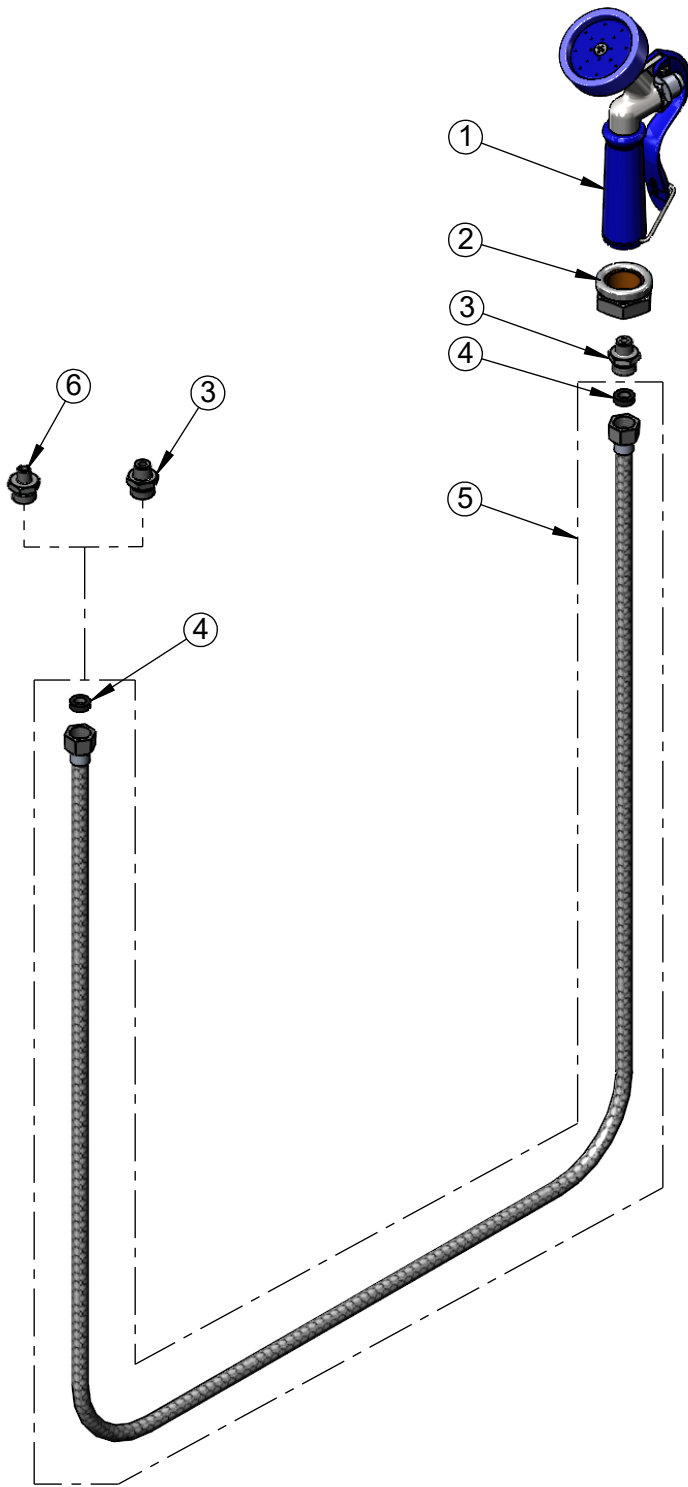

Product Specifications:
Aluminum Spray Valve, 7' Vinyl Hose, Protective Deck Flange & (2) Adapters

Product Compliance:
NSF 61 Exempt (Non-Potable)