



T&S BRASS AND BRONZE WORKS, INC.
 2 Saddleback Cove / P.O. Box 1088
 Travelers Rest, SC 29690

Model No.
MV-1907-12CW

Item No.

Travelers Rest, SC: 800-476-4103 • Simi Valley, CA: 800-423-0150 • Fax: 864-834-3518 • www.tsbrass.com

This Space for Architect/Engineer Approval

Job Name _____ Date _____

Model Specified _____ Quantity _____

Customer/Wholesaler _____

Contractor _____

Architect/Engineer _____

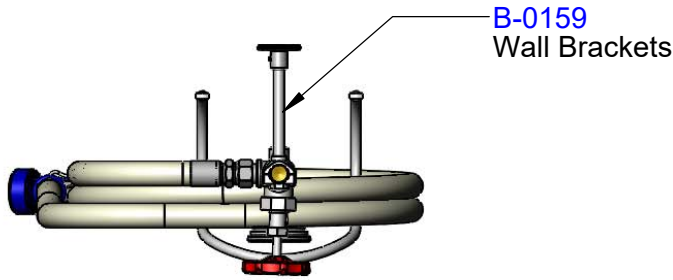

Adjustable from
 1 1/4" to 6"
 [32mm to 152mm]

3/4" Supply Piping
 by Others

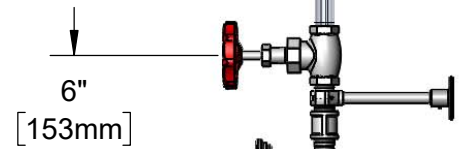

Hose Swivel
 (Hose not
 Shown for
 Clarity)

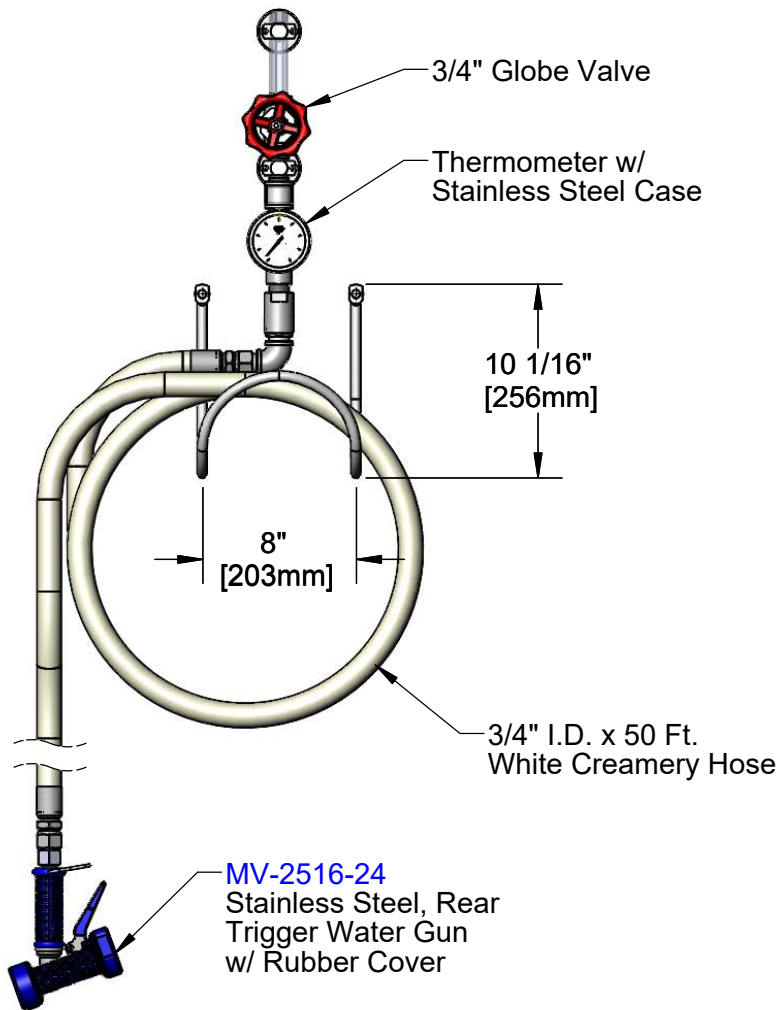
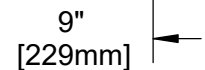

Product Specifications:
 Chrome Plated Washdown Station w/ 3/4" Inlet, Single Service Valve,
 Thermometer, 50 Ft. Hose, Stainless Steel Water Gun & Hose Rack

Product Compliance:
 NSF 61 Exempt (Non-Potable)



T&S BRASS AND BRONZE WORKS, INC.
 2 Saddleback Cove / P.O. Box 1088
 Travelers Rest, SC 29690

Model No.
MV-1907-12CW

Item No.

Travelers Rest, SC: 800-476-4103 • Simi Valley, CA: 800-423-0150 • Fax: 864-834-3518 • www.tsbrass.com

| ITEM NO. | SALES NO. | DESCRIPTION |
|----------|------------|--------------------------------|
| 1 | B-0159 | 6" Wall Bracket |
| 2 | 006648-25 | 3/4" Globe Valve |
| 3 | 003799-45 | Thermometer, Bi-Metallic |
| 4 | 004980-40 | 50' of 3/4" Hose w/ Adapters |
| 5 | MV-2516-24 | 5/16" Water Gun, Rear Trigger |
| 6 | 002970-45 | Hose Rack w/ Mounting Hardware |
| 7 | 007252-25 | Swivel |
| 8 | 002721-45 | O-Ring |

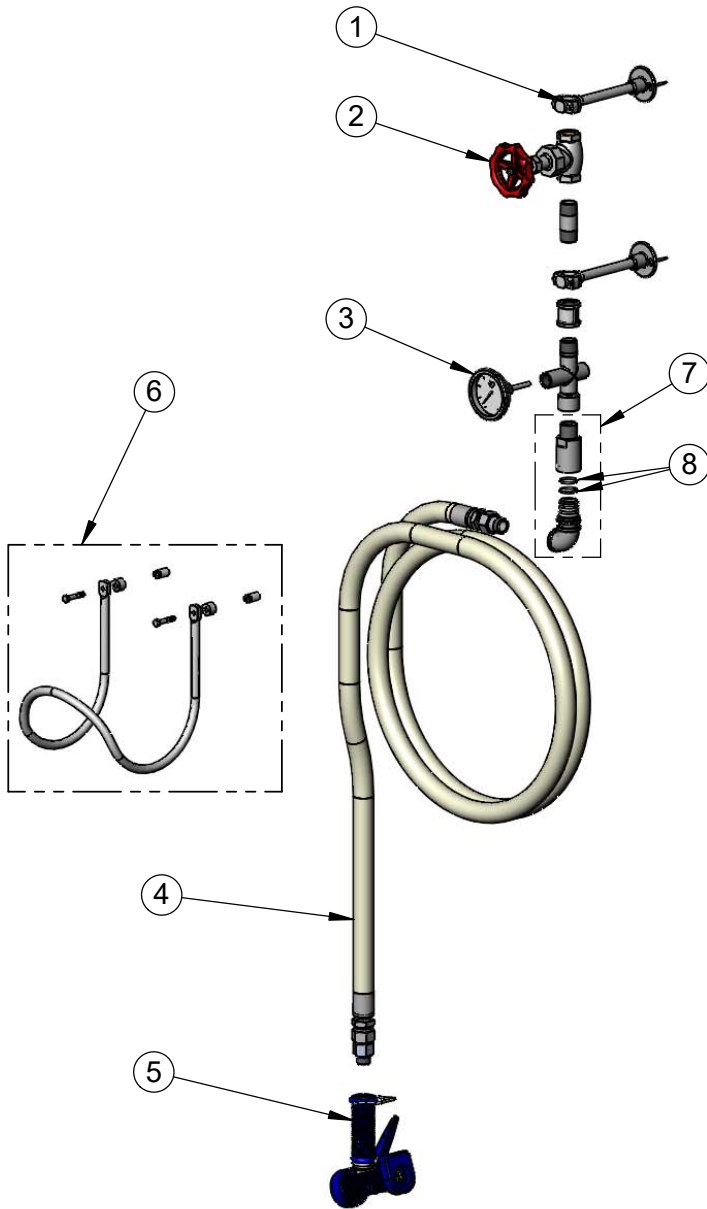

Product Specifications:
 Chrome Plated Washdown Station w/ 3/4" Inlet, Single Service Valve,
 Thermometer, 50 Ft. Hose, Stainless Steel Water Gun & Hose Rack

Product Compliance:
 NSF 61 Exempt (Non-Potable)