



**T&S BRASS AND BRONZE WORKS, INC.**  
 2 Saddleback Cove / P.O. Box 1088  
 Travelers Rest, SC 29690

Model No.

**B-7132-08H**

Item No.

Travelers Rest, SC: 800-476-4103 • Simi Valley, CA: 800-423-0150 • Fax: 864-834-3518 • www.tsbrass.com

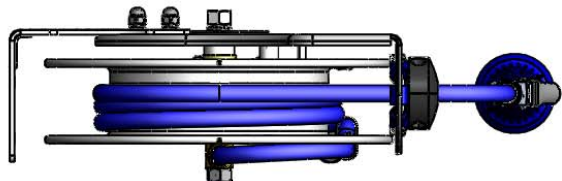

3/8" NPT Female Inlet  
 (Left Side of Reel)

This Space for Architect/Engineer Approval

Job Name \_\_\_\_\_ Date \_\_\_\_\_

Model Specified \_\_\_\_\_ Quantity \_\_\_\_\_

Customer/Wholesaler \_\_\_\_\_

Contractor \_\_\_\_\_

Architect/Engineer \_\_\_\_\_

Open Stainless Steel Hose Reel;  
 35 Ft. of 3/8" Hose

Ø 14 1/2"  
 [368mm]

18"  
 [458mm]

8 3/4"  
 [222mm]

16 9/16"  
 [421mm]

019652-40  
 3/8" NPT  
 Live Swivel

B-0108-H  
 Hi-Flow  
 Spray Valve

7 3/16"  
 [182mm]

Mounting Hole Details

5 1/2"  
 [139mm]

Ø 1/2"  
 [13mm]

6 7/16"  
 [164mm]

5 1/4"  
 [133mm]

3/4"  
 [19mm]

1/2"  
 [13mm]

2 3/8"  
 [60mm]

Product Specifications:

3/8" x 35 Ft. Open Stainless Steel Reel Hi-Flow Spray Valve & Swivel

Product Compliance:

NSF 61 Exempt (Non-Potable)  
 EPA 2005 Non-Compliant (PRSV)



**T&S BRASS AND BRONZE WORKS, INC.**  
 2 Saddleback Cove / P.O. Box 1088  
 Travelers Rest, SC 29690

Model No.  
**B-7132-08H**

Item No.

Travelers Rest, SC: 800-476-4103 • Simi Valley, CA: 800-423-0150 • Fax: 864-834-3518 • www.tsbrass.com

ITEM NO.	SALES NO.	DESCRIPTION
1	B-0108-H	Hi-Flow Spray Valve
2	001359-40	Hex Bushing, 1/2" NPT Male x 3/8" NPT Female
3	014949-45	Hose Stop Repair Kit
4	014941-45	3/8" x 35' Hose Replacement Kit
5	014946-45	3/8" Swivel Repair Kit
6	014948-45	O-Ring Replacement Kit
7	014933-45	Small SS Spring Assembly
8	014938-45	Roller Assembly Repair Kit
9	014940-45	Ratchet Repair Kit
10	019652-40	3/8" NPT Live Swivel

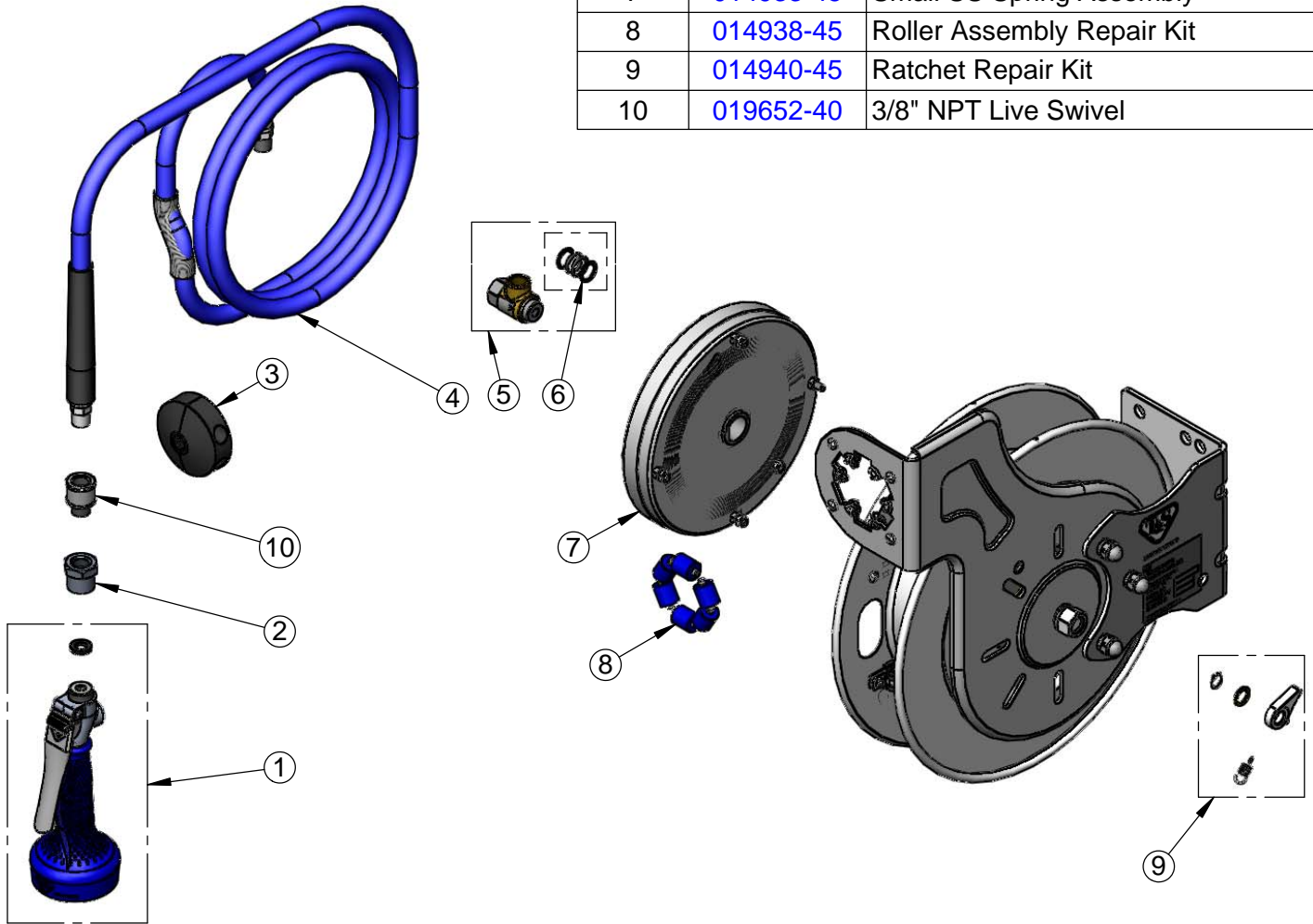

Product Specifications:  
 3/8" x 35 Ft. Open Stainless Steel Reel Hi-Flow Spray Valve & Swivel

Product Compliance:  
 NSF 61 Exempt (Non-Potable)  
 EPA Act 2005 Non-Compliant (PRSV)