



T&S BRASS AND BRONZE WORKS, INC.
 2 Saddleback Cove / P.O. Box 1088
 Travelers Rest, SC 29690

Model No.
B-6RK

Item No.

Travelers Rest, SC: 800-476-4103 • Simi Valley, CA: 800-423-0150 • Fax: 864-834-3518 • www.tsbrass.com

This Space for Architect/Engineer Approval

Job Name _____ Date _____

Model Specified _____ Quantity _____

Customer/Wholesaler _____

Contractor _____

Architect/Engineer _____



000933-45
 Seat Washer Screw
 (Qty=4)

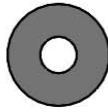

001092-45
 Seat Washer
 (Qty=8)

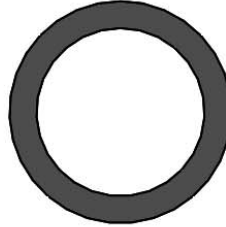

002601-45
 Top Gasket
 (Qty=4)

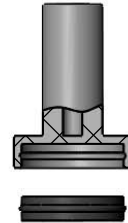

003164-45
 Spring Check Washer
 (Qty=8)

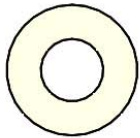

012915-45
 B-0107 Seat Washer
 (New Style)
 (Qty=2)



000974-45
 Bonnet Washer
 (Qty=4)



001098-45 (New Style)
 Eterna Spindle Packing Seal
 [Replaces 001063-45, 001098-45
 (Old Style) & 009745-45]
 (Qty=4)



001479-45
 Spring Check Spring
 (Qty=4)

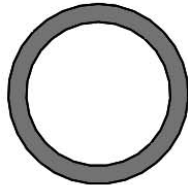

001040-45
 Bonnet Binding Washer
 (Qty=2)



001100-45
 Packing Stem
 (Qty=2)



001014-45
 Hose Barrel Washer
 (Qty=4)



010476-45
 #27 B-0107 Washer
 (Qty=4)



001022-45
 Bottom Gasket
 (Qty=4)

Product Specifications:
 Cartridge Repair Kit

Product Compliance:
 NSF 61 - Section 9
 NSF 372 (Low Lead Content)