



**T&S BRASS AND BRONZE WORKS, INC.**  
 2 Saddleback Cove / P.O. Box 1088  
 Travelers Rest, SC 29690

Model No.  
**B-0425-KIT**

Item No.

Travelers Rest, SC: 800-476-4103 • Simi Valley, CA: 800-423-0150 • Fax: 864-834-3518 • www.tsbrass.com

This Space for Architect/Engineer Approval

Job Name \_\_\_\_\_ Date \_\_\_\_\_

Model Specified \_\_\_\_\_ Quantity \_\_\_\_\_

Customer/Wholesaler \_\_\_\_\_

Contractor \_\_\_\_\_

Architect/Engineer \_\_\_\_\_

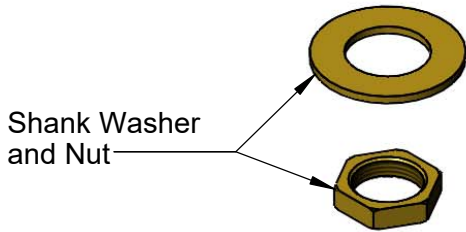

Shank Washer  
and Nut

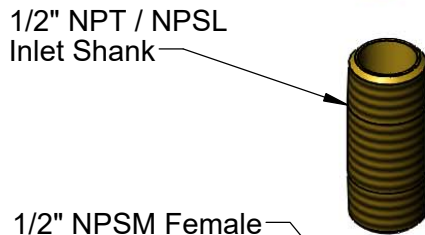

1/2" NPT / NPSL  
Inlet Shank

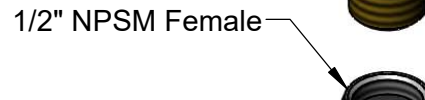

1/2" NPSM Female

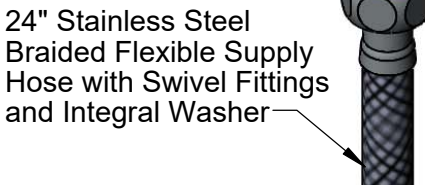

24" Stainless Steel  
Braided Flexible Supply  
Hose with Swivel Fittings  
and Integral Washer

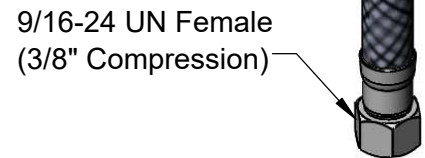

9/16-24 UN Female  
(3/8" Compression)

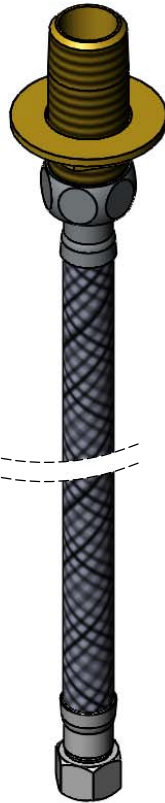

Typical Faucet  
Mounting Flange  
(Not Included)

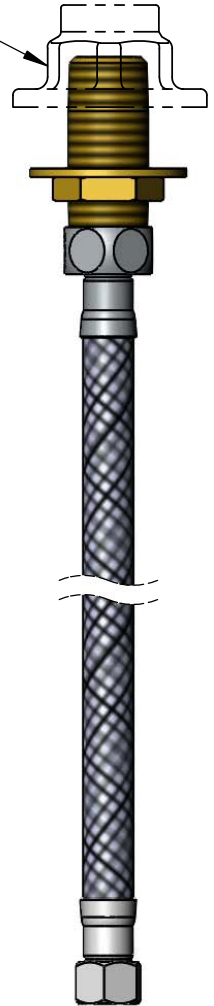

(2) Sets Supplied per Kit

Product Specifications:  
 Inlet Kit w/ 1/2" NPT Shanks, Washers, Nuts & 24" Flexible Supply  
 Hoses

Product Compliance:  
 ASME A112.18.1 / CSA B125.1  
 NSF 61 - Section 9  
 NSF 372 (Low Lead Content)



**T&S BRASS AND BRONZE WORKS, INC.**  
 2 Saddleback Cove / P.O. Box 1088  
 Travelers Rest, SC 29690

Model No.  
**B-0425-KIT**

Item No.

Travelers Rest, SC: 800-476-4103 • Simi Valley, CA: 800-423-0150 • Fax: 864-834-3518 • www.tsbrass.com

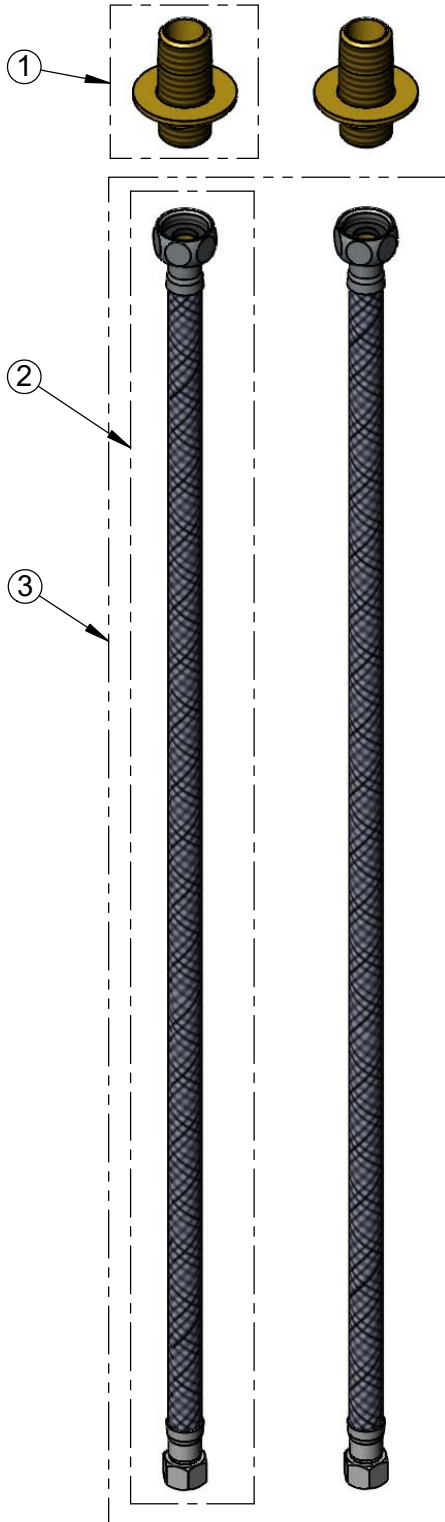

ITEM NO.	SALES NO.	DESCRIPTION
1	B-0425	1/2" NPT Inlet Supply Nipple Kit
2	017420-45	24" Flexible Supply Hose
3	B-1100-KIT	24" Flexible Supply Hose (2)

Product Specifications:  
 Inlet Kit w/ 1/2" NPT Shanks, Washers, Nuts & 24" Flexible Supply Hoses

Product Compliance:  
 ASME A112.18.1 / CSA B125.1  
 NSF 61 - Section 9  
 NSF 372 (Low Lead Content)