

3/4-14 UN
Female Outlet

3/4-14 UN
Female Inlet

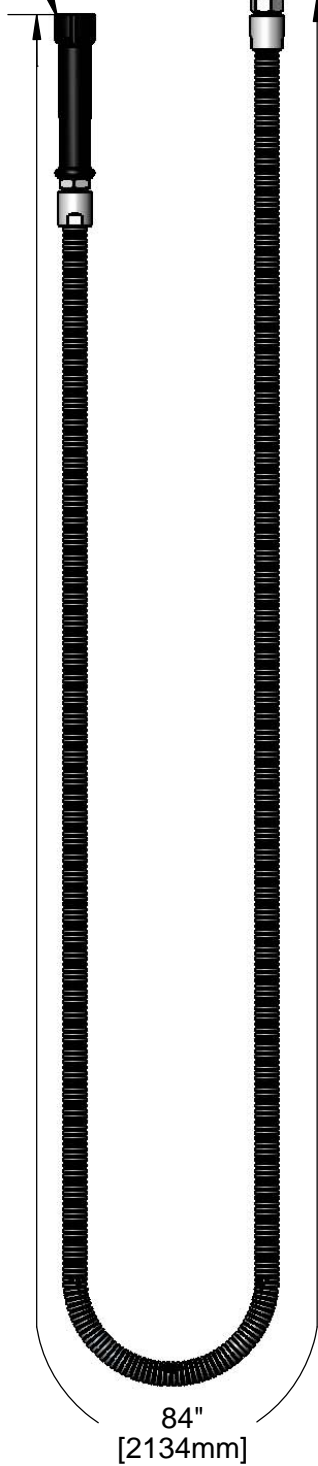

84"
[2134mm]

This Space for Architect/Engineer Approval

Job Name _____ Date _____

Model Specified _____ Quantity _____

Customer/Wholesaler _____

Contractor _____

Architect/Engineer _____



(2) 010476-45
Washers Furnished
w/ Hose

Model Number

5HSE84

Product Specifications:

84" Flexible Stainless Steel Hose w/ Black Handle & Polyurethane Inner Hose

Product Compliance:

ASME A112.18.1 / CSA B125.1
NSF 61 - Section 9
NSF 372 (Low Lead Content)

equip
Foodservice
Accessories

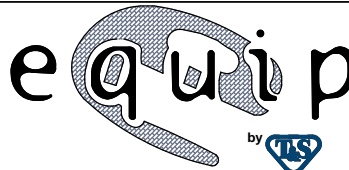

2 Saddleback Cove, P.O. Box 1088
Travelers Rest, South Carolina 29690
Phone: 800.891.4808 Fax: 800.868.0084
equip.tsbrass.com

Drawn: JBC

Checked: JRM

Approved: JHB

Date: 08/08/17

Scale: 1:6

Sheet: 1 of 2

ITEM NO.	SALES NO.	DESCRIPTION
1	001014-45	Washer, B-0100 Hose Barrel
2	000729-40	Nut, 7/8-20 Male x 3/4-14 Female
3	010476-45	#27 Washer

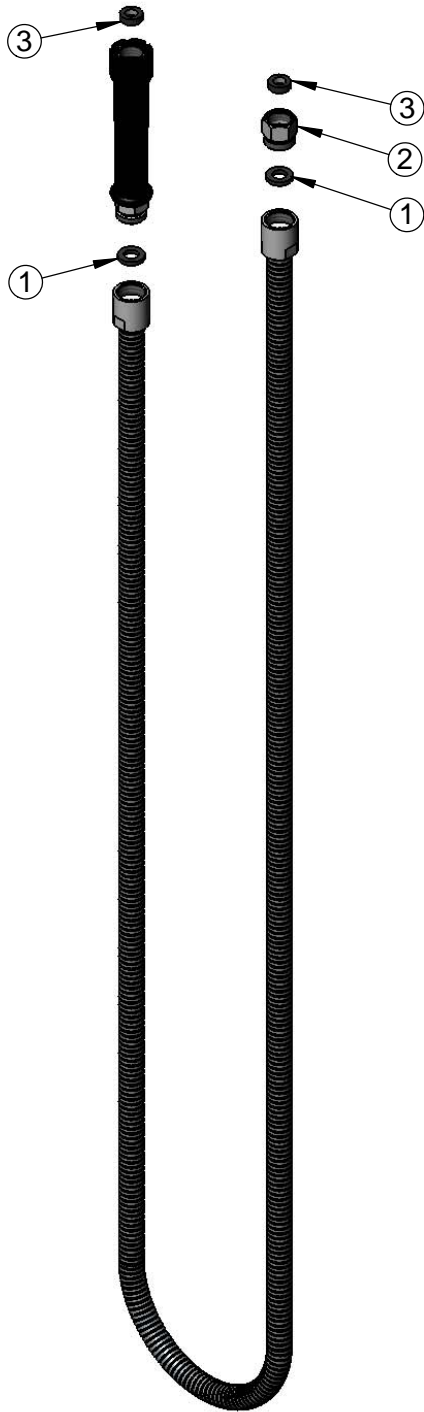

Model Number

5HSE84

Product Specifications:

84" Flexible Stainless Steel Hose w/ Black Handle & Polyurethane Inner Hose

Product Compliance:

ASME A112.18.1 / CSA B125.1
NSF 61 - Section 9
NSF 372 (Low Lead Content)

equip
Foodservice
Accessories

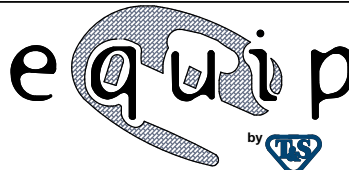

2 Saddleback Cove, P.O. Box 1088
Travelers Rest, South Carolina 29690
Phone: 800.891.4808 Fax: 800.868.0084
equip.tsbrass.com