



# T&S BRASS AND BRONZE WORKS, INC.

2 Saddleback Cove / P.O. Box 1088  
Travelers Rest, SC 29690

Model No.

**012436-45DR**

Item No.

Travelers Rest, SC: 800-476-4103 • Simi Valley, CA: 800-423-0150 • Fax: 864-834-3518 • www.tsbrass.com

This Space for Architect/Engineer Approval

Job Name \_\_\_\_\_ Date \_\_\_\_\_

Model Specified \_\_\_\_\_ Quantity \_\_\_\_\_

Customer/Wholesaler \_\_\_\_\_

Contractor \_\_\_\_\_

Architect/Engineer \_\_\_\_\_

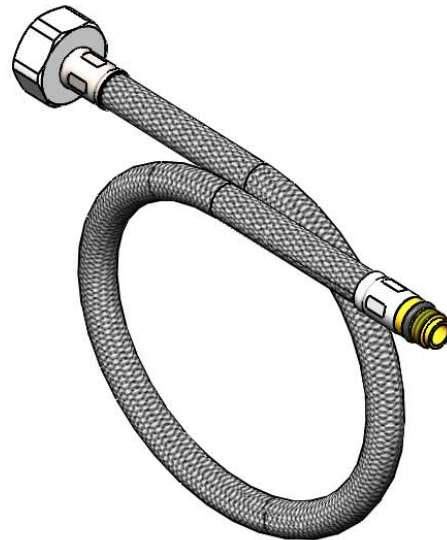

G1/2 (1/2 BSPP)  
Female Swivel Nut  
(Compatible w/  
1/2" NPSM Threads)



19 11/16" Long Flexible Hose.  
Stainless Steel Outer Braid on  
Flexible Portion of Hose

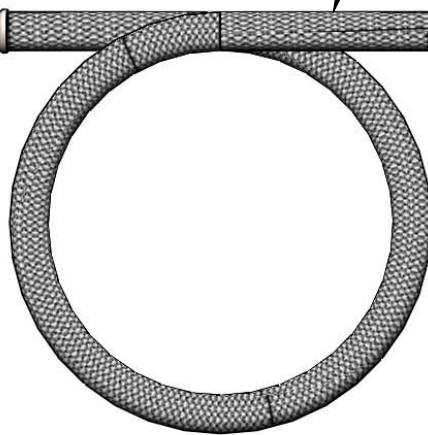

M10 x 1g  
Male Fitting with O-ring



**Product Specifications:**

DR Flexible Supply Hose  
G1/2 Female X M10 x 1 Male

**Product Compliance:**

ASME A112.18.6 / CSA B125.6  
NSF 61 - Section 9  
NSF 372 (Low Lead Content)  
WRAS Approved Product (UK)  
Singapore PUB Compliant  
Dezincification Resistant