

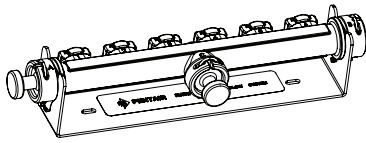

EVERPURE® SIMPLIFLOW™ WATER MANAGEMENT SYSTEM

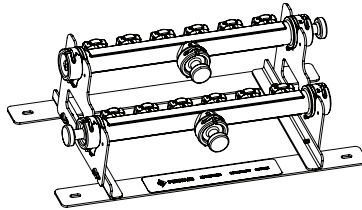

Single System



Twin System

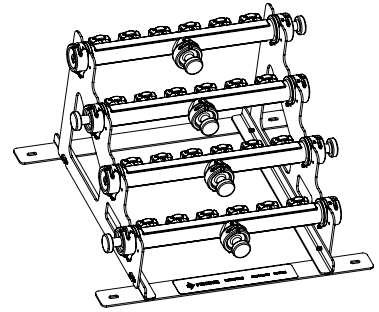

Quad System

INTRODUCTION

The Everpure SimpliFlow™ is a water line management manifold system. The labels and assorted valves are used to organize and identify water movement.

INSPECTION

Before assembling the SimpliFlow manifold, inspect the parts. Use the table and illustration to verify the parts and quantities. If any parts are missing, contact Customer Service at 630.307.3000 or by email at CSeverpure@pentair.com.

Parts	Single	Single Split	Twin	Quad
1. Sideplate	—	—	2	2
2. Frame	1	1	1	1
3. Port Manifold	1	1	2	4
4. Retaining Pin	3	3	6	12
5. Inlet Plug	2	1	4	8
6. Tapping Screw	2	2	8	12
7. SimpliFlow Asst. Sticker Sheet	1	1	2	4
8. Lubricant Packet	2	2	4	8

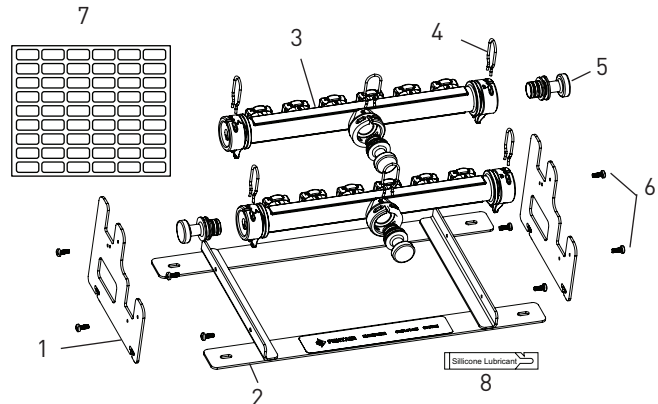

SELECTING A LOCATION

The location selected for system installation should allow for:

- Adequate space for “in” and “out” water line connections.
- Mounting screws should anchor into a solid structure.
- The frame is designed to mount on 16 inch (40.6 cm) centers (wall studs).

OPERATING SPECIFICATIONS

- Temperature Limits: 35-100°F (2-38°C)
- Pressure Maximum: 125 psi (8.6 bar)
- For cold water use only.

DIMENSIONS

	Single & Single Split	Twin	Quad
Base (Provide clearance for tubing)*			
L x W x H inch (cm)	4.5 x 18 x 3 (11.4 x 45.7 x 7.6)	9 x 18 x 5.8 (22.8 x 45.7 x 14.7)	16 x 18 x 10 (40.6 x 45.7 x 25.4)
Mounting Holes			
Side to Side inch (cm)	9 (22.8)	16 (40.6)	16 (40.6)
Top to Bottom inch (cm)	—	7.5 (19)	14.5 (36.8)
Size inch (mm)	0.250 x 0.625 (6.3 x 15.8)		

*Can be mounted on wall studs 16 inches (40.6 cm) apart.

INSTALLATION INSTRUCTIONS

1. Insert screws halfway.
2. Position sideplates over screws and shift forward or back to move the screw to the end of the slot. Tighten the screws.

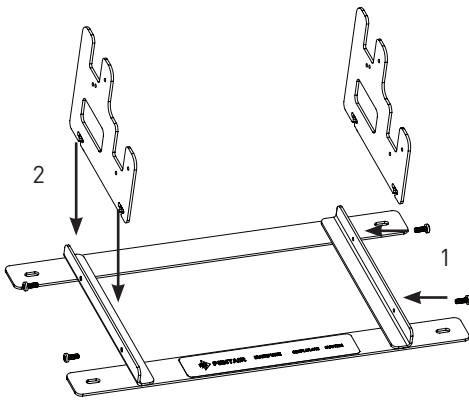

Figure 1

3. Rotate manifold to line up slot with one of the screw holes.
4. Insert screws (one each end) and tighten.

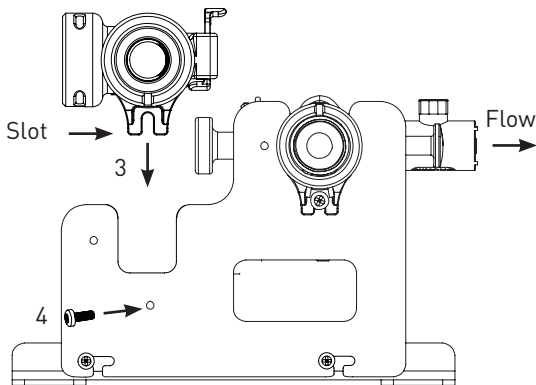

Figure 2

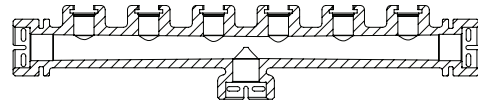

Figure 3 Cross Section of the Single Manifold

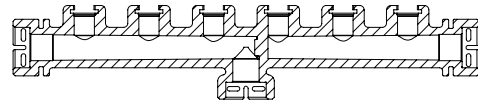
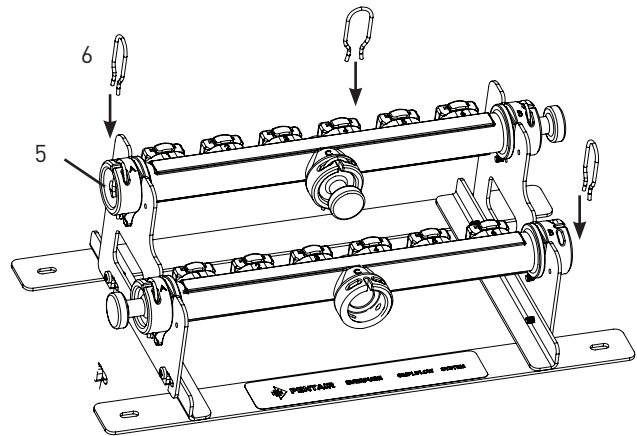

Figure 4 Cross Section of the Single Split Manifold

NOTE: All inlet and outlet fittings must use two o-rings. Before inserting the fitting into the opening, clean the contact area and apply clean silicone grease to both o-rings. Select fittings for all inlet ports (three per manifold). Ports that will not be connected must be plugged. All fittings must have two o-rings in place.

5. Push fittings and valves in and insert retaining clip completely.



Inlet Fitting Options (ordered separately)

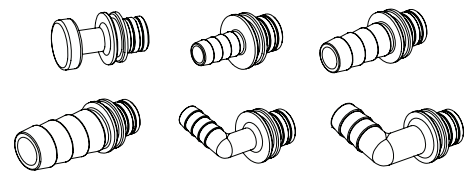

Figure 5

6. Select fittings for all outlet ports (six per manifold). Ports that will not be connected must be plugged. All fittings and valves must have two o-rings in place.
7. Slide blue clamp to open position and insert fitting or valve to full depth. Slide blue clamp to the closed position. The blue clamp will "click" into place when fully locked.

8. Use sticker sheet to identify outlets.

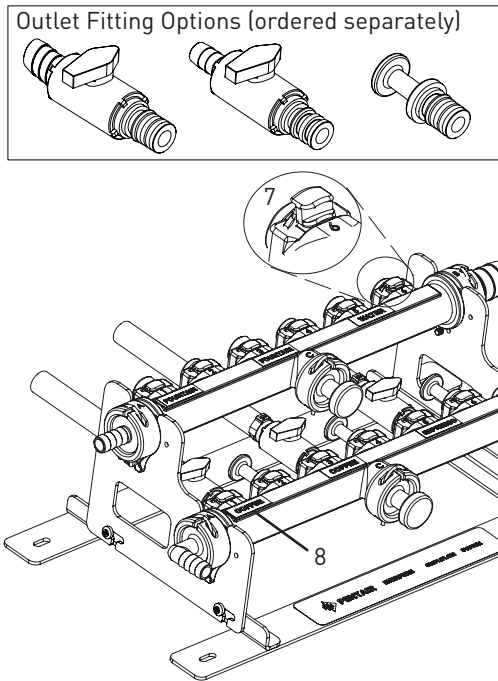

Figure 6

9. Mount the SimpliFlow manifold securely.

10. Install tubing for the application. All tubing should be cut to proper length. The tubing should not push with force on any of the fittings or valves.

REPLACEMENT PARTS

Contact your local Pentair® Everpure dealer for system replacement parts.

Number	Part Number	Description
1	EV306416	Tap Screw #10-32 x 1/2 410 SS
2	EV313518	Retaining Pin
3	EV313552	1/2" Barb Ball Valve
4	EV313609	3/8" Barb Ball Valve
5	EV313535	1/2" Barb Elbow Fitting
6	EV313534	1/2" Barb Straight Fitting
7	EV313600	3/4" Barb Elbow Fitting
8	EV313550	3/4" Barb Straight Fitting
9	EV313589	1" Barb Straight Fitting
10	EV313549	Outlet Plug
11	EV313548	Inlet Plug
12	5-042-111	Small o-ring, (for outlet fittings)
13	5-042-630	Large o-ring, (for inlet fittings)
14	SH143495	Lubricant Packet
Not Shown	EV313716	Inlet Plug w 1/8" NPT Port
Not Shown	EV313717	SimpliFlow Assorted Sticker Sheet

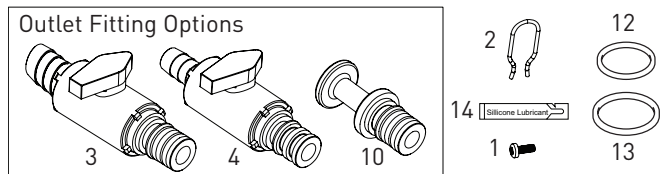
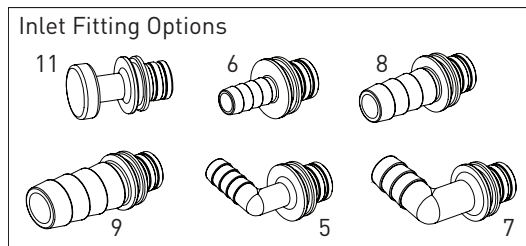

LIMITED WARRANTY

SIMPLIFLOW™ WATER MANAGEMENT SYSTEMS

****This unit is for use with cold, non-carbonated water only.****

You have just purchased one of the finest water management systems made. As an expression of confidence in this product, Pentair Filtration Solutions, LLC ("PFS") offers the following product warranty. This product is warranted against material defects in materials and workmanship to the original end-user when installed in accordance with the PFS specifications. The warranty period commences on the date of purchase and is administered as follows:

For a period of ONE YEAR	Replaceable elements (valves and fittings)*
For a period of TWO YEARS	Manifolds and brackets

The unit must be used in operating conditions that conform to PFS's recommended guidelines. This warranty will not apply if the unit has been modified, repaired or altered by someone not authorized by PFS.

If a part described above is found to have a material defect in materials or workmanship within the specified warranty period, you should notify Everpure® technical service at the phone number listed below. Any part found materially defective within the terms of this warranty will be repaired or replaced (at PFS's discretion) by your local dealer or Everpure technical service. You pay only freight from our factory and local dealer charges. Any item repaired or replaced pursuant to this warranty will be covered under the original warranty terms of the system.

PFS is not responsible for damage caused by accident, fire, flood, freezing, Act of God, misuse, misapplication, neglect, oxidizing agents (such as chlorine, ozone, chloramines and other related components), alteration, installation or operation contrary to our printed instructions, or by the use of accessories or components which do not meet PFS's specifications. Use only Everpure valves with this system. Use of non-Everpure valves will void this warranty. Refer to the specifications section in the Installation and Operating manual for approved application parameters.

TO THE EXTENT PERMITTED BY LAW, PFS DISCLAIMS ALL OTHER EXPRESS AND IMPLIED WARRANTIES, INCLUDING WITHOUT LIMITATION WARRANTIES OF MERCHANTABILITY AND FITNESS FOR PARTICULAR PURPOSE. OUR OBLIGATIONS UNDER THIS WARRANTY ARE LIMITED TO THE REPAIR OR REPLACEMENT (AT OUR DISCRETION) OF THE FAILED PART(S) OF THE UNIT, AND WE ASSUME NO LIABILITY WHATSOEVER FOR DIRECT, INDIRECT, INCIDENTAL, CONSEQUENTIAL, SPECIAL, GENERAL OR OTHER DAMAGES.

Some states do not allow the exclusion of implied warranties or limitations on how long an implied warranty lasts, so the above limitation may not apply to you. Similarly, some states do not allow the exclusion of incidental or consequential damages, so the above limitation or exclusion may not apply to you. This warranty gives you specific legal rights, and you may also have other rights which vary from state to state.

*Warranty applies to material defects in materials & workmanship only.

Everpure Technical Support:

Phone: 1-800-942-1153 (US Only) • 630-307-3000 Main

Email: servicespecialist@pentair.com



WATER SOLUTIONS

EVERPURE-SHURFLO WORLD HEADQUARTERS, 1040 MUIRFIELD DRIVE, HANOVER PARK, IL 60133 USA • WWW.EVERPURE.COM
800.942.1153 (US ONLY) • 630.307.3000 MAIN • 630.307.3030 FAX • CSEVERPURE@PENTAIR.COM EMAIL

EVERPURE-SHURFLO AUSTRALIA, 2 REDWOOD DRIVE, NOTTING HILL, VICTORIA, 3168, AUSTRALIA
011.61.39.574.4000 TEL • 011.61.39.562.7237 FAX • AU.EVERPURE@PENTAIR.COM EMAIL

EVERPURE-SHURFLO CHINA, 21F CLOUD 9 PLAZA, NO 1118, SHANGHAI, 200052, CHINA
86.21.3211.4588 TEL • 86.21.3211.4580 FAX • CHINA.WATER@PENTAIR.COM EMAIL

EVERPURE-SHURFLO INDIA, GREEN BOULEVARD, B-9/A, 7TH FLOOR - TOWER B SECTOR 62, NOIDA - 201301
91.120.419.9444 TEL • 91.120.419.9400 FAX • INDIACUSTOMER@PENTAIR.COM EMAIL

EVERPURE-SHURFLO EUROPE, PENTAIR WATER BELGIUM BVBA, INDUSTRIEPARK WOLFSTEE, TOEKOMSTLAAN, 30 B-2200 HERENTALS, BELGIUM
+32.(0).14.283.500 TEL • +32.(0).14.283.505 FAX • SALES@EVERPURE-EUROPE.COM EMAIL

EVERPURE-SHURFLO JAPAN INC., HASHIMOTO MN BLDG. 7F, 3-25-1 HASHIMOTO, MIDORI-KU, SAGAMIHARA-SHI KANAGAWA 252-0143, JAPAN
81.(0)42.775.3011 TEL • 81.(0)42.775.3015 FAX • INFO@EVERPURE.CO.JP EMAIL

EVERPURE-SHURFLO SOUTHEAST ASIA, 18 BOON LAY WAY, #04-110/111, TRADEHUB 21, 609966, SINGAPORE
65.6795.2213 TEL • FAX: 65.6795.2219 FAX • CSEVERPURE@PENTAIR.COM EMAIL

All Pentair trademarks and logos are owned by Pentair, Inc. All other brand or product names are trademarks or registered marks of their respective owners. Because we are continuously improving our products and services, Pentair reserves the right to change specifications without prior notice.

Pentair is an equal opportunity employer.

SimpliFlow and Everpure are trademarks of Pentair Filtration Solutions, LLC