

2M-Z5818, Split-Top Two Sided Grill

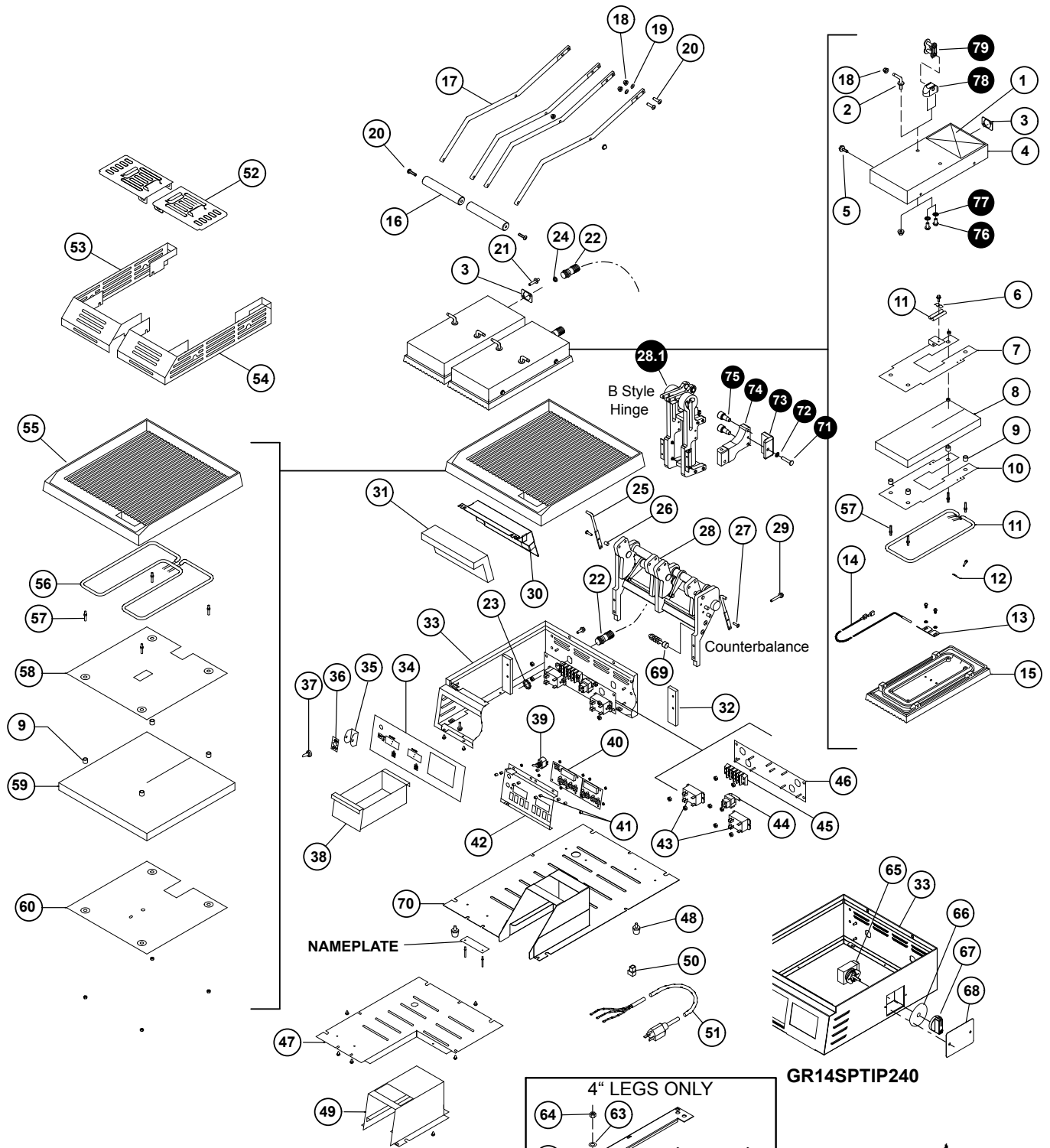

SOME ITEMS ARE INCLUDED FOR ILLUSTRATIVE PURPOSES ONLY AND IN CERTAIN INSTANCES MAY NOT BE AVAILABLE

This drawing contains information confidential to Star Manufacturing International, Inc. No reproduction or disclosure of its contents is permitted.

● = B Style Hinge Units Only

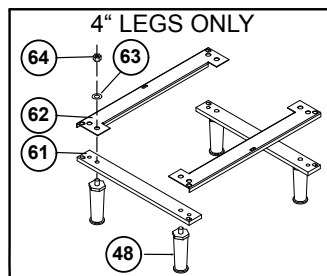

GR14SPTIP240



MODEL CG/GR14SPT

STAR MANUFACTURING INTERNATIONAL, INC.
SK1901 REV. H 9/14/2011

PARTS LIST

January 16, 2013, Rev N

CG14SPT, CG14SPTIG-120V, 120C, 230V & 240V, CG/GR14STE
 GR14SPTA, GR14SPTC, GR14SPTK-120V, 120C, 230V & 240V
 CG/GR14SPTI-240V, GR14SPTIP240 Split Lid Table Top Grill

MODEL _____

Item No	Part No	Qty	Description	Application
1	2M-Z2620	2	LABEL CAUTION, BI-LINGUAL	
2	2C-Z3200	4	PIN - TOP HOUSING	
3	2A-Z3827	2	PLATE, STAMPING CONDUIT	
4	D9-GR0181	2	TOP HOUSING & CONDUIT ASSEMBLY	
	D9-Z11716	1	TOP HOUSING, LT SPLT	CG14STKE-120, GR14STB, GR14STE, GR14STKE120C
	D9-Z11717		TOP HOUSING, RT SPLT	
5	2C-Z5883	8	10-24 X 1/2" FZA SCREW, TOP HOUSING	
6	B9-04-WB-0046	2	CLAMP WIRE SUPPORT	
7	D9-GR0182	2	TOP RETAINING PLATE ASSEMBLY	
8	D9-Z2133	2	INSULATION FIBERGLASS TOP	
9	2A-Z6604	12	SPACER - INSULATION PLATE	SPTC, SPTI
	2A-Z9514			
10	D9-Z3902	2	PLATE - TOP ELEMENT RETAINING	SPTC, SPTI
	D9-Z9513			
11	PS-Z9325	2	ELEMENT, HEATING, TOP 500W	120V
	PS-Z9326		ELEMENT, HEATING, TOP 500W 230/240V	SPT, SPTA, SPTC, SPTA, SPTG 230/240V
	PS-Z9521		ELEMENT, HEATING, TOP 700W	SPTI
	2N-Z13966		ELEMENT, 400W 120V SPT	CG14STE120CL
	2N-Z11709		ELEMENT, 650 WATT, 120V	CG14STKE, GR14STE, GR14STKE
	2N-Z14893		ELEMENT, 650W, 208V TOP STE	GR14STECB208
12	2C-Z3350	2	HALF CLAMP - .188 DIAMETER	
13	D9-Z3903	2	BRACKET, PROBE MOUNT	
14	2E-Z3278	2	RTD PROBE - 48" LONG WIRE - THERMISTOR	
15	PS-GR0356	2	KIT, 2F-Z3237 CASTING REPLACEMENT	SMOOTH - ALUM
	PS-GR0355		KIT, 2F-Z5615 CASTING REPLACEMENT	GROOVED - ALUM
	PS-GR0504		KIT, 2F-Z5615-1 COATED CASTING REP.	GROOVED - ALUM
	2F-Z9651		CASTING - TOP SMOOTH, CHROME	
	2F-Z8349	2	CASTING - TOP SMOOTH, IRON	CG14SPTIS240
		1		
2F-Z7967	2	CASTING - TOP GROOVE, IRON	CG14SPTIS240	
	1			
16	2V-Z3152	2	HANDLE	
17	2B-Z3336	4	14" CG14SPT ARM	
	2B-Z9515		ARM	SPTC, SPTI
	2B-Z10355		ARM	CG14SPTK-120/240V, GR14SPTKM-UK
	2B-Z12554	2	ARM, LEFT ST	CG14STKE-120, GR14STB, GR14STE, GR14STKE120C
	2B-Z12555		ARM, RIGHT ST	CG14STKE-120, GR14STB, GR14STE, GR14STKE120C
18	2C-40637	12	ACORN NUT, 1/4-20 CAP MS	
19	2C-08-07-0262	8	WASHER 1/4 INT STL NP	
20	2C-Z2992	12	BOLT 1/4-20X1 PHP STL NP	Used w/Fig. No 28
	2C-1523	4	.250-20UNC X 0.75 LG RHP SCREW	Used w/Fig. No 28.1
	2C-08-07-0262		.250 INTERNAL TOOTH LOCK WASHER	
			ADD LOCKTITE 242 TO THREADS	
21	2C-Z3917	4	RIVET, POP,	
22	2E-Z2898	2	CONDUIT ASSEMBLY	

2M-Z5818, Split-Top Two Sided Grill

**IMPORTANT: WHEN ORDERING, SPECIFY VOLTAGE OR TYPE GAS DESIRED
 INCLUDE MODEL AND SERIAL NUMBER**

PAGE 1
 OF 4

Some items are included for illustrative purposes only and in certain instances may not be available.



Star International Holdings, Inc.

PARTS LIST

January 16, 2013, Rev N

CG14SPT, CG14SPTIG-120V, 120C, 230V & 240V
GR14SPTA, GR14SPTC, GR14SPTK-120V, 120C, 230V & 240V

MODEL CG/GR14SPTI-240V, GR14SPTIP240 Split Lid Table Top Grill

Item No	Part No	Qty	Description	Application
23	2E-Z3768	2	LOCKNUT, CONDUIT 1/2"	
24	2C-Z3780	4	RETAINER, CONDUIT	
25	2V-Z3252	2	TOP HOUSING LATCH ROD	
26	2A-Y6142	4	SLEEVE HANDLE	
27	2C-1516	4	SCREW 10-24 X 1" STL RH NP, LATCH ROD	
28	2R-Z3345	1	COUNTER BALANCE - SPLIT TOP	
28.1	PS-GR0536	2	KIT, HINGE & SPRING, 14SPLT	CG14STE, CG14STKE, GR14STB, GR14STE,GR14STKE120C
29	2C-Z2593	4	SCREW - 10-24X1 1/2 SL HX/W NP	
30	D9-Z11677	1	INSULATION BAFFLE ASSEMBLY	
31	D9-Z3826	1	INSULATION - BAFFLE	
32	2A-Z6484	2	PLATE (COUNTER BALANCE MOUNT)	
33	D9-GR0152	1	BODY ASSEMBLY	CG14SPTK-120/240V
	D9-GR0393			GR14SPTIP
	D9-GR0394		BODY ASSY - 14" CG/CG14	GR14STE
	D9-GR0507		BODY ASSY 14" SPT	GR14STB
	D9-GR0461			
34	2M-Z5817	1	OVERLAY-STANDARD	CG14SPT, CG14SPTI, CG14STE, GR14SPTA, GR14SPTC, GR14SPTI, GR14SPB,. GR14STE, GR14SPTT
	2M-Z3337		OVERLAY	GR14SPT-120/240V & CUL
	2M-Z10851			CG14SPTK-120/240V
	2M-Z11984			GR14STE-120
	2M-Z11983			GR14STE-120V
	2M-Z10087			GR14STKE120C, GR14SPTK-120, GR14SPTKM
35	Z1-70-07-0343	1	SWITCH GUARD	
36	2M-12-07-0038	1	LABEL ON & OFF	
37	2I-05-07-0013	1	BOOT SWITCH	
38	D9-GR0518	1	GREASE DRAWER ASSY: FLAT FRONT	CG14SPTK, CG14STE
	D9-GR0517		GREASE DRAWER ASSY: SLOPED FRONT	GR14SPTKG120, GR14STKE, GR14SPTKM
39	2E-Z3808	1	SWITCH TOGGLE	
40	2J-Z3263	1	TIME/TEMP CONTROL+HRDW (Taco Bell Only)	GR14SPT-120/240/CUL, GR14STB-120/240V, GR14STE-120V, CG14SPT-120/230/240V, GR14SPT-CE
	2J-Z6323		CONTROLLER, TIME/TEMP (C - F)	CG14SPT, CG14SPTI, CG14STE, GR14SPTA, GR14SPTC, GR14SPTI, GR14STE, GR14SPT120/240V/ CUL
	2J-Z13327		TIME/TEMP CONTROL F/C	GR14STECB208
	D9-GR0387		CONTROL PROGRAMMING	CG14SPTK-120/120C/240V
	D9-GR0483		CONTROL PROGRAMMING	GR14SPTIP240
	D9-GR0380		CONTROL PROGRAMMING	GR14SPTK-120/120C/240, GR14SPTKG120/240, GR14SPTKM120/240, GR14STKE120C
	D9-GR0539		CONTROL PROGRAMMING	GR14SPTKM-UK
	D9-GR0533		TIME/TEMP CONTROL F/C	GR14SPTT120V
	D9-GR0653		CTRL PGM, PITA PIT	GR14STEPP
41	2K-Z1971	14	SPACER	

2M-Z5818, Split-Top Two Sided Grill

**IMPORTANT: WHEN ORDERING, SPECIFY VOLTAGE OR TYPE GAS DESIRED
INCLUDE MODEL AND SERIAL NUMBER**

PAGE 2
OF 4

Some items are included for illustrative purposes only and in certain instances may not be available.



Star International Holdings, Inc.

PARTS LIST

January 16, 2013, Rev N

CG14SPT, CG14SPTIG-120V, 120C, 230V & 240V

GR14SPTA, GR14SPTC, GR14SPTK-120V, 120C, 230V & 240V

MODEL CG/GR14SPTI-240V, GR14SPTIP240 Split Lid Table Top Grill

Item No	Part No	Qty	Description	Application
42	D9-GR0151	1	FACEPLATE ASSEMBLY	
	D9-GR0382		FACEPLATE ASSEMBLY	CG14SPTK
43	2E-Z3335	2	RELAY DOUBLE POLE-SINGLE THROW	
		3		GR14STECB208
44	2E-05-07-0350	1	TRANSFORMER 230V/10V 6VA	230V
	2E-05-07-0351		TRANSFORMER 115/10V 6VA	
45	2E-Z2894	1	TERMINAL BLOCK (304)	
46	D9-GR0156	1	REAR PLATE ASSEMBLY	
47	D9-Z3259	1	BASE BOTTOM	CG14SPTID240, GR14SPTA-CE
	D9-Z10086			
48	2A-Z12980	4	2.5" FOOT BASE	SPTC, SPTI, SPTIP
	2A-Z11500		4" NON SKID FOOT BASE	SPTC, SPTI
	2A-Z11501		FOOT 1" SOLID RUBBER	CG14SPTK, GR14SPTG
49	D9-GR0150	1	GREASE CABINET ASSEMBLY	CG14SPTID240
	D9-GR0034			GR14SPTA-CE
50	2K-Y6764	1	BUSHING - STRAIN RELIEF	
51	2E-Z4119	1	CORD POWER	120V
	D9-GR0193		CORD POWER	120C
	D9-GR0194		CORD POWER	240V
	2E-Y9251		CORD SET CONT EUR 16AMP	CG14SPT-230V between 1-15-01 thru 8-16-04
	2E-Z2905		CORD POWER	CG14SPT-230V, GR14STE-230, CG14SPTI-230
	2E-Z9192		CORDSET (DETACHABLE) - UK	SPTI- 240V
52	D9-GR0189	2	TOP BURN GUARD ASSEMBLY	
53	D9-GR0177	1	BURN GUARD ASSEMBLY - LEFT	
	D9-GR0501		BURN GUARD, LT WELD ASSY	CG14STKE-120, GR14STB, GR14STE, GR14STKE120C
	D9-GR0335			CG14SPTI-230
54	D9-GR0176	1	BURN GUARD ASSEMBLY - RIGHT	
	D9-GR0500		BURN GUARD, RT WELD ASSY	CG14STKE-120, GR14STB, GR14STE, GR14STKE120C
	D9-GR0334			CG14SPTI-230
55	PS-GR0361	1	KIT, 2F-Z1945, CASTING SM REPLACEMENT	GR SERIES (NON-SPTI)
	PS-GR0362		KIT, 2F-Z1947, CASTING GR REPLACEMENT	CG SERIES (NON-SPTI)
	PS-GR0503		KIT, 2F-Z1947, COATED CASTING GR REPL	CG SERIES (NON-SPTI)
	2F-Z9653		CASTING - SMOOTH BOTTOM, CHROME	SPTC
	PS-GR0363		KIT, 2F-Z1949, CSTNG - BOTTOM, IRON	GR14SPTI
	PS-GR0364		KIT, 2F-Z1951, CSTNG - GROOVE, IRON	CG14SPTI
56	2N-Z9324	1	ELEMENT, HEATING, BTM	120V
	2N-Z9327		ELEMENT, HEATING, BTM 1300 W	230V-240V (NON-SPTI)
	2N-Z9520		ELEMENT, HEATING, BTM 2150 W	SPTI 230/240V
	2N-Z13967		ELEMENT, 1100W, 120V-14B	CG14STE120CL
	2N-Z14894		ELEMENT, 1800W, 208V BTM	GR14STECB208
57	2C-08-07-0285	12	SCREW 10-24 x 3/4 x 3/8	
58	D9-Z13338	1	BOTTOM ELEMENT RETAINING PLATE	
	D9-Z9701		BOTTOM ELEMENT RETAINING PLATE	SPTC

2M-Z5818, Split-Top Two Sided Grill

IMPORTANT: WHEN ORDERING, SPECIFY VOLTAGE OR TYPE GAS DESIRED

INCLUDE MODEL AND SERIAL NUMBER

PAGE 3

OF 4

Some items are included for illustrative purposes only and in certain instances may not be available.



Star International Holdings, Inc.

PARTS LIST

January 16, 2013, Rev N

CG14SPT, CG14SPTIG-120V, 120C, 230V & 240V

GR14SPTA, GR14SPTC, GR14SPTK-120V, 120C, 230V & 240V

MODEL CG/GR14SPTI-240V, GR14SPTIP240 Split Lid Table Top Grill

Item No	Part No	Qty	Description	Application
59	D9-Z2888	1	INSULATION - 14"	
60	D9-Z13338	1	BOTTOM INSULATION RETAINING PLATE	
61	2V-Z3027	2	CROSS SUPPORT	SPTC, SPTI
62	D9-Z9516	2	SUPPORT BRACKET, LEGS	SPTC, SPTI
63	2C-08-07-0262	4	WASHER 1/4 INT STL NP	SPTC, SPTI
64	2C-Z2992	4	BOLT 1/4-20X1 PHP STL NP	SPTC, SPTI
65	2T-6447	1	THERMOSTAT 118V-236V	SPTIP
66	2M-Z11301	1	LABEL - DIAL	SPTIP
67	2R-Z4621	1	KNOB, 1-3/4 - .250"D"HOLE	SPTIP
68	D9-Z11304	1	PLATE, COVER	SPTIP
69	PS-GR134	AR	KIT, BEARING ASSY, COUNTER BALANCE	
70	D9-GR0520	1	BASE ASSY / GREASE CABINET	CG14SPT, CG14SPTI, CG14SPTIG, GR14SPTA, GR14SPTC, GR14SPTI, GR14SPTIP, GR14STB, GR14SPTE
	D9-GR0522			CG14SPTK, CG14STKE, GR14SPTK, GR14SPTKM120, GR14STKE
71	2C-1516	4	#10-24 UNC X 1.00 LG RHP SCREW	CG14STE, CG14STKE, GR14STB, GR14STE, GR14STKE120C
72	2C-6260	4	#10 INTERNAL TOOTH LOCK WASHER	
73	2A-Z12620	4	SPACER BLOCK	
74	2F-Z11943	2	BRACKET LT, ROLLER MOUNT	ALL B VERSION SPLIT TOP
	2F-Z11944		BRACKET RT, ROLLER MOUNT	
75	2C-Z13975	8	CAM FOLLOWER ASSY, B VERS HNG	ALL B VERSION HNG
76	2C-1512	8	SCREW 10-24X3/8 RHP STL NP	B SERIES UNITS
77	2C-6260	8	WASHER #10 INT STL NP	B SERIES UNITS
78	2V-Z11388	4	LINK ASSY BASE, TOP HOUSING	B SERIES UNITS
79	2A-Z11676	4	CHAIN LINK, 50SS	B SERIES UNITS
NI	D9-Z11977	1	PLATE, BASE CONDUIT	CG142TB, CG14B, CG14E, CG14IB, CG14IGTB, CG14ITB, CG14ITGTB, CG14ITLB, CG14ITSC, CG14TB, GR14B, GR14E, GR14E, GR14IB, GR14ITB, GR14SNB, GR14TB, CG14STKE, GR14STB, GR14STE, GR14STKE
NI	2E--Y9253	1	INLET IEC 320 16 AMP	CG14SPTI-230

2M-Z5818, Split-Top Two Sided Grill

**IMPORTANT: WHEN ORDERING, SPECIFY VOLTAGE OR TYPE GAS DESIRED
INCLUDE MODEL AND SERIAL NUMBER**

PAGE 4
OF 4

Some items are included for illustrative purposes only and in certain instances may not be available.



Star International Holdings, Inc.