

JetStar® JetStar® JetStar® JetStar® JetStar®

JetStar® POPCORN CART

MODEL
JPC-4/6

Installation and Operation Instructions

2M-Z7691 Rev.D 12/16/05

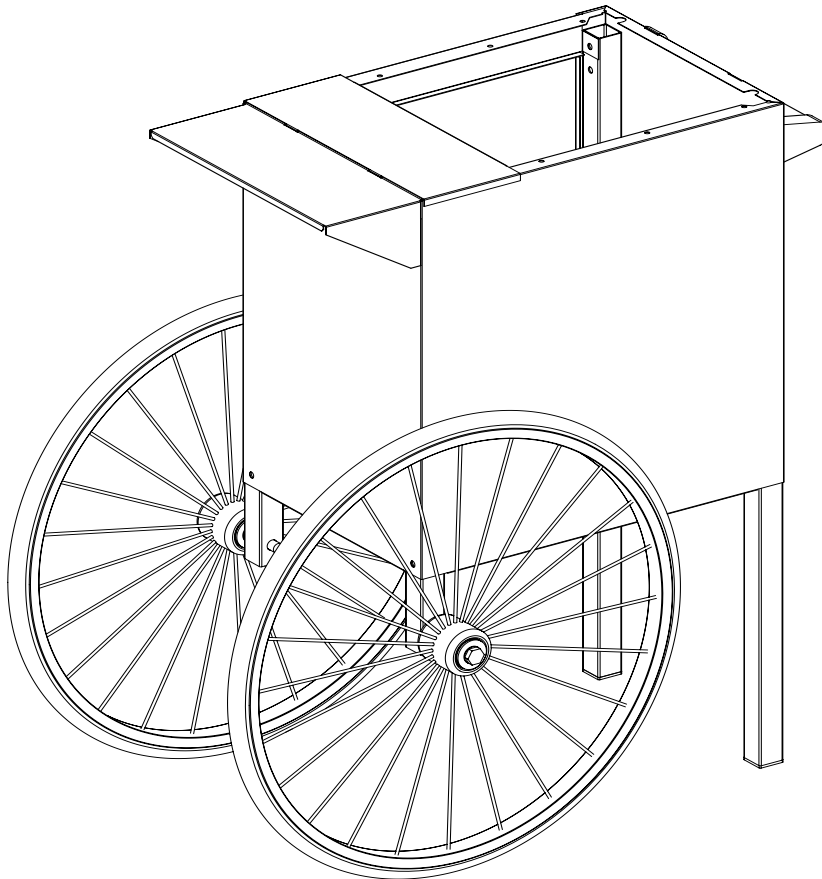

JPC-4/6



IMPORTANT

Before assembling your new equipment, read and understand all the instructions & labels associated with the unit prior to putting it together.

All shipping containers should be checked for freight damage both visible and concealed. This unit has been carefully packaged to insure delivery of your unit in perfect condition. If equipment is received in damaged condition, either apparent or concealed, a claim must be made with the delivering carrier.

Concealed damage or loss - if damage or loss is not apparent until after equipment is unpacked, a request for inspection of concealed damage must be made with carrier within 15 days. Be certain to retain all contents plus external and internal packaging materials for inspection. The carrier will make an inspection and will supply necessary claim forms.

ASSEMBLY INSTRUCTIONS FOR JETSTAR POPPER CART

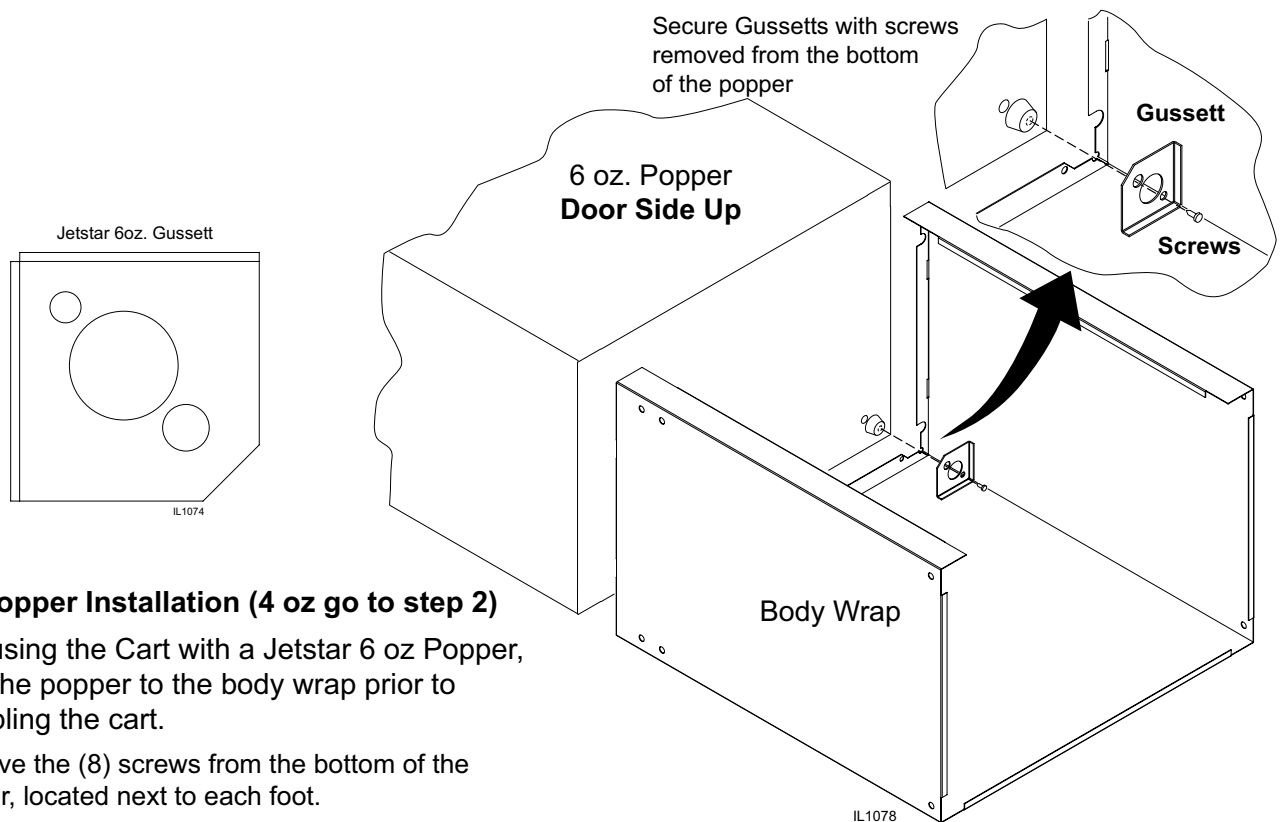

1. 6 oz. Popper Installation (4 oz go to step 2)

When using the Cart with a Jetstar 6 oz Popper, attach the popper to the body wrap prior to assembling the cart.

- Remove the (8) screws from the bottom of the popper, located next to each foot.
- Position the body wrap so the top faces the bottom of the popper, as shown.
- Locate the (4) 6 oz Gussetts as shown, and secure them in place with the previously removed screws from the bottom of the popper.

2. Bottom Shelf & Leg Post

When using the Cart with a Jetstar 4 oz. Popper, assemble the cart prior to attaching the popper.

- Begin by positioning the Bottom Shelf to the Body Wrap as shown.
- Slide the Leg Posts into position on the left side.
- Line up the holes in the Leg Post with the holes on the Bottom Shelf and Body Wrap.
- Secure with one 1/4-20 bolt, washer, and nut per leg.
- Install the Black Plastic Leg Plugs into position as shown.

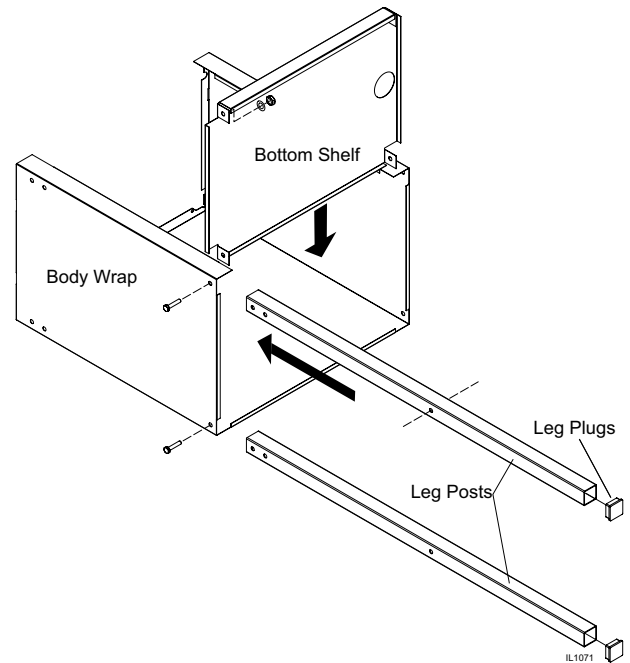

3. Handle & Handle Support

- Attach one Handle Support (a) with the open end facing in the up position and secure it with: **TWO** 1/4-20 bolts and washers.
- Place the Handle and remaining Handle Support (b) in position and secure with: **ONE** 1/4-20 bolt and washer in the lower of the two holes.

Do not install the second 1/4-20 bolt or washer on the top side at this time.

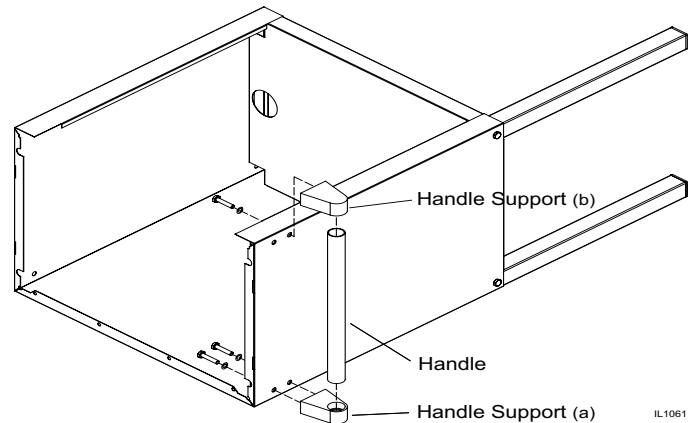

4. Wheel Post

- Slide the Wheel Posts into position as shown.
- Line up the holes in the Leg Post with the holes on the Bottom Shelf and Body Wrap.
- Attach to the Body Wrap & Bottom Shelf with one 1/4-20 bolt, washer, and nut per post.

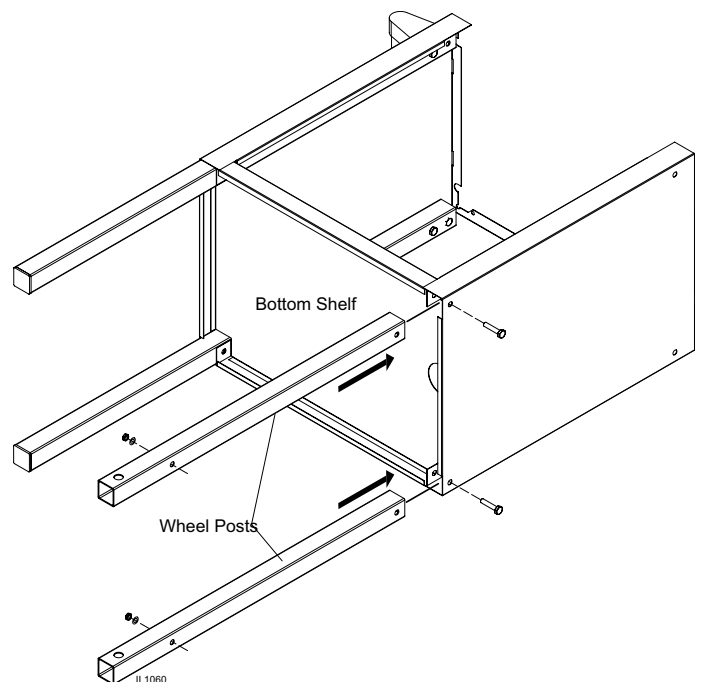

5. Shelf Installation

- Position the Shelf by inserting shelf tabs into the Body Wrap
- Align the holes in the Shelf, Body Wrap, and Wheel Post.
- Attach with one 1/4-20 bolt, washer, and nut as shown.

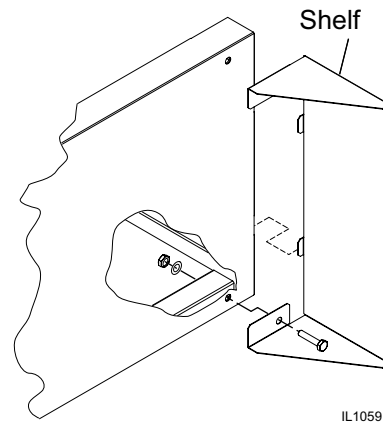

6. Top Rear Trim

- Position the Top Rear Trim as shown.
- Secure using two 1/4-20 bolts, washers, and nuts.

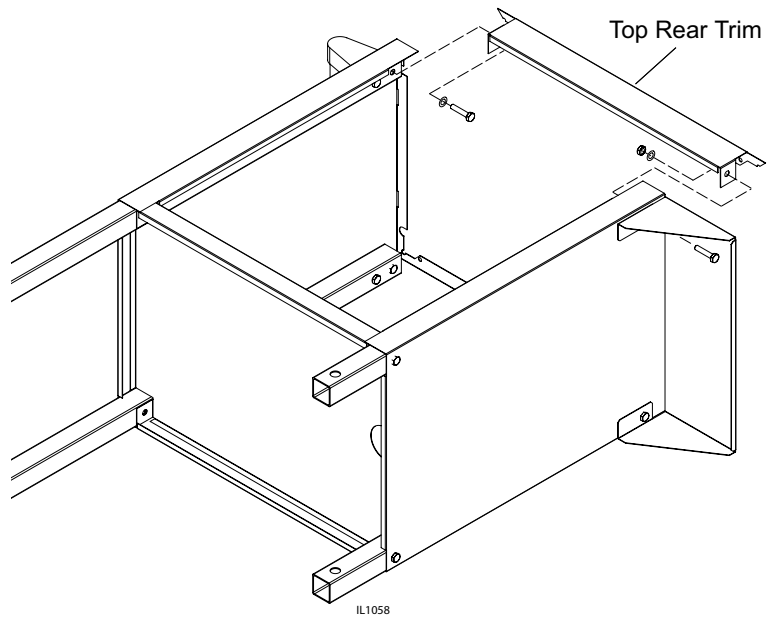

7. Wheel Installation

- Position the cart so the Wheel Posts are suspended as shown.
- Install the Wheels as shown using two 1/2-13 x 4-3/4 Axle Bolts and Locknuts.

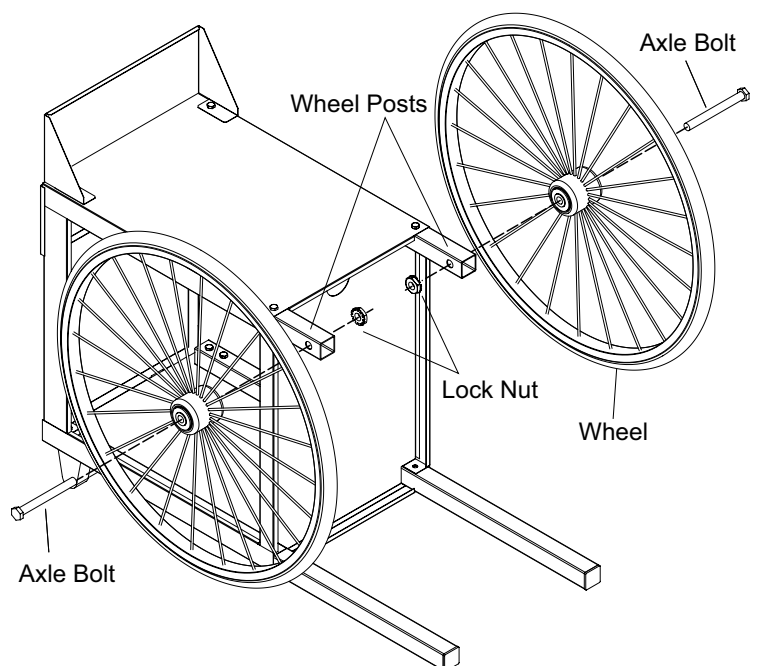

9. Final Cart Assembly

- With help from another person, carefully lift the Cart into an upright position.
- Insert the Snap Bushing into position on the lower shelf.

Mini-Jetstar Only:

Place the Mini-JetStar Shelf into position as shown, by sliding the tabs into the appropriate grooves. The panel may be attached to either the left or right side.

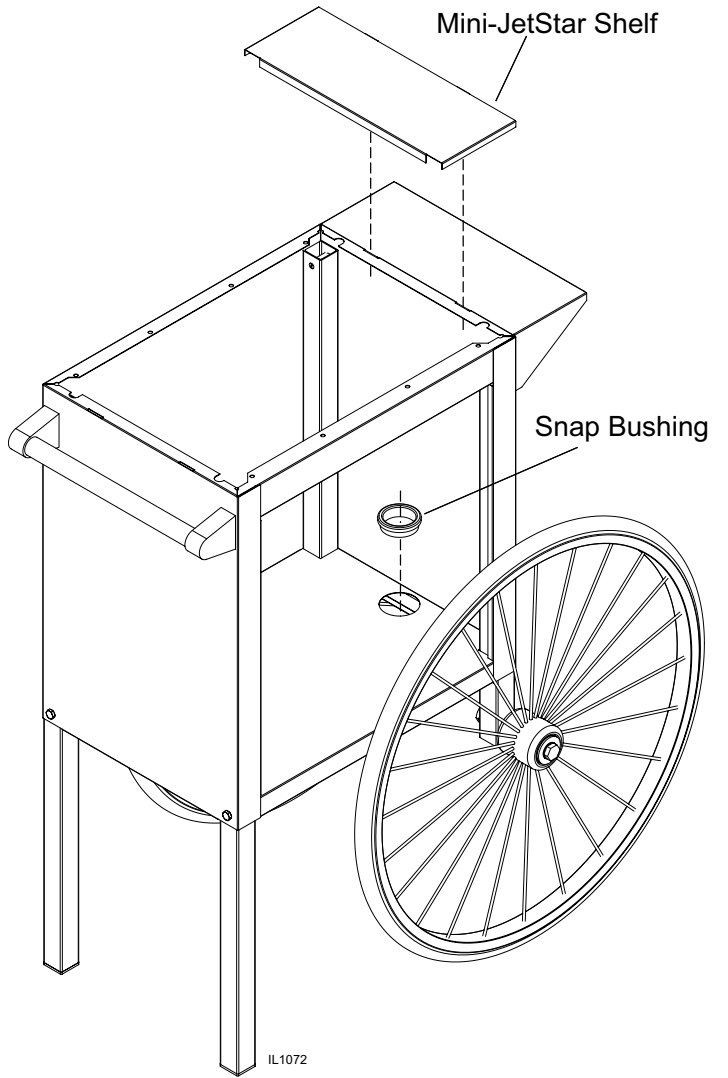

10. Popper to Cart Installation (4 oz Only)

- Remove (8) screws located next to the feet on the popper. These will be used to secure the popper to the cart.
- Place the popper on top of the cart,
- Make sure to place the cord and unit legs inside the top opening.
- Reaching in through the side opening, place the correct Gusset for your model in place (as shown), securing the popper to the cart using the screws removed.
- Pull the power cord through the Snap Bushing and follow the operating instructions provided with your popper.

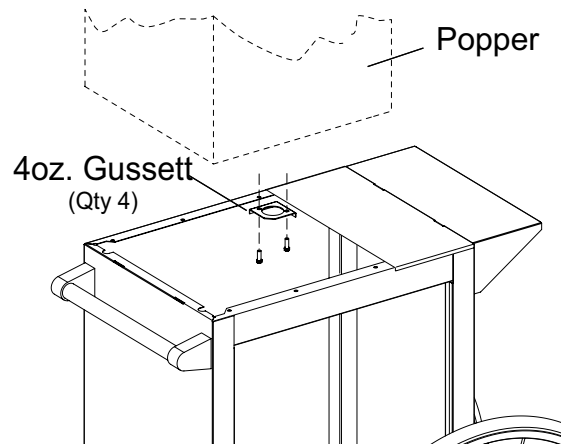
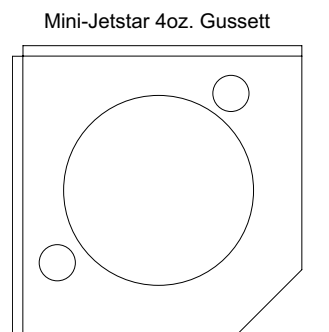

THOROUGHLY INSPECT YOUR UNIT ON ARRIVAL

This unit has been tested for proper operation before leaving our plant to insure delivery of your unit in perfect condition. However, there are instances in which the unit may be damaged in transit. In the event you discover any type of damage to your product upon receipt, you must immediately contact the transportation company who delivered the item to you and initiate your claim with same. If this procedure is not followed, it may affect the warranty status of the unit.

LIMITED EQUIPMENT WARRANTY

All workmanship and material in Star products have a one (1) year limited warranty on parts & labor in the United States and Canada. Such warranty is limited to the original purchaser only and shall be effective from the date the equipment is placed in service. Star's obligation under this warranty is limited to the repair of defects without charge, by the factory authorized service agency or one of its sub-agencies. Models that are considered portable (*see below*) should be taken to the closest Star service agency, transportation prepaid.

- > Star will not assume any responsibility for loss of revenue.
- > On all shipments outside the United States and Canada, see International Warranty.
- * The warranty period for the JetStar series six (6) ounce popcorn machines is two (2) years.
- * The warranty period for the Chrome-Max Griddles is five (5) years on the griddle surface. See detailed warranty provided with unit.
- * The warranty period for Teflon/Dura-Tec coatings is one year under normal use and reasonable care. This warranty does not apply if damage occurs to Teflon/Dura-Tec coatings from improper cleaning, maintenance, use of metallic utensils, or abrasive cleaners. This warranty does not apply to the "non-stick" properties of such materials.
- > This warranty does not apply to "Special Products" but to regular catalog items only. Star's warranty on "Special Products" is six (6) months on parts and ninety (90) days on labor.
- > This warranty does not apply to any item that is disassembled or tampered with for any purpose other than repair by a Star Authorized Service Center or the Service Center's sub-agency.
- > This warranty does not apply if damage occurs from improper installation, misuse, wrong voltage, wrong gas or operated contrary to the Installation and Operating instructions.
- > This warranty is not valid on Conveyor Ovens *unless* a "start-up/check-out" has been performed by a Factory Authorized Technician.

PARTS WARRANTY

Parts that are sold to repair out of warranty equipment are warranted for ninety (90) days. The part only is warranted. Labor to replace the part is chargeable to the customer.

SERVICES NOT COVERED BY WARRANTY

- | | |
|--|---|
| 1. Travel time and mileage rendered beyond the 50 mile radius limit | 10. Voltage conversions |
| 2. Mileage and travel time on portable equipment (<i>see below</i>) | 11. Gas conversions |
| 3. Labor to replace such items that can be replaced easily during a daily cleaning routine, ie; removable kettles on fryers, knobs, grease drawers on griddles, etc. | 12. Pilot light adjustment |
| 4. Installation of equipment | 13. Miscellaneous adjustments |
| 5. Damages due to improper installation | 14. Thermostat calibration and by-pass adjustment |
| 6. Damages from abuse or misuse | 15. Resetting of circuit breakers or safety controls or reset buttons |
| 7. Operated contrary to the Operating and Installation Instructions | 16. Replacement of bulbs |
| 8. Cleaning of equipment | 17. Replacement of fuses |
| 9. Seasoning of griddle plates | 18. Repair of damage created during transit, delivery, & installation OR created by acts of God |

PORTABLE EQUIPMENT

Star will not honor service bills that include travel time and mileage charges for servicing any products considered "Portable" including items listed below. These products should be taken to the Service Agency for repair:

- * The Model 510FD Fryer.
- * The Model J4R, 4 oz. Popcorn Machine.
- * The Model 518CMA & 526CMA Cheese Melter.
- * The Model 12MC & 15MC & 18MCP Hot Food Merchandisers.
- * The Model 12NCPW & 15NCPW Nacho Chip/Popcorn Warmer.
- * All Hot Dog Equipment **except Roller Grills & Drawer Bun Warmers.**
- * All Nacho Cheese Warmers **except Model 11WLA Series Nacho Cheese Warmer.**
- * All Condiment Dispensers **except the Model HPDE, & SPDE Series Dispenser.**
- * All Specialty Food Warmers **except Model 130R, 11RW Series, and 11WSA Series.**
- * All QCS/RCS Series Toasters **except Model QCS3 & RCS3 Series.**

ALL:

- * Pop-Up Toasters
- * Butter Dispensers
- * Pretzel Merchandisers
- * Pastry Display Cabinets
- * Nacho Chip Merchandisers
- * Accessories of any kind
- * Sneeze Guards
- * Pizza Ovens
- * Heat Lamps
- * Pumps

The foregoing warranty is in lieu of any and all other warranties expressed or implied and constitutes the entire warranty.

FOR ASSISTANCE

Should you need any assistance regarding the Operation or Maintenance of any Star equipment; write, phone, fax or email our Service Department. In all correspondence mention the Model number and the Serial number of your unit, and the voltage or type of gas you are using.

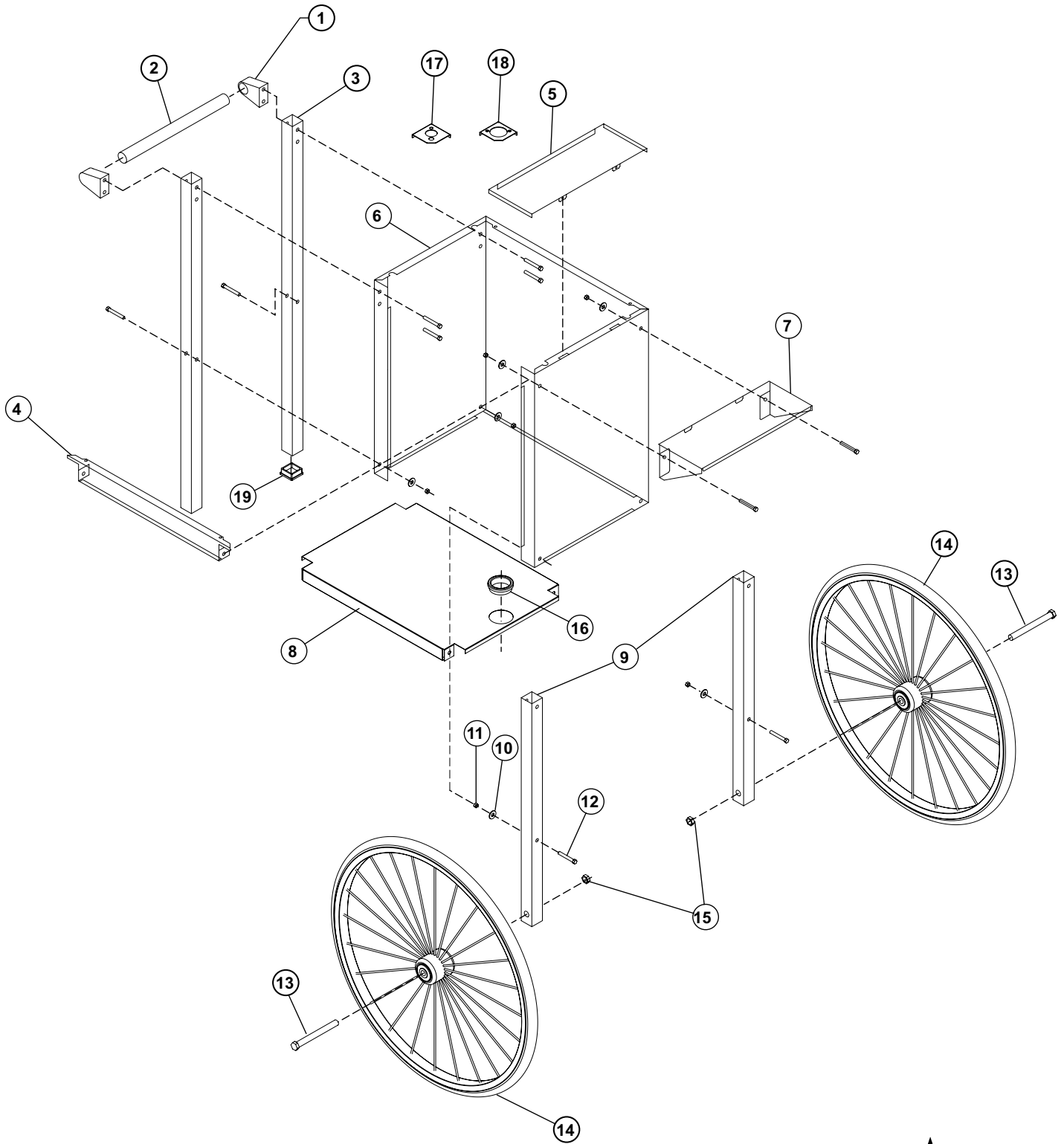

J4 POPCORN CART



SOME ITEMS ARE INCLUDED FOR ILLUSTRATIVE PURPOSES ONLY AND IN CERTAIN INSTANCES MAY NOT BE AVAILABLE

MODEL - 8C-JPC-4-6

STAR MANUFACTURING INTERNATIONAL, INC.

SK2060

REV. A

11/11/05

PARTS LIST

December 16, 2005, Rev D

MODEL Jetstar/Mini-Jetstar Popcorn Cart 8C-JPC-4/6

Key Number	Part Number	Number Per Unit	Description	
1	2R-Z7695	2	HANDLE SUPPORT - GOLD	
2	2A-Z7688	1	HANDLE	
3	2V-Z7681	2	LEG POST	
4	C3-Z7685	1	TRIM REAR TOP	
5	C3-Z7700	1	FILLER PANEL	
6	C3-Z7683	1	BODY WRAP	
7	C3-Z7690	1	SHELF	
8	C3-Z7682	1	BOTTOM SHELF	
9	2V-Z7680	2	WHEEL POST	
10	2C-Y9714	10	WASHER 1/4 FL STL ZP	
11	2C-Z2670	6	NUT 1/4-20	
12	2C-Z3154	10	BOLT 1/4-20 x 1-3/4 HEX	
13	2C-Z7684	2	AXLE BOLT 1/2-13 x 4-3/4	
14	2B-Y4752	2	WHEEL	
15	2C-Y4755	2	LOCKNUT 1/2-13 NYLON INSERT	
16	2K-Y8571	1	SNAP BUSHING	
17	C3-Z9131	4	CORNER GUSSET	Jetstar
18	C3-Z9132	4	CORNER GUSSET	Mini-Jetstar
19	2K-Z7879	2	PLUG, BLACK PLASTIC	

**IMPORTANT: WHEN ORDERING, SPECIFY VOLTAGE OR TYPE GAS DESIRED
INCLUDE MODEL AND SERIAL NUMBER**

PAGE 1
OF 1

Some items are included for illustrative purposes only and in certain instances may not be available.



Star Manufacturing International, Inc.