



**Star  
Manufacturing  
International Inc.**

10 Sunnen Dr.  
St. Louis, MO 63143

Phone: (314) 781-2777  
FAX: (314) 781-3636

**Installation  
and  
Operating  
Instructions**

2M-Z1192 Rev. -- 3/26/97

---

# **WAFFLE BAKER**

## **MODEL CWB**



# INSTALLATION AND OPERATING INSTRUCTIONS

## INSTALLATION

For your protection, we recommend that a qualified electrician install this appliance. The electrician should be familiar with electrical installations and your local electrical requirements. Proper connections and power supply are essential for efficient performance. The supply circuit should be properly fused as required by local electrical code.

A removable full coverage drip ring is packed with this unit. Plug into A.C. wall outlet. Be sure the line is the same voltage as that shown on the nameplate. Be sure system is grounded. The case to be connected to a ground, such as a water pipe. Use A.C. current only.

## LOAD

Full load 1650 Watts. Wire in receptacle must be heavy enough to carry this load, or waffle baker will be slow in performing. Have your power company or electrician check for proper voltage if you have difficulty.

## TREATED GRIDS

Grids are treated with a special process to prevent sticking for the initial break in period, but it is advisable to give them additional treatment as follows:

## OPERATING PROCEDURE

### TO BREAK IN WAFFLE GRIDS

Connect waffle baker to outlet. Turn power on. When pilot light goes out, take brush and spread a good brand of fresh frying oil lightly on both grids. Waffle baker should then be closed for five minutes. The pilot light will go off and on during this time. This indicates the baker is maintaining temperature.

## BAKING

Turn power on. When pilot light goes out, pour in batter to proper level, just enough to fill up the

lower grid. Set 0-5 minute bell timer to approximately 3-1/2 minutes. When bell rings, waffle will be finished. If darker waffle is required, set bell timer to longer time. DO NOT open grids during baking (while timer is running), as this will part the waffle and cause sticking. When the bell rings, the waffle is finished and should be removed from grids.

NOTE: After the bell rings, the waffle is removed and fresh batter is poured in. You will notice, it takes a little time before the pilot light goes back on again, as the heat is retained in the grids. The light will go on during the baking of the new waffle and will remain on until the new waffle is finished. During the idling period, leave grids closed to prevent drying out. The pilot light goes on and off while idling, indicating the baker is maintaining uniform temperature.

When you put your Toastswell waffle baker out of service for the day, turn the switch to "off" position. Leave the grids open until they cool. When putting baker in service again, be sure to preheat grids until pilot light goes out. You need the proper temperature to make waffles.

Season grids lightly with a good grade of cooking oil. Do not grease grids every time you make a waffle, doing so will build up a thick layer of carbon on the grids. This carbon cannot be removed easily. To prevent waffles from sticking, use shortening in the waffle batter. This will make waffles come out of the grids without sticking, provided the baker grids are at the proper temperature before the batter is put in.

Do not open baker until waffle stops steaming. Waffle is not done if steaming. If waffle baker lid is opened too soon, waffle will separate and stick to grids. Waffle baker uses 1650 Watts and it takes 10 minutes to preheat baker. Batter must never be put in baker until proper temperature of grids is reached. Starting from cold baker takes 10 minutes to preheat. Pilot light will go out when right temperature is reached. ONLY then should batter be put in baker. After baker is preheated and current

is left on, only then can batter be put in baker as soon as needed without waiting. After putting batter in lower grid, close top and be sure top grid is seated in bottom grid.

A thin, watery batter will take longer to cook than a thick batter, as a waffle is not done until the moisture is baked out. Therefore, to increase the speed of your baker, use a thicker batter. Do not fill grids with more batter than is needed to make a full waffle. If too much batter is used, you will make to thick a waffle, costing you more and taking longer to bake.

Do not store batter in refrigerator and expect same speed in baking, cold batter will be slow in baking. Thermostats will keep baker at proper temperature, ready for immediate serving if baker is allowed sufficient time to preheat first. If grids are not up to proper temperature, waffles will stick.

Do not press down on spring handle and let loose to shake out waffle. Doing so will damage thermostat and elements. Waffle will never stick if baker is at proper temperature when baking and batter has enough shortening in it.

## **CLEANING**

On bakers that do NOT have teflon coated grids, in order to remove carbon from grids, disconnect waffle baker from current, place cloth over bottom grid, soak with ammonia, close lid and leave over night. Next day, wire brush top and bottom grids to remove carbon. Then heat and season grids. This should not be done on teflon coated grids.

## **SERVICE**

If the waffle baker does not heat, check the cord and plug and wall receptacle for proper contact. Do not slam lid down or let loose of spring handles under tension as this may cause damage.

## **PREVENTATIVE MAINTENANCE**

Clean outside of baker every day that it is in use. Do not clean grids unless a buildup of carbon forms. In order to remove carbon from the grids, disconnect waffle baker from current, place cloth over the bottom grid, soak with ammonia,

close the lid, and leave overnight. Then clean off the residue and season the grids as described above. This should not be done on teflon-coated grids. If carbon buildup persists, You can order a grid cleaning kit which will remove even the heaviest carbon buildup.

## **REPAIR INSTRUCTION**

This unit is of the simplest design. The only repairs ever required are, replacement of thermostat, wires, cord, or bottom element which can all be reached by removing bottom plate. The top element can be reached by removing one center screw on top of grid. Before any repair is made, disconnect cord from power supply to prevent shock.

## **CORD PLUG AND GROUNDING INSTRUCTIONS**

For your protection, this appliance is equipped with a 3 conductor load cord, having a grounding type plug. A special grounding adaptor is available to permit the use of this appliance with conventional 2 wire receptacles on 115V only. To use the adaptor, first determine if this system is grounded. For grounded electrical systems, connect the green wire of the adaptor to a mounting screw on the receptacle. For ungrounded electrical systems, attach the green wire of adaptor to a known permanent ground.

## **MAINTENANCE AND REPAIRS**

Contact the factory or one of its representatives or a local service company for service or maintenance if required.

RETAIN THIS MANUAL FOR FUTURE REFERENCE  
Part No. 2M-71192 Rev. - 4/4/97

**WAFFLE BAKER**  
**TROUBLE SHOOTING GUIDE**

<b>TROUBLE</b>	<b>CAUSE</b>	<b>REMEDY</b>
Bakes waffle too slow	Mix or batter too cold - just out of refrigerator	Allow mix to come to room temperature before baking
	Temperature set too low	Adjust thermostat or replace thermostat grid. Thermostat should be 400 to 420 after 2 cycles with grids open
	Line voltage too low	Have line voltage checked
Pilot light does not go on or unit does not heat	Defective pilot light switch or defective switch	Replace pilot light or switch
	Defective cord or defective internal wire	Check cord and wiring -- replace if necessary
Waffle sticks to grids	Grids not seasoned correctly	Season grids with cooking oil
	Mix or batter not a good mix	Experiment with different mix. Add some shortening to mix.
Bakes waffle only on one side	Element burned out	Replace element

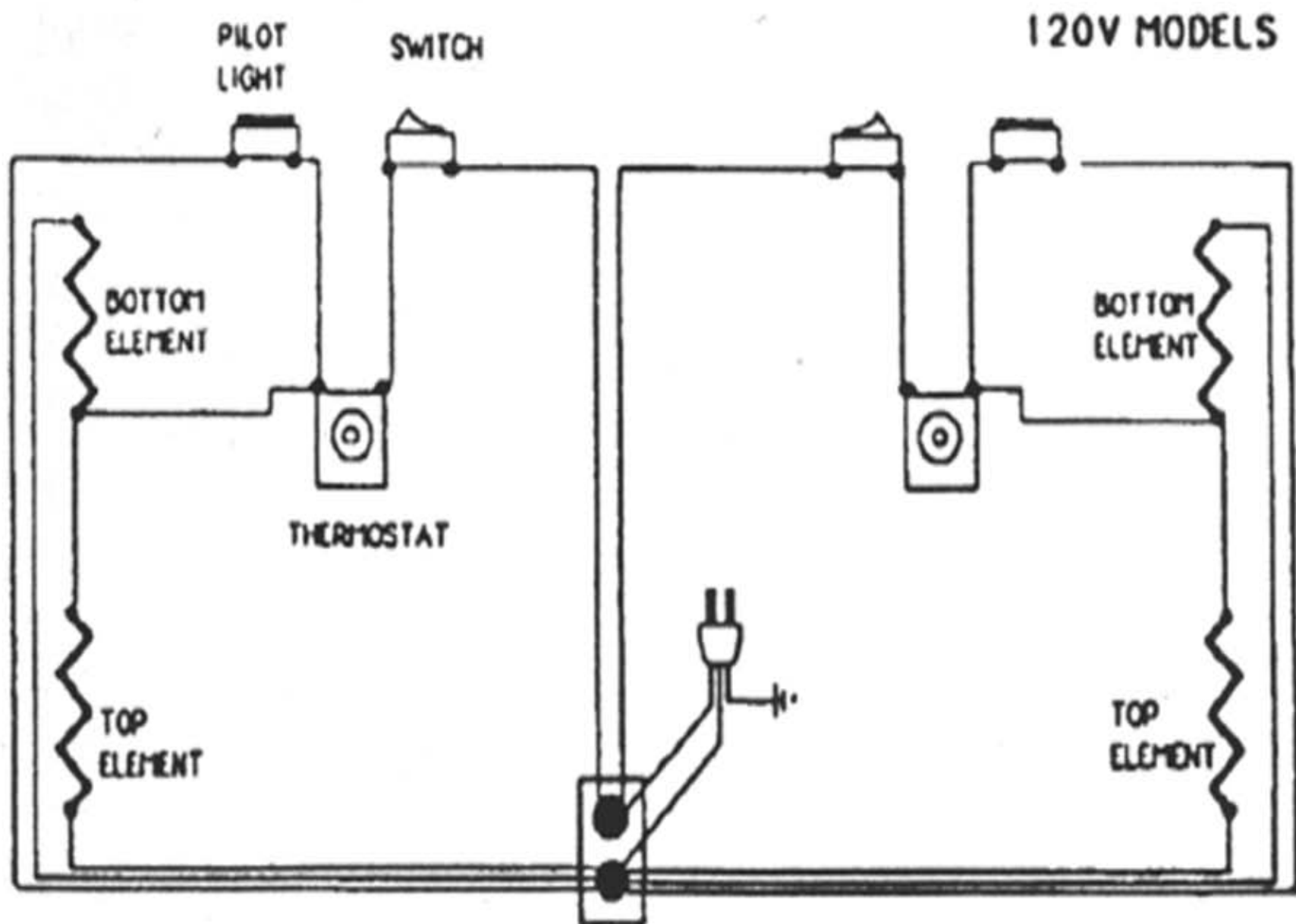

**TO CHANGE FROM 120V TO 240V, YOU CHANGE WIRING FROM SERIES TO PARALLEL, CHANGE CORD, AND PILOT LIGHT. THIS TO BE DONE ONLY AT THE FACTORY.**

**TO CHANGE FROM 120V TO 240V, YOU CHANGE WIRING F  
SERIES TO PARALLEL, CHANGE CORD, AND PILOT LIGHT.  
THIS TO BE DONE ONLY AT THE FACTORY.**

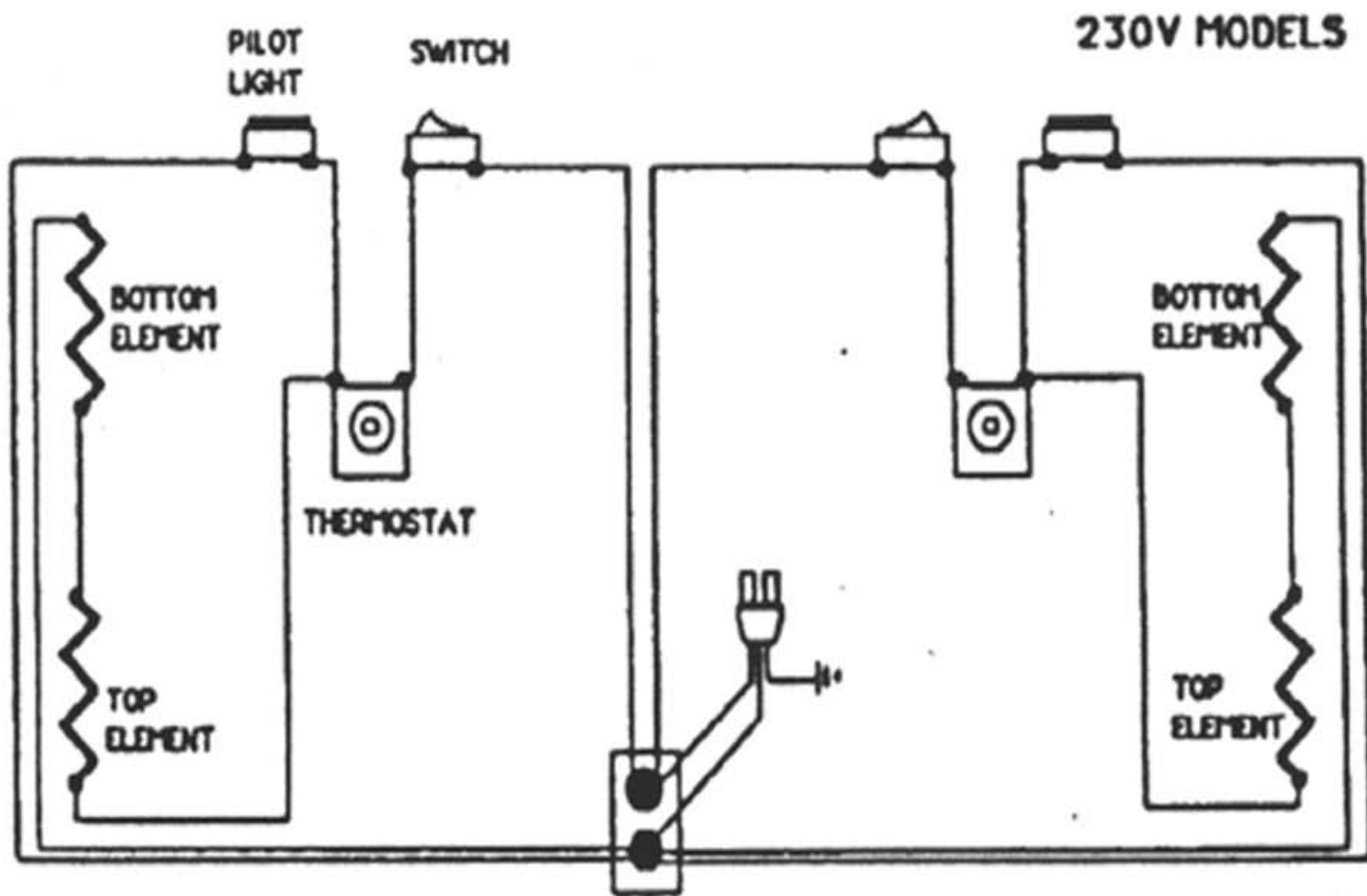

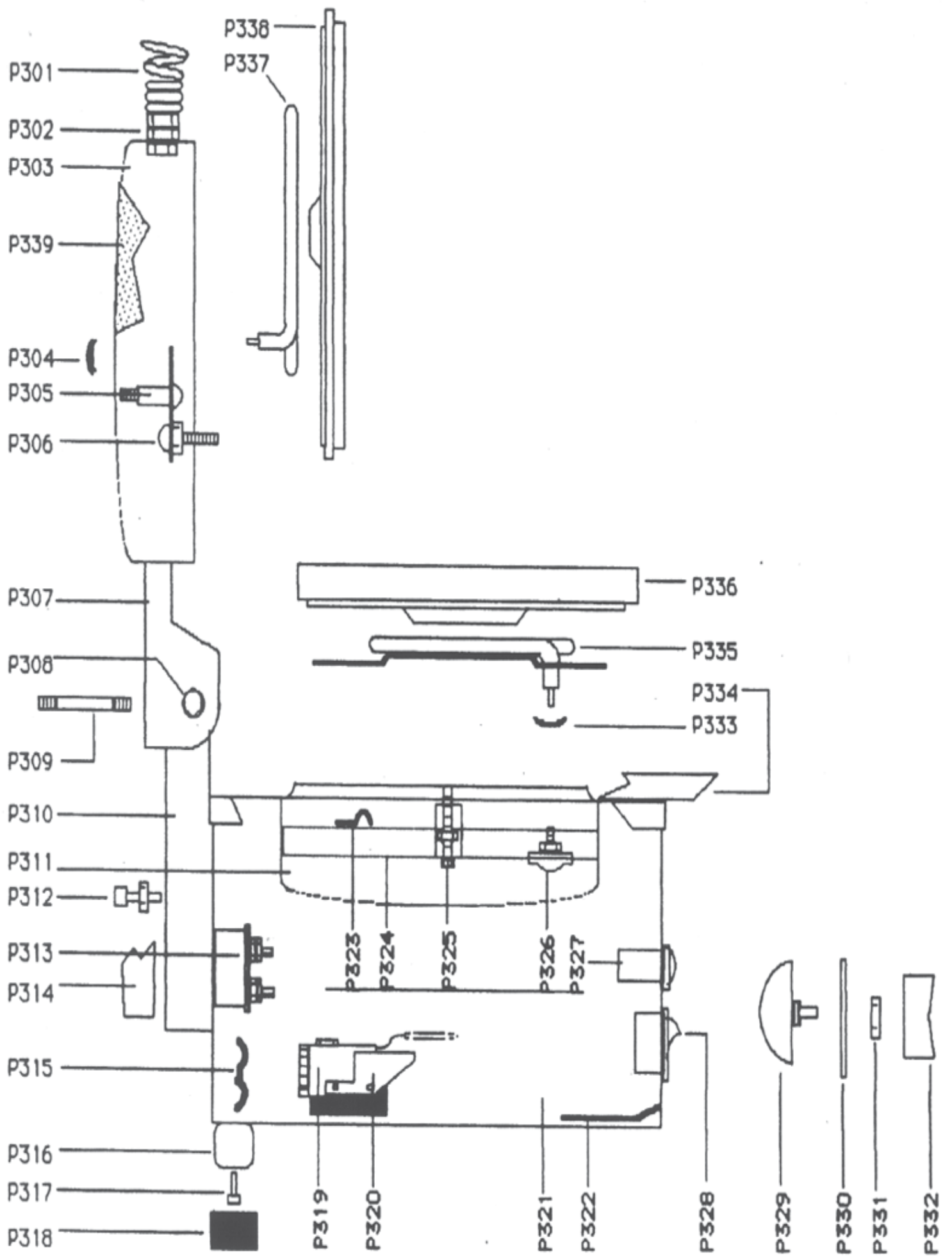

MODEL **9B-CWB2**

Key Number	Part Number	Number Per Unit	Description
P301	<a href="#">B9-70-WB-0003</a>	1	Spring Handle
P302	2C-08-07-0260	1	Palnut for Spring Handle
P303	<a href="#">B9-04-WB-0077</a>	1	Top Cup
P304	<a href="#">2P-09-WB-0003</a>	1	Button
P305	<a href="#">B9-30-WB-0119</a>	1	Spacer and Pointed Screw
P306	<a href="#">2C-8833</a>	1	Locator Screw
P307	<a href="#">B9-04-WB-0200</a>	1	Top Hinge Arm
P308	Unknown - NLA	1	Large Acorn Nut, 1/4-20
P309	B9-70-WB-0198	1	Rod, 1/4-20
P310	B9-04-WB-0220	1	Back Wire Channel
P310a	<a href="#">B9-04-WB-0221</a>	1	Cover, Wire Channel
P311	B9-04-WB-0009	1	Bottom Cup
P312	Unknown - NLA	1	Adjusting Nut and Bolt
P313	<a href="#">2E-05-07-0250</a>	1	Terminal Assembly
P314	B9-04-WB-0007	1	Back Small Cover
P315	Unknown - NLA	1	Wire Clamp
P316	<a href="#">Z1-70-07-0006</a>	4	Metal Leg
P318	<a href="#">2A-09-07-0076</a>	4	Plastic Cap for Metal Leg
P319	<a href="#">B9-40-WB-0155</a>	1	S & W Thermostat w/Hardware
	<a href="#">2T-05-WB-0055</a>	1	Selco Products Thermostat w/o Hardware (Vendor # CAP-380)
P320	<a href="#">2C-09-WB-0023</a>	1	Bracket for Thermostat
P321	B9-50-WB-0214	1	Case and Cover
P322	B9-51-WB-0023	1	Bottom Plate
P323	<a href="#">B9-04-WB-0046</a>	1	Wire Clamp
P324	<a href="#">B9-30-WB-0119</a>	1	Screw and Grid Spacer Assembly
P325	Unknown - NLA	1	
P326	2C-05-07-0041	1	Terminal Assembly for Front Arms
P327	<a href="#">B9-05-07-0006</a>	1	Pilot Light (120V)
	<a href="#">2J-05-07-0010</a>	1	Pilot Light (240V)
P328	<a href="#">2E-Y6144</a>	1	On/Off Switch
P329	<a href="#">2P-09-WB-0007</a>	1	Bell Timer
P330	<a href="#">2C-09-WB-0005</a>	1	Decal for Bell Timer
P331	<a href="#">2C-08-WB-0008</a>	1	Nut for Bell Timer
P332	<a href="#">2R-09-WB-0006</a>	1	Knob for Bell Timer
P333	<a href="#">2C-08-07-0147</a>	1	Element Clip
P334	<a href="#">B9-04-WB-0004</a>	1	Drip Tray
P335	<a href="#">B9-40-WB-0027</a>	1	Bottom Element Assembly, 475W (120V)
	<a href="#">B9-40-WB-0026</a>	1	Bottom Element Assembly, 410W (240V)
P336	<a href="#">B9-30-WB-0035</a>	1	Bottom Grid
P337	<a href="#">B9-40-WB-0026</a>	1	Top Element Assembly, 410W (120V)
	<a href="#">B9-40-WB-0027</a>	1	Top Element Assembly, 475W (240V)
P338	<a href="#">B9-30-WB-0034</a>	1	Top Grid
P339	<a href="#">2I-09-WB-0002</a>	1	Insulation
P340	Unknown - NLA	1	Box and Pads
NI	<a href="#">2Z-09-WB-2001</a>		Grid Cleaner
NI	<a href="#">2E-05-07-0005</a>		Lead-In-Cord, Nema #5-15P (120V)
NI	<a href="#">2E-05-07-0052</a>		Lead-In-Cord, Nema #6-15P (240V)

IMPORTANT: WHEN ORDERING, SPECIFY VOLTAGE OR TYPE GAS DESIRED  
INCLUDE MODEL AND SERIAL NUMBER

PAGE 1  
OF 1

Some items are included for illustrative purposes only and in certain instances may not be available.



Star Manufacturing International, Inc.