

EXPLODED VIEW: 530TF & 530TEF 30lb COUNTERTOP ELECTRIC FRYER

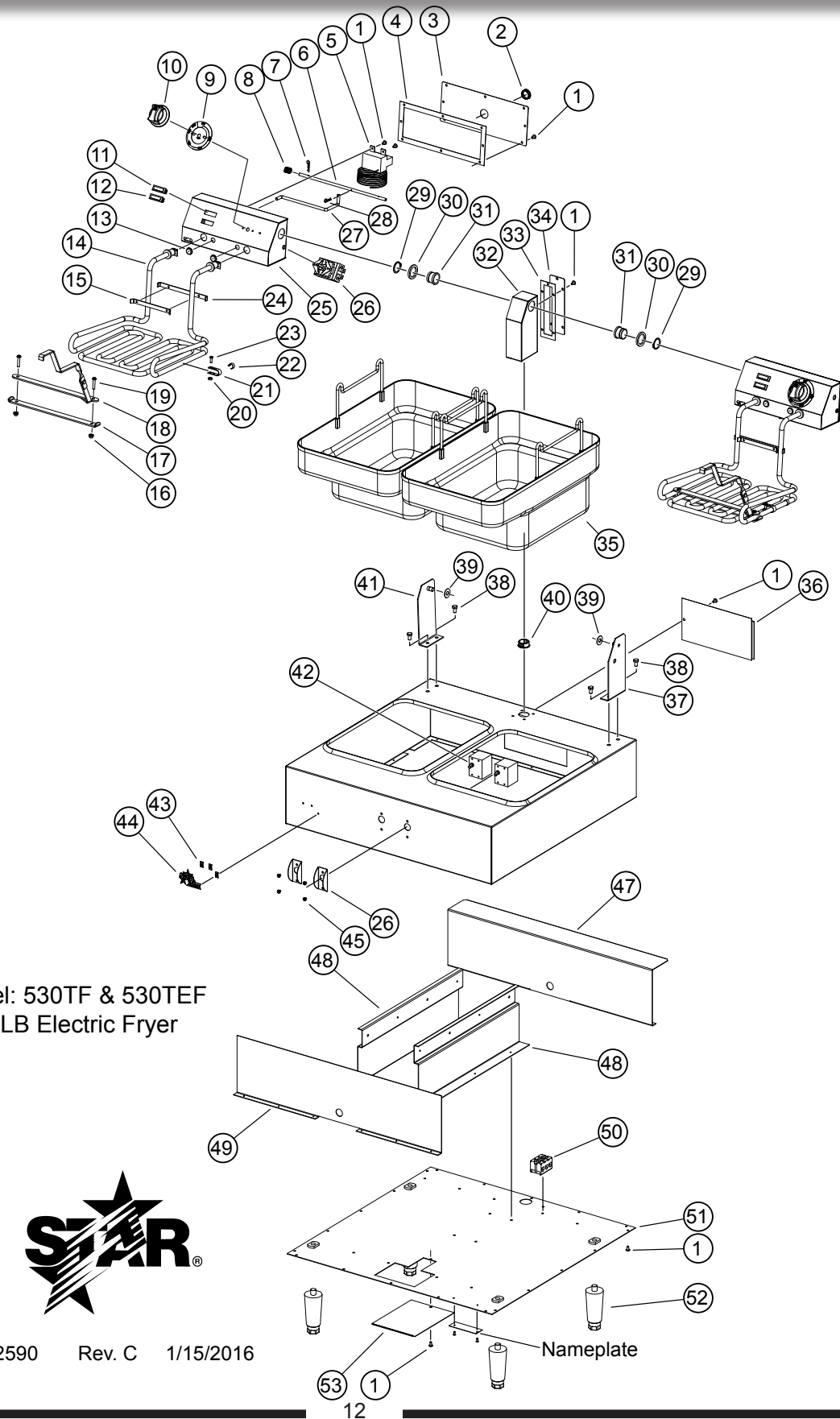

Model: 530TF & 530TEF
30LB Electric Fryer



SK2590 Rev. C 1/15/2016

2M-Z16001 Owners Manual for Countertop 30LB Electronic Fryer

PARTS LIST: 530TF & 530TEF

Model: 530TF & 530TEF Electric Deep Fat Fryer

Fig No.	Part Number	Quantity	Description	Application
1	2C-6349	61	SCREW #8X3/8 B THP STL NP	
2	2K-70229	2	BUSHING SHORTY HEYCO 2850	
3	E1-Y5087	2	BACK-ELEMENT HOUSING	
4	2I-Y5097	2	GASKET-ELEMENT HOUSING	
5	2T-Y1668	2	HI-LIMIT/SAFETY T-STAT	
6	2A-Y5109	1	ROD-CATCH	
7	2A-7435	4	PIN-COTTER 1/16DX3/8 STL	
8	2P-7969	2	SPRING 11/321DX7/8LG#18	
9	2M-Z15483	2	LABEL, KNOB ELEC. FRYER	
10	E1-Z15706	2	KNOB ASSEMBLY SM E-T KEYL	
11	E1-116313	2	SIGNAL LITE ASSEM-HEATING	
12	E1-116314	2	SIGNAL LITE ASSEM-POWER	
13	2I-5659	4	9061 GROMMET DRILL#55	
14	2N-Y5168	2	ELEMENT-240V 5750W	530TF
	2N-Y5169		ELEMENT 240V, 4600W	530TEF
15	E1-Y1890	2	BRACE-ELEMENT (SMALL)	
16	2C-2559	4	NUT 10-24 ACHD BR NP	
17	E1-Y1669	2	CLAMP-ELEMENT UPPER	
18	2R-115719	2	HANDLE BRKT ASSY-115 FRYR	
19	2C-1516	4	SCREW 10-24X1 STL RH NP	
20	2C-2556	10	NUT 8-32 HEX STL NP	
21	E1-7363	8	CLAMP-THERMOSTAT BULB	
22	2P-5737	12	CLIP- CAPILLARY TUBE	
23	2C-1494	8	SCREW 8-32X1/2 RHP STL NP	
24	E1-Y1889	2	BRACE-ELEMENT	
25	E1-530048	2	RH ELEM & CTRL HSG ASSY	
26	2T-Z7208	2	THERMOSTAT 375F	
27	2A-Y5108	2	ROD-CATCH RELEASE	
28	2A-5401	2	PIN-COTTER 3/32DX3/4 SS	
29	2C-Y5094	2	RING-RETAINING-1.000 ID	
30	2I-Y5088	2	GASKET-PIVOT 1.37 X 1.4	
31	2A-Y5090	2	BUSHING PIVOT - PLATED	
32	E1-530005	1	WIRE HOUSING ASSEMBLY	
33	2I-Y5095	1	GASKET-WIRE HOUSING	
34	E1-Y5086	1	BACK-WIRE HOUSING	
35	E1-115714	2	KETTLE ASSEMBLY COMPLETE	
36	E1-Y5084	1	PANEL-INSPECTION	
37	E1-530006	1	RH HOUSING SUPPORT ASSY	
38	2C-Y1221	4	BOLT 1/4-20X1/2 HEX STL	
39	2C-Y5096	2	NUT-PUSH ON #C1400-017	
40	2K-Y5093	1	BUSHING-SNAP #SB-1000-12	
41	E1-530007	1	LH HOUSING SUPPORT ASSY	
42	2E-Y5166	2	SWITCH-2 POLE 30 AMP	
43	2C-8477	3	CLIP .125 PO STL PHOS	
44	2M-Z15804	1	LOGO, STAR-MAX	
45	2C-200067	4	SCREW 6-32X1/4 THP SS	
46	E1-Z15962	2	SWITCH GUARD SINGLE SST	

PARTS LIST: 530TF & 530TEF continued

Model: 530TF & 530TEF Electric Deep Fat Fryer				
Fig No.	Part Number	Quantity	Description	Application
47	E1-Y5101	1	DIVIDER-REAR	
48	E1-Y5100	2	DIVIDER-KETTLE	
49	E1-Y5099	1	DIVIDER-FRONT	
50	2E-Y2849	1	BLOCK TERMINAL	
51	E1-530071	1	BOTTOM ASSY 530TED	
52	2A-Z5942	4	FOOT, 1/2-13 X 4"L.	
53	E1-Z3758	1	PANEL-INSPECTION	
NI	2B-Y8846	1	BASKET, RIGHT HANGER	
NI	2B-Y8847	1	BASKET, LEFT HANGER	
NI	2M-Y5135	1	LABEL-WIRING DIAGRAM	
NI	2M-Z8943	1	SIGN-FRYER WARNINGS	