

Gas-Fired Wood-Burning Stationary Rack BBQ Smoker

OWNER'S MANUAL



SRG-400



Southern Pride smokers have been tested and approved by Intertek Testing Services, and are ETL listed to ANSI Z83.11:2016 Ed 4, CSA 1.8:2016 Ed 4, and to NSF/ANSI Standard 4.
ETL File Number 4007026



CONGRATULATIONS!

In selecting Southern Pride, you have chosen the finest, most advanced and most fully automatic wood burning barbecue smoker available. With us, “It’s simply, a matter of Pride”.

Please read this manual carefully prior to installation, operation and maintenance of your Southern Pride smoker. Proper installation, operation, and maintenance are essential for your satisfaction and safe operation.

KEEP THIS MANUAL FOR REFERENCE

NOTE: An Electrical Diagram for this appliance can be found on the inside of the fan motor compartment. This smoker may be operated outdoors.

Southern Pride smokers are gas-fired, wood-burning, ETL listed, commercial cooking appliances whose installation, operation, and maintenance should comply with the instructions in this manual, NFPA® 96 and other codes and standards as called out in this manual.







For a list of ETL approved smokers go to www.intertek.com/directories, click on ETL Listed Mark Directory and search “Southern Pride.”

For more information on NFPA® 96, or to obtain a copy of the latest publication, please contact:

**NFPA®
1 Batterymarch Park
PO Box 9101
Quincy, MA 02169-7471
www.nfpa.org**

SAFETY INFORMATION AND PRECAUTIONS

This manual should be considered a permanent part of this smoker. **THE SMOKER MUST BE INSTALLED BY A QUALIFIED SERVICE TECHNICIAN.** All troubleshooting guides, component views and parts lists included in this manual are for general reference only and are intended for use by qualified technical personnel.

| | | |
|---|---|--|
|  | <p align="center">DANGER:</p> <p>Improper installation, alteration, adjustment, service, or maintenance could result in severe injury, death, or cause property damage. Read the installation, operating, and maintenance instructions thoroughly before installing or servicing this equipment.</p> | |
|  | <p>DANGER:</p> <p>Do not store or use gasoline or other flammable vapors or liquids in the vicinity of this or any other appliances.</p> | <p align="center">WARNING:</p> <p align="center">FOR YOUR SAFETY IF YOU SMELL GAS.....</p> <ol style="list-style-type: none"> 1. Open windows 2. Do not touch electrical switches 3. Extinguish any open flames 4. Immediately call your gas supplier |
|  | <p align="center">CAUTION:</p> <p>Metal parts and surfaces of this smoker become extremely hot when in operation. To avoid burns, always use hand protection when operating the smoker.</p> |  |
|  | <p align="center">WARNING:</p> <p align="center">ELECTRIC SHOCK HAZARD</p> <p>Follow these rules to avoid electric shock.</p> <ul style="list-style-type: none"> • Use only a properly grounded circuit. • Do not spray water directly on electrical components. • Turn off power before servicing. • Read the owner's manual before using. | |
| | | <p align="center"> WARNING: CARBON MONOXIDE POISONING HAZARD</p> <p>Carbon monoxide is a colorless, odorless gas that can kill. Follow these rules to control carbon monoxide.</p> <ul style="list-style-type: none"> • Do not use the smoker if in an unvented, enclosed area. Carbon monoxide may accumulate. • Allow only qualified burner service persons to adjust the burner. Special instruments and training are required. • Read the owner's manual before using. |

1. **IT IS EXTREMELY IMPORTANT TO FOLLOW THE PRESCRIBED CLEANING INSTRUCTIONS. GREASE OR SOLIDS BUILDUP INSIDE THE SMOKER COULD RESULT IN A FIRE HAZARD.**
2. This smoker is intended for use in commercial facilities where all operators are familiar with the purpose, limitations, and associated hazards of this equipment. The operating instructions and warnings must be read and understood by all operators and users.
3. This manual and all supplied instructions, diagrams, schematics, parts lists, notices and labels must remain with the smoker even if the smoker is sold or moved to another location.
4. The area around the smoker **MUST** be kept clear and free of combustible materials, gasoline and other flammable vapors and liquids.
5. The flow of combustion and ventilating air **MUST NOT** be obstructed from reaching the smoker.
6. The frame of the smoker **MUST** be electrically grounded at all times. See "Electrical Instructions".
7. Caution should be used when opening and closing the firebox door. The door is **HOT** during operation.
8. **DO NOT** remove service compartment access panels when smoker is in operation or leave off during operation.
9. Gas burners require the services of a qualified service technician for proper setting and adjustment. If the burner does not appear to be operating properly, **DO NOT ATTEMPT TO ADJUST THE BURNER YOURSELF.**
10. **DO NOT** allow unqualified personnel to perform service work or adjustments on this smoker. Doing so, will **VOID WARRANTY** and could result in a hazardous condition.
11. Ensure new employees, who might operate the smoker, are properly instructed and supervised on the operation and safety information prior to operating the smoker.
12. Ashes removed from the firebox should be stored in a non-combustible container with a sealed lid only. Store ashes in a well ventilated area. **FUMES COULD BE HAZARDOUS.**

TABLE OF CONTENTS

| | |
|--|-------|
| Diagram of Controls & Components..... | 5-6 |
| INSTALLATION | |
| Receiving the Smoker..... | 7 |
| Delivery Location..... | 7 |
| Unloading the Smoker..... | 8 |
| Unpacking the Smoker..... | 8 |
| Site Instructions | 8 |
| Electrical Instructions | 9 |
| Gas Piping Instructions..... | 10-12 |
| Gas Connection Instructions | 13 |
| Burner Specifications | 14 |
| Venting Instructions..... | 15 |
| OPERATION | |
| Control Operating Instructions..... | 16-19 |
| Product Loading Instructions | 20 |
| Firebox Loading Instructions..... | 20 |
| Product Unloading Instructions..... | 21 |
| Ash Removal Instructions..... | 21 |
| Grease Removal Instructions | 22 |
| Wood Storage Instructions | 22 |
| Mobile Smoker Operation | 23 |
| Mobile Smoker Electrical Information | 23 |
| Mobile Smoker Warnings..... | 23-25 |
| MAINTENANCE | |
| Daily..... | 26 |
| Weekly | 26 |
| Monthly | 27-28 |
| Quarterly | 28 |
| Semi-Annually..... | 28 |
| As Needed | 29-30 |
| Wiring Diagram..... | 31 |
| Replacement Parts List | 32 |
| Before You Call For Service..... | 32 |
| Troubleshooting the Gas Burner | 33 |
| Limited Warranty | 34 |

DIAGRAM OF CONTROLS AND COMPONENTS

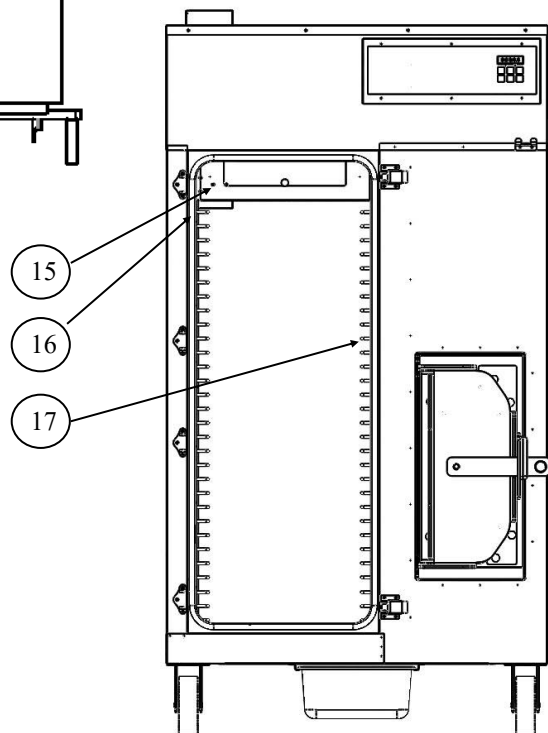
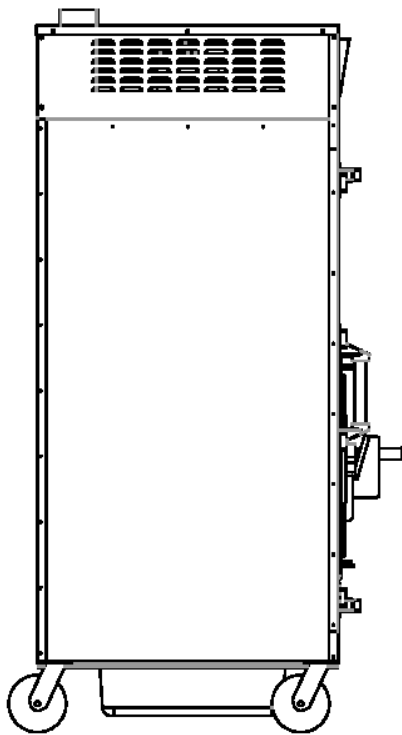
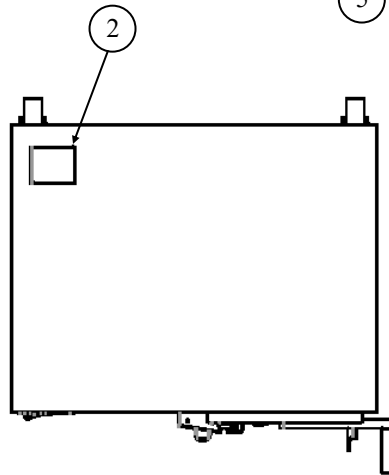
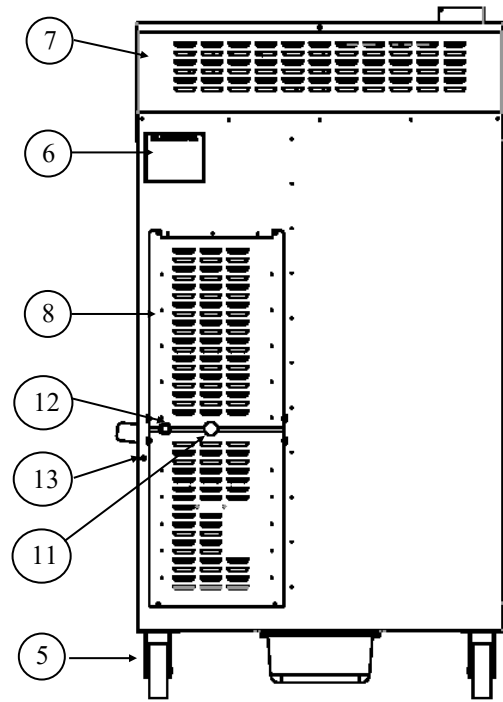
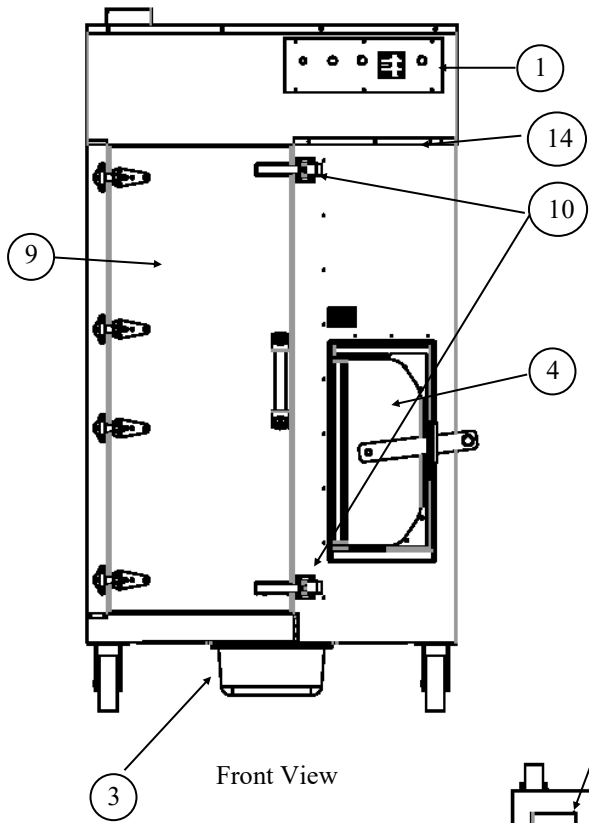

Left Side View

Inside View

DIAGRAM OF CONTROL AND COMPONENTS

1. **DIGITAL COOK & HOLD CONTROL** - Provides precise temperature control of the smoker along with control of the other functions of the smoker.
2. **FLUE** - Designed for use with Type-1 Canopy hood.
3. **GREASE DRAIN PAN** – Opening in bottom of smoker allows grease to drain from smoker into pan during the cook cycle. **Pan must be emptied after each cook cycle.**
4. **FIREBOX DOOR** - Provides access to the firebox chamber for loading wood and ash removal. **Keep closed while cooking.**
5. **6” LOCKING CASTER WHEELS** - Heavy duty locking casters provide a solid base and offers convenient mobility.
6. **DATA PLATE** - Label containing smoker’s serial number, model number, manufactured date, etc.
7. **CONTROL / FAN MOTOR COMPARTMENT** – Location of the convection fan motor, control module and relay board.
8. **SERVICE COMPARTMENT COVER** - Access to service bay where burner is located.
9. **PRODUCT LOADING DOOR** – Provides access to load/unload product and for cleaning the interior of the smoker.
10. **PRODUCT LOADING DOOR LATCHES** - Latches apply positive pressure and seals door.
11. **GAS SUPPLY CONNECTION** - Drip leg connection point for incoming gas supply to smoker.
12. **POWER CORD CONNECTION** - Access point for supply power cord to smoker.
13. **TETHER / WALL ANCHOR BOLT MOUNTING LOCATION** - Threaded hole for installation of eyelet bolt used to attach restraining device for smokers mounted on caster wheels to guard against transmission of strain to the gas and electrical connections. Required by ANSI Z83.11:2016 Ed 4.
14. **ASH PAN HANDLE HOOK** - Storage location for ash pan handle.
15. **BLOWER WHEEL SHROUD** - Access to the convection fan blower wheel.
16. **THERMOCOUPLE** - Provides the temperature reading for the control.
17. **HIGH LIMIT** - Ensures that the smoker does not exceed safe operating temperatures.

INSTALLATION

RECEIVING THE SMOKER

Your smoker can be shipped via a contract hauler on a flatbed trailer, or Common Carrier. Once the smoker arrives you will need a forklift to remove the crated smoker from the truck (Common Carrier deliveries).

| Model | Approx. Wt. Uncrated | Approx. Wt. Crated |
|---------|----------------------|--------------------|
| SRG-400 | 780 lb. | 1,005 lb. |

NOTE: The above weights are for the base model only.

DELIVERY LOCATION

Commercial smokers are large and heavy. Before scheduling the delivery of your smoker have a plan and location in place to accept the delivery of the smoker and maneuver the smoker into the desired installation location. The trucker will require a flat, level surface that is safe from traffic to unload the smoker. A forklift will be required to unload the smoker. The trucker is only responsible for delivery of the smoker. It is your responsibility to unpack the smoker, move it to its installation location, and have a qualified service technician install the smoker.



WARNING:

If the forklift forks are not long enough to support the entire smoker/crate do not attempt to move the smoker; obtain another forklift or use fork extensions.



WARNING:

Only proper heavy lifting machinery and heavy lifting equipment should be used for unloading, moving and installing the smoker. This duty should only be performed by professionals trained in this kind of work. Improper handling of the equipment could result in damaging the smoker or personal injury and even death.

UNLOADING THE SMOKER

Smokers Shipped via Common Carrier

Remove the crated smoker from the truck using the appropriate forklift. Note any damage to the crate, smoker or accessories. **Do not sign the delivery bill until the smoker has been inspected and any damage noted on the delivery bill.**

The smoker is shipped strapped to a wooden pallet with an industrial cardboard carton. Once the smoker is in a level and safe place remove the cardboard carton. Located on top of the wooden pallet are two (2) wooden ramps. Fasten the ramps to the edge of the wooden pallet using the metal clasps located on the end of the pallet and ramps. The smoker is secured to the wooden pallet with metal banding straps. A board prevents the smoker from moving. After removing the banding straps securing the smoker to the wooden pallet and the board (with a Phillips screwdriver), release the brakes on each of the smokers casters. Then the smoker can be slowly and carefully rolled down the ramps secured to the pallet.

Smokers Shipped via Contract Hauler

The driver will unload the smoker from the trailer. Once the smoker is in a level and safe place remove the white protective wrap from the outside of the smoker.

UNPACKING THE SMOKER

- The ash pan handle is secured to a product rack with a plastic zip tie.
- The smoker is shipped with plastic zip ties holding the product racks to the rack slides. These zip ties should be removed prior to initial operation.
- A 6" (152mm) drain pan is located inside the smoker.

SITE INSTRUCTIONS

The Southern Pride smoker must be installed in a location that will permit the smoker to function for its intended purpose and to allow adequate clearance for ventilation, proper cleaning, and maintenance access.

Minimum Clearance Requirement from Combustible Material

Back.....18" (457mm) Front.....48" (1219mm)

Top.....18" (457mm) Right & Left Side.....2" (51mm)

NOTE: If provision is made for service access, back clearance can be reduced to 2" (51mm).



WARNING: Failure to maintain proper safety, storage, handling, and ash removal for solid fuel appliances on or around combustible materials may result in fire, property damage and/or death. Our product listing allows for the smoker to be installed on a combustible surface however, Southern Pride recommends the use of a noncombustible material for the floor surface area under the firebox, which should extend at least 6" (152 mm) beyond each side of the firebox, and outward from the smoker beyond the area needed for placement of the ash container.

ELECTRICAL INSTRUCTIONS

Electrical Requirements:

- 120 volts AC, 60 Hz
- 2 wire, single phase
- 15 amp required, NEMA 5-15P plug



WARNING:

This appliance, when installed, must be electrically grounded in accordance with local codes, or in the absence of local codes, with the National Electrical Code, ANSI/NFPA 70, or the Canadian Electrical Code, CSA C22.2, as applicable.

THE WARRANTY IS VOID IF THE SMOKER IS CONNECTED TO ANY VOLTAGE OTHER THAN SPECIFIED ABOVE AND ON THE SMOKER DATA PLATE.

Remove all packing material before connecting the electrical and gas supply to the smoker.

1. An electrician must provide the conduit and wire for electrical hookup. The smoker should be connected to a dedicated 15 amp receptacle.
2. The power is to be left OFF throughout the installation.
3. The electrical service is connected via the factory supplied power cord located on the rear of the smoker on the service bay side. Alternatively, the power cord can be removed and the smoker hard wired.
4. If venting or gas connections are to be done at a later time, be sure that the power remains OFF.
5. A restraining device must be installed.

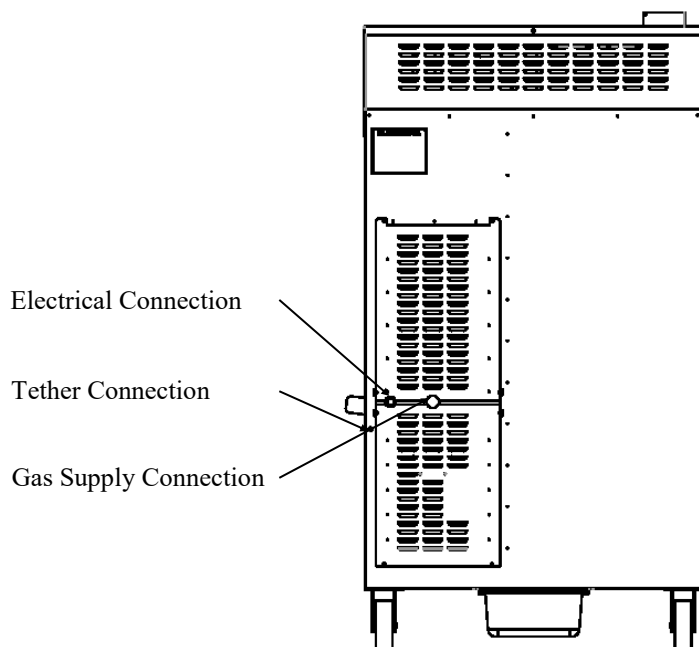

GAS PIPING INSTRUCTIONS

IMPORTANT NOTES TO THE INSTALLER

- Read all instructions contained in this owner's manual before making gas connections.
- Ensure all packing material is removed from the smoker compartments before connecting the gas supply to the smoker.
- Be sure your smoker is installed and grounded properly by a qualified service technician.
- Observe all governing codes and ordinances.

WARNING: IMPROPER GAS HOOKUP WILL VOID WARRANTY AND COULD RESULT IN A HAZARDOUS CONDITION.

1. All local and national codes and ordinances must be observed. Installation must conform with local codes or in the absence of codes, the National Fuel Gas Code ANSI Z223.1 / NFPA-54, latest edition available from The American Gas Association, Inc., 1515 Wilson Boulevard, Arlington, VA 22209.
2. The gas supply (service) line must be the same size or greater than the inlet line of the appliance. This smoker uses a 1/2" ID NPT (Sch40) inlet. Sealant on all pipe joints must be resistive to LP gas.
3. Supply line and manifold pressure should be checked with a manometer. Refer to page 14 for minimum and maximum pressures. Incoming line pressure upstream from the regulator must be 1" W.C.P. higher than the manifold pressure in order to check the regulator. The regulator used on this smoker can withstand a maximum input pressure of 1/2" PSI (14.0" W.C.P.). Over pressuring the valve may cause damage to the valve. If the line pressure is in excess of that amount, a step down regulator will be required.
4. It is recommended new pipe be used and located so that a minimum amount of work will be required in future servicing. The piping should be so installed as to be durable, substantial, and gas tight. It should be free from cutting burrs and defects in structure and threading. Cast iron fittings or aluminum tubing should not be used for the main gas circuit. Joint compounds (pipe dope) should be used sparingly on male threads only and be approved for all gases.

NOTE: The building structure should not be weakened by installation of the gas piping. The piping should not be supported by other piping, but should be firmly supported by pipe hooks, straps, bands, or hangers. Butt or lap welded pipe should not be bent.

5. **TEST PIPING FOR LEAKS.** Before turning gas under pressure into piping, all openings from which gas can escape must be closed. Immediately after turning on gas, the system should be checked for leaks. This can be done by watching the 1/2 cubic foot test dial for 5 minutes to show any movement, or by soaping each pipe connection and watching for bubbles. If a leak is found, make the necessary repairs and repeat the above test.

NOTE: Defective pipes or fittings should be replaced and not repaired. Never use a flame or fire of any form to locate gas leaks, use a soap solution.

6. After the piping and meter have been checked completely, **PURGE THE SYSTEM OF AIR. DO NOT** bleed the air inside the smoker. Be sure to relight all the gas pilots on other appliances.

NOTE: The burner and its individual shutoff valve must be disconnected from the gas supply piping system during any pressure testing in excess of 1/2 psig.

GAS PIPING INSTRUCTIONS (continued)

Pipe Sizing Chart for Natural Gas (0-0.5 psi) with Straight Schedule 40 Metal Pipe

The following chart is based on 0-0.5 psi inlet pressure, specific gravity of 0.6, and a pressure loss of 0.5" w.c.

Maximum Capacity of Pipe Size in Btu per Hour

| Pipe Size | 1/2" | 3/4" | 1" | 1 1/4" | 1 1/2" |
|------------------|----------------------------|---------|---------|-----------|-----------|
| Pipe Length (ft) | Maximum Capacity in Btu/hr | | | | |
| 10 | 175,000 | 360,000 | 680,000 | 1,400,000 | 2,100,000 |
| 20 | 120,000 | 250,000 | 465,000 | 950,000 | 1,460,000 |
| 30 | 97,000 | 200,000 | 375,000 | 770,000 | 1,180,000 |
| 40 | 82,000 | 170,000 | 320,000 | 660,000 | 990,000 |
| 50 | 73,000 | 151,000 | 285,000 | 580,000 | 900,000 |
| 60 | 66,000 | 138,000 | 260,000 | 530,000 | 810,000 |
| 70 | 61,000 | 125,000 | 240,000 | 490,000 | 750,000 |
| 80 | 57,000 | 118,000 | 220,000 | 460,000 | 690,000 |
| 90 | 53,000 | 110,000 | 205,000 | 430,000 | 650,000 |
| 100 | 50,000 | 103,000 | 195,000 | 400,000 | 620,000 |
| 150 | 40,000 | 84,000 | 160,000 | 325,000 | 500,000 |
| 200 | 35,000 | 72,000 | 135,000 | 280,000 | 430,000 |

Pipe Sizing Chart for Liquid Propane (11" w.c.) with Copper Tubing

The following chart is based on 11" w.c. inlet pressure and a pressure drop of 0.5" w.c.

NOTE: Copper tubing shall comply with standard type K or L of ASTM B 88 or STM B 280.

Maximum Capacity of Tube Size in Btu per Hour

| Pipe Size | 1/2" | 5/8" | 3/4" | 7/8" |
|------------------|----------------------------|---------|---------|---------|
| Pipe Length (ft) | Maximum Capacity in Btu/hr | | | |
| 10 | 110,000 | 206,000 | 348,000 | 536,000 |
| 20 | 76,000 | 141,000 | 239,000 | 368,000 |
| 30 | 61,000 | 114,000 | 192,000 | 296,000 |
| 40 | 52,000 | 97,000 | 164,000 | 253,000 |
| 50 | 46,000 | 86,000 | 146,000 | 224,000 |
| 60 | 42,000 | 78,000 | 132,000 | 203,000 |
| 70 | 38,000 | 71,000 | 120,000 | 185,000 |
| 80 | 36,000 | 67,000 | 113,000 | 174,000 |
| 90 | 33,000 | 62,000 | 105,000 | 161,000 |
| 100 | 32,000 | 59,000 | 100,000 | 154,000 |

GAS PIPING INSTRUCTIONS (continued)

Pipe Sizing Chart for Liquid Propane (11" w.c.) with Straight Schedule 40 Metal Pipe

The following chart is based on 11" w.c. inlet pressure and a pressure drop of 0.5" w.c.

Maximum Capacity of Pipe Size in Btu per Hour

| Pipe Size | 1/2" | 3/4" | 1" | 1 1/4" | 1 1/2" | 2" | 3" |
|------------------|----------------------------|---------|-----------|-----------|-----------|-----------|------------|
| Actual ID | 0.622 | 0.824 | 1.049 | 1.38 | 1.61 | 2.067 | 3.068 |
| Pipe Length (ft) | Maximum Capacity in Btu/hr | | | | | | |
| 10 | 291,000 | 608,000 | 1,145,000 | 2,352,000 | 3,523,000 | 6,786,000 | 19,119,000 |
| 20 | 200,000 | 418,000 | 787,000 | 1,616,000 | 2,422,000 | 4,664,000 | 13,141,000 |
| 30 | 160,000 | 336,000 | 632,000 | 1,298,000 | 1,945,000 | 3,745,000 | 10,552,000 |
| 40 | 137,000 | 287,000 | 541,000 | 1,111,000 | 1,664,000 | 3,205,000 | 9,031,000 |
| 50 | 122,000 | 255,000 | 480,000 | 984,000 | 1,475,000 | 2,841,000 | 8,004,000 |
| 60 | 110,000 | 231,000 | 434,000 | 892,000 | 1,337,000 | 2,574,000 | 7,253,000 |
| 80 | 94,000 | 197,000 | 372,000 | 763,000 | 1,144,000 | 2,203,000 | 6,207,000 |
| 100 | 84,000 | 175,000 | 330,000 | 677,000 | 1,014,000 | 1,952,000 | 5,501,000 |
| 125 | 74,000 | 155,000 | 292,000 | 600,000 | 899,000 | 1,730,000 | 4,876,000 |
| 150 | 67,000 | 140,000 | 265,000 | 543,000 | 814,000 | 1,568,000 | 4,418,000 |
| 200 | 58,000 | 120,000 | 227,000 | 465,000 | 697,000 | 1,342,000 | 3,781,000 |
| 250 | 51,000 | 107,000 | 201,000 | 412,000 | 618,000 | 1,189,000 | 3,351,000 |
| 300 | 46,000 | 97,000 | 182,000 | 373,000 | 560,000 | 1,078,000 | 3,036,000 |
| 350 | 42,000 | 89,000 | 167,000 | 344,000 | 515,000 | 991,000 | 2,793,000 |
| 400 | 40,000 | 83,000 | 136,000 | 320,000 | 479,000 | 922,000 | 2,599,000 |

GAS CONNECTION INSTRUCTIONS

For smokers equipped with casters, the installation shall be made with a connector that complies with the Standard for Connectors for Movable Gas Appliances, ANSI Z21.69 CSA 6.16, and a quick-disconnect device that complies with the Standard for Quick-Disconnect Devices for Use With Gas Fuel, ANSI Z21.41 CSA 6.9.

Adequate means must be provided to limit the movement of the appliance without depending on the connector and the quick-disconnect device or its associated piping to limit the appliance movement.

A restraining device may be attached using the mounting hole provided on the rear of the smoker. Refer to page 5 to locate the mounting hole.

WARNING: Operator should be aware that a restraint device is in place on smokers equipped with casters. If disconnection of the restraint is necessary, it must be reconnected after the appliance has been returned to its originally installed position.

IMPORTANT ITEMS TO CHECK BEFORE FIRING THE BURNER

1. Gas line **MUST** be installed by a qualified technician and in accordance with this manual.
2. Gas line **MUST** include an easily accessible manual shutoff valve, drip leg, and pressure gauge port.
3. Gas pipe size **MUST** be in accordance with the Pipe Capacity Chart in this manual (pages 11 and 12).
4. Gas line **MUST** be tested for leaks under pressure.
5. Gas line **MUST** be purged to remove any air in the system.
6. Gas line pressure **MUST** be checked and **MUST NOT** exceed the maximum pressure specified in the Burner Specifications on page 14.
7. Burner orifice **MUST** correlate with the type of gas being supplied, as specified in the Burner Specifications on page 14.



WARNING:

Improper gas hookup will void the warranty and could result in a hazardous condition.

BURNER SPECIFICATIONS

Burner Models: Wayne P265-EP

Fuels: Natural or L.P. Gases

Electrical: 120 V.A.C., 60 Hz, 1 ph

NOTE: Orifice and valve setting must correlate with type of gas being supplied.

| Firing Capacity | |
|-------------------------------|----------------------|
| Firing Rate Btu KW | 65,000 19 |
| SRG-400 | X |

| | Gas Supply Line Pressure | | Manifold Pressure | |
|----------------|--------------------------|-------------------------|------------------------|-------------------------|
| | Minimum | Maximum | Minimum | Maximum |
| Natural | 4.5" w.c. 11.2 mbar | 10.0" w.c. 24.9 mbar | 3.0" w.c. 7.5 mbar | 3.5" w.c. 8.7 mbar |
| LP | 11.0" w.c. 27.4 mbar | 13.0" w.c. 32.4 mbar | 9.5" w.c. 23.7 mbar | 10.0" w.c. 24.9 mbar |

| Pilot Orifice Size Chart | |
|--------------------------|--------|
| Natural | BCR-24 |
| LP | BCR-18 |

| Main Orifice Size Chart | | |
|---------------------------|-------------|-------------------------|
| 65,000 Btu/hr 19 KW/hr | Natural Gas | #26 (.147") (3.73mm) |
| 65,000 Btu/hr 19 KW/hr | LP Gas | #43 (.089") (2.26mm) |

Gas Valve

Knob must be in ON (vertical) position.

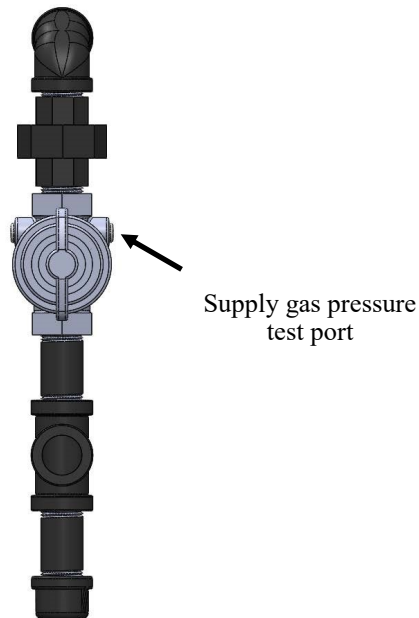

VENTING INSTRUCTIONS

THE METHOD OF VENTILATION MUST BE APPROVED BY THE LOCAL CODE ENFORCEMENT AGENCY PRIOR TO EQUIPMENT INSTALLATION.

1. The smoker ventilation system should comply with this manual and the current edition of NFPA® 96.
2. It is recommended that Local Code Officials and a Commercial Kitchen Ventilation Contractor be consulted prior to installation.
3. Provisions must be made for adequate air supply for the smoker. If the smoker is to be installed in a sealed room or building utilizing exhaust fans, the room must be supplied with a return air system. Return air must be equal or in excess of the exhausted air.
4. The smoker should be positioned to provide a direct, or shortest, path to the outside for the exhaust duct.

Minimum Clearance Requirement from Combustible Material

Back.....18" (457mm) Front.....48" (1219mm)

Top.....18" (457mm) Right & Left Side.....2" (51mm)

NOTE: If provision is made for service access, back clearance can be reduced to 2" (51mm).

TYPE-1 CANOPY HOOD VENT

All smoker models may be installed under an approved Type-1 canopy hood system rated for commercial cooking appliances.

- Placement under a common hood shared with other appliances may be prohibited.
- Southern Pride recommends a minimum 18 inch (457mm) overhang on the product loading door side of the smoker and a 6 inch (152mm) overhang on all other sides.
- Exhaust fan size must be determined by a ventilation contractor specifically for your application. Hood dimensions, exhaust duct length and routing all factor into the calculation.

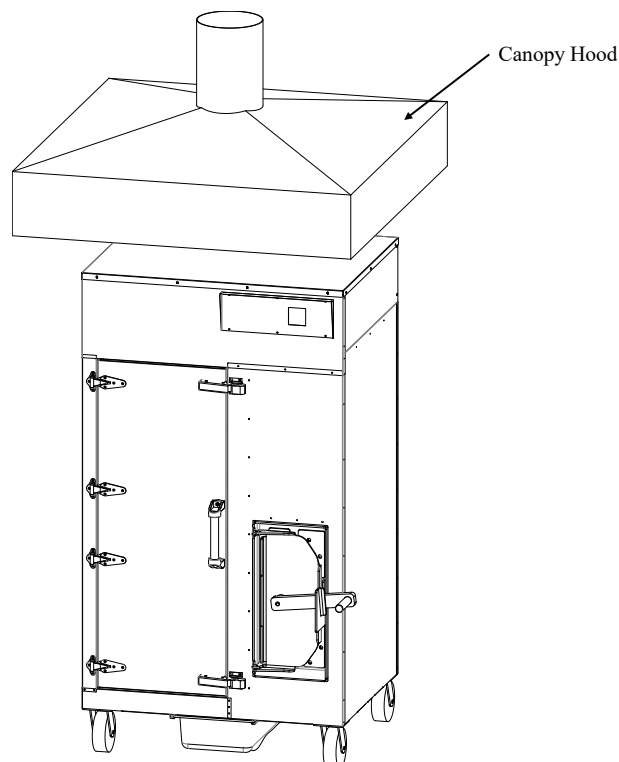

OPERATION

The smoker should be operated in the following order (with all operations according to the subsequent instructions):

1. Ensure that the drain pan is empty and installed in the pan rails located under the smoker drain hole.
2. Set the control and start the cook cycle.
3. Once the smoker reaches the temperature set point, pause the menu, load the product into the smoker and close the product loading door.
4. Place the desired wood into the firebox, close the firebox door and resume the menu.
5. Once the cook cycle is complete, turn the control off.
6. Remove the product from the smoker.
7. Remove the ashes from the firebox.
8. Empty the grease from the grease pan.

CONTROL OPERATING INSTRUCTIONS

DIGITAL COOK & HOLD CONTROL - Manual Menu

1. The product loading door must be closed.
2. The display must read IDLE. (The burner, and convection fan will be off). If the display reads OFF, a press of any button will bring the control to IDLE.
3. A menu consists of a cook temperature, cook time, and, when the cook time has elapsed, a choice to end the menu (HOLD OFF) or go into hold mode (HOLD TEMP SETPOINT).
4. Press the manual menu button (TENP1 will be displayed), then press the up/down buttons to obtain the desired cook temperature.
5. Press the manual menu button (TINE1 will be displayed), then press the up/down buttons to obtain the desired cook time.
6. Press the manual menu button (HTENP will be displayed), press the up/down buttons to obtain the desired hold temp, if a hold temp is not desired press the down button until OFF is displayed.
7. Programming the menu is complete. To start the menu, press the start/stop button one time. The control will begin the menu.
8. To pause the menu, press the start/stop button one time and PAUSE will be displayed. To resume the menu, press the start/stop button one time.
9. To cancel or stop the menu, press and hold the start/stop button until IDLE is displayed.
10. Once the smoker has reached the temperature set point an audible alarm will sound. A press of any button on the control will stop the alarm. After two minutes the alarm will stop; if no button is pressed.
11. When the cook cycle is complete there are two possible actions that can be taken. One is if a hold temperature was programmed into the menu, the control will momentarily sound an audible alarm then, HOLD and the length of time the control has been in the hold mode will alternately flash in the display. The control will maintain the hold temperature until the start/stop button is depressed to END the menu, and bring the control to the IDLE mode.
12. If the hold temperature was programmed to OFF and the cook time has elapsed, END will be displayed, and an audible alarm will sound continuously until the start/stop button is depressed, to END the menu, and bring the control to the IDLE mode.
13. After the control has been in the IDLE mode for five minutes it will go to OFF, a press of any button will bring the control back to IDLE.
14. After each cook cycle the ashes should be removed from the firebox and the grease emptied from the drain pan.

NOTE: When the control is in IDLE the convection fan will continue to run until the smoker temperature falls below 120°F (49°C).

CONTROL OPERATING INSTRUCTIONS (continued)

DIGITAL COOK & HOLD CONTROL - Automatic Menu Programming

1. The product loading door must be closed.
2. The display must read IDLE. (The burner, and convection fan will be off). If the display reads OFF, a press of any button will bring the control to IDLE.
3. A menu consists of a cook temperature, cook time, and, when the cook time has elapsed, a choice to end the menu (HOLD OFF) or go into hold mode (HOLD TEMP SETPOINT).
4. Press and hold the up and down buttons for 10 seconds to access the menu program state (M 1 will be displayed).
5. Press the manual menu button to access the menu parameters for menu 1 (STPT1 will be displayed), this is the set point temperature for the menu.
6. Press the manual menu button again to change the cook temperature. Use the up/down buttons to obtain the desired cook temperature. Press the enter button to save the change.
7. Press the down button to advance to cook time (TINE1 will be displayed). To change the cook time, press the manual menu button. Use the up/down buttons to obtain the desired cook time. Press the enter button to save the change.
8. Press the down button to advance to hold temperature (HSTPT1 will be displayed). To change the hold temperature, press the manual menu button. Use the up/down buttons to obtain the desired hold temperature, if a hold temperature is not desired press the down button until OFF is displayed. Press the enter button to save the change.
9. Programming the menu is complete. Press the enter button to return to the menu list. Use the up/down buttons to select the next menu to program. Repeat the above steps to program the next menu. Once programming is complete, press the enter button twice to return to IDLE.

CONTROL OPERATING INSTRUCTIONS (continued)

DIGITAL COOK & HOLD CONTROL - Automatic Menu Operation

1. The product loading door must be closed.
2. Press the auto menu button. The number of the first automatic menu will be displayed.
3. Use the up/down buttons to scroll through the list of automatic menus. When the desired menu number is displayed, press the start/stop button to start the menu.
4. To pause the menu, press the start/stop button one time and PAUSE will be displayed. To resume the menu, press the start/stop button one time.
5. To cancel or stop the menu, press and hold the start/stop button until IDLE is displayed.
6. Once the smoker has reached the temperature set point an audible alarm will sound. A press of any button on the control will stop the alarm. After two minutes the alarm will stop; if no button is pressed.
7. When the cook cycle is complete there are two possible actions that can be taken. One is if a hold temperature was programmed into the menu, the control will momentarily sound an audible alarm then, HOLD and the length of time the control has been in the hold mode will alternately flash in the display. The control will maintain the hold temperature until the start/stop button is depressed to END the menu, and bring the control to the IDLE mode.
8. If the hold temperature was programmed to OFF and the cook time has elapsed, END will be displayed, and an audible alarm will sound continuously until the start/stop button is depressed, to END the menu, and bring the control to the IDLE mode.
9. After the control has been in the IDLE mode for five minutes it will go to OFF, a press of any button will bring the control back to IDLE.
10. After each cook cycle the ashes should be removed from the firebox and the grease emptied from the drain pan.

NOTE: When the control is in IDLE the convection fan will continue to run until the smoker temperature falls below 120°F (49°C).

PRODUCT LOADING INSTRUCTIONS

The smoker is equipped with fourteen (14), 18" x 26" (457 x 660mm) product racks in its standard configuration for the loading of product. The modular designed rack slide system has 1.5" (38mm) spacing that allows the smoker to hold up to 27 product racks at one time.

1. Before opening the product door, the control should be in the IDLE or PAUSE position.
2. Remove the product rack from the smoker.
3. Place the product directly on the product rack, leaving an air gap between each piece of product.
4. With the product placed on the food rack, carefully slide the loaded product rack into the smoker starting from the bottom rack slide position.
5. Repeat steps 2 and 3 until all product is loaded into the smoker. Product height will determine how many rack slide spaces you need to advance to maintain an air gap between each loaded product rack.
6. If the cook menu was paused, a press of the start/stop button is required to resume the menu.

FIREBOX LOADING INSTRUCTIONS

1. The solid fuel should be handled in accordance with NFPA® 96.
2. Southern Pride recommends that the smoker be allowed to reach the temperature set point (the audible alarm will sound) before loading wood into the firebox. This will help prevent the smoker from exceeding the temperature set point.
3. Before opening the firebox door, the control should be in the IDLE or PAUSE position.
4. Use 1-3 logs, 3-5 inches (76 - 127mm) in diameter, 10-12 inches (254 - 305mm) long. Use green or slightly seasoned hardwoods, fruitwoods, or charcoal (not to exceed six pounds, 2.7kg). **THE WOOD OR CHARCOAL IS ONLY USED TO FLAVOR THE PRODUCT, NOT TO HEAT THE SMOKER.**
5. Be sure to keep the wood 4 inches (102mm) from the burner or ashes can accumulate on the burner and cause it to not work properly.
6. Place the logs on top and inline with each other to minimize air flow around each log. This will help promote a smoldering, slow burn, which maximizes smoke.
7. The wood does not have to be lit manually; the smoker is equipped with a gas burner that will light the wood. Combustible or flammable liquids shall not be used to assist ignition.
8. Tightly close the firebox door to prevent air from being pulled into the firebox.
9. If the cook menu was paused, a press of the start/stop button is required to resume the menu.

CAUTION:

- **Remove coals and ashes from previous cook cycle before loading new wood into the firebox. Refer to Ash Removal Instructions on page 21.**
- **Do not use dry wood or kindling.**
- **Do not overload firebox. Too much wood or charcoal can cause overheating of the smoker. Keep wood at least 4 inches (102mm) from the burner.**
- **Do not allow ashes in or near the burner opening.**

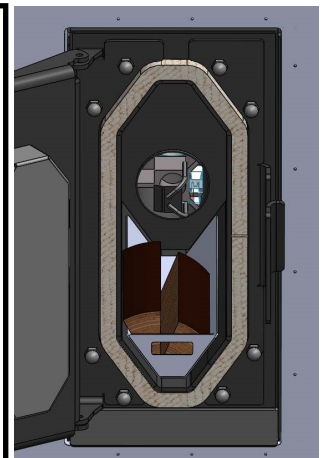



PRODUCT UNLOADING INSTRUCTIONS

1. Before unloading the product, the control should be in the IDLE or OFF position.
2. Carefully open the product loading door just enough to release the smoke from the cabinet, then wait approximately 5 seconds before fully opening the product loading door.
3. Product should be removed from top rack to the bottom rack.

ASH REMOVAL INSTRUCTIONS

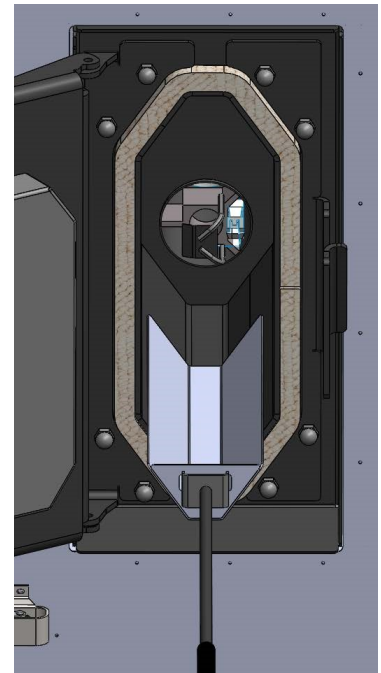
1. The ashes should be handled in accordance with NFPA® 96.
2. Before emptying the firebox, the control should be in the IDLE or OFF position.
3. After each cook cycle, remove the remaining wood and hot coals from firebox. Use heat resistant gloves while handling ash container and ash removal tools. The ash pan handle should be used to remove the ash pan from the firebox. The end of the ash pan handle is inserted into the opening in the end of the ash pan. The two hooks on the ash pan handle grip the opening in the ash pan and leverage is used as the ash pan is removed from the firebox.
4. Place small lots of them in a noncombustible corrosion resistant pan and spray with water. A noncombustible corrosion resistant pan should be kept just outside the firebox door for this purpose.
5. Once wood and ash have been sprayed, place them in a heavy metal container with a tight fitting metal lid (16 gauge (1.59mm) minimum, capacity not to exceed 20 gallon (76 liters)). This container shall be assigned for this one purpose, shall be able to be handled easily by any employee assigned the task, and shall pass easily through any passageway to the outside of the building. The container shall always be covered when it is being moved through the premises. When any hole occurs in a container from corrosion or damage, the container shall be repaired or replaced immediately.
6. The ashes should be carried to a separate heavy metal container (or dumpster), outside the premises, that is used exclusively for the purpose of hot ash storage.



| | |
|---|---|
|  | <p>WARNING</p> <p>Never empty ash/coals from the smoker into a common trash dumpster. Embers from ash/coals could ignite materials resulting in a fire.</p> |
|---|---|

| | |
|---|--|
|  | <p>CAUTION</p> <p>Be sure smoker product loading door and firebox door are secured in the closed position immediately following a cook cycle and during non-use periods.</p> |
|---|--|

GREASE REMOVAL INSTRUCTIONS

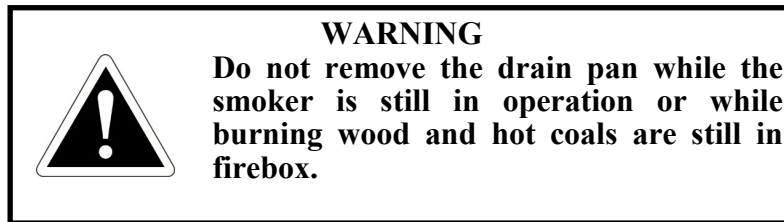

1. Immediately empty the grease pan after each cook cycle. **CAUTION: Grease will be hot.**
2. Grease should be poured into an approved grease recycling bin.

WOOD STORAGE INSTRUCTIONS

- The solid fuel should be stored in accordance with NFPA® 96.
- Wood stored in the same room as the smoker or the smoker firebox door shall not exceed a 1-day supply.
- Wood shall not be stored above any heat-producing appliance or vent or closer than 0.92 m (3ft) to any portion of a solid fuel appliance constructed of metal or to any other cooking appliance that could ignite the wood.
- Wood shall not be stored in the path of ash removal.
- Where stored in the same building as the smoker, wood shall be stored only in an area with walls, floor and ceiling of noncombustible construction extending at least 0.92m (3ft) past the outside dimension of the storage pile.
- Wood shall be separated from all flammable liquids, all ignition sources, all chemicals, and all product supplies and packaging goods.
- All wood storage areas shall be provided with a sprinkler system meeting the requirements of NFPA® 13.

Exceptions:

- Where acceptable to the authority having jurisdiction, wood storage areas shall be permitted to be protected with a fixed water pipe system with a hose capable of reaching all parts of the area.
- In lieu of a sprinkler system a listed 2-A rated water spray extinguisher or a 6 L (1.6 gal) wet chemical fire extinguisher listed for Class K fires with a maximum travel distance of 6 m (20 ft.) to the wood piles shall be permitted to be used for a wood pile, provided that the wood pile does not exceed 0.14 cubic meters (5 cubic feet) volume.

MOBILE SMOKER OPERATION

- Check the fuel level of the LP tanks prior to starting a cook cycle. Proper monitoring of the LP tanks will eliminate the chance of running out of gas.
- The burner in the smoker is equipped with an automatic ignition system. **Do not attempt to manually light the burner.**
- Do not transport the smoker while the smoker is in operation or with product on the product racks.
- Disconnect the electrical power supply before removing the service compartment access panels for servicing.
- Do not transport the smoker with hot coals or a wood fire in the firebox.
- Never place anything over the flue of the smoker, it must be unobstructed to work properly.
- Never attempt to cook with the product door, or firebox door, open.
- **Dry wood, too much wood, or too much charcoal may cause the temperature in the smoker to override the thermostat setting.** Follow instructions in this manual for the proper amount of wood or charcoal to use.

MOBILE SMOKER ELECTRICAL INFORMATION

This smoker is equipped with a power cord with a 3 prong grounded plug. DO NOT cut or remove the grounding prong from the smoker power cord or from any extension cord used with the smoker.

The smoker should only be plugged into a 120 VAC, 15 amp, grounded receptacle.

Use only a 3 prong grounded extension cord rated for outdoor use marked with a “w” (formerly w-A). This designation indicates the cord is rated for outdoor use and includes sunlight resistant jacket and wet location rated conductors.

MOBILE SMOKER WARNINGS

GENERAL

1. Mobile smokers are intended for outdoor use. NEVER use in a garage, building, shed, breezeway or other enclosed area. The mobile smoker shall not be used under any overhead combustible construction.
2. Store your smoker in a well-ventilated area. If stored indoors, detach and leave LP cylinders outdoors in a well-ventilated area away from heat and away from where children may tamper with them.
3. Keep the electrical supply cord and the fuel supply hose away from any heated surfaces.
4. Do not remove service compartment access panels when smoker is in operation or leave off during operation.
5. After a period of storage or nonuse, check the smoker for gas leaks and burner obstructions before use.
6. Wheel chocks must be used when the smoker is sitting stationary.
7. Level the smoker, both front to back and side to side, before operating the smoker.

MOBILE SMOKER WARNINGS (continued)

ELECTRICAL

1. To protect against electrical shock:
 - a) do not immerse any part of the power cord, plug or extension cord in water or any other liquid.
 - b) use only a 3 prong extension cord, and only plug into a 15 amp grounded receptacle.
2. Unplug the smoker from the outlet when not in use and before cleaning.
3. Do not let the extension cord hang over the edge of a table or touch hot surfaces. Keep the cord out of walkways to avoid a tripping hazard.
4. Do not use this smoker for purposes other than intended.
5. Do not operate this smoker with a damaged cord, plug, or after the smoker malfunctions or has been damaged in any manner.

LP GAS

1. The LP cylinders must be constructed and marked in accordance with the specifications for LP gas cylinders by the U.S. Department of Transportation (DOT), or CAN/CSA B339.
2. The handling, storage and transportation of gas cylinders must be in accordance with storage and handling of Liquid Petroleum Gases, ANSI/NFPA 58 or Natural Gas and Propane Installation Code, CSA B149.1.
3. Never use a cylinder with a damaged valve. A dented or rusty LP cylinder may be hazardous and should be avoided. If in doubt, have the cylinder checked by your LP supplier. Always check for leaks after every LP cylinder change.
4. Always shut off the LP gas supply at the cylinder when the smoker is not in use.
5. Cylinders must be stored outdoors in a well-ventilated area out of the reach of children. If your smoker is stored indoors, the LP cylinder must be removed and stored outside. LP gas cylinders are not to be stored in any compartment on the smoker that is not intended for cylinder storage. Such unauthorized storage could lead to an explosion, fire, or personal injury.
6. Cylinders should not be allowed to remain in a high heat area such as a closed car, trunk, or in direct sunlight.

MOBILE SMOKER WARNINGS (continued)

LP GAS (continued)

7. Before each use, inspect the gas hose. If excessive abrasion, wear or if the hose is cut it must be replaced prior to the smoker being put into operation.
8. LEAK TESTING: Do not use a flame to check for a gas leak. To prevent fire or explosion hazard, DO NOT smoke or allow any potential source of ignition (sparks, electrical arcing, etc.) in the area while performing a leak test. Leak tests should be conducted outdoors only.
 - a. Create a soapy solution of 1 part soap and 1 part water, or use a gas leak detector solution available for purchase from a plumbing supply or hardware store. Confirm that all control knobs are in the off position.
 - b. Open the gas supply valves and apply the soap solution generously by paint brush or squirt bottle on all connections and fittings. If bubbles appear to “grow” on any of the connections, you have a gas leak, immediately turn off the gas supply.
9. Fixing a gas leak: Wash off the soapy solution with cold water and dry. Tighten the loose joint, or replace the faulty part with manufacturer-recommended replacement parts.
10. Do not attempt to repair the LP cylinder valve if it is damaged. The only way to safely resolve a damaged cylinder is to replace it.
11. Repeat the leak test to ensure that no leaks are present.
12. Do not operate the smoker if there is a gas leak present.
13. Leaking gas may cause a fire or explosion which can cause serious bodily injury or death.
14. When not in use, the gas valve on the LP tanks must be turned off and the supply line disconnected from the tanks. The protective dust cap must be installed on the valve outlet.
15. Liquid propane is not natural gas. The conversion to or attempted use of natural gas in a liquid propane smoker is dangerous and will void your warranty.
16. Do not attempt to disconnect any gas fitting while your smoker is in operation.
17. Although your liquid propane cylinder may appear to be empty, gas may still be present. The cylinder should be transported and stored with the valve closed.

MAINTENANCE



WARNING

It is extremely important to follow the below maintenance procedures. Grease or solids buildup inside the smoker could result in a fire hazard.



WARNING:

Before any service is performed on the smoker, the gas supply should be turned off and the power disconnected.

DAILY:

1. Remove all product racks from smoker and take to sink area for cleaning. Use a commercial foodservice detergent/degreaser. Follow the product manufacturer's instructions for proper use, cautions and warnings. Protective gear such as goggles and rubber gloves should be used.
2. Sanitize product racks with a commercial product service sanitizer. Follow the product manufacturer's instructions for proper use, cautions and warnings. Protective gear such as goggles and rubber gloves should be used.
3. Drain grease after each cook cycle. Refer to the Grease Removal Instructions on page 22 of this manual.
4. Remove ashes and coals from firebox after each cook cycle. Refer to the Ash Removal Instructions on page 21 of this manual.

WEEKLY:

1. The flue shall be inspected weekly for the following conditions in accordance with NFPA® 96:
 - a. Residue that might begin to restrict the vent or create an additional fuel source. The flue or chimney should be cleaned before these conditions exist.
 - b. Corrosion or physical damage that might reduce the flue's capacity to contain effluent. The flue or chimney shall be repaired or replaced if any unsafe condition is evident.
2. The combustion chamber shall be scraped clean to its original surface once each week and shall be inspected for deterioration or defects.
3. Inspect the burner head for accumulation of ashes. If ashes are present, clean immediately. Ashes in the burner head can cause the burner to misfire.
4. Inspect the product door and firebox door gaskets. Replace if damaged or leaking.

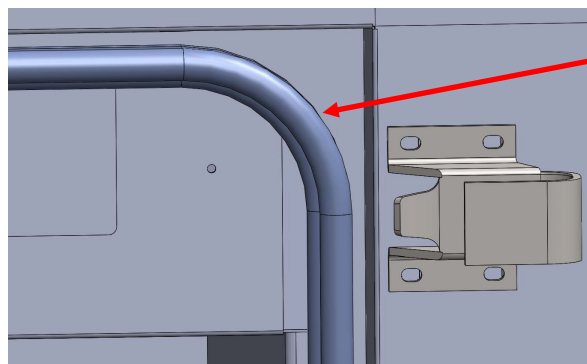

Product door gasket

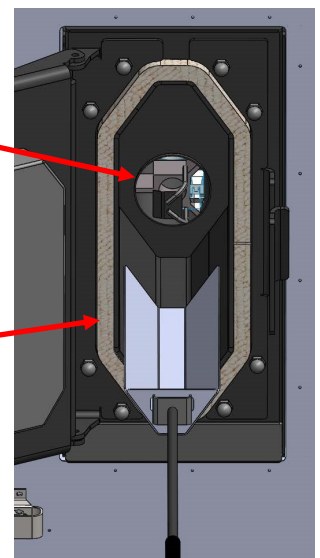

Burner head

Firebox gasket

MAINTENANCE (continued)

MONTHLY:

1. Inspect the blower wheel for solids or creosote buildup or an out-of-balance condition. Clean as needed. Remove and clean the rack slides and air channels.

WARNING: Solids buildup will cause the blower wheel to be out of balance and, if not cleaned, can cause damage to the blower wheel and to the convection fan motor.

WARNING: Smoker MUST be off and power disconnected before opening service door.

Removing the thumb screw and inspection cover allows for inspection of the blower wheel.

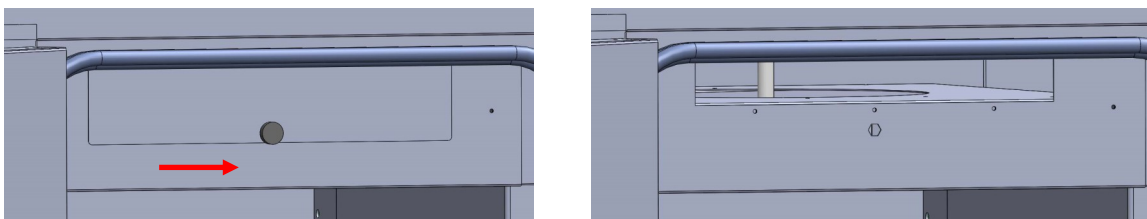

To remove the rack slides, air channels and blower wheel for cleaning:

- a. Remove the rack slides on both sides of the smoker by lifting up and out.
- b. Remove the air channels on both sides of the smoker by lifting up and out.
- c. Remove six, 1/4-20 bolts that secure the blower wheel shroud to the smoker.
- d. Carefully lower the shroud away from the blower wheel and out of the smoker.

NOTE: If there is not a lot of buildup on the blower wheel, it can be carefully cleaned without removing it from the motor shaft. If a more thorough cleaning is needed, proceed to the next steps.

- e. Insert a 5/32" Allen wrench through the access holes in the blower wheel to loosen the set screws.
- f. Remove the retaining ring on the end of convection motor shaft.

To re-install repeat the above steps in reverse order. Be sure to tighten the blower wheel set screw against the flat portion of the convection motor shaft. When re-installing the air channels, the sections with the smaller holes should go to the bottom.

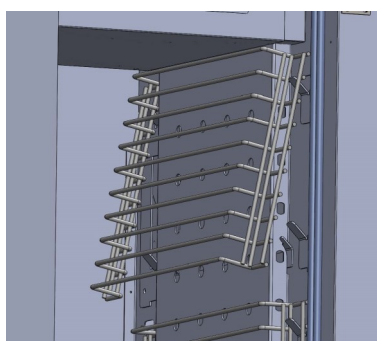

a.

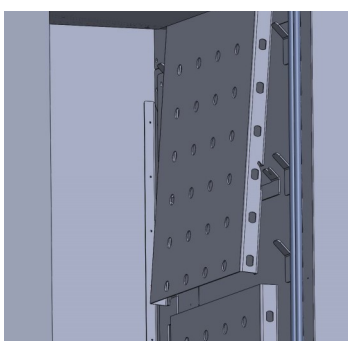

b.

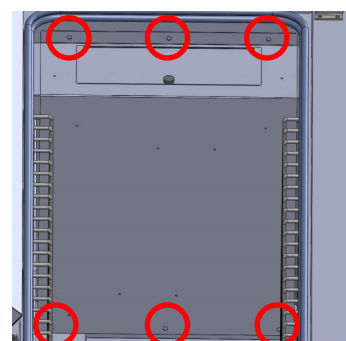

c.

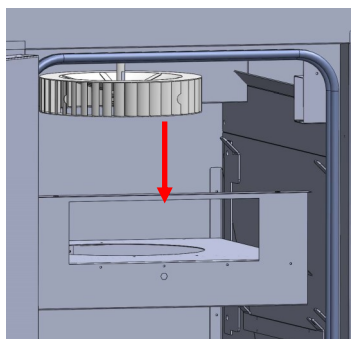

d.

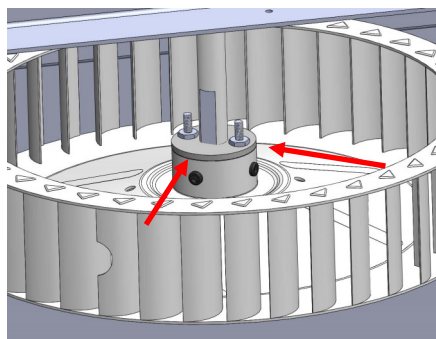

e.

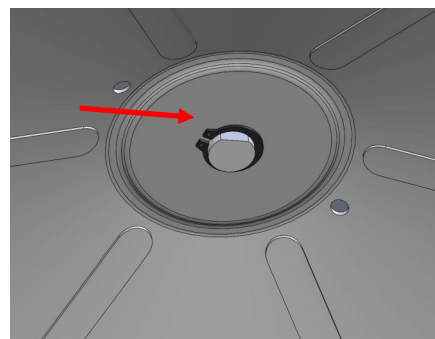

f.

MAINTENANCE (continued)

MONTHLY (continued):

2. Check the thermostat thermocouple. Be sure there is no solids or creosote buildup. Clean as needed.

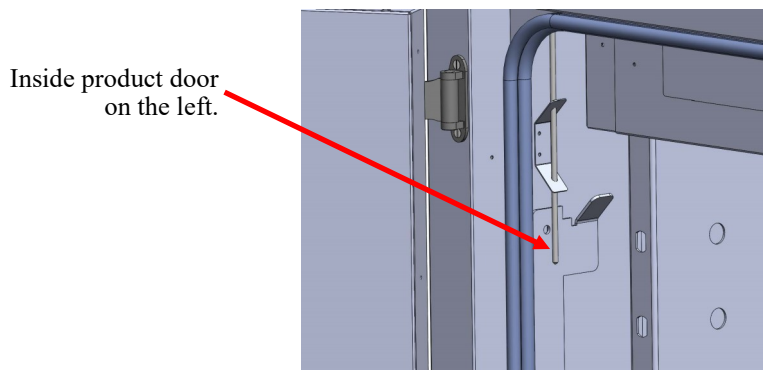

3. Check the product door hinges and the product door latches. Tighten screws and align as needed.

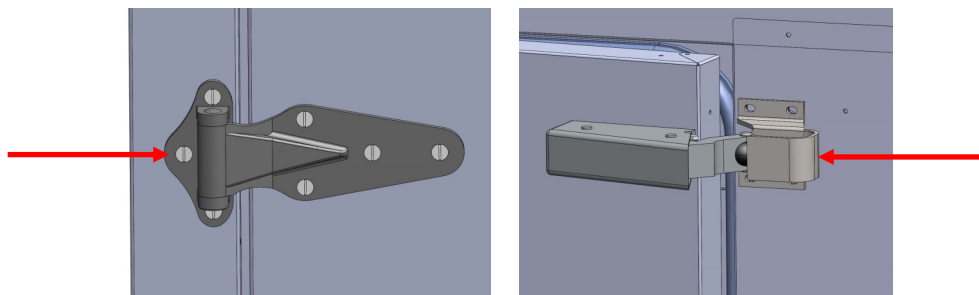

QUARTERLY:

1. At least quarterly, the baffle board should be removed, and the creosote scrapped off of the firebox side of the baffle board, along with the interior of the smoker around the firebox. The top portion of the baffle board (red highlighted area) stays in the smoker, while the bottom portion (green highlighted area) is removed. **Before removing the bottom portion, the top, right, back wire rack slide hanger (blue highlighted area) must be removed from the interior liner of the smoker and the baffle board.**

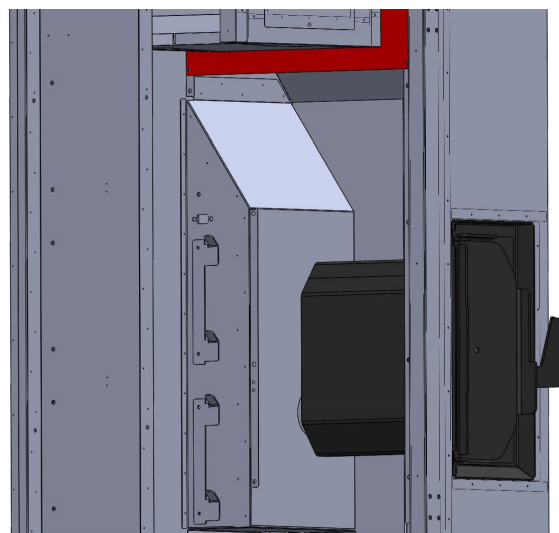

SEMI - ANNUALLY:

1. Have an experienced service technician inspect and clean the burner electrode. Southern Pride recommends replacing the burner electrode every 12-18 months, depending on usage.

MAINTENANCE (continued)

AS NEEDED:

(Frequency will depend on usage and local health department's requirements):

INTERIOR:



WARNING

It is extremely important to follow the below maintenance procedures. Grease or solids buildup inside the smoker could result in a fire hazard.

- Use a commercial product service detergent/degreaser to clean the smoker interior. Follow the product manufacturer's instructions for proper use, cautions and warnings. Protective gear such as goggles and rubber gloves should be used. **Note: Avoid the use of abrasive cleaning compounds, chloride based cleaners, or cleaners containing quaternary salts. Never use hydrochloric acid (muriatic acid) on stainless steel.**
- Smoker should be cool. Do not try to put cleaner on smoker when hot.
- While product racks are out of the smoker apply cleaner to the smoker interior: walls, ceiling, and floor and allow to soak for 10 minutes.
- Thoroughly rinse smoker interior with water using a water hose or pressure washer. **(Do not directly pressure wash the convection blower wheel; the blower wheel should be removed for cleaning).**
- Drain waste water; place a container under the drain. Dispose of rinse water according to local environmental requirements.
- Inspect the interior of the smoker for any areas that did not come clean; repeat the cleaning procedure in those areas.
- Thoroughly rinse the interior of the smoker and drain.
- Sanitize the smoker interior: walls, ceiling, floor, and convection fan with a commercial product service sanitizer. Follow the product manufacturer's instructions for proper use, cautions and warnings. Protective gear such as goggles and rubber gloves should be used. Wet all surfaces using a cloth or sprayer. Allow to remain wet for 10 minutes.
- Rinse surfaces by wiping with a cloth and clean warm water, and dry with a clean, soft cloth.
- To dry interior of the smoker leave product door open and allow to air dry.

Note: Consult with the appropriate state or local health department regarding all applicable cleaning and sanitation requirements for equipment.

MAINTENANCE (continued)

AS NEEDED:

(Frequency will depend on usage and local health department's requirements):

STAINLESS STEEL SURFACES:

Use non-abrasive cleaning products for use on stainless steel surfaces. Cleaning agents must be chloride-free compounds and must not contain quaternary salts. Never use hydrochloric acid (muriatic acid) on stainless steel surfaces. Always use the proper cleaning agent at the manufacturer's recommended strength.

EXTERIOR:

Southern Pride Smokers are known for their attractive appearance. We achieve this by selecting only the finest grade of type 304 stainless steel and applying exacting workmanship.

- All of the exterior of the smoker can be cleaned with a mild soap and water solution.
- Before cleaning the smoker, make sure it is turned off, main power switch off, and power cord disconnected from power.
- On mobile smokers, turn off LP gas.
- If the smoker is HOT from use, allow adequate time for it to cool down (approximately 1 hour).
- After the smoker exterior has been washed, apply a stainless steel polish cleaner to all surfaces.
- Wipe control panel, door handles, and door gaskets thoroughly, since these areas harbor food debris.
- **Do not use scotch bright pads or scouring pads to clean the outside of your smoker. If a non-abrasive scouring pad must be used, make certain to scrub with the visible grain of the surface metal to avoid scratches.**

Caution: Some cleaning products are not suitable for stainless steel; be sure to read the label before use.

PRODUCT DOOR LATCHES:

Remove and clean the product door latches.

1. After the smoker has been turned off and given time to cool, open the product door leaving the roller in the open position.
2. Using a crescent wrench on the edge of the latch cover, apply force to the crescent wrench towards the smoker to pop the latch cover free, and then the latch can be lifted away from the backing plate.
3. TO RE-INSTALL: Position the door latch, with the roller in the up position, over the backing plate, fastening the hooks on the latch over the tabs on the backing plate. Using the palm of your hand, push the bottom of the latch into the backing plate until it locks in position.

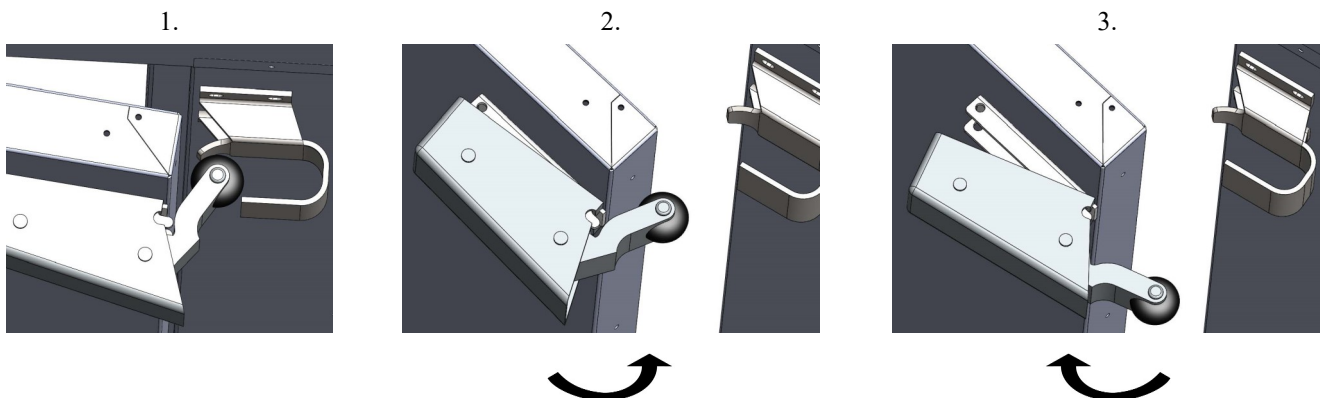

CAUTION:
The latch rollers are spring-loaded and will open quickly with a lot of force.
Do not pinch a finger or hand.

WIRING DIAGRAM

REV5

| | |
|--------------|-----|
| WHITE | --- |
| BLACK | --- |
| PURPLE/WHITE | --- |
| PURPLE | --- |
| ORANGE/WHITE | --- |
| ORANGE | --- |
| YELLOW | --- |
| RED/ORANGE | --- |
| RED/PURPLE | --- |
| RED | --- |
| GREEN | --- |
| BLUE | --- |

F=FEMALE END OF THE OVEN PLUG

| | | | | |
|----|----|----|----|----|
| 15 | 14 | 13 | 12 | 11 |
| 10 | 9 | 8 | 7 | 6 |
| 5 | 4 | 3 | 2 | 1 |

M=MALE END OF THE CONTROL PANEL PLUG

| | | | | |
|----|----|----|----|----|
| 5 | 4 | 3 | 2 | 1 |
| 10 | 9 | 8 | 7 | 6 |
| 15 | 14 | 13 | 12 | 11 |

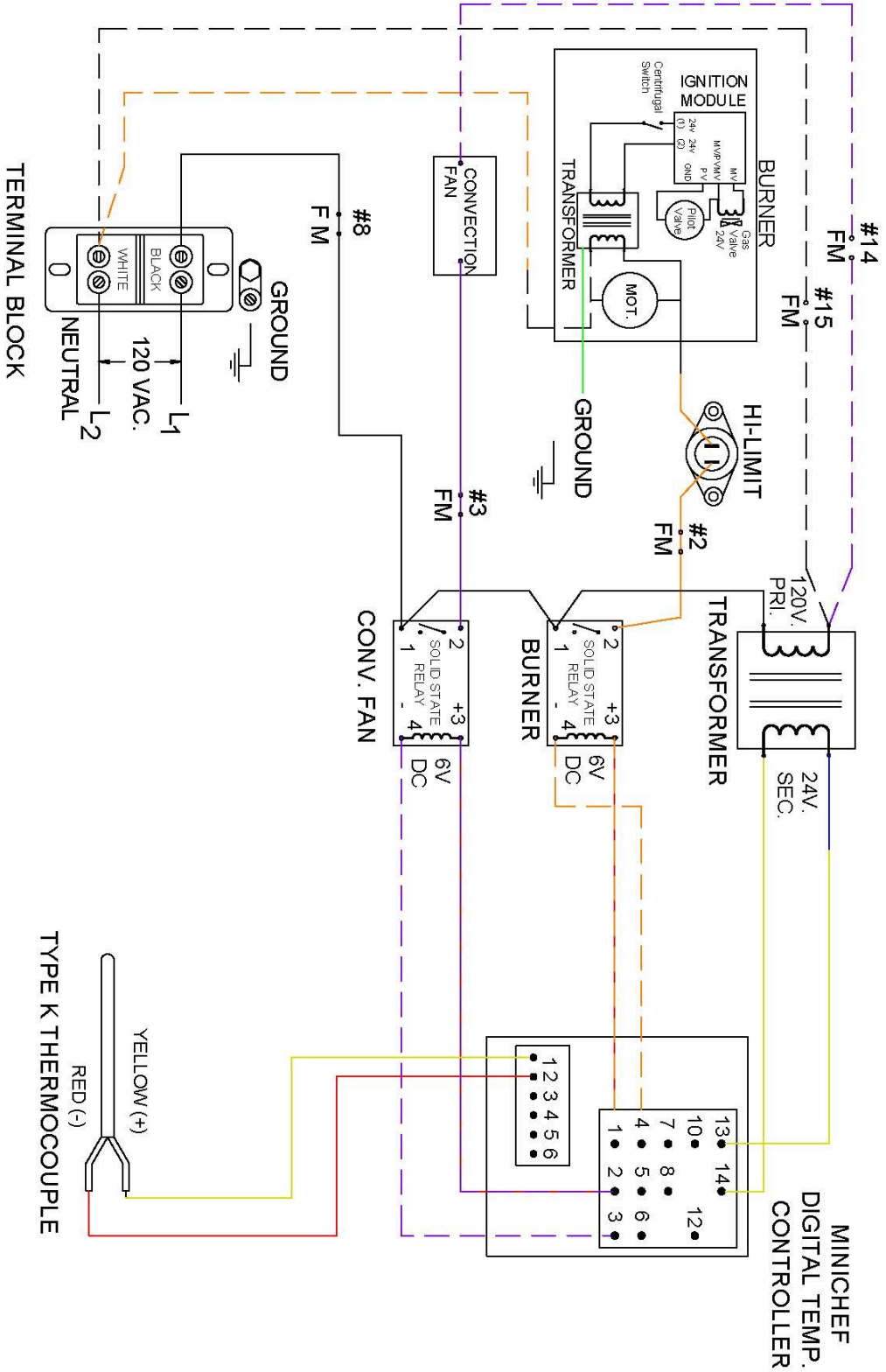

REPLACEMENT PARTS LIST

| Gaskets | |
|--------------------------|------------------------------|
| Product door | 070092 |
| Firebox door | 071014 |
| Electrical | |
| Cook & hold control | 431024 |
| Bi-metal high limit | 434002 |
| 10 amp solid state relay | 422006 |
| Type "K" thermocouple | 435011 |
| Convection | |
| Fan motor | 522009 |
| Blower wheel | 531003 |
| Burner | |
| Transformer | 582005 |
| Blower motor | 582008 |
| Gas valve | 582010 (Nat.) 582016 (LP) |
| Electrode/pilot assembly | 582011 (Nat.) 582015 (LP) |
| High voltage lead | 582012 |
| Ignition control module | 582019 |

| Door Hinges/Closers | |
|------------------------------|--------|
| Product door hinge | 870003 |
| Mechanical door closer | 771001 |
| Mechanical door closer latch | 771002 |
| Product Racks/Hangers | |
| Nickel chrome product rack | 970002 |
| Stainless steel product rack | 971001 |
| Stainless steel rack slides | 977013 |

BEFORE YOU CALL FOR SERVICE



WARNING:

Before any service is performed on the smoker, the gas supply should be turned off and the power disconnected.

| SYMPTOM | WHAT TO DO |
|--------------------------------|--|
| Smoker does not start | <ul style="list-style-type: none"> • Check that the power cord is plugged into a live outlet. • Check that the menu is programmed and the Start/Stop button has been pressed. |
| Noise inside the smoker | <ul style="list-style-type: none"> • Check and clean the convection blower wheel. |
| BFail appears on the control | <ul style="list-style-type: none"> • Press the start/stop button until "IDLE" is displayed. • Press the start/stop button to restart the cook cycle. • If the error reappears, call a service technician to service the burner. |
| Error 7 appears on the control | <ul style="list-style-type: none"> • Wet a cloth with warm water and hold it against the thermocouple located on the left inside wall of the smoker for 20-30 seconds. |

TROUBLESHOOTING THE GAS BURNER



WARNING:

Gas burners require an experienced technician for proper service and adjustment. If the burner does not appear to be operating properly, **DO NOT ATTEMPT TO ADJUST THE BURNER YOURSELF**, but call in a competent service technician.

GAS BURNER SEQUENCE OF OPERATION

It is very important to know the sequence of operation when troubleshooting the burner. The below steps describe the cycle for ignition in the sequence of operation for the burner.

1. The smoker is powered on with the desired cooking temperature set.
2. At a call for heat from the thermostat, 120 volts of power go through the thermostat, the high limit switch, and on to the burner.
3. The power comes into the burner at the junction box, which is located on top of the blower motor; 120 volts AC go to the primary side of the 24 volt AC step down transformer and to the combustion motor and the combustion motor comes on.
4. The step down transformer sends 24 volts AC out to the centrifugal switch on the blower motor.
5. When the blower motor is powered up and reaches full speed, the centrifugal switch (located on the end of the motor) is activated, sending 24 volts through it and on to the ignition control module.
6. When 24 volts reaches the ignition control module, it sends a high voltage spark out to the electrode (igniter) to light the pilot flame, and at the same time, it sends 24 volts to open the pilot valve on the main gas valve.
7. After the pilot lights, the electrode (igniter) acts as a flame sensor sending a DC micro amp signal back to the control module that there is a pilot flame, then the ignition control module sends out 24 volts AC to open the main valve.
8. The pilot flame lights the flow of gas from the main valve and the burner will fire until the call for heat from the thermostat has been satisfied, shutting the burner down.

NOTE: The burner is equipped with an ignition module that has a 3-try for ignition sequence.

TROUBLESHOOTING GUIDE

| SYMPTOM | WHAT TO DO |
|-------------------------------------|--|
| Blower motor does not run | <ul style="list-style-type: none">• Check for 120v present at the blower motor. |
| Burner does not fire | <ul style="list-style-type: none">• Check for 24 volts at the ignition control module.• Clean the centrifugal switch.• Check the condition of the ignition wire.• Clean the electrode and check the spark gap (1/8”). |
| Burner sparks, but does not fire | <ul style="list-style-type: none">• Remove any ash in the burner head.• Check that the gas is turned on.• Check the supply line pressure. (see page 14).• Clean the electrode. |
| Pilot lights, but burner does not | <ul style="list-style-type: none">• Check for loose wire connection at the valve and control module.• Clean the igniter rod. |
| Pilot lights, but does not stay lit | <ul style="list-style-type: none">• Check the igniter-sensor probe and wire. |

LIMITED WARRANTY

Southern Pride Distributing, LLC (“Southern Pride”) warrants to the original purchaser that any original part found to be defective in material or workmanship will, at Southern Pride’s option, subject to provisions hereinafter stated, be replaced with a new or rebuilt part. The labor warranty, provided only in the U.S.A., remains in effect one (1) year from installation or fifteen (15) months from the shipping date, whichever occurs first. Southern Pride will bear normal labor charges performed by an authorized Southern Pride service agent during standard business hours, and excluding overtime, holiday rates or any additional fees. The parts warranty remains in effect for one (1) year from installation or fifteen (15) months from the shipping date, whichever occurs first. All warranty parts ship via standard ground delivery service.

This warranty does not cover the following:

- Improper installation, delivery or maintenance.
- Failure of the Product if it is abused, misused, or used for other than intended purpose.
- Products which are not defective or broken, or which are working as described in the Owner’s Manual.
- Damage to the Product caused by accident, fire, floods, or acts of God.
- Damage caused by services performed by unauthorized service companies.
- Service calls to correct the installation of your Product or to instruct you how to use your Product.
- Expenses for making the Product accessible for servicing.
- Replacement of consumable parts; belts, gaskets, light bulbs, etc.

NO IMPLIED WARRANTY, REPRESENTATION OR CONDITION

To the extent permitted by law, neither Southern Pride nor any company/individual affiliated with it makes any warranties, representations, conditions or promises express or implied as to the quality, performance or freedom from defect of the smokers covered by these warranties other than those set forth above, and NO STATUTORY OR IMPLIED WARRANTIES OR CONDITIONS OF MERCHANTABILITY OR APPLICABLE PERIOD OF WARRANTY SET FORTH ON THIS PAGE. THE PURCHASER’S ONLY REMEDIES IN CONNECTION WITH THE BREACH OR PERFORMANCE OF ANY WARRANTY ON THE PRODUCTS ARE THOSE SET FORTH ON THIS PAGE. IN NO EVENT WILL SOUTHERN PRIDE OR ANY COMPANY/INDIVIDUAL AFFILIATED WITH IT BE LIABLE FOR INCIDENTAL OR CONSEQUENTIAL DAMAGES. In no event shall Southern Pride be liable for loss of use, loss of revenue or profit, or loss of product, or for any indirect, incidental or consequential damages.

LIMITATION OF LIABILITY

Southern Pride will not be liable under any circumstances for any incidental, consequential or special damages, including without limitation any lost profits or labor costs, arising from the sale, use or installation of the products, from the products being incorporated into or becoming a component of another product or from any other cause whatsoever, whether based on warranty (expressed or implied) or otherwise based on contract, on tort or any other theory of liability, and regardless of any advice or representations not in writing that may have been rendered by Southern Pride concerning the sale, use or installation of the products. In the event the above warranty fails to correct purchaser’s performance problems caused by defects in workmanship and/or materials, purchaser’s exclusive remedy shall be limited to payment by Southern Pride of actual damages in an amount not to exceed the amount paid for the smoker

IF YOU NEED SERVICE

To secure warranty service, the purchaser must (1) report the equipment defect to their authorized Southern Pride distributor and request warranty service within the applicable warranty term; (2) present evidence of the warranty start date with a valid proof of purchase; and (3) make the Product available within a reasonable time.

Should your problem not be solved to your complete satisfaction by your authorized Southern Pride distributor, you should contact Southern Pride at PO Box 354, Alamo, TN 38001, Phone: 1-800-437-2679. When contacting the manufacturer, the following information will be requested: (a) Model and serial number of the Product, (b) Address where the Product is installed, (c) Name and address of the installer and any service agency that performed service on the Product, (d) Date of original installation and dates any service work was performed, (e) Details of the problems as you can best describe them, (f) List of people, with dates, who have been contacted regarding your problem.



Gas-Fired Wood-Burning Stationary Rack BBQ Smoker

OWNER'S MANUAL 230 VAC / 50 Hz UNITS



SRG-400

CONGRATULATIONS!

In selecting Southern Pride, you have chosen the finest, most advanced and most fully automatic wood burning barbecue smoker available. With us, “It’s simply, a matter of Pride”.







Please read this manual carefully prior to installation, operation and maintenance of your Southern Pride smoker. Proper installation, operation, and maintenance are essential for your satisfaction and safe operation.

KEEP THIS MANUAL FOR REFERENCE

**NOTE: An Electrical Diagram for this appliance can be found on the inside of the fan motor compartment.
This smoker may be operated outdoors.**

SAFETY INFORMATION AND PRECAUTIONS

This manual should be considered a permanent part of this smoker. **THE SMOKER MUST BE INSTALLED BY A QUALIFIED SERVICE TECHNICIAN.** All troubleshooting guides, component views and parts lists included in this manual are for general reference only and are intended for use by qualified technical personnel.

| | | |
|---|--|---|
|  | <p style="text-align: center;">DANGER:</p> <p>Improper installation, alteration, adjustment, service, or maintenance could result in severe injury, death, or cause property damage. Read the installation, operating, and maintenance instructions thoroughly before installing or servicing this equipment.</p> | |
|  | <p style="text-align: center;">DANGER:</p> <p>Do not store or use gasoline or other flammable vapors or liquids in the vicinity of this or any other appliances.</p> | <p style="text-align: center;">WARNING: FOR YOUR SAFETY IF YOU SMELL GAS.....</p> <ol style="list-style-type: none"> 1. Open windows 2. Do not touch electrical switches 3. Extinguish any open flames 4. Immediately call your gas supplier |
|  | <p style="text-align: center;">CAUTION:</p> <p>Metal parts and surfaces of this smoker become extremely hot when in operation. To avoid burns, always use hand protection when operating the smoker.</p> |  |
|  | <p style="text-align: center;">WARNING: ELECTRIC SHOCK HAZARD</p> <p>Follow these rules to avoid electric shock.</p> <ul style="list-style-type: none"> • Use only a properly grounded circuit. • Do not spray water directly on electrical components. • Turn off power before servicing. • Read the owner's manual before using. | |
| | | <p style="text-align: center;">WARNING: CARBON MONOXIDE POISONING HAZARD</p>  <p>Carbon monoxide is a colorless, odorless gas that can kill. Follow these rules to control carbon monoxide.</p> <ul style="list-style-type: none"> • Do not use the smoker if in an unvented, enclosed area. Carbon monoxide may accumulate. • Allow only qualified burner service persons to adjust the burner. Special instruments and training are required. • Read the owner's manual before using. |

1. **IT IS EXTREMELY IMPORTANT TO FOLLOW THE PRESCRIBED CLEANING INSTRUCTIONS. GREASE OR SOLIDS BUILDUP INSIDE THE SMOKER COULD RESULT IN A FIRE HAZARD.**
2. This smoker is intended for use in commercial facilities where all operators are familiar with the purpose, limitations, and associated hazards of this equipment. The operating instructions and warnings must be read and understood by all operators and users.
3. This manual and all supplied instructions, diagrams, schematics, parts lists, notices and labels must remain with the smoker even if the smoker is sold or moved to another location.
4. The area around the smoker **MUST** be kept clear and free of combustible materials, gasoline and other flammable vapors and liquids.
5. The flow of combustion and ventilating air **MUST NOT** be obstructed from reaching the smoker.
6. The frame of the smoker **MUST** be electrically grounded at all times. See "Electrical Instructions".
7. Caution should be used when opening and closing the firebox door. The door is **HOT** during operation.
8. **DO NOT** remove service compartment access panels when smoker is in operation or leave off during operation.
9. Gas burners require the services of a qualified service technician for proper setting and adjustment. If the burner does not appear to be operating properly, **DO NOT ATTEMPT TO ADJUST THE BURNER YOURSELF.**
10. **DO NOT** allow unqualified personnel to perform service work or adjustments on this smoker. Doing so, will **VOID WARRANTY** and could result in a hazardous condition.
11. Ensure new employees, who might operate the smoker, are properly instructed and supervised on the operation and safety information prior to operating the smoker.
12. Ashes removed from the firebox should be stored in a non-combustible container with a sealed lid only. Store ashes in a well ventilated area. **FUMES COULD BE HAZARDOUS.**

TABLE OF CONTENTS

| | |
|---------------------------------------|-----|
| Diagram of Controls & Components..... | 5-6 |
|---------------------------------------|-----|

INSTALLATION

| | |
|-----------------------------------|----|
| Receiving the Smoker..... | 7 |
| Delivery Location..... | 7 |
| Unloading the Smoker..... | 8 |
| Unpacking the Smoker..... | 8 |
| Site Instructions | 8 |
| Electrical Instructions | 9 |
| Gas Piping Instructions..... | 10 |
| Gas Connection Instructions | 11 |
| Burner Specifications | 12 |
| Venting Instructions..... | 13 |

OPERATION

| | |
|--|-------|
| Control Operating Instructions..... | 15-17 |
| Product Loading Instructions | 18 |
| Firebox Loading Instructions..... | 18 |
| Product Unloading Instructions..... | 19 |
| Ash Removal Instructions..... | 19 |
| Grease Removal Instructions | 20 |
| Wood Storage Instructions | 20 |
| Mobile Smoker Operation | 21 |
| Mobile Smoker Electrical Information | 21 |
| Mobile Smoker Warnings..... | 21-23 |

MAINTENANCE

| | |
|--------------------------------------|-------|
| Daily..... | 24 |
| Weekly | 24 |
| Monthly | 25-26 |
| Quarterly | 26 |
| Semi-Annually..... | 26 |
| As Needed | 27-28 |
| Wiring Diagram..... | 29 |
| Replacement Parts List | 30 |
| Before You Call For Service..... | 30 |
| Troubleshooting the Gas Burner | 31 |
| Limited Warranty | 32 |

DIAGRAM OF CONTROLS AND COMPONENTS

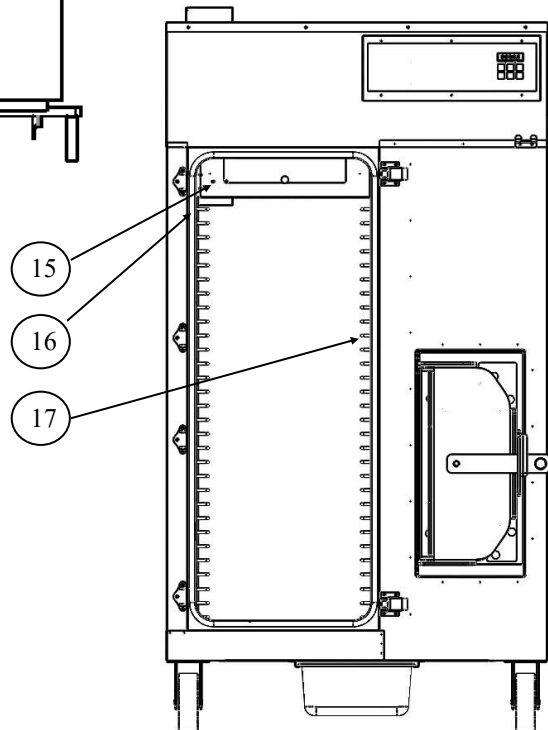
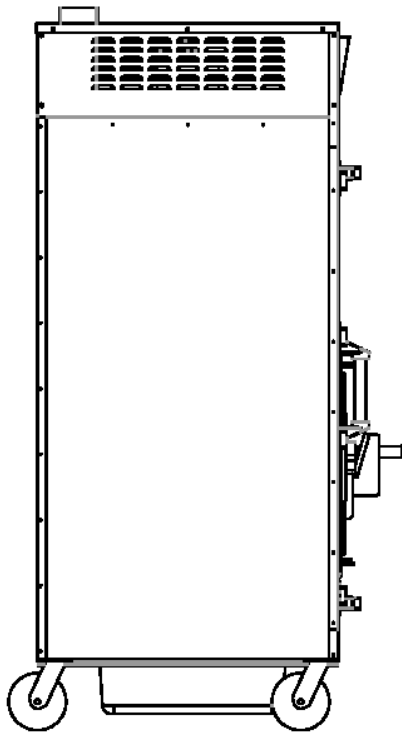
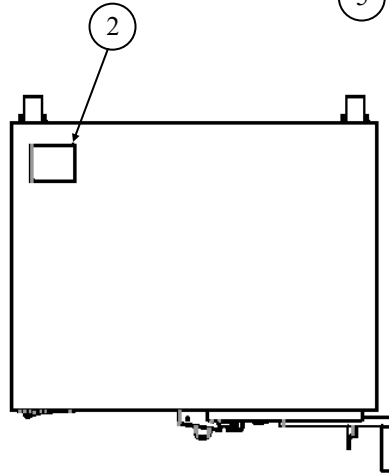
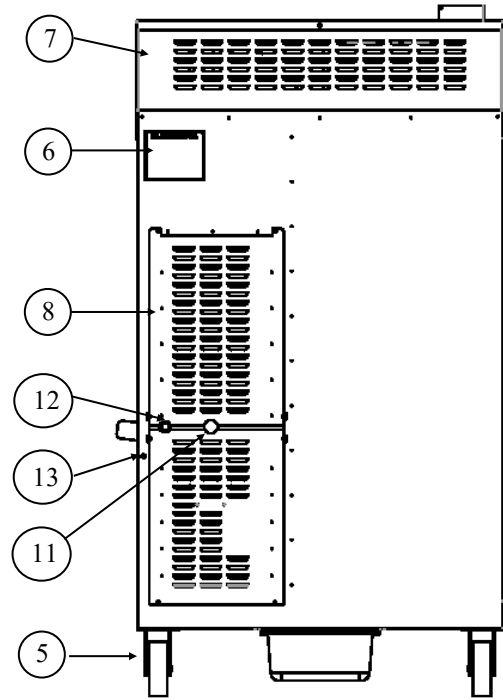
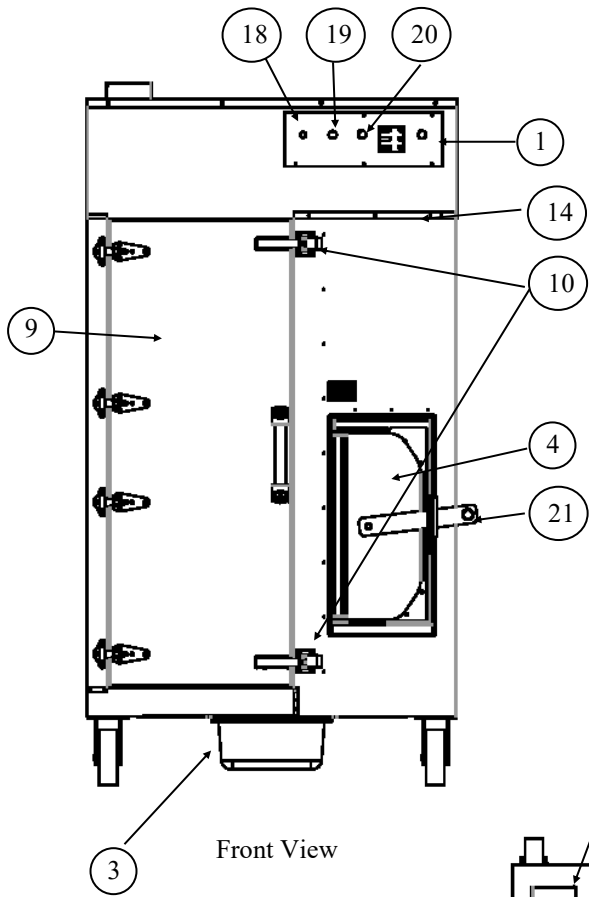

Left Side View

Inside View

DIAGRAM OF CONTROL AND COMPONENTS

1. **DIGITAL COOK & HOLD CONTROL** - Provides precise temperature control of the smoker along with control of the other functions of the smoker.
2. **FLUE** - Designed for use with canopy hood system.
3. **GREASE DRAIN PAN** – Opening in bottom of smoker allows grease to drain from smoker into pan during the cook cycle. **Pan must be emptied after each cook cycle.**
4. **FIREBOX DOOR** - Provides access to the firebox chamber for loading wood and ash removal. **Keep closed while cooking.**
5. **6” LOCKING CASTER WHEELS** - Heavy duty locking casters provide a solid base and offers convenient mobility.
6. **DATA PLATE** - Label containing smoker’s serial number, model number, manufactured date, etc.
7. **CONTROL / FAN MOTOR COMPARTMENT** – Location of the convection fan motor, control module and relay board.
8. **SERVICE COMPARTMENT COVER** - Access to service bay where burner is located.
9. **PRODUCT LOADING DOOR** – Provides access to load/unload product and for cleaning the interior of the smoker.
10. **PRODUCT LOADING DOOR LATCHES** - Latches apply positive pressure and seals door.
11. **GAS SUPPLY CONNECTION** - Drip leg connection point for incoming gas supply to smoker.
12. **POWER CORD CONNECTION** - Access point for supply power cord to smoker.
13. **TETHER / WALL ANCHOR BOLT MOUNTING LOCATION** - Threaded hole for installation of eyelet bolt used to attach restraining device for smokers mounted on caster wheels to guard against transmission of strain to the gas and electrical connections.
14. **ASH PAN HANDLE HOOK** - Storage location for ash pan handle.
15. **BLOWER WHEEL SHROUD** - Access to the convection fan blower wheel.
16. **THERMOCOUPLE** - Provides the temperature reading for the control.
17. **HIGH LIMIT** - Ensures that the smoker does not exceed safe operating temperatures.
18. **EMERGENCY STOP SWITCH** - Shuts incoming power off to the smoker.
19. **HIGH LIMIT RESET** - If the smoker exceeds 400°F (204°C) the high limit will trip, shutting the burner off. Once smoker cools below 400°F (204°C), press the reset button to resume normal operation.
20. **BURNER LIT INDICATOR** - Indicates power has been applied to the main gas valve.
21. **FIREBOX PROXIMITY SWITCH** - Shuts off power to burner when firebox door is opened during smoker operation.

INSTALLATION

RECEIVING THE SMOKER

Once the smoker arrives you will need a forklift to remove the crated smoker from the truck.

| Model | Approx. Wt. Uncrated | Approx. Wt. Crated |
|---------|----------------------|--------------------|
| SRG-400 | 354 kg | 635 kg |

NOTE: The above weights are for the base model only.

DELIVERY LOCATION

Commercial smokers are large and heavy. Before scheduling the delivery of your smoker have a plan and location in place to accept the delivery of the smoker and maneuver the smoker into the desired installation location. The trucker will require a flat, level surface that is safe from traffic to unload the smoker. A forklift will be required to unload the smoker. The trucker is only responsible for delivery of the smoker. It is your responsibility to unpack the smoker, move it to its installation location, and have a qualified service technician install the smoker.



WARNING:

If the forklift forks are not long enough to support the entire smoker/crate do not attempt to move the smoker; obtain another forklift or use fork extensions.



WARNING:

Only proper heavy lifting machinery and heavy lifting equipment should be used for unloading, moving and installing the smoker. This duty should only be performed by professionals trained in this kind of work. Improper handling of the equipment could result in damaging the smoker or personal injury and even death.

UNLOADING THE SMOKER

Smokers Shipped via Common Carrier

Remove the crated smoker from the truck using the appropriate forklift. Note any damage to the crate, smoker or accessories. **Do not sign the delivery bill until the smoker has been inspected and any damage noted on the delivery bill.**

The smoker is shipped strapped to a wooden pallet with OSB sides and top. Once the smoker is in a level and safe place remove the top and sides. Located on top of the wooden pallet are two (2) wooden ramps. Fasten the ramps to the edge of the wooden pallet using the metal clasps located on the end of the pallet and ramps. The smoker is secured to the wooden pallet with metal banding straps. A board prevents the smoker from moving. After removing the banding straps securing the smoker to the wooden pallet and the board (with a Phillips screwdriver), release the brakes on each of the smokers casters. Then the smoker can be slowly and carefully rolled down the ramps secured to the pallet.

UNPACKING THE SMOKER

- The ash pan handle is secured to a product rack with a plastic zip tie.
- The smoker is shipped with plastic zip ties holding the product racks to the rack slides. These zip ties should be removed prior to initial operation.
- A 6" (152mm) drain pan is located inside the smoker.

SITE INSTRUCTIONS

The Southern Pride smoker must be installed in a location that will permit the smoker to function for its intended purpose and to allow adequate clearance for ventilation, proper cleaning, and maintenance access.

Minimum Clearance Requirement from Combustible Material

| | |
|----------------------|---------------------------------|
| Back.....18" (457mm) | Front.....48" (1219mm) |
| Top.....18" (457mm) | Right & Left Side.....2" (51mm) |

NOTE: If provision is made for service access, back clearance can be reduced to 2" (51mm).



WARNING: Failure to maintain proper safety, storage, handling, and ash removal for solid fuel appliances on or around combustible materials may result in fire, property damage and/or death. Our product listing allows for the smoker to be installed on a combustible surface however, Southern Pride recommends the use of a noncombustible material for the floor surface area under the firebox, which should extend at least 6" (152 mm) beyond each side of the firebox, and outward from the smoker beyond the area needed for placement of the ash container.

ELECTRICAL INSTRUCTIONS

Electrical Requirements:

- 230 volts AC, 50 Hz, 16 A IP23
- 2 wire with ground

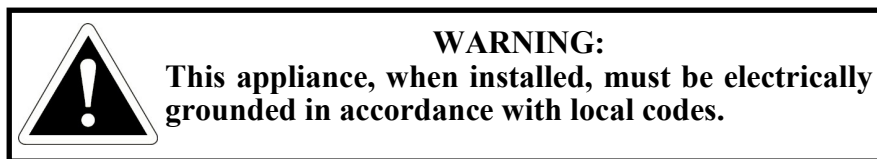

THE WARRANTY IS VOID IF THE SMOKER IS CONNECTED TO ANY VOLTAGE OTHER THAN SPECIFIED ABOVE AND ON THE SMOKER DATA PLATE.

Remove all packing material before connecting the electrical and gas supply to the smoker.

1. An electrician must provide the conduit and wire for electrical hookup. The smoker should be connected to a dedicated 16 amp receptacle.
2. The power is to be left OFF throughout the installation.
3. The electrical service is connected on the rear of the smoker on the service bay side.
4. If venting or gas connections are to be done at a later time, be sure that the power remains OFF.
5. A restraining device must be installed.

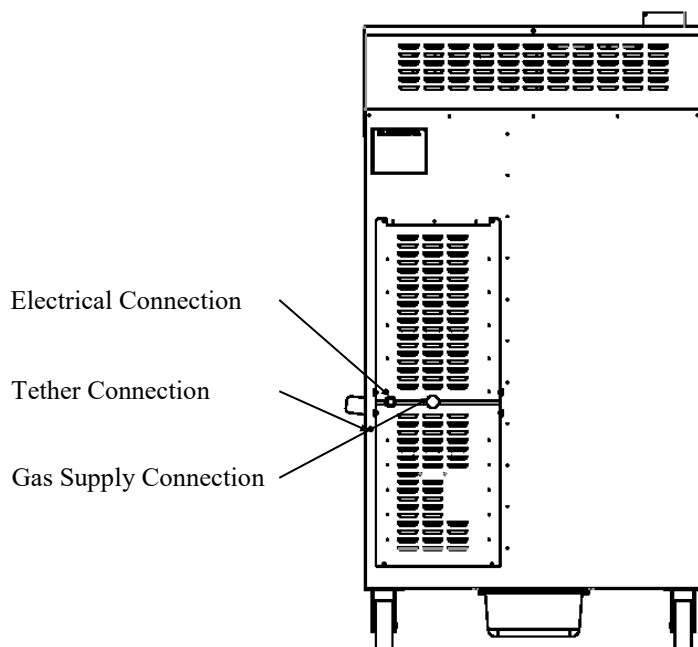

GAS PIPING INSTRUCTIONS

IMPORTANT NOTES TO THE INSTALLER

- Read all instructions contained in this owner's manual before making gas connections.
- Ensure all packing material is removed from the smoker compartments before connecting the gas supply to the smoker.
- Be sure your smoker is installed and grounded properly by a qualified service technician.
- Observe all governing codes and ordinances.

WARNING: IMPROPER GAS HOOKUP WILL VOID WARRANTY AND COULD RESULT IN A HAZARDOUS CONDITION.

1. All local and national codes and ordinances must be observed. Installation must conform with local codes.
2. The gas supply (service) line must be the same size or greater than the inlet line of the appliance. This smoker uses a 1/2" ID NPT (Sch40) inlet. Sealant on all pipe joints must be resistive to LP gas.
3. Supply line and manifold pressure should be checked with a manometer. Refer to page 12 for minimum and maximum pressures. Incoming line pressure upstream from the regulator must be 2.49 mbar higher than the manifold pressure in order to check the regulator. The regulator used on this smoker can withstand a maximum input pressure of 34.47 mbar (3.48 kpa). Over pressuring the valve may cause damage to the valve. If the line pressure is in excess of that amount, a step down regulator will be required.
4. It is recommended new pipe be used and located so that a minimum amount of work will be required in future servicing. The piping should be so installed as to be durable, substantial, and gas tight. It should be free from cutting burrs and defects in structure and threading. Cast iron fittings or aluminum tubing should not be used for the main gas circuit. Joint compounds (pipe dope) should be used sparingly on male threads only and be approved for all gases.

NOTE: The building structure should not be weakened by installation of the gas piping. The piping should not be supported by other piping, but should be firmly supported by pipe hooks, straps, bands, or hangers. Butt or lap welded pipe should not be bent.

5. **TEST PIPING FOR LEAKS.** Before turning gas under pressure into piping, all openings from which gas can escape must be closed. Immediately after turning on gas, the system should be checked for leaks. This can be done by watching the smallest graduation on the test dial for 5 minutes to show any movement, or by soaping each pipe connection and watching for bubbles. If a leak is found, make the necessary repairs and repeat the above test.

NOTE: Defective pipes or fittings should be replaced and not repaired. Never use a flame or fire of any form to locate gas leaks, use a soap solution.

6. After the piping and meter have been checked completely, **PURGE THE SYSTEM OF AIR. DO NOT** bleed the air inside the smoker. Be sure to relight all the gas pilots on other appliances.

NOTE: The burner and its individual shutoff valve must be disconnected from the gas supply piping system during any pressure testing in excess of 34.47 mbar.

GAS CONNECTION INSTRUCTIONS

For smokers equipped with casters, the installation shall be made with a connector, and a quick-disconnect device.

Adequate means must be provided to limit the movement of the appliance without depending on the connector and the quick-disconnect device or its associated piping to limit the appliance movement.

A restraining device may be attached using the mounting hole provided on the rear of the smoker. Refer to page 5 to locate the mounting hole.

WARNING: Operator should be aware that a restraint device is in place on smokers equipped with casters. If disconnection of the restraint is necessary, it must be reconnected after the appliance has been returned to its originally installed position.

IMPORTANT ITEMS TO CHECK BEFORE FIRING THE BURNER

1. Gas line **MUST** be installed by a qualified technician and in accordance with this manual.
2. Gas line **MUST** include an easily accessible manual shutoff valve, drip leg, and pressure gauge port.
3. Gas line **MUST** be tested for leaks under pressure.
4. Gas line **MUST** be purged to remove any air in the system.
5. Gas line pressure **MUST** be checked and **MUST NOT** exceed the maximum pressure specified in the Burner Specifications on page 12.
6. Burner orifice **MUST** correlate with the type of gas being supplied, as specified in the Burner Specifications on page 12.



WARNING:
Improper gas hookup will void the warranty and could result in a hazardous condition.

BURNER SPECIFICATIONS

Burner Models: Wayne P265-EP

Fuels: Natural or L.P. Gases

Electrical: 230 V.A.C., 50 Hz, 1 ph

NOTE: Orifice and valve setting must correlate with type of gas being supplied.

| Firing Capacity | |
|-------------------------------|----------------------|
| Firing Rate Btu KW | 65,000 19 |
| SRG-400 | X |

| | Gas Supply Line Pressure | | Manifold Pressure | |
|----------------|--------------------------|-------------------------|------------------------|-------------------------|
| | Minimum | Maximum | Minimum | Maximum |
| Natural | 4.5" w.c. 11.2 mbar | 10.0" w.c. 24.9 mbar | 3.0" w.c. 7.5 mbar | 3.5" w.c. 8.7 mbar |
| LP | 11.0" w.c. 27.4 mbar | 13.0" w.c. 32.4 mbar | 9.5" w.c. 23.7 mbar | 10.0" w.c. 24.9 mbar |

| Pilot Orifice Size Chart | |
|--------------------------|--------|
| Natural | BCR-24 |
| LP | BCR-18 |

| Main Orifice Size Chart | | |
|---------------------------|-------------|-------------------------|
| 65,000 Btu/hr 19 KW/hr | Natural Gas | #26 (.147") (3.73mm) |
| 65,000 Btu/hr 19 KW/hr | LP Gas | #43 (.089") (2.26mm) |

NOTE: An approved gas valve should be locally sourced and installed to allow the gas supply to be shutoff prior to entering the smoker.

VENTING INSTRUCTIONS

THE METHOD OF VENTILATION MUST BE APPROVED BY THE LOCAL CODE ENFORCEMENT AGENCY PRIOR TO EQUIPMENT INSTALLATION.

1. The smoker ventilation system should comply with this manual.
2. It is recommended that Local Code Officials and a Commercial Kitchen Ventilation Contractor be consulted prior to installation.
3. Provisions must be made for adequate air supply for the smoker. If the smoker is to be installed in a sealed room or building utilizing exhaust fans, the room must be supplied with a return air system. Return air must be equal or in excess of the exhausted air.
4. The smoker should be positioned to provide a direct, or shortest, path to the outside for the exhaust duct.

Minimum Clearance Requirement from Combustible Material

Back.....18" (457mm) Front.....48" (1219mm)

Top.....18" (457mm) Right & Left Side.....2" (51mm)

NOTE: If provision is made for service access, back clearance can be reduced to 2" (51mm).

CANOPY HOOD VENT

All smoker models may be installed under an approved canopy hood system rated for commercial cooking appliances.

- Placement under a common hood shared with other appliances may be prohibited.
- Southern Pride recommends a minimum 18 inch (457mm) overhang on the product loading door side of the smoker and a 6 inch (152mm) overhang on all other sides.
- Exhaust fan size must be determined by a ventilation contractor specifically for your application. Hood dimensions, exhaust duct length and routing all factor into the calculation.

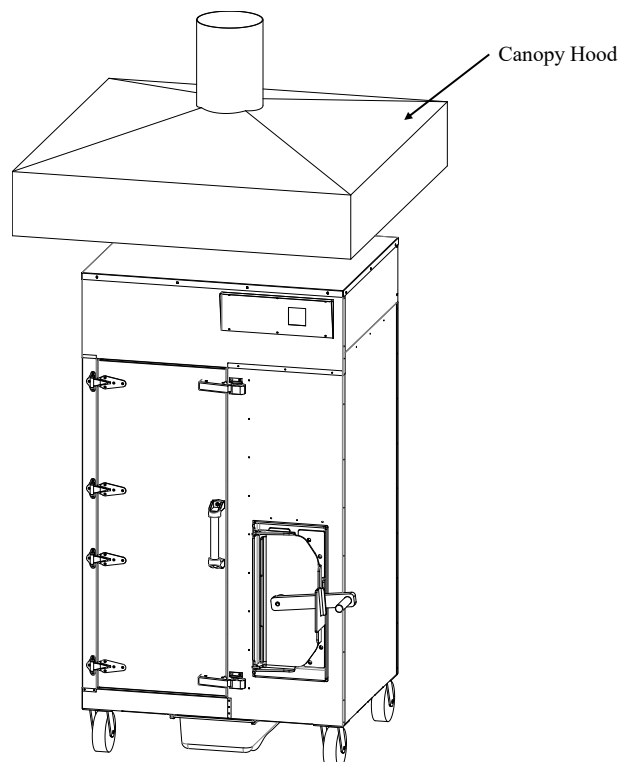

OPERATION

The smoker should be operated in the following order (with all operations according to the subsequent instructions):

1. Ensure that the drain pan is empty and installed in the pan rails located under the smoker drain hole.
2. Set the control and start the cook cycle.
3. Once the smoker reaches the temperature set point, pause the menu, load the product into the smoker and close the product loading door.
4. Place the desired wood into the firebox, close the firebox door and resume the menu.
5. Once the cook cycle is complete, turn the control off.
6. Remove the product from the smoker.
7. Remove the ashes from the firebox.
8. Empty the grease from the grease pan.

CONTROL OPERATING INSTRUCTIONS

DIGITAL COOK & HOLD CONTROL - Manual Menu

1. The product loading door must be closed.
2. The display must read IDLE. (The burner, and convection fan will be off). If the display reads OFF, a press of any button will bring the control to IDLE.
3. A menu consists of a cook temperature, cook time, and, when the cook time has elapsed, a choice to end the menu (HOLD OFF) or go into hold mode (HOLD TEMP SETPOINT).
4. Press the manual menu button (TENP1 will be displayed), then press the up/down buttons to obtain the desired cook temperature.
5. Press the manual menu button (TINE1 will be displayed), then press the up/down buttons to obtain the desired cook time.
6. Press the manual menu button (HTENP will be displayed), press the up/down buttons to obtain the desired hold temp, if a hold temp is not desired press the down button until OFF is displayed.
7. Programming the menu is complete. To start the menu, press the start/stop button one time. The control will begin the menu.
8. To pause the menu, press the start/stop button one time and PAUSE will be displayed. To resume the menu, press the start/stop button one time.
9. To cancel or stop the menu, press and hold the start/stop button until IDLE is displayed.
10. Once the smoker has reached the temperature set point an audible alarm will sound. A press of any button on the control will stop the alarm. After two minutes the alarm will stop; if no button is pressed.
11. When the cook cycle is complete there are two possible actions that can be taken. One is if a hold temperature was programmed into the menu, the control will momentarily sound an audible alarm then, HOLD and the length of time the control has been in the hold mode will alternately flash in the display. The control will maintain the hold temperature until the start/stop button is depressed to END the menu, and bring the control to the IDLE mode.
12. If the hold temperature was programmed to OFF and the cook time has elapsed, END will be displayed, and an audible alarm will sound continuously until the start/stop button is depressed, to END the menu, and bring the control to the IDLE mode.
13. After the control has been in the IDLE mode for five minutes it will go to OFF, a press of any button will bring the control back to IDLE.
14. After each cook cycle the ashes should be removed from the firebox and the grease emptied from the drain pan.

NOTE: When the control is in IDLE the convection fan will continue to run until the smoker temperature falls below 120°F (49°C).

CONTROL OPERATING INSTRUCTIONS (continued)

DIGITAL COOK & HOLD CONTROL - Automatic Menu Programming

1. The product loading door must be closed.
2. The display must read IDLE. (The burner, and convection fan will be off). If the display reads OFF, a press of any button will bring the control to IDLE.
3. A menu consists of a cook temperature, cook time, and, when the cook time has elapsed, a choice to end the menu (HOLD OFF) or go into hold mode (HOLD TEMP SETPOINT).
4. Press and hold the up and down buttons for 10 seconds to access the menu program state (M 1 will be displayed).
5. Press the manual menu button to access the menu parameters for menu 1 (STPT1 will be displayed), this is the set point temperature for the menu.
6. Press the manual menu button again to change the cook temperature. Use the up/down buttons to obtain the desired cook temperature. Press the enter button to save the change.
7. Press the down button to advance to cook time (TINE1 will be displayed). To change the cook time, press the manual menu button. Use the up/down buttons to obtain the desired cook time. Press the enter button to save the change.
8. Press the down button to advance to hold temperature (HSTPT1 will be displayed). To change the hold temperature, press the manual menu button. Use the up/down buttons to obtain the desired hold temperature, if a hold temperature is not desired press the down button until OFF is displayed. Press the enter button to save the change.
9. Programming the menu is complete. Press the enter button to return to the menu list. Use the up/down buttons to select the next menu to program. Repeat the above steps to program the next menu. Once programming is complete, press the enter button twice to return to IDLE.

CONTROL OPERATING INSTRUCTIONS (continued)

DIGITAL COOK & HOLD CONTROL - Automatic Menu Operation

1. The product loading door must be closed.
2. Press the auto menu button. The number of the first automatic menu will be displayed.
3. Use the up/down buttons to scroll through the list of automatic menus. When the desired menu number is displayed, press the start/stop button to start the menu.
4. To pause the menu, press the start/stop button one time and PAUSE will be displayed. To resume the menu, press the start/stop button one time.
5. To cancel or stop the menu, press and hold the start/stop button until IDLE is displayed.
6. Once the smoker has reached the temperature set point an audible alarm will sound. A press of any button on the control will stop the alarm. After two minutes the alarm will stop; if no button is pressed.
7. When the cook cycle is complete there are two possible actions that can be taken. One is if a hold temperature was programmed into the menu, the control will momentarily sound an audible alarm then, HOLD and the length of time the control has been in the hold mode will alternately flash in the display. The control will maintain the hold temperature until the start/stop button is depressed to END the menu, and bring the control to the IDLE mode.
8. If the hold temperature was programmed to OFF and the cook time has elapsed, END will be displayed, and an audible alarm will sound continuously until the start/stop button is depressed, to END the menu, and bring the control to the IDLE mode.
9. After the control has been in the IDLE mode for five minutes it will go to OFF, a press of any button will bring the control back to IDLE.
10. After each cook cycle the ashes should be removed from the firebox and the grease emptied from the drain pan.

NOTE: When the control is in IDLE the convection fan will continue to run until the smoker temperature falls below 120°F (49°C).

PRODUCT LOADING INSTRUCTIONS

The smoker is equipped with fourteen (14), 18" x 26" (457 x 660mm) product racks in its standard configuration for the loading of product. The modular designed rack slide system has 1.5" (38mm) spacing that allows the smoker to hold up to 27 product racks at one time.

1. Before opening the product door, the control should be in the IDLE or PAUSE position .
2. Remove the product rack from the smoker.
3. Place the product directly on the product rack, leaving an air gap between each piece of product.
4. With the product placed on the food rack, carefully slide the loaded product rack into the smoker starting from the bottom rack slide position.
5. Repeat steps 2 and 3 until all product is loaded into the smoker. Product height will determine how many rack slide spaces you need to advance to maintain an air gap between each loaded product rack.
6. If the cook menu was paused, a press of the start/stop button is required to resume the menu.

FIREBOX LOADING INSTRUCTIONS

1. Southern Pride recommends that the smoker be allowed to reach the temperature set point (the audible alarm will sound) before loading wood into the firebox. This will help prevent the smoker from exceeding the temperature set point.
2. Before opening the firebox door, the control should be in the IDLE or PAUSE position
3. Use 1-3 logs, 3-5 inches (76 - 127mm) in diameter, 10-12 inches (254 - 305mm) long. Use green or slightly seasoned hardwoods, fruitwoods, or charcoal (not to exceed six pounds, 2.7kg). **THE WOOD OR CHARCOAL IS ONLY USED TO FLAVOR THE PRODUCT, NOT TO HEAT THE SMOKER.**
4. Be sure to keep the wood 4 inches (102mm) from the burner or ashes can accumulate on the burner and cause it to not work properly.
5. Place the logs on top and inline with each other to minimize air flow around each log. This will help promote a smoldering, slow burn, which maximizes smoke.
6. The wood does not have to be lit manually; the smoker is equipped with a gas burner that will light the wood. Combustible or flammable liquids shall not be used to assist ignition.
7. Tightly close the firebox door to prevent air from being pulled into the firebox.
8. If the cook menu was paused, a press of the start/stop button is required to resume the menu.

CAUTION:

- **Remove coals and ashes from previous cook cycle before loading new wood into the firebox. Refer to Ash Removal Instructions on page 19.**
- **Do not use dry wood or kindling.**
- **Do not overload firebox. Too much wood or charcoal can cause overheating of the smoker. Keep wood at least 4 inches (102mm) from the burner.**
- **Do not allow ashes in or near the burner opening.**

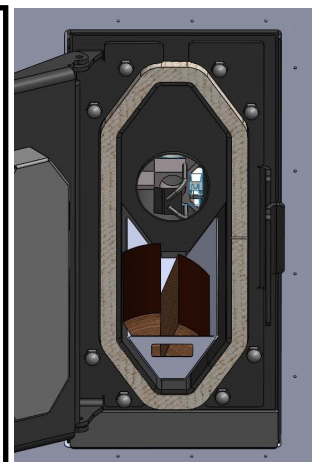



PRODUCT UNLOADING INSTRUCTIONS

1. Before unloading the product, the control should be in the IDLE or OFF position.
2. Carefully open the product loading door just enough to release the smoke from the cabinet, then wait approximately 5 seconds before fully opening the product loading door.
3. Product should be removed from top rack to the bottom rack.

ASH REMOVAL INSTRUCTIONS

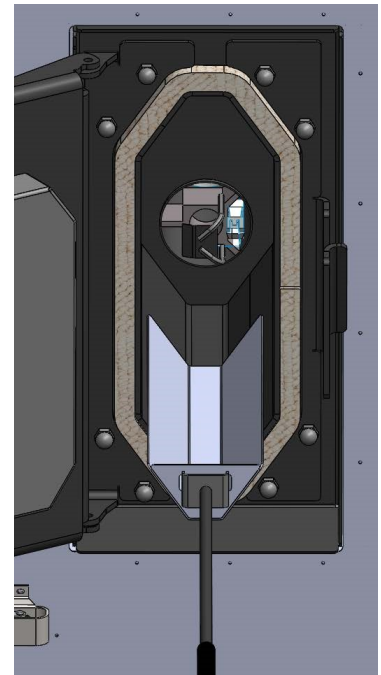
1. Before emptying the firebox, the control should be in the IDLE or OFF position.
2. After each cook cycle, remove the remaining wood and hot coals from firebox. Use heat resistant gloves while handling ash container and ash removal tools. The ash pan handle should be used to remove the ash pan from the firebox. The end of the ash pan handle is inserted into the opening in the end of the ash pan. The two hooks on the ash pan handle grip the opening in the ash pan and leverage is used as the ash pan is removed from the firebox.
3. Place small lots of them in a noncombustible corrosion resistant pan and spray with water. A noncombustible corrosion resistant pan should be kept just outside the firebox door for this purpose.
4. Once wood and ash have been sprayed, place them in a heavy metal container with a tight fitting metal lid (16 gauge (1.59mm) minimum, capacity not to exceed 20 gallon (76 liters)). This container shall be assigned for this one purpose, shall be able to be handled easily by any employee assigned the task, and shall pass easily through any passageway to the outside of the building. The container shall always be covered when it is being moved through the premises. When any hole occurs in a container from corrosion or damage, the container shall be repaired or replaced immediately.
5. The ashes should be carried to a separate heavy metal container (or dumpster), outside the premises, that is used exclusively for the purpose of hot ash storage.



| | |
|---|---|
|  | <p>WARNING</p> <p>Never empty ash/coals from the smoker into a common trash dumpster. Embers from ash/coals could ignite materials resulting in a fire.</p> |
|---|---|

| | |
|---|--|
|  | <p>CAUTION</p> <p>Be sure smoker product loading door and firebox door are secured in the closed position immediately following a cook cycle and during non-use periods.</p> |
|---|--|

GREASE REMOVAL INSTRUCTIONS

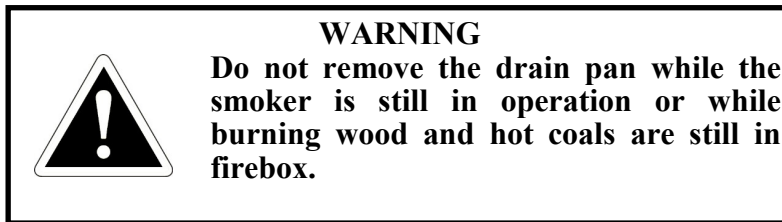

1. Immediately empty the grease pan after each cook cycle. **CAUTION: Grease will be hot.**
2. Grease should be poured into an approved grease recycling bin.

WOOD STORAGE INSTRUCTIONS

- Wood stored in the same room as the smoker or the smoker firebox door shall not exceed a 1-day supply.
- Wood shall not be stored above any heat-producing appliance or vent or closer than 0.92 m (3ft) to any portion of a solid fuel appliance constructed of metal or to any other cooking appliance that could ignite the wood.
- Wood shall not be stored in the path of ash removal.
- Where stored in the same building as the smoker, wood shall be stored only in an area with walls, floor and ceiling of noncombustible construction extending at least 0.92m (3ft) past the outside dimension of the storage pile.
- Wood shall be separated from all flammable liquids, all ignition sources, all chemicals, and all product supplies and packaging goods.

MOBILE SMOKER OPERATION

- Check the fuel level of the LP tanks prior to starting a cook cycle. Proper monitoring of the LP tanks will eliminate the chance of running out of gas.
- The burner in the smoker is equipped with an automatic ignition system. **Do not attempt to manually light the burner.**
- Do not transport the smoker while the smoker is in operation or with product on the product racks.
- Disconnect the electrical power supply before removing the service compartment access panels for servicing.
- Do not transport the smoker with hot coals or a wood fire in the firebox.
- Never place anything over the flue of the smoker, it must be unobstructed to work properly.
- Never attempt to cook with the product door, or firebox door, open.
- **Dry wood, too much wood, or too much charcoal may cause the temperature in the smoker to override the thermostat setting.** Follow instructions in this manual for the proper amount of wood or charcoal to use.

MOBILE SMOKER ELECTRICAL INFORMATION

DO NOT cut or remove the grounding prong from the smoker power cord or from any extension cord used with the smoker.

The smoker should only be plugged into a 230 VAC, 16 amp, grounded receptacle.

Use only a 3 prong grounded extension cord rated for outdoor use.

MOBILE SMOKER WARNINGS

GENERAL

1. Mobile smokers are intended for outdoor use. NEVER use in a garage, building, shed, breezeway or other enclosed area. The mobile smoker shall not be used under any overhead combustible construction.
2. Store your smoker in a well-ventilated area. If stored indoors, detach and leave LP cylinders outdoors in a well-ventilated area away from heat and away from where children may tamper with them.
3. Keep the electrical supply cord and the fuel supply hose away from any heated surfaces.
4. Do not remove service compartment access panels when smoker is in operation or leave off during operation.
5. After a period of storage or nonuse, check the smoker for gas leaks and burner obstructions before use.
6. Wheel chocks must be used when the smoker is sitting stationary.
7. Level the smoker, both front to back and side to side, before operating the smoker.

MOBILE SMOKER WARNINGS (continued)

ELECTRICAL

1. To protect against electrical shock:
 - a) do not immerse any part of the power cord, plug or extension cord in water or any other liquid.
 - b) use only a 3 prong extension cord, and only plug into a 16 amp grounded receptacle.
2. Unplug the smoker from the outlet when not in use and before cleaning.
3. Do not let the extension cord hang over the edge of a table or touch hot surfaces. Keep the cord out of walkways to avoid a tripping hazard.
4. Do not use this smoker for purposes other than intended.
5. Do not operate this smoker with a damaged cord, plug, or after the smoker malfunctions or has been damaged in any manner.

LP GAS

1. Never use a cylinder with a damaged valve. A dented or rusty LP cylinder may be hazardous and should be avoided. If in doubt, have the cylinder checked by your LP supplier. Always check for leaks after every LP cylinder change.
2. Always shut off the LP gas supply at the cylinder when the smoker is not in use.
3. Cylinders must be stored outdoors in a well-ventilated area out of the reach of children. If your smoker is stored indoors, the LP cylinder must be removed and stored outside. LP gas cylinders are not to be stored in any compartment on the smoker that is not intended for cylinder storage. Such unauthorized storage could lead to an explosion, fire, or personal injury.
4. Cylinders should not be allowed to remain in a high heat area such as a closed car, trunk, or in direct sunlight.

MOBILE SMOKER WARNINGS (continued)

LP GAS (continued)

5. Before each use, inspect the gas hose. If excessive abrasion, wear or if the hose is cut it must be replaced prior to the smoker being put into operation.
6. LEAK TESTING: Do not use a flame to check for a gas leak. To prevent fire or explosion hazard, DO NOT smoke or allow any potential source of ignition (sparks, electrical arcing, etc.) in the area while performing a leak test. Leak tests should be conducted outdoors only.
 - a. Create a soapy solution of 1 part soap and 1 part water, or use a gas leak detector solution available for purchase from a plumbing supply or hardware store. Confirm that all control knobs are in the off position.
 - b. Open the gas supply valves and apply the soap solution generously by paint brush or squirt bottle on all connections and fittings. If bubbles appear to “grow” on any of the connections, you have a gas leak, immediately turn off the gas supply.
7. Fixing a gas leak: Wash off the soapy solution with cold water and dry. Tighten the loose joint, or replace the faulty part with manufacturer-recommended replacement parts.
8. Do not attempt to repair the LP cylinder valve if it is damaged. The only way to safely resolve a damaged cylinder is to replace it.
9. Repeat the leak test to ensure that no leaks are present.
10. Do not operate the smoker if there is a gas leak present.
11. Leaking gas may cause a fire or explosion which can cause serious bodily injury or death.
12. When not in use, the gas valve on the LP tanks must be turned off and the supply line disconnected from the tanks. The protective dust cap must be installed on the valve outlet.
13. Liquid propane is not natural gas. The conversion to or attempted use of natural gas in a liquid propane smoker is dangerous and will void your warranty.
14. Do not attempt to disconnect any gas fitting while your smoker is in operation.
15. Although your liquid propane cylinder may appear to be empty, gas may still be present. The cylinder should be transported and stored with the valve closed.

MAINTENANCE



WARNING

It is extremely important to follow the below maintenance procedures. Grease or solids buildup inside the smoker could result in a fire hazard.



WARNING:

Before any service is performed on the smoker, the gas supply should be turned off and the power disconnected.

DAILY:

1. Remove all product racks from smoker and take to sink area for cleaning. Use a commercial foodservice detergent/degreaser. Follow the product manufacturer's instructions for proper use, cautions and warnings. Protective gear such as goggles and rubber gloves should be used.
2. Sanitize product racks with a commercial product service sanitizer. Follow the product manufacturer's instructions for proper use, cautions and warnings. Protective gear such as goggles and rubber gloves should be used.
3. Drain grease after each cook cycle. Refer to the Grease Removal Instructions on page 20 of this manual.
4. Remove ashes and coals from firebox after each cook cycle. Refer to the Ash Removal Instructions on page 19 of this manual.

WEEKLY:

1. The flue shall be inspected weekly for the following conditions
 - a. Residue that might begin to restrict the vent or create an additional fuel source. The flue or chimney should be cleaned before these conditions exist.
 - b. Corrosion or physical damage that might reduce the flue's capacity to contain effluent. The flue or chimney shall be repaired or replaced if any unsafe condition is evident.
2. The combustion chamber shall be scraped clean to its original surface once each week and shall be inspected for deterioration or defects.
3. Inspect the burner head for accumulation of ashes. If ashes are present, clean immediately. Ashes in the burner head can cause the burner to misfire.
4. Inspect the product door and firebox door gaskets. Replace if damaged or leaking.

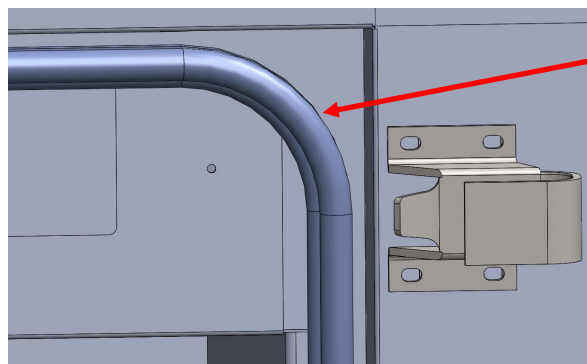

Product door gasket

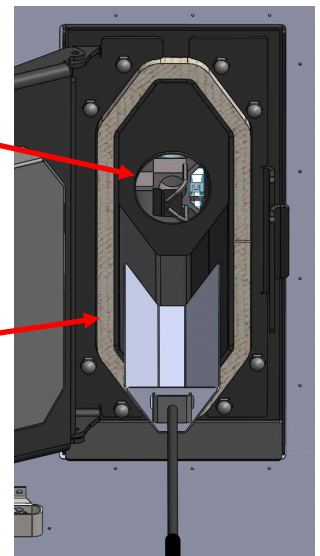

Burner head

Firebox gasket

MAINTENANCE (continued)

MONTHLY:

1. Inspect the blower wheel for solids or creosote buildup or an out-of-balance condition. Clean as needed. Remove and clean the rack slides and air channels.

WARNING: Solids buildup will cause the blower wheel to be out of balance and, if not cleaned, can cause damage to the blower wheel and to the convection fan motor.

WARNING: Smoker MUST be off and power disconnected before opening service door.

Removing the thumb screw and inspection cover allows for inspection of the blower wheel.

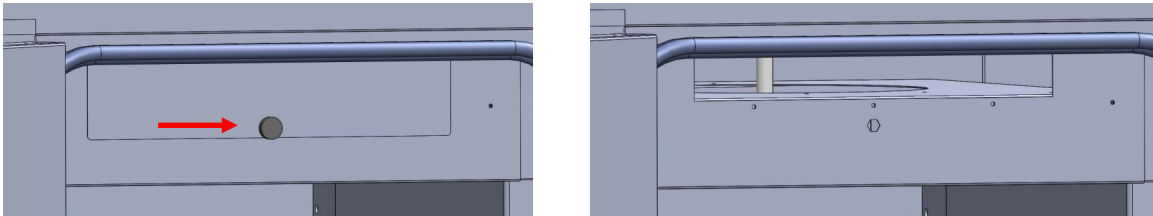

To remove the rack slides, air channels and blower wheel for cleaning:

- a. Remove the rack slides on both sides of the smoker by lifting up and out.
- b. Remove the air channels on both sides of the smoker by lifting up and out.
- c. Remove six, 1/4-20 bolts that secure the blower wheel shroud to the smoker.
- d. Carefully lower the shroud away from the blower wheel and out of the smoker.

NOTE: If there is not a lot of buildup on the blower wheel, it can be carefully cleaned without removing it from the motor shaft. If a more thorough cleaning is needed, proceed to the next steps.

- e. Insert a 5/32" Allen wrench through the access hole in the blower wheel to loosen the set screws.
- f. Remove the retaining ring on the end of convection motor shaft.

To re-install repeat the above steps in reverse order. Be sure to tighten the blower wheel set screw against the flat portion of the convection motor shaft. When re-installing the air channels, the sections with the smaller holes should go to the bottom.

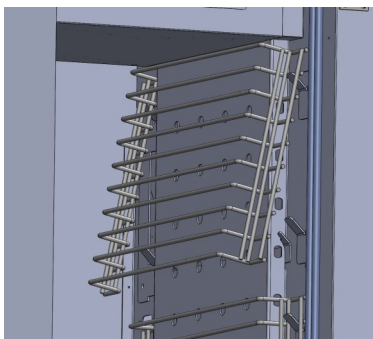

a.

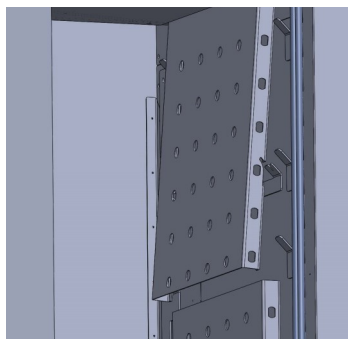

b.

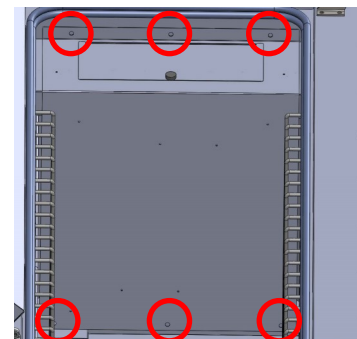

c.

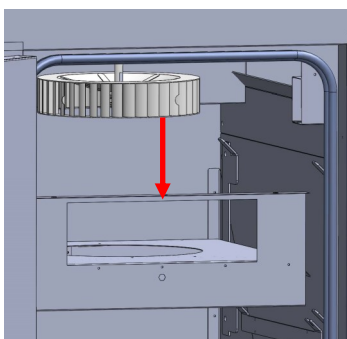

d.

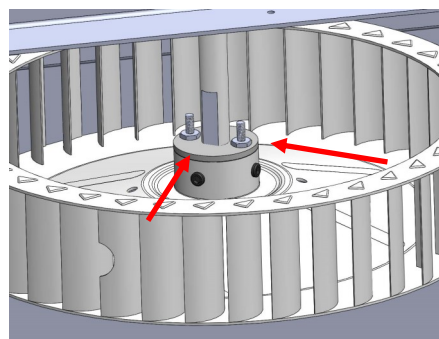

e.

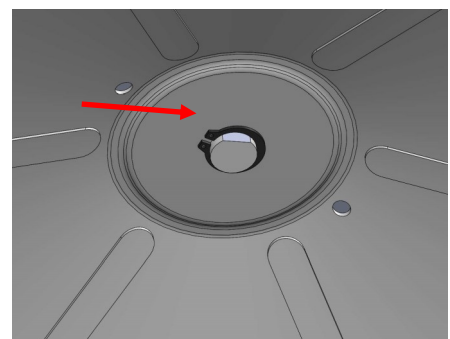

f.

MAINTENANCE (continued)

MONTHLY (continued):

2. Check the thermostat thermocouple. Be sure there is no solids or creosote buildup. Clean as needed.

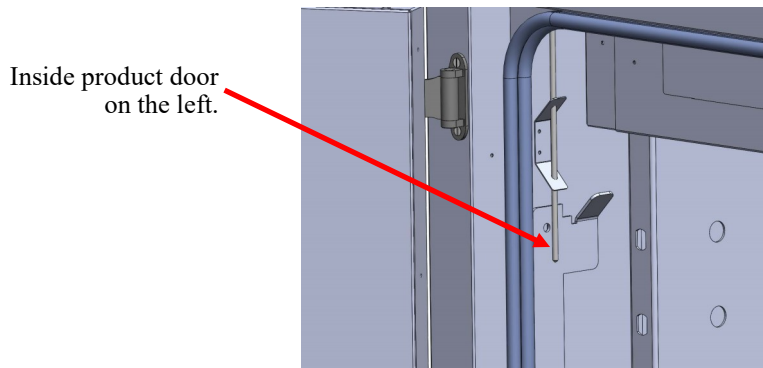

3. Check the product door hinges and the product door latches. Tighten screws and align as needed.

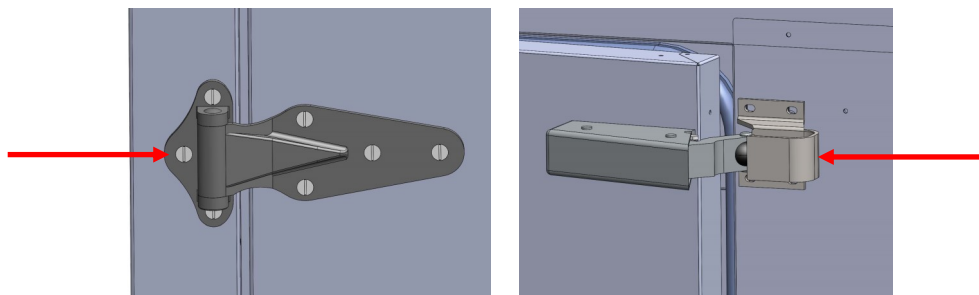

QUARTERLY:

1. At least quarterly, the baffle board should be removed, and the creosote scrapped off of the firebox side of the baffle board, along with the interior of the smoker around the firebox. The top portion of the baffle board (red highlighted area) stays in the smoker, while the bottom portion (green highlighted area) is removed. **Before removing the bottom portion, the top, right, back wire rack slide hanger (blue highlighted area) must be removed from the interior liner of the smoker and the baffle board.**

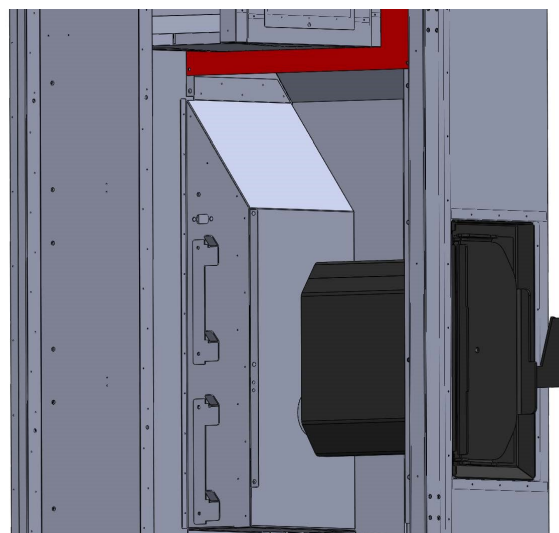
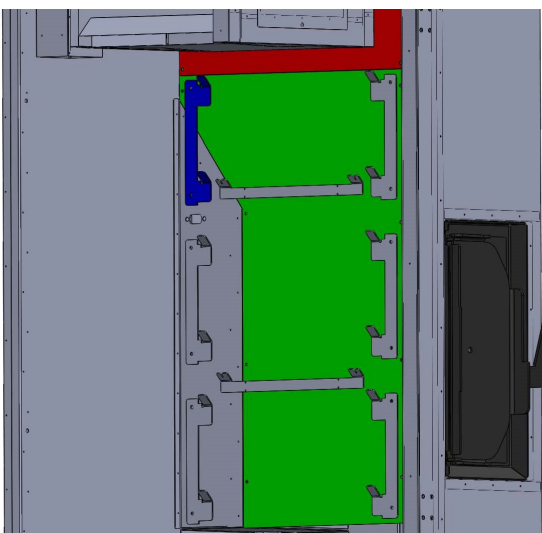

SEMI - ANNUALLY:

1. Have an experienced service technician inspect and clean the burner electrode. Southern Pride recommends replacing the burner electrode every 12-18 months, depending on usage.

MAINTENANCE (continued)

AS NEEDED:

(Frequency will depend on usage and local health department's requirements):

INTERIOR:



WARNING

It is extremely important to follow the below maintenance procedures. Grease or solids buildup inside the smoker could result in a fire hazard.

- Use a commercial product service detergent/degreaser to clean the smoker interior. Follow the product manufacturer's instructions for proper use, cautions and warnings. Protective gear such as goggles and rubber gloves should be used. **Note: Avoid the use of abrasive cleaning compounds, chloride based cleaners, or cleaners containing quaternary salts. Never use hydrochloric acid (muriatic acid) on stainless steel.**
- Smoker should be cool. Do not try to put cleaner on smoker when hot.
- While product racks are out of the smoker apply cleaner to the smoker interior: walls, ceiling, and floor and allow to soak for 10 minutes.
- Thoroughly rinse smoker interior with water using a water hose or pressure washer. **(Do not directly pressure wash the convection blower wheel; the blower wheel should be removed for cleaning).**
- Drain waste water; place a container under the drain. Dispose of rinse water according to local environmental requirements.
- Inspect the interior of the smoker for any areas that did not come clean; repeat the cleaning procedure in those areas.
- Thoroughly rinse the interior of the smoker and drain.
- Sanitize the smoker interior: walls, ceiling, floor, and convection fan with a commercial product service sanitizer. Follow the product manufacturer's instructions for proper use, cautions and warnings. Protective gear such as goggles and rubber gloves should be used. Wet all surfaces using a cloth or sprayer. Allow to remain wet for 10 minutes.
- Rinse surfaces by wiping with a cloth and clean warm water, and dry with a clean, soft cloth.
- To dry interior of the smoker leave product door open and allow to air dry.

Note: Consult with the appropriate state or local health department regarding all applicable cleaning and sanitation requirements for equipment.

MAINTENANCE (continued)

AS NEEDED:

(Frequency will depend on usage and local health department's requirements):

STAINLESS STEEL SURFACES:

Use non-abrasive cleaning products for use on stainless steel surfaces. Cleaning agents must be chloride-free compounds and must not contain quaternary salts. Never use hydrochloric acid (muriatic acid) on stainless steel surfaces. Always use the proper cleaning agent at the manufacturer's recommended strength.

EXTERIOR:

Southern Pride Smokers are known for their attractive appearance. We achieve this by selecting only the finest grade of type 304 stainless steel and applying exacting workmanship.

- All of the exterior of the smoker can be cleaned with a mild soap and water solution.
- Before cleaning the smoker, make sure it is turned off, main power switch off, and power cord disconnected from power.
- On mobile smokers, turn off LP gas.
- If the smoker is HOT from use, allow adequate time for it to cool down (approximately 1 hour).
- After the smoker exterior has been washed, apply a stainless steel polish cleaner to all surfaces.
- Wipe control panel, door handles, and door gaskets thoroughly, since these areas harbor food debris.
- **Do not use scotch bright pads or scouring pads to clean the outside of your smoker. If a non-abrasive scouring pad must be used, make certain to scrub with the visible grain of the surface metal to avoid scratches.**

Caution: Some cleaning products are not suitable for stainless steel; be sure to read the label before use.

PRODUCT DOOR LATCHES:

Remove and clean the product door latches.

1. After the smoker has been turned off and given time to cool, open the product door leaving the roller in the open position.
2. Using a crescent wrench on the edge of the latch cover, apply force to the crescent wrench towards the smoker to pop the latch cover free, and then the latch can be lifted away from the backing plate.
3. TO RE-INSTALL: Position the door latch, with the roller in the up position, over the backing plate, fastening the hooks on the latch over the tabs on the backing plate. Using the palm of your hand, push the bottom of the latch into the backing plate until it locks in position.

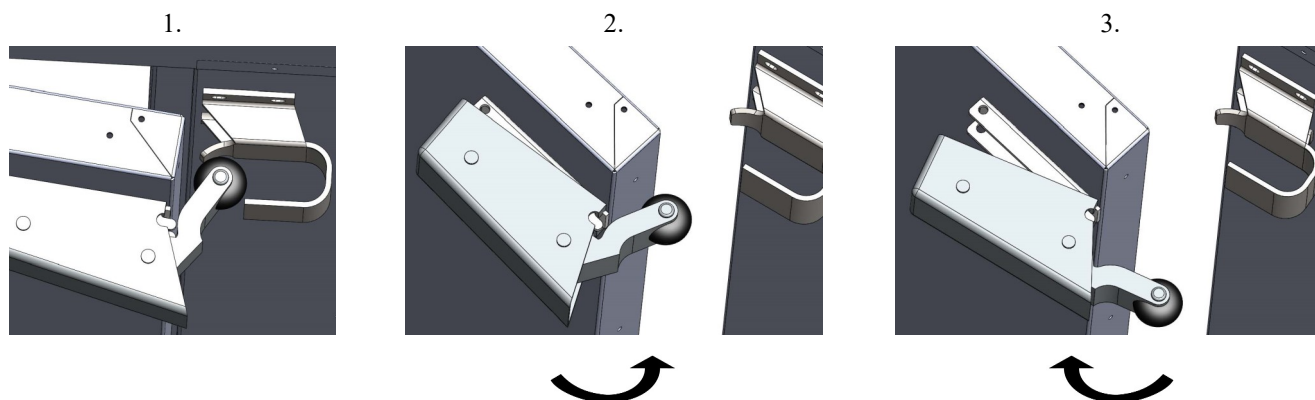

CAUTION:

The latch rollers are spring-loaded and will open quickly with a lot of force. Do not pinch a finger or hand.



WIRING DIAGRAM

REV 3

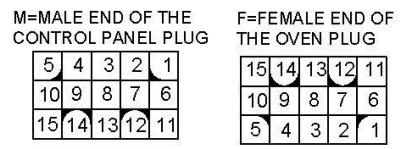
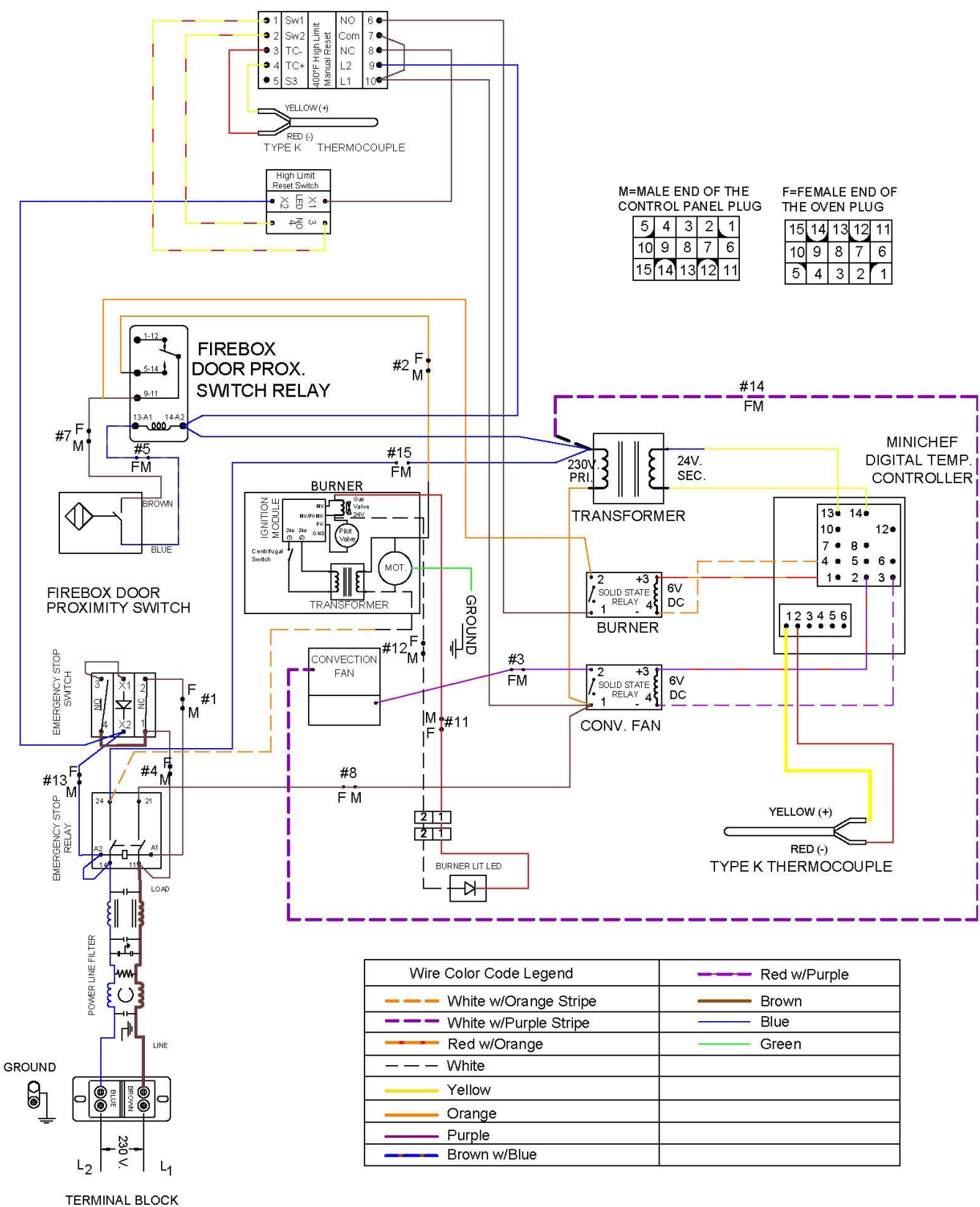

REPLACEMENT PARTS LIST

| Gaskets | |
|--------------------------|------------------------------|
| Product door | 070092 |
| Firebox door | 071014 |
| Electrical | |
| Cook & hold control | 431026 |
| Manual reset high limit | 434006 |
| Type "K" thermocouple | 435011 |
| Convection | |
| Fan motor | 522008 |
| Blower wheel | 531003 |
| Burner | |
| Transformer | 582020 |
| Blower motor | 582021 |
| Gas valve | 582023 (Nat.) 582025 (LP) |
| Electrode/pilot assembly | 582011 (Nat.) 582015 (LP) |
| High voltage lead | 582012 |
| Ignition control module | 582022 |

| Door Hinges/Closers | |
|------------------------------|--------|
| Product door hinge | 870003 |
| Mechanical door closer | 771001 |
| Mechanical door closer latch | 771002 |
| Product Racks/Hangers | |
| Nickel chrome product rack | 970002 |
| Stainless steel product rack | 971001 |
| Stainless steel rack slides | 977013 |

BEFORE YOU CALL FOR SERVICE



WARNING:

Before any service is performed on the smoker, the gas supply should be turned off and the power disconnected.

| SYMPTOM | WHAT TO DO |
|--------------------------------|--|
| Smoker does not start | <ul style="list-style-type: none"> • Check that the power cord is plugged into a live outlet. • Check that the menu is programmed and the Start/Stop button has been pressed. |
| Noise inside the smoker | <ul style="list-style-type: none"> • Check and clean the convection blower wheel. |
| BFail appears on the control | <ul style="list-style-type: none"> • Press the start/stop button until "IDLE" is displayed. • Press the start/stop button to restart the cook cycle. • If the error reappears, call a service technician to service the burner. |
| Error 7 appears on the control | <ul style="list-style-type: none"> • Wet a cloth with warm water and hold it against the thermocouple located on the left inside wall of the smoker for 20-30 seconds. |

TROUBLESHOOTING THE GAS BURNER



WARNING:

Gas burners require an experienced technician for proper service and adjustment. If the burner does not appear to be operating properly, **DO NOT ATTEMPT TO ADJUST THE BURNER YOURSELF**, but call in a competent service technician.

GAS BURNER SEQUENCE OF OPERATION

It is very important to know the sequence of operation when troubleshooting the burner. The below steps describe the cycle for ignition in the sequence of operation for the burner.

1. The smoker is powered on with the desired cooking temperature set.
2. At a call for heat from the thermostat, 230 volts of power go through the thermostat, the high limit switch, and on to the burner.
3. The power comes into the burner at the junction box, which is located on top of the blower motor; 230 volts AC go to the primary side of the 24 volt AC step down transformer and to the combustion motor and the combustion motor comes on.
4. The step down transformer sends 24 volts AC out to the centrifugal switch on the blower motor.
5. When the blower motor is powered up and reaches full speed, the centrifugal switch (located on the end of the motor) is activated, sending 24 volts through it and on to the ignition control module.
6. When 24 volts reaches the ignition control module, it sends a high voltage spark out to the electrode (igniter) to light the pilot flame, and at the same time, it sends 24 volts to open the pilot valve on the main gas valve.
7. After the pilot lights, the electrode (igniter) acts as a flame sensor sending a DC micro amp signal back to the control module that there is a pilot flame, then the ignition control module sends out 24 volts AC to open the main valve.
8. The pilot flame lights the flow of gas from the main valve and the burner will fire until the call for heat from the thermostat has been satisfied, shutting the burner down.

NOTE: The burner is equipped with an ignition module that has a 3-try for ignition sequence.

TROUBLESHOOTING GUIDE

| SYMPTOM | WHAT TO DO |
|-------------------------------------|--|
| Blower motor does not run | <ul style="list-style-type: none">• Check for 230v present at the blower motor. |
| Burner does not fire | <ul style="list-style-type: none">• Check for 24 volts at the ignition control module.• Clean the centrifugal switch.• Check the condition of the ignition wire.• Clean the electrode and check the spark gap (1/8”). |
| Burner sparks, but does not fire | <ul style="list-style-type: none">• Remove any ash in the burner head.• Check that the gas is turned on.• Check the supply line pressure. (see page 12).• Clean the electrode. |
| Pilot lights, but burner does not | <ul style="list-style-type: none">• Check for loose wire connection at the valve and control module.• Clean the igniter rod. |
| Pilot lights, but does not stay lit | <ul style="list-style-type: none">• Check the igniter-sensor probe and wire. |

LIMITED WARRANTY

Southern Pride Distributing, LLC (“Southern Pride”) warrants to the original purchaser that any original part found to be defective in material or workmanship will, at Southern Pride’s option, subject to provisions hereinafter stated, be replaced with a new or rebuilt part. The labor warranty, provided only in the U.S.A., remains in effect one (1) year from installation or fifteen (15) months from the shipping date, whichever occurs first. Southern Pride will bear normal labor charges performed by an authorized Southern Pride service agent during standard business hours, and excluding overtime, holiday rates or any additional fees. The parts warranty remains in effect for one (1) year from installation or fifteen (15) months from the shipping date, whichever occurs first. All warranty parts ship via standard ground delivery service.

This warranty does not cover the following:

- Improper installation, delivery or maintenance.
- Failure of the Product if it is abused, misused, or used for other than intended purpose.
- Products which are not defective or broken, or which are working as described in the Owner’s Manual.
- Damage to the Product caused by accident, fire, floods, or acts of God.
- Damage caused by services performed by unauthorized service companies.
- Service calls to correct the installation of your Product or to instruct you how to use your Product.
- Expenses for making the Product accessible for servicing.
- Replacement of consumable parts; belts, gaskets, light bulbs, etc.

NO IMPLIED WARRANTY, REPRESENTATION OR CONDITION

To the extent permitted by law, neither Southern Pride nor any company/individual affiliated with it makes any warranties, representations, conditions or promises express or implied as to the quality, performance or freedom from defect of the smokers covered by these warranties other than those set forth above, and NO STATUTORY OR IMPLIED WARRANTIES OR CONDITIONS OF MERCHANTABILITY OR APPLICABLE PERIOD OF WARRANTY SET FORTH ON THIS PAGE. THE PURCHASER’S ONLY REMEDIES IN CONNECTION WITH THE BREACH OR PERFORMANCE OF ANY WARRANTY ON THE PRODUCTS ARE THOSE SET FORTH ON THIS PAGE. IN NO EVENT WILL SOUTHERN PRIDE OR ANY COMPANY/INDIVIDUAL AFFILIATED WITH IT BE LIABLE FOR INCIDENTAL OR CONSEQUENTIAL DAMAGES. In no event shall Southern Pride be liable for loss of use, loss of revenue or profit, or loss of product, or for any indirect, incidental or consequential damages.

LIMITATION OF LIABILITY

Southern Pride will not be liable under any circumstances for any incidental, consequential or special damages, including without limitation any lost profits or labor costs, arising from the sale, use or installation of the products, from the products being incorporated into or becoming a component of another product or from any other cause whatsoever, whether based on warranty (expressed or implied) or otherwise based on contract, on tort or any other theory of liability, and regardless of any advice or representations not in writing that may have been rendered by Southern Pride concerning the sale, use or installation of the products. In the event the above warranty fails to correct purchaser’s performance problems caused by defects in workmanship and/or materials, purchaser’s exclusive remedy shall be limited to payment by Southern Pride of actual damages in an amount not to exceed the amount paid for the smoker

IF YOU NEED SERVICE

To secure warranty service, the purchaser must (1) report the equipment defect to their authorized Southern Pride distributor and request warranty service within the applicable warranty term; (2) present evidence of the warranty start date with a valid proof of purchase; and (3) make the Product available within a reasonable time.

Should your problem not be solved to your complete satisfaction by your authorized Southern Pride distributor, you should contact Southern Pride at PO Box 354, Alamo, TN 38001, Phone: 1-800-437-2679. When contacting the manufacturer, the following information will be requested: (a) Model and serial number of the Product, (b) Address where the Product is installed, (c) Name and address of the installer and any service agency that performed service on the Product, (d) Date of original installation and dates any service work was performed, (e) Details of the problems as you can best describe them, (f) List of people, with dates, who have been contacted regarding your problem.