

WF-SP700N

BC-WFSP700N/WF-SP700NL/SP700NR

SERVICE MANUAL

Ver. 1.0 2018.03

*US Model
Canadian Model
AEP Model
UK Model
E Model
Australian Model
Chinese Model
Tourist Model*



Photo: WF-SP700NR
(R-ch)



Photo: BC-WFSP700N



Photo: WF-SP700NL
(L-ch)

- All of the units included in the WF-SP700N (WF-SP700NL/ WF-SP700NR/BC-WFSP700N) are required to repairing of this unit. Check in advance that you have all of the units.

COMPONENT MODEL NAME (WF-SP700N)

Charging case		BC-WFSP700N
Wireless noise canceling stereo headset	L-ch	WF-SP700NL
	R-ch	WF-SP700NR

SPECIFICATIONS

General

Communication system: Bluetooth Specification version 4.1
Output: Bluetooth Specification Power Class 1
Maximum communication range:
 Line of sight approx. 10 m (30 ft)¹⁾
Frequency band: 2.4 GHz band (2,4000 GHz - 2,4835 GHz)
Operating frequency (AEP, UK):
 Bluetooth 2,400 MHz - 2,483.5 MHz
 NFC 13.56 MHz
Maximum output power (AEP, UK):
 Bluetooth < 10 dBm

(CH)

频率范围: 2400 MHz - 2483.5 MHz
 发射功率: ≤ 20 dBm (EIRP)

Compatible Bluetooth profiles²⁾:

A2DP (Advanced Audio Distribution Profile)
 AVRCP (Audio Video Remote Control Profile)
 HFP (Hands-free Profile)
 HSP (Headset Profile)

Supported Codec³⁾: SBC⁴⁾, AAC⁵⁾

Supported content protection method: SCMS-T

Transmission range (A2DP):

20 Hz - 20,000 Hz (Sampling frequency 44.1 kHz)

Included items:

Wireless noise canceling stereo headset (1)
 Micro-USB cable (approx. 50 cm (19 3/4 in.)) (1)
 Charging case (1)
 Long Hybrid silicone rubber earbuds (SS/S/M/L 2 each)
 Arc supporters (M/L 2 each)
 Reference Guide (this sheet) (1)
 Operating Instructions (1 set)
 Other documents (1 set)

- ¹⁾ The actual range will vary depending on factors such as obstacles between devices, magnetic fields around a microwave oven, static electricity, reception sensitivity, antenna's performance, operating system, software application, etc.
²⁾ Bluetooth standard profiles indicate the purpose of Bluetooth communications between devices.
³⁾ Codec: Audio signal compression and conversion format
⁴⁾ Subband Codec
⁵⁾ Advanced Audio Coding

Wireless noise canceling stereo headset

Power source (Except CH):

DC 3.7 V: Built-in lithium-ion rechargeable battery
 DC 5 V: When charged using USB

(CH)

电源:

DC 3.7 V: 内置锂离子充电电池
 型号: CP1254 A3
 额定容量: 60 mAh
 充电限制电压: 4.2 V
 DC 5 V: 使用USB充电时

Mass: Approx. 7.6 g × 2 (0.27 oz × 2) (Headset, not including the arc supporters)

Approx. 45 g (1.59 oz) (Charging case)

Operating temperature: 0 °C to 40 °C (32 °F to 104 °F)

Rated power consumption (E, IND, CH, AUS, RU, JE):
 1 W (Headset), 3 W (Charging case)

– Continued on next page –

CAUTION

Danger of explosion if battery is incorrectly replaced.
 Replace only with the same or equivalent type.

注意

如果电池更换不当会有爆炸危险
 只能用同样类型或等效类型的电池来更换

警告

本電池如果更換不正確會有爆炸的危險
 請依製造商說明書處理用過之電池

WF-SP700N/SP700NL/SP700NR
WIRELESS NOISE CANCELING STEREO HEADSET
 BC-WFSP700N
CHARGING CASE

9-896-506-01

2018C33-1

© 2018.03

Sony Video & Sound Products Inc.

SONY®

WF-SP700N**Usage hours:**

When connecting via the Bluetooth device

Music playback time:

Max. 3 hours (NC ON), Max. 3 hours (NC OFF)

Communication time:

Max. 3.5 hours

Standby time:

Max. 8 hours (NC ON), Max. 35 hours (NC OFF)

Note: Usage hours may be shorter depending on the Codec and the conditions of use.

Charging time:

Approx. 1.5 hours

(About 70 minutes of music playback is possible after 15 minutes charging.) (Headset)

Approx. 3 hours (Charging case)

Note: Charging hours may be different depending on the conditions of use.

Charging temperature: 5 °C to 35 °C (41 °F to 95 °F)

Receiver

Type: Closed, Dynamic

Driver unit: 6 mm

Microphone

Type: Electret condenser

Directivity: Omni directional

Effective frequency range: 50 Hz - 8,000 Hz

System requirements for battery charge using USB

USB AC adaptor

A commercially available USB AC adaptor capable of feeding in more than 0.5 A (500 mA)

Personal Computer

(As of January 2018)

Personal Computer with pre-installed with any of the following operating systems and USB port:

Operating Systems:

(when using Windows)

Windows® 10 Home / Windows® 10 Pro

Windows® 8.1 / Windows® 8.1 Pro

Windows® 8 / Windows® 8 Pro

Windows® 7

Home Basic / Home Premium / Professional / Ultimate

(when using Mac)

Mac OS X (version 10.9 or later)

Design and specifications are subject to change without notice.

The Bluetooth® word mark and logos are registered trademarks owned by the Bluetooth SIG, Inc. and any use of such marks by Sony Corporation is under license.

The N-Mark is a trademark or registered trademark of NFC Forum, Inc. in the United States and in other countries.

Windows is a registered trademark or trademark of Microsoft Corporation in the United States and/or other countries.

Mac, OS X, iPhone and iPod touch are trademarks of Apple Inc., registered in the U.S. and other countries.

“Made for iPod” and “Made for iPhone” mean that an electronic accessory has been designed to connect specifically to iPod or iPhone, respectively, and has been certified by the developer to meet Apple performance standards. Apple is not responsible for the operation of this device or its compliance with safety and regulatory standards. Please note that the use of this accessory with iPod or iPhone may affect wireless performance.

Android is a trademark of Google Inc.

Other trademarks and trade names are those of their respective owners.

TABLE OF CONTENTS

1. SERVICING NOTES	3
2. DISASSEMBLY	
2-1. Disassembly Flow	18
2-2. Lid	19
2-3. Case Cap	20
2-4. Front Case, Magnet B Block.....	21
2-5. CRADLE CONTACT L Board Block, CRADLE CONTACT R Board Block	22
2-6. CRADLE NFC Board, Rear Case, Light Guide	23
2-7. CRADLE Board Block	24
2-8. Lithium Ion Storage Battery, CRADLE Board, CRADLE CONTACT L Board, CRADLE CONTACT R Board.....	25
3. EXPLODED VIEWS	
3-1. Headset Section.....	26
3-2. Charging Case Section (BC-WFSP700N)	27
4. ACCESSORIES	28

SECTION 1 SERVICING NOTES

The **SERVICING NOTES** contains important information for servicing. Be sure to read this section before repairing the unit.

REUSE OF THE BUILT-IN LITHIUM ION RECHARGEABLE BATTERY (BC-WFSP700N)

When the lithium ion rechargeable battery is removed from the adhesive tape, it cannot be reused. Be sure to replace it with new parts.

ABOUT INSULATING OF THE BUILT-IN LITHIUM ION RECHARGEABLE BATTERY (BC-WFSP700N)

When wire of the built-in lithium ion rechargeable battery is removed from board, insulate the end of battery wire by wrap of a tape etc. to prevent short-circuited of the battery wire part.

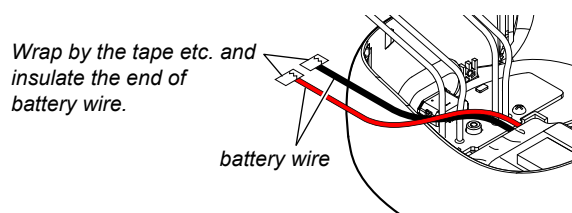

CHECKING THE NEW LITHIUM ION RECHARGEABLE BATTERY FOR BEFORE USE AND NOTES ON HANDLING (BC-WFSP700N)

• Checking before use

When replacing the lithium ion rechargeable battery to the new parts, be sure to check the exterior condition before installing the new lithium ion rechargeable battery in this unit.

- No external wound such as scratches
- No swell etc.

If there are some abnormality with the exterior, do not use that lithium ion rechargeable battery.

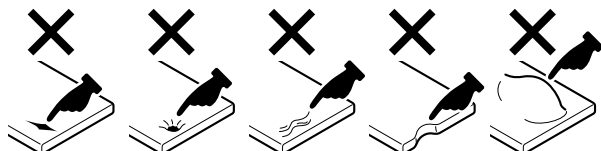

• Notes on handling

When handling the new lithium ion rechargeable battery, handle with notes of the following.

- Do not drop it
If it drops accidentally, do not use that lithium ion rechargeable battery.
- Do not scratch with tweezers or other sharp objects
If it scratches accidentally, do not use that lithium ion rechargeable battery.

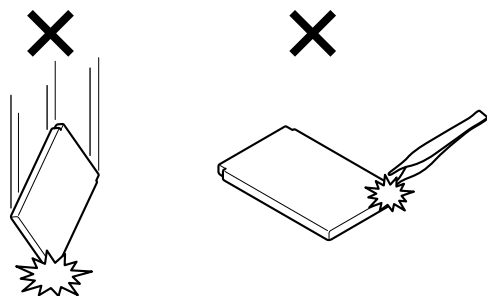

DESTINATION ABBREVIATIONS

The following abbreviations for model destinations are used in this service manual.

- Abbreviations
 - AEP : European area, East European area, CIS area (Moldova) and Middle East area (Israel) models
 - AUS : Australian and New Zealand models
 - CH : Chinese model
 - CND : Canadian model
 - IND : Indian model
 - JE : Tourist model
 - LA : Latin American model
 - RU : CIS area (Except for Moldova) model

MODEL IDENTIFICATION

BC-WFSP700N:

Refer to the print contents of model number label that is stuck on the bottom of main unit.

Note: The figure below may differ from the actual model number label.

Also, print contents of the model number label may be changed in the midway of production.

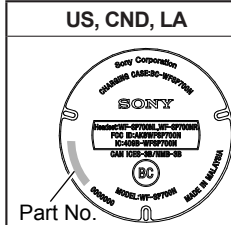
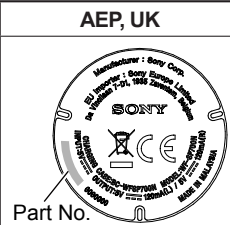
	US, CND, LA	AEP, UK
		
Black	4-726-332-0□	4-726-333-0□
White	4-726-332-1□	4-726-333-1□
Yellow	4-726-332-2□	4-726-333-2□
Pink	4-726-332-3□	4-726-333-3□

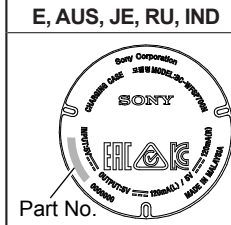
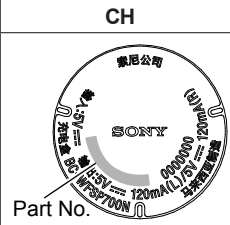
	E, AUS, JE, RU, IND	CH
		
Black	4-726-331-0□	4-726-330-0□
White	4-726-331-1□	4-726-330-1□
Yellow	4-726-331-2□	4-726-330-2□
Pink	4-726-331-3□	4-726-330-3□

WF-SP700NL/SP700NR:

It is can not to distinguish of the destination by the unit.

COLOR VARIATIONS

Except IND : (B) Black, (W) White, (Y) Yellow, (P) Pink
IND : (B) Black

ADVANCE PREPARATION WHEN REPAIRING

All of the units included in the WF-SP700N (WF-SP700NL/WF-SP700NR/BC-WFSP700N) are required to repairing of this unit. Check in advance that you have all of the units.

WF-SP700N

ABOUT REPAIR OF BOARDS

The BC-WFSP700N (charging case) can be disassembled and repaired. However, when boards installed in the BC-WFSP700N (charging case) are defective, it is replaced by the board.

Replace the complete mounted board or the whole parts including the applicable board.

In addition, when replace the CRADLE NFC board, be sure to refer to “REPAIRING AND REPLACING OF THE BC-WFSP700N (charging case) OR THE CRADLE NFC BOARD” on page 9.

The WF-SP700NL (L-ch) and the WF-SP700NR (R-ch) can not be disassembled and repaired.

OPERATION CHECK OF THE NFC FUNCTION AFTER COMPLETING THE REPAIRS

After completing the repairs of this unit, follow the procedure below to check normal operation of the NFC.

Note: After checking of NFC operation, be sure to delete the pairing information before returning this unit to the customer.

For deleting method of the pairing information, refer to “INITIALIZING METHOD” on page 6.

Preparation:

- NFC compatible device (smartphone or music player etc.)

Procedure:

1. Turn on the NFC function of the NFC compatible device.
(For details, refer to the instruction manual of your NFC compatible device. The figure below is a reference example)



2. Remove the WF-SP700NL (L-ch) and WF-SP700NR (R-ch), from the BC-WFSP700N (charging case).

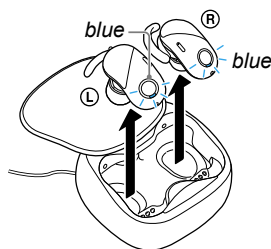

If it is already removed to the WF-SP700NL (L-ch) and WF-SP700NR (R-ch) from the BC-WFSP700N (charging case) and the power is off, put it in the charging case again and remove it, or press and hold the WF-SP700NL (L-ch) and WF-SP700NR (R-ch) buttons for about 2 seconds, then check that the blue lamp blinks.



3. Touch and connection the N-mark part of the NFC compatible device to the N-mark part of the BC-WFSP700N (charging case).

Note: Please unlock if the screen of the NFC compatible device is locked.

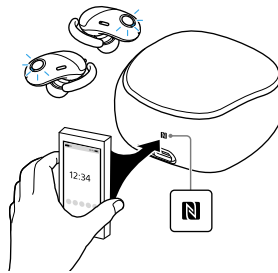

4. Playback the audio from the NFC compatible device and check that the sound is outputted from the WF-SP700NL (L-ch) and WF-SP700NR (R-ch).



5. Touch the N-Mark part of the BC-WFSP700N (charging case) with N-Mark of the NFC compatible device again to disconnect the connection.
6. Refer to “INITIALIZING METHOD” on page 6, delete the device pairing information and complete the operation check.

RESETTING METHOD

If the unit does not operate properly, perform the reset.

Note: Even if this work is performed, device pairing information is not deleted. Also, other settings are retained.

Procedure:

1. Connect the BC-WFSP700N (charging case) to a optional USB AC adaptor using the supplied micro-USB cable, then the BC-WFSP700N (charging case) to the charging state, and check that the charging lamp lights up red.

Note 1: It can also use the micro-USB cable provided with this unit to connect the BC-WFSP700N (charging case) to the running PC to charge it.

Note 2: When charging with a PC, charging may not be possible when the PC is in standby (sleep) or hibernate.

Note 3: The charging lamp turns off when charging is completed.

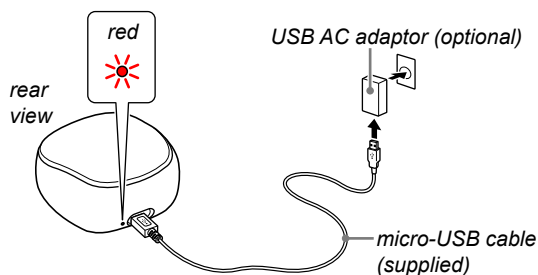

2. Open the lid of the BC-WFSP700N (charging case), insert the WF-SP700NL (L-ch) and WF-SP700NR (R-ch) and check that the WF-SP700NL (L-ch) and WF-SP700NR (R-ch) lamps are lit in red.

Note 4: Please lock the WF-SP700NL (L-ch) and WF-SP700NR (R-ch) securely to the BC-WFSP700N (charging case).

Note 5: The charging lamp turns off when charging is completed.

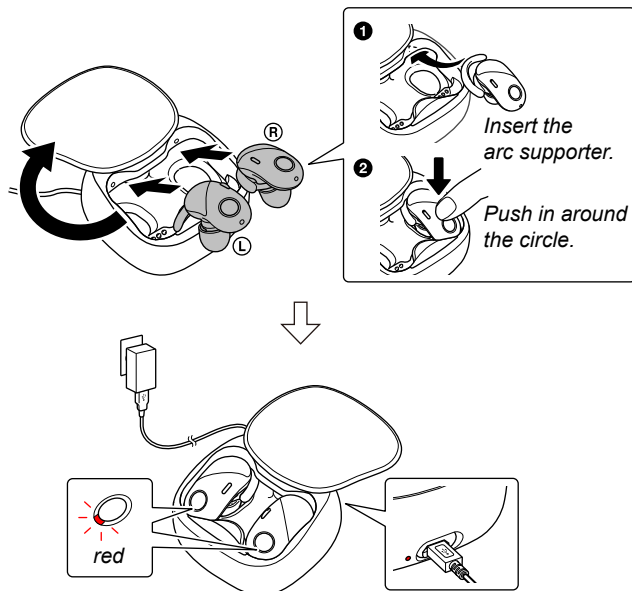

3. The WF-SP700NL (L-ch) and WF-SP700NR (R-ch) buttons are pressed simultaneously for about 7 seconds in the state of step 2, the red lamp flashes once and the reset is completed automatically.

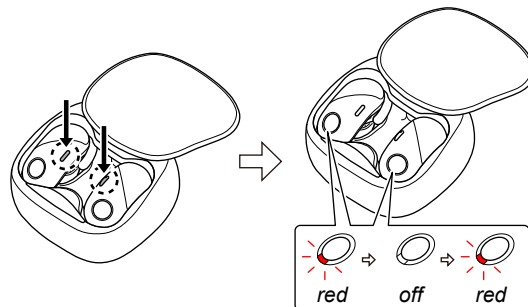

WF-SP700N

INITIALIZING METHOD

After completion of repairs, be sure to perform the following procedure to initialize this unit.

Note 1: When this work is performed, all device pairing information is deleted and settings return to factory defaults.

Procedure:

1. Remove the WF-SP700NL (L-ch) and WF-SP700NR (R-ch), from the BC-WFSP700N (charging case).

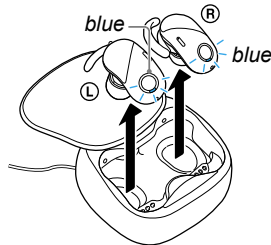

2. Press the button on the WF-SP700NL (L-ch) for more than about 2 seconds to turn the power off.

Note 2: By pressing the button on the WF-SP700NL (L-ch) for about 2 seconds or more, the WF-SP700NR (R-ch) also linked together and the power is turned off.

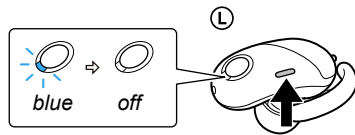

3. While the WF-SP700NL (L-ch) and WF-SP700NR (R-ch) turned power off state, pressing each buttons simultaneously for about 15 seconds or more.

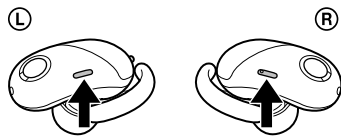

Note 3: While the buttons are pressing, the lamp of WF-SP700NL (L-ch) is flashes in the middle, but keep pressing for more than 15 seconds as it is.

4. When the lamps of the WF-SP700NL (L-ch) and WF-SP700NR (R-ch) are switched from flashing red several times to flashing blue 4 times and the lamps are turn off, and initialize is complete.

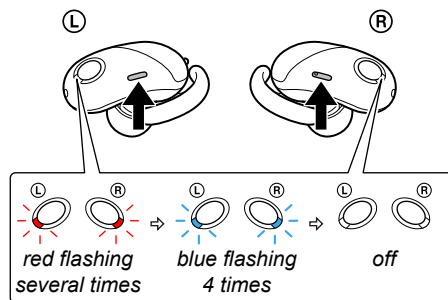

Note 4: When this unit is initialized, it might not be able to connect to iPhone or PC.

In that case, delete the registration of this unit on iPhone or PC, register the device again.

REPAIRING AND REPLACING OF THE WF-SP700NL (L-ch)

The WF-SP700NL (L-ch) will be replaced in the state of the finished product. It can not be repaired by disassembling the WF-SP700NL (L-ch).

Also, if replace the WF-SP700NL (L-ch), be sure to disassemble the BC-WFSP700N (charging case) and replace the CRADLE NFC board at the same time.

When replacing the WF-SP700NL (L-ch), perform the following procedure to works.

Check in advance:

- Check in advance that you have all of WF-SP700NL (L-ch), WF-SP700NR (R-ch) and BC-WFSP700N (charging case).
- Be sure to check that there are no WF-SP700N in the surroundings. If using WF-SP700N in the surroundings, there is a possibility that is connect another WF-SP700N.

Preparation:

- Windows PC with Bluetooth function
- NFC compatible smartphone that installed the NFC Tag Data Writing Application

Note 1: For the NFC Tag Data Writing Application, refer to “BLUETOOTH INFORMATION WRITING METHOD” on page 11.

Note 2: Confirm the method of obtaining the NFC Tag Data Writing Application and its latest version with the each service headquarters.

Replacing procedure:

1. Replace the broken WF-SP700NL (L-ch) with a new WF-SP700NL (L-ch).

Note 3: Change the Long Hybrid silicone rubber earbud and the Arc supporter to new WF-SP700NL (L-ch) from the broken WF-SP700NL (L-ch).

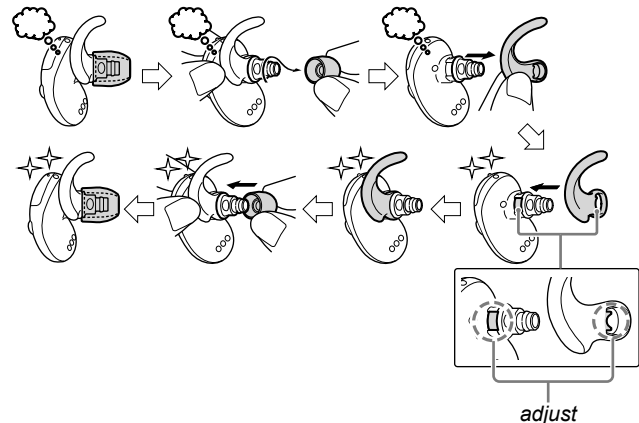

– Continued on next page –

- Refer to “2. DISASSEMBLY” on page 18, disassemble the BC-WFSP700N (charging case) and replace the CRADLE NFC board with new CRADLE NFC board and assemble as it was before.

Note 4: The figure below is an image figure. Be sure to refer to “2. DISASSEMBLY” on page 18.

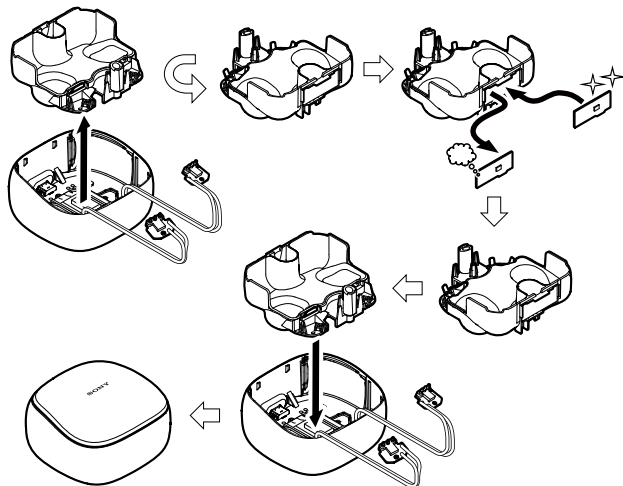

Note 5: The repair parts of WF-SP700NL (L-ch) do not include the CRADLE NFC board of inside the BC-WFSP700N (charging case). It is a single repair part each.

- Attach the WF-SP700NL (L-ch) and WF-SP700NR (R-ch) to the BC-WFSP700N (charging case).

Note 6: Please check that the WF-SP700NL (L-ch) and WF-SP700NR (R-ch) are locked to the BC-WFSP700N (charging case).

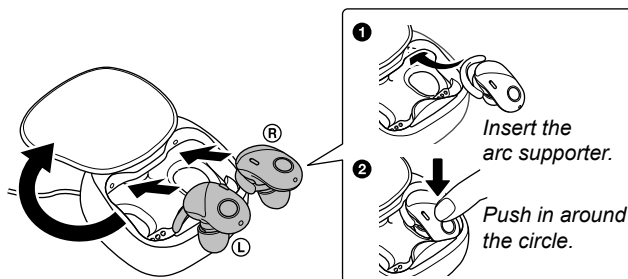

- Remove only the WF-SP700NL (L-ch) from the BC-WFSP700N (charging case). (The power on the WF-SP700NL (L-ch) automatically and the blue lamp flashes)

Note 7: Do not remove the WF-SP700NR (R-ch) from the BC-WFSP700N (charging case).

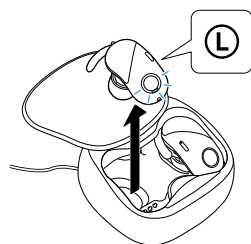

- Press the [⏻] button on the WF-SP700NL (L-ch) for about 7 seconds until the blue and red lamps alternately flash, put them in pairing state and connect to the PC with the Bluetooth function.

(In order to check the Bluetooth address, it is necessary to connect the PC and the WF-SP700NL (L-ch). It is also possible to display the Bluetooth address, by the Bluetooth connect to the walkman (NW-S series or NW-A series etc.) with Bluetooth function. In this example, describes how to display Bluetooth address on PC.)

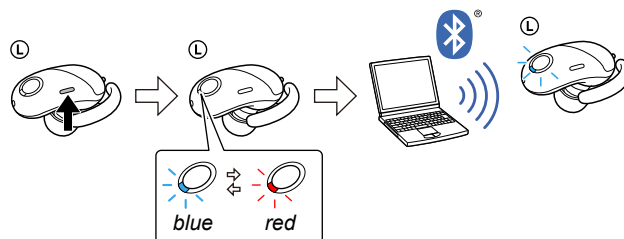

Note 8: For the Bluetooth connection method of the PC, refer to the manual of the PC to be used.

- Display information of this unit Bluetooth connected on the PC screen. Then open the property, display the Bluetooth address of this unit, and take a memorandum the Bluetooth address.

(In the Windows 8.1, open the “Control Panel → Device and Printers” in this order, right click the icon showing the model name (WF-SP700N) of this unit and open its properties) (The figure below is a reference example.)

“Device and Printers” screen on PC



Right click and select the “Properties”.

“Properties” screen

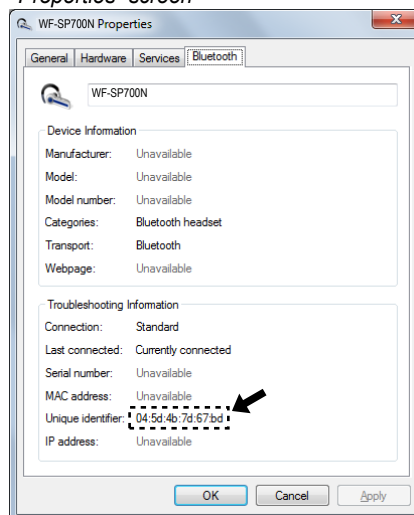

Note 9 : Check the device name carefully so as not to confuse Bluetooth address with other devices, and take a memorandum.

Note 10: The display method of Bluetooth address may be different depending on Windows OS.

- Write the Bluetooth information to the BC-WFSP700N (charging case) using NFC compatible smartphone that installed the NFC Tag Data Writing Application. (Refer to “BLUETOOTH INFORMATION WRITING METHOD” on page 11)

– Continued on next page –

WF-SP700N

8. After writing Bluetooth information, with the power of WF-SP700NL (L-ch) and WF-SP700NR (R-ch) turned off state, press each buttons for about 15 seconds simultaneously.

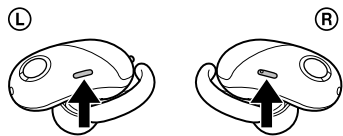

Note 11: If the power is on, press the [⏻] button on the WF-SP700NL (L-ch) for about 2 seconds or more and turn off the power before performing this step.

Note 12: While the buttons are pressing, the lamp of WF-SP700NL (L-ch) is flashes in the middle, but keep pressing for more than about 15 seconds as it is.

9. When the lamps of WF-SP700NL (L-ch) and WF-SP700NR (R-ch) are switched from flashing red several times to flashing blue 4 times and the lamps are turn off, pairing of WF-SP700NL (L-ch) and WF-SP700NR (R-ch) are completed.

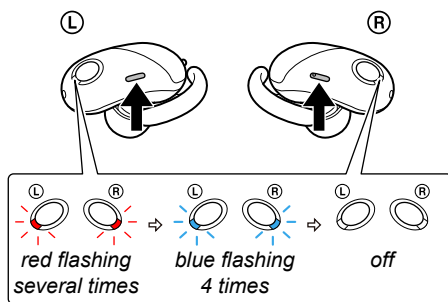

Note 13: When this unit is initialized, it might not be able to connect to iPhone or PC.

In that case, delete the registration of this unit on iPhone or PC, register the device again.

10. Check the operation of this unit and complete replacement works.

REPAIRING AND REPLACING OF THE WF-SP700NR (R-ch)

The WF-SP700NR (R-ch) will be replaced in the state of the finished product. It can not be repaired by disassembling the WF-SP700NR (R-ch).

When replacing the WF-SP700NR (R-ch), perform the following procedure to works.

Check in advance:

- Check in advance that you have all of WF-SP700NL (L-ch), WF-SP700NR (R-ch) and BC-WFSP700N (charging case).
- Be sure to check that there are no WF-SP700N in the surroundings. If using WF-SP700N in the surroundings, there is a possibility that is connect another WF-SP700N.

Replacing procedure:

1. Replace the broken WF-SP700NR (R-ch) with a new WF-SP700NR (R-ch).

Note 1: Change the Long Hybrid silicone rubber earbud and the Arc supporter to new WF-SP700NR (R-ch) from the broken WF-SP700NR (R-ch).

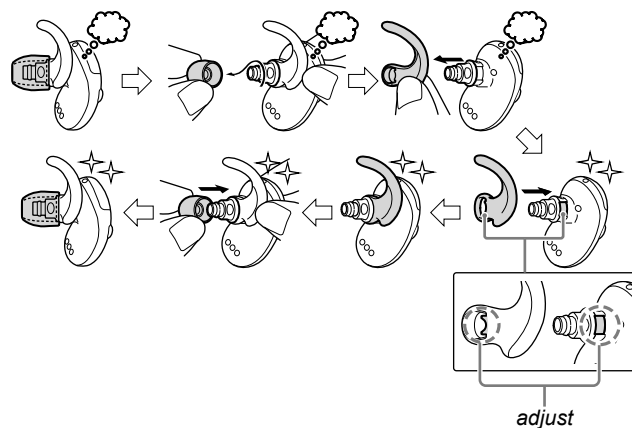

2. The power of WF-SP700NL (L-ch) and WF-SP700NR (R-ch) turned off state, press each buttons for about 15 seconds simultaneously.



Note 2: If the power is on, press the [⏻] button on the WF-SP700NL (L-ch) for about 2 seconds or more and turn off the power before performing this step.

Note 3: While the buttons are pressing, the lamp of WF-SP700NL (L-ch) is flashes in the middle, but keep pressing for more than about 15 seconds as it is.

– Continued on next page –

3. When the lamps of WF-SP700NL (L-ch) and WF-SP700NR (R-ch) are switched from flashing red several times to flashing blue 4 times and the lamps are turn off, pairing of WF-SP700NL (L-ch) and WF-SP700NR (R-ch) are completed.

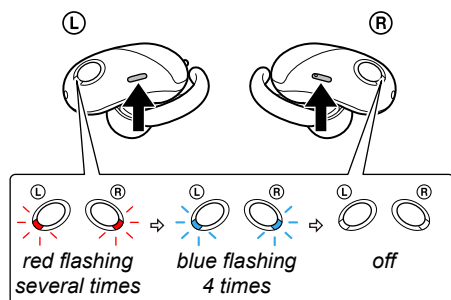

Note 4: When this unit is initialized, it might not be able to connect to iPhone or PC.

In that case, delete the registration of this unit on iPhone or PC, register the device again.

4. Check the operation of this unit and complete replacement works.

REPAIRING AND REPLACING OF THE BC-WFSP700N (charging case) OR THE CRADLE NFC BOARD

The BC-WFSP700N (charging case) can be disassembled and repaired.

When disassembling and repairing, refer to “2. DISASSEMBLY” on page 18 and “3. EXPLODED VIEWS” on page 26.

However, when replacing the BC-WFSP700N (charging case) whole, or when replacing the CRADLE NFC board of the internal, be sure to perform the following procedure to works.

Check in advance:

- Check in advance that you have all of WF-SP700NL (L-ch), WF-SP700NR (R-ch) and BC-WFSP700N (charging case).
- Be sure to check that there are no WF-SP700N in the surroundings. If using WF-SP700N in the surroundings, there is a possibility that is connect another WF-SP700N.

Preparation:

- Windows PC with Bluetooth function
- NFC compatible smartphone that installed the NFC Tag Data Writing Application

Note 1: For the NFC Tag Data Writing Application, refer to “BLUETOOTH INFORMATION WRITING METHOD” on page 11.

Note 2: Confirm the method of obtaining the NFC Tag Data Writing Application and its latest version with the each service headquarters.

Replacing procedure:

1. Replace the broken BC-WFSP700N (charging case) with a new BC-WFSP700N (charging case), or refer to “2. DISASSEMBLY” on page 18 and replace the broken CRADLE NFC board with a new CRADLE NFC board and the BC-WFSP700N (charging case) assemble as it was before.

Note 3: The figure below is an image figure. Be sure to refer to “2. DISASSEMBLY” on page 18.

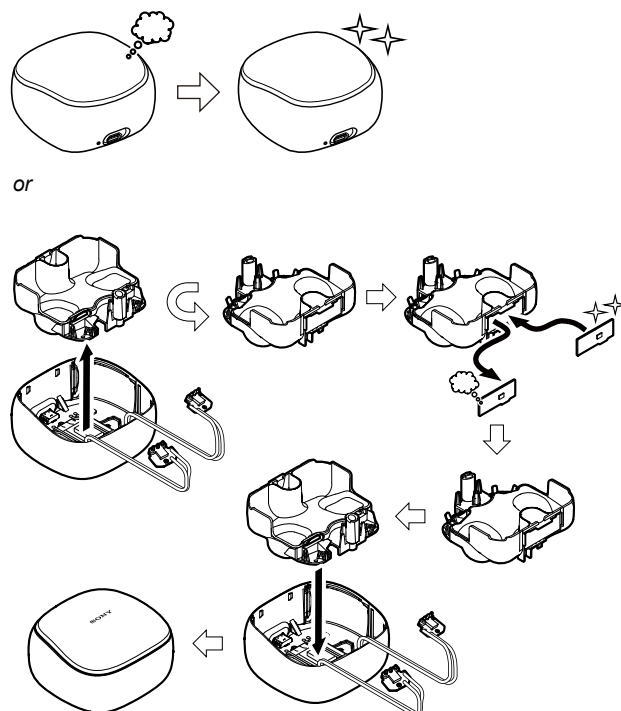

– Continued on next page –

WF-SP700N

2. Attach the WF-SP700NL (L-ch) and WF-SP700NR (R-ch) to the BC-WFSP700N (charging case).

Note 4: Please check that the WF-SP700NL (L-ch) and WF-SP700NR (R-ch) are locked to the BC-WFSP700N (charging case).

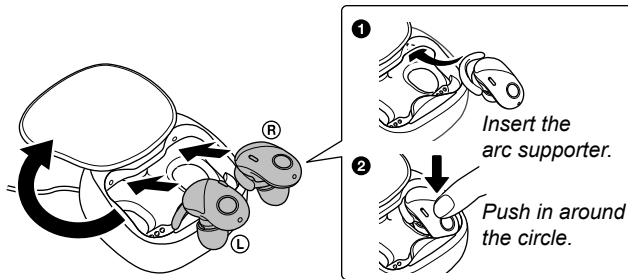

3. Remove only the WF-SP700NL (L-ch) from the BC-WF-SP700N (charging case).

(The power on the WF-SP700NL (L-ch) automatically and the blue lamp flashes)

Note 5: Do not remove the WF-SP700NR (R-ch) from the BC-WF-SP700N (charging case).

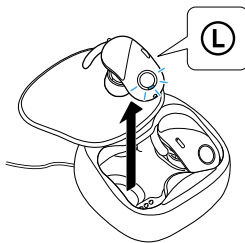

4. Press the [⏻] button on the WF-SP700NL (L-ch) for about 7 seconds until the blue and red lamps alternately flash, put them in pairing state and connect to the PC with the Bluetooth function.

(In order to check the Bluetooth address, it is necessary to connect the PC and the WF-SP700NL (L-ch). It is also possible to display the Bluetooth address, by the Bluetooth connect to the walkman (NW-S series or NW-A series etc.) with Bluetooth function. In this example, describes how to display Bluetooth address on PC.)

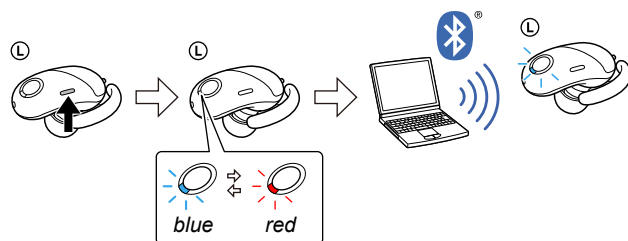

Note 6: For the Bluetooth connection method of the PC, refer to the manual of the PC to be used.

5. Display information of this unit Bluetooth connected on the PC screen. Then open the property, display the Bluetooth address of this unit, and take a memorandum the Bluetooth address.

(In the Windows 8.1, open the “Control Panel → Device and Printers” in this order, right click showing the model name (WF-SP700N) of this unit and open its properties)

(The figure below is a reference example.)

“Device and Printers” screen on PC



Right click and select the “Properties”.

“Properties” screen

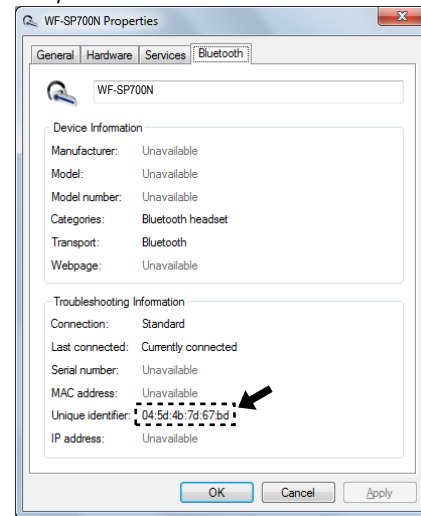

Note 7: Check the device name carefully so as not to confuse Bluetooth address with other devices, and take a memorandum.

Note 8: The display method of Bluetooth address may be different depending on Windows OS.

6. Write the Bluetooth information to the BC-WFSP700N (charging case) using NFC compatible smartphone that installed the NFC Tag Data Writing Application.

(Refer to “BLUETOOTH INFORMATION WRITING METHOD” on page 11)

7. After writing Bluetooth information, with the power of WF-SP700NL (L-ch) and WF-SP700NR (R-ch) turned off state, press each buttons for about 15 seconds simultaneously.

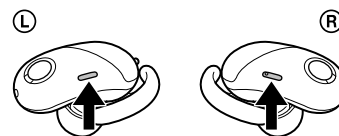

Note 9 : If the power is on, press the [⏻] button on the WF-SP700NL (L-ch) for about 2 seconds or more and turn off the power before performing this step.

Note 10: While the buttons are pressing, the lamp of WF-SP700NL (L-ch) is flashes in the middle, but keep pressing for more than about 15 seconds as it is.

– Continued on next page –

8. When the lamps of WF-SP700NL (L-ch) and WF-SP700NR (R-ch) are switched from flashing red several times to flashing blue 4 times and the lamps are turn off, pairing of WF-SP700NL (L-ch) and WF-SP700NR (R-ch) are completed.

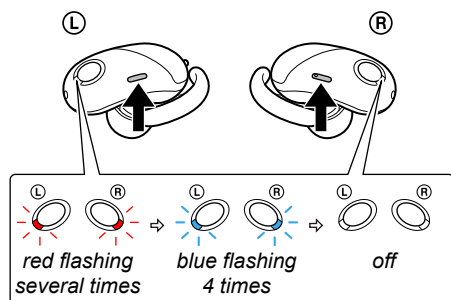

Note 11: When this unit is initialized, it might not be able to connect to iPhone or PC.

In that case, delete the registration of this unit on iPhone or PC, register the device again.

9. Check the operation of this unit and complete replacement works.

BLUETOOTH INFORMATION WRITING METHOD

When the WF-SP700NL (L-ch), BC-WFSP700N (charging case) is replaced, or the CRADLE NFC board of inside the BC-WFSP700N (charging case) is replaced, it is necessary to perform writing of Bluetooth information.

Write the Bluetooth information according to the procedure below.

Preparation:

- Windows PC with Bluetooth function
- NFC compatible smartphone that installed the file manager application (ASTRO File Manager, File Expert, etc.)
- USB cable for the smartphone
- NFC Tag Data Writing Application

(Application name: mdr-nfc-tag-writer_1.0.0.apk)

Note 1: "1.0.0" in the file name indicates the version of NFC Tag Data Writing Application. Always use the latest version of the NFC Tag Data Writing Application.

Example: mdr-nfc-tag-writer_1.0.0.apk

└ version

Note 2: Confirm the method of obtaining the NFC Tag Data Writing Application and its latest version with the each service headquarters.

Notes on the use of the NFC Tag Data Writing Application

- The NFC Tag Data Writing Application may be updated irregularly.
Always use the latest version of the NFC Tag Data Writing Application.
The version of NFC Tag Data Writing Application is represented by the file name of NFC Tag Data Writing Application.
Example: mdr-nfc-tag-writer_1.0.0.apk
└ version
- Be sure to uninstall older versions of the NFC Tag Data Writing Application before installing the latest version.
- The NFC Tag Data Writing Application is also used in models other than the headphone category, and there are multiple types. If multiple NFC Tag Data Writing Applications are installed on a smartphone, do not launch more than one at the same time.
- The NFC Tag Data Writing Application varies depending on your model.
Be sure to use the specified NFC Tag Data Writing Application.
Use of not specified NFC Tag Data Writing Application is strictly prohibited.

1. Installing the NFC Tag Data Writing Application

Install the NFC Tag Data Writing Application on the smartphone for writing of Bluetooth information.

If the NFC Tag Data Writing Application is already installed, confirm the following.

- Be absolutely sure that the NFC Tag Data Writing Application supports your model.
- Confirm that the NFC Tag Data Writing Application is the latest version.

The version of NFC Tag Data Writing Application is represented by the file name.

Example: mdr-nfc-tag-writer_1.0.0.apk

└ version

WF-SP700N

Procedure:

1. Prepare the NFC Tag Data Writing Application on the PC.
Note: Be absolutely sure that the NFC Tag Data Writing Application supports your model and that it is the latest version.
2. Using the USB cable for the smartphone, connect the smartphone and the PC, and transfer the NFC Tag Data Writing Application to the smartphone.

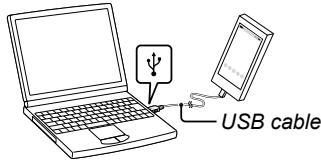

3. When tapping the “Settings” → “Security” on the screen of the smartphone, and check the “Unknown sources” checkbox.
 (The figure below is a reference example)

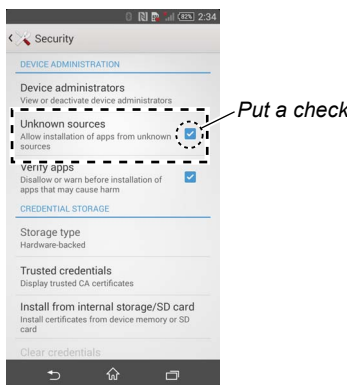

4. Disconnect the smartphone from the PC.

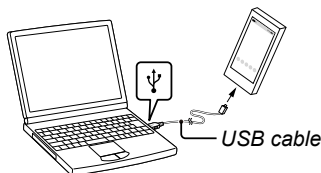

5. Use the file manager application to open the location to the NFC Tag Data Writing Application on the smartphone.
6. Tap on the NFC Tag Data Writing Application to open it, and install the NFC Tag Data Writing Application to the smartphone.
 (The figure below is a reference example)

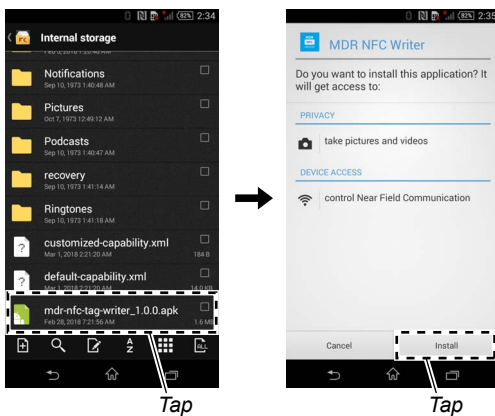

7. When tapping the “Settings” → “Security” on the screen of the smartphone, and uncheck the “Unknown sources” checkbox.
 (The figure below is a reference example)

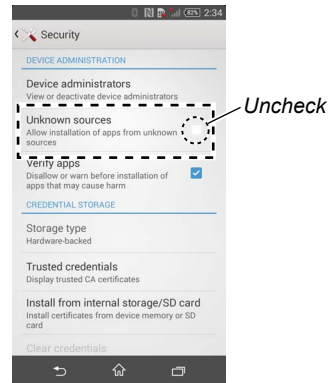

8. Complete install of NFC tag data writing application.
 (The figure below is a reference example)

– Screen after the installation for reference –

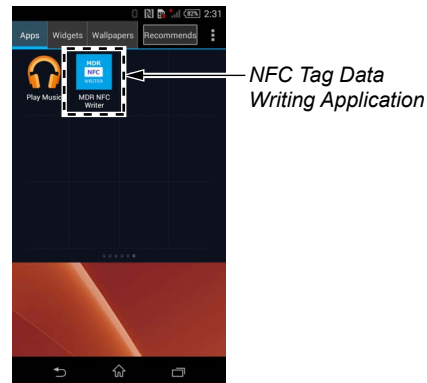

2. Writing the NFC Tag Data

Write the NFC tag data (Bluetooth information) to the NFC module.

Procedure:

1. Prepare the Bluetooth address (BD_ADDR) recorded in step 6 of “REPAIRING AND REPLACING OF THE WF-SP700NL (L-ch)” on page 6, or step 5 of “REPAIRING AND REPLACING OF THE BC-WFSP700N (charging case) OR THE CRADLE NFC BOARD” on page 9.
2. Open the NFC setting from “Settings” on the smartphone screen and turn on the NFC function of the smartphone.
 (The figure below is a reference example)

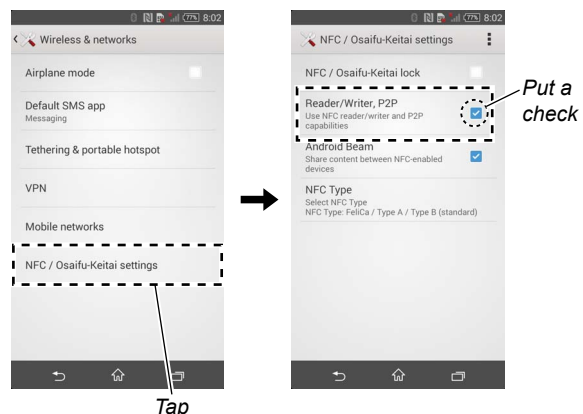

– Continued on next page –

- Start the NFC Tag Data Writing Application on the smartphone.
(The figure below is a reference example)

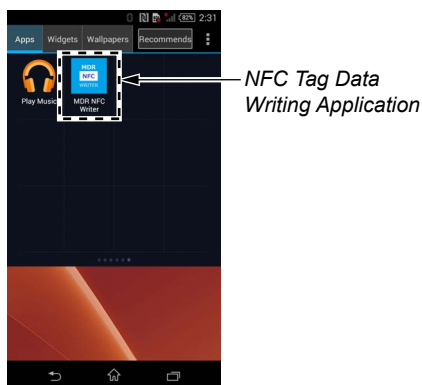

- Tap the "Write" button.

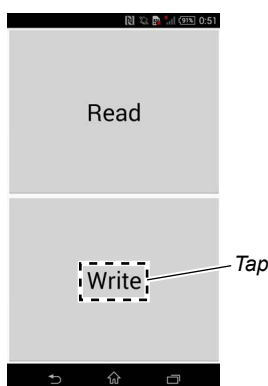

- Tap the "List" button and select the model name of this unit, or tap the "Bluetooth Local Name" to input the model name with the keyboard on the smartphone.

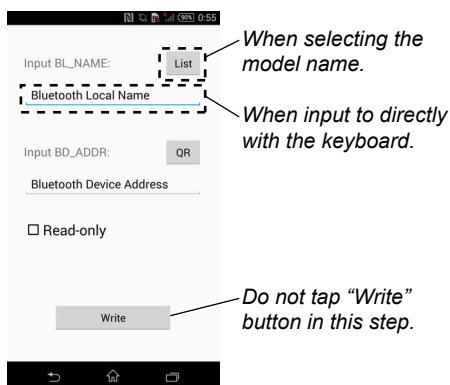

- Tap the "Bluetooth Device Address" and input the Bluetooth address prepared in step 1 directly with the keyboard on the smartphone.

Note 1: In the case of this unit, "QR" button is not used.

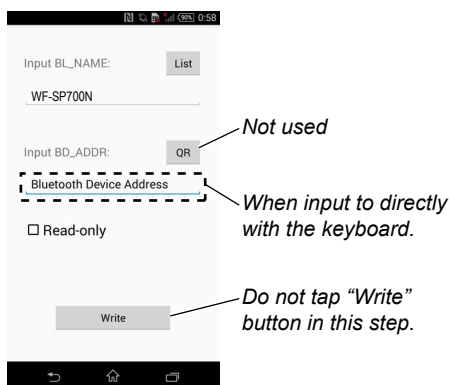

- Check the "Read-only" checkbox is unchecked, and tap the "Write" button and check that "Writable" is displayed.

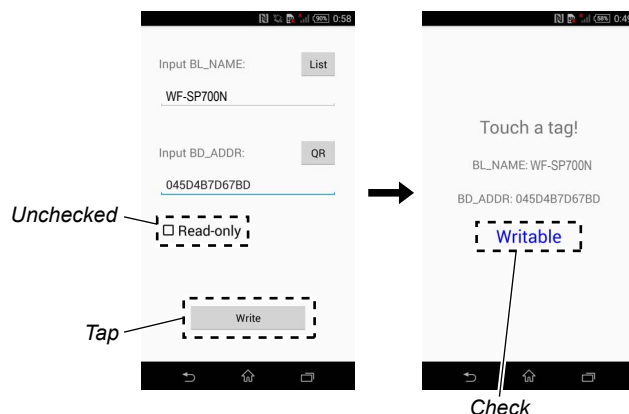

- In the state of step 7, touch the N-mark part of the smartphone to the N-mark part of the BC-WFSP700N (charging case).

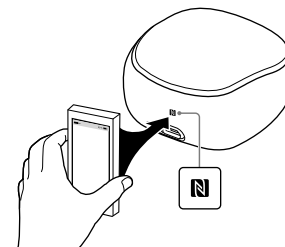

- Check that "Success!" is displayed on the screen of the smartphone and tap "OK" button.

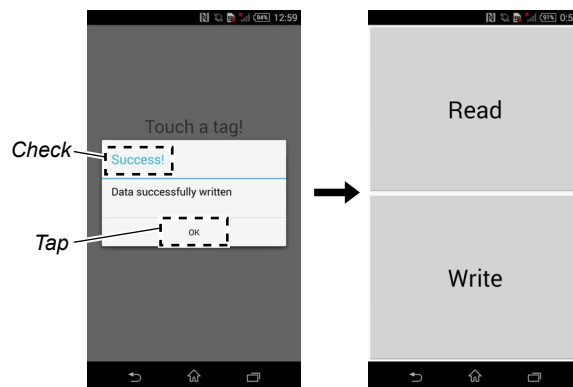

Note 2: When "Success!" is not displayed, refer to "3. Error Display" on page 15.

- End the NFC Tag Data Writing Application.
- Check the operation of connecting smartphone and this unit with NFC function.
(Refer to "OPERATION CHECK OF THE NFC FUNCTION AFTER COMPLETING THE REPAIRS" on page 4)

– Continued on next page –

WF-SP700N

12. Start again the NFC Tag Data Writing Application.
(The figure below is a reference example)

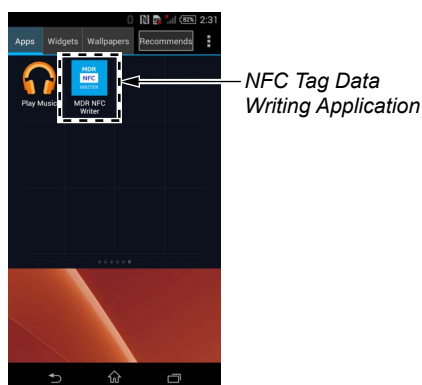

13. Tap the "Write" button.

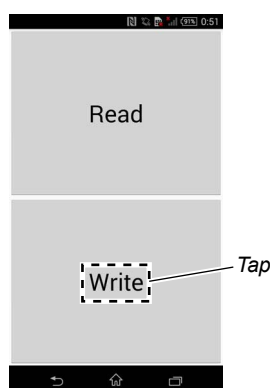

14. Check the "Read-only" checkbox is checked, and tap the "Write" button and check that "Read-only" is displayed.

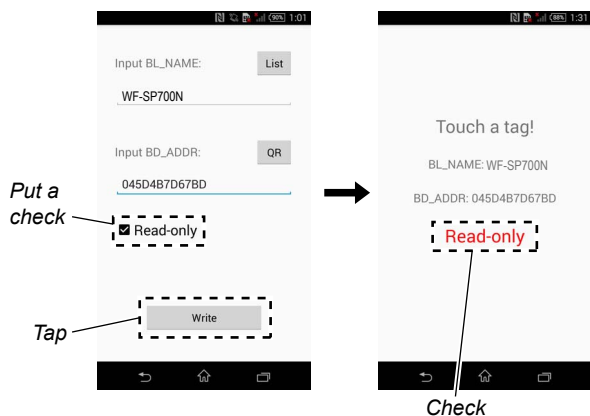

15. In the state of step 14, touch the N-mark part of the smartphone to the N-mark part of the BC-WFSP700N (charging case).

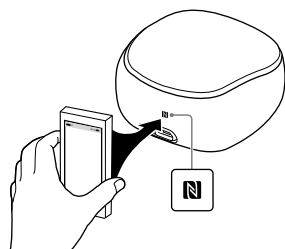

16. Check that "Success!" is displayed on the screen of the smart-
phone and tap "OK" button.

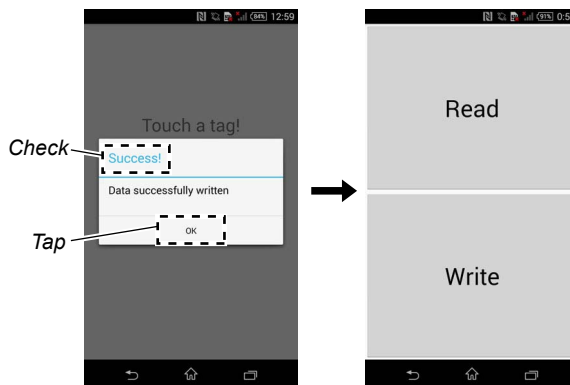

Note 3: When "Success!" is not displayed, refer to "3. Error Display" on page 15.

17. Tap the "Read" button.

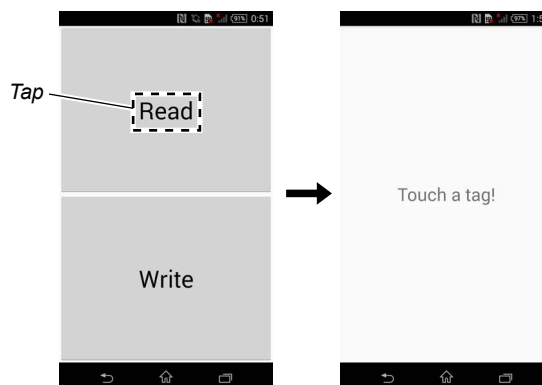

18. In the state of step 17, touch the N-mark part of the smartphone to the N-mark part of the BC-WFSP700N (charging case).

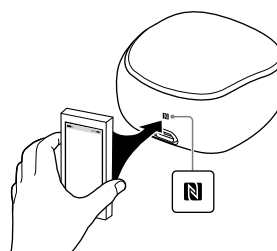

19. Check that "BD_ADDR" displayed on the screen of the smart-
phone matches the Bluetooth address checked in step 1 and the
"MODE" column is "0000 (Read-only)".

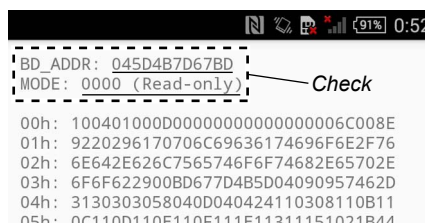

- 20. End the NFC Tag Data Writing Application.
- 21. Check the operation of connecting smartphone and this unit with NFC function.
(Refer to "OPERATION CHECK OF THE NFC FUNCTION AFTER COMPLETING THE REPAIRS" on page 4)
- 22. Complete writing the NFC tag data.

3. Error Display

When the writing of the NFC tag data has failed, “Error” is displayed on the screen of the smartphone. When “Error” is displayed, operate according to the procedure below.

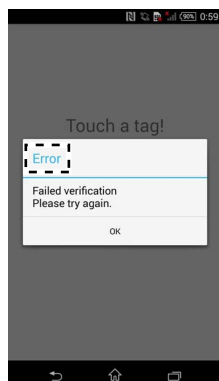

4. Tap the “Read” button.

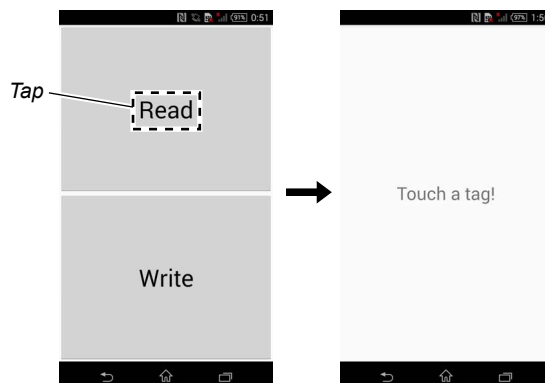

5. In the state of step 4, touch the N-mark part of the smartphone to the N-mark part of the BC-WFSP700N (charging case).

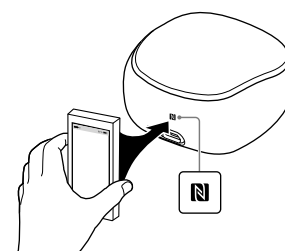

Procedure:

1. Tap “OK” button of “Error” display screen.

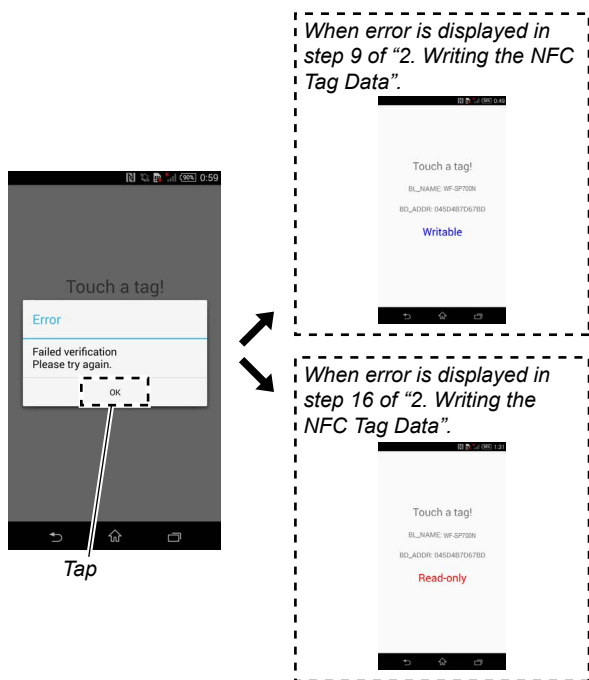

6. Check that the “MODE” column is other than “0000 (Read-only)”.

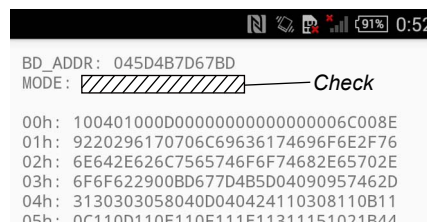

Note: If “MODE” column is displayed as “0000 (Read-only)”, replace the new CRADLE NFC board and write the NFC tag data again. (If “MODE” column is displayed as “0000 (Read-only)”, NFC tag data can not be written)

- When error occurs in step 9 of “2. Writing the NFC Tag Data”, operate the procedure from step 8 again. When error occurs in step 16 of “2. Writing the NFC Tag Data”, operate the procedure from step 15 again.
- If “Error” is displayed again in step 9 or step 16 of “2. Writing the NFC Tag Data”, after tapping “OK” button on “Error” display screen, tap “↶” twice and return to the first screen. (The figure below is an example of an error case in step 9)

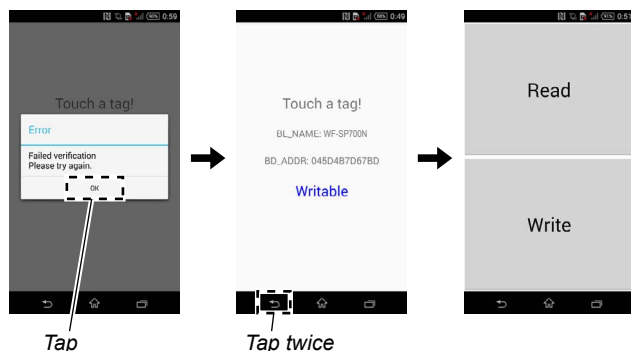

WF-SP700N

4. Check Method of the NFC Tag Data

If you want to check the NFC tag data of this unit after completing writing NFC tag data, check to the following procedure.

Preparation:

- Windows PC with Bluetooth function
- NFC compatible smartphone that installed the NFC Tag Data Writing Application

Procedure:

1. Press the [⏻] button on the WF-SP700NL (L-ch) for about 7 seconds until the blue and red lamps alternately flash, put them in pairing state and connect to the PC with the Bluetooth function.

(In order to check the Bluetooth address, it is necessary to connect the PC and the WF-SP700NL (L-ch). It is also possible to display the Bluetooth address, by the Bluetooth connect to the walkman (NW-S series or NW-A series etc.) with Bluetooth function. In this example, describes how to display Bluetooth address on PC.)

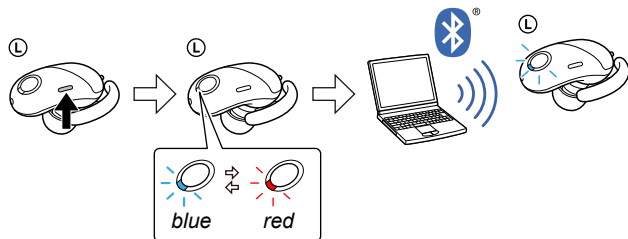

Note 1: For the Bluetooth connection method of the PC, refer to the manual of the PC to be used.

2. Display information of this unit Bluetooth connected on the PC screen. Then open the property, display the Bluetooth address of this unit.

(In the Windows 8.1, open the “Control Panel → Device and Printers” in this order, right click the icon showing the model name (WF-SP700N) of this unit and open its properties) (The figure below is a reference example.)

“Device and Printers” screen on PC

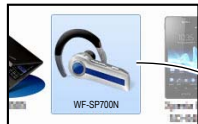

Right click and select the “Properties”.

“Properties” screen

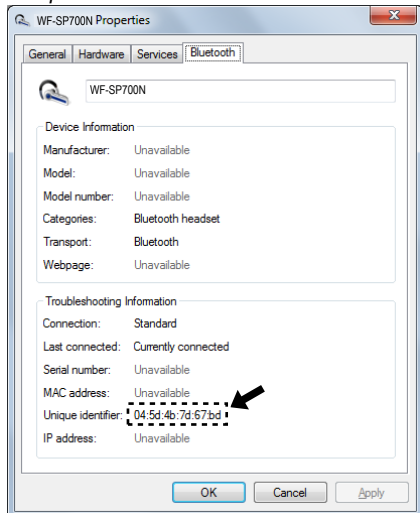

Note 2: Check the device name carefully so as not to confuse Bluetooth address with other devices, and take a memorandum.

Note 3: The display method of Bluetooth address may be different depending on Windows OS.

3. Open the NFC setting from “Settings” on the smartphone screen and turn on the NFC function of the smartphone. (The figure below is an example)

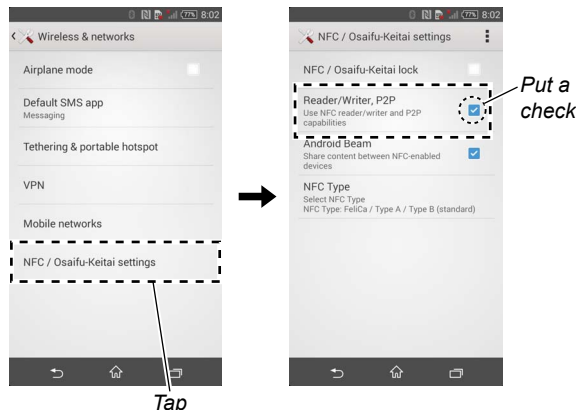

4. Start the NFC Tag Data Writing Application on the smartphone. (The figure below is a reference example)

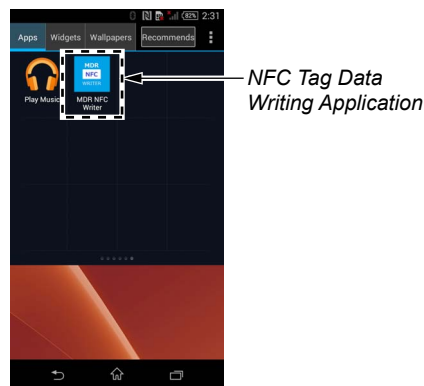

5. Tap the “Read” button.

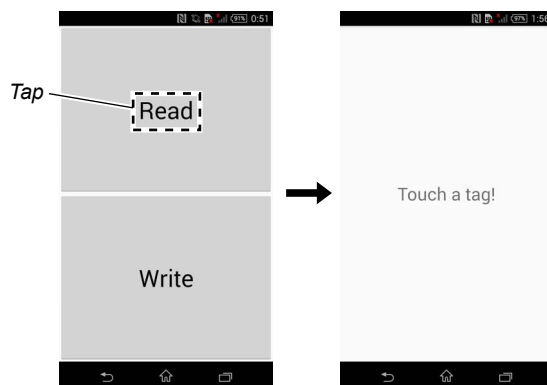

6. In the state of step 5, touch the N-mark part of the smartphone to the N-mark part of the BC-WFSP700N (charging case).

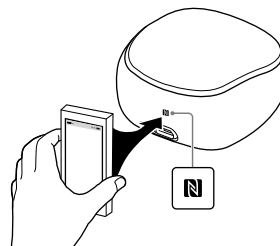

– Continued on next page –

7. Check that the alphanumeric characters of “BD_ADDR” displayed on the screen of the smartphone matches the Bluetooth address displayed on the PC in step 2.
Also, if “0000 (Read-only)” is displayed in the “MODE” column of the screen of the smartphone, NFC tag data has been written without any problem and can not be changed.

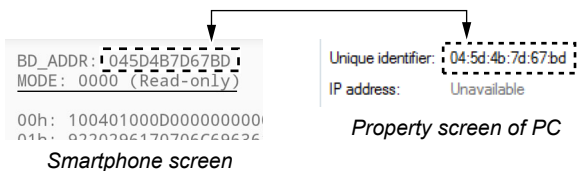

8. End the NFC Tag Data Writing Application on the smartphone.
Also, end the property screen of the PC, and the check of the NFC tag data is completed.

5. The Factor that One Touch Connection (NFC function) is Impossible

The four following factors are considered as the factor that one touch connection (NFC function) is impossible.

Guess and check the defective factor by each checking result.

Note: The four failure factors are examples.

	Factor	Bluetooth manual connection check by user	NFC tag data check	Bluetooth manual connection check by servicing	NFC one touch connection check with smartphone
1	WF-SP700NL (L-ch) defect	NG	—	NG	NG
2	CRADLE NFC board defect	OK	NG	OK	NG
3	NFC tag data writing failure	OK	NG	OK	NG
4	Smartphone trouble	OK	OK	OK	NG

SECTION 2 DISASSEMBLY

- This set can be disassembled in the order shown below.

2-1. DISASSEMBLY FLOW

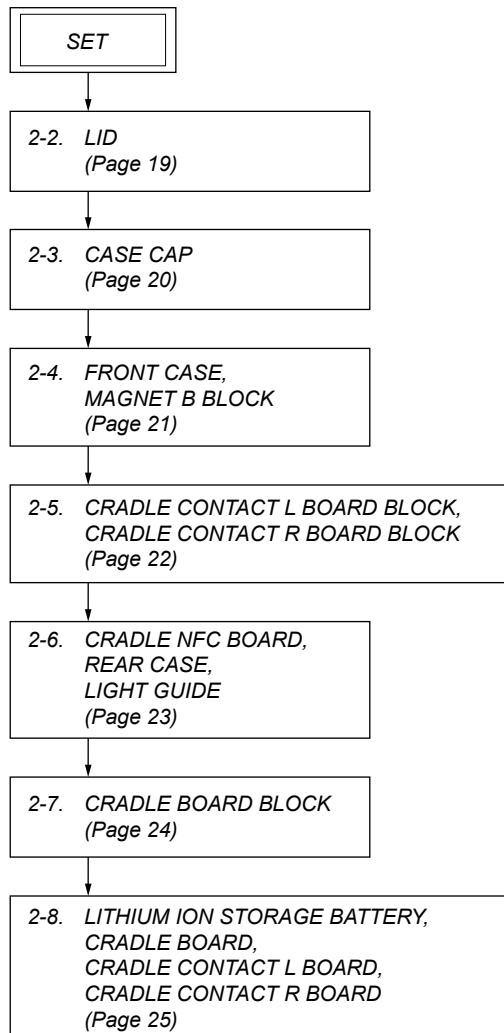

- JIG
When disassembling the unit, use the following jig.

Part No.	Description
9-913-402-33	TOOL FOR DISASSEMBLING

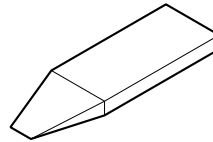

Note: Follow the disassembly procedure in the numerical order given.

2-2. LID

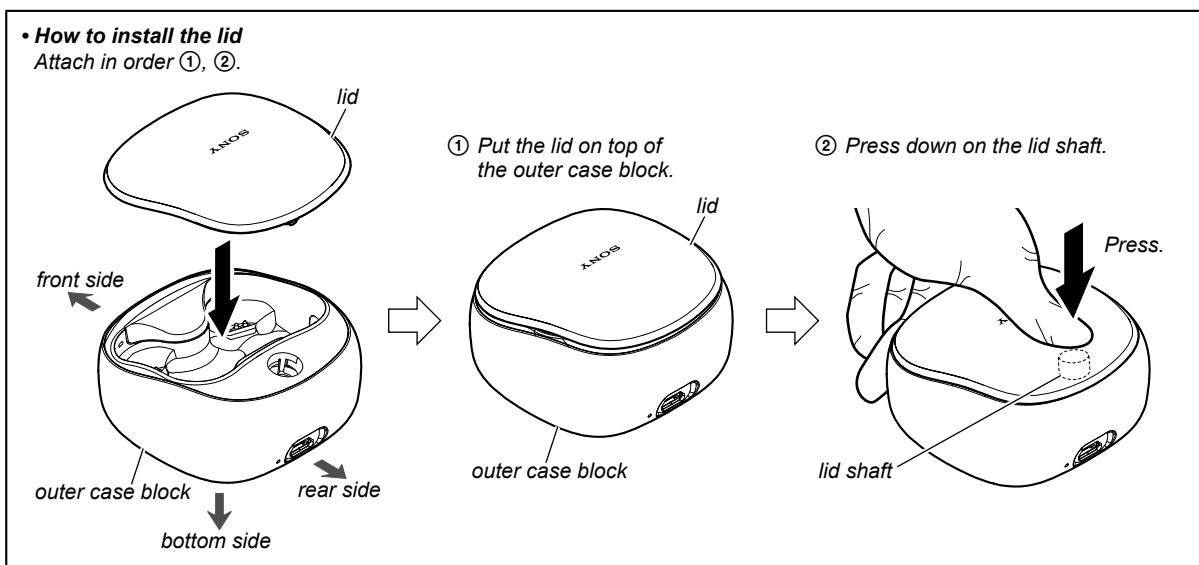
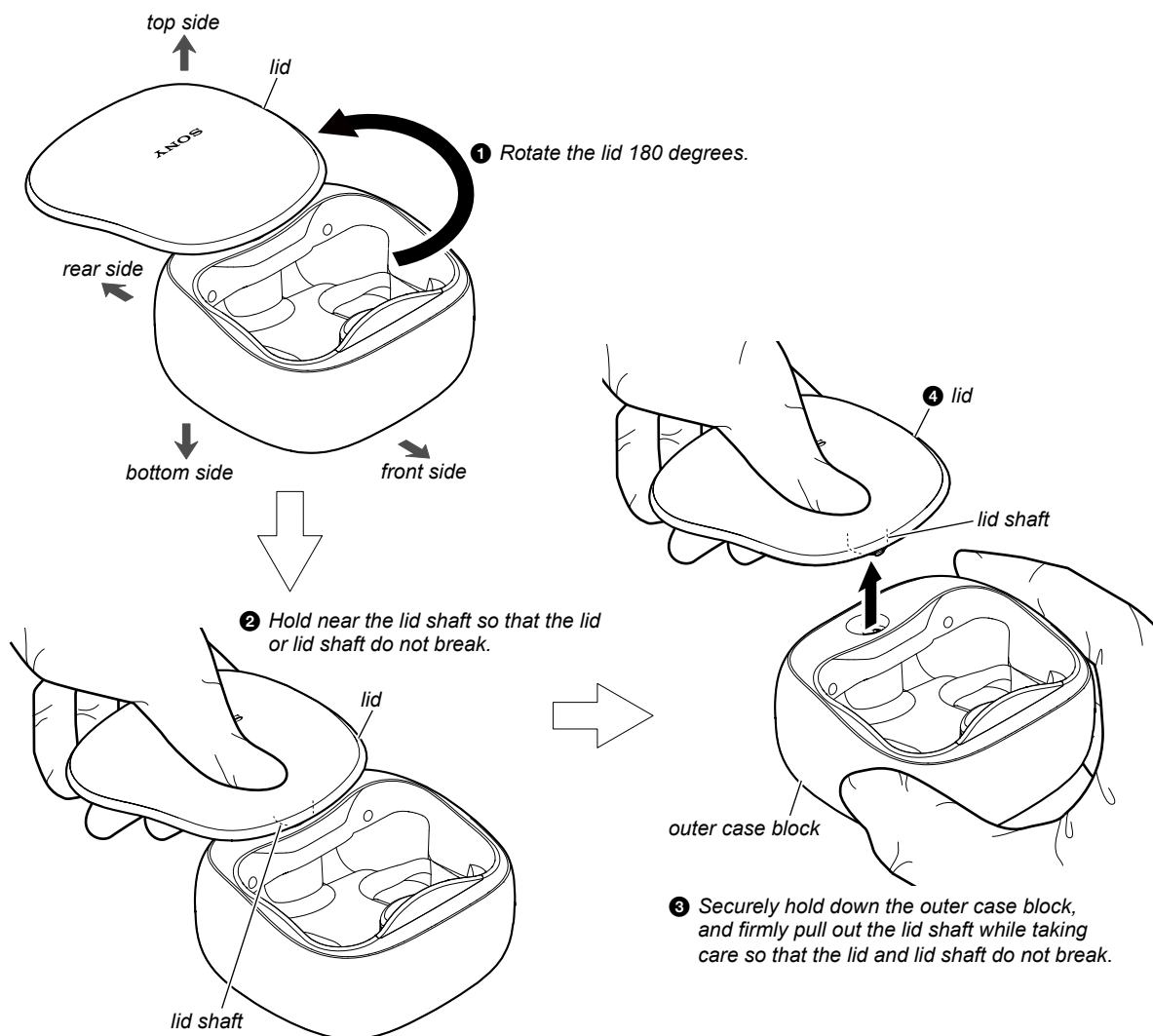

WF-SP700N

2-3. CASE CAP

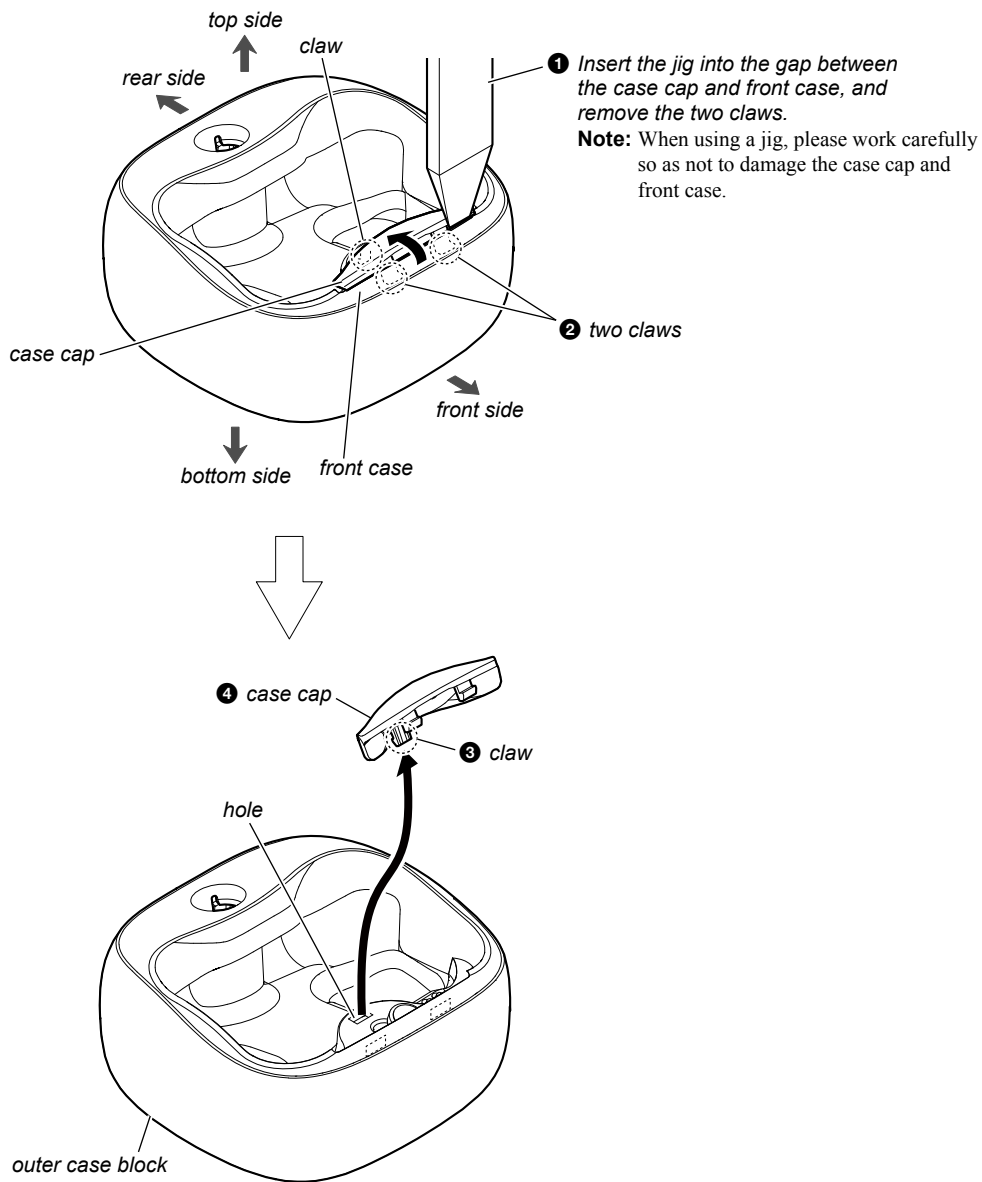

2-4. FRONT CASE, MAGNET B BLOCK

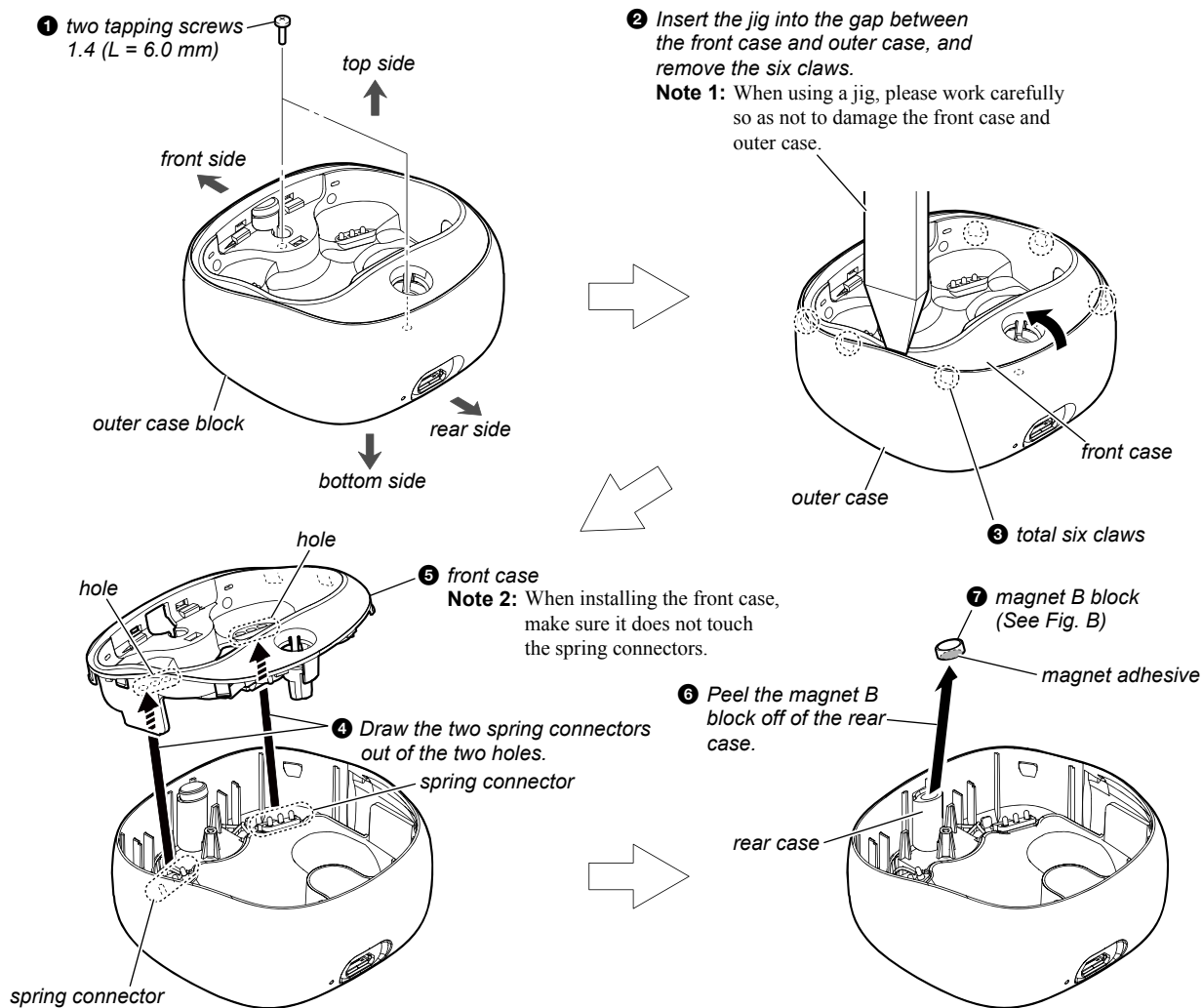

• How to install the magnet B block

< Fig. B >

Attach in order from ① to ③.

- ① Align the two spring connectors and two holes, and install the front case.

Note 2: When installing the front case, make sure it does not touch the spring connectors.

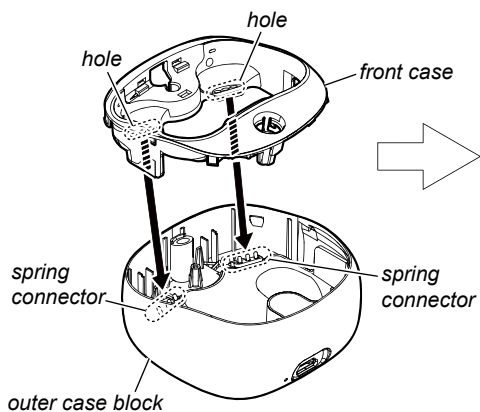

• Installation position of the magnet B block

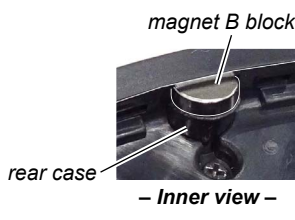

- ② Affix the magnet adhesive to magnet B.

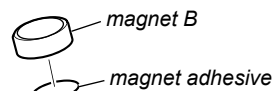

magnet B block

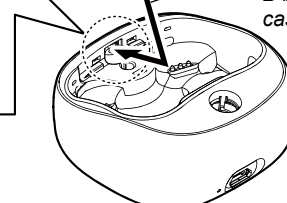

- ③ Install the magnet B block to the rear case.



WF-SP700N

2-5. CRADLE CONTACT L BOARD BLOCK, CRADLE CONTACT R BOARD BLOCK

• Note about installing the rubber cushion

OK	NG
Insert straight into the interior.	Insert only part way.
	

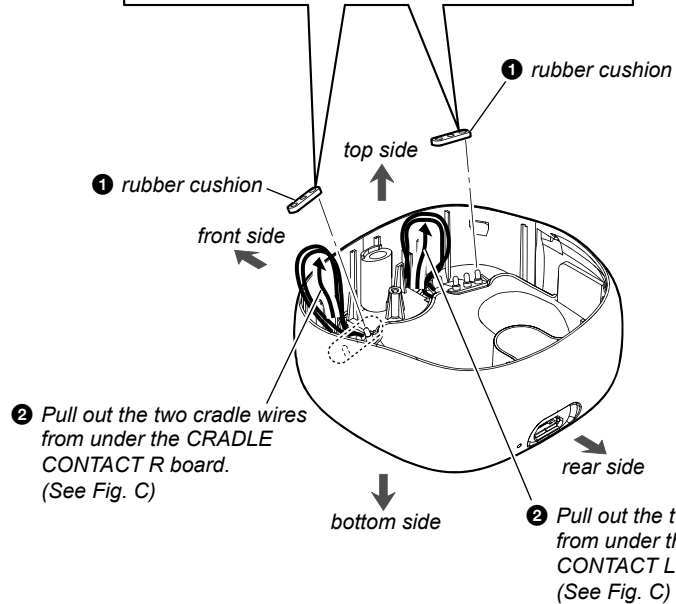

Note: The lithium ion storage battery is connected. Be careful so that terminals are not short-circuited.

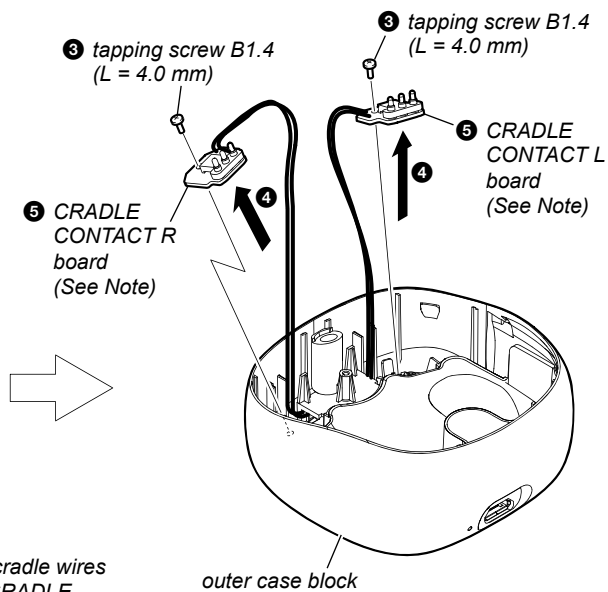

• Wire setting
< Fig. C >

cradle wire ORG [orange]

cradle wire BLU [blue]

CRADLE CONTACT L board

CRADLE CONTACT R board

Press.

Press.

CRADLE CONTACT L board

CRADLE CONTACT R board

- Top view -

2-6. CRADLE NFC BOARD, REAR CASE, LIGHT GUIDE

Note 1: When replacing the CRADLE NFC board, make sure to refer to "REPAIRING AND REPLACING OF THE BC-WF-SP700N (charging case) OR THE CRADLE NFC BOARD" on page 9.

Note 2: The lithium ion storage battery is connected. Be careful so that terminals are not short-circuited.

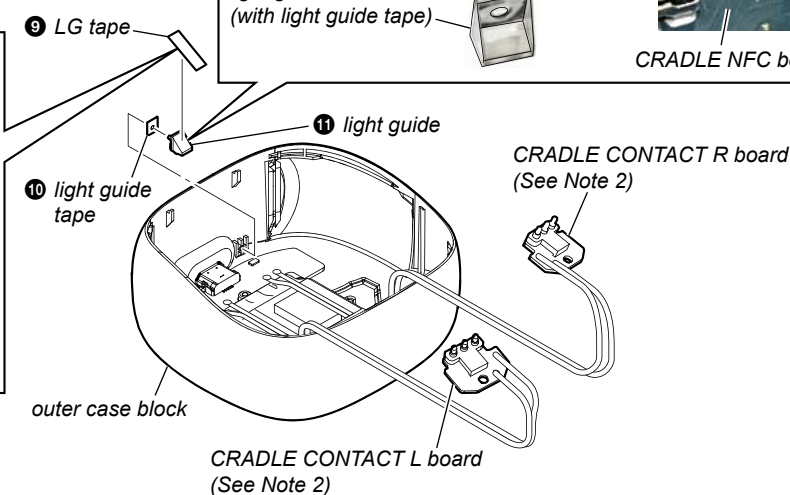
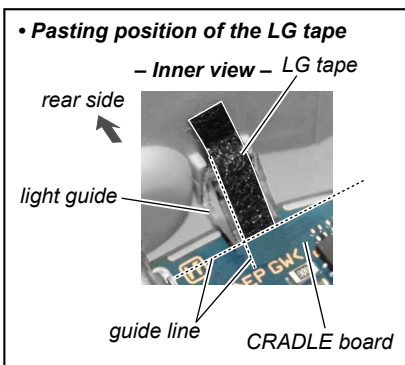
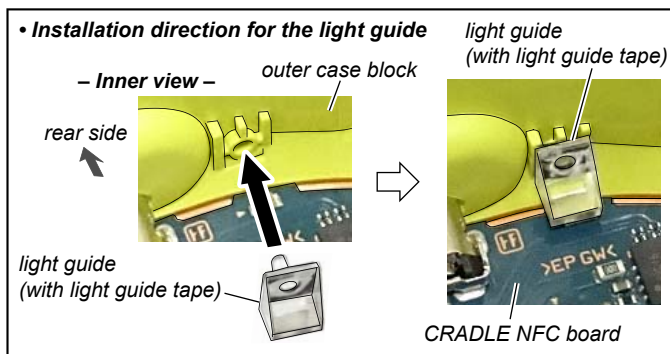
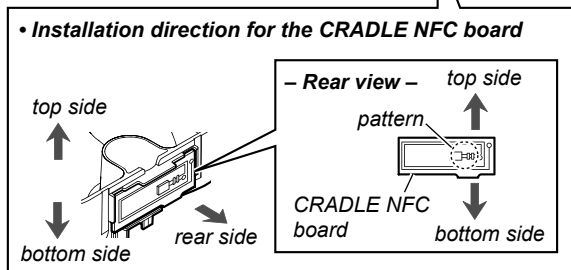
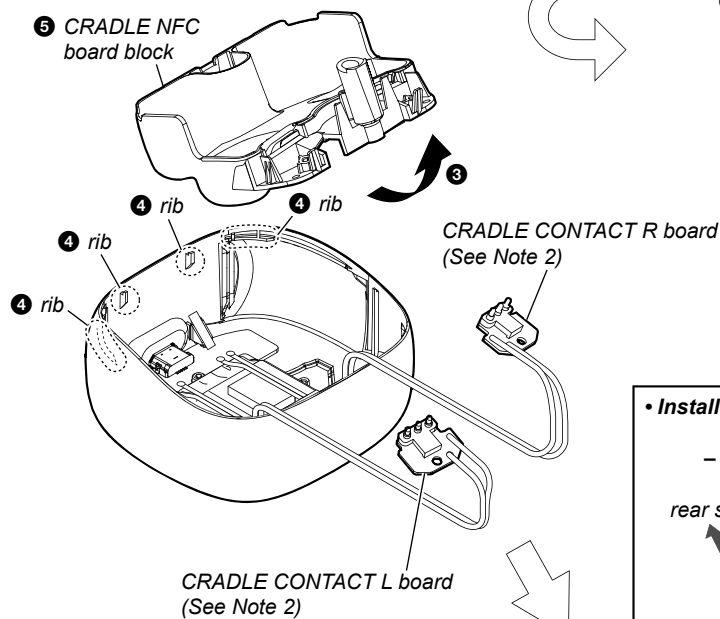
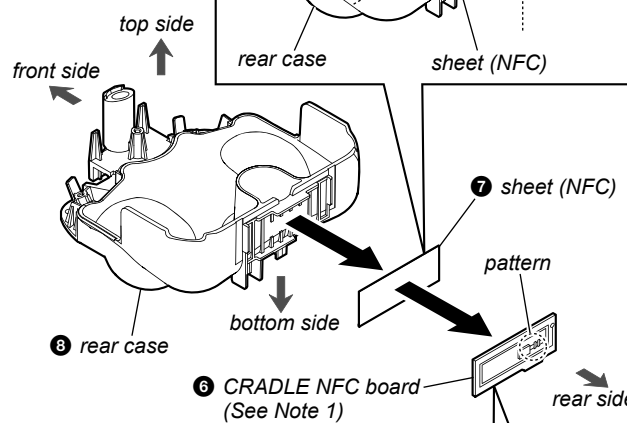
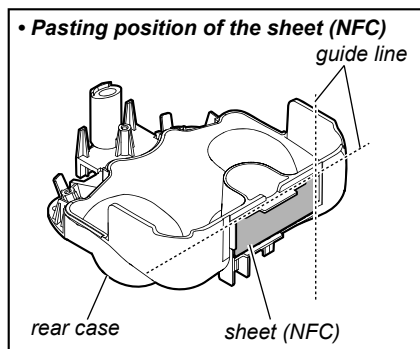
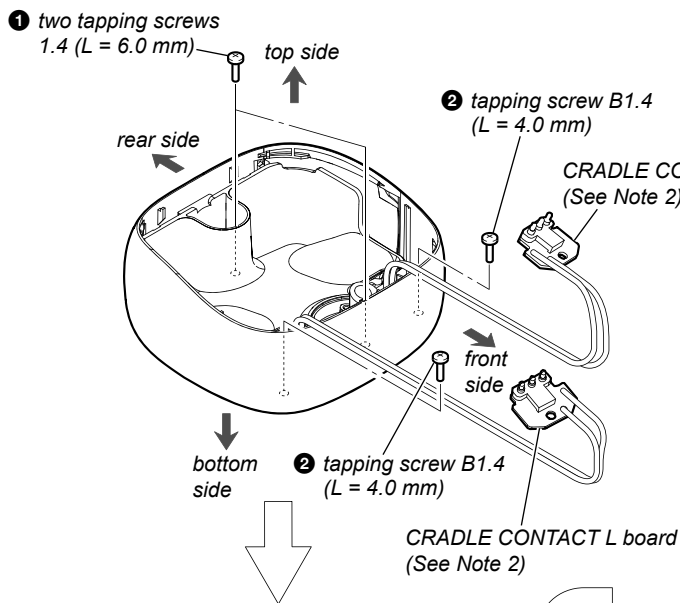

WF-SP700N

2-7. CRADLE BOARD BLOCK

Note 1: When removing the lithium ion storage battery from the adhesive tape (BATT), the lithium ion storage battery cannot be reused. Be sure to replace them with new parts.

• Pasting position of the tape

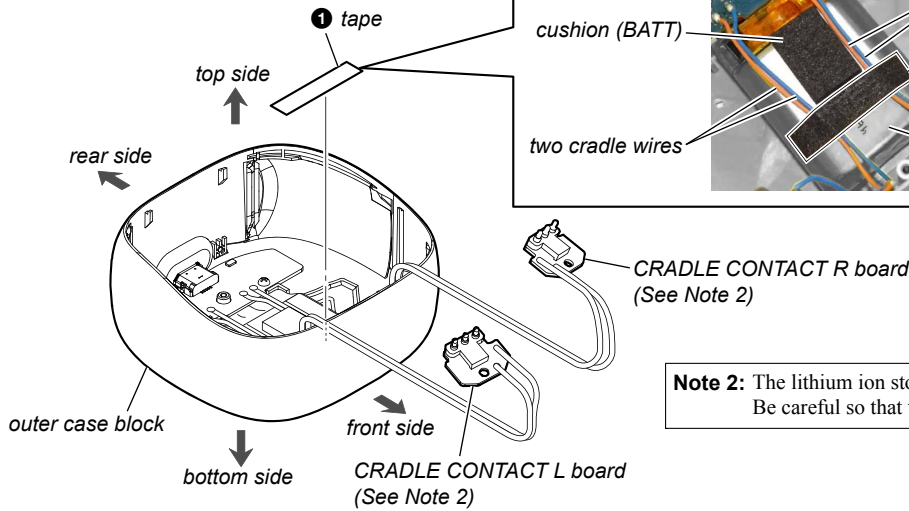
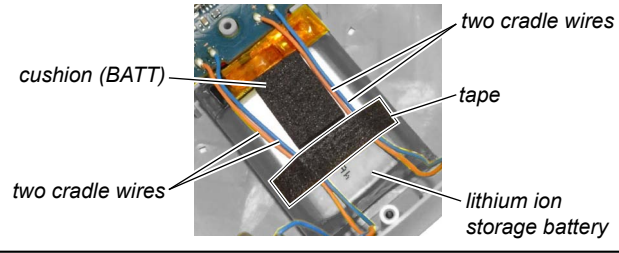

Note 2: The lithium ion storage battery is connected. Be careful so that terminals are not short-circuited.

• Battery wire setting

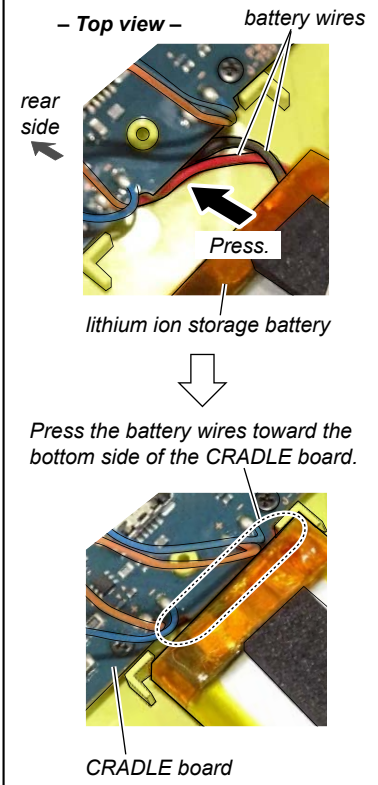

• Pasting position of the adhesive tape (BATT)
< Fig. D >

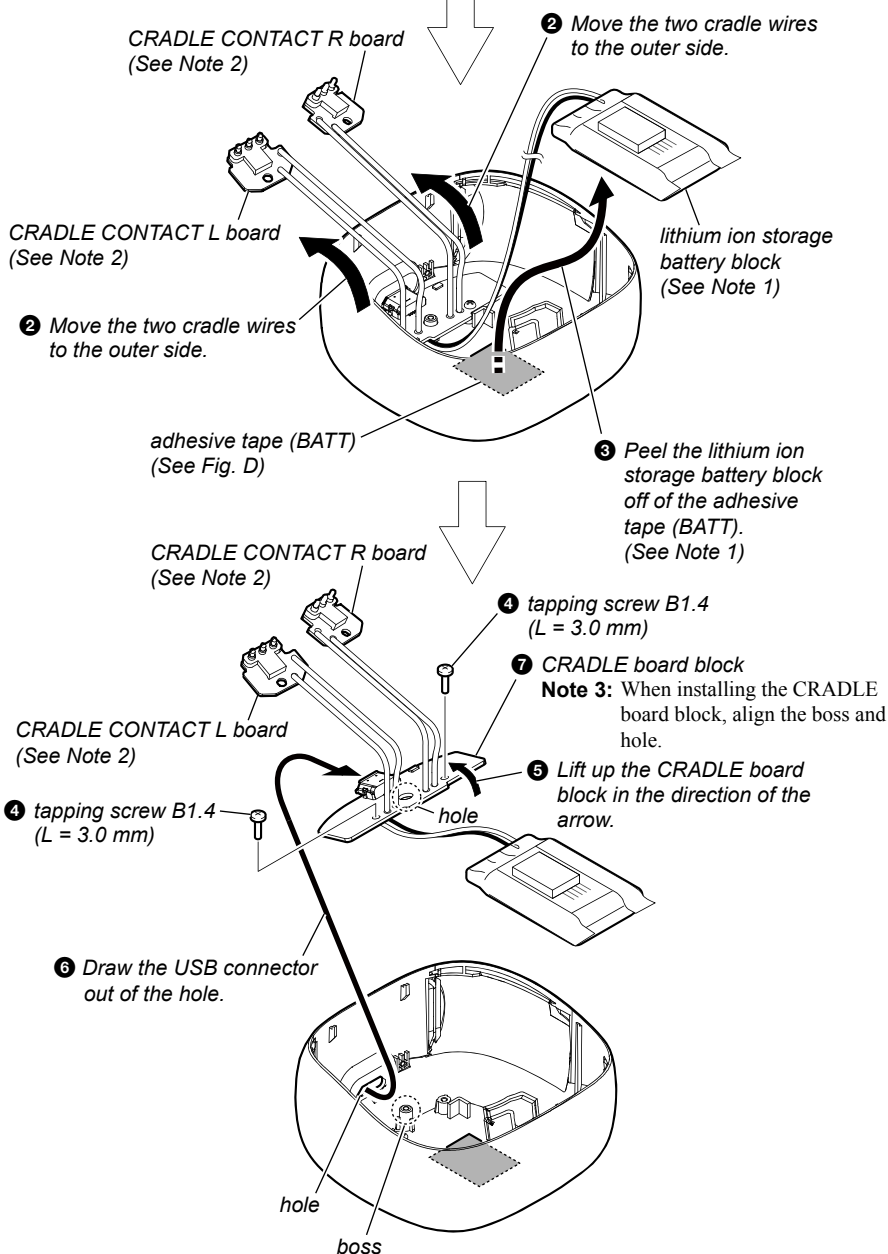
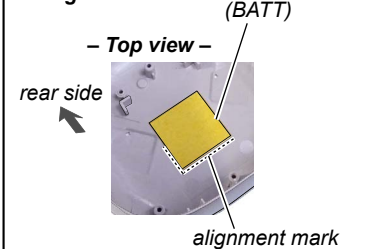

2-8. LITHIUM ION STORAGE BATTERY, CRADLE BOARD, CRADLE CONTACT L BOARD, CRADLE CONTACT R BOARD

Note 1: When replacing the lithium ion storage battery, refer to “CHECKING THE NEW LITHIUM ION RECHARGEABLE BATTERY FOR BEFORE USE AND NOTES ON HANDLING (BC-WFSP700N)” on page 3.

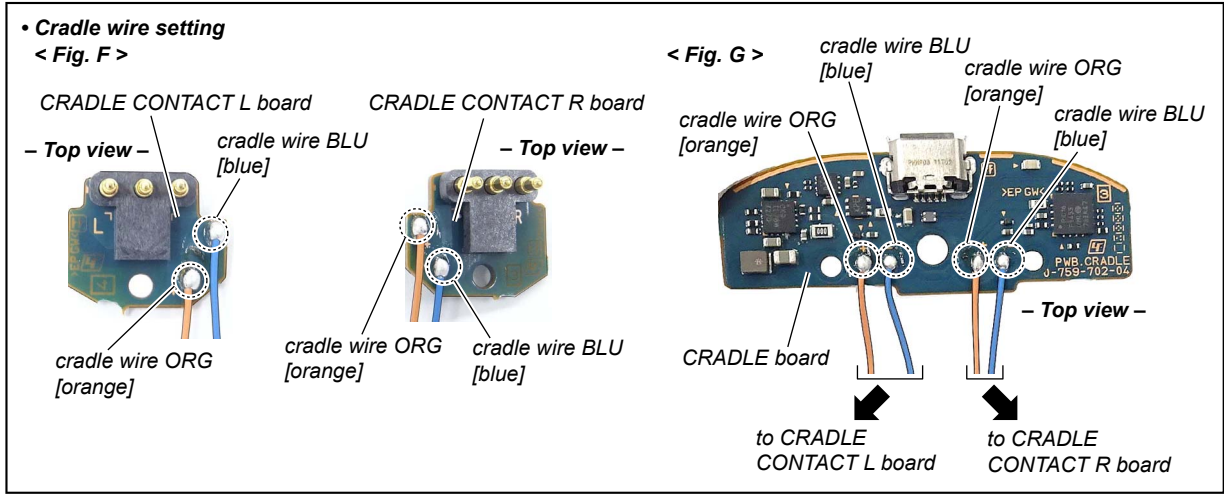
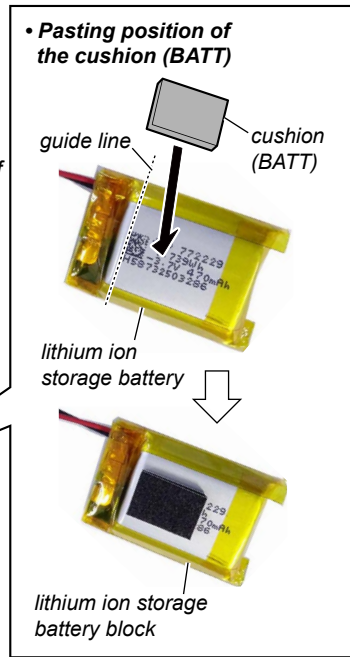
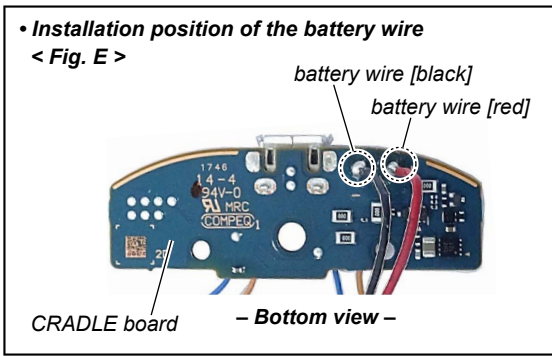
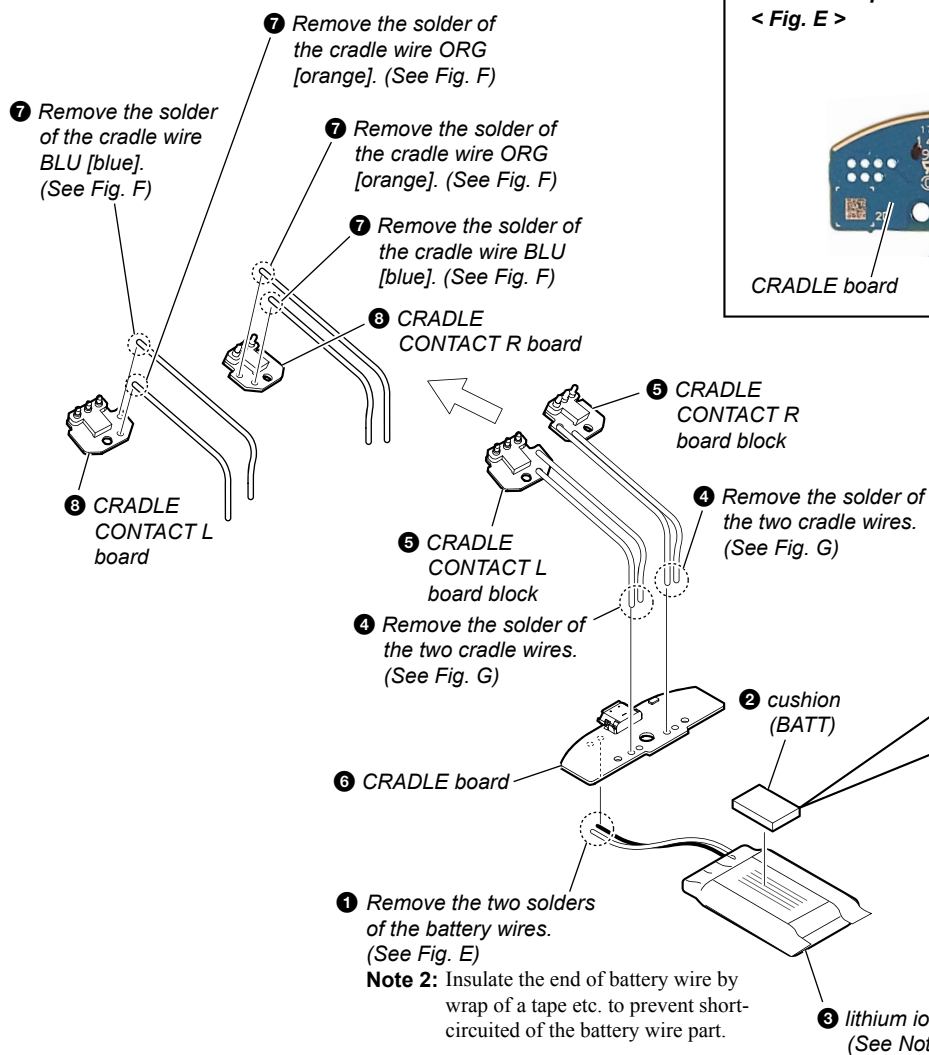

3-2. CHARGING CASE SECTION (BC-WFSP700N)

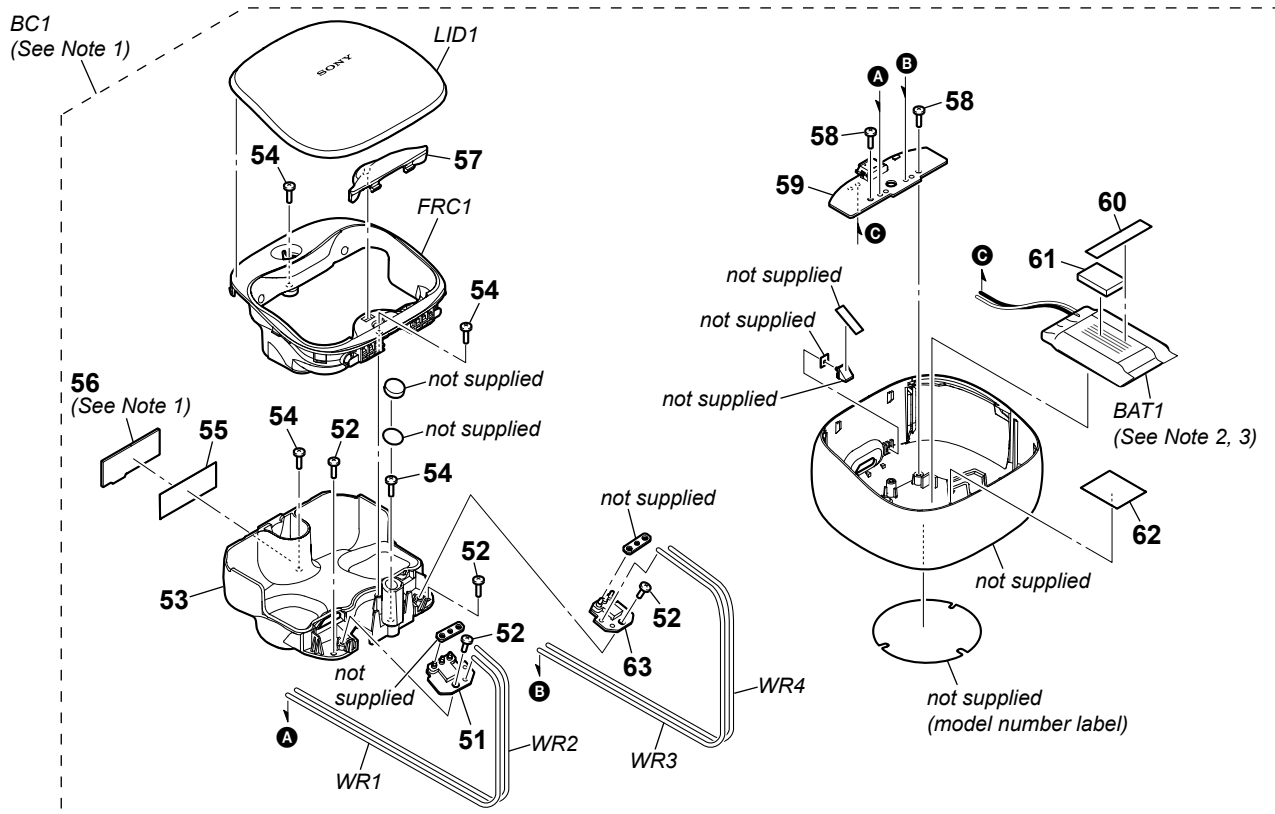

Note 1: When replacing the BC-WFSP700N (Ref. No. BC1) or the complete CRADLE NFC board (Ref. No. 56), make sure to refer to “REPAIRING AND REPLACING OF THE BC-WFSP700N (charging case) OR THE CRADLE NFC BOARD” on page 9. Also, when the BC-WFSP700N is replaced, the serial number changes.

Note 2: When removing the lithium ion storage battery (Ref. No. BAT1) from the adhesive tape (BATT) (Ref. No. 62), the lithium ion storage battery cannot be reused. Be sure to replace them with new parts. Also, when wire of the lithium ion storage battery is removed from board, insulate the end of battery wire by wrap of a tape etc. to prevent short-circuited of the battery wire part.

Note 3: When replacing the lithium ion storage battery (Ref. No. BAT1), refer to “CHECKING THE NEW LITHIUM ION RECHARGEABLE BATTERY FOR BEFORE USE AND NOTES ON HANDLING (BC-WFSP700N)” on page 3.

Ref. No.	Part No.	Description	Remark
51	A-2192-802-A	CRADLE CONTACT L BOARD, COMPLETE	(for left side)
52	3-254-136-01	SCREW (B1.4) (L = 4.0 mm)	
53	4-726-310-01	CASE, REAR	
54	3-252-824-21	SCREW +PTP 1.4 (L = 6.0 mm)	
55	4-698-515-01	SHEET (NFC)	
56	A-2192-804-A	CRADLE NFC BOARD, COMPLETE (See Note 1)	
57	4-726-317-02	CAP, CASE	
58	3-254-135-01	SCREW (B1.4) (L = 3.0 mm)	
59	A-2218-998-A	CRADLE BOARD, COMPLETE (SV)	
60	4-214-276-21	TAPE	
61	4-546-021-02	CUSHION (BATT)	
62	4-546-020-11	ADHESIVE, TAPE (BATT)	
63	A-2192-803-A	CRADLE CONTACT R BOARD, COMPLETE	(for right side)
BAT1	1-853-668-11	BATTERY, STORAGE, LITHIUM ION (See Note 2, 3)	
BC1	A-2207-827-A	BC-WFSP700N_BLACK_CN_SVX (Charging case)	(for Black) (CH) (See Note 1)
BC1	A-2207-828-A	BC-WFSP700N_WHITE_CN_SVX (Charging case)	(for White) (CH) (See Note 1)
BC1	A-2207-829-A	BC-WFSP700N_YELLOW_CN_SVX (Charging case)	(for Yellow) (CH) (See Note 1)
BC1	A-2207-830-A	BC-WFSP700N_PINK_CN_SVX (Charging case)	(for Pink) (CH) (See Note 1)
BC1	A-2207-831-A	BC-WFSP700N_BLACK_E_SVX (Charging case)	(for Black) (E, AUS, JE, RU, IND) (See Note 1)
BC1	A-2207-832-A	BC-WFSP700N_WHITE_E_SVX (Charging case)	(for White) (E, AUS, JE, RU) (See Note 1)
BC1	A-2207-833-A	BC-WFSP700N_YELLOW_E_SVX (Charging case)	(for Yellow) (E, AUS, JE, RU) (See Note 1)

Ref. No.	Part No.	Description	Remark
BC1	A-2207-834-A	BC-WFSP700N_PINK_E_SVX (Charging case)	(for Pink) (E, AUS, JE, RU) (See Note 1)
BC1	A-2207-835-A	BC-WFSP700N_BLACK_UC_SVX (Charging case)	(for Black) (US, CND, LA) (See Note 1)
BC1	A-2207-836-A	BC-WFSP700N_WHITE_UC_SVX (Charging case)	(for White) (US, CND, LA) (See Note 1)
BC1	A-2207-837-A	BC-WFSP700N_YELLOW_UC_SVX (Charging case)	(for Yellow) (US, CND, LA) (See Note 1)
BC1	A-2207-838-A	BC-WFSP700N_PINK_UC_SVX (Charging case)	(for Pink) (US, CND, LA) (See Note 1)
BC1	A-2207-839-A	BC-WFSP700N_BLACK_CE7_SVX (Charging case)	(for Black) (AEP, UK) (See Note 1)
BC1	A-2207-840-A	BC-WFSP700N_WHITE_CE7_SVX (Charging case)	(for White) (AEP, UK) (See Note 1)
BC1	A-2207-841-A	BC-WFSP700N_YELLOW_CE7_SVX (Charging case)	(for Yellow) (AEP, UK) (See Note 1)
BC1	A-2207-842-A	BC-WFSP700N_PINK_CE7_SVX (Charging case)	(for Pink) (AEP, UK) (See Note 1)
FRC1	A-2218-996-A	CASE FRONT_SVX (Including Magnet B, Rubber ball, Plate spring, Cover spring L, Cover spring R)	
LID1	A-2207-819-A	LID (BLACK SVX)	(for Black)
LID1	A-2207-820-A	LID (WHITE SVX)	(for White)
LID1	A-2207-821-A	LID (YELLOW SVX)	(for Yellow)
LID1	A-2207-822-A	LID (PINK SVX)	(for Pink)
WR1	1-912-471-21	WIRE, CRADLE ORG	(Orange)
WR2	1-912-471-11	WIRE, CRADLE BLU	(Blue)
WR3	1-912-471-21	WIRE, CRADLE ORG	(Orange)
WR4	1-912-471-11	WIRE, CRADLE BLU	(Blue)

SECTION 4 ACCESSORIES

Ref. No.	Part No.	Description	Remark	Ref. No.	Part No.	Description	Remark
	4-730-306-12	MANUAL, INSTRUCTION (Except CH)		504	4-543-905-01	EAR PIECE, LONG (M) (Long Hybrid silicone rubber earbud: size M) (1 piece) (Outside: SMOKE BLACK/Inside: GREEN) (for Black)	
	4-730-306-22	MANUAL, INSTRUCTION (CH)					
	4-730-307-11	GUIDE, REFERENCE (ENGLISH, SPANISH, FRENCH) (US, CND, LA)		504	4-543-905-11	EAR PIECE, LONG (M) (Long Hybrid silicone rubber earbud: size M) (1 piece) (Outside: MILKY WHITE/Inside: GREEN) (for White)	
	4-730-307-21	GUIDE, REFERENCE (SIMPLIFIED CHINESE) (CH)		504	4-543-905-71	EAR PIECE, LONG (M) (Long Hybrid silicone rubber earbud: size M) (1 piece) (Outside: TRANSPARENT LIGHT YELLOW/ Inside: GREEN) (for Yellow)	
	4-730-307-32	GUIDE, REFERENCE (ENGLISH, RUSSIAN, ARABIC, TRADITIONAL CHINESE, KOREAN, UKRAINIAN) (E, AUS, JE, RU, IND)		504	4-543-905-81	EAR PIECE, LONG (M) (Long Hybrid silicone rubber earbud: size M) (1 piece) (Outside: TRANSPARENT MISTYROSE/ Inside: GREEN) (for Pink)	
	4-730-307-41	GUIDE, REFERENCE (ENGLISH, FRENCH, GERMAN, SPANISH, DUTCH, ITALIAN, POLISH, HUNGARIAN) (AEP, UK)		505	4-543-906-01	EAR PIECE, LONG (L) (Long Hybrid silicone rubber earbud: size L) (1 piece) (Outside: SMOKE BLACK/Inside: LIGHT BLUE) (for Black)	
	4-730-307-51	GUIDE, REFERENCE (PORTUGUESE, GREEK, CZECH, BULGARIAN, SLOVAK, SLOVENIAN, ROMANIAN) (AEP, UK)		505	4-543-906-11	EAR PIECE, LONG (L) (Long Hybrid silicone rubber earbud: size L) (1 piece) (Outside: MILKY WHITE/Inside: LIGHT BLUE) (for White)	
501	1-848-682-21	CABLE, CONNECTION (USB) (Micro-USB cable (approx. 50 cm))		505	4-543-906-71	EAR PIECE, LONG (L) (Long Hybrid silicone rubber earbud: size L) (1 piece) (Outside: TRANSPARENT LIGHT YELLOW/ Inside: LIGHT BLUE) (for Yellow)	
502	4-543-903-01	EAR PIECE, LONG (SS) (Long Hybrid silicone rubber earbud: size SS) (1 piece) (Outside: SMOKE BLACK/Inside: RED) (for Black)		505	4-543-906-81	EAR PIECE, LONG (L) (Long Hybrid silicone rubber earbud: size L) (1 piece) (Outside: TRANSPARENT MISTYROSE/ Inside: LIGHT BLUE) (for Pink)	
502	4-543-903-11	EAR PIECE, LONG (SS) (Long Hybrid silicone rubber earbud: size SS) (1 piece) (Outside: MILKY WHITE/Inside: RED) (for White)					
502	4-543-903-71	EAR PIECE, LONG (SS) (Long Hybrid silicone rubber earbud: size SS) (1 piece) (Outside: TRANSPARENT LIGHT YELLOW/ Inside: RED) (for Yellow)					
502	4-543-903-81	EAR PIECE, LONG (SS) (Long Hybrid silicone rubber earbud: size SS) (1 piece) (Outside: TRANSPARENT MISTYROSE/ Inside: RED) (for Pink)					
503	4-543-904-01	EAR PIECE, LONG (S) (Long Hybrid silicone rubber earbud: size S) (1 piece) (Outside: SMOKE BLACK/Inside: ORANGE) (for Black)					
503	4-543-904-11	EAR PIECE, LONG (S) (Long Hybrid silicone rubber earbud: size S) (1 piece) (Outside: MILKY WHITE/Inside: ORANGE) (for White)					
503	4-543-904-71	EAR PIECE, LONG (S) (Long Hybrid silicone rubber earbud: size S) (1 piece) (Outside: TRANSPARENT LIGHT YELLOW/ Inside: ORANGE) (for Yellow)					
503	4-543-904-81	EAR PIECE, LONG (S) (Long Hybrid silicone rubber earbud: size S) (1 piece) (Outside: TRANSPARENT MISTYROSE/ Inside: ORANGE) (for Pink)					

– Continued on next page –

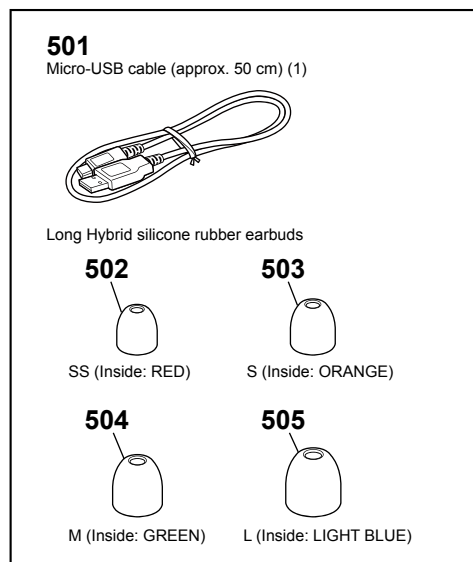

• How to remove the ear piece

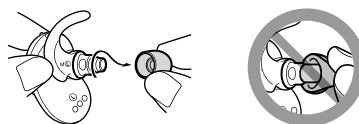

• How to install the ear piece

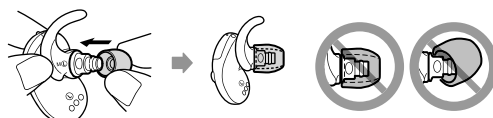

• Refer to "COLOR VARIATIONS" on page 3 about color variation of the unit.

Ref. No.	Part No.	Description	Remark
506	4-726-291-01	ARC SUPPORTER L (M) (for L-ch: size M) (LIGHT SMOKE) (for Black)	
506	4-726-291-11	ARC SUPPORTER L (M) (for L-ch: size M) (MILKY WHITE) (for White)	
506	4-726-291-21	ARC SUPPORTER L (M) (for L-ch: size M) (TRANSPARENT YELLOW) (for Yellow)	
506	4-726-291-31	ARC SUPPORTER L (M) (for L-ch: size M) (TRANSPARENT PINK) (for Pink)	
507	4-726-292-01	ARC SUPPORTER R (M) (for R-ch: size M) (LIGHT SMOKE) (for Black)	
507	4-726-292-11	ARC SUPPORTER R (M) (for R-ch: size M) (MILKY WHITE) (for White)	
507	4-726-292-21	ARC SUPPORTER R (M) (for R-ch: size M) (TRANSPARENT YELLOW) (for Yellow)	
507	4-726-292-31	ARC SUPPORTER R (M) (for R-ch: size M) (TRANSPARENT PINK) (for Pink)	
508	4-726-293-01	ARC SUPPORTER L (L) (for L-ch: size L) (LIGHT SMOKE) (for Black)	
508	4-726-293-11	ARC SUPPORTER L (L) (for L-ch: size L) (MILKY WHITE) (for White)	
508	4-726-293-21	ARC SUPPORTER L (L) (for L-ch: size L) (TRANSPARENT YELLOW) (for Yellow)	
508	4-726-293-31	ARC SUPPORTER L (L) (for L-ch: size L) (TRANSPARENT PINK) (for Pink)	
509	4-726-294-01	ARC SUPPORTER R (L) (for R-ch: size L) (LIGHT SMOKE) (for Black)	
509	4-726-294-11	ARC SUPPORTER R (L) (for R-ch: size L) (MILKY WHITE) (for White)	
509	4-726-294-21	ARC SUPPORTER R (L) (for R-ch: size L) (TRANSPARENT YELLOW) (for Yellow)	
509	4-726-294-31	ARC SUPPORTER R (L) (for R-ch: size L) (TRANSPARENT PINK) (for Pink)	

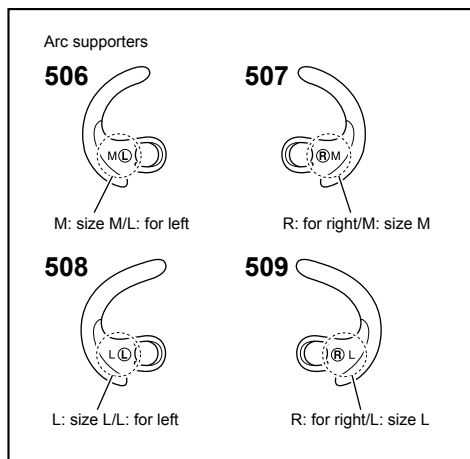

• How to remove the arc supporter

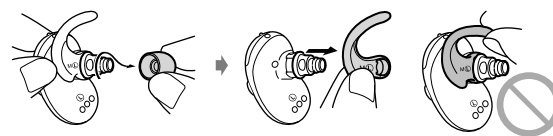

• How to install the arc supporter

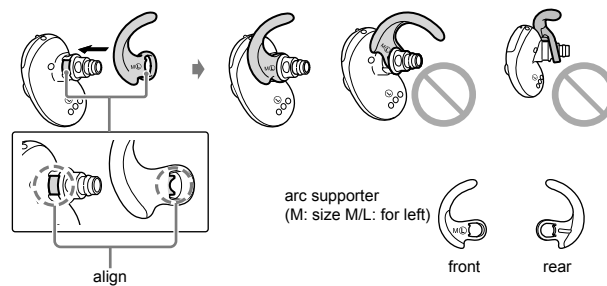

- Refer to "COLOR VARIATIONS" on page 3 about color variation of the unit.

