

MDR-ZX770BN/ZX770BT/ ZX780DC

SERVICE MANUAL

Ver. 1.1 2016.08



Photo: MDR-ZX770BN

US Model
Canadian Model
MDR-ZX770BN/ZX770BT/ZX780DC
AEP Model
UK Model
Latin American Model
MDR-ZX770BN
E Model
Australian Model
Tourist Model
Russian Model
MDR-ZX770BN/ZX770BT

SPECIFICATIONS

General

Communication system: BLUETOOTH Specification version 3.0
Output: BLUETOOTH Specification Power Class 2
Maximum communication range: Line of sight approx. 10 m (30 ft)¹⁾

Frequency band: 2.4 GHz band (2.4000 GHz - 2.4835 GHz)

Modulation method: FHSS

Compatible BLUETOOTH profiles²⁾:

A2DP (Advanced Audio Distribution Profile)
AVRCP (Audio Video Remote Control Profile)
HFP (Hands-free Profile)
HSP (Headset Profile)

Supported Codec: ³⁾ SBC ⁴⁾ AAC ⁵⁾ aptX

Supported content protection method: SCMS-T

Transmission range (A2DP): 20 Hz - 20,000 Hz (Sampling frequency 44.1 kHz)

Included items:

Wireless noise canceling stereo headset (1)
(MDR-ZX770BN/ZX780DC only)
Wireless stereo headset (1) (MDR-ZX770BT only)
Micro-USB cable (approx. 50 cm (19 3/4 in.)) (1)
Headphone cable (approx. 1.2 m (47 1/4 in.)) (1)
(MDR-ZX770BN/ZX780DC only)
Carrying pouch (1) (MDR-ZX770BN/ZX780DC only)
Carrying case (1) (MDR-ZX780DC only)
USB charger (1) (MDR-ZX780DC only)
Reference Guide (1)
Quick Start Guide (1)
Other documents (1 set)
(MDR-ZX770BN: US, Canadian, AEP, UK and Latin American/
ZX770BT: US and Canadian/ZX780DC only)

¹⁾ The actual range will vary depending on factors such as obstacles between devices, magnetic fields around a microwave oven, static electricity, reception sensitivity, antenna's performance, operating system, software application, etc.

²⁾ BLUETOOTH standard profiles indicate the purpose of BLUETOOTH communications between devices.

³⁾ Codec: Audio signal compression and conversion format

⁴⁾ Subband Codec

⁵⁾ Advanced Audio Coding

Wireless noise canceling stereo headset (MDR-ZX770BN/ZX780DC)

Power source:
DC 3.7 V: Built-in lithium-ion rechargeable battery
DC 5 V: When charged using USB

Mass: Approx. 245 g (8.64 oz)

Operating temperature: 0 °C to 40 °C (32 °F to 104 °F)

Rated power consumption: 1.5 W (Except US and Canadian models)

Usage hours:

When connecting via the BLUETOOTH device

Music playback time:

Max. 13 hours (NC ON), Max. 19 hours (NC OFF)

Communication time:

Max. 10 hours (NC ON), Max. 12 hours (NC OFF)

Standby time:

Max. 26 hours (NC ON), Max. 150 hours (NC OFF)

When connecting via the headphone cable

Max. 24 hours (NC ON)

Note: Usage hours may be shorter depending on the Codec and the conditions of use.

Charging time:

Approx. 2.5 hours

Note: Charging hours may be different depending on the conditions of use.

Charging temperature: 5 °C to 35 °C (41 °F to 95 °F)

Receiver

Type: Closed, Dynamic

Driver units: 40 mm

Frequency response: 8 Hz - 22,000 Hz (when using the headphone cable)

Maximum input: 100 mW (when using the headphone cable)

Impedance:
NC ON: 25 Ω (1 kHz) (when using the headphone cable)

NC OFF: 50 Ω (1 kHz) (when using the headphone cable)

Sensitivity:

NC ON: 98 dB/mW (when using the headphone cable)

NC OFF: 100 dB/mW (when using the headphone cable)

Microphone

Type: Electret condenser

Directivity: Omni directional

Effective frequency range: 100 Hz - 10,000 Hz

Wireless stereo headset (MDR-ZX770BT)

Power source:

DC 3.7 V: Built-in lithium-ion rechargeable battery

DC 5 V: When charged using USB

Mass: Approx. 240 g (8.47 oz)

Operating temperature: 0 °C to 40 °C (32 °F to 104 °F)

(US and Canadian models)

5 °C to 35 °C (Except US and Canadian models)

Rated power consumption: 1.5 W (Except US and Canadian models)

Usage hours:

When connecting via the BLUETOOTH device

Music playback time: Max. 17 hours

Communication time: Max. 17 hours

Standby time: Max. 450 hours

Note: Usage hours may be shorter depending on the

Codec and the conditions of use.

Charging time:

Approx. 2.5 hours

Note: Charging hours may be different depending on the conditions of use.

Charging temperature: 5 °C to 35 °C (41 °F to 95 °F)

Receiver

Type: Closed, Dynamic

Driver units: 40 mm

Microphone

Type: Electret condenser

Directivity: Omni directional

Effective frequency range: 100 Hz - 10,000 Hz

System requirements for battery charge using USB

Personal Computer with pre-installed with any of the following operating systems and USB port:

Operating Systems

(when using Windows)

Windows © 8.1 / Windows © 8.1 Pro

Windows © 8 / Windows © 8 Pro

Windows © 7

Home Basic / Home Premium / Professional / Ultimate

Windows Vista © (Service Pack 2 or later)

Home Basic / Home Premium / Business / Ultimate

(when using Mac)

Mac OS X (version 10.3 or later)

Design and specifications are subject to change without notice.

CAUTION

Danger of explosion if battery is incorrectly replaced.
Replace only with the same or equivalent type.

警告

本電池如果更換不正確會有爆炸的危險
請依製造商說明書處理用過之電池

MDR-ZX770BN/ZX780DC

WIRELESS NOISE CANCELING STEREO HEADSET

MDR-ZX770BT

WIRELESS STEREO HEADSET

9-896-156-02

2016H33-1

© 2016.08

Sony Video & Sound Products Inc.

SONY®

MDR-ZX770BN/ZX770BT

The BLUETOOTH word mark and logos are owned by the Bluetooth SIG, Inc. and any use of such marks by Sony Corporation is under license.

The N Mark is a trademark or registered trademark of NFC Forum, Inc. in the United States and in other countries.

Microsoft, Windows and Windows Vista are registered trademarks or trademarks of Microsoft Corporation in the United States and/or other countries.

Mac and Mac OS are trademarks of Apple Inc., registered in the U.S. and other countries.

iPhone is a trademark of Apple Inc., registered in the U.S. and other countries.

The aptX® mark and the aptX logo are trade marks of CSR plc or one of its group companies and may be registered in one or more jurisdictions.

Other trademarks and trade names are those of their respective owners.

MDR-ZX780DC

The BLUETOOTH word mark and logos are owned by the Bluetooth SIG, Inc. and any use of such marks by Sony Corporation is under license.

The N Mark is a trademark or registered trademark of NFC Forum, Inc. in the United States and in other countries.

Microsoft, Windows and Windows Vista are registered trademarks or trademarks of Microsoft Corporation in the United States and/or other countries.

Mac and Mac OS are trademarks of Apple Inc., registered in the U.S. and other countries.

iPhone is a trademark of Apple Inc., registered in the U.S. and other countries.

Qualcomm® is a trademark of Qualcomm Incorporated, registered in the United States and other countries, used with permission. Qualcomm aptX™ audio is a trademark of Qualcomm Technologies International, Ltd., registered in the United States and other countries, used with permission.

Android and Google Play are trademarks of Google Inc.

Other trademarks and trade names are those of their respective owners.

TABLE OF CONTENTS

1. SERVICING NOTES	3
2. DISASSEMBLY	
2-1. Disassembly Flow	4
2-2. Ear Pad	5
2-3. Cap Housing (L) Sub Assy (L-ch)	6
2-4. Front Plate (L) Sub Assy (DR1) (L-ch)	7
2-5. Ring (L), Electret Cap Microphone (MIC1) (L-ch)	8
2-6. NFC Module (RC-S711), MAIN Board (L-ch)	9
2-7. Housing (L) (L-ch)	10
2-8. Cap Housing (R) Sub Assy (R-ch)	11
2-9. Front Plate (R) Sub Assy (DR2) (R-ch)	12
2-10. Ring (R) (ZX770BN/ZX770BT/ZX780DC), Electret Cap Microphone (MIC2) (R-ch) (ZX770BN/ZX780DC)	12
2-11. SUB Board (R-ch)	13
2-12. Battery (R-ch)	14
2-13. Housing (R) (R-ch)	14
3. TEST MODE	15
4. EXPLODED VIEWS	
4-1. Ear Pad Section	17
4-2. Housing (L) Section	18
4-3. Housing (R), Head Band Section	19
5. ACCESSORIES	20

SAFETY-RELATED COMPONENT WARNING!

COMPONENTS IDENTIFIED BY MARK \triangle OR DOTTED LINE WITH MARK \triangle ON THE SCHEMATIC DIAGRAMS AND IN THE PARTS LIST ARE CRITICAL TO SAFE OPERATION. REPLACE THESE COMPONENTS WITH SONY PARTS WHOSE PART NUMBERS APPEAR AS SHOWN IN THIS MANUAL OR IN SUPPLEMENTS PUBLISHED BY SONY.

ATTENTION AU COMPOSANT AYANT RAPPORT À LA SÉCURITÉ!

LES COMPOSANTS IDENTIFIÉS PAR UNE MARQUE \triangle SUR LES DIAGRAMMES SCHÉMATIQUES ET LA LISTE DES PIÈCES SONT CRITIQUES POUR LA SÉCURITÉ DE FONCTIONNEMENT. NE REMPLACER CES COMPOSANTS QUE PAR DES PIÈCES SONY DONT LES NUMÉROS SONT DONNÉS DANS CE MANUEL OU DANS LES SUPPLÉMENTS PUBLIÉS PAR SONY.

SECTION 1 SERVICING NOTES

The **SERVICING NOTES** contains important information for servicing. Be sure to read this section before repairing the unit.

DESTINATION ABBREVIATIONS

The following abbreviations for model destinations are used in this service manual.

- Abbreviations
 - AUS : Australian model
 - CND : Canadian models
 - JE : Tourist model
 - LA : Latin American model
 - RU : Russian model

CHECKING THE SERIAL NUMBER

The serial number of this unit can be checked on the rear side of the housing the on the right unit.

Refer to the following figure.

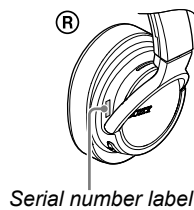

NOTE FOR PARTS REPAIR OF BOARDS

When the boards installed in this unit are defective, replace the complete mounted board or the whole parts including the complete mounted board. The mounted parts cannot replace with single.

NOTE FOR REPLACING THE MAIN BOARD OR NFC MODULE (RC-S711)

When replacing the MAIN board or NFC module (RC-S711), be sure replace both simultaneously. It cannot replace either of one of the MAIN board or NFC module (RC-S711). Among the repair parts, the MAIN board and NFC module (RC-S711) are supplied as one unit.

PROCESSING AFTER COMPLETION OF REPAIRS

After completion of repairs, be sure to perform the following procedure to initialize the unit.

Note 1: When this procedure is performed, all device pairing information is erased and settings return to factory defaults. When initializing the unit, it may be impossible to connect to the iPhone and PC.

Procedure:

1. Press and hold the [POWER] button for 2 seconds or longer to turn off the unit.

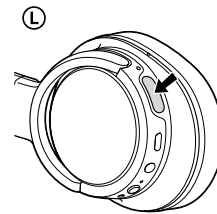

2. When pressing and holding the [POWER] button on the left unit and the [▶||/⤵] button on the right unit simultaneously for 7 seconds or longer, the lamp (blue color) flashes 4 times and the settings return to factory defaults (initialization).

Note 2: All pairing information is deleted.

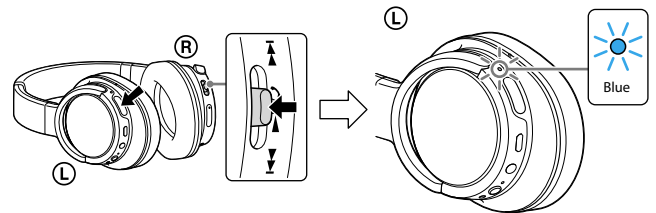

SECTION 2 DISASSEMBLY

- This set can be disassembled in the order shown below.

2-1. DISASSEMBLY FLOW

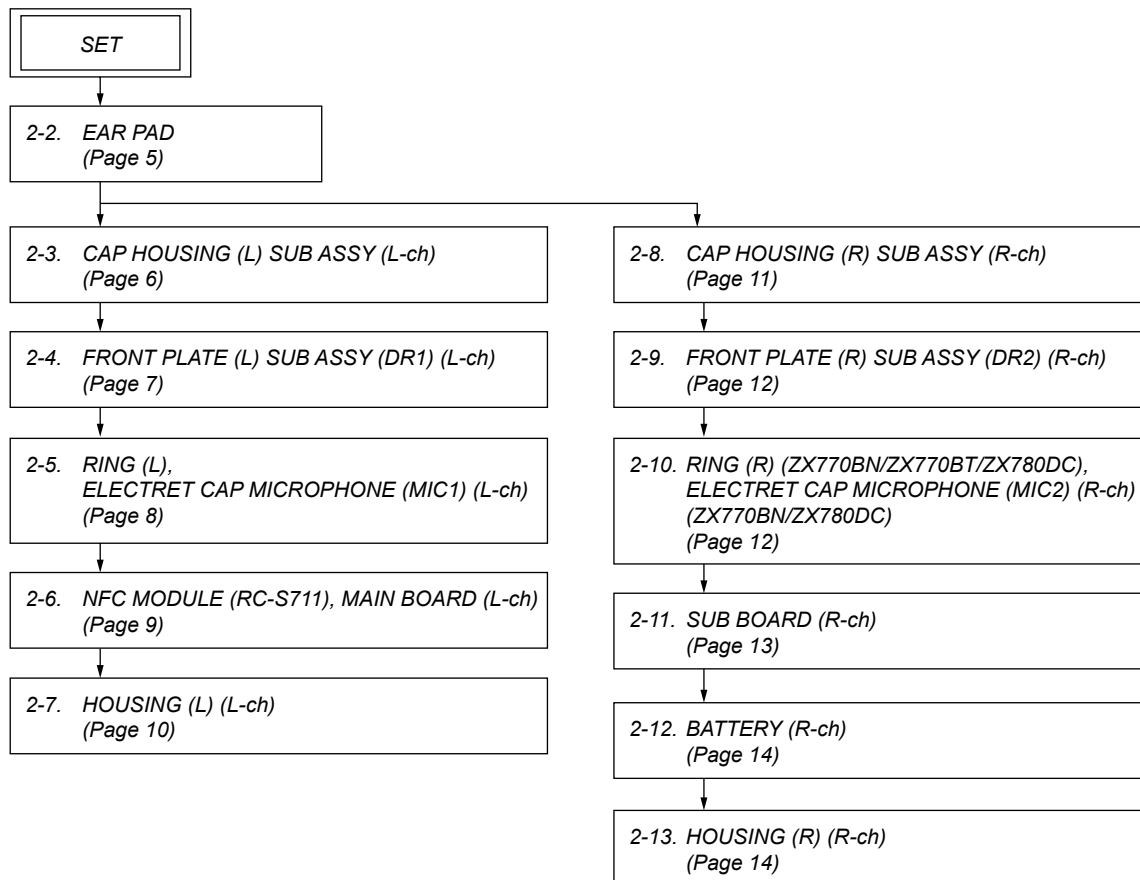

Note: Follow the disassembly procedure in the numerical order given.

2-2. EAR PAD

Note 1: L-ch and R-ch can be similarly disassembled.

① Pull the ear pad in the direction of the arrow.

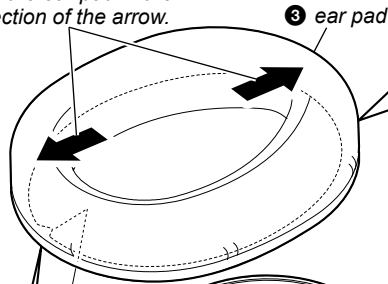

③ ear pad

• **About the difference in the ear pad by the model**

(ZX770BN)



Inside color is [black].

(ZX770BT)



Inside color is [blue].

(ZX780DC)



Inside color is [red].

front plate

② Remove the ear pad from the groove between of front plate and housing.

housing

– R-ch –

• **How to install the ear pad**

① Install the ear pad into the groove between of front plate and housing, then adjust the ear pad to match the shape of the groove of the housing.

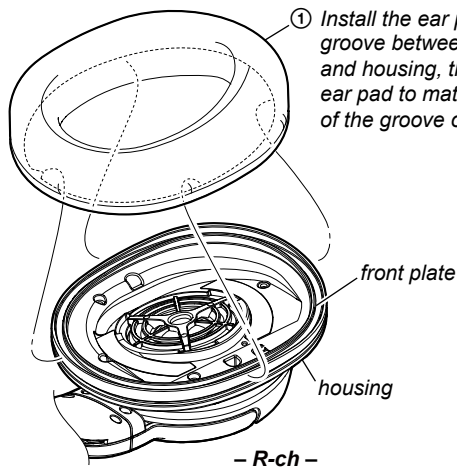

front plate

housing

– R-ch –

Note 2: Check the position of mark on top and do not confuse the top and bottom.



front plate

ear pad

Note 3: When installing the earpad, confirm side of the earpad to ensure it is definitely insert into the groove between plate front and housing.

OK

Insert is flat.



NG

Insert is not fully.



NG

Insert is bumps up.



② Massage surface of the ear pad three times in the direction of the arrow.

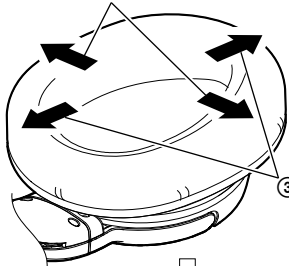

③ Massage surface of the ear pad three times in the direction of the arrow.

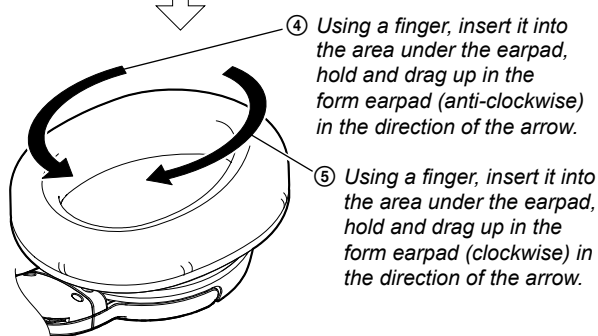

④ Using a finger, insert it into the area under the earpad, hold and drag up in the form earpad (anti-clockwise) in the direction of the arrow.

⑤ Using a finger, insert it into the area under the earpad, hold and drag up in the form earpad (clockwise) in the direction of the arrow.

Note 4: When installing the earpad, adjust the shape of earpad.

OK

nice egg shape



NG

askew



Note 5: When installing the earpad, adjust the shape of earpad and confirm the direction of earpad is facing up.

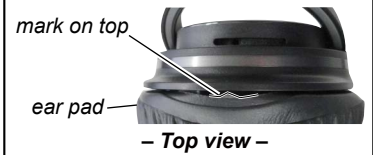

– Top view –

Note 6: When installing the earpad, both earpad need to adjust until make sure small curve area must be at the bottom side.

OK

small curve

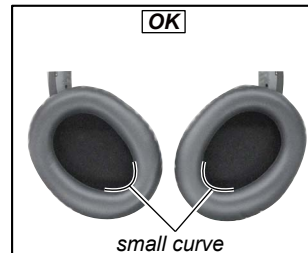

NG

small curve

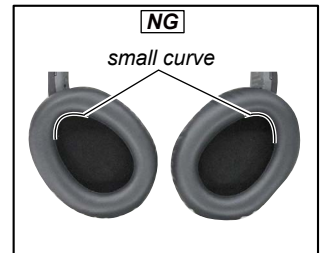

2-3. CAP HOUSING (L) SUB ASSY (L-ch)

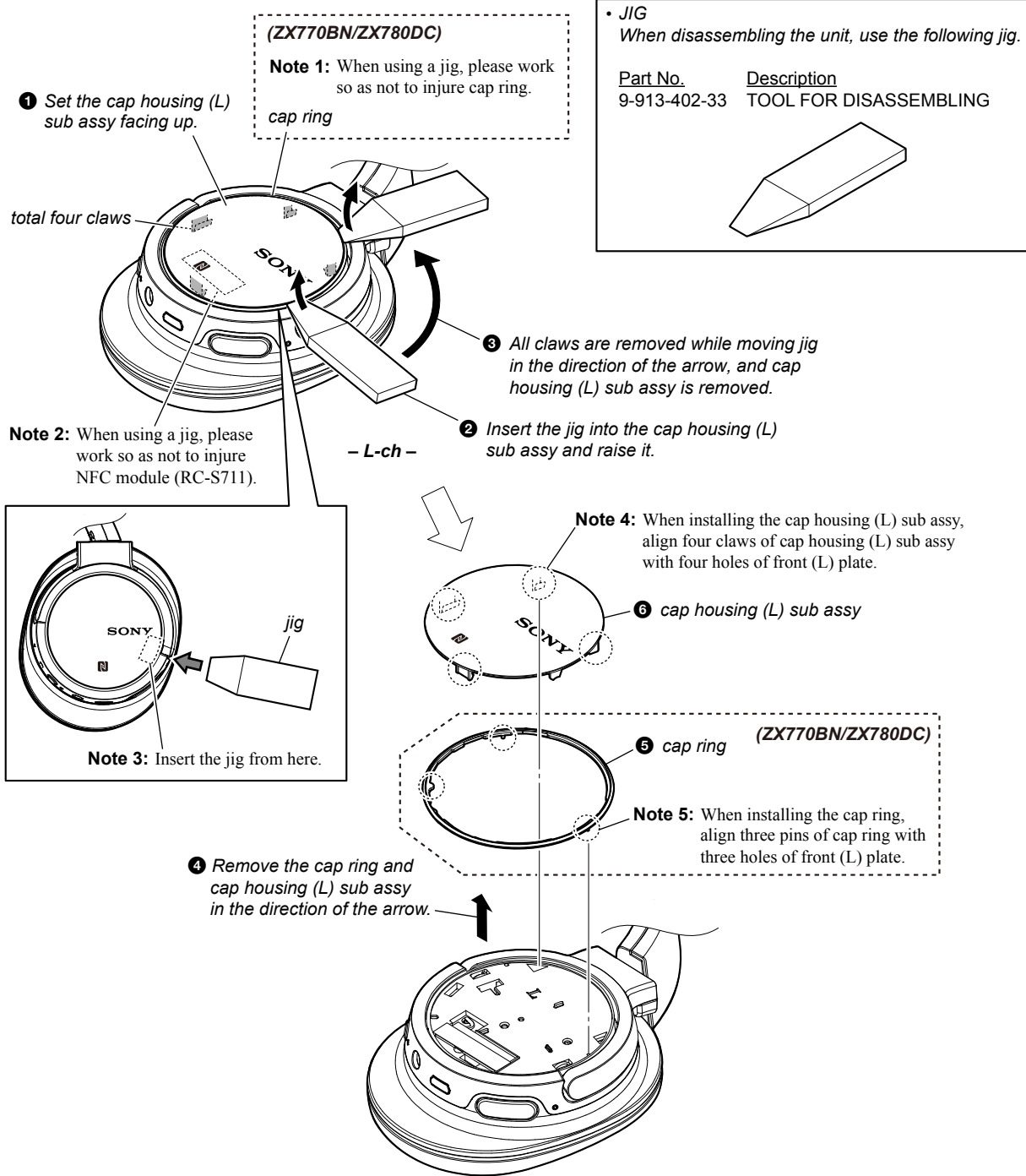

2-4. FRONT PLATE (L) SUB ASSY (DR1) (L-ch)

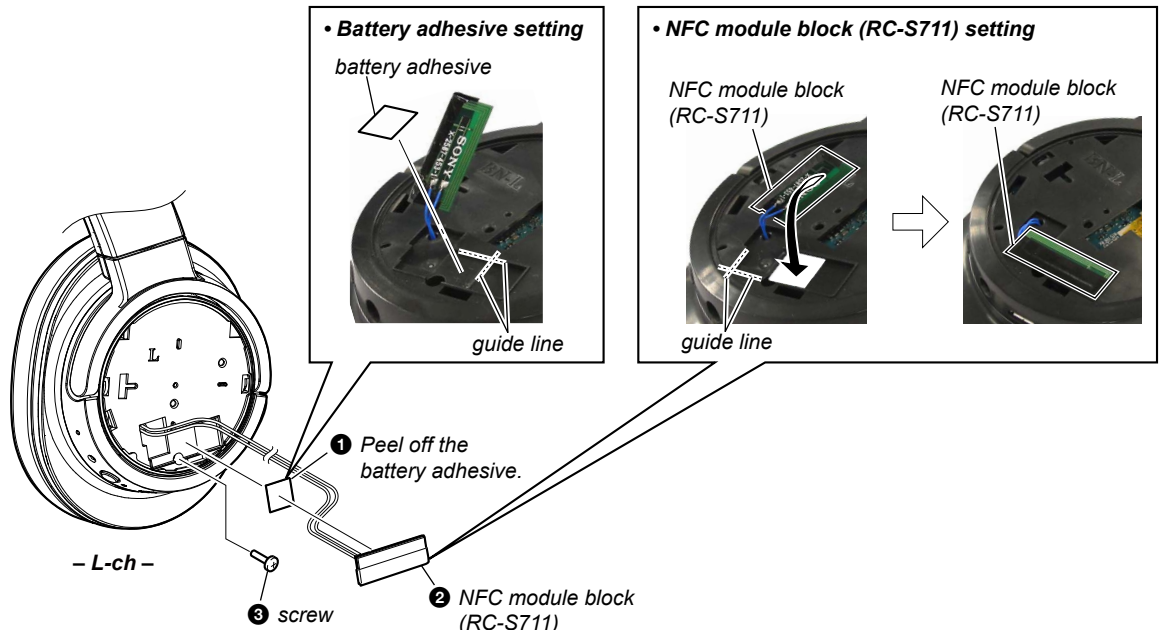

Note: When installing the front plate (L) sub assy, align three holes of front plate (L) sub assy with three screw holes of housing (L) block.

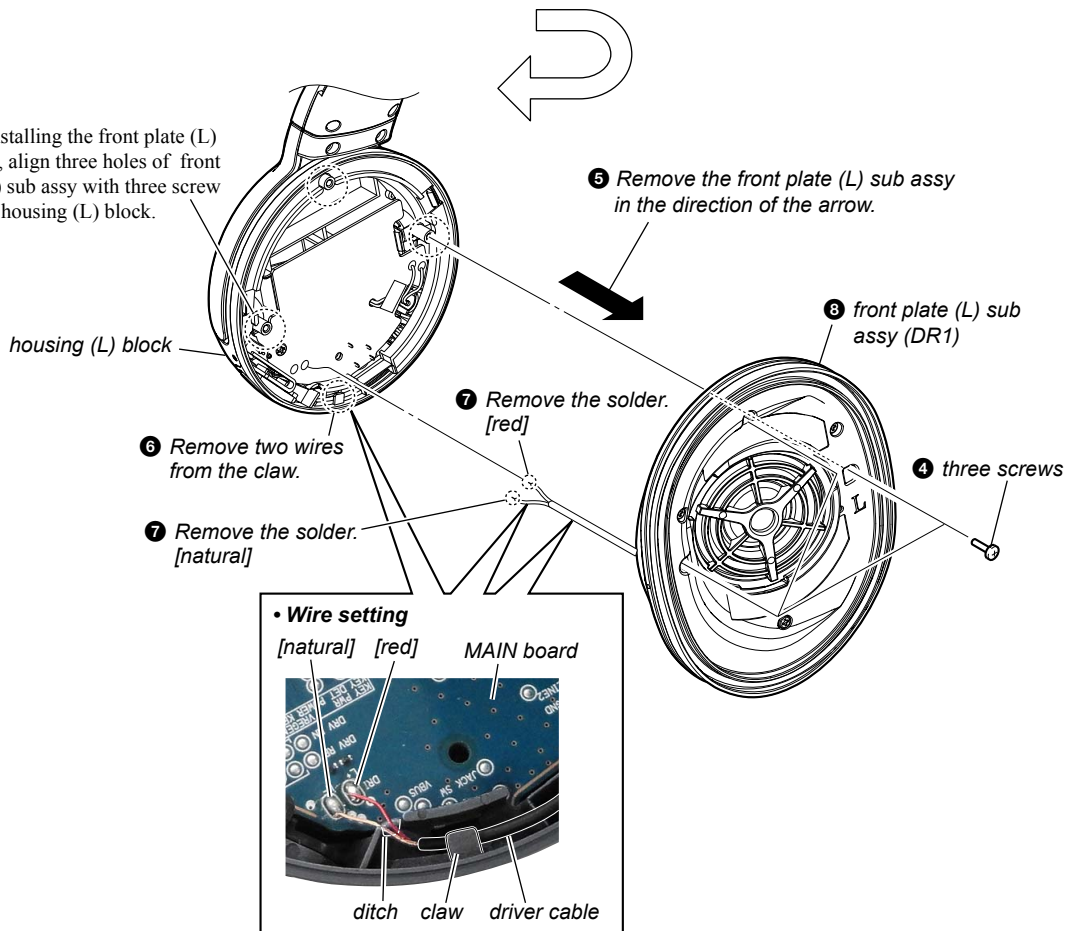

2-5. RING (L), ELECTRET CAP MICROPHONE (MIC1) (L-ch)

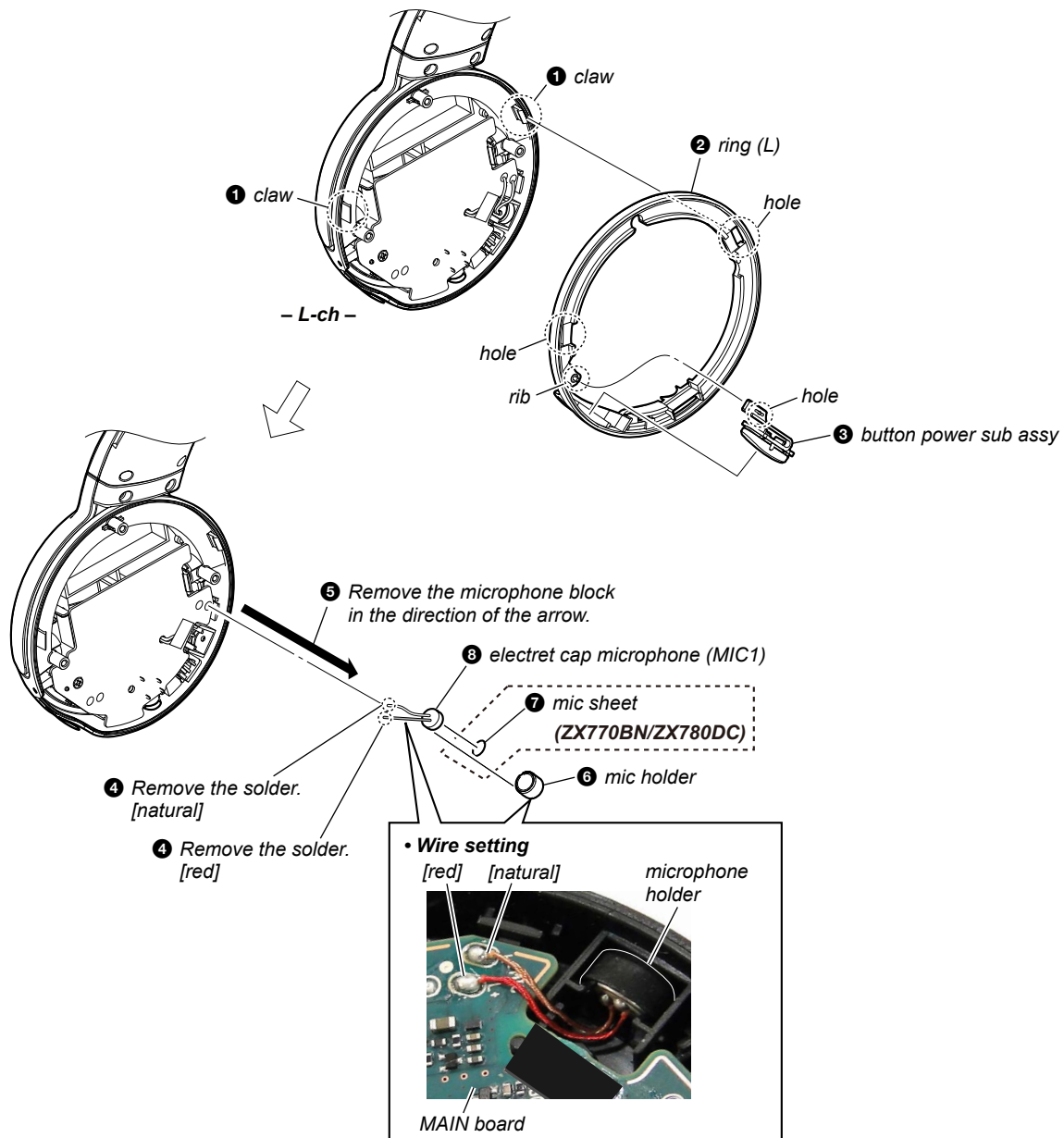

2-6. NFC MODULE (RC-S711), MAIN BOARD (L-ch)

Note: When replacing the MAIN board or NFC module (RC-S711), be sure replace both simultaneously. It cannot replace either of one of the MAIN board or NFC module (RC-S711). Among the repair parts, the MAIN board and NFC module (RC-S711) are supplied as one unit.

• **Note of replacing the NFC module or the MAIN board**

Repair parts are supplied together with parts that include the NFC module and the MAIN board that connected by the wire. When replacing the NFC module or the MAIN board, remove the wire from the MAIN board.

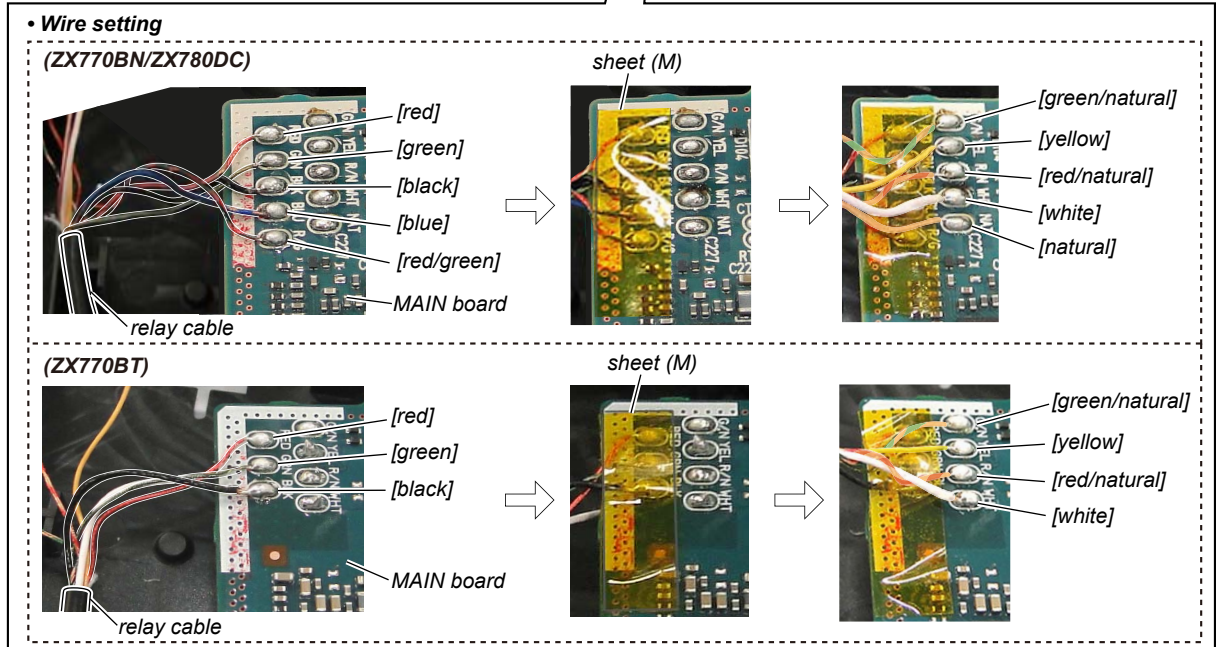
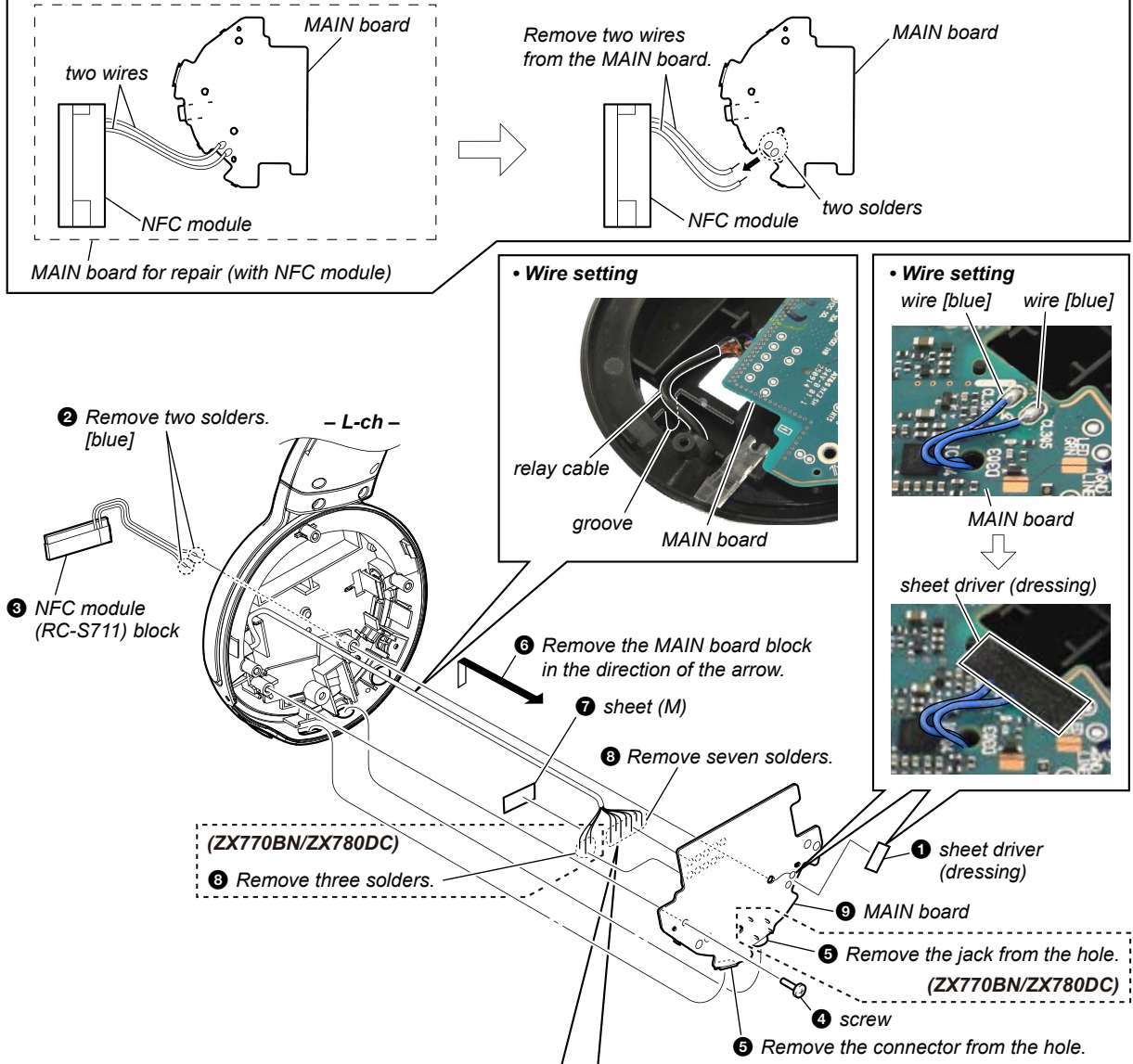

2-7. HOUSING (L) (L-ch)

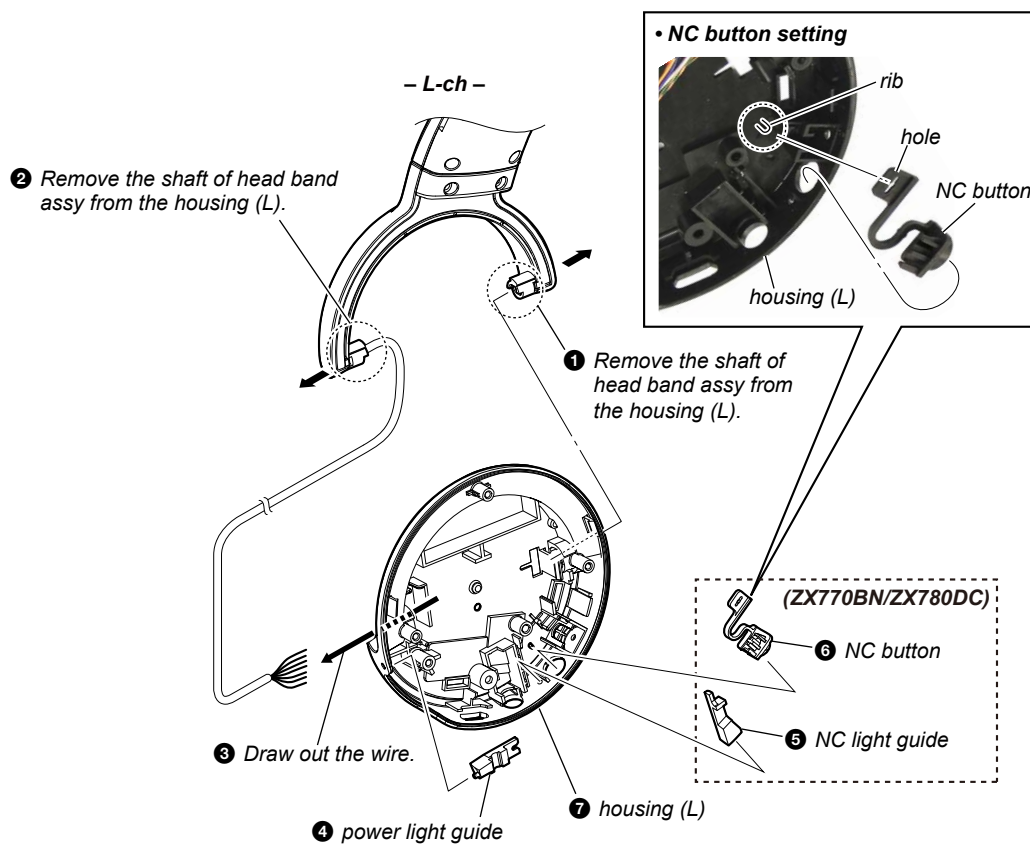

2-8. CAP HOUSING (R) SUB ASSY (R-ch)

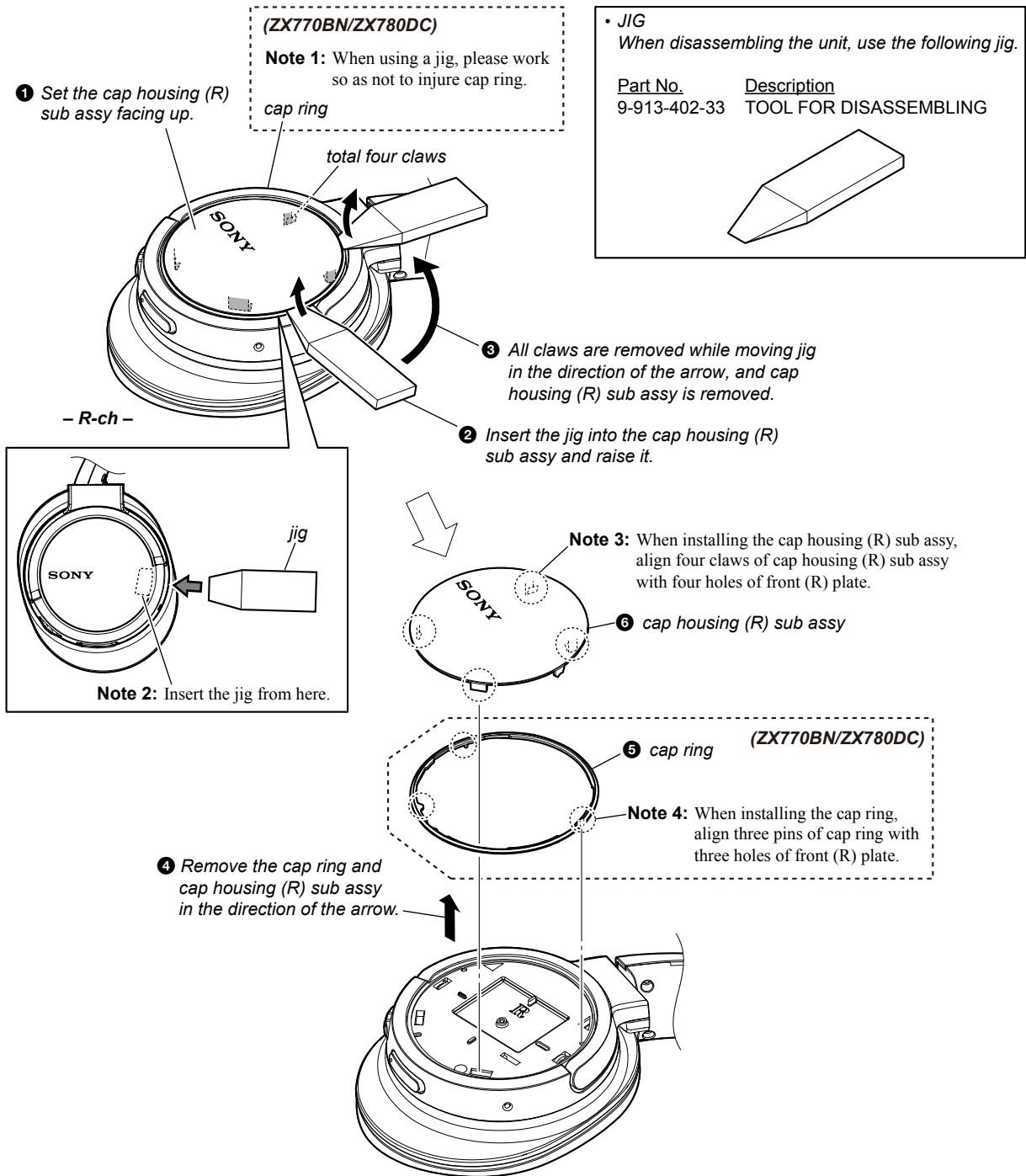

2-9. FRONT PLATE (R) SUB ASSY (DR2) (R-ch)

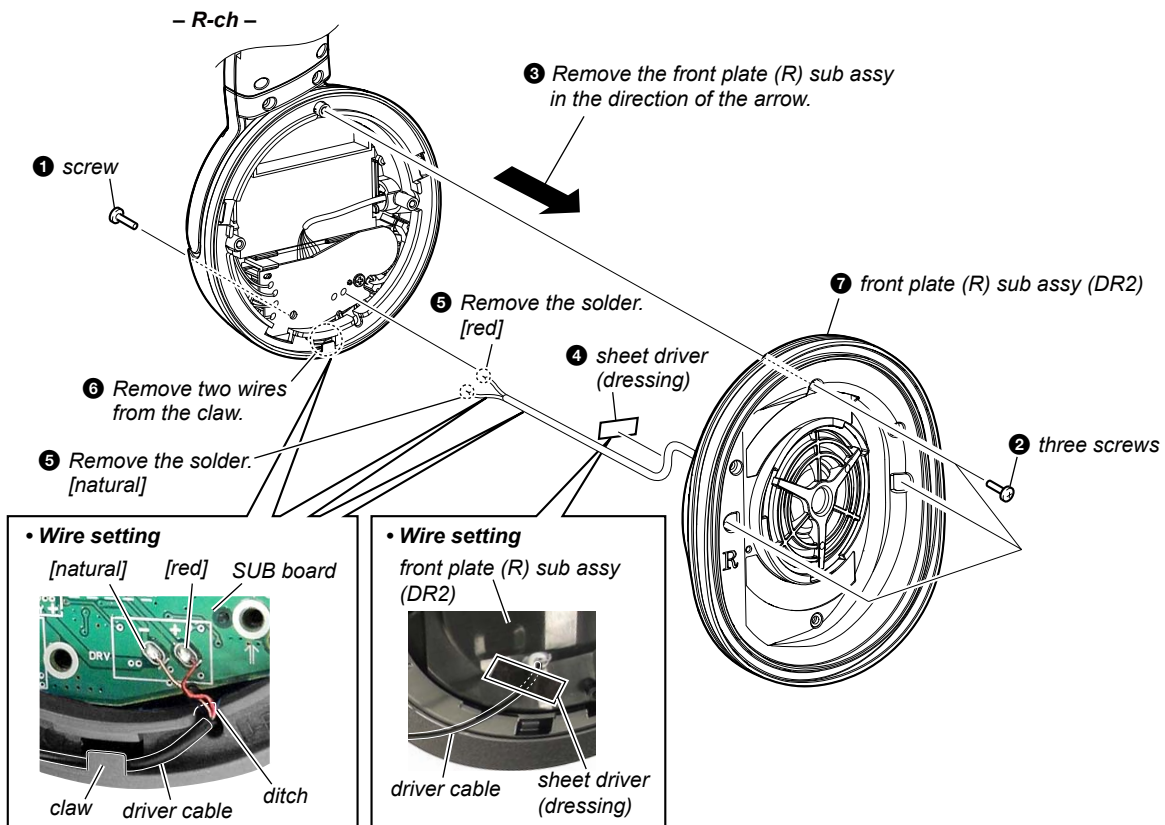

2-10. RING (R) (ZX770BN/ZX770BT/ZX780DC),
ELECTRET CAP MICROPHONE (MIC2) (R-ch) (ZX770BN/ZX780DC)

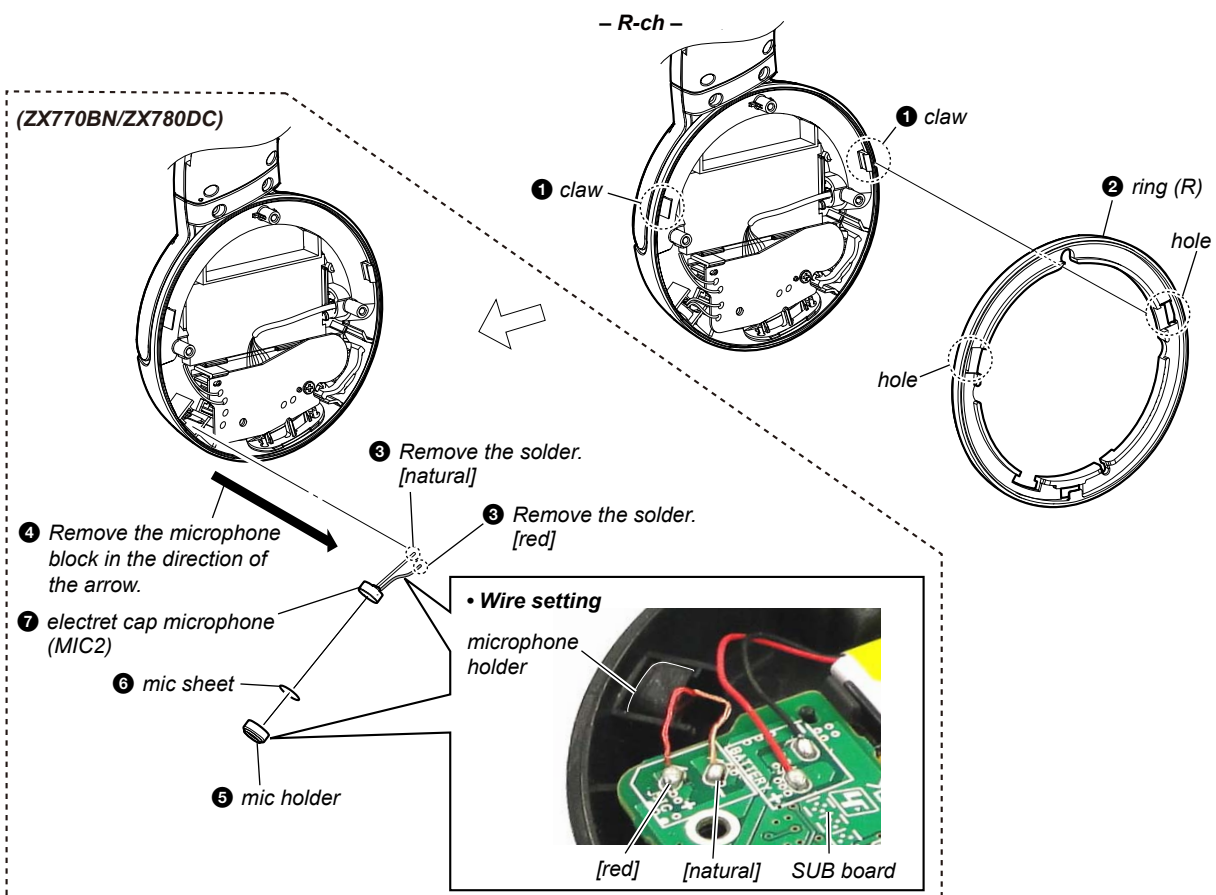

2-11. SUB BOARD (R-ch)

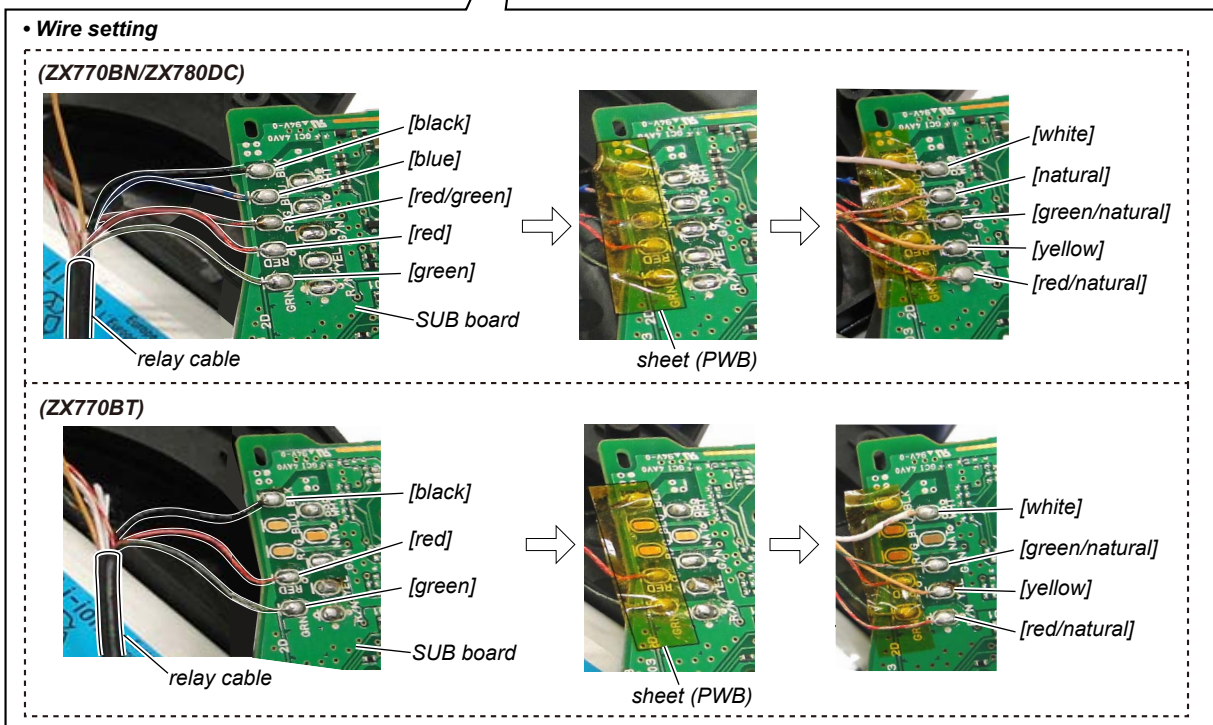
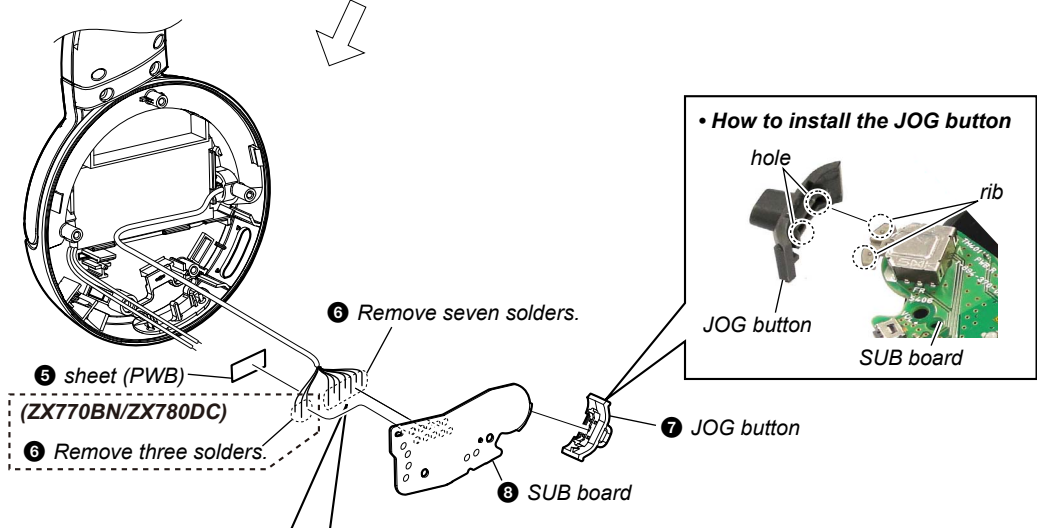
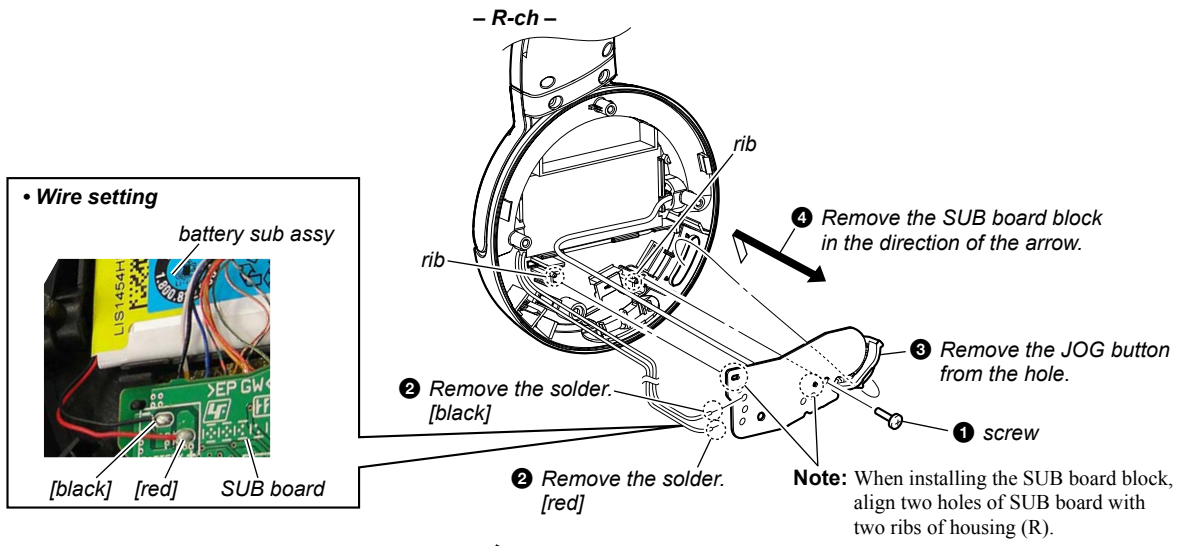

2-12. BATTERY (R-ch)

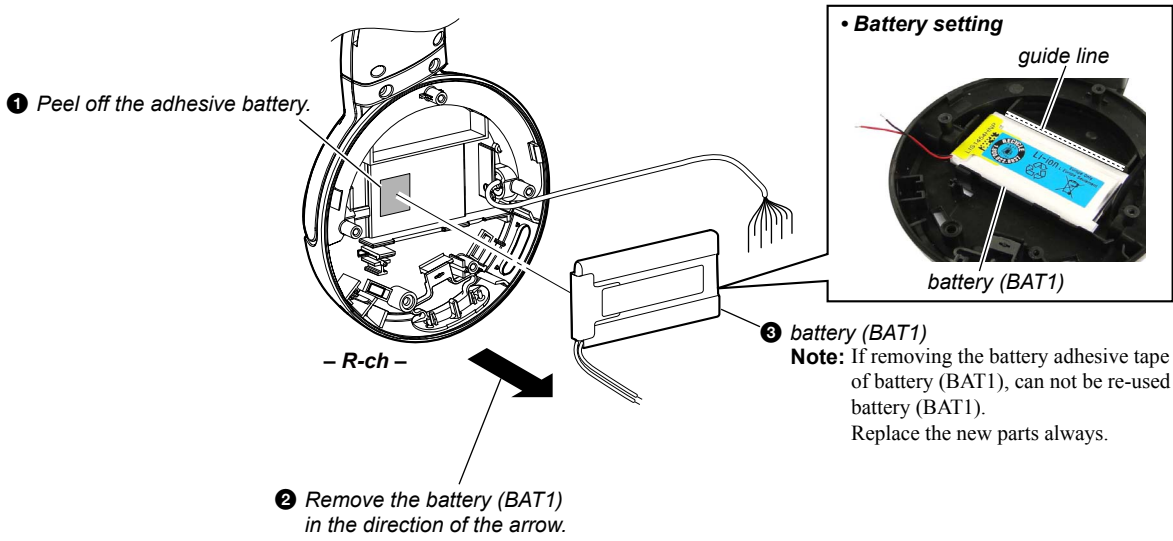

2-13. HOUSING (R) (R-ch)

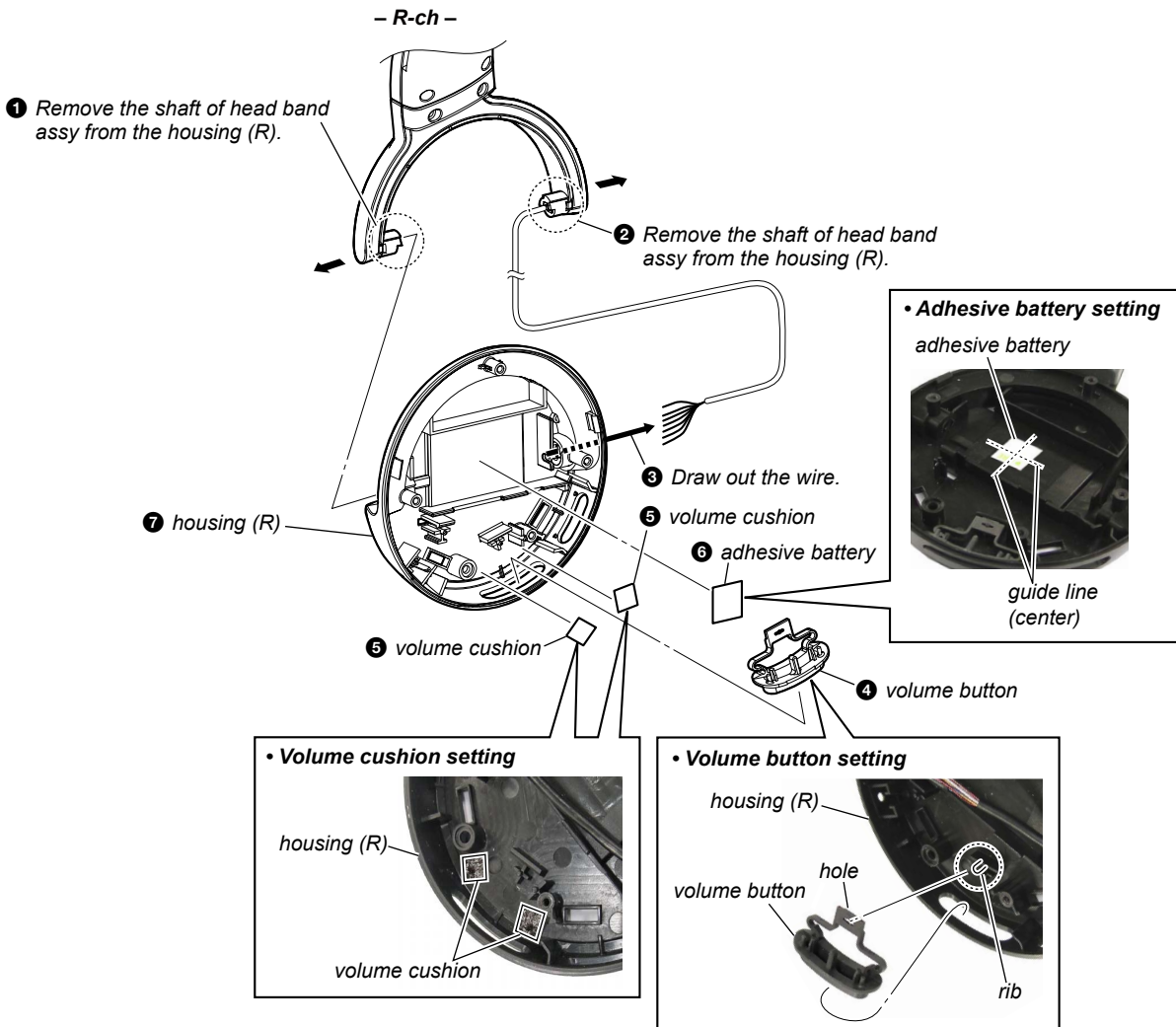

SECTION 3 TEST MODE

NOISE CANCEL VOLUME ADJUSTMENT (MDR-ZX770BN/ZX780DC only)

When the complete mounted board or driver section of this unit is replaced, be sure to perform the noise cancel volume adjustment.

1. Preparation of adjustment

Prepare the following before adjustment.

- AF oscillator
- Amplifier
- Speaker
- Headphone cable (Supplied accessories)

Connection:

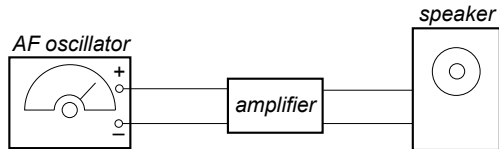

2. Setting the noise cancel volume adjustment mode

Procedure:

1. Headphone cable is connected to the [INPUT] jack in the state of the power off.

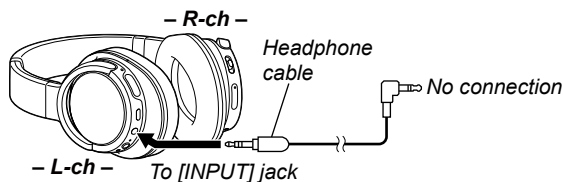

2. While pressing the [NC] button, press and hold (2 seconds) the [POWER] button.

Press the button as following order.

[VOL+] → [VOL+] (hold for 2 seconds) → [VOL-] → [VOL-] (hold for 2 seconds) → [POWER] → [POWER] (hold for 2 seconds)

Note: When operation is not completed within 1 minute or procedure is mistaken, it does not enter the adjustment mode. Please turn the power off and redo from step 1.

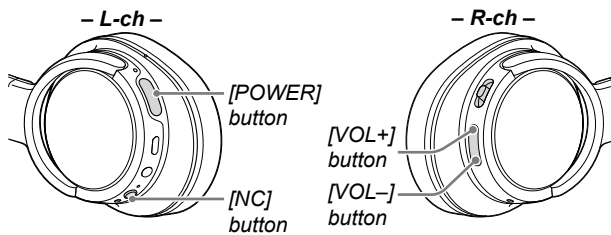

3. Enter the noise cancel volume adjustment mode (L-ch), and the LED of [NC] button blinks (cycle of the 500 ms).

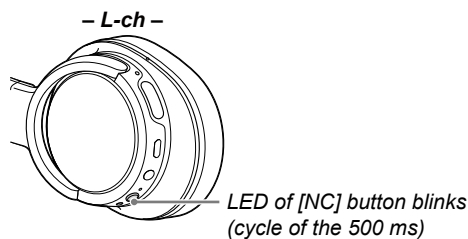

3. Deactivating the noise cancel volume adjustment mode

When the adjustment value is set and saved:

Press and hold (2 seconds) the [NC] button, and deciding the adjustment value, adjustment mode is released and it changes to the normal mode.

When canceling without saving the adjustment value:

Press and hold (2 seconds) the [POWER] button to turn the power off, or the headphone cable is pulled out to turn the power off.

4. Noise cancel volume adjustment operation

Procedure:

1. Enter the noise cancel volume adjustment mode, and the noise cancel volume of a L-ch and R-ch will become a center value. (Refer to “2. Setting the noise cancel volume adjustment mode”)
2. Check that the LED of [NC] button blinks cycle of the 500 ms and has become L-ch adjustment. (R-ch adjustment blinking cycle of the 160 ms) Slide the [▶||/◀] button in the direction of [▶▶](FF), it will change to R-ch adjustment, and if it slide the direction of [◀◀](REW), it will change to L-ch adjustment.

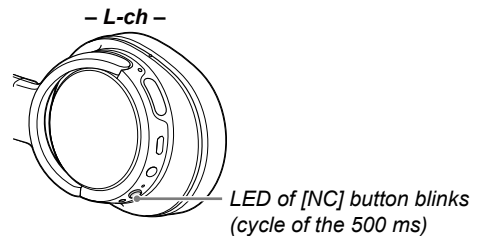
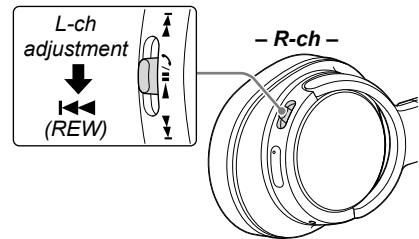

3. Generate a sine wave of frequency (160 Hz) from a AF oscillator, and output it from the forward speaker.
4. Set this unit over your ears.
5. Press the [VOL+]/[VOL-] buttons and adjust it so the volume for frequency 160 Hz is as quiet as possible. Press the [VOL+] button, noise cancel volume increases 0.8 db. Press the [VOL-] button, noise cancel volume decreases 0.8 db. When noise cancel volume becomes the center value, the beep sound of “Duhlala” sounds. When noise cancel volume becomes the maximum or the minimum, the beep sound of “Dun Dun” sounds.

– Continued on next page –

- Remove the unit and slide the [▶||/↶] button in the direction of [▶▶▶](FF).
Check that the LED of [NC] button blinks cycle of the 160 ms and has become R-ch adjustment.

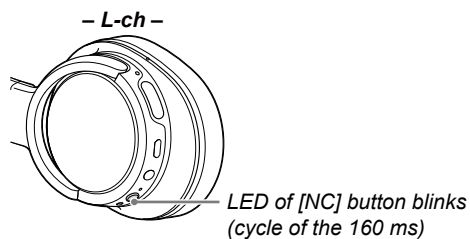
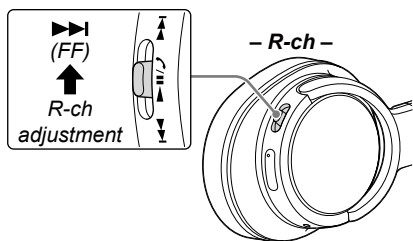

- Set this unit over your ears.
- Refer to step 5 for R-ch adjustment, R-ch adjustment is the same as L-ch adjustment.
- After adjustment of both L-ch and R-ch is completed, press and hold (2 seconds) the [NC] button and the adjustment value is set.
If it set and saved, the beep sound of “Ding dong” sounds.
- Press and hold (2 seconds) the [POWER] button to turn the power off.
- Press and hold (2 seconds) the [POWER] button to turn the power on. Check that sound of frequency 160 Hz outputted from the forward speaker is canceled as according to setting.

MDR-ZX770BN/ZX770BT/ZX780DC

Ver. 1.1

4-2. HOUSING (L) SECTION

• Rear view

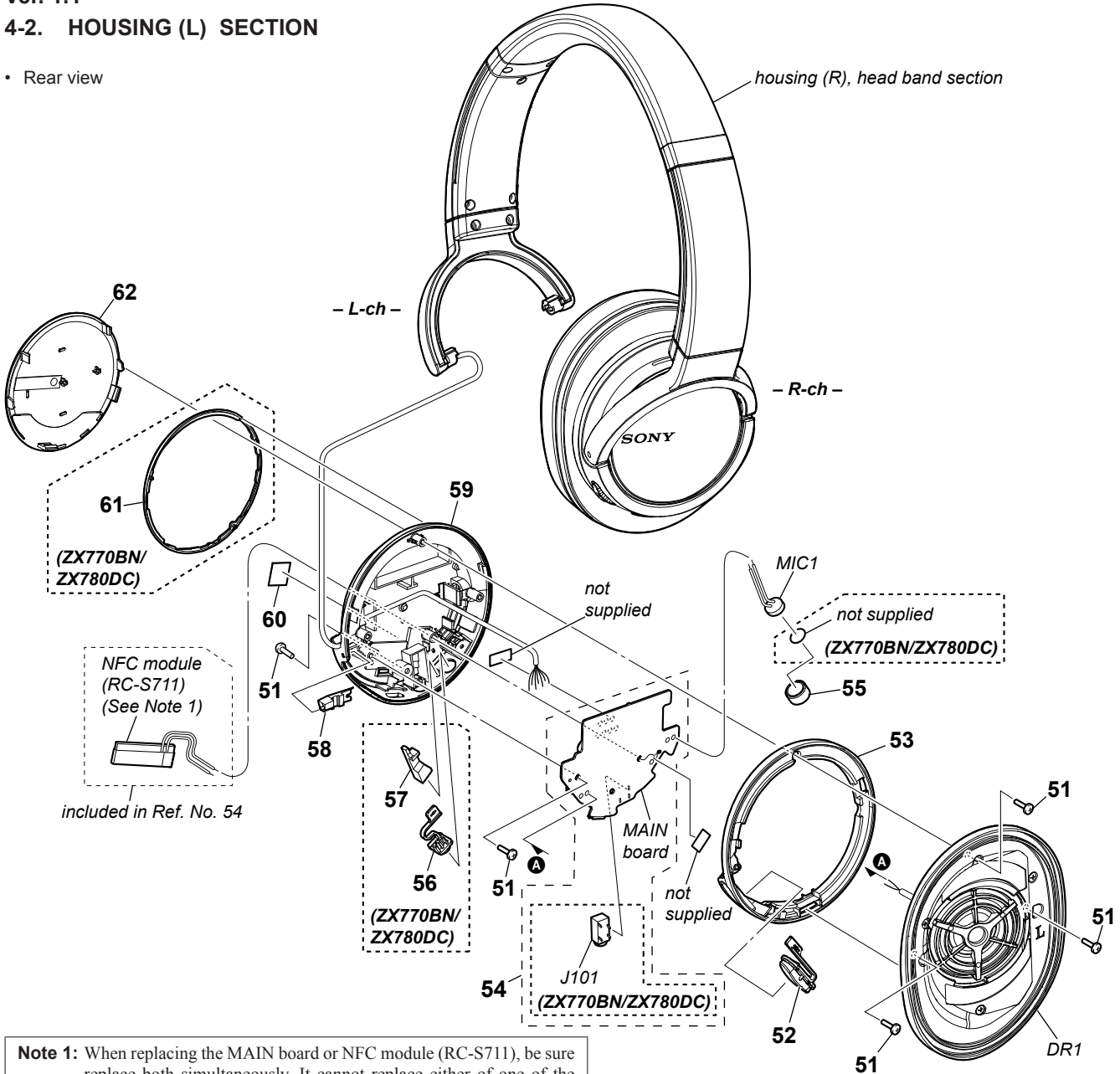

Note 1: When replacing the MAIN board or NFC module (RC-S711), be sure replace both simultaneously. It cannot replace either of one of the MAIN board or NFC module (RC-S711). Among the repair parts, the MAIN board and NFC module (RC-S711) are supplied as one unit.

Note 2: When replacing the front plate (L) sub assy (Ref. No. DR1), refer to the "TEST MODE" (page 15).

Ref. No.	Part No.	Description	Remark
51	3-254-058-21	SCREW	
52	A-2143-127-A	BUTTON POWER SUB ASSY, SVX (for BLACK)	
52	X-2591-397-1	BUTTON POWER SUB ASSY (SV) (for BLACK)	(ZX780DC)
52	X-2591-398-1	BUTTON POWER SUB ASSY (SV) (for BLUE)	(ZX770BN/ZX770BT)
52	X-2591-398-1	BUTTON POWER SUB ASSY (SV) (for BLUE)	(ZX770BN: Except LA/ZX770BT)
53	4-564-489-02	RING (L) (for L-ch) (for BLACK)	(ZX770BN/ZX770BT)
53	4-564-489-12	RING (L) (for L-ch) (for BLUE)	(ZX770BN: Except LA/ZX770BT)
53	4-564-489-21	RING (L) (for L-ch) (for BLACK)	(ZX780DC)
54	A-2074-945-A	MAIN BOARD, COMPLETE (SV)	(Including NFC module (RC-S711), WIRE, SEAL SHEET, JACK) (ZX770BN) (See Note 1)
54	A-2074-946-A	MAIN BOARD, COMPLETE (SV)	(Including NFC module (RC-S711), WIRE) (ZX770BT) (See Note 1)
54	A-2143-199-A	MAIN BOARD, COMPLETE (SV)	(Including NFC module (RC-S711), WIRE, SEAL SHEET, JACK) (ZX780DC) (See Note 1)
55	4-545-633-01	HOLDER, MIC	
56	4-559-812-02	BUTTON, NC (NC) (ZX770BN)	
56	4-559-812-11	BUTTON, NC (NC) (ZX780DC)	
57	4-559-813-01	LIGHT GUIDE, NC (ZX770BN/ZX780DC)	

Ref. No.	Part No.	Description	Remark
58	4-559-814-01	LIGHT GUIDE, POWER	
59	4-559-810-03	HOUSING (L) (for L-ch) (ZX770BN)	
59	4-559-810-12	HOUSING (L) (for L-ch) (ZX780DC)	
59	4-559-811-02	HOUSING (L) (for L-ch) (ZX770BT)	
60	4-478-790-01	ADHESIVE, BATTERY	
61	4-564-490-02	RING, CAP (ZX770BN)	
61	4-564-490-11	RING, CAP (ZX780DC)	
62	X-2591-395-2	CAP HOUSING (L) SUB ASSY (SV) (for L-ch)	(ZX770BN/ZX780DC)
62	X-2591-396-2	CAP HOUSING (L) SUB ASSY (SV) (for L-ch)	(ZX770BT)
DR1	A-2074-944-A	PLATE, FRONT (L) SUB ASSY (SV) (for L-ch)	(Including DRIVER, DRIVER WIRE) (ZX770BN/ZX770BT) (See Note 2)
DR1	A-2129-962-A	PLATE, FRONT (L) SUB ASSY, SVX (for L-ch)	(Including DRIVER, DRIVER WIRE) (ZX780DC) (See Note 2)
J101	1-779-881-11	JACK (INPUT) (Included in MAIN board)	(ZX770BN/ZX780DC)
MIC1	1-542-974-31	MICROPHONE, ELECTRET CAP (Including WIRE)	(ZX770BN/ZX780DC)
MIC1	1-852-043-11	MICROPHONE, ELECTRET CAP (Including WIRE)	(ZX770BT)

4-3. HOUSING (R), HEAD BAND SECTION

• Front view

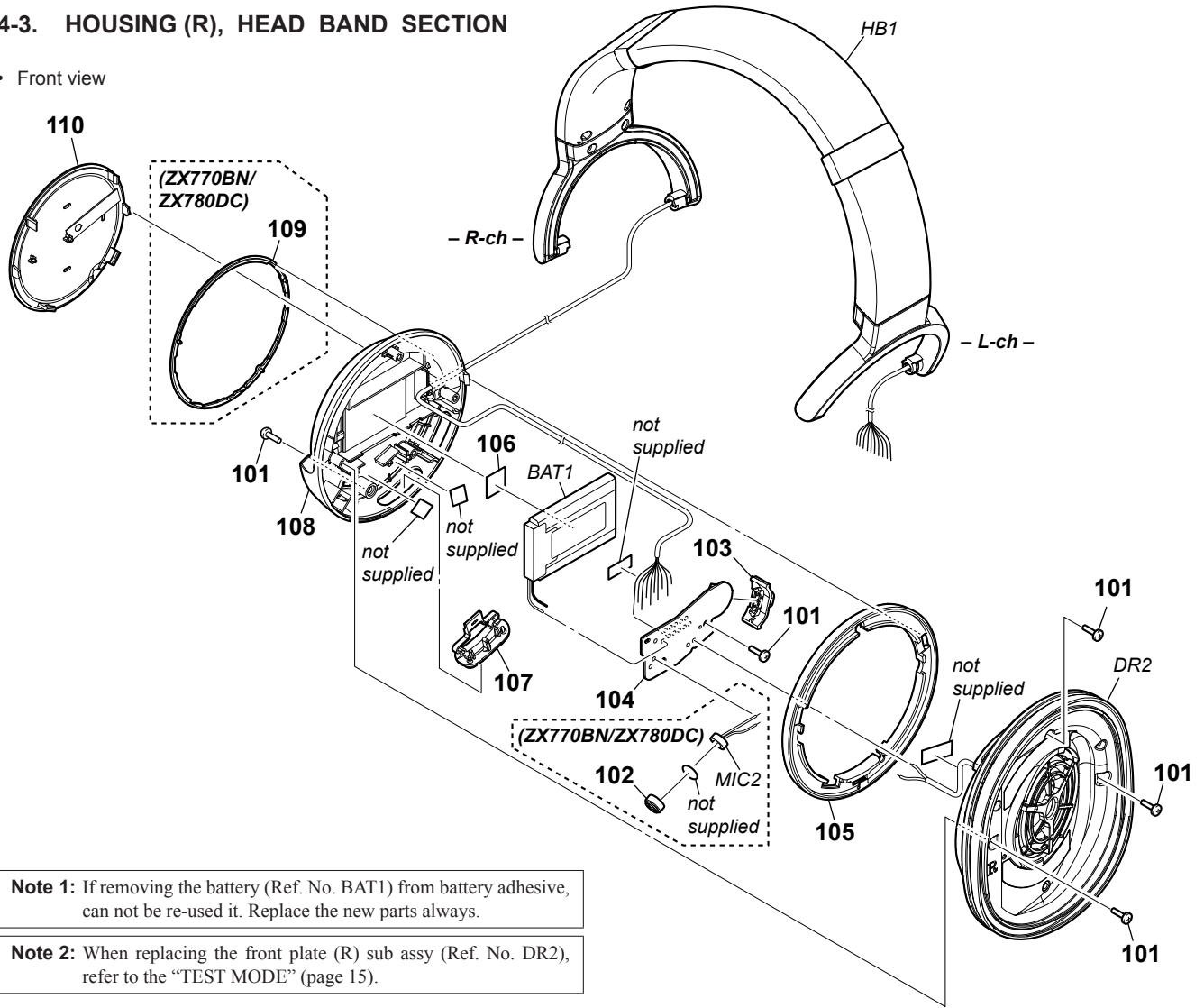

Note 1: If removing the battery (Ref. No. BAT1) from battery adhesive, can not be re-used it. Replace the new parts always.

Note 2: When replacing the front plate (R) sub assy (Ref. No. DR2), refer to the "TEST MODE" (page 15).



Ref. No.	Part No.	Description	Remark	Ref. No.	Part No.	Description	Remark
101	3-254-058-21	SCREW		DR2	A-2129-963-A	PLATE, FRONT (R) SUB ASSY, SVX (for R-ch) (Including DRIVER, DRIVER WIRE) (ZX780DC) (See Note 2)	
102	4-545-633-01	HOLDER, MIC (ZX770BN/ZX780DC)		HB1	A-2074-932-A	HEADBAND ASSY (SV) (Including RELAY CABLE) (for BLACK) (ZX770BN: E, AUS, JE, RU)	
103	4-559-824-01	BUTTON, JOG (◀◀, ⏪, ▶▶, ▶▶)	(ZX770BN/ZX770BT)	HB1	A-2074-933-A	HEADBAND ASSY (SV) (Including RELAY CABLE) (for BLACK) (ZX770BN: US, CND)	
103	4-559-824-11	BUTTON, JOG (◀◀, ⏪, ▶▶, ▶▶)	(ZX780DC)	HB1	A-2074-934-A	HEADBAND ASSY (SV) (Including RELAY CABLE) (for BLACK) (ZX770BN: AEP, UK)	
104	A-2069-946-A	SUB, BOARD, COMPLETE (ZX770BN/ZX780DC)		HB1	A-2074-935-A	HEADBAND ASSY (SV) (Including RELAY CABLE) (ZX770BN: LA)	
104	A-2069-948-A	SUB, BOARD, COMPLETE (ZX770BT)		HB1	A-2074-937-A	HEADBAND ASSY (SV) (Including RELAY CABLE) (for BLUE) (ZX770BN: E, AUS, JE, RU)	
105	4-564-493-02	RING (R) (for R-ch) (for BLACK)	(ZX770BN/ZX770BT)	HB1	A-2074-938-A	HEADBAND ASSY (SV) (Including RELAY CABLE) (for BLUE) (ZX770BN: US, CND)	
105	4-564-493-12	RING (R) (for R-ch) (for BLUE)	(ZX770BN: Except LA/ZX770BT)	HB1	A-2074-939-A	HEADBAND ASSY (SV) (Including RELAY CABLE) (for BLUE) (ZX770BN: AEP, UK)	
105	4-564-493-21	RING (R) (for R-ch) (for BLACK) (ZX780DC)		HB1	A-2074-940-A	HEADBAND ASSY (SV) (Including RELAY CABLE) (for BLACK) (ZX770BT: E, AUS, JE, RU)	
106	4-478-790-01	ADHESIVE, BATTERY		HB1	A-2074-941-A	HEADBAND ASSY (SV) (Including RELAY CABLE) (for BLACK) (ZX770BT: US, CND)	
107	4-559-823-01	BUTTON, VOLUME (+ VOLUME -)	(ZX770BN/ZX770BT)	HB1	A-2074-942-A	HEADBAND ASSY (SV) (Including RELAY CABLE) (for BLUE) (ZX770BT: E, AUS, JE, RU)	
107	4-559-823-11	BUTTON, VOLUME (+ VOLUME -)	(ZX780DC)	HB1	A-2074-943-A	HEADBAND ASSY (SV) (Including RELAY CABLE) (for BLUE) (ZX770BT: US, CND)	
108	4-559-822-01	HOUSING (R) (for R-ch) (ZX770BN)		HB1	A-2127-588-A	HEADBAND ASSY (FOR SVX) (Including RELAY CABLE) (for BLACK) (ZX780DC)	
108	4-559-822-11	HOUSING (R) (for R-ch) (ZX780DC)		MIC2	1-542-974-31	MICROPHONE, ELECTRET CAP (Including WIRE) (ZX770BN/ZX780DC)	
108	4-564-494-01	HOUSING (R) (for R-ch) (ZX770BT)					
109	4-564-490-02	RING, CAP (ZX770BN)					
109	4-564-490-11	RING, CAP (ZX780DC)					
110	X-2591-401-2	CAP HOUSING (R) SUB ASSY (SV) (for R-ch) (ZX770BN/ZX780DC)					
110	X-2591-402-2	CAP HOUSING (R) SUB ASSY (SV) (for R-ch) (ZX770BT)					
BAT1	1-853-017-13	BATTERY, STORAGE, LITHIUM (E, AUS, JE, RU) (See Note 1)					
BAT1	A-2075-160-B	BATTERY SUB ASSY (SV) (US, CND, AEP, UK, LA) (See Note 1)					
DR2	A-2075-159-A	PLATE, FRONT(R) SUB ASSY (SV) (for R-ch) (Including DRIVER, DRIVER WIRE) (ZX770BN/ZX770BT) (See Note 2)					

SECTION 5
ACCESSORIES

Ref. No.	Part No.	Description	Remark
4-559-832-11		GUIDE, QUICK START (ENGLISH, SPANISH, FRENCH) (ZX770BN: US, CND)	
4-559-832-31		GUIDE, QUICK START (ENGLISH, RUSSIAN, TRADITIONAL CHINESE, KOREAN) (ZX770BN: E, AUS, JE, RU)	
4-559-832-41		GUIDE, QUICK START (ENGLISH, FRENCH, GERMAN, SPANISH, DUTCH, ITALIAN, POLISH, HUNGARIAN) (ZX770BN: AEP, UK)	
4-559-832-51		GUIDE, QUICK START (PORTUGUESE, GREEK, CZECH, BULGARIAN, SLOVAK, SLOVENIAN, ROMANIAN) (ZX770BN: AEP, UK)	
4-559-832-61		GUIDE, QUICK START (ENGLISH, SPANISH, PORTUGUESE) (ZX770BN: LA)	
4-559-833-11		GUIDE, REFERENCE (ENGLISH, SPANISH, FRENCH) (ZX770BN: US, CND)	
4-559-833-32		GUIDE, REFERENCE (ENGLISH, RUSSIAN, TRADITIONAL CHINESE, KOREAN) (ZX770BN: E, AUS, JE, RU)	
4-559-833-41		GUIDE, REFERENCE (ENGLISH, FRENCH, GERMAN, SPANISH, DUTCH, ITALIAN, POLISH, HUNGARIAN) (ZX770BN: AEP, UK)	
4-559-833-51		GUIDE, REFERENCE (PORTUGUESE, GREEK, CZECH, BULGARIAN, SLOVAK, SLOVENIAN, ROMANIAN) (ZX770BN: AEP, UK)	
4-559-833-61		GUIDE, REFERENCE (ENGLISH, SPANISH, PORTUGUESE) (ZX770BN: LA)	
4-564-472-11		GUIDE, QUICK START (ENGLISH, SPANISH, FRENCH) (ZX770BT: US, CND)	
4-564-472-31		GUIDE, QUICK START (ENGLISH, RUSSIAN, TRADITIONAL CHINESE, KOREAN, UKRAINIAN) (ZX770BT: E, AUS, JE, RU)	
4-564-473-11		GUIDE, REFERENCE (ENGLISH, SPANISH, FRENCH) (ZX770BT: US, CND)	
4-564-473-32		GUIDE, REFERENCE (ENGLISH, RUSSIAN, TRADITIONAL CHINESE, KOREAN, UKRAINIAN) (ZX770BT: E, AUS, JE, RU)	
4-596-342-11		MANUAL, INSTRUCTION (Operating Instructions) (ENGLISH, FRENCH) (ZX780DC)	
4-596-345-11		REFERENCE GUIDE (ENGLISH, FRENCH) (ZX780DC)	

Ref. No.	Part No.	Description	Remark
501	1-848-682-11	CABLE, CONNECTION (USB) (Micro-USB cable (approx. 50 cm))	
502	1-846-746-62	CABLE (WITH PLUG) (Headphone cable (approx. 1.2 m)) (ZX770BN/ZX780DC)	
503	4-564-470-01	POUCH, CARRYING (ZX770BN/ZX780DC)	
504	4-539-657-01	CASE, CARRYING (ZX780DC)	
△ 505	1-493-084-12	AC ADAPTOR (USB charger) (AC-UUD12) (ZX780DC)	

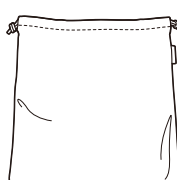

(ZX770BN)

<p>501 Micro-USB cable (approx. 50 cm) (1)</p> 	<p>502 Headphone cable (approx. 1.2 m) (1)</p> 
<p>503 Carrying pouch (1)</p> 	

(ZX770BT)

<p>501 Micro-USB cable (approx. 50 cm) (1)</p> 
--

(ZX780DC)

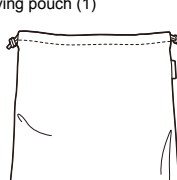
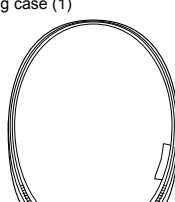
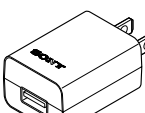
<p>501 Micro-USB cable (approx. 50 cm) (1)</p> 	<p>502 Headphone cable (approx. 1.2 m) (1)</p> 
<p>503 Carrying pouch (1)</p> 	<p>504 Carrying case (1)</p> 
<p>505 USB charger (1)</p> 	

The components identified by mark △ or dotted line with mark △ are critical for safety.
Replace only with part number specified.

Les composants identifiés par une marque △ sont critiques pour la sécurité.
Ne les remplacer que par une pièce portant le numéro spécifié.

MEMO

