

SEC 1. DISASSEMBLY/PART NUMBER INFORMATION

1-1. TABLE-TOP STAND ASSEMBLY REMOVAL

- Ⓐ Remove 4 screws from Table-Top Stand Assembly
- Ⓑ Lift up TV set to detach from Table-Top Stand Assembly

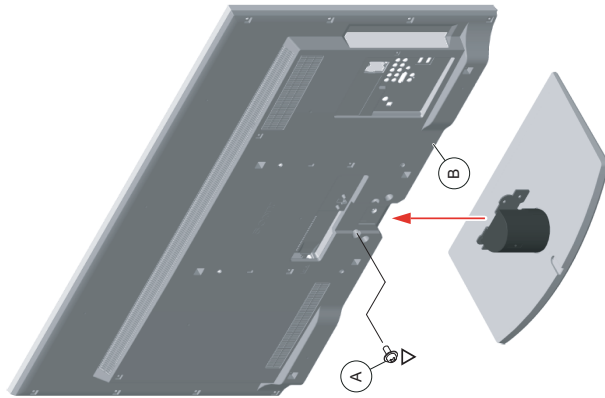

- Ⓒ Gently place the TV set face down onto a soft cloth

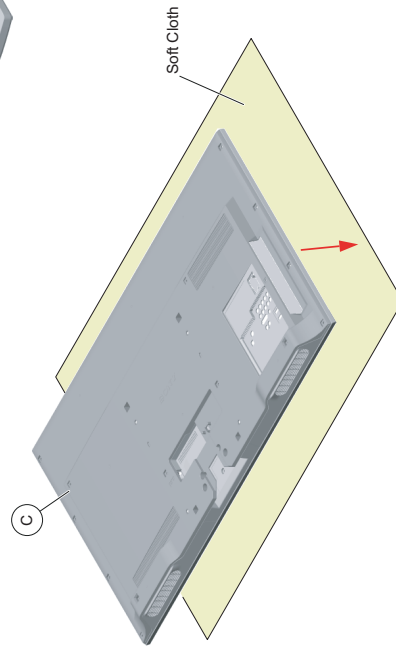

Components not identified by a part number or description are not stocked because they are seldom required for routine service.

NOTE: The components identified by shading and Δ mark are critical for safety. Replace only with part number specified.

The component parts of an assembly are indicated by the reference numbers in the far right column of the parts list and within the dotted lines of the diagram.

NOTE: Les composants identifiés par un trame et une marque Δ sont critiques pour la sécurité. Ne les remplacer que par une pièce portant le numéro spécifié.

* Items marked with an asterisk are not stocked since they are seldom required for routine service. Expect some delay when ordering these components.

NOTE: The components identified by a red outline and a Δ mark contain confidential information. Specific instructions must be adhered to whenever these components are repaired and/or replaced. See Appendix A: Encryption Key Components in the back of this manual.

(Check the [Sony Electronics Service Information](#) website for any additional service related issues for this model.)

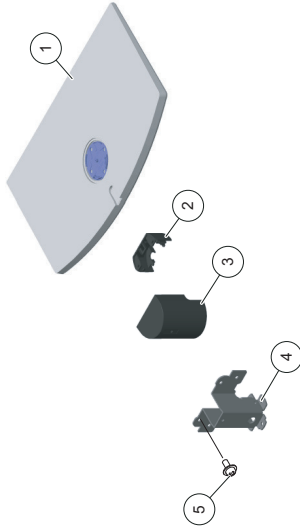

| REF. NO. | PART NO. | DESCRIPTION | [ASSEMBLY INCLUDES] | REF. NO. | PART NO. | DESCRIPTION | [ASSEMBLY INCLUDES] |
|----------|--------------|--|---------------------|----------|--------------|--|---------------------|
| 1 | X-2547-872-1 | BASE (M3A) ASSEMBLY (KDL-40HX800 ONLY) | | 4 | 4-170-450-01 | NECK (ML3A) (KDL-40HX800/46HX800 ONLY) | |
| 1 | X-2547-878-1 | BASE (L3C) ASSEMBLY (KDL-46HX800 ONLY) | | 4 | 4-170-451-01 | NECK (LL3A) (KDL-55HX800 ONLY) | |
| 1 | X-2547-877-1 | BASE (LL3A) ASSEMBLY (KDL-55HX800 ONLY) | | 5 | 2-580-608-01 | SCREW, +FSW M5X16 (SCREWS TO ATTACH TABLE-TOP STAND TO LCD TV) | |
| 2 | 4-170-477-01 | COVER, NECK (M3A FRONT) (KDL-40HX800/46HX800 ONLY) | | | | For product protection and safety reasons, Sony strongly recommends that you use the screws provided with the TV | |
| 2 | 4-187-684-01 | COVER, NECK (L3A FRONT) (KDL-55HX800 ONLY) | | | | CAUTION: These screws cannot be used to secure the TV to the Wall Mount Brackets | |
| 3 | 4-170-485-01 | COVER, NECK (M3A REAR) (KDL-40HX800/46HX800 ONLY) | | ∇ | 2-580-608-01 | SCREW, +FSW M5X16 | |
| 3 | 4-187-685-01 | COVER, NECK (L3A REAR) (KDL-55HX800 ONLY) | | | | | |

DISASSEMBLY/PART NUMBER INFORMATION

1-2. REAR COVER, UNDER COVER, VESA BRACKETS AND SWITCH UNIT REMOVAL

1-2-1. KDL-40HX800/46HX800 ONLY

- A Remove 4 screws from Rear Cover
- B Remove 8 screws from Rear Cover (KDL-40HX800 Only)
Remove 10 screws from Rear Cover (KDL-46HX800 Only)
- C Remove 1 screw from Rear Cover to detach from Terminal area
- D Remove 1 screw from Rear Cover to detach from Side Jack area
- E Lift up Rear Cover from bottom side to detach from Bezel
- F Disconnect AC Inlet from G4E/G6B (Power) Boards and detach from Under Cover
- G Remove 1 screw from Under Cover to detach from Bottom Frame
- H Slide out Vesa Brackets to detach from Rear Cover
- I Lift up Switch Unit and disconnect 1 connector to remove from LCD Panel
- J Slide out Power Switch and disconnect 1 connector to remove from Switch Unit

NOTE: The Vesa Brackets are not included with the Rear Cover and must be reattached to the replacement Rear Cover

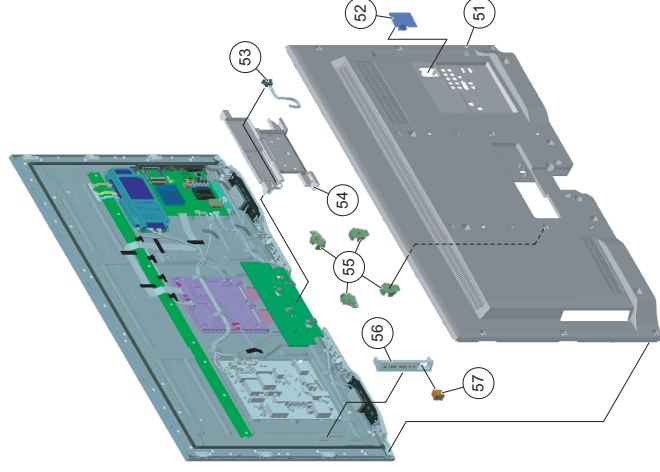
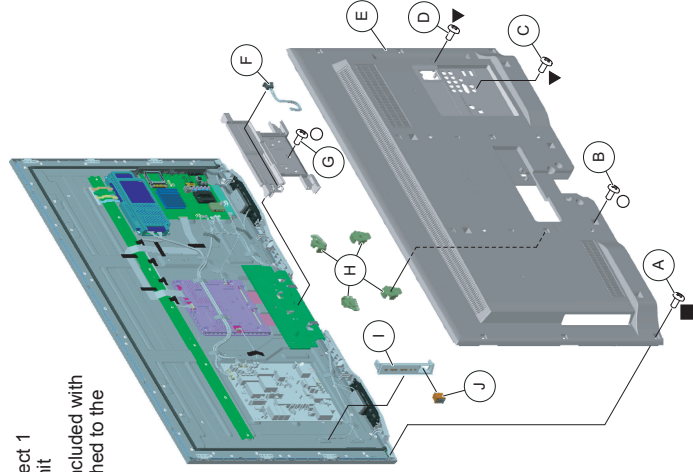

NOTE: The components identified by shading and Δ mark are critical for safety. Replace only with part number specified.

NOTE: Les composants identifiés par un trame et une marque Δ sont critiques pour la sécurité. Ne les remplacer que par une pièce portant le numéro spécifié.

NOTE: The components identified by a red outline and a Δ mark contain confidential information. Specific instructions must be adhered to whenever these components are repaired and/or replaced. See Appendix A: Encryption Key Components in the back of this manual.

(Check the [Sony Electronics Service Information](#) website for any additional service related issues for this model.)

| REF. NO. | PART NO. | DESCRIPTION | [ASSEMBLY INCLUDES] | REF. NO. | PART NO. | DESCRIPTION | [ASSEMBLY INCLUDES] |
|-------------|--------------|---------------------------------------|---------------------|----------|--------------|----------------------------|---------------------|
| 51 | 4-176-759-21 | REAR COVER (40) (KDL-40HX800 ONLY) | | 55 | 4-167-326-01 | BRACKET, VESA (S) | |
| 51 | 4-176-759-21 | REAR COVER (46) (KDL-46HX800 ONLY) | | 56 | 1-487-804-11 | SWITCH UNIT | |
| 52 | 3-297-324-02 | COVER, EGS | | 57 | 1-798-309-11 | POWER SWITCH | |
| Δ 53 | 1-942-031-11 | AC INLET (2P) | | | 2-806-640-01 | SCREW +B1VP 4X16 TYPE2 IT3 | |
| | | | | | 7-685-648-79 | SCREW +B1VP 3X12 TYPE2 IT3 | |
| 54 | 4-184-861-01 | COVER, UNDER (40) | | | 4-159-298-01 | SCREW +PSW MAX10 | |

DISASSEMBLY/PART NUMBER INFORMATION

1-2-2. KDL-55HX800 ONLY

- Ⓐ Remove 9 screws from Rear Cover
- Ⓑ Remove 4 screws from Rear Cover
- Ⓒ Remove 1 screw from Rear Cover to detach from Terminal area
- Ⓓ Remove 6 screws from Rear Cover to detach from Panel Bracket
- Ⓔ Remove 4 screws from Rear Cover LCD Panel
- Ⓕ Lift up Rear Cover from bottom side to detach from Bezel
- Ⓖ Lift up Hook Cover from bottom side to detach from Under Cover
- Ⓗ Disconnect AC Inlet from G6B (Power) Board and detach from Under Cover
- Ⓛ Remove 1 screw from Under Cover to detach from Bottom Frame
- Ⓜ Remove 4 screws to detach Vesa Brackets from LCD Panel
- Ⓝ Lift up Switch Unit and disconnect 1 connector to remove from LCD Panel
- Ⓚ Slide out Power Switch and disconnect 1 connector to remove from Switch Unit

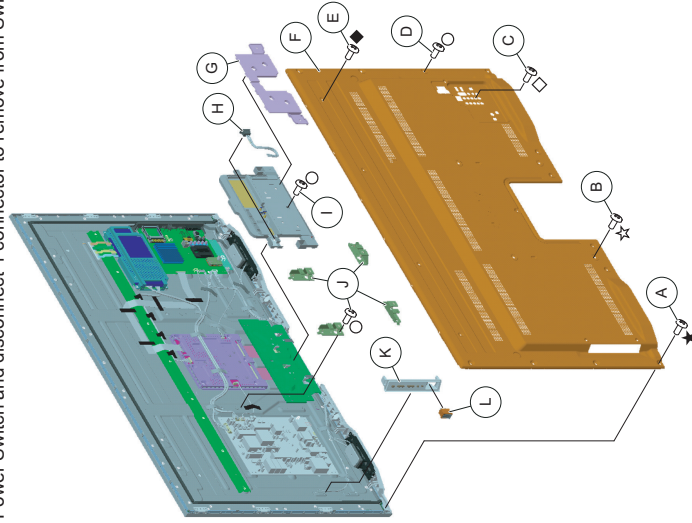

NOTE: The components identified by shading and a Δ mark are critical for safety. Replace only with part number specified.

NOTE: Les composants identifiés par un trame et une marque Δ sont critiques pour la sécurité. Ne les remplacer que par une pièce portant le numéro spécifié.

NOTE: The components identified by a red outline and a Δ mark contain confidential information. Specific instructions must be adhered to whenever these components are repaired and/or replaced. See Appendix A, Encryption Key Components in the back of this manual.

(Check the [Sony Electronics Service Information](http://SonyElectronicsService.Information) website for any additional service related issues for this model.)

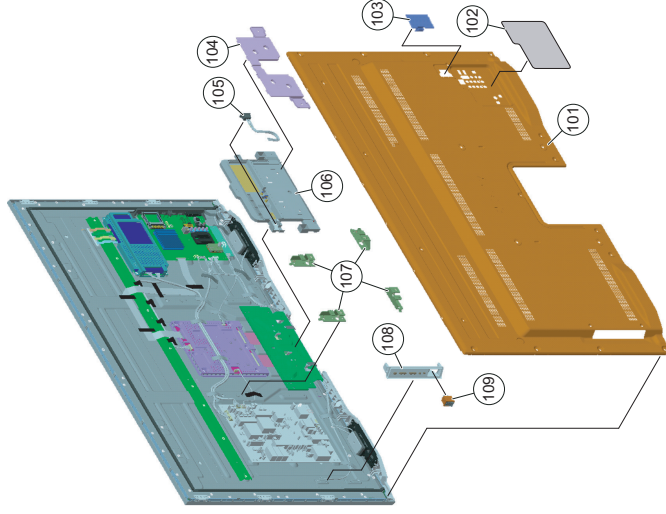

| REF. NO. | PART NO. | DESCRIPTION | [ASSEMBLY INCLUDES] | REF. NO. | PART NO. | DESCRIPTION | [ASSEMBLY INCLUDES] |
|----------|--------------|--------------------------------|---------------------|----------|--------------|------------------------------|---------------------|
| 101 | X-2547-039-2 | REAR COVER ASSEMBLY (55) | | 106 | X-2548-510-1 | COVER, UNDER (55) ASSEMBLY | |
| 102 | 4-164-917-21 | LABEL, REAR TERMINAL (FOR LIC) | | 107 | 4-176-944-01 | BRACKET, VESA T (ML) | |
| 102 | 4-164-917-31 | LABEL, REAR TERMINAL (FOR MX) | | 108 | 1-487-804-11 | SWITCH UNIT | |
| 103 | 3-297-324-02 | COVER, ECS | | 109 | 1-798-309-11 | POWER SWITCH | |
| 104 | 4-180-832-01 | COVER, HOOK (55) | | ○ | 4-159-298-01 | SCREW, +PSW1MX10 | |
| △ 105 | 1-842-031-11 | AC INLET (2P) | | ★ | 2-580-639-01 | SCREW, +BV1P 4X12 TYPE2 IT-3 | |
| | | | | ☆ | 2-580-611-01 | SCREW, +PSW1MX16 | |
| | | | | ◆ | 2-580-591-01 | SCREW, +PSW1M3X5 | |
| | | | | ◇ | 7-885-646-79 | SCREW, +BV1P 3X8 TYPE2 IT-3 | |

DISASSEMBLY/PART NUMBER INFORMATION

NOTE: The components identified by shading and a Δ mark are critical for safety. Replace only with part number specified.

NOTE: Les composants identifiés par un trame et une marque Δ sont critiques pour la sécurité. Ne les remplacer que par une pièce portant le numéro spécifié.

(Check the [Sony Electronics Service Information](http://www.sonyelectronics.com) website for any additional service related issues for this model.)

1-3. SPEAKERS, SPEAKER BRACKETS AND HLR BOARD REMOVAL

- Ⓐ Remove screws from Speaker Bracket Right to detach from Bezel
2 from KDL-40HX800/46HX800 Only
4 from KDL-55HX800 Only
- Ⓑ Remove 2 screws from Speaker to detach from Speaker Bracket Right
- Ⓒ Remove screws from Speaker Bracket Left to detach from Bezel
2 from KDL-40HX800/46HX800 Only
4 from KDL-55HX800 Only
- Ⓓ Remove 2 screws from Speaker to detach from Speaker Bracket Left
- Ⓔ Remove 5 screws from Bottom Frame to detach from LCD Panel
- Ⓕ Disconnect 1 connector from HLR Board, then release clips and lift up to remove from LED Guide

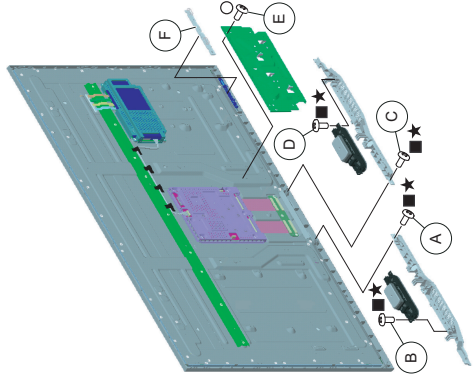
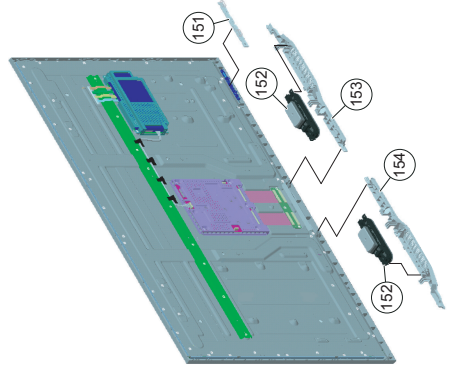

| REF. NO. | PART NO. | DESCRIPTION | [ASSEMBLY INCLUDES] | REF. NO. | PART NO. | DESCRIPTION | [ASSEMBLY INCLUDES] |
|----------|--------------|--|---------------------|----------|--------------|--|---------------------|
| 151 | A-1772-855-A | HLR BOARD, MOUNTED | | 154 | X-2548-514-1 | BRACKET, SP R (40) ASSEMBLY (KDL-40HX800 ONLY) | |
| 152 | 1-828-873-41 | LOUDSPEAKER (3.4X17.5CM) | | 154 | X-2548-516-1 | BRACKET, SP R (46) ASSEMBLY (KDL-46HX800 ONLY) | |
| 153 | X-2548-515-1 | BRACKET, SP L (40) ASSEMBLY (KDL-40HX800 ONLY) | | 154 | X-2548-518-1 | BRACKET, SP R (65) ASSEMBLY (KDL-55HX800 ONLY) | |
| 153 | X-2548-515-1 | BRACKET, SP L (46) ASSEMBLY (KDL-46HX800 ONLY) | | ■ | 2-580-640-01 | SCREW, #VTP 4X16 TYPE2 IT-3 (KDL-40HX800/46HX800 ONLY) | |
| 153 | X-2548-517-1 | BRACKET, SP L (65) ASSEMBLY (KDL-55HX800 ONLY) | | ○ | 4-159-298-01 | SCREW, #PSW MAX10 | |
| | | | | ★ | 2-580-639-01 | SCREW, #VTP 4X12 TYPE2 IT-3 (KDL-55HX800 ONLY) | |

DISASSEMBLY/PART NUMBER INFORMATION

1-4. G4E/G6B (POWER) BOARDS, BAL BOARD, HTD BOARD AND LCD PANEL REMOVAL

- Ⓐ Lift-up Panel Brackets to detach from Bezel
 - 4 from KDL-40HX800 Only
 - 6 from KDL-46HX800/55HX800 Only
- Ⓑ Remove 4 screws from G4E/G6B (Power) Boards
- Ⓒ Disconnect 5 connectors from G4E/G6B (Power) Boards
- Ⓓ Remove 4 screws from BAL Board
- Ⓔ Disconnect 5 connectors from BAL Board
- Ⓕ Slide Side Jack Bracket to right-side to remove from BAL Board
- Ⓖ Disconnect 1 connector from HTD Board and remove 2 screws
- Ⓗ Carefully Lift up LCD Panel to remove from Bezel

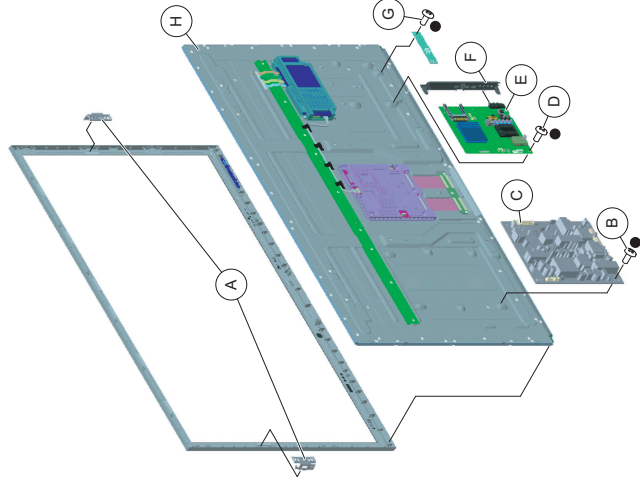

NOTE: The components identified by shading and a Δ mark are critical for safety. Replace only with part number specified.

NOTE: Les composants identifiés par un trame et une marque Δ sont critiques pour la sécurité. Ne les remplacer que par une pièce portant le numéro spécifié.

NOTE: The components identified by a red outline and a \square mark contain confidential information. Specific instructions must be adhered to whenever these components are repaired and/or replaced. See Appendix A, Encryption Key Components in the back of this manual.

(Check the Sony Electronics Service Information website for any additional service related issues for this model.)

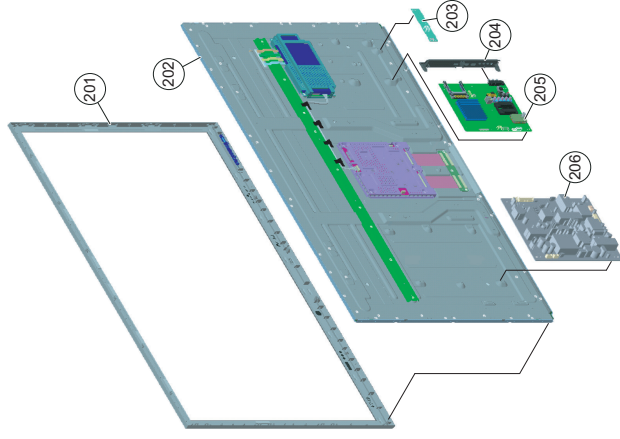

| REF. NO. | PART NO. | DESCRIPTION | [ASSEMBLY INCLUDES] | REF. NO. | PART NO. | DESCRIPTION | [ASSEMBLY INCLUDES] |
|----------|--------------|--|---------------------|---------------|--------------|--|---|
| 201 | X-2546-579-1 | BEZEL (40) ASSEMBLY (KDL-40HX800 ONLY) | | 204 | 4-171-117-01 | BRACKET, SIDE JACK (KDL-55HX800 ONLY) | |
| 201 | X-2546-580-1 | BEZEL (46) ASSEMBLY (KDL-46HX800 ONLY) | | \square 205 | A-1778-906-A | BAL BOARD, COMPLETE | |
| 201 | X-2547-038-1 | BEZEL (55) ASSEMBLY (KDL-55HX800 ONLY) | | | | | NOTE: For BAL Board replacement, please refer to section 2.2, Setting the Destination after Replacing the BAL Board or LCD Panel. |
| 202 | NA | LCD PANEL | | | | | NOTE: Final software is not installed on this BAL Board. Install the update after replacing this board using the instructions provided with the software. |
| | | FOR ALL LCD PANEL PART NUMBER INFORMATION REFER TO THE LCD PANELS SERVICE MANUAL | | 206 | 1-474-238-11 | G4E (POWER) BOARD, COMPLETE (KDL-40HX800 ONLY) | |
| 203 | A-1745-580-A | HTD BOARD, MOUNTED | | 206 | 1-474-240-11 | G6B (POWER) BOARD, COMPLETE (KDL-46HX800/55HX800 ONLY) | |
| 204 | 4-186-288-21 | BRACKET, SIDE JACK (KDL-40HX800/46HX800 ONLY) | | | | | ● 2-580-592-01 |
| | | | | | | | SCREW, +PSW M3X8 |