

DSC-W360

SERVICE MANUAL

Ver. 1.0 2010.02

LEVEL 2

Canadian Model
AEP Model
UK Model
E Model
Australian Model
Hong Kong Model
Korea Model

Internal memory
ON BOARD

Revised-1

Replace the previously issued SERVICE MANUAL 9-852-743-31 with this Manual.



Photo: Silver

SERVICE NOTE (Check the following note before the service.)

- 1-1. PRECAUTION ON REPLACING THE SY-241 BOARD
- 1-2. METHOD FOR COPYING OR ERASING THE DATA IN INTERNAL MEMORY
- 1-3. HOW TO WRITE DATA TO INTERNAL MEMORY
- 1-4. SELF-DIAGNOSIS FUNCTION
- 1-5. PROCESS AFTER FIXING FLASH ERROR
- 1-6. ORNAMENTAL RING A OR BARRIER ASSY REPLACING METHOD
- 1-7. OPTICAL STEPIING MOTOR (F1380) REPLACING METHOD
- 1-8. DC MOTOR WORM A ASSY REPLACING METHOD
- 1-9. CAM TUBE BLOCK ASSY AND STRAIGHT TUBE LUBRICATED ASSY AND 1 GROUP FRAME REPLACING METHOD
- 1-10. FINAL INSPECTION

DIGITAL STILL CAMERA

SONY®

The components identified by mark Δ or dotted line with mark Δ are critical for safety. Replace only with part number specified.
Les composants identifiés par une marque Δ sont critiques pour la sécurité. Ne les remplacer que par une pièce portant le numéro spécifié.

DSC-W360_L2
9-852-743-32

Sony EMCS Co.

Revision History

Ver.	Date	History	Contents	S.M. Rev. issued
1.0	2010.01	Official Release	—	—
1.1	2010.02	Revised-1 (A1 09-403)	<ul style="list-style-type: none"> • Correction of PRECAUTION ON REPLACING THE SY-241 BOARD Page 1-1 • Correction of SELF-DIAGNOSIS FUNCTION Page 1-3 • Correction of EXPLODED VIEWS Page 2-3, 2-4, 2-5 • Correction of Accessories Page 2-7 • Correction of ELECTRICAL PARTS LIST Page 2-8 • Correction of BLOCK DIAGRAMS Page 4-1, 4-2 • Correction of PRINTED WIRING BOARDS Page 6-6 	Yes

2. REPAIR PARTS LIST

IDENTIFYING PARTS

Follow the disassembly in the numerical order given.

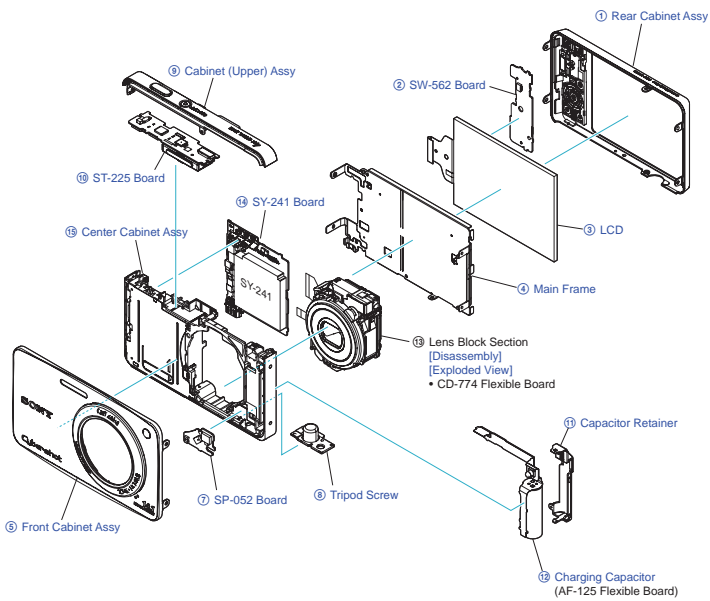

(ENGLISH)

NOTE:

- XX, -X mean standardized parts, so they may have some differences from the original one.
- Items marked "*" are not stocked since they are seldom required for routine service. Some delay should be anticipated when ordering these items.
- The mechanical parts with no reference number in the exploded views are not supplied.
- Due to standardization, replacements in the parts list may be different from the parts specified in the diagrams or the components used on the set.

CAPACITORS:

uF: μ F

COILS

uH: μ H

RESISTORS

All resistors are in ohms.

METAL: metal-film resistor

METAL OXIDE: Metal Oxide-film resistor

F: nonflammable

SEMICONDUCTORS

In each case, u, μ , for example:

uA...: μ A..., uPA..., μ PA...,

uPB..., μ PB..., μ PC..., μ PC...,

uPD..., μ PD...

The components identified by mark Δ , or dotted line with mark Δ , are critical for safety. Replace only with part number specified.
Les composants identifiés par une marque Δ sont critiques pour la sécurité. Ne les remplacer que par une pièce portant le numéro spécifié.

Color Indication of Appearance Parts

Example:

(SILVER): Cabinet's Color

(Silver) : Parts Color

Abbreviation

AUS : Australian model

CND : Canadian model

HK : Hong Kong model

KR : Korea model

View Position

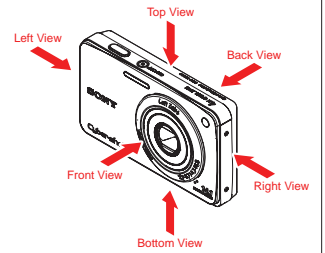

Link

DISCHARGING OF THE CHARGING CAPACITOR

ACCESSORIES

ASSEMBLY

NOTE FOR REPAIR

- Make sure that the flat cable and flexible board are not cracked or bent at the terminal.
Do not insert the cable insufficiently nor crookedly.
- When remove a connector, don't pull at wire of connector. It is possible that a wire is snapped.
- When installing a connector, don't press down at wire of connector.
It is possible that a wire is snapped.
- Do not apply excessive load to the gilded flexible board.

Cut and remove the part of gilt which comes off at the point.
(Be careful or some pieces of gilt may be left inside)

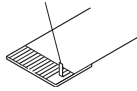

DISCHARGING OF THE CHARGING CAPACITOR (C901)

The charging capacitor (C901) of the AF-125 flexible board is charged up to the maximum 315 V potential.

There is a danger of electric shock by this high voltage when the capacitor is handled by hand. The electric shock is caused by the charged voltage which is kept without discharging when the main power of the unit is simply turned off. Therefore, the remaining voltage must be discharged as described below.

Preparing the Short Jig

To preparing the short jig, a small clip is attached to each end of a resistor of 1 k Ω / 1 W (1-215-869-11). Wrap insulating tape fully around the leads of the resistor to prevent electrical shock.

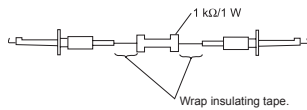

Note: High-voltage cautions

Discharging the Capacitor
Short-circuit between two points with the short jig about 10 seconds.

R: 1 k Ω / 1 W
(Part code: 1-215-869-11)

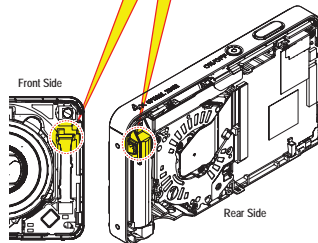
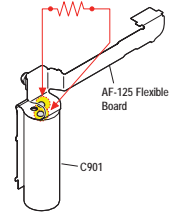

Ver. 1.1 2010.02
 The changed portions from
 Ver. 1.0 are shown in blue.

2-1. EXPLODED VIEWS

2-1-1. REAR SECTION

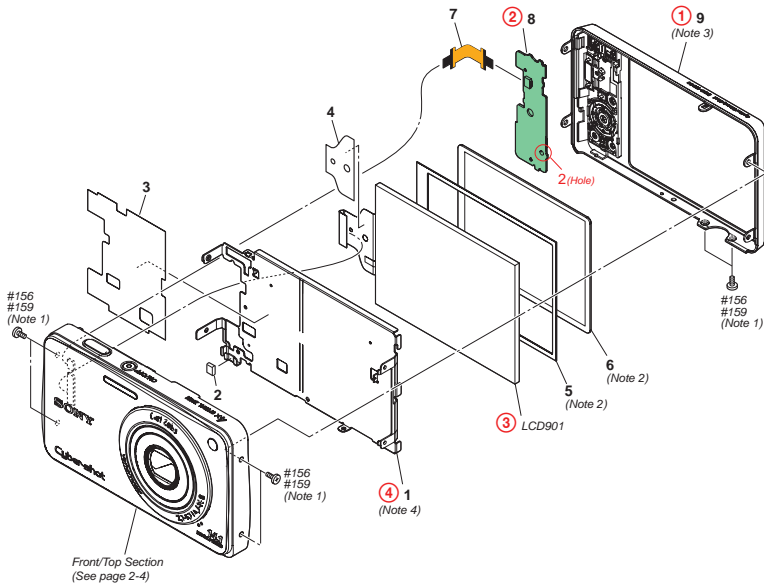

Ref. No.	Part No.	Description
* 1	4-167-590-01	FRAME (650), MAIN (Note 4)
* 2	3-289-764-01	GASKET (280)
* 3	4-167-566-01	SHEET (650), SY INSULATING
4	4-168-192-01	SHEET (680), LCD INSULATING
5	4-167-569-01	CUSHION (680), LCD (Note 2)

Ref. No.	Part No.	Description
6	4-167-568-01	WINDOW (680), LCD (Note 2)
7	1-880-209-11	FPC-019 FLEXIBLE BOARD
8	A-1731-539-A	SW-562 BOARD, COMPLETE
9	X-2541-644-1	CABINET (REAR) ASSY (650C) (Note 3)
	LCD901 1-802-983-11	LCD MODULE (LMS300GF07)
#156	2-635-591-61	SCREW (M1.4), NEW TRUSTAR P2 (Note 1)
#159	2-662-396-51	SCREW (M1.4), NEW, TRUSTAR, P2 (Note 1)

DSC-W360_L2

DISASSEMBLY

1. Remove to numerical order (① to ④) in the left figure.

① #156/#159 X 6

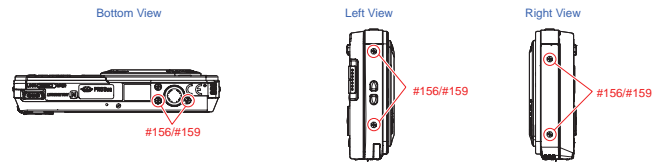

Screw

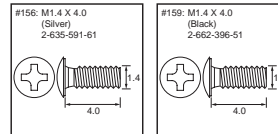

Note

Note 1

THE COMBINATION OF CABINET'S COLOR AND SCREW

The screw pointed  is different according to the cabinet's color. For the combination of cabinet's color and screw, please refer to Table 2-1.



Table 2-1

Screw's Ref. No. (Parts Color.)	Cabinet's Color
#156 (Silver)	SILVER
#159 (Black)	BLACK

Note 2: Refer to "Assembly-6: Attaching Method of LCD cushion (680) and LCD window (680)".

Note 3: Refer to "Assembly-5: Precaution During Cabinet (Rear) Assy Installation".

Note 4: Refer to "Assembly-4: Precaution During Main Frame Installation".

Ver. 1.1 2010.02
 The changed portions from
 Ver. 1.0 are shown in blue.

2-1-2. FRONT/TOP SECTION

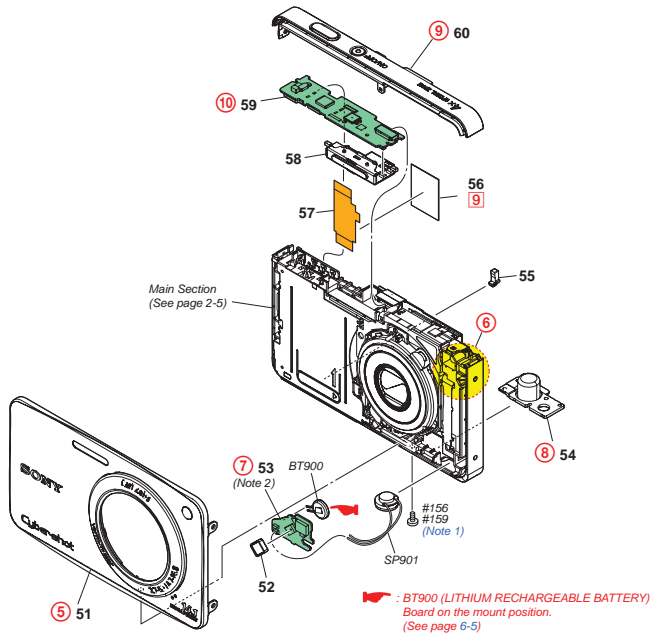

Ref. No.	Part No.	Description
51	X-2541-630-1	CABINET (FRONT) ASSY (650C) (SILVER)
51	X-2541-631-1	CABINET (FRONT) ASSY (650D) (BLACK)
52	4-111-391-01	HOLDER, MICROPHONE
53	A-1731-544-A	SP-052 BOARD, COMPLETE (Note 2)
* 54	4-167-574-01	SCREW (640), TRIPOD
55	4-167-564-01	LIGHT (640), MS GUIDE.

Ref. No.	Part No.	Description
* 56	4-168-315-01	TAPE (N5)
57	1-880-206-11	FRC-016 FLEXIBLE BOARD
Δ 58	1-487-596-11	FLASH UNIT
59	A-1731-542-A	ST-225 BOARD, COMPLETE
60	X-2541-637-1	CABINET (UPPER) ASSY (650C) (SILVER)
60	X-2541-638-1	CABINET (UPPER) ASSY (650D) (BLACK)
Δ BT900	1-756-710-12	LITHIUM RECHARGEABLE BATTERY
SP901	1-858-302-11	LOUDSPEAKER (0.8CM)
#156	2-635-591-61	SCREW (M1.4), NEW TRUSTAR P2 (Note 1)
#159	2-662-396-51	SCREW (M1.4), NEW, TRUSTAR, P2 (Note 1)

DSC-W360_L2

DISASSEMBLY

1. Remove to numerical order (9) to (19) in the left figure.

9 #156 / #159 X 6

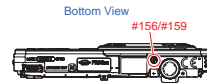

9

DISCHARGING OF THE CHARGING CAPACITOR

9 Tape (N5) (9)

Screw

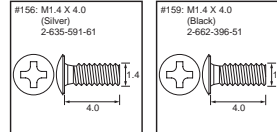

Note

Note 1

THE COMBINATION OF CABINET'S COLOR AND SCREW

The screw pointed 9 is different according to the cabinet's color.
 For the combination of cabinet's color and screw, please refer to Table 2-1.



Table 2-1

Screw's Ref. No. (Parts Color)	Cabinet's Color
#156 (Silver)	SILVER
#159 (Black)	BLACK

Caution :
 Danger of explosion if battery is incorrectly replaced.
 Replace only with the same or equivalent type.
 Dispose of used batteries according to the instructions.

Note 2: Refer to "Assembly-4; Precaution During SP-052 Board Installation".

Ver. 1.1 2010.02
 The changed portions from
 Ver. 1.0 are shown in blue.

2-1-3. MAIN SECTION

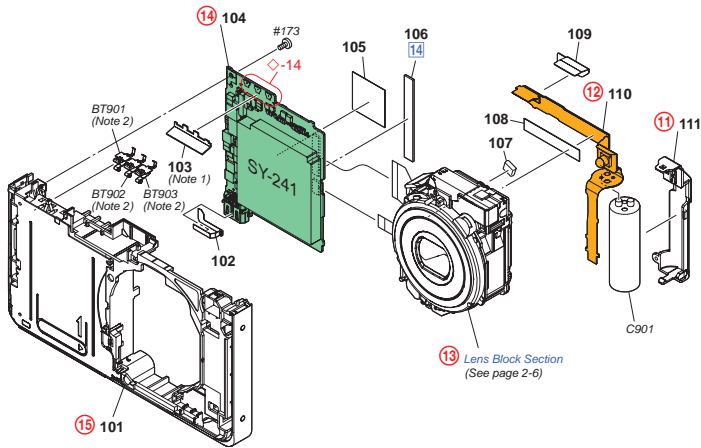

Ref. No.	Part No.	Description
101	X-2541-623-1	CABINET ASSY (650C), CENTER (SILVER)
101	X-2541-624-1	CABINET ASSY (650D), CENTER (BLACK)
102	4-167-571-01	SHEET, MULTI RADIATION
103	4-168-198-01	INSULATING SHEET (670) (Note 1)
104	A-1752-372-A	SY-241 BOARD, COMPLETE (SERVICE)
* 105	4-167-589-01	SHEET, SY RADIATION
* 106	4-172-609-01	SHEET, LCD REINFORCEMENT
* 107	3-289-764-01	GASKET (280)
108	4-172-234-01	TAPE (4X23), DOUBLE STICK
* 109	4-167-565-01	TAPE (AF)
110	A-1731-548-A	AF-125 FLEXIBLE BOARD, COMPLETE

Ref. No.	Part No.	Description
* 111	4-167-573-01	RETAINER (640), CAPACITOR
△* BT901	1-780-835-11	TERMINAL BOARD BATTERY (Note 2)
△* BT902	1-780-835-11	TERMINAL BOARD BATTERY (Note 2)
△* BT903	1-780-835-11	TERMINAL BOARD BATTERY (Note 2)
△ C901	1-116-439-11	CAP, ELECT 56MF 315V

#173 4-167-570-01 SCREW (M1.4 (ECOLOGY)), 2 MAIN

DSC-W360_L2

DISASSEMBLY

1. Remove to numerical order (10) to (15) in the left figure.
2. The meaning of the sign in left figure is as follows. Be careful when it removes.
 ◇-X: Solder

14 #173 X 1 → LCD REINFORCEMENT SHEET (14)

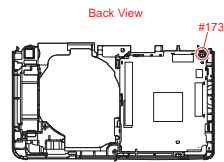

Screw

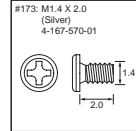

Note

Note 1: Refer to "Assembly-2: Insulating Sheet (670) Putting Position".

Note 2: Refer to "Assembly-1: Installation Method of Battery Terminal Board".

2-1-4. LENS BLOCK SECTION

ns: not supplied

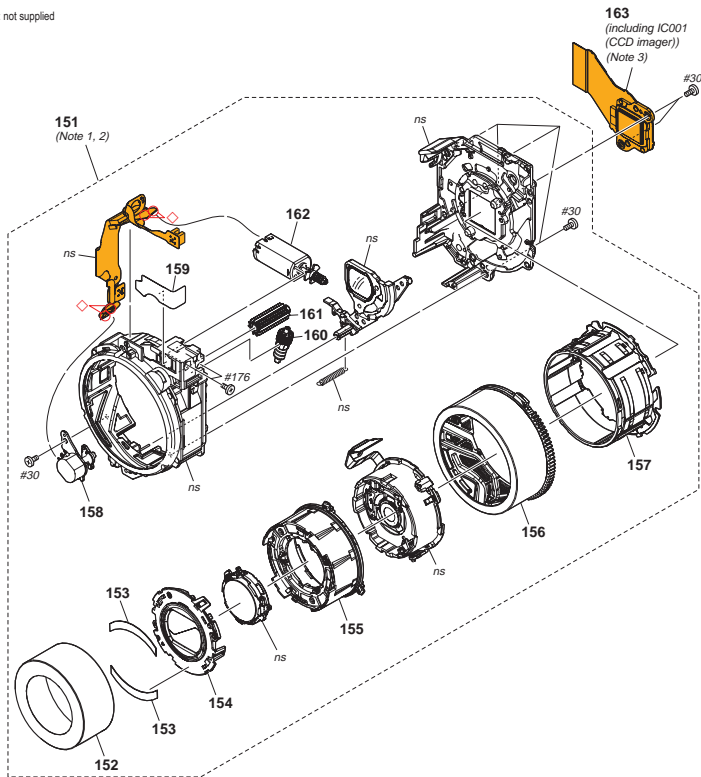

Ref. No.	Part No.	Description
151	8-848-861-01	DEVICE, LENS LSV-1380A (Note 1, 2)
152	4-155-850-01	RING A (S), ORNAMENTAL
153	4-147-109-01	TAPE, BARRIER
154	A-1743-714-A	BARRIER ASSY
155	4-147-091-01	FRAME, 1 GROUP
156	A-1743-728-A	CAM TUBE BLOCK ASSY
157	A-1743-727-A	STRAIGHT TUBE LUBRICATED ASSY
158	1-787-874-11	STEPPING MOTOR, OPTICAL (F1380)
159	4-147-113-01	SEAL, FG
160	A-1743-730-A	WORM B LUBRICATED ASSY

Ref. No.	Part No.	Description
161	A-1743-731-A	NARUTO GEAR LUBRICATED ASSY
162	A-1743-725-A	DC MOTOR WORM A ASSY
163	A-1731-547-A	CD-774 BOARD, COMPLETE (including IC001 (CCD imager)) (Note 3)
#30	3-086-156-11	SCREW B1.2
#176	3-947-504-31	SCREW (M1.2)

DISASSEMBLY

- The meaning of the sign in left figure is as follows. Be careful when it removes.
 Solder

Screw

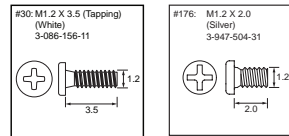

Note

Note 1

PRECAUTIONS WHEN HOLDING THE LENS BLOCK

- Hold the Lens Block at the center of both sides.
- Do not hold the following part.

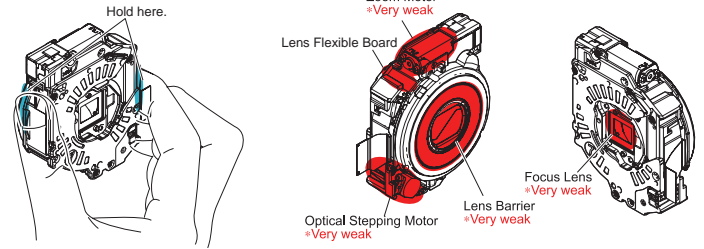

Note 2: Refer to the following each item when you exchange parts of Lens Block.

- 1-6. ORNAMENTAL RING A OR BARRIER ASSY REPLACING METHOD (page 1-4)
- 1-7. OPTICAL STEPPING MOTOR (F1380) REPLACING METHOD (page 1-4)
- 1-8. DC MOTOR WORM A ASSY REPLACING METHOD (page 1-5)
- 1-9. CAM TUBE BLOCK ASSY AND STRAIGHT TUBE LUBRICATED ASSY AND 1 GROUP FRAME REPLACING METHOD (page 1-5)
- 1-10. FINAL INSPECTION (page 1-9)

Note 3: Be sure to read "Precautions for Replacement of Imager" on page 6-1 when changing the imager.

Checking supplied accessories.

Note: This item is supplied with the unit as an accessory, but is not prepared as a service part.



Battery charger
(BC-CSN/BC-CSNB)
△ 1-837-323-21 (CND)
△ 1-837-323-41
(EXCEPT CND)



Rechargeable battery pack
(NP-BN1)
(Note)



Power cord (mains lead)
(EXCEPT CND)
△ 1-837-421-11 (UK, HK)
△ 1-837-427-11 (AEP, E)
△ 1-837-428-11 (KR)
△ 1-837-429-11 (AUS)



Conversion (2P) Adaptor
△ 1-569-008-33
(E, Latin America)



Instruction Manual
4-166-513-11 (ENGLISH)
* 4-166-513-31 (ENGLISH, FRENCH)
* 4-166-513-41 (ENGLISH, RUSSIAN, UKRAINIAN)
* 4-166-513-51 (ENGLISH, FRENCH, ITALIAN, SPANISH,
PORTUGUESE, GERMAN, DUTCH, TURKISH, GREEK,
POLISH, CZECH, HUNGARIAN, SLOVAK, SWEDISH,
FINNISH, NORWEGIAN, DANISH, CROATIAN, ROMANIAN)
* 4-166-513-61 (ENGLISH, TRADITIONAL CHINESE,
SIMPLIFIED CHINESE, MALAY, INDONESIAN, THAI,
ARABIC, PERSIAN)
* 4-166-513-71 (ENGLISH, SPANISH, PORTUGUESE)
* 4-166-513-81 (ENGLISH, TRADITIONAL CHINESE,
SIMPLIFIED CHINESE, INDONESIAN, ARABIC,
PERSIAN)
* 4-171-811-11 (ENGLISH, TRADITIONAL CHINESE, SIMPLIFIED CHINESE)
4-171-811-21 (KOREAN)

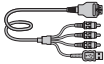

USB A/V cable for
multi-use terminal
1-837-299-11



Wrist strap
2-650-981-01 (Gray) (SILVER)
2-650-981-11 (Black) (BLACK)



Cyber-shot Handbook (PDF)

The CD-ROM supplied contains all of language version of the instruction Manual in pdf (Cyber-shot Handbook.pdf) for printing.
• The printed matter is not supplied. If required, please order it with the part number below.



CD-ROM
(Cyber-shot application software /
"Cyber-shot Handbook" /
"Cyber-shot Step-up Guide")
4-162-396-01

- | | |
|--------------------------------------|-----------------------------|
| * 4-162-397-01 (JAPANESE) | * 4-162-398-61 (CZECH) |
| * 4-162-397-11 (ENGLISH) | * 4-162-398-71 (HUNGARIAN) |
| * 4-162-397-21 (FRENCH) | * 4-162-398-81 (SLOVAK) |
| * 4-162-397-31 (ITALIAN) | * 4-162-398-91 (SWEDISH) |
| * 4-162-397-41 (SPANISH) | * 4-162-399-11 (FINNISH) |
| * 4-162-397-51 (PORTUGUESE) | * 4-162-399-21 (NORWEGIAN) |
| * 4-162-397-61 (GERMAN) | * 4-162-399-31 (DANISH) |
| * 4-162-397-71 (DUTCH) | * 4-162-399-41 (THAI) |
| * 4-162-397-81 (TRADITIONAL CHINESE) | * 4-162-399-51 (MALAY) |
| * 4-162-397-91 (SIMPLIFIED CHINESE) | * 4-162-399-61 (TURKISH) |
| * 4-162-398-11 (RUSSIAN) | * 4-162-399-71 (GREEK) |
| * 4-162-398-21 (ARABIC) | * 4-162-399-81 (UKRAINIAN) |
| * 4-162-398-31 (PERSIAN) | * 4-162-399-91 (CROATIAN) |
| * 4-162-398-41 (KOREAN) | * 4-162-400-11 (ROMANIAN) |
| * 4-162-398-51 (POLISH) | * 4-162-400-21 (INDONESIAN) |