

CDX-G1200U/G1201U/ G1202U/G1280UM

SERVICE MANUAL

Ver. 1.0 2016.08



Photo: CDX-G1200U

The service manual of the mechanism deck, used in this model, has been issued in a separate volume. Please refer to the service manual of the MG-101 series for the mechanism deck information.

US Model
Canadian Model
Australian Model
Hong Kong Model
Argentina Model
CDX-G1200U
AEP Model
UK Model
Saudi Arabia Model
CDX-G1200U/G1201U/G1202U
E Model
Korean Model
CDX-G1200U/G1201U
Indian Model
CDX-G1200U/G1280UM

- The tuner and CD sections have no adjustments.

Model Name Using Similar Mechanism	CDX-G1100U/G1150U/G3100UP
Mechanism Type	MG-101CF-188
Optical Pick-up Name	DAX-25A

SPECIFICATIONS

(US, CND)

FOR THE CUSTOMERS IN THE USA. NOT APPLICABLE IN CANADA, INCLUDING IN THE PROVINCE OF QUEBEC.

POUR LES CLIENTS AUX ÉTATS-UNIS. NON APPLICABLE AU CANADA, Y COMPRIS LA PROVINCE DE QUÉBEC.

AUDIO POWER SPECIFICATIONS

CTA2006 Standard
Power Output: 20 Watts RMS x 4 at 4 Ohms < 1% THD+N
SN Ratio: 80 dBa
(reference: 1 Watt into 4 Ohms)

Tuner section

(US, CND)

FM
Tuning range: 87.5 MHz – 107.9 MHz
Antenna (aerial) terminal:
External antenna (aerial) connector
Intermediate frequency:
FM CCIR: -1,956.5 kHz to -487.3 kHz and +500.0 kHz to +2,095.4 kHz
Usable sensitivity: 7 dBf
Selectivity: 75 dB at 400 kHz
Signal-to-noise ratio: 73 dB
Separation: 50 dB at 1 kHz
Frequency response: 20 Hz – 15,000 Hz

AM

Tuning range: 530 kHz – 1,710 kHz
Antenna (aerial) terminal:
External antenna (aerial) connector
Sensitivity: 26 µV

(AEP, UK, HK)

FM

Tuning range:
When [AREA] is set to [EUROPE]:
87.5 MHz – 108.0 MHz
When [AREA] is set to [RUSSIA]:
FM1/FM2: 87.5 MHz – 108.0 MHz (at 50 kHz step)
FM3: 65 MHz – 74 MHz (at 30 kHz step)
Antenna (aerial) terminal:
External antenna (aerial) connector
Intermediate frequency:
When [AREA] is set to [EUROPE]:
FM CCIR: -1,956.5 kHz to -487.3 kHz and +500.0 kHz to +2,095.4 kHz
When [AREA] is set to [RUSSIA]:
FM CCIR: -1,956.5 kHz to -487.3 kHz and +500.0 kHz to +2,095.4 kHz
FM OIRT: -1,815.6 kHz to -943.7 kHz and +996.6 kHz to +1,776.6 kHz
Usable sensitivity: 7 dBf
Selectivity: 75 dB at 400 kHz
Signal-to-noise ratio: 73 dB
Separation: 50 dB at 1 kHz
Frequency response: 20 Hz – 15,000 Hz

MW/LW

Tuning range:
MW: 531 kHz – 1,602 kHz
LW: 153 kHz – 279 kHz
Antenna (aerial) terminal:
External antenna (aerial) connector
Sensitivity: MW: 26 µV, LW: 50 µV

(E, AR, KR, AUS)

FM

Tuning range:
87.5 MHz – 108.0 MHz (at 50 kHz step)
87.5 MHz – 108.0 MHz (at 100 kHz step)
87.5 MHz – 107.9 MHz (at 200 kHz step)
For Argentine models:
87.5 MHz – 107.9 MHz
FM tuning step (except for Argentine models):
50 kHz/100 kHz/200 kHz switchable
Antenna (aerial) terminal:
External antenna (aerial) connector
Intermediate frequency:
FM CCIR: -1,956.5 kHz to -487.3 kHz and +500.0 kHz to +2,095.4 kHz
Usable sensitivity: 7 dBf
Selectivity: 75 dB at 400 kHz
Signal-to-noise ratio: 73 dB
Separation: 50 dB at 1 kHz
Frequency response: 20 Hz – 15,000 Hz

AM

Tuning range:
531 kHz – 1,602 kHz (at 9 kHz step)
530 kHz – 1,710 kHz (at 10 kHz step)
For Argentine models:
530 kHz – 1,710 kHz
AM tuning step (except for Argentine models):
9 kHz/10 kHz switchable
Antenna (aerial) terminal:
External antenna (aerial) connector
Sensitivity: 26 µV

(EA)

FM

Tuning range: 87.5 MHz – 108.0 MHz
Antenna (aerial) terminal:
External antenna (aerial) connector
Intermediate frequency:
FM CCIR: -1,956.5 kHz to -487.3 kHz and +500.0 kHz to +2,095.4 kHz
Usable sensitivity: 7 dBf
Selectivity: 75 dB at 400 kHz
Signal-to-noise ratio: 73 dB
Separation: 50 dB at 1 kHz
Frequency response: 20 Hz – 15,000 Hz

MW

Tuning range: 531 kHz – 1,602 kHz
Antenna (aerial) terminal:
External antenna (aerial) connector
Sensitivity: 26 µV

SW

Tuning range:
SW1: 2,940 kHz – 7,735 kHz
SW2: 9,500 kHz – 18,135 kHz
(except for 10,140 kHz – 11,575 kHz)
Antenna (aerial) terminal:
External antenna (aerial) connector
Intermediate frequency:
-2,463.8 kHz to -1,710.1 kHz and +1,710.0 kHz to +2,418.4 kHz
Sensitivity: 26 µV

CD Player section

Signal-to-noise ratio: 95 dB
Frequency response: 10 Hz – 20,000 Hz
Wow and flutter: Below measurable limit
The maximum number of: (CD-/CD-RW only)
-folders (albums): 150 (including root folder)
-files (tracks) and folders: 300 (may less than 300 if folder/file names contain many characters)
-displayable characters for a folder/file name: 32 (Joliet)/64 (Romeo)
Corresponding codec: MP3 (.mp3) and WMA (.wma)

USB Player section

Interface: USB (Full speed)
Maximum current: 500 mA
The maximum number of recognizable tracks:
-folders (albums): 256
-files (tracks) per folder: 256
Compatible Android Open Accessory protocol (AOA): 2.0
Corresponding codec:
MP3 (.mp3)
Bit rate: 8 kbps – 320 kbps (Supports VBR (Variable Bit Rate))
Sampling rate: 16 kHz – 48 kHz
WMA (.wma)
Bit rate: 32 kbps – 192 kbps (Supports VBR (Variable Bit Rate))
Sampling rate: 32 kHz, 44.1 kHz, 48 kHz
FLAC (.flac)
Bit depth: 16 bit, 24 bit
Sampling rate: 44.1 kHz, 48 kHz

Power amplifier section

Output: Speaker outputs
Speaker impedance: 4 Ω – 8 Ω
Maximum power output: 55 W x 4 (at 4 Ω)

General

Outputs:
Audio outputs terminal (REAR, SUB)
Power antenna (aerial)/Power amplifier control terminal (REM OUT)
Inputs:
Remote controller input terminal
Antenna (aerial) input terminal
AUX input jack (stereo mini jack)
USB port
Power requirements: 12 V DC car battery (negative ground (earth))
Rated current consumption: 10 A
Dimensions:
Approx. 178 mm x 50 mm x 177 mm (7 1/8 in x 2 in x 7 in) (w/h/d)
Mounting dimensions:
Approx. 182 mm x 53 mm x 160 mm (7 1/4 in x 2 1/8 in x 6 5/16 in) (w/h/d)
Mass: Approx. 1.2 kg (2 lb 11 oz)
Package contents:
Main unit (1)
Remote commander (1): RM-X211 (Except AEP, UK, HK)
Parts for installation and connections (1 set)
Design and specifications are subject to change without notice.

US, Canadian, E, Argentina, Korean, Indian and Australian models
FM/AM COMPACT DISC PLAYER
AEP, UK and Hong Kong models
FM/MW/LW COMPACT DISC PLAYER
Saudi Arabia model
FM/MW/SW COMPACT DISC PLAYER

9-896-303-01

2016H33-1

© 2016.08

Sony Video & Sound Products Inc.

SONY®

Copyrights

Windows Media is either a registered trademark or trademark of Microsoft Corporation in the United States and/or other countries.

This product is protected by certain intellectual property rights of Microsoft Corporation. Use or distribution of such technology outside of this product is prohibited without a license from Microsoft or an authorized Microsoft subsidiary.

MPEG Layer-3 audio coding technology and patents licensed from Fraunhofer IIS and Thomson.

Android is a trademark of Google Inc.

libFLAC

Copyright (C) 2000-2009 Josh Coalson
Copyright (C) 2011-2013 Xiph.Org Foundation

Redistribution and use in source and binary forms, with or without modification, are permitted provided that the following conditions are met:

- Redistributions of source code must retain the above copyright notice, this list of conditions and the following disclaimer.
- Redistributions in binary form must reproduce the above copyright notice, this list of conditions and the following disclaimer in the documentation and/or other materials provided with the distribution.

-Neither the name of the Xiph.org Foundation nor the names of its contributors may be used to endorse or promote products derived from this software without specific prior written permission.

THIS SOFTWARE IS PROVIDED BY THE COPYRIGHT HOLDERS AND CONTRIBUTORS "AS IS" AND ANY EXPRESS OR IMPLIED WARRANTIES, INCLUDING, BUT NOT LIMITED TO, THE IMPLIED WARRANTIES OF MERCHANTABILITY AND FITNESS FOR A PARTICULAR PURPOSE ARE DISCLAIMED. IN NO EVENT SHALL THE FOUNDATION OR CONTRIBUTORS BE LIABLE FOR ANY DIRECT, INDIRECT, INCIDENTAL, SPECIAL, EXEMPLARY, OR CONSEQUENTIAL DAMAGES (INCLUDING, BUT NOT LIMITED TO, PROCUREMENT OF SUBSTITUTE GOODS OR SERVICES; LOSS OF USE, DATA, OR PROFITS; OR BUSINESS INTERRUPTION) HOWEVER CAUSED AND ON ANY THEORY OF LIABILITY, WHETHER IN CONTRACT, STRICT LIABILITY, OR TORT (INCLUDING NEGLIGENCE OR OTHERWISE) ARISING IN ANY WAY OUT OF THE USE OF THIS SOFTWARE, EVEN IF ADVISED OF THE POSSIBILITY OF SUCH DAMAGE.

TABLE OF CONTENTS

1. SERVICING NOTES	3
2. GENERAL	7
3. DISASSEMBLY	
3-1. Disassembly Flow	13
3-2. Mini Fuse (Blade Type) (FU1), Cover.....	13
3-3. Sub Panel Assy.....	14
3-4. CD Mechanism Deck (MG-101CF-188)	14
3-5. MAIN Board	15
3-6. Service Position	15
4. DIAGRAMS	
4-1. Block Diagram - MAIN Section -	16
4-2. Block Diagram - PANEL/POWER SUPPLY Section -	17
4-3. Printed Wiring Boards - MAIN Section (1/2) -	18
4-4. Printed Wiring Boards - MAIN Section (2/2) -	19
4-5. Schematic Diagram - MAIN Section (1/4) -	20
4-6. Schematic Diagram - MAIN Section (2/4) -	21
4-7. Schematic Diagram - MAIN Section (3/4) -	22
4-8. Schematic Diagram - MAIN Section (4/4) -	23
5. EXPLODED VIEWS	
5-1. Sub Panel Section	31
5-2. Chassis Section	32
6. ELECTRICAL PARTS LIST	33

Accessories are given in the last of the electrical parts list.

NOTES ON CHIP COMPONENT REPLACEMENT

- Never reuse a disconnected chip component.
- Notice that the minus side of a tantalum capacitor may be damaged by heat.

FLEXIBLE CIRCUIT BOARD REPAIRING

- Keep the temperature of soldering iron around 270 °C during repairing.
- Do not touch the soldering iron on the same conductor of the circuit board (within 3 times).
- Be careful not to apply force on the conductor when soldering or unsoldering.

CAUTION

Use of controls or adjustments or performance of procedures other than those specified herein may result in hazardous radiation exposure.

• US and CND models:

CAUTION

The use of optical instruments with this product will increase eye hazard.

• EA model:

This product is classified as a Class 1 Laser product under IEC 60825-1:2007.



This label is located on bottom surface of the product.

SAFETY-RELATED COMPONENT WARNING!

COMPONENTS IDENTIFIED BY MARK \triangle OR DOTTED LINE WITH MARK \triangle ON THE SCHEMATIC DIAGRAMS AND IN THE PARTS LIST ARE CRITICAL TO SAFE OPERATION. REPLACE THESE COMPONENTS WITH SONY PARTS WHOSE PART NUMBERS APPEAR AS SHOWN IN THIS MANUAL OR IN SUPPLEMENTS PUBLISHED BY SONY.

ATTENTION AU COMPOSANT AYANT RAPPORT À LA SÉCURITÉ!

LES COMPOSANTS IDENTIFIÉS PAR UNE MARQUE \triangle SUR LES DIAGRAMMES SCHÉMATIQUES ET LA LISTE DES PIÈCES SONT CRITIQUES POUR LA SÉCURITÉ DE FONCTIONNEMENT. NE REMPLACER CES COMPOSANTS QUE PAR DES PIÈCES SONY DONT LES NUMÉROS SONT DONNÉS DANS CE MANUEL OU DANS LES SUPPLÉMENTS PUBLIÉS PAR SONY.

CDX-G1200U/G1201U/G1202U/G1280UM

SECTION 1

SERVICING NOTES

The **SERVICING NOTES** contains important information for servicing. Be sure to read this section before repairing the unit.

NOTES ON HANDLING THE OPTICAL PICK-UP BLOCK OR BASE UNIT

The laser diode in the optical pick-up block may suffer electrostatic break-down because of the potential difference generated by the charged electrostatic load, etc. on clothing and the human body. During repair, pay attention to electrostatic break-down and also use the procedure in the printed matter which is included in the repair parts.

The flexible board is easily damaged and should be handled with care.

NOTES ON LASER DIODE EMISSION CHECK

Never look into the laser diode emission from right above when checking it for adjustment. It is feared that you will lose your sight.

If the optical pick-up block is defective, please replace the whole optical pick-up block.

Never turn the semi-fixed resistor located at the side of optical pick-up block.

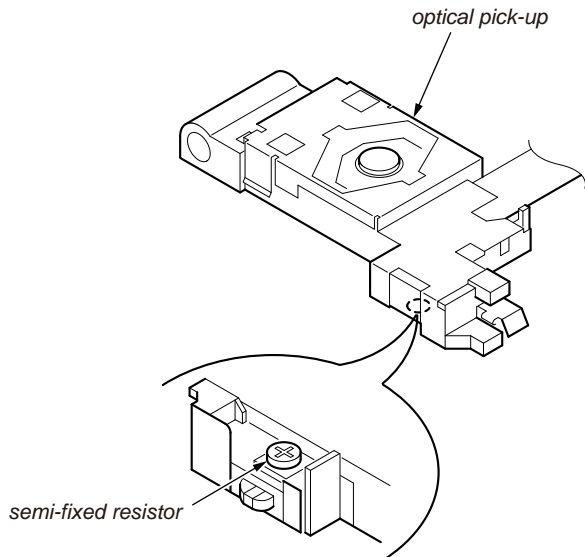

UNLEADED SOLDER

Boards requiring use of unleaded solder are printed with the lead-free mark (LF) indicating the solder contains no lead.

(Caution: Some printed circuit boards may not come printed with the lead free mark due to their particular size)

LF : LEAD FREE MARK

Unleaded solder has the following characteristics.

- Unleaded solder melts at a temperature about 40 °C higher than ordinary solder.
Ordinary soldering irons can be used but the iron tip has to be applied to the solder joint for a slightly longer time.
Soldering irons using a temperature regulator should be set to about 350 °C.
Caution: The printed pattern (copper foil) may peel away if the heated tip is applied for too long, so be careful!
- Strong viscosity
Unleaded solder is more viscous (sticky, less prone to flow) than ordinary solder so use caution not to let solder bridges occur such as on IC pins, etc.
- Usable with ordinary solder
It is best to use only unleaded solder but unleaded solder may also be added to ordinary solder.

REPLACING THE LITHIUM BATTERY OF THE REMOTE COMMANDER (Except AEP, UK and HK models)

Under normal conditions, the battery will last approximately 1 year. (The service life may be shorter, depending on the conditions of use.)

When the battery becomes weak, the range of the remote commander becomes shorter.

CAUTION

Danger of explosion if battery is incorrectly replaced. Replaced only with the same or equivalent type.

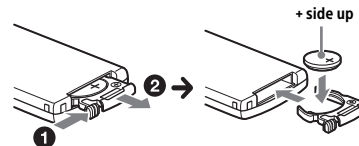

Notes on the lithium battery

- Keep the lithium battery out of the reach of children. Should the battery be swallowed, immediately consult a doctor.
- Wipe the battery with a dry cloth to ensure a good contact.
- Be sure to observe the correct polarity when installing the battery.
- Do not hold the battery with metallic tweezers, otherwise a short-circuit may occur.

DESTINATION ABBREVIATIONS

The following abbreviations for model destinations are used in this service manual.

- Abbreviations
 - AR : Argentina (Including for Paraguay and Uruguay) model
 - AUS : Australian model
 - CND : Canadian (Including for Puerto Rico) model
 - EA : Saudi Arabia (Including for Middle East area and African area) model
 - HK : Hong Kong model
 - KR : Korean model
 - IND : Indian model (G1280UM: MARUTI SUZUKI model)

MODEL IDENTIFICATION

Distinguish by Part No. on the bottom side of the main unit.

– Bottom view – (US, CND, AEP, UK, EA, HK and KR models)

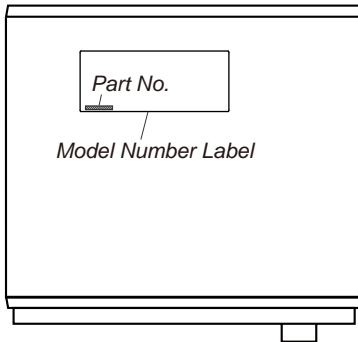

– Bottom view – (E, AR, IND and AUS models)

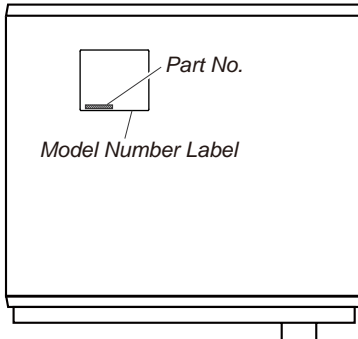

Part No.	Destination
4-596-372-0□	G1200U: AEP, UK, HK models (EUR)
4-596-373-0□	G1201U: AEP, UK models (EUR)
4-596-374-0□	G1202U: AEP, UK models (EUR)
4-596-375-0□	G1200U: E, AUS models (E)
4-596-376-0□	G1200U: AR model (AR)
4-596-377-0□	G1200U: IND model (IN)
4-596-378-0□	G1280UM: IND model (IN)
4-596-379-0□	G1200U: EA model (EA)
4-596-380-0□	G1200U: KR model (KR)
4-596-381-0□	G1201U: E model (E)
4-596-382-0□	G1201U: EA model (EA)
4-596-383-0□	G1202U: EA model (EA)
4-596-384-0□	G1201U: KR model (KR)
4-599-961-0□	G1200U: US, CND models (UC)

DESTINATION SETTING METHOD

When the complete MAIN board or system controller (IC501) is replaced, the destination setting is necessary.

1. Destination Setting

Set destination according to the procedure below.

1-1. Setting the Destination Code

1. In the state of source off (the clock is displayed on the liquid crystal display), enter the test mode by pressing the buttons in order of the [↺ 4] → [5] → [▶▶ 6] (press only the [▶▶ 6] button for two seconds).

Clock display



2. In the state in which the software main version is displayed on the liquid crystal display (refer to the following figure), enter the destination setting mode by pressing the buttons in order of the [▶▶▶▶] → [◀◀◀◀] → [PUSH ENTER/MENU] or pressing the buttons on the remote commander in order of the [▶] → [◀] → [ENTER].

(Displayed characters/values in the following figure are example)

Software main version



3. Input the alphanumeric character of 6 digits displayed on the liquid crystal display, and execute the destination setting.

Note 1: The displayed contents of the following figure is an example. The destination code is different depending on the destination of the product.

Note 2: Refer to the following “1-3. Entering the Destination Code” for operation method.

Destination code



4. The resetting operation is executed by pressing the [OFF SRC] button for 1 second after the setting ends, and the unit returns to the normal condition.

Display after reset



1-2. Display in Destination Setting Mode

Note: The displayed contents of the following figure is an example. The destination code is different depending on the destination of the product.

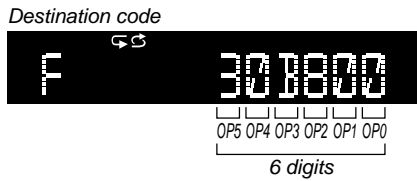

1-3. Entering the Destination Code

- **Method of operation by main unit**

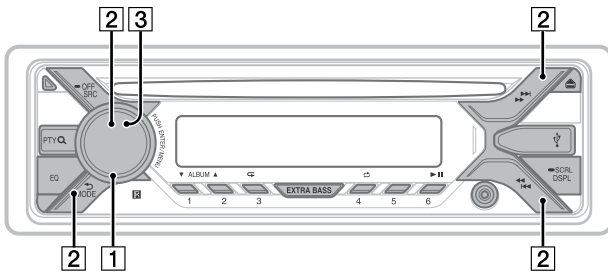

1. Rotate the control dial, and select the alphanumeric character of "0 to F".
2. The digit advances by pressing the [PUSH ENTER/MENU] or [▶▶▶▶] button.
The digit returns by pressing the [MODE ◀] or [◀◀◀◀] button.
3. The setting is completed by pressing the [PUSH ENTER/MENU] button at the state of cursor position "OP0", then the display turns off, the initialization operation is done, and the display returns to the clock display.

- **Method of operation by remote commander (Except AEP, UK and HK models)**

Note: The model to which the remote commander is not attached can also be operated by using the remote commander.

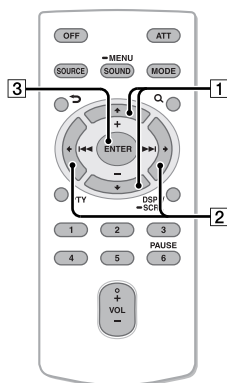

1. Press the [▲] or [▼] button, and select the alphanumeric character of "0 to F".
2. The digit advances by pressing the [▶] or [ENTER] button.
The digit returns by pressing the [◀] button.
3. The setting is completed by pressing the [ENTER] button at the state of cursor position of "OP0", then the display turns off, the initialization operation is done, and the display returns to the clock display.

1-4. Destination Code

Model	Destination	OP5	OP4	OP3	OP2	OP1	OP0
CDX-G1200U	US, CND	0	0	9	0	0	2
	AEP, UK, HK	0	0	9	0	0	1
	E, AUS	3	0	B	8	0	0
	EA	2	0	9	8	0	4
	AR	3	0	B	8	0	3
	KR	3	0	9	8	0	0
CDX-G1201U	AEP, UK	0	0	9	0	0	1
	E	3	0	B	8	0	0
	EA	2	0	9	8	0	4
CDX-G1202U	AEP, UK	0	0	9	0	0	1
	EA	2	0	9	8	0	4
CDX-G1280UM	IND	1	0	9	8	0	0

2. Confirmation After Destination Setting

Execute the following operation after completing the destination setting, and confirm a correct destination was set.

Destination setting checking method:

1. In the state of source off (the clock is displayed on the liquid crystal display), enter the test mode by pressing the buttons in order of the [◀ 4] → [5] → [▶▶▶▶ 6] (press only the [▶▶▶▶ 6] button for two seconds).

Clock display



2. In the state in which the software main version is displayed on the liquid crystal display (refer to the following figure), enter the destination setting value display mode by pressing the [▶ SCRL DSPL] button twice (software main version → software DSP version → destination code).
(Displayed characters/values in the following figure are example)

Software main version



3. Confirm the alphanumeric character of 6 digits on the liquid crystal display is a value correctly input.

Note: The displayed contents of the following figure is an example. The destination code is different depending on the destination of the product.

Destination code

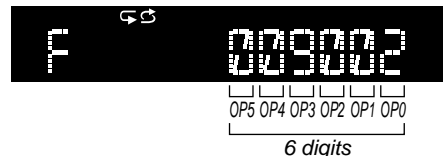

4. The resetting operation is executed by pressing the [▶ OFF SRC] button for 1 second after the confirming ends, and the unit returns to the normal condition.

Display after reset



NOTE OF REPLACING THE IC001 AND IC1301 ON THE MAIN BOARD

IC001 and IC1301 on the MAIN board cannot replace with single. When these parts are damaged, replace the complete mounted board.

NOTE OF REPLACING THE KEY BOARD

When the KEY board is defective, replace the FRONT PANEL OVERALL ASSY (Ref. No. FP1).

TEST DISCS

Use following TEST DISC (for CD) when this unit confirms the operation and checks it.

<u>Part No.</u>	<u>Description</u>
3-702-101-01	DISC (YEDS-18), TEST
4-225-203-01	DISC (PATD-012), TEST

NOTE OF PERFORMING THE OPERATION CHECK

When performing the operation check in the state that is removed the CD mechanism deck from the main unit, it is necessary to use a long flexible flat cable.

When performing the operation check, use following flexible flat cable.

<u>Part No.</u>	<u>Description</u>
1-846-819-31	CABLE FLEXIBLE FLAT (27 CORE) (Length: 150 mm)

CANCELING THE DEMO MODE

You can cancel the demonstration display which appears when the source is off and the clock is displayed.

- 1 Press **MENU**, rotate the control dial to select **[GENERAL]**, then press it.
- 2 Rotate the control dial to select **[SET DEMO]**, then press it.
- 3 Rotate the control dial to select **[SET DEMO-OFF]**, then press it.
The setting is complete.
- 4 Press **↩ (back)** twice.
The display returns to normal reception/play mode.

CLEANING THE CONNECTORS

The unit may not function properly if the connectors between the unit and the front panel are not clean. In order to prevent this, detach the front panel and clean the connectors with a cotton swab. Do not apply too much force. Otherwise, the connectors may be damaged.

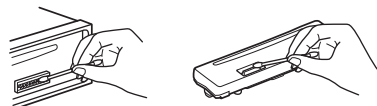

Notes

- For safety, turn off the ignition before cleaning the connectors, and remove the key from the ignition switch.
- Never touch the connectors directly with your fingers or with any metal device.

(US, CND)

Connection/Installation

Cautions

- Run all ground (earth) leads to a common ground (earth) point.
- Do not get the leads trapped under a screw, or caught in moving parts (e.g., seat raiting).
- Before making connections, turn the car ignition off to avoid short circuits.
- Connect the **yellow** and **red** power supply leads only after all other leads have been connected.
- Be sure to insulate any loose unconnected leads with electrical tape for safety.

Precautions

- Choose the installation location carefully so that the unit will not interfere with normal driving operations.
- Avoid installing the unit in areas subject to dust, dirt, excessive vibration, or high temperature, such as in direct sunlight or near heater ducts.
- Use only the supplied mounting hardware for a safe and secure installation.

Note on the power supply lead (yellow)

When connecting this unit in combination with other stereo components, the amperage rating of the car circuit to which the unit is connected must be higher than the sum of each component's fuse amperage rating.

Mounting angle adjustment

Adjust the mounting angle to less than 45°.

Connection

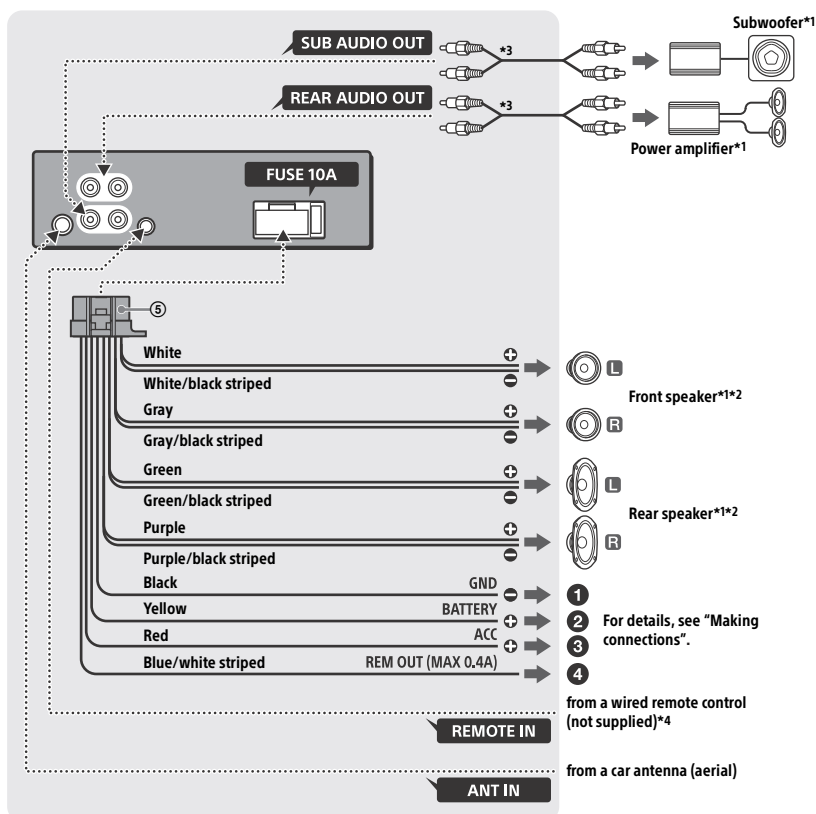

*1 Not supplied

*2 Speaker impedance: 4 Ω – 8 Ω × 4

*3 RCA pin cord (not supplied)

*4 Depending on the type of car, use an adaptor for a wired remote control (not supplied). For details on using the wired remote control, see "Using the wired remote control".

Making connections

- To a common ground (earth) point**
First connect the black ground (earth) lead, then connect the yellow and red power supply leads.
- To the +12 V power terminal which is energized at all times**
Be sure to first connect the black ground (earth) lead to a common ground (earth) point.
- To the +12 V power terminal which is energized when the ignition switch is set to the accessory position**
If there is no accessory position, connect to the +12 V power (battery) terminal which is energized at all times.
Be sure to first connect the black ground (earth) lead to a common ground (earth) point.
- To the power antenna (aerial) control lead or the power supply lead of the antenna (aerial) booster**
It is not necessary to connect this lead if there is no power antenna (aerial) or antenna (aerial) booster, or with a manually-operated telescopic antenna (aerial).
To AMP REMOTE IN of an optional power amplifier
This connection is only for amplifiers and a power antenna (aerial). Connecting any other system may damage the unit.

Subwoofer Easy Connection

You can use a subwoofer without a power amplifier when it is connected to a rear speaker cord.

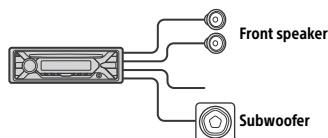

Note

Use a subwoofer with an impedance of 4 Ω to 8 Ω, and with adequate power handling capacities to avoid damage.

Memory hold connection

When the yellow power supply lead is connected, power will always be supplied to the memory circuit even when the ignition switch is turned off.

Speaker connection

- Before connecting the speakers, turn the unit off.
- Use speakers with an impedance of 4 Ω to 8 Ω, and with adequate power handling capacities to avoid damage.

Installation

Removing the protection collar and the bracket

Before installing the unit, remove the protection collar ③ and the bracket ① from the unit.

- 1 Pinch both edges of the protection collar ③, then pull it out.

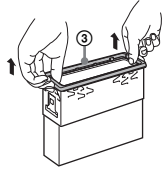

- 2 Insert both release keys ② until they click, and pull down the bracket ①, then pull up the unit to separate.

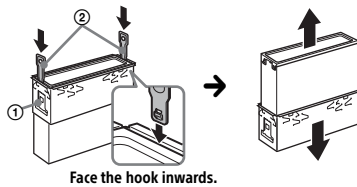

Note
Before installing this unit, remove the screw and box on the back of the unit. Do not use the previous parts you removed when installing the unit.

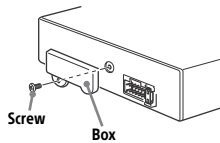

Mounting the unit in the dashboard

- Before installing, make sure the catches on both sides of the bracket ① are bent inwards 2 mm (3/32 in).
- For Japanese cars, see "Mounting the unit in a Japanese car".

- 1 Position the bracket ① inside the dashboard, then bend the claws outward for a tight fit.

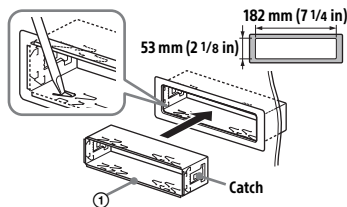

- 2 Mount the unit onto the bracket ①, then attach the protection collar ③.

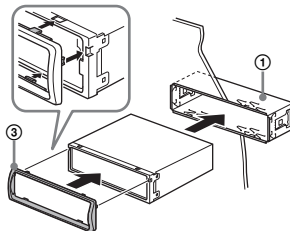

- Notes**
- If the catches are straight or bent outwards, the unit will not be installed securely and may spring out.
 - Make sure the 4 catches on the protection collar ③ are properly engaged in the slots of the unit.

Mounting the unit in a Japanese car

You may not be able to install this unit in some makes of Japanese cars. In such a case, consult your Sony dealer.

TOYOTA

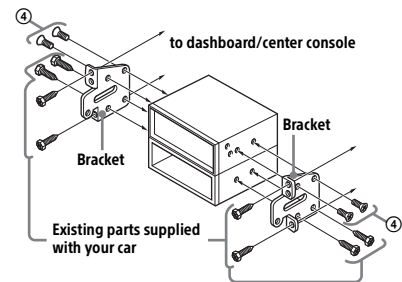

NISSAN

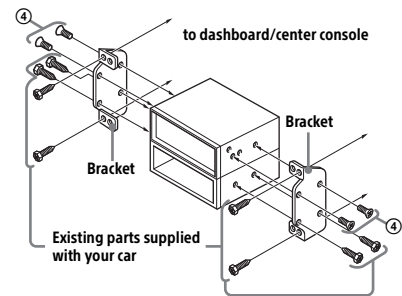

Note
To prevent malfunction, install only with the supplied screws ④.

Fuse replacement

When replacing the fuse, be sure to use one matching the amperage rating stated on the original fuse. If the fuse blows, check the power connection and replace the fuse. If the fuse blows again after replacement, there may be an internal malfunction. In such a case, consult your nearest Sony dealer.

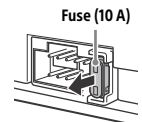

(AEP, UK, HK)

Connection/Installation

Cautions

- Run all ground (earth) leads to a common ground (earth) point.
- Do not get the leads trapped under a screw, or caught in moving parts (e.g., seat raiting).
- Before making connections, turn the car ignition off to avoid short circuits.
- Connect the power supply lead ⑥ to the unit and speakers before connecting it to the auxiliary power connector.
- Be sure to insulate any loose unconnected leads with electrical tape for safety.

Precautions

- Choose the installation location carefully so that the unit will not interfere with normal driving operations.
- Avoid installing the unit in areas subject to dust, dirt, excessive vibration, or high temperature, such as in direct sunlight or near heater ducts.
- Use only the supplied mounting hardware for a safe and secure installation.

Note on the power supply lead (yellow)

When connecting this unit in combination with other stereo components, the amperage rating of the car circuit to which the unit is connected must be higher than the sum of each component's fuse amperage rating.

Mounting angle adjustment

Adjust the mounting angle to less than 45°.

Making connections

If you have a power antenna (aerial) without a relay box, connecting this unit with the supplied power supply lead ⑥ may damage the antenna (aerial).

① To the car's speaker connector

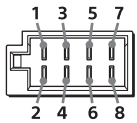

1	Rear speaker (right)	+	Purple
2		-	Purple/black striped
3	Front speaker (right)	+	Gray
4		-	Gray/black striped
5	Front speaker (left)	+	White
6		-	White/black striped
7	Rear speaker (left)	+	Green
8		-	Green/black striped

Connection

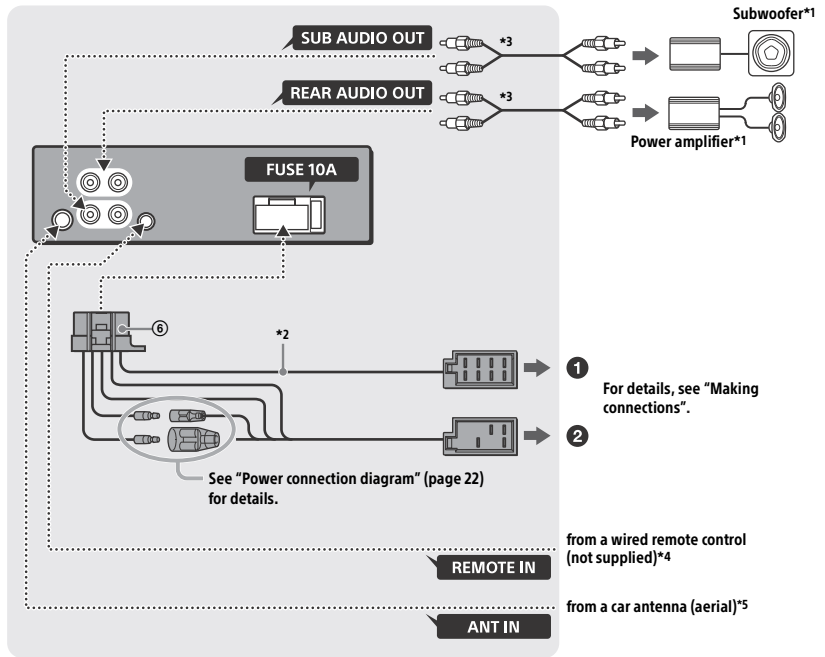

- *1 Not supplied
- *2 Speaker impedance: 4 Ω – 8 Ω × 4
- *3 RCA pin cord (not supplied)
- *4 Depending on the type of car, use an adaptor for a wired remote control (not supplied). For details on using the wired remote control, see "Using the wired remote control".
- *5 Depending on the type of car, use an adaptor (not supplied) if the antenna connector does not fit.

② To the car's power connector

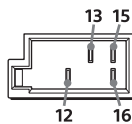

12	continuous power supply	Yellow
13	power antenna (aerial) /power amplifier control (REM OUT)	Blue/white striped
15	switched power supply	Red
16	ground (earth)	Black

Subwoofer Easy Connection

You can use a subwoofer without a power amplifier when it is connected to a rear speaker cord.

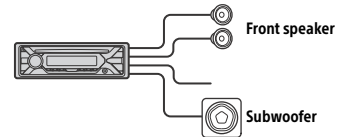

Notes

- Preparation of the rear speaker cords is required.
- Use a subwoofer with an impedance of 4 Ω to 8 Ω, and with adequate power handling capacities to avoid damage.

Memory hold connection

When the yellow power supply lead is connected, power will always be supplied to the memory circuit even when the ignition switch is turned off.

Speaker connection

- Before connecting the speakers, turn the unit off.
- Use speakers with an impedance of 4 Ω to 8 Ω, and with adequate power handling capacities to avoid damage.

Power connection diagram

Make sure your car's auxiliary power connector, and match the connections of cords correctly depending on the car.

Auxiliary power connector

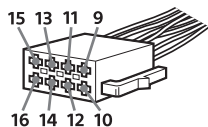

Common connection

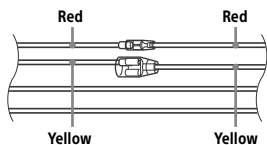

12	continuous power supply	Yellow
15	switched power supply	Red

When the positions of the red and yellow leads are inverted

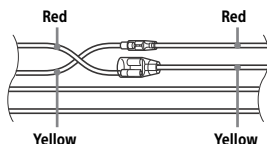

12	switched power supply	Yellow
15	continuous power supply	Red

When the car without ACC position

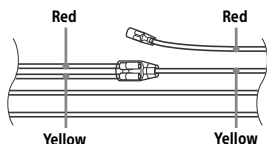

After matching the connections and switching power supply leads correctly, connect the unit to the car's power supply. If you have any questions and problems connecting your unit that are not covered in this manual, consult the car dealer.

Installation

Removing the protection collar and the bracket

Before installing the unit, remove the protection collar ③ and the bracket ① from the unit.

- 1 Pinch both edges of the protection collar ③, then pull it out.

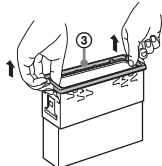

- 2 Insert both release keys ② until they click, and pull down the bracket ①, then pull up the unit to separate.

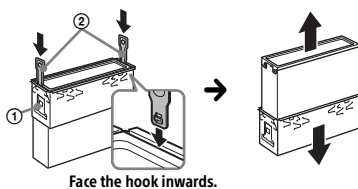

Mounting the unit in the dashboard

Before installing, make sure the catches on both sides of the bracket ① are bent inwards 2 mm (3/32 in).

- 1 Position the bracket ① inside the dashboard, then bend the claws outward for a tight fit.

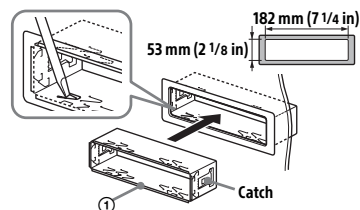

- 2 Mount the unit onto the bracket ①, then attach the protection collar ③.

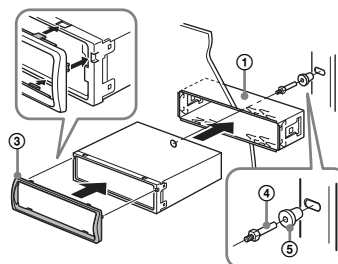

Notes

- If the catches are straight or bent outwards, the unit will not be installed securely and may spring out.
- Make sure the 4 catches on the protection collar ③ are properly engaged in the slots of the unit.

Fuse replacement

When replacing the fuse, be sure to use one matching the amperage rating stated on the original fuse. If the fuse blows, check the power connection and replace the fuse. If the fuse blows again after replacement, there may be an internal malfunction. In such a case, consult your nearest Sony dealer.

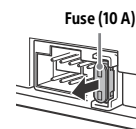

(E, EA, AR, KR, IND, AUS)

Connection/Installation

Cautions

- Run all ground (earth) leads to a common ground (earth) point.
 - Do not get the leads trapped under a screw, or caught in moving parts (e.g., seat raiting).
 - Before making connections, turn the car ignition off to avoid short circuits.
 - Connect the yellow and red power supply leads only after all other leads have been connected.
- For Argentine models: Connect the power supply lead ⑦ to the unit and speakers before connecting it to the auxiliary power connector.
- Be sure to insulate any loose unconnected leads with electrical tape for safety.

Precautions

- Choose the installation location carefully so that the unit will not interfere with normal driving operations.
- Avoid installing the unit in areas subject to dust, dirt, excessive vibration, or high temperature, such as in direct sunlight or near heater ducts.
- Use only the supplied mounting hardware for a safe and secure installation.

Note on the power supply lead (yellow)

When connecting this unit in combination with other stereo components, the amperage rating of the car circuit to which the unit is connected must be higher than the sum of each component's fuse amperage rating.

Mounting angle adjustment

Adjust the mounting angle to less than 45°.

*1 Not supplied
 *2 Speaker impedance: 4 Ω – 8 Ω × 4
 *3 RCA pin cord (not supplied)
 *4 Depending on the type of car, use an adaptor for a wired remote control (not supplied). For details on using the wired remote control, see "Using the wired remote control".
 *5 Note for the antenna (aerial) connecting (Argentine models only):
 If your car antenna (aerial) is an ISO (International Organization for Standardization) type, use the supplied adaptor ⑥ to connect it.

Making connections

- To a common ground (earth) point**
 First connect the black ground (earth) lead, then connect the yellow and red power supply leads.
- To the +12 V power terminal which is energized at all times**
 Be sure to first connect the black ground (earth) lead to a common ground (earth) point.
- To the +12 V power terminal which is energized when the ignition switch is set to the accessory position**
 If there is no accessory position, connect to the +12 V power (battery) terminal which is energized at all times.
 Be sure to first connect the black ground (earth) lead to a common ground (earth) point.

Connection

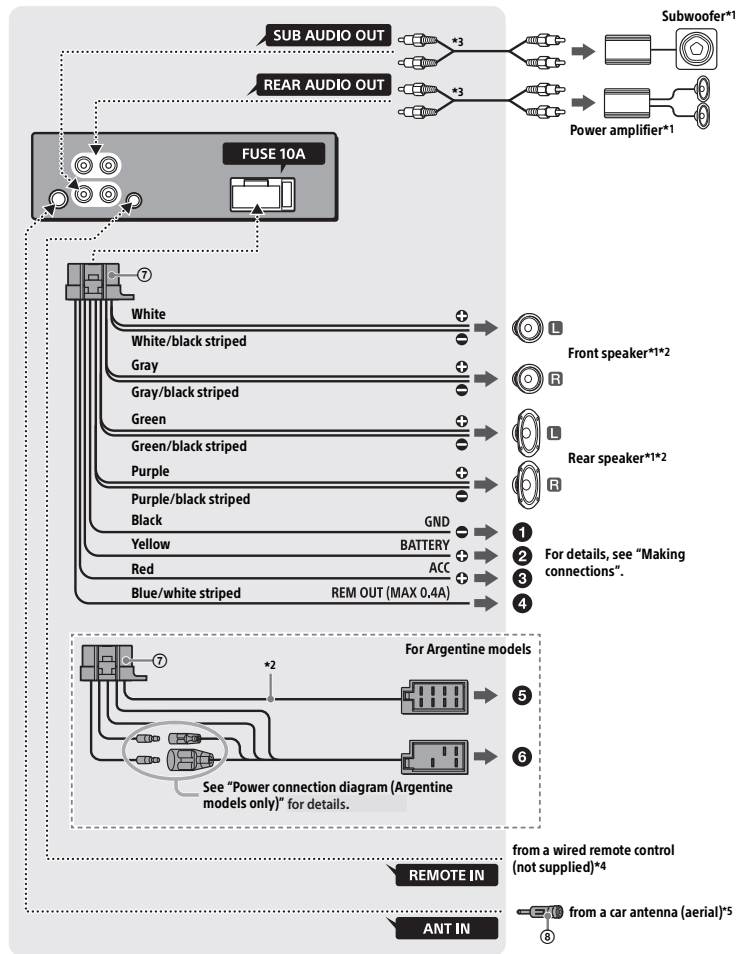

- To the power antenna (aerial) control lead or the power supply lead of the antenna (aerial) booster**
 It is not necessary to connect this lead if there is no power antenna (aerial) or antenna (aerial) booster, or with a manually-operated telescopic antenna (aerial).
To AMP REMOTE IN of an optional power amplifier
 This connection is only for amplifiers and a power antenna (aerial). Connecting any other system may damage the unit.

For Argentine models:
 If you have a power antenna (aerial) without a relay box, connecting this unit with the supplied power supply lead ⑦ may damage the antenna (aerial).

- To the car's speaker connector**

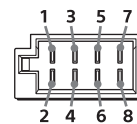

1	Rear speaker (right)	⊕	Purple
2		⊖	Purple/black striped
3	Front speaker (right)	⊕	Gray
4		⊖	Gray/black striped
5	Front speaker (left)	⊕	White
6		⊖	White/black striped
7	Rear speaker (left)	⊕	Green
8		⊖	Green/black striped

- To the car's power connector**

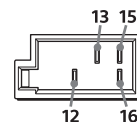

12	continuous power supply	Yellow
13	power antenna (aerial) / power amplifier control (REM OUT)	Blue/white striped
15	switched power supply	Red
16	ground (earth)	Black

Subwoofer Easy Connection

You can use a subwoofer without a power amplifier when it is connected to a rear speaker cord.

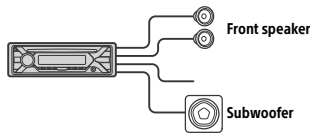

Notes

- Preparation of the rear speaker cords is required (Argentine models only).
- Use a subwoofer with an impedance of 4 Ω to 8 Ω, and with adequate power handling capacities to avoid damage.

Memory hold connection

When the yellow power supply lead is connected, power will always be supplied to the memory circuit even when the ignition switch is turned off.

Speaker connection

- Before connecting the speakers, turn the unit off.
- Use speakers with an impedance of 4 Ω to 8 Ω, and with adequate power handling capacities to avoid damage.

Power connection diagram (Argentine models only)

Make sure your car's auxiliary power connector, and match the connections of cords correctly depending on the car.

Auxiliary power connector

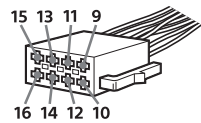

Mounting the unit in the dashboard

- Before installing, make sure the catches on both sides of the bracket ① are bent inwards 2 mm (3/32 in).
- For Japanese cars, see "Mounting the unit in a Japanese car".

- 1 Position the bracket ① inside the dashboard, then bend the claws outward for a tight fit.

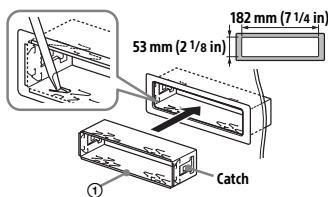

- 2 Mount the unit onto the bracket ①, then attach the protection collar ③.

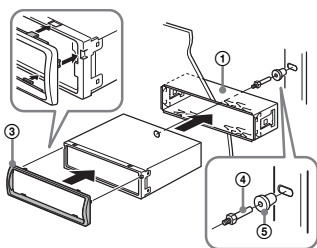

Notes

- If the catches are straight or bent outwards, the unit will not be installed securely and may spring out.
- Make sure the 4 catches on the protection collar ③ are properly engaged in the slots of the unit.

Common connection

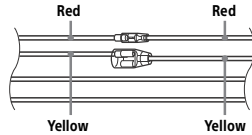

12	continuous power supply	Yellow
15	switched power supply	Red

When the positions of the red and yellow leads are inverted

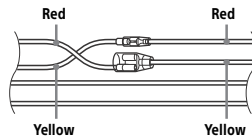

12	switched power supply	Yellow
15	continuous power supply	Red

When the car without ACC position

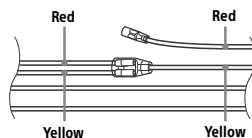

After matching the connections and switching power supply leads correctly, connect the unit to the car's power supply. If you have any questions and problems connecting your unit that are not covered in this manual, consult the car dealer.

Installation

Removing the protection collar and the bracket

Before installing the unit, remove the protection collar ③ and the bracket ① from the unit.

- 1 Pinch both edges of the protection collar ③, then pull it out.

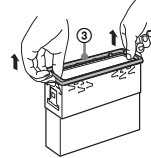

- 2 Insert both release keys ② until they click, and pull down the bracket ①, then pull up the unit to separate.

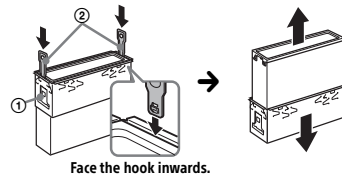

Fuse replacement

When replacing the fuse, be sure to use one matching the amperage rating stated on the original fuse. If the fuse blows, check the power connection and replace the fuse. If the fuse blows again after replacement, there may be an internal malfunction. In such a case, consult your nearest Sony dealer.

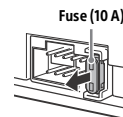

Mounting the unit in a Japanese car

You may not be able to install this unit in some makes of Japanese cars. In such a case, consult your Sony dealer.

TOYOTA

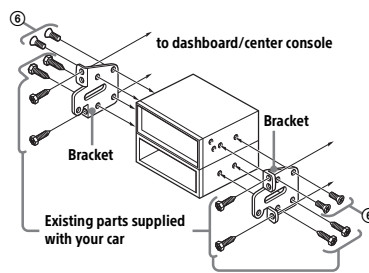

NISSAN

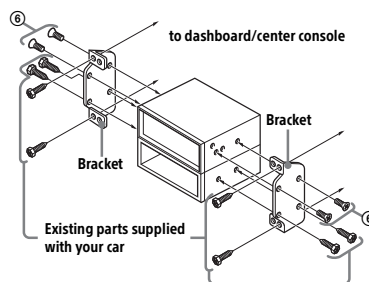

Note

To prevent malfunction, install only with the supplied screws ⑥.

CDX-G1200U/G1201U/G1202U/G1280UM

SECTION 3 DISASSEMBLY

- This set can be disassembled in the order shown below.

3-1. DISASSEMBLY FLOW

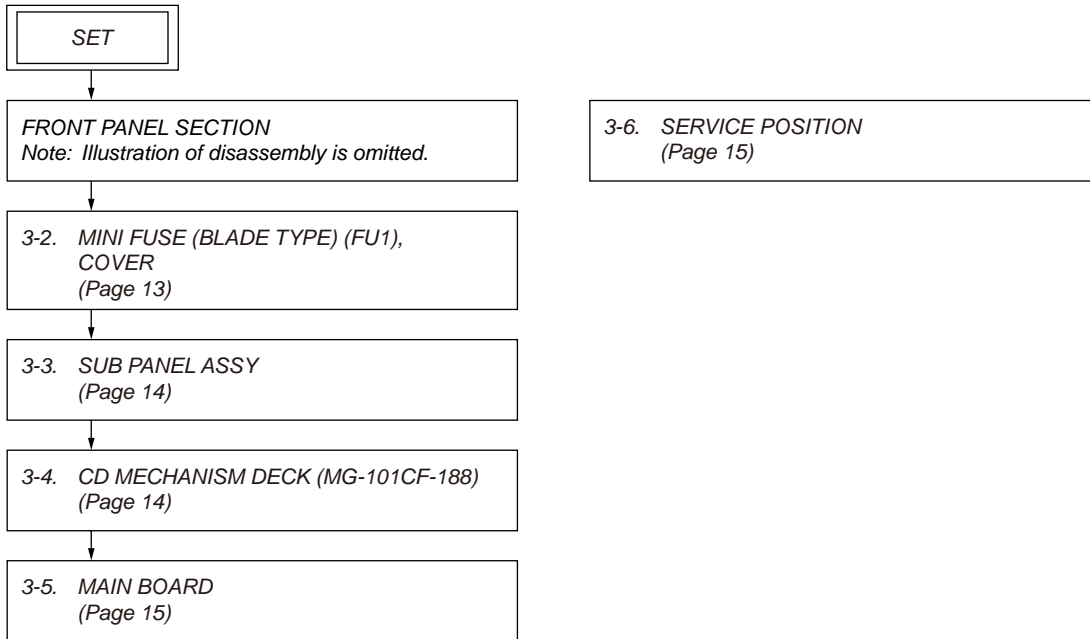

Note: Follow the disassembly procedure in the numerical order given.

3-2. MINI FUSE (BLADE TYPE) (FU1), COVER

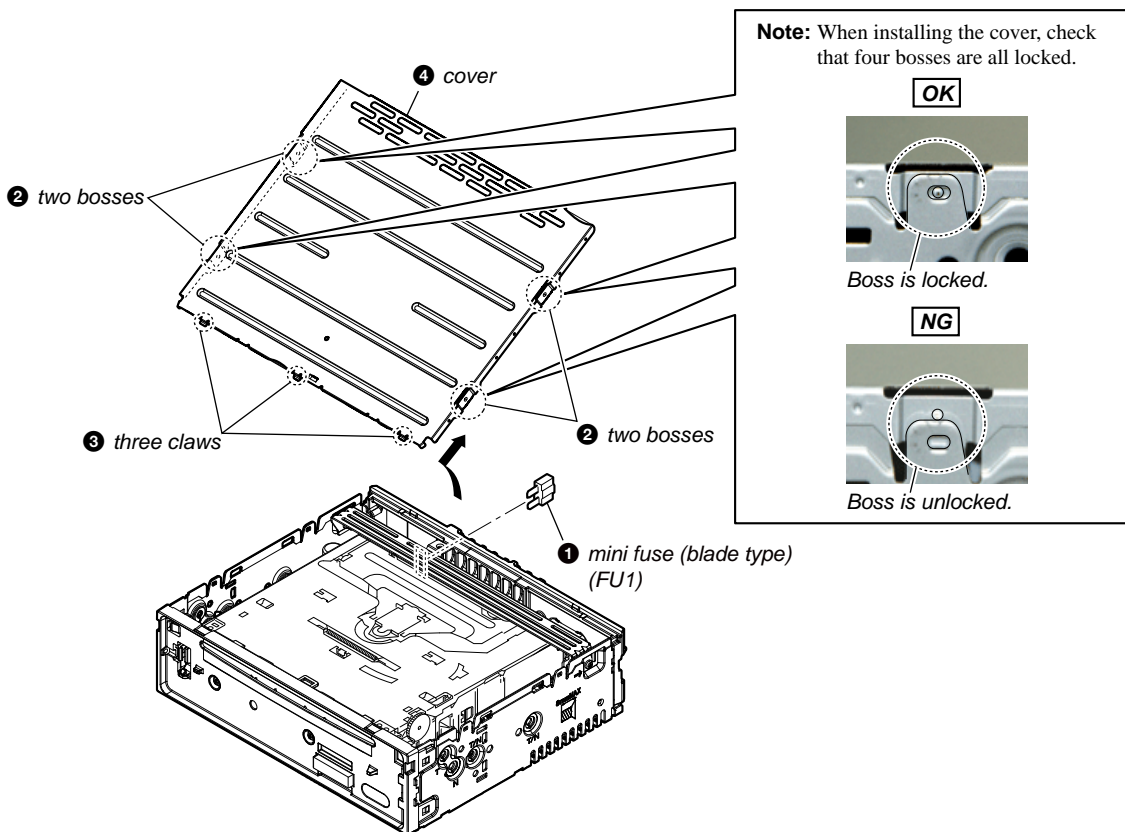

3-3. SUB PANEL ASSY

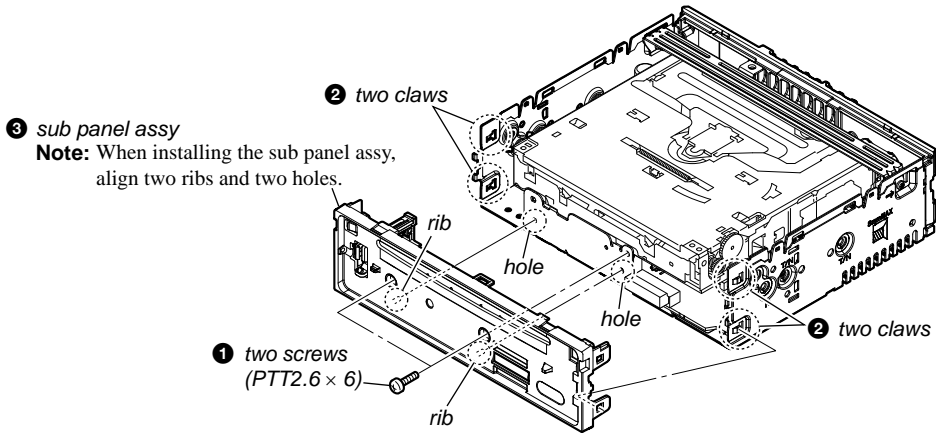

3-4. CD MECHANISM DECK (MG-101CF-188)

Note 1: The service manual of the mechanism deck, used in this model has been issued in a separate volume. Please refer to the service manual of the MG-101 series for the mechanism deck information.

• How to install the CD mechanism block

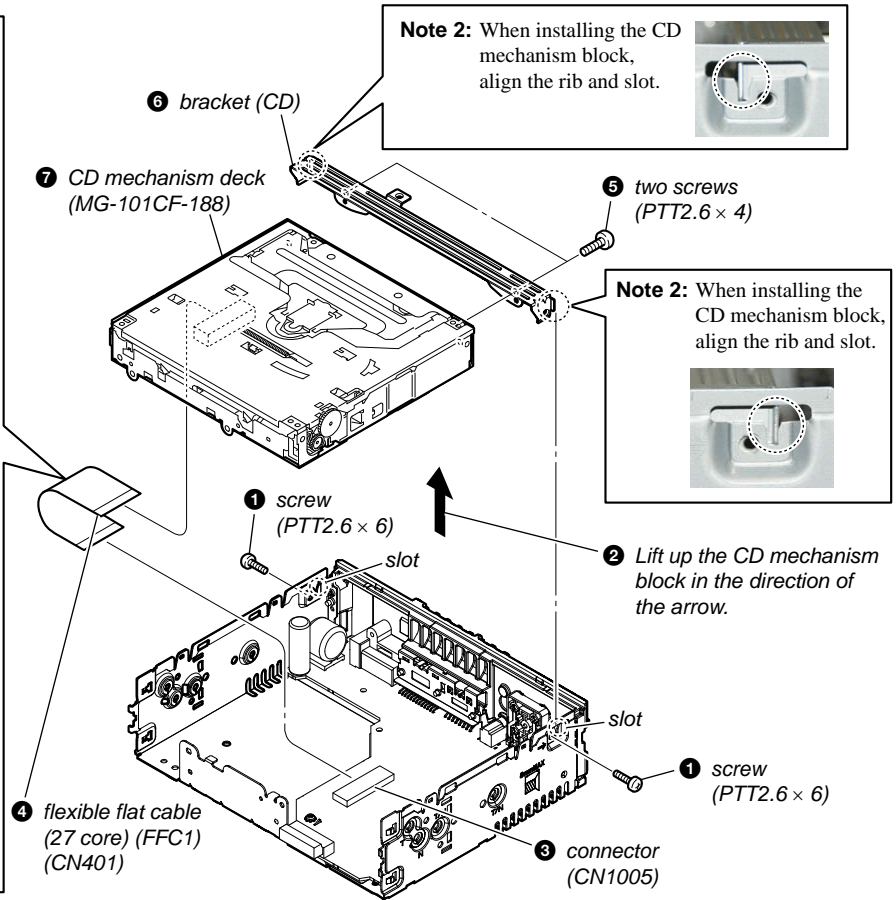
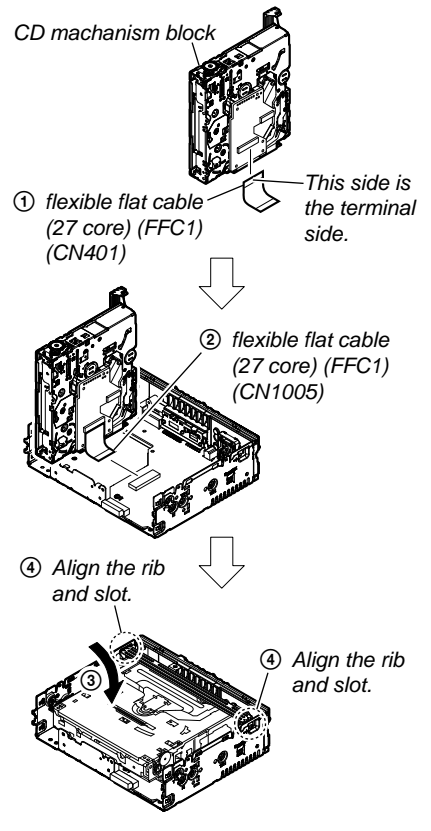

Note 3: When installing the flexible flat cable (27 core) (FFC1), insert straight to the connector and lock a connector completely. No slanting after insertion.

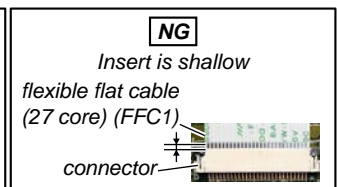
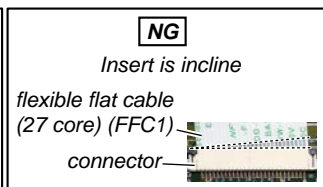
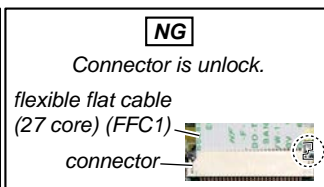
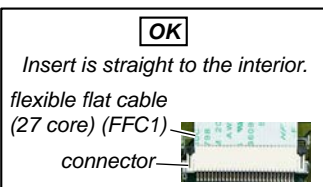

3-5. MAIN BOARD

Note: When the complete MAIN board is replaced, the destination setting is necessary. Refer to "DESTINATION SETTING METHOD" on page 4.

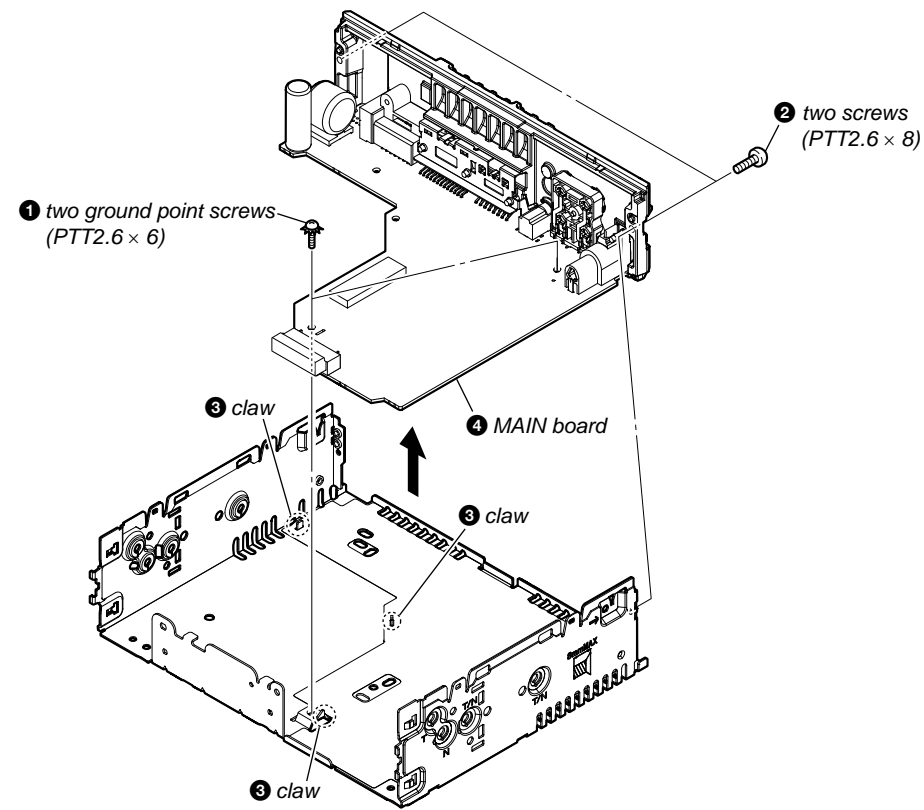

3-6. SERVICE POSITION

Note 1: The service position below cannot be performed with the flexible flat cable (length: 80 mm) used with the unit. Refer to "NOTE OF PERFORMING THE OPERATION CHECK" in the servicing notes, and use a long flexible flat cable (length: 150 mm).

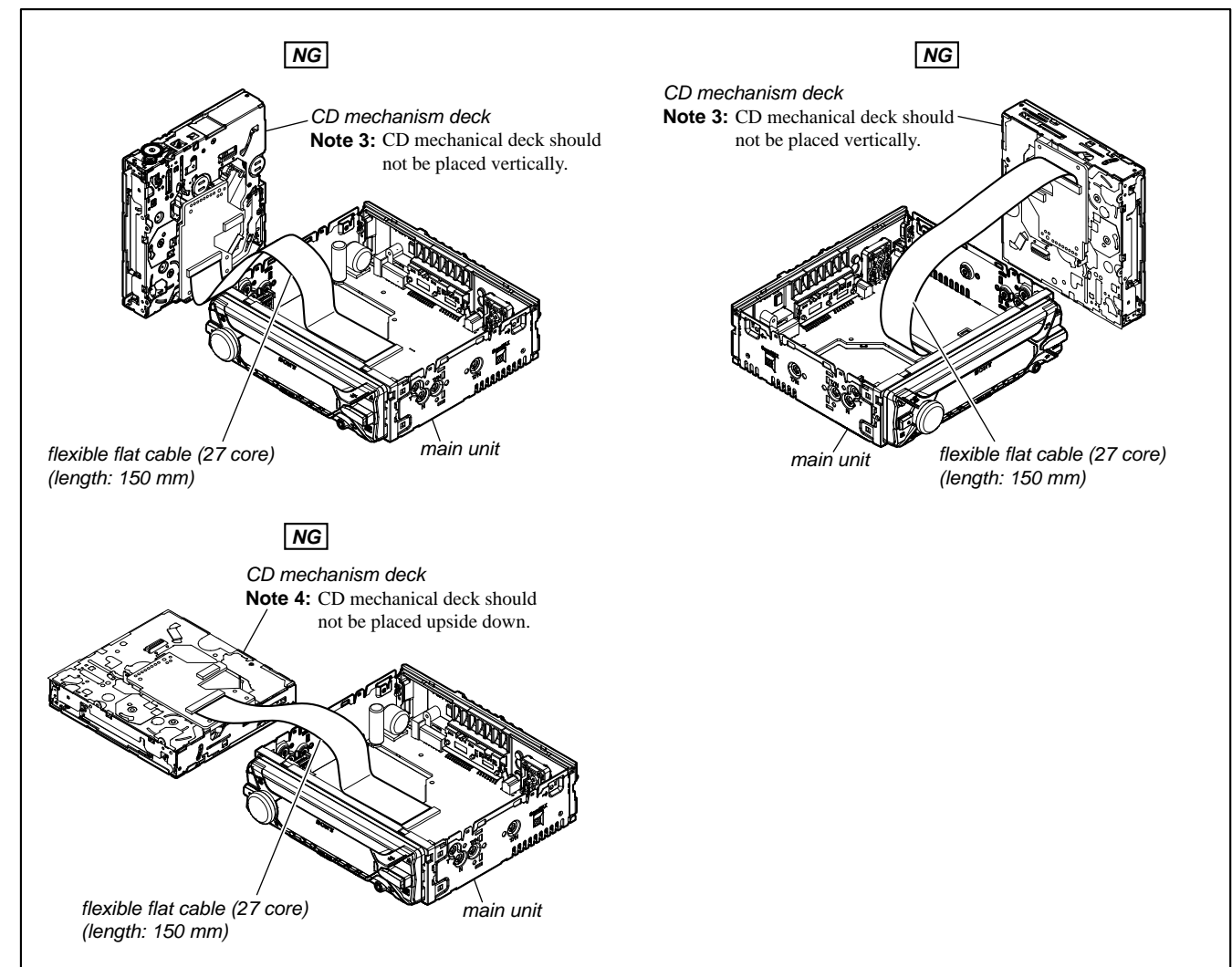
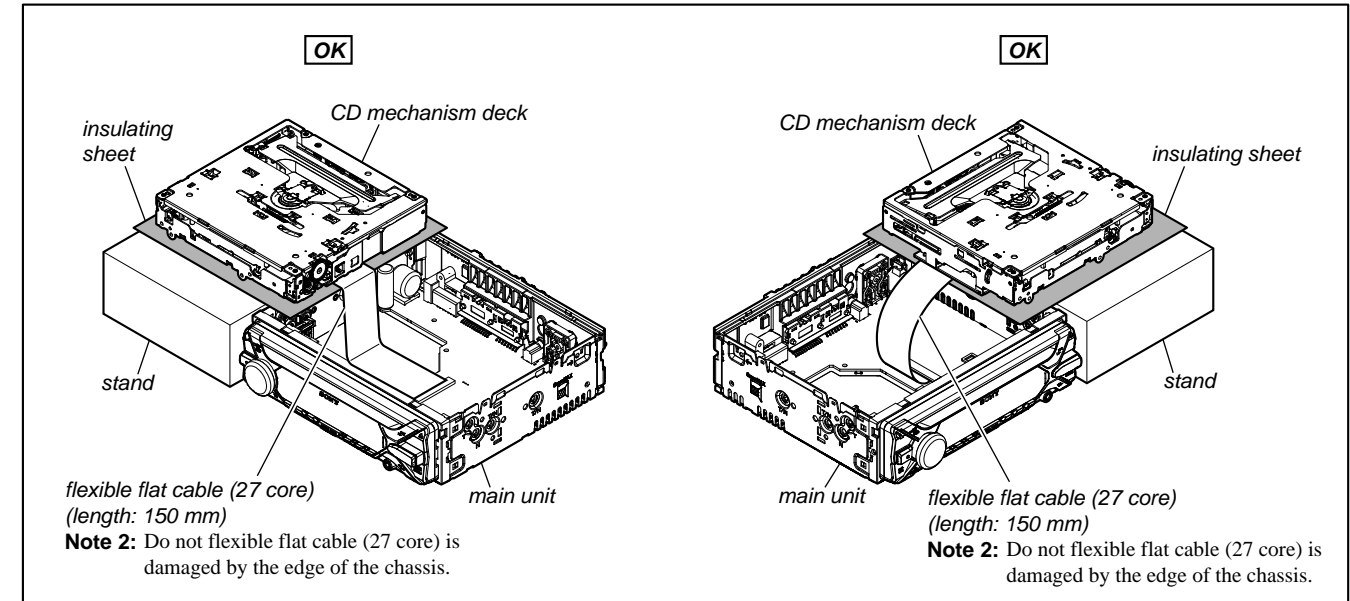

CDX-G1200U/G1201U/G1202U/G1280UM
SECTION 4
DIAGRAMS

4-1. BLOCK DIAGRAM - MAIN Section -

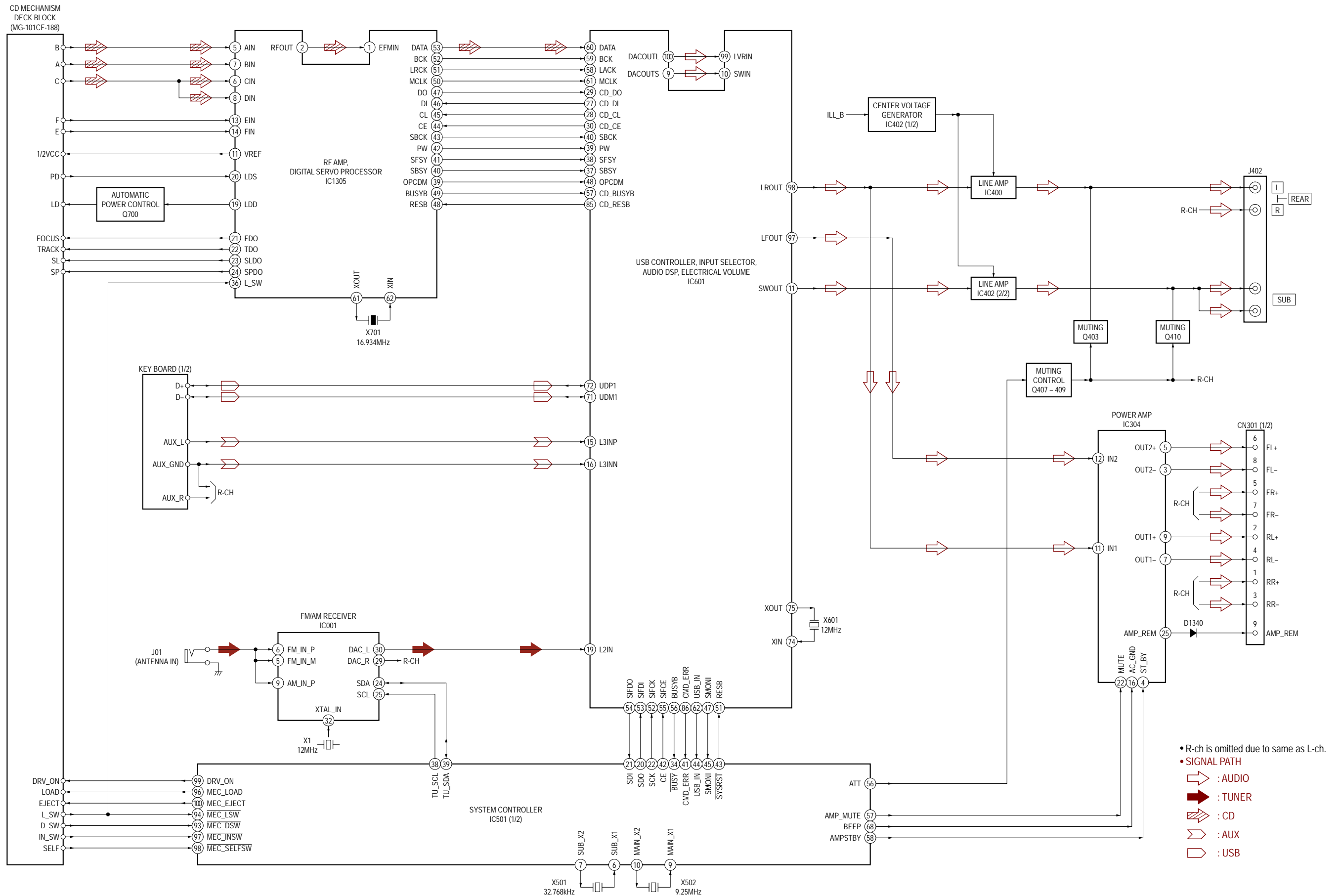

- R-ch is omitted due to same as L-ch.
- SIGNAL PATH
- ➡ : AUDIO
- ➡ : TUNER
- ➡ : CD
- ➡ : AUX
- ➡ : USB

4-2. BLOCK DIAGRAM - PANEL/POWER SUPPLY Section -

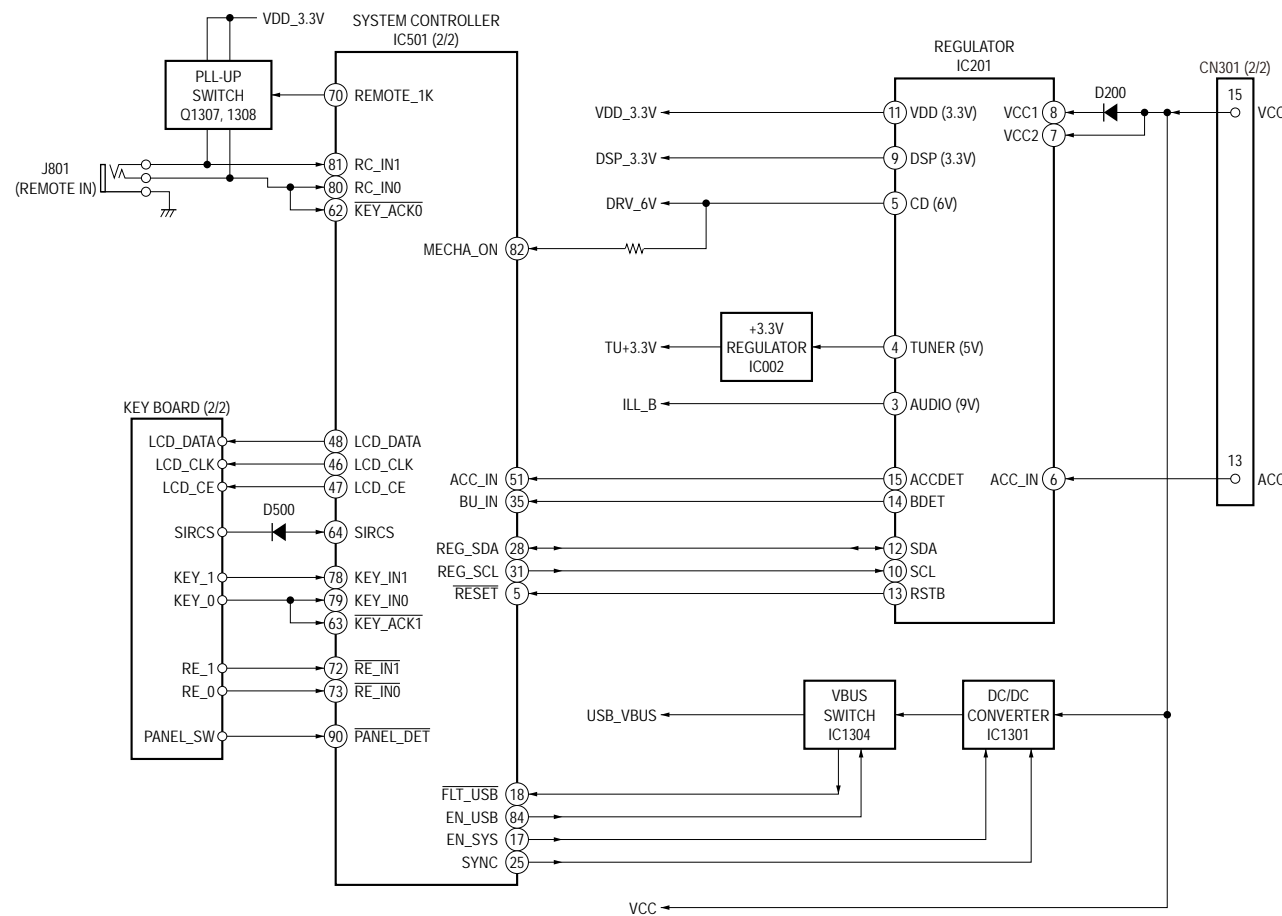

THIS NOTE IS COMMON FOR PRINTED WIRING BOARDS AND SCHEMATIC DIAGRAMS.
(In addition to this, the necessary note is printed in each block.)

For Printed Wiring Boards.

Note:

- : Parts extracted from the component side.
- : Parts extracted from the conductor side.
- △ : Internal component.
- : Pattern from the side which enables seeing. (The other layers' patterns are not indicated.)

Caution:

Pattern face side: Parts on the pattern face side seen (Conductor Side) from the pattern face are indicated.
Parts face side: Parts on the parts face side seen from (Component Side) the parts face are indicated.

- Indication of transistor.

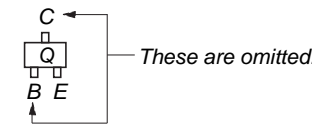

Note: When the complete MAIN board is replaced, the destination setting is necessary. Refer to "DESTINATION SETTING METHOD" on page 4.

For Schematic Diagrams.

Note:

- All capacitors are in μF unless otherwise noted. (p: pF) 50 WV or less are not indicated except for electrolytics and tantalums.
- All resistors are in Ω and 1/4 W or less unless otherwise specified.
- △ : Internal component.
- □ : Panel designation.

Note: The components identified by mark △ or dotted line with mark △ are critical for safety. Replace only with part number specified.

Note: Les composants identifiés par une marque △ sont critiques pour la sécurité. Ne les remplacer que par une pièce portant le numéro spécifié.

- — : B+ Line.
- Power voltages is dc 14.4V and fed with regulated dc power supply from ACC and BATT cords.
- Voltages and waveforms are dc with respect to ground under no-signal (detuned) conditions.
 - no mark: TUNER (FM)
 - []: TUNER (AM)
 - (): CD PLAY
- Voltages are taken with VOM (Input impedance 10 M Ω). Voltage variations may be noted due to normal production tolerances.
- Waveforms are taken with a oscilloscope. Voltage variations may be noted due to normal production tolerances.
- Circled numbers refer to waveforms.
- Signal path.
 - ◁ : AUDIO
 - ▶ : TUNER
 - ◁▶ : CD
 - ◁▶ : AUX
 - ◁▶ : USB

Note: When the complete MAIN board is replaced, the destination setting is necessary. Refer to "DESTINATION SETTING METHOD" on page 4.

4-3. PRINTED WIRING BOARDS - MAIN Section (1/2) - •  : Uses unleaded solder.

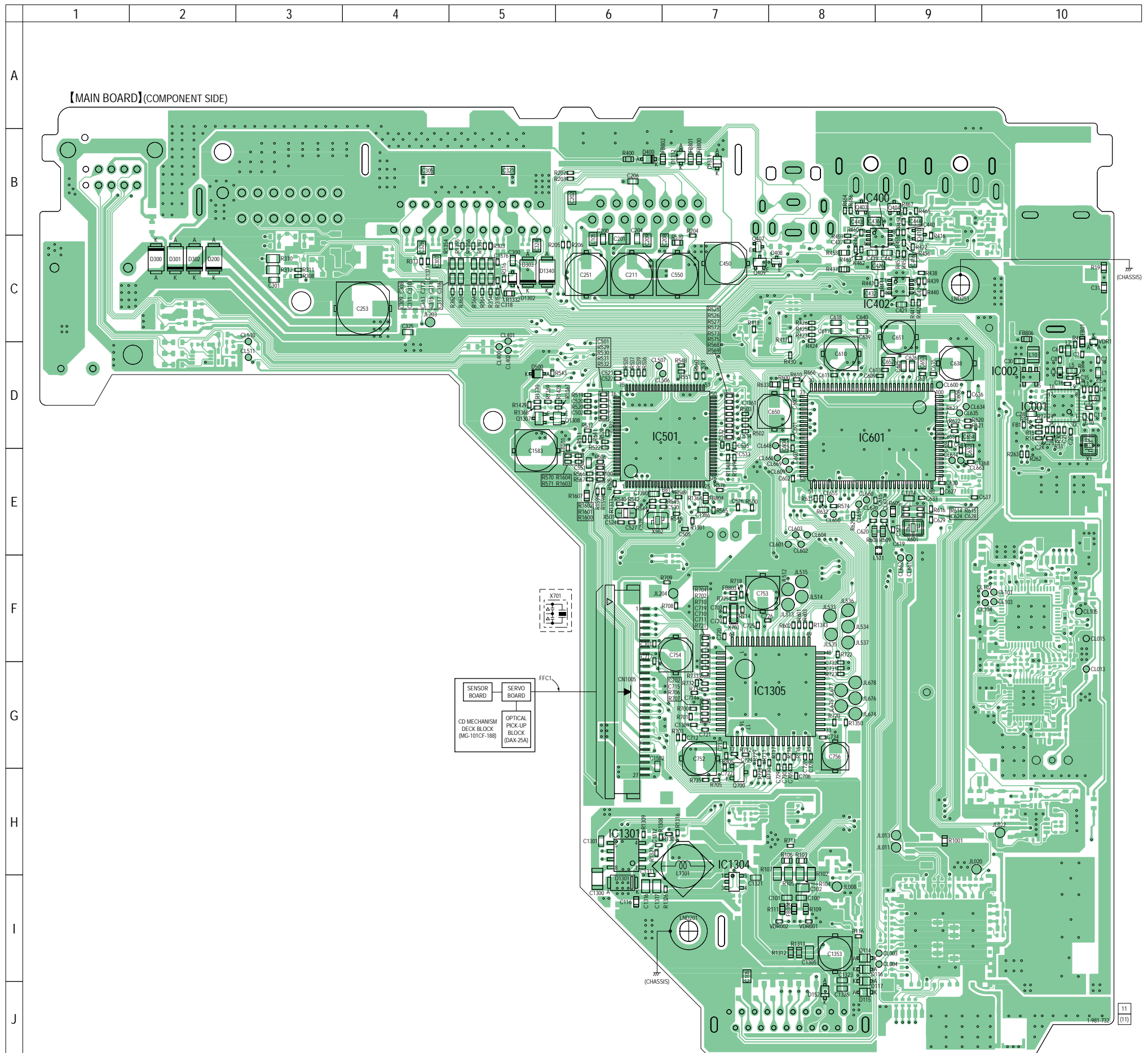

- Note 1:** When the IC501 on the MAIN board is replaced, the destination setting is necessary. Refer to "DESTINATION SETTING METHOD" on page 4.
- Note 2:** IC001 and IC1301 on the MAIN board cannot replace with single. When these parts are damaged, replace the complete mounted board.
- Note 3:** The service manual of the mechanism deck, used in this model, has been issued in a separate volume. Please refer to the service manual of the MG-101 series for the mechanism deck information.

4-5. SCHEMATIC DIAGRAM - MAIN Section (1/4) - • See page 24 for Waveforms. • See page 24 for IC Block Diagrams. • See page 26 for IC Pin Function Description.

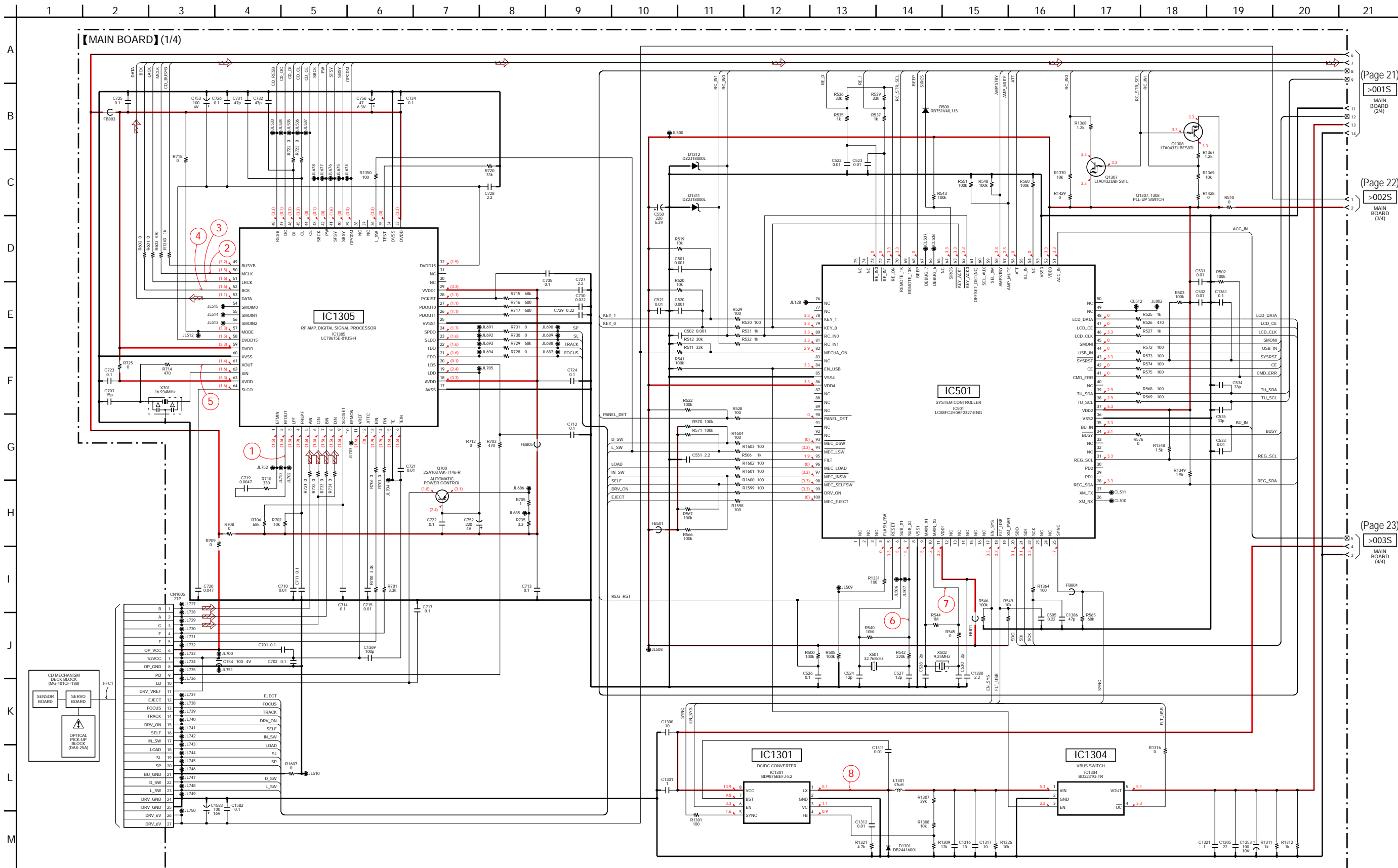

(Page 21)
>001S
MAIN BOARD (24)

(Page 22)
>002S
MAIN BOARD (34)

(Page 23)
>003S
MAIN BOARD (44)

Note 1: When the IC501 on the MAIN board is replaced, the destination setting is necessary. Refer to "DESTINATION SETTING METHOD" on page 4.

Note 2: IC1301 on the MAIN board cannot replace with single. When this part is damaged, replace the complete mounted board.

Note 3: The service manual of the mechanism deck, used in this model, has been issued in a separate volume. Please refer to the service manual of the MG-101 series for the mechanism deck information.

4-6. SCHEMATIC DIAGRAM - MAIN Section (2/4) • See page 24 for Waveforms. • See page 26 for IC Pin Function Description.

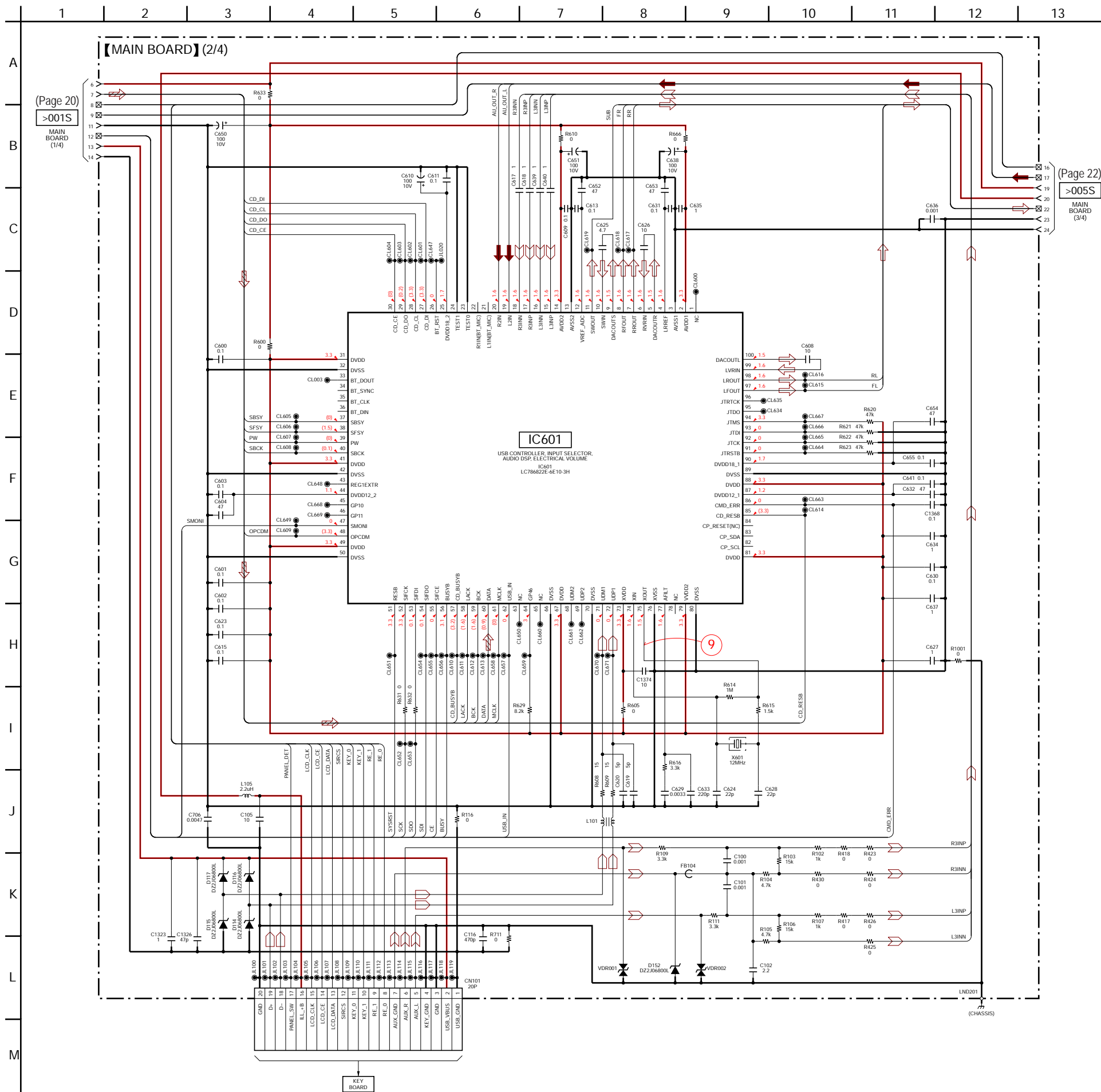

4-7. SCHEMATIC DIAGRAM - MAIN Section (3/4) - • See page 24 for Waveforms. • See page 24 for IC Block Diagrams.

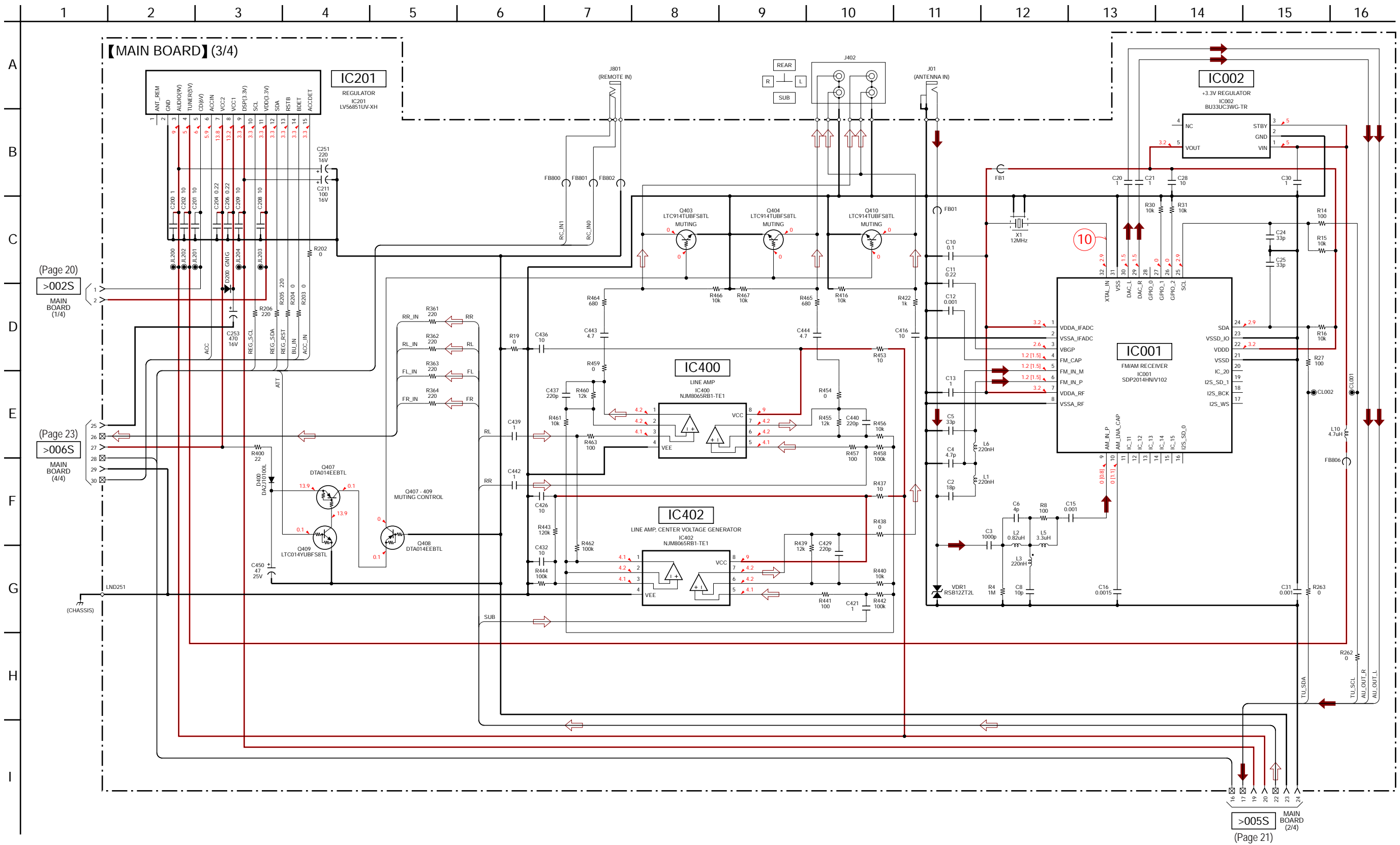

Note: IC001 on the MAIN board cannot replace with single. When this part is damaged, replace the complete mounted board.

4-8. SCHEMATIC DIAGRAM - MAIN Section (4/4) - • See page 24 for IC Block Diagrams.

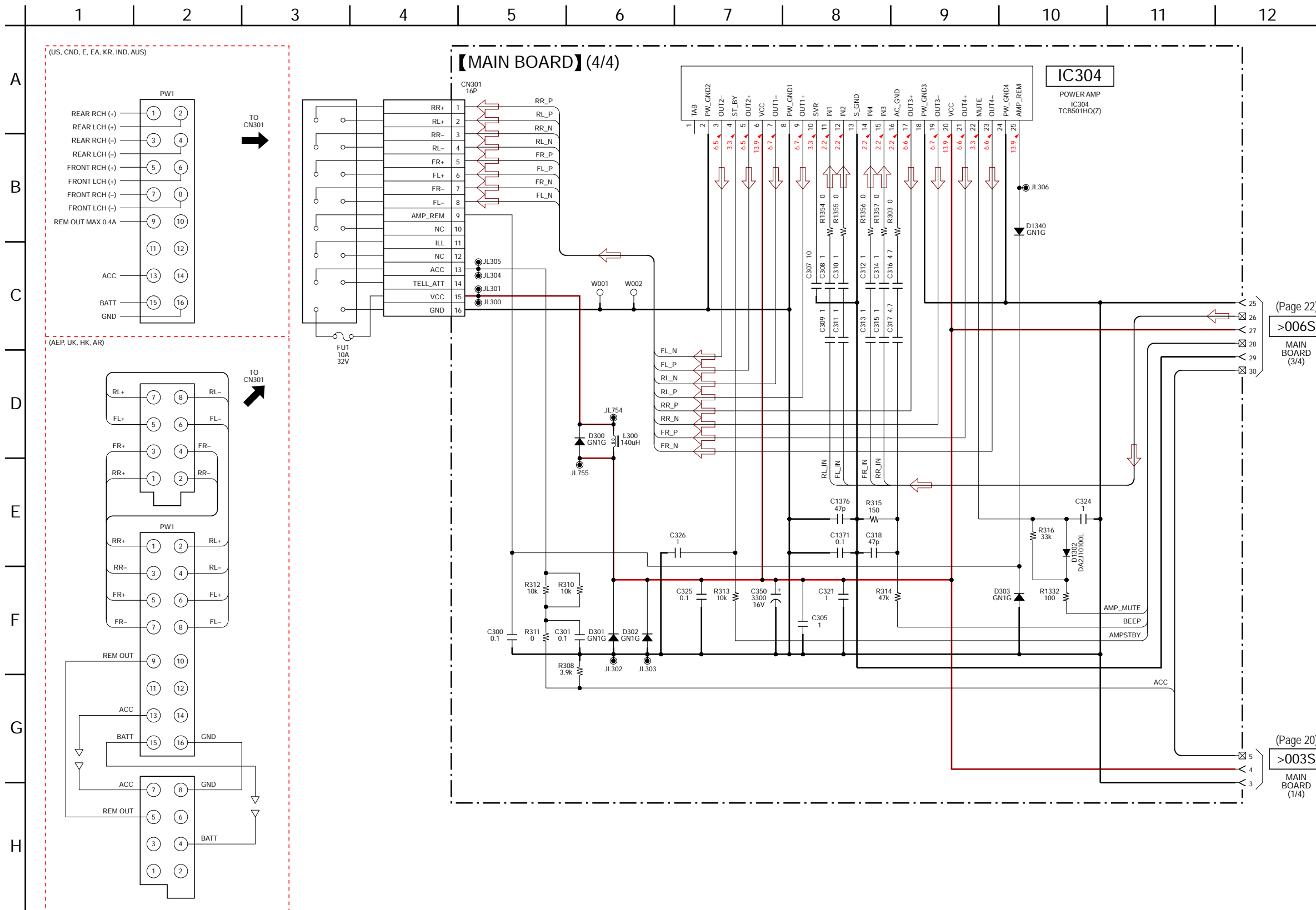

• Waveforms

– MAIN Board –

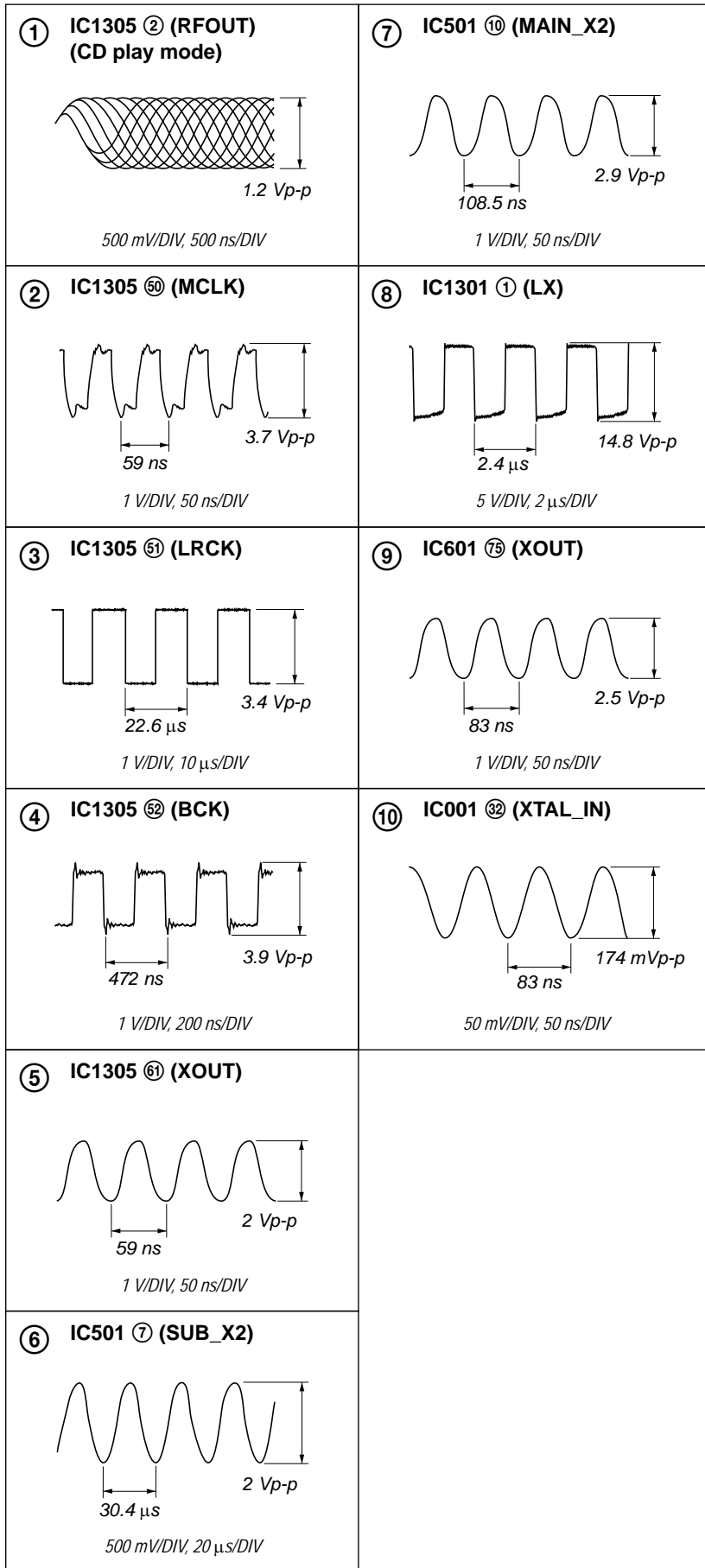

• IC Block Diagrams

– MAIN Board –
IC001 SDP2014HN/V102

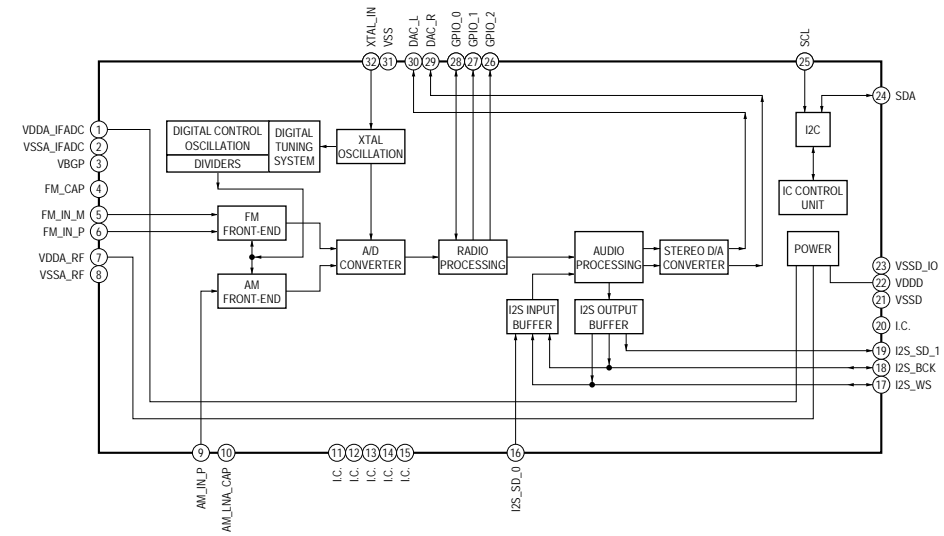

IC002 BU33UC3WG-TR

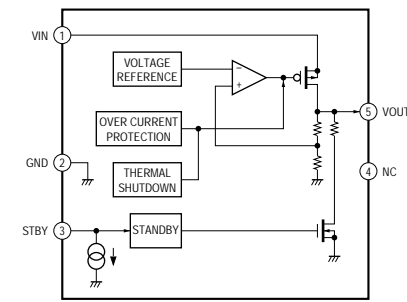

IC201 LV56851UV-XH

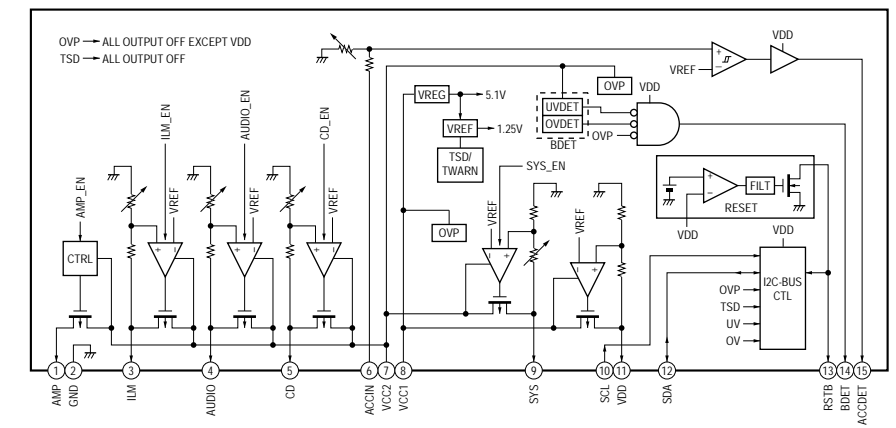

IC304 TCB501HQ (Z)

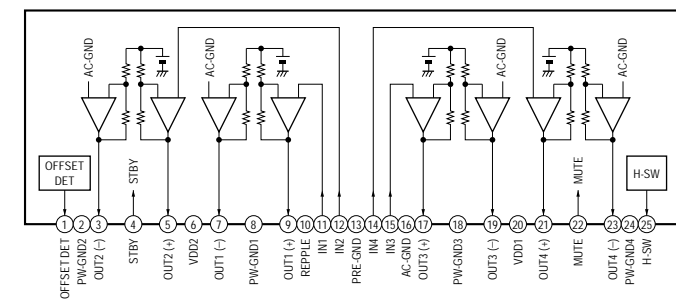

IC1301 BD9876BEFJ-E2

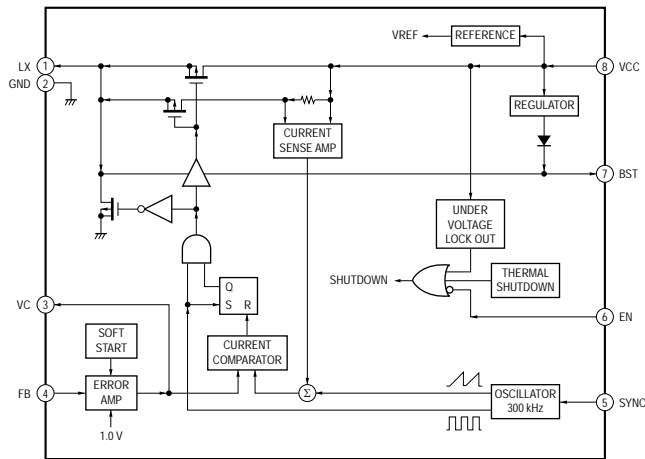

IC1304 BD2231G-TR

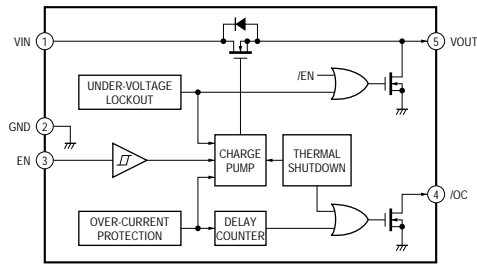

CDX-G1200U/G1201U/G1202U/G1280UM

• IC Pin Function Description

MAIN BOARD IC501 LC88FC2H0AF2327-ENG (SYSTEM CONTROLLER)

Pin No.	Pin Name	I/O	Description
1 to 3	NC	O	Not used
4	FLASH_RW	I/O	Debug communication terminal Not used
5	$\overline{\text{RESET}}$	I	System reset signal input terminal "L": reset For several hundreds msec. after the power supply rises, "L" is input, then it change to "H"
6	SUB_X1	I	Low-speed clock input terminal (32.768 kHz)
7	SUB_X2	O	Low-speed clock output terminal (32.768 kHz)
8	VSS1	-	Ground terminal
9	MAIN_X1	I	High-speed clock input terminal (9.25 MHz)
10	MAIN_X2	O	High-speed clock output terminal (9.25 MHz)
11	VDD1	-	Power supply terminal (+3.3V)
12 to 16	NC	O	Debug test terminal Not used
17	EN_SYS	O	Power on/off control signal output to the DC/DC converter "H": power on
18	$\overline{\text{FLT_USB}}$	I	USB power fault status signal input from the VBUS switch "L": power fault
19	XM_PWR	O	SIRIUSXM power supply on/off control signal output terminal Not used
20	SDO	O	Serial data output to the audio DSP
21	SDI	I	Serial data input from the audio DSP
22	SCK	O	Serial data transfer clock signal output to the audio DSP
23, 24	NC	O	Not used
25	SYNC	O	Frequency control signal output to the DC/DC converter
26	XM_RX	I	Serial data input terminal Not used
27	XM_TX	O	Serial data output terminal Not used
28	REG_SDA	I/O	Two-way data bus with the regulator
29, 30	PD1, PD2	O	Not used
31	REG_SCL	O	Serial data transfer clock signal output to the regulator
32, 33	NC	-	Not used
34	$\overline{\text{BUSY}}$	I	Busy signal input from the audio DSP "L": busy
35	BU_IN	I	Back-up power detection signal input from the regulator
36	VSS2	-	Ground terminal
37	VDD2	-	Power supply terminal (+3.3V)
38	TU_SCL	O	Serial data transfer clock signal output to the FM/AM receiver
39	TU_SDA	I/O	Two-way serial data bus with the FM/AM receiver
40	NC	O	Not used
41	CMD_ERR	I	Command error signal input from the audio DSP "H": error
42	CE	O	Chip enable signal output to the audio DSP
43	$\overline{\text{SYSRST}}$	O	Reset signal output to the audio DSP "L": reset
44	USB_IN	I	USB device detection signal input from the audio DSP "L": USB device is connected
45	SMONI	I	Watch-dog timer status monitor input from the audio DSP
46	LCD_CLK	O	Serial data transfer clock signal output to the front panel block
47	LCD_CE	O	Chip enable signal output to the front panel block
48	LCD_DATA	O	Serial data output to the front panel block
49, 50	NC	O	Not used
51	ACC_IN	I	Accessory power detection signal input from the regulator "L": accessory power on
52	VDD3	-	Power supply terminal (+3.3V)
53	VSS3	-	Ground terminal
54	NC	O	Not used
55	ILL_IN	I	Not used
56	ATT	O	Audio muting on/off control signal output terminal "H": muting on
57	AMP_MUTE	O	Amplifier muting on/off control signal output to the power amplifier "L": muting on
58	AMPSTBY	O	Standby signal output to the power amplifier "L": standby
59	SEL_XM	O	SIRIUSXM mode selection signal output terminal Not used
60	SEL_AUX	O	AUX mode selection signal output terminal Not used
61	OFFSET_DET (NC)	O	Not used
62	$\overline{\text{KEY_ACK0}}$	I	Key acknowledge signal (wake up signal) input from the rotary commander
63	$\overline{\text{KEY_ACK1}}$	I	Key acknowledge signal (wake up signal) input from the front panel block
64	SIRCS	I	Remote control signal input from the front panel block
65	NC	O	Not used

Pin No.	Pin Name	I/O	Description
66, 67	DEBUG_6, DEBUG_7	O	Debug test terminal Not used
68	BEEP	O	Beep sound output to the power amplifier
69	REMOTE_10K	O	Pull-up resistor (10K) selection signal output terminal (for rotary commander) Not used
70	REMOTE_1K	O	Pull-up resistor (1K) selection signal output terminal (for steering control)
71	RE_ON	O	Jog dial pulse pull-up signal output terminal
72	RE_IN1	I	Jog dial pulse signal input from the rotary encoder (B phase input)
73	RE_IN0	I	Jog dial pulse signal input from the rotary encoder (A phase input)
74 to 77	NC	-	Not used
78, 79	KEY_1, KEY_0	I	Front panel key input terminal
80	RC_IN0	I	Rotary commander key input terminal
81	RC_IN1	I	Rotary commander shift key input terminal
82	MECHA_ON	I	Power detection signal input terminal for CD mechanism section "H": CD mechanism power on
83	NC	O	Not used
84	EN_USB	O	USB power on/off control signal output to the VBUS switch "H": power on
85	VSS4	-	Ground terminal
86	VDD4	-	Power supply terminal (+3.3V)
87 to 89	NC	O	Not used
90	PANEL_DET	I	Front panel detach/attach detection signal input terminal "L": front panel is attached
91, 92	NC	O	Not used
93	MEC_DSW	I	Chucking end detection switch input from the CD mechanism deck block
94	MEC_LSW	I	Limit in detection switch input from the CD mechanism deck block
95	FILT	I	Filter terminal for PLL
96	MEC_LOAD	O	Loading motor drive signal (loading direction) output to the CD mechanism deck block "H": motor on
97	MEC_INSW	I	Disc insert detection switch input from the CD mechanism deck block
98	MEC_SELF SW	I	Self loading position detection switch input from the CD mechanism deck block
99	DRV_ON	O	Driver control signal output to the CD mechanism deck block
100	MEC_EJECT	O	Loading motor drive signal (eject direction) output to the CD mechanism deck block "H": motor on

CDX-G1200U/G1201U/G1202U/G1280UM

MAIN BOARD IC601 LC786822E-6E10-3H (USB CONTROLLER, INPUT SELECTOR, AUDIO DSP, ELECTRICAL VOLUME)

Pin No.	Pin Name	I/O	Description
1	NC	-	Not used
2	AVDD1	-	Power supply terminal (+3.3V) (for analog system)
3	AVSS1	-	Ground terminal (for analog system)
4	LRREF	-	External capacitor connection terminal for audio D/A converter and electrical volume reference voltage
5	DACOUTR	O	Audio signal (R-ch) output terminal
6	RVRIN	I	Audio signal (R-ch) input terminal
7	RROUT	O	Audio signal (rear R-ch) output to the power amplifier and REAR AUDIO OUT jack
8	RFOUT	O	Audio signal (front R-ch) output to the power amplifier
9	DACOUTS	O	Audio signal (subwoofer) output terminal
10	SWIN	I	Audio signal (subwoofer) input terminal
11	SWOUT	O	Audio signal (subwoofer) output to the SUB AUDIO OUT jack
12	VREF_ADC	-	External capacitor connection terminal for audio A/D converter reference voltage
13	AVSS2	-	Ground terminal (analog system)
14	AVDD2	-	Power supply terminal (+3.3V) (analog system)
15	L3INP	I	Audio signal (AUX L-ch) input terminal (positive)
16	L3INN	I	Audio signal (AUX L-ch) input terminal (negative)
17	R3INP	I	Audio signal (AUX R-ch) input terminal (positive)
18	R3INN	I	Audio signal (AUX R-ch) input terminal (negative)
19	L2IN	I	Audio signal (tuner L-ch) input from the FM/AM receiver
20	R2IN	I	Audio signal (tuner R-ch) input from the FM/AM receiver
21	L1IN (BT_MIC)	I	Audio signal input terminal Not used
22	R1IN (BT_MIC)	I	Audio signal input terminal Not used
23, 24	TEST0, TEST1	I	Test terminal Not used
25	DVDD18_2	-	External capacitor connection terminal for internal regulator
26	BT_RST	O	Reset signal output terminal Not used
27	CD_DI	O	Serial data output to the digital servo processor
28	CD_CL	O	Serial data transfer clock signal output to the digital servo processor
29	CD_DO	I	Serial data input from the digital servo processor
30	CD_CE	O	Chip enable signal output to the digital servo processor
31	DVDD	-	Power supply terminal (+3.3V) (for digital system)
32	DVSS	-	Ground terminal (for digital system)
33	BT_DOUT	O	Audio data output terminal Not used
34	BT_SYNC	I	Sync signal input terminal Not used
35	BT_CLK	I	Serial data transfer clock signal input terminal Not used
36	BT_DIN	I	Audio data input terminal Not used
37	SBSY	I	CD sub-code block sync signal input from the digital servo processor
38	SFSY	I	CD sub-code flame sync signal input from the digital servo processor
39	PW	I	CD sub-code PW data input from the digital servo processor
40	SBCK	I	CD sub-code data transfer clock signal input from the digital servo processor
41	DVDD	-	Power supply terminal (+3.3V) (for digital system)
42	DVSS	-	Ground terminal (for digital system)
43	REG1EXTR	O	Reserve terminal for internal regulator Not used
44	DVDD12_2	-	External capacitor connection terminal for internal regulator
45, 46	GP10, GP11	I/O	Not used
47	SMONI	O	Watch-dog timer status monitor output to the system controller
48	OPCDM	I	External decode permission signal input from the digital servo processor
49	DVDD	-	Power supply terminal (+3.3V) (for digital system)
50	DVSS	-	Ground terminal (for digital system)
51	RESB	I	Reset signal input from the system controller "L": reset
52	SIFCK	I	Serial data transfer clock signal input from the system controller
53	SIFDI	I	Serial data input from the system controller
54	SIFDO	O	Serial data output to the system controller
55	SIFCE	I	Chip enable signal input from the system controller
56	BUSYB	O	Busy signal output to the system controller "L": busy
57	CD_BUSYB	I	Busy signal input from the digital servo processor "L": busy
58	LACK	I	L/R sampling clock signal input from the digital servo processor
59	BCK	I	Bit clock signal input from the digital servo processor

Pin No.	Pin Name	I/O	Description
60	DATA	I	Audio data input from the digital servo processor
61	MCLK	I	Master clock signal input from the digital servo processor
62	USB_IN	O	USB device detection signal output to the system controller "L": USB device is connected
63	NC	I/O	Not used
64	GP46	I/O	Not used
65	NC	I/O	Not used
66	DVSS	-	Ground terminal (for digital system)
67	DVDD	-	Power supply terminal (+3.3V) (for digital system)
68	UDM2	I/O	Two-way data (-) bus terminal Not used
69	UDP2	I/O	Two-way data (+) bus terminal Not used
70	DVSS	-	Ground terminal (for digital system)
71	UDM1	I/O	Two-way USB data (-) bus with the USB connector
72	UDP1	I/O	Two-way USB data (+) bus with the USB connector
73	XVDD	-	Power supply terminal (+3.3V) (for oscillator)
74	XIN	I	System clock input terminal (12 MHz)
75	XOUT	O	System clock output terminal (12 MHz)
76	XVSS	-	Ground terminal (for oscillator)
77	AFILT	O	Charge pump output terminal (for PLL)
78	NC	-	Not used
79	VVDD2	-	Power supply terminal (+3.3V) (for PLL)
80	DVSS	-	Ground terminal (for digital system)
81	DVDD	-	Power supply terminal (+3.3V) (for digital system)
82	CP_SCL	O	Serial data transfer clock signal output terminal Not used
83	CP_SDA	I/O	Two-way data bus terminal Not used
84	CP_RESET (NC)	O	Reset signal output terminal Not used
85	CD_RESB	O	Reset signal output to the digital servo processor "L": reset
86	CMD_ERR	O	Command error signal output to the system controller "H": error
87	DVDD12_1	-	External capacitor connection terminal for internal regulator
88	DVDD	-	Power supply terminal (+3.3V) (for digital system)
89	DVSS	-	Ground terminal (for digital system)
90	DVDD18_1	-	External capacitor connection terminal for internal regulator
91	JTRSTB	I	Reset signal input terminal (for JTAG) Normally: fixed at "L"
92	JTCK	I	Clock signal input terminal (for JTAG) Normally: fixed at "L"
93	JTDI	I	Data input terminal (for JTAG) Normally: fixed at "L"
94	JTMS	I	Mode selection signal input terminal (for JTAG) Normally: fixed at "H"
95	JTDO	O	Data output terminal (for JTAG) Normally: open
96	JTRTCK	O	Return clock signal output terminal (for JTAG) Normally: open
97	LFOUT	O	Audio signal (front L-ch) output to the power amplifier
98	LROUT	O	Audio signal (rear L-ch) output to the power amplifier and REAR AUDIO OUT jack
99	LVRIN	I	Audio signal (L-ch) input terminal
100	DACOUTL	O	Audio signal (L-ch) output terminal

CDX-G1200U/G1201U/G1202U/G1280UM

MAIN BOARD IC1305 LC78615E-01US-H (RF AMP, DIGITAL SERVO PROCESSOR)

Pin No.	Pin Name	I/O	Description
1	EFMIN	I	RF signal input terminal
2	RFOUT	O	RF signal output terminal
3	LPF	-	External low-pass filter capacitor connection terminal for DC level detection of RF signal
4	PHLPF	-	External low-pass filter capacitor connection terminal for defect detection
5	AIN	I	Main beam (B) input from the CD mechanism deck block
6	CIN	I	Main beam (C) input from the CD mechanism deck block
7	BIN	I	Main beam (A) input from the CD mechanism deck block
8	DIN	I	Main beam (C) input from the CD mechanism deck block
9	SLCISSET	-	External resistor connection terminal for current setting of SLCO output
10	RFMON	O	Internal analog signal monitor terminal of LSI Not used
11	VREF	O	Reference voltage (+1.65V) output terminal for RF
12	JITTC	-	External capacitor connection terminal for jitter detection
13	EIN	I	Sub beam (F) input from the CD mechanism deck block
14	FIN	I	Sub beam (E) input from the CD mechanism deck block
15	TE	O	Tracking error signal output terminal
16	TEIN	I	Tracking error signal input terminal
17	AVSS	-	Ground terminal (analog system)
18	AVDD	-	Power supply terminal (+3.3V) (analog system)
19	LDD	O	Laser power control signal output to the CD mechanism deck block
20	LDS	I	Laser power detection signal input from the CD mechanism deck block
21	FDO	O	Focus coil control signal output to the CD mechanism deck block
22	TDO	O	Tracking coil control signal output to the CD mechanism deck block
23	SLDO	O	Sled motor control signal output to the CD mechanism deck block
24	SPDO	O	Spindle motor control signal output to the CD mechanism deck block
25	VVSS1	-	Ground terminal (for EFMPLL)
26, 27	PDOUT1, PDOUT0	O	Charge pump output terminal for EFMPLL
28	PCKIST	-	External resistor connection terminal for charge pump current setting for EFMPLL
29	VVDD1	-	Power supply terminal (+3.3V) (for EFMPLL)
30, 31	NC	-	Not used
32	DVDD15	-	External power capacitor connection terminal for digital system power
33	DVDD	-	Power supply terminal (+3.3V) (digital system)
34	DVSS	-	Ground terminal (digital system)
35	TEST	I	Test mode setting terminal Fixed at "L"
36	L_SW	I	Limit in detection switch input terminal
37, 38	NC	-	Not used
39	OPCDM	O	External decode permission signal output to the audio DSP
40	SBSY	O	CD sub-code block sync signal output to the audio DSP
41	SFSY	O	CD sub-code flame sync signal output to the audio DSP
42	PW	O	CD sub-code PW data output to the audio DSP
43	SBCK	O	CD sub-code data transfer clock signal output to the audio DSP
44	CE	I	Chip enable signal input from the audio DSP
45	CL	I	Serial data transfer clock signal input from the audio DSP
46	DI	I	Serial data input from the audio DSP
47	DO	O	Serial data output to the audio DSP
48	RESB	I	Reset signal input from the audio DSP "L": reset
49	BUSYB	O	Busy signal output to the audio DSP "L": busy
50	MCLK	O	Master clock signal output to the audio DSP
51	LRCK	O	L/R sampling clock signal output to the audio DSP
52	BCK	O	Bit clock signal output to the audio DSP
53	DATA	O	Audio data output to the audio DSP
54 to 56	SMOIN0 to SMOIN2	O	Servo internal signal monitor output terminal Not used
57	MODE	I	LSI operation mode setting terminal Fixed at "H"
58	DVDD15	-	External power capacitor connection terminal for digital system power
59	DVDD	-	Power supply terminal (+3.3V) (digital system)
60	XVSS	-	Ground terminal (for oscillation circuit)
61	XOUT	O	System clock output terminal (16.934 MHz)
62	XIN	I	System clock input terminal (16.934 MHz)
63	XVDD	-	Power supply terminal (+3.3V) (for oscillation circuit)
64	SLCO	O	Slice level control signal output terminal

5-2. CHASSIS SECTION

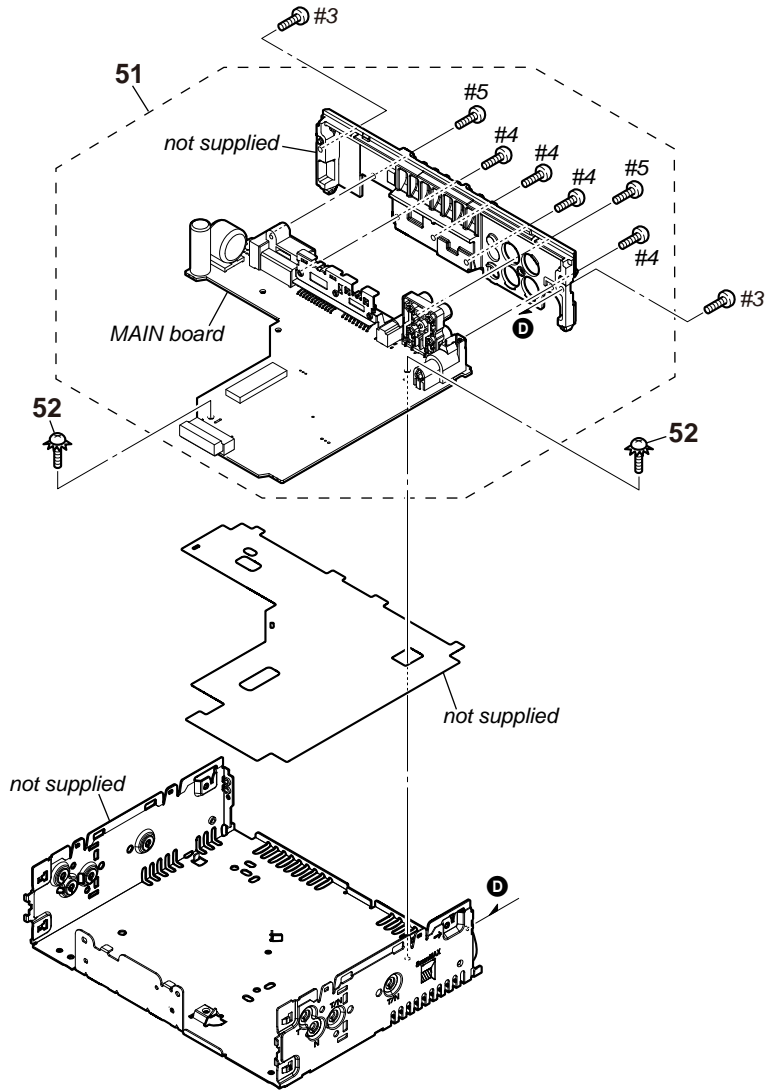

Note: When the complete MAIN board (Ref. No. 51) is replaced, the destination setting is necessary. Refer to "DESTINATION SETTING METHOD" on page 4.

Ref. No.	Part No.	Description	Remark	Ref. No.	Part No.	Description	Remark
51	A-2127-623-A	MAIN BOARD, COMPLETE (See Note)		#4	7-685-794-01	SCREW +PTT 2.6X10 (S)	
52	4-410-504-01	SCREW (+PTT 2.6X6), GROUND POINT		#5	7-685-134-19	SCREW +P 2.6X8 TYPE2 NON-SLIT	
#3	7-685-793-01	SCREW +PTT 2.6X8 (S)					

SECTION 6
ELECTRICAL PARTS LIST

KEY MAIN

Note:

- Due to standardization, replacements in the parts list may be different from the parts specified in the diagrams or the components used on the set.
- -XX and -X mean standardized parts, so they may have some difference from the original one.
- Items marked "*" are not stocked since they are seldom required for routine service. Some delay should be anticipated when ordering these items.
- RESISTORS
All resistors are in ohms.
METAL: Metal-film resistor.
METAL OXIDE: Metal oxide-film resistor.
F: nonflammable

- CAPACITORS
uF: μF
uH: μH
- COILS
uH: μH
- SEMICONDUCTORS
In each case, u: μ, for example:
uA. . . : μA. . . , uPA. . . , μPA. . . ,
uPB. . . : μPB. . . , uPC. . . , μPC. . . ,
uPD. . . : μPD. . .

When indicating parts by reference number, please include the board name.

Ref. No.	Part No.	Description	Remark	Ref. No.	Part No.	Description	Remark
		KEY BOARD *****		C253	1-127-931-21	ELECT CHIP 470uF	20% 16V
				C300	1-118-361-11	CERAMIC CHIP 0.1uF	10% 50V
When the KEY board is defective, replace the FRONT PANEL OVERALL ASSY (Ref. No. FP1). *****				C301	1-118-361-11	CERAMIC CHIP 0.1uF	10% 50V
		A-2127-623-A MAIN BOARD, COMPLETE (See Note) *****		C305	1-116-733-11	CERAMIC CHIP 1uF	10% 25V
		7-685-134-19 SCREW +P 2.6X8 TYPE2 NON-SLIT		C307	1-116-716-11	CERAMIC CHIP 10uF	10% 16V
		7-685-794-01 SCREW +PTT 2.6X10 (S)		* C308	1-116-735-11	CERAMIC CHIP 1uF	10% 16V
		< CAPACITOR >		* C309	1-116-735-11	CERAMIC CHIP 1uF	10% 16V
C2	1-116-153-11	CERAMIC CHIP 18PF	1% 50V	* C310	1-116-735-11	CERAMIC CHIP 1uF	10% 16V
C3	1-112-692-11	CERAMIC CHIP 1000PF	5% 50V	* C311	1-116-735-11	CERAMIC CHIP 1uF	10% 16V
C4	1-116-385-81	CERAMIC CHIP 4.7PF	0.1PF 50V	* C312	1-116-735-11	CERAMIC CHIP 1uF	10% 16V
C5	1-116-194-81	CERAMIC CHIP 33PF	1% 50V	* C313	1-116-735-11	CERAMIC CHIP 1uF	10% 16V
C6	1-164-844-11	CERAMIC CHIP 4PF	0.25PF 50V	* C314	1-116-735-11	CERAMIC CHIP 1uF	10% 16V
C8	1-164-850-11	CERAMIC CHIP 10PF	0.5PF 50V	* C315	1-116-735-11	CERAMIC CHIP 1uF	10% 16V
C10	1-118-386-11	CERAMIC CHIP 0.1uF	10% 16V	C316	1-112-746-11	CERAMIC CHIP 4.7uF	10% 6.3V
C11	1-116-745-11	CERAMIC CHIP 0.22uF	10% 6.3V	C317	1-112-746-11	CERAMIC CHIP 4.7uF	10% 6.3V
C12	1-118-403-11	CERAMIC CHIP 0.001uF	10% 50V	C318	1-164-866-11	CERAMIC CHIP 47PF	5% 50V
C13	1-116-737-11	CERAMIC CHIP 1uF	20% 10V	C321	1-116-733-11	CERAMIC CHIP 1uF	10% 25V
C15	1-118-403-11	CERAMIC CHIP 0.001uF	10% 50V	C324	1-116-733-11	CERAMIC CHIP 1uF	10% 25V
* C16	1-118-401-11	CERAMIC CHIP 0.0015uF	10% 50V	C325	1-118-361-11	CERAMIC CHIP 0.1uF	10% 50V
C20	1-116-737-11	CERAMIC CHIP 1uF	20% 10V	C326	1-116-733-11	CERAMIC CHIP 1uF	10% 25V
C21	1-116-737-11	CERAMIC CHIP 1uF	20% 10V	C350	1-118-997-11	ELECT 3300uF	20% 16V
C24	1-164-862-81	CERAMIC CHIP 33PF	5% 50V	C416	1-100-966-91	CERAMIC CHIP 10uF	20% 10V
C25	1-164-862-81	CERAMIC CHIP 33PF	5% 50V	C421	1-116-734-11	CERAMIC CHIP 1uF	20% 16V
* C28	1-116-720-11	CERAMIC CHIP 10uF	20% 6.3V	C426	1-118-047-11	CERAMIC CHIP 10uF	10% 16V
C30	1-165-908-11	CERAMIC CHIP 1uF	10% 10V	C429	1-164-882-11	CERAMIC CHIP 220PF	5% 16V
C31	1-118-290-11	CERAMIC CHIP 0.001uF	10% 50V	C432	1-118-047-11	CERAMIC CHIP 10uF	10% 16V
C100	1-118-290-11	CERAMIC CHIP 0.001uF	10% 50V	C436	1-118-047-11	CERAMIC CHIP 10uF	10% 16V
C101	1-118-290-11	CERAMIC CHIP 0.001uF	10% 50V	C437	1-164-882-11	CERAMIC CHIP 220PF	5% 16V
C102	1-116-992-21	CERAMIC CHIP 2.2uF	10% 50V	C439	1-116-734-11	CERAMIC CHIP 1uF	20% 16V
C105	1-116-716-11	CERAMIC CHIP 10uF	10% 16V	C440	1-164-882-11	CERAMIC CHIP 220PF	5% 16V
C116	1-164-315-91	CERAMIC CHIP 470PF	5% 50V	C442	1-116-734-11	CERAMIC CHIP 1uF	20% 16V
C200	1-118-039-11	CERAMIC CHIP 1uF	10% 25V	C443	1-116-722-11	CERAMIC CHIP 4.7uF	10% 16V
C201	1-116-865-11	CERAMIC CHIP 10uF	10% 25V	C444	1-116-722-11	CERAMIC CHIP 4.7uF	10% 16V
C202	1-100-966-91	CERAMIC CHIP 10uF	20% 10V	C450	1-128-992-21	ELECT CHIP 47uF	20% 25V
C204	1-116-742-11	CERAMIC CHIP 0.22uF	10% 25V	C501	1-118-403-11	CERAMIC CHIP 0.001uF	10% 50V
C206	1-116-742-11	CERAMIC CHIP 0.22uF	10% 25V	C502	1-118-403-11	CERAMIC CHIP 0.001uF	10% 50V
C208	1-100-966-91	CERAMIC CHIP 10uF	20% 10V	C505	1-116-745-11	CERAMIC CHIP 0.22uF	10% 6.3V
C209	1-100-966-91	CERAMIC CHIP 10uF	20% 10V	C520	1-118-403-11	CERAMIC CHIP 0.001uF	10% 50V
C211	1-117-681-11	ELECT CHIP 100uF	20% 16V	C521	1-118-459-11	CERAMIC CHIP 0.01uF	10% 25V
C251	1-100-767-21	ELECT CHIP 220uF	20% 16V	C522	1-118-459-11	CERAMIC CHIP 0.01uF	10% 25V
				C523	1-118-459-11	CERAMIC CHIP 0.01uF	10% 25V
				C524	1-164-852-11	CERAMIC CHIP 12PF	5% 50V
				C526	1-118-386-11	CERAMIC CHIP 0.1uF	10% 16V
				C527	1-164-852-11	CERAMIC CHIP 12PF	5% 50V
				C528	1-164-842-11	CERAMIC CHIP 2PF	0.25PF 50V

Note: When the complete MAIN board is replaced, the destination setting is necessary. Refer to "DESTINATION SETTING METHOD" on page 4.

CDX-G1200U/G1201U/G1202U/G1280UM

MAIN

Ref. No.	Part No.	Description	Remark			Ref. No.	Part No.	Description	Remark		
C530	1-164-842-11	CERAMIC CHIP	2PF	0.25PF	50V	C719	1-118-395-11	CERAMIC CHIP	0.0047uF	10%	50V
C531	1-118-459-11	CERAMIC CHIP	0.01uF	10%	25V	C720	1-118-388-11	CERAMIC CHIP	0.047uF	10%	25V
C532	1-118-459-11	CERAMIC CHIP	0.01uF	10%	25V	C721	1-118-391-11	CERAMIC CHIP	0.01uF	10%	50V
C533	1-118-459-11	CERAMIC CHIP	0.01uF	10%	25V	C722	1-118-386-11	CERAMIC CHIP	0.1uF	10%	16V
C534	1-164-862-81	CERAMIC CHIP	33PF	5%	50V	C723	1-118-386-11	CERAMIC CHIP	0.1uF	10%	16V
C535	1-164-862-81	CERAMIC CHIP	33PF	5%	50V	C724	1-118-386-11	CERAMIC CHIP	0.1uF	10%	16V
C550	1-114-612-21	ELECT CHIP	220uF	20%	6.3V	C725	1-118-386-11	CERAMIC CHIP	0.1uF	10%	16V
C551	1-118-040-11	CERAMIC CHIP	2.2uF	10%	16V	C726	1-118-386-11	CERAMIC CHIP	0.1uF	10%	16V
C600	1-118-386-11	CERAMIC CHIP	0.1uF	10%	16V	C727	1-118-477-11	CERAMIC CHIP	2.2uF	10%	6.3V
C601	1-118-386-11	CERAMIC CHIP	0.1uF	10%	16V	C728	1-118-477-11	CERAMIC CHIP	2.2uF	10%	6.3V
C602	1-118-386-11	CERAMIC CHIP	0.1uF	10%	16V	C729	1-116-744-11	CERAMIC CHIP	0.22uF	10%	10V
C603	1-118-386-11	CERAMIC CHIP	0.1uF	10%	16V	C730	1-118-389-11	CERAMIC CHIP	0.022uF	10%	25V
C604	1-116-350-21	CERAMIC CHIP	47uF	20%	4V	C731	1-164-866-11	CERAMIC CHIP	47PF	5%	50V
* C608	1-116-720-11	CERAMIC CHIP	10uF	20%	6.3V	C732	1-164-866-11	CERAMIC CHIP	47PF	5%	50V
C609	1-118-386-11	CERAMIC CHIP	0.1uF	10%	16V	C734	1-118-386-11	CERAMIC CHIP	0.1uF	10%	16V
C610	1-165-492-21	ELECT CHIP	100uF	20%	10V	C752	1-100-363-11	ELECT CHIP	220uF	20%	4V
C611	1-118-386-11	CERAMIC CHIP	0.1uF	10%	16V	C753	1-126-209-11	ELECT CHIP	100uF	20%	4V
C613	1-118-386-11	CERAMIC CHIP	0.1uF	10%	16V	C754	1-126-209-11	ELECT CHIP	100uF	20%	4V
C615	1-118-386-11	CERAMIC CHIP	0.1uF	10%	16V	C756	1-165-708-11	ELECT CHIP	47uF	20%	6.3V
C617	1-165-908-11	CERAMIC CHIP	1uF	10%	10V	C1300	1-116-865-11	CERAMIC CHIP	10uF	10%	25V
C618	1-165-908-11	CERAMIC CHIP	1uF	10%	10V	C1301	1-118-039-11	CERAMIC CHIP	1uF	10%	25V
C619	1-164-845-11	CERAMIC CHIP	5PF	0.25PF	50V	C1305	1-118-418-11	CERAMIC CHIP	22uF	20%	6.3V
C620	1-164-845-11	CERAMIC CHIP	5PF	0.25PF	50V	C1311	1-118-391-11	CERAMIC CHIP	0.01uF	10%	50V
C623	1-118-386-11	CERAMIC CHIP	0.1uF	10%	16V	C1312	1-118-391-11	CERAMIC CHIP	0.01uF	10%	50V
C624	1-164-858-11	CERAMIC CHIP	22PF	5%	50V	C1316	1-100-966-91	CERAMIC CHIP	10uF	20%	10V
C625	1-116-724-11	CERAMIC CHIP	4.7uF	20%	6.3V	C1317	1-100-966-91	CERAMIC CHIP	10uF	20%	10V
* C626	1-116-720-11	CERAMIC CHIP	10uF	20%	6.3V	C1321	1-165-908-11	CERAMIC CHIP	1uF	10%	10V
C627	1-116-737-11	CERAMIC CHIP	1uF	20%	10V	C1323	1-165-908-11	CERAMIC CHIP	1uF	10%	10V
C628	1-164-858-11	CERAMIC CHIP	22PF	5%	50V	C1326	1-162-923-11	CERAMIC CHIP	47PF	5%	50V
C629	1-118-397-11	CERAMIC CHIP	0.0033uF	10%	50V	C1353	1-165-492-21	ELECT CHIP	100uF	20%	10V
C630	1-118-386-11	CERAMIC CHIP	0.1uF	10%	16V	C1361	1-118-386-11	CERAMIC CHIP	0.1uF	10%	16V
C631	1-118-386-11	CERAMIC CHIP	0.1uF	10%	16V	C1368	1-118-386-11	CERAMIC CHIP	0.1uF	10%	16V
C632	1-116-350-21	CERAMIC CHIP	47uF	20%	4V	C1369	1-164-874-11	CERAMIC CHIP	100PF	5%	50V
C633	1-164-882-11	CERAMIC CHIP	220PF	5%	16V	C1371	1-125-777-11	CERAMIC CHIP	0.1uF	10%	10V
C634	1-116-737-11	CERAMIC CHIP	1uF	20%	10V	* C1374	1-116-720-11	CERAMIC CHIP	10uF	20%	6.3V
C635	1-116-737-11	CERAMIC CHIP	1uF	20%	10V	C1376	1-164-866-11	CERAMIC CHIP	47PF	5%	50V
C636	1-118-403-11	CERAMIC CHIP	0.001uF	10%	50V	C1380	1-118-040-11	CERAMIC CHIP	2.2uF	10%	16V
C637	1-112-717-91	CERAMIC CHIP	1uF	10%	6.3V	C1386	1-162-923-11	CERAMIC CHIP	47PF	5%	50V
C638	1-165-492-21	ELECT CHIP	100uF	20%	10V	C1582	1-118-361-11	CERAMIC CHIP	0.1uF	10%	50V
C639	1-165-908-11	CERAMIC CHIP	1uF	10%	10V	C1583	1-117-681-11	ELECT CHIP	100uF	20%	16V
C640	1-165-908-11	CERAMIC CHIP	1uF	10%	10V						
C641	1-118-386-11	CERAMIC CHIP	0.1uF	10%	16V			< CONNECTOR >			
C650	1-165-492-21	ELECT CHIP	100uF	20%	10V	CN101	1-842-266-22	SOCKET, CONNECTOR 20P			
C651	1-165-492-21	ELECT CHIP	100uF	20%	10V	CN301	1-843-330-41	PIN, CONNECTOR 16P			
C652	1-116-350-21	CERAMIC CHIP	47uF	20%	4V	CN1005	1-843-775-11	CONNECTOR, FFC/FPC (ZIF) 27P			
C653	1-116-350-21	CERAMIC CHIP	47uF	20%	4V			< DIODE >			
C654	1-116-350-21	CERAMIC CHIP	47uF	20%	4V						
C655	1-118-386-11	CERAMIC CHIP	0.1uF	10%	16V	D114	6-502-969-01	DIODE DZ2J06800L			
C701	1-118-386-11	CERAMIC CHIP	0.1uF	10%	16V	D115	6-502-969-01	DIODE DZ2J06800L			
C702	1-118-386-11	CERAMIC CHIP	0.1uF	10%	16V	D116	6-502-969-01	DIODE DZ2J06800L			
C703	1-164-854-11	CERAMIC CHIP	15PF	5%	50V	D117	6-502-969-01	DIODE DZ2J06800L			
C705	1-118-386-11	CERAMIC CHIP	0.1uF	10%	16V	D152	6-502-969-01	DIODE DZ2J06800L			
C706	1-118-395-11	CERAMIC CHIP	0.0047uF	10%	50V	D200	6-503-238-01	DIODE GN1G			
C710	1-118-391-11	CERAMIC CHIP	0.01uF	10%	50V	D300	6-503-238-01	DIODE GN1G			
C711	1-118-386-11	CERAMIC CHIP	0.1uF	10%	16V	D301	6-503-238-01	DIODE GN1G			
C712	1-118-386-11	CERAMIC CHIP	0.1uF	10%	16V	D302	6-503-238-01	DIODE GN1G			
C713	1-118-386-11	CERAMIC CHIP	0.1uF	10%	16V	D303	6-503-238-01	DIODE GN1G			
C714	1-118-386-11	CERAMIC CHIP	0.1uF	10%	16V	D400	6-502-961-01	DIODE DA2J10100L			
C715	1-118-391-11	CERAMIC CHIP	0.01uF	10%	50V	D500	6-503-759-01	DIODE RB751V40, 115			
C717	1-118-386-11	CERAMIC CHIP	0.1uF	10%	16V	D1301	6-503-548-01	DIODE DB2441600L			

Ref. No.	Part No.	Description	Remark
D1302	6-502-961-01	DIODE DA2J10100L	
D1311	6-503-031-01	DIODE DZ2J18000L	
D1312	6-503-031-01	DIODE DZ2J18000L	
D1340	6-503-238-01	DIODE GN1G	
< FERRITE BEAD >			
FB01	1-400-334-21	FERRITE, EMI (SMD) (1608)	
FB1	1-481-912-21	EMI FERRITE (SMD) (1005)	
FB104	1-400-334-21	FERRITE, EMI (SMD) (1608)	
FB501	1-469-081-21	INDUCTOR, FERRITE BEAD (1005)	
FB800	1-500-113-22	BEAD, FERRITE (CHIP) (1608)	
FB801	1-500-113-22	BEAD, FERRITE (CHIP) (1608)	
FB802	1-500-113-22	BEAD, FERRITE (CHIP) (1608)	
FB803	1-469-081-21	INDUCTOR, FERRITE BEAD (1005)	
FB804	1-481-396-21	FERRITE, EMI (SMD) (1608)	
FB805	1-469-084-21	INDUCTOR, FERRITE BEAD (1005)	
FB806	1-500-113-22	BEAD, FERRITE (CHIP) (1608)	
FB811	1-481-643-21	FERRITE, EMI (SMD)	
< IC >			
IC001	(Not supplied)	IC SDP2014HN/V102 (See Note 1)	
IC002	6-721-116-01	IC BU33UC3WG-TR	
IC201	6-723-094-01	IC LV56851UV-XH	
IC304	6-723-099-01	IC TCB501HQ (Z)	
IC400	6-721-638-01	IC NJM8065RB1-TE1	
IC402	6-721-638-01	IC NJM8065RB1-TE1	
IC501	6-723-318-01	IC LC88FC2H0AF2327-ENG (SV) (See Note 2)	
IC601	6-723-098-01	IC LC786822E-6E10-3H	
IC1301	(Not supplied)	IC BD9876BEFJ-E2 (See Note 1)	
* IC1304	6-718-253-01	IC BD2231G-TR	
IC1305	6-720-790-01	IC LC78615E-01US-H	
< JACK >			
J01	1-843-791-21	JACK (ANT) (ANTENNA IN)	
J402	1-844-648-11	JACK, PIN 4P (AUDIO OUT REAR/SUB)	
J801	1-566-822-81	JACK (REMOTE IN)	
< COIL >			
L1	1-469-293-21	INDUCTOR 220nH	
L2	1-412-978-41	INDUCTOR 0.82uH	
L3	1-481-330-21	INDUCTOR 220nH	
L5	1-412-985-31	INDUCTOR 3.3uH	
L6	1-469-293-21	INDUCTOR 220nH	
L10	1-400-073-21	INDUCTOR 4.7uH	
* L101	1-457-443-22	COMMON MODE CHOKE COIL	
L105	1-469-844-11	INDUCTOR 2.2uH	
L300	1-460-443-11	CHOKE COIL 140uH	
L1301	1-481-904-11	INDUCTOR 47uH	
< TRANSISTOR >			
Q403	6-552-856-01	TRANSISTOR LTC914TUBFS8TL	
Q404	6-552-856-01	TRANSISTOR LTC914TUBFS8TL	
Q407	6-552-895-01	TRANSISTOR DTA014EEBTL	
Q408	6-552-895-01	TRANSISTOR DTA014EEBTL	
* Q409	6-552-938-01	TRANSISTOR LTC014YUBFS8TL	
Q410	6-552-856-01	TRANSISTOR LTC914TUBFS8TL	
Q700	8-729-026-49	TRANSISTOR 2SA1037AK-T146-R	
Q1307	6-552-933-01	TRANSISTOR LTA043ZUBFS8TL	
Q1308	6-552-933-01	TRANSISTOR LTA043ZUBFS8TL	

Ref. No.	Part No.	Description	Remark
< RESISTOR >			
R4	1-218-989-11	METAL CHIP 1M	5% 1/16W
R8	1-218-941-81	METAL CHIP 100	5% 1/16W
R14	1-218-941-81	METAL CHIP 100	5% 1/16W
R15	1-218-965-11	METAL CHIP 10K	5% 1/16W
R16	1-218-965-11	METAL CHIP 10K	5% 1/16W
R19	1-216-864-91	SHORT CHIP 0	
R27	1-218-941-81	METAL CHIP 100	5% 1/16W
R30	1-218-965-11	METAL CHIP 10K	5% 1/16W
R31	1-218-965-11	METAL CHIP 10K	5% 1/16W
R102	1-216-049-11	METAL CHIP 1K	5% 1/8W
R103	1-216-835-11	METAL CHIP 15K	5% 1/10W
R104	1-216-065-91	METAL CHIP 4.7K	5% 1/8W
R105	1-216-065-91	METAL CHIP 4.7K	5% 1/8W
R106	1-216-835-11	METAL CHIP 15K	5% 1/10W
R107	1-216-049-11	METAL CHIP 1K	5% 1/8W
R109	1-216-827-11	METAL CHIP 3.3K	5% 1/10W
R111	1-216-827-11	METAL CHIP 3.3K	5% 1/10W
R116	1-218-990-81	SHORT CHIP 0	
R202	1-218-990-81	SHORT CHIP 0	
R203	1-218-990-81	SHORT CHIP 0	
R204	1-218-990-81	SHORT CHIP 0	
R205	1-218-945-11	METAL CHIP 220	5% 1/16W
R206	1-218-945-11	METAL CHIP 220	5% 1/16W
R262	1-218-990-81	SHORT CHIP 0	
R263	1-218-990-81	SHORT CHIP 0	
R303	1-218-990-81	SHORT CHIP 0	
R308	1-218-960-11	METAL CHIP 3.9K	5% 1/16W
R310	1-216-073-91	METAL CHIP 10K	5% 1/8W
R311	1-218-990-81	SHORT CHIP 0	
R312	1-216-073-91	METAL CHIP 10K	5% 1/8W
R313	1-218-965-11	METAL CHIP 10K	5% 1/16W
R314	1-218-973-11	METAL CHIP 47K	5% 1/16W
R315	1-218-943-11	METAL CHIP 150	5% 1/16W
R316	1-218-971-81	METAL CHIP 33K	5% 1/16W
R361	1-218-945-11	METAL CHIP 220	5% 1/16W
R362	1-218-945-11	METAL CHIP 220	5% 1/16W
R363	1-218-945-11	METAL CHIP 220	5% 1/16W
R364	1-218-945-11	METAL CHIP 220	5% 1/16W
R400	1-216-801-11	METAL CHIP 22	5% 1/10W
R416	1-218-965-11	METAL CHIP 10K	5% 1/16W
R417	1-218-990-81	SHORT CHIP 0	
R418	1-218-990-81	SHORT CHIP 0	
R422	1-218-953-11	METAL CHIP 1K	5% 1/16W
R423	1-218-990-81	SHORT CHIP 0	
R424	1-218-990-81	SHORT CHIP 0	
R425	1-218-990-81	SHORT CHIP 0	
R426	1-218-990-81	SHORT CHIP 0	
R430	1-218-990-81	SHORT CHIP 0	
R437	1-216-797-11	METAL CHIP 10	5% 1/10W
R438	1-218-990-81	SHORT CHIP 0	
R439	1-218-966-11	METAL CHIP 12K	5% 1/16W
R440	1-218-965-11	METAL CHIP 10K	5% 1/16W
R441	1-218-941-81	METAL CHIP 100	5% 1/16W
R442	1-218-977-11	METAL CHIP 100K	5% 1/16W
* R443	1-250-545-11	METAL CHIP 120K	1% 1/16W
R444	1-218-977-11	METAL CHIP 100K	5% 1/16W
R453	1-216-797-11	METAL CHIP 10	5% 1/10W
R454	1-218-990-81	SHORT CHIP 0	
R455	1-218-966-11	METAL CHIP 12K	5% 1/16W

Note 1: IC001 and IC1301 on the MAIN board cannot replace with single. When these parts are damaged, replace the complete mounted board.

Note 2: When the IC501 on the MAIN board is replaced, the destination setting is necessary. Refer to "DESTINATION SETTING METHOD" on page 4.

CDX-G1200U/G1201U/G1202U/G1280UM

MAIN

Ref. No.	Part No.	Description			Remark	Ref. No.	Part No.	Description			Remark
R456	1-218-965-11	METAL CHIP	10K	5%	1/16W	R602	1-218-990-81	SHORT CHIP	0		
R457	1-218-941-81	METAL CHIP	100	5%	1/16W	R603	1-218-949-11	METAL CHIP	470	5%	1/16W
R458	1-218-977-11	METAL CHIP	100K	5%	1/16W	R605	1-216-864-91	SHORT CHIP	0		
R459	1-218-990-81	SHORT CHIP	0			R608	1-216-799-11	METAL CHIP	15	5%	1/10W
R460	1-218-966-11	METAL CHIP	12K	5%	1/16W	R609	1-216-799-11	METAL CHIP	15	5%	1/10W
R461	1-218-965-11	METAL CHIP	10K	5%	1/16W	R610	1-218-990-81	SHORT CHIP	0		
R462	1-218-977-11	METAL CHIP	100K	5%	1/16W	R614	1-218-989-11	METAL CHIP	1M	5%	1/16W
R463	1-218-941-81	METAL CHIP	100	5%	1/16W	R615	1-218-955-11	METAL CHIP	1.5K	5%	1/16W
R464	1-218-951-11	METAL CHIP	680	5%	1/16W	R616	1-218-959-11	METAL CHIP	3.3K	5%	1/16W
R465	1-218-951-11	METAL CHIP	680	5%	1/16W	R620	1-218-973-11	METAL CHIP	47K	5%	1/16W
R466	1-218-965-11	METAL CHIP	10K	5%	1/16W	R621	1-218-973-11	METAL CHIP	47K	5%	1/16W
R467	1-218-965-11	METAL CHIP	10K	5%	1/16W	R622	1-218-973-11	METAL CHIP	47K	5%	1/16W
R500	1-218-977-11	METAL CHIP	100K	5%	1/16W	R623	1-218-973-11	METAL CHIP	47K	5%	1/16W
R502	1-218-977-11	METAL CHIP	100K	5%	1/16W	R629	1-218-964-81	METAL CHIP	8.2K	5%	1/16W
R503	1-218-977-11	METAL CHIP	100K	5%	1/16W	R631	1-218-990-81	SHORT CHIP	0		
R505	1-218-977-11	METAL CHIP	100K	5%	1/16W	R632	1-218-990-81	SHORT CHIP	0		
R506	1-218-953-11	METAL CHIP	1K	5%	1/16W	R633	1-216-864-91	SHORT CHIP	0		
R510	1-216-864-91	SHORT CHIP	0			R666	1-218-990-81	SHORT CHIP	0		
R511	1-218-971-81	METAL CHIP	33K	5%	1/16W	R700	1-218-959-11	METAL CHIP	3.3K	5%	1/16W
R512	1-220-200-81	METAL CHIP	30K	5%	1/16W	R701	1-218-959-11	METAL CHIP	3.3K	5%	1/16W
R519	1-250-519-11	METAL CHIP	10K	1%	1/16W	R702	1-218-965-11	METAL CHIP	10K	5%	1/16W
R520	1-250-519-11	METAL CHIP	10K	1%	1/16W	R703	1-218-949-11	METAL CHIP	470	5%	1/16W
R522	1-218-977-11	METAL CHIP	100K	5%	1/16W	R704	1-218-975-11	METAL CHIP	68K	5%	1/16W
R525	1-218-953-11	METAL CHIP	1K	5%	1/16W	R705	1-242-967-11	METAL CHIP	1	5%	1/16W
R526	1-218-949-11	METAL CHIP	470	5%	1/16W	R706	1-218-990-81	SHORT CHIP	0		
R527	1-218-953-11	METAL CHIP	1K	5%	1/16W	R707	1-218-990-81	SHORT CHIP	0		
R528	1-218-941-81	METAL CHIP	100	5%	1/16W	R708	1-218-990-81	SHORT CHIP	0		
R529	1-218-941-81	METAL CHIP	100	5%	1/16W	R709	1-218-990-81	SHORT CHIP	0		
R530	1-218-941-81	METAL CHIP	100	5%	1/16W	R710	1-218-947-11	METAL CHIP	330	5%	1/16W
R531	1-218-953-11	METAL CHIP	1K	5%	1/16W	R711	1-218-990-81	SHORT CHIP	0		
R532	1-218-953-11	METAL CHIP	1K	5%	1/16W	R712	1-218-990-81	SHORT CHIP	0		
R535	1-218-953-11	METAL CHIP	1K	5%	1/16W	R714	1-218-949-11	METAL CHIP	470	5%	1/16W
R536	1-218-971-81	METAL CHIP	33K	5%	1/16W	R715	1-218-975-11	METAL CHIP	68K	5%	1/16W
R537	1-218-953-11	METAL CHIP	1K	5%	1/16W	R716	1-218-951-11	METAL CHIP	680	5%	1/16W
R539	1-218-971-81	METAL CHIP	33K	5%	1/16W	R717	1-218-951-11	METAL CHIP	680	5%	1/16W
R540	1-245-604-11	METAL CHIP	10M	5%	1/16W	R718	1-218-990-81	SHORT CHIP	0		
R541	1-218-977-11	METAL CHIP	100K	5%	1/16W	R720	1-218-971-81	METAL CHIP	33K	5%	1/16W
R542	1-218-981-81	METAL CHIP	220K	5%	1/16W	R721	1-218-990-81	SHORT CHIP	0		
R543	1-218-977-11	METAL CHIP	100K	5%	1/16W	R722	1-218-990-81	SHORT CHIP	0		
R544	1-218-989-11	METAL CHIP	1M	5%	1/16W	R723	1-218-990-81	SHORT CHIP	0		
R545	1-218-990-81	SHORT CHIP	0			R725	1-218-990-81	SHORT CHIP	0		
R546	1-218-977-11	METAL CHIP	100K	5%	1/16W	R728	1-218-990-81	SHORT CHIP	0		
R548	1-218-977-11	METAL CHIP	100K	5%	1/16W	R729	1-218-975-11	METAL CHIP	68K	5%	1/16W
R549	1-218-965-11	METAL CHIP	10K	5%	1/16W	R730	1-218-990-81	SHORT CHIP	0		
R551	1-218-977-11	METAL CHIP	100K	5%	1/16W	R731	1-218-990-81	SHORT CHIP	0		
R560	1-218-977-11	METAL CHIP	100K	5%	1/16W	R732	1-218-990-81	SHORT CHIP	0		
R565	1-218-975-11	METAL CHIP	68K	5%	1/16W	R733	1-218-990-81	SHORT CHIP	0		
R566	1-218-977-11	METAL CHIP	100K	5%	1/16W	R734	1-218-990-81	SHORT CHIP	0		
R567	1-218-977-11	METAL CHIP	100K	5%	1/16W	R735	1-220-802-11	METAL CHIP	3.3	5%	1/16W
R568	1-218-941-81	METAL CHIP	100	5%	1/16W	R1001	1-216-864-91	SHORT CHIP	0		
R569	1-218-941-81	METAL CHIP	100	5%	1/16W	R1301	1-218-941-81	METAL CHIP	100	5%	1/16W
R570	1-218-977-11	METAL CHIP	100K	5%	1/16W	R1307	1-208-721-11	METAL CHIP	39K	0.5%	1/16W
R571	1-218-977-11	METAL CHIP	100K	5%	1/16W	R1308	1-208-911-11	METAL CHIP	10K	0.5%	1/16W
R572	1-218-941-81	METAL CHIP	100	5%	1/16W	R1309	1-208-709-11	METAL CHIP	12K	0.5%	1/16W
R573	1-218-941-81	METAL CHIP	100	5%	1/16W	R1311	1-216-821-11	METAL CHIP	1K	5%	1/10W
R574	1-218-941-81	METAL CHIP	100	5%	1/16W	R1312	1-216-821-11	METAL CHIP	1K	5%	1/10W
R575	1-218-941-81	METAL CHIP	100	5%	1/16W	R1316	1-218-990-81	SHORT CHIP	0		
R576	1-218-990-81	SHORT CHIP	0			R1321	1-218-961-11	METAL CHIP	4.7K	5%	1/16W
R600	1-216-864-91	SHORT CHIP	0			R1326	1-218-965-11	METAL CHIP	10K	5%	1/16W
R601	1-218-990-81	SHORT CHIP	0			R1331	1-218-941-81	METAL CHIP	100	5%	1/16W

CDX-G1200U/G1201U/G1202U/G1280UM

Ref. No.	Part No.	Description	Remark
PARTS FOR INSTALLATION AND CONNECTIONS			

501	X-2583-962-1	FRAME ASSY, FITTING	
502	4-276-003-03	KEY (FRAME) (1 piece)	
503	4-461-753-01	COLLAR	
504	3-255-785-02	COLLAR (1DIN) (G1280UM)	
505	1-846-032-11	CONNECTION CABLE (ISO) (POWER)	(AEP, UK, HK, AR)
505	1-846-978-11	CONNECTION CABLE, AUTOMOBILE (POWER)	(US, CND, E, EA, KR, IND, AUS)
506	1-465-459-51	ADAPTOR, ANTENNA (AR)	
507	X-2584-360-1	SCREW ASSY (BS), FITTING (AEP, UK, HK)	
507	X-2587-114-1	SCREW ASSY (BS4), FITTING	(E, EA, AR, KR, IND, AUS)
508	3-349-410-11	BUSHING (Except US, CND)	
509	3-934-325-21	SCREW, +K (5X8) TAPPING (1 piece)	(Except AEP, UK, HK)

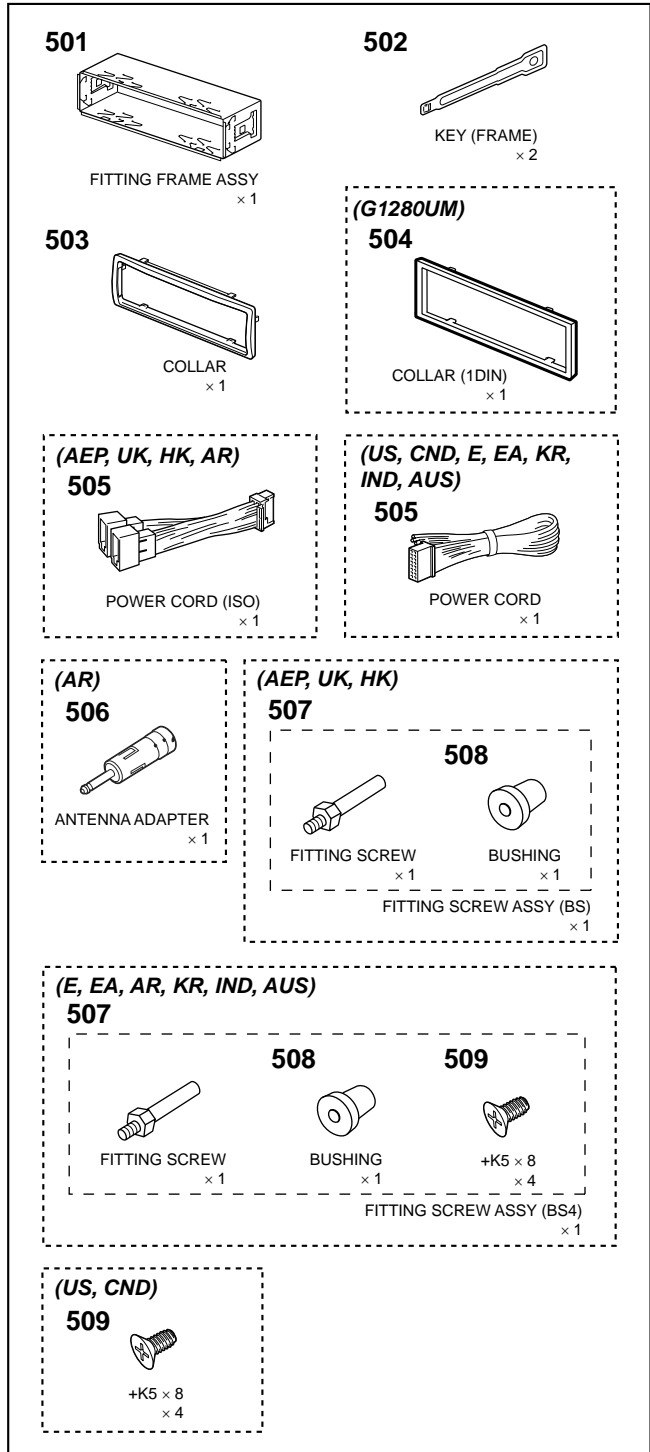

MEMO

