

5. Exploded View & Part List

5-1 HPT5054X/XAP Exploded View

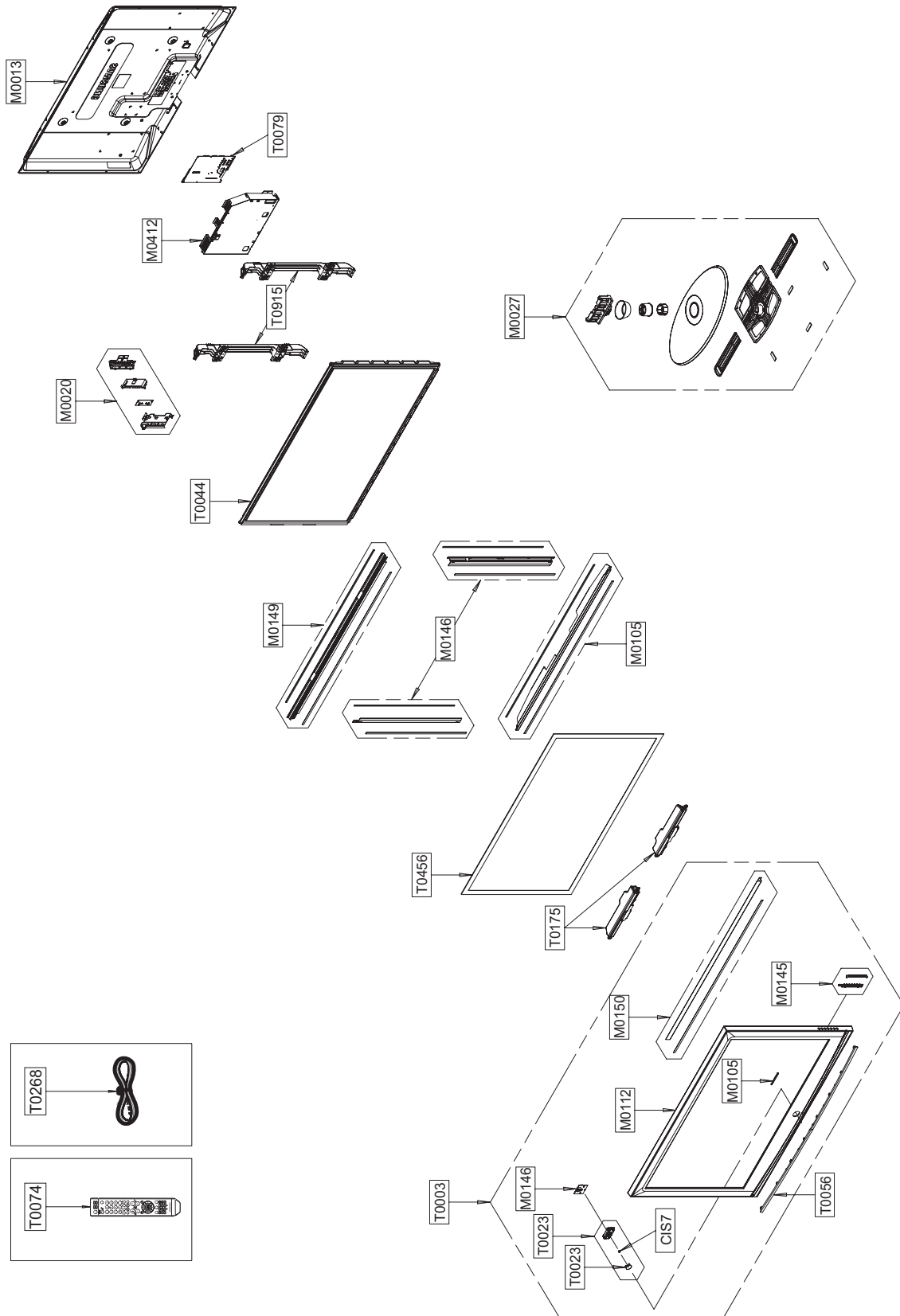

Loc. No.	Code No.	Description	Specification	Q'ty	SA/SNA	Remark
CIS7	AA61-60003B	SPRING ETC-CS	-,SUS304,-,-,OD11.2,N7,OD1	1	S.N.A	
M0013	BN96-04711E	ASSY COVER P-REAR	50Q9/C9,DO,PCM T0.5,BL	1	S.A	
M0020	BN96-05039G	ASSY BOARD P-SIDE HDMI A/V	HP-T5054,CT50	1	S.A	
M0027	BN96-04714B	ASSY STAND P-BASE	C9/Q9,ABS HB SF-0507,B	1	S.A	
M0105	BN67-00190A	LENS-LED	42Q9,PC,light blue,Material of	1	S.N.A	
M0112	BN63-03067B	COVER-FRONT	50C9,ABS,HB,BK23,STEAM MOLD	1	S.N.A	
M0145	BN96-04853B	ASSY BOARD P-FUNCTION	Lily/Calla,CT5000-	1	S.A	
M0146	BN96-04690A	ASSY BRACKET P-FILTER SIDE	50Q9,AL6063,T	2	S.N.A	
M0146	BN96-04861D	ASSY BOARD P-POWER & IR	Lily/Calla,CT500	1	S.A	
M0149	BN96-04688A	ASSY BRACKET P-FILTER TOP	50Q9,AL6063,T1	1	S.N.A	
M0150	BN96-04692A	ASSY BRACKET P-SUPPORT FILTER	50Q9,AL606	1	S.N.A	
M0150	BN96-04689A	ASSY BRACKET P-FILTER BOTTOM	50Q9,AL6063	1	S.N.A	
M0412	BN96-04903C	ASSY BRACKET P-PCB	42Q9,SECC T0.8	1	S.N.A	
T0003	BN96-04713B	ASSY COVER P-FRONT	50C9,ABS HB,BK23,STEAM	1	S.A	
T0023	BN96-04707A	ASSY COVER P-KNOB POWER	C9/Q9,ABS HB	1	S.A	
T0023	BN64-00567A	KNOB POWER	42Q9,PC,VIOLET	1	S.N.A	
T0044	BN96-05772A	ASSY PDP MODULE P	PL50HW025A,50HD W2A,PL	1	S.A	△
T0056	BN63-03081A	COVER-DECORATION	50C9,ABS,HB BLK	1	S.N.A	
T0074	BN59-00599A	REMOCON	Bordeaux plus,TM87C,SAMSUNG28P+E	1	S.A	
T0079	BN94-01418A	ASSY PCB MISC-MAIN	HPT5054X(C9),F34B,BN4	1	S.A	△
T0175	BN96-04704A	ASSY SPEAKER P	8ohm,C9,10W,4P connector,	1	S.A	
T0268	3903-000144	CBF-POWER CORD	DT,US,BP3/Y,U(IEC C13-RA)	1	S.A	
T0456	BN67-00199A	GLASS-FILTER EMI	50", C9,Sputter,46%,115	1	S.A	△
T0915	BN61-02895B	HOLDER-MODULE	50Q9,PCABS	2	S.N.A	

5-2 HPT5054X/XAP Service Item

※ This is the list which is available to repair the real material at the time of service.

Loc. No.	Code No.	Description	Specification	Q'ty	Remark
M0013	BN96-04711E	ASSY COVER P-REAR	50Q9/C9,DO,PCM T0.5,BL	1	
M0027	BN96-04714B	ASSY STAND P-BASE	C9/Q9,ABS HB SF-0507,B	1	
M2893	BN39-00802C	LEAD CONNECTOR	HPT4264H,UL1617#22,24P/24	1	
M2893	BN39-00859A	LEAD CONNECTOR	CALLA 50",UL20276#30,UL/C	1	
T0003	BN96-04713B	ASSY COVER P-FRONT	50C9,ABS HB,BK23,STEA	1	
T0044	BN96-05772A	ASSY PDP MODULE P	PL50HW025A,50HD W2A,PL	1	△
T0074	BN59-00599A	REMOCON	Bordeaux plus,TM87C,SAMSUNG28P+E	1	
T0079	BN94-01418A	ASSY PCB MISC-MAIN	HPT5054X(C9),F34B,BN4	1	△
T0175	BN96-04704A	ASSY SPEAKER P	8ohm,C9,10W,4P connector,	1	
T0764	BN44-00160A	SMPS-PDP TV	PS50P7H,DYREL,AC/DC,460W,AC1	1	△
T1910	BN96-06091A	ASSY PDP MODULE P-X-MAIN BOARD	PL50HW025	1	△
T1911	BN96-06092A	ASSY PDP MODULE P-Y-MAIN BOARD	PL50HW025	1	△
T1914	BN96-06096A	ASSY PDP MODULE P-ADDRESS E BU	PL50HW025	1	
T1915	BN96-06097A	ASSY PDP MODULE P-ADDRESS F BU	PL50HW025	1	
T1917	BN96-06095A	ASSY PDP MODULE P-LOGIC MAIN	PL50HW025A,	1	
T1960	BN96-06093A	ASSY PDP MODULE P-Y-MAIN UPPER	PL50HW025	1	
T1961	BN96-06094A	ASSY PDP MODULE P-Y-MAIN LOWWE	PL50HW025	1	