

4-2 L3 Engine Ass'y

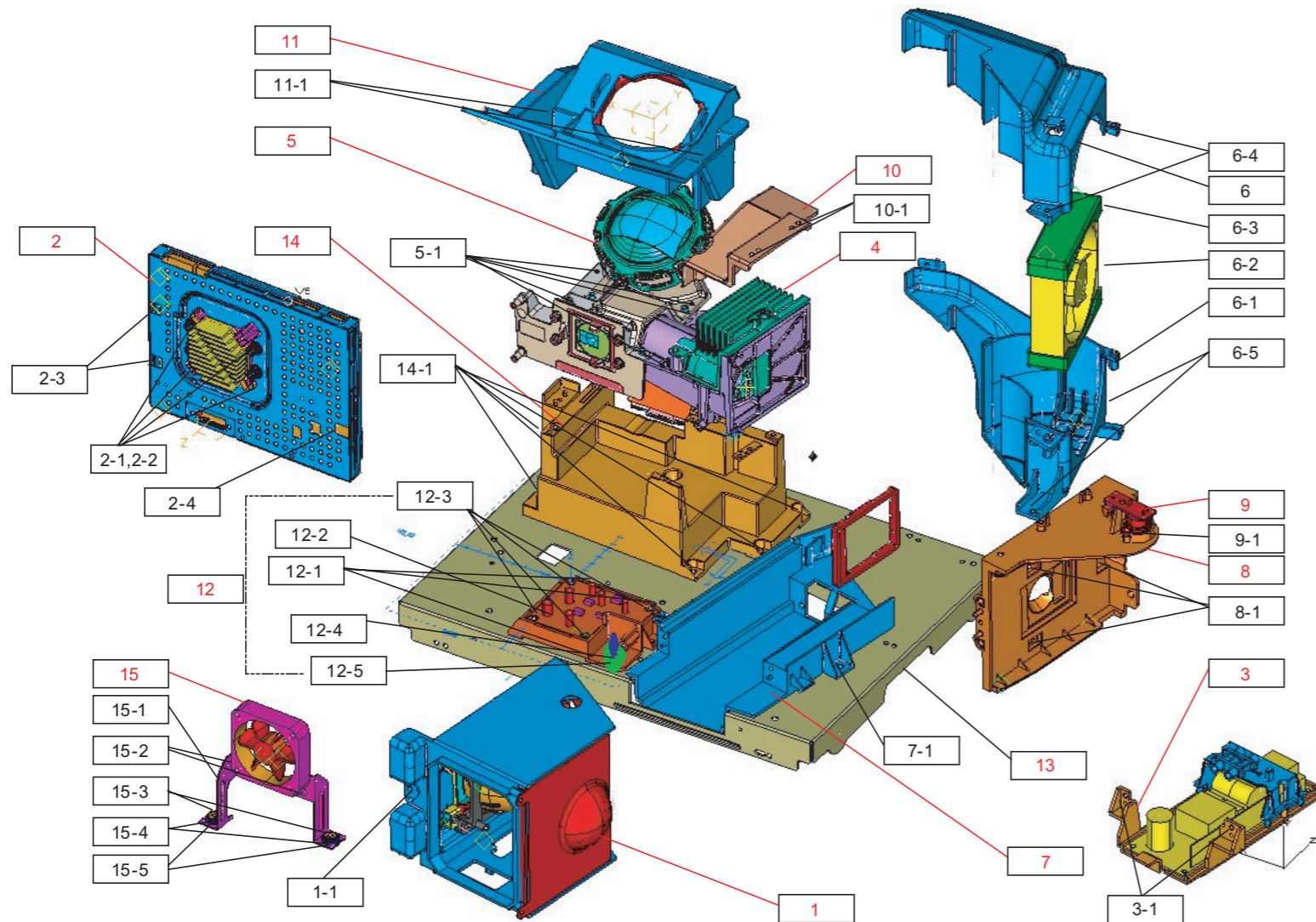

L3 Engine Exploded View List						
No.	Loc. No.	Description	Code No.	Specification	Q'ty	SA/SNA
1	T0888	BP96-00826A	ASSY LAMP P	L3,LAMP SERVICE,PHILIPS 120W	1	S.A
1-1	CCM1	6006-001039	SCREW-MACHINE	WSP,PH,+,M4,L12,ZPC(YEL),S	1	S.N.A
2	T0703	BP96-00678B	ASSY DMD BOARD P	L3 PHILIPS,DMD BOARD,SE	1	S.A
2-1		AA61-01195A	SPRING ETC-COIL,DMD	B3K,SPRING STEEL	4	S.N.A
2-2	CCM1	6001-000819	SCREW-MACHINE	PWH,+,-,M3,L30,ZPC(YEL),SW	4	S.N.A
2-3	M0081	6006-000248	SCREW-TAPTITE	PWH,+,-,S,M3,L8,ZPC(YEL),S	2	S.N.A
2-4	M0081	6003-000264	SCREW-TAPTITE	PWH,+B,M3,L6,ZPC(YEL),SWR	1	S.N.A
3	T0751	BP96-00690A	ASSY BALLAST P	L3,SERVICE BALLST	1	S.A
3-1	M0081	6003-001023	SCREW-TAPTITE	PWH,+B,M3,L10,ZPC(YEL),SW	2	S.N.A
4		BP98-00489A	ASSY K/D-COLOR WHEEL	L3 ENGINE,SERVICE	1	S.N.A
5		BP98-00490A	ASSY K/D-OPTIC MODULE	L3 ENGINE(AIR),SER	1	S.N.A
5-1	M0081	6003-000277	SCREW-TAPTITE	BH,+B,M3,L12,ZPC(YEL),SWR	5	S.N.A
6		BP63-00295A	COVER DUCT-TOP23	SVP-50L3HR,PC G/F20	1	S.N.A
6-1		BP63-00296A	COVER DUCT-BOTTOM23	SVP-50L3HR,PC G/F20	1	S.N.A
6-2	T0286	BP31-00010B	FAN-DC	SVP-50L7XHD,UL94V-0, PBT,Wire Len	1	S.A
6-3		BP73-00012A	RUBBER-FAN,LAMP	SHP700,NBR,50,LOSS FACTO	2	S.N.A
6-4	M0081	6003-001023	SCREW-TAPTITE	PWH,+B,M3,L10,ZPC(YEL),SW	3	S.N.A
6-5	CCM1	6006-001039	SCREW-MACHINE	WSP,PH,+,M4,L12,ZPC(YEL),S	3	S.N.A
7		BP61-00732A	GUIDE-BALLAST 23	SVP-50L3HR,PC G/F 20	1	S.N.A
7-1	CCM1	6006-001039	SCREW-MACHINE	WSP,PH,+,M4,L12,ZPC(YEL),S	3	S.N.A
8		BP61-00726A	HOUSING-LAMP,BOTTOM 23	SVP-50L3HR,AL D/	1	S.N.A
8-1	M0081	6006-000249	SCREW-TAPTITE	PWH,+,-,S,M3,L7,ZPC(YEL),S	3	S.N.A
9	T0926	BP91-00612A	ASSY MISC-THERMOSTAT	HLP5063W,L62B	1	S.N.A
9-1	CCM1	6006-001035	SCREW-MACHINE	WSP,PH,+,M3,L8,ZPC(YEL),SW	2	S.N.A
10		BP63-00299A	COVER-CW 23	SVP-50L3HR,PC G/F20	1	S.N.A
10-1	CCM1	6006-001035	SCREW-MACHINE	WSP,PH,+,M3,L8,ZPC(YEL),SW	2	S.N.A
11		BP63-00338A	COVER-LENS PROJECTION	SVP-50L3,PS,T0.3	1	S.N.A
11-1	M0081	6003-001023	SCREW-TAPTITE	PWH,+B,M3,L10,ZPC(YEL),SW	2	S.N.A
12		BP61-00668A	HOLDER-INTERFACE	SVP-50L3HR,ABS V0 BLK	1	S.N.A
12-1	CCM1	6006-001039	SCREW-MACHINE	WSP,PH,+,M4,L12,ZPC(YEL),S	3	S.N.A
12-2	T0753	BP94-02149K	ASSY PCB S-ACTUATOR	DP,BP41-00121A,L62B,	1	S.A
12-3	M0081	6003-001023	SCREW-TAPTITE	PWH,+B,M3,L10,ZPC(YEL),SW	4	S.N.A
12-4		BP91-00775A	ASSY MISC-DETECTOR S/W	HLP5063WX/XAA,L62	1	S.N.A
12-5	M0081	6003-001023	SCREW-TAPTITE	PWH,+B,M3,L10,ZPC(YEL),SW	1	S.N.A
13		BP61-00730A	BRACKET-BASE 23	SVP-50L3HR,SECC,1.6	1	S.N.A
14		BP61-00590A	HOLDER-BASE	DLP L3,PPS G/F30	1	S.N.A
14-1	CCM1	6006-001039	SCREW-MACHINE	WSP,PH,+,M4,L12,ZPC(YEL),S	6	S.N.A
15	T0286	BP31-00011A	FAN-DC	AD0612LB-D72GL,P.B.T UL94-Vo,Wire	1	S.A
15-1		BP61-00595A	BRACKET-FAN DMD	DLP L3,SECC,T1.0	1	S.N.A
15-2	M0081	6006-000250	SCREW-TAPTITE	BH,+WT,B,M3,L20,ZPC(YEL),	2	S.N.A
15-3	M0081	6003-000199	SCREW-TAPTITE	PWH,+B,M3,L14,ZPC(YEL),SW	2	S.N.A
15-4		BN61-00236A	HOLDER-SPACER,RUBBER	B3K,BSBM	2	S.N.A
15-5		BP73-00040A	RUBBER-DAMP FAN	HLN507W,CR,30,BLACK,V0	2	S.N.A