

5. Exploded View & Part List

5-1 HL61A750A1FXZA Exploded View

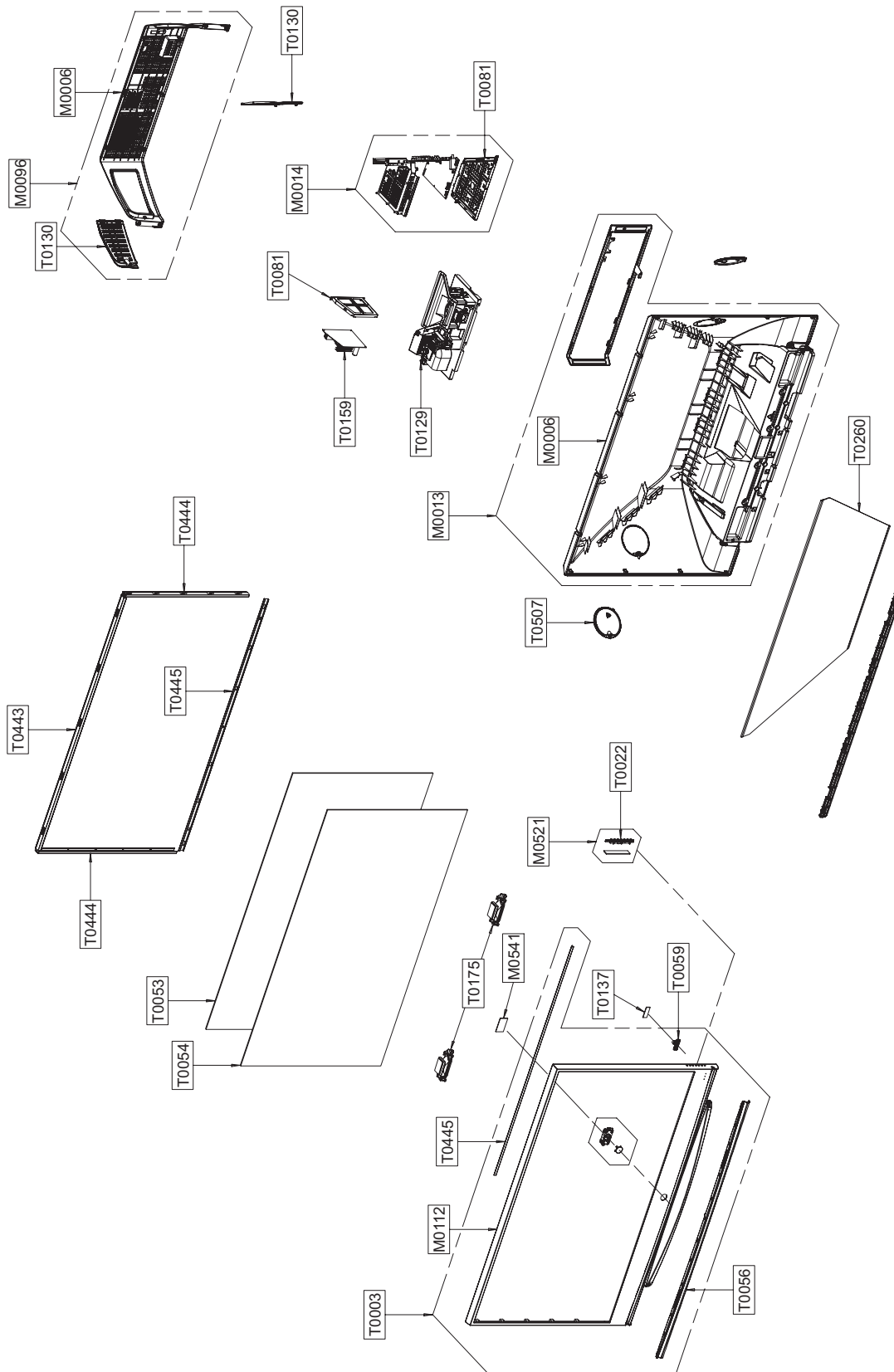

Loc. No.	Code No.	Description	Specification	Q'ty	SA/SNA	Remark
M0006	BP63-00880A	COVER-REAR BOTTOM	56K6(SLIM),PS,V0,BK500	1	S.N.A	
M0006	BP63-00883A	COVER-REAR	61K8(SLIM),PS,V0,BK500,NON-DE	1	S.N.A	
M0013	BP96-02056A	ASSY COVER P-REAR	61K8,PS,V0,BK500,NON-D	1	S.A	
M0014	BP96-02089A	ASSY PCB P-MAIN	AQUAMARINE,L70A,BP94-023	1	S.A	△
M0096	BP96-01743C	ASSY COVER P-REAR BOTTOM	K8(LED),,PS,V0,	1	S.A	
M0112	BP63-01071A	COVER-FRONT	61A750,ABS+PMMA,HB,BK23,STEAL	1	S.N.A	
M0521	BP96-01802A	ASSY PCB P-KEY CONTROL	HLT5075SX/XAA,L64	1	S.A	
M0541	BP96-02052A	ASSY BOARD P-RMC	AquaMarine,CT5000-5750A	1	S.A	
T0003	BP96-02022A	ASSY COVER P-FRONT	D750 61",ABS+PMMA,HB,	1	S.A	
T0022	BP64-00610B	KNOB CONTROL	K6/K8,ABS,HB,ORIGINAL COLOR	1	S.N.A	
T0053	BP67-00361A	SCREEN FRESNEL	CITRINE,1.9T,61W, 1372mm	1	S.A	
T0054	BP67-00344A	SCREEN LENTI	Laurel,1.7T,61W, 1372mm x 7	1	S.A	
T0056	BP63-01092A	COVER-DECORATION	61A750,HIPS HB,DGM-1713	1	S.N.A	
T0059	BP64-00625A	INDICATOR LED	56K6(SLIM),PC,CLEAR	1	S.N.A	
T0081	BP61-01408A	BRACKET-POWER	56K8(SLIM LED),SECC,T0.8,N	1	S.N.A	
T0081	BP61-01601A	BRACKET-MAIN	750 series,SECC,T0.5,NTR	1	S.N.A	
T0129	BP91-02113A	ASSY ENGINE	A750(61,67 INCH),GEN 2.3 LED	1	S.N.A	△
T0130	BP63-00968A	COVER DUCT	56K8(SLIM LED),ABS,-,-,V0(N	1	S.N.A	
T0130	BP96-02023A	ASSY COVER P-TERMINAL BOARD	D650/750,PS	1	S.A	
T0137	BP96-01861A	ASSY PCB P-LED	K6,-,-,(BP94-02304C),-	1	S.A	
T0159	BP96-01726B	ASSY PCB P-SMPS	Aquamarine,LED DLP TV,DC2	1	S.A	△
T0175	BP96-01794A	ASSY SPEAKER P	8ohm,Horn type,10W,1100/4	1	S.A	
T0260	BP67-00321A	MIRROR-FRONT	61K6,Glass,1274×644×717×	1	S.A	
T0443	BP96-01755A	ASSY BRACKET P-SCREEN TOP	-,61K8,-,AL606	1	S.N.A	
T0444	BP96-01753A	ASSY BRACKET P-SCREEN SIDE	-,61K8(LEFT),	1	S.N.A	
T0444	BP96-01754A	ASSY BRACKET P-SCREEN SIDE	-,61K8(RIGHT)	1	S.N.A	
T0445	BP96-01819A	ASSY BRACKET P-SCREEN BOTTOM	-,61K8,TOP,	1	S.N.A	
T0445	BP96-01752B	ASSY BRACKET P-SCREEN BOTTOM	-,61K7,-,AL	1	S.N.A	
T0507	BP63-00832A	COVER-DUST	46K5(SLIM),PS,HB,BK500	2	S.N.A	

5-2 HL67A750A1FXZA Exploded View

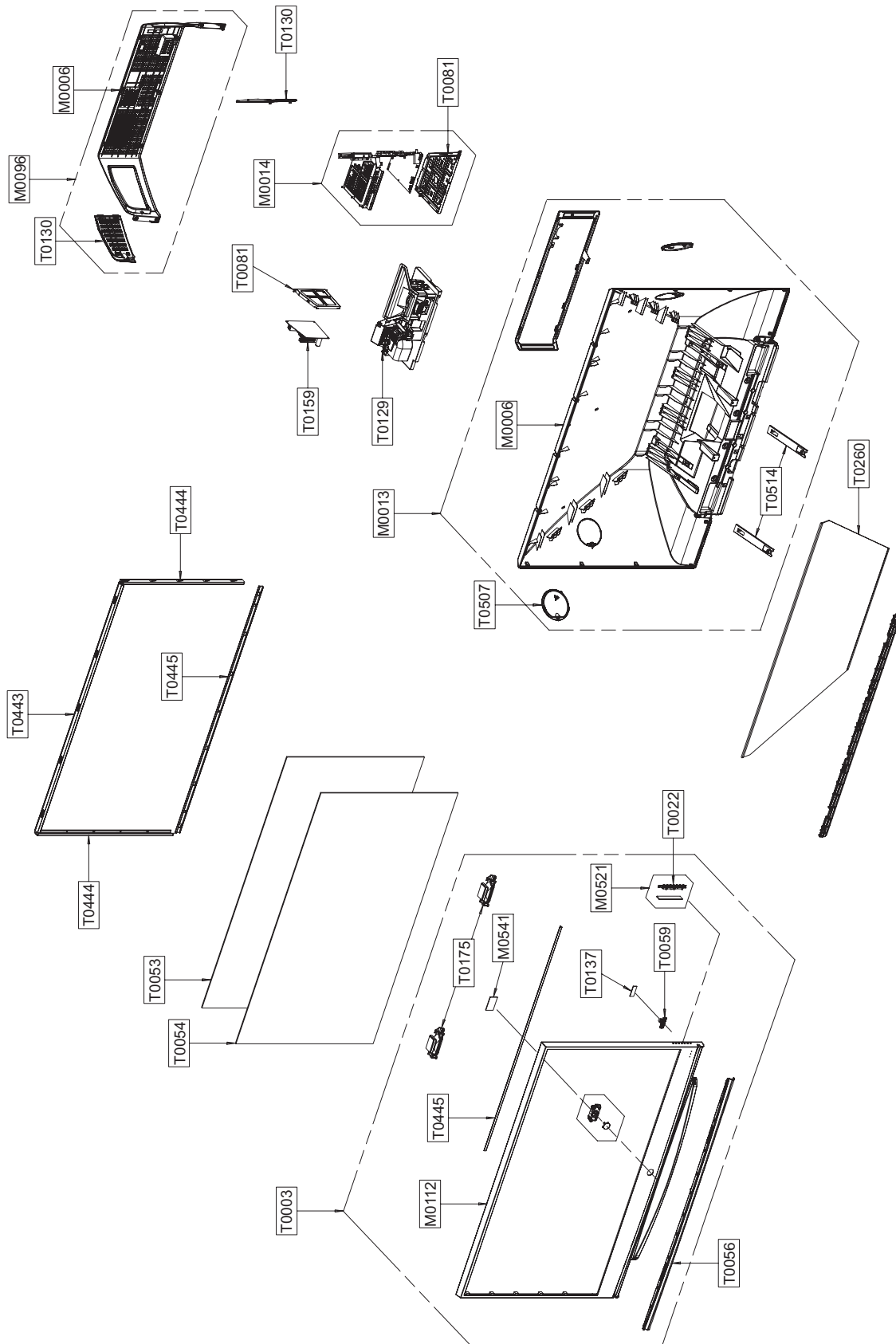

Loc. No.	Code No.	Description	Specification	Q'ty	SA/SNA	Remark
M0006	BP63-00880A	COVER-REAR BOTTOM	56K6(SLIM),PS,V0,BK500	1	S.N.A	
M0006	BP63-01074A	COVER-REAR	67A750,PS,V0,BK500,NON-DECA	1	S.N.A	
M0013	BP96-02025A	ASSY COVER P-REAR	D750 67"	1	S.A	
M0014	BP96-02089A	ASSY PCB P-MAIN	AQUAMARINE,L70A,BP94-023	1	S.A	△
M0096	BP96-01743C	ASSY COVER P-REAR BOTTOM	K8(LED),,PS,V0,	1	S.A	
M0112	BP63-01072A	COVER-FRONT	67A750,ABS+PMMA,HB,BK23,STEAL	1	S.N.A	
M0521	BP96-01802A	ASSY PCB P-KEY CONTROL	HLT5075SX/XAA,L64	1	S.A	
M0541	BP96-02052A	ASSY BOARD P-RMC	AquaMarine,CT5000-5750A	1	S.A	
T0003	BP96-02024A	ASSY COVER P-FRONT	D750 67",ABS+PMMA,HB,	1	S.A	
T0022	BP64-00610B	KNOB CONTROL	K6/K8,ABS,HB,ORIGINAL COLOR	1	S.N.A	
T0053	BP67-00352A	SCREEN FRESNEL	K3, 67inch, DNP,MS,offset	1	S.A	
T0054	BP67-00355A	SCREEN LENTI	aquamarine, 67inch, DNP,MS,	1	S.A	
T0056	BP63-01093A	COVER-DECORATION	67A750,HIPS HB,DGM-1713	1	S.N.A	
T0059	BP64-00625A	INDICATOR LED	56K6(SLIM),PC,CLEAR	1	S.N.A	
T0081	BP61-01408A	BRACKET-POWER	56K8(SLIM LED),SECC,T0.8,N	1	S.N.A	
T0081	BP61-01601A	BRACKET-MAIN	750 series,SECC,T0.5,NTR	1	S.N.A	
T0129	BP91-02113B	ASSY ENGINE	A750(67 INCH),GEN 2.3 LED	1	S.N.A	△
T0130	BP63-00968A	COVER DUCT	56K8(SLIM LED),ABS,-,-,-,V0(N	1	S.N.A	
T0130	BP96-02023A	ASSY COVER P-TERMINAL BOARD	D650/750,PS	1	S.A	
T0137	BP96-01861A	ASSY PCB P-LED	K6,-,-,-,(BP94-02304C),-	1	S.A	
T0159	BP96-01726B	ASSY PCB P-SMPS	Aquamarin,LED DLP TV,DC2	1	S.A	△
T0175	BP96-01794A	ASSY SPEAKER P	8ohm,Horn type,10W,1100/4	1	S.A	
T0260	BP67-00353A	MIRROR-FRONT	67K8,Glass,1407.84×719×79	1	S.A	
T0267	BP61-01628A	BRACKET-MIRROR TOP	67A750,AL 6063 EXTR	1	S.N.A	
T0443	BP96-02030A	ASSY BRACKET P-SCREEN TOP	D750 67",AL606	1	S.N.A	
T0444	BP96-02026A	ASSY BRACKET P-SCREEN SIDE	D750 67"(RIGH	1	S.N.A	
T0444	BP96-02031A	ASSY BRACKET P-SCREEN SIDE	D750 67"(LEFT	1	S.N.A	
T0445	BP96-02027A	ASSY BRACKET P-SCREEN BOTTOM	D750 67"(BO	1	S.N.A	
T0445	BP96-02029A	ASSY BRACKET P-SCREEN BOTTOM	D750 67"(TO	1	S.N.A	
T0507	BP63-00832A	COVER-DUST	46K5(SLIM),PS,HB,BK500	2	S.N.A	
T0514	BP61-01631A	BRACKET-SUPPORT	67A750,SECC,T1.2,NTR,BAC	2	S.N.A	

5-3 HL61A750A1FXZA Service Item

※ This is the list which is available to repair the real material at the time of service.

Loc. No.	Code No.	Description	Specification	Q'ty	SA/SNA	Remark
M0013	BP96-02056A	ASSY COVER P-REAR	61K8,PS,V0,BK500,NON-D	1	S.A	
M0014	BP96-02089A	ASSY PCB P-MAIN	AQUAMARINE,L70A,BP94-023	1	S.A	△
M0096	BP96-01743C	ASSY COVER P-REAR BOTTOM	K8(LED),,PS,V0,	1	S.A	
M0910	BP07-00029A	LED DISPLAY-RED	Phlat light,PT 120,W=4.6	1	S.A	
M0911	BP07-00030A	LED DISPLAY-GREEN	Phlat light,PT 120,W=4	1	S.A	
M0912	BP07-00031A	LED DISPLAY-BLUE	Phlat light,PT 120,W=4.	1	S.A	
M2893	BN39-00640C	LEAD CONNECTOR	HLS5686W,UL1007#26,UL/CSA	1	S.A	
M2893	BP39-00174J	LEAD CONNECTOR	HL56A650C,UL1007#22,UL/CS	1	S.A	
M2893	BP39-00180D	LEAD CONNECTOR	HLS4676SX/XAA,UL1015#18,U	1	S.A	
M2893	BP39-00247A	LEAD CONNECTOR	LAUREL.,UL1617#22,UL/CSA,	1	S.A	
M2893	BP39-00254B	LEAD CONNECTOR	HLT5687SX/XAA,UL2835#28,U	1	S.A	
M2893	BP39-00255A	LEAD CONNECTOR	HLT5687SX/XAA,UL1061#28,U	1	S.A	
M2893	BP39-00265B	LEAD CONNECTOR	Laurel,UL1015 #14,UL/CSA,	1	S.A	
M2893	BP39-00265B	LEAD CONNECTOR	Laurel,UL1015 #14,UL/CSA,	1	S.A	
M2893	BP39-00266B	LEAD CONNECTOR	Laurel,UL1015 #14,UL/CSA,	1	S.A	
M2893	BP39-00266B	LEAD CONNECTOR	Laurel,UL1015 #14,UL/CSA,	1	S.A	
M2893	BP39-00267B	LEAD CONNECTOR	Laurel,UL1015 #14,UL/CSA,	1	S.A	
M2893	BP39-00267B	LEAD CONNECTOR	Laurel,UL1015 #14,UL/CSA,	1	S.A	
M2893	BP39-00268B	LEAD CONNECTOR	aquamarine,UL1061#28,UL/C	1	S.A	
M2893	BP39-00268B	LEAD CONNECTOR	aquamarine,UL1061#28,UL/C	1	S.A	
M2893	BP39-00274B	LEAD CONNECTOR	LOTUS,UL2464#26,UL2464 #2	1	S.A	
M2893	BP39-00297A	LEAD CONNECTOR	HLT5689SX/XAA,UL1617#22,U	1	S.A	
M2893	BP39-00297A	LEAD CONNECTOR	HLT5689SX/XAA,UL1617#22,U	1	S.A	
M2893	BP39-00298A	LEAD CONNECTOR	HLT5689SX/XAA,UL1061#28,5	1	S.A	
M2893	BP39-00299A	LEAD CONNECTOR	HLT5689SX/XAA,UL1617#22,U	1	S.A	
T0003	BP96-02022A	ASSY COVER P-FRONT	D750 61",ABS+PMMA,HB,	1	S.A	
T0053	BP67-00361A	SCREEN FRESNEL	CITRINE,1.9T,61W, 1372mm	1	S.A	
T0054	BP67-00344A	SCREEN LENTI	Laurel,1.7T,61W, 1372mm x 7	1	S.A	
T0074	BN59-00673A	REMOCON	PEARL,TM96A,49,USA,SAMSUNG,TOOLS	1	S.A	
T0100	BP62-00097A	HEAT SINK-PIPE RED	K750,CU, AL,RED	1	S.A	
T0101	BP62-00098A	HEAT SINK-PIPE GREEN	K750,CU, AL,GREEN	1	S.A	
T0102	BP62-00099A	HEAT SINK-PIPE BLUE	K750,CU, AL,BLUE	1	S.A	
T0129	BP96-02090A	ASSY PCB P-DMD	AQUAMARINE,L70A,BP94-0232	1	S.A	△
T0159	BP96-01726B	ASSY PCB P-SMPS	Aquamarin,LED DLP TV,DC2	1	S.A	△
T0175	BP96-01794A	ASSY SPEAKER P	8ohm,Horn type,10W,1100/4	1	S.A	
T0764	BP44-01001A	SMPS-DLP TV	PN082DPS-VF(A),AC/DC,90V-132	1	S.A	△
M0241	BP96-02013A	ASSY PCB P-COLOR SENSOR	HL61A750A1FXZA,L	1	S.A	
M0521	BP94-02327A	ASSY PCB S-LED DRIVE	HL61A750A1FXZA,L70A	1	S.A	
T0136	BP31-00032A	FAN	3110RL-04W-S19-H04,DC FAN	1	S.A	
T0136	BP31-00025B	FAN	K880 DLP TV(LAUREL)	2	S.A	
T0268	4719-001997	DLP	1920x1080/xHD5,0.65"/ DC4,Type X Non	1	S.A	
T0965	BP64-00661A	GLASS-ACTUATOR	K880, high reflexivity,	1	S.A	△

5-4 HL67A750A1FXZA Service Item

※ This is the list which is available to repair the real material at the time of service.

Loc. No.	Code No.	Description	Specification	Q'ty	SA/SNA	Remark
M0013	BP96-02025A	ASSY COVER P-REAR	D750 67"	1	S.A	
M0014	BP96-02089A	ASSY PCB P-MAIN	AQUAMARINE,L70A,BP94-023	1	S.A	△
M0096	BP96-01743C	ASSY COVER P-REAR BOTTOM	K8(LED),,PS,V0,	1	S.A	
M0910	BP07-00029A	LED DISPLAY-RED	Phlat light,PT 120,W=4.6	1	S.A	
M0911	BP07-00030A	LED DISPLAY-GREEN	Phlat light,PT 120,W=4	1	S.A	
M0912	BP07-00031A	LED DISPLAY-BLUE	Phlat light,PT 120,W=4.	1	S.A	
M2893	BN39-00640C	LEAD CONNECTOR	HLS5686W,UL1007#26,UL/CSA	1	S.A	
M2893	BP39-00174J	LEAD CONNECTOR	HL56A650C,UL1007#22,UL/CS	1	S.A	
M2893	BP39-00180D	LEAD CONNECTOR	HLS4676SX/XAA,UL1015#18,U	1	S.A	
M2893	BP39-00247A	LEAD CONNECTOR	LAUREL.,UL1617#22,UL/CSA,	1	S.A	
M2893	BP39-00254B	LEAD CONNECTOR	HLT5687SX/XAA,UL2835#28,U	1	S.A	
M2893	BP39-00255A	LEAD CONNECTOR	HLT5687SX/XAA,UL1061#28,U	1	S.A	
M2893	BP39-00265B	LEAD CONNECTOR	Laurel,UL1015 #14,UL/CSA,	1	S.A	
M2893	BP39-00265B	LEAD CONNECTOR	Laurel,UL1015 #14,UL/CSA,	1	S.A	
M2893	BP39-00266B	LEAD CONNECTOR	Laurel,UL1015 #14,UL/CSA,	1	S.A	
M2893	BP39-00266B	LEAD CONNECTOR	Laurel,UL1015 #14,UL/CSA,	1	S.A	
M2893	BP39-00267B	LEAD CONNECTOR	Laurel,UL1015 #14,UL/CSA,	1	S.A	
M2893	BP39-00267B	LEAD CONNECTOR	Laurel,UL1015 #14,UL/CSA,	1	S.A	
M2893	BP39-00268B	LEAD CONNECTOR	aquamarine,UL1061#28,UL/C	1	S.A	
M2893	BP39-00268B	LEAD CONNECTOR	aquamarine,UL1061#28,UL/C	1	S.A	
M2893	BP39-00274B	LEAD CONNECTOR	LOTUS,UL2464#26,UL2464 #2	1	S.A	
M2893	BP39-00297A	LEAD CONNECTOR	HLT5689SX/XAA,UL1617#22,U	1	S.A	
M2893	BP39-00297A	LEAD CONNECTOR	HLT5689SX/XAA,UL1617#22,U	1	S.A	
M2893	BP39-00298A	LEAD CONNECTOR	HLT5689SX/XAA,UL1061#28,5	1	S.A	
M2893	BP39-00299A	LEAD CONNECTOR	HLT5689SX/XAA,UL1617#22,U	1	S.A	
T0003	BP96-02024A	ASSY COVER P-FRONT	D750 67",ABS+PMMA,HB,	1	S.A	
T0053	BP67-00352A	SCREEN FRESNEL	K3, 67inch, DNP,MS,offset	1	S.A	
T0054	BP67-00355A	SCREEN LENTI	aquamarine, 67inch, DNP,MS,	1	S.A	
T0074	BN59-00673A	REMOCON	PEARL,TM96A,49,USA,SAMSUNG,TOOLS	1	S.A	
T0100	BP62-00097A	HEAT SINK-PIPE RED	K750,CU, AL,RED	1	S.A	
T0101	BP62-00098A	HEAT SINK-PIPE GREEN	K750,CU, AL,GREEN	1	S.A	
T0102	BP62-00099A	HEAT SINK-PIPE BLUE	K750,CU, AL,BLUE	1	S.A	
T0129	BP96-02090A	ASSY PCB P-DMD	AQUAMARINE,L70A,BP94-0232	1	S.A	△
T0159	BP96-01726B	ASSY PCB P-SMPS	Aquamarin,LED DLP TV,DC2	1	S.A	△
T0175	BP96-01794A	ASSY SPEAKER P	8ohm,Horn type,10W,1100/4	1	S.A	
T0764	BP44-01001A	SMPS-DLP TV	PN082DPS-VF(A),AC/DC,90V-132	1	S.A	△
M0241	BP96-02013A	ASSY PCB P-COLOR SENSOR	HL61A750A1FXZA,L	1	S.A	
M0521	BP94-02327A	ASSY PCB S-LED DRIVE	HL61A750A1FXZA,L70A	1	S.A	
T0136	BP31-00032A	FAN	3110RL-04W-S19-H04,DC FAN	1	S.A	
T0136	BP31-00025B	FAN	K880 DLP TV(LAUREL)	2	S.A	
T0268	4719-001997	DLP	1920x1080/xHD5,0.65"/ DC4,Type X Non	1	S.A	
T0965	BP64-00661A	GLASS-ACTUATOR	K880, high reflexivity,	1	S.A	△

MEMO

10P DMD POWER CABLE, 24P POWER CABLE,M289 2-PIN,M2893 A/ENGINE,T0129 A/KCTRL A/MAIN,M0014 A/SMPS,T0159 ACF,T0003 ACR,M0013 ACRBOT ACTB ALED,T0137 ARMC,M0541 ASPK,T0175 B/MAIN+C/R,B/MIRROR+ BAG,T0524 BASE-E+COVER P/J,BAS BATT,T0685 BD1000,BD1001,BD1002 BD1001,BD1101,BD1102 BD1005,BD802,BD803,B BD1201,T0121 BD304,BD305,BD306,L1 BD401,BD402,BD403,BD BD600,BD601,BD602,BD BD601,BD602,L309,L31 BD9000,BD9001,BD9002 BRACKET-E+BASE-E,BRA BRK FAN+ FAN,M0081 BRK FAN+FAN,COVER-FA BRKT+DMD,T0136 C1,C9002,C104,C105,C C1001,C1002,C1005,C3 C1006,C120,C152,C304 C1014,C1015,C1021,C2 C1016,C1205,C1307,C1 C1017,C103,C1101,C11 C1018,C252,C313 C1019,C1020,C1101 C1022,C1023,AD480 C1022,C375,C376,C153 C1024,C1029 C1034,C3 C1035,C526,C527,C702	BP39-00274B BP39-00174J BP39-00247A BP91-02113B BP96-01802A BP94-02326A BP96-01726B BP96-02024A BP96-02025A BP96-01743C BP96-02023A BP96-01861A BP96-02052A BP96-01794A 6002-001294 6902-000018 6003-001782 4301-000103 3301-001145 3301-001404 3301-001569 3301-000316 3301-001428 3301-001236 3301-001393 2703-001778 3301-001412 6001-000581 6003-001355 AA60-10050T BP31-00029B 2203-006333 2203-001554 2203-000405 2203-000280 2203-006361 2203-000189 2203-001630 2203-000697 2203-006024 2203-000426 2409-001127 2203-000384 2203-000626	LEAD CONNECTOR;LOTUS,UL2464#26,UL2464 #2 LEAD CONNECTOR;HL56A650C,UL1007#22,UL/CS LEAD CONNECTOR;LAUREL.,UL1617#22,UL/CSA, ASSY ENGINE;A750(67 INCH),GEN 2.3 LED ASSY PCB P-KEY CONTROL;HLT5075SX/XAA,L64 ASSY PCB MAIN;HL61A750A1FXZA,AQUAMARINE ASSY PCB P-SMPS;AQUAMARIN,LED DLP TV,DC2 ASSY COVER P-FRONT;D750 67",ABS+PMMA,HB, ASSY COVER P-REAR;D750 67" ASSY COVER P-REAR BOTTOM;K8(LED),,PS,V0, ASSY COVER P-TERMINAL BOARD;D650/750,PS ASSY PCB P-LED;K6,-,-,(BP94-02304C),- ASSY BOARD P-RMC;AQUAMARINE,CT5000-5750A ASSY SPEAKER P;8OHM,HORN TYPE,10W,1100/4 SCREW-TAPPING;BH,+,,M4,L16,ZPC(BLK) BAG PE;LDPE,TO.1,W280,L400,CLEAR,8,2,20. SCREW-TAPTYPE;BH,+ ,B,M4,L12,ZPC(BLK),SWR BATTERY-ALKALINE;1.5V,750MAH,LR03,10.5X4 BEAD-SMD;600HM,4516,TP,700HM/45MHZ,82OHM BEAD-SMD;300HM,2012,TP,15.9OHM/30MHZ,- BEAD-SMD;600OHM,2012,1000MA,TP,520OHM/90 CORE-FERRITE BEAD;1200HM,2012,TP BEAD-SMD;2000OHM,2X1.25X0.85MM,200MA,TP, BEAD-SMD;600HM,1608 BEAD-SMD;600HM,3216,1500MA,TP,410HM/40MH INDUCTOR-SMD;3.3UH,20%,3225 BEAD-SMD;600HM,2012,800MA,TP,65OHM/110MH SCREW-MACHINE;PH,+ ,M4,L12,NI PLT,SWRCH18 SCREW-TAPTYPE;BH,+ ,S,M4,L20,ZPC(BLK),SWR SCREW-TAPPING;RH,+ ,2S,M4,L20,ZPC(BLK),SW FAN;2406GL-04W-B29-TAJ,DC FAN C-CER,CHIP;10000NF,20%,16V,X5R,TP,3216 C-CER,CHIP;1.8NF,10%,50V,X7R,1608 C-CER,CHIP;0.18NF,5%,50V,COG,1608 C-CER,CHIP C-CER,CHIP C-CER,CHIP C-CER,CHIP;330NF,+80-20%,16V,Y5V,1608 C-CER,CHIP;0.002NF,0.25PF,50V,COG,1608 C-CER,CHIP;2200NF,10%,10V,X7R,2012 C-CER,CHIP;0.018NF,5%,50V,COG,1608 C-POLYMER ,CHIP;2.2UF,20%,10V,WT,TP,1.6X C-CER,CHIP;0.015NF,5%,50V,COG,TP,1608,0. C-CER,CHIP;0.022NF,5%,50V,COG,1608
---	--	---

C1050,C4N08	2203-000140	C-CER,CHIP;1.5NF,10%,50V,X7R,1608
C110	2401-000183	C-AL;1000UF,20%,35V,WT,TP,12.5X25,5
C1122,C1137,C338,C33	2203-005065	C-CER,CHIP
C1140,C155,C254,C947	2409-001118	C-POLYMER ,CHIP;47UF,-+20,10V,WT,REEL,3.
C118,AD480	2203-000798	C-CER,CHIP
C119,AD480	2203-001397	C-CER,CHIP;2.2NF,5%,50V,NP0,TP,1608
C121,C510	2203-006170	C-CER,CHIP;220NF,10%,16V,X7R,1608
C123,EC9	2203-005834	C-CER,CHIP
C135	2402-001268	C-AL,SMD;100UF,20%,25V,WT,TP,8X6.3MM
C154,JC31	2203-000715	C-CER,CHIP;3.3NF,10%,50V,X7R,1608
C2,C9118,C9119,C9128	2203-005261	C-CER,CHIP;1000NF,10%,25V,X7R,TP,3216
C201,C347,C350,C352,	2203-000888	C-CER,CHIP;4.7NF,10%,50V,X7R,TP,1608
C202,C214,C803,AD480	2203-005437	C-CER,CHIP;10000NF,+80-20%,10V,Y5V,3216
C205,C396,C397,AC611	2203-005194	C-CER,CHIP;0.22NF,10%,50V,X7R,TP,1608
C207,C303,C305,C307,	2203-000236	C-CER,CHIP
C208,C245,C246,C247,	2203-000125	C-CER,CHIP;1.2NF,10%,50V,X7R,TP,1608,-
C215,C218	2402-001323	C-AL,SMD;100UF,20%,25V,LZ,TP,6.3X8MM
C232,PC11	2203-006141	C-CER,CHIP
C233,C234,C235,C236,	2203-000575	C-CER,CHIP;220NF,10%,25V,X7R,TP,2012
C253,C3A09	2203-001103	C-CER,CHIP;6.8NF,10%,50V,X7R,TP,1608
C3,C4,C404,C114,C120	2203-000257	C-CER,CHIP;10NF,10%,50V,X7R,TP,1608
C304,EC14	2203-001724	C-CER,CHIP;4700NF,+80-20%,16V,Y5V,TP,321
C326,C344,C717,C102,	2402-001128	C-AL,SMD;100UF,20%,16V,TP,6.3X5.7MM
C348,C3502	2203-001222	C-CER,CHIP
C371,C510,C515,C521,	2203-000440	C-CER,CHIP;1NF,10,50V,X7R,TP,1608
C372,C710,C234	2203-006378	C-CER,CHIP;4700NF,10%,6.3V,X5R,TP,1608
C373,C374,AD480	2203-001402	C-CER,CHIP;220NF,+80-20%,16V,Y5V,TP,1608
C380,C381,C382,C383,	2203-005918	C-CER,CHIP;1000NF,10%,6.3V,X7R,1608
C405,C406,C1010,ZC35	2203-000681	C-CER,CHIP;0.027NF,5%,50V,C0G,1608
C418,C419,C420,C421,	2203-005249	C-CER,CHIP;100NF,10%,50V,X7R,TP,1608
C422	2402-000193	C-AL,SMD;33UF,20%,25V,TP,6.6X6.6X6.3MM
C433,C443	2404-000426	C-TA,CHIP;3.3UF,20%,50V,GP,TP,7343
C439,C440	2409-001128	C-POLYMER ,CHIP;3.3UF,20%,16V,WT,TP,3.2X
C5,C6,AC124	2203-000998	C-CER,CHIP;0.047NF,5%,50V,C0G,1608
C504,AC28	2203-001607	C-CER,CHIP;0.22NF,5%,50V,NP0,1608
C509,C511,C512,C513,	2203-000975	C-CER,CHIP;47NF,10%,25V,X7R,TP,1608,-
C609,C615,AD480	2203-006104	C-CER,CHIP;1000NF,10%,50V,X7R,TP,3225,2.
C750,C751,C752,C753,	2203-000753	C-CER,CHIP;330NF,+80-20%,50V,Y5V,TP,3216
C754,C755,MC15	2203-000560	C-CER,CHIP;220NF,+80-20%,25V,Y5V,1608
C756,C758,C759,C762,	2402-001129	C-AL,SMD;47UF,20%,16V,WT,TP,6.3X5.2MM
C9000,AC139	2203-000491	C-CER,CHIP;2.2NF,10%,50V,X7R,1608
C9006	2402-001260	C-AL,SMD;100UF,20%,10V,WT,REEL,6.3X5.7
C9007,C9008,C9009,C1	2402-001259	C-AL,SMD;220UF,20%,16V,WT,REEL,8X10
C9008,C9047,E2838	2402-001086	C-AL,SMD;100UF,20%,16V,WT,TP,6.6X6.6X5.3

C9010,C9011	2402-001153	C-AL,SMD;100UF,20%,6.3V,WI,TP,6.3X5.8MM
C9018,C9054,C9056,C9	2203-005809	C-CER,CHIP;1000NF,10%,16V,X7R,TP,2012
C9048,C1000,C1001,C1	2203-005005	C-CER,CHIP;100NF,10%,16V,X7R,1608
C9050,C503,C901,C902	2203-000815	C-CER,CHIP
C9101,C9201,C9301,C2	2203-000041	C-CER,CHIP;0.01NF,0.25PF,50V,COG,TP,1608
C9102,C9110,C9120,C9	2203-000357	C-CER,CHIP;0.15NF,5%,50V,COG,1608
C9104,C9204,C9304	2409-001156	C-ORGANIC,SMD;4.7UF,20%,25V,TP,6.6X6.6X6
C9114,C9115,C9213,C9	2409-001158	C-ORGANIC,LEAD;150UF,20%,25V,WT,BK,10X10
C9309,C222,C223,C301	2203-000783	C-CER,CHIP;0.33NF,5%,50V,COG,1608
CIS,T0066	BP62-00100A	HEAT SINK-ES;AQUAMARINE,T2.0,24*50*21,TA
CLOTH,M9889	BN63-01798B	CLOTH-CLEAN;CLOTH,180,200,SEA BLUE,TOC
CN1,HB01A	3711-005471	HEADER-BOARD TO CABLE;BOX,12P,1R,1.25MM,
CN1001,CN803,CN804,H	3711-005939	HEADER-BOARD TO CABLE;BOX,3P,1R,2MM,SMD-
CN1002,CN1301,EH01	3711-006354	HEADER-BOARD TO CABLE;BOX,41P,2R,0.5MM,S
CN101	3711-005582	HEADER-BOARD TO CABLE;BOX,24P,2R,2.5MM,S
CN101,HB01A	3711-000922	HEADER-BOARD TO CABLE;BOX,4P,1R,1.25MM,S
CN101,PCN	3711-006043	HEADER-BOARD TO CABLE;BOX,4P,1R,2MM,SMD-
CN102,EH01	3711-006099	HEADER-BOARD TO CABLE;BOX,10P,1R,2MM,SMD
CN201,HB01A	3711-003043	HEADER-BOARD TO CABLE;BOX,4P,1R,2.5MM,ST
CN3,HB01A	3711-005509	HEADER-BOARD TO CABLE;BOX,4P,1R,1.25MM,S
CN302,USBJK1	3722-001051	JACK-USB;4P/1C,AU,BLK,ANGLE,A TYPE
CN401,CN402,CN403	3701-001293	CONNECTOR-HDMI;19P,2R,FEMALE,SMD-A,AU
CN404	3701-001219	CONNECTOR-DSUB;15P,3R,FEMALE,ANGLE,AUF
CN701,EH01	3711-003895	HEADER-BOARD TO CABLE;BOX,13P,1R,2MM,STR
CN702,EH01	3711-004182	HEADER-BOARD TO CABLE;BOX,10P,1R,2MM,STR
CN802,EH01	3711-006042	HEADER-BOARD TO CABLE;BOX,6P,1R,2MM,SMD-
CN805,CN1,CN2,HB01A	3711-005743	HEADER-BOARD TO CABLE;BOX,5P,1R,1.25MM,A
CN9001,CN9002,CN9003	3711-001298	CONNECTOR-HEADER;NOWALL,15P,1R,2MM,ANGLE
CN9004,CN906	3711-006741	CONNECTOR-HEADER;NOWALL,8P,1R,2MM,ANGLE,
CN9005,CN906	3711-000344	CONNECTOR-HEADER;1WALL,8P,1R,3.96MM,STRA
CN9006,CN9008,HB01A	3711-005543	HEADER-BOARD TO CABLE;BOX,6P,1R,1.25MM,S
CN9100,CN9200,CN9300	3711-006456	CONNECTOR-HEADER;BOX,2P,1R,10.01MM,STRAI
COVER-DUCT BOT+TOP,C	6003-001023	SCREW-TAPTYPE;PWH,+,-,B,M3,L10,ZPC(WHT),
D0254	0404-001408	DIODE-SCHOTTKY;M2035SL,35V,2000MA,TO-22
D1,D0254	0404-001020	DIODE-SCHOTTKY;BAT54C,30V,200MA,SOT-23,T
D101,D104,D401,D402,	0402-000553	DIODE-SCHOTTKY;SS24/B240,40V,2000MA,DO-2
D101,D400	0403-001282	DIODE-ZENER;BZT52-C15,13.8-15.6,410MW,SO
D201,D427,D428,D450	0403-000002	DIODE-ZENER;VLZ5V6B,5.45/5.73V,500MW,SOD
D202,D203,D204,D205,	0401-001099	DIODE-SWITCHING;1N4148WS,75V,150MA,SOD-3
D209	0403-001174	DIODE-ZENER;VLZ8V2B,7.78-8.19V,500MW,SOD
D211,D750,ZD2001	0402-001019	DIODE-SCHOTTKY;MBRS340,40V,3000MA,DO-214
D301	0406-001181	DIODE-TVS;NUP4201MR6,6/-/-V,500W,TSOP-6
D302,D303,D304,D305,	0403-001052	DIODE-ZENER;RD8.2MB,7.7-8.7V,200MW,SOT-2
D401,D402,D429,D702,	1405-001233	VARISTOR;30VDC,5A,1.6X0.8X0.8MM,TP

D404,D406,D407,D408,	0401-001056	DIODE-SWITCHING;MMBD4148SE,100V,200MA,SO
D710,D711,D712,AD12	0407-000123	DIODE-SWITCHING;DAN202K,80V,100MA,SOT-23
D714,D715,D315,D336,	0403-000771	DIODE-ZENER;VLZ6V2B,5.96-6.27V,500MW,SOD
D900	0403-001280	DIODE-ZENER;MMSZ5240B,9.5-10.5V,500MW,SO
D9000,D0254	0404-001166	DIODE-SCHOTTKY;MBRM130LT3,30V,1000MA,DO-
DLP,T0268	4719-001997	DLP;1920X1080/XHD5,0.65"/ DC4,TYPE X NON
ENGINE+CR,M0081	6003-001315	SCREW-TAPTYPE;BH,+ ,B,M4,L20,ZPC(WHT),SWR
ETC01,M2893	BP39-00268B	LEAD CONNECTOR;AQUAMARINE,UL1061#28,UL/C
ETC02,M2893	BP39-00265B	LEAD CONNECTOR;LAUREL,UL1015 #14,UL/CSA,
ETC03,M2893	BP39-00266B	LEAD CONNECTOR;LAUREL,UL1015 #14,UL/CSA,
ETC04,M2893	BP39-00267B	LEAD CONNECTOR;LAUREL,UL1015 #14,UL/CSA,
ETC05,M2893	BP39-00297A	LEAD CONNECTOR;HLT5689SX/XAA,UL1617#22,U
F9000,F9002	3601-001061	FUSE-SURFACE MOUNT;125V,10A,FAST-ACTING,
FAN+LED,T0136	BP31-00029A	FAN;2406GL-04W-B29-TAH,DC FAN
FRUBBER,RF01	BH61-40002A	FOOT-RUBBER;NR,PMS428U,GA4237
FT401,FT402,FT403,FT	2901-001506	FILTER-EMI SMD;5V,0.13A,OPF,2X1X0.5MM,TP
GND,M0081	6003-001439	SCREW-TAPTYPE;BH,+ ,S,M4,L8,ZPC(WHT),SWRC
H/BOX,T0214	AA61-20285C	HOLDER-BOX;CORAL,PP,BLACK,HB,17.5G
H/LOCK+C/F,H/POW+C/F	6003-001188	SCREW-TAPTYPE;BH,+ ,-,B,M4,L10,ZPC(WHT),S
HOLDER-C+S-DMD(F),SC	6003-000269	SCREW-TAPTYPE;BH,+ ,-,S,M3,L6,ZPC(WHT),SW
HOLDERCDMD+BPANEL,TO	6001-000116	SCREW-MACHINE;BH,+ ,M3,L12,NI PLT,SWRCH18
IC1,DU410	1201-001473	IC-OP AMP;5220,MSOP,TP,8P,120MIL,DUAL,95
IC100,IC401,IC402,IC	1103-001310	IC-EEPROM;24LC02B,256X8BIT,SOIC,8P,3.91X
IC1000,IC125	BP13-00017A	IC ASIC;TMS320F2801PZA-XHD5,2508134-0001
IC1001	1204-002814	IC-DECODER;S4LJ003X,PBGA,816P,35X35MM,PL
IC1001,IC751,IC1103,	1203-003696	IC-POSI.FIXED REG.;NCP1117DT18T5G,DPAK,3
IC1002	1209-001794	IC-PLL;ICS475G-16,TSSOP,16P,5.0X4.4MM,PL
IC1002,T0087	1203-003695	IC-POSI.FIXED REG.;NCP1117ST33T3G,SOT-22
IC101,IC102	1205-003196	IC-RECEIVER;DTC35LF90,TQFP,64P,10X10MM,P
IC102,IC901,T0087	1203-002842	IC-POSI.FIXED REG.;AP1117D-33,TO-252,3P,
IC104,IC105,T0170	1203-003059	IC-SWITCH VOL. REG.;MP1583,SOIC,8P,4.9X3
IC106,U101	1203-002699	IC-POSI.FIXED REG.;78D05,DPAK,3P,6.6X6.1
IC1101,IC1102	1105-001835	IC-DDR2 SDRAM;K4T51163QE-ZCE7,DDR2 SDRAM
IC1201,IC115	1107-001699	IC-FLASH MEMORY;KFG1216U2B,512MBIT,32MX1
IC200,IC118	1204-002501	IC-VIDEO PROCESS;DDP3021,PBGA,644P,35X35
IC201,T0124	1201-002796	IC-POWER AMP;STA339BWS,PSSO,36P,10.3X7.5
IC202,T0170	1203-004868	IC-SWITCH VOL. REG.;MP2363,SOIC,8P,4.9X3
IC203,IC702	1203-004364	IC-VOL. DETECTOR;RT9818C-42PV,SOT-23,3P,
IC204,IC801,IC860,IC	1203-001519	IC-POSI.ADJUST REG.;LM317,SOT223,3P,274
IC301,T0087	1203-003943	IC-POSI.FIXED REG.;TPS51100,MSOP,10P,3X3
IC302,IC113	1105-001701	IC-DRAM;MT49H8M36BM-TI,RLDRAM,288MBIT,8M
IC400,IC107	1002-001397	IC-D/A CONVERTER;AD7801BRU,8,TSSOP,20P,6
IC401	1209-001638	IC-SYNTHESIZER;ICS650GI-41LF,TSSOP,16P,5
IC405	1003-001892	IC-POWER DRIVER;DAD2000,PQFP,80P,12X12MM

IC405,IC406	1203-005067	IC-POWER SUPERVISOR;SP619,SOT23,6P,2.9X1
IC406,ND51C2	0801-002780	IC-CMOS LOGIC;74LVC1G17,SCHMITT-TRIGGER
IC500,IC115	1107-001475	IC-FLASH MEMORY;29LV320,32MBIT,4MX8/2MX1
IC501	1205-003410	IC-RECEIVER;MST336CCLK-LF-170,LQFP,144P,
IC503,IC504,IC505,IC	1205-003201	IC-BUS SWITCH;TC7WB125FK,SSOP,8P,2X2.3MM
IC601	1203-004844	IC-DC/DC CONVERTER;BD9307FVM-TR,MSOP,8P,
IC703,IC112	1103-001385	IC-EEPROM;AT24C256,256KBIT,32KX8,SOP,8P,
IC704	1001-001109	IC-ANALOG SWITCH;FST3125M,BUS SWITCH & C
IC750	1003-001891	IC-MOTOR DRIVER;PMD1000,QFP,48P,7.0X7.0MM
IC801,IC802,IC104	0801-002393	IC-CMOS LOGIC;74VHC244,BUS BUFFER,TSSOP,
IC803	1006-001266	IC-LINE TRANSCEIVER;3232,TSSOP,16P,174MI
IC803,IC804,IC104	0801-002765	IC-CMOS LOGIC;74LVC1G07,SINGLE BUFFER/DR
IC805,IC104	0801-000920	IC-CMOS LOGIC;74HCT125,BUFFER,SOP,14,150
IC806,IC807,IC104	0801-003196	IC-CMOS LOGIC;74ALVC125,BUFFER/LINE DRIV
IC9000	1203-001211	IC-VOL. DETECTOR;7027,SOT-89,3P,PLASTIC,
IC9002,T0087	1203-001960	IC-POSI.FIXED REG.;9163,SOT-223,3P,PLAST
IC9004,T0087	1203-001293	IC-POSI.FIXED REG.;033,T0-252,3P,6.5MIL,
IC9005,T0087	1203-005080	IC-POSI.FIXED REG.;37100-2.5WS,SOT-223,3
IC9006,IC703	1203-003121	IC-POSI.FIXED REG.;FAN1112,SOT-223,3P,6.
IC9007	1101-001062	IC-PROM;XCF01S,1MBIT,1MX1BIT,TSOP,20P,6.
IC9008,T0087	1203-001816	IC-POSI.FIXED REG.;78M08,TO-252,3P,-,PLA
IC9009	1301-001682	IC-FPGA;XC3S200,TQFP,144P,22X22MM,1.2V,1
IC901,IC104	0801-003032	IC-CMOS LOGIC;7SZ86,EX-OR GATE,SC-70,5P,
IC9010,IC9011,DU410	1201-002046	IC-OP AMP;LM324,TSSOP,TP,14P,5X4.4MM,QUA
IC9401,IC9501,IC9601	1002-001560	IC-D/A CONVERTER;AD11/2063Z-OREEL7,8,TSS
IC9402,IC9502,DU410	1201-001907	IC-OP AMP;4580,EMP,TP,8P,5X3.9MM,DUAL,11
ILL+SHIELD-DMD(F),T0	6006-000245	SCREW-MACHINE;PH,+,WSP,M4,L8,ZPC(WHT),SW
ILLUMINATION+B-PANEL	6001-000819	SCREW-MACHINE;PWH,+,M3,L30,NI PLT,SWRCH1
ILLUMINATION+H-PIPE,	6003-000282	SCREW-TAPTYPE;BH,+,-,B,M3,L8,ZPC(BLK),SW
INLET,M0125	BP96-02046A	ASSY INLET P;AQUAMARINE,UL 1617 #22,150M
L101,L103,L203,T0010	BN27-00008A	COIL CHOKE-SMD;SMD12*12*8.5,GH15/17PS,22
L201,L202,T0052	2704-000018	INDUCTOR-SMD-ARRAY;15UH,2000MA,2,0.124OH
L301,L302,L303,L304,	2703-000398	INDUCTOR-SMD;10UH,10%,3225
L400,L401,L753,T0010	BP27-00002A	COIL CHOKE;SLF6028T-220MR77,22UF,20%,0.1
L602,T0052	2703-001070	INDUCTOR-SMD;100UH,10%,4532
L603,T0052	2703-002327	INDUCTOR-SMD;3.9UH,5%,3225
L750,L752,T0052	2703-002916	INDUCTOR-SMD;10UH,20%,8080
L751,S1L0142	2703-001865	INDUCTOR-SMD;33UH,20%,6060
L9000,T0010	BN27-00007A	COIL CHOKE-SMD;DHB0504-100,RB15/17NS,10U
L9100,L9101,L9102,L9	2703-003365	INDUCTOR-SMD;1.2UH,20%,10.3X10.3MM
LEAD,M2893	AA39-20497E	LEAD CONNECTOR;HLT5689SX/XAA,UL1617#22,1
LENS-P/J ASSY+SP,LEN	6006-000105	SCREW-MACHINE;BH,+,WSP,M3,L16,ZPC(WHT),S
Location	Part No	Parts Description
M/BOT	AA63-00021W	SPACER-MIRROR;61L6,PVC,1360,BLK

M0081	6003-000333	SCREW-TAPTYPE;RH,+,-,2S,M3,L10,ZPC(WHT),
M0081	6003-001003	SCREW-TAPTYPE;BH,+ ,B,M4,L12,ZPC(BLK),SWR
M0214	BP96-01970D	ASSY CABLE P-FLAT;HL56A650C1FXZA,FFC,117
M0521	BP94-02327A	ASSY PCB S-LED DRIVE;HL61A750A1FXZA,L70A
M0910	BP07-00029A	LED DISPLAY-RED;PHLAT LIGHT,PT 120,W=4.6
M0911	BP07-00030A	LED DISPLAY-GREEN;PHLAT LIGHT,PT 120,W=4
M0912	BP07-00031A	LED DISPLAY-BLUE;PHLAT LIGHT,PT 120,W=4.
M2893	BN39-00640C	LEAD CONNECTOR;HLS5686W,UL1007#26,UL/CSA
M2893	BP39-00298A	LEAD CONNECTOR;HLT5689SX/XAA,UL1061#28,5
M2893	BP39-00299A	LEAD CONNECTOR;HLT5689SX/XAA,UL1617#22,U
MAIN SMPS,T0764	BP44-01001A	DC VSS-DLP TV;PN082DPS-VF(A),AC/DC,90V-1
MFRONT,T0260	BP67-00353A	MIRROR-FRONT;67K8,GLASS,1407.84X719X798X
OP1	0603-001224	PHOTO DIODE;10V,540NM,TP
OP100,OP703,OP102,OP	0601-001313	LED;SMD,GRN,2X1.8MM,565NM,3.16X1.6X1.1MM
OP101,L0405	0601-001419	LED;SMD,RED,3.2X1.6X1.1MM,660NM,3.2X1.6X
P/CORD,T0268	3903-000467	CBF-POWER CORD;DT,US,EP3,IEC320 C13-RA,1
Q1,Q9003,Q9004,Q9005	0505-000110	FET-SILICON;2N7002,N,60V,115MA,7.5OHM,0.
Q1001,Q201,Q203,Q204	0501-000445	TR-SMALL SIGNAL;KTC3875S-Y,NPN,150MW,SOT
Q101,Q102,Q103	0501-000434	TR-SMALL SIGNAL
Q202	0501-000669	TR-SMALL SIGNAL;KTA1505Y,PNP,150MW,SOT-2
Q750,Q409	0505-001916	FET-SILICON;SI4800BDY,N,30V,9A,0.03OHM,2
Q801,Q802	0504-001129	TR-DIGITAL;KRC104S-I,NPN,200MW,47K/47K,S
Q9000,Q409	0505-002234	FET-SILICON;PMV65XP,P,-20V,-3.9A,0.076OH
Q9100,Q9103,Q9106,Q9	0501-000457	TR-SMALL SIGNAL;MMBT2222A/KST2222A,NPN,3
Q9101,Q9104,Q9107,Q9	0505-001622	FET-SILICON;SUD50N03-16P,N,30V,37A,0.024
Q9102,Q9105,Q9108,Q9	0501-000462	TR-SMALL SIGNAL;MMBT2907A,PNP,350MW,SOT-
R1,R3A08	2007-000091	R-CHIP;12KOHM,5%,1/10W,TP,1608
R1003,R1005,R1007,R1	2007-000033	R-CHIP;0OHM,5%,1/4W,TP,3216
R1005,R1034,R1050,R1	2007-000078	R-CHIP;1KOHM,5%,1/10W,TP,1608
R1007,R1009,R1011,R1	2007-000084	R-CHIP;4.7KOHM,5%,1/10W,TP,1608
R101,R102,R3A06	2007-000539	R-CHIP
R101,R105,R1026,R102	2007-000074	R-CHIP;100OHM,5%,1/10W,TP,1608
R1019,R1058,R1059,R1	2007-000071	R-CHIP;22OHM,5%,1/10W,TP,1608
R102,R106,R9309,AAR3	2007-000123	R-CHIP;1.5KOHM,5%,1/10W,TP,1608
R1020,MR122	2007-000094	R-CHIP;22KOHM,5%,1/10W,TP,1608
R1020,R1021,R1022,R1	2007-000070	R-CHIP
R103,R107,R329	2007-000081	R-CHIP;2.7KOHM,5%,1/10W,TP,1608
R103,R719,FMR4	2007-000080	R-CHIP;2KOHM,5%,1/10W,TP,1608
R1033,R409,R410,R508	2007-000113	R-CHIP;33OHM,5%,1/10W,TP,1608
R1035	2007-007797	R-CHIP;44.2OHM,1%,1/10W,TP,1608
R1042,R1043,R1044,R1	2007-000090	R-CHIP;10KOHM,5%,1/10W,TP,1608
R105,R25	2007-001139	R-CHIP;7.5KOHM,1%,1/10W,TP,1608
R107,R299	2007-000772	R-CHIP;33KOHM,1%,1/10W,TP,1608
R1074,R1081,R220,R22	2007-000072	R-CHIP;47OHM,5%,1/10W,TP,1608

R108	2007-002900	R-CHIP;11KOHM,1%,1/10W,TP,1608
R1091,KR7	2007-000402	R-CHIP;150OHM,5%,1/10W,TP,1608
R1096,R302,R303,R304	2007-000077	R-CHIP;470OHM,5%,1/10W,TP,1608
R1131,R1132,R1133,R1161,R1162,R346	2007-000309	R-CHIP;100OHM,5%,1/10W,TP,1608
R121,R619,R9026,R908	2007-000729	R-CHIP;300OHM,5%,1/10W,TP,1608
R123	2007-000092	R-CHIP;15KOHM,5%,1/10W,TP,1608
R124,R238	2007-002768	R-CHIP;6.2KOHM,1%,1/10W,TP,1608
R1322,R1337,R9039,R1	2007-000701	R-CHIP;3.6KOHM,1%,1/10W,TP,1608
R201,R215,R510,R716,	2007-000088	R-CHIP;7.5KOHM,5%,1/10W,TP,1608
R211,R212,R617,R9105	2007-000124	R-CHIP;2.2KOHM,5%,1/10W,TP,1608
R218,R219,R726	2007-000082	R-CHIP;3.3KOHM,5%,1/10W,TP,1608
R224,R225,R226,R227,	2007-000695	R-CHIP;3.3OHM,5%,1/10W,TP,1608
R232,R233,R3505	2007-000362	R-CHIP
R235,R328,R38	2007-000950	R-CHIP;470OHM,5%,1/4W,TP,3216
R236,AR02	2007-000640	R-CHIP;270OHM,1%,1/10W,TP,1608
R300,R301,R302,R303,	2007-000125	R-CHIP;3.9KOHM,5%,1/10W,TP,1608
R311,R325,R326,R1035	2007-000040	R-CHIP;150OHM,1%,1/10W,TP,1608
R313,R9100,R9106,R91	2007-000287	R-CHIP;100OHM,1%,1/10W,TP,1608
R315,R316,R317,R319,	2007-000570	R-CHIP;220OHM,1%,1/10W,TP,1608
R318,R320,R322,R330,	2007-000097	R-CHIP;47KOHM,5%,1/10W,TP,1608
R368,MR311	2007-001164	R-CHIP;75OHM,1%,1/10W,TP,1608
R4,R1080,FR6	2007-000426	R-CHIP
R402,R405,R809	2007-000536	R-CHIP;200OHM,1%,1/10W,TP,1608
R421,R422,R423,R424,	2007-000475	R-CHIP;1MOHM,1%,1/10W,TP,1608
R442,R448,R449,R537,	2007-000882	R-CHIP;4.7OHM,5%,1/10W,TP,1608
R501,R502,R503,R504,	2007-001167	R-CHIP;75OHM,5%,1/10W,TP,1608
R514,R516,R517,UR16	2011-001093	R-NETWORK;100OHM,5%,1/16W,L,CHIP,8P,TP,3
R515,R520,R526,MR34	2007-000552	R-CHIP
R519,R522,R524,R642	2007-000118	R-CHIP;390OHM,5%,1/10W,TP,1608
R610	2007-007512	R-CHIP;43OHM,5%,1/10W,TP,1608
R612,KAR13	2007-002906	R-CHIP;200KOHM,1%,1/10W,TP,1608
R616,KAR9	2007-000060	R-CHIP;100KOHM,1%,1/10W,TP,1608
R618	2007-000093	R-CHIP;20KOHM,5%,1/10W,TP,1608
R701,AR174	2007-000819	R-CHIP;390KOHM,5%,1/10W,TP,1608
R755,R102,R103,R1167	2007-000129	R-CHIP;27KOHM,5%,1/10W,TP,1608
R756,R1S36	2007-008596	R-CHIP;0.1OHM,1%,1/4W,TP,3216
R757,R1001,R1002,R10	2007-000491	R-CHIP;2.2KOHM,1%,1/10W,TP,1608
R758	2007-000669	R-CHIP;2KOHM,1%,1/10W,TP,1608
R759,R9007,R9011,R90	2007-007617	R-CHIP;2.49KOHM,1%,1/10W,TP,1608
R818,R860,R530,HR13	2007-000043	R-CHIP;1KOHM,1%,1/10W,TP,1608
R819,R861,AR60	2007-000821	R-CHIP;390OHM,1%,1/10W,TP,1608
R820,R862,AR61	2007-000708	R-CHIP;3.9KOHM,1%,1/10W,TP,1608
R9001,R401	2007-000869	R-CHIP;4.7KOHM,1%,1/10W,TP,1608
	2007-000034	R-CHIP;1OHM,5%,1/4W,TP,3216

R9003,R9004,R15	2007-000134	R-CHIP;33KOHM,5%,1/10W,TP,1608
R9004,R9018,R9022	2011-001015	R-NETWORK
R9008,MR14	2007-000842	R-CHIP;3KOHM,1%,1/10W,TP,1608
R901,R114	2007-001101	R-CHIP;62OHM,5%,1/10W,TP,1608
R9013,R9046,DRP29	2011-000515	R-NETWORK;4.7KOHM,5%,1/16W,L,CHIP,8P,TP,
R9014,R9015,R9016,R9	2007-000381	R-CHIP;13KOHM,5%,1/10W,TP,1608
R9015	2011-001283	R-NETWORK;15KOHM,5%,1/16W,L,CHIP,8P,TP,3
R9017	2007-007548	R-CHIP;39.2OHM,1%,1/10W,TP,1608
R9020,R19	2007-000763	R-CHIP;330OHM,1%,1/10W,TP,1608
R9033,R9006,AR2	2007-001068	R-CHIP
R9034,ND51C2	2007-000066	R-CHIP;20KOHM,1%,1/10W,TP,1608
R9035	2007-007723	R-CHIP;75KOHM,1%,1/10W,TP,1608
R9037,KR24	2007-000067	R-CHIP;15KOHM,1%,1/10W,TP,1608
R9041,R9042,R9043,R9	2007-000052	R-CHIP;10KOHM,1%,1/10W,TP,1608
R907,RR2	2007-000075	R-CHIP;220OHM,5%,1/10W,TP,1608
R9087	2007-002910	R-CHIP;30.1KOHM,1%,1/10W,TP,1608
R9088,R9102,R9110,R9	2007-000102	R-CHIP;100KOHM,5%,1/10W,TP,1608
R9104,R9113,R9121,R9	2007-000219	R-CHIP;1.2KOHM,1%,1/10W,TP,1608
R9109,R9209,KAR7	2007-000120	R-CHIP;680OHM,5%,1/10W,TP,1608
R9112,R9212,R9312,RR	2007-002901	R-CHIP;12.1KOHM,1%,1/10W,TP,1608
R9122,R9123,R9124,R9	2007-007046	R-CHIP;0.02OHM,1%,1W,TP,6432
R9203,R9211,R9220,R9	2007-008714	R-CHIP;0.01OHM,1%,1W,TP,6432
R929,ZR24	2007-000109	R-CHIP;1MOHM,5%,1/10W,TP,1608
R9403,R9503,R9603,R9	2007-007526	R-CHIP;23.7KOHM,1%,1/10W,TP,1608
R9406,R9508,R234,R15	2007-000208	R-CHIP;1.1KOHM,1%,1/10W,TP,1608
R9408,R9506	2007-008195	R-CHIP;845OHM,1%,1/10W,TP,1608
RA1000,RA1001,RA1002	2011-001011	R-NETWORK;10KOHM,5%,1/16W,L,CHIP,8P,TP,3
RA101,RA102,RA103,RA	2011-000585	R-NETWORK;47OHM,5%,1/16W,L,CHIP,8P,TP,3.
SF,T0053	BP67-00352A	SCREEN FRESNEL;K3, 67INCH, DNP,MS,OFFSET
SHIELD DMD(R)+DMD(F)	6003-000264	SCREW-TAPTYPE;PWH,+,-,B,M3,L6,ZPC(WHT),S
SL,T0054	BP67-00355A	SCREEN LENTI;AQUAMARINE, 67INCH, DNP,MS,
SUB DRIVER	BP95-00452A	ASSY SUB PCB-LED DRIVER;HL61A750A1FXZA,A
SW101,SW102,SW103,SW	3404-001207	SWITCH-TACT;12V,50MA,160GF,6.2X6.2,SPST
T0027	BP94-02327B	ASSY PCB S-DMD;HL61A750A1FXZA,L70A
T0074	BN59-00673A	REMOCON;PEARL,TM98A,49,USA,SAMSUNG,TOOLS
T0101	BP62-00098A	HEAT SINK-PIPE GREEN;K750,CU, AL,NTR,GRE
T0109	BP67-00313A	LENS-P/J ASSY;K880,ASSY-LENS,F#2.0 SEKIN
T0124	1201-002678	IC-POWER AMP;STA335BWS,PSSO,36P,10.3X7.5
T0136	BP31-00032A	FAN;3110RL-04W-S19-H04,DC FAN
T0268	3903-000144	CBF-POWER CORD;DT,US,BP3/Y,U(IEC C13-RA)
T0965	BP64-00661A	GLASS-ACTUATOR;K880, HIGH REFLEXIBILITY,
TU601,CIS3	BN40-00119A	TUNER;TDQU2-K01A,TDQU2-K01A,NTSC,181CH,4
WIRE,M2893	BP39-00254B	LEAD CONNECTOR;HLT5687SX/XAA,UL2835#28,U
WIRE01,M2893	BP39-00255A	LEAD CONNECTOR;HLT5687SX/XAA,UL1061#28,U

WIRE-THUNDER,M2893	BP39-00180D	LEAD CONNECTOR;HLS4676SX/XAA,UL1015#18,U
X1000	2804-001671	OSCILLATOR-CLOCK;20MHZ,100PPM,30PF,TP,3.
X1001	2801-004732	CRYSTAL-UNIT;27MHZ,30PPM,28-AAM,12PF,30O
X301,X902,X202	2801-004733	CRYSTAL-SMD;24.576000MHZ,20PPM,28-AAN,13
X400,X6	2801-004058	CRYSTAL-SMD;25MHZ,30PPM,SMD,20PF,50OHM,T
X501,X202	2801-003667	CRYSTAL-SMD;14.31818MHZ,30PPM,28-AAN,16P
X701,X202	2801-003326	CRYSTAL-SMD;24MHZ,30PPM,28-ABX,20PF,50OH
X9000	2804-001378	OSCILLATOR-CLOCK;33MHZ,100PPM,CMOS(30PF)
	AA63-60117A	SPACER-FOOT;SVP-403J,NEOPRENE(CR),BLK,VO
	BP61-01344A	BRACKET FAN;S20,SECC,T2.0
	BP62-00097A	HEAT SINK-PIPE RED;K750,CU, AL,NTR,RED
	BP62-00099A	HEAT SINK-PIPE BLUE;K750,CU, AL,NTR,BLUE
	BP91-02113C	ASSY ENGINE;A750(61 INCH),GEN 2.3 LED,NE
	BP94-02304C	ASSY PCB MISC-LED;HLT5675SX/XAA,CATTLEYA
	BP94-02305A	ASSY PCB MISC-KEY CONTROL;HLT5075SX/XAA,
	BP96-01724B	ASSY LENS P-ILLUMINATION;BLACK,FRONT
	BP96-01725B	ASSY LENS P-ILLUMINATION;BLACK,BACK
	BP96-02013A	ASSY PCB P-COLOR SENSOR;HL61A750A1FXZA,L