

BASYS® Infrared Sensor Activated

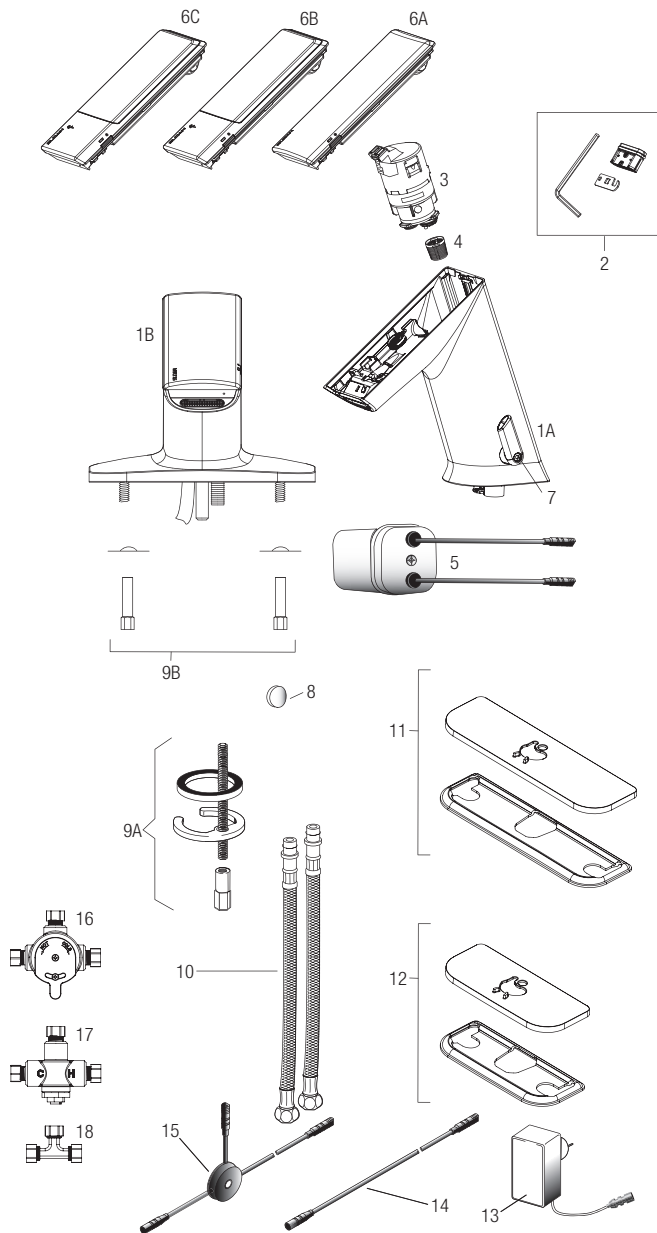

EFX-3XX SERIES

EFX-6XX SERIES



PARTS LIST—BASYS FAUCETS

| Item No. | Code No. | Part No. | Description |
|----------|----------------|------------|---|
| 1A. | — | — | Low Pedestal Faucet Assembly* |
| | — | — | Low Pedestal Faucet Assembly with Mixer* |
| 1B. | — | — | Low Integrated Base Faucet Assembly† |
| 2. | 3324104 | EFX-1002-A | 0.5 gpm/1.9 Lpm Multi-Lam Spray Head (includes insert, o-ring, 2.5 mm allen key, and removal tool) |
| | 3324103 | EFX-1001-A | 1.5 gpm/5.7 Lpm Aerated Stream Insert (includes insert, o-ring, 2.5 mm allen key, and removal tool) |
| | 3324102 | EFX-1000-A | 1.5 gpm/5.7 Lpm Laminar Stream Insert (includes insert, o-ring, 2.5 mm allen key, and removal tool) |
| 3. | — | EFX-37 | 0.5 gpm/1.9 Lpm Solenoid Valve Caddy Assembly — Low (Green) |
| | — | EFX-38 | 1.5 gpm/5.7 Lpm Solenoid Valve Caddy Assembly — Low (Blue) |
| 4. | 0324019 | EFX-19 | Strainer (Filter) |
| 5. | 3324117 | EFX-23-A | Battery Pack Assembly |
| 6A. | 3324118 | EFX-1-A | Crown Assembly |
| 6B. | 3324119 | EFX-3-A | Solar Crown Assembly |
| 6C. | 3324120 | EFX-4-A | Solar Crown with LCD Assembly |
| 7. | — | — | Mixer Handle Assembly (for EFX-3 IR models only) |
| 8. | — | EFX-25 | Handle Cap (for EFX-3 IR models only) |
| 9A. | 0335000 | EAF-1 | Faucet Mounting Kit (for pedestal model only) |
| 9B. | — | EFX-21-A | Faucet Mounting Kit (for integrated base model only) |
| 10. | 3335023 | EAF-1008 | 13" (330 mm) Flexible Supply Hose (1) |
| 11. | 3324101 | EFX-26-A | Trim Plate for 8" Centerset Sink |
| 12. | 3324100 | EFX-20-A | Trim Plate for 4" Centerset Sink |
| 13. | 0335009 | EAF-11 | Plug-in Voltage Adapter (US) |
| | 0335041 | EAF-41 | Plug-in Voltage Adapter (EU) |
| | 0335039 | EAF-39 | Plug-in Voltage Adapter (UK) |
| | 0335037 | EAF-37 | Box Type Voltage Adapter |
| 14. | 0335024 | EAF-24-A | 11-13/16" (300 mm) Extension Cable |
| | 0335025 | EAF-25-A | 47-1/4" (1200 mm) Extension Cable |
| | 0335015 | EAF-17-A | 126" (3200 mm) Extension Cable |
| 15. | 0335023 | EAF-23-A | Splitter |
| 16. | 3326009 | MIX-60-A | Mechanical, Below Deck Mixing Valve |
| 17. | 0326045 | MIX-135-A | Thermostatic, Below Deck Mixing Valve |
| 18. | 3365461 | ETF-617-A | Bak-Chek Tee |

NOTE: If changing flow rate caddy and spray insert must be changed in conjunction.

† Single Supply faucets include Bak-Chek®

*Integral Base model not available with integral to faucet side mixer; single supply faucets include Bak-Chek®

— in Item No. column = Not shown in illustration

— in Code No. and Part No. column = Not sold separately

Electrical Connection for up to Six (6) Faucets Using One (1) Adapter

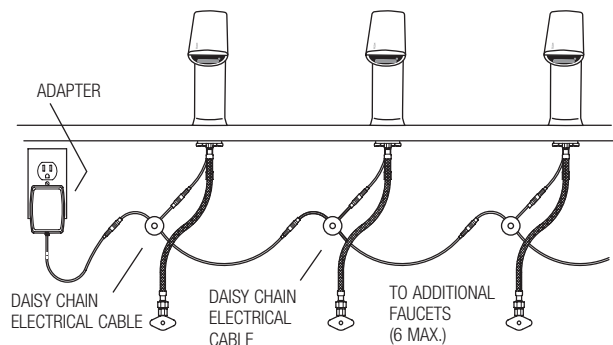

BASYS® Infrared Sensor Activated

REPLACING THE SOLENOID STRAINER (FILTER)

NOTE: Turning off water is not necessary, due to integrated automatic stop valve.

Remove crown by loosening hex screw located on underside of spout and slide crown down and lift off.

NOTE: Screw is captive within faucet body and will not fall out.

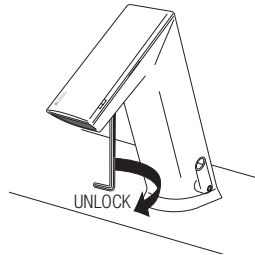

Remove battery pack assembly by lifting out of spout.

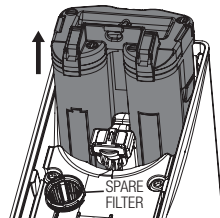

Rotate solenoid assembly counter-clockwise through a 45° angle.

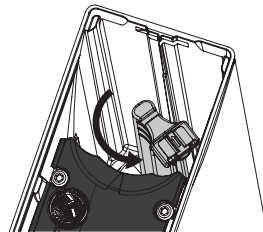

Pull solenoid caddy from faucet.
NOTE: STRAINER (FILTER) CAN BE REMOVED, CLEANED AND REPLACED AT THIS TIME.

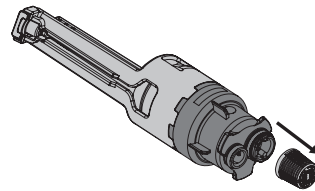

Insert new solenoid caddy at a 45° angle.

Rotate solenoid caddy clockwise to align with arrow, locking the unit and opening water path.

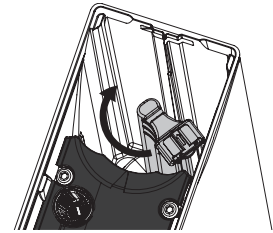

Reinsert battery pack assembly.

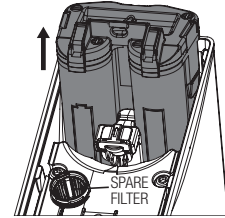

Slide on crown and secure.

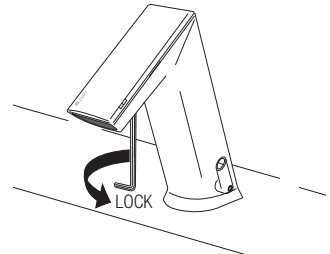

BASYS® Infrared Sensor Activated

SENSOR RANGE ADJUSTMENT

Factory setting is appropriate for the majority of applications and should not require resetting unless under extreme situations.

IR Activation (see page 129). To enter programming mode place finger on IR clic for 2 times then remove. Light on side of crown should blink red to indicate programming mode.

Cover IR clic until LED flashes 4x - hold on until LED flashes 1x to 8x, from minimum to maximum range. See diagram below. Release when requested range is reached.

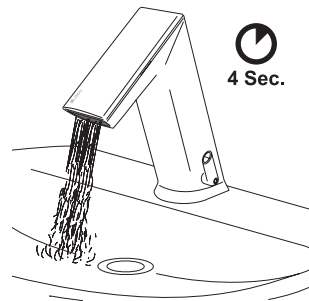
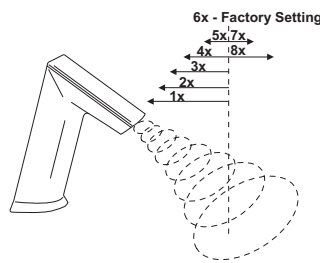
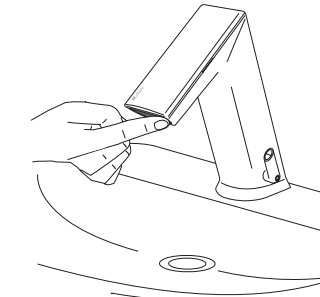

Wait, until LED flashes GREEN.

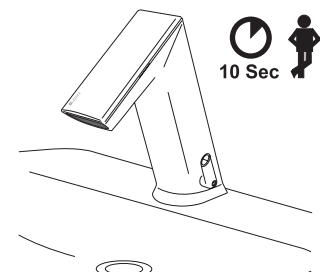

BATTERY REPLACEMENT

NOTE: Replace Battery when LED1 indicator flashes red each time faucet is in use or when faucet stops functioning. LED1 is identified by the battery symbol.

NOTE: Turning off water is not necessary.

Loosen cover screw and remove cover from battery pack.

Install four (4) AA-size batteries (supplied) as indicated by the (+) and (-) symbols inside the battery compartment.

Replace battery pack lid and tighten with screwdriver.

NOTE: Insure batteries are installed with proper polarity. The cover of the case indicates polarity of batteries. Improper polarity will not harm the faucet. Improper polarity will cause the faucet not to operate.

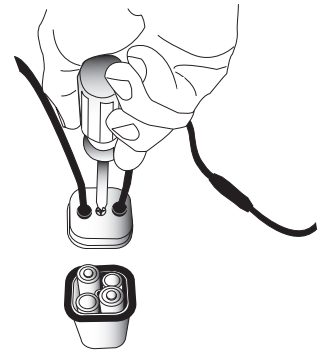

BASYS® Infrared Sensor Activated

OPERATION

As the user's hands enter the beam's effective range, the beam is reflected back into the sensor receiver and activates the solenoid valve allowing water to flow from the faucet. Water will flow until the hands are removed or until the faucet reaches its automatic time out limit setting.

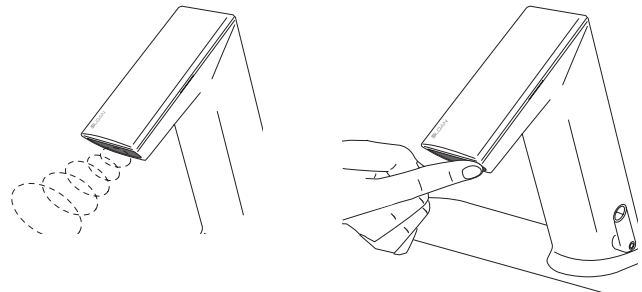

SET AND FIX TEMPERATURE AND ADJUST HOT LIMIT STOP

Adjust lever to set temperature.

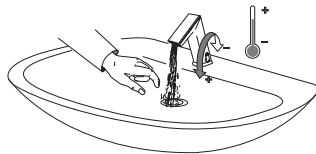

OPTIONAL – To fix temperature, set lever to the desired position, then remove lever and plug hole with cap.

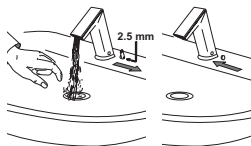

Optional Hot Limit Stop Adjustment – To adjust the hot/cold mix (factory set at 50/50) remove the lever.

Check to make sure dot is in center position before beginning adjustment.

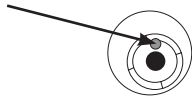

Faucet may be adjusted in 10° increments.

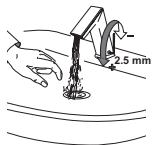

| Function | Steps to Activate Function | Default Setting | IR Clic |
|---------------------------------|--|-----------------|---------------------|
| IR Activation | Cover IR clic approximately for 2 sec. until LED will flash GREEN 1x - then remove finger from IR clic (Active for 5 sec.) | — | — |
| Cleaning Mode | IR activation; Cover IR clic 2x - confirmation of the function is active by a couple flashes by the LED; to return to normal operation cover IR clic 1x or the faucet will automatically return to normal function after 2 min. | 2 min. | — |
| 12/24 Line Purge Feature | See below. | Off | Off 12HR 24HR |
| Sensor Range Adjustment | See page 130. | 6 | 1-8 |
| Reset Electronics | IR activation; Cover IR clic 2x; LED will flash 5x Cover IR clic 1x for 5 sec. until LED flashes 4x, then remove finger from IR clic Wait for 20 sec. (After 10 sec. water will flow for 6 sec. and automatically adjust to environment) | Manually | — |
| Security Off | After 90 seconds (max) of hand and/or object within sensor appears permanent, waterflow will stop and will remeasure environment | On | — |

Please contact factory for more extensive programming options.

12/24 LINE PURGE FEATURE

This feature will operate the faucet every 12 or 24 hours since last use, if not used to prevent stagnant water conditions.

Default purge duration is two minutes.

Consult factory regarding other timing options.

IR activation (see above). Cover IR clic approximately 24 sec. (ignore LED indications during this period). Release when requested program is reached. (See diagram to right). Programming mode will time out after 2 minutes if no changes are made.

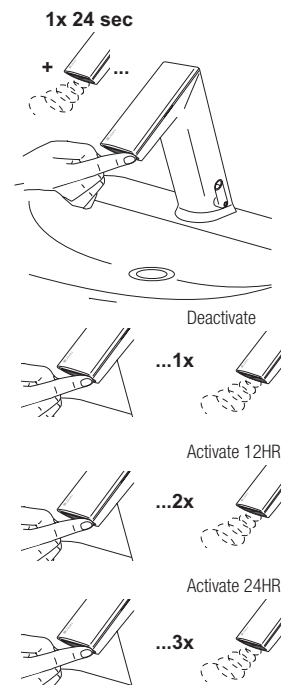

BASYS® Infrared Sensor Activated

UPGRADE FAUCET FUNCTIONALITY

Remove crown by loosening hex screw located on underside of spout and slide crown down and lift off.

NOTE: Screw is captive within faucet body and will not fall out.

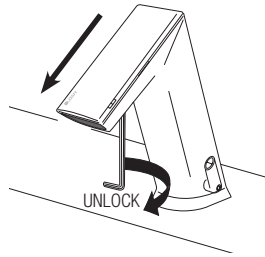

Place new crown on faucet by sliding onto spout and tightening hex screw on underside of spout.

NOTE: All electronics are fully encapsulated in the crown and thus protected from the environment and easy to replace or upgrade.

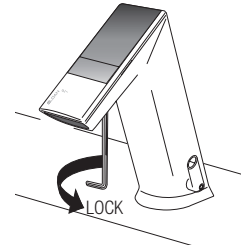
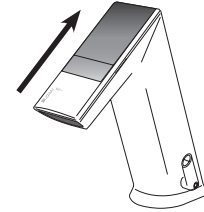

LED DISPLAY DIAGNOSTIC CODES

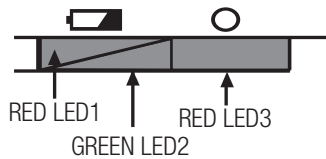

COLOR LEDs BLINKING



COLOR LEDs ON

| Function | LED1 | LED2 | LED3 | Description 1 | Description 2 |
|---------------------------------|------|------|------|---|---|
| Start Up Boot | | | | LED1 and LED2 alternate blinking | Fast Toggle |
| Battery Check after Start Up | | | | LED1 on for 2 sec, if battery greater than 3.5V | |
| Line Power Check after Start Up | | | | LED3 on for 2 sec, if line power greater than 3.5V | |
| IR Adjust Process | | | | LED1 blinking while IR adjusts | Few seconds |
| IR Adjust IR | | | | LED2 on for 2 sec, if adjustment OK | |
| Battery Low | | | | LED1 blinks 3x, if battery is less than warning level | Only while in detection mode |
| Battery Empty | | | | LED1 double flashes 3x, if battery is less than empty level | Only while in detection mode |
| Valve Error | | | | LED3 double flashes 3x, if valve current error; flash after the 3rd error, off after the 3rd good operation | Flashes after the 3rd error, off after the 3rd good operation |
| IR Activation | | | | LED2 on for 2 sec, if IR-click has been activated | After 5 sec. automatically back to operating mode |
| Cleaning Mode | | | | LED1 4-in-1 flash, if cleaning mode is activated | During "Cleaning Mode" is activated Permanent 4-in-1 flashes |



BASYS® Infrared Sensor Activated

REPLACING THE SOLENOID STRAINER (FILTER)

NOTE: Turning off water is not necessary, due to integrated automatic stop valve.

Remove crown by loosening hex screw located on underside of spout and slide crown down and lift off.

NOTE: Screw is captive within faucet body and will not fall out.

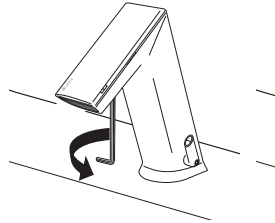

Rotate solenoid assembly counter-clockwise through a 45° angle.

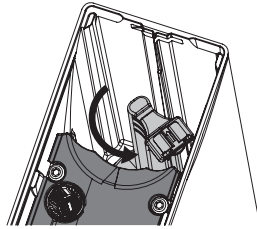

Pull solenoid caddy from faucet.

NOTE: Strainer can be removed, cleaned and replaced at this time.

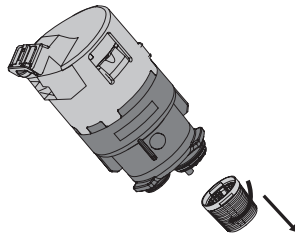

Insert new solenoid caddy at a 45° angle.

Rotate solenoid caddy clockwise to align with arrow, locking the unit and opening water path.

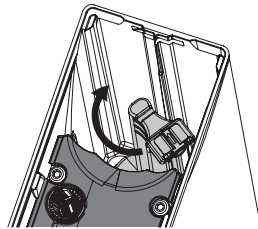

Slide on crown and secure.

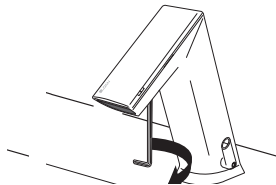

REPLACE SPRAY INSERT

NOTE: Turning off water is not necessary, due to integrated automatic stop valve.

Remove crown by loosening hex screw located on underside of spout and slide crown down and lift off.

NOTE: Screw is captive within faucet body and will not fall out.

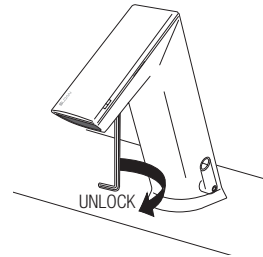

Retrieve spray removal tool located near the spray insert.

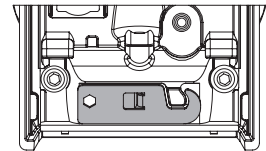

Insert spray removal tool into spray slot by sliding hook end of key between faucet spout and insert. Pull insert out of faucet once hooked.

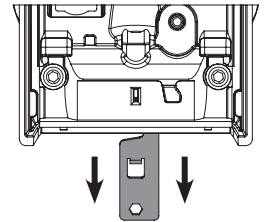

Install new insert.

NOTE: If changing to a different flow rate solenoid caddy must be changed in conjunction.

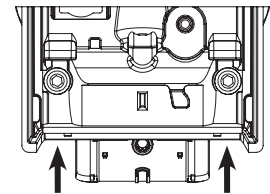

Return spray removal tool to storage location.

NOTE: This can only be done once spray head is installed. This will lock the spray head in place.

NOTE: If spray head is inserted incorrectly – key will not lock in properly. Turn faucet on to push insert out and re-install.

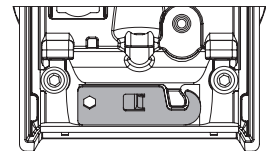

Slide on crown and secure.

