

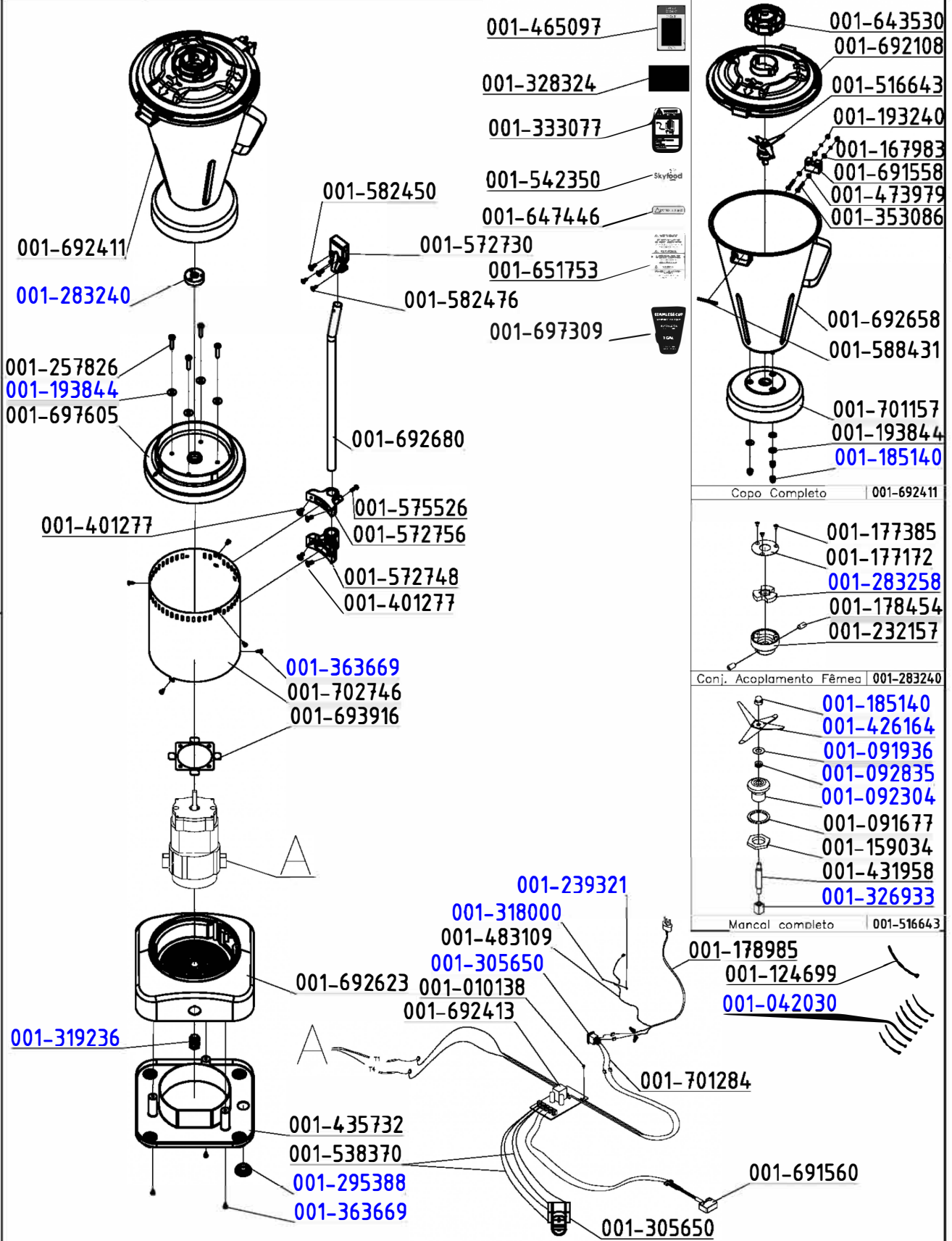

Denominação/Denomination/Denominación
 LIQUIDIFICADOR DE ALTA ROTAÇÃO
 HIGH ROTATION BLENDER
 LICUADORA DE ALTA ROTACION

Modelo/Model/Modelo
 TA-4.0MBE

SKYSEN
 Página/Page/Página: -X-
 Data/Date/Fecha: 11/09/2025



Versão/Release/Versión: 02 | Último N° de Série/Last Serial Number/Último N° de Série: ***** | RA/AR/RA: ****

Especificações do Motor/Motor Especifications/Specificación del Motor						A	PADRAO CERTIFICADO NR-12 + INMETRO
Pólos Poles Polos	Fases Phases Fases	Corrente Current [A] Corriente	Potência Rating Potencia	Frequência Frequency [Hz] Frecuencia	Voltagem Voltage [V] Voltaje	Código do Motor Motor Code Código del Motor	Código da Máquina Machine Code Código de la Máquina

2	1	-X-	1200W	60	115	692412	709670
---	---	-----	-------	----	-----	--------	--------

Cód.	Descrição	UM
001-042030	BRACER T-18R-SMALL	By the each
001-091677	BEARING SEAL RING LAR-15/25	By the each
001-091936	FIBER WASHER 0,7MM	By the each
001-092304	COMPLETE BEARING WITH BUSH	By the each
001-092835	V RING 11X7,5X4MM	By the each
001-124699	CLAMP K22-LM(T-80I)	By the each
001-175820	TERMINAL COVER	By the each
001-318000	NUT M4 DIN 985 INOX	By the each
001-177172	COVER PLATE	By the each
001-177385	SCREW 2,9X6,5 DIN 7982 IN	By the each
001-178454	SCREW M6X12 DIN 916 FOSF.	By the each
001-185140	NUT M6 DIN 1587	By the each
001-193844	WASHER 1/4X5/8X1,2MM STAINLESS STEEL	By the each
001-232157	COUPLING	By the each
001-257826	SCREW B.5,5X32 DIN 7981 INOX FOR TA4	By the each
001-283240	LOWER COUPLING SET TA-04 TA-04	By the each
001-283258	UPPER COUPLING SET	By the each
001-167983	WASHER L.A4,3	By the each
001-193240	STYROFOAM FOR BOX PROTECTION PCA M4 DIN 1587 INOX	By the each
001-363669	SCREW B.3,5X10 ZB PLAST.C/P	By the each
001-178985	CABLE 3X1.0MM WITH PLUG	By the each
001-295388	RUBBER COVER	By the each
001-305650	SWITCH 30223 - MPAL/PSP-98M/CFI-300/RQ-150/PA-7/ESB-N/MSL/PS-10/PS-22/PAIE	By the each
001-319236	CORD PRESS PG13,5 LCP13,5BL+ NUT WITH REDUCTOR	By the each
001-328324	INSTRUCTION MANUAL LABEL	By the each

Cód.	Descrição	UM
001-333077	LABEL WARNING ENG/FRE	By the each
001-239321	SCREW M4X5 DIN 7985	By the each
001-401277	PFS B.4,5x12 FLANGEADO P/PLASTICO	By the each
001-426164	HELIX SET BLADE TA-02/04MB	By the each
001-326933	UPPER COUPLING TA-02S	By the each
001-435732	BASE CLOSURE	By the each
001-159034	NUT SEX 3/4	By the each
001-431958	CENTRAL SHAFT TA-02S/04MB	By the each
001-465097	ETIQ.CHAVE GERAL(465097)	By the each
001-483109	EARTH-WIRE CORD 1,5X250X400	By the each
001-542350	SKYFOOD STICKER 120MM LAR-25LMB/PA7 PRO/CR-8L	By the each
001-010138	SCREW 2,9X6,5 7971 ZB	By the each
001-588431	GUIDE PIN 4X45 DIN 7 M6 STAINLESS STEEL	By the each
001-575526	6 PFS B.4, 5X20 FLANGE ADD INOX	By the each
001-572730	SENSOR SUPPORT - CR-4L	By the each
001-582450	PFS B.4,5x12 FLANGEADO P/PLASTICO INO	By the each
001-582476	PFS B.3,5x12 FLANGEADO P/PLASTICO INO	By the each
001-572756	REFORCO DO TUBO (MOLDE 574767)	By the each
001-572748	SUPORTE DO TUBO (MOLDE 574767)	By the each
001-353086	PFS M4x25 DIN 965 INOX	By the each
001-643530	OVER LID - LAR-15PMB/25PMB	By the each
001-647446	ETIQ.DO NOT RUN DRY	By the each
001-651753	WARNING LABEL	By the each
001-701157	FLANGE DO COPO(701157)	By the each
001-697605	FLANGE DO MOTOR(697605)	By the each

Cód.	Descrição	UM
001-701284	FIO PRETO 1x250mm C/TERM.	By the each
001-538370	TWO WAY WHIP 350MM	By the each
001-697309	ETIQ.E/I COPO MB BAR BLENDER (TA-4.0M	By the each
001-693916	CHAPA BASE DE REFORCO DO MOTOR	By the each
001-692411	COPO COMPLETO TA4(692411)	By the each
001-692680	TUBO SUPORTE DO SENSOR(692680)	By the each
001-702746	GABINETE(702746)	By the each
001-692623	BASE (MOLDE 451061)	By the each
001-692413	UNID.SEG.MON.S/FREIO 115V	By the each
001-646679	ACTUATOR+SENSOR SET CE/ROHS	By the each
001-692108	COVER 04 MONITORED	By the each
001-516643	COMPLETE CUTTING UNIT TA-04MB	By the each
001-692658	CS COPO TA-04MB	By the each