

| Denomination/Denominación/Dénomination | Item | Skyfoam Sistemas |
|--|------|---------------------|
| BAND SAW | SKGE | |
| SIERRA PARA HUESOS | | |
| SCIE A OS - 124" | | |

Date/Fecha/Date: 30/09/2016

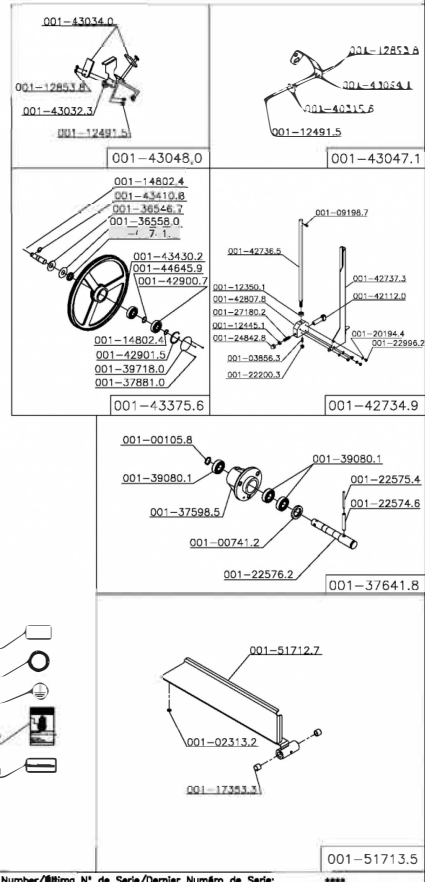
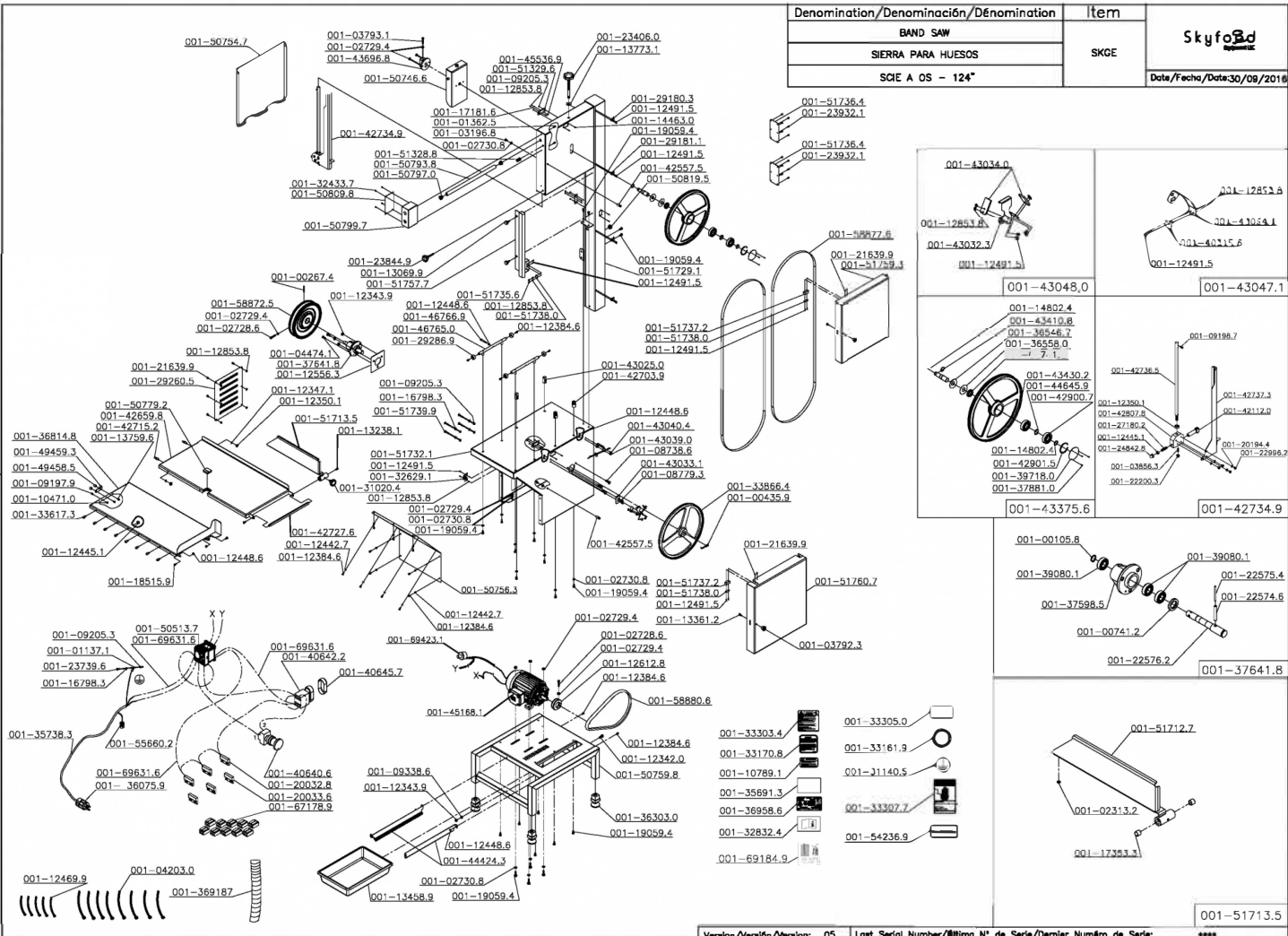

Version/Versión/Version: 05 Last Serial Number/Último N° de Serie/Dernier Numéro de Série: ****

| Cód. | Descrição | UM |
|-------------|-------------------------------------|-------------|
| 001-298239 | EMERGENCY BUTTON PROTECTOR | By the each |
| 001-292869 | PULLEY | By the each |
| 001-141836 | DRIVEN PULLY SKG/SKGL | By the each |
| 001-234060 | KNOB M12X154MM - SI-282HD | By the each |
| 001-190594 | SCREW M8X16 DIN 933 ZB | By the each |
| 001-027294 | SCREW NUT DIN 934 ZB | By the each |
| 001-027308 | WASHER L.A8,4 ZB | By the each |
| 001-250724 | CONTACTOR CWM18.10 220V 50/60 | By the each |
| 001-126128 | MOTOR PULLEY SK/SKL | By the each |
| 001-209112 | MAGNET DIAM.8X4MM | By the each |
| 001-262285 | ON / OFF SWITCH | By the each |
| 001-042030 | BRACER T-18R-SMALL | By the each |
| 001-124699 | CLAMP K22-LM(T-80I) | By the each |
| 001-104710 | NUT M5 DIN 934 S/S | By the each |
| 001-123471 | WASHER L.A10,5 INOX | By the each |
| 001-124451 | NUT M8 DIN 934 STAINLESS STEEL | By the each |
| 001-124486 | NUT M6 DIN 934 STAINLESS STEEL | By the each |
| 001-124605 | WASHER L.A8,4 STAINLESS STEEL | By the each |
| 001-185140 | NUT M6 DIN 1587 | By the each |
| 001-222003 | NUT M6 DIN 1587 STAINLESS | By the each |
| 001-201944 | WASHER L. A5,3 DIN 125 STAINLESS | By the each |
| 001-166391 | SCREW M8X30 DIN 933 STAINLESS STEEL | By the each |
| 001-124915 | SCREW M3X10 DIN 84 S/S | By the each |
| 001-128538 | NUT M3 DIN 934 S/S | By the each |
| 001-216399 | SCREW M3X6 DIN 7985 STAINLESS STEEL | By the each |

| Cód. | Descrição | UM |
|-------------|--|-------------|
| 001-123846 | SCREW M6X12 DIN 933 STAINLESS STEEL | By the each |
| 001-044741 | SCREW M8X20 DIN 933 ZB | By the each |
| 001-087386 | SCREW M10X30 DIN 933 ZB | By the each |
| 001-091979 | SCREW M5X10 DIN 84 INOX | By the each |
| 001-091987 | SCREW M4X10 DIN 912 S/S | By the each |
| 001-092150 | SCREW M5X10 DIN 912 S/S | By the each |
| 001-123439 | NUT M10 DIN 934 ZB | By the each |
| 001-134392 | SCREW M8X30 | By the each |
| 001-173533 | BUCH DRY MET 15X17X15 | By the each |
| 001-229989 | SCREW M5X8 DIN 7985 | By the each |
| 001-229962 | SCREW M5X6 DIN 84 STAINLESS STEEL | By the each |
| 001-319236 | CORD PRESS PG13,5 LCP13,5BL+ NUT WITH REDUCTOR | By the each |
| 001-326291 | THERMAL PROTECTION (PROTECTOR) | By the each |
| 001-328324 | INSTRUCTION MANUAL LABEL | By the each |
| 001-331619 | LABEL TERMO PROTECTION | By the each |
| 001-331708 | LABEL ATTENTION GROUND WIRE | By the each |
| 001-333034 | LABEL ATTENTION CAUTION ENG/FRE | By the each |
| 001-333050 | ATTENTION TAG 110/220/380V UN. PC | By the each |
| 001-333077 | LABEL WARNING ENG/FRE | By the each |
| 001-357383 | CHORD.3X2,1MM2 SJX2M CERTIF. | By the each |
| 001-007412 | SEAL 01604BR - RQ-150 | By the each |
| 001-134589 | RESIDUE TRAY 522 | By the each |
| 001-130699 | KNOB FOR SHIELD | By the each |
| 001-311405 | EARTH-WIRE LABEL | By the each |
| 001-357405 | CABLE 3X3, 3MM2 SJX2M CERTIF | By the each |

| Cód. | Descrição | UM |
|-------------|-------------------------------------|-------------|
| 001-030902 | PRESSION RIVET AD-429-S | By the each |
| 001-087793 | SCREW M6X20 DIN 965 STAINLESS STEEL | By the each |
| 001-200328 | REED SWITCH | By the each |
| 001-200336 | ENCAPSULATED MAGNET | By the each |
| 001-037931 | SCREW M8X30 DIN 933 ZB | By the each |
| 001-132381 | SCREW M8X16 | By the each |
| 001-031968 | SCREW M8X10 DIN 933 ZB | By the each |
| 001-093386 | WASHER L.A10,5 ZB | By the each |
| 001-123420 | SCREW M10X20 DIN 933 ZB | By the each |
| 001-210811 | SCREW M5X10 DIN 933 SS | By the each |
| 001-324337 | SCREW M4X8 DIN 7985 STAINLESS STEEL | By the each |
| 001-040010 | SCREW M8X20 | By the each |
| 001-001058 | RING 20X1,2 DIN 471 | By the each |
| 001-038563 | SCREW M6X16 DIN 916 | By the each |
| 001-107891 | EMERGENCY LABEL E/I/P | By the each |
| 001-248428 | WASHER M8 DIN 1587 | By the each |
| 001-013625 | SCREW M4X10 | By the each |
| 001-027286 | SCREW M8X25 DIN 933 ZB | By the each |
| 001-109754 | LARGE RUBBER RING | By the each |
| 001-123501 | NUT M10 DIN 934 SS | By the each |
| 001-001678 | LOGOTIPO SKYMSSEN 145mm | By the each |
| 001-004359 | CLIP - MSL | By the each |
| 001-008729 | BELT A 33 | By the each |
| 001-023132 | COVER | By the each |
| 001-037923 | DOOR KNOB 1/4 CRW | By the each |

| Cód. | Descrição | UM |
|-------------|--------------------------------------|-------------|
| 001-124559 | SCREW M8X20 DIN 933 S/S | By the each |
| 001-133612 | SCREW FRD UNC1/4X1/2 RTIN | By the each |
| 001-225746 | ELASTIC PIN 8X60 | By the each |
| 001-225754 | ELASTIC PIN 5X60 | By the each |
| 001-225762 | INFERIOR BEARING SKLG | By the each |
| 001-238449 | KNOB WITH BAR M8-50 STAINLESS STEEL | By the each |
| 001-291803 | PLATE GR | By the each |
| 001-291811 | ARTICULATION SHEET PQ | By the each |
| 001-336173 | PINO ARRASTE MESA MOVEL | By the each |
| 001-365467 | V-RING 55X24X8 | By the each |
| 001-365580 | SUPERIOR WHEEL WASHER | By the each |
| 001-011371 | TERMINAL | By the each |
| 001-124567 | PFS M10x25 DIN 933 INOX | By the each |
| 001-224669 | BELT A 43 | By the each |
| 001-319210 | *BLADE 124 (3.150 mm) 3/4 6TPI | By the each |
| 001-338664 | LOWER WHEEL - VARNISHED | By the each |
| 001-376418 | COMPLETE LOWER BEARING | By the each |
| 001-433756 | COMPLETE UPPER WHEEL | By the each |
| 001-390801 | ROL 6004 Z DIN 625 NSK/TK | By the each |
| 001-360759 | PLUG AMERICANO CERT.20A 250V (1X991) | By the each |
| 001-125563 | ENCOSTO SK (BRANCO) | By the each |
| 001-136751 | MANIPULO DO PRENDEDOR | By the each |
| 001-137596 | SCREW M6X10 DIN 933 | By the each |
| 001-266132 | BOTAO EMER.IMPULSO 1NF | By the each |
| 001-292605 | VENEZIANA 25x5x100(292605) | By the each |

| Cód. | Descrição | UM |
|-------------|---|-------------|
| 001-375985 | LOWER SHAFT (GREY) | By the each |
| 001-406422 | SI-315HD SWITCH ON/OFF | By the each |
| 001-406457 | APBD SWITCH PROTECTION | By the each |
| 001-406406 | EMERGENCY BUTTON W/LOCK 2NF | By the each |
| 001-455369 | PFS M3x12 DIN 7985 INOX | By the each |
| 001-397180 | WHEEL LID | By the each |
| 001-148024 | RING 25X1,2 DIN 471 UM | By the each |
| 001-429015 | RING 62X2 DIN 472 | By the each |
| 001-429007 | BEARING 6305 DDU FAG/NSK | By the each |
| 001-085740 | PFS M8x30 DIN 916 FOSF. | By the each |
| 001-123463 | SCREW M10X30 DIN 933 STAINLESS STEEL | By the each |
| 001-137731 | WASHER L 1/2 AISI 304 | By the each |
| 001-218650 | POLIA MOTORA 3CV (PRIMER)(218650) | By the each |
| 001-369187 | PROTECAO ESPIRAL 1/2" x 1/2" x 1/2" x 600mm | By the each |
| 001-369586 | ETIQ.ETL LISTED | By the each |
| 001-378810 | PFS M3x8 DIN 965 INOX | By the each |
| 001-406937 | SWITCH IEC 60715 | By the each |
| 001-425575 | EIXO TRAVA DA PORTA | By the each |
| 001-427039 | APOIO DIANTEIRO MESA FIXA(427039) | By the each |
| 001-427152 | FIXED TABLE LOCK PIN | By the each |
| 001-427284 | CUT REGULATOR SET | By the each |
| 001-428078 | BLADE GUIDE HOLDER | By the each |
| 001-434302 | UPPER WHEEL 400MM (VARNISHED) | By the each |
| 001-421120 | BLADE GUIDE | By the each |
| 001-430250 | APOIO TRASEIRO MESA FIXA | By the each |

| Cód. | Descrição | UM |
|--------------|---------------------------------------|-------------|
| 001-363030 | ANTI-SLIP STAND 7/8 TB.Q.40 | By the each |
| 001-434108 | UPPER WHEEL SHAFT | By the each |
| 001-430471 | COMPLETE WHEEL SCRAPPER | By the each |
| 001-430480 | BLADE SCRAPPER - SFL-282HD | By the each |
| 001-484288 | PROTECAO GUIA LAMINA INOX 430 | By the each |
| 001-484296 | COMPLETE BLADE GUIDE - SI-282HD | By the each |
| 001-486116 | CS EMPURRADOR 315 | By the each |
| 001-486167 | EIXO EMPURRADOR VERTICAL(486167) | By the each |
| 001-484270 | SUPORTE DO EMPURRADOR(484270) | By the each |
| 001-427365 | ROD SI-315HD | By the each |
| 001-403156 | WHEEL SCRAPPER PLUG | By the each |
| 001-507792 | TABLE BLADE GUIDE | By the each |
| 001-444243 | SUPORTE DA BANDEJA(444243) | By the each |
| 001-507997 | ELECTRIC BOX SET | By the each |
| 001-508098 | ELECTRIC CASE CLOSING | By the each |
| 001-494593 | TABLE LOCK | By the each |
| 001-494585 | BATENTE M6(494585) | By the each |
| 001-507938 | TUBO PASSAGEM CABOS(507938) | By the each |
| 001-507970 | PARAFUSO M18X12 | By the each |
| 001-508101 | FECHAMENTO DA COLUNA | By the each |
| 001-451630 | SUPORTE SI-315HD-N(451630) | By the each |
| 001-310204 | HANDLE W/STEM M8X12MM STAINLESS STEEL | |
| 001-513105 | BASE P/CONTATORA 105mm C/FURO(513105) | By the each |
| 001-508195 | PASSADOR FIO GR. 19X31,8MM (MOLDE 694 | By the each |
| 004-MCI-V2-1 | BACK COVER | By the each |

| Cód. | Descrição | UM |
|---------------|------------------------|-------------|
| 004-MCI-V2-2 | DRAINAGE CHANNEL | By the each |
| 004-MCI-V2-3 | PRESSING PLATE | By the each |
| 004-MCI-V2-4 | UPPER PROTECTING COVER | By the each |
| 004-MCI-V2-5 | AUXILIARY ROLLER II | By the each |
| 004-MCI-V2-6 | BEARING COVER II | By the each |
| 004-MCI-V2-7 | LEFT SUPPORTING BLOCK | By the each |
| 004-MCI-V2-8 | BEARING 203 | By the each |
| 004-MCI-V2-9 | BEARING COVER I | By the each |
| 004-MCI-V2-10 | GEAR Z=41 | By the each |
| 004-MCI-V2-11 | WASHER | By the each |
| 004-MCI-V2-12 | GEAR Z=35 | By the each |
| 004-MCI-V2-13 | BEARING 304 | By the each |
| 004-MCI-V2-14 | BEARING COVER I | By the each |
| 004-MCI-V2-15 | GEAR Z=35 | By the each |
| 004-MCI-V2-16 | LEFT PROTECTING COVER | By the each |
| 004-MCI-V2-17 | TOP COVER | By the each |
| 004-MCI-V2-18 | GEAR Z=41 | By the each |
| 004-MCI-V2-19 | BEARING COVER I | By the each |
| 004-MCI-V2-20 | BEARING 304 | By the each |
| 004-MCI-V2-21 | MACHINE FRAME | By the each |
| 004-MCI-V2-23 | BEARING COVER II | By the each |
| 004-MCI-V2-24 | BEARING COVER II | By the each |
| 004-MCI-V2-25 | AUXILIARY ROLLER I | By the each |
| 004-MCI-V2-26 | MAIN PRESSING ROLLER | By the each |
| 004-MCI-V2-27 | BEARING COVER II | By the each |

| Cód. | Descrição | UM |
|---------------|------------------------|-------------|
| 004-MCI-V2-28 | BEARING COVER II | By the each |
| 004-MCI-V2-29 | RIGHT SUPPORTING BLOCK | By the each |
| 004-MCI-V2-30 | BEARING 180304G | By the each |
| 004-MCI-V2-31 | BEARING COVER I | By the each |
| 004-MCI-V2-32 | GEAR Z=72D24 | By the each |
| 004-MCI-V2-33 | RIGHT PROTECTING COVER | By the each |
| 004-MCI-V2-34 | GEAR Z=18 | By the each |
| 004-MCI-V2-35 | DECELERATING SHAFT I | By the each |
| 004-MCI-V2-36 | BEARING 203 | By the each |
| 004-MCI-V2-37 | PLUG | By the each |
| 004-MCI-V2-38 | BEARING 203 | By the each |
| 004-MCI-V2-39 | BEARING 203 | By the each |
| 004-MCI-V2-40 | BEARING SEAT I | By the each |
| 004-MCI-V2-42 | DECELARATING SHAFT II | By the each |
| 004-MCI-V2-41 | BEARING 180204G | By the each |
| 004-MCI-V2-43 | GEAR Z=18 | By the each |
| 004-MCI-V2-45 | GEAR 180203 | By the each |
| 004-MCI-V2-46 | BEARING SEAT | By the each |
| 004-MCI-V2-47 | BIG BELT PULLEY | By the each |
| 004-MCI-V2-48 | BELT A850 | By the each |
| 004-MCI-V2-49 | SMALL BELT PULLEY | By the each |
| 004-MCI-V2-50 | SEAT | By the each |
| 004-MCI-V2-51 | MOTOR 220V 550W | By the each |
| 004-MCI-V2-52 | MOTOR SEAT | By the each |
| 004-MCI-V2-53 | FEED PLATE | By the each |

| Cód. | Descrição | UM |
|---------------|------------------------------------|-------------|
| 004-MCI-V2-54 | FILTER TRAY | By the each |
| 004-MCI-V2-55 | SUPPORTING RACK | By the each |
| 004-MCI-V2-56 | JUICE TRAY | By the each |
| 004-MCI-V2-57 | BEARING COVER II | By the each |
| 004-MCI-V2-58 | SHAFT PLUG CAP | By the each |
| 004-MCI-V2-59 | BEARING 180203 | By the each |
| 004-MCI-V2-22 | POWER SWITCH | By the each |
| 004-MCI-V2-44 | GEAR Z=72 D18 | By the each |
| 001-237396 | PFS M4x10 DIN 933 INOX | By the each |
| 001-428833 | SUPORTE DO SENSOR | By the each |
| 001-430331 | GUIA DO RASPADOR | By the each |
| 001-430340 | SCRAPPER | By the each |
| 001-436828 | PFS M3x20 DIN 7985 INOX (OBSOLETO) | By the each |
| 001-451681 | MOTOR 2CV 60HZ MONOF.W | By the each |
| 001-467650 | CS EIXO DOS ROLETES(467650) | By the each |
| 001-467669 | MOVABLE TABLE STOP | By the each |
| 001-490571 | FIXADOR PARA CABO | By the each |
| 001-507334 | CS ESTRUTURA (CINZA) | By the each |
| 001-507415 | CS PORTA INFERIOR (CINZA)(507415) | By the each |
| 001-507431 | CS GABINETE (CINZA)(507431) | By the each |
| 001-507466 | STRETCHER SET | By the each |
| 001-507520 | CS PORTA SUPERIOR (CINZA)(507520) | By the each |
| 001-507547 | CHAPA FECHAMENTO TS(507547) | By the each |
| 001-507555 | CHAPA DE FECHAMENTO (CINZA) | By the each |
| 001-507563 | FECHAMENTO DO GABINETE (CINZA) | By the each |

| Cód. | Descrição | UM |
|-------------|---------------------------------------|-------------|
| 001-507598 | CS CAVALETE (CINZA)(507598) | By the each |
| 001-513288 | PRENSA CABO HSK-K PG07 (C209070115) | By the each |
| 001-513296 | SENSOR SUPPORT | By the each |
| 001-517127 | CUT REGULATOR SET | By the each |
| 001-517135 | COMPLETE CUT REGULATOR | By the each |
| 001-517291 | STRUCTURE SET | By the each |
| 001-517321 | CS GABINETE(517321) | By the each |
| 001-517356 | NUT M3 DIN 1587 STAINLESS STEEL | By the each |
| 001-517364 | FECHAMENTO DA COLUNA(517364) | By the each |
| 001-517372 | ACTUATOR SPACER | By the each |
| 001-517380 | ACTUATOR WASHER SHEET | By the each |
| 001-517399 | PFS M4x16 DIN 933 INOX | By the each |
| 001-517577 | BLADE PROTECTION SET SI-315HD | By the each |
| 001-517593 | UPPER DOOR CS | By the each |
| 001-517607 | LOWER DOOR CS | By the each |
| 001-429570 | CUT REGULATOR ASSEMBLY | By the each |
| 001-542369 | SKYFOOD STICKER | By the each |
| 001-671789 | CONECTOR EMENDA WAGO 2X0,25-4MM2 | By the each |
| 001-696316 | CHICOTE ELETRICO COMPL.SKGE/SI-282/31 | By the each |