

Denomination/Denominación/Dénominación	Item	Skyfo8d Repertic	Date/Fecha/Date: 27/02/2025
BAND SAW-124"S/S T.P.220V	SI-315HDE-2		
SIERRA P/HUES.124"*.T.220V			
SCIE A OS - 124"			

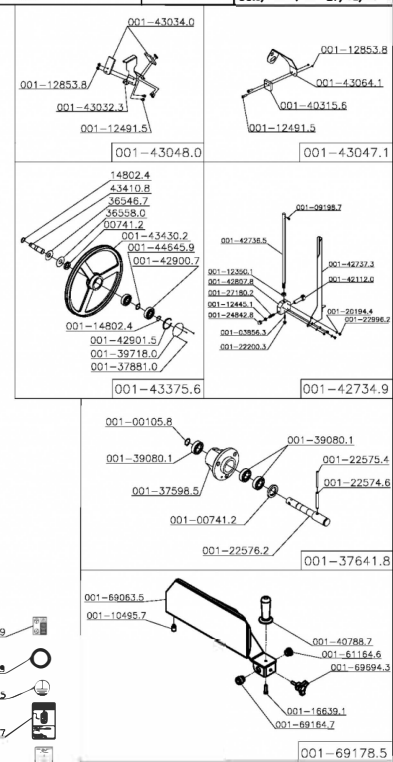
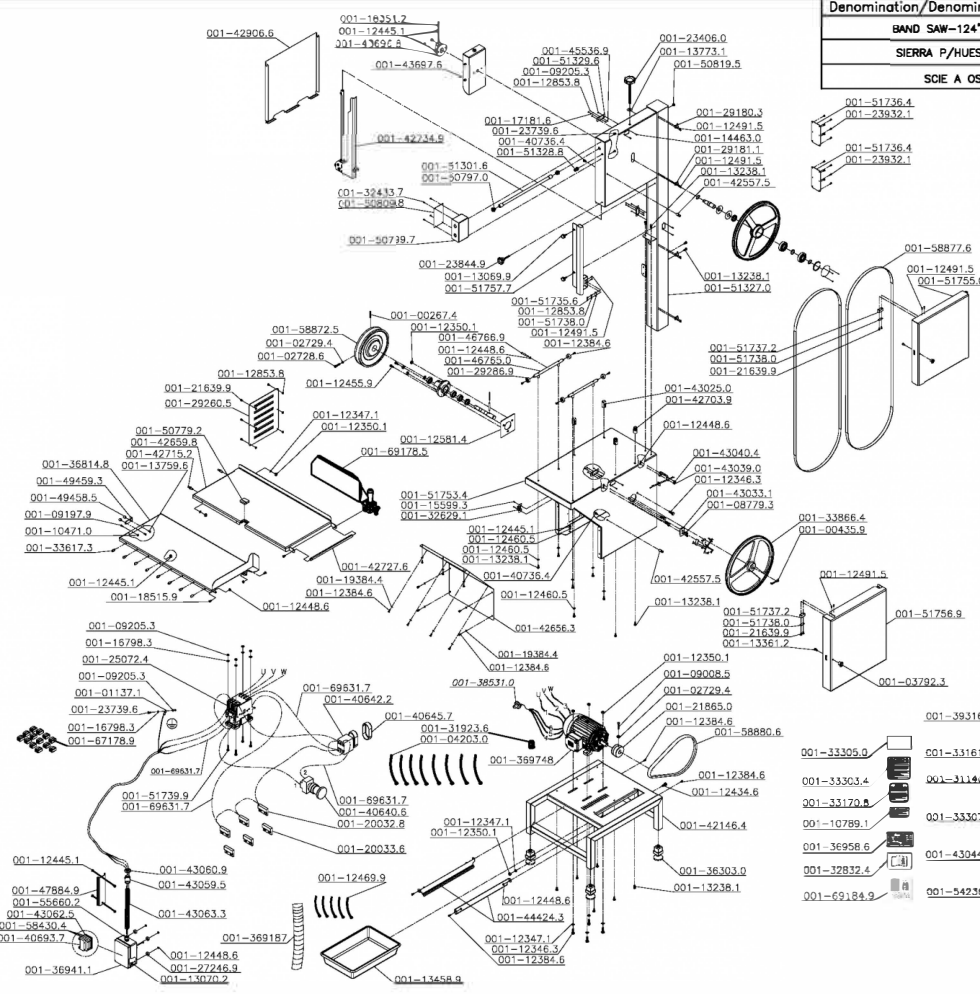

- 001-39316.9
- 001-33303.4
- 001-33170.8
- 001-10789.1
- 001-36958.6
- 001-32832.4
- 001-69184.9
- 001-33161.8
- 001-31140.5
- 001-33307.2
- 001-43944.7
- 001-54256.8

Cód.	Descrição	UM
001-298239	EMERGENCY BUTTON PROTECTOR	By the each
001-292869	PULLEY	By the each
001-234150	TABLE GUIDE	By the each
001-141836	DRIVEN PULLY SKG/SKGL	By the each
001-234060	KNOB M12X154MM - SI-282HD	By the each
001-027294	SCREW NUT DIN 934 ZB	By the each
001-250724	CONTACTOR CWM18.10 220V 50/60	By the each
001-209112	MAGNET DIAM.8X4MM	By the each
001-262285	ON / OFF SWITCH	By the each
001-002186	WIRE PASSER MOLDE 0922231	By the each
001-042030	BRACER T-18R-SMALL	By the each
001-124699	CLAMP K22-LM(T-80I)	By the each
001-002674	LOCK PIN 6X50 DIN1481	By the each
001-104710	NUT M5 DIN 934 S/S	By the each
001-123471	WASHER L.A10,5 INOX	By the each
001-124451	NUT M8 DIN 934 STAINLESS STEEL	By the each
001-124486	NUT M6 DIN 934 STAINLESS STEEL	By the each
001-124605	WASHER L.A8,4 STAINLESS STEEL	By the each
001-183512	SCREW M8X40 DIN 933 SS	By the each
001-171816	WASHER L.A3,2 DIN 125 S/S	By the each
001-178454	SCREW M6X12 DIN 916 FOSF.	By the each
001-185140	NUT M6 DIN 1587	By the each
001-222003	NUT M6 DIN 1587 STAINLESS	By the each
001-167983	WASHER L.A4,3	By the each
001-124427	WASHER L.A6,4 125 INOX	By the each

Cód.	Descrição	UM
001-201944	WASHER L. A5,3 DIN 125 STAINLESS	By the each
001-092053	NUT M4 DIN 934	By the each
001-124915	SCREW M3X10 DIN 84 S/S	By the each
001-128538	NUT M3 DIN 934 S/S	By the each
001-144630	SCREW M4X10	By the each
001-216399	SCREW M3X6 DIN 7985 STAINLESS STEEL	By the each
001-003069	ELASTIC PIN 6X40	By the each
001-123846	SCREW M6X12 DIN 933 STAINLESS STEEL	By the each
001-002151	PRESSION RIVET AD-635-S	By the each
001-085634	WASHER 10X28X1,5MM	By the each
001-155993	SCREW B.3,5X9,5 DIN 7971	By the each
001-090085	SCREW M8X40 DIN 933 ZB	By the each
001-091979	SCREW M5X10 DIN 84 INOX	By the each
001-091987	SCREW M4X10 DIN 912 S/S	By the each
001-092150	SCREW M5X10 DIN 912 S/S	By the each
001-134392	SCREW M8X30	By the each
001-173533	BUCH DRY MET 15X17X15	By the each
001-217719	SCREW M6X16 DIN 963	By the each
001-229989	SCREW M5X8 DIN 7985	By the each
001-271802	PFS M8x40 DIN 916 FOSF.	By the each
001-272965	SCREW M5X16 DIN 965 STAINLESS STEEL	By the each
001-307530	PIN DIAM.3X13	By the each
001-229962	SCREW M5X6 DIN 84 STAINLESS STEEL	By the each
001-319236	CORD PRESS PG13,5 LCP13,5BL+ NUT WITH REDUCTOR	By the each
001-326291	THERMAL PROTECTION (PROTECTOR)	By the each

Cód.	Descrição	UM
001-328324	INSTRUCTION MANUAL LABEL	By the each
001-331619	LABEL TERMO PROTECTION	By the each
001-331708	LABEL ATTENTION GROUND WIRE	By the each
001-333034	LABEL ATTENTION CAUTION ENG/FRE	By the each
001-333050	ATTENTION TAG 110/220/380V UN. PC	By the each
001-333077	LABEL WARNING ENG/FRE	By the each
001-357383	CHORD.3X2,1MM2 SJX2M CERTIF.	By the each
001-007412	SEAL 01604BR - RQ-150	By the each
001-134589	RESIDUE TRAY 522	By the each
001-185159	SCREW M6X10 DIN 7985 SS	By the each
001-130699	KNOB FOR SHIELD	By the each
001-311405	EARTH-WIRE LABEL	By the each
001-030902	PRESSION RIVET AD-429-S	By the each
001-087793	SCREW M6X20 DIN 965 STAINLESS STEEL	By the each
001-194450	CONTACTOR BRACKET	By the each
001-200328	REED SWITCH	By the each
001-200336	ENCAPSULATED MAGNET	By the each
001-132381	SCREW M8X16	By the each
001-296937	SILICONE PROTECTION CAP	By the each
001-239321	SCREW M4X5 DIN 7985	By the each
001-206601	SCREW M4X7 DIN 963 S/S	By the each
001-210811	SCREW M5X10 DIN 933 SS	By the each
001-324337	SCREW M4X8 DIN 7985 STAINLESS STEEL	By the each
001-040010	SCREW M8X20	By the each
001-215368	PFS M8x20 DIN 912 FOSF.	By the each

Cód.	Descrição	UM
001-001058	RING 20X1,2 DIN 471	By the each
001-038563	SCREW M6X16 DIN 916	By the each
001-107891	EMERGENCY LABEL E/I/P	By the each
001-248428	WASHER M8 DIN 1587	By the each
001-272469	PULLEY	By the each
001-027286	SCREW M8X25 DIN 933 ZB	By the each
001-285811	BEARING DDU	By the each
001-109754	LARGE RUBBER RING	By the each
001-123501	NUT M10 DIN 934 SS	By the each
001-001678	LOGOTIPO SKYMSEN 145mm	By the each
001-004359	CLIP - MSL	By the each
001-008729	BELT A 33	By the each
001-017612	WHEEL LID SI/L/R/S	By the each
001-023132	COVER	By the each
001-037923	DOOR KNOB 1/4 CRW	By the each
001-124346	PFS M10x20 DIN 933 INOX	By the each
001-124559	SCREW M8X20 DIN 933 S/S	By the each
001-124737	KNOB M8X30 - SKG CUT REGULATOR	By the each
001-133612	SCREW FRD UNC1/4X1/2 RTIN	By the each
001-225746	ELASTIC PIN 8X60	By the each
001-225754	ELASTIC PIN 5X60	By the each
001-225762	INFERIOR BEARING SKLG	By the each
001-231860	CHAPA MANCAL D	By the each
001-238449	KNOB WITH BAR M8-50 STAINLESS STEEL	By the each
001-291803	PLATE GR	By the each

Cód.	Descrição	UM
001-291811	ARTICULATION SHEET PQ	By the each
001-336173	PINO ARRASTE MESA MOVEL	By the each
001-365467	V-RING 55X24X8	By the each
001-365580	SUPERIOR WHEEL WASHER	By the each
001-366161	ROLL BALL BEARING CON.30204 NSK/TK	By the each
001-378208	TAMPA DE APERTO ROLAMENTO	By the each
001-011371	TERMINAL	By the each
001-124567	PFS M10x25 DIN 933 INOX	By the each
001-125814	BACKBOARD	By the each
001-218600	PFS M8x50 DIN 933 INOX	By the each
001-224669	BELT A 43	By the each
001-292877	EIXO DOS ROLETES(292877)	By the each
001-319210	*BLADE 124 (3.150 mm) 3/4 6TPI	By the each
001-338664	LOWER WHEEL - VARNISHED	By the each
001-366781	EIXO SUPERIOR(366781)	By the each
001-376418	COMPLETE LOWER BEARING	By the each
001-378534	VOLANTE SUPERIOR (VERNIZ)	By the each
001-433756	COMPLETE UPPER WHEEL	By the each
001-390801	ROL 6004 Z DIN 625 NSK/TK	By the each
001-393169	ETIQ.SENTIDO DE TRABALHO	By the each
001-130702	PFS M6x25 DIN 933 INOX	By the each
001-000477	LOGO SKYMPSEN 120MM LAR-25/PA7 PRO/CR8L	By the each
001-136751	MANIPULO DO PRENDEDOR	By the each
001-137596	SCREW M6X10 DIN 933	By the each
001-264407	CHAVETA 8x7x50	By the each

Cód.	Descrição	UM
001-266132	BOTAO EMER.IMPULSO 1NF	By the each
001-292605	VENEZIANA 25x5x100(292605)	By the each
001-375985	LOWER SHAFT (GREY)	By the each
001-406422	SI-315HD SWITCH ON/OFF	By the each
001-406457	APBD SWITCH PROTECTION	By the each
001-458805	PULLEY - SI-282HD	By the each
001-406406	EMERGENCY BUTTON W/LOCK 2NF	By the each
001-455369	PFS M3x12 DIN 7985 INOX	By the each
001-397180	WHEEL LID	By the each
001-148024	RING 25X1,2 DIN 471 UM	By the each
001-429015	RING 62X2 DIN 472	By the each
001-429007	BEARING 6305 DDU FAG/NSK	By the each
001-378569	COMPLETE UPPER WHEEL	By the each
001-085740	PFS M8x30 DIN 916 FOSF.	By the each
001-123463	SCREW M10X30 DIN 933 STAINLESS STEEL	By the each
001-137731	WASHER L 1/2 AISI 304	By the each
001-218650	POLIA MOTORA 3CV (PRIMER)(218650)	By the each
001-354740	ETIQ.IDENTIF.MOTOR/RESIST	By the each
001-368890	FIO EL.FLEX.2,1x500mm CERT.	By the each
001-368911	FIO EL.FLEX.2,1x100mm CERT.(368911)	By the each
001-369187	PROTECAO ESPIRAL 1/2"ç1/2"ç1/2x600mm	By the each
001-369276	CHAPA MANCAL E CERT.	By the each
001-369586	ETIQ.ETL LISTED	By the each
001-369748	MOTOR 3CV 60Hz TRIFASICO W (C/PROTETO)	By the each
001-378810	PFS M3x8 DIN 965 INOX	By the each

Cód.	Descrição	UM
001-385310	THERMAL PROTECTOR 11066747	By the each
001-404691	CHAPA DE FECHAMENTO(404691)	By the each
001-406937	SWITCH IEC 60715	By the each
001-430447	ETIQUETA LIGACAO 220V TRIFASICO	By the each
001-430595	TERMINACAO SMN M20X1,5 PR	By the each
001-425575	EIXO TRAVA DA PORTA	By the each
001-430609	CONTRA PORCA GMFSPA M20x1,5	By the each
001-427039	APOIO DIANTEIRO MESA FIXA(427039)	By the each
001-430617	BORNE PFS BTWP2,5-CZ 2,5	By the each
001-427152	FIXED TABLE LOCK PIN	By the each
001-430625	BORNE PFS TERRA BTWP4T	By the each
001-427284	CUT REGULATOR SET	By the each
001-430633	CONDUITE 300mm	By the each
001-428078	BLADE GUIDE HOLDER	By the each
001-434302	UPPER WHEEL 400MM (VARNISHED)	By the each
001-421120	BLADE GUIDE	By the each
001-430250	APOIO TRASEIRO MESA FIXA	By the each
001-363030	ANTI-SLIP STAND 7/8 TB.Q.40	By the each
001-434108	UPPER WHEEL SHAFT	By the each
001-407364	SCREW M8X12 DIN 933 STAINLESS STEEL	By the each
001-430471	COMPLETE WHEEL SCRAPPER	By the each
001-430480	BLADE SCRAPPER - SFL-282HD	By the each
001-484288	PROTECAO GUIA LAMINA INOX 430	By the each
001-484296	COMPLETE BLADE GUIDE - SI-282HD	By the each
001-486116	CS EMPURRADOR 315	By the each

Cód.	Descrição	UM
001-486167	EIXO EMPURRADOR VERTICAL(486167)	By the each
001-484270	SUORTE DO EMPURRADOR(484270)	By the each
001-427365	ROD SI-315HD	By the each
001-403156	WHEEL SCRAPPER PLUG	By the each
001-507792	TABLE BLADE GUIDE	By the each
001-508110	CS ESTRUTURA	By the each
001-444243	SUORTE DA BANDEJA(444243)	By the each
001-507997	ELECTRIC BOX SET	By the each
001-508098	ELECTRIC CASE CLOSING	By the each
001-494593	TABLE LOCK	By the each
001-494585	BATENTE M6(494585)	By the each
001-507938	TUBO PASSAGEM CABOS(507938)	By the each
001-507970	PARAFUSO M18X12	By the each
001-436968	STRETCHER ASSEMBLY	By the each
001-508101	FECHAMENTO DA COLUNA	By the each
001-310204	HANDLE W/STEM M8X12MM STAINLESS STEEL	
001-511412	RETAINER 01048BR	By the each
001-513415	PINO GUIA 10x60 DIN 7 h8 TEMPERADO	By the each
001-511382	EIXO INFERIOR(511382)	By the each
001-513733	BIGGER STRAP	By the each
001-508195	PASSADOR FIO GR. 19X31,8MM (MOLDE 694	By the each
001-511404	MANCAL INFERIOR 315 COMPLETO	By the each
001-511390	MANCAL INFERIOR 315	By the each
001-512052	VOLANTE INFERIOR 400 (VERNIZ)	By the each
001-513440	VOLANTE INFERIOR(VERNIZ)	By the each

Cód.	Descrição	UM
001-512044	BUCHA DO VOLANTE	By the each
001-512060	POLIA MOVIDA (PRIMER)(512060)	By the each
004-MCI-V2-1	BACK COVER	By the each
004-MCI-V2-2	DRAINAGE CHANNEL	By the each
004-MCI-V2-3	PRESSING PLATE	By the each
004-MCI-V2-4	UPPER PROTECTING COVER	By the each
004-MCI-V2-5	AUXILIARY ROLLER II	By the each
004-MCI-V2-6	BEARING COVER II	By the each
004-MCI-V2-7	LEFT SUPPORTING BLOCK	By the each
004-MCI-V2-8	BEARING 203	By the each
004-MCI-V2-9	BEARING COVER I	By the each
004-MCI-V2-10	GEAR Z=41	By the each
004-MCI-V2-11	WASHER	By the each
004-MCI-V2-12	GEAR Z=35	By the each
004-MCI-V2-13	BEARING 304	By the each
004-MCI-V2-14	BEARING COVER I	By the each
004-MCI-V2-15	GEAR Z=35	By the each
004-MCI-V2-16	LEFT PROTECTING COVER	By the each
004-MCI-V2-17	TOP COVER	By the each
004-MCI-V2-18	GEAR Z=41	By the each
004-MCI-V2-19	BEARING COVER I	By the each
004-MCI-V2-20	BEARING 304	By the each
004-MCI-V2-21	MACHINE FRAME	By the each
004-MCI-V2-23	BEARING COVER II	By the each
004-MCI-V2-24	BEARING COVER II	By the each

Cód.	Descrição	UM
004-MCI-V2-25	AUXILIARY ROLLER I	By the each
004-MCI-V2-26	MAIN PRESSING ROLLER	By the each
004-MCI-V2-27	BEARING COVER II	By the each
004-MCI-V2-28	BEARING COVER II	By the each
004-MCI-V2-29	RIGHT SUPPORTING BLOCK	By the each
004-MCI-V2-30	BEARING 180304G	By the each
004-MCI-V2-31	BEARING COVER I	By the each
004-MCI-V2-32	GEAR Z=72D24	By the each
004-MCI-V2-33	RIGHT PROTECTING COVER	By the each
004-MCI-V2-34	GEAR Z=18	By the each
004-MCI-V2-35	DECELERATING SHAFT I	By the each
004-MCI-V2-36	BEARING 203	By the each
004-MCI-V2-37	PLUG	By the each
004-MCI-V2-38	BEARING 203	By the each
004-MCI-V2-39	BEARING 203	By the each
004-MCI-V2-40	BEARING SEAT I	By the each
004-MCI-V2-42	DECELARATING SHAFT II	By the each
004-MCI-V2-41	BEARING 180204G	By the each
004-MCI-V2-43	GEAR Z=18	By the each
004-MCI-V2-45	GEAR 180203	By the each
004-MCI-V2-46	BEARING SEAT	By the each
004-MCI-V2-47	BIG BELT PULLEY	By the each
004-MCI-V2-48	BELT A850	By the each
004-MCI-V2-49	SMALL BELT PULLEY	By the each
004-MCI-V2-50	SEAT	By the each

Cód.	Descrição	UM
004-MCI-V2-51	MOTOR 220V 550W	By the each
004-MCI-V2-52	MOTOR SEAT	By the each
004-MCI-V2-53	FEED PLATE	By the each
004-MCI-V2-54	FILTER TRAY	By the each
004-MCI-V2-55	SUPPORTING RACK	By the each
004-MCI-V2-56	JUICE TRAY	By the each
004-MCI-V2-57	BEARING COVER II	By the each
004-MCI-V2-58	SHAFT PLUG CAP	By the each
004-MCI-V2-59	BEARING 180203	By the each
004-MCI-V2-22	POWER SWITCH	By the each
004-MCI-V2-44	GEAR Z=72 D18	By the each
001-210790	PFS M6x10 DIN 7985 INOX (OBSOLETO)	By the each
001-237396	PFS M4x10 DIN 933 INOX	By the each
001-428833	SUPORTE DO SENSOR	By the each
001-429066	CHAPA FECHAMENTO TS(429066)	By the each
001-430331	GUIA DO RASPADOR	By the each
001-430340	SCRAPPER	By the each
001-436828	PFS M3x20 DIN 7985 INOX (OBSOLETO)	By the each
001-436976	STRETCHER SET	By the each
001-467650	CS EIXO DOS ROLETES(467650)	By the each
001-467669	MOVABLE TABLE STOP	By the each
001-478849	BASE P/CONTATORA 108mm C/FURO	By the each
001-513270	CS ESTRUTURA(513270)	By the each
001-513288	PRENSA CABO HSK-K PG07 (C209070115)	By the each
001-513296	SENSOR SUPPORT	By the each

Cód.	Descrição	UM
001-517127	CUT REGULATOR SET	By the each
001-517135	COMPLETE CUT REGULATOR	By the each
001-517356	NUT M3 DIN 1587 STAINLESS STEEL	By the each
001-517364	FECHAMENTO DA COLUNA(517364)	By the each
001-517372	ACTUATOR SPACER	By the each
001-517380	ACTUATOR WASHER SHEET	By the each
001-517399	PFS M4x16 DIN 933 INOX	By the each
001-517534	CS GABINETE(517534)	By the each
001-517550	UPPER DOOR 315	By the each
001-517569	LOWER DOOR 315	By the each
001-517577	BLADE PROTECTION SET SI-315HD	By the each
001-429570	CUT REGULATOR ASSEMBLY	By the each
001-542369	SKYFOOD STICKER	By the each
001-556602	CORD PRESS PG13,5 HSK-K COMPLETE	By the each
001-427349	COMPLETE BLADE GUIDE	By the each
001-427276	REGULATOR SHAFT	By the each
001-588806	BELT A 34 (GOODYEAR)	By the each
001-588776	*BLADE 124 (3.150 MM) 3/4 4TPI S	By the each
001-588725	MOVED PULLEY DIAM. 180MM	By the each
001-426598	STATIONARY TABLE SET	By the each
001-368148	CS MESA MOVEL CERT.	By the each
001-430641	WHEEL SCRAPPER SHEET	By the each
001-584304	BORNE BTWP 10	By the each
001-427373	CS PROTECAO GUIA LAMINA(427373)	By the each
001-430323	CHAPA DO RASPADOR(430323)	By the each

Cód.	Descrição	UM
001-421464	CS CAVALETE CERTIFICADO(421464)	By the each
001-369411	CAIXA DE LIGACAO TRIF.CER(369411)	By the each
001-430404	PINO GUIA DO RASPADOR	By the each
001-430390	PINO TRAVA DO RASPADOR	By the each
001-513016	CS TUBO PASSAGEM(513016)	By the each
001-671789	CONECTOR EMENDA WAGO 2X0,25-4MM2	By the each
001-696317	CHICOTE ELETRICO COMPL.SI-282/315HDE	By the each