

035-0130030003

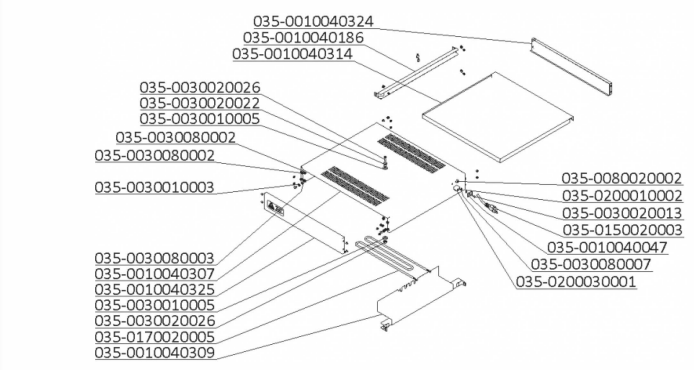

035-0190030096
035-0040020003
035-0070020001

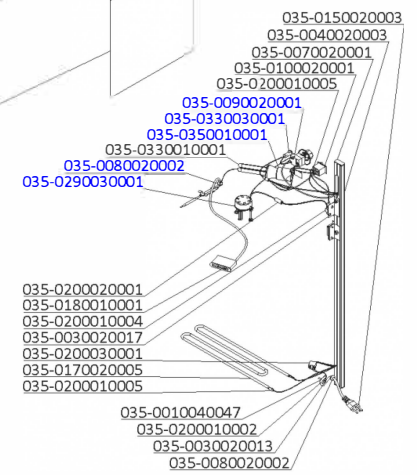

Cód.	Descrição	UM
035-0030020017	SLOTTED BOLT FO NUT 5/32"x 3/8" ROUNDED HEAD (FOR THE GROUND WIRE)	By the each
035-0030020023	SELF-DRILLING HEX BOLT 4.2x13mm	By the each
035-0330030001	NYLON RED PILOT LAMP, BIVOLT 14K	By the each
035-0080020002	PLUG-IN POWER CONNECTOR FOR WIRE REF. 20mm	By the each
035-0150020003	POWER CORD 3 x 0.75m2 FOR ALL MODELS	By the each
035-0090020001	THERMOSTAT SLAT	By the each
035-0200010002	UNINSULATED RING TERMINAL	By the each
035-0350010001	PORCELAIN SOCKET LORENZETTI	By the each
035-0330010001	FLUORESCENT LAMP WITH ROUND SHAPED STARTER 11W 127V YELLOW	By the each
035-0030020014	SLOT SCREW NUT - ROUND HEAD (LIGHTING)	By the each
035-0030080007	HEX NUT 5/32"	By the each
035-0010040047	CABLE GLAND	By the each
035-0200010004	TERMINAL SLIP - NOS FEMALE BLUE	By the each
035-0030020013	SLOTTED BOLT 5/32 x 1"	By the each
035-0040020003	FOOT PROFILE	By the each
035-0030020012	RIFT BOLT 5/32" X 1 1/4"	By the each
035-0030020018	BOLT CRACK POT 3/16" X 5/16"	By the each
035-0100030001	ON-OFF SECURITY	By the each
035-0030010006	WASHER 5/32" ZINC WHITE	By the each
035-0030020015	SCREW SLOT NUT 5/32" X 2"	By the each
035-0030080008	NUT M6	By the each
035-0030020026	ALLEN SCREW M6 X 25 MM	By the each
035-0030020022	SCREW 3/8 X 1/2"	By the each
035-0030010005	WASHER 3/8	By the each
035-0030080003	HEX NUT 1/4" PYTHON	By the each

Cód.	Descrição	UM
035-0030020020	SCREW PYTHON	By the each
035-0200030001	CONNECTOR	By the each
035-0170020005	ARMOURED ELEMENT 700W 127V TUBULAR	By the each
035-0030080002	SQUARE NUT 3/8 X 3/16	By the each
035-0030010003	LOCK WASHER 3/16 X 1	By the each
035-0180010001	THERMOMETER	By the each
035-0030050002	MAGNETIC CLOSURE PL BROWN	By the each
035-0010040196	SUPPORT MAGNETIC CLOSURE	By the each
035-0030040001	HINGE	By the each
035-0070020001	FOOT CAP -PP	By the each
035-0100020001	ON/OFF SWITCH	By the each
035-0010040186	TRAIL	By the each
035-0200010005	UNINSULATED FEMALE TERMINAL 6,3 X 0,8 MM - SILVER	By the each
035-0290030001	ROTARY ENGINE 127V	By the each
035-0010040309	PROTECTION ARMARED ELEMENT	By the each
035-0010040307	BOTTOM BASE	By the each
035-0030080001	HEX NUT 3/8	By the each
035-0010040314	DRAWER	By the each
035-0190030098	DOOR GLASS WITH HANDLE	By the each
035-0190030003	FRONT GLASS 4MM 500 X 500 MM	By the each
035-0010040318	UPPER COVER	By the each
035-0250020019	GLASSPEC	By the each
035-0720010011	PHOTO 3D 620 X 160 MM	By the each
035-0010040315	SUPPORT PHOTO	By the each
035-0010040319	UPPER BASE	By the each

Cód.	Descrição	UM
035-0010040324	BACK BOTTOM PART	By the each
035-0010040325	FRONT BOTTOM PART	By the each
035-0010040310	PANEL UPPER BACK	By the each
035-0190030096	LATERAL GLASS 4MM 490 X 900 MM	By the each
035-0200020001	AMENDMENT NYLON INSULATED RED	By the each
035-0120010004	TRAY 18	By the each
035-0280020005	RACK 18	By the each