

NO. U8AA-2202

ISSUED: FEB.28,2000

REVISED: APR.12,2002



**HOSHIZAKI
WATER ELECTROLYZER**

MODEL ROX-20TA-U

PARTS LIST

K-1 FEB. 2000

L-0 MAR. 2001

M-1 ? 2002

MATERIAL ABBREVIATIONS

PLASTIC

ABS	=	Acrylonitrile-butadien-styrene
AC	=	Polyacetal
EVA	=	Ethylene vinyl acetate
PA	=	Polyamide = Nylon
PC	=	Polycarbonate
PE	=	Polyethylene
PES	=	Polyester
PETP	=	Polyethylene terephthalate = Tetlon
PF	=	Phenol-formaldehyde
PP	=	Polypropyleneoride
PS	=	Polystyrene
PTFE	=	Polytetrafluoroethylene = Teflon
PUR	=	Polyurethane
PVC	=	Polyvinyl chloride

RUBBER

EPDM	=	EP rubber
NBR	=	Nitrile butadiene rubber
NR	=	Natural rubber
SI.R	=	Silicone rubber
SY.R	=	Synthetic rubber

STEEL

G.S	=	Galvanized steel
S.S	=	Stainless steel

AUXILIARY CODE

- Ex.1
- K-0
- Parts are the same as in the preceding year.
- "K" is the tenth in alphabetical order with "I" skipped.
So, "K" indicates "2000".
- Ex.2
- A-1
- "A" is the first in alphabetical order.
So, "A" indicates "2001".
- Ex.3
- A-2
- Each time a part is changed in a year, this number advances.

(Note)

--= Part deleted.
X = Part deleted and replaced by "O" part.
O = New part for "X" in the same auxiliary code.

FASTENER ABBREVIATION LIST

ST	Phillips Truss Head Machine Screw
SP	Phillips Pan Head Machine Screw
SF	Phillips Flat Head Machine Screw
SS	Phillips Pan Head Machine Screw with Split Lock Washer
SW	Phillips Pan Head Machine Screw with Split Lock Washer and Flat Washer
T1	Phillips Truss Head Tapping Screw (Correspond to Type A)
T2	Phillips Truss Head Tapping Screw (Correspond to Type B)
T3	Phillips Truss Head Tapping Screw (Correspond to Type C)
FT	Phillips Truss Head Tapping Screw (Special)
BH	Hexagon Head Bolt
BC	Socket Head Cap Screw
BS	Hexagon Bolt with Split Washer
BW	Hexagon Bolt with Split Washer and Flat Washer
BF	Hexagon Flange Bolt
BR	Cross-Recessed Hexagon Head Bolt
BRW	Cross-Recessed Hexagon Head Bolt with Split Lock Washer and Flat Washer
WL	Split Lock Washer
WT	External Tooth Washer
WF	Flat Washer
WS	Spring Washer
NH	Hexagon Nut
NF	Hexagon Flange Nut
NC	Hexagon Cap Nut
NS	Square Nut
NW	Wing Nut

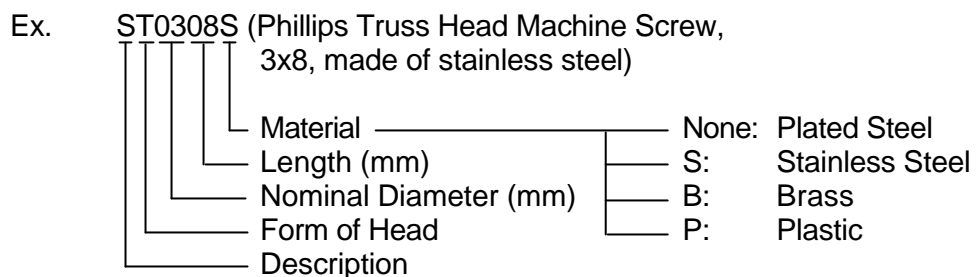

(Note) Second character is numerical except the list.

Ex. S1, S2, B3 etc.

And abbreviations and names are shown under the illustration.

HA

MODEL: ROX-20TA-U		TITLE: A. WATER ELECTROLYZER ASSY					
INDEX NO.	DESCRIPTION	MATERIAL OR MODEL NUMBER	PART NUMBER	REQ'D NUMBER			
				K-1 L-0	M-1		
B	WATER CIRCUIT	-	110414A01	1	1		
C	CONTROL BOX ASSY	-	110415A01	1	1		
1	DISPLAY PANEL	ACRYLIC PVC	225947G01	1	-		
		ABS	112027-01		1		
2	DISPLAY LABEL	PES FILM	345798-01	1	-		
			350909-01		1		
3	LAMP BOARD	R601CT001	452245-02	1	1		
4	RUBBER MASTIC TAPE	NO. 2228	110412-14	1	1		
5	ENCLOSURE	S.S	345730G01	1	1		
6	BASE	GS	345731G01	1	1		
7	REAR PANEL	G.S	345732-01	1	1		
8	"O" RING	P24	7616-P024	1	1		
9	"O" RING	P22	7616-P022	2	2		
10	CAP - BOLT	EPDM	449712-01	2	2		
11	BRACKET - CELL	G.S	458252G01	1	1		
12	TERMINAL BLOCK	TXM2003	456810-01	2	2		
13	TERMINAL BLOCK COVER	G.S	345733-01	1	1		
14	RUBBER LEG	C-30-RK-3215	418767-02	4	4		
15	DOOR	G.S	345734G01	1	1		
16	DOOR LOCK	C-88-8A	458003-01	1	1		
17	POWER SUPPLY CORD	KP-30B	421824-01	1	1		
		SJT#16AWG					
18	BUSHING	SR-6N3-4	420472-04	1	1		
19	GROMMET	BW-12-2	409655-10	1	1		
20	BLIND BUSHING	BB-0562	455601-02	2	2		
21	EDGE SADDLE	EDS-2	421552-02	1	1		
22	INSULATION (A)	C-4205, L=255	452227-01	2	2		
23	INSULATION (B)	C-4205, L=240	452227-02	2	2		
24	INSULATION (A) - DISPLAY PANEL	C-4305, L=40	452230-01	2	2		
25	INSULATION (B) - DISPLAY PANEL	C-4305, L=275	452230-02	1	1		
26	INSULATION (C) - DISPLAY PANEL	C-4305, L=125	458258-01	1	1		
27	INSULATION (D) - DISPLAY PANEL	C-4305, L=105	458258-02	1	1		
28	SURGE ABSORBER		436573-03	2	2		

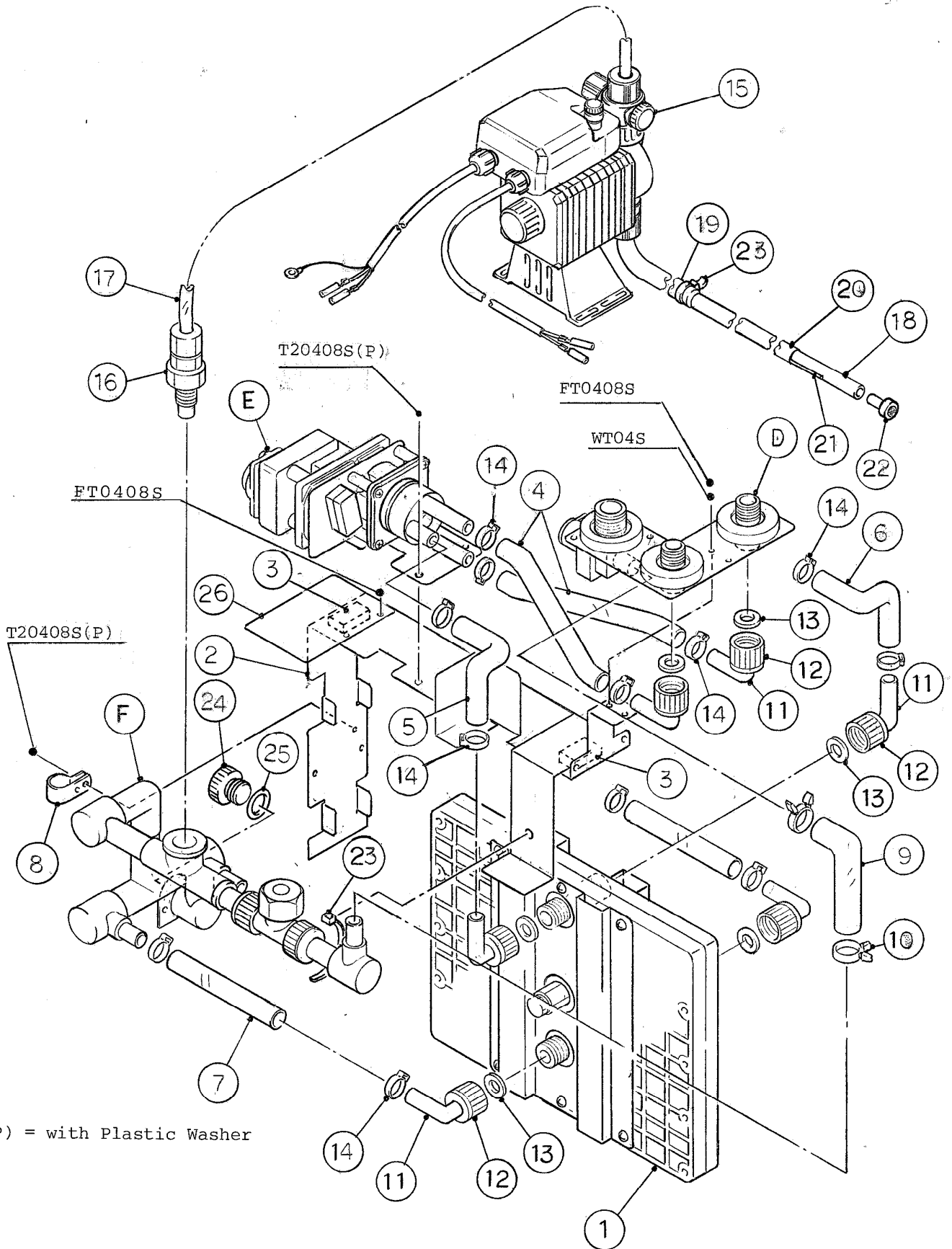

*(P) = with Plastic Washer

HA

MODEL: ROX-20TA-U		TITLE: B. WATER CIRCUIT					
INDEX NO.	DESCRIPTION	MATERIAL OR MODEL NUMBER	PART NUMBER	REQ'D NUMBER			
				K-1 L-0	M-1		
D	JOINT ASSY	-	345736A01	1	1		
E	FLOW SWITCHING VALVE ASSY	-	232532A01	1	1		
F	PLUMBING ASSY	-	458373A01	1	1		
1	ELECTROLYTIC CELL	(S-0957)	108397A01	1	1		
2	FRAME	G.S	345735G01	1	1		
3	CUSHION	EPDM	452229-01	2	2		
4	HOSE	PVC, L=168±2	110414-07	2	2		
5	OUTLET HOSE (L)	PVC	452181-01	1	1		
6	OUTLET HOSE (R)	PVC	452181-02	1	1		
7	HOSE	PVC, L=115	110414-13	2	2		
8	NYLON CLAMP	NK-12N	418814-12	1	1		
9	HOSE - WATER SUPPLY	EPDM	452177-01	1	1		
10	HOSE CLIP (B)	T19	423866-02	2	2		
11	ELBOW	PVC	452261-01	6	6		
12	UNION NUT	AC	448586-01	6	6		
13	GASKET		448570-01	6	6		
14	HOSE CLAMP	19.8-706R	450890-06	12	12		
15	METERING PUMP ASSY (ELECTROMAGNETIC METERING PUMP)	(EH-B10PC- 11UPR-PR1-27)	345737A01 (457649-01)	1	1		
16	HOSE - JOINT	15R-4	456815-01	1	1		
17	BRAIDED HOSE	PVC, L=420	110414-23	1	1		
18	BRAIDED HOSE	PVC, L=1650	110414-24	1	1		
19	PVC TUBE	PVC, L=1370	110414-25	1	1		
20	CONTRACTION TUBE	PVC, L=250	110414-26	1	1		
21	WATER LEVEL SENSOR	FDS-E020	458545F01	1	1		
22	SALT WATER FILTER		458374G01	1	1		
23	TIE	CV-150	7920-0003	2	2		
24	CAP - DRAIN	PVC	458375-01	1	1		
25	"O" RING	P20	7611-P020	1	1		
26	BARRIER - GEAR MOTOR		458253-01	1	1		

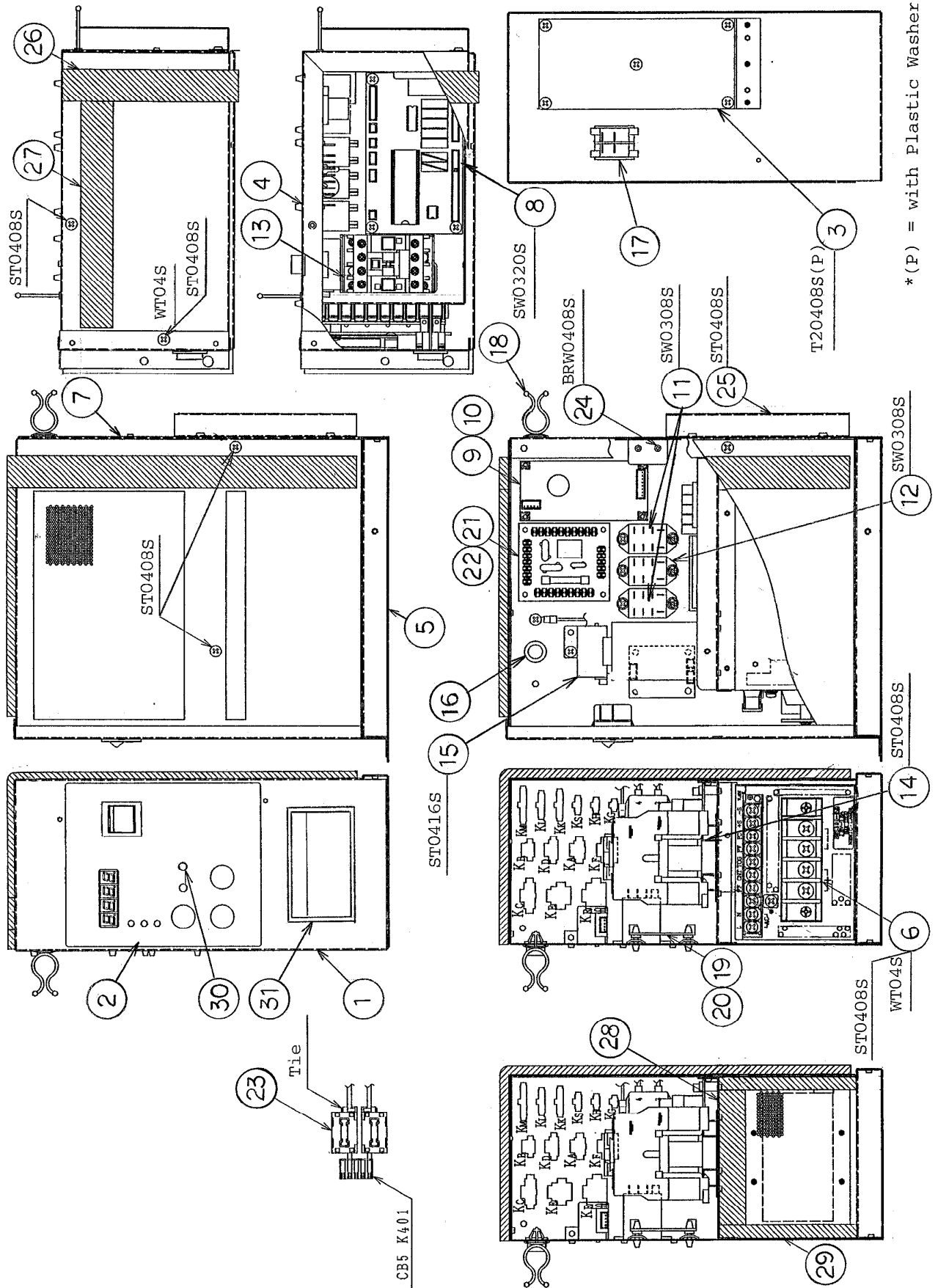

*(P) = with Plastic Washer

HA

MODEL: ROX-20TA-U				TITLE: C. CONTROL BOX ASSY			
INDEX NO.	DESCRIPTION	MATERIAL OR MODEL NUMBER	PART NUMBER	REQ'D NUMBER			
				K-1 L-0	M-1		
1	FRONT PANEL - CONTROL BOX	G.S	345739G01	1	1		
2	CONTROL BOX LABEL	PES FILM	344833-01	1	1		
3	OPERATION BOARD	R601CT002	452210-02	1	1		
4	CONTROL BOX	S.S	345740G01	1	1		
5	BASE - CONTROL BOX	G.S	340775-01	1	1		
6	DC POWER SUPPLY	EWS300- 18/HZCUL	458001-01	1	1		
7	COVER - CONTROL BOX	S.S	345722G01	1	1		
8	PROGRAMMABLE CONTROLLER	TC0C	452212-05	1	1		
9	SWITCHING REGULATOR	SLM012-02	452543-01	1	1		
10	BOARD SUPPORT	2451	449969-01	4	4		
11	RELAY	LY2F, AC120V	406132-07	2	2		
12	RELAY	LY2ZF, DC12V	457847-04	1	1		
13	MAGNETIC CONTACTOR	LC1D12008G7	456818-01	1	1		
14	BASE	GV2-AF02	453714-01	1	1		
15	CURRENT SENSOR	HC-TN020V2PP12	452215-01	1	1		
16	BUSHING	SB-562-7	420470-09	1	1		
17	POWER SWITCH	HL216A	456819-01	1	1		
18	CLAMP	NO. 4253	427902-05	2	2		
19	WATER LEVEL SENSOR BOARD	FDS-2001	458545-01	1	1		
20	BOARD SUPPORT	KGLS-4S	414929-02	4	4		
21	NOISE BOARD	RX801WA001a	454997-01	1	1		
22	BOARD SUPPORT	KGLS-4S	414929-02	4	4		
23	FERRITE CORE	ZCAT2032-0930	452682-01	2	2		
24	NOISE FILTER	ZGB2201-01U	457108-01	1	1		
25	AIR GUIDE	S.S	457228-01	1	1		
26	INSULATION (B) - CONTROL BOX	C-4205, L=390	452611-02	1	1		
27	INSULATION (C) - CONTROL BOX	C-4205, L=175	457225-01	1	1		
28	INSULATION (A) - DC POWER SUPPLY	C-4205, L=105	457226-01	1	1		
29	INSULATION (B) - DC POWER SUPPLY	C-4205, L=105	457227-01	2	2		
30	HOLE PLUG	9N6	428819-02	2	2		

