

# Wendy's GST-2V Vertical Toaster

**Manufacturing Numbers:**

9210980

## TABLE OF CONTENTS

<b>Table of Contents</b>	<b>2</b>
<b>Warranty Information</b>	<b>2</b>
<b>Service/Technical Assistance</b>	<b>2</b>
<b>Important Safety Information</b>	<b>3</b>
<b>Warnings</b>	<b>3</b>
<b>Specifications</b>	<b>4</b>
<b>Installation</b>	<b>5</b>
<b>Operation</b>	<b>5</b>
Light/Dark Adjustments	5
<b>User Mode</b>	<b>6</b>
<b>Manager Mode</b>	<b>6</b>
<b>Safety Features</b>	<b>6</b>
Hi-Limit Control	6
Purging buns from Toaster	6
Fault Messages	6
Error Codes	6
<b>Daily Cleaning</b>	<b>7</b>
Clean the Toaster and Belt Wraps	7
<b>Quarterly Cleaning</b>	<b>9</b>
Remove Belt Wraps and Clean Rollers	9
Install Belt Wraps	9
Clean Cooling Fan and Electrical Housing	10
<b>Troubleshooting</b>	<b>11</b>
<b>Wiring Diagram</b>	<b>12</b>
<b>Replacement PArts</b>	<b>13</b>
<b>Limited Warranty</b>	<b>16</b>

## WARRANTY INFORMATION

Please read the full text of the Limited Warranty in this manual.

If the unit arrives damaged, contact the carrier immediately and file a damage claim with them. Save all packing materials when filing a claim. Freight damage claims are the responsibility of the purchaser and are not covered under warranty.

The warranty does not extend to:

- Damages caused in shipment or damage as result of improper use.
- Installation of electrical service.
- Normal maintenance as outlined in this manual.
- Malfunction resulting from improper maintenance.
- Damage caused by abuse or careless handling.
- Damage from moisture into electrical components.
- Damage from tampering with, removal of, or changing any preset control or safety device.

## SERVICE/TECHNICAL ASSISTANCE

If you experience any problems with the installation or operation of your unit, contact Antunes Technical Service at +1-877-392-7854.

Fill in the information below and have it handy when calling for assistance. The serial number is on the specification plate located on Use only genuine Antunes replacement parts in this unit. Use of replacement parts other than those supplied by the manufacturer will void the warranty.

\_\_\_\_\_  
Purchased From

\_\_\_\_\_  
Date of Purchase

\_\_\_\_\_  
Model Number

\_\_\_\_\_  
Serial Number

\_\_\_\_\_  
Manufacturing Number

### IMPORTANT

A.J. Antunes & Co. reserves the right to change specifications and product design without notice. Such revisions do not entitle the buyer to corresponding changes, improvements, additions or replacements for previously purchased equipment.

### IMPORTANT

Keep these instructions for future reference. If the unit changes ownership, be sure this manual accompanies the equipment.

## IMPORTANT SAFETY INFORMATION

Use the following guidelines for safe operation of the unit.

- Read all instructions before using equipment.
- For your safety, the equipment is furnished with a properly grounded cord connector. Do not attempt to defeat the grounded connector.
- Install or locate the equipment only for its intended use as described in this manual. Do not use corrosive chemicals in this equipment.
- Do not operate this equipment if it has a damaged cord or plug, if it is not working properly, or if it has been damaged or dropped.
- This equipment should be serviced by qualified personnel only. Contact your nearest Authorized Service Agency for adjustment or repair.
- Do not block or cover any openings on the unit.
- Do not immerse cord or plug in water.
- Keep cord away from heated surfaces.
- Do not allow cord to hang over edge of table or counter.
- Turn the power off, unplug the power cord, and allow unit to cool down before performing any service or maintenance on the unit.

**NOTE:** **Turning off the power switch does NOT turn off all power to the unit.**

- The procedures in this manual may include the use of chemical products. These chemical products will be highlighted with bold face letters followed by the abbreviated HCS (Hazard Communication Standard). See Hazard Communication Standard manual for the appropriated Material Safety Data Sheets (MSDS).
- The equipment should be grounded according to local electrical codes to prevent the possibility of electrical shock. It requires a grounded receptacle with separate electrical lines, protected by fuses or circuit breaker of the proper rating.
- All electrical connections must be in accordance with local electrical codes and any other applicable codes.
- Do not clean this appliance with a water jet.

## WARNINGS

Be advised of the following warnings when operating and performing maintenance on this unit.

- If the supply cord is damaged, it must be replaced by the manufacturer or its service agent or a similarly qualified person in order to avoid a hazard.
- Do not modify the power supply cord plug. If it does not fit the outlet, have a proper outlet installed by a qualified electrician.
- Do not use an extension cord with this appliance.
- Electrical ground is required on this appliance.
- Check with a qualified electrician if you are in doubt as to whether the appliance is properly grounded.
- When using a chemical cleaner, be sure it is safe to use on cast aluminum. Observe all precautions and warnings on product label.
- Inspection, testing, and repair of electrical equipment should only be performed by qualified service personnel.
- Do not use a sanitizing solution or abrasive materials. These may cause damage to the stainless steel finish.
- Chlorides or phosphates in cleaning agents (e.g. bleach, sanitizers, degreasers or detergents) could cause permanent damage to stainless steel equipment. The damage is usually in the form of discoloration, dulling of metal surface finish, pits, voids, holes, or cracks. This damage is permanent and not covered by warranty.
- The following tips will help in the maintenance of stainless steel equipment:
  - Always use soft, damp cloth for cleaning, rinse with clear water and wipe dry. When required, always rub in direction of metal polish lines.
  - Routine cleaning should be done daily with soap, ammonia detergent, and water.
  - Stains and spots should be sponged using a vinegar solution.
  - Finger marks and smears should be rubbed off using soap and water.
  - Hard water spots should be removed using a vinegar solution.

# SPECIFICATIONS

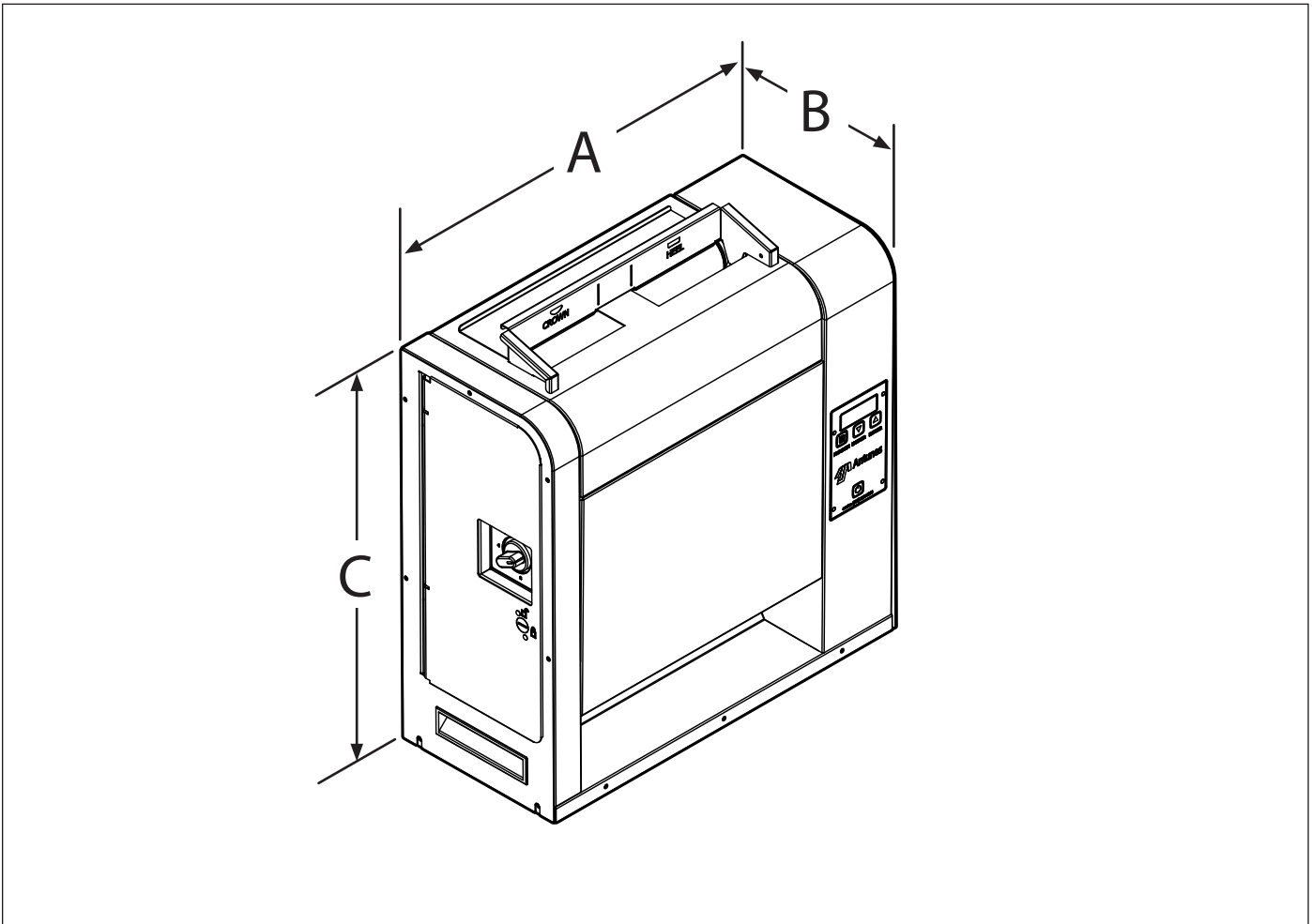

Model & Mfg. No.	Width (A)	Depth (B)	Height (C)
GST-2V 9210980	20" (508 mm)	9" (227 mm)	21 5/8" (549 mm)

Model & Mfg. No.	Volts	Watts	Hertz	Plug Description
GST-2V 9210980	208	2000	60	NEMA 6-20P 20 Amp, 250 Volt Right Angle

## INSTALLATION

1. Remove unit and all packing materials from shipping carton.

**NOTE:** If any parts are missing or damaged, contact Antunes Customer Service IMMEDIATELY at +1-877-392-7856 (toll free).

2. Remove all packing materials and protective coverings from the unit.
3. Wipe the entire exterior of the toaster and the accessories mentioned above with a hot damp cloth. Allow to air dry.

**NOTE:** Do NOT use a dripping wet cloth. Wring out before use.

4. Attach the top cover and bun feeder (Figure 3).
5. Set the Compression Knobs to the desired setting (Figure 1). The recommended Compression Settings are:  
**CROWN - #4**  
**HEEL - #3**
6. Plug the power cord into the appropriate power outlet. Refer to the specification plate for the proper voltage.

When placing the toaster into service, pay attention to the following guidelines.

- Make sure the power switch is off and the unit is at room temperature before plugging in the power cord.
- Do not block or cover any openings on the unit.
- Do not immerse the power cord or plug in water.
- Keep the power cord away from heated surfaces.
- Do not allow the power cord to hang over edge of table or counter.
- Place the unit on a sturdy, level table or other work surface.
- Turn the power switch to off (if it is set to on).
- Ensure the line voltage corresponds to the stated voltage on the specification label and power cord warning tag.

## OPERATION

1. Press and release the **Power** button to turn the toaster on. Allow the toaster to warm up until **USE** appears in the display. See Figure 2.
2. Set the Compression Knobs to the desired setting. The recommended Compression Settings are:  
**CROWN - #4**  
**HEEL - #3**
3. Insert product into the appropriate lane on the Bun Feeder according to Bun Feeder labels. Insert buns with the cut side towards the inside of the toaster.
4. Finished product drops onto the heated bun landing zone.

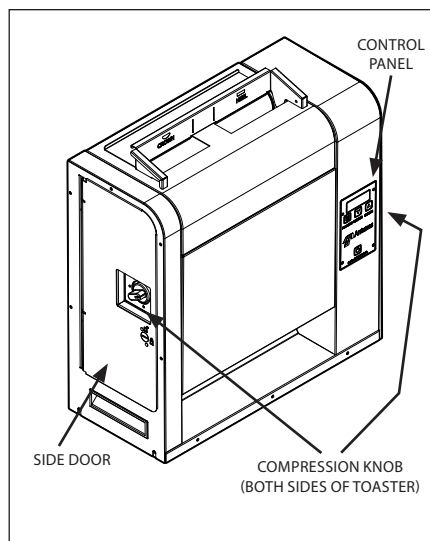

Figure 1. GST-2V Toaster

## Light/Dark Adjustments

The light/dark value (Figure 2) can be adjusted when the unit is displaying **USE**. To adjust the light/dark value:

1. Press the **LIGHTER** or **DARKER** button. The display changes to show the current light/dark value.

**NOTE:** The default setting is **d0**.

2. Press the **LIGHTER** or **DARKER** buttons to change the light/dark value. The adjustment range is L1-L9 and d0-d9. L9 is the lightest, d0 is the middle, and d9 is the darkest setting.
3. To save the light/dark value, wait 5 seconds until **USE** appears in the display.

**NOTE:** Adjusting the light/dark value changes the speed of the conveyors - it does NOT change the temperature. The light/dark value resets to the default value of d0 when the unit is turned off.

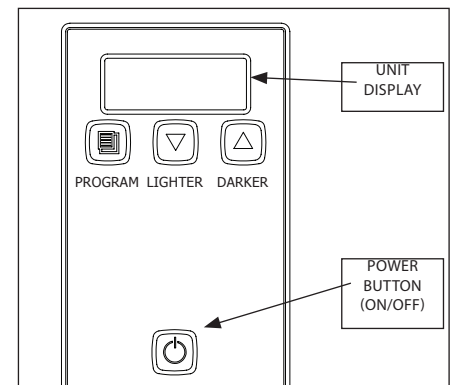

Figure 2. - GST-2V Control Panel

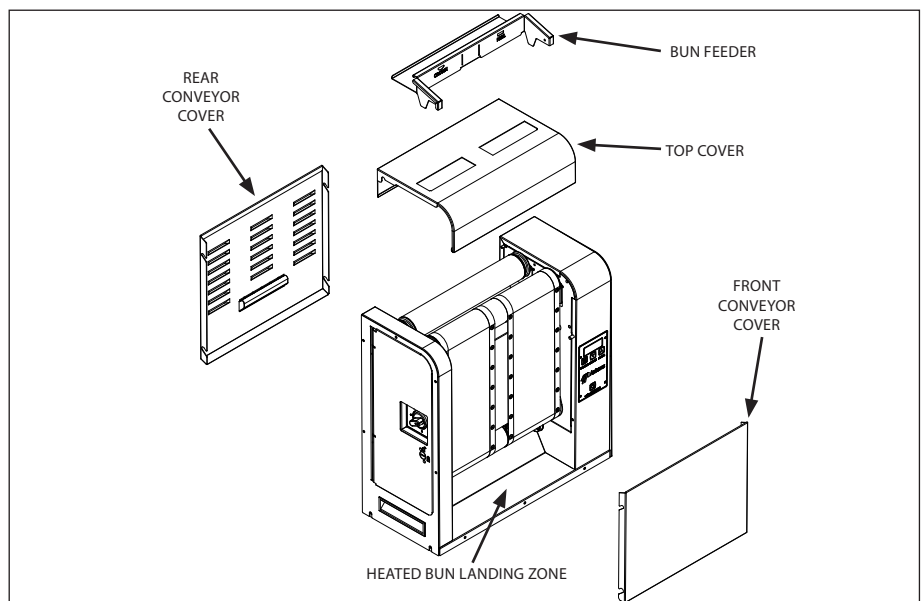

Figure 3. Components

## USER MODE

User Mode allows an operator to view the toaster settings but does not permit any adjustments. User Mode is accessed via the Control Panel (Figure 4).

1. Press and hold the **PROGRAM** button for 5 seconds. After 5 seconds, the unit displays the actual temperature of the Platen.
2. Press the **LIGHTER** button to toggle between the Setpoint and actual temperature of the Platen heater.
3. Press the **PROGRAM** button to proceed to the Motor Menu. The display shows pass through time in seconds.
4. Press the **LIGHTER** button to toggle between the Setpoint and actual speed of the Motor.

**NOTE:** The unit exits User Mode after 5 seconds of keypad inactivity.

## MANAGER MODE

Manager Mode, accessed via the Control Panel (Figure 4), allows an operator to view and adjust the following settings:

- Heater Temperature
- Pass Through Time
- Temperature Units (Celsius or Fahrenheit)

Manager Mode also allows an operator to view (but not adjust) the Ambient Temperature of the Control Compartment.

1. Press and release the **Power** button to turn the toaster off.
2. Press and release the **Power** button while holding the **PROGRAM** button. Continue holding the button until "ENA" appears on the display (after approximately 10 seconds).
3. Release the **PROGRAM** button. The display shows the Heater Setpoint Temperature.
4. To adjust the Heater Setpoint Temperature, press the **LIGHTER** or **DARKER** buttons to reach the desired temperature.

**NOTE:** The recommended temperature setting for the Platen is 535 °F (279 °C).

5. Press the **PROGRAM** button to proceed to the Pass Through Time.
6. Adjust the Motor Speed Setpoint by pressing the **LIGHTER** or **DARKER** buttons change the pass through time in 0.5 second increments.

**NOTE:** The Motor Speed is adjustable from 1-100. The recommended setting is 17.0 seconds.

7. Press the **PROGRAM** button to proceed to the Temperature Units.
8. To change the Temperatures units from Fahrenheit or Celsius, press the **LIGHTER** or **DARKER** buttons.
9. Press and hold the **PROGRAM** button to save any changes.

**NOTE:** The unit exits Manager Mode after 30 seconds of keypad inactivity.

## SAFETY FEATURES

### Hi-Limit Control

A Hi-Limit Control turns off electrical power to the heaters and control circuits and displays HL if the unit overheats. To reset the control:

1. Let the unit cool for 15 minutes.
2. Locate the Hi-Limit Controls on the rear of the unit. Remove the black protective cap.
3. Press and release the button. Reinstall the protective cap.

**NOTE:** If the Hi-Limit Control requires continuous resetting, contact your Authorized Service Agency.

### Purging buns from Toaster

If buns get stuck in the toaster, press and hold both the **UP** and **DOWN** arrow buttons to increase the belt speed until the buns are purged from the toaster.

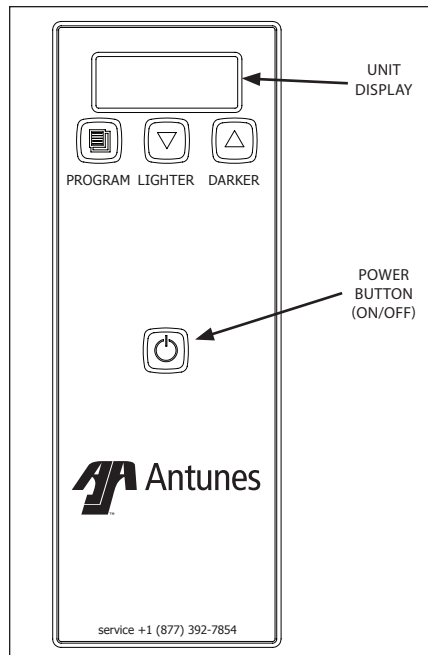

Figure 4. - GST-2V Control Panel

## Fault Messages

The unit displays fault messages when there is a problem with the unit.

- **"Hi"** flashes if the Platen Heater temperature is 30 °F more than the Setpoint or if the Platen Thermocouple is disconnected or open.
- **"CHEC"** flashes when the control compartment ambient temperature is more than 150 °F (66 °C). All heaters shut off. The unit will not restart until the control compartment ambient temperature falls below 140 °F (60 °C).
- **"PO"** flashes if the incoming power drops below 190 volts. The toaster shuts down.
- **"StoP"** flashes when the motor has stopped for seven continuous seconds.
- **"SpEd"** flashes when the motor speed drops 25% below the Setpoint for 30 continuous seconds.
- **"HL"** The Hi-Limit has tripped and needs to be reset.

## Error Codes

If any of the following Error Codes appear, press and release the Power button to turn the toaster off. Allow the unit to cool. Then press and release the Power button to turn the toaster on. If the error repeats, contact Antunes Technical Service for assistance.

**NOTE:** ERR #1, 2, 3, 5, 6, 7, and 30 to 51: Internal Error. Cycle the power. If error persists, replace the board.

Error	Description
ERR 8	Motor running when it should be off.
ERR 10	High Internal Temperature.
ERR 11	Shorted Thermocouple.
ERR 12	Open Thermocouple.
ERR 13	Slow warm up.
ERR 14	Shorted Solid State Relay (SSR).

## DAILY CLEANING

### Clean the Toaster and Belt Wraps

1. Press the Power button to turn the unit off. The unit enters a cool down mode and the belts continue to turn. The toaster automatically shuts down when complete.

**NOTE:** You do not need to wait for the unit to shut down to perform these steps.

2. Wearing Heat-resistant gloves, Remove the bun feeder, top cover, and the front and rear conveyor covers (Figure 5).
3. See Figures 6 - 9. Inspect the front belt for any tears, discoloration, or damage to the Belt Wrap snaps. Replace any damaged Belt Wrap as needed. With proper maintenance the Crown and Main Belt Wraps can last six months or longer.
4. If the front belt is in good condition, spray a clean, sanitizer-soaked towel Sink Detergent solution. Wipe the front belt clean. Rinse the front belt with a separate clean, sanitizer-soaked towel. Allow to air dry.

**NOTE:** The belt rollers continue turning while in cool-down mode. This allows you to clean the entire belt. Only clean the belt where it is in front of the Backing Plate - between the support rods - to avoid causing damage to the belt. Repeat this step several times if there is heavy carbon buildup on the conveyor belt.

5. See Figures 6 - 9. Inspect the rear belts for any tears, discoloration, or damage to the Belt Wrap snaps. Replace any damaged Belt Wrap as needed. With proper maintenance the Crown and Main Belt Wraps can last six months or longer.
6. If the rear belt is in good condition, spray a clean, sanitizer-soaked towel with Sink Detergent solution. Wipe the rear belt clean. Rinse the rear belt with a separate clean, sanitizer-soaked towel. Allow to air dry.

**NOTE:** The belt rollers continue turning while in cool-down mode. This allows you to the entire belt.

**NOTE:** Only clean the belt where it is in front of the Backing Plate to avoid causing damage to the belt.

7. Wash, rinse, and sanitize the bun feeder and top cover in the three-compartment sink.
8. Wash, rinse, and sanitize the front and rear conveyor covers in the three-compartment sink.
9. Reinstall the clean front and rear conveyor covers, top cover, and bun feeder (Figure 5).
10. Clean the outside surfaces of the toaster with clean, sanitizer-soaked towel sprayed with Heavy Duty Degreaser Solution. Rinse with a clean, sanitizer soaked towel and allow to air dry.
11. Turn the unit on.
12. Place all used towels into the soiled towel bucket.

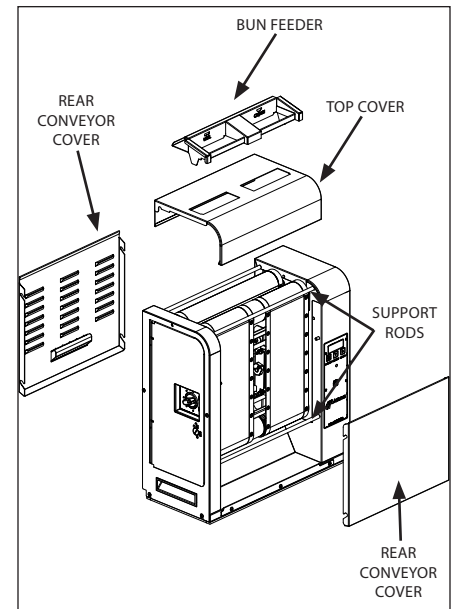

Figure 5. - Removing Components

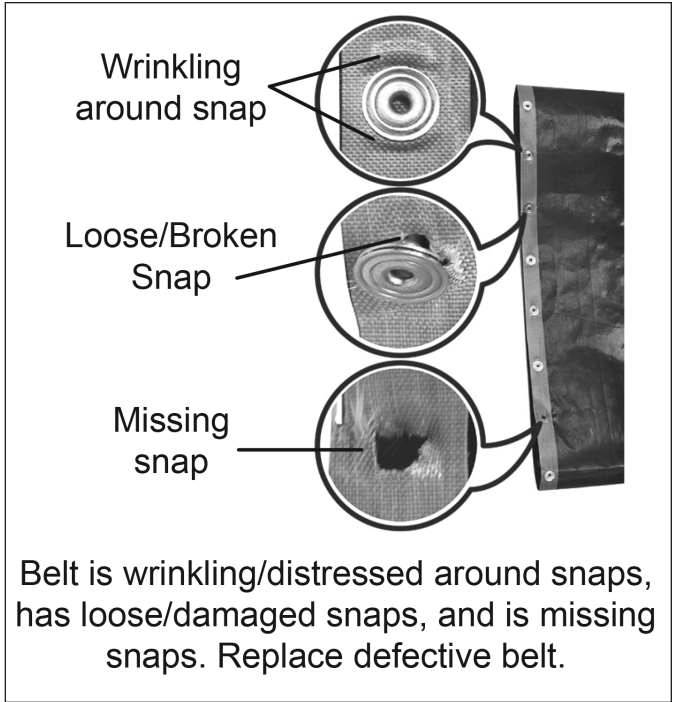

Figure 6. - Examples of Damaged Belt Wraps



**BELT IS TORN AND FOLDED.  
REPLACE BELT.**

Figure 7. Example of Damaged Belt



Belt is wrinkling/distressed around snaps, has loose/damaged snaps, and is missing snaps. Replace defective belt.

Figure 9. Example of Damaged Belt



**BELT IS MISSING SNAPS  
AND IS DAMAGED. REPLACE BELT.**

Figure 8. Example of Damaged Belt

## QUARTERLY CLEANING

### Remove Belt Wraps and Clean Rollers

1. Press the **Power** button to turn the unit off. The unit enters a cool down mode and the belts continue to turn. The toaster automatically shuts down when complete.

**NOTE:** You do not need to wait for the unit to shut down to perform these steps.

2. Wearing Heat-resistant gloves, Remove the bun feeder, top cover, and the front and rear conveyor covers (Figure 10).

**NOTE:** Reposition the toaster as needed to perform these steps.

3. Set both bun compression knobs to 7.
4. Unlock the lock on the left side panel with a flathead screwdriver and open the panel (Figure 10).
5. Push down on the front and rear belt rollers and move them away from the center of the toaster. Use both hands. This removes tension and locks the rollers in place.
6. Lift the upper belt frame lock. Then rotate down so it rests on the compression shaft (Figure 11).
7. Pull down the lower belt frame lock. This provides access to the front and rear belt rollers and belts (Figure 11).
8. Carefully remove the belts from the toaster (Figure 12).
9. Wipe all four rollers and backing plates with a clean, sanitizer-soaked towel. Make sure to remove all debris from the rollers and the backing plates so they are as clean as possible.
10. Use a dry cloth towel or nylon-bristled brush to remove all debris from both side compartments, inside of the toaster, and underneath the rollers.

### Install Belt Wraps

1. If you are installing the existing belt wraps, inspect the belts. Replace belt wraps if worn or damaged. If the belt wraps are in good condition put them back on the toaster.
2. For new or existing belts, wipe both sides of the belts with a clean, sanitizer-soaked towel. Allow to air dry.
3. Slide the belts gently over the appropriate top and bottom roller. Make sure the belt lines up properly on the rollers. The snaps on the belts should face the inside of the roller (Figure 12).
4. Lift up the front and rear belt roller. Use both hands and slide them towards the middle of the toaster until they snap into place. This restores tension and lock them in place.
5. Lift the lower conveyor lock to lock the rollers into place (Figure 11).

**NOTE:** Lift up on the camshaft of the rear conveyor roller while lifting the conveyor lock.

6. Lift the upper belt frame lock and lock in place on the conveyor assembly (Figure 11)
7. Set the compression knobs to their original settings. The recommended Compression Settings are:  
**CROWN - #4**  
**HEEL - #3**
8. Close the side panel and lock the lock using a flathead screwdriver on the side panel (Figure 10).
9. Re-install the front and rear conveyor covers, top cover, and bun feeder (Figure 10).
10. Return the unit to use.

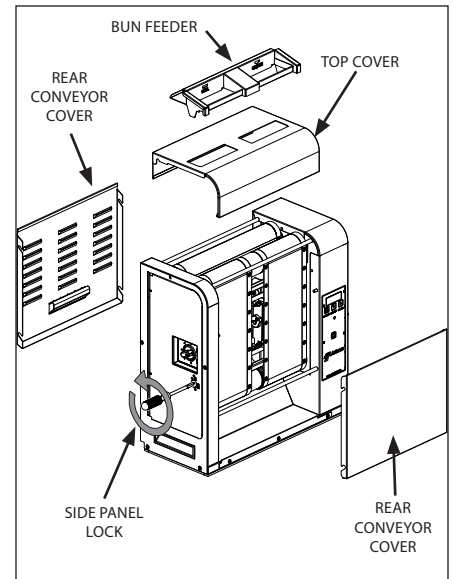

Figure 10. Removing Components

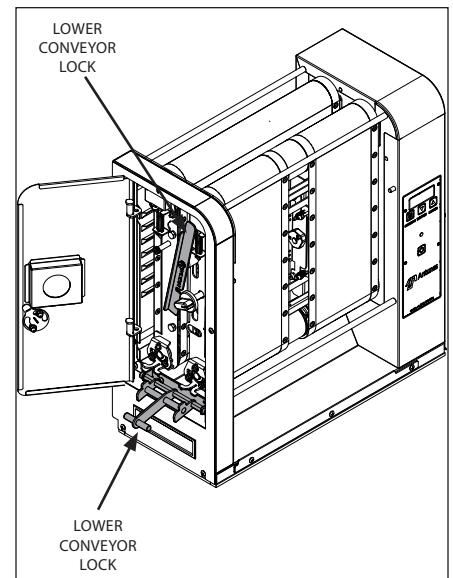

Figure 11. Conveyor Locks

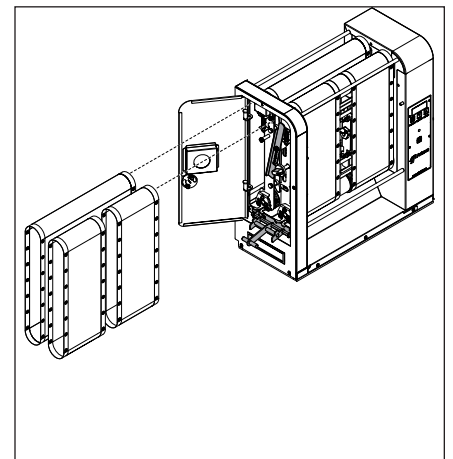

Figure 12. Belt Wraps

## Clean Cooling Fan and Electrical Housing

1. Press the Power button to turn the unit off. The unit enters a cool down mode and the belts continue to turn. The toaster automatically shuts down when complete. Wait for the unit to shut down.

**NOTE:** For this step, you must wait until the toaster shuts down after the cool down period.

2. Refer to Figure 13. Loosen but do not remove the bottom screws indicated. Then, remove the other indicated screws.
3. Remove any debris or dust from the cooling fan with a small brush. Wipe away any debris with a clean, dry towel.
4. Inspect the electrical compartment for crumbs and debris. Clean out all crumbs and debris using a clean, dry towel or nylon bristled brush. Be careful not to disrupt any of the electrical wiring.
5. Slowly close the control housing cover. Reconnect with the screws.
6. Remove the screws from the bottom plate on the rear of the unit and slowly lower the cover.
7. Remove any debris or dust from the cooling fan with a small brush. Wipe away any debris with a clean, dry towel. Inspect the electrical compartment for crumbs and debris. Clean out the crumbs and debris using a clean, dry towel or nylon bristled brush. Be careful not to disrupt any of the electrical wiring.
8. Close the bottom plate and re-install the screws.
9. Reattach the bun feeder. Plug in the power cord, turn the power on, and test the unit before returning it to service.

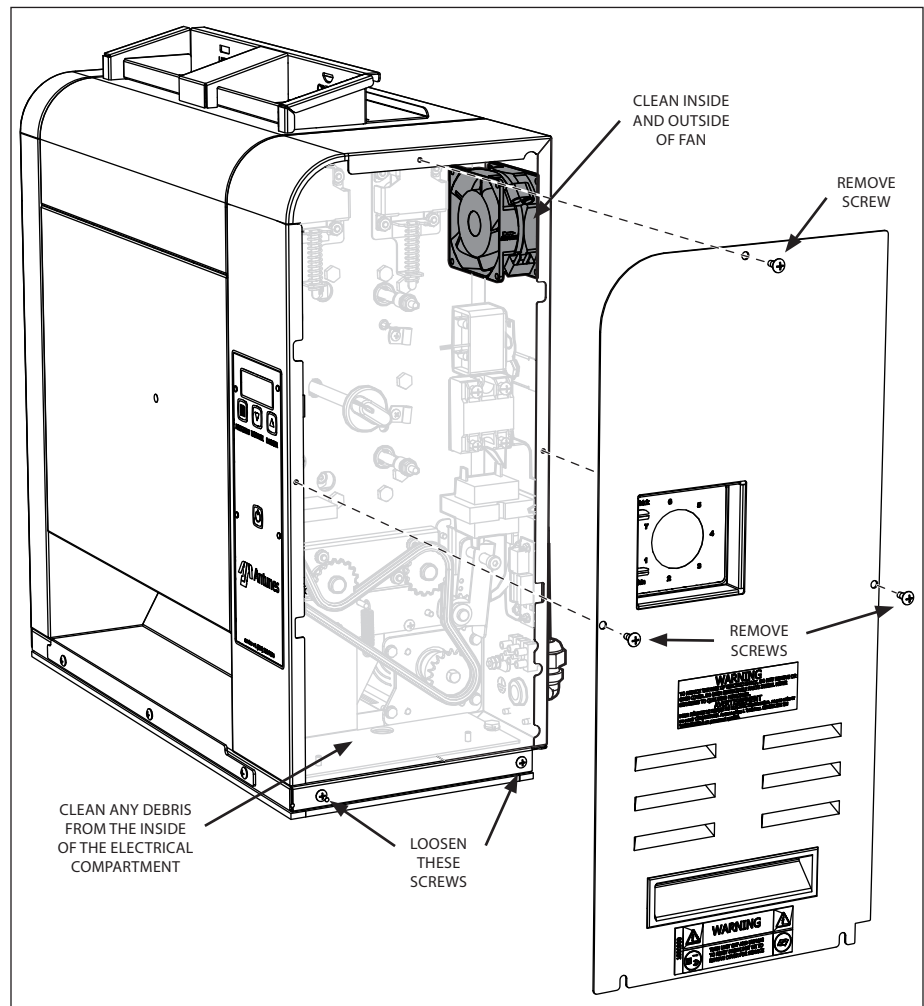

Figure 13. Cleaning Fan and Electrical Compartment

# TROUBLESHOOTING

Problem	Possible Cause	Corrective Action
Control Display flashes <b>PLt</b> continuously. Buns not toasting properly.	Platen temperature is below 545 °F (285 °C).	Allow the unit to warm up for 30 minutes and then recheck. If the Control Display still flashes <b>PLt</b> , contact your maintenance person or Antunes Technical Service for service.
	Failed Platen Thermocouple.	Contact your maintenance person or Antunes Technical Service for service.
	Failed Control Board	
Control Display flashes <b>Er 10</b> continuously.	Control Compartment ambient temperature is above 150 °F (66 °C)	Verify side vents on toaster are unblocked and not near other heating appliances. If problem persists, contact your maintenance person or Antunes Technical Service for service.
	Failed Cooling Fan.	
	Failed Control Board	
Control Display Flashes <b>SSr</b> continuously. Buns Burn.	Failed Front Platen Solid State Relay.	Contact your maintenance person or Antunes Technical Service for service.
	Failed Control Board.	
	Failed Front Platen Thermocouple.	
Control Display flashes <b>Er 12</b> continuously. Buns not toasting properly.	Loose Platen Thermocouple connection on Control Board or the Platen Thermocouple is open.	Re-secure the Platen Thermocouple to the Control Board. If the Control Display still reads <b>Er 11</b> , check the Thermocouple for continuity. Contact your maintenance person or Antunes Technical Service for service.
	Failed Control Board.	
Control Display flashes <b>Er 11</b> continuously. Buns not toasting properly.	Shorted Platen Thermocouple to ground.	Disconnect and re-secure the Platen Thermocouple connection to the Control Board. If the Control Display still reads <b>Er 10</b> , check the Thermocouple for continuity. Contact your maintenance person or Antunes Technical Service for service.
	Failed Control Board	
Control Display flashes <b>StoP</b> .	Mechanical bind in one or both conveyors.	Enter "user mode" to check the motor speed. Check both conveyors for mechanical binds. Test the motor. Replace necessary parts. Contact your maintenance person or Antunes Technical Service for service.
	Worn or damaged Ball Bearings.	
	Drive chain or sprockets damaged.	
	Failed Motor.	
	Failed Control Board.	
Control Display flashes <b>SpEd</b> .	Mechanical bind in one or both conveyors.	Enter "user mode" to check motor speed. Check both conveyors for mechanical binds. Replace necessary parts. Contact your maintenance person or Antunes Technical Service for service.
	Worn or damaged Ball Bearings.	
	Conveyor chains loose or damaged.	
	Drive chain or sprockets damaged.	
Crowns and/or Heels must be forced into the toaster. Buns sticking and burning.	Belts are dirty, worn, or damaged (replace every 2-4 months).	Clean or replace Belts as described in the Maintenance section of this manual.
	Buns do not meet specifications.	Contact your bun supplier.
Buns not toasting adequately.	Compression Setting is incorrect.	Use the recommended setting of 4 for Crowns and 3 for Heels.
	One of the Conveyor shafts is stuck in the lower lock position.	Inspect positions of the shafts as described in the Maintenance section of this manual.
	Either both Upper/Lower Conveyor locks are not properly locked in place.	Inspect the proper position of the locks as described in the Maintenance section of this manual.
	Buns do not meet specifications.	Contact your bun supplier.
	Motor settings are incorrect.	Verify that the motor setting is set to 4000 as described in the Programming section of this Manual.
Compression side door will not close.	Either both Upper/Lower Conveyor Locks are not properly locked in place.	Inspect the proper position of the locks as described in the Maintenance section of this manual.
	The lock on the Compression Side Door is in the locked position when trying to close the door.	Turn the lock to the unlocked position before closing the door.
Fan is making an unusual sound.	Failed Cooling Fan.	Verify vents on toaster are unblocked and not near other heating appliances. Clean fans as described in the Maintenance section of this manual. If problem persists, contact your maintenance person or Antunes Technical Service for service.
	Cooling Fan is dirty and needs to be cleaned.	
Control Display flashes <b>HL</b> continuously. Buns are not toasting properly.	Hi-Limit Control is tripped.	Allow the unit to cool and reset the Hi-Limit Control. If it trips again, contact your maintenance person or Antunes Technical Service for service.

Problem	Possible Cause	Corrective Action
Control Display is blank.	Power Cord is not plugged in.	Plug the Power Cord into the appropriate outlet. Turn the toaster on. If the Control Display is still blank, contact your maintenance person or Antunes Technical Service for service.
	Circuit Breakers turned off or tripped. Damaged electrical outlet, plug, or Power Cord. Power Switch damaged.	Reset Circuit Breakers. If they trip again, check the Power Cord, Plug, and outlet for damage. Contact your maintenance person, Antunes Technical Service, and Electrician for service.
	Faulty Transformer.	Replace Transformer.
Conveyors not turning.	Belt is damaged.	Replace Belts
	Motor Drive Chain is detached from sprockets.	Reinstall the Drive Chain.
	Failed Drive Motor.	Contact your maintenance person or Antunes Technical Service for service.
Belts are ripped or torn.	Rollers or Heater Cover Plates are dirty and need to be cleaned.	Clean Rollers and Heater Cover Plates as outlined in the Maintenance section of this manual.
	Belts are not installed properly.	Install Belts correctly as outlined in the Maintenance section of this manual.
	Roller(s) in the incorrect locked position during operation.	Unlock Rollers to operational position.
	Front Conveyor Lock is disengaged.	Engage and lock the Front Conveyor Lock.

## WIRING DIAGRAM

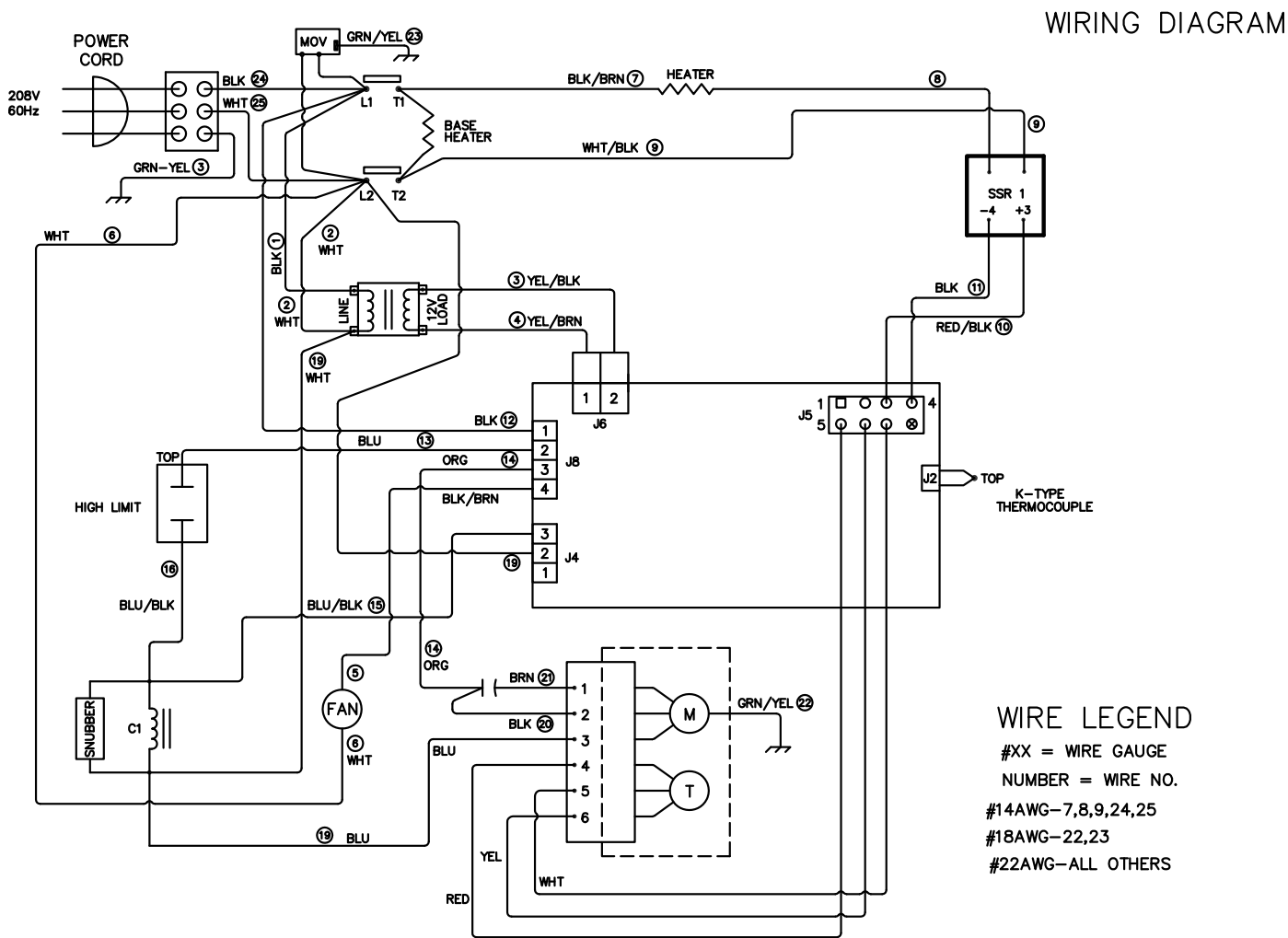

# REPLACEMENT PARTS

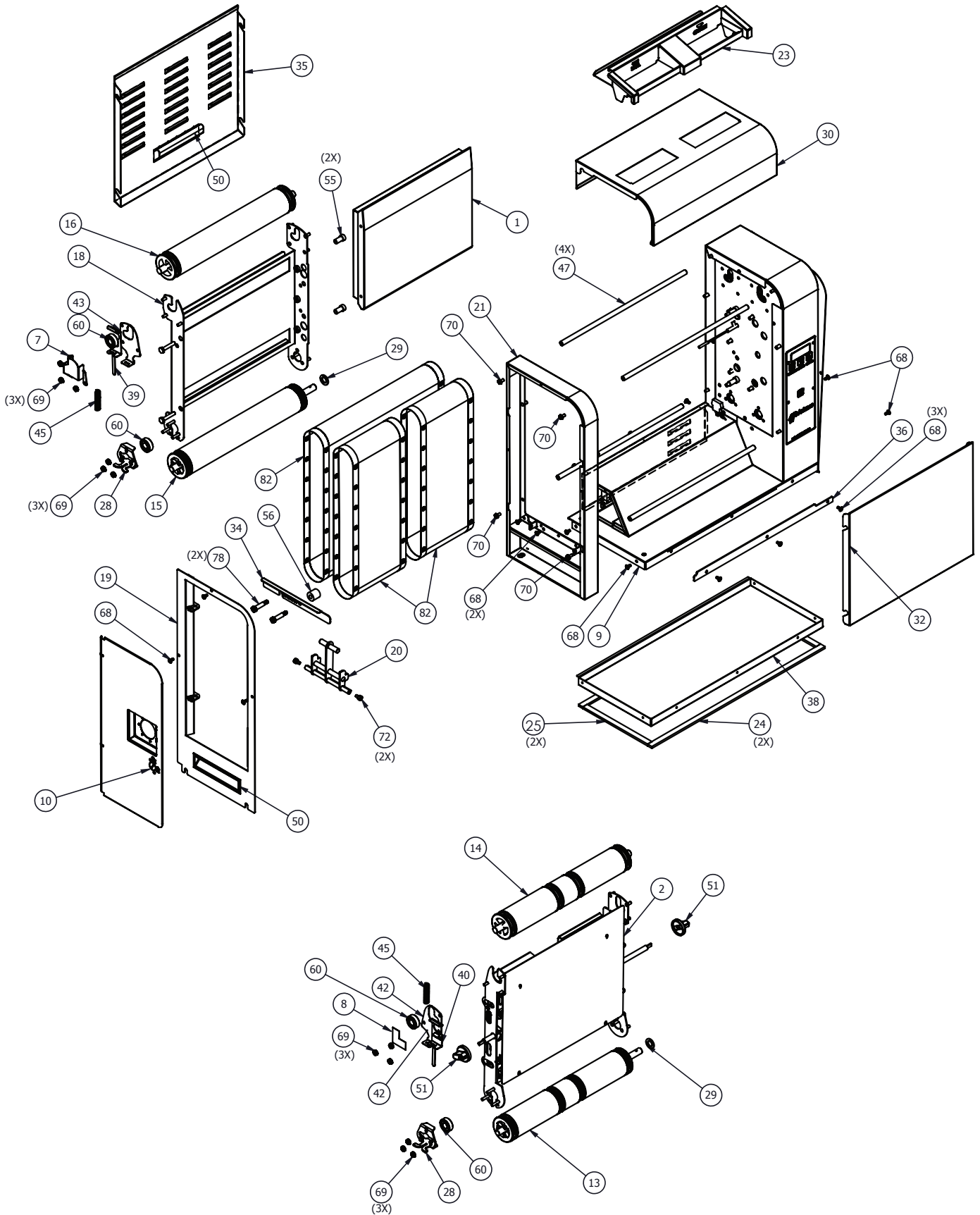



ITEM NO.	PART NUMBER	DESCRIPTION	QTY.
1	0013024	PLATEN ASSY	1
2	0013363	ADJUSTABLE FRAME ASSEMBLY	1
3	0013368	CONTACTOR MOUNT ASSY	1
4	0013427	MOTOR ASSY	1
5	0013476	ASSEMBLY, BEARING RETAINER	1
6	0013644	HEAT SINK ASSY SSR	1
7	0013697	BEARING RETAINER ASSY LH	1
8	0013698	BEARING ASSY RH	1
9	0013703	BASE ASSEMBLY	1
10	0013704	DOOR ASSEMBLY	1
11	0013705	ELECTRICAL PANEL ASSY.	1
12	0013706	ASSEMBLY, DRIVE CHAIN TENSIONER	1
13	0021953	DRIVE ROLLER 2 LANE	1
14	0021954	IDLER ROLLER 2 LANE	1
15	0021976	DRIVE ROLLER MAIN PLATEN	1
16	0021977	IDLER ROLLER MAIN PLATEN	1
17	0021983	WELDMENT , THERMOCOUPLE TUBE	1
18	0022353	PLATEN FRAME WELDMENT	1
19	0022635	END HOUSING PANEL WELDMENT	1
20	0022637	LOCK BAR MOUNT WELDMENT	1
21	0022801	END HOUSING WELDMENT	1
22	0022863	CONTROL HOUSING WLDMT	1
23	0022938	FEEDER WELMT	1
24	0200343	GASKET 20"	2
25	0200401	GASKET, 7.5" LG	2
26	0400119	BUSHING, SHORTY	2
27	0504083	GUARD, HI-LIMIT	1
28	0506167	BEARING BRACKET	2
29	0507140	SPACER	2
30	0507637	CONTROL HOUSING FRONT	1
31	0507638	MOTOR COVER	1
32	0507647	FRONT COVER	1

ITEM NO.	PART NUMBER	DESCRIPTION	QTY.
33	0507703	BEARING RETAINER	2
34	0507723	LOCK BAR	1
35	0507763	BACK COVER	1
36	0507767	BUN STOP	1
37	0507904	ANTI-ROTATION PLATE	1
38	0508444	BASE BOTTOM	1
39	0508501	SPRING GUIDE LH	2
40	0508502	SPRING GUIDE LH	2
41	0508507	PLATE TENSIONER	2
42	0508508	PLATE TENSIONER RH	1
43	0508509	PLATE TENSIONER LH	1
44	0600143	SPRING COMPRESSION	1
45	0600158	SPRING, ROLLER TENSIONER	4
46	0701026	WIRE SET	1
47	0800473	ROD, HSG SPACER 14.375 LG	4
48	1001213	LABEL, SHOCK HAZARD	1
49	1001664	LABEL, CONTROL	1
50	2100212	HANDLE, POCKET PULL, SNAP-IN	2
51	2100253	KNOB, 1/4" SHAFT, PUSH-ON	2
52	2100333	TEFLON STRIP	2
53	2110197	CLIP, STEEL CABLE	2
54	2120221	SHAFT SPACER	2
55	2120233	SPACER .252ID X .50D X .925LG	4
56	2120275	SPACER 5/16 ID X 3/4 OD X 3/4 LG	1
57	2140101	ADHESIVE/SEALANT-RTV	1
58	2150185	SPROCKET, 25B18 1/2" BORE	2

ITEM NO.	PART NUMBER	DESCRIPTION	QTY.
59	2150380	DRIVE CHAIN	1
60	2150384	BEARING ASSY, HIGH TEMP 1 1/8" OD X 1/2" ID	8
61	3040105	NUT, HEX 'KEPS' # 4-40	4
62	3060101	NUT,HEX #06-32 ST.STL	3
63	3060104	SCR, MACH #06-32 X 1/4 SLTRSHD: 304 S/S; BRT	2
64	3060123	SCREW, MACH #6-32 X 7/8"	2
65	3080124	SCREW, MACH, ONE WAY #8-32	1
66	3080143	NUT, HEX 'KEPS' #8-32	4
67	3080199	NUT, HEX KEPS #8-32 S/S	2
68	3080203	SCREW, 8-32 X 3/8" W/INT. TOOTH WASHER	22
69	3100146	NUT, HEX "KEPS" #10-32	26
70	3100178	SCREW, #10-32 X 3/8	8
71	3100187	SCREW SET #10-32 X 3/8 HEX SOCKET-CONE POINT	2
72	3100196	BOLT, SHDR 1/4 DIA X 1/8, 10-32 S.S.	2
73	3100214	SCREW 1/4-20 HEX	4
74	3250109	SCREW, HEXCAP 1/4-20 X 1/2"	9
75	3250154	1/4 LOCK WASHER	4
76	3250177	SCREW, SHOULDER	1
77	3250193	SCREW, HEX HEAD, 1/4-20 X 1.375" SCREW	4
78	3250219	SH BOLT 5/16 DIA X 1" LG 1/4-20	2
79	4000202	FAN, AXIAL - 230V, METAL HOUSING & IMP	1
80	4010221	CAP-MP, MOTOR RUN	1
81	4030352	HI LIMIT	1
82	4050214	THERMOCOUPLE, TYPE K (OPEN END)	1
83	4060355	TERMINAL BLOCK 3 POLE	1
84	4060374	GROUNDING LUG	1
85	4070295	CONTROL BOARD PC-13239	1
86	7001054	BELT KIT	1

## LIMITED WARRANTY

Equipment manufactured by Roundup Food Equipment Division of A.J. Antunes & Co. has been constructed of the finest materials available and manufactured to high quality standards. These units are warranted to be free from electrical and mechanical defects for a period of one (1) year from date of purchase under normal use and service, and when installed in accordance with manufacturer's recommendations. To insure continued operation of the units, follow the maintenance procedures outlined in the Owner's Manual. During the first 12 months, electro-mechanical parts, non-overtime labor, and travel expenses up to 2 hours (100 miles/160 km), round trip from the nearest Authorized Service Center are covered.

1. This warranty does not cover cost of installation, defects caused by improper storage or handling prior to placing of the Equipment. This warranty does not cover overtime charges or work done by unauthorized service agencies or personnel. This warranty does not cover normal maintenance, calibration, or regular adjustments as specified in operating and maintenance instructions of this manual, and/or labor involved in moving adjacent objects to gain access to the equipment. This warranty does not cover consumable/wear items. This warranty does not cover damage to the Load Cell or Load Cell Assembly due to abuse, misuse, dropping of unit/shock loads or exceeding maximum weight capacity (4 lbs). This warranty does not cover water contamination problems such as foreign material in water lines or inside solenoid valves. It does not cover water pressure problems or failures resulting from improper/incorrect voltage supply. This warranty does not cover Travel Time & Mileage in excess of 2 hours (100 miles/160 km) round trip from the nearest authorized service agency.
2. Roundup reserves the right to make changes in design or add any improvements on any product. The right is always reserved to modify equipment because of factors beyond our control and government regulations. Changes to update equipment do not constitute a warranty charge.
3. If shipment is damaged in transit, the purchaser should make a claim directly upon the carrier. Careful inspection should be made of the shipment as soon as it arrives and visible damage should be noted upon the carrier's receipt. Damage should be reported to the carrier. This damage is not covered under this warranty.
4. Warranty charges do not include freight or foreign, excise, municipal or other sales or use taxes. All such freight and taxes are the responsibility of the purchaser.
5. THIS WARRANTY IS EXCLUSIVE AND IS IN LIEU OF ALL OTHER WARRANTIES, EXPRESSED OR IMPLIED, INCLUDING ANY IMPLIED WARRANTY OR MERCHANTABILITY OR FITNESS FOR A PARTICULAR PURPOSE, EACH OF WHICH IS HEREBY EXPRESSLY DISCLAIMED. THE REMEDIES DESCRIBED ABOVE ARE EXCLUSIVE AND IN NO EVENT SHALL ROUNDUP BE LIABLE FOR SPECIAL CONSEQUENTIAL OR INCIDENTAL DAMAGES FOR THE BREACH OR DELAY IN PERFORMANCE OF THIS WARRANTY.



**Corporate Headquarters**

Carol Stream, Illinois  
Phone: +1 (630) 784-1000  
Toll Free: +1 (800) 253-2991  
Fax: +1 (630) 784-1650

**China Facility**

Suzhou, China  
Phone: +86-512-6841-3637  
Fax: +86-512-6841-3907