

Operating Instructions

Q-20ECT Q-20ECTW Conveyor Toaster

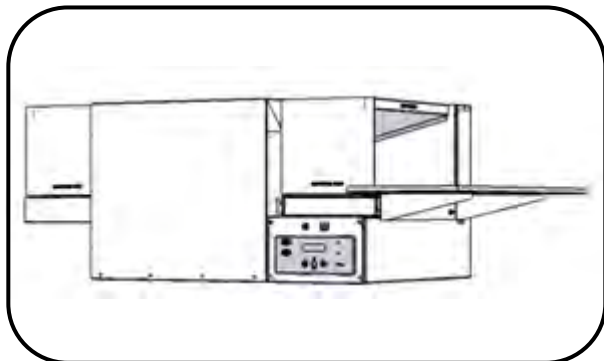

TABLE OF CONTENTS

Set-up & Installation Page 2
 Operation Page 2
 Cleaning Page 3
 Troubleshooting Page 4
 Controls Page 5
 Parts breakdown – Control panel Page 14
 Parts breakdown – Components rear .. Page 15
 Wiring Page 18

Specifications

General:

Dimensions:	40" L x 23" D x 21" H
Product Height Clearance:	2.5"
Belt Width:	16"
Cooking Zone:	320 sq in.
Conveyor Speed (Min/Max):	:20 sec to 8:00 min
Conveyor Direction:	User Adjustable
Agency Approvals:	Safety UL (USA & Canada)
	Sanitation NSF

Electrical:

Volts	Amps	Watts	Phase	Circuit Size
208-240	36-43	8.1 - 10.5kw	1	50 amps

ELECTRICAL

ENSURE PROPER VOLTAGE IS PROVIDED TO YOUR BUILDING AND TOASTING OVEN

ALL ELECTRICAL INSTALLATION, WORK, AND REPAIRS SHOULD ONLY BE COMPLETED BY A QUALIFIED ELECTRICIAN. FAILURE TO USE A QUALIFIED ELECTRICIAN MAY VOID YOUR WARRANTY.

LIMITED WARRANTY

This product is warranted to be free from defects in material and /or workmanship for a period of 1 year from the date of original installation, not to exceed 18 months from the date of manufacture.

Any component which proves to be faulty in material and /or workmanship be replaced or repaired by a certified technician (at the option of the manufacturer) without cost to the customer for parts and labor.

This warranty covers on location service (i.e. trip charges and or mileage).

This warranty is subject to the following exceptions /conditions:

- Manufacturer requests all toaster controllers (699-051) be returned to the manufacture's address for inspection in order to diagnose reason for failure. Failure to do so may void warranty.
- Use of any non-genuine parts voids this warranty
- All labor to be performed during regular work hours. Any overtime charges above standard hourly rates will be charged to the customer
- Damages caused by carelessness, neglect and /or abuse (e.g., dropping, tampering, or altering parts, equipment damaged in shipment, by fire, flood or an act of God) is not covered under this warranty.
- All problems due to operation at voltages other than that specified on equipment nameplate are not covered by this warranty. **Conversion to correct voltage is the customer's responsibility.**
- **Installation must be completed by a licensed electrician**
- All equipment must be serviced by a Q-Matic service technician or an authorized service technician during the warranty period.
- **Motors that fail due to lack of monthly lubrication and/or equipment maintenance may not be covered under warranty.**

Set-up & Installation

- 1) After removing the unit from the packaging take a moment to inspect the unit for signs of damage. If there is any damage to the unit:
 - Notify the carrier within 24 hours after delivery.
 - Save the carton and packing materials for inspection purposes.
 - Contact your dealer (from whom you purchased unit) for further details on obtaining a replacement.
- 2) Verify that all parts have been received and remove any protective coatings from them.
- 3) If optional legs purchased, attach four (4) legs to the bottom of the unit and tighten by turning clockwise.
- 4) Adjust optional legs if necessary by turning the bottom portion of each leg until unit sits level.
- 5) Install the crumb pans, exit trays and other accessories. (see fig 1)
- 6) Position unit on the stand (not included with unit) or on counter and place under the ventilation hood.
- 7) The cooling fan is located in the rear of the unit and it draws cool room temperature air in and circulates it through the control panel. It also circulates air over the inner body to keep the exterior cooler. To ensure that the fan properly circulates cool air do not place the unit so the fan draws hot air from another appliance or place it closer than 8" from the rear of the unit.

Operation

- 1) Plug the unit into the proper receptacle
- 2) Press the power button located in the bottom center of the controller. (see fig 2)



- 3) The control display will illuminate and the display will show "HEATING" and "CONV TIME XX:XX"
- 4) Allow approx 45 minutes for the unit to properly heat up. The lower right corner has a green LED that will illuminate when the unit is ready to use.
- 5) When finished using the unit simply push the power button again to turn it off. (the fan will continue to run until the unit has cooled down.)

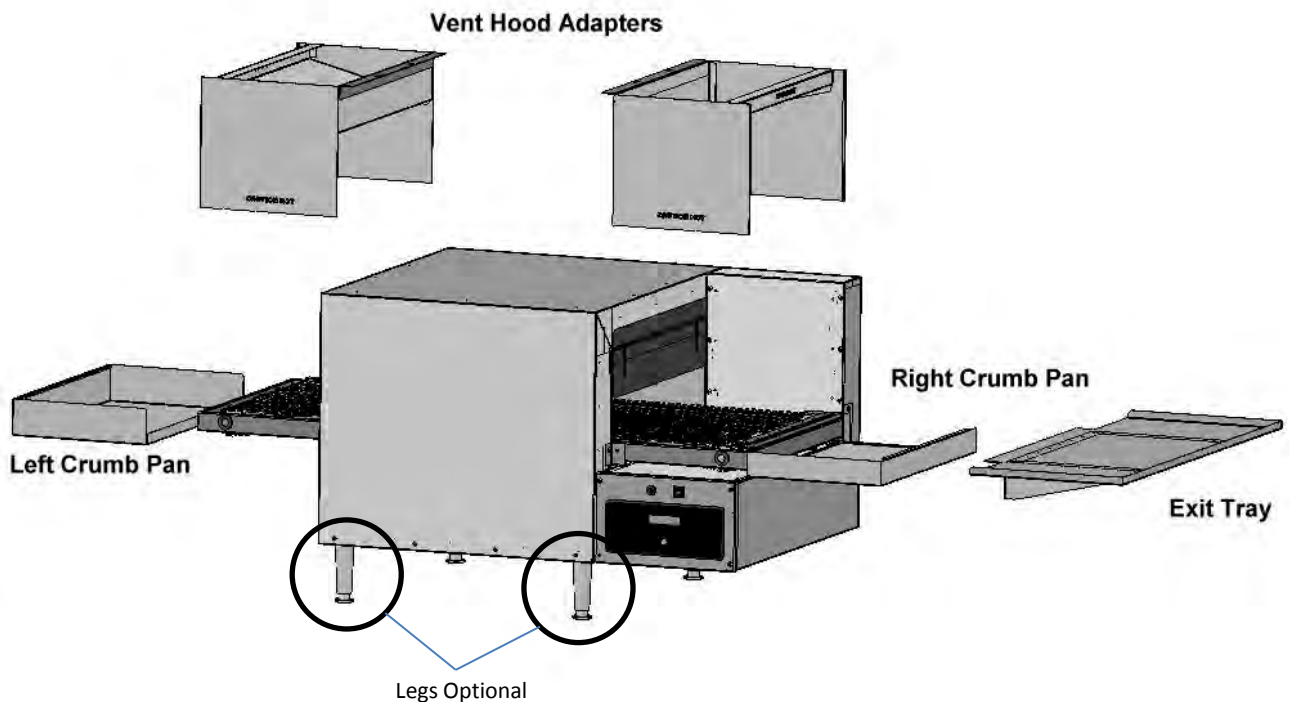

Fig 1

Cleaning

Note: It is important to turn off the circuit breaker and unplug The unit before attempting to clean it . This unit is electric so if it is wiped off with a damp cloth or sponge make certain it is wrung out thoroughly and is damp but not excessively wet

Daily:

- 1) Turn off circuit breaker and unplug the unit.
- 2) Unit must be cool before handling any part of the oven.
- 3) Remove the extended exit tray (see photo 1). Wash with soap and water if needed.
- 4) Remove and empty the left and right crumb pans (see photo 2 & 3). Wash with soap and water if needed.
- 5) Wipe the exterior with a lightly damp rag or sponge. **(Note : Stainless steel polish on the exterior is OK but do not use any kind of oven cleaner or harsh degreaser on any surface of the oven, especially the interior! This will cause damage to the interior finishes and/or the heating elements. Doing so will void the warranty!)**

Weekly:

- 1) Turn off circuit breaker and unplug the unit.
- 2) Allow unit to cool thoroughly before handling any part of the oven.
- 3) All of the steps listed above plus:
- 4) remove the left side end plug (see photo 4)
- 5) Slide out the tray located below the lower heating elements. (see photo 5)
- 6) Wipe the conveyor belt down with a damp cloth. (see photo 6)
- 7) Wipe the cooling fan grill guard located at the rear of the unit with a damp cloth. (see photo 7)

Monthly:

- 1) Lubricate the motor chain drive and chain

Quarterly:

- 1) Turn off circuit breaker and unplug the unit.
- 2) Allow unit to cool thoroughly before handling any part of the oven.
- 3) All of the steps listed above plus:
- 4) Remove the conveyor belt by removing the connecting links (see photo 8) and removing the belt from the conveyor assembly. (The belt can be soaked in soap and water or a *mild* degreaser to remove any heavy debris that may be stuck to the belt)
- 5) Wipe the lower heating elements off with a damp rag or sponge. **(Note : do not use any kind of oven cleaner or harsh degreaser on any surface of the oven, especially the interior! This will cause damage to the interior finishes and/or the heating elements. Doing so will void the warranty!)**
- 6) Dry the conveyor belt thoroughly before replacing it on the unit. (the conveyor belt can be shortened by removing a belt link if the belt has excess sag.)

Annually:

- 1) Turn off circuit breaker and unplug the unit.
- 2) Allow unit to cool thoroughly before handling any part of the oven.

Continued on next page.



Cleaning (cont.)

Annually (cont.)

- 3) All of the steps listed on previous page plus:
- 4) Have the unit inspected and adjusted by a qualified service personnel to keep in good working order and check for any signs of components with excessive wear.

Troubleshooting



Problem:

Beginning of the day the control has no display/ will not power up.

Possible reasons:

- 1) Circuit breaker tripped in electrical panel.
- 2) Fuse in the units control panel is blown. (see fig 3).

Possible solution:

- 1) Reset the breaker. (if breaker trips again call qualified service personnel.)
- 2) Replace the fuse (if fuse blows again call qualified service personnel.)

Problem:

The unit works for a period of time then shuts off

Possible reasons:

- 1) Circuit breaker tripped in electrical panel. (see fig 3).
- 2) Fuse in the units control panel is blown
- 3) Unit is shutting off through the high limit switch. (usually caused by a blocked or non functioning cooling fan)

Possible solution:

- 1) Reset the breaker. (if breaker trips again call qualified service personnel.)
- 2) Replace the fuse (if fuse blows again call qualified service personnel.)
- 3) Clean or have cooling fan replaced by qualified service personnel.

Problem:

The unit conveyor runs and has a display on control but unit is not heating:

Possible reasons:

- 1) Heater fuses are blown
- 2) Electrical supply problem (faulty connection from supply or faulty delivery from supply).

Possible solution:

- 1) Check or replace fuses. (Call qualified service personnel.)
- 2) Check power supply to unit.(reset supply circuit breaker or call qualified service personnel.)

Continued on next page.



Photo 5



Photo 6

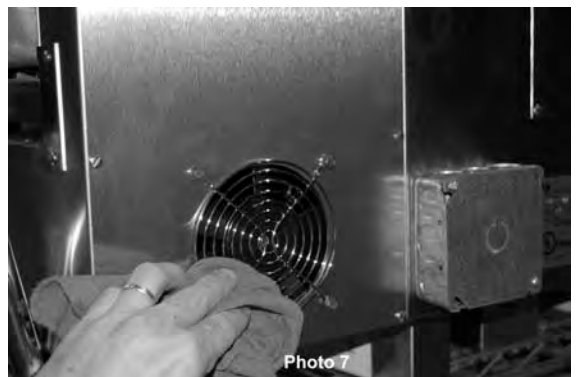

Photo 7

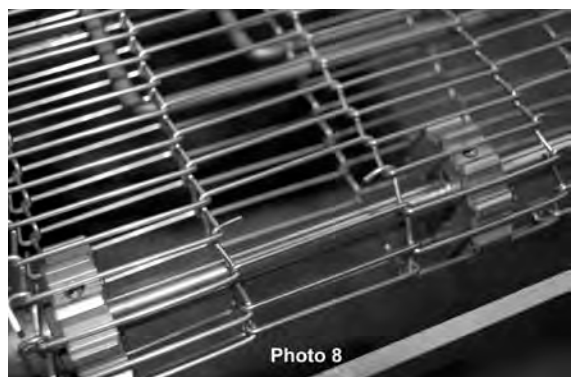

Photo 8

Troubleshooting (cont.)

Problem:

Unit is heating but the conveyor is not turning.

Possible reasons:

- 1) Circuit breaker tripped in unit control panel (see fig 3).
- 2) Conveyor motor brushes are worn or motor has other problem.

Possible solution:

- 1) Reset the 1/2 amp circuit breaker. (see fig 3). If breaker trips again call qualified service personnel.
- 2) Replace the motor brushes or conveyor motor (call qualified service personnel.)



Problem:

Products are not heating/toasting properly

Possible reasons:

- 1) Heat settings in the heat/conveyor controller are not adjusted properly.
- 2) Heating element(s) are not working
- 3) Conveyor speed in the heat/conveyor controller is not correct.
- 4) Unit is excessively dirty

Possible solution:

- 1) Adjust heat settings (see page 8)
- 2) Check for heating elements not working (call qualified service personnel.)
- 3) Readjust conveyor speed to compensate. (see page 6)
- 4) Clean unit. (see page 3)

For any problems not described here or for further assistance please call 1(800) 880-6836

Controls

- A) Power/Select Button
- B) Power Indication LED
- C) Display Panel
- D) Ready LED
- E) Left Arrow Button
- F) Right Arrow Button
- G) Conveyor Faster Button
- H) Conveyor Slower button

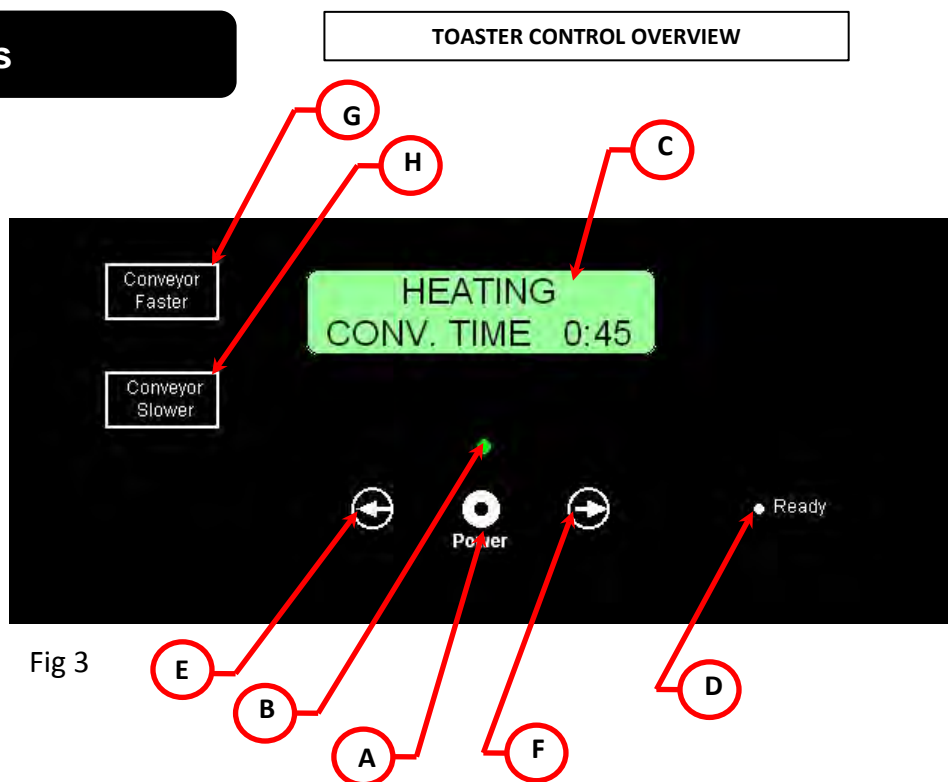

Fig 3

CHANGING THE CONVEYOR SPEED

This is the default display that will always appear when the controller is operating

Press the "Conveyor Faster" or "Conveyor Slower" buttons to change conveyor speed.



When a button is pressed the control's display will change to read "SPEED SET POINT" on the top and the speed is displayed at the bottom.



Once it is adjusted to the desired speed and the button is released the display will automatically return to the default display



The new conveyor speed will appear each time the controller is turned unless it is changed



CHANGING THE CONVEYOR DIRECTION

To change the direction of the conveyor belt begin with the control off.

Press and hold the **“Power”** and **“Left arrow”** buttons simultaneously for 2-3 seconds.

Press the **“SELECT”** button to enter the direction command prompt.

The display will show **“MOTOR DIRECTION”**, **“SELECT”** & the left and right arrows in the display

When the direction of the conveyor is changed the control also changes the setup of the heating elements. This means that that top or bottom **“A”** is always the entry side and top or bottom **“B”** is always the exit side.

Use the **“LEFT”** or **“RIGHT”** arrow buttons to change the direction of the conveyor belt. The display will read either **“LEFT TO RIGHT”** or **“RIGHT TO LEFT”**. This indicates which side the product enters to where it exits



Press and hold for 2-3 seconds

For all programming operation the **“Power”** button also serves as the **“SELECT”** button.



Press once



Press either arrow button to change the conveyor belt direction.

Once all the changes have been made press the “SELECT (Power)” button. Once the “SELECT” button is pushed the controller will shut off and all the changes made will be stored and will be used the next time the control is turned on.



Press the “SELECT” button to return to the programming menu .

Once the “SELECT (Power)” button is pushed the controller will shut off and all the changes made will be stored. The changes will be used the next time the control is turned on.

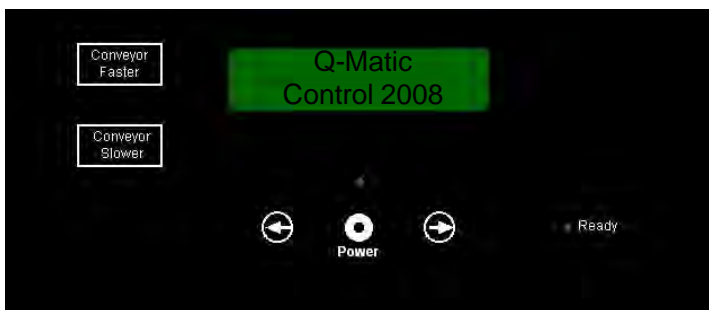

CHANGING POWER OUTPUT SETTINGS

To change the heater power output settings begin with the control off.

Press and hold the “Power” button for 2-3 seconds.

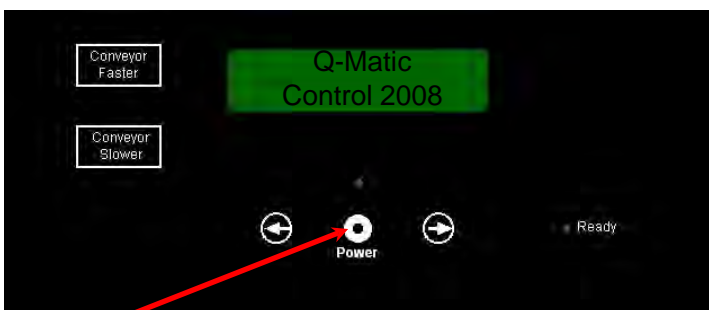

Press and hold for 2-3 seconds

Top A Duty – Is the percentage of output for the top heater on the entry side.

Press the “SELECT” button to enter the programming of the Top A Duty.



Press once

Use the “LEFT” or “RIGHT” arrow buttons to change the length of the cycle. The value of this is adjustable between 0 to 100 percent

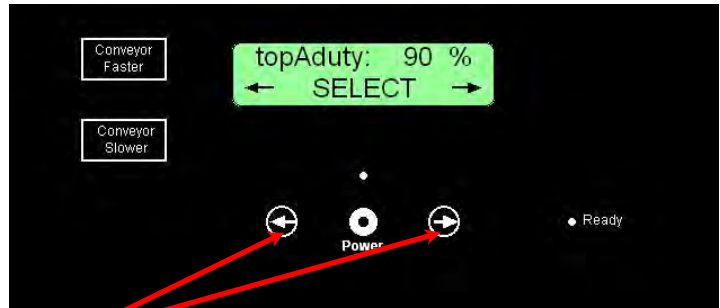

Press either arrow button to change the percentage of output for the heater.

Once the selection has been made press the “SELECT (Power)” button



Press the “SELECT” button to return to the programming menu .

Use the “RIGHT” arrow button to advance to the next step in the programming menu.



Use the “Right” arrow to advance to the next programming step – Top B Duty.

Top B Duty – Is the percentage of output for the top heater on the exit side.

Press the “SELECT” button to enter the programming of the Top B Duty.



Press once

Use the “LEFT” or “RIGHT” arrow buttons to change the length of the cycle. The value of this is adjustable between 0 to 100 percent

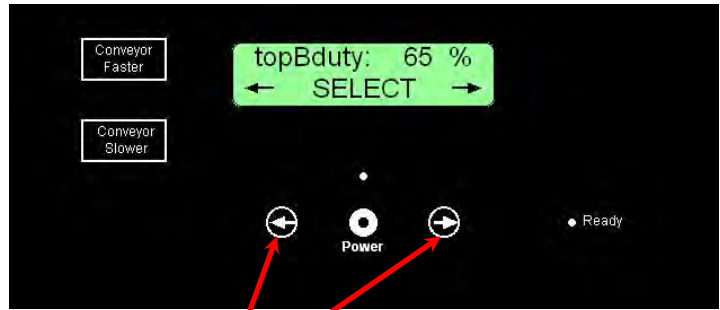

Press either arrow button to change the percentage of output for the heater.

Once the selection has been made press the “SELECT” (Power) button



Press the “SELECT” button to return to the programming menu .

Use the “RIGHT” arrow button to advance to the next step in the programming menu.



Use the “Right” arrow to advance to the next programming step – Bottom A Duty.

Bottom A Duty – Is the percentage of output for the **bottom** heater on the entry side.

Press the “SELECT” button to enter the programming of the Bottom A Duty.



Press once

Use the “LEFT” or “RIGHT” arrow buttons to change the length of the cycle. The value of this is adjustable between 0 to 100 percent

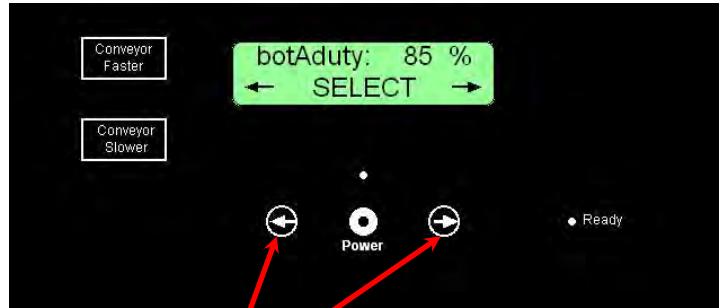

Press either arrow button to change the percentage of output for the heater.

Once the selection has been made press the “SELECT (Power)” button



Press the “SELECT” button to return to the programming menu .

Use the “RIGHT” arrow button to advance to the next step in the programming menu.



Use the “Right” arrow to advance to the next programming step – Bottom B Duty.

Bottom B Duty – Is the percentage of output for the **bottom** heater on the exit side.

Press the “SELECT” button to enter the programming of the Bottom B Duty.



Press once

Use the “LEFT” or “RIGHT” arrow buttons to change the length of the cycle. The value of this is adjustable between 0 to 100 percent

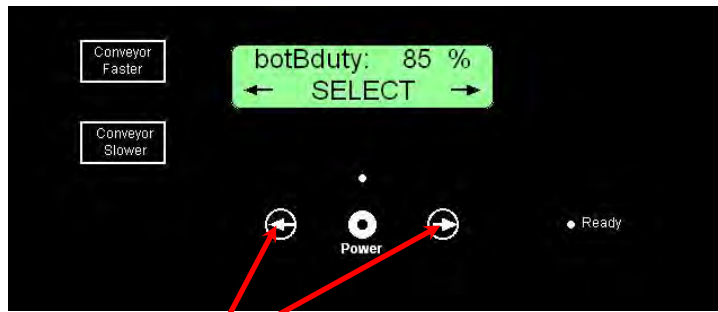

Press either arrow button to change the percentage of output for the heater.

Once the selection has been made press the “SELECT (Power)” button



Press the “SELECT” button to return to the programming menu .

Use the “RIGHT” arrow button to advance to the next step in the programming menu.



Use the “Right” arrow to advance to the next programming step – EXIT.

Once all the changes have been made press the “SELECT (Power)” button. Once the “SELECT” button is pushed the controller will shut off and all the changes made will be stored and will be used the next time the control is turned on.



Press the “SELECT” button to return to the programming menu .

Once the “SELECT (Power)” button is pushed the controller will shut off and all the changes made will be stored. The changes will be stored and used until they are changed.



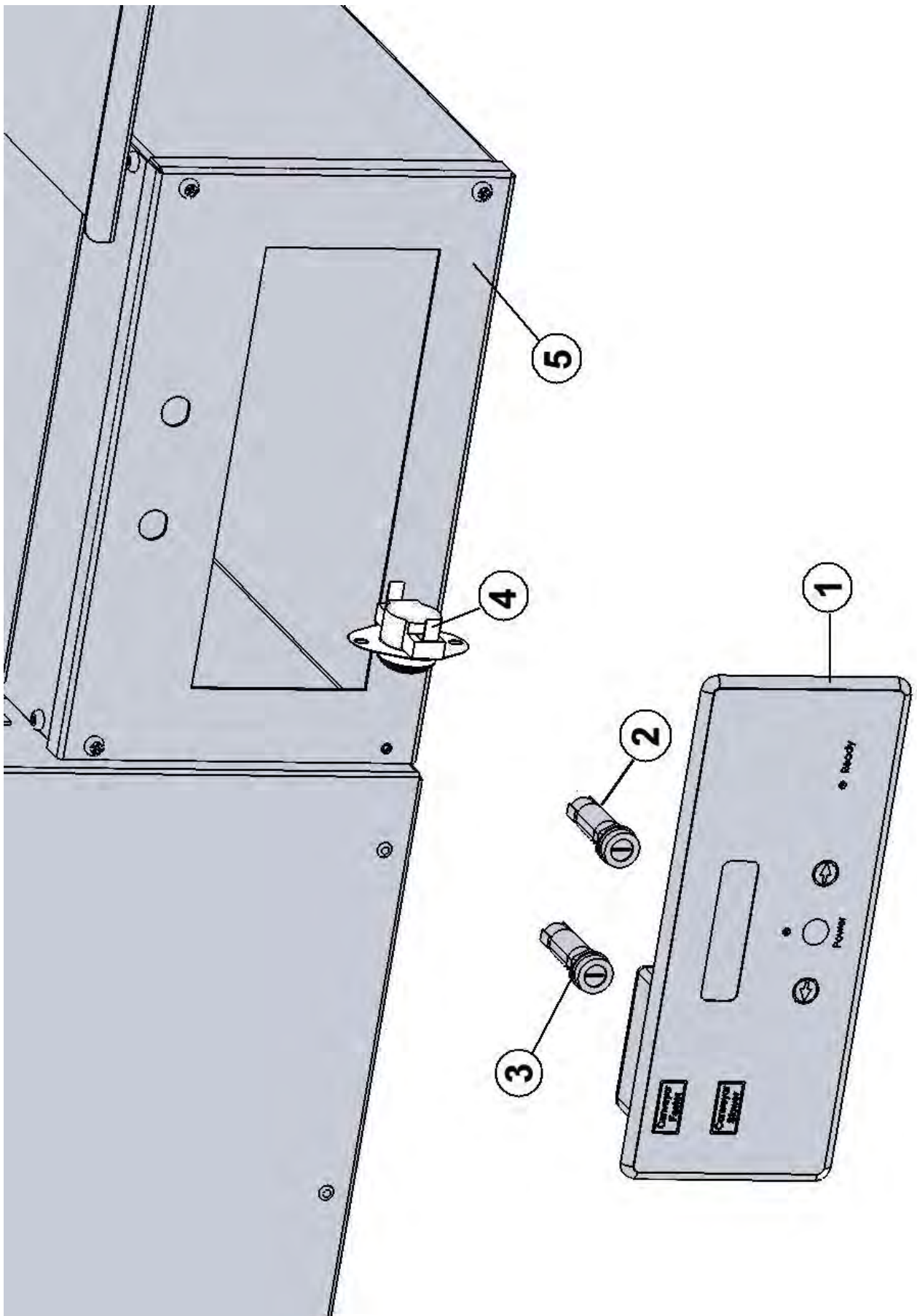

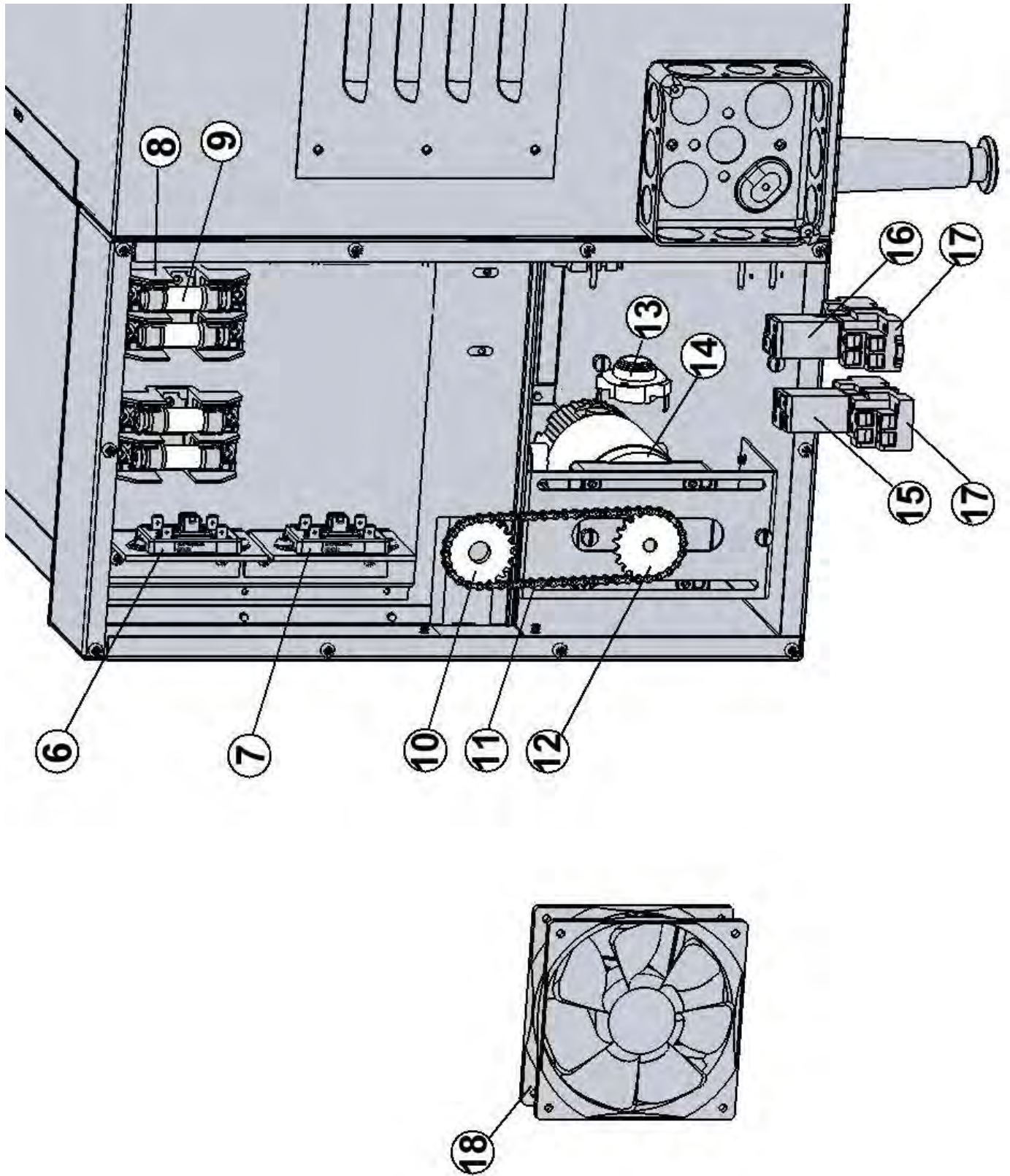

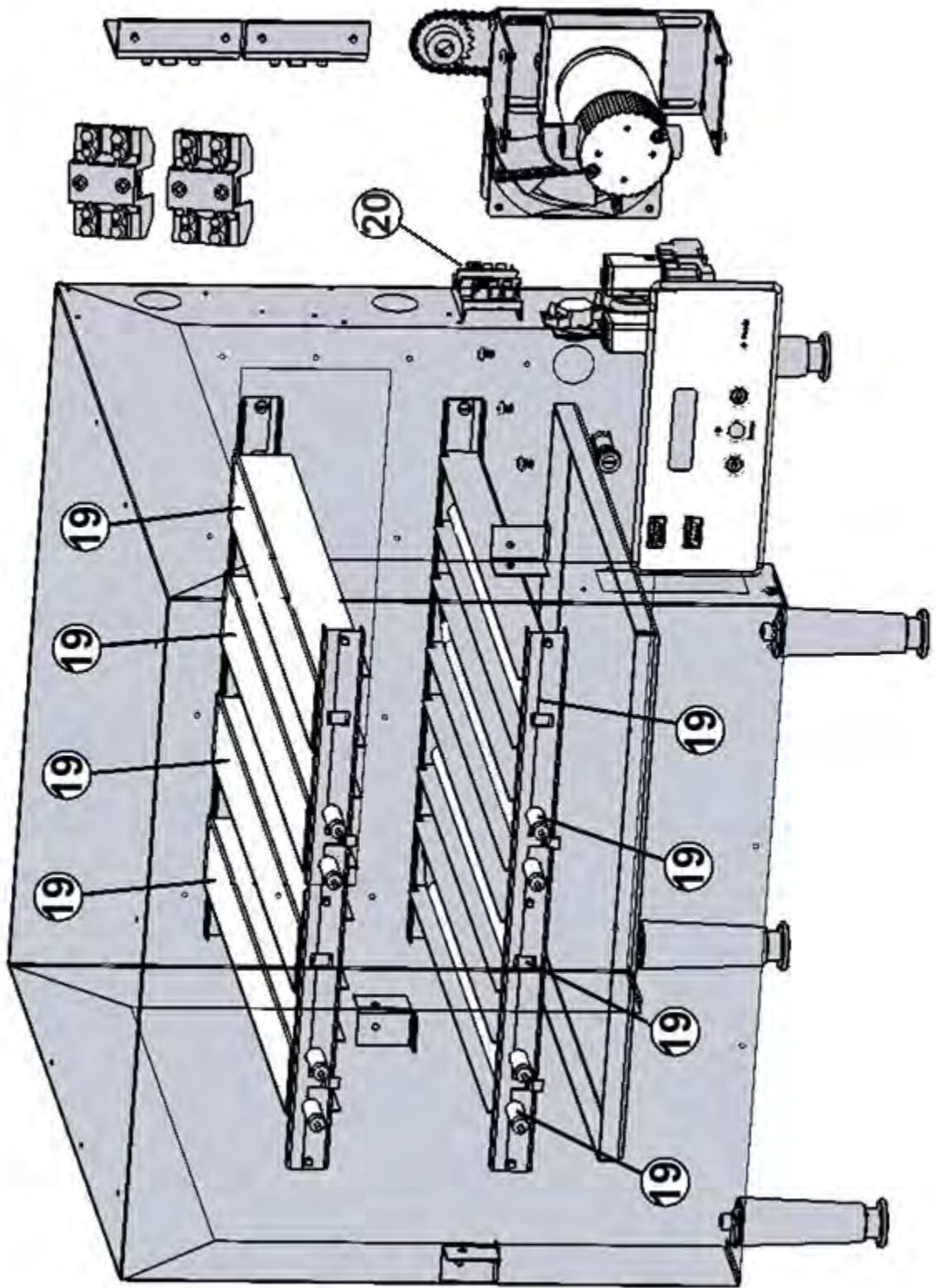

Page	Item	Part No.	Description
14	1	699-051	Controller, conveyor / heat
14	2	88-787	Fuse Holder, panel mount
14	-	699-110	Fuse, 1 amp (for above fuse holder)
14	3	88-787	Fuse Holder, panel mount
14	-	699-110	Fuse, 1 amp (for above fuse holder)
14	4	RE1058	Switch, high limit
14	5	699-047	Panel, control mounting
15	6 & 7	699-009	Relay, dual output heater
15	8	RE1063	Fuse Holder, heater fuse
15	9	RE1048	Fuse, 10 amp heater
15	10	699-049	Sprocket, conveyor shaft drive
15	11	699-002	Chain, conveyor drive
15	12	699-048	Sprocket, conveyor motor drive
15	13	RE1047	Switch, fan control
15	14	699-052	Motor, conveyor drive
15	15	699-112	Relay, conveyor direction
15	16	699-113	Relay, cooling fan cool down
15	17	699-114	Base, relay mounting
15	18	89-1097	Fan, Cooling
16	19	699-081	Heater, 1200w – All Positions
16	20	89-1123	Block, terminal power
Not shown		699-027	Belt, conveyor
Not shown		699-115	Transformer, 208-240vac to 120vac
Optional		699-040	4" Adjustable Leg (Order part FMP 119-1010)

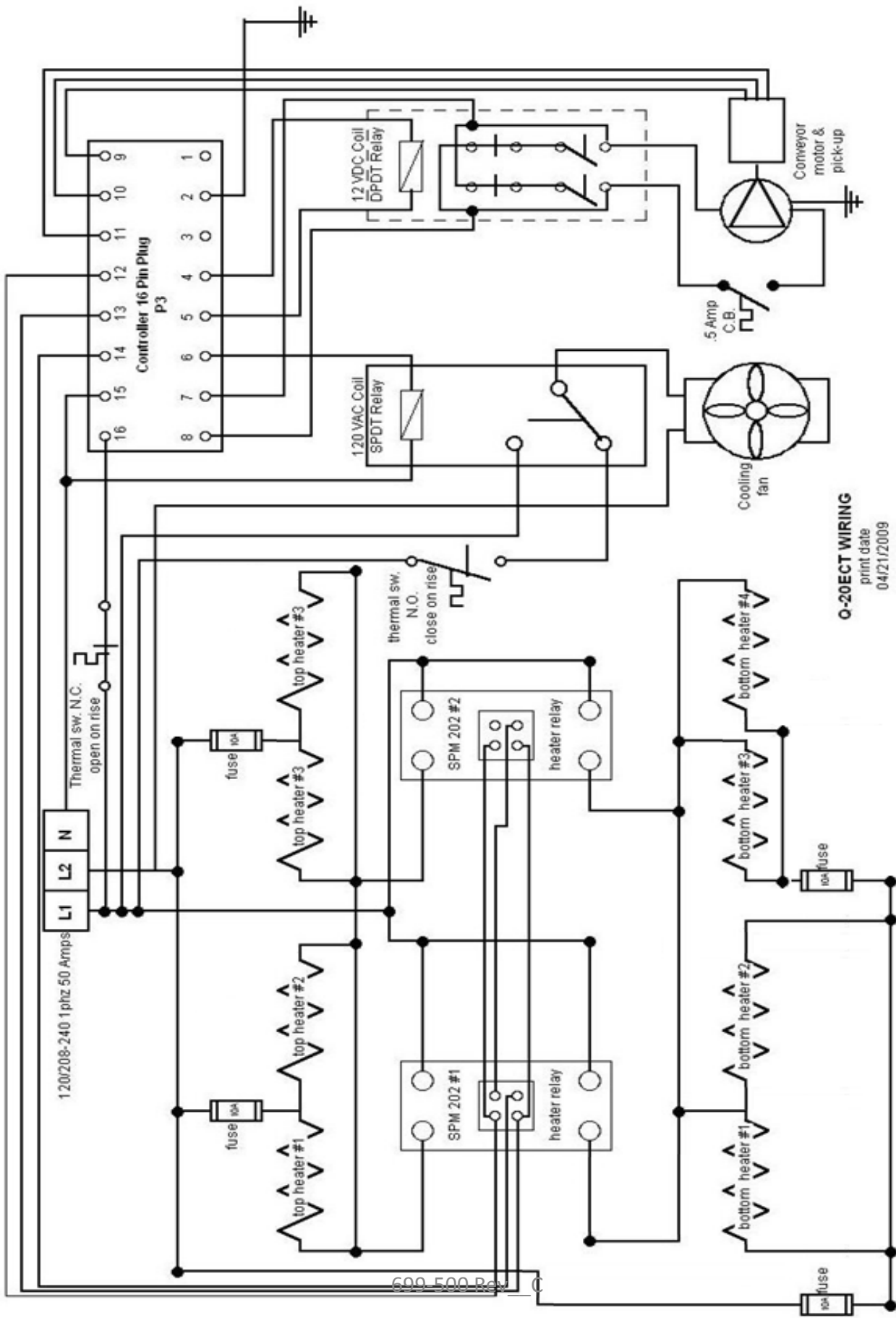

O-20ECT WIRING
 print date 04/21/2009