

Service Manual

Electronic Warm Jar

SR-DF101

SR-DF181



		SR-DF101	SR-DF181
Power supply	TWN	AC 110V/60Hz	
	Latin America,USA	AC 120V/60Hz	
	Brazil	AC 127V/50Hz	
	HongKong,Thailand,Viet Nam,RSU, Peru,Indonesia,Singapore RBD	AC 220V/50Hz	
	India,Singapore DBD	AC 230V/50Hz	
	Malaysia,Oceania	AC 240V/50Hz	
Power consumption	Max.for cooking	HongKong,Malaysia,India, Singapore RBD,Viet Nam, Singapore DBD,Thailand, Oceania,USA,RUS, Latin America,Peru,Brazil	750W
		TWN,Indonesia	760W
	Max.for keeping warm	HongKong,Malaysia,India, Singapore RBD,Viet Nam, Singapore DBD,Thailand, Oceania,USA,RUS, Latin America,Peru,Brazil	750W
		TWN,Indonesia	760W
Cooking method		Heat directly	
Menu select	HongKong,Malaysia,Singapore RBD, USA, Oceania,Singapore DBD, India, Viet Nam,Thailand,TWN,Indonesia	Quick Cook/Steam,White Rice, Brown Rice,Porridge/Soup	
	Latin America,Peru,Brazil,RSU	Quick Cook/Steam,White Rice,Cake,Porridge/Soup	

Keep Warm temperature	HongKong, Malaysia, India, Singapore RBD, Oceania, USA, Singapore DBD, Viet Nam, RUS, Thailand, TWN, Indonesia	73±4°C	
	TWN, Indonesia	73±4°C	
Rice cooking volume (rice quantify)	White Rice/Quick Cook	0.18L~1.0 L(1~5.5cups)	0.18L~1.8 L(1~10cups) Quick Cook(1~8cups)
	Brown Rice	0.18L~0.54L(1~3cups)	0.18L~1.08L(1~6cups)
	Mixed rice/Glutinous rice	0.18L~0.54L(1~3cups)	0.18L~0.9L(1~5cups)
Porri cooking volume (rice quantify)		0.09L~0.18L(1/2~1cups)	0.09L~0.3.6L(1/2~2cups)
Maximun cooking volume (ingredints+water)for soup		1. 5L※	2.3L※
Cake	Latin America, Peru, Brazil	Max(480g)	Max(480g)
Heat source (Heating part)	HongKong, Malaysia, India, Singapore RBD, Oceania, USA, Singapore DBD, Viet Nam, RSU, Thailand, TWN, Indonesia	Cooking....bottom(cast heater)	
	TWN, Indonesia	Keep Warm....bottom(cast heater), side(warming heater), lid (lid heater)	
Temperature checking	HongKong, Malaysia, India, Singapore RBD, Oceania, USA, Singapore DBD, Viet Nam, RSU, Thailand, TWN, Indonesia	Pan sensor(thermal resistor with negative temperature coefficient)	
	TWN, Indonesia	Pan sensor(thermal resistor with negative temperature coefficient), lid sensor(thermal resistor with negative temperature coefficient)	
Safe equipment		Thermal fuse A 250V 10A 172°C, Thermal fuse B 250V 10A 172°C	
Power cord		Component coupling(the applicabie power cord is about 1.0m lcm)	
Dimension		(W)24.5cm ×(L)33.9cm ×(H)19.9cm	(W)24.5cm ×(L)33.9cm ×(H)24.7cm
Weight		2.5kg	2.8kg
Accessory		Measuring cup, rice scoop, steaming	
※It means that the maximum cooking volume for soup is the highest waterline for "PORRIDGE".			
●The power consumption is about 1W when both Cooking and Off mode(room temperature 20°C).			
●If any change occurred to the appearance, wiring or other parts of the warm jar due to property improvement or other reasons, there will be additional notice.			

⚠ WARNING

This service information is designed for experienced repair technicians only and is not designed for use by the general public. It does not contain warnings or cautions to advise non-technical individuals of potential dangers in attempting to service a product. Products powered by electricity should be serviced or repaired only by experienced professional technicians. Any attempt to service or repair the product or products dealt with in this service information by anyone else could result in serious injury or death.

Entire unit

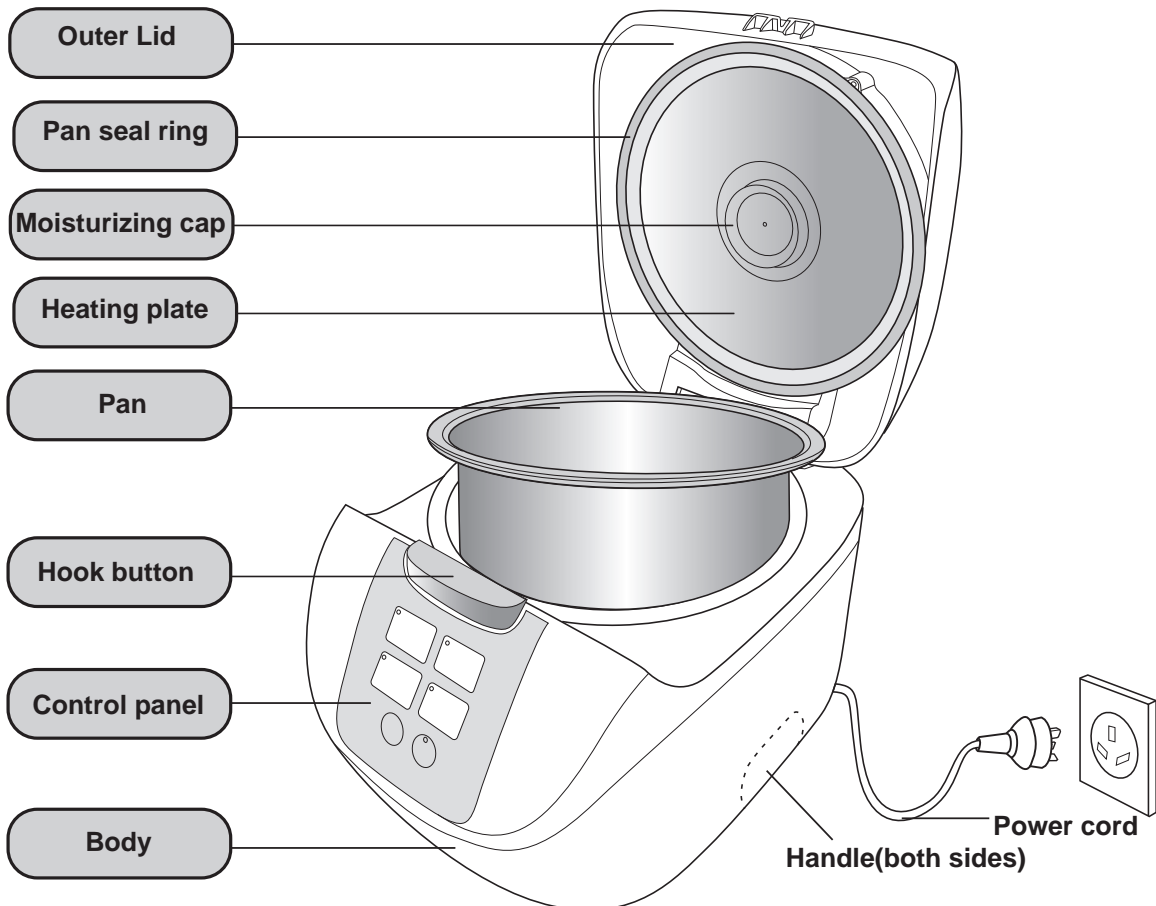

Accessories

Please clean the accessories before using.

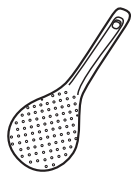

Rice scoop (1)



Measuring cup (about 180mL) (1)



Steaming basket (1)

1 SR-DF101,181 Electric Circuit Diagram

Factory:
HongKong
Malaysia
Singapore DBD

完成制御UA (全体)
 Control Unit Assy A (Whole)

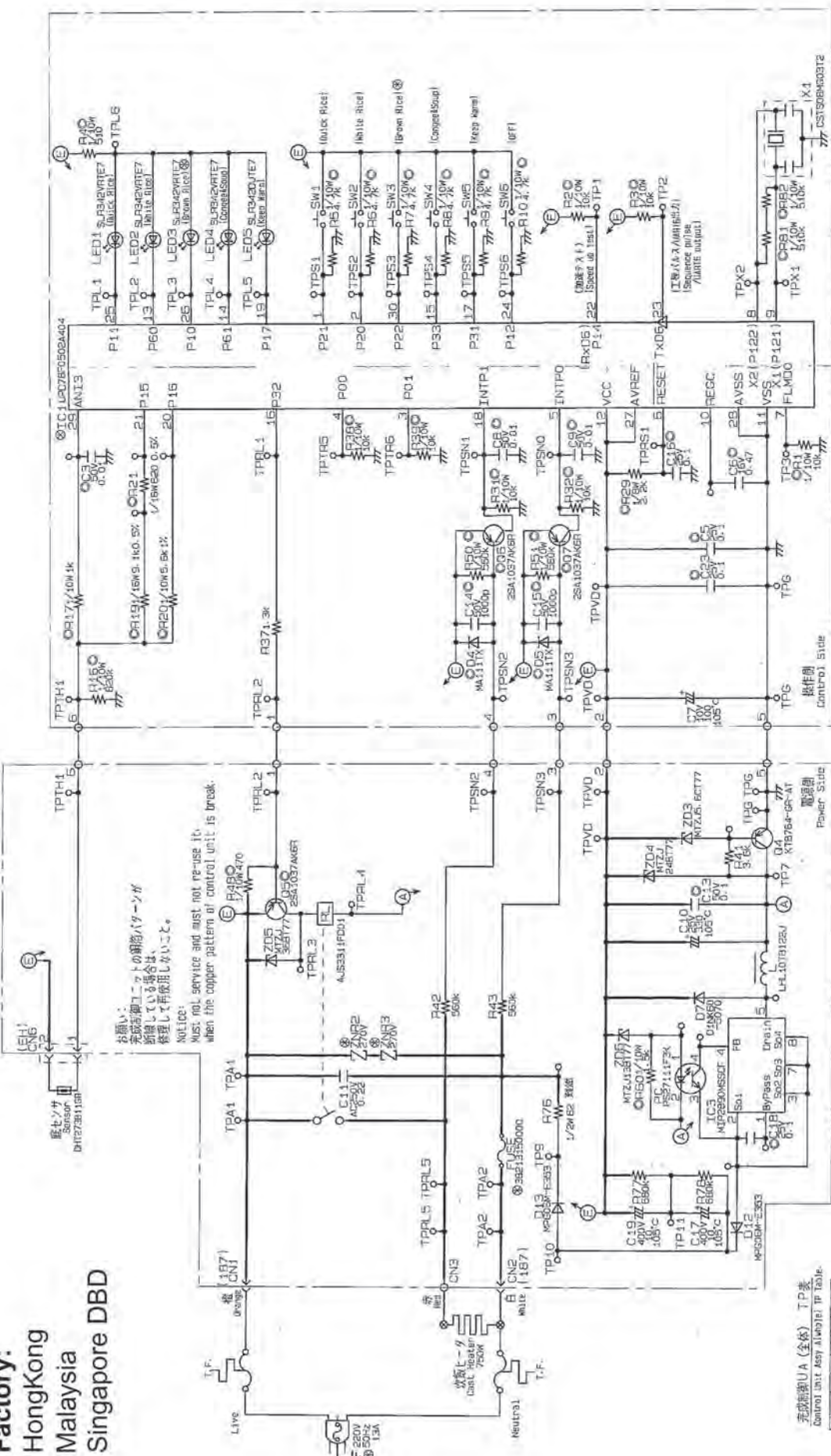

完成制御UA (全体) TP表
 Control Unit Assy A(Whole) TP Table

A1	11	V0	S3	1
A2	6	S4	2	
V0	TH1	S5	PC	3
G	SNA	X1	S6	TRB
TH1SN3	X2	L1	SN0	
FL2	RS1	L2	SN1	
FL3	7	FL1	L3	SN2
FL4		FL2	L4	SN3
FL5	9	S1	L5	
	10	S2	L6	

1 SR-DF101,181 Electric Circuit Diagram

Factory:
India

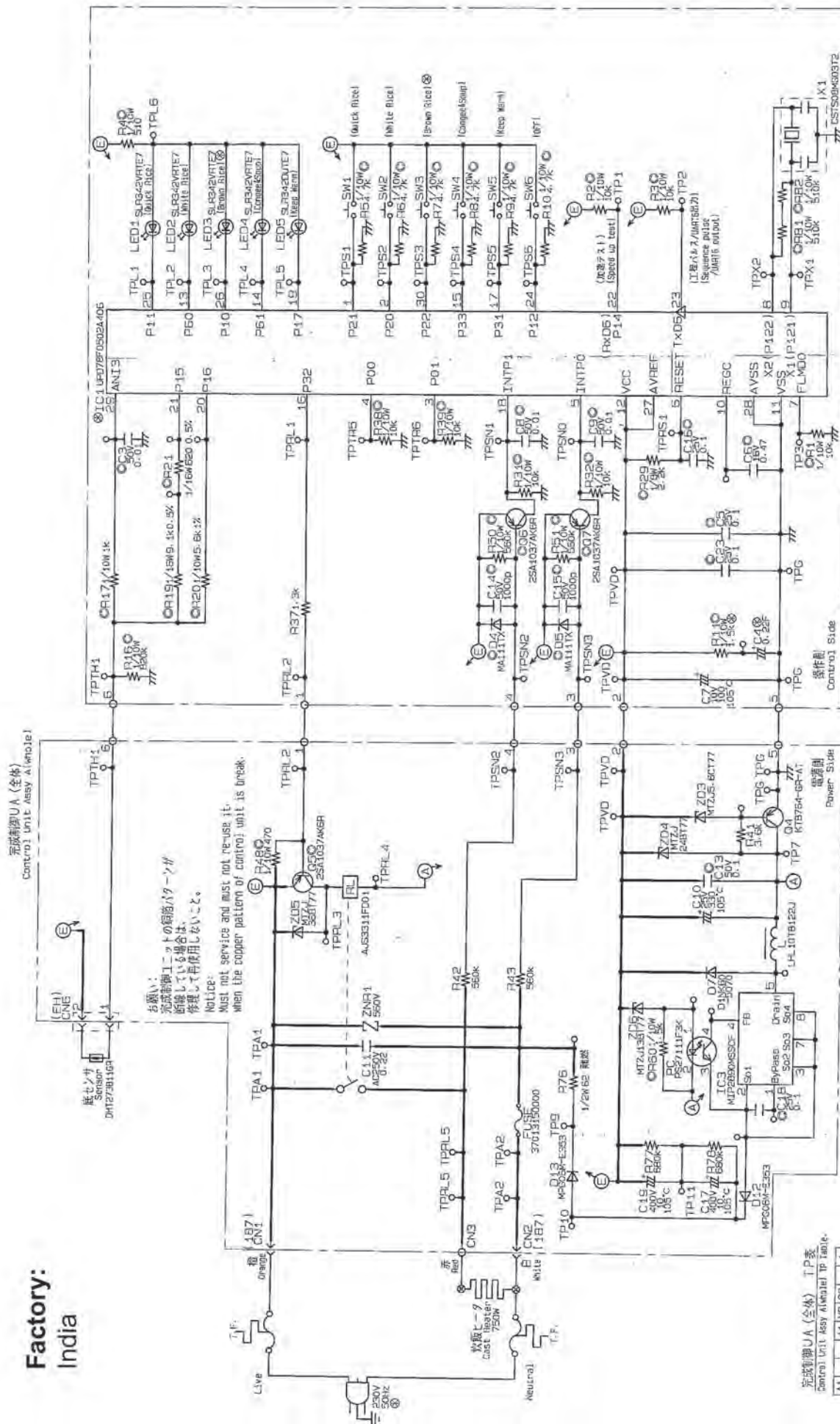

完成制御ユニット (全体)
Control Unit Assy A (entire)

お願い:
完成制御ユニットの短絡パターンが
破損している場合は、
修理して再使用しないこと。
Notice:
Must not service and must not re-use it.
When the copper pattern of control unit is break.

完成制御ユニット (全体) TP 表
Control Unit Assy A (entire) TP Table.

A1	11	VO	S3	1
A2	6	SA	2	
VO		TH:SS	PH:3	
B	SV2	X1	SS	TR6
TH:SHG	X2	L1	SN0	
FL3	7	FL1	L2	SN1
FL4		FL2	L3	SN2
FL5	9	S1	L4	ENC
	10	S2	L5	
			L6	

電源側 ← 操作側
Power Side ← Control Side

1 SR-DF101,181 Electric Circuit Diagram

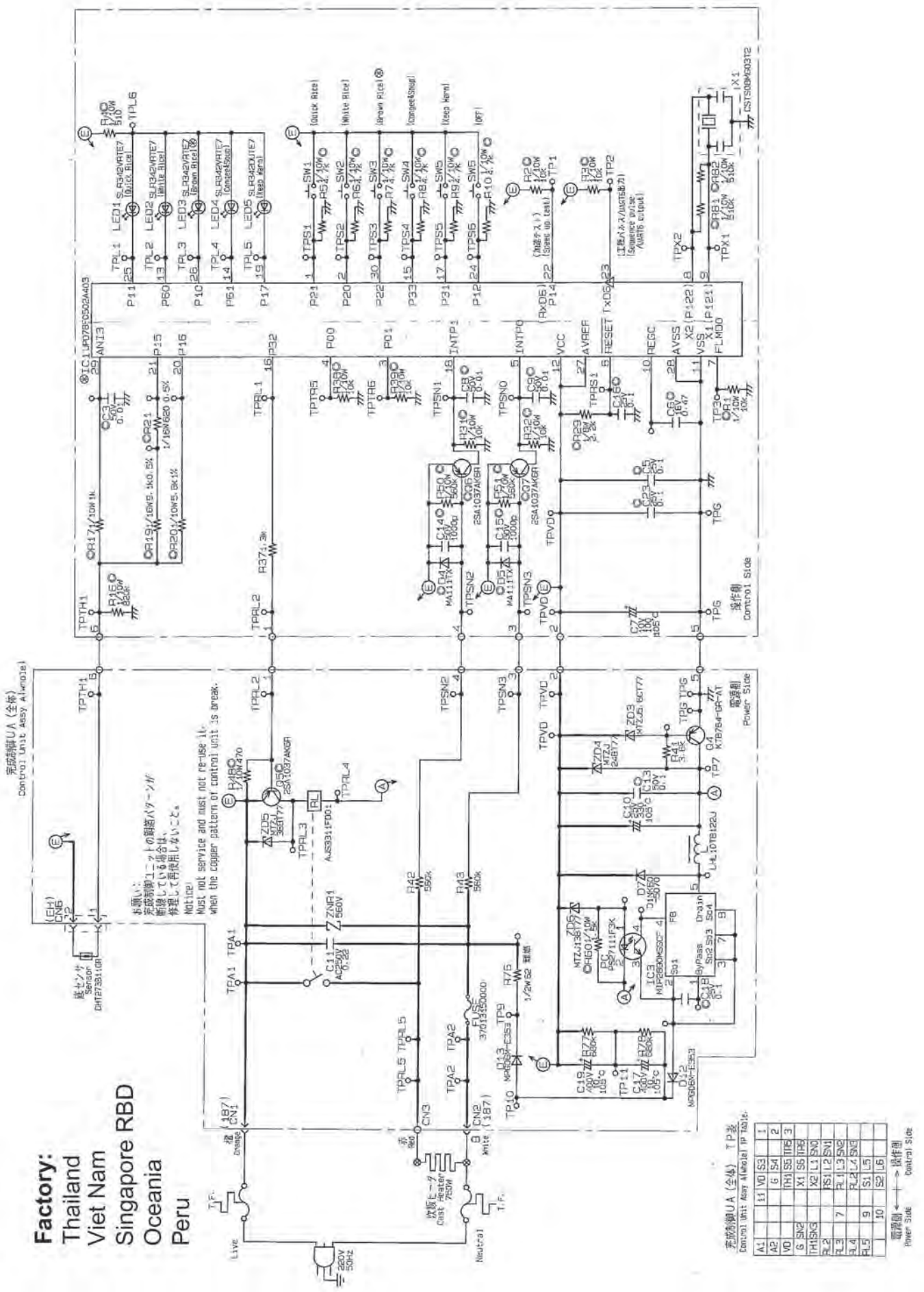

1 SR-DF101,181 Electric Circuit Diagram

Factory:
Latin America
Brazil

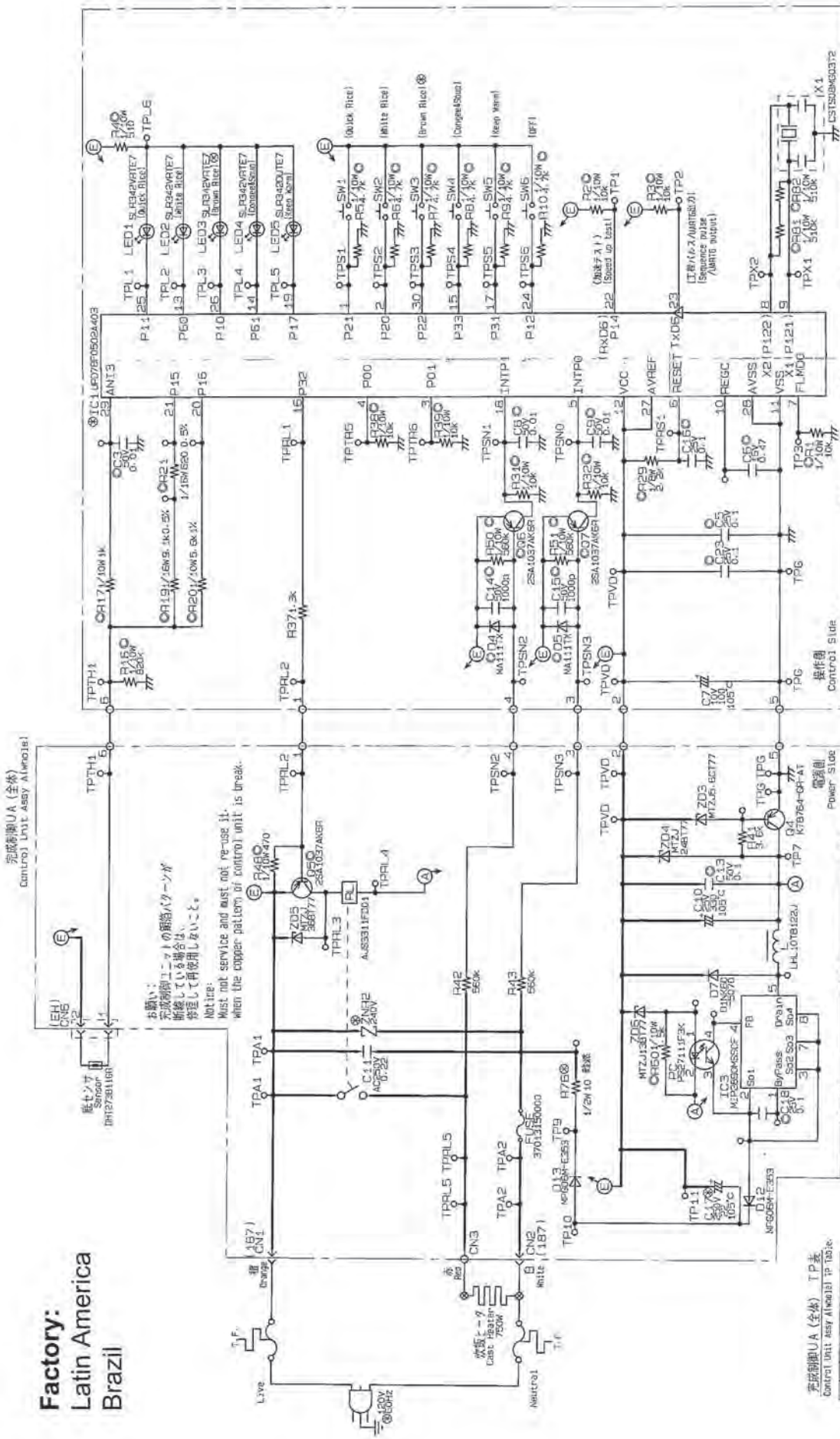

完成制御U.A. (全体) T.P.表
Control Unit Assy (All) TP Table

A1	11	VO	S3	1
A2	6	S4	2	
VO		THISS	THRE	3
S	SNG	X1	IS	IPR
THISNG	X2	L1	SNQ	
RL2	RS	L2	SNL	
RL3	PL	L3	SNQ	
RL4	PL	L4	SNQ	
RL5	9	S1	L5	
RL6	10	S2	L6	

電源側 ← 操作側
Power Side ← Control Side

1 SR-DF101,181 Electric Circuit Diagram

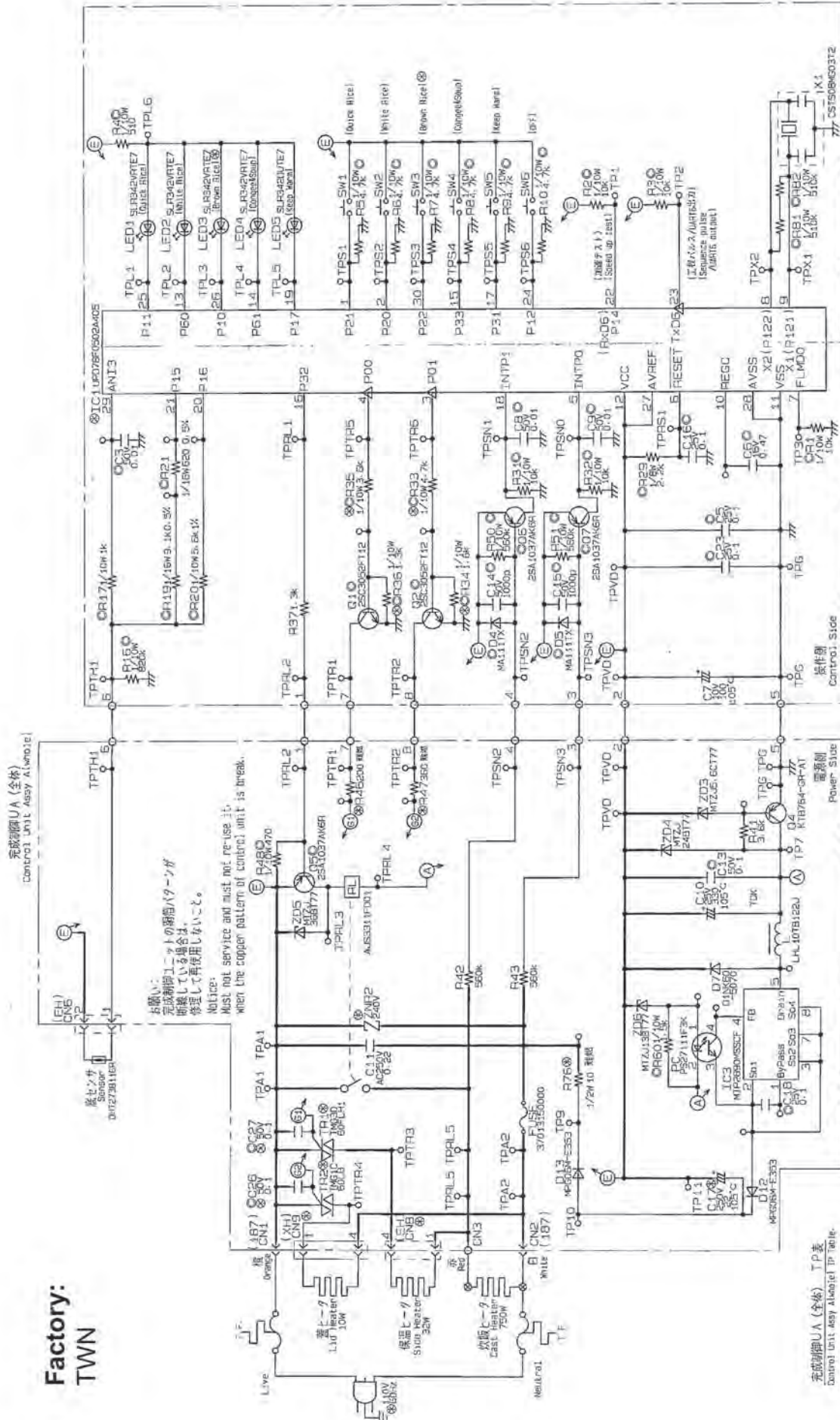

1 SR-DF101,181 Electric Circuit Diagram

Factory:
Indonesia

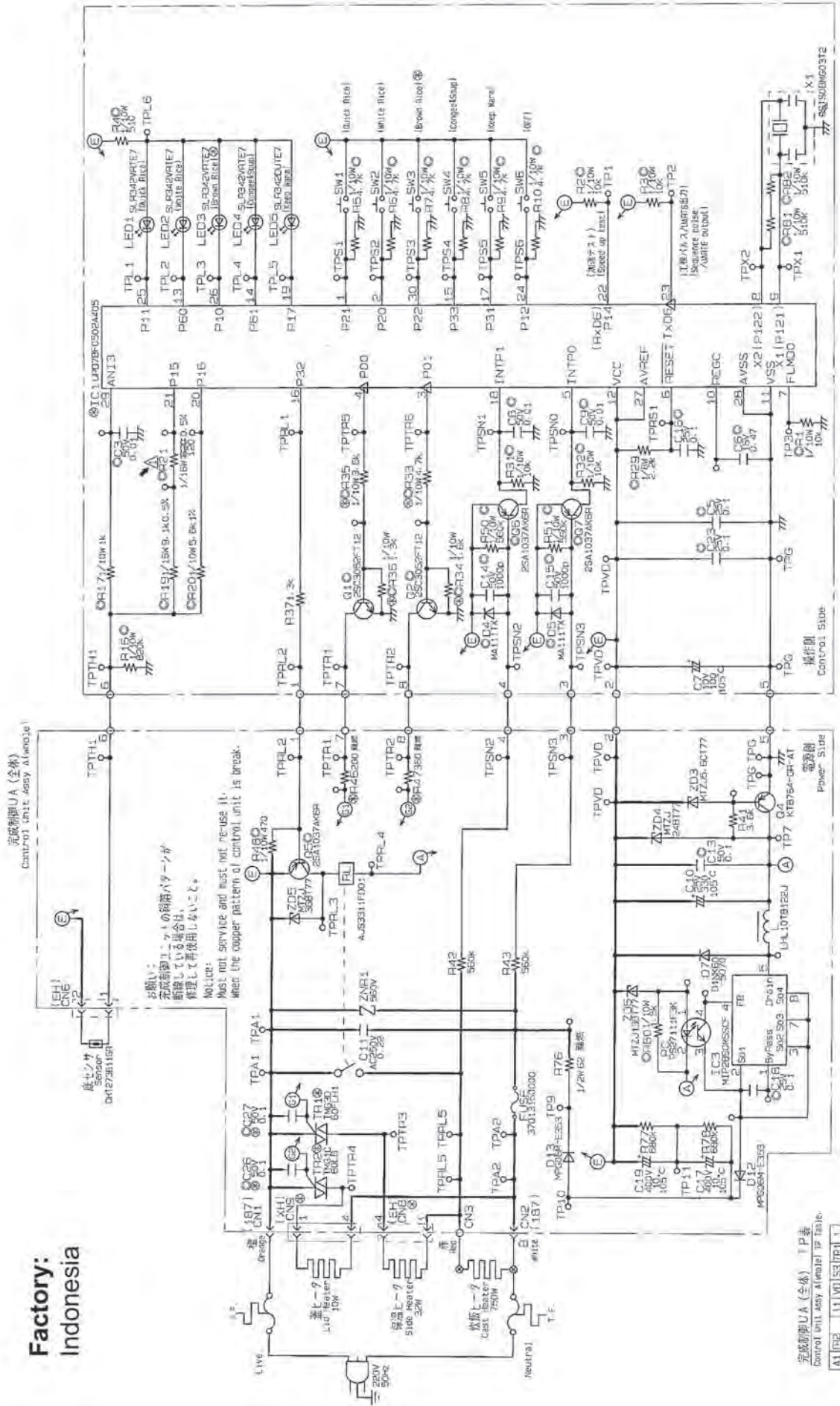

完成制御U.A (全体) TP番号
Control Unit Assy (Altogether) TP Table:

AI	PI2	VI	VO	SS	TR1	1
A2	TR3	G	S4	TR2	2	
VO	TR4		TR1	SS	TR3	3
G	SNG	X1	SS	TR6		
TR1	SN3	X2	L1	SN0		
PL2		RS1	L2	SN1		
PL3	7	PL1	L3	SN2		
PL4		PL2	L4	SN3		
PL5	9	S1	L5			
TR1	10	SS	LE1			

電源側 ← Control Side
制御側 → Control Side

1 SR-DF101,181 Electric Circuit Diagram

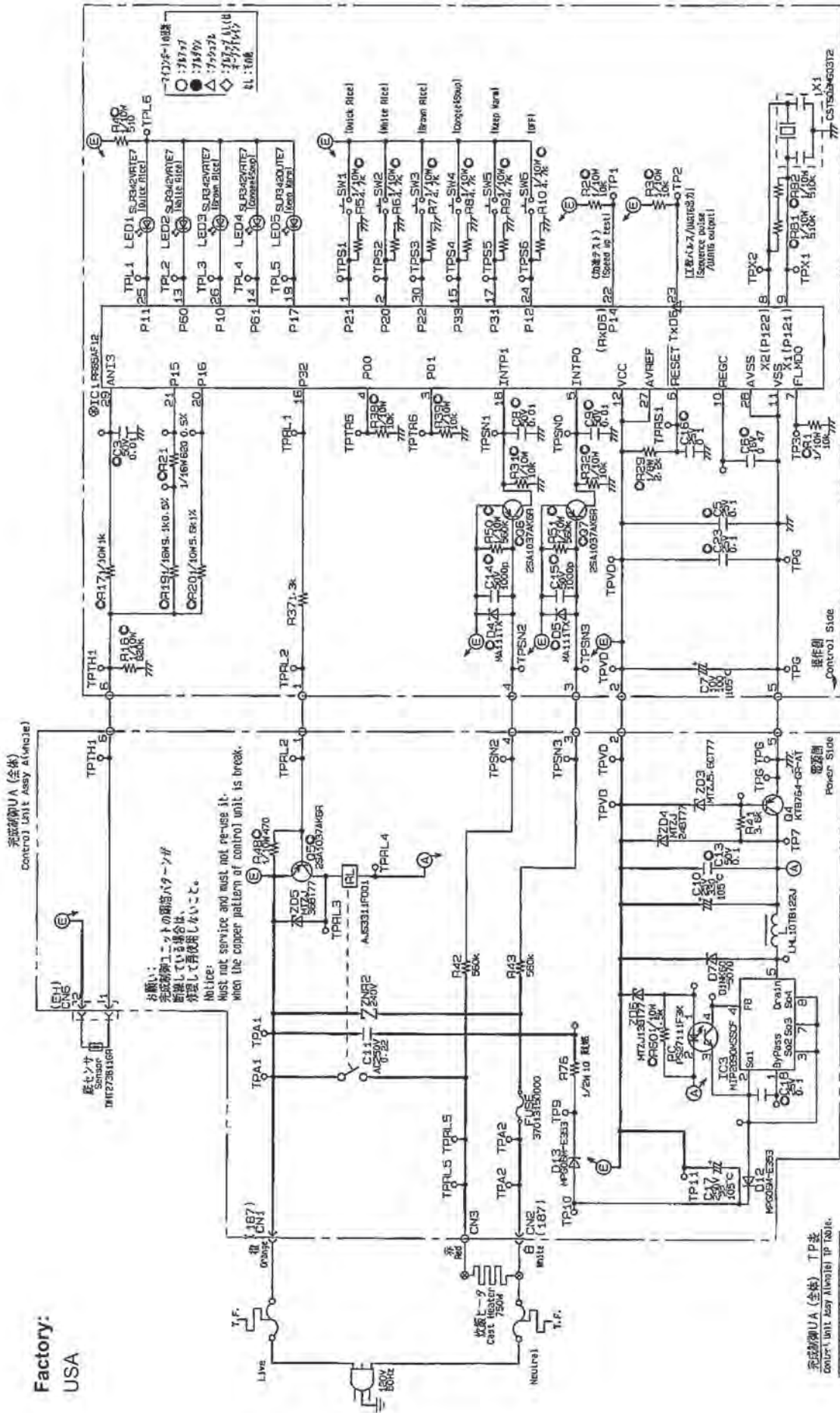

注) 使用元回路: SR-DF1 (中継機)
Based circuit diagram: SR-DF1 (Latin America)
注) 接地配線は IEC-3. その他は IEC-4 で設計

電源側
Power Side

操作側
Control Side

1 SR-DF101,181 Electric Circuit Diagram

Factory:
RUS

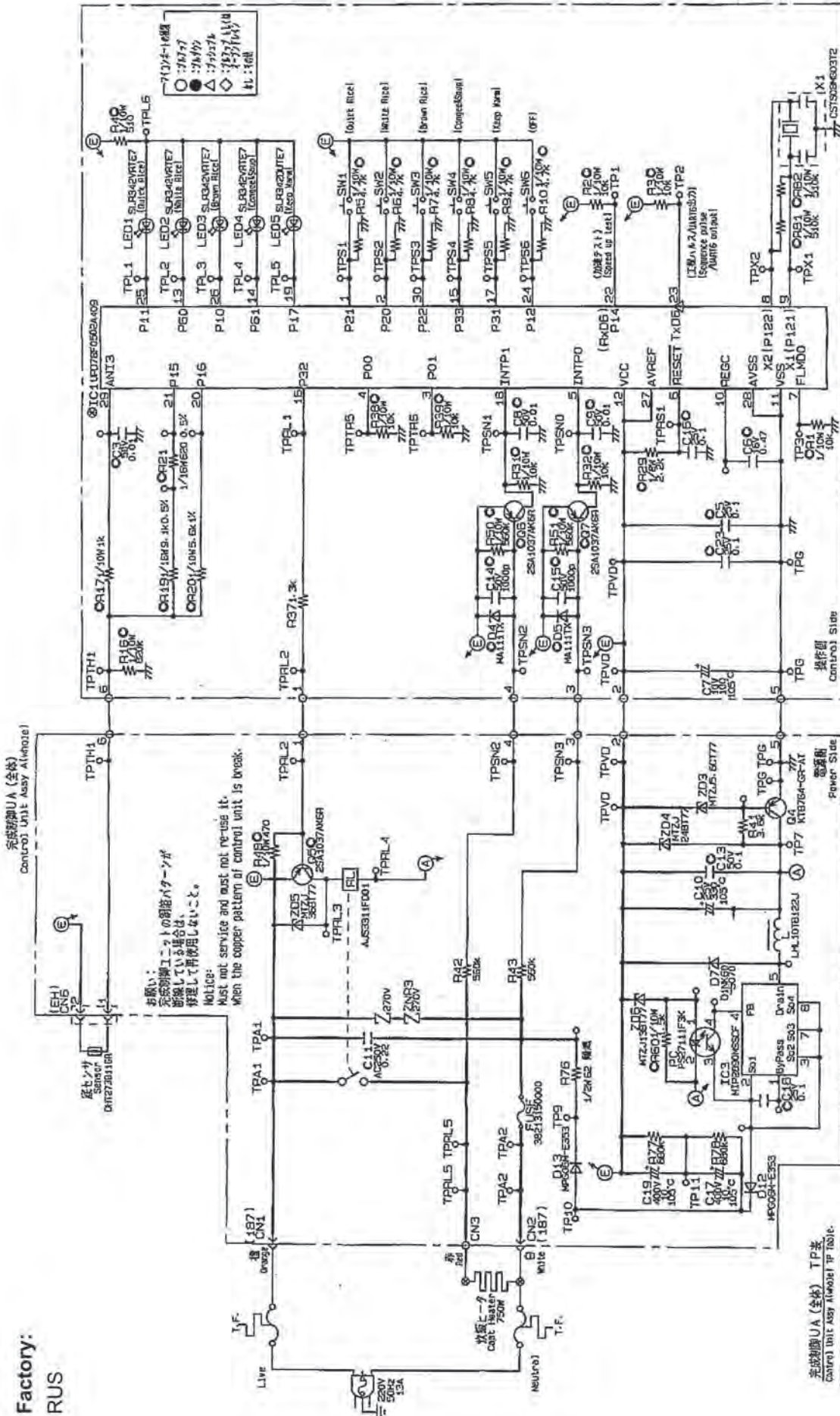

お願い:
 空冷制御ユニットの銅箔パターンが
 変形している場合は、
 修理して再使用しないこと。
 Notice:
 Must not service and must not re-use it.
 when the copper pattern of control unit is broken.

注) 冷却回路: SR-DF1 (空冷)
 Based circuit diagram: SR-DF1 (空冷)
 注) 冷却回路は IEC-3. その他は IEC-4 設計

空冷制御UA (全体) TP表
 Control Unit Assy Airflow TP Table

A1	11VD	S3	1
A2	G	S4	2
VD	TH1	SS1	3
G	SG	X1	SS1RE
TH1	SN1	X2	L1
TH2	SN2	SS1	L2
TH3	SN3	FL1	L3
TH4	SN4	FL2	L4
TH5	SN5	SI1	L5
TH6	SN6	SI2	L6

電源側 ← 操作側
 Power Side ← Control Side

2 Schematic Diagram (SR-DF101, 181)

Factory:

HongKong
SingaporeRBD
SingaporeDBD
Oceania
India
Viet Nam
Malaysia
Thailand
Latin America
Brazil
Peru

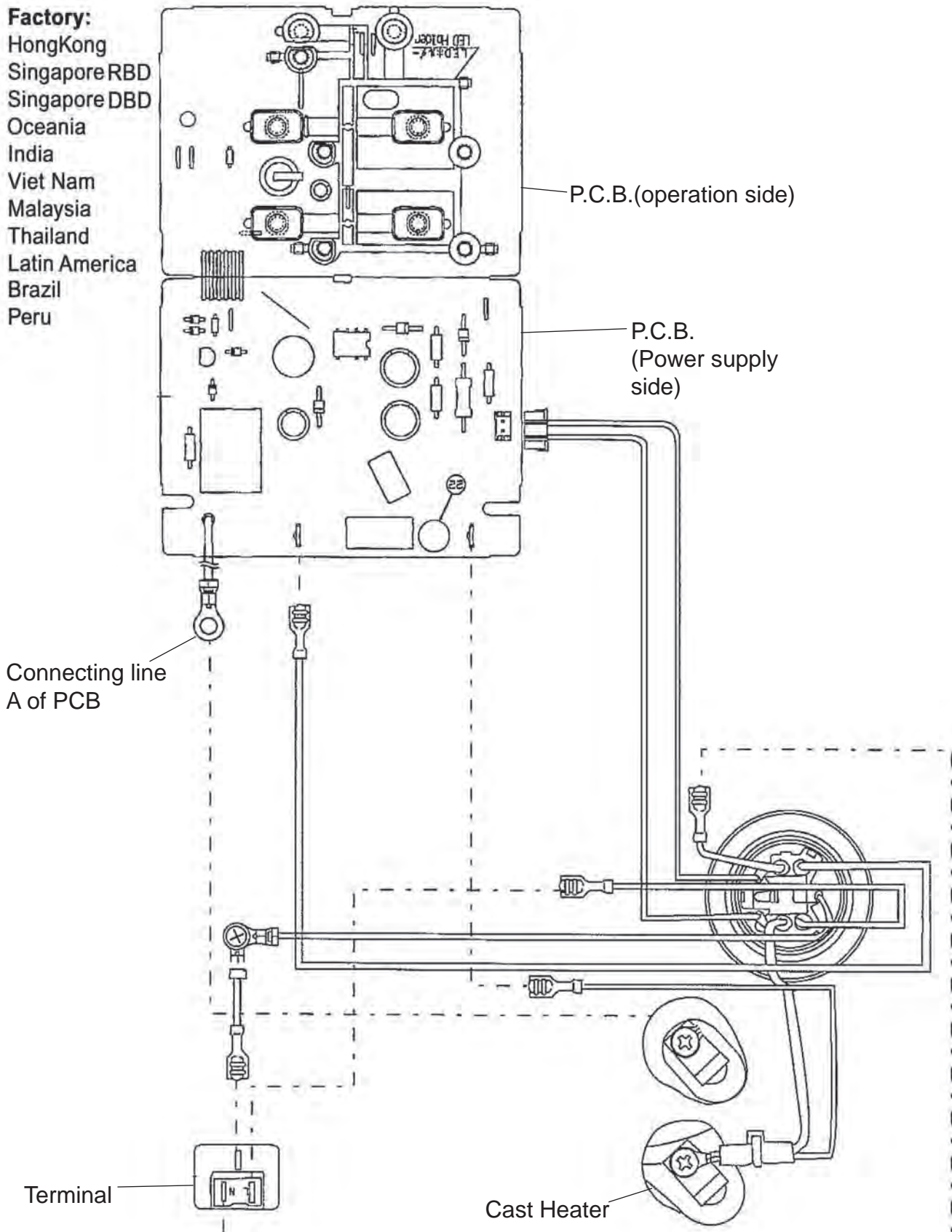

2 Schematic Diagram (SR-DF101, 181)

Factory:
TWN Indonesia

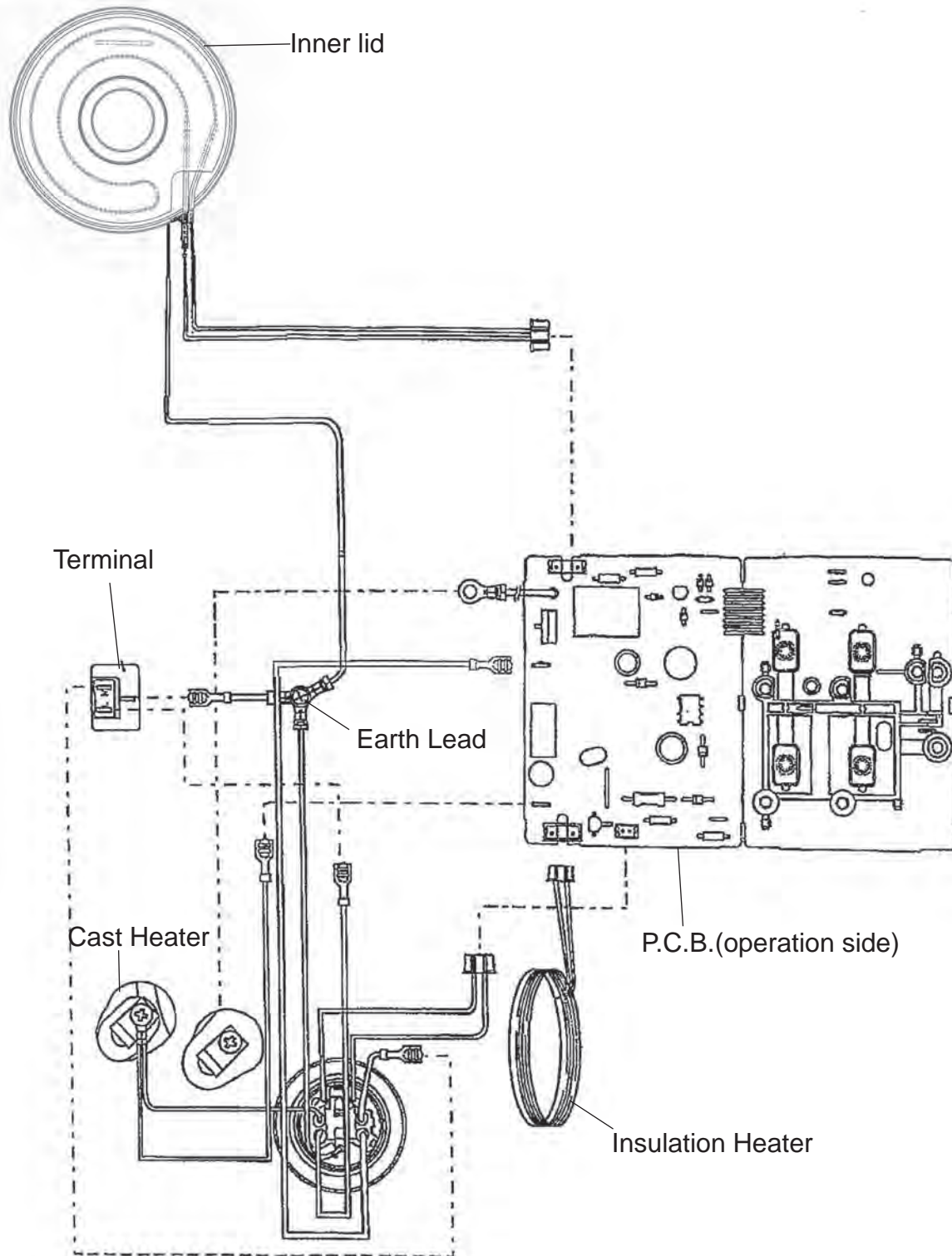

3 Wiring Connection Diagram

Factory:

- HongKong
- Singapore RBD
- Singapore DBD
- Oceania
- India
- Viet Nam
- Malaysia
- Thailand
- Latin America
- Brazil
- Peru

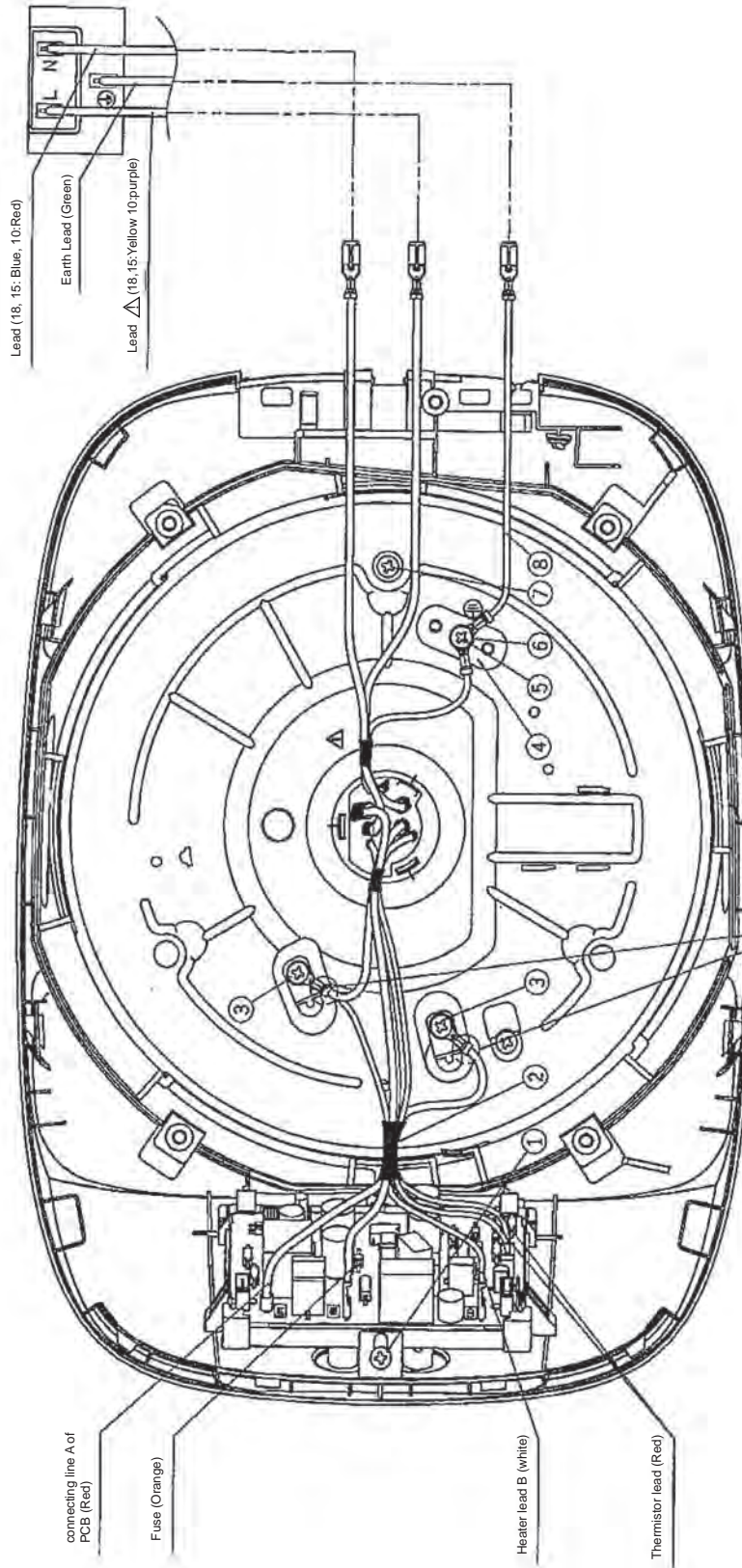

DF181 Wiring Connection Diagram

Note: For actual needs, some junctions of the connecting wires of the product are wined with flame retardant tapes. Don't attempt to tear off the tapes unless it is absolutely necessary. And wind the tapes on the initial positions as before after repair.

3 Wiring Connection Diagram

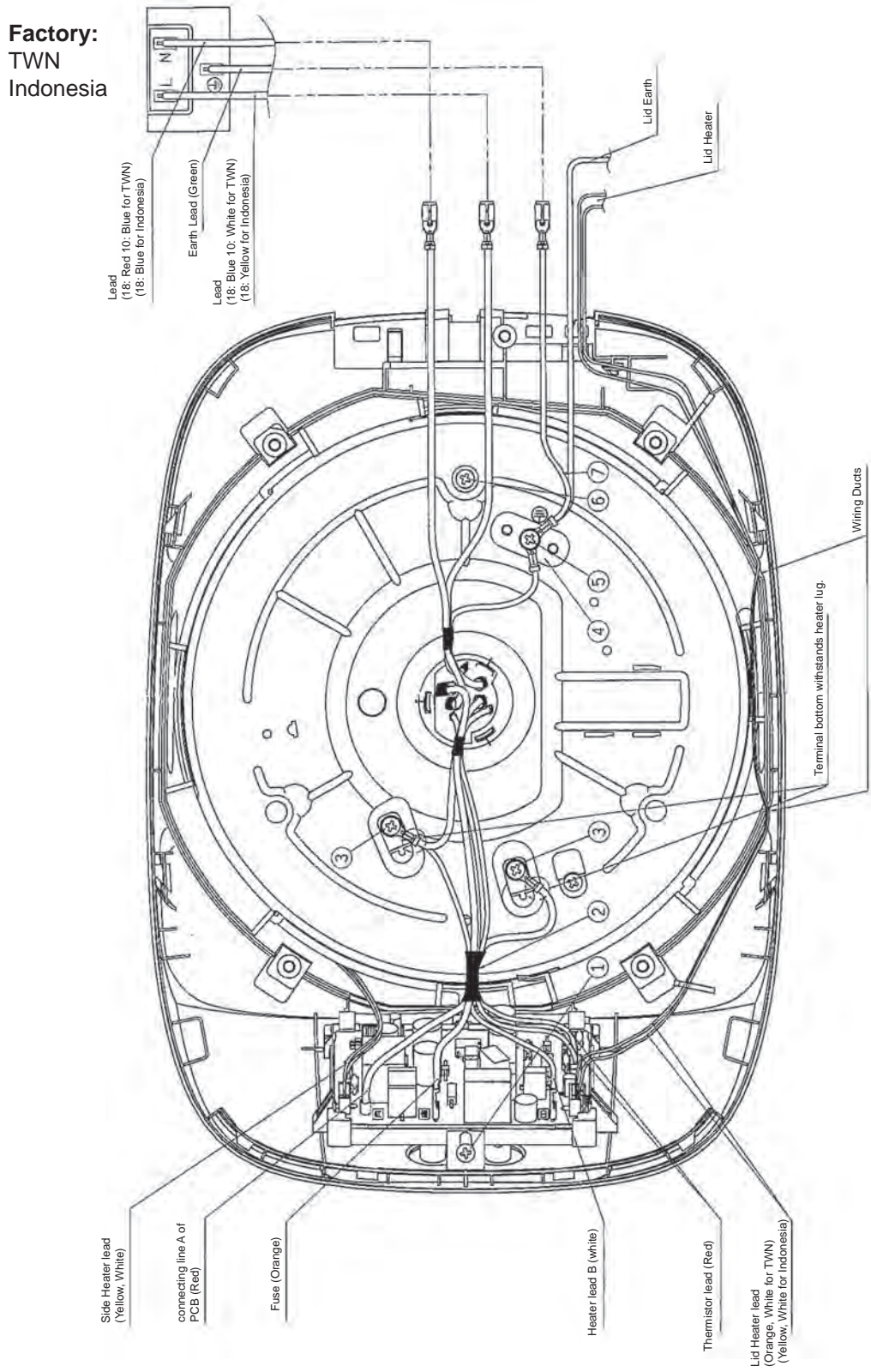

DF181 Wiring Connection Diagram Note: For actual needs, some junctions of the connecting wires of the product are wound with flame retardant tapes. Don't attempt to tear off the tapes unless it is absolutely necessary. And wind the tapes on the initial positions as before after repair.

4 Troubleshooting

When receiving a cooker for service from the user, please check if the product remains intact (e.g. pan, valve for warming, etc.), and ask the user to describe the symptom of the malfunction. Unplug the power cord when carrying out component-level checks.

4.1. Before Problem Diagnosis

- The problem diagnosis table is divided into two sections: Vol. 1 for the cooker's main unit, Vol. 2 for the control circuit board.
- Start diagnostic evaluations with Vol. 1.
- Check if the symptom of the malfunction cooker is listed in the Vol. 1 diagnostic section. If no item is found, perform a quick check test of the control circuit board (refer to P9). If any fault is found, continue the diagnostic evaluation referring to Vol. 2.
- The problem diagnosis table primarily lists suspect component assemblies (parts) and areas.
- Refer to P11 for parts-level determination of malfunctions for each board.

Notes on handling the printed circuit board with microprocessor

The microprocessor is constructed of CMOS digital IC (integrated circuit) and MOS FET (Metal-Oxide-Semiconductor Field-Effect Transistor) technology, and is extremely sensitive to static electricity, including static discharges from human body, clothing, and from objects, including soldering irons. Handling with great care as specified below:

- When handling, workers should be well grounded.
- Ground soldering irons. Do not use poorly insulated soldering irons. It is recommended to use soldering irons with microcircuitry.
- Do not touch the pins of ICs or other elements with your hands before well grounded. Do not place the board on a conductive surface that may be charged.

- Do not insert parts from the reverse side of the board.
- When testing with a multimeter during continuous tests, do not use high resistance ranges ($\times 10,000$), which may subject ICs and other components on the board to excess voltage and thus cause damage.
- Keep soldering time as short as possible (within a few seconds)
- Unplug the power cord before replacing any components.
- Be aware of the risk of electric shock or injury when handling a live control board. The control board's transformer carries 220 V AC.

6 QUICK CHECK TEST OF THE CONTROL BOARD

Before beginning diagnostic evaluation of a problem, perform a quick check test of the control board, as explained below. If anything abnormal, then perform reset operation once (refer to P11)

If still abnormal, please refer to the problem diagnosis table Vol. 2. (P9) and diagnosis methods for defective components (P10), to exchange the parts on P.C.B or control board comp.

1

Connect the unit to a power source. In stand-by mode, using three fingers simultaneously press and hold [Start], [Off], [White Rice] buttons.

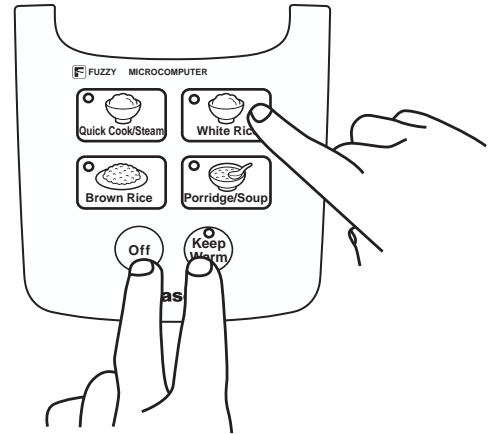

[Figure A]

2

As soon as you release the three buttons, as shown in Fig. B on the right, [Quick Cook/Steam] indicator lights up, and press [Quick Cook/Steam] button.

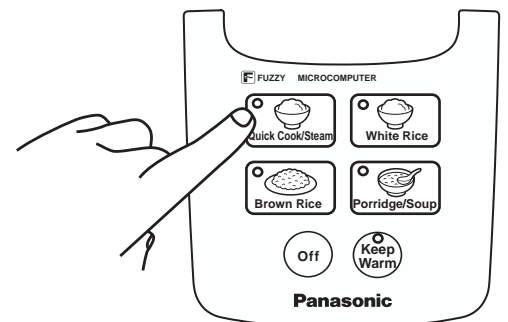

[Figure B]

3

Repeat according to the sequence of:
Quick Cook/Steam indicator lamp
White Rice indicator lamp
indicator lamp for Brown Rice
indicator lamp for Porridge/Soup
Keep Warm indicator lamp

and then the heating becomes the full-power heating mode. When it is heated to the final temperature of cooking, it will automatically shift to constant temperature mode.

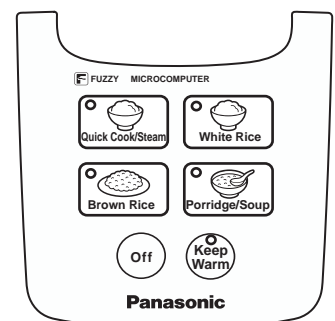

[Figure C]

4

Press [off] button once. Press other buttons and confirm that operation is normal.

After carrying out procedures 1 to 4, if test results are normal, you can conclude that P.C.B.(Comp.) has passed the test.

7 PROBLEM DIAGNOSIS TABLE Vol.2 (for PCB)

		SW	X1	RL											Remarks
Malfunction Symptom	Status of main unit	Control board	Parts on control board												
			Tact switch	Crystal	Relay										
Does not cook rice	COOKING LED lights up.	<input type="radio"/>			<input type="radio"/>										
	COOKING LED does not light up.	<input type="radio"/>	<input type="radio"/>	<input type="radio"/>											
		<input type="radio"/>													
		<input type="radio"/>													
		<input type="radio"/>													
Cannot cook rice correctly. (Stops early or cooking is uneven, etc.)		<input type="radio"/>													
Rice on the bottom of the inner pan is scorched dark brown.		<input type="radio"/>													
Keep Warm temperature is high. (78°C or higher)		<input type="radio"/>													
Keep Warm temperature is low.(68°C or lower)		<input type="radio"/>													
Does not Keep Warm	Keep Warm LED lights up	<input type="radio"/>													
Don't keep warm continuously.		<input type="radio"/>													
Droplets fall onto the surface of the rice.		<input type="radio"/>													
		<input type="radio"/>													
		<input type="radio"/>													
		<input type="radio"/>													

8 Inspection method of components on control board

LED5		
LED		
Detection method	Qualified	Defective
If LED5 lights up when it is short-circuited between TP [G] and [L5]?	Yes	No

SW5		
Tact switch		
Detection method	Qualified	Defective
Hold down SW5 and measure if the resistance between TP [VD] and [S5] is 0 Ω?	Yes	No

SW6		
Tact switch		
Detection method	Qualified	Defective
Hold down SW6 and measure if the resistance between TP [VD] and [S6] is 0 Ω?	Yes	No

X1		
Crystal		
Detection method	Qualified	Defective
Output 8 MHZ between TP [G] and [X1]?	Yes	No

SW4		
Tact switch		
Detection method	Qualified	Defective
Hold down SW 4 and measure if the resistance between TP [VD] and [S4] is 0 Ω?	Yes	No

SW3		
Tact switch		
Detection method	Qualified	Defective
Hold down SW 3 and measure if the resistance between TP [VD] and [S3] is 0 Ω?	Yes	No

LED4		
LED		
Detection method	Qualified	Defective
If LED4 lights up when it is short-circuited between TP [G] and [L4]?	Yes	No

LED3		
LED		
Detection method	Qualified	Defective
If LED3 lights up when it is short-circuited between TP [G] and [L3]?	Yes	No

SW2		
Tact switch		
Detection method	Qualified	Defective
Hold down SW 2 and measure if the resistance between TP [VD] and [S2] is 0 Ω?	Yes	No

SW1		
Tact switch		
Detection method	Qualified	Defective
Hold down SW 1 and measure if the resistance between TP [VD] and [S1] is 0 Ω?	Yes	No

RL		
Relay		
Inspection method	Qualified	Defective
Connect TP[G]-[RL1], and check if the power consumption is the rated cooking power.	Yes	No
Unplug the power and check if the resistance between TP [A1] and [RL5] is ∞ Ω? Note 1: Disconnect the connector CN3 before measuring the resistance. Note 2: Connect one end of TP [A1] to the positive terminal.	Yes	No

LED1		
LED		
Detection method	Qualified	Defective
If LED1 lights up when it is short-circuited between TP [G] and [L1]?	Yes	No

LED2		
LED		
Detection method	Qualified	Defective
If LED2 lights up when it is short-circuited between TP [G] and [L2]?	Yes	No

9 Test Mode

9.1. Bubble test

1. Insert the pan into the cooker entire unit and turn it slightly clockwise and anti-clockwise to place the pan properly on the cast heater.
2. Pour small quantity of water into the pan so that the bottom of the pan is immersed with water and close the outer lid completely.
3. After connecting to power, select "Quick Cook" from [Menu Select] and then press [Start] button.
4. When the water boils, the cooker will blow off steam. When you see the steam, open the lid, and then press the brim of the inner pan firmly to fully touch it to the cast heater. Then check the water bubbling condition.

See the right figures:

- Water bubbles appear at three areas and are distributed evenly around the circle..... Normal
 - Water bubbles are distributed unevenly and not around the circle.....Defective
- The unacceptable result is possibly due to incomplete contact of bottom of pan and the cast heater. So please check the heater surface for foreign substance, and remove them or replace the defective parts (inner pan or cast heater)

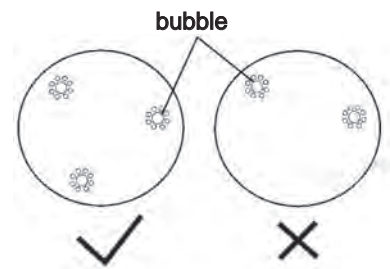

9.2. Keep warm test

1. When it shifts to constant temperature mode, place a mercury thermometer between urethane foam blocks, as indicated in the following picture. Urethane foam blocks (ASN-300) and thermometer (ASN-150H) are supplied as spare parts.
2. Place the urethane foam blocks holding the thermometer in the center of the bottom of the pan, and allow the cooker to run in the Keep Warm process for more than 1 hour.
3. More than one hour later, open the lid and read the temperature within 10 seconds.
The temperature range from 69°C to 77°C..... Normal
If the warming temperature is out of this range, make sure that no dirt or foreign substance is stuck to the pan sensor or on the bottom of the pan.
Remove the dirt or foreign substance if there is any.
Replace the control board if no dirt or foreign substance is found.

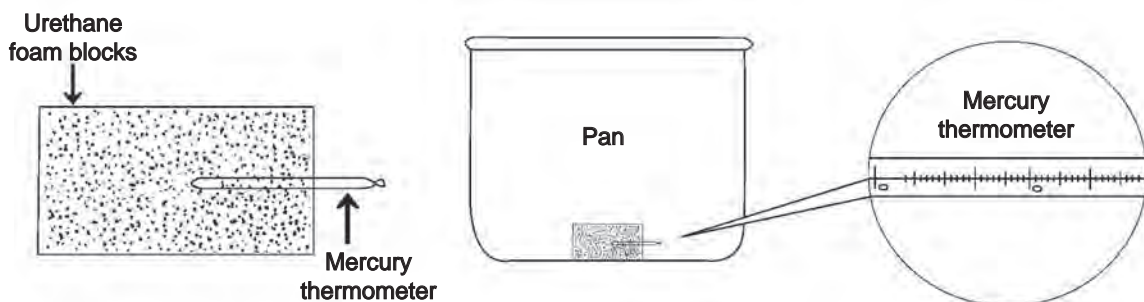

10 The exchange method of PCB for complete control

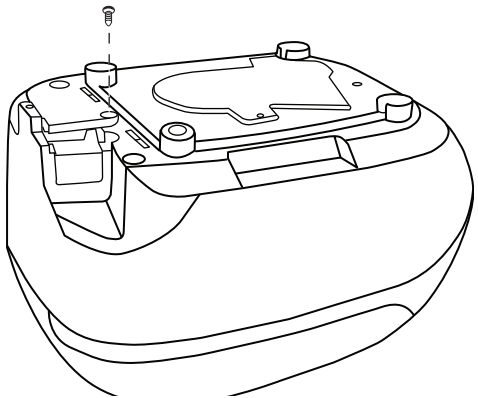
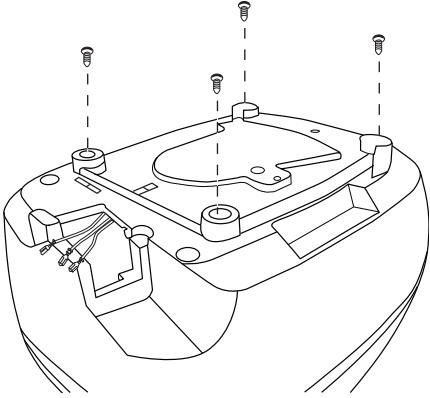
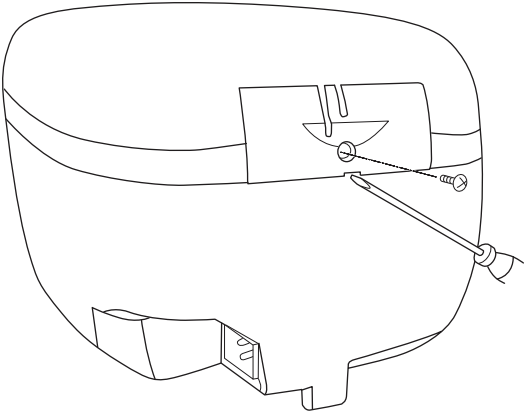
1	Remove terminal for complete power
<ul style="list-style-type: none">• Lay the cooker on a rubber sheet or similar so as not to damage the unit; open the outer lid and make the bottom of the cooker facing upwards (see figure on the right).• Unplug the power cord.• Dismantle the set screw of the outlet cover (x1), take out the outlet cover and complete outlet and outlet box.• Remove the wirings of the power terminal (3 places). 	
2	Remove screw for body
<ul style="list-style-type: none">• Remove screws for body (x4) 	
3	Remove the hinge cover
<ul style="list-style-type: none">• Firstly, remove the fixing screw as shown on the right figure. And then inserts a slotted screwdriver in the crack at the hinge cover and the body.• Using slotted screwdriver as a lever and pry the hinge cover upwards. And separate the hinge cover and the body. 	

4 Remove the body

- Lay the cooker for service on a rubber sheet or similar so as not to damage the unit. Insert the slotted screwdriver 30-40mm upwards as the figure shown.
- Remove the body by applying force on the slotted screwdriver in the direction indicated by the arrow on the right figure.

NOTES:

- Don't tap the slotted screwdriver to remove the body which may cause damage to contact part of screwdriver. The above procedures must be followed.

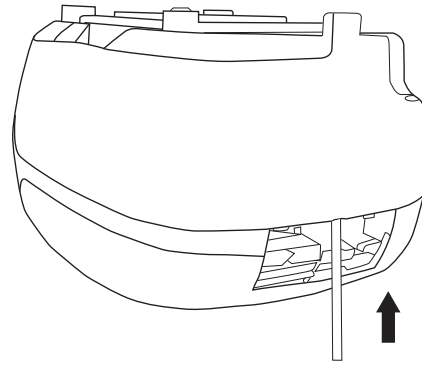

5 Disconnect the wirings on the control board

- Please use needle nose pliers to pull out each connector.
- Use needle nose pliers to pull out fasten terminal (2 places)

NOTES:

- When pulling out the plug or similar, pull directly in the outward direction. If pulling in different directions, it may place pressure on the control board and cause damage to the coil and breakdown of PCB.
- To pull out the fasten terminal, please press down the stopper in the direction of the arrow shown in the figure, and pull outwards at the same time. Otherwise, the fasten terminal couldn't be pulled out.

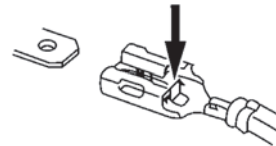

6 Remove the base for control PCB

- Unplug the wiring which connects with the control PCB
- Remove fixing screw (×1).
- Hold the base for PCB and take it out directly.

* For the sake of safety, make sure you wear an ESD-protective wrist strap or take preventive measures.

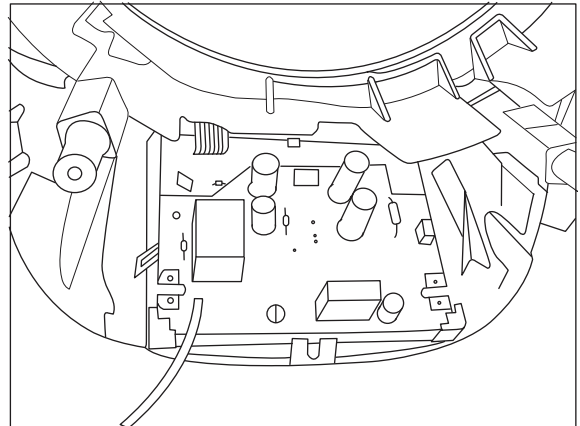

7 Take out the components of control PCB

- Break off the stationary claws slightly, lift up the control PCB (operation parts) and take them out.
- Use the same method to remove control PCB (power parts) and take it out.

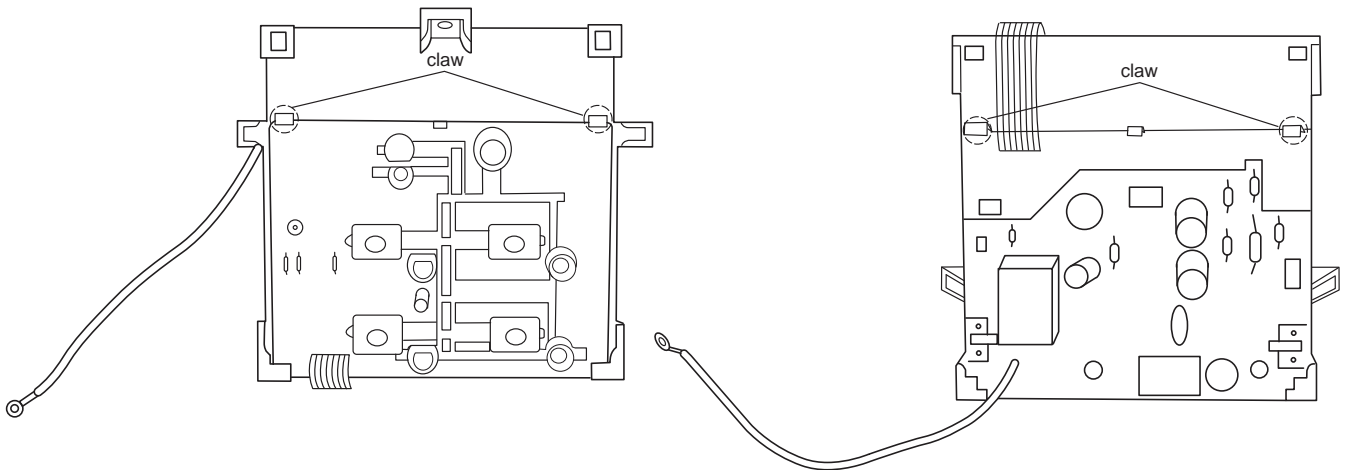

8 Assembly of base for control PCB

- Reassemble the base of PCB for complete power in reverse order for disassembly.

NOTES:

- Refer to P5 for wiring connection.
- When assembling, make sure to paste the flame retardant tape on the initial position as before.

11 The exchange method of cast heater

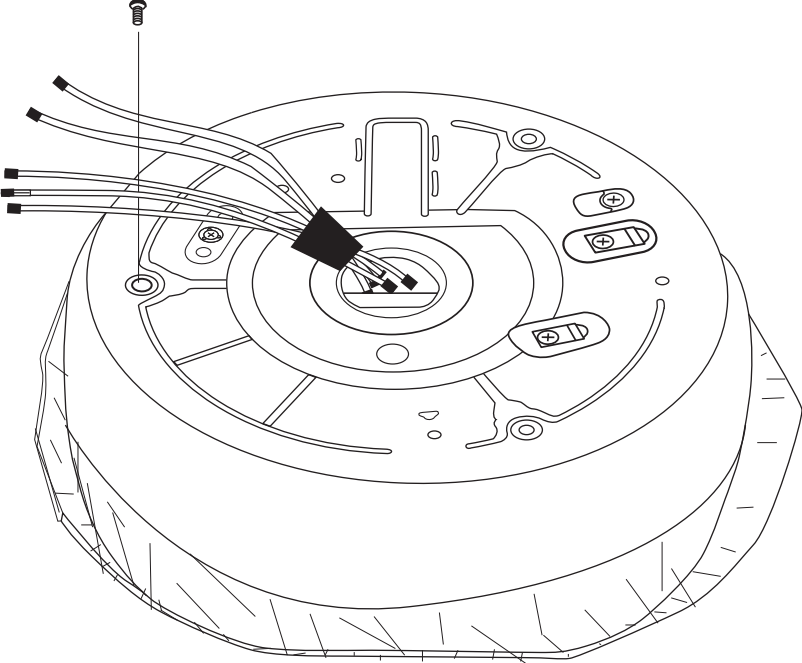
1	Remove terminal for complete power and body
<ul style="list-style-type: none">Refer to the exchange method of base for control PCB (See item 1 to 4, P13), remove the terminal and body.	
2	Remove the cast heater
<ul style="list-style-type: none">Remove the fixing screws (x2) of cast heater.Take out the cast heater from inner enclosure. 	
2	Reassembly
<ul style="list-style-type: none">Reassemble the new cast heater in reverse order for disassembly.	
<p>NOTES:</p> <ul style="list-style-type: none">Refer to P5 for wiring connection.When assembling, make sure to paste the flame retardant tape on the initial position as before.	

12 The exchange method of pan sensor and thermal fuse

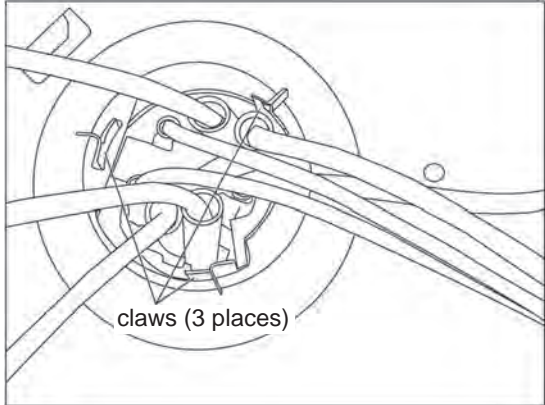
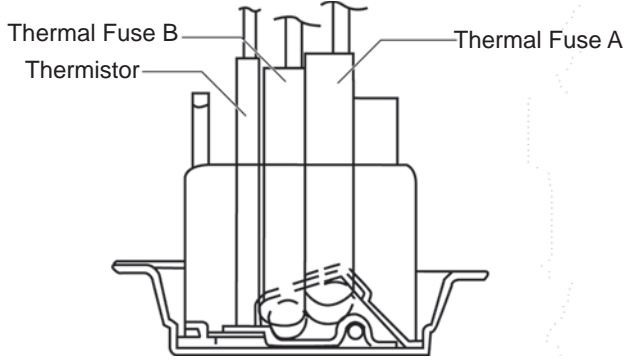
1	Remove the cast heater
<ul style="list-style-type: none">To remove the cast heater, please refer to “The exchange method of cast heater” (Item 1 to 3, P16).	
2	Remove pan sensor
<ul style="list-style-type: none">Loosen and stretch out the claws (3 places) and take out the pan sensor. <p>NOTES:</p> <ul style="list-style-type: none">Care must be taken to avoid the spring for sensor from deformation when removing. 	
3	Exchange thermal fuse
<ul style="list-style-type: none">The replacement of pan sensor is the exchange of thermal fuse A/B. This is because the thermal fuse A/B are both fixed within the pan sensor. 	
4	Reassembly
<ul style="list-style-type: none">Reassemble the new pan sensor in reverse order for disassembly. <p>NOTES:</p> <ul style="list-style-type: none">Care must be taken to avoid the spring for sensor from deformation when reassembling.Care must be taken to avoid the spring for sensor from tilting when reassembling.Refer to P5 for wiring connection.Please note the direction of pan sensor.	

13 Exploded View

Factory:
TWN
Indonesia

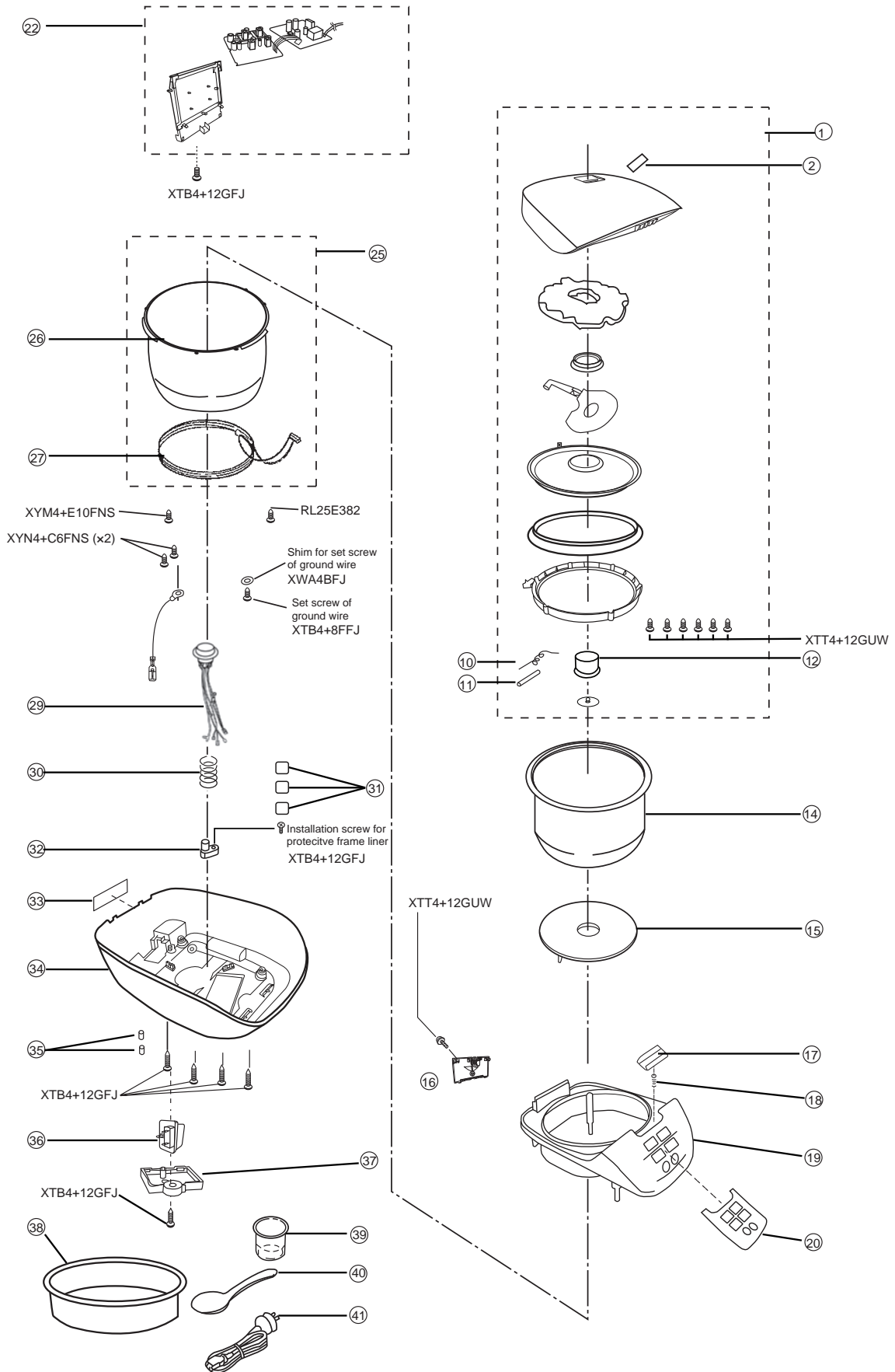

13 Exploded View

Factory:
 HongKong
 Singapore RBD
 Singapore DBD
 Oceania
 India
 Viet Nam
 Malaysia
 Thailand
 Latin America
 Brazil
 Peru
 USA
 RUS

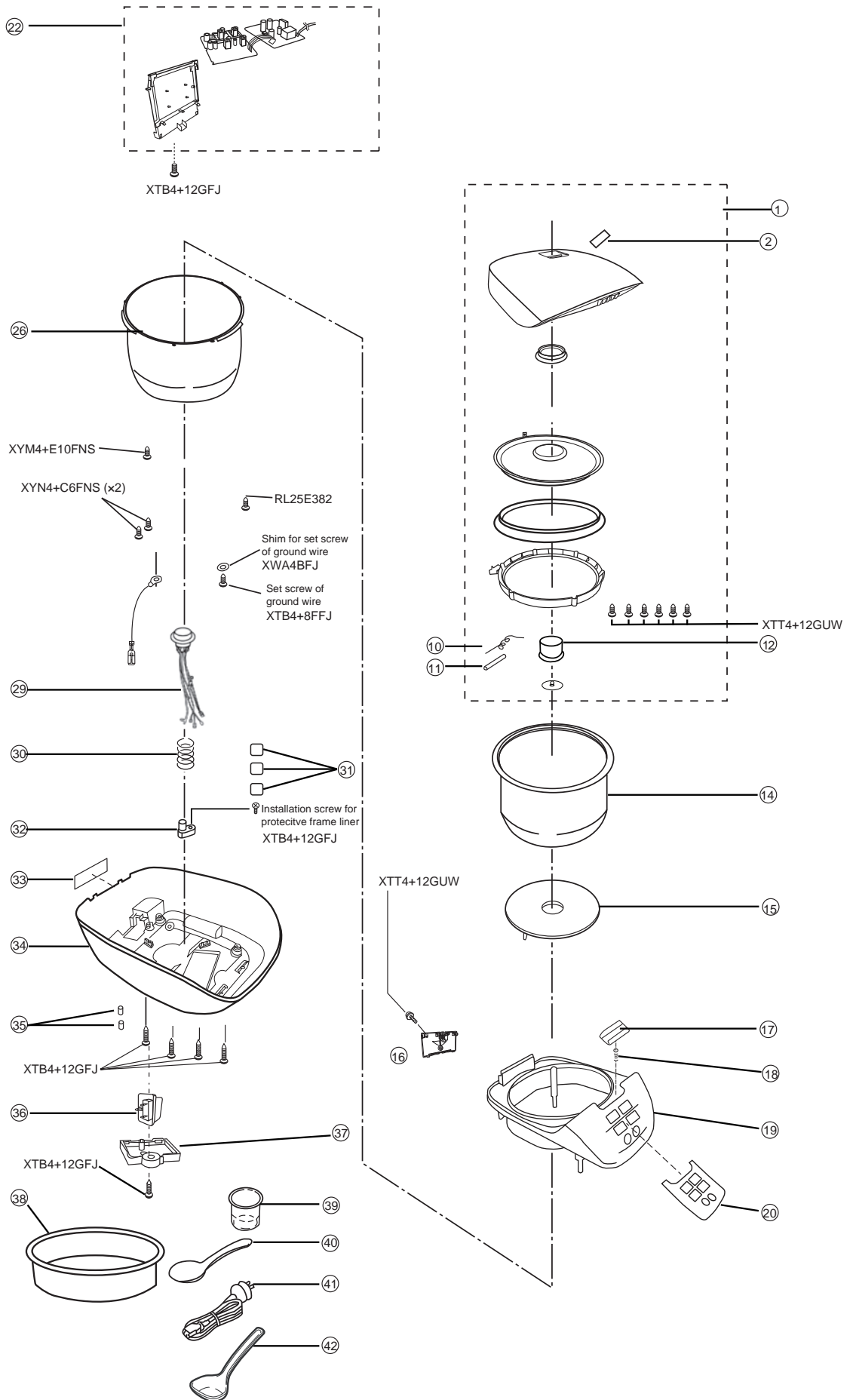

14 Replacement Part List

NOTE: Important safety Notice

Parts market with \triangle symbol have very important safety features.

Use only the spare parts designated by manufacturer for replacement of such components

MODEL NO:SR-DF101,DF181

Ref No.	safety	Part No.	Part Name	Latin America		Brazil		Peru		Remarks
				DF101	DF181	DF101	DF181	DF101	DF181	
1	\triangle	ARB01BE50WQU	outer lid comp.	1	1	1	1			
		ARB01PE52WQU	outer lid comp.					1	1	
2	\triangle	ARB32BE50	caution label	1	1					
		ARB32BE54	caution label			1	1			
		ARB32PE52	caution label					1	1	
10		ARB70ED94	spring for hing	1	1	1	1	1	1	
11		ARB74E7692	shaft for hinge	1	1	1	1	1	1	
12		ARB45ED40-JU	valve for warming	1	1	1	1	1	1	
14		ARE50HE36	pan		1		1		1	
		ARE50HE37	pan	1		1		1		
15	\triangle	ARL20BE5000U	cast heater	1	1					
		ARL20BE5400U	cast heater			1	1			
		ARL20ED9400U	cast heater					1	1	
16		ARE40ED941WQ	hinge cover	1	1	1	1	1	1	
17		ARE05ED941WQ	hook lever	1	1	1	1	1	1	
18		ARE06EA29	spring for hook lever	1	1	1	1	1	1	
19		ARE00ED94WQU	upper frame	1	1	1	1	1	1	
20		ARN21BE50-LN	lable A		1				1	
		ARN21BE51-LN	lable A	1				1		
		ARN21BE54-LN	lable A				1			
		ARN21BE55-LN	lable A			1				
22	\triangle	ARH01BE5000U	PCB comp.	1	1	1	1			
		ARH01TE3400U	PCB comp.					1	1	
26		ARE20ED9400U	inner enclosure		1		1		1	
		ARE20ED9600U	inner enclosure	1		1		1		
29	\triangle	ARS10TE4500U	pan sensor	1	1					
		ARS10ED9400U	pan sensor			1	1	1	1	
30		ARS61-783	spring for sensor	1	1	1	1	1	1	
31		ARH92ED37	support for inner enclosure	3	3	3	3	3	3	
32		ARE42ED94	buau ofr inner enclosure	1	1	1	1	1	1	
33		ARY00BE501LN	name plate		1					
		ARY00BE511LN	name plate	1						
		ARY00BE541LN	name plate				1			
		ARY00BE551LN	name plate			1				
		ARY00PE521LN	name plate						1	
34		ARE10ED94-WQ	body		1		1		1	
		ARE10ED96-WQ	body	1		1		1		
35		ARH90ED94	cushion	2	2	2	2	2	2	
36	\triangle	ARG10EB1000U	terminal	1	1	1	1	1	1	
37		ARF27ED94	cover for terminal	1	1	1	1	1	1	
38		ARK53ED94-W9	steam basket	1	1	1	1	1	1	
39		ARK06ED37	measuring cup	1	1	1	1	1	1	
40		ARK02ED37-WQ	rice scoop	1	1	1	1	1	1	
41	\triangle	ARQ00BE5000U	AC cord	1	1					
		ARQ00BE5400U	AC cord			1	1			
		ARQ00PE5200U	AC cord					1	1	

SCREW

		XTB4+12GFJ	Screw For PCB Base	1	1	1	1	1	1	
		XTB4+12GFJ	Screw For Body	4	4	4	4	4	4	
		XTT4+12GUW	Screw For Hinge	1	1	1	1	1	1	
		XYM4+E10FNS	Screw For Cast Heater	1	1	1	1	1	1	
		XYN4+C6FNS	Screw For Lead	2	2	2	2	2	2	
		XYA4+EF8FJ	Screw For Earth	1	1	1	1	1	1	
		XTT4+12GUW	Screw For Inner Cover	6	6	6	6	6	6	
		XTB4+12GFJ	Screw For Terminal	1	1	1	1	1	1	
		ARL25E382	Screw	1	1	1	1	1	1	

PACKING SPECIFICATIONS

		ARZ01BE501LN	Outer Carton		1					
		ARZ01BE511LN	Outer Carton	1						
		ARZ01BE541LN	Outer Carton				1			
		ARZ01BE551LN	Outer Carton			1				
		ARZ01PE521LN	Outer Carton						1	
		ARZ01PE531LN	Outer Carton					1		
		ARZ04ED9400U	Top Filler	1	1	1	1	1	1	
		ARZ11ED9400U	Bottom Filler	1	1	1	1	1	1	
	△	ARZ19BE501	Operating Instructions	1	1					
		ARZ19BE541	Operating Instructions			1	1			
		ARZ19PE521	Operating Instructions					1	1	
		ARZ75E382	Plastic Bag	1	1	1	1	1	1	
		ARZ57E7227	Packing Sheet	1	1	1	1	1	1	

14 Replacement Part List

NOTE: Important safety Notice

Parts market with \triangle symbol have very important safety features.

Use only the spare parts designated by manufacturer for replacement of such components

MODEL NO:SR-DF101,DF181

Ref No.	safety	Part No.	Part Name	Viet Nam		Singapore DBD		Thailand		Remarks
				DF101	DF181	DF101	DF181	DF101	DF181	
1	\triangle	ARB01VE41WQU	outer lid comp.	1	1					
		ARB01HE36WQU	outer lid comp.			1	1			
		ARB01TE34WQU	outer lid comp.					1	1	
2	\triangle	ARB32VE41	caution label	1	1					
		ARB32H487	caution label			1	1			
		ARB32TE34	caution label					1	1	
10		ARB70ED94	spring for hing	1	1	1	1	1	1	
11		ARB74E7692	shaft for hinge	1	1	1	1	1	1	
12		ARB45ED40-JU	valve for warming	1	1	1	1	1	1	
14		ARE50HE36	pan		1		1		1	
		ARE50HE37	pan	1		1		1		
15	\triangle	ARL20ED9400U	cast heater	1	1			1	1	
		ARL20SE3800U	cast heater			1	1			
16		ARE40ED941WQ	hinge cover	1	1	1	1	1	1	
17		ARE05ED941WQ	hook lever	1	1	1	1	1	1	
18		ARE06EA29	spring for hook lever	1	1	1	1	1	1	
19		ARE00ED94WQU	upper frame	1	1	1	1	1	1	
20		ARN21HE36-GR	lable A		1		1			
		ARN21HE36-LN	lable A		1		1			
		ARN21HE37-GR	lable A	1		1				
		ARN21HE37-LN	lable A	1		1				
		ARN21TE34-GR	lable A						1	
		ARN21TE34-LN	lable A						1	
22	\triangle	ARH01TE3400U	PCB comp.	1	1			1	1	
		ARH01HE3600U	PCB comp.			1	1			
26		ARE20ED9400U	inner enclosure		1		1		1	
		ARE20ED9600U	inner enclosure	1		1		1		
29	\triangle	ARS10ED9400U	pan sensor	1	1	1	1	1	1	
30		ARS61-783	spring for sensor	1	1	1	1	1	1	
31		ARH92ED37	support for inner enclosure	3	3	3	3	3	3	
32		ARE42ED94	buau ofr inner enclosure	1	1	1	1	1	1	
33		ARY00VE411CR	name plate		1					
		ARY00VE411LN	name plate		1					
		ARY00VE421CR	name plate	1						
		ARY00VE421LN	name plate	1						
		ARY00SE381CR	name plate				1			
		ARY00SE381LN	name plate				1			
		ARY00SE391CR	name plate			1				
		ARY00SE391LN	name plate			1				
		ARY00TE341CR	name plate						1	
34		ARE10ED94-WQ	body		1		1		1	
		ARE10ED96-WQ	body	1		1		1		
35		ARH90ED94	cushion	2	2	2	2	2	2	
36	\triangle	ARG10EB1000U	terminal	1	1	1	1	1	1	
37		ARF27ED94	cover for terminal	1	1	1	1	1	1	
38		ARK53ED94-W9	steam basket	1	1	1	1	1	1	
39		ARK06ED37	measuring cup	1	1	1	1	1	1	
40		ARK02ED37-WQ	rice scoop	1	1	1	1	1	1	
41	\triangle	ARQ00VE4000U	AC cord	1	1					
		ARQ00SE3800U	AC cord			1	1			
		ARQ00TE3400U	AC cord					1	1	

SCREW

	XTB4+12GFJ	Screw For PCB Base	1	1	1	1	1	1	1
	XTB4+12GFJ	Screw For Body	4	4	4	4	4	4	4
	XTT4+12GUW	Screw For Hinge	1	1	1	1	1	1	1
	XYM4+E10FNS	Screw For Cast Heater	1	1	1	1	1	1	1
	XYN4+C6FNS	Screw For Lead	2	2	2	2	2	2	2
	XYA4+EF8FJ	Screw For Earth	1	1	1	1	1	1	1
	XTT4+12GUW	Screw For Inner Cover	6	6	6	6	6	6	6
	XTB4+12GFJ	Screw For Terminal	1	1	1	1	1	1	1
	ARL25E382	Screw	1	1	1	1	1	1	1

PACKING SPECIFICATIONS

	ARZ01VE412CR	Outer Carton		1					
	ARZ01VE412LN	Outer Carton		1					
	ARZ01VE42-CR	Outer Carton	1						
	ARZ01VE42-LN	Outer Carton	1						
	ARZ01SE382CR	Outer Carton				1		1	
	ARZ01SE382LN	Outer Carton				1		1	
	ARZ01SE392LN	Outer Carton			1		1		
	ARZ04ED9400U	Top Filler	1	1	1	1	1	1	1
	ARZ11ED9400U	Bottom Filler	1	1	1	1	1	1	1
	△ ARZ19VE411	Operating Instructions	1	1					
	ARZ19SE381	Operating Instructions			1	1			
	ARZ19TE431	Operating Instructions					1	1	
	ARZ25VE41	Interleaf	1	1					
	ARZ75E382	Plastic Bag	1	1	1	1	1	1	1
	ARZ57E7227	Packing Sheet	1	1	1	1	1	1	1

14 Replacement Part List

NOTE: Important safety Notice

Parts market with \triangle symbol have very important safety features.

Use only the spare parts designated by manufacturer for replacement of such components

MODEL NO:SR-DF101,DF181

Ref No.	safety	Part No.	Part Name	Oceania		Malaysia		Remarks
				DF101	DF181	DF101	DF181	
1	\triangle	ARB01HE36WQU	outer lid comp.	1	1	1	1	
2	\triangle	ARB32H487	caution label	1	1	1	1	
10		ARB70ED94	spring for hing	1	1	1	1	
11		ARB74E7692	shaft for hinge	1	1	1	1	
12		ARB45ED40-JU	valve for warming	1	1	1	1	
14		ARE50HE36	pan		1		1	
		ARE50HE37	pan	1		1		
15	\triangle	ARL20ME4300U	cast heater	1	1	1	1	
16		ARE40ED941WQ	hinge cover	1	1	1	1	
17		ARE05ED941WQ	hook lever	1	1	1	1	
18		ARE06EA29	spring for hook lever	1	1	1	1	
19		ARE00ED94WQU	upper frame	1	1	1	1	
20		ARN21HE36-GR	lable A				1	
		ARN21HE36-LN	lable A		1		1	
		ARN21HE37-LN	lable A	1		1		
22	\triangle	ARH01TE3400U	PCB comp.	1	1			
		ARH01HE3600U	PCB comp.			1	1	
26		ARE20ED9400U	inner enclosure		1		1	
		ARE20ED9600U	inner enclosure	1		1		
29	\triangle	ARS10ED9400U	pan sensor	1	1	1	1	
30		ARS61-783	spring for sensor	1	1	1	1	
31		ARH92ED37	support for inner enclosure	3	3	3	3	
32		ARE42ED94	buan ofr inner enclosure	1	1	1	1	
33		ARY00RE561LN	name plate		1			
		ARY00RE571LN	name plate	1				
		ARY00ME431CR	name plate				1	
		ARY00ME431LN	name plate				1	
		ARY00ME441LN	name plate			1		
34		ARE10ED94-WQ	body		1		1	
		ARE10ED96-WQ	body	1		1		
35		ARH90ED94	cushion	2	2	2	2	
36	\triangle	ARG10EB1000U	terminal	1	1	1	1	
37		ARF27ED94	cover for terminal	1	1	1	1	
38		ARK53ED94-W9	steam basket	1	1	1	1	
39		ARK06ED37	measuring cup	1	1	1	1	
40		ARK02ED37-WQ	rice scoop	1	1	1	1	
41	\triangle	ARQ00RE5600U	AC cord	1	1			
		ARQ00ME4300U	AC cord			1	1	

SCREW

SCREW								
		XTB4+12GFJ	Screw For PCB Base	1	1	1	1	
		XTB4+12GFJ	Screw For Body	4	4	4	4	
		XTT4+12GUW	Screw For Hinge	1	1	1	1	
		XYM4+E10FNS	Screw For Cast Heater	1	1	1	1	
		XYN4+C6FNS	Screw For Lead	2	2	2	2	
		XYA4+EF8FJ	Screw For Earth	1	1	1	1	
		XTT4+12GUW	Screw For Inner Cover	6	6	6	6	
		XTB4+12GFJ	Screw For Terminal	1	1	1	1	
		ARL25E382	Screw	1	1	1	1	

PACKING SPECIFICATIONS							
		ARZ01SE382CR	Outer Carton		1		1
		ARZ01SE382LN	Outer Carton		1		1
		ARZ01SE392LN	Outer Carton	1		1	
		ARZ04ED9400U	Top Filler	1	1	1	1
		ARZ11ED9400U	Bottom Filler	1	1	1	1
	△	ARZ19RE561	Operating Instructions	1	1		
		ARZ19ME431	Operating Instructions			1	1
		ARZ25ME43	Interleaf			1	1
		ARZ75E382	Plastic Bag	1	1	1	1
		ARZ57E7227	Packing Sheet	1	1	1	1

14 Replacement Part List

NOTE: Important safety Notice

Parts market with Δ symbol have very important safety features.

Use only the spare parts designated by manufacturer for replacement of such components
MODEL NO:SR-DF101,DF181

Ref No.	safety	Part No.	Part Name	TWN		Indonesia	Remarks
				DF101	DF181	DF181	
1	Δ	ARB01TE45WQU	outer lid comp.	1	1		
		ARB01LE47WQU	outer lid comp.			1	
2	Δ	ARB32TC66-K0	caution label	1	1		
		ARB32LE47	caution label			1	
10		ARB70ED94	spring for hing	1	1	1	
11		ARB74E7692	shaft for hinge	1	1	1	
12		ARB45ED40-JU	valve for warming	1	1	1	
14		ARE50HE36	pan		1	1	
		ARE50HE37	pan	1			
15	Δ	ARL20TE4500U	cast heater	1	1		
		ARL20ED9400U	cast heater			1	
16		ARE40ED941WQ	hinge cover	1	1	1	
17		ARE05ED941WQ	hook lever	1	1	1	
18		ARE06EA29	spring for hook lever	1	1	1	
19		ARE00ED94WQU	upper frame	1	1	1	
20		ARN21TE45-LN	lable A		1		
		ARN21TE46-LN	lable A	1			
		ARN21HE36-LN	lable A			1	
22	Δ	ARH01TE4500U	PCB comp.	1	1		
		ARH01LE4700U	PCB comp.			1	
25	Δ	ARE20TE4500U	inner enclosure comp.		1		
		ARE20TE4600U	inner enclosure comp.	1			
		ARE20LE4700U	inner enclosure comp.			1	
26		ARE20ED94	inner enclosure		1	1	
		ARE20ED96	inner enclosure	1			
27	Δ	ARL10TE4500U	warming heater	1	1		
		ARL10LE4700U	warming heater			1	
29	Δ	ARS10TE4500U	pan sensor	1	1		
		ARS10ED9400U	pan sensor			1	
30		ARS61-783	spring for sensor	1	1	1	
31		ARH92ED37	support for inner enclosure	3	3		
		ARH92ED37	support for inner enclosure			3	
32		ARE42ED94	buan ofr inner enclosure	1	1		
		ARE42ED94	buan ofr inner enclosure			1	
33		ARY00TE45-LN	name plate		1		
		ARY00TE46-LN	name plate	1			
		ARY00LE47-LN	name plate			1	
34		ARE10ED94-WQ	body		1	1	
		ARE10ED96-WQ	body	1			
35		ARH90ED94	cushion	2	2	2	
36	Δ	ARG10EB1000U	terminal	1	1	1	
37		ARF27ED94	cover for terminal	1	1	1	
38		ARK53ED94-W9	steam basket	1	1	1	
39		ARK06ED37	measuring cup	1	1	1	
40		ARK02ED37-WQ	rice scoop	1	1	1	
41	Δ	ARQ21TA5500U	AC cord	1	1		
		ARQ00VE4000U	AC cord			1	

SCREW

		XTB4+12GFJ	Screw For PCB Base	1	1	1	
		XTB4+12GFJ	Screw For Body	4	4	4	
		XTT4+12GUW	Screw For Hinge	1	1	1	
		XYM4+E10FNS	Screw For Cast Heater	1	1	1	
		XYN4+C6FNS	Screw For Lead	2	2	2	
		XYA4+EF8FJ	Screw For Earth	1	1	1	
		XTT4+12GUW	Screw For Inner Cover	6	6	6	
		XTB4+12GFJ	Screw For Terminal	1	1	1	
		ARL25E382	Screw	1	1	1	

PACKING SPECIFICATIONS						
		ARZ01TE451LN	Outer Carton		1	
		ARZ01TE461LN	Outer Carton	1		
		ARZ01LE471LN	Outer Carton			1
		ARZ04ED9400U	Top Filler	1	1	1
		ARZ11ED9400U	Bottom Filler	1	1	1
	△	ARZ19TE451	Operating Instructions	1	1	
		ARZ19LE471	Operating Instructions			1
		ARZ25TE46	Interleaf	1	1	
		ARZ25LE47	Interleaf			1
		ARZ75E382	Plastic Bag	1	1	1
		ARZ57E7227	Packing Sheet	1	1	1

14 Replacement Part List

NOTE: Important safety Notice

Parts market with \triangle symbol have very important safety features.

Use only the spare parts designated by manufacturer for replacement of such components

MODEL NO:SR-DF101,DF181

Ref No.	safety	Part No.	Part Name	HongKong		Singapore RBD	India		Remarks
				DF101	DF181	DF181	DF101	DF181	
1	\triangle	ARB01HE36WQU	outer lid comp.	1	1	1	1	1	
2	\triangle	ARB32H487	caution label	1	1	1	1	1	
10		ARB70ED94	spring for hing	1	1	1	1	1	
11		ARB74E7692	shaft for hinge	1	1	1	1	1	
12		ARB45ED40-JU	valve for warming	1	1	1	1	1	
14		ARE50HE36	pan		1	1		1	
		ARE50HE37	pan	1			1		
15	\triangle	ARL20ED9400U	cast heater	1	1	1			
		ARL20SE3800U	cast heater				1	1	
16		ARE40ED941WQ	hinge cover	1	1	1	1	1	
17		ARE05ED941WQ	hook lever	1	1	1	1	1	
18		ARE06EA29	spring for hook lever	1	1	1	1	1	
19		ARE00ED94WQU	upper frame	1	1	1	1	1	
20		ARN21HE36-GR	lable A		1	1			
		ARN21HE36-LN	lable A		1	1		1	
		ARN21HE37-GR	lable A	1					
		ARN21HE37-LN	lable A	1			1		
22	\triangle	ARH01HE3600U	PCB comp.	1	1				
		ARH01TE3400U	PCB comp.			1			
		ARH01DE4800U	PCB comp.				1	1	
26		ARE20ED9400U	inner enclosure		1	1		1	
		ARE20ED9600U	inner enclosure	1			1	1	
29	\triangle	ARS10ED9400U	pan sensor	1	1	1	1	1	
30		ARS61-783	spring for sensor	1	1	1	1	1	
31		ARH92ED37	support for inner enclosure	3	3	3	3	3	
32		ARE42ED94	buan ofr inner enclosure	1	1	1	1	1	
33		ARY00HE361CR	name plate		1				
		ARY00HE361LN	name plate		1				
		ARY00HE371CR	name plate	1					
		ARY00HE371LN	name plate	1					
		ARY00VE401CR	name plate			1			
		ARY00VE401LN	name plate			1			
		ARY00DE481LN	name plate					1	
34		ARE10ED94-WQ	body		1	1		1	
		ARE10ED96-WQ	body	1			1		
35		ARH90ED94	cushion	2	2	2	2	2	
36	\triangle	ARG10EB1000U	terminal	1	1	1	1	1	
37		ARF27ED94	cover for terminal	1	1	1	1	1	
38		ARK53ED94-W9	steam basket	1	1	1	1	1	
39		ARK06ED37	measuring cup	1	1	1	1	1	
40		ARK02ED37-WQ	rice scoop	1	1	1	1	1	
41	\triangle	ARQ00HD2100U	AC cord	1	1				
		ARQ00VE4000U	AC cord			1			
		ARQ00DE4800U	AC cord				1	1	

SCREW

		XTB4+12GFJ	Screw For PCB Base	1	1	1	1	1	
		XTB4+12GFJ	Screw For Body	4	4	4	4	4	
		XTT4+12GUW	Screw For Hinge	1	1	1	1	1	
		XYM4+E10FNS	Screw For Cast Heater	1	1	1	1	1	
		XYN4+C6FNS	Screw For Lead	2	2	2	2	2	
		XYA4+EF8FJ	Screw For Earth	1	1	1	1	1	
		XTT4+12GUW	Screw For Inner Cover	6	6	6	6	6	
		XTB4+12GFJ	Screw For Terminal	1	1	1	1	1	
		ARL25E382	Screw	1	1	1	1	1	

PACKING SPECIFICATIONS

		ARZ01HE362CR	Outer Carton		1				
		ARZ01HE362LN	Outer Carton		1				
		ARZ01HE372CR	Outer Carton	1					
		ARZ01HE372CR	Outer Carton	1					
		ARZ01SE382CR	Outer Carton			1			
		ARZ01SE382LN	Outer Carton			1		1	
		ARZ01SE392LN	Outer Carton				1		
		ARZ04ED9400U	Top Filler	1	1	1	1	1	
		ARZ11ED9400U	Bottom Filler	1	1	1	1	1	
	△	ARZ19HE361	Operating Instructions	1	1				
		ARZ19VE40	Operating Instructions			1			
		ARZ19ED481	Operating Instructions				1	1	
		ARZ25HD21	Interleaf	1	1				
		ARZ75E382	Plastic Bag	1	1	1	1	1	
		ARZ57E7227	Packing Sheet	1	1	1	1	1	

14 Replacement Part List

NOTE: Important safety Notice

Parts market with \triangle symbol have very important safety features.

Use only the spare parts designated by manufacturer for replacement of such components

MODEL NO:SR-DF101,DF181

Ref No.	safety	Part No.	Part Name	USA		RUS	Remarks
				DF181	DF101	DF101	
1	\triangle	ARB01AF12WQU	outer lid comp.	1	1		
		ARB01FF43WQU	outer lid comp.			1	
2	\triangle	ARB32AF12	caution label	1	1		
		ARB32FF43	caution label			1	
10		ARB70ED94	spring for hing	1	1	1	
11		ARB74E7692	shaft for hinge	1	1	1	
12		ARB45ED40-JU	valve for warming	1	1	1	
14		ARE50HE36	pan	1			
		ARE50HE37	pan		1		
		ARE50FF43	pan			1	
15	\triangle	ARL20BE5000U	cast heater	1	1		
		ARL20ED9400U	cast heater			1	
16		ARE40ED941WQ	hinge cover	1	1	1	
17		ARE05ED941WQ	hook lever	1	1	1	
18		ARE06EA29	spring for hook lever	1	1	1	
19		ARE00ED94WQU	upper frame	1	1	1	
20		ARN21HE36-LN	lable A	1			
		ARN21HE37-LN	lable A		1		
		ARN21FF43-LN	lable A			1	
22	\triangle	ARH01AF1200U	PCB comp.	1	1		
		ARH01FF4300U	PCB comp.			1	
26		ARE20ED941	inner enclosure	1			
		ARE20ED961	inner enclosure		1		
		ARE20ED9600U	inner enclosure			1	
29	\triangle	ARS10AF1200U	pan sensor	1	1		
		ARS10ED9600U	pan sensor			1	
30		ARS61-783	spring for sensor	1	1	1	
31		ARH92ED37	support for inner enclosure	3	3	3	
32		ARE42ED94	buan for inner enclosure	1	1	1	
33		ARY00AF12-LN	name plate	1			
		ARY00AF13-LN	name plate		1		
		ARY00FF43-LN	name plate			1	
34		ARE10ED94-WQ	body	1			
		ARE10ED96-WQ	body		1	1	
35		ARH90ED94	cushion	2	2	2	
36	\triangle	ARG10AF1200U	terminal	1	1		
		ARG10EB1000U	terminal			1	
37		ARF27ED94	cover for terminal	1	1	1	
38		ARK53ED94-W9	steam basket	1	1	1	
39		ARK06ED37	measuring cup	1	1	1	
40		ARK02ED37-WQ	rice scoop	1	1		
41	\triangle	ARQ24AF1200U	AC cord	1	1		
		ARQ00VE4000U	AC cord			1	
42		ARK16ED37-WQ	Soup Scoop			1	

SCREW

				USA	USA	RUS	
				DF181	DF101	DF101	
		XTB4+12GFJ	Screw For PCB Base	1	1	1	
		XTB4+12GFJ	Screw For Body	4	4	4	
		XTT4+12GUW	Screw For Hinge	1	1	1	
		XYM4+E10FNS	Screw For Cast Heater	1	1	1	
		XYN4+C6FNS	Screw For Lead	2	2	2	
		XYA4+EF8FJ	Screw For Earth	1	1	1	
		XTT4+12GUW	Screw For Inner Cover	6	6	6	
		XTB4+12GFJ	Screw For Terminal	1	1	1	
		ARL25E382	Screw	1	1	1	

PACKING SPECIFICATIONS

		ARZ01AF12-LN	Outer Carton	1			
		ARZ01AF13-LN	Outer Carton		1		
		ARZ01FF43-LN	Outer Carton			1	
		ARZ04ED9400U	Top Filler	1	1	1	
		ARZ11ED9400U	Bottom Filler	1	1	1	
	△	ARZ19AF12	Operating Instructions	1	1		
		ARZ19FF43	Operating Instructions			1	
		ARZ25FF43	Interleaf			1	
		ARZ75E382	Plastic Bag	1	1	1	
		ARZ57E7227	Packing Sheet	1	1	1	
		ARZ80HD21	POS Label			1	