



Display Warmers

Models DW-CN-0076, 0096, 0136, 0186

Items 44437, 40003, 39999, 44438

Instruction Manual



Revised - 10/10/2019

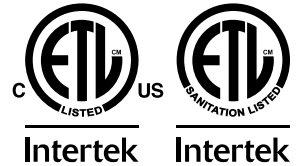

Toll Free: 1-800-465-0234
Fax: 905-607-0234
Email: service@omcan.com
www.omcan.com

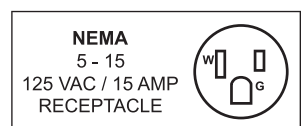

Table of Contents

Model DW-CN-0076 / Model DW-CN-0096
Model DW-CN-0136 / Model DW-CN-0186

Section	Page
General Information -----	3 - 4
Safety and Warranty -----	4 - 6
Technical Specifications -----	6
Installation -----	7
Operation -----	7
Maintenance -----	7 - 8
Parts Breakdown -----	9 - 16
Electrical Schematics -----	17
Notes -----	18
Warranty Registration -----	19



General Information

Omcan Manufacturing and Distributing Company Inc., Food Machinery of America, Inc. dba Omcan and Omcan Inc. are not responsible for any harm or injury caused due to any person's improper or negligent use of this equipment. The product shall only be operated by someone over the age of 18, of sound mind, and not under the influence of any drugs or alcohol, who has been trained in the correct operation of this machine, and is wearing authorized, proper safety clothing. Any modification to the machine voids any warranty, and may cause harm to individuals using the machine or in the vicinity of the machine while in operation.

CHECK PACKAGE UPON ARRIVAL

Upon receipt of an Omcan shipment please inspect for external damage. If no damage is evident on the external packaging, open carton to ensure all ordered items are within the box, and there is no concealed damage to the machine. If the package has suffered rough handling, bumps or damage (visible or concealed), please note it on the bill of lading before accepting the delivery and contact Omcan within 24 hours, so we may initiate a claim with the carrier. A detailed report on the extent of the damage caused to the machine must be filled out within three days, from the delivery date shown in the shipping documents. Omcan has no recourse for damaged products that were shipped collect or third party.

Before operating any equipment, always read and familiarize yourself with all operation and safety instructions.

Omcan would like to thank you for purchasing this machine. It's of the utmost importance to save these instructions for future reference. Also save the original box and packaging for shipping the equipment if servicing or returning of the machine is required.

Omcan Fabrication et distribution Compañie Limité et Food Machinery d'Amérique, dba Omcan et Omcan Inc. ne sont pas responsables de tout dommage ou blessure causé du fait que toute personne ait utilisé cet équipement de façon irrégulière. Le produit ne doit être exploité que par quelqu'un de plus de 18 ans, saine d'esprit, et pas sous l'influence d'une drogue ou d'alcool, qui a été formé pour utiliser cette machine correctement, et est vêtu de vêtements de sécurité approprié. Toute modification de la machine annule toute garantie, et peut causer un préjudice à des personnes utilisant la machine ou des personnes à proximité de la machine pendant son fonctionnement.

VÉRIFIEZ LE COLIS DÈS RÉCEPTION

Dès réception d'une expédition d'Omcan veuillez inspecter pour dommages externes. Si aucun dommage n'est visible sur l'emballage externe, ouvrez le carton afin de s'assurer que tous les éléments commandés sont dans la boîte, et il n'y a aucun dommage dissimulé à la machine. Si le colis n'a subi aucune mauvaises manipulations, de bosses ou de dommages (visible ou cachée), notez-le sur le bond de livraison avant d'accepter la livraison et contactez Omcan dans les 24 heures qui suivent, pour que nous puissions engager une réclamation auprès du transporteur. Un rapport détaillé sur l'étendue des dommages causés à la machine doit être rempli dans un délai de trois jours, à compter de la date de livraison indiquée dans les documents d'expédition. Omcan n'a aucun droit de recours pour les produits endommagés qui ont été expédiés ou cueilli par un tiers transporteur.

General Information

Avant d'utiliser n'importe quel équipement, toujours lire et vous familiariser avec toutes les opérations et les consignes de sécurité.

Omcan voudrais vous remercier d'avoir choisi cette machine. Il est primordial de conserver ces instructions pour une référence ultérieure. Également conservez la boîte originale et l'emballage pour l'expédition de l'équipement si l'entretien ou le retour de la machine est nécessaire.

Omcan Empresa De Fabricacion Y Distribucion Inc. Y Maquinaria De Alimentos De America, Inc. dba Omcan y Omcan Inc. no son responsables de ningun daño o perjuicio causado por cualquier persona inadecuada o el uso descuidado de este equipo. El producto solo podra ser operado por una persona mayor de 18 años, en su sano juicio y no bajo alguna influencia de droga o alcohol, y que este ha sido entrenado en el correcto funcionamiento de esta máquina, y ésta usando ropa apropiada y autorizada. Cualquier modificación a la máquina anula la garantía y puede causar daños a las personas usando la máquina mientras esta en el funcionamiento.

REVISE EL PAQUETE A SU LLEGADA

Tras la recepcion de un envio Omcan favor inspeccionar daños externos. Si no hay daños evidentes en el empaque exterior, Habra el carton para asegurarse que todos los articulos solicitados estén dentro de la caja y no encuentre daños ocultos en la máquina. Si el paquete ha sufrido un manejo de poco cuidado, golpes o daños (visible o oculto) por favor anote en la factura antes de aceptar la entrega y contacte Omcan dentro de las 24 horas, de modo que podamos iniciar una reclamación con la compañía. Un informe detallado sobre los daños causados a la máquina debe ser llenado en el plazo de tres días, desde la fecha de entrega que se muestra en los documentos de envío. Omcan no tiene ningun recurso por productos dañados que se enviaron a recoger por terceros.

Antes de utilizar cualquier equipo, siempre lea y familiarizarse con todas las instrucciones de funcionamiento y seguridad.

Omcan le gustaría darle las gracias por la compra de esta máquina. Es de la mayor importancia para salvar estas instrucciones para futuras consultas. Además, guarda la caja original y el embalaje para el envío del equipo si servicio técnico o devolución de la máquina que se requiere.

Safety and Warranty

1. This instruction manual contains information about the installation, operation and maintenance of the device and should be consulted as an important source of information and reference guide.
 2. Awareness of the safety instructions and instructions for use in this manual will ensure the safe and correct use of the device.
- To prevent hazards and to ensure optimum efficiency, no modifications or alterations to the device that are not explicitly approved by Omcan may be undertaken. This device may only be operated when in proper



Safety and Warranty

working condition.

- The device should be never left unattended during operation. Keep children away.
- Preserve this manual safely. When passing on/selling the device to a third party, the manuals must be handed over along with the device.
- Every person using the device must act in accordance to the manuals and under consideration of the safety advice.
- The device is to be used indoors only.
- Any technical interventions, as well as assembly and maintenance are to be made by a qualified customer service only.
- This appliance is not intended for use by persons (including children) with reduced physical, sensory or mental capabilities, or lack of experience and knowledge, unless they have been given supervision or instruction concerning use of the appliance by a person responsible for their safety.
- Children should be supervised to ensure that they do not play with the appliance.
- The operation manual is not suitable for the persons (including children) with reduced physical, sensory or mental capabilities, or lack of experience and knowledge.

<p>Exclusive power outlet The power outlet must be in close proximity to the ground.</p>	<p>No shared power outlets Warmer cable should never share the power outlet with any other appliance, as cable may overheat and may result in a fire.</p>
<p>Protect cables Extra caution should be used when handling cables, as broken or damaged cables can cause sparking and may result in a fire.</p>	<p>No water flushing Never flush the warmer surface. This can cause leakage, which may result in electrical damage or fire.</p>
<p>Never store flammables and explosives No explosives or flammables should be stored in, or in proximity to, the warmer, such as gasoline, alcohol, and adhesives.</p>	

Omcan display warmers are engineered and designed to maintain previously cooked foods at serving temperatures. Improper use of this machine’s maximum temperature for extended periods of time, in an attempt to thoroughly cook food products, is prohibited. Such operation will void the manufacturer’s warranty and may result in under-cooked and unsafe food.

1 YEAR PARTS AND LABOUR WARRANTY

Within the warranty period, contact Omcan Inc. at 1-800-465-0234 to schedule an Omcan authorized service technician to repair the equipment locally.

Unauthorized maintenance will void the warranty. Warranty covers electrical and part failures, not improper use.

Please see <https://omcan.com/disclaimer> for complete info.

Safety and Warranty

WARNING:

The packaging components are classified as normal solid urban waste and can therefore be disposed of without difficulty.

In any case, for suitable recycling, we suggest disposing of the products separately (differentiated waste) according to the current norms.

DO NOT DISCARD ANY PACKAGING MATERIALS IN THE ENVIRONMENT!

Technical Specifications



Model	DW-CN-0076	DW-CN-0096	DW-CN-0136	DW-CN-0186
Temperature Range	30°C - 90°C / 86°F - 194°F			
Power	800 W	980 W	1020 W	1800 W
Lamp Power	1.44W X 3			
Electrical	110V / 60Hz / 1Ph			
Storage Volume	76 L / 2.7 cu. ft.	96 L / 3.4 cu. ft.	136 L / 4.8 cu. ft.	186 L / 6.6 cu. ft.
Top Shelf Dimensions	11.4" x 11.3" 289 x 287mm	11" x 24.4" 279 x 620mm	33.7" x 11.3" 856 x 287mm	45.7" x 11.3" 1160 x 287mm
Middle Shelf Dimensions	11.4" x 12.4" 289 x 316mm	12" x 24.4" 305 x 620mm	33.7" x 12.4" 856 x 315mm	45.7" x 12.4" 1160 x 315mm
Bottom Shelf Dimensions	11.4" x 13.7" 289 x 347mm	13.6" x 24.4" 345 x 620mm	33.7" x 13.6" 856 x 345mm	45.7" x 13.6" 1160 x 346mm
Shelf Load Capacity	22 lbs. / 10 kgs.	22 lbs. / 10 kgs.	33 lbs. / 15 kgs.	22 lbs. / 10 kgs.
Dimensions	19.5" x 13.2" x 26" 496 x 335 x 660mm	25.8" x 19.8" x 26.2" 654 x 503 x 665mm	35" x 18.8" x 26.2" 889 x 478 x 665mm	19.4" x 47.4" x 26" 492 x 1204 x 660mm
Weight	46.7 lbs. / 21.2 kgs.	96 lbs. / 43.5 kgs.	136 lbs. / 61.7 kgs.	117.9 lbs. / 53.5 kgs.
Item Number	44437	40003	39999	44438

Installation

- Place the device on top of a stable and even surface which supports the weight of the device, and is not heat sensitive.
- Never place the device on a flammable surface (such as table cloth, carpet, etc).
- Do not place the device near open fireplaces, electric ovens/arc furnaces/electric heaters or other heat sources.
- Ensure that the power outlet is easily accessible and within 6 feet/182.9 cm from the warmer.

Operation

- Before the first use, clean the inner sides and the shelves with a soft cloth and a mild cleaning agent. Afterwards, dry the device thoroughly.
- To fill water bowl, remove the water bowl from the device and then fill the water bowl with water.
- Connect the device to a single grounded power outlet.
- Set the temperature as required for respective foods. You may adjust the desired temperature between 30-90°C / 86-194°F.
- The temperature inside of the hot display can be read from the front display.
- Put the food in appropriate containers before placing them inside the hot display.
- Always use safety gloves or tongs when placing or removing foods, as some of the device's parts become very hot.
- The foods are kept warm at the temperature set.
- Open rear side door to place or remove foods.
- Turn on light switch when inner light is desired.
- Disconnect the device from the power outlet when the device is not in use.

Maintenance

- Before cleaning or repairing, make sure the device has been disconnected from the power socket and has cooled down.
- Do not use any acidic agents and make sure that no water enters the device.
- To protect yourself from electric shock, never immerse the device, its cables or the plug in water or any other liquids.
- Do not use any type of water pressure jet for cleaning the device.

CLEANING

- The device should be cleaned regularly.
- Clean the device in the inside and outside with a soft, damp cloth and a mild cleaning agent.
- Clean the shelves and the housing with a soft, damp cloth and a mild cleaning agent.
- Clean the water bowl regularly. Calcifications at the water bowl may be removed with common agents or

Maintenance

liquids.

- Only use a soft cloth to clean the display warmer, and make sure you never use any kind of abrasive agents or pads which could scratch the surface.
- After the cleaning procedure, you should use a soft and dry cloth to dry and polish the surface.
- Make sure the device has been cleaned properly before storing it in a dry place.

MAINTENANCE

- Check the electrical cord regularly to ensure it is not damaged in any way.
- Never use the device if the electrical cord is damaged. If the electrical cord is damaged, it must be replaced by a qualified electrician.
- Only a qualified technician should carry out repairs and maintenance of the device. Do not attempt to repair the device by yourself.

CAUTIONS

Children should be supervised to ensure that they do not play with the appliance.

- If the supply cord is damaged, it must be replaced by the manufacturer, its service agent or similarly qualified persons in order to avoid a hazard.

REFERENCE

Item Number	Model Number	Description	Manufacturer Model Number
44437	DW-CN-0076	Display Warmer 76 L / 2.7 Cu. Ft. 800W 110V/60/1 cETLus ETL Sanitation	RTR-76L
40003	DW-CN-0096	Display Warmer 96 L / 3.4 Cu. Ft. 1000W 110V/60/1 cETLus ETL Sanitation	RTR-96L
39999	DW-CN-0136	Display Warmer 136 L / 4.8 Cu. Ft. 1100W 110V/60/1 cETLus ETL Sanitation	RTR-136L
44438	DW-CN-0186	Display Warmer 186 L / 6.6 Cu. Ft. 1800W 110V/60/1 cETLus ETL Sanitation	RTR-186L

Parts Breakdown

Model DW-CN-0076 44437

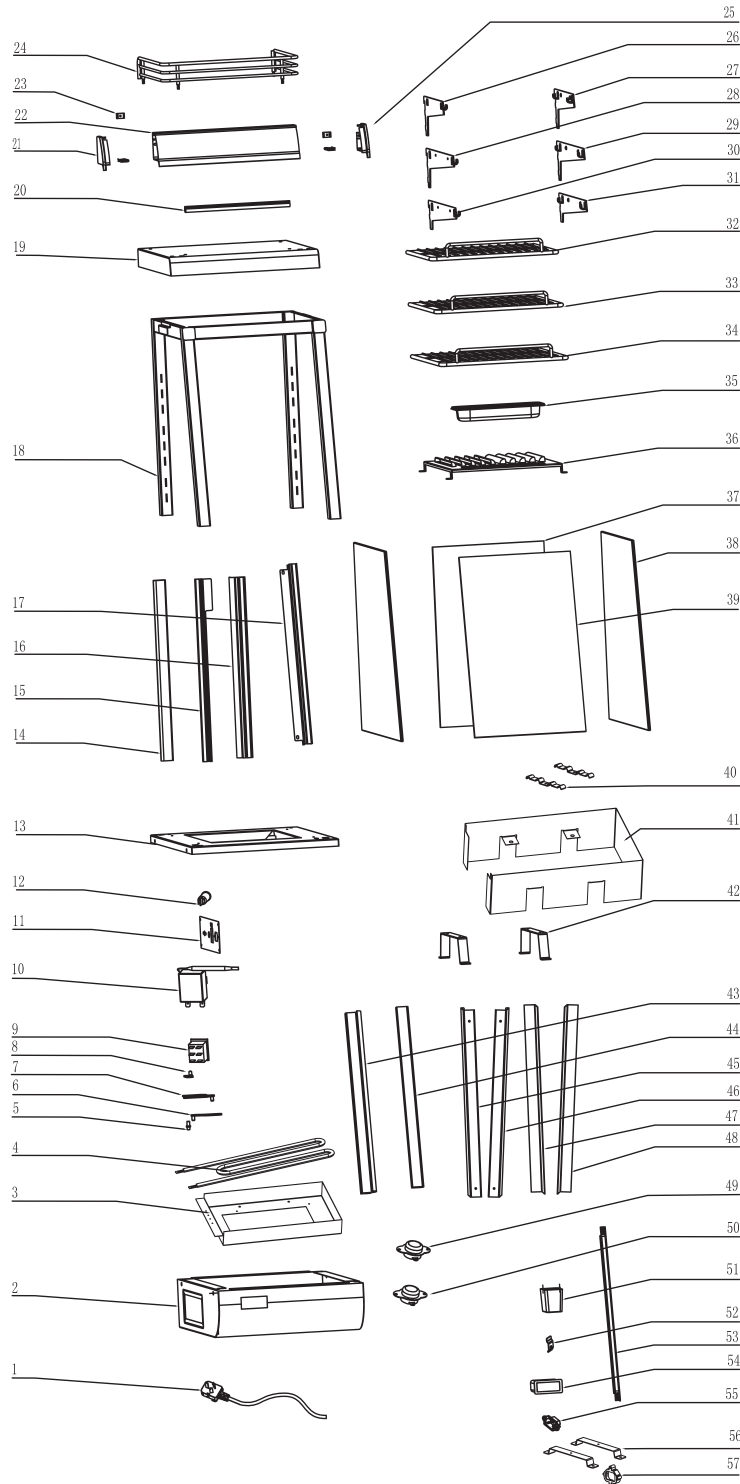

Parts Breakdown

Model DW-CN-0076 44437

Item No.	Description	Position	Item No.	Description	Position	Item No.	Description	Position
30621	Power Cord for RTR-76L	1	67307	LED Lights for RTR-76L	20	67321	Front Door Glass for RTR-76L	39
67292	Base for RTR-76L	2	67308	Side Cover Left for RTR-76L	21	67322	Heating Tube Plate for RTR-76L	40
67293	Tray for Heater for RTR-76L	3	67309	Advertisement Light Box for RTR-76L	22	67323	Left Panel of Heater for RTR-76L	41
67294	Heater Element for RTR-76L	4	67310	Nut for RTR-76L	23	67324	Bracket for Heater for RTR-76L	42
67295	Door Pin for RTR-76L	5	67311	Wire Fence for RTR-76L	24	67325	Front Door Knob Left for RTR-76L	43
67296	Upper Hinge Back for RTR-76L	6	67312	Side Cover Right for RTR-76L	25	67326	Front Door Knob Right for RTR-76L	44
67297	Upper Hinge Front for RTR-76L	7	79322	Left Shelf Bracket for RTR-76L	26	67327	Lamp Holder Left for RTR-76L	45
67298	Bottom Hinge Front for RTR-76L	8	79336	Right Shelf Bracket for RTR-76L	27	67328	Lamp Holder Right for RTR-76L	46
71644	On/Off Switch for RTR-76L	9	71654	Left Shelf Bracket for RTR-76L	28	67329	Transparent Lamp Cover Right for RTR-76L	47
71640	Temperature Thermostat for RTR-76L	10	71655	Right Shelf Bracket for RTR-76L	29	67330	Transparent Lamp Cover Left for RTR-76L	48
67299	Control Panel for RTR-76L	11	67313	Bottom Shelf Bracket Left for RTR-76L	30	71662	Control 125°C for RTR-76L	49
60218	Indicator Light for RTR-76L	12	67314	Bottom Shelf Bracket Right for RTR-76L	31	71661	Control 150°C for RTR-76L	50
67300	Bottom Panel for RTR-76L	13	67315	Bottom Shelf for RTR-76L	32	71647	Base Feet for RTR-76L	51
67301	Back Door Knob Left for RTR-76L	14	67316	Middle Shelf for RTR-76L	33	67331	Glass Clamp for RTR-76L	52
67302	Back Door Frame for RTR-76L	15	67317	Upper Shelf for RTR-76L	34	67332	LED Lighting for RTR-76L	53
67303	Back Door Knob Right for RTR-76L	16	60735	Water Receiver for RTR-76L	35	70686	Temperature Display for RTR-76L	54
67304	Front Door Frame for RTR-76L	17	67318	Ventilated Board for RTR-76L	36	70860	Socket for RTR-76L	55
67305	Cabinet Frame for RTR-76L	18	67319	Back Door Glass for RTR-76L	37	67333	Heater Brace for RTR-76L	56
67306	Top Cover for RTR-76L	19	67320	Side Glass for RTR-76L	38	71638	Socket A for RTR-76L	57

Parts Breakdown

Model DW-CN-0096 40003

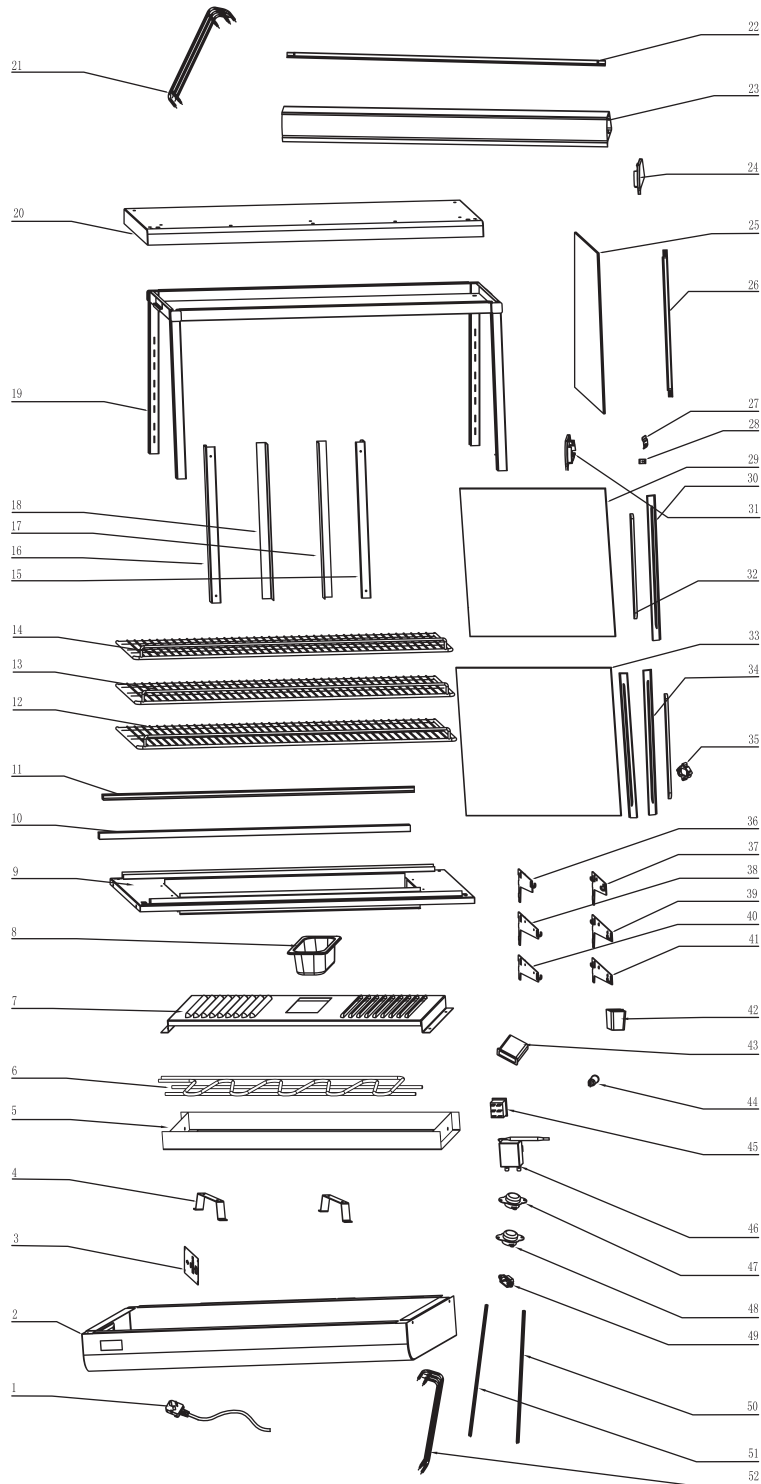

Parts Breakdown

Model DW-CN-0096 40003

Item No.	Description	Position	Item No.	Description	Position	Item No.	Description	Position
30621	Power Cord for RTR-96L	1	70662	Cabinet Frame for RTR-96L	19	71653	Right Small Bracket for RTR-96L	37
70645	Base for RTR-96L	2	70663	Top Cover for RTR-96L	20	71654	Left Shelf Bracket for RTR-96L	38
70646	Control Panel for RTR-96L	3	70664	Wire Fence Left for RTR-96L	21	71655	Right Shelf Bracket for RTR-96L	39
70647	Bracket for Heater for RTR-96L	4	70665	LED Lights for RTR-96L	22	79322	Left Shelf Bracket for RTR-96L	40
70648	Tray for Heater for RTR-96L	5	70666	Advertisement Light Box for RTR-96L	23	79336	Right Shelf Bracket for RTR-96L	41
70649	Heater Element for RTR-96L	6	67312	Side Cover Right for RTR-96L	24	71647	Base Feet for RTR-96L	42
67334	Upper Hinge Front for RTR-96L	7	67320	Side Glass for RTR-96L	25	70686	Temperature Display for RTR-96L	43
71658	1/9 GN Pan for RTR-96L	8	70669	LED Lights for RTR-96L	26	60509	Indicating Light for RTR-96L	44
70652	Bottom Panel for RTR-96L	9	67331	Glass Clamp for RTR-96L	27	70688	Switch for RTR-96L	45
70653	Front Sliding Slot for RTR-96L	10	67310	Nut for RTR-96L	28	71640	Temperature Thermostat for RTR-96L	46
70654	Back Sliding Slot for RTR-96L	11	70672	Front Door Glass for RTR-96L	29	71662	Control 125°C for RTR-96L	47
70655	Bottom Shelf for RTR-96L	12	70673	Front Door Knob for RTR-96L	30	71661	Control 150°C for RTR-96L	48
70656	Middle Shelf for RTR-96L	13	67308	Side Cover Left for RTR-96L	31	70692	Socket Connector for RTR-96L	49
70657	Upper Shelf for RTR-96L	14	70675	Sheath of Door Knob for RTR-96L	32	70693	Waterproof Strip for RTR-96L	50
67327	Lamp Holder Left for RTR-96L	15	70676	Back Door Glass for RTR-96L	33	70694	Waterproof Strip for RTR-96L	51
67328	Lamp Holder Right for RTR-96L	16	70677	Back Door Knob for RTR-96L	34	70695	Wire Fence Right for RTR-96L	52
67329	Transparent Lamp Cover Right for RTR-96L	17	70678	Socket for RTR-96L	35			
67330	Transparent Lamp Cover Left for RTR-96L	18	71652	Left Small Bracket for RTR-96L	36			

Parts Breakdown

Model DW-CN-0136 39999

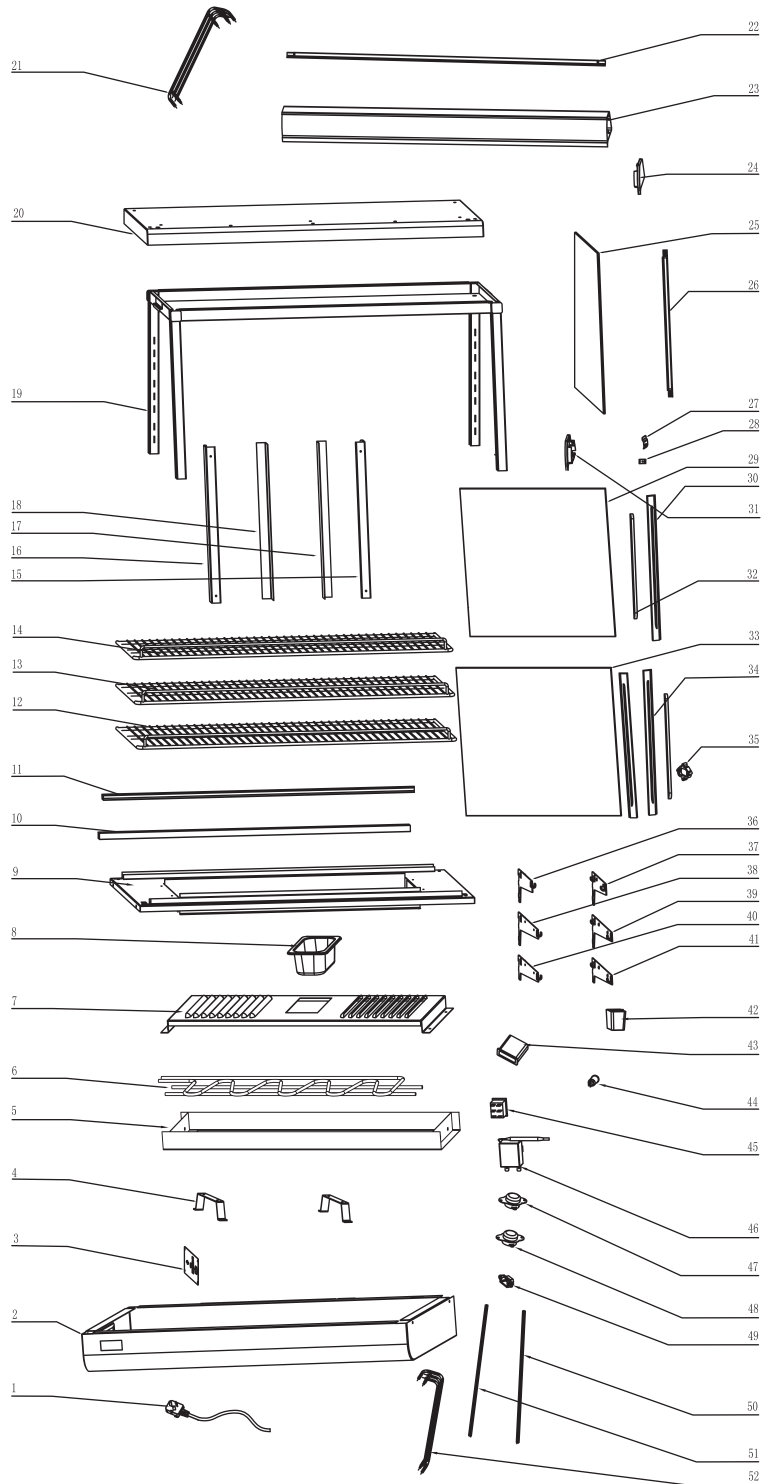

Parts Breakdown

Model DW-CN-0136 39999

Item No.	Description	Position	Item No.	Description	Position	Item No.	Description	Position
30621	Power Cord for RTR-136L	1	70714	Cabinet Frame for RTR-136L	19	71653	Right Small Bracket for RTR-136L	37
70697	Base for RTR-136L	2	70715	Top Cover for RTR-136L	20	71654	Left Shelf Bracket for RTR-136L	38
70646	Control Panel for RTR-136L	3	70664	Wire Fence Left for RTR-136L	21	71655	Right Shelf Bracket for RTR-136L	39
70647	Bracket for Heater for RTR-136L	4	70717	LED Lights for RTR-136L	22	79322	Left Shelf Bracket for RTR-136L	40
71688	Chassis of Heater for RTR-136L	5	70718	Advertisement Light Box for RTR-136L	23	79336	Right Shelf Bracket for RTR-136L	41
70701	Heater Element for RTR-136L	6	67312	Side Cover Right for RTR-136L	24	71647	Base Feet for RTR-136L	42
67297	Upper Hinge Front for RTR-136L	7	67320	Side Glass for RTR-136L	25	70686	Temperature Display for RTR-136L	43
71658	1/9 GN Pan for RTR-136L	8	70669	LED Lights for RTR-136L	26	60509	Indicating Light for RTR-136L	44
70704	Bottom Panel for RTR-136L	9	67331	Glass Clamp for RTR-136L	27	70688	Switch for RTR-136L	45
70653	Front Sliding Slot for RTR-136L	10	67310	Nut for RTR-136L	28	71640	Temperature Thermostat for RTR-136L	46
70654	Back Sliding Slot for RTR-136L	11	70724	Front Door Glass for RTR-136L	29	71662	Control 125°C for RTR-136L	47
70707	Bottom Shelf for RTR-136L	12	70673	Front Door Knob for RTR-136L	30	71661	Control 150°C for RTR-136L	48
70708	Middle Shelf for RTR-136L	13	67308	Side Cover Left for RTR-136L	31	70692	Socket Connector for RTR-136L	49
70709	Upper Shelf for RTR-136L	14	70675	Sheath of Door Knob for RTR-136L	32	70693	Waterproof Strip for RTR-136L	50
67327	Lamp Holder Left for RTR-136L	15	70728	Back Door Glass for RTR-136L	33	70694	Waterproof Strip for RTR-136L	51
67328	Lamp Holder Right for RTR-136L	16	70677	Back Door Knob for RTR-136L	34	70747	Wire Fence Right for RTR-136L	52
67329	Transparent Lamp Cover Right for RTR-136L	17	70678	Socket for RTR-136L	35			
67330	Transparent Lamp Cover Left for RTR-136L	18	71652	Left Small Bracket for RTR-136L	36			

Parts Breakdown

Model DW-CN-0186 44438

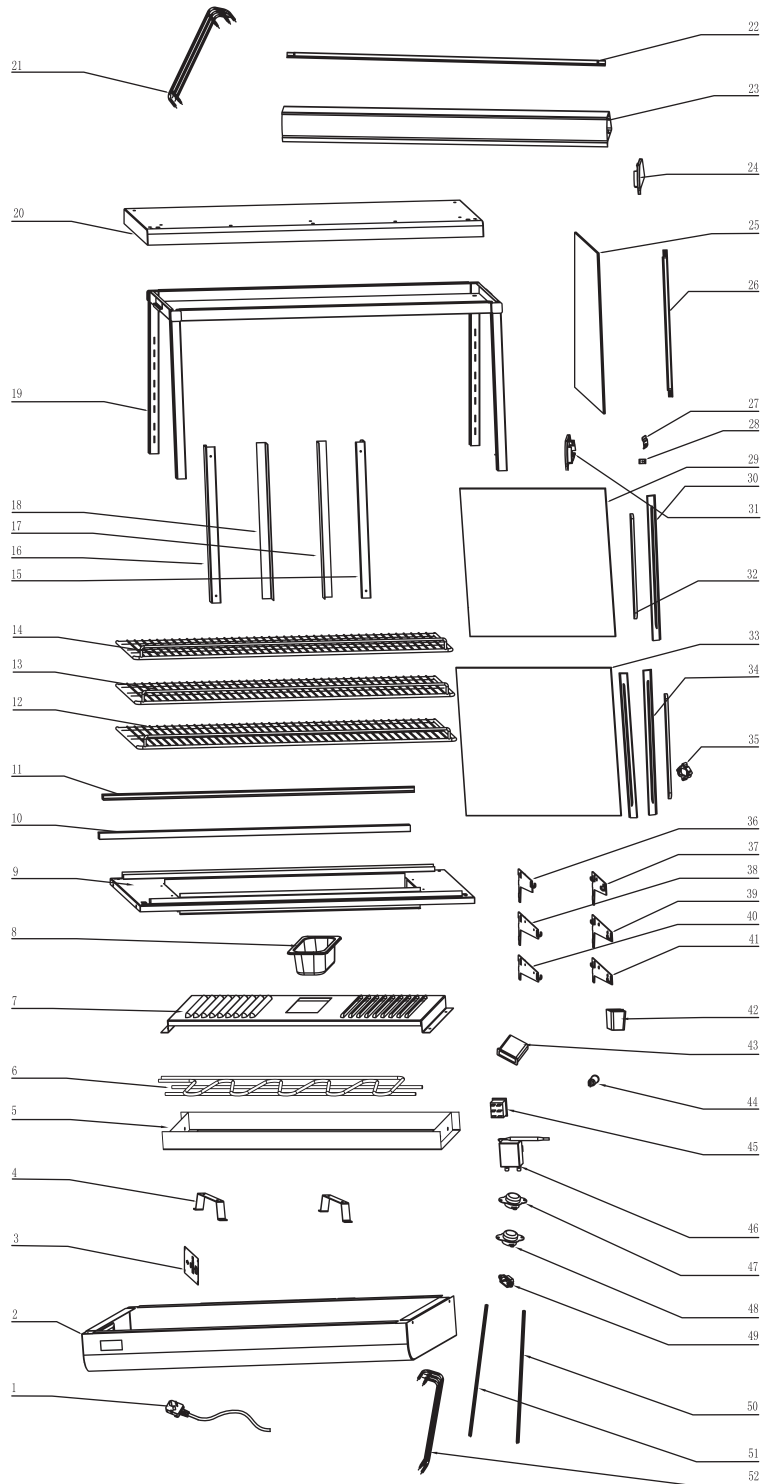

Parts Breakdown

Model DW-CN-0186 44438

Item No.	Description	Position	Item No.	Description	Position	Item No.	Description	Position
30621	Power Cord for RTR-186L	1	67345	Cabinet Frame for RTR-186L	19	79336	Right Shelf Bracket for RTR-186L	37
67335	Base for RTR-186L	2	67346	Top Cover for RTR-186L	20	71654	Left Shelf Bracket for RTR-186L	38
67299	Control Panel for RTR-186L	3	70664	Wire Fence Left for RTR-186L	21	71655	Right Shelf Bracket for RTR-186L	39
70647	Bracket for Heater for RTR-186L	4	67347	LED Lights for RTR-186L	22	67313	Bottom Shelf Bracket Left for RTR-186L	40
67336	Tray for Heater for RTR-186L	5	67348	Advertisement Light Box for RTR-186L	23	67314	Bottom Shelf Bracket Right for RTR-186L	41
67337	Heater Element for RTR-186L	6	67312	Side Cover Right for RTR-186L	24	71647	Base Feet for RTR-186L	42
67338	Ventilated Board for RTR-186L	7	67320	Side Glass for RTR-186L	25	70686	Temperature Display for RTR-186L	43
71658	1/9 GN Pan for RTR-186L	8	67332	LED Lighting for RTR-186L	26	60218	Indicator Light for RTR-186L	44
67339	Bottom Panel for RTR-186L	9	67349	Glass Clamp for RTR-186L	27	71644	On/Off Switch for RTR-186L	45
67340	Front Sliding Slot for RTR-186L	10	67350	Nut for RTR-186L	28	71640	Temperature Thermostat for RTR-186L	46
67341	Back Sliding Slot for RTR-186L	11	67351	Side Cover Left for RTR-186L	29	71662	Control 125°C for RTR-186L	47
67342	Bottom Shelf for RTR-186L	12	70673	Front Door Knob for RTR-186L	30	71661	Control 150°C for RTR-186L	48
67343	Middle Shelf for RTR-186L	13	67308	Side Cover Left for RTR-186L	31	70860	Socket for RTR-186L	49
67344	Upper Shelf for RTR-186L	14	70675	Sheath of Door Knob for RTR-186L	32	70693	Waterproof Strip for RTR-186L	50
67327	Lamp Holder Left for RTR-186L	15	67352	Back Door Glass for RTR-186L	33	70694	Waterproof Strip for RTR-186L	51
67328	Lamp Holder Right for RTR-186L	16	67353	Back Door Knob for RTR-186L	34	70695	Wire Fence Right for RTR-186L	52
67329	Transparent Lamp Cover Right for RTR-186L	17	71638	Socket A for RTR-186L	35			
67330	Transparent Lamp Cover Left for RTR-186L	18	79322	Left Shelf Bracket for RTR-186L	36			

Electrical Schematics

Model DW-CN-0076 44437

Model DW-CN-0096 40003

Model DW-CN-0136 39999

Model DW-CN-0186 44438

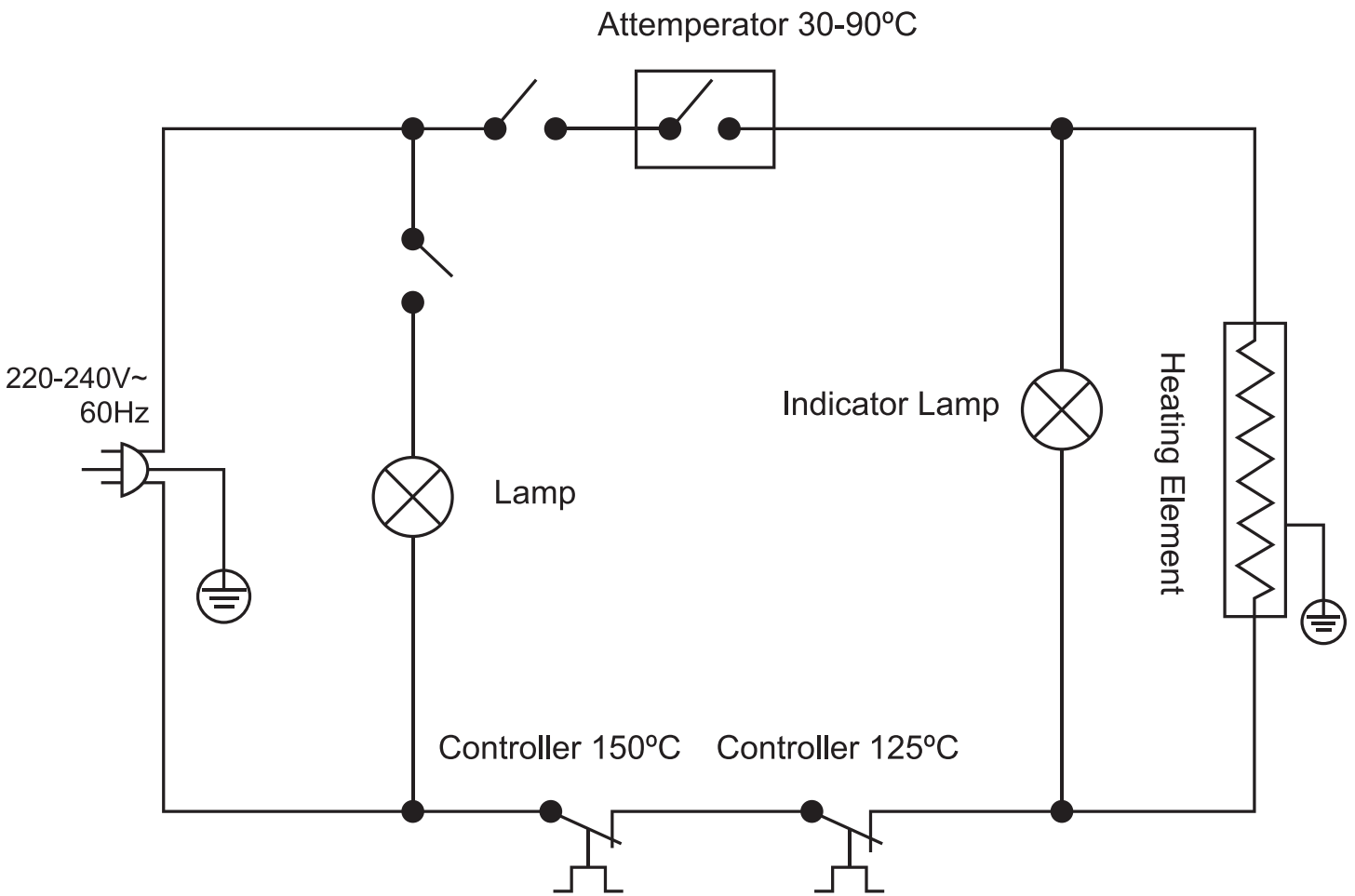



Warranty Registration

Thank you for purchasing an Omcan product. To register your warranty for this product, complete the information below, tear off the card at the perforation and then send to the address specified below. You can also register online by visiting:

Merci d'avoir acheté un produit Omcan. Pour enregistrer votre garantie pour ce produit, complétez les informations ci-dessous, détachez la carte au niveau de la perforation, puis l'envoyer à l'adresse spécifiée ci-dessous. Vous pouvez également vous inscrire en ligne en visitant:

Gracias por comprar un producto Omcan usted. Para registrar su garantía para este producto, complete la información a continuación, cortar la tarjeta en la perforación y luego enviarlo a la dirección indicada a continuación. También puede registrarse en línea en:

<https://omcan.com/warranty-registration/>

For mailing in Canada

Pour postale au Canada

Por correo en Canadá

OMCAN

PRODUCT WARRANTY REGISTRATION

3115 Pepper Mill Court,

Mississauga, Ontario

Canada, L5L 4X5

For mailing in the US

Pour diffusion aux États-Unis

Por correo en los EE.UU.

OMCAN

PRODUCT WARRANTY REGISTRATION

4450 Witmer Industrial Estates, Unit 4,

Niagara Falls, New York

USA, 14305

or email to: service@omcan.com



Purchaser's Information

Name: _____

Address: _____

City: _____ Province or State: _____ Postal or Zip: _____

Country: _____

Dealer from which Purchased: _____

Dealer City: _____ Dealer Province or State: _____

Invoice: _____

Model Name: _____ Model Number: _____

Machine Description: _____

Date of Purchase (MM/DD/YYYY): _____

Would you like to extend the warranty? Yes No

Company Name: _____

Telephone: _____

Email Address: _____

Type of Company:

Restaurant Bakery Deli

Butcher Supermarket Caterer

Institution (*specify*): _____

Other (*specify*): _____

Serial Number: _____

Date of Installation (MM/DD/YYYY): _____

Thank you for choosing Omcan | Merci d'avoir choisi Omcan | Gracias por elegir Omcan



Since 1951 Omcan has grown to become a leading distributor of equipment and supplies to the North American food service industry. Our success over these many years can be attributed to our commitment to strengthen and develop new and existing relationships with our valued customers and manufacturers. Today with partners in North America, Europe, Asia and South America, we continually work to improve and grow the company. We strive to offer customers exceptional value through our qualified local sales and service representatives who provide convenient access to over 5,000 globally sourced products.

Depuis 1951 Omcan a grandi pour devenir un des “leaders” de la distribution des équipements et matériel pour l’industrie des services alimentaires en Amérique du Nord. Notre succès au cours de ces nombreuses années peut être attribué à notre engagement à renforcer et à développer de nouvelles et existantes relations avec nos clients et les fabricants de valeur. Aujourd’hui avec des partenaires en Amérique du Nord, Europe, Asie et Amérique du Sud, nous travaillons continuellement à améliorer et développer l’entreprise. Nous nous efforçons d’offrir à nos clients une valeur exceptionnelle grâce à nos ventes locales qualifiées et des représentants de service qui offrent un accès facile à plus de 5000 produits provenant du monde entier.

Desde 1951 Omcan ha crecido hasta convertirse en un líder en la distribución de equipos y suministros de alimentos en América del Norte industria de servicios. Nuestro éxito en estos años se puede atribuir a nuestro compromiso de fortalecer y desarrollar nuevas relaciones existentes con nuestros valiosos clientes y fabricantes. Hoy con socios de América del Norte, Europa, Asia y América del Sur, que trabajan continuamente para mejorar y crecer la empresa. Nos esforzamos por ofrecer a nuestros clientes valor excepcional a través de nuestro local de ventas y representantes de los servicios que proporcionan un fácil acceso a más de 5,000 productos con origen a nivel mundial.

