

REPLACEMENT PARTS LIST

MG2R SERIES
SINGLE STAGE CONDENSING DOWNFLOW GAS FURNACE
95% AFUE

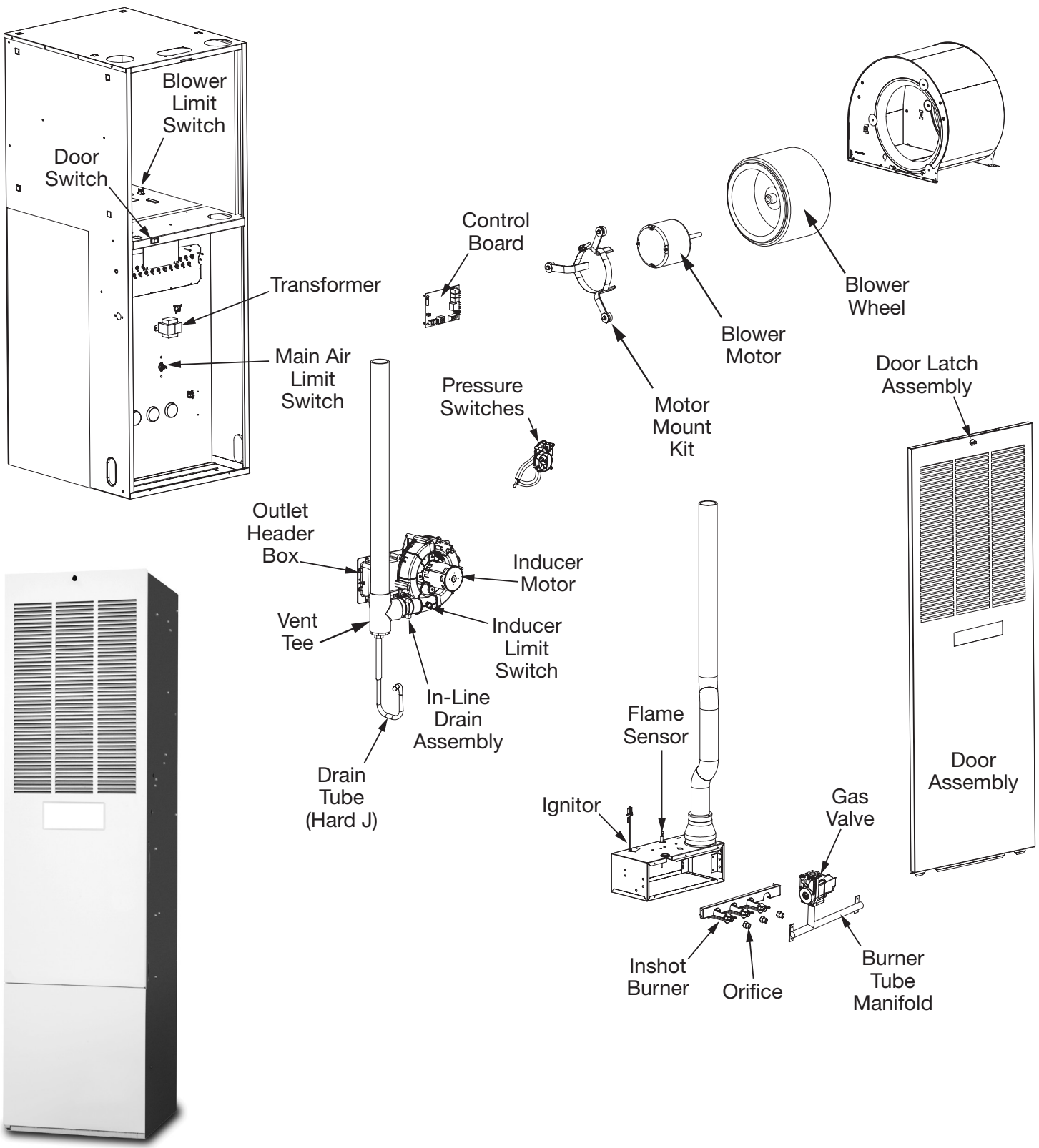

95% AFUE**MG2R SERIES GAS FURNACE**

DESCRIPTION	045F	045T	060F	060T	072F	072T
Blower Deck Limit	626602R	626602R	626602R	626602R	626602R	626602R
Blower Housing	297217R	297217R	297217R	297217R	297217R	297217R
Blower Motor	1028495R	1028498R	1028496R	1028499R	1028497R	1028500R
Blower Motor Mount Kit	904951	904951	904951	904951	904951	904951
Blower Wheel	667258R	667258R	667258R	667258R	667258R	667258R
Burner Box Assembly	921495	921495	921599	921599	921496	921496
Burner Tube Manifold	664639R	664639R	664639R	664639R	664640R	664640R
Coil Door Assembly (Not Shown)	903094	903094	903094	903094	903094	903094
Burner View Port (Not Shown)	632216R	632216R	632216R	632216R	632216R	632216R
Coil Door Assembly (Not Shown)* <i>NOTE: Only Used On ACM2 Models</i>	104391803R	104391803R	104391803R	104391803R	104391803R	104391803R
Control Board (Nordyne/UTEC)	1021573R	1021573R	1021573R	1021573R	1021573R	1021573R
Control Board (Emerson) <i>NOTE: For units manufactured after 7/4/2022</i>	1041648R	1041648R	1041648R	1041648R	1041648R	1041648R
Door Assembly	903977	904049	903977	904049	903977	904049
Door Assembly* <i>NOTE: Only Used On ACM2 Models</i>	104391801R	104391802R	104391801R	104391802R	104391801R	104391802R
Door Latch Assembly	1036349R	1036349R	1036349R	1036349R	1036349R	1036349R
Door Switch	632337R	632337R	632337R	632337R	632337R	632337R
Drain Tube (Hard, "J") (Not Shown)	663706R	663706R	663706R	663706R	663706R	663706R
Drain Tube (Soft, "J" 42") (Not Shown)	664278R	664278R	664278R	664278R	664278R	664278R
Filter (Not Shown)	669363R	—	669363R	—	669363R	—
Flame Sensor	903600	903600	903600	903600	903600	903600
Fuse (Not Shown)	632261R	632261R	632261R	632261R	632261R	632261R
Gas Valve	903596	903596	903596	903596	903596	903596
Heat Exchanger (Not Shown)	921597	921597	921597	921597	921598	921598
Heat Exchanger (Not Shown)* <i>NOTE: Only Used On ACM2 Models</i>	104391603R	104391603R	104391603R	104391603R	104391604R	104391604R
Ignitor	1016290S	1016290S	1016290S	1016290S	1016290S	1016290S
Inducer Motor (with Gasket)	921494	921494	921494	921494	921494	921494
Inducer Orifice (Not Shown)	669927R	669927R	669749R	669749R	669712R	669712R
Inline Drain Assembly	664435R	664435R	664435R	664435R	664435R	664435R
Inshot Burner	661135R	661135R	661135R	661135R	661135R	661135R
Main Air Limit Switch	626567R	626567R	626617R	626617R	626598R	626598R
Main Air Limit Switch* <i>NOTE: Only Used On ACM2 Models</i>	1018472R	1018472R	1018472R	1018472R	626598R	626598R
Motor Choke (<i>For Select Models</i>)	622340R	622340R	622340R	622340R	622340R	622340R
Orifice (Natural Gas)	661049R	661049R	661045R	661045R	661047R	661047R
Orifice (LP Gas)	661057R	661057R	661055R	661055R	661056R	661056R
Outlet Header Box	904802	904802	904802	904802	904802	904802
Pressure Switch	632492R	632492R	632624R	632624R	632492R	632492R
Roll-Out Limit Switch (Not Shown)	626608R	626608R	626608R	626608R	626608R	626608R
Set of Wires (Nordyne/UTEC Control Board)	1028602R	1028602R	1028602R	1028602R	1028602R	1028602R
Set of Wires (Emerson Control Board) <i>NOTE: For units manufactured after 7/4/2022</i>	1040685	1040685	1040685	1040685	1040685	1040685
Transformer	622341R	622341R	622341R	622341R	622341R	622341R
Vent Limit Switch	626599R	626599R	626599R	626599R	626599R	626599R
Barbed Vent Tee (1/2 x 1/2 x 1/2)	618060R	618060R	618060R	618060R	618060R	618060R
PVC Tee (2 x 2 x 2)	663115R	663115R	663115R	663115R	663115R	663115R

* Items used only on ACM2 models

Please specify the correct Model No., Serial No, and part number(s) when ordering parts from the nearest authorized dealer or service center.



Specifications & illustrations subject to change without notice or incurring obligations (03/23).
 O'Fallon, MO, © Nortek Global HVAC LLC 2023. All Rights Reserved.

D311719E
 (Replaces D311719D)