

EXPLODE OF MXM3-72R

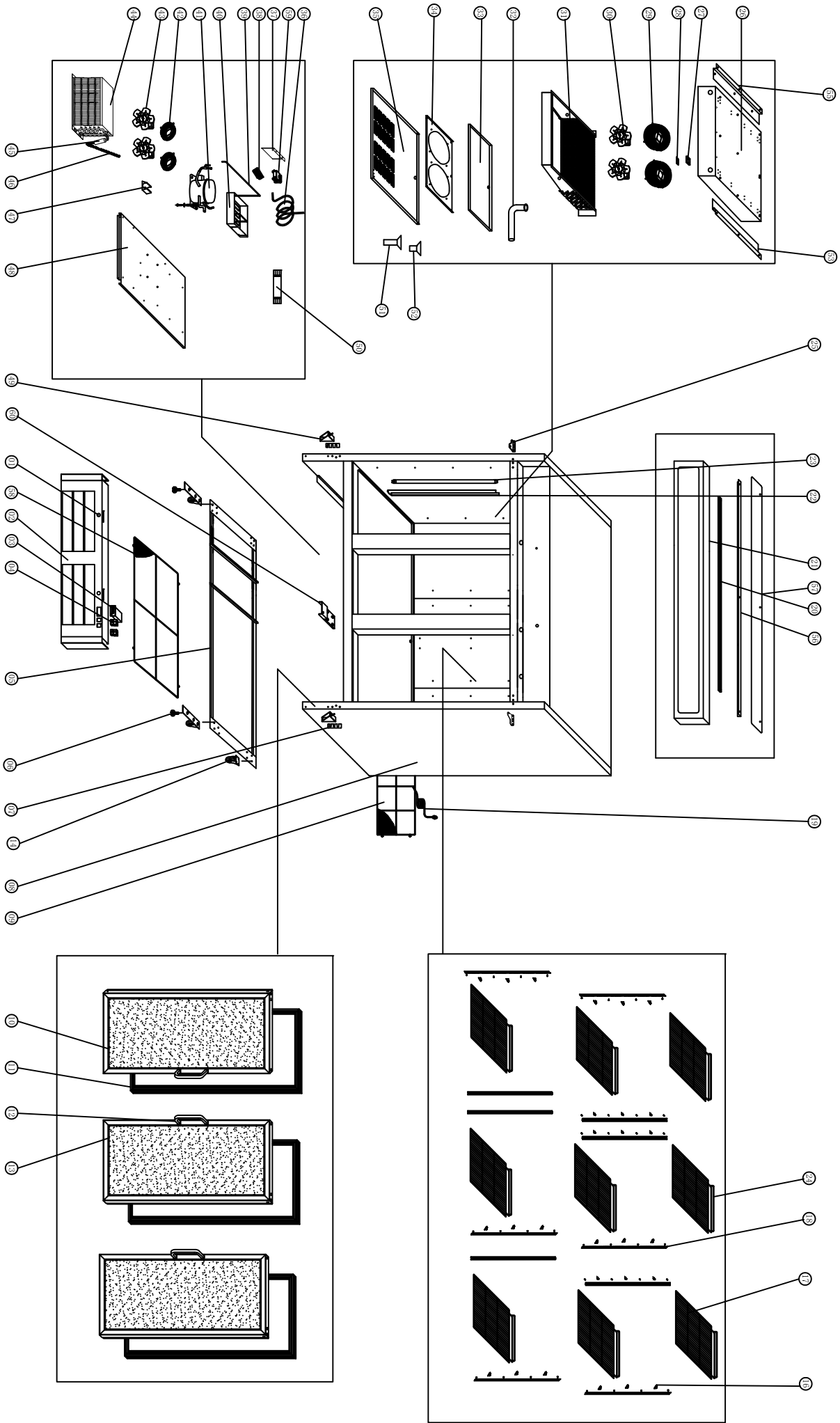

## SPARE PARTS LIST OF MXM3-72R

| NØ. | CODE               | NAME                  | MODEL                        | QTY.  |
|-----|--------------------|-----------------------|------------------------------|-------|
| 01  | GN650TN.86         | LOCK                  |                              | 2PCS  |
| 02  | HGD-72R.01-M05     | FRONT PANEL           |                              | 1PC   |
| 03  | 27R.10             | THERMOSTAT            | XR20C 115V                   | 1PC   |
| 04  | S900.01            | MAIN SWITCH           | DRH-2415-3                   | 1PC   |
| 05  | HGD-72R.02         | SUPPORT OF UNIT BOARD |                              | 2PCS  |
| 06  | HGD-12R.02         | FRONT WHEEL           |                              | 2PCS  |
| 07  | HGD12R.17          | WASHER OF DOWN HINGE  |                              | 2PCS  |
| 08  | HGD-72R.03         | BODY                  |                              | 1PC   |
| 09  | HGD-72R.04         | UNIT ROOM COVER       |                              | 1PC   |
| 10  | HGD-48R.02-M05     | LEFT DOOR             |                              | 1PC   |
| 11  | HGD-23R.15         | GASKET                |                              | 3PCS  |
| 12  | U-GNM2100TN.17-M05 | GLASS DOOR HANDLE     |                              | 3PCS  |
| 13  | HGD-23R.01-M05     | DOOR/RIGHT            |                              | 2PCS  |
| 14  | HGD-12R.04         | BACK WHEEL            |                              | 2PCS  |
| 16  | G350.08            | K SHAPE CLIP          |                              | 32PCS |
| 17  | HGD-48R.18         | SHELF                 |                              | 8PCS  |
| 18  | G350.06            | SHELF SUPPORT         |                              | 8PCS  |
| 19  | 27R.14             | PLUG                  | LT312/1.5MM <sup>2</sup> x3G | 1PC   |
| 20  | HGD-48R.18         | LAMP                  |                              | 1PC   |
| 21  | HGD-72R.05         | LAMP COVER            |                              | 1PC   |
| 22  | HGD-23R.16         | INSIDE LAMP COVER     |                              | 2PCS  |
| 23  | HGD-23R.17         | INSIDE LAMP           |                              | 4PCS  |
| 24  | HGD-72R.09         | SHELF(MIDDLE)         |                              | 4PCS  |
| 25  | D420.08            | DOOR UP HINGE         |                              | 1PAIR |

|    |             |                              |              |      |
|----|-------------|------------------------------|--------------|------|
| 26 | HGD-48R.04  | FIXED BOARD OF<br>EVAPORATOR |              | 1PC  |
| 27 | GN650TN.17  | PROBE PADDING                |              | 1PC  |
| 28 | S900.31     | SENSOR FIXED CLIP            |              | 1PC  |
| 29 | GN650TN.23  | WALL RING                    |              | 2PCS |
| 30 | 27R.30      | CIRCLE FAN                   | CA27-04/C20  | 2PCS |
| 31 | HGD-72R.10  | EVAPORATOR                   |              | 1PC  |
| 32 | D420.40     | WATER PIPER                  |              | 1PC  |
| 33 | HGD-48R.06  | EVAPORATOR WATER PAN         |              | 1PC  |
| 34 | 54F.05      | CIRCLE FAN SUPPORT           |              | 1PC  |
| 35 | HGD-48R.12  | CIRCLE FAN COVER             |              | 1PC  |
| 36 | 27R.23      | SUCTION PIPE                 | Φ9.52        | 1PC  |
| 37 | HGD-23F.04  | FIXING STRIP                 |              | 1PC  |
| 38 | 27R.15      | CABLE CONNECTOR              |              | 1PC  |
| 39 | HGD-48F.09  | EVAPORATE PIPE               | Φ8*0.75      | 1PC  |
| 40 | S900.40A    | WATER BOX                    |              | 1PC  |
| 41 | TPP93.02    | COMPRESSOR                   | T6213Z 110V  | 1PC  |
| 42 | GN650TN.46  | BASKET GUARD GRILLES         |              | 2PCS |
| 43 | 27R.32      | CONDENSER FAN                | CA01-01/Φ230 | 2PCS |
| 44 | GN1410BT.06 | CONDENSER                    |              | 1PC  |
| 45 | GN1410TN.14 | FILTER DRIER                 | 25g          | 1PC  |
| 46 | 81R.08      | CAPILLARY                    | Φ1.6*4500    | 1PC  |
| 47 | 27F.06      | DRIER SUPPORT                |              | 1PC  |
| 48 | HGD-48F.05  | UNIT BOARD                   |              | 1PC  |
| 49 | HGD-12R.15  | DOOR HINGE /DOWN             |              | 2PCS |
| 50 | HGD-12F.08  | LED POWER                    |              | 1PC  |
| 51 | D420D.13    | DRAIN PIPE (B)               |              | 1PC  |
| 52 | D420D.14    | DRAIN PIPE (A)               |              | 1PC  |

|    |            |                                 |  |      |
|----|------------|---------------------------------|--|------|
| 53 | HGD-48R.13 | SUPPORT OF<br>EVAPORATOR(RIGHT) |  | 1PC  |
| 54 | HGD-12R.23 | FEET                            |  | 2PCS |
| 55 | HGD-48R.14 | SUPPORT OF<br>EVAPORATOR(LEFT)  |  | 1PC  |
| 56 | HGD-72R.06 | SUPPORT OF LAMP COVER           |  | 1PC  |
| 57 | HGD-72R.07 | LAMP COVER PROTECTER            |  | 1PC  |
| 58 | HGD-72F.07 | UNIT BOARD GUARD GRILLS         |  | 1PC  |
| 59 | 27F.03     | CONTACTOR                       |  | 1PC  |
| 60 | HGD-72R.08 | DOWN HINGE (MIDDLE)             |  | 1PC  |