

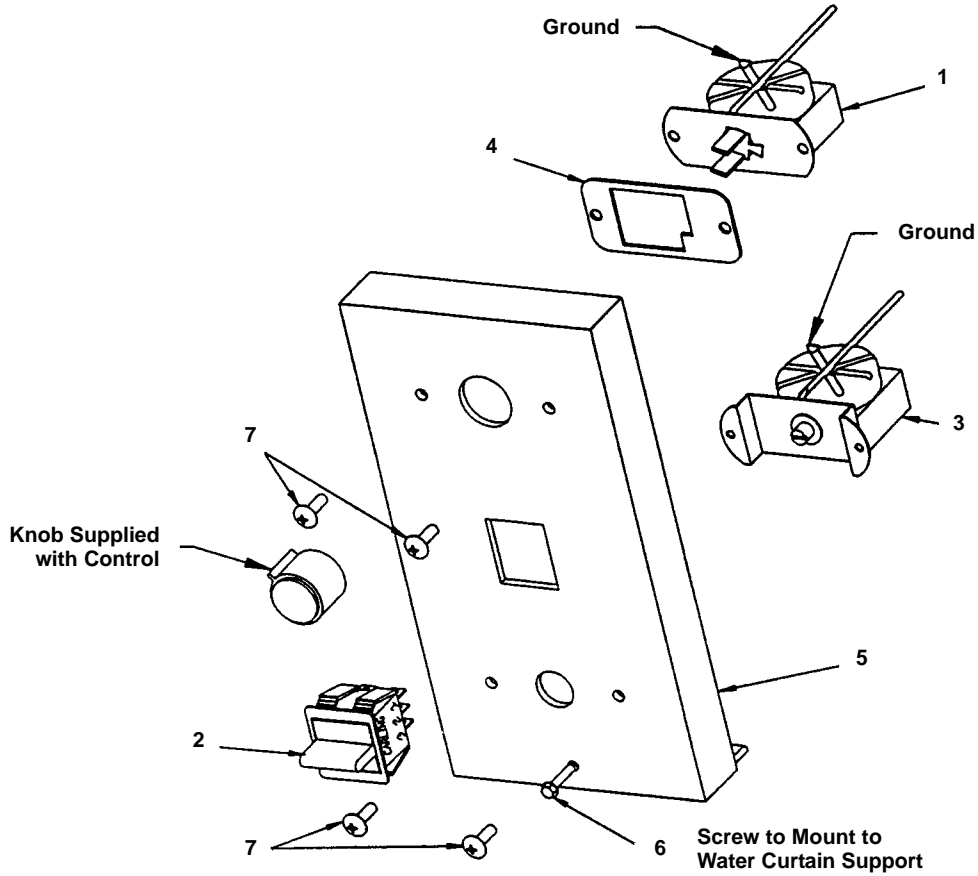

## **Ice Machine Parts List for Series I25**

# I25 CONTROL BOX



PT1107

		<b>115V/60</b>	<b>230V/50</b>	<b>230V/60</b>
1	Cube size control .....	† 7626133	same	same
2	Switch - toggle .....	No Longer Available	same	same
3	Bin thermostat .....	2351263	same	same
4	Stop - cube size control .....	No Longer Available	same	same
5	Control box cover .....	7626143	same	same
6	Screw, 8-18 x 5/8 hex .....	† 5012259	same	same
7	Screw, 8-32 x 1/2 phil .....	† 5026249	same	same
8	Power Cord (Not shown) .....	No Longer Available	2031883	No Longer Available

# I25 EVAPORATOR COMPARTMENT

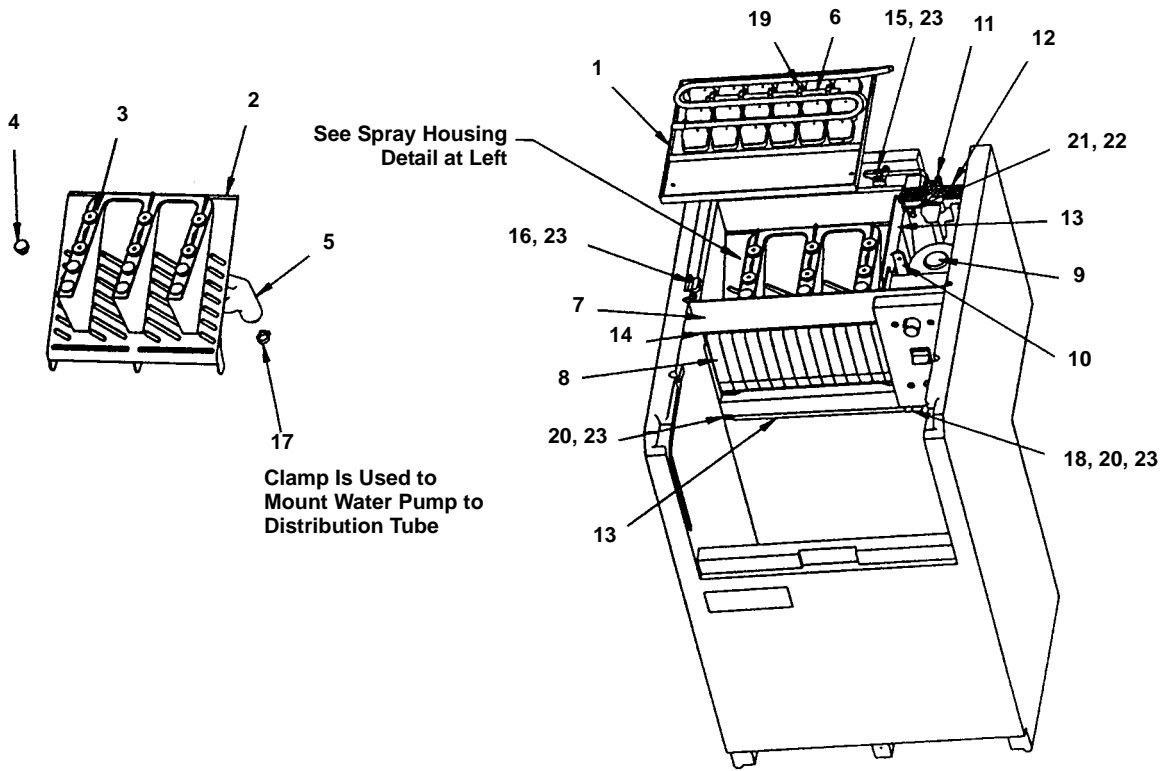

PT1108

	<b>115V/60</b>	<b>230V/50</b>	<b>230V/60</b>
1 Evaporator, 18 cube, assy	No Longer Available	same	same
2 Spray assembly	No Longer Available	same	same
3 Spray nozzle (uses 6)	No Longer Available	same	same
4 Water plug	† 4300629	same	same
5 Distribution tube - vinyl molded	No Longer Available	same	same
6 Thermal tube (for cube size ctl)	No Longer Available	same	same
7 Water curtain support	No Longer Available	same	same
8 Water curtain flap (uses 14)	No Longer Available	same	same
9 Water pump	† 7625523	† 1480279	† 1480279
10 Standpipe (near water pump)	No Longer Available	same	same
11 Vent, sump (behind water pump)	No Longer Available	same	same
12 Water pump lead	No Longer Available	same	same
13 Sump divider	No Longer Available	same	same
14 Rod for water curtain flaps	No Longer Available	same	same
15 Clip - evap/water tube	4302683	same	same
16 Clip - evaporator	No Longer Available	same	same
17 Clamp (on water pump)	† 5650539	same	same
18 Clamp on vinyl tube	† 5650039	same	same
19 Clamp to hold thermal tube	No Longer Available	same	same
20 Spacer	† 4302749	same	same
21 Lockwasher	† 5545169	same	same
22 Screw, 10-32 x 3/8	† 5027079	same	same
23 Screw, 8-18 x 5/9	† 5012259	same	same
24 Water Shield - Mylar	No Longer Available	same	same

† Refer to Cross Reference Guide

# I25 COMPRESSOR COMPARTMENT

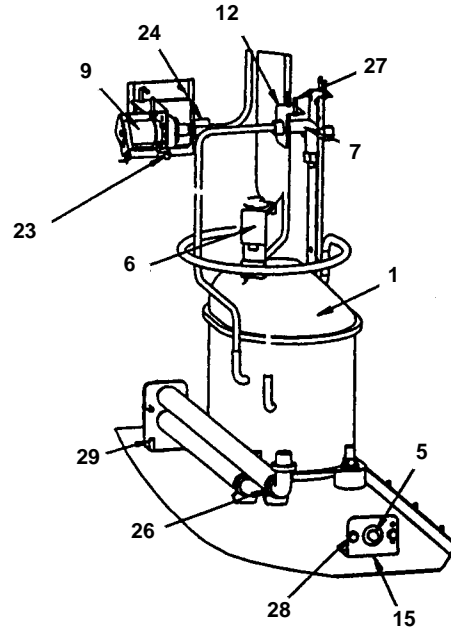
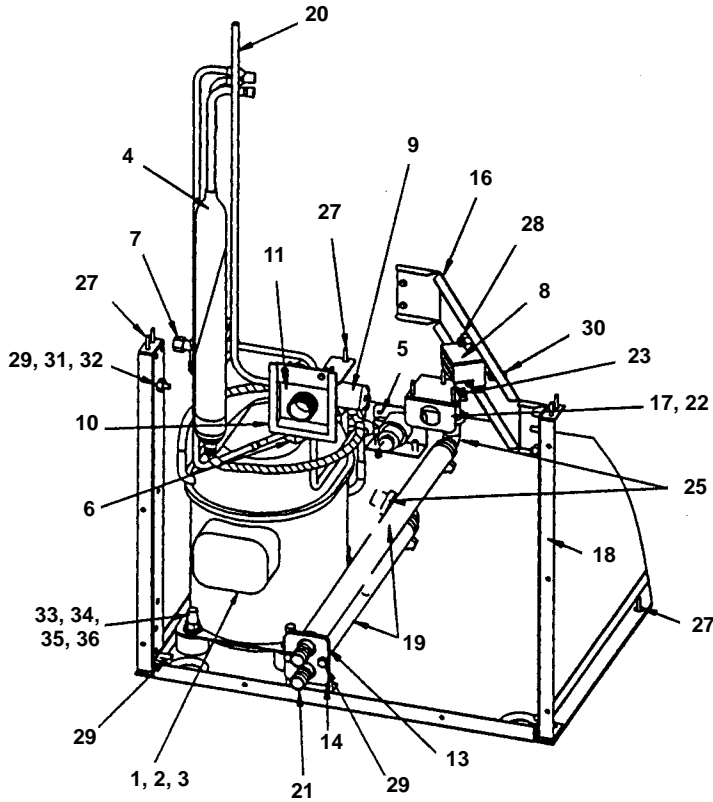

PT1104

1	Compressor	.....
2	Overload	.....
3	Relay	.....
4	Cap tube/heat exchanger assembly 125	.....
5	High pressure Cut-out control	.....
6	Hot gas solenoid valve (Danfoss)	.....
7	Service valve	.....
8	Terminal board	.....
9	Water inlet valve	.....
10	Water inlet splash guard	.....
11	Bracket, inlet support	.....
12	Bracket, service valve	.....
13	Bracket, drain	.....
14	Bracket, locking drain	.....
15	Bracket, high pressure control	.....
16	Bracket, upper shroud	.....
17	Bracket, strain relief	.....
18	Corner support	.....
19	Tubing, vinyl, 0.625 ID	.....
20	Tubing, poly, 0.025 OD	.....
21	Drain fittings	.....
22	Bushing, strain relief	.....
23	Clip, blade grounding	.....
24	Ferrule nut on water inlet valve	.....
25	Elbow, 90D black poly (uses 2)	.....
26	Plastic clamp	.....
27	Screw, 8-18 x 5/8	.....
28	Screw, #8 x 3/4	.....
29	Screw, 10-24 x 1/2	.....
30	Screw, 10-24 x 1/2	.....
31	Washer, #10, lock	.....
32	Hexnut 10-24 x 3/8	.....
33	Rubber Grommet	.....
34	Flatwasher 5/16	.....
35	Hexnut 3/8 x 16	.....
36	Sleeve 3/8 x 1	.....
37	Reducer (sent w/unit) (Not shown)	.....

	<b>115V/60</b>	<b>230V/50</b>	<b>230V/60</b>
No Longer Available	No Longer Available	No Longer Available	No Longer Available
No Longer Available	No Longer Available	<b>8504733</b>	No Longer Available
No Longer Available	No Longer Available	No Longer Available	No Longer Available
No Longer Available	same	same	same
† 2355369	same	same	same
† 7630001	† 7630061	† 7630061	† 7630061
† 8373109	same	same	same
No Longer Available	same	same	same
2405073	No Longer Available	No Longer Available	No Longer Available
No Longer Available	same	same	same
No Longer Available	same	same	same
6012771	same	same	same
No Longer Available	same	same	same
No Longer Available	same	same	same
No Longer Available	same	same	same
No Longer Available	same	same	same
No Longer Available	same	same	same
† 4420383	same	same	same
4420291	same	same	same
No Longer Available	same	same	same
2512043	2512063	2512063	2512043
2511103	same	same	same
† 5650729	same	same	same
No Longer Available	same	same	same
† 5650609	same	same	same
† 5012259	same	same	same
† 5121669	same	same	same
† 5202069	same	same	same
† 5202169	same	same	same
† 5545169	same	same	same
No Longer Available	same	same	same
† 8503069	same	same	same
† 5573099	same	same	same
5430029	same	same	same
† 8503949	same	same	same
No Longer Available	same	same	same

† Refer to Cross Reference Guide

## I25 AIR-COOLED

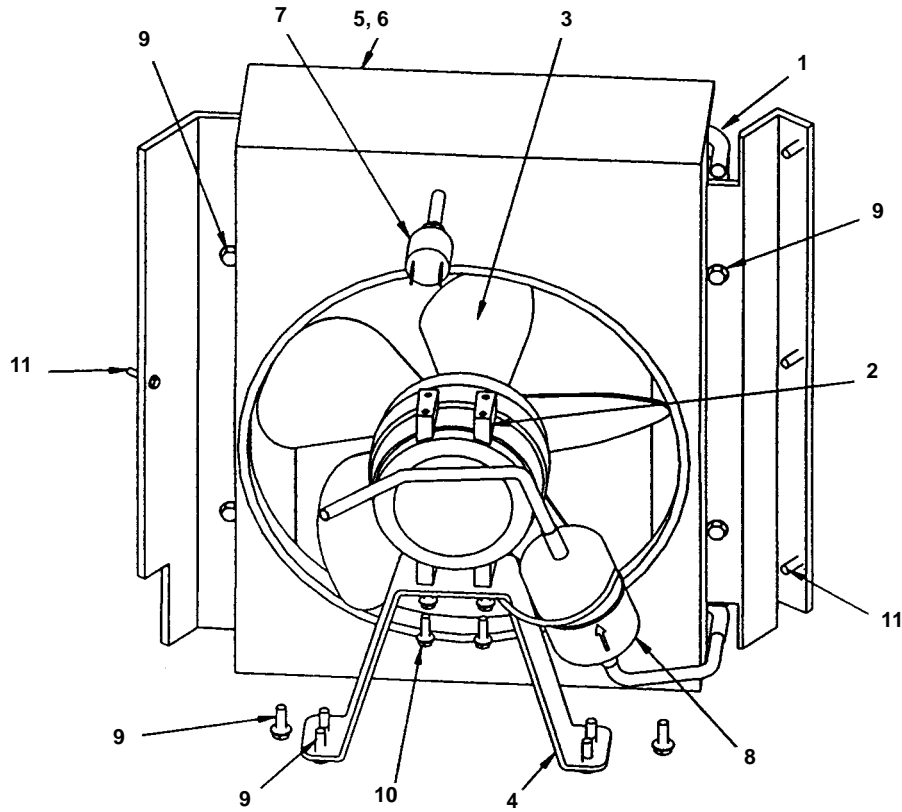

PT1105

	<b>115V/60</b>	<b>230V/50</b>	<b>230V/60</b>
1 Air condenser *	No Longer Available	same	same
2 Fan motor 115V/60 Hz	† 2412873	† 2412883	† 2412883
3 Fan blade	† 2416021	same	same
4 Fan bracket	No Longer Available	same	same
5 Fan shroud (metal)	No Longer Available	same	same
6 Fan shroud (fiberboard)	7111743	same	same
7 Fan cycling control	No Longer Available	same	same
8 Drier	† 8930259	same	same
9 Screw, 10-24 x 1/2	† 5202069	same	same
10 Screw, 8-38 x 7/16	† 5025599	same	same
11 Screw, 8-18 x 5/8	† 5012259	same	same

\* When ordering air condenser for units prior to SN 961061802, you must order fiberboard shroud # 7111743.

## I25 WATER-COOLED

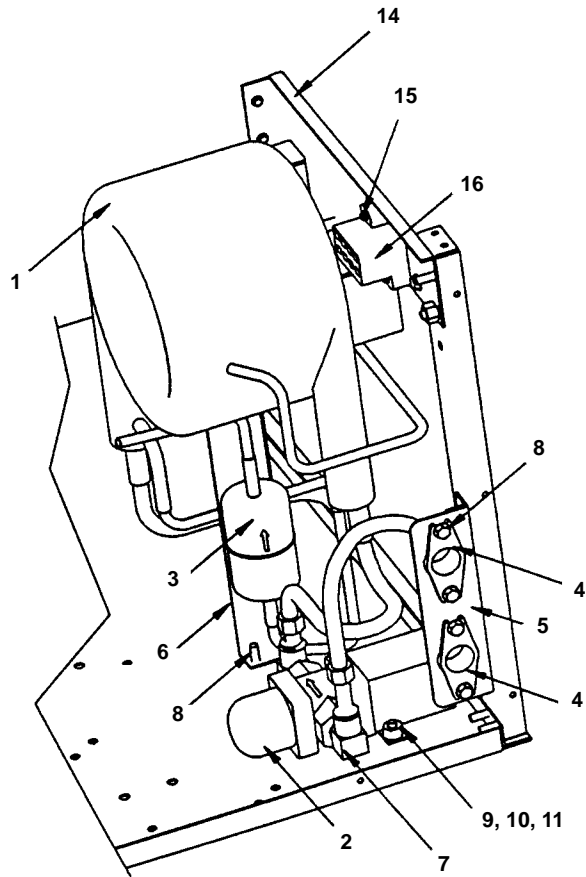
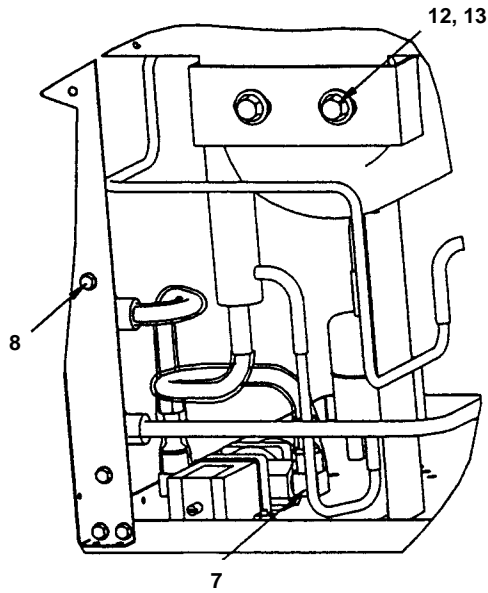

PT1106

	<b>115V/60</b>	<b>230V/50</b>	<b>230V/60</b>
1 Water condenser .....	8865223	same	same
2 Water regulating valve .....	No Longer Available	same	same
3 Drier .....	† 8430229	same	same
4 Adapter, 1/2 x 3/8 .....	8706103	same	same
5 Bracket for adapter .....	No Longer Available	same	same
6 Bracket for drier .....	No Longer Available	same	same
7 Elbow, half union .....	No Longer Available	same	same
8 Screw, 10-24 x 1/2 .....	† 5202069	same	same
9 Washer, #10 lock ext teeth .....	† 5545169	same	same
10 Screw 10-32 x 1/2 .....	No Longer Available	same	same
11 Hex nut 10-32 .....	No Longer Available	same	same
12 Washer .....	† 5573099	same	same
13 Screw, 1/4 x 20 .....	5035683	same	same
14 Bracket to mount condenser .....	No Longer Available	same	same
15 Screw, #8 x 3/4 .....	† 5121669	same	same
16 Terminal board .....	No Longer Available	same	same

# I25 CABINET

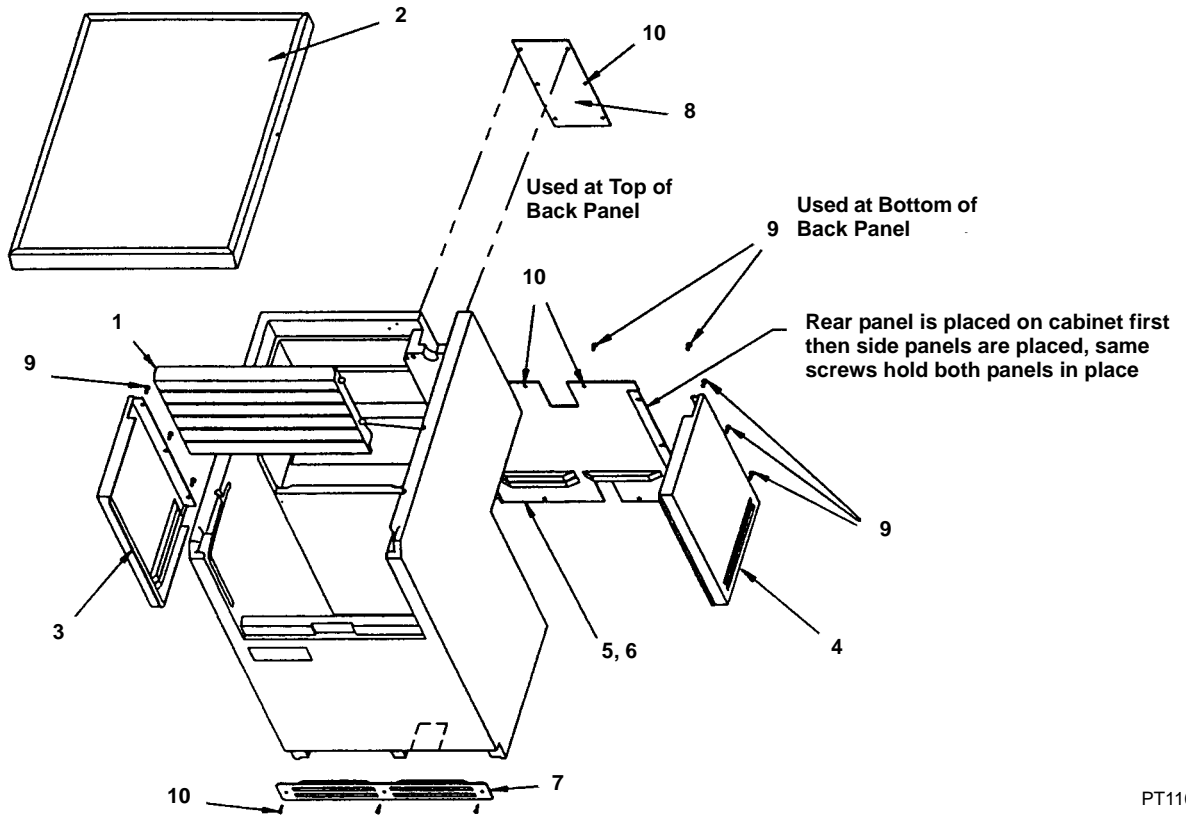

PT1109

1	Door	.....	No Longer Available
2	Top cover	.....	No Longer Available
3	Panel, Side LH	.....	No Longer Available
4	Panel, Side RH	.....	No Longer Available
5	Panel, rear, air cooled	.....	No Longer Available
6	Panel, rear, water cooled	.....	No Longer Available
7	Grill, front, vacuum formed	.....	No Longer Available
8	Panel, tubing	.....	No Longer Available
9	Screw, 10-24 x 1/2	.....	† 5202069
10	Screw, 8-18 x 5/8	.....	5012253
11	Ice Scoop (Not shown)	.....	3302563

**INTENTIONALLY LEFT BLANK**