



**COMMERCIAL**

### Spare Parts List

Model: KCHMT70.30

PNC: 738262

REV: 4/12/2024

NO	DESCRIPTION	Serial #	QTY	COMPONENT PNC	Model Number	Model PNC
2	TEMPERATURE CONTROLLER	<00521012	1PC	0USF42	KCHMT70.30	738262
		≥00521012	1PC	0USDET	KCHMT70.30	738262
2a	Inner Chest Temperature Sensor Probe	ALL	1PC	0USC4C	KCHMT70.30	738262
2b	Controller Mounting Plate	ALL	1PC	0USDIF	KCHMT70.30	738262
8	CABLE COVER	ALL	1PC	0USK07	KCHMT70.30	738262
9	BRAKE WHEEL	ALL	2PCS	0USF03	KCHMT70.30	738262
10	FRONT SUPPORT OF UNIT BOARD	ALL	1PC	0USJ63	KCHMT70.30	738262
11	NORMAL WHEEL	ALL	2PCS	0USH63	KCHMT70.30	738262
11a	Castor Mounting Bolt (4-PACK)	ALL	4PC	0USC2U	KCHMT70.30	738262
11b	Castor Mounting Locking Washer (4-PACK)	ALL	4PC	0USC4A	KCHMT70.30	738262
11c	Castor Mounting Flat Washer (4-PACK)	ALL	4PC	0USC2X	KCHMT70.30	738262
12	BACK SUPPORT OF UNIT BOARD	ALL	1PC	0USJ64	KCHMT70.30	738262
13	RIGHT DOWN HINGE	ALL	2PCS	0USF81	KCHMT70.30	738262
14	BODY	ALL	1PC	N/A	KCHMT70.30	738262
15	TOP CLIP	ALL	4PCS	0USL80	KCHMT70.30	738262
16	UNIT ROOM COVER	ALL	1PC	0USI15	KCHMT70.30	738262
17	PLUG	ALL	1PC	0USH67	KCHMT70.30	738262
18	LOCATION KNOB	ALL	2PCS	0USH46	KCHMT70.30	738262
19	FIXED CLIP OF CUTTING BOARD	ALL	2PCS	0USG68	KCHMT70.30	738262
20	TOP	<04121245	1PC	0USN42	KCHMT70.30	738262
		≥04121245	1PC	0USDGK	KCHMT70.30	738262
21	CUTTING BOARD	ALL	1PC	0USN43	KCHMT70.30	738262
22	PAN SUPPORT /FRONT/BACK(LEFT SIDE)	<04121245	2PCS	0USN44	KCHMT70.30	738262
		≥04121245	2PCS	0USDGL	KCHMT70.30	738262
23	STANDARD PAN	<04121245	27PCS	N/A	KCHMT70.30	738262
		≥04121245	30PCS	N/A	KCHMT70.30	738262
24	PAN SUPPORT /LEFT/RIGHT	ALL	4PCS	0USJ32	KCHMT70.30	738262
25	PAN SUPPORT	ALL	7PCS	0USJ31	KCHMT70.30	738262
26	HANDLE OF COVER	ALL	2PCS	0USH09	KCHMT70.30	738262
27	LEFT MOVING COVER	<04121245	1PC	0USN45	KCHMT70.30	738262
		≥04121245	1PC	0USDGM	KCHMT70.30	738262
27a	LEFT MOVING COVER LINER	<04121245	1PC	0USL33	KCHMT70.30	738262
		≥04121245	1PC	0USDGN	KCHMT70.30	738262
28	LEFT FIXED COVER	<04121245	1PC	0USN46	KCHMT70.30	738262
		≥04121245	1PC	0USDGO	KCHMT70.30	738262
28a	LEFT FIXED COVER LINER	<04121245	1PC	0USL34	KCHMT70.30	738262
		≥04121245	1PC	0USDGP	KCHMT70.30	738262
29	CONDENSER	ALL	1PC	0USF34	KCHMT70.30	738262
30	FILTER DRIER	ALL	1PC	0USG66	KCHMT70.30	738262
30a	CAPILLARY	ALL	1PC	0USM13	KCHMT70.30	738262
31	DRIER SUPPORT	ALL	1PC	0USI78	KCHMT70.30	738262
33	CONDENSER FAN	ALL	1PC	0USF40	KCHMT70.30	738262
33a	CONDENSER FAN BLADE	ALL	1PC	0USC4J	KCHMT70.30	738262
34	BASKET GUARD GRILLS	ALL	1PC	0USDIJ	KCHMT70.30	738262
35	EVAPORATE PIPE	ALL	1PC	0USG14	KCHMT70.30	738262
36	WATER BOX	ALL	1PC	0USI29	KCHMT70.30	738262
37	COMPRESSOR	ALL	1PC	0USF28	KCHMT70.30	738262

37a	COMPRESSOR ELECTRICAL COMPONENT SET	ALL	1PC	0USDF5	KCHMT70.30	738262
38	SUCTION PIPE	ALL	1PC	0USN47	KCHMT70.30	738262
39	CONNECTOR SUPPORT	ALL	1PC	0USDEE	KCHMT70.30	738262
40	CABLE CONNECTOR	ALL	1PC	0USF09	KCHMT70.30	738262
41	CONNECTOR COVER	ALL	1PC	0USJ98	KCHMT70.30	738262
42	GUIDE OF UNIT BOARD/LEFT	ALL	1PC	0USK50	KCHMT70.30	738262
42a	GUIDE OF UNIT BOARD/RIGHT	ALL	1PC	0USK49	KCHMT70.30	738262
43	UNIT BOARD	ALL	1PC	0USK32	KCHMT70.30	738262
45	CIRCLE FAN	ALL	3PCS	0USF14	KCHMT70.30	738262
46	CIRCLE FAN SUPPORT	ALL	1PC	0USL37	KCHMT70.30	738262
47	EVAPORATOR	ALL	1PC	0USN48	KCHMT70.30	738262
47a	Evaporator Temperature Sensor Probe	ALL	1PC	0USC6R	KCHMT70.30	738262
48	EVAPORATOR WATER PAN	ALL	1PC	0USL40	KCHMT70.30	738262
49	FIXED SUPPORT OF EVAPORATOR COVER	ALL	2PCS	0USK05	KCHMT70.30	738262
50	EVAPORATOR COVER	ALL	1PC	0USL35	KCHMT70.30	738262
52	SENSOR FIXED CLIP	ALL	1PC	0USM10	KCHMT70.30	738262
53	SHELF SUPPORT B	ALL	6PCS	0USI66	KCHMT70.30	738262
53a	Shelf Support Screw	ALL	12PCS	0USM14	KCHMT70.30	738262
54	SHELF	ALL	2PCS	0USCOM	KCHMT70.30	738262
55	SHELF SUPPORT A	ALL	6PCS	0USI44	KCHMT70.30	738262
55a	Shelf Support Screw	ALL	18PCS	0USM14	KCHMT70.30	738262
56	K SHAPE CLIP	ALL	12PCS	0USH19	KCHMT70.30	738262
57	UP HINGE/LEFT	ALL	1PC	0USI16	KCHMT70.30	738262
58	UP HINGE /RIGHT	ALL	2PCS	0USI17	KCHMT70.30	738262
59	BUSHING	ALL	3PCS	096268	KCHMT70.30	738262
60	GASKET	ALL	3PCS	0USH00	KCHMT70.30	738262
61	DOOR/LEFT	ALL	1PC	0USM97	KCHMT70.30	738262
62	DOOR SPRING HINGE	ALL	3PCS	0USF83	KCHMT70.30	738262
63	CONDUCT BOARD(RIGHT SIDE)	<04121245	1PC	0USN49	KCHMT70.30	738262
		≥04121245	1PC	0USDGQ	KCHMT70.30	738262
63a	CONDUCT BOARD SIDE PLATE	<04121245	2PCS	0USL14	KCHMT70.30	738262
		≥04121245	2PCS	0USDGR	KCHMT70.30	738262
64	CONDUCT BOARD(LEFT SIDE)	<04121245	1PC	0USN50	KCHMT70.30	738262
		≥04121245	1PC	0USDGQ	KCHMT70.30	738262
64a	CONDUCT BOARD SIDE PLATE	<04121245	2PCS	0USL14	KCHMT70.30	738262
		≥04121245	2PCS	0USDGR	KCHMT70.30	738262
65	RIGHT DOOR	ALL	2PCS	0USM98	KCHMT70.30	738262
66	LEFT DOWN HINGE	ALL	1PC	0USF80	KCHMT70.30	738262
67	MIDDLE SHELF	ALL	1PC	0USC0Q	KCHMT70.30	738262
68	PAN SUPPORT /FRONT (right side)	<04121245	1PC	0USN51	KCHMT70.30	738262
68a	PAN SUPPORT /BACK (right side)	<04121245	1PC	0USDEK	KCHMT70.30	738262
68	PAN SUPPORT /FRONT/BACK (Right side)	≥04121245	2PCS	0USDGL	KCHMT70.30	738262
69	DRAIN PIPE(A INT)	ALL	1PC	096263	KCHMT70.30	738262
70	DRAIN PIPE(B EXT)	ALL	1PC	0USG04	KCHMT70.30	738262
71	MIDDLE GIRDER/ LEFT	ALL	1PC	0USC6K	KCHMT70.30	738262
71a	MIDDLE GIRDER/ RIGHT	ALL	1PC	0USC6D	KCHMT70.30	738262
72	MIDDLE GIRDER FIXER	ALL	4PCS	0USH59	KCHMT70.30	738262
73	RIGHT MOVING COVER	<04121245	1PC	0USN52	KCHMT70.30	738262
		≥04121245	1PC	0USDGM	KCHMT70.30	738262
73a	RIGHT MOVING COVER LINER	<04121245	1PC	0USL38	KCHMT70.30	738262
		≥04121245	1PC	0USDGN	KCHMT70.30	738262
74	RIGHT FIXED COVER	<04121245	1PC	0USN53	KCHMT70.30	738262
		≥04121245	1PC	0USDGO	KCHMT70.30	738262
74a	RIGHT FIXED COVER LINER	<04121245	1PC	0USL47	KCHMT70.30	738262

74a	RIGHT FIXED COVER LINER	≥04121245	1PC	0USDGP	KCHMT70.30	738262
75	FIXED BOLT	ALL	4PCS	0USG67	KCHMT70.30	738262
76	FIXED NUT	ALL	4PCS	0USG73	KCHMT70.30	738262

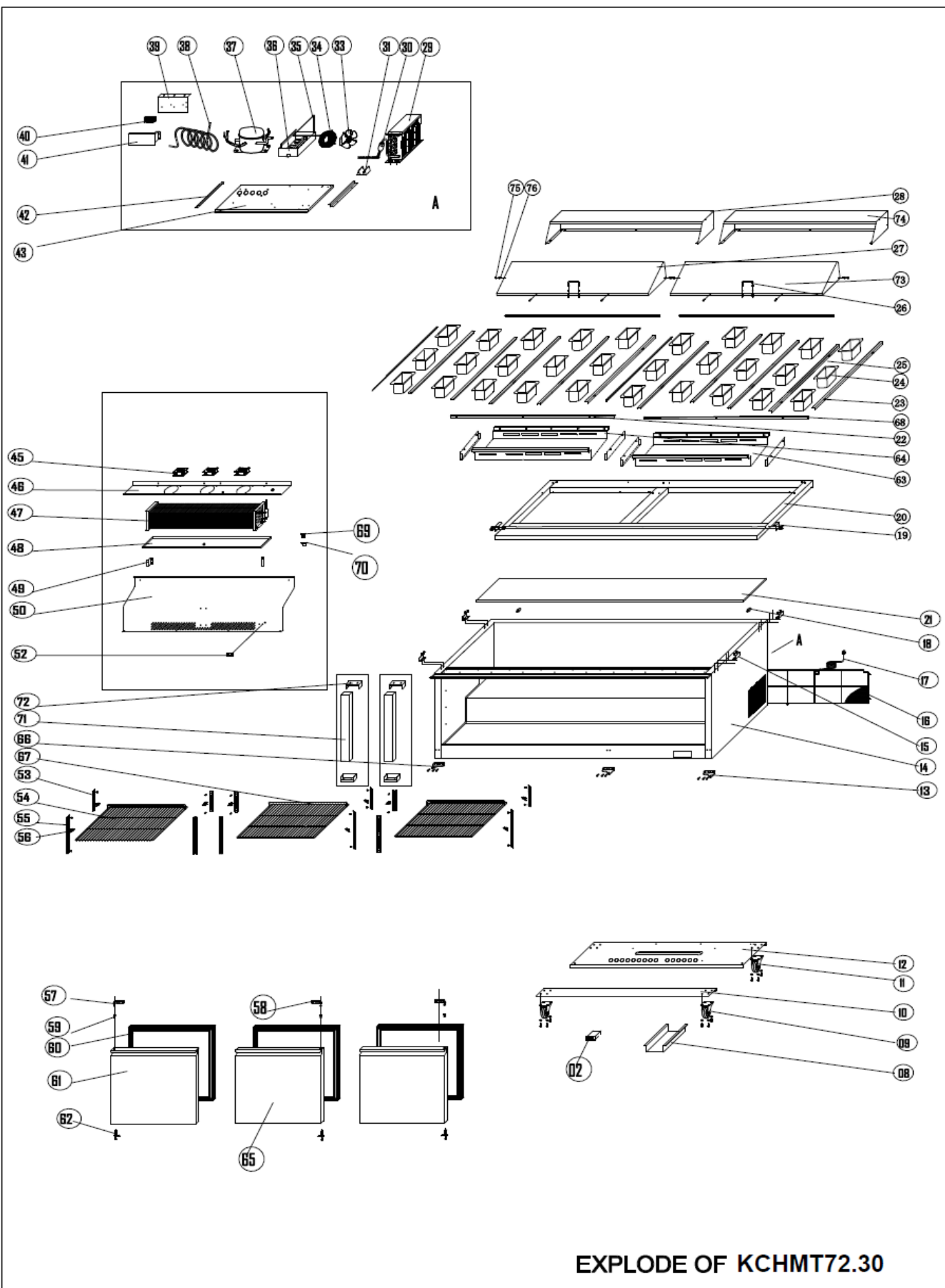

EXPLODE OF KCHMT72.30