

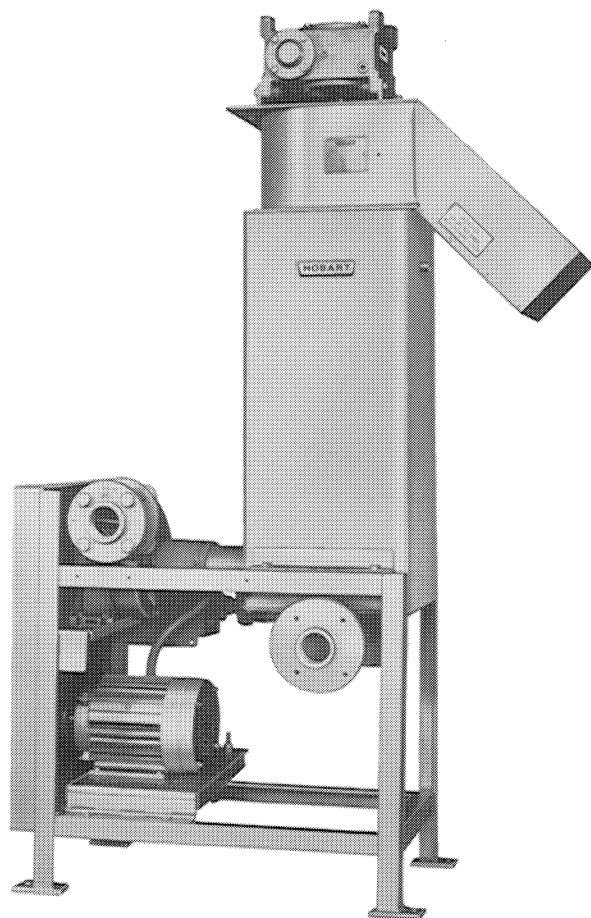

CATALOG OF REPLACEMENT PARTS



MODEL W-738 WATERPRESS

(Formerly W-38A)

**FOOD SERVICE ENGINEERED
WASTE EQUIPMENT SYSTEMS**

WATERPRESS

ML	MODEL			OPERATION
ML-35036	W-38A	2 H.P.	STANDARD CHUTE	L-R
ML-35037	W-38A	2 H.P.	THRU WALL CHUTE	L-R
ML-35038	W-38A	2 H.P.	STANDARD CHUTE	R-L
ML-35039	W-38A	2 H.P.	THRU WALL CHUTE	R-L
ML-35040	W-38A	3 H.P.	STANDARD CHUTE	L-R
ML-35041	W-38A	3 H.P.	THRU WALL CHUTE	L-R
ML-35042	W-38A	3 H.P.	STANDARD CHUTE	R-L
ML-35043	W-38A	3 H.P.	THRU WALL CHUTE	R-L
ML-35044	W-38A	5 H.P.	STANDARD CHUTE	L-R
ML-35045	W-38A	5 H.P.	THRU WALL CHUTE	L-R
ML-35046	W-38A	5 H.P.	STANDARD CHUTE	R-L
ML-35047	W-38A	5 H.P.	THRU WALL CHUTE	R-L

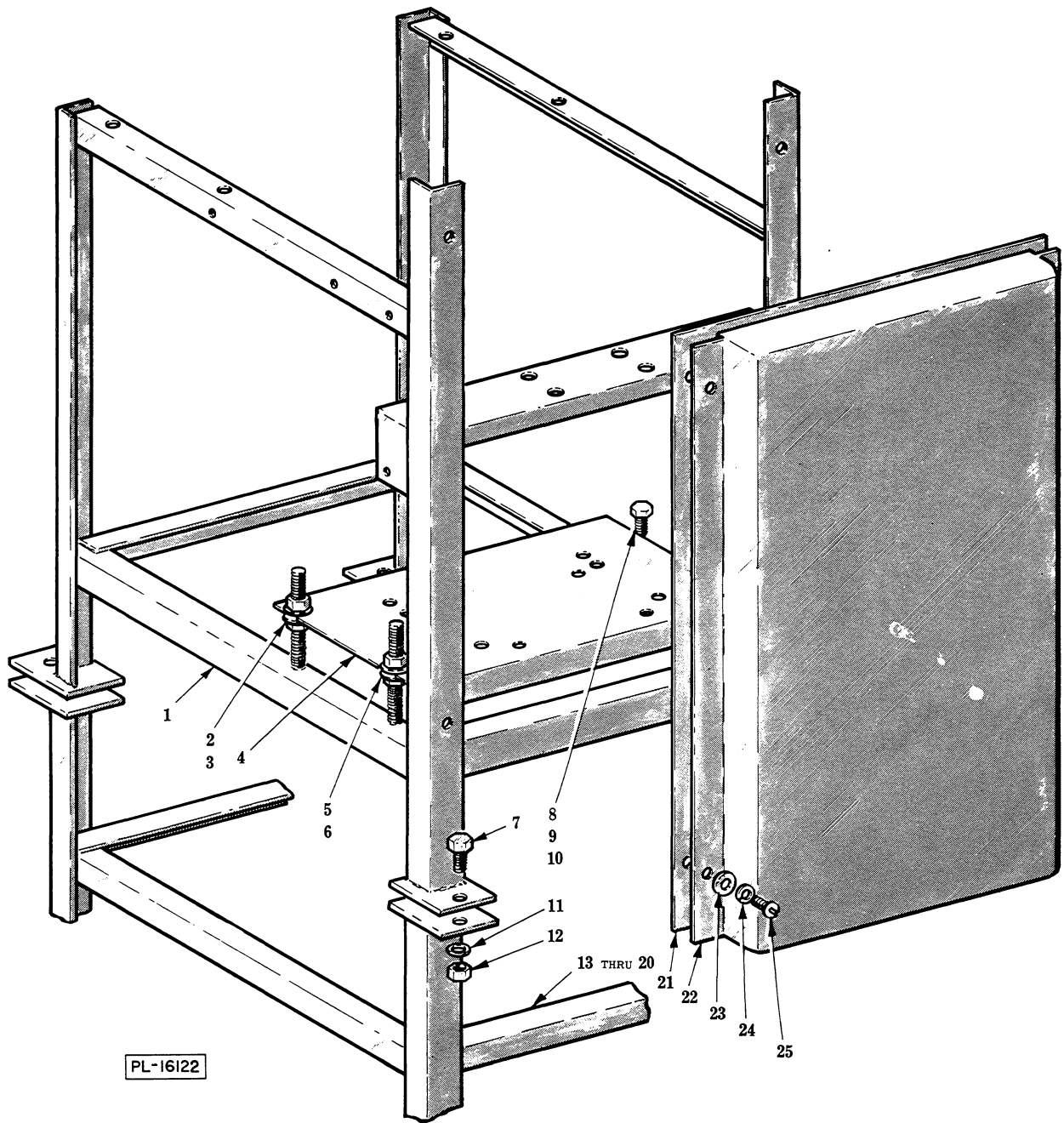

BASE UNIT

BASE UNIT

ILLUS. PL-16122	PART NO.	NAME OF PART	AMT.
1	D-223090	Frame Assy	1
2	NS-15-20	Full Nut - 1/2"-13 Hex Fin	2
3	WS-24-9	Washer	2
4	B-223089	Motor Support Plate Assy	1
5	NS-15-20	Full Nut - 1/2"-13 Hex Fin	2
6	WS-24-9	Washer	2
7	SC-41-45	Fin. Bolt - 1/2"-13 x 1-1/2" Hex Hd	4
8	SC-41-13	Fin. Bolt - 5/16"-18 x 1" Hex Hd	2
9	WS-5-39	Washer	2
10	NS-15-11	Full Nut - 5/16"-18 Hex Fin	2
11	WL-6-36	Lock Washer - 1/2" Medium	4
12	NS-15-20	Full Nut - 1/2"-13 Hex Fin	4
13	B-223133-1	Auxiliary Base Assy. (6" Height) (Incls. items #7, 11 & 12)	1
14	B-223133-2	Auxiliary Base Assy. (12" Height) (Incls. items #7, 11 & 12)	1
15	B-223133-3	Auxiliary Base Assy. (18" Height) (Incls. items #7, 11 & 12)	1
16	B-223133-4	Auxiliary Base Assy. (24" Height) (Incls. items #7, 11 & 12)	1
17	B-223134-1	Auxiliary Base Assy. (30" Height) (Incls. items #7, 11 & 12)	1
18	B-223134-2	Auxiliary Base Assy. (36" Height) (Incls. items #7, 11 & 12)	1
19	B-223134-3	Auxiliary Base Assy. (42" Height) (Incls. items #7, 11 & 12)	1
20	B-223134-4	Auxiliary Base Assy. (48" Height) (Incls. items #7, 11 & 12)	1
21	B-223104	Back Plate - Belt Guard	1
22	C-223105	Guard - Belt	1
23	WS-28-8	Washer	4
24	WL-6-7	Lock Washer - #10 Medium	4
25	SC-21-23	Mach. Screw - #10-24 x 1/2" Rd. Hd	4

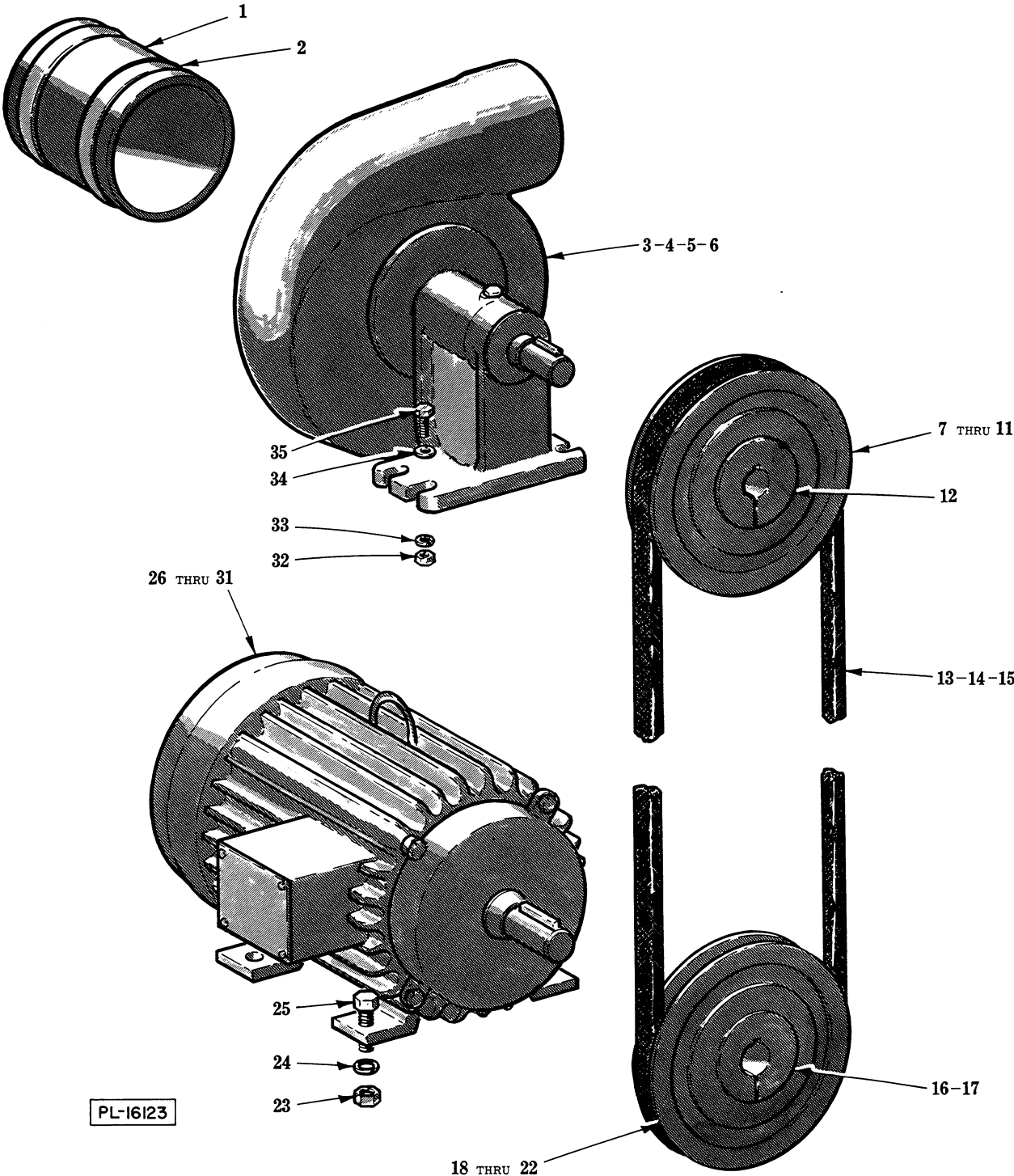

MOTOR AND PUMP UNIT

MOTOR AND PUMP UNIT

ILLUS. PL-16123	PART NO.	NAME OF PART	AMT.
1	B-222392-15	Hose - 3-1/2" x 4-1/2" Lg	1
2	A-222565-4	Clamp - Hose	2
3	E-223475-3	Pump Assy. (L. to R.) (Incls. item #5)	1
4	E-223475-4	Pump Assy. (R. to L.) (Incls. item #6)	1
5	A-222635-2	Impeller (5-1/2" Dia.) (Use with item #3)	1
6	A-222635-3	Impeller (5-1/2" Dia.) (Use with item #4)	1
7	D-223468-1	Sheave - Pump (2 H.P.) (50 Hz.)	1
8	D-223468-2	Sheave - Pump (2 H.P.) (60 Hz.)	1
9	D-223468-3	Sheave - Pump (3 H.P.) (60 Hz.)	1
10	D-223468-4	Sheave - Pump (3 H.P., 50 Hz.) (5 H.P., 60 Hz.)	1
11	D-223468-5	Sheave - Pump (5 H.P.) (50 Hz.)	1
12	C-223465-5	Hub - Sheave (5/8" Bore) (Incls. Key)	1
13	BV-13-2	"V" Belt (2 H.P., 50/60 Hz.; 3 H.P., 60 Hz.)	1
14	BV-13-5	"V" Belt (3 H.P., 50 Hz.; 5 H.P., 60 Hz.)	1
15	BV-13-6	"V" Belt (5 H.P.) (50 Hz.)	1
16	C-223465-1	Hub - Sheave (1-1/8" Bore) (3 & 5 H.P.) (Incls. Key)	1
17	C-223465-2	Hub - Sheave (7/8" Bore) (2 H.P.) (Incls. Key)	1
18	D-223468-2	Sheave - Motor (2 H.P.) (60 Hz.)	1
19	D-223468-4	Sheave - Motor (2 H.P.) (50 Hz.)	1
20	D-223468-5	Sheave - Motor (3 H.P.) (60 Hz.)	1
21	D-223468-8	Sheave - Motor (3 H.P., 50 Hz.; 5 H.P., 60 Hz.)	1
22	D-223468-9	Sheave - Motor (5 H.P., 50 Hz.)	1
23	NS-15-11	Full Nut - 5/16"-18 Hex Fin	4
24	WL-6-23	Lock Washer - 5/16" Medium	4
25	SC-41-13	Fin. Bolt - 5/16"-18 x 1" Hex Hd	4
26	D-223462-3	Motor (2 H.P.) (200 V., 60 Hz., 3 Ph.)	1
27	D-223462-4	Motor (2 H.P.) (230/460 V., 60 Hz., 3 Ph.; 200 V., 50 Hz., 3 Ph.)	1
28	D-223463-1	Motor (3 H.P.) (200 V., 60 Hz., 3 Ph.)	1
29	D-223463-2	Motor (3 H.P.) (230/460 V., 60 Hz., 3 Ph.; 200 V., 50 Hz., 3 Ph.)	1
30	D-223464-1	Motor (5 H.P.) (200 V., 60 Hz., 3 Ph.)	1
31	D-223464-2	Motor (5 H.P.) (230/460 V., 60 Hz., 3 Ph.; 200 V., 50 Hz., 3 Ph.)	1
32	NS-15-13	Full Nut - 3/8"-16 Hex Fin	4
33	WL-6-28	Lock Washer - 3/8" Medium	4
34	WS-28-22	Washer	4
35	SC-41-31	Fin. Bolt - 3/8"-16 x 1-1/4" Hex Hd	4

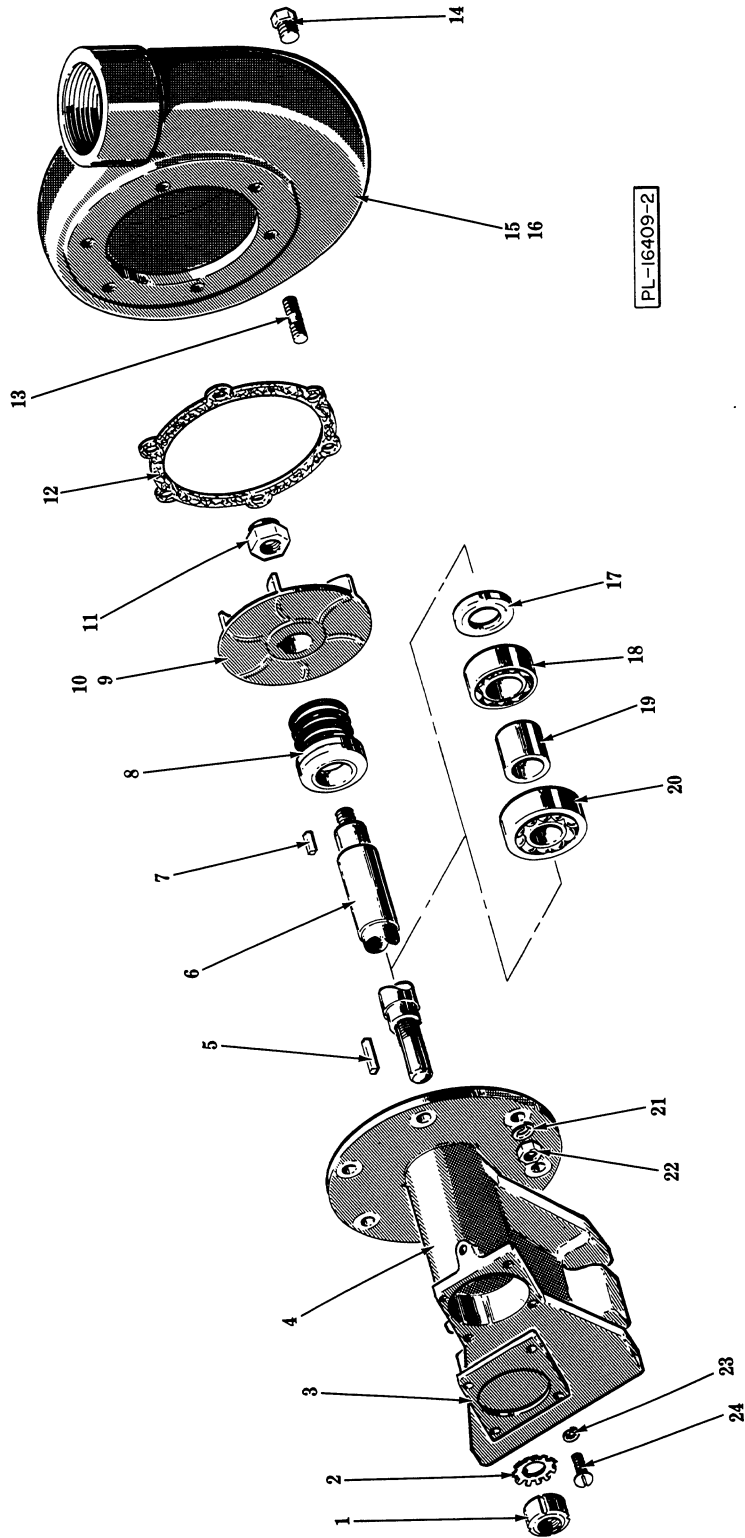

RETURN PUMP UNIT

RETURN PUMP UNIT

ILLUS. PL-16409-2	PART NO.	NAME OF PART	AMT.
1	C-223625-16	Lock Nut - Shaft	1
2	C-223625-5	Lock Washer	1
3	C-223625-12	Retainer - Bearing	1
4	C-223625-1	Body - Pump	1
5	C-223625-15	Key - Shaft	1
6	C-223625-6	Shaft	1
7	C-223625-13	Key - Impeller	1
8	C-223625-7	Seal Assy	1
9	A-222635-2	Impeller (L. to R.)	1
10	A-222635-3	Impeller (R. to L.)	1
11	C-223625-14	Lock Nut - Impeller	1
12	C-223625-19	Shim	4
13	C-223625-4	Stud	6
14	C-223625-18	Plug - 1/4" Pipe	1
15	C-223625-2	Housing - Pump (L. to R.)	1
16	C-223625-3	Housing - Pump (R. to L.)	1
17	C-223625-11	Slinger	1
18	C-223625-8	Ball Bearing	1
19	C-223625-10	Spacer	1
20	C-223625-9	Ball Bearing	1
21	WL-6-28	Lock Washer - 3/8" Medium	6
22	NS-15-13	Full Nut - 3/8"-16 Hex Fin	6
23	WL-6-17	Lock Washer - 1/4" Medium	4
24	C-223625-17	Mach. Screw - 1/4"-20 Rd. Hd	4
	C-223625-20	Housing Assy. (L. to R.) (Incls. items #13, 14 & 15)	1
	C-223625-21	Housing Assy. (R. to L.) (Incls. items #13, 14 & 16)	1

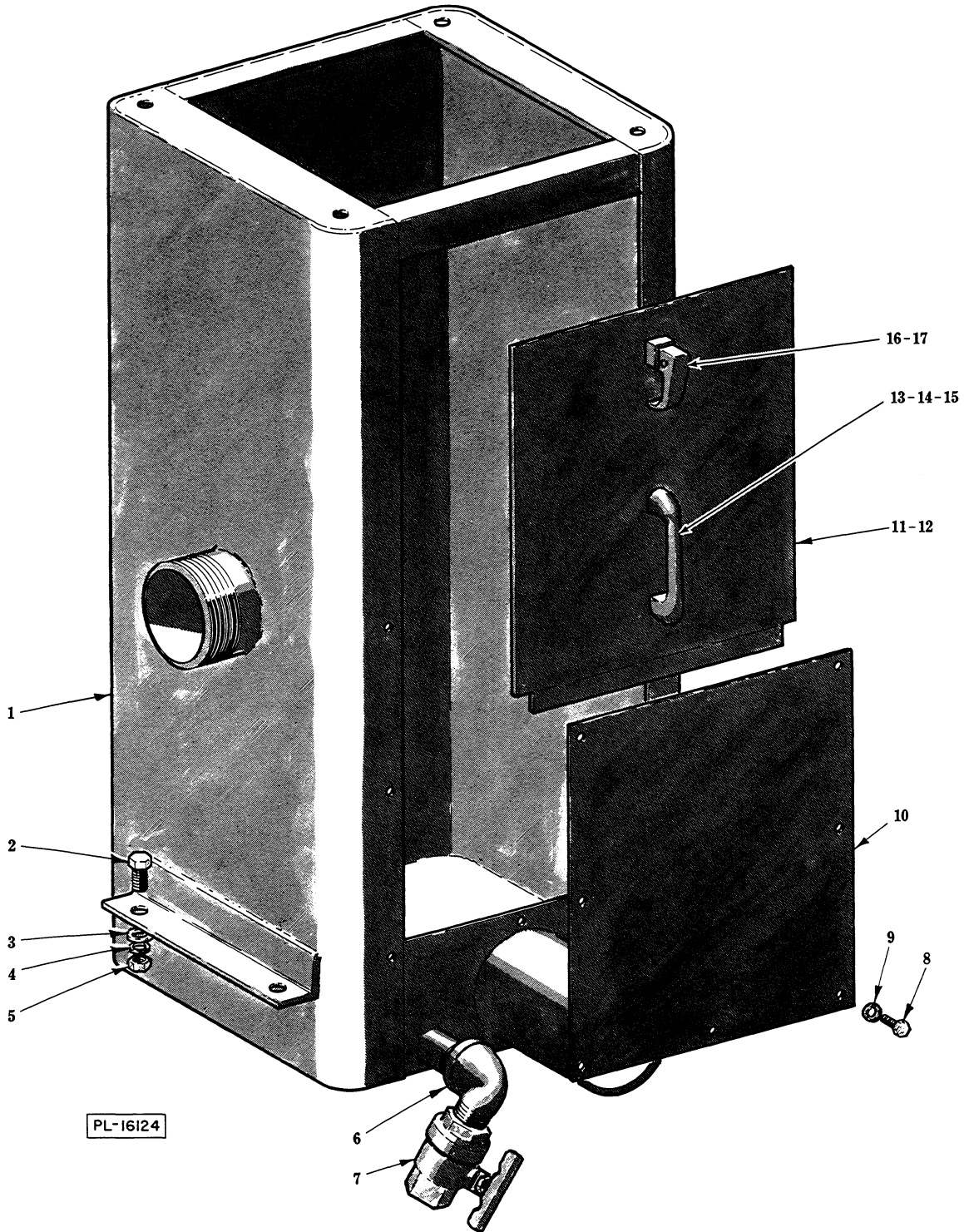

WATER PRESS HOUSING UNIT

WATER PRESS HOUSING UNIT

ILLUS. PL-16124	PART NO.	NAME OF PART	AMT.
1	D-223109	Shell Sub-Assy	1
2	SC-41-44	Fin. Bolt - 1/2"-13 x 1-1/4" Hex Hd	4
3	WS-24-9	Washer	4
4	WL-6-36	Lock Washer - 1/2" Medium	4
5	NS-15-20	Full Nut - 1/2"-13 Hex Fin	4
6	FP-15-24	Elbow - 3/4" x 90° Street	1
7	A-223220-3	Ball Valve - 3/4"	1
8	SC-41-50	Fin. Bolt - 1/4"-20 x 1/2" Hex Hd	7
9	B-223535	Washer - Sealing	7
10	B-222194-4	Cover (Stationary)	1
11	B-216070	Removable Cover Sub-Assy. (Incls. items #12 thru 17)	1
12	A-222954-1	Access Cover & Gasket Sub-Assy	1
13	B-222559	Handle	1
14	SC-21-22	Mach. Screw - #10-24 x 3/8" Rd. Hd	2
15	WL-14-7	Lock Washer - #10 Ext. Shakeproof	2
16	P-82474	Fastener - Adj. Pawl	1
17	WL-14-34	Lock Washer - 5/8" Ext. Shakeproof	1

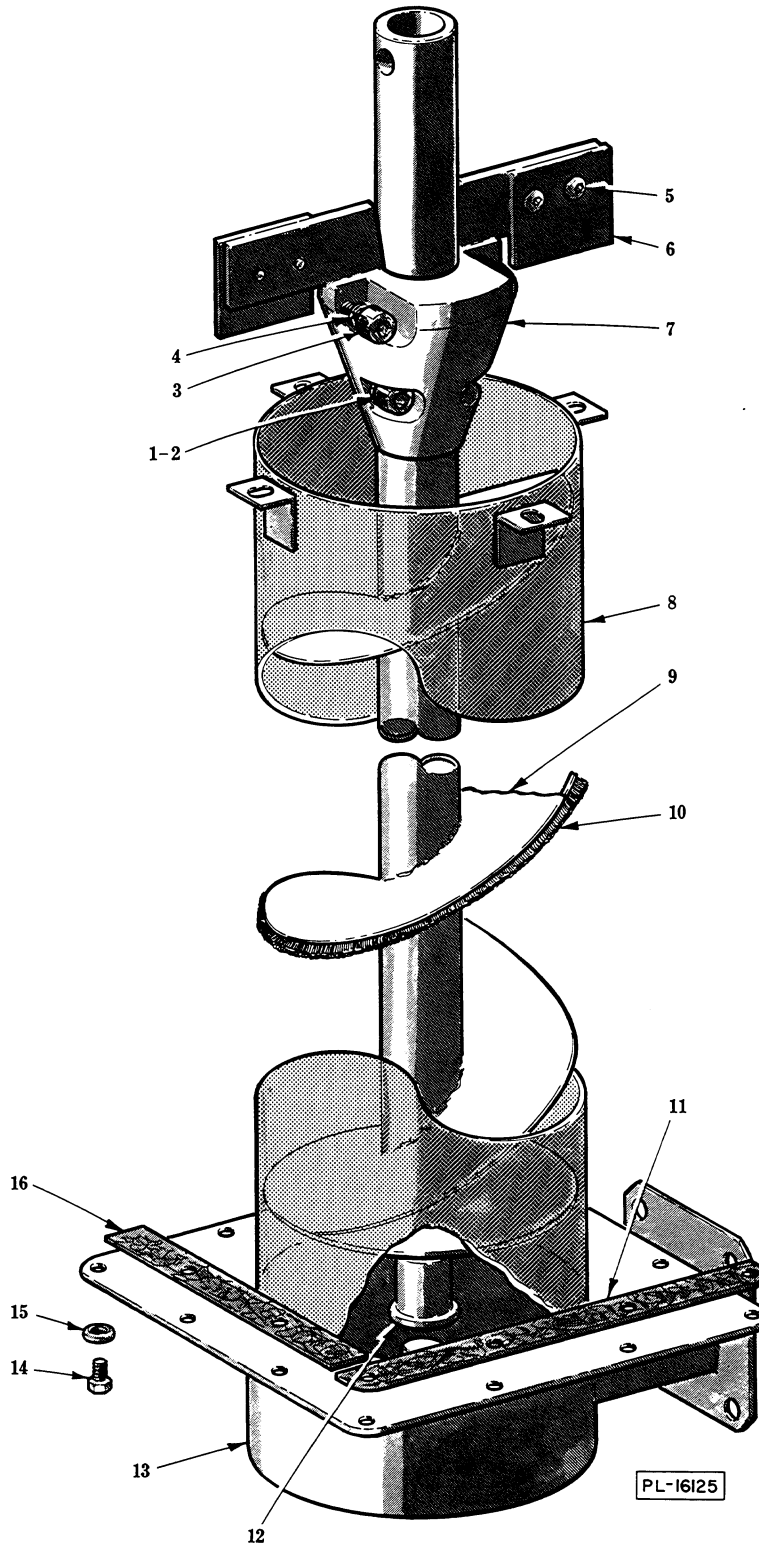

WATER PRESS SCREW UNIT

WATER PRESS SCREW UNIT

ILLUS. PL-16125	PART NO.	NAME OF PART	AMT.
1	SC-59-32	Cap Screw - 5/16"-18 x 1" Soc. Fil. Hd	2
2	WL-6-23	Lock Washer - 5/16" Medium	2
3	SC-59-32	Cap Screw - 5/16"-18 x 1" Soc. Fil. Hd	2
4	WL-6-23	Lock Washer - 5/16" Medium	2
5	SC-85-19	Cap Screw - 5/16"-18 x 5/8" Soc. Button Hd	4
6	B-222361-3	Plate - Wiper	2
7	C-222420-1	Cone - Compression	1
8	C-216017	Screen Sub-Assy	1
9	C-216046	Screw Sub-Assy. (Incls. items #10 & 12)	1
10	A-223136	Brush - Screw	1
11	B-222968-2	Gasket - 1/8" x 1" x 12-1/2"	2
12	B-222424-1	Bearing - Screw (Oilless)	1
13	C-216032	Slurry Inlet Sub-Assy	1
14	SC-41-5	Fin. Bolt - 1/4"-20 x 5/8" Hex Hd	12
15	B-223535	Washer - Sealing	12
16	B-222968-1	Gasket - 1/8" x 1" x 10-1/2"	2
	B-216258-1	Compression Cone Sub-Assy. (Incls. items #1 thru 7)	1

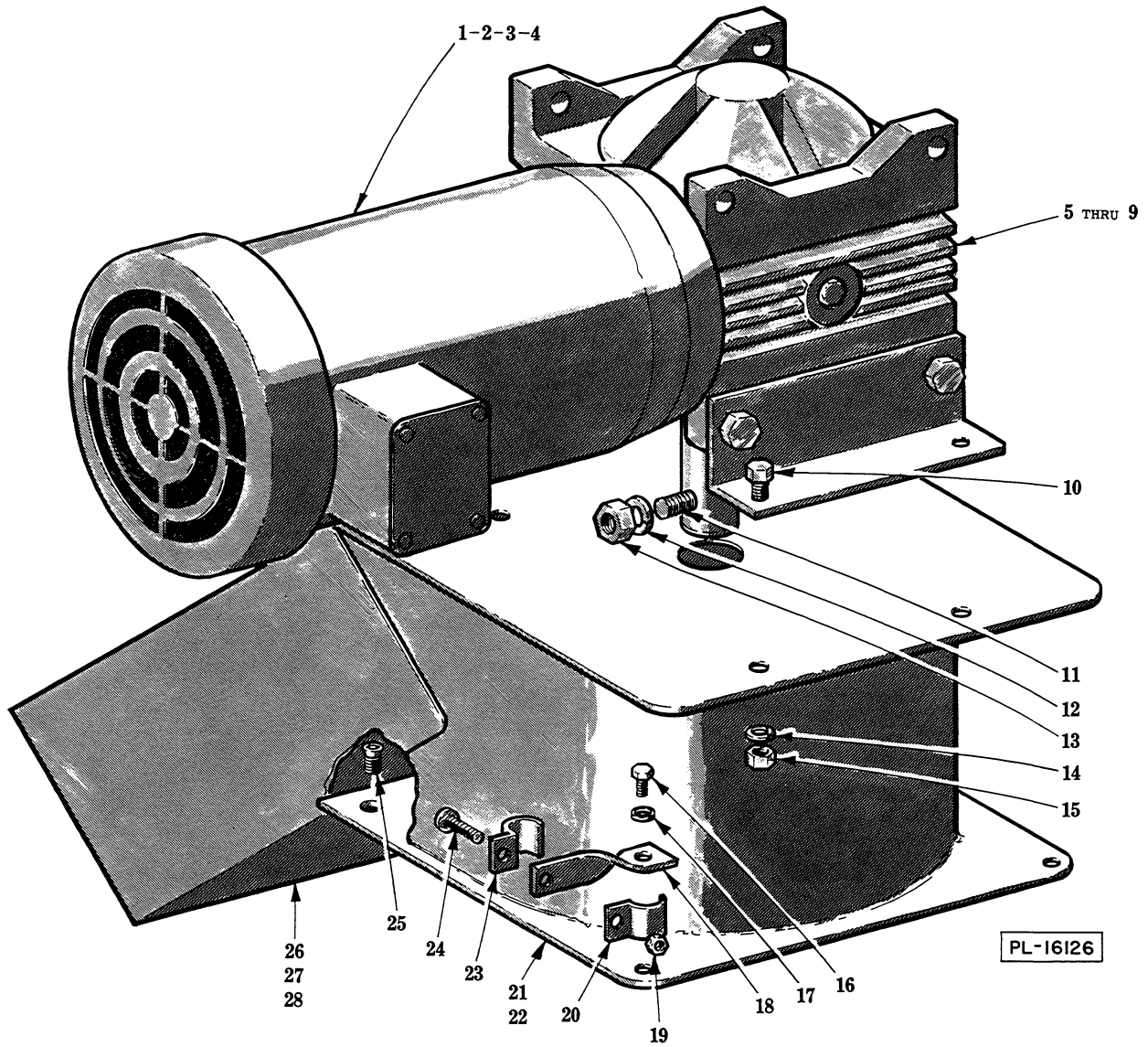

DISCHARGE UNIT

DISCHARGE UNIT

ILLUS. PL-16126	PART NO.	NAME OF PART	AMT.
1	D-223476-1	Motor - Water Press (200 V., 60 Hz.) (3 Ph.)	1
2	D-223476-2	Motor - Water Press (230/460 V., 60 Hz.; 200 V., 50 Hz.) (3 Ph.)	1
3	SC-36-54	Fin. Bolt - 3/8"-16 x 1" Hex Hd	4
4	WL-6-28	Lock Washer - 3/8" Medium	4
5	E-222583-1	Gear Reducer (Incls. items #6 thru 9)	1
6	B-223610	Seal - Oil (1-1/4" Dia. Shaft)	1
7	B-223611	Seal - Oil (1-3/4" Dia. Shaft)	1
8	BB-21-5	Ball Bearing - Fafnir #5305-KG	1
9	BR-3-1	Roller Bearing - Cup & Cone Assy	1
10	SC-41-30	Fin. Bolt - 3/8"-16 x 1" Hex Hd	4
11	SC-37-43	Fin. Bolt - 1/2"-13 x 2-1/2" Hex Hd	1
12	WL-6-36	Lock Washer - 1/2" Medium	1
13	NS-15-20	Full Nut - 1/2"-13 Hex Fin	1
14	WL-6-28	Lock Washer - 3/8" Medium	4
15	NS-15-13	Full Nut - 3/8"-16 Hex Fin	4
16	SC-41-5	Fin. Bolt - 1/4"-20 x 5/8" Hex Hd	2
17	WL-6-17	Lock Washer - 1/4" Medium	2
18	B-222431-1	Bracket - Conduit Clamp	1
19	NS-15-1	Full Nut - 1/4"-20 Hex Fin	1
20	FE-18-35	Clamp - 3/4" Conduit	1
21	C-216042-1	Discharge Housing Sub-Assy. (Std. Chute)	1
22	C-216042-2	Discharge Housing Sub-Assy. (Thru Wall Chute)	1
23	FE-18-35	Clamp - 3/4" Conduit	1
24	SC-21-39	Mach. Screw - 1/4"-20 x 5/8" Rd. Hd	1
25	SC-110-34	Cap Screw - 1/4"-20 x 1/2" Soc. Flat Hd	2
26	C-223103	Discharge Chute Sub-Assy. (Std. Chute) (Incls. items #1, 2 & 3 on Pg. 21)	1
27	SC-67-27	Mach. Screw - 1/4"-20 x 3/8" Indented Hex Hd	3
28	WL-6-17	Lock Washer - 1/4" Medium	3

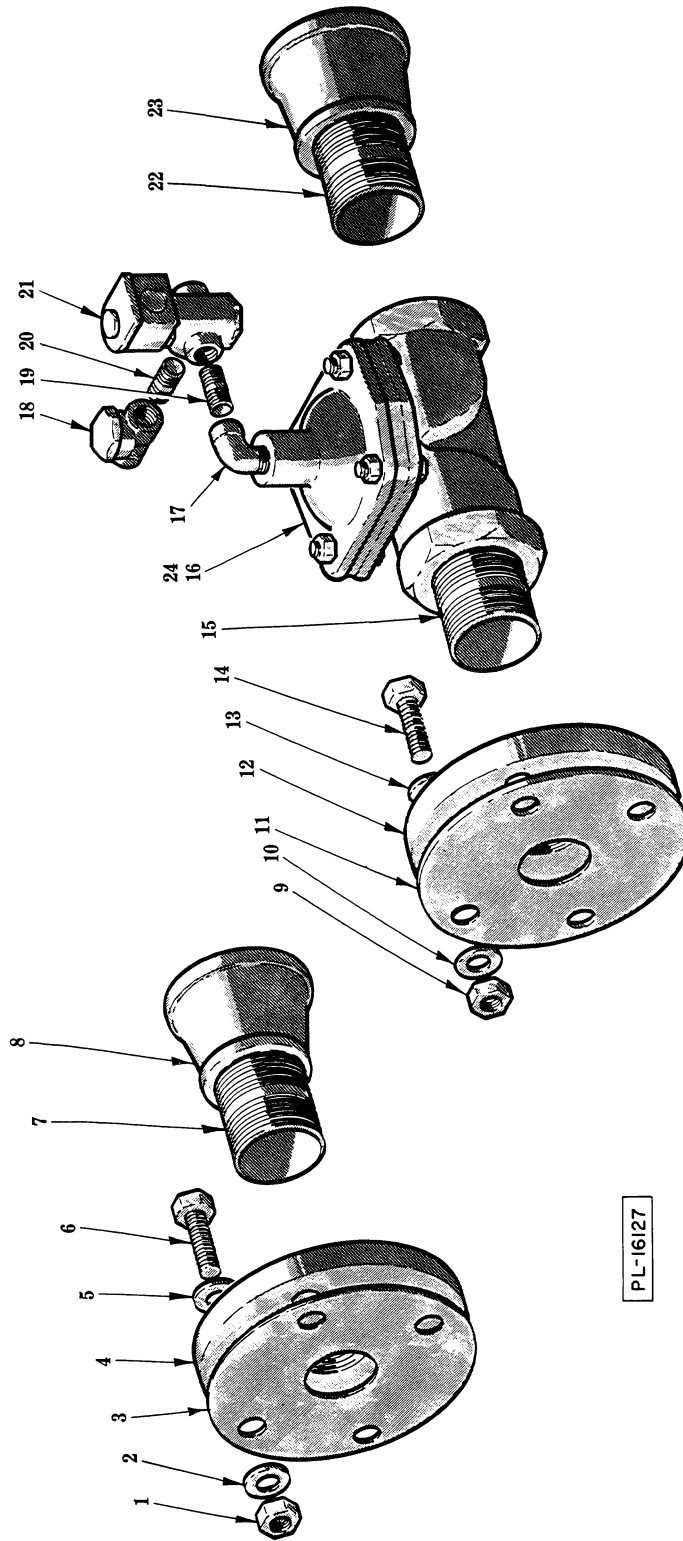

PL-16127

SLURRY INLET UNIT

SLURRY INLET UNIT

ILLUS. PL-16127	PART NO.	NAME OF PART	AMT.
1	NS-15-13	Full Nut - 3/8"-16 Hex Fin	4
2	WS-6-33	Washer	4
3	B-222430-2	Gasket - Full Face (7" O.D.)	1
4	C-223529	Companion Flange (7" O.D.)	1
5	WS-6-33	Washer	4
6	SC-36-59	Fin. Bolt - 3/8"-16 x 1-1/2" Hex Hd	4
7	FP-43-6	Nipple - 2" x 2" Lg. (T.B.E.)	1
8	FP-25-12	Coupling (3" to 2" Reducing)	1
9	NS-15-13	Full Nut - 3/8"-16 Hex Fin	4
10	WS-6-33	Washer	4
11	B-222430-2	Gasket - Full Face (7" O.D.)	1
12	C-223529	Companion Flange (7" O.D.)	1
13	WS-6-33	Washer	4
14	SC-36-59	Fin. Bolt - 3/8"-16 x 1-1/2" Hex Hd	4
15	FP-43-6	Nipple - 2" x 2" Lg. (T.B.E.)	1
16	A-223041-1	Diaphragm Valve (Incls. item #24)	1
17	FP-15-6	Elbow - 1/4" x 90° Street	1
18	A-223044-1	Check Valve - 1/4"	1
19	FP-40-9	Nipple - 1/4" x 1-1/4" Lg. (T.B.E.)	1
20	FP-40-9	Nipple - 1/4" x 1-1/4" Lg. (T.B.E.)	1
21	C-223470	Solenoid Valve - 1/4"	1
22	FP-43-6	Nipple - 2" x 2" Lg. (T.B.E.)	1
23	FP-25-12	Coupling (3" to 2" Reducing)	1
24	FP-10-40	Diaphragm	1

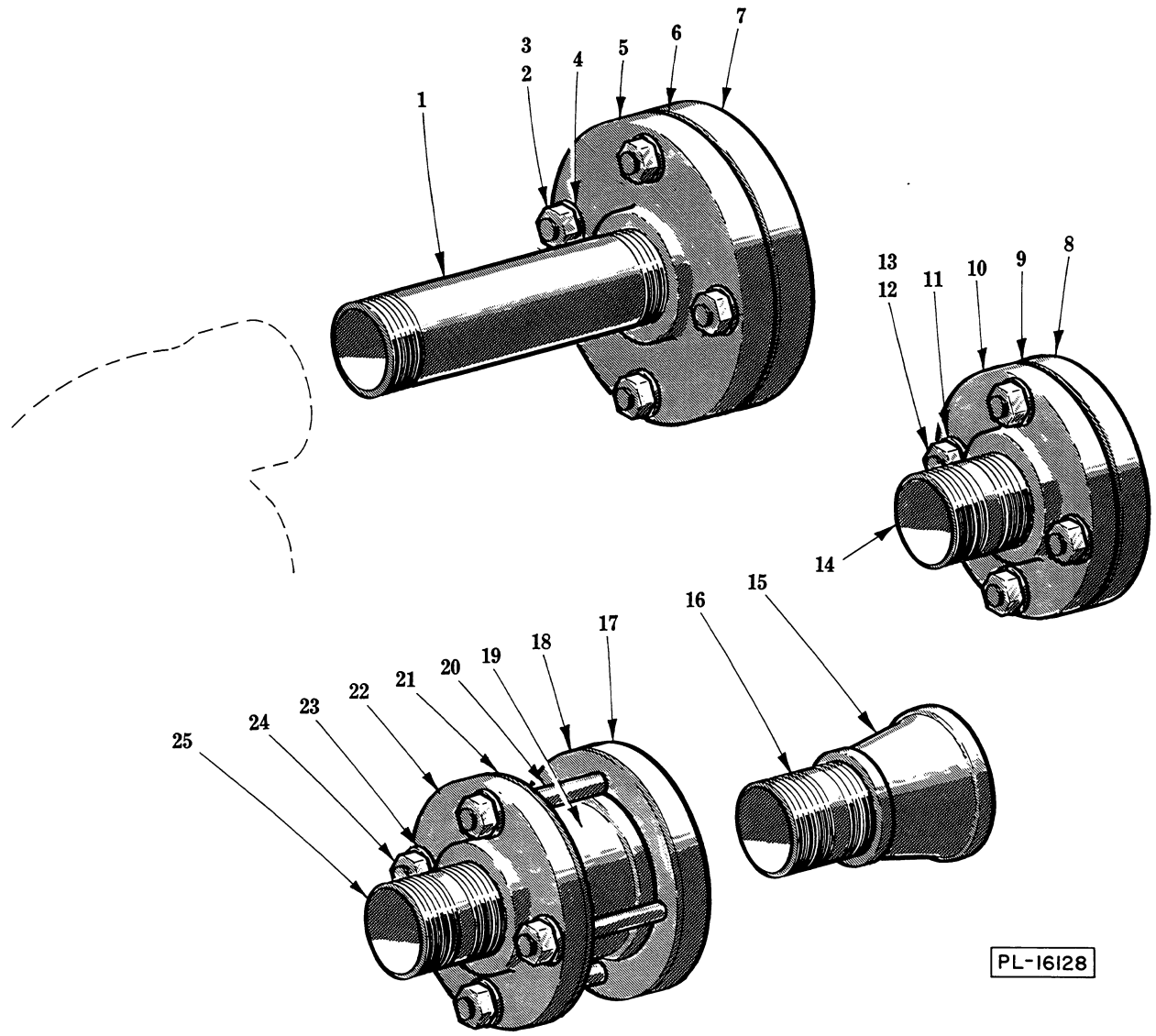

DISCHARGE PIPING UNIT

DISCHARGE PIPING UNIT

ILLUS. PL-16128	PART NO.	NAME OF PART	AMT.
1	FP-70-25	Nipple - 2" x 7-1/8" Lg. (T.B.E.)	1
2	SC-37-32	Fin. Bolt - 5/8"-11 x 2-1/4" Hex Hd	4
3	NS-15-17	Full Nut - 5/8"-11 Hex Fin	4
4	WS-28-31	Washer	4
5	C-223530	Companion Flange (7-1/2" O.D.)	1
6	C-223540	Gasket - Full Face (7-1/2" O.D.)	1
7	C-223537	Companion Flange (7-1/2" O.D.)	1
8	C-223543	Companion Flange (6" O.D.)	1
9	C-223545	Gasket - Full Face (6" O.D.)	1
10	C-223543	Companion Flange (6" O.D.)	1
11	WS-28-31	Washer	4
12	SC-37-32	Fin. Bolt - 5/8"-11 x 2-1/4" Hex Hd	4
13	NS-15-17	Full Nut - 5/8"-11 Hex Fin	4
14	FP-43-6	Nipple - 2" x 2" Lg. (T.B.E.)	1
15	FP-25-12	Coupling (3" to 2" Reducing)	1
16	FP-43-6	Nipple - 2" x 2" Lg. (T.B.E.)	1
17	C-223543	Companion Flange (6" O.D.)	1
18	C-223545	Gasket - Full Face (6" O.D.)	1
19	A-223045-1	Check Vavle - 2"	1
20	SC-97-60	Fin. Bolt - 5/8"-11 x 4-1/2" Hex Hd	4
21	C-223545	Gasket - Full Face (6" O.D.)	1
22	C-223543	Companion Flange (6" O.D.)	1
23	WS-28-31	Washer	4
24	NS-15-17	Full Nut - 5/8"-11 Hex Fin	4
25	FP-43-6	Nipple - 2" x 2" Lg. (T.B.E.)	1

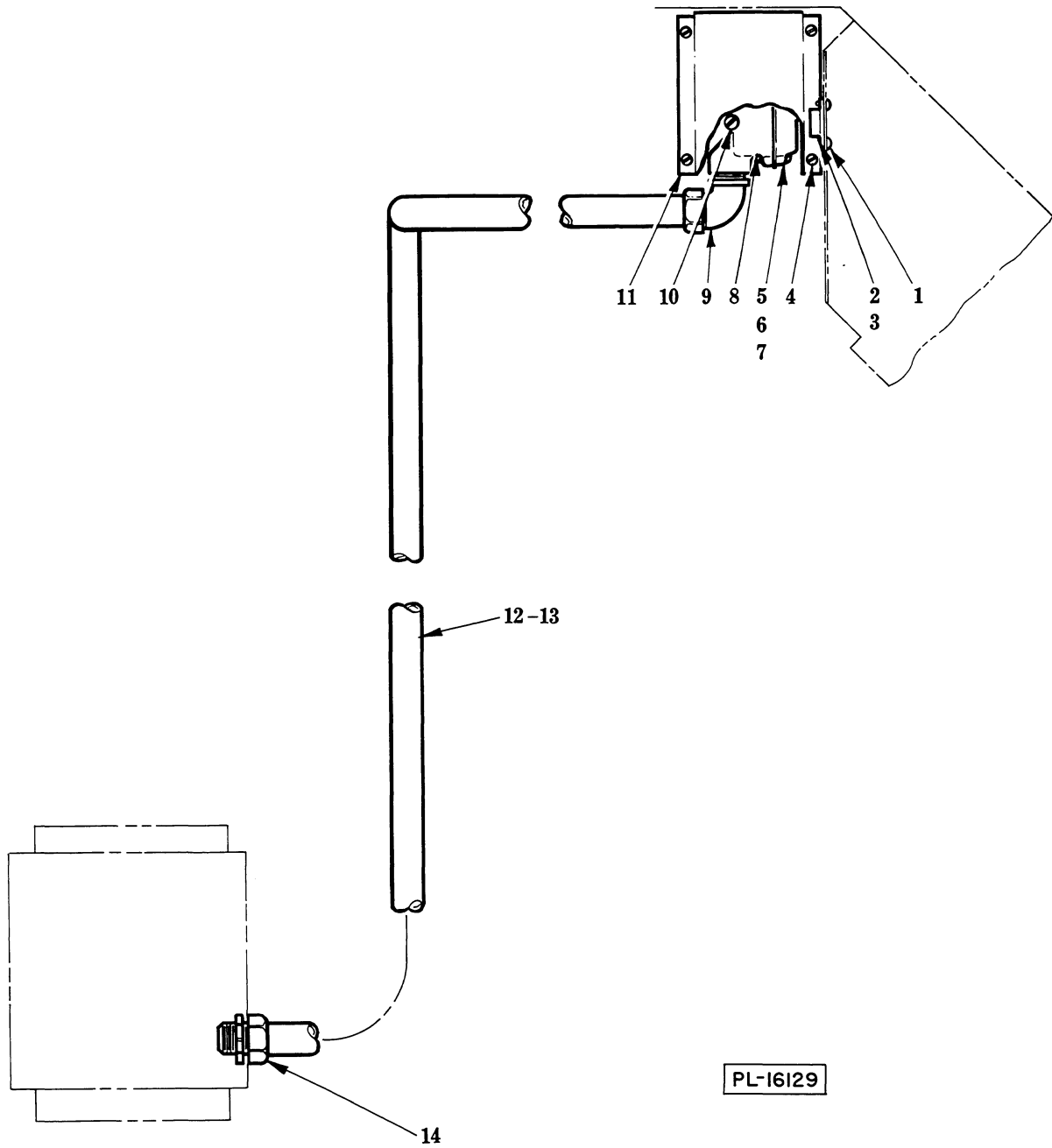

**SAFETY SWITCH UNIT
(STANDARD CHUTE)**

**SAFETY SWITCH UNIT
(STANDARD CHUTE)**

ILLUS. PL-16129	PART NO.	NAME OF PART	AMT.
1	RS-30-8	Rivet - 1/8" Domed Hd	2
2	A-223304	Retainer - Magnet	1
3	B-111941	Magnet	1
4	SC-21-13	Mach. Screw - #8-32 x 1/4" Rd. Hd	4
5	B-114922	Switch & Cover Assy	1
6	SD-25-12	Self-Tapping Screw - #8-18 x 1/2" Phil. Pan Hd "Shakeproof"	2
7	B-106803	Gasket	1
8	D-109366	Housing - Safety Switch	1
9	FE-22-17	Connector - 90° (1/2" Male Thd. x 3/8" Flex. Cnd.)	1
10	SC-98-5	Mach. Screw - #10-24 x 1-1/2" Rd. Hd	2
11	B-222870-1	Box - Reed Switch	1
12	C-222984-7	Conduit - 3/8" x 84" Flex. (L. to R.)	1
13	C-222984-8	Conduit - 3/8" x 66" Flex. (R. to L.)	1
14	FE-22-14	Connector - Straight (1/2" Male Thd. x 3/8" Flex. Cnd.)	1

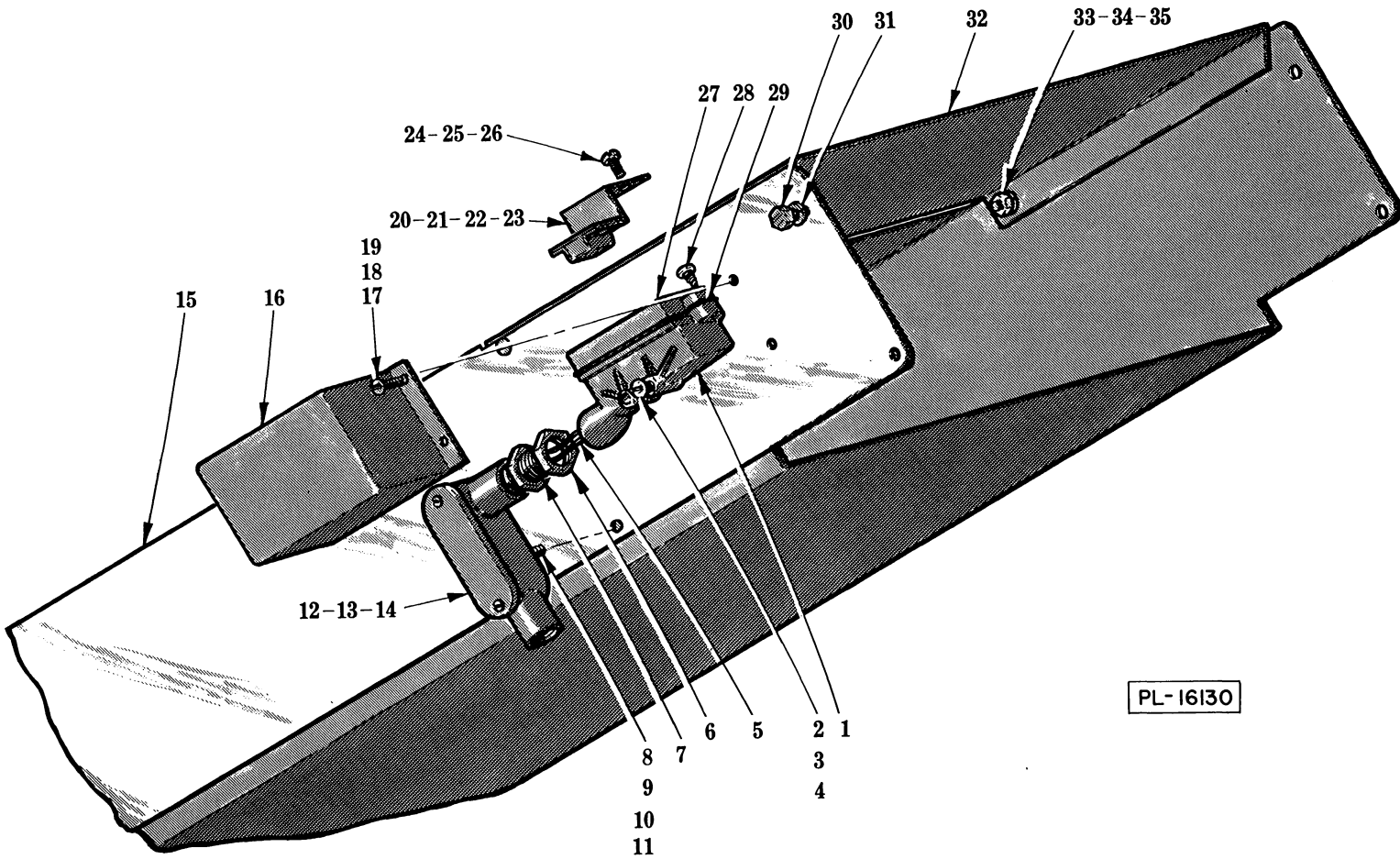

SAFETY SWITCH AND CHUTE UNIT
(THRU WALL)

**SAFETY SWITCH AND CHUTE UNIT
(THRU WALL)**

ILLUS. PL-16130	PART NO.	NAME OF PART	AMT.
1	D-109366	Housing - Safety Switch	1
2	SC-98-5	Mach. Screw - #10-24 x 1-1/2" Rd. Hd	2
3	WL-6-7	Lock Washer - #10 Medium	2
4	NS-11-18	Mach. Nut - #10-24 Hex	2
5	B-223039	Wire & Terminal Assy	2
6	FE-6-7	Lock Nut - 1/2" Conduit	2
7	FE-22-12	Nipple - 1/2" x 1-1/8" Lg. (T.B.E.)	1
8	SC-21-22	Mach. Screw - #10-24 x 3/8" Rd. Hd	2
9	WS-28-8	Washer	2
10	WL-6-7	Lock Washer - #10 Medium	2
11	NS-11-18	Mach. Nut - #10-24 Hex	2
12	B-222921-1	Unilet (Type "LL")	1
13	FE-4-18	Cover - Unilet	1
14	FE-8-35	Gasket	1
15	C-223141	Discharge Chute Assy. (Incls. items #32, 33, 34 & 35)	1
16	B-222919-1	Box - Reed Switch	1
17	SC-21-14	Mach. Screw - #8-32 x 3/8" Rd. Hd	3
18	WL-6-1	Lock Washer - #8 Light	3
19	NS-11-12	Mach. Nut - #8-32 Hex	3
20	B-222918-1	Clip - Mounting	1
21	RS-30-8	Rivet - 1/8" Domed Hd	2
22	A-223304	Retainer - Magnet	1
23	B-111941	Magnet	1
24	SC-21-22	Mach. Screw - #10-24 x 3/8" Rd. Hd	2
25	WL-6-7	Lock Washer - #10 Medium	2
26	NS-11-18	Mach. Nut - #10-24 Hex	2
27	B-114922	Switch & Cover Assy	1
28	SD-25-12	Self-Tapping Screw - #8-18 x 1/2" Phil. Pan Hd "Shakeproof"	2
29	B-106803	Gasket	1
30	SC-67-27	Mach. Screw - 1/4"-20 x 3/8" Indented Hex Hd	4
31	WL-6-17	Lock Washer - 1/4" Medium	4
32	C-223328-1	Cover - Discharge Chute	1
33	SC-21-38	Mach. Screw - 1/4"-20 x 1/2" Rd. Hd	2
34	WL-6-17	Lock Washer - 1/4" Medium	2
35	NS-15-1	Full Nut - 1/4"-20 Hex Fin	2
	C-222916	Reed Switch Sub-Assy. (Incls. items #1, 5, 6, 7, 12, 13, 14, 27, 28 & 29)	1
	B-222917	Magnet & Mounting Clip Assy. (Incls. items #20, 21, 22 & 23)	1

W-38A REPLACEMENT PARTS

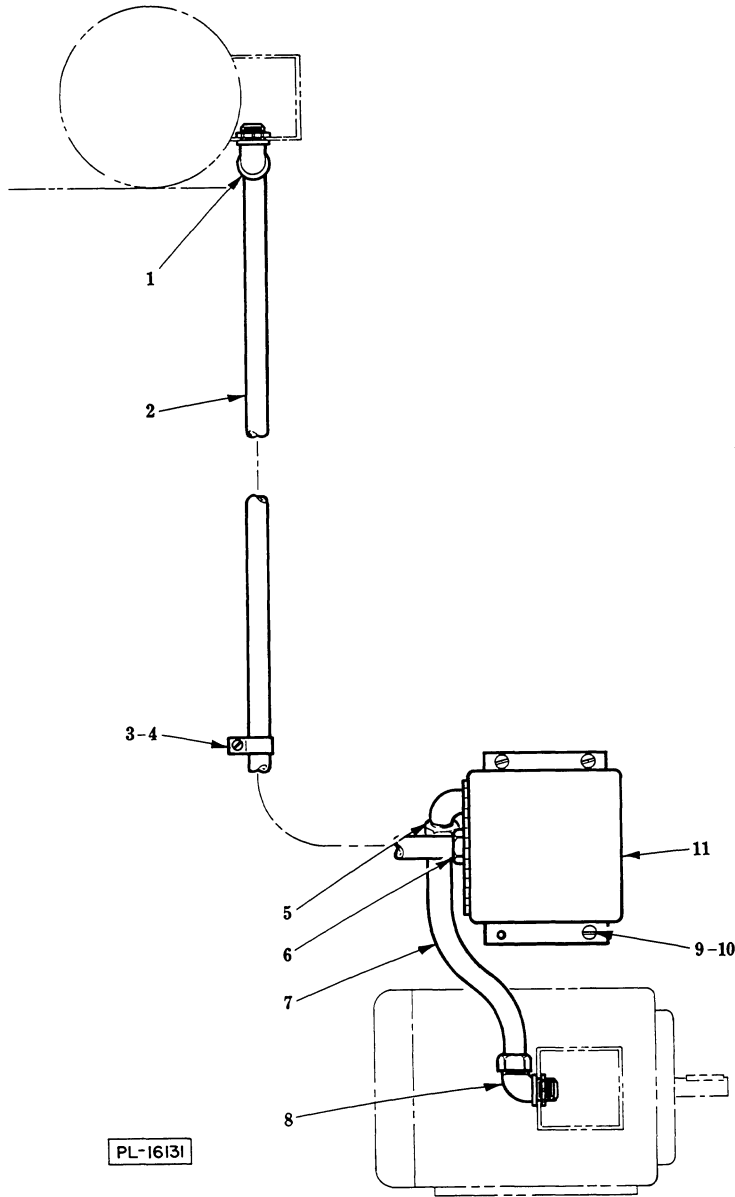

**CONDUIT
(L. TO R. OPERATION)**

ILLUS. PL-16131	PART NO.	NAME OF PART	AMT.
1	FE-22-18	Connector - 90° (1/2" Male Thd. x 1/2" Flex Cnd.)	1
2	C-222983-15	Conduit - 1/2" x 60" Flex	1
3	FE-18-35	Clamp - 3/4" Conduit	1
4	SC-21-39	Mach. Screw - 1/4"-20 x 5/8" Rd. Hd	1
5	FE-22-18	Connector - 90° (1/2" Male Thd. x 1/2" Flex. Cnd.)	1
6	FE-22-15	Connector - Straight (1/2" Male Thd. x 1/2" Flex. Cnd.)	1
7	C-222983-19	Conduit - 1/2" x 24" Flex	1
8	FE-22-18	Connector - 90° (1/2" Male Thd. x 1/2" Flex. Cnd.)	1
9	SC-21-38	Mach. Screw - 1/4"-20 x 1/2" Rd. Hd	3
10	WL-6-17	Lock Washer - 1/4" Medium	3
11	C-223115-1	Junction Box	1

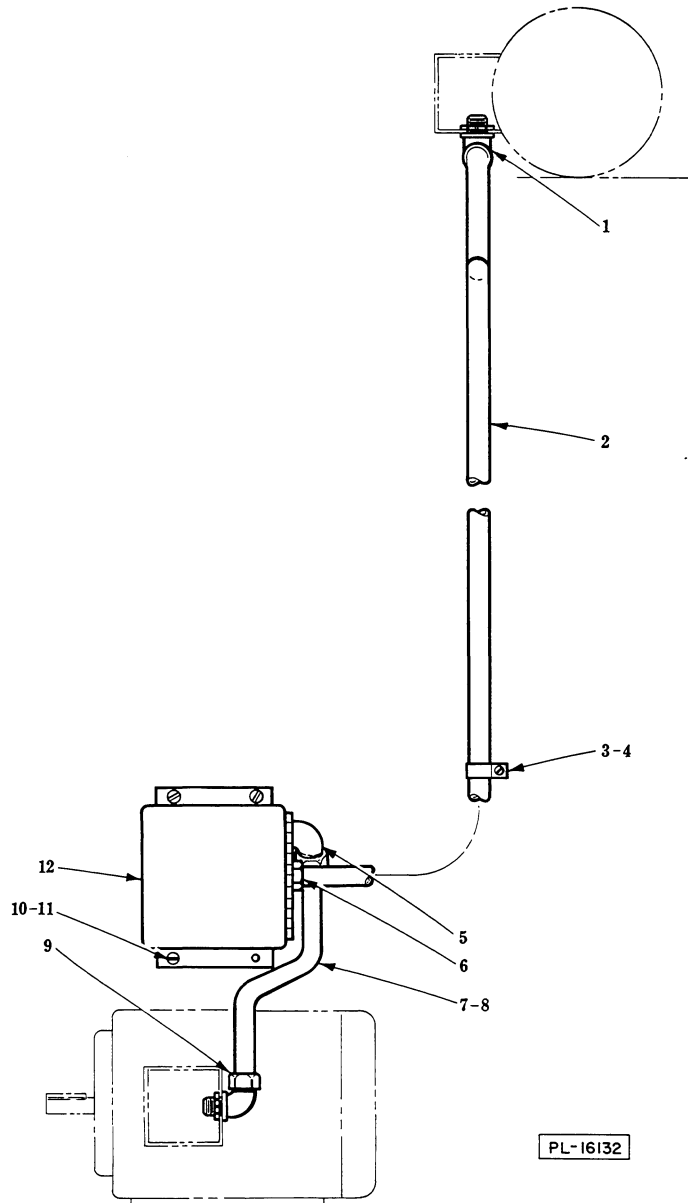

**CONDUIT
(R. TO L. OPERATION)**

ILLUS. PL-16132	PART NO.	NAME OF PART	AMT.
1	FE-22-18	Connector - 90° (1/2" Male Thd. x 1/2" Flex. Cnd.)	1
2	C-222983-12	Conduit - 1/2" x 72" Flex	1
3	FE-18-35	Clamp - 3/4" Conduit	1
4	SC-21-39	Mach. Screw - 1/4"-20 x 5/8" Rd. Hd	1
5	FE-22-18	Connector - 90° (1/2" Male Thd. x 1/2" Flex. Cnd.)	1
6	FE-22-15	Connector - Straight (1/2" Male Thd. x 1/2" Flex. Cnd.)	1
7	C-222983-11	Conduit - 1/2" x 36" Flex. (2 H.P.)	1
8	C-222983-20	Conduit - 1/2" x 30" (3 & 5 H.P.)	1
9	FE-22-18	Connector - 90° (1/2" Male Thd. x 1/2" Flex. Cnd.)	1
10	SC-21-38	Mach. Screw - 1/4"-20 x 1/2" Rd. Hd	3
11	WL-6-17	Lock Washer - 1/4" Medium	3
12	C-223115-1	Junction Box	1

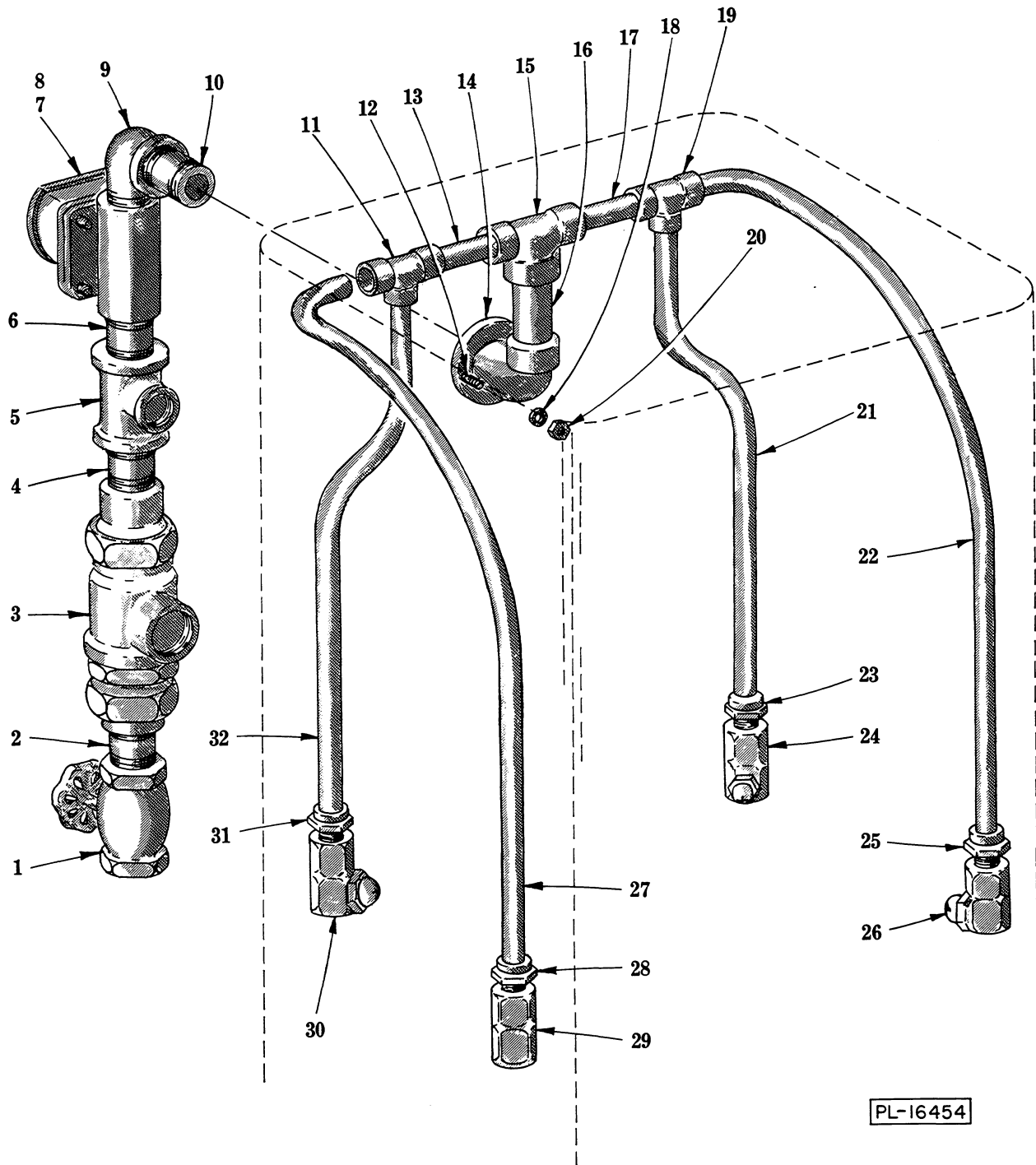

SCREEN FLUSH UNIT

SCREEN FLUSH UNIT

ILLUS. PL-16454	PART NO.	NAME OF PART	AMT.
1	FP-77-37	Valve - 1/2" Globe	1
2	FP-40-45	Nipple - 1/2" x 1-1/2" Lg. (T.B.E.)	1
3	C-223472	Preventor - Back Flow	1
4	FP-40-45	Nipple - 1/2" x 1-1/2" Lg. (T.B.E.)	1
5	FP-69-6	Tee - 1/2" x 1/2" x 1/4" Reducing	1
6	FP-40-45	Nipple - 1/2" x 1-1/2" Lg. (T.B.E.)	1
7	C-223461	Solenoid Valve - 1/2" (Incls. item #8)	1
8	A-222602-2	Coil - Solenoid Valve	1
9	FP-15-17	Elbow - 1/2" x 90° Street	1
10	FP-40-45	Nipple - 1/2" x 1-1/2" Lg. (T.B.E.)	1
11	A-223366-1	Tee - 1/4" Tube	1
12	SC-21-23	Mach. Screw - #10-24 x 1/2" Rd. Hd	2
13	B-223367-3	Tube - 1/4" x 2-1/2" Lg	1
14	A-223365-1	Elbow - 90° (1/2" Tube - 1/2" Female Pipe)	1
15	A-223366-2	Tee - 1/2" Tube x 1/4" Tube x 1/4" Tube Reducing	1
16	B-223367-1	Tube - 1/2" x 1-11/16" Lg	1
17	B-223367-3	Tube - 1/4" x 2-1/2" Lg	1
18	WL-6-7	Lock Washer - #10 Medium	2
19	A-223366-1	Tee - 1/4" Tube	1
20	NS-11-18	Mach. Nut - #10-24 Hex	2
21	B-223367-4	Tube - 1/4" x 6-1/2" Lg	1
22	B-223367-6	Tube - 1/4" x 16" Lg	1
23	B-223505	Adapter - Male (1/4" Tube x 1/8" Male Pipe)	1
24	B-223517	Nozzle - Spray (1/8" Thd.)	1
25	B-223505	Adapter - Male (1/4" Tube x 1/8" Male Pipe)	1
26	B-223517	Nozzle - Spray (1/8" Thd.)	1
27	B-223367-6	Tube - 1/4" x 16" Lg	1
28	B-223505	Adapter - Male (1/4" Tube x 1/8" Male Pipe)	1
29	B-223517	Nozzle - Spray (1/8" Thd.)	1
30	B-223517	Nozzle - Spray (1/8" Thd.)	1
31	B-223505	Adapter - Male (1/4" Tube x 1/8" Male Pipe)	1
32	B-223367-4	Tube - 1/4" x 6-1/2" Lg	1

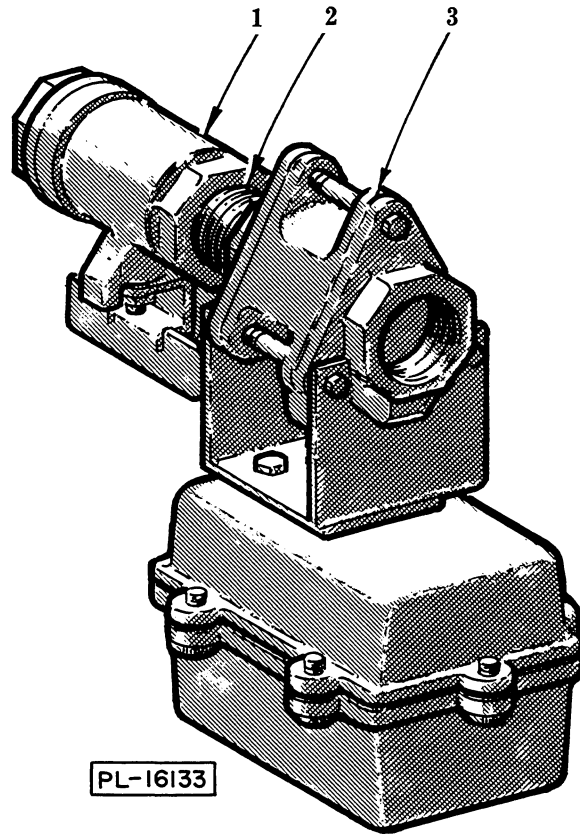

DRAIN VALVE UNIT

ILLUS. PL-16133	PART NO.	NAME OF PART	AMT.
1	A-223220-1	Ball Valve - 1-1/2"	1
2	FP-46-63	Nipple - 1-1/2" x 1-3/4" Lg. (T.B.E.)	1
3	B-223219-1	Motorized Valve - 1-1/2"	1
	B-223225-1	Drain Valve Assy. (Incls. items #1, 2 & 3)	1