

# Parts Catalog



*precisely.*



**Model PS13**

## PORTION SCALES

MODELS:  
PS10 & PS13

12-15-11

IMPORTANT!

TO EXPEDITE SHIPMENT OF PARTS, ALWAYS SPECIFY MODEL, REV,  
PART NUMBER, AND SERIAL NUMBER OF SCALE.

### GLOBE FOOD EQUIPMENT COMPANY

2215 East River Road  
Dayton, Ohio 45439

#### Parts Department

Toll Free 1-800-745-6238 · Fax (937) 290-0585

E-Mail: [globeinfo@globeslicers.com](mailto:globeinfo@globeslicers.com)

Website: [www.globeslicers.com](http://www.globeslicers.com)

Not for resale

# SCALE COMPONENTS

Scale Parts List			
Item	P/N	Description	Qty
1	190020	Lower Housing	1
2	190070	Foot	4
3	P125	Load Cell Assembly	1
4	P123	Spacer, Load Cell	1
5	190050	Upper Plate	1
6	190100	Bumper	5
7	190030	Platter	1
8	P124	Screw, Upper - Load Cell	2
9	190060	Screw, Lower - Load Cell	2
10	P128	Load Cell Cable Assembly	1

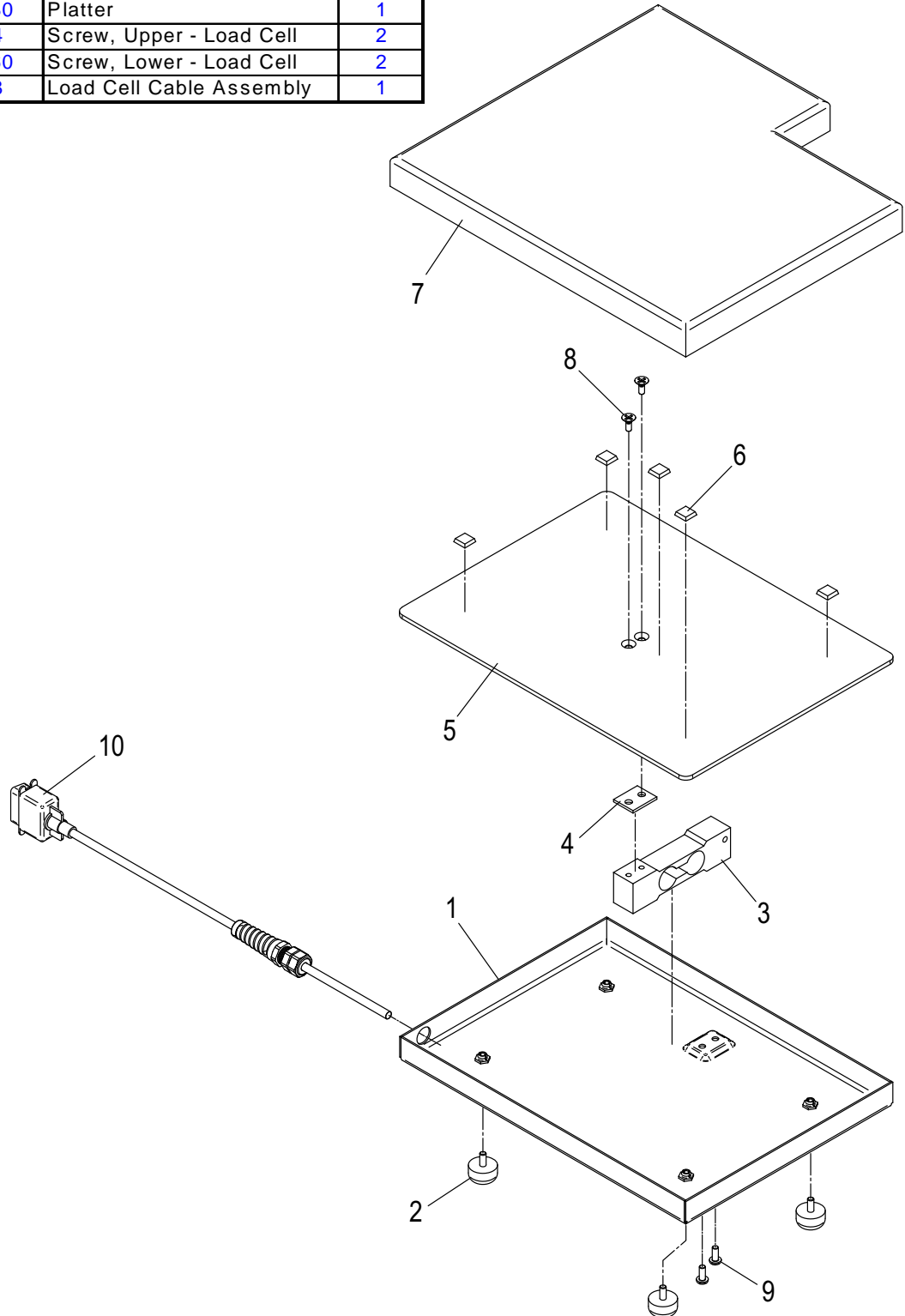

# INDICATOR COMPONENTS

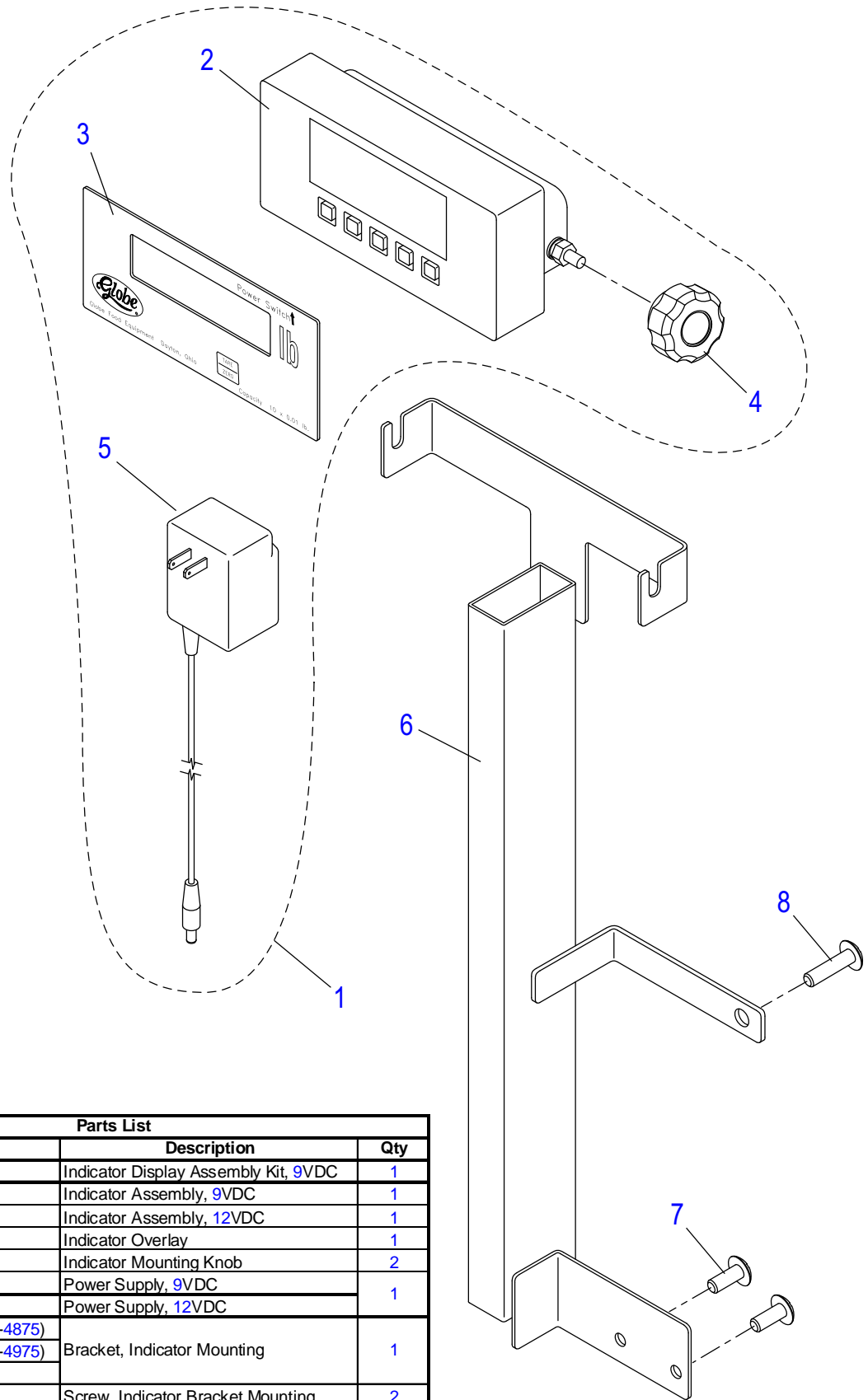

Parts List			
Item	P/N	Description	Qty
1	P100-9VDC-K	Indicator Display Assembly Kit, 9VDC	1
2	P100-9VDC	Indicator Assembly, 9VDC	1
	*P100	Indicator Assembly, 12VDC	1
3	P101	Indicator Overlay	1
4	P103	Indicator Mounting Knob	2
	P111-9VDC	Power Supply, 9VDC	1
P111	Power Supply, 12VDC		
6	P110 (PS10, 3500-4875)	Bracket, Indicator Mounting	1
	P129 (PS10, 3600-4975)		
	330060 (PS13)		
7	P131	Screw, Indicator Bracket Mounting	2
**8	810300	Screw, Motor Cover	1

\*Not available after S/N 091007. Replace 12VDC components with 9VDC Indicator & Power Supply Kit. \*\*Use existing hardware from Slicer.

