

Parts Catalog



GHP36G

Hot Plate Gas Cooking Equipment Model: GHP36G

08/15/2023 Rev B

IMPORTANT!

TO EXPEDITE SHIPMENT OF PARTS, ALWAYS SPECIFY MODEL, REV,
PART NUMBER, AND SERIAL NUMBER OF UNIT.

GLOBE FOOD EQUIPMENT COMPANY

2215 East River Road
Dayton, Ohio 45439

Parts Department

Toll Free 1-800-745-6238 · Fax (937) 290-0585

E-Mail: info@globefoodequip.com

Website: www.globefoodequip.com

Not for resale

Table of Contents

Description

Page

GHP36G Hot Plate Components

4

GHP36G Gas Orifice Elevation Chart

6



GHP36G Hot Plate Components

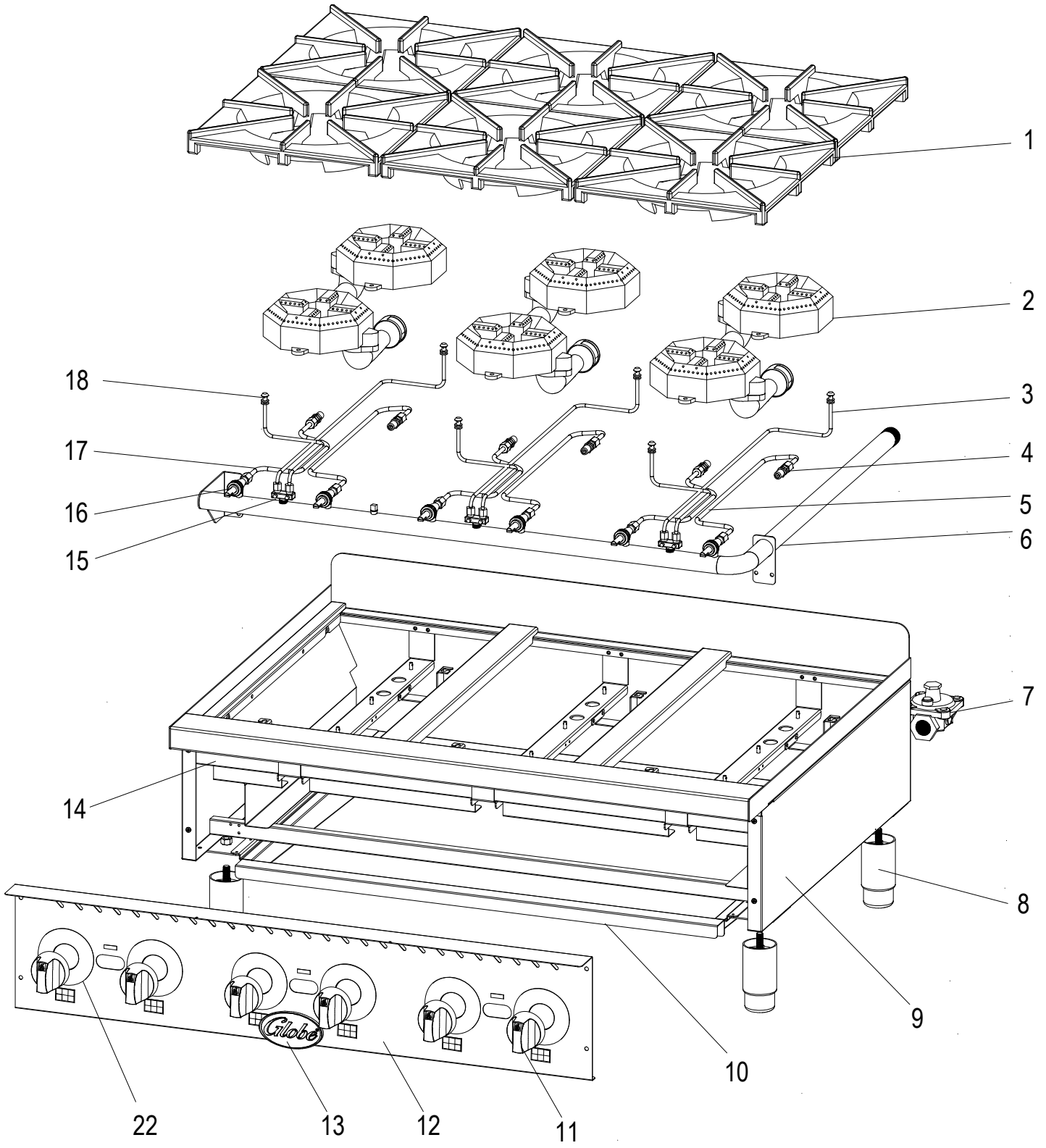



GHP36G Hot Plate Components

Item	Part Number	Description	Qty	Serial Number
1	U01072	Trivet	6	
2	U02042	Burner Assembly	6	
3	U01537	Back Pipe, Pilot Assembly	3	1814118747 ->
4	U06051470695	Hood Orifice (2 Pack) #46	6	
4	U06051470693	Hood Orifice #54	6	
4	U06051470929	Hood Orifice #47	6	
4	U06057470836	Hood Orifice (2 Pack) #55	6	
4	U06051470881	Hood Orifice (2 Pack) #48	6	
4	U01201068649	Hood Orifice #49	6	
4	U06051470896	Hood Orifice #56	6	
4	U01201068651	Hood Orifice #51	6	
5	U02003	Rear Gas Pipe	3	
6		Manifold Assembly	1	
7	U01221069501	Regulator	1	
8	U01021005165	Foot	4	
9		Main Enclosure	1	
10	U00815	Drip Tray	1	1814118747 ->
11	U01021005188	Control Knob	6	
12	U03036	Front Panel	1	
13	U01021005383	Globe Badge	1	
14		Isolating Plate Front	3	
15	U01201068502	Manual Control Valve (A18)	3	
16	U01201068508	Pilot Valve	6	
17	U02004	Front Gas Pipe	3	
18	U01536	Front Pipe, Pilot Assembly	3	1814118747 ->
19	U01021005186	Ignition Bar	1	Not Shown
20		Fixture Block, Pilot Pipe	6	Not Shown
21	U03021	Top Support Bar	1	Not Shown
22	U04031317503	Control Knob Overlay	1	



GHP36G Gas Office Elevation Chart

Model	Rated Input Per Burner (BTU/HR)	Elevation		Elevation	
		Nat	LP	Nat	LP
		0-2000 ft		2000 - 4000 ft	
		Nat	LP	Nat	LP
Hot Plate	22500	U06051470695 (#46)	U06051470693 (#54)	U06051470929 (#47)	U06051470836 (#55)
		Elevation		Elevation	
		4000 - 6000 ft		6000 - 8000 ft	
		Nat	LP	Nat	LP
Hot Plate	22500	U06051470881 (#48)	U06051470836 (#55)	U01201068649 (#49)	U06051470896 (#56)
		Elevation			
		8000 - 10000 ft			
		Nat	LP		
Hot Plate	22500	U01201068651 (#51)	U06051470896 (#56)		