

Model: OVH-10



Model: PO-VH



Responsive. Reliable.

ISO 9001-2015 Registered • Committed to Quality  
2750 Gunter Park Drive West • Montgomery, AL 36109 USA  
Phone: 334.272.1457 • Toll Free: 800.554.4537 (USA & Canada Only)  
Fax: 334.239.4117 • Website: [www.gfse.com](http://www.gfse.com)

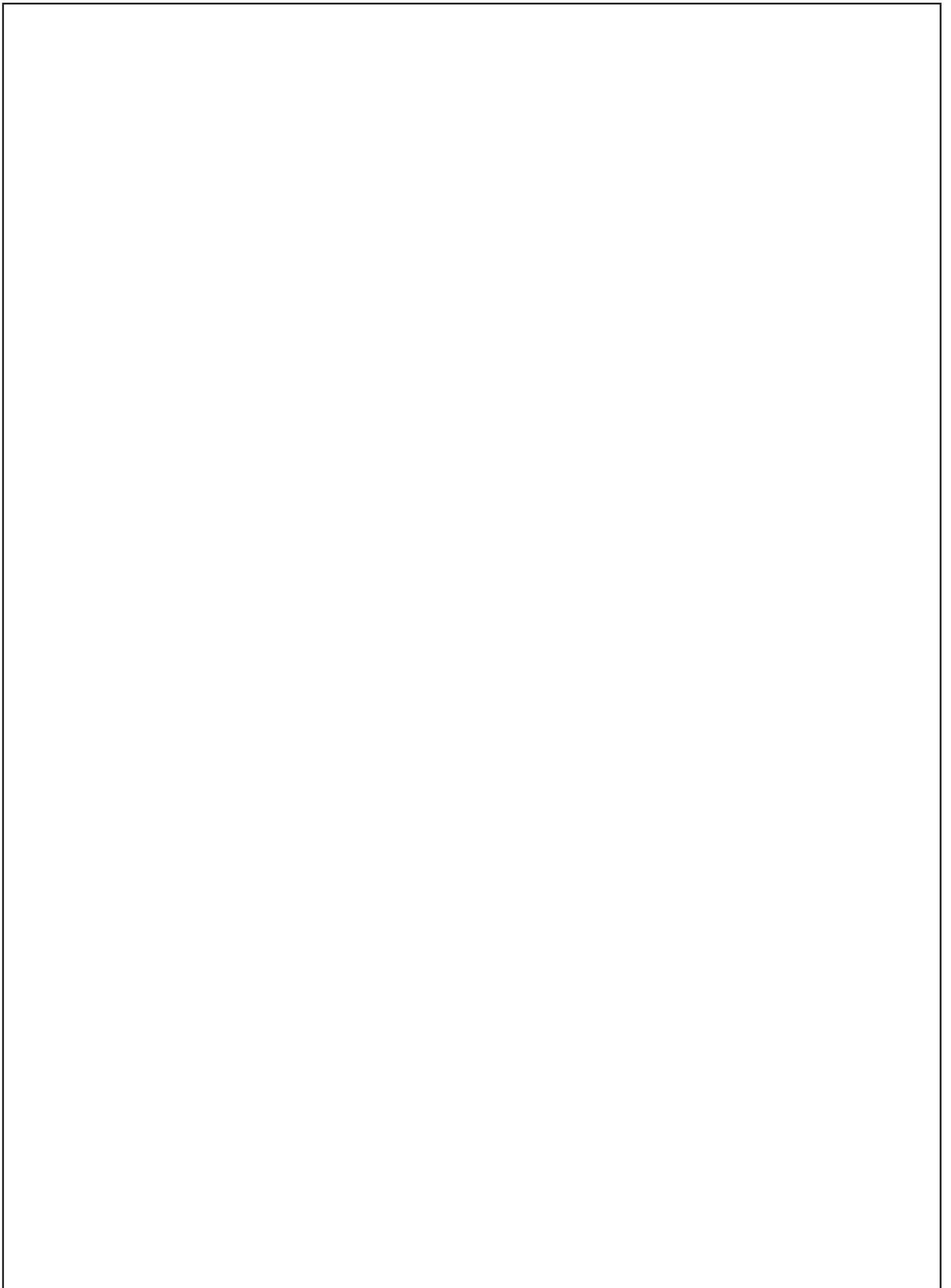



Responsive. Reliable.

## LIMITED WARRANTY

- Subject to the terms and conditions of this Limited Warranty as herein stated, all Giles Enterprises Inc. (hereafter referred to as "Giles") food service equipment and parts purchased new from an authorized Giles representative are warranted as to defects in material or workmanship for a period of twenty-four (24) months from the date of installation, provided, however, that with regard to labor costs in connection with this warranty, see below. All installations must be made by a qualified installing agency in accordance with all applicable codes and/or regulations in the jurisdiction in which installed. Limited warranty coverage is extended only to the original owner and is void if the unit is resold.
- During the Limited Warranty period, Giles will replace or recondition, at its factory, any part or parts of this unit which Giles inspectors judge defective, provided the unit has been properly installed, subjected to normal usage, and operated and maintained in accordance with specified procedures. This Limited Warranty does not cover cosmetic damage, and damage due to acts of God, accident, misuse, alteration, negligence, abuse, or use of unorthodox repair methods. All parts replaced under this Limited Warranty carry only the unexpired term of this Limited Warranty. Limited Warranty service may be furnished only by an authorized Giles service representative.
- If Limited Warranty service is requested, Giles will dispatch factory-authorized service representatives to inspect, repair, recondition, or replace units of its manufacture with such labor being rendered without cost to owner for twenty-four (24) months from the date of installation. Otherwise, service, including labor and transportation charges or other expenses, in connection with the removal or installation of any part or parts supplied under this Limited Warranty, are specified on the original sales contract between the purchaser and the authorized Giles representative.
- **Failure to use Giles OEM replacement parts and Giles OEM filters may void this Warranty.**
- Giles reserves the right to change or improve its equipment and/or parts in any way without obligation to alter such equipment or parts previously manufactured.
- Giles makes no further warranties, express or implied, including implied warranties of merchantability or fitness for a particular purpose, and has no other obligation or liability not specifically stated herein.
- Repair or replacement as provided under this limited warranty is the exclusive remedy. Giles shall not be liable for any incidental or consequential damages for breach of any express or implied warranty on this product, except to the extent prohibited by applicable law. Any implied warranty of merchantability or fitness for a particular purpose on this product is limited in duration to the duration of this limited warranty.
- Used Giles foodservice equipment or parts, or Giles foodservice equipment or parts not purchased from an authorized Giles representative, carry no warranties, express or implied.



## Safety v

Safety Overview .....	v
Specific Safety Precautions .....	vi

## 1. Introduction ..... 1

1.01 Construction .....	1
1.02 Standard Features .....	1
1.03 Optional Features .....	2
1.04 Specifications .....	2
1.04.1 Overall Dimensions for PO-VH (UCM) .....	2
1.04.2 Overall Dimensions for OVH-10 (UCM) .....	3
1.04.3 Regulatory Listings .....	4
1.04.4 Hood Weights .....	4
1.04.5 Appliance Limitations & Clearances: PO-VH Hood .....	4
1.04.6 Appliance Limitations & Clearances: OVH-10 Hood .....	4

## 2. Installation ..... 5

2.01 Location .....	5
2.02 Unpacking .....	6
2.03 Mounting the Hood .....	6
2.04 Electrical Specification .....	7
2.05. Electrical Connections .....	8
2.05.1 Routing Power Wires .....	9
2.05.2 Electrical Connections for Installation over a 208/240V Appliance .....	9
2.05.3 Electrical Connections for Installation over a 480V Appliance .....	10
2.06. Skirt Corner Guards Installation (certain PO-VH only) .....	10
2.07. Fire Suppression System Factory-Installed Pre-Plumb .....	11
2.07.1 General Installation w/Fire System Pre-Plumb Option .....	11
2.07.2 Fire Suppression - Final System Installation .....	12

## 3. Overview ..... 13

3.01 Hood Controls & Indicators .....	14
3.01.1 PO-VH Model .....	14
3.01.2 OVH-10 Model .....	16
3.02 Filter Chamber & Exhaust .....	18
3.03 Accessories (Included) .....	20

## 4. Operation & Filter Maintenance ..... 23

4.01 Hood Operation .....	23
4.02 Filters, Filter Maintenance & Filter Alarms .....	23
4.02.1 Ventless Hood Filter Table .....	23
4.02.2 Accessing the Filter Chamber .....	24
4.02.3 Filter Management .....	26
4.02.3.1 Baffle Filter Removal/Installation .....	26
4.02.3.2 E.A.C. Filter Cell Removal/Installation .....	27
4.02.3.3 Charcoal Filter Removal/Installation .....	28

4.02.4	Hood Filter Alarms . . . . .	29
4.02.4.1	Charcoal or Baffle Filter Missing . . . . .	29
4.02.4.2	Charcoal or Baffle Filter Clogged . . . . .	29
4.02.4.3	E.A.C. Filter Status & Alarm . . . . .	30
4.02.5	Filter Cleaning & Maintenance . . . . .	31
4.02.5.1	Baffle Filter Cleaning . . . . .	31
4.02.5.2	E.A.C. Filter Cell Cleaning . . . . .	31
4.02.5.3	Charcoal Filter Maintenance . . . . .	33
<b>5.</b>	<b>Hood Cleaning &amp; Maintenance . . . . .</b>	<b>35</b>
5.01	Quarterly Hood Cleaning . . . . .	35
5.02	Monthly Hood Interlock Inspection . . . . .	36
5.03	Fire Suppression System Maintenance (Only for Hood w/Required Fire System) . . . . .	37
5.03.1	Semi-Annual Inspection & Maintenance . . . . .	37
5.03.2	Annual Inspection & Maintenance . . . . .	37
5.03.3	12-Year Inspection & Maintenance . . . . .	38
5.04	Inspection & Maintenance Log . . . . .	39
<b>6.</b>	<b>Troubleshooting . . . . .</b>	<b>40</b>
6-01	Troubleshooting Procedures . . . . .	40
<b>7.</b>	<b>Parts List . . . . .</b>	<b>43</b>
7.01	Parts Ordering & Service Information . . . . .	43
7.02	Control Panel: PO-VH . . . . .	44
7.03	Control Panel: OVH-10 . . . . .	46
7.04	Fan Compartment: PO-VH . . . . .	48
7.05	Fan Compartment: OVH-10 . . . . .	50
7.06	Filter Compartment: PO-VH . . . . .	52
7.07	Filter Compartment: OVH-10 . . . . .	54

## Safety

### Safety Overview:

The information contained in this manual has been prepared to describe the proper procedures for safely installing, operating and maintaining *Giles Food Service Equipment*.

Throughout the manual, safety precautions are identified by a hazard alert symbol and key words such as **DANGER**, **WARNING** or **CAUTION**. Alert information precedes the tasks to which it applies. Suggested, recommended, or other noteworthy information is identified as **NOTES**, or will be noted as **IMPORTANT!**. Additionally, certain words are used to indicate a specific meaning, or to add emphasis as follows:

- Shall:** understood to be mandatory.
- Should:** understood to be advisory.
- May:** understood to be permissive.
- Will:** indicates a future event or condition to occur.

 **Hazard Alert Symbols** are used in conjunction with key words, such as **DANGER**, **WARNING**, or **CAUTION**, to alert Users to potential personal injury hazards and/or poor operating practices. These will immediately precede precautionary measures pertaining to avoiding such hazards or practices. Adhere to all information following these symbols to avoid possible injury, or even death. Failure to do so may also void the factory warranty.

 *This product can expose users to chemicals including lead, nickel, aluminum, brass, carbon, copper or BPA which are known in the state of California to cause cancer, birth defects and other reproductive harm. For more information go to: [www.p65warnings.ca.gov](http://www.p65warnings.ca.gov).*

### DANGER

- Indicates an imminently hazardous situation which, if not avoided, will result in serious personal injury, even death.

### WARNING

- Indicates a potentially hazardous situation which, if not avoided, could result in serious injury, even death.

### CAUTION

- Indicates a potentially hazardous situation which, if not avoided, may result in minor to moderate injury. This notification is also used as an alert to unsafe practices.

### CAUTION

- If used without the safety alert symbol, indicates a potentially hazardous situation which, if not avoided, may result in equipment and/or property damage, and may void the factory warranty.

### NOTE or IMPORTANT!

- Identifies suggested, recommended, or other important information.

### Specific Safety Precautions:

For your safety, please observe the following precautions when operating or servicing **OVH-10 or PO-VH Model Ventless Recirculating Hoods**. Adhering to the following important safety information will help to prevent personal injury and/or damage to the equipment.

#### DANGER

- Before cleaning or performing maintenance, place power switch in the [OFF] position. To remove all power from the appliance, unplug power cord or turn OFF power at the electrical panel supplying the unit.
- Failure to place **Power Switch** in the [OFF] position when replacing filters, could result in equipment damage, electrical shock and/or serious personal injury.
- **DO NOT** wash down interior or exterior of hood with water from a spray hose.
- Failure to comply with **DANGER** notices will result in serious injury, even death; or damage to equipment and/or property and may void the factory warranty.

#### WARNING

- Ventless/recirculating hoods are not suitable for every commercial food service application. Failure to fully comply with all site requirements and installation limitations as outlined in the GFSE Hood Approval Letter and this Manual, may result in poor or highly unsatisfactory hood performance.
- **DO NOT** use ventless/recirculating hoods with gas-fired cooking appliances due to high potential of inhalation hazard due to carbon monoxide build-up in the kitchen area. Hood is approved ONLY for use with electrically heated appliances.
- Prior to installation, consult a qualified electrician to ensure that installation will comply with all electrical requirements and codes.
- The unit must be adequately and properly grounded. Improper grounding may result in electrical shock to the user. Always refer to local electrical code to ensure proper grounding of this or any other electrical equipment.
- Check the rating label on the unit to determine the proper power supply required. Always consult with an electrician, or other qualified service technician, to ensure that circuit breakers and wiring are of sufficient rating and gauge to power this equipment. A wiring diagram has been provided with the unit as an aid for technicians. The unit must be installed and electrically grounded in accordance with local codes, or in the absence of local codes, in accordance with the National Electrical Code, NFPA 70.
- Improper installation, alterations of the unit, or improper service/maintenance could result in serious injury, even death; equipment and/or property damage; and will potentially void the factory warranty.
- **DO NOT** use or store flammable liquids, or materials that produce flammable vapors, in the vicinity of this or any other appliance!
- Failure to comply with **WARNING** notices could result in serious injury, even death; damage to equipment and/or property; and will potentially void the factory warranty.

## Specific Safety Precautions:

### CAUTION

- Exercise care when removing wooden crate framework and the unit from shipping pallet.
- **DO NOT** operate the appliance, unless the intended function of components and all operating procedures are fully understood (see **Section 3**). Once you have read and fully understand **Section 3**, closely follow the instructions presented in this Manual to avoid equipment damage or malfunction.
- The appliance is not intended to be used by persons (including children) with reduced physical, sensory, or mental capabilities, or lack of experience and knowledge, unless they have been given adequate instruction and/or supervision concerning use by a person responsible for their safety. Children should be kept clear of the appliance.
- When working in a kitchen environment, take necessary precautions to avoid injury due to **HOT** cooking appliances, utensils, tools, etc. As applicable, always wear thermal protection, such as oven mitts or gloves, when handling hot pans, utensils or foods.
- Failure to comply with **CAUTION** notices may result in minor to moderate personal injury, damage to equipment or property, and potentially void the warranty.

### CAUTION

- Some components and controls are impact-sensitive. To avoid damage and maintain proper operation, exercise care when moving items and working near the hood.
- Handle the Electronic Air Cleaner (E.A.C.) cell carefully. **DO NOT** bend the collection plates (fins) or break the ionizer wires, as this will significantly reduce the performance of the air cleaning system and can eventually cause power supplying the fryer beneath hood to be shutdown.
- **DO NOT** attempt to dry the E.A.C. cell after cleaning by installing it and running the hood. **NEVER PLACE A WET E.A.C. CELL INTO THE HOOD, as doing so can potentially damage the system and cause improper operation. Such damage is NOT cover by the factory warranty.**
- When cleaning the appliance:
  - **DO NOT** steam clean hood.
  - **DO NOT** clean with products containing chlorine, or other corrosive chemicals.
  - **DO NOT** use abrasive products, steel wool or scouring pads.
  - **DO NOT** use oven cleaner products.
- **DO NOT** alter, add attachments, or otherwise modify this equipment! **DO NOT** attach any type of ductwork extensions to the hood exhaust in an attempt to redirect airflow.
- Failure to comply with **CAUTION** notices may result in damage to equipment or property. Such damages are **NOT** covered by the factory warranty.

**NOTE:**

- When received, If damage to the shipping pallet is evident, immediately and thoroughly inspect the equipment and its accessories. Notify the freight company of any damages. Generally, negotiating freight damage claims shall be the responsibility of the Customer.
- Comply with all appropriate state and/or local health regulations regarding cleaning and sanitation of any foodservice equipment.
- To clean surface areas, having build-up of grease residue, *GILES* recommends using ***Simple Green® Crystal Foaming Spray Cleaner/Degreaser*** (NSF approved, biodegradable, non-toxic).
- *GILES* assumes no responsibility in regard to code compliance for installation and use of Ventless Recirculating Ventilation equipment. The customer is responsible for obtaining all of the necessary approvals from ***Authorities Having Jurisdiction (AHJ)*** concerning installation and use of this equipment.

## 1. Introduction

Thank You! for purchasing a **OVH-10 or PO-VH Ventless Recirculating Hood System** manufactured by *Giles Enterprises, Inc.*, Montgomery, Alabama, USA, hereafter referred to as “*Giles*”. Giles Ventless Hood technology is the result of extensive engineering, research and development. Every unit is thoroughly inspected and tested prior to shipment to ensure it operates flawlessly after installation. With proper care and maintenance these units should provide years of trouble-free service.

These hoods are designed to remove grease-laden vapors from the air emanating from various ovens, conveyor ovens and rotisseries, used in limited/light duty applications, when *Type 1* hoods with a fire suppression system are typically not required. Cleaned air is recirculated into the space.

For some applications, a *direct-mount* skirt is available, allowing mounting of hood directly to the appliance, otherwise the universal ceiling suspended mounting accommodates most any listed appliance.

To help protect your investment, we recommend that you take the time to review this Manual and become familiar with the procedures in it pertaining to installation, operation, cleaning and maintenance. Adherence to recommended procedures will minimize potential for costly “downtime” and future repair expense. **Please retain this Manual for future reference.**

***NOTE: Due to continuing improvements and product enhancements, some illustrations shown in this Manual might not exactly depict your actual equipment.***

### 1.01 Construction

Primarily constructed of Series 430 Stainless Steel. Certain internal parts are of aluminized steel.

### 1.02 Standard Features

#### **Control Panel**

- Indicator lights show the status of various hood systems: Electronic Air Cleaner (EAC), power to appliance, and missing/clogged filter warnings.

#### **3-Stage Filter System**

- Baffle Filter: Captures and removes large grease particulate from the air stream.
- Electronic Air Cleaner (E.A.C.): Captures & collects fine grease and smole particulate from the air stream. A HEPA filter version of the hood is available as an alternative.
- Charcoal Filter: Helps to control cooking aromas in the recirculated air.

#### **Multiple Mounting Options**

- For universal application, the hood is suspended from the ceiling to accommodate practically any listed and approved appliance.
- Numerous ***direct-mount skirts*** have been engineered, allowing hood to be directly mounted onto a wide variety of oven makes and models.

#### **PUSH-TO-START Power Switch**

- Hood must be restarted by pressing switch after any power interruption. Meets code requirements for certain jurisdictions.

## 1.03 Optional Features

- **Fire Suppression Plumbing:** Hood can be factory pre-plumbed for connection to an approved fire suppression system. Includes piping, discharge nozzles, detector link brackets, and cable conduit. *Purchase, installation and field set-up of the system is the customer's responsibility ... not included with hood purchase. Must be provided and installed by an authorized Ansul® Dealer/Distributor.*
- **Power Cord/Appliance Receptacle:** OVH-10 model can optionally be equipped with a hood power cord & plug and an interlocked appliance power receptacle, providing appliance supply power through the hood.

## 1.04 Specifications

### 1.04.1 Overall Dimensions: PO-VH [UCM Model]

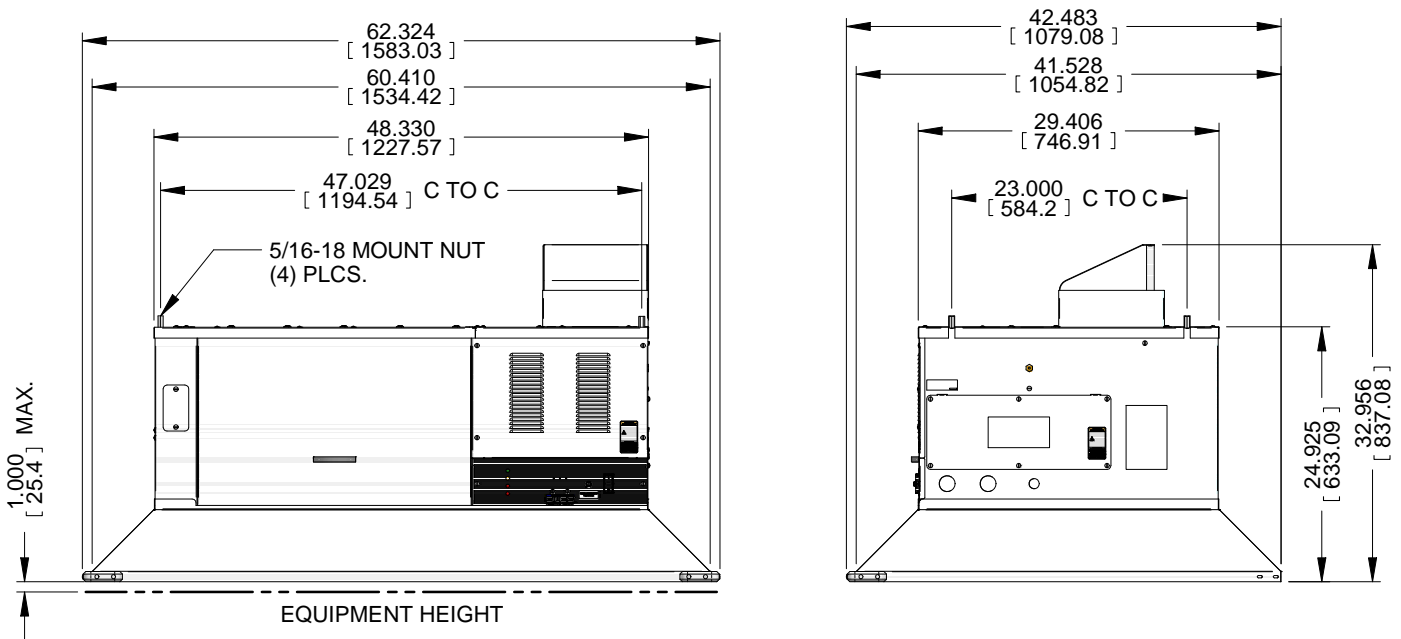

## 1.04.2 Overall Dimensions: OVH-10 [UCM Model]

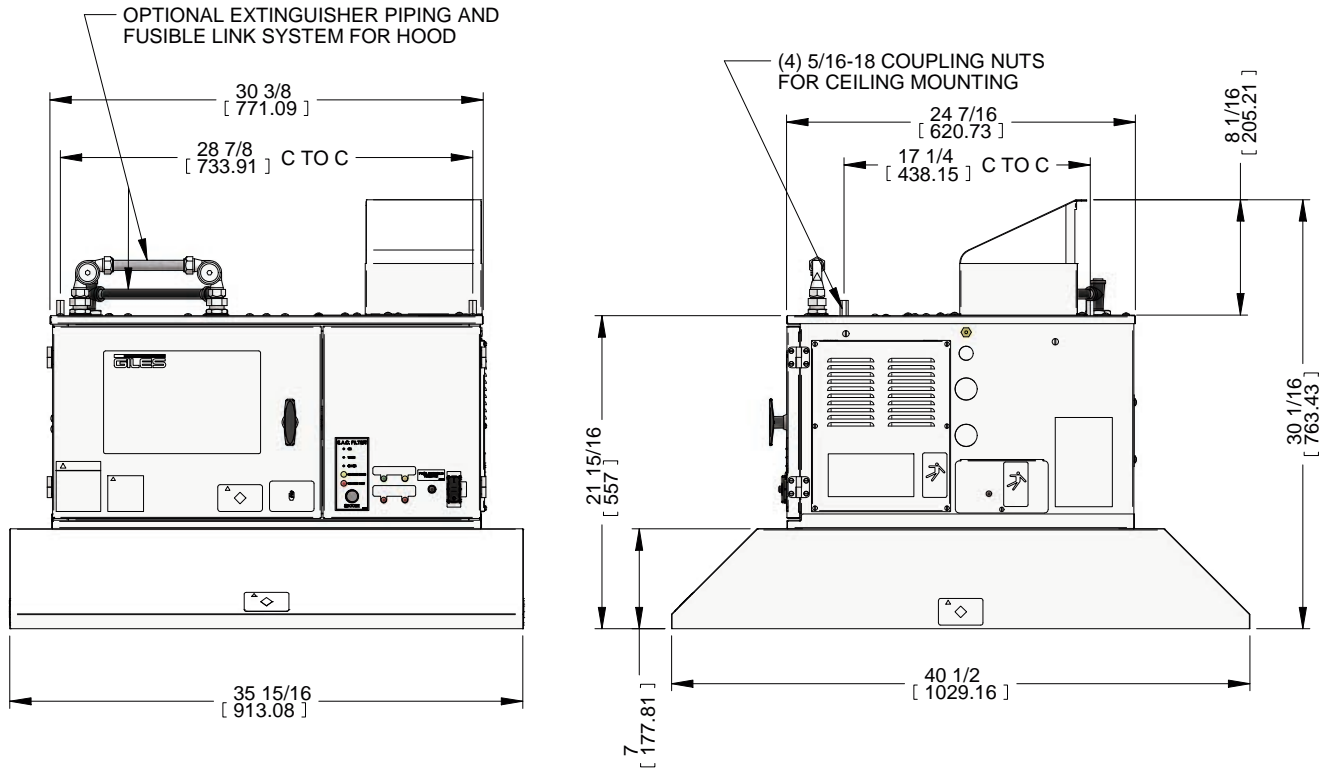

## 1.04.3 Agency Certifications



- HEPA version ONLY

Hoods are listed to UL-KNLZ (-7 for Canada); complying w/ANSI/UL197 & ANSI/NFPA96 - EPA202 as per ANSI/UL710B requirements

## 1.04.4 Hood Weight

Hood	Crated Weight	Uncrated Weight
PO-VH	455 lbs [206 kg]	370 lbs [168 kg]
OVH-10	245 lbs [111 kg]	170 lbs [77 kg]

\* Weights shown are typical; actual weight may vary depending upon the Skirt design and selected options.

## 1.04.5 Appliance Limitations & Clearances: PO-VH Hood

Equipment Type	Max. Input Power (kW)	Clearances		
		Skirt Bottom to Top of Door or Conveyor	Skirt Bottom to Top of Oven	Skirt Overhang @ Heated Oven Opening
Oven	50	6" [153mm] max.	1" [25.4mm] min.	6" [153mm] min.
Conveyor Oven	50	30" [762mm] max.	1" [25.4mm] min.	6" [153mm] min.
Rotisserie	6.2	6" [153mm] max.	1" [25.4mm] min.	6" [153mm] min.

*Ovens may be double stacked in certain situations.*

## 1.04.6 Appliance Limitations & Clearances: OVH-10 Hood

Equipment Type	Max. Input Power (kW)	Clearances		
		Skirt Bottom to Top of Door or Conveyor	Skirt Bottom to Top of Oven	Skirt Overhang @ Heated Oven Opening
Oven	11.5	6" [153mm] max.	1" [25.4mm] min.	6" [153mm] min.
Conveyor Oven	11.5	30" [762mm] max.	1" [25.4mm] min.	6" [153mm] min.
Rotisserie	6.2	6" [153mm] max.	1" [25.4mm] min.	6" [153mm] min.



**PO-VH & OVH-10 Recirculating Ventless Hoods CANNOT be used for gas heated appliances.**

## 2. Installation

This section summarizes procedures necessary for proper equipment installation. To help avoid personal injury or equipment damage, be sure to adhere to all of these recommended procedures.

Installation is the Purchaser's responsibility. It is advisable to engage the services of a professional commercial kitchen equipment specialist, licensed electrician, and qualified HVAC contractor to assist with the details of installation. Call *Giles Technical Support* @ 800.554.4537, if assistance is required.

### 2.01 Location

#### IMPORTANT!!

Before installing the GILES Recirculating/Ventless Hood system ensure that, A). all necessary approvals from local code authorities have been obtained, B). the cooking appliance to be used with the hood is within the hood's listing limitations, as stated in Section 1.04.5 or 1.04.6, and C). the installation site complies with the specific requirements and limitations outlined in the *GFSE Recirculating/Ventless Hood Approval Letter (HAL)*. The HAL is available for review or download at [www.gfse.com](http://www.gfse.com) under the *SUPPORT* tab in *VENTLESS DOCUMENTS*.

To ensure satisfactory hood performance after installation, the intended site MUST comply with minimum requirements for kitchen size (>300 sq ft), ceiling height, fresh outdoor air make-up, supplemental exhaust ventilation, clearances, etc. as stipulated in Giles' Hood Approval Letter.

- MAXIMUM of 1 hood per 300 sq ft of commercial kitchen space.
- Fresh outside air make-up must be equal to a MINIMUM of fifteen (15) complete room air exchanges per hour.
- Giles makes no representations as to the proper design or layout of an establishment in which the ventless hood will be used. Further, Giles does not perform site inspections prior to installation of any of its units.
- When operating, the hood produces a sound level of approximately 65 dB.

#### CAUTION

- **DO NOT ALTER, ADD ATTACHMENTS OR OTHERWISE MODIFY THIS EQUIPMENT.**
- **Failure to comply with installation requirements as specified by the Giles Hood Approval Letter will void the factory warranty.**

1. For ceiling mount installations, be certain that overhead structure is sufficient to support the hood's weight.
2. Any obstruction of the hood's exhaust air outlet must be avoided. An air diverter directs the exhausted air to the rear and sides. Zero [0"] clearance from top of diverter to ceiling or overhead obstruction is allowed, however **DO NOT block or obstruct the area around diverter opening**. A blockage can significantly impact hood capture, which may result in unsatisfactory performance.

**Giles recommends to allow some clearance for future moving, service or maintenance.**

## 2.02 Unpacking

Unit is shipped on a wooden pallet, secured by high-tensile plastic strapping and wrapped in machine-applied stretch wrap. In most cases a wooden framework is built around the unit for added protection. Unpack unit as follows:

1. Position received pallet in an area that provides adequate space for unpacking.
2. Remove the plastic stretch wrap, strapping and other packaging materials as necessary.
3. Carefully remove any wooden supports and/or framework that might be attached.
4. Locate and secure the envelope containing Warranty Card, Operation Manual, Mounting Instructions and any other hardware provided for installation. In some cases, additional mounting components may be wrapped separately and packed with the hood ... secure any such items and retain for later use.

### CAUTION

- Exercise care when lifting and handling the unit. See **Section 1.04.4, Hood Weights**.
- Take care when removing and disposing of packaging materials.
- Failure to comply with these **CAUTION** notices may result in moderate to minor injury, equipment or property damage, and could void the warranty.

### IMPORTANT!

If there is evidence of damage to the unit, or any of the accompanying items, immediately and thoroughly inspect the unit and all components. Notify the freight company of all damages. Generally, it is the responsibility of the customer to file and negotiate freight damage claims with freight carriers.

## 2.03 Mounting the Hood

### Direct-Mount Hood:

A direct-mount model hood is designed to mount directly to the cooking appliance (most typically electric ovens and conveyor ovens).

1. If installing a model of this type, refer to the mounting instruction sheet that accompanied the hood.
2. Follow the described steps necessary to prepare the appliance to accept the hood. In some cases additional mounting hardware and/or components will have been included with the hood for this purpose.
3. Using sufficient manpower, or appropriate lifting equipment, lift and mount hood unit onto the appliance.

**EXERCISE DUE CAUTION TO AVOID PERSONAL INJURY OR PROPERTY DAMAGE.**

4. Secure hood unit to appliance with provided fasteners, or with those previously removed from the appliance.

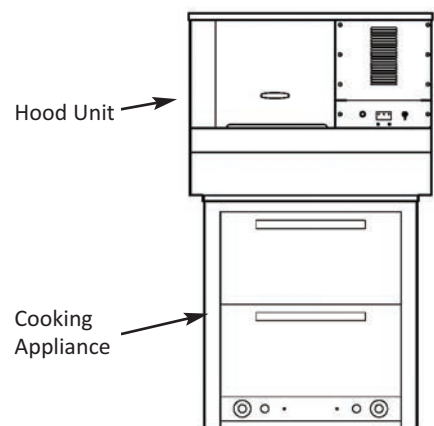

Continued on Next Page

## 2.03 Mounting the Hood - continued

### Ceiling Suspended Hood (UCM model):

All materials and hardware are provided by the purchaser. Follow the steps below to suspend the hood from ceiling:

1. Inspect the ceiling structure to determine whether it is substantial enough to safely support the weight of the hood. See **Section 1.04.4, Hood Weight**.
2. Four (4) 5/16-18 mounting couplings are affixed to the hood top (one at each corner).
3. The hood is to be suspended from the ceiling by 5/16 all-thread rods, cut to appropriate length such that the installation complies with clearance above the cooking appliance specified in **Sections 1.04.5 & 1.04.6**.
4. Place a jam nut onto the threaded rod and screw rod fully into coupling, then tighten jam nut against coupling.
5. Attach appropriate hanger or clamp hardware to ceiling rafters, joists or other suitable structures.

**⚠ EXERCISE DUE CAUTION TO AVOID PERSONAL INJURY OR PROPERTY DAMAGE.**

6. Using sufficient manpower, or appropriate lifting equipment, lift the hood unit and attach support rods to the ceiling hanger hardware. Adjust as needed to level the unit at the proper height. Secure all fasteners.

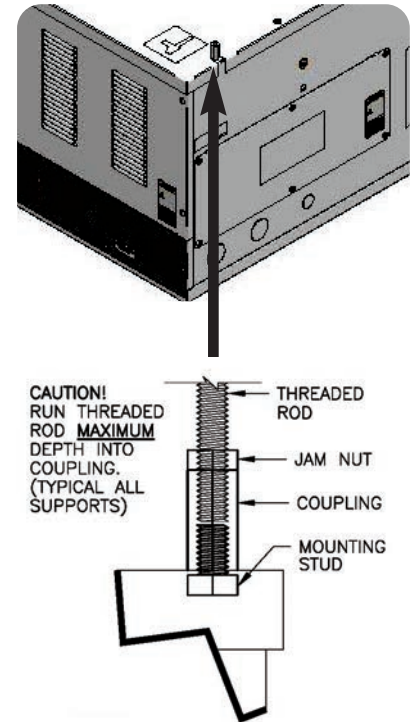

## 2.04 Electrical Specification

### ⚠ WARNING

- Food service equipment must be properly grounded in accordance with local code, or in the absence of local code, with the *National Electrical Code, ANSI/NFPA 70*. Improper grounding may result in electrical shock to users. Check local electrical code to ensure proper grounding.
- Always consult a certified electrician, or other qualified service technician, prior to installation to ensure that electrical circuits are of sufficient rating to power the hood and appliance load.
- Improper installation, adjustment, alteration, service or maintenance could result in serious injury or possible death, equipment or property damage, and could void the warranty.

## 2.04 Electrical Specification - continued

Electrical Specifications (Hood Only)						
Unit	Voltage	Hz	Phase	Watts	Amps	Breaker
OVH-10	208	60	1	433	2.1	10
	240	60	1	433	1.8	10
PO-VH	208	60	1	920	4.4	10
	240	60	1	920	3.8	10
	220	50	1	920	4	10

### IMPORTANT!

- *PO-VH* & *OVH-10* hoods are designed to operate with either 208V or 240V supply power; the table above shows different amp draw at each voltage.
- Breaker sizes shown apply to hood power only. Power to the served appliance is typically interlocked through the hood so that the both are powered through the same breaker. In such cases, breaker size shall be determined by the combined electrical load of hood and appliance.

## 2.05 Electrical Connections

1. Confirm that the appropriate circuit breakers are installed in the main electrical panel supplying power. Refer to table in **Section 2.03**.
2. Connect appropriately size wire at the main breaker. As applicable, allow enough wire length so the unit may be moved for cleaning and servicing.
3. Remove the hood Service Panel, see to **Figure 2.04.1**. Route the power wires to the unit in accordance with local codes.
4. If hood is to be installed above a 208/240V appliance connect appropriate incoming power wires to the proper terminal blocks. Use appropriate strain relief connectors or conduit fittings (**not provided**) for routing wiring through knock-out holes. See **Section 2.04.2** and review label affixed to the Service Panel.  
  
If the unit is to be installed above a 480V appliance, see **Section, 2.04.3** and review label affixed to the Service Panel.
6. Reinstall Service Panel.
8. Turn **ON** breaker supplying power to Hood.

## 2.05 Electrical Connections - continued

### 2.05.1 Routing Power Supply Wiring

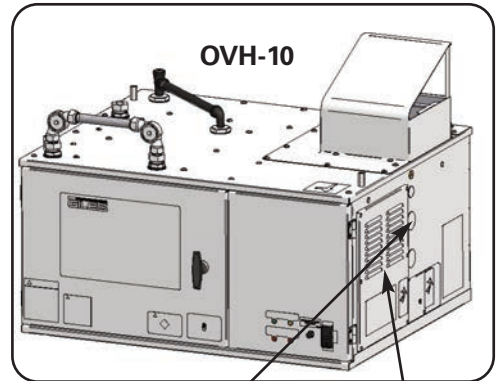
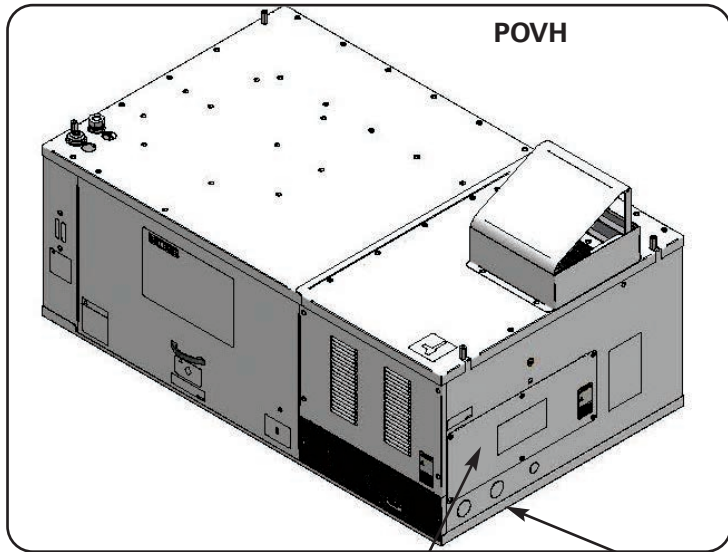

**Hole Plugs** - Openings for routing appropriate power cables. Use proper fittings and strain reliefs, as needed (**not provided**).

**NOTE:** Skirt not shown

### 2.05.2 Electrical Connections for Installation Over a 208/240V Appliance

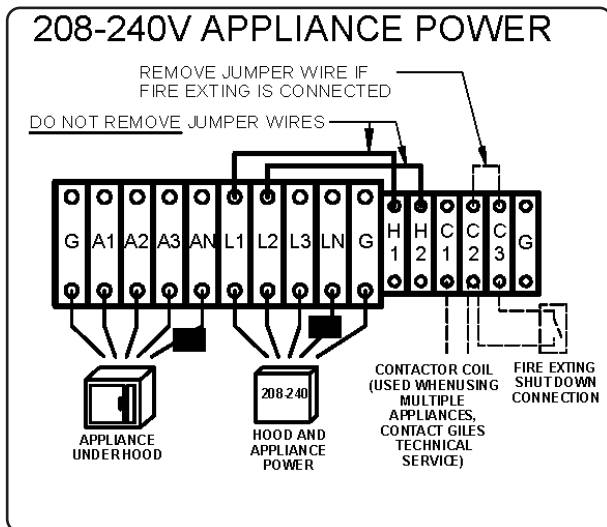

- Connect incoming main power wires from breaker panel to terminal blocks **L1, L2, L3, G**.
- Connect appliance power wires to terminal blocks **A1, A2, A3, G** (outgoing power).
- Should there be any question as to proper connection procedures call **Giles Technical Service - 800.554.4537**.
- If hood is equipped with the fire suppression system option, connect as directed.
- All materials and labor needed for electrical installation are to be provided by the customer.

## 2.05.3 Electrical Connections for Installation Over a 480V Appliance

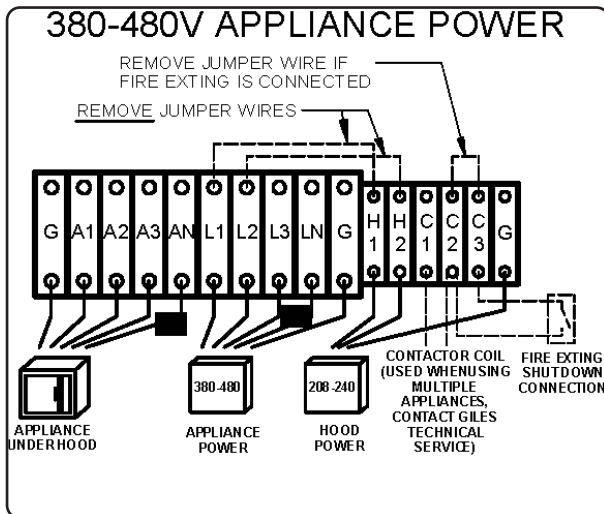

- Connect incoming main power wires (480V) from breaker panel to terminal blocks **L1, L2, L3, G**.
- Connect wires from appliance power cord to terminal blocks **A1, A2, A3, G** (outgoing power).
- Connect incoming low voltage (208-240V) power wires to terminal blocks **H1, H2, G**
- **Remove jumper wires from between L1-L2 and H1-H2.**
- Should there be any question as to proper connection procedures call **Giles Technical Service - 800.554.4537**.
- If hood is equipped with the fire suppression system option, connect as directed.
- All materials and labor needed for electrical installation are to be provided by the customer.

**NOTE:** The neutral line terminal blocks (LN & AN) are not required for domestic installations. Adhere to all local codes when installing this equipment. A certified electrician may be required to complete installation.

## 2.06 Skirt Corner Guards [certain PO-VH Models Only]

Certain **PO-VH** models are supplied with a Corner Bumper Guard Kit (2 pieces). Installing these guards can help prevent personal injury to persons who may inadvertently come in contact with the overhanging front corners of the skirt. Attach the rubber bumpers to the exposed front corners as described below.

1. Align hole in bumper with the holes in skirt.
2. Insert (2) 8-32 x 3/4 screws and secure with 8-32 nut on inside of flange.
3. Insert (2) plastic hole plugs into bumper to conceal screws.

**NOTE:** Not all **PO-VH** models are supplied with this kit as standard. It can be purchased separately through your equipment dealer ... **Item no. 70380**.

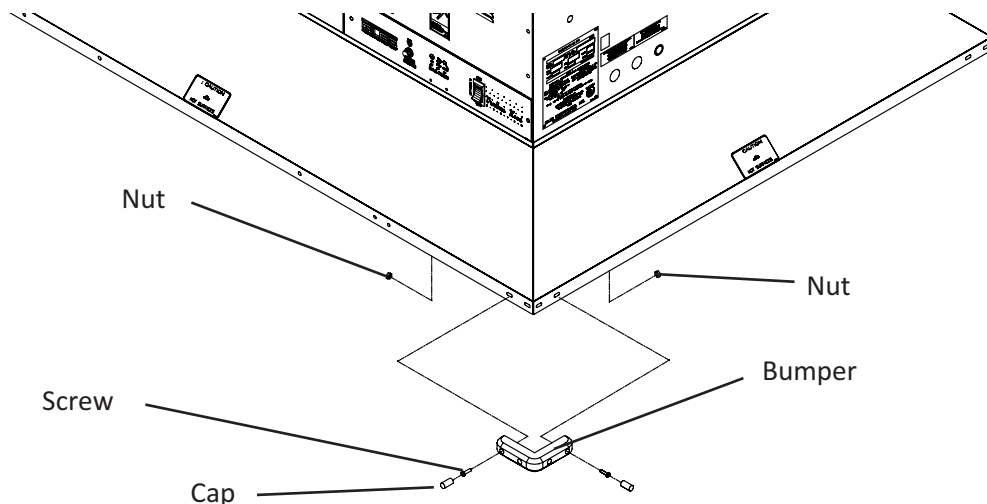

## 2.07 Fire Suppression Factory-Installed Plumbing (Optional)

Some jurisdictions require that this type hood be equipped with a fire suppression system, regardless of the application. Giles **PO-VH** and **OVH-10** model hoods can be ordered with optional factory-installed fire suppression system plumbing which includes piping, discharge nozzles, exhaust fire damper, detector link brackets, and conduit. Piping and conduit are stubbed out, ready for connection of an approved fire extinguishing system.

**Purchase of the system, field installation, set-up, testing and certification must be performed by an authorized Ansul® Distributor/Dealer ... provided by the customer, not included with purchase.**

### 2.07.1 General Installation w/Fire System Option

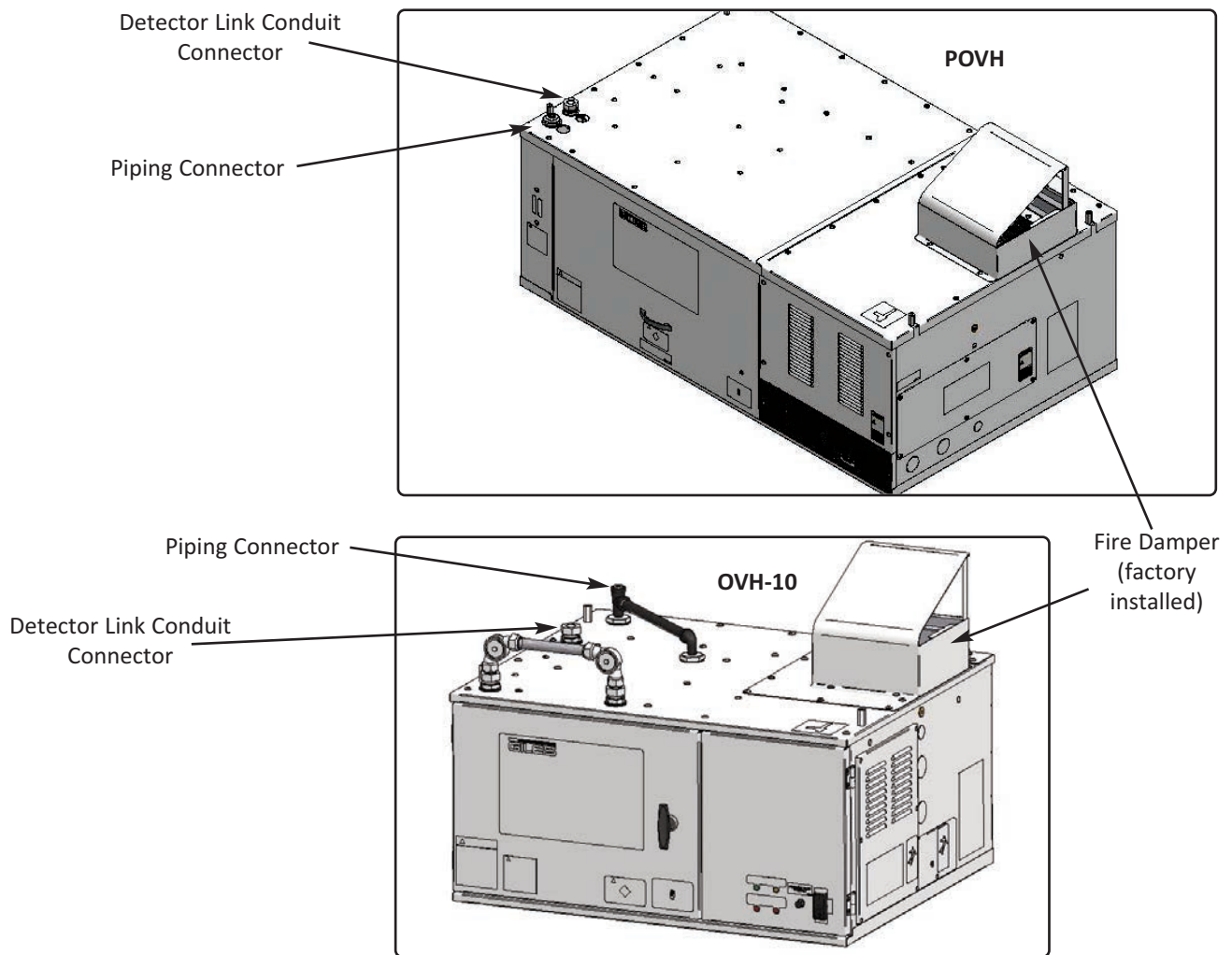

## 2.07.2 Fire Suppression - Final System Installation

To comply with the hood’s listing, the connected fire extinguishing system must be the ***Ansul R102 Restaurant Fire Suppression System***. Purchase, field installation, set-up and testing of the system is the responsibility of the customer and is not included with hood purchase. The system and all installation must be provided by an authorized Ansul® Distributor/Dealer.

1. An Ansul® Service Agent shall install a regulated extinguisher release mechanism and tank, and install necessary connecting piping and fusible link conduit to the hood connectors.
2. Appropriately rated fusible links will be installed in detector brackets and connected with stainless steel wire cabling throughout the link conduit circuit. Link cable is connected to the Automan release mechanism.
3. An emergency egress Manual Release Station must be installed in accordance with local code.
4. Provision for tie-in to the building’s fire alarm system is available on these hoods, refer to ***Sections 2.04.2 & 2.04.3***.
5. After installation and set-up, the system is to be tested and charged with wet chemical suppressant and compressed gas cartridge.
6. The extinguishing system is to be maintained as outlined in the ***Standard of Wet Chemical Extinguishing Systems, NFPA 17A***.

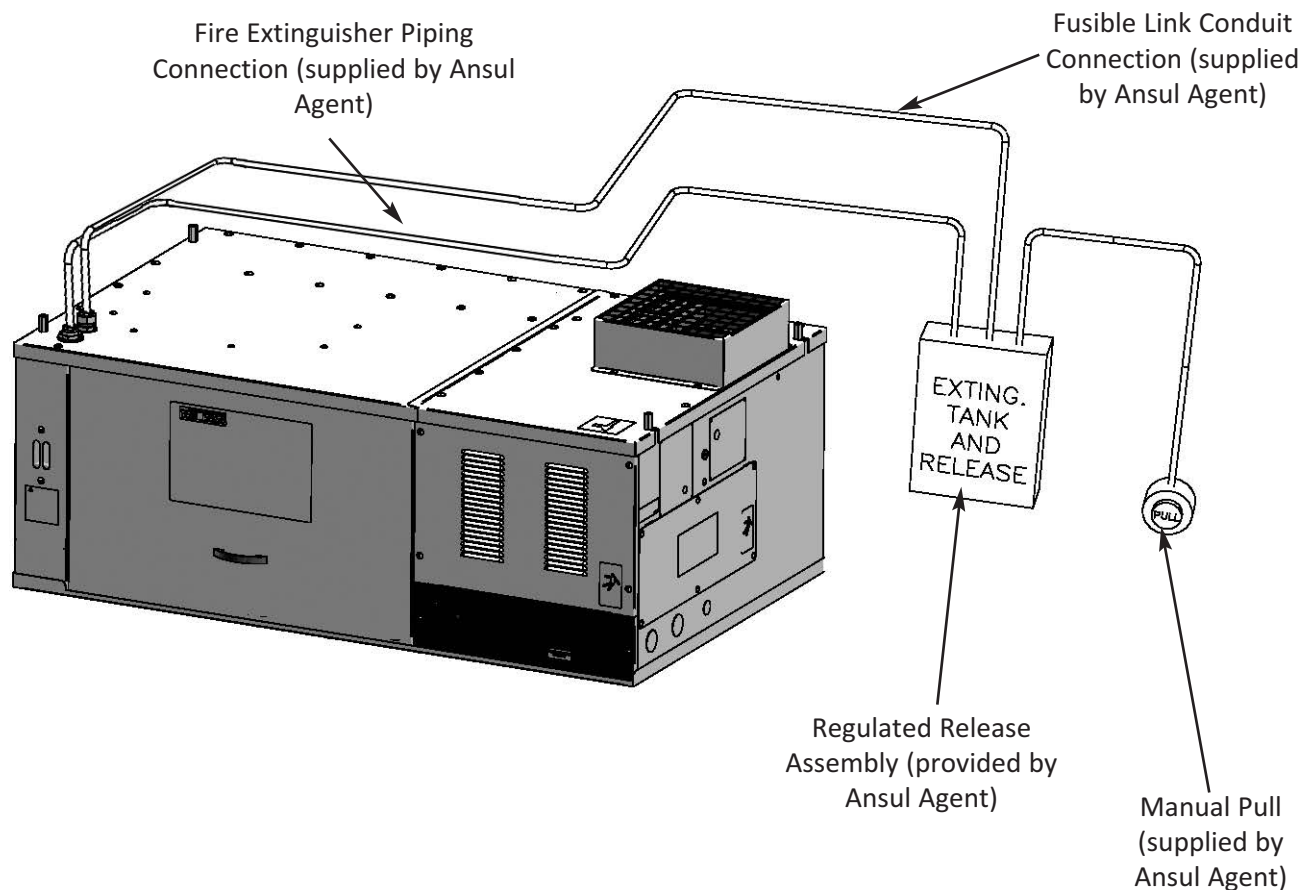

**3. Overview**

The following section provides a brief overview of the components, functions, and accessories of the *PO-VH* and *OVH-10 Ventless Hood*. It will be very helpful to thoroughly review this section before proceeding.

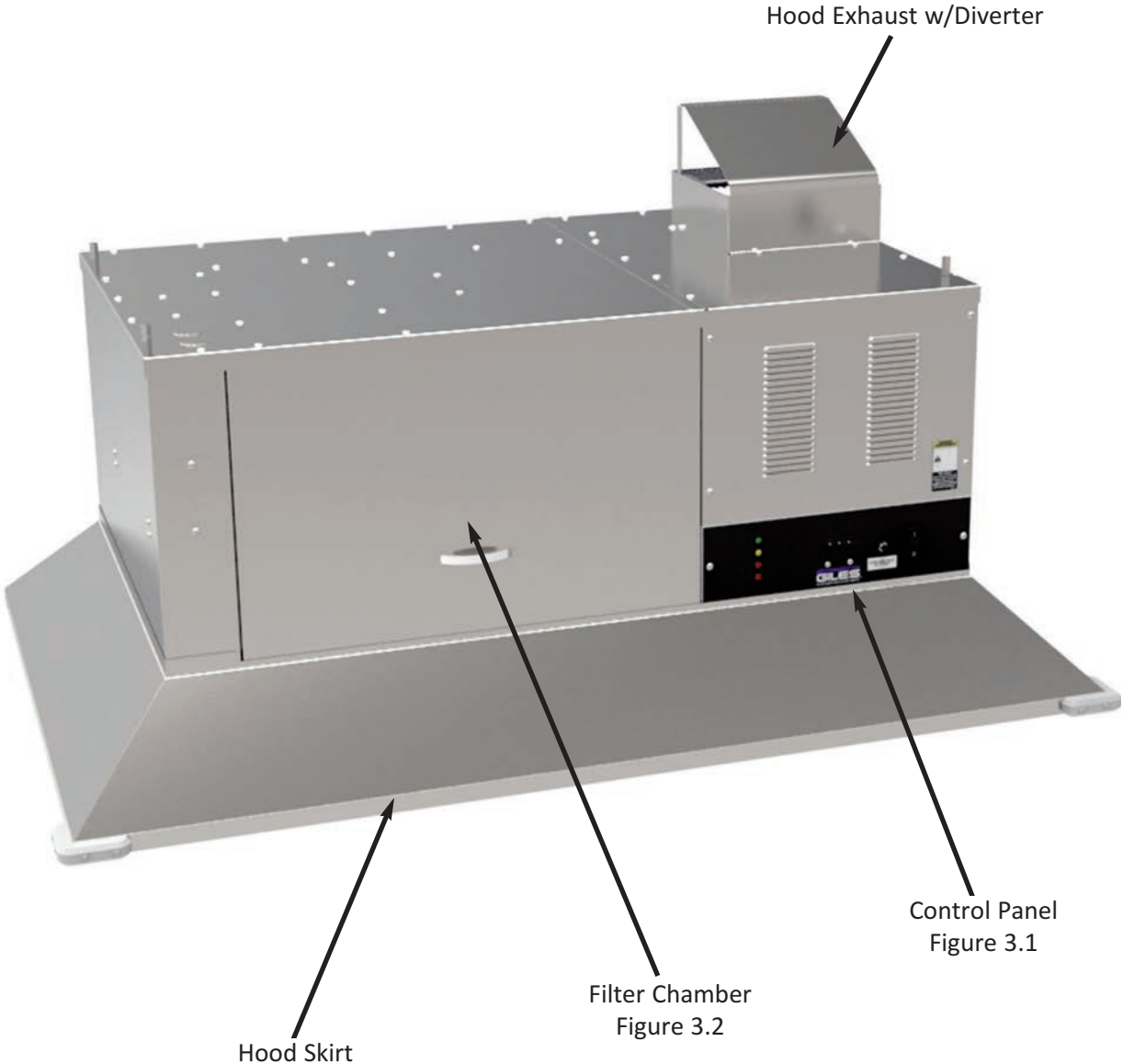

POVH Hood pictured

3.01 Hood Controls & Indicators

3.01.1 PO-VH Model



3.01.1 PO-VH Model		
Item	Description	Function
1	Power Switch <i>(Push-To-Start)</i>	The <b>Power Switch</b> is a 3-position Switch. Press and momentarily hold the top <b>[START]</b> portion of the switch to start hood and provide power to the appliance underneath. When released, switch remains in the <b>[ON]</b> (center) position. To turn hood <b>OFF</b> press the bottom of switch (power to appliance is also turned <b>OFF</b> ).
2	E.A.C. Filter Status Indicators	<p>LED light cluster indicates the status of the Electronic Air Cleaner (E.A.C.).</p> <p><b>[ON]</b> - Turns <b>ON</b> when hood is powered-up. Indicates that the E.A.C. system is powered and functioning normally to clean the air. This is the only light <b>ON</b> when E.A.C. is operating properly.</p> <p><b>[WASH]</b> - Indicates excessive grease film build-up on collector fins (dirty), collector cell is missing, poor contact, missing ionizer wires, etc. Approximately 2 minutes after this light turn <b>ON</b>, a intermittent (beeping) alarm tone will begin sounding and power to appliances is shutdown.</p> <p><b>IMPORTANT! Do not rely on this indicator as a signal for routine cleaning; cell must be cleaned daily to maintain peak performance and extend the useful life of charcoal filters.</b></p> <p><b>[CHECK]</b> - Indicates that collector cell has stopped operating properly; either damaged &amp; shorted to ground, fins shorted due to excessive moisture, etc. No alarm sounds &amp; the appliances remain powered, but air cleaning system is not functioning.</p>
3	<b>HOOD POWERED</b> Light	Green <b>[POWER]</b> light turns <b>ON</b> when <b>Power Switch</b> is placed in the <b>[ON]</b> position.
4	<b>APPLIANCE POWERED</b> Light	Amber <b>[APPLIANCE POWERED]</b> light turns <b>ON</b> when the hood is operating normally, and the interlocked appliance is powered and ready for use.
5	<b>CHARCOAL OR BAFFLE FILTER MISSING</b> Light	Red <b>[CHARCOAL OR BAFFLE FILTER MISSING]</b> light turns <b>ON</b> when either the baffle filter or the charcoal filter is missing or improperly installed
6	<b>CHARCOAL OR BAFFLE FILTER CLOGGED</b> Light	Red <b>[CHARCOAL OR BAFFLE FILTER CLOGGED}</b> light turns <b>ON</b> when there is insufficient air flow through hood to provide adequate capture of cooking vapors. Either the baffle filter or charcoal filter has becomes clogged, there is an obstruction in the hood, the blower is dirty or running slowly, or the exhaust outlet may be blocked.

3.01.2 OVH-10 Model

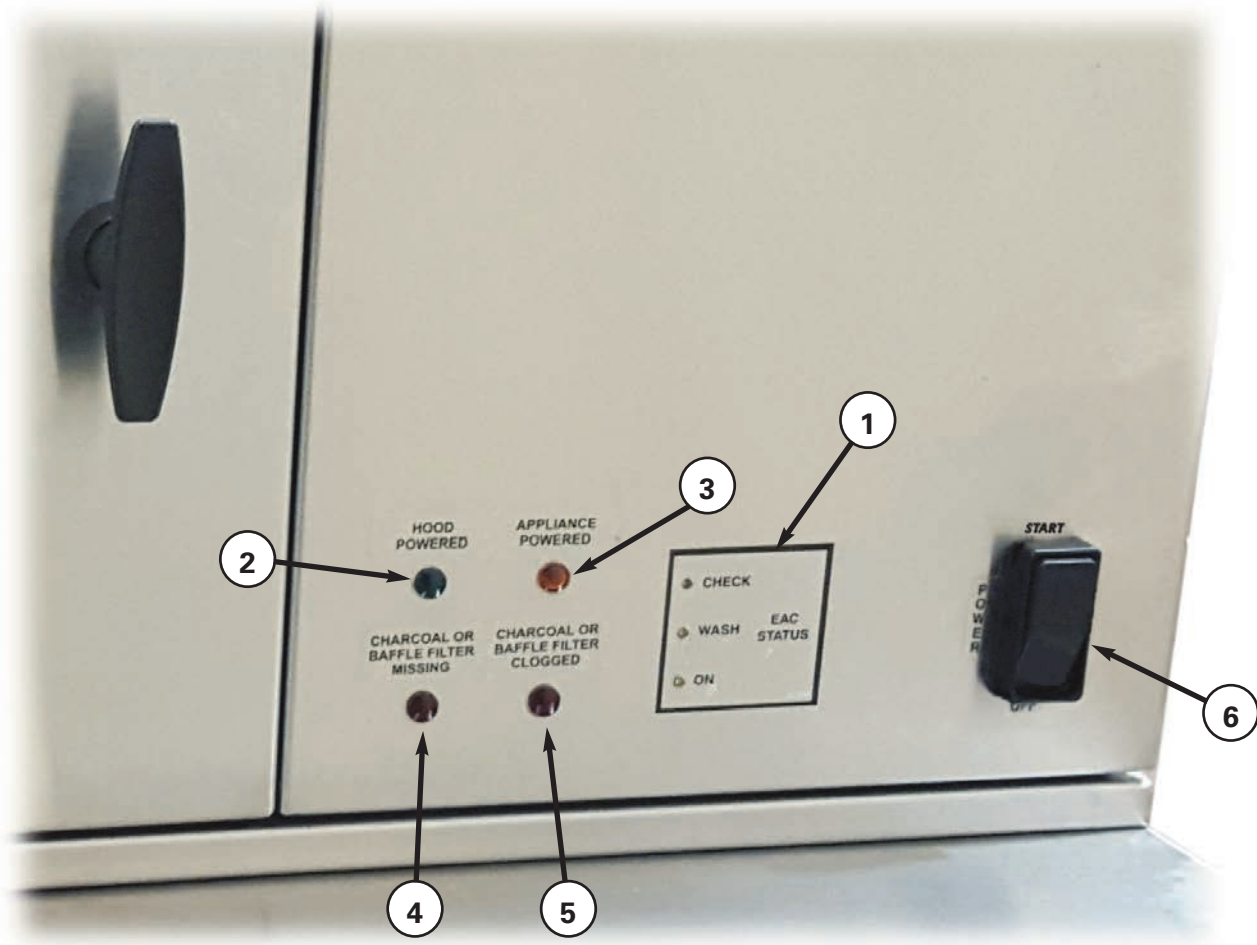

3.01.2 OVH-10 Model		
Item	Description	Function
1	E.A.C. Filter Status Indicators	<p>LED light cluster indicates the status of the Electronic Air Cleaner (E.A.C.).</p> <p><b>[ON]</b> - Turns <b>ON</b> when hood is powered-up. Indicates that the E.A.C. system is powered and functioning normally to clean the air. This is the only light <b>ON</b> when E.A.C. is operating properly.</p> <p><b>[WASH]</b> - Indicates excessive grease film build-up on collector fins (dirty), collector cell is missing, poor contact, missing ionizer wires, etc. Approximately 2 minutes after this light turn <b>ON</b>, a intermittent (beeping) alarm tone will begin sounding and power to appliances is shutdown.</p> <p><b>IMPORTANT! Do not rely on this indicator as a signal for routine cleaning; cell must be cleaned daily to maintain peak performance and extend the useful life of charcoal filters.</b></p> <p><b>[CHECK]</b> - Indicates that collector cell has stopped operating properly; either damaged &amp; shorted to ground, fins shorted due to excessive moisture, etc. No alarm sounds &amp; the appliances remain powered, but air cleaning system is not functioning.</p>
2	<b>HOOD POWERED</b>	Green <b>[POWER]</b> light turns <b>ON</b> when <b>Power Switch</b> is placed in the <b>[ON]</b> position.
3	<b>APPLIANCE POWERED</b> Light	Amber <b>[APPLIANCE POWERED]</b> light turns <b>ON</b> when the hood is operating normally, and the interlocked appliance is powered and ready for use.
4	<b>CHARCOAL OR BAFFLE FILTER MISSING</b> Light	Red <b>[CHARCOAL OR BAFFLE FILTER MISSING]</b> light turns <b>ON</b> when either the baffle filter or the charcoal filter is missing or improperly installed
5	<b>CHARCOAL OR BAFFLE FILTER CLOGGED</b> Light	Red <b>[CHARCOAL OR BAFFLE FILTER CLOGGED]</b> light turns <b>ON</b> when there is insufficient air flow through the hood to provide adequate capture of cooking vapor. Either, 1). baffle filter or charcoal filter is clogged, 2). there is an obstruction inside the hood, 3). the blower is dirty or running too slow, or 4). the exhaust outlet is blocked.
6	Power Switch	The <b>Power Switch</b> has (3) positions. Press and momentarily hold the top <b>[START]</b> portion of the switch to start the hood blower and supply power to the interlocked appliance. When released, switch remains in the <b>[ON]</b> (centered) position. Pressing bottom <b>[OFF]</b> portion of switch shuts down hood and power to appliance.

3.02 Filter Chamber & Exhaust

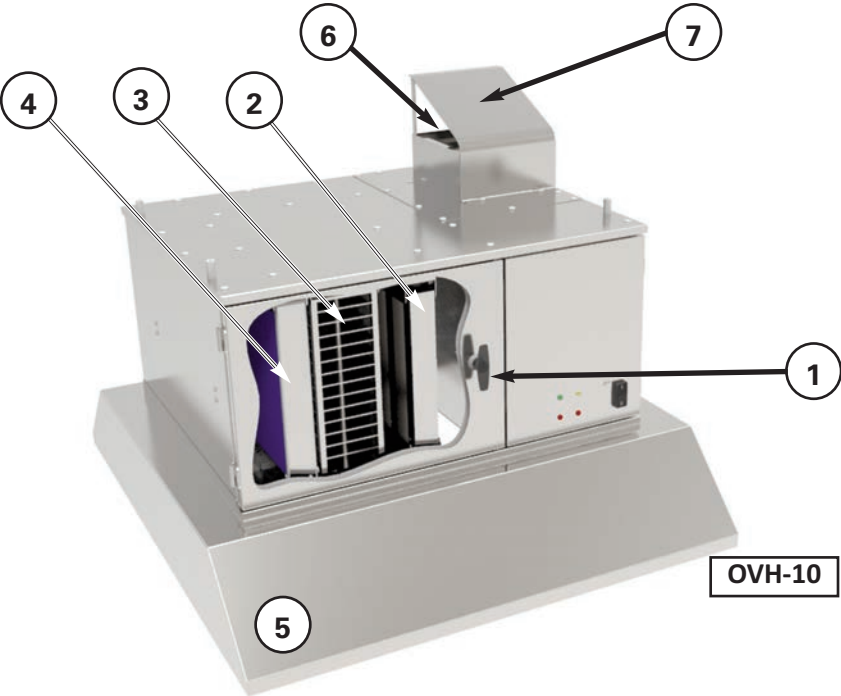
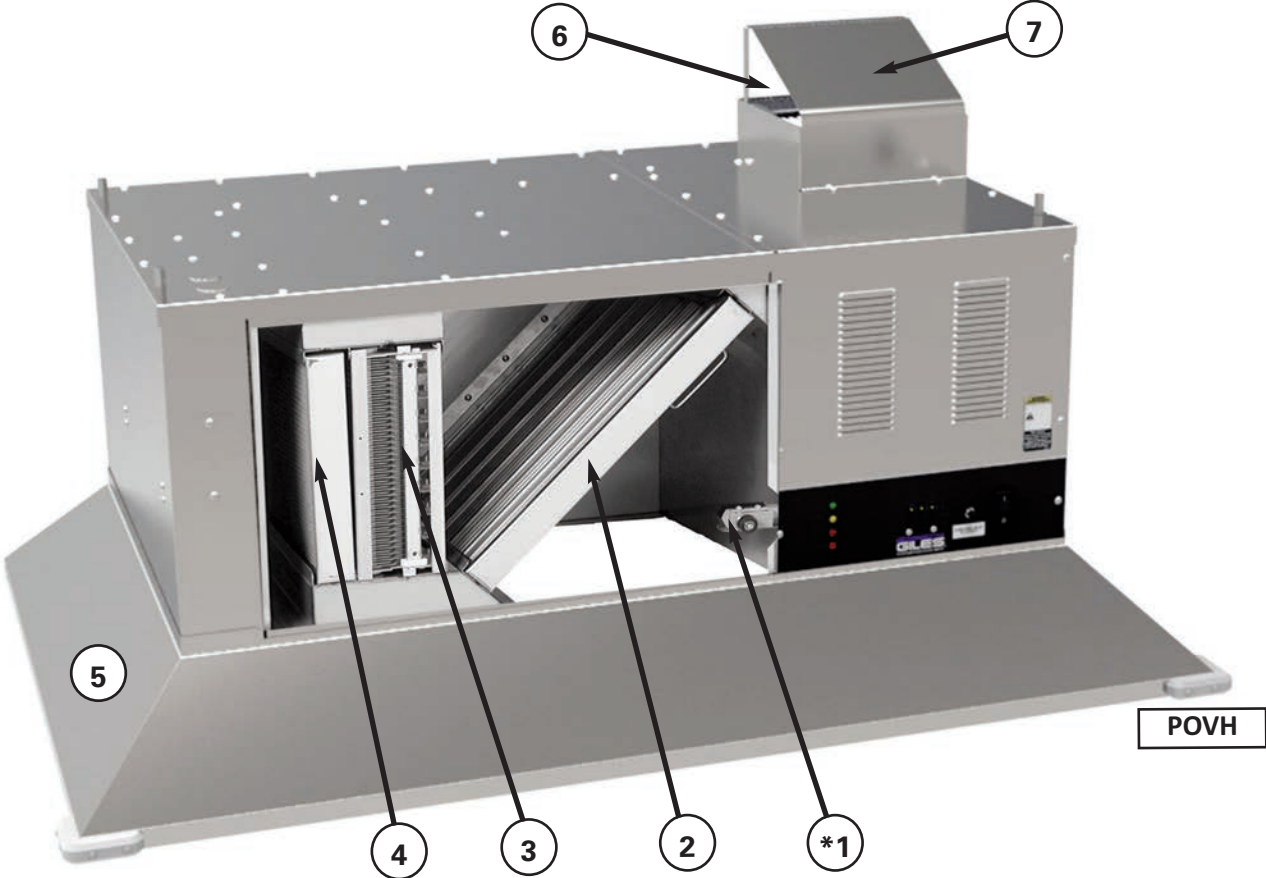



\* Not Shown for POVH

3.02 Filter Chamber & Exhaust		
Item	Description	Function
*1	POVH = Access Cover OVH-10 = Hinged Door	The POVH* Cover must be in place and secure, or the OVH-10 Door must be fully closed and latched before the Hood will operate. <b>NOTE: No power is supplied to the interlocked appliance underneath, unless the Hood is operating.</b>
2	Baffle Filter	The the first stage for air cleaning and grease-laden vapor removal. It is easily removed for daily cleaning. <b>NEVER by-pass interlock switches attempting to operate hood without filter as it will create a potential for electrical shock. The filter should be cleaned daily for best performance.</b>
3	EAC Filter Cell	The EAC filter system electrostatically removes grease vapor and smoke generated by the cooking appliance. <b>DO NOT operate hood without the EAC Filter Cell in place. Cell must be cleaned daily for optimum performance.</b>
4	Charcoal Filter	Helps control aromas generated during cooking. <u>This Filter should be replaced monthly (approx.).</u> <b>NEVER attempt to clean and reuse filter. NEVER by-pass interlock switches attempting to operate hood without filter in place. NOTE: No filter will completely remove cooking odors.</b>
5	Hood Skirt	Helps hood capture vapors and smoke produced by the cooking appliance. Skirt designs vary depending on the served appliance. Some skirts allow mounting hood directly to appliances. <i>The Universal Ceiling Mount, UCM skirt (pictured) will generally accommodate any of the listed appliances, when hood is suspended from ceiling.</i>
6	Exhaust Outlet	Located on top of the unit. <b>Keep area around exhaust free of obstructions.</b>
7	Air Diverter	Directs exhaust air to the sides and rear, allowing use with less ceiling clearance. Zero [0"] clearance is required from top of diverter to ceiling.

**IMPORTANT: Failure to use Giles OEM parts and OEM replacement filters may void the factory warranty.**

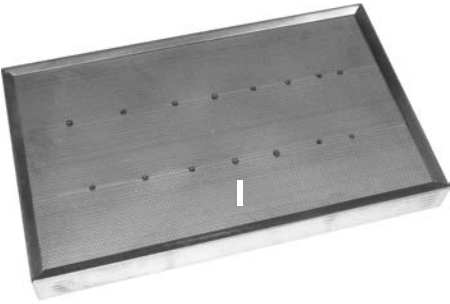

\* Not Shown for POVH

**3.03 Items Included w/Hood**

Part	Description/Part Number	Function
	<p>Baffle Filter                      P/N 42300 [PO-VH]                      P/N 45096 [OVH-10]</p>	<p>Captures and removes larger grease particulate from the air stream.</p>
	<p>EAC Filter Cell                      P/N 20520 [PO-VH]                      P/N 22360 [OVH-10]</p>	<p>Captures and removes finer grease particulate and smoke from the air stream.</p>
	<p>Charcoal Filter                      P/N 30248 [PO-VH]                      P/N 31963 [OVH-10]</p>	<p>Helps eliminate cooking aromas from the exhausted air stream.  <b>NOT A CLEANABLE FILTER</b>  <b>NOTE: NO FILTER COMPLETELY REMOVES ODORS</b></p>

**IMPORTANT: Failure to use Giles OEM parts and OEM replacement filters may void the factory warranty.**

## 3.03 Items Included w/Hood

Part	Description/Part Number	Function
	<p>(1) <b>Sample Can</b> Foaming Crystal Cleaner/Degreaser <b>P/N 41510</b> <b>12-count Case</b> <b>NSF approved</b></p>	<p>Spray on foaming degreaser for cleaning EAC collector cell. We provide a sample can of our recommended collector cell cleaning product. It is readily available through <i>Giles dealers</i>, as well as from on-line suppliers and many national retail outlets. Also excellent for general cleaning and degreasing of all food service equipment.</p>
	<p>Corner Bumper Kit (2) Bumpers (Certain POVH Models Only) <b>P/N 70380</b></p>	<p>Protect operators from exposed corners on Hood Skirt</p>



## 4. Operation & Filter Maintenance

This section explains hood operation, required filter maintenance and cleaning, and alarm conditions.

### 4.01 Hood Operation

Before attempting to operate the hood, be certain that all filters are in place and properly positioned.

#### To Start the Hood:

1. Press and momentarily hold the top [START] portion of the **Power Switch** ① until the hood fan starts running. When released, switch remains in the [ON] position.
2. The green [HOOD POWERED] light ② should be ON.
3. The **EAC Status** [ON] LED ③ will illuminate.
4. Alarm sounds briefly until fan reaches speed, then amber [APPLIANCE POWERED] light ④ will turn ON. This indicates that power is supplied to the cooking appliances under the hood and they are ready be used.
5. Should an audible alarm remain ON, any other indicator lights come on, and/or if the [APPLIANCE POWERED] light does not turn ON, refer to **Troubleshooting Section** of this manual.

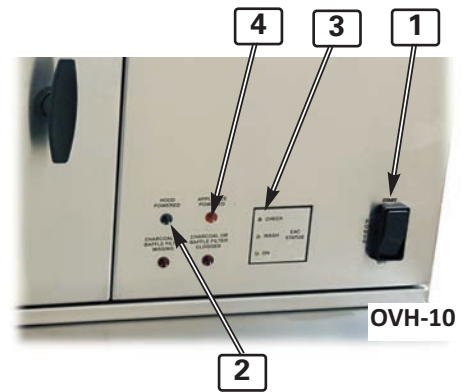
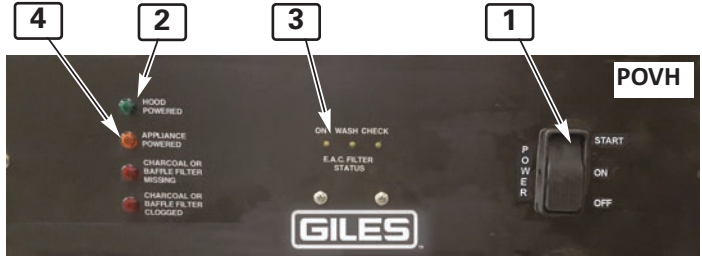

#### To Shutdown the Hood:

1. Press the bottom [OFF] portion of the **Power Switch** ①.
2. Blower stops and all indicator lights turn OFF.
3. Power to the fryer is shutdown.

### 4.02 Filter, Filter Maintenance & Filter Alarms

#### 4.02.1 Ventless Hood Filter Table

Filter	When to Clean/Replace	How to Remove	How to Clean	How to Install
Baffle Filter	Clean daily	Section 4.02.3.1	Section 4.02.5.1	Section 4.02.3.1
EAC Filter Cell	Clean daily	Section 4.02.3.2	Section 4.02.5.2	Section 4.02.3.2
Charcoal Filter	Replace every 30 to 40 days, P/N 30248 [PO-VH] P/N 31963 [OVH-10]	Section 4.02.3.3	<b>NEVER attempt to clean. ONLY Replace</b> Section 4.02.5.3	Section 4.02.3.3

## 4.02.2 Accessing the Filter Chamber



① Although removing Cover or opening Door causes hood to shutdown, **always place Power Switch in [OFF] position before opening the filter chamber.**

### Opening the Filter Chamber

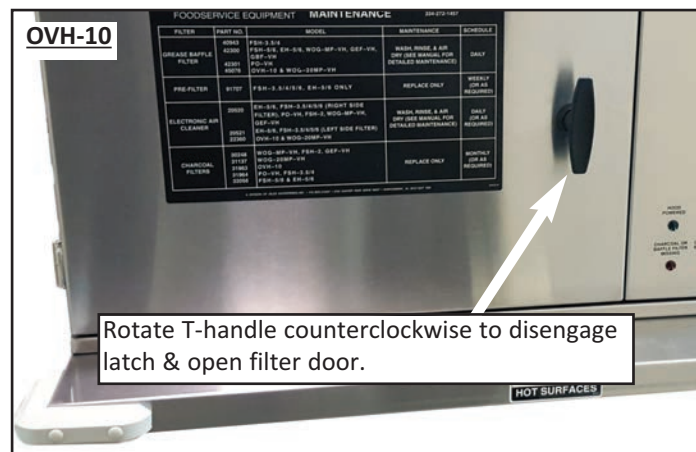
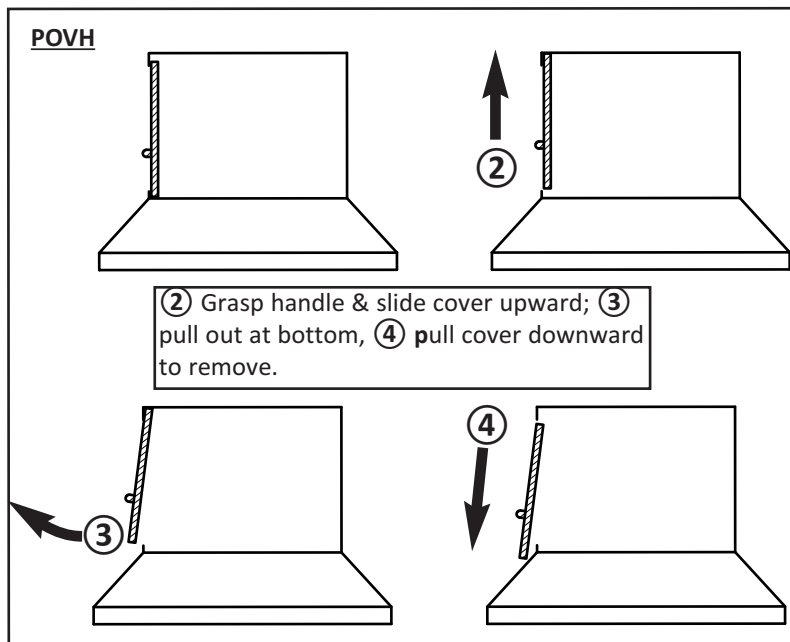

## 4.02.2 Accessing the Filter Chamber - continued

### Closing the Filter Chamber

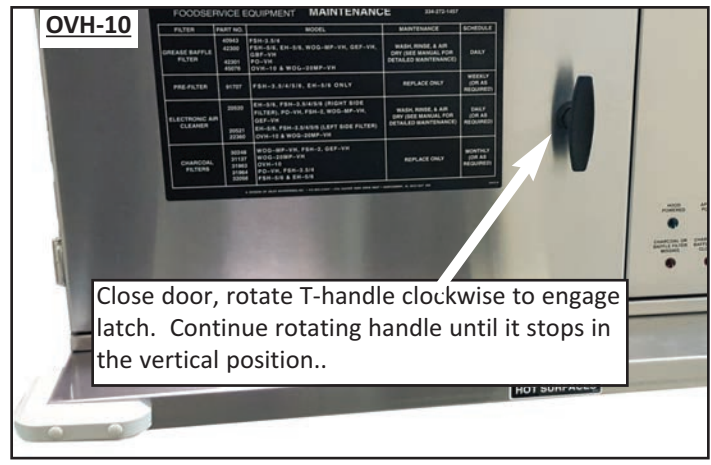
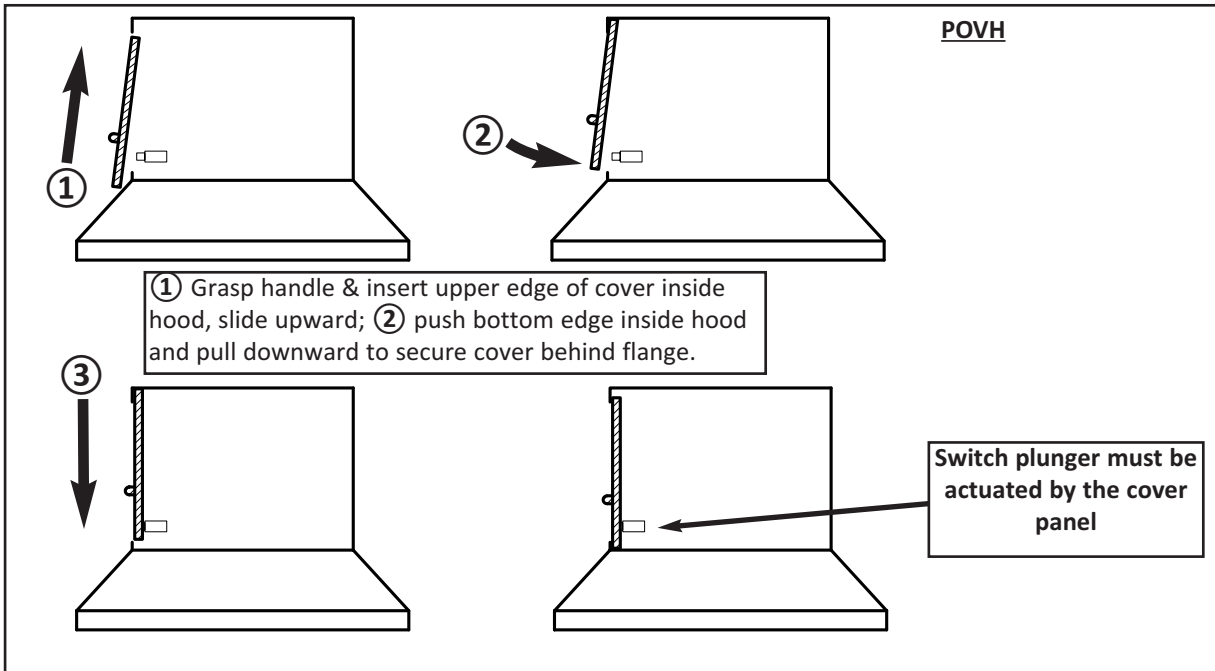

**IMPORTANT:** Hood will NOT operate unless interlock switch is engaged by the closed cover or door.

## 4.02.3 Filter Management

### 4.02.3.1 Baffle Filter Removal/Installation



① Place **Power Switch** in [OFF] position

#### A. Removing Filter:

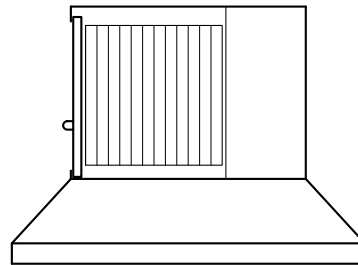

Remove cover [POVH] or open access door [OVH-10]

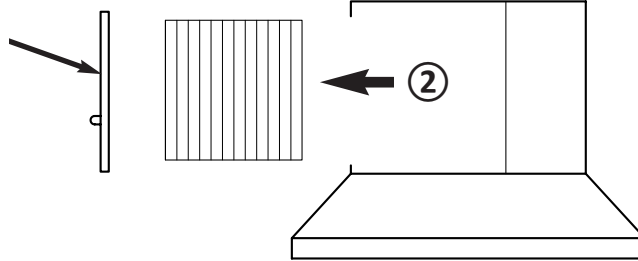

② Grasp filter & pull straight out of filter chamber.

#### B. Installing Filter:

Remove cover [POVH] or open access door [OVH-10]

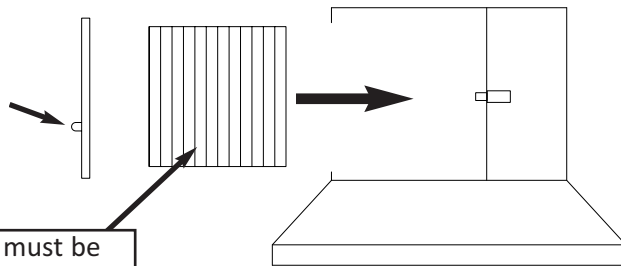

Align filter in guide channels & slide straight in to stop.

Filter baffle fins must be oriented in a vertical position.

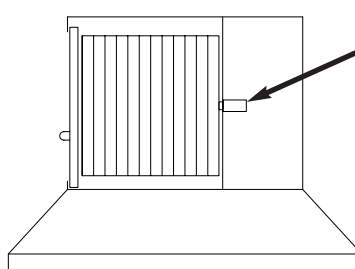

Switch plunger must be actuated by the filter when installed.

## 4.02.3.2 E.A.C. Filter Cell Removal/Installation



① Place **Power Switch** in [OFF] position

### A. Removing E.A.C. Filter Cell

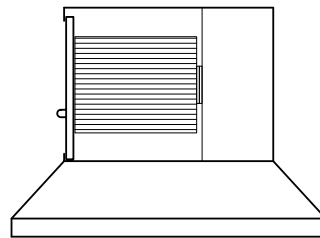

Remove cover [POVH] or open access door [OVH-10]

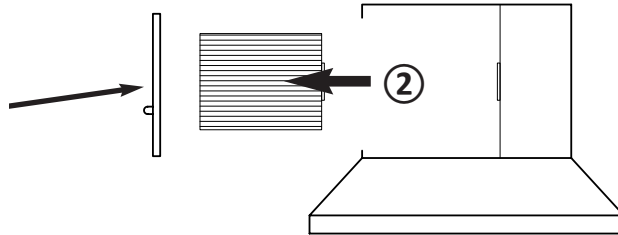

② Grasp cell by the frame & pull straight out of hood. **Take care not to damage fins or the fine ionizer wires.**

### B. Installing E.A.C. Filter Cell

Remove cover [POVH] or open access door [OVH-10]

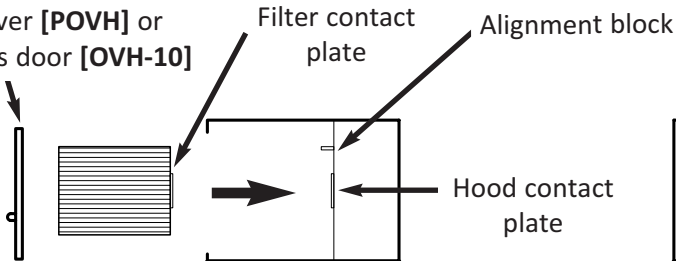

Align filter cell in guide channels with contact plate to the back and slide straight into hood to stop.

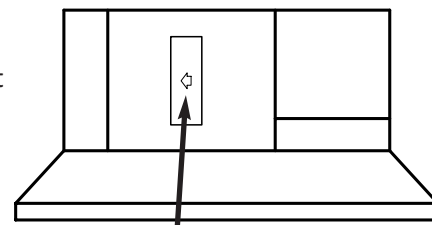

Note position of airflow arrow; it must be pointing to the left.

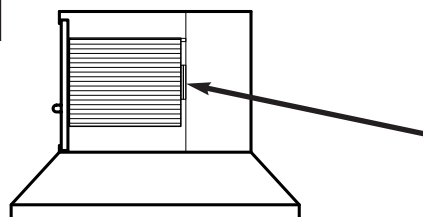

Filter and hood contacts must make good connection. Wipe away any grease residue.

## 4.02.3.3 Charcoal Filter Removal/Installation



① Place **Power Switch** in [OFF] position

### A. Removing Filter

Remove cover [POVH] or open access door [OVH-10]

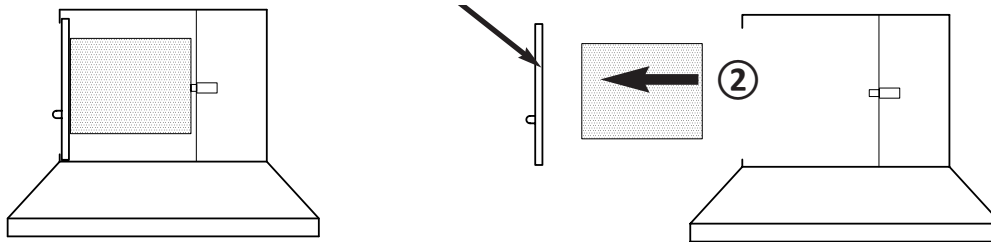

② Grasp filter & pull straight out of filter chamber.

### B. Installing Filter

Align filter in guide channels & slide straight into hood to stop.

Position blue foam side of filter toward the left side of hood.

Remove cover [POVH] or open access door [OVH-10]

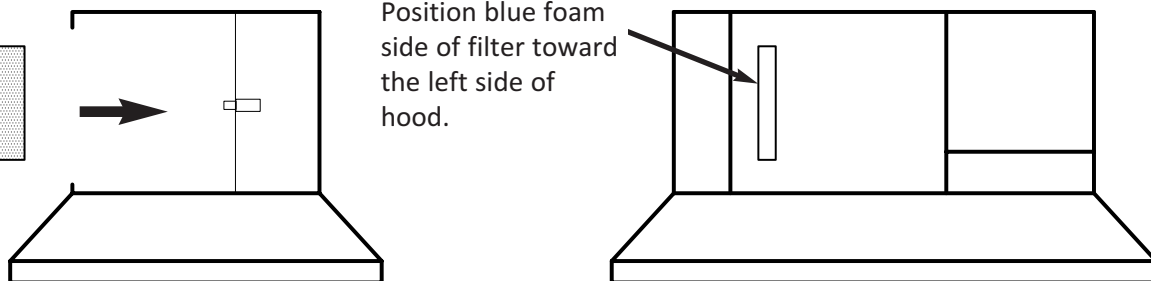

Switch plunger must be actuated by the filter when installed.

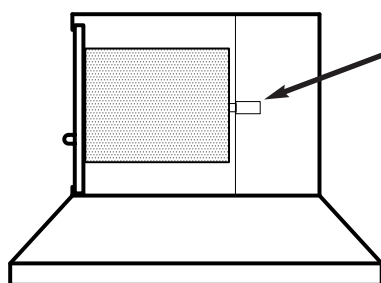

## 4.02.4 Hood Filter Alarms

### 4.02.4.1 Charcoal or Baffle Filter Missing

If either the charcoal or baffle filter, or both, is not in place, or not positioned correctly, the red [CHARCOAL OR BAFFLE FILTER MISSING] light will turn ON. Power to the appliance under hood is shutdown until the condition is corrected and the amber [APPLIANCE POWERED] light turns OFF.

- **No audible alarm will sound.**
- Hood fan will continue to run.
- Check to confirm that both Filters are in place. See **Sections 4.02.3.1, Baffle Filter Removal/Installation and 4.02.3.3, Charcoal Filter Removal/Installation.**
- Remove and reinstall filters, ensuring they are seated properly in the guides and are pushed fully into the filter compartment. Be certain that cover or door is in securely placed or latched, respectively. Each filter must actuate a proofing located on the rear wall of the compartment.

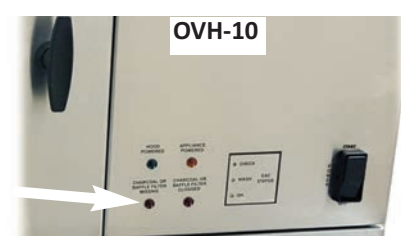

switch

### 4.02.4.2 Charcoal or Baffle Filter Clogged

If the baffle or charcoal filter become clogged, or other type restrictions occur, that reduce airflow through hood to a level below the minimum required for effective capture of cooking vapors, the [CHARCOAL OR BAFFLE FILTER CLOGGED] light will turn ON. Power to the appliance under the hood is shutdown until the condition is corrected and the amber [APPLIANCE POWERED] light turns OFF.

- **A steady tone audible alarm will sound.**
- Hood fan will continue to run.
- Clean the baffle filter, see **Section 4.02.5.1, Cleaning the Baffle Filter.**
- Replace charcoal filter with a fresh new filter, see **Section 4.02.5.4, Charcoal Filter Maintenance**
- Inspect inside hood plenum to ensure that no other obstructions exist
- Check the hood exhaust outlet and be sure that nothing is obstructing the exhaust air flow.



## 4.02.4.3 E.A.C. Filter Status & Alarm

Three L.E.D. indicator lights on the control panel will display the operational status of the E.A.C. filter system.

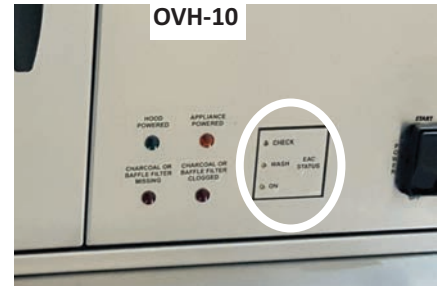

**[ON]** Indicates that the E.A.C. cell is installed, powered and operating. Only light **ON** when the system is operating normally.

**[WASH]** This light turns **ON** to indicate:

- Filter cell is not installed or is mis-aligned.
- Collection fins contain excessive amount of captured grease residue.
- Poor contact with filter cell contact plate inside hood.
- Ionizer wire, or wires, completely missing.

When **[WASH]** light is **ON**, an alarm condition exists and air cleaning is not occurring. After approximately two (2) minutes, an intermittent (beeping) alarm tone will begin sounding and shortly thereafter, power to the appliance under the hood is shutdown and **[APPLIANCE POWERED]** light turns **OFF**.

**[WASH]** light is **NOT** intended to be a signal for routine cleaning of the cell, **DO NOT use as such**. Typically, the collection cell must be cleaned **DAILY** to ensure optimum performance. See **Section 4.02.5.2, EAC Filter Cell Cleaning**.

**[CHECK]** This light turns **ON** to indicate:

- Ionizer wire broken and touching cell frame, shorted out.
- Cell is damaged and has shorted out to ground.
- Collection fins are shorted out because of excessive moisture.

When **[CHECK]** light is **ON**, system is no longer operating to clean the air, even though the hood continues to run and the appliance is powered. **DO NOT CONTINUE TO USE APPLIANCE WHEN THIS CONDITION EXIST ... UNDESIRABLE CONDITIONS MAY IMPACT DINING OR SERVING AREAS**

The following actions may clear the alarm condition:

1. Turn **OFF** hood **Power Switch**.
2. Remove the E.A.C. cell and clean as described in **Section 4.02.5.2**.
3. Inspect the cell for broken or missing ionizer wires, bent fins, or other damage. Ionizer wires are replaceable (when ordering replacements, note length ... available in **16" or 20"**). Bent fins may be gently straightened by hand, such that no fins are touching adjacent fins. A cell with excessive damage (broken frame, badly bent frame, broken insulators, etc) must be replaced.
4. Inspect the E.A.C. contact pad inside hood. Clean grease accumulation away with a mild degreasing cleaner and dry thoroughly.
5. Replace filter cell (**Section 4.02.3.2**) and restart Hood (**Section 4.01**). If the condition persist, contact a qualified service technician. If none of the LED lights turn **ON**, the EAC power supply may be faulty.

## 4.02.5 Filter Cleaning & Maintenance

### 4.02.5.1 Baffle Filter Cleaning

	The stainless steel baffle filter is fabricated from thin gauge metal that can potentially have sharp edges. Exercise due care when handling and cleaning to avoid injury. <b>It is recommended that heavy-duty rubber gloves be worn.</b>
---	--

Grease baffle filter should be cleaned daily. Clean in sink with a mild, biodegradable, degreasing cleaner (**Giles recommends Simple Green® Crystal Foaming Cleaner**). Rinse and dry filter thoroughly. Reinstall in the unit. Generally, a baffle filter may be washed in a dishwasher.

**Ensure that filter is completely dry before reinstalling in the hood. NEVER PLACE WET FILTER INTO HOOD!**

### 4.02.5.2 E.A.C. Filter Cell Cleaning

	The E.A.C. collector cell contains parts fabricated from thin gauge sheet metal that can potentially have sharp edges, which may cause cuts if not handled properly. To avoid injury, exercise due care when handling and/or cleaning the cell. <b>It is recommended that heavy-duty rubber gloves be worn as a precaution.</b>
---	---

The E.A.C. collector cell is sustainable and renewable; it should last for years if cleaned and handled properly. To maintain peak performance, it **MUST BE CLEANED DAILY**; not doing so can lead to an interruption of appliance operation, premature failure of the electronic cleaning system, or reduced useful life of consumable charcoal filters. Follow the procedures detailed below for effective cleaning.

**IMPORTANT: The cell CANNOT withstand washing in commercial dishwashing equipment, and some commercial cleaners/detergents will cause oxidation, or create a layer of contamination, on the aluminum collection fins that can lead to system malfunction and result in interruption of power to appliances being served by a ventless hood unit.**

Two (2) different cleaning methods are endorsed by GILES Food Service, as follows.

- Preferred **spray foam method** uses **Simple Green® Crystal Foaming Spray Cleaner/Degreaser**. A readily available foaming aerosol that is an exceptionally effective cleaner, as well as being safe for use on aluminum (**NSF approved**, food-grade, non-toxic, and biodegradable). Cleaning the E.A.C. cell is quick and easy with this convenient ready-to-use cleaner. A complimentary sample is supplied with new equipment. It is available through *Giles dealers*, **item #41510 (12-count case)**. When used as directed, a case of cleaner should last for approximately 4 to 5 weeks of cleaning, depending on equipment model.
- Alternative **soaking method** uses a diluted solution of **Simple Green® Pro-HD** and water. Although not as convenient as the spray method, requiring more planning and time, the procedure has proven to be very satisfactory for cleaning E.A.C. collector cells for many years. This product has the same characteristics of the spray product, but requires mixing with water before use ... **dilution factor is 1:12**, e.g. mix 1/2 gal. of cleaner with 6 gals. of water.



**With proper care, cleaning, and handling, the E.A.C. collector cell is designed to provide years of service.**

4.02.5.2 E.A.C. Filter Cell Cleaning - continued

**CAUTION** While handling and cleaning the cell, take care not to bend the collection fins or break the fine ionizer wires that are stretched across the face of the cell. Bent fins and broken/missing wires can prevent the electronic collection system from performing properly. System faults and alarms will occur that can potentially interrupt appliance operation.

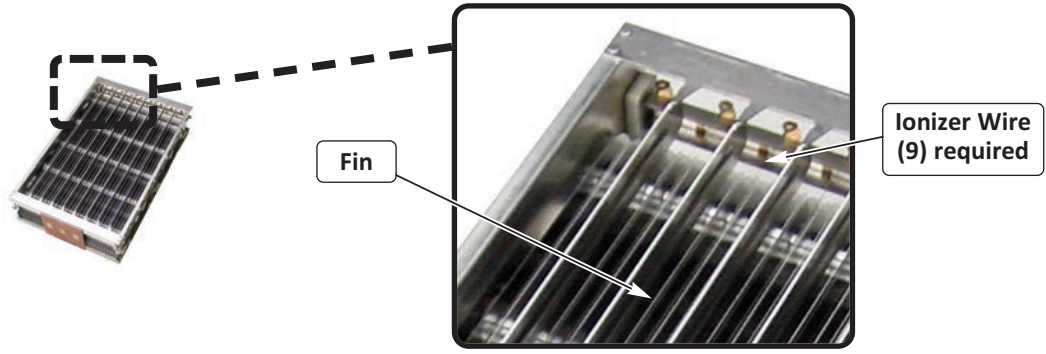

Damage from abusive handling and/or improper maintenance may not be covered by the factory warranty.

**A. Preferred Cleaning Method - Spray Cleaner**

1. Remove collector cell from hood (see **Section 4.02.3.2**) and lay on a drain board, or other suitable surface.
2. Holding the can at an appropriate distance, spray **Simple Green® Crystal Foaming Degreaser** onto the E.A.C. cell, completely covering all surfaces ... collection fins, contact plate, brass fittings and inside corners of frame. Turn cell over and apply to the other side in like manner, ensuring that both sides of all collector fins are completely covered with the foam.
3. Allow foam to soak for **5 to 10 minutes**. In cases of extreme build-up, a second application may be required after rinsing.
4. Carefully move cell to sink and rinse thoroughly, using hot water spray. **Rinse ONLY, DO NOT scrub with brushes.**
5. Stand cell upright on end on a drain board, w/contact plate up ... allow it to drain and air dry overnight. The cell must be completely dry before being replaced in hood unit. If desired, a small electric fan can be used to blow across the cell to help expedite drying. **DO NOT run hood with a wet cell installed, damage to the air cleaning system will occur.**
6. Before replacing cell in the hood, inspect for broken/missing ionizer wires and bent fins. Broken or missing wires need to be replaced promptly. Bent fins may be straightened by hand so that no fins are touching adjacent fins.

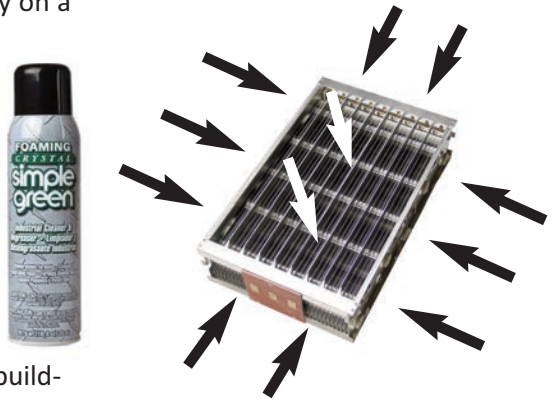

**IMPORTANT!** ONLY Simple Green® Crystal Foaming Cleaner/Degreaser is recommended by GILES for cleaning the E.A.C. cell in this manner. Other spray cleaners can contain corrosive ingredients that may damage the metal components of the cell, causing it to fail or not perform properly. Such damages are not covered by the factory warranty.

## 4.02.5.2 E.A.C. Filter Cell Cleaning - continued

### B. Alternate Cleaning Method - Soaking

The factory-recommended product to use for cleaning the E.A.C. cell in this manner is **Simple Green® Pro-HD**. It is a readily available, biodegradable, non-toxic degreasing cleaner that is safe for use on aluminum. It performs well to clean the cell when diluted at a **1:12 ratio** (e.g. 1/2 gal. cleaner to 6 gals ambient water).

**DO NOT use DISHWASHING DETERGENTS or CORROSIVE CLEANERS as they can contain ingredients that may damage the metal cell components, causing failure or unsatisfactory performance. Such damages are not covered by the factory warranty.**

1. Cleaning with this method requires a suitable, leakproof container, such as a tall trash bin, recycle bin, plastic tote, etc. that is large enough to hold the cell along with enough degreasing solution to completely cover and soak it, either standing on end, on edge, or lying flat.
2. Fill the container with fresh water to a level that will cover the cell. Measure water as filling and note the quantity. Add **Simple Green® Pro-HD** in the **ratio of 1:12** to the water (e.g. 8 gals of water would require .67 gals (2 qts+21 ozs) degreaser. Stir solution well to mix.
3. After preparing a quantity of degreaser solution sufficient to completely cover the cell in the soaking container, hold cell by the contact plate, the frame, or the handle and carefully place it into the solution. Be sure that it is fully submerged.
4. Allow cell to soak for approximately **20 minutes (no more than 30 mins)**, then lift it slightly and briefly agitate it up & down in the solution to help dislodge grease residue.
5. Carefully remove cell from container and follow **Steps 4 thru 6** as detailed in the previous section.



#### NOTE:

The degreasing solution may be used multiple times ... cover container with a lid or other suitable cover when not in use to prevent contamination. Discard and replenish solution when a greasy film seems to remain visible, floating on the liquid. When soaking, always ensure that solution completely covers the cell ... add some water if needed.

## 4.02.5.3 Charcoal Filter Maintenance

### CAUTION

NEVER attempt to clean and reuse a charcoal filter. Doing so can cause damage to the unit.

The charcoal filter is a consumable, single-use, item which must be replaced periodically, see **Section 4.02.3.3**. It **CANNOT** be cleaned and reused.

Typical replacement cycle is every **30 to 40 days**, depending on usage.

Use Giles replacement **Part No. 30248 (PO-VH) or 31963 (OVH-10)**, available through *Giles equipment dealers or parts distributors* Record replacement date on the new filter when installing.

**IMPORTANT! Failure to use Giles OEM parts and OEM replacement filters may void the factory warranty.**



## 5. Hood Cleaning & Maintenance

### 5.01 Quarterly Hood Cleaning (Except Where Noted)

**INTERIOR:** Disconnect supply power to the unit.

- Remove the filter cover (POVH) or open filter door (OVH-10).
- Remove all filters from hood. Using a mild, non-caustic, biodegradable, degreasing cleaner (**Giles recommends Simple Green® Crystal Foaming Spray Cleaner**). Spray surfaces and wipe with towel or sponge. Clean all surfaces inside the hood plenum, including filter channels and EAC contact pad.

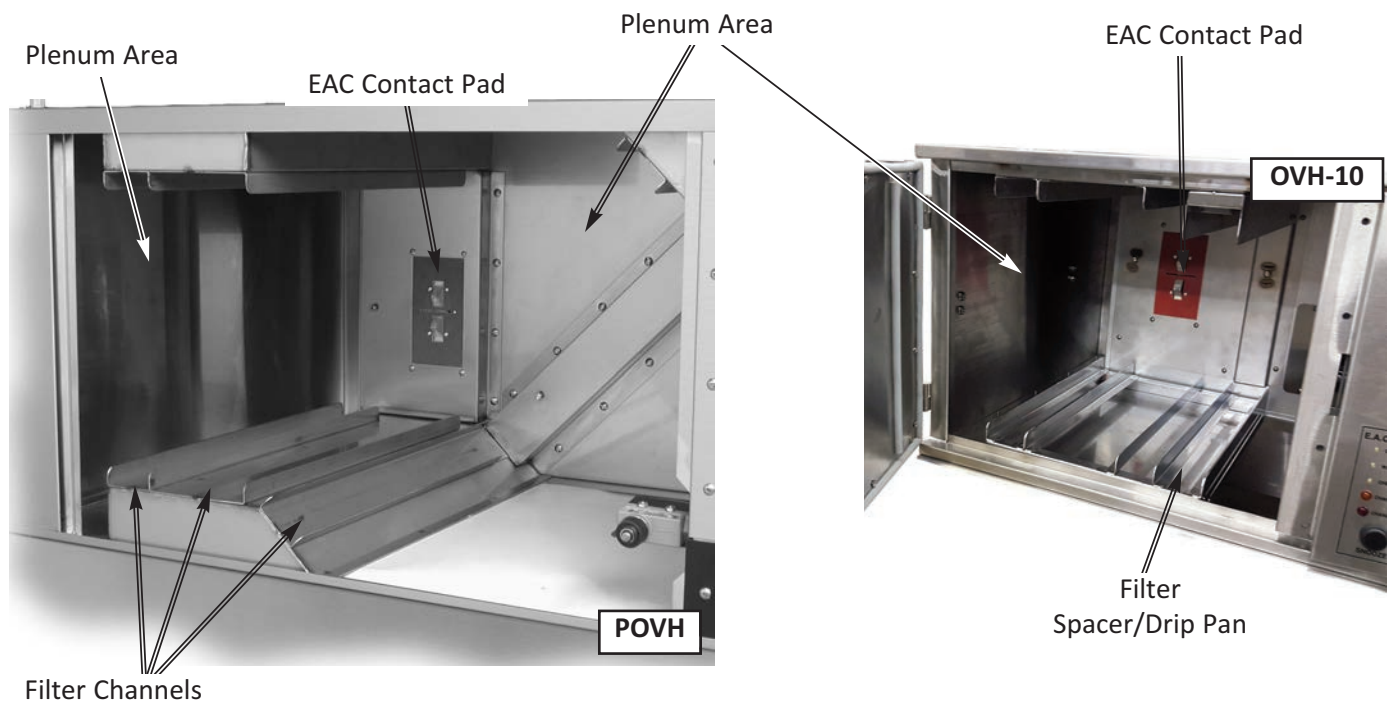

**EXTERIOR:** Disconnect supply power to the unit. Use a good quality stainless steel cleaner/polish to clean all external surfaces, including the underside of the hood skirt.

**FILTER SPACER/DRIP PAN (OVH-10 ONLY, AT LEAST WEEKLY):**

- Lift the spacer out of the hood and wash in sink using a mild, non-caustic, biodegradable, degreaser, or warm soapy water. Dry thoroughly before replacing in Hood.
- Spacer can be washed in the dishwasher.

**Filters:** Clean and replace filters as described in **Section 4.02.5, Filter Cleaning & Maintenance.**

## 5.02 Monthly Hood Interlock Inspection (User Performed)

The hood has various interlock switches to ensure that the unit cannot operate if certain conditions exist, which are not consistent with safe and effective operation. These interlocks should be tested **MONTHLY** as described below. Use the **Maintenance & Service Log (see Section 5.07)** to record completion of the inspection. If problems are detected, contact *GILES* or an authorized service provider.

**NOTE:** Anytime the *filter access cover (POVH)* is removed and replaced, or *door (OVH-10)* is opened and reclosed, the hood must be restarted by pressing and momentarily holding the top [START] portion of the *Power Switch*.

1. **Door/Cover Interlock Test:** Start hood. While running, partially remove access cover, or slightly open the access door. Confirm hood powers **OFF** and the amber [APPLIANCE POWERED] light turns **OFF**. Verify that all appliances under hood will **NOT** turn **ON**.
2. **Baffle Filter Test:** Remove the baffle filter, then reclose access cover/door securely and restart hood. The red [BAFFLE OR CHARCOAL FILTER MISSING] light should turn **ON** and the [APPLIANCE POWERED] light should **NOT** turn **ON**. Verify that appliances under hood will **NOT** turn **ON**. Reinstall baffle filter (*Section 4.02.3.1*).
3. **Charcoal Filter Test:** Same procedure as #2 above except remove the charcoal filter, then proceed as described above. Reinstall the charcoal filter (*Section 4.02.3.3*).
3. **E.A.C. Filter Test:** Same procedure as #2 & #3 except remove the E.A.C. collector cell. Note if [WASH] light of the small E.A.C. Status LED Lights come **ON**; the amber [APPLIANCE POWERED] light should be **ON**. Wait approximately two (2) minutes. A beeping tone alarm will begin sounding and within several seconds the [APPLIANCE POWERED] light should turn **OFF**. After this occurs, verify that appliances under hood will **NOT** turn **ON**. Reinstall the E.A.C. Cell (*Section 4.02.3.2*).
5. **Filter Clogged Test:** *Perform this test ONLY after installing a new charcoal filter.* Start hood normally and allow to run. Use cardboard or other suitable material to completely block hood exhaust outlet, holding it firmly in place so that no air is escaping. Within a few seconds, a continuous tone alarm will begin sounding. The red [BAFFLE OR CHARCOAL FILTER CLOGGED] light should turn **ON** and the [APPLIANCE POWERED] light should turn **OFF**. Verify that appliances under Hood will **NOT** turn **ON**. Remove the obstruction; the alarm should silence and the [APPLIANCE POWERED] light should turn **ON** again.

Should any of these tests fail to give the results as described above, contact a factory-authorized service company and have the unit evaluated and repaired. Any *Giles Manufacturer's Representative* can provide information about nearby authorized service companies, or call Giles Services at **800.554.4537** for assistance locating a representative or an authorized service company.

## 5.03 Fire Suppression System Maintenance (Only Hoods Equipped w/Fire System)

If hood is equipped with a required fire extinguishing system, it must be maintained according to the **Standard for Wet Chemical Extinguishing Systems, NFPA 17A** and in accordance with the instructions of the system provider. Hood is listed for use of an **Ansul® R102 Resturant Fire Suppression System, which must be installed by an authorized Ansul® Distributor/Dealer**

All inspection, maintenance, troubleshooting, repairs and general servicing for the fire extinguishing system must be performed by an authorized Ansul® service company. Required maintenance activities are described in the following sections.

**For complete maintenance guidelines, consult the Fire Suppression System documentation supplied by the provider.**

**Local code authorities may require that fire system maintenance records be retained and be available for inspection during routine site inspections.**

### 5.03.1 Semi-Annual (6-Month) Inspection & Maintenance

Service and inspection of the fire suppression system must be performed by an authorized Ansul® service company. As a minimum, field inspection of the system must be conducted semi-annually (every 6 months). Such maintenance shall consist of the following:

1. Confirm that fire hazard potential has not changed.
2. Inspect storage tank for suppressant chemical level and charge pressure.
3. Inspect and test the release mechanism.
4. Check all discharge nozzles to ensure they are free of grease build-up. Confirm that all discharge nozzle blow-off caps are in place and in good condition; replace as needed.
5. Inspect and test the remote manual activation station for function and wear.
6. Install test link; cut to simulate and test automatic actuation.
7. Inspect and clean fusible links. Confirm that fusible links are the correct temperature rating.
8. Inspect fusible link conduit and wire cable for wear at pulleys and detectors; replace if necessary.
9. Record maintenance date and service performed in a permanent file, and sign-off on tag attached to system in a conspicuous location.

### 5.03.2 Annual (12-Month) Inspection & Maintenance

The annual inspection and maintenance is the same as the semi-annual inspection except:

- 1 All fusible links must be replaced with new links.

## **5.03.3 12-Year Inspection & Maintenance**

Same as annual inspection and maintenance except:

1. Wet-chemical fire suppressant in storage tank shall be replaced.
2. Suppressant tank and compressed gas charging cartridge shall be certified by hydrostatic testing. As alternative components can be replaced with new.
3. Regulator shall be flow tested.

# Hood Cleaning & Maintenance

OVH-10 / PO-VH

**5.04 Inspection & Maintenance Log**

Check	Initial/Date	Check	Initial/Date
-------	--------------	-------	--------------

✓	✓	✓	✓	✓					<i>ABC</i>	1/31/12	1	2	3	4	5					
1	2	3	4	5							1	2	3	4	5					
1	2	3	4	5	6						1	2	3	4	5	6				
1	2	3	4	5							1	2	3	4	5					
1	2	3	4	5							1	2	3	4	5					
1	2	3	4	5	6	7					1	2	3	4	5	6	7			
1	2	3	4	5							1	2	3	4	5					
1	2	3	4	5							1	2	3	4	5					
1	2	3	4	5	6						1	2	3	4	5	6				
1	2	3	4	5							1	2	3	4	5					
1	2	3	4	5							1	2	3	4	5					
1	2	3	4	5	6	7	8				1	2	3	4	5	6	7	8		
1	2	3	4	5							1	2	3	4	5					
1	2	3	4	5							1	2	3	4	5					
1	2	3	4	5	6						1	2	3	4	5	6				
1	2	3	4	5							1	2	3	4	5					
1	2	3	4	5							1	2	3	4	5					
1	2	3	4	5	6	7					1	2	3	4	5	6	7			
1	2	3	4	5							1	2	3	4	5					
1	2	3	4	5							1	2	3	4	5					
1	2	3	4	5	6						1	2	3	4	5	6				
1	2	3	4	5							1	2	3	4	5					
1	2	3	4	5							1	2	3	4	5					
1	2	3	4	5	6	7					1	2	3	4	5	6	7			
1	2	3	4	5							1	2	3	4	5					
1	2	3	4	5							1	2	3	4	5					
1	2	3	4	5	6						1	2	3	4	5	6				
1	2	3	4	5							1	2	3	4	5					
1	2	3	4	5							1	2	3	4	5					
1	2	3	4	5	6	7	8				1	2	3	4	5	6	7	8		

1	Cover/Door Test	Section 5.02
2	Baffle Filter Missing Test	Section 5.02
3	E.A.C. Filter Cell Missing Test	Section 5.02
4	Charcoal Filter Missing Test	Section 5.02
5	Filter Clogged Test	Section 5.02
6	Quarterly Cleaning	Section 5.01
7	Semi-annual Fire System Inspection	Section 5.03.1
8	Annual Fire System Inspection	Section 5.03.2

## 6. Troubleshooting

This section describes troubleshooting procedures for **PO-VH and OVH-10 Ventless Oven Hoods**. These procedures are generally presented to aid qualified technicians and service agents. **Users should limit troubleshooting only to matters involving operating procedures.**



Electrical troubleshooting procedures should **ONLY** be performed by qualified service technicians. Serious personal injury, even death, will result from contact with energized electrical components or circuits.

### 6.01 Troubleshooting Procedures

Problem	Probable Cause	Corrective Action
Hood will not turn ON	a. Filter access door/cover not closed	Close & secure door or cover.
	b. Improper start-up	Press & hold in top <b>[START]</b> portion of power switch until hood starts.
	c. Power Switch is faulty	Replace Power Switch.
	c. Improper supply voltage	Connect to proper electrical supply.
	e. Not properly connected to power source.	Confirm connections & correct.
	f. Blown fuse/tripped circuit breaker.	Check fuse in hood and main breaker panel.
[CHARCOAL OR BAFFLE FILTER MISSING] light ON at start-up	a. Baffle or charcoal filter is not installed or is mis-aligned	Install appropriate filter and/or check positioning.
EAC [WASH] light ON & intermittent (beeping) alarm sounding	a. Excessive film build-up on fins	Clean the EAC cell, <b>Section 4.02.5.2</b>
	b. EAC cell is not installed	Install EAC cell
	c. Poor connection at contact plate inside hood.	Check cell position, clean contacts.
	d. Faulty EAC contact plate	Have plate inspected, replace if needed.
EAC [CHECK] light ON; no alarm sounding	a. EAC shorted to ground (damaged)	Replace or repair the EAC cell.
	b. High voltage wires shorted to ground.	Correct shorted condition.
	c. Collector fins shorted out due to excessive moisture.	Eliminate cause of condensation - cold air being drawn into hood, etc.

## 6.01 Troubleshooting Procedures

Problem	Probable Cause	Corrective Action
<b>Under-hood appliance will not power-up:</b> <ul style="list-style-type: none"> <li>• [HOOD POWERED] light ON</li> <li>• [CHARCOAL OR BAFFLE FILTER MISSING] light ON</li> <li>• [APPLIANCE POWERED] light OFF</li> </ul>	a. Baffle filter missing or not properly installed	Install baffle filter / check alignment.
	b. Charcoal filter missing or not properly installed	Install charcoal filter / check alignment.
	c. One or both filter switches are faulty	Test & replace as needed.
<b>Under-hood Appliance will not power-up:</b> <ul style="list-style-type: none"> <li>• [HOOD POWERED] light ON</li> <li>• [CHARCOAL OR BAFFLE FILTER CLOGGED] light ON</li> <li>• [APPLIANCE POWERED] light OFF</li> <li>• <b>Steady tone</b> alarm sounding.</li> </ul>	a. Baffle or charcoal filter clogged	Replace charcoal filter or clean baffle filter.
	b. Hood exhaust outlet block	Confirm exhaust is clear of any obstruction around diverter.
	c. Vacuum switch out of adjustment	Test & adjust vacuum switch.
	d. Kinked or blocked vacuum line	Remove vacuum line kinks or blockage.
	e. Fan running slow or blades are loaded with grease film	Check voltage and inspect blower, clean if needed
<b>Under-hood Appliance will not power-up:</b> <ul style="list-style-type: none"> <li>• [HOOD POWERED] light ON</li> <li>• [WASH] light ON</li> <li>• [APPLIANCE POWERED] light OFF</li> <li>• <b>Beeping tone</b> alarm sounding.</li> </ul>	a. Excessive film built up on collector fins; too dirty	Clean the EAC cell, <b>Section 4.02.5.2</b> .
	b. EAC cell is not installed	Install clean EAC cell.
	c. EAC driver board is faulty	Test & replace EAC power supply if needed.
	d. Poor connection at contact plate, dirty contacts, cell mis-aligned, faulty contacts.	Check cell position, clean contacts, inspect contact plate & replace if needed.
	e. Ionizer wire(s) missing	Replace missing wire(s)
<b>Under-hood Appliance operates:</b> <ul style="list-style-type: none"> <li>• [HOOD POWERED] light ON</li> <li>• [CHECK] light ON</li> <li>• [APPLIANCE POWERED] light ON</li> <li>• <b>No alarm sounding, although cell is NOT cleaning air.</b></li> </ul>	a. Ionizer wire broken & touching chassis.	Replace ionizer wire.
	b. Collector fins shorted to ground by moisture.	Dry cell, determine cause of moisture, cool air being drawn into hood creating condensation.



## 7. Parts List

This section lists some of the various parts that are available for replacement on the unit. This is not an all inclusive listing; please contact an authorized *Giles* representative or service agent concerning other parts that may be replaced in the field.

### 7.01 Parts Ordering & Service Information

*Giles* is an equipment manufacturer and we do not sell parts direct. Parts for our equipment are available through authorized service agents, part distributors, and/or kitchen equipment dealers. If assistance with sourcing parts or equipment repair service is required, please contact a *GILES* Manufacturer’s Representative to assist with locating a parts source or authorized service provider near you. For further assistance you may contact the ***GILES* Technical/Customer Service Support** as follows:

**IN THE UNITED STATES & CANADA call: 800.554.4537**

**ALL OTHERS call: 334.272.1457**

Normal business hours are 8:00 AM to 5:00 PM Central Time ... calls are handled by an auto-attendant answering system. Please follow the recorded prompts to route your call appropriately. If necessary after hours, leave a voicemail message and a representative should respond within 30 minutes.

Website: [www.gfse.com](http://www.gfse.com) Email: [services@gfse.com](mailto:services@gfse.com)

Our goal at Giles is to provide the highest possible quality of service and assistance. To help us accomplish this, please have the following information readily available when calling, along with a brief description of the problem being experienced. Please record the unit information in the table below for quick reference.

<b>Model:</b>	
<b>Serial Number:</b>	
<b>Voltage:</b>	
<b>Phase:</b>	

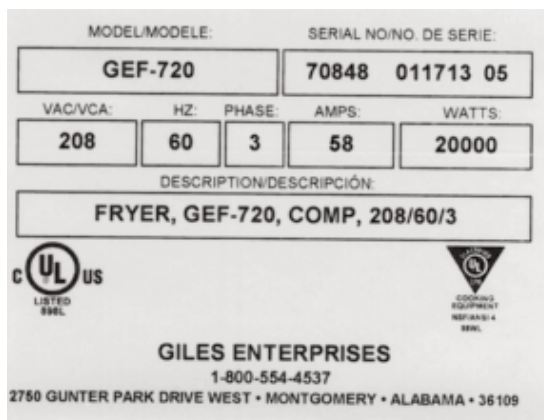

The information can be found on a serial/data label, similar to this one, located on the hood side.

7.02 Control Panel: PO-VH



\* Hidden

## 7.02 Parts List, Control Panel: PO-VH

ITEM	PART NO.	QTY	DESCRIPTION
1	21441	1	SWITCH, ROCKER, (ON)-ON-OFF, 250V, 20A
2	24209	1	L.E.D. CLUSTER, AIR FILTER, E.A.C.
*3	30833	1	BRACKET, E.A.C. LED ( <b>behind Panel</b> )
4	20398	1	INDICATOR LIGHT, GREEN, 250V, 0.5W
5	20399	1	INDICATOR LIGHT, AMBER, 250V, 0.5W
6	20402	2	INDICATOR LIGHT, RED, 250V, 0.5W

\* Hidden

7.03 Control Panel: OVH-10

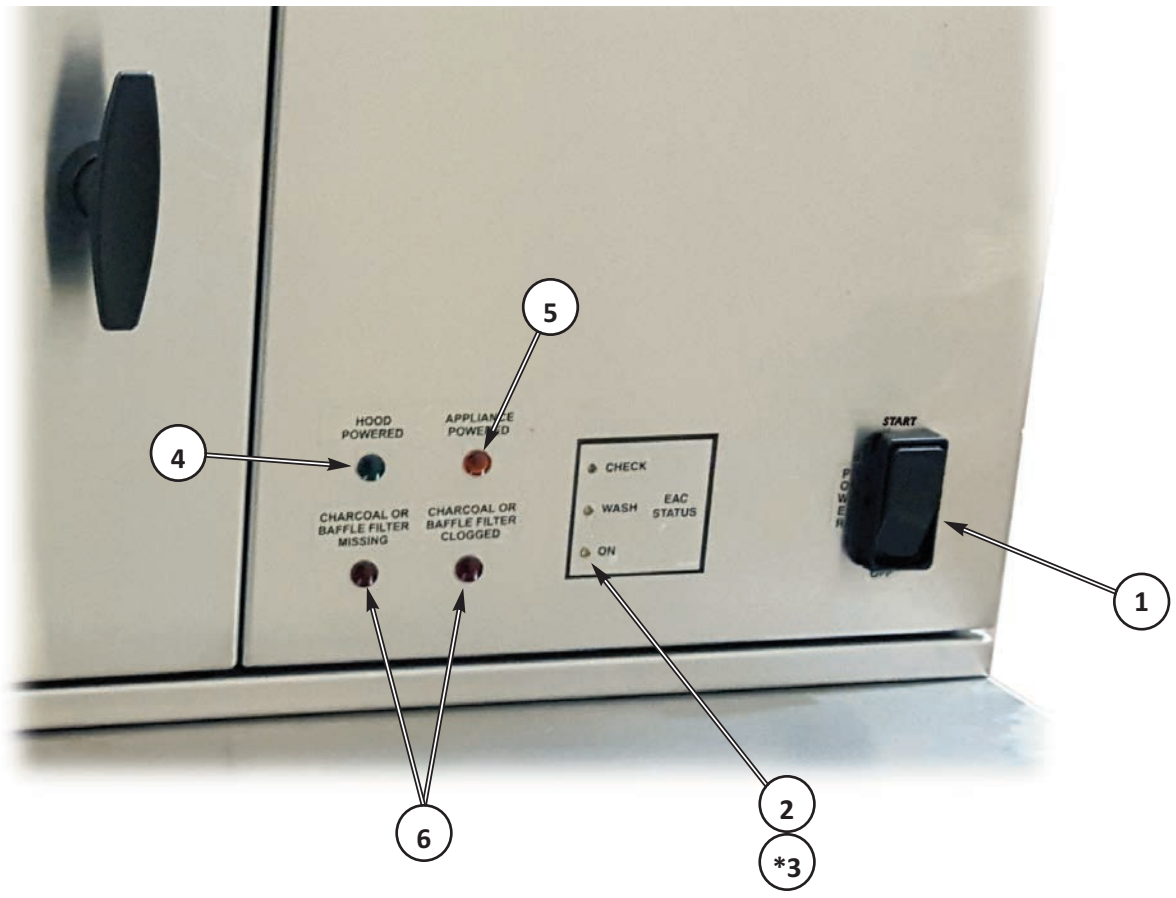

\* Hidden

**7.03**      *Parts List, Control Panel: OVH-10*

ITEM	PART NO.	QTY	DESCRIPTION
1	21441	1	SWITCH, ROCKER, (ON)-ON-OFF, 250V, 20A
2	24209	1	L.E.D. CLUSTER, E.A.C. FILTER
*3	93995	1	L.E.D. MOUNTING BRACKET
4	20398	1	INDICATOR LIGHT, GREEN, 250V, 0.5W
5	20399	1	INDICATOR LIGHT, AMBER, 250V, 0.5W
6	20402	2	INDICATOR LIGHT, RED, 250V, 0.5W

\* Hidden

7.04 Fan Compartment: PO-VH

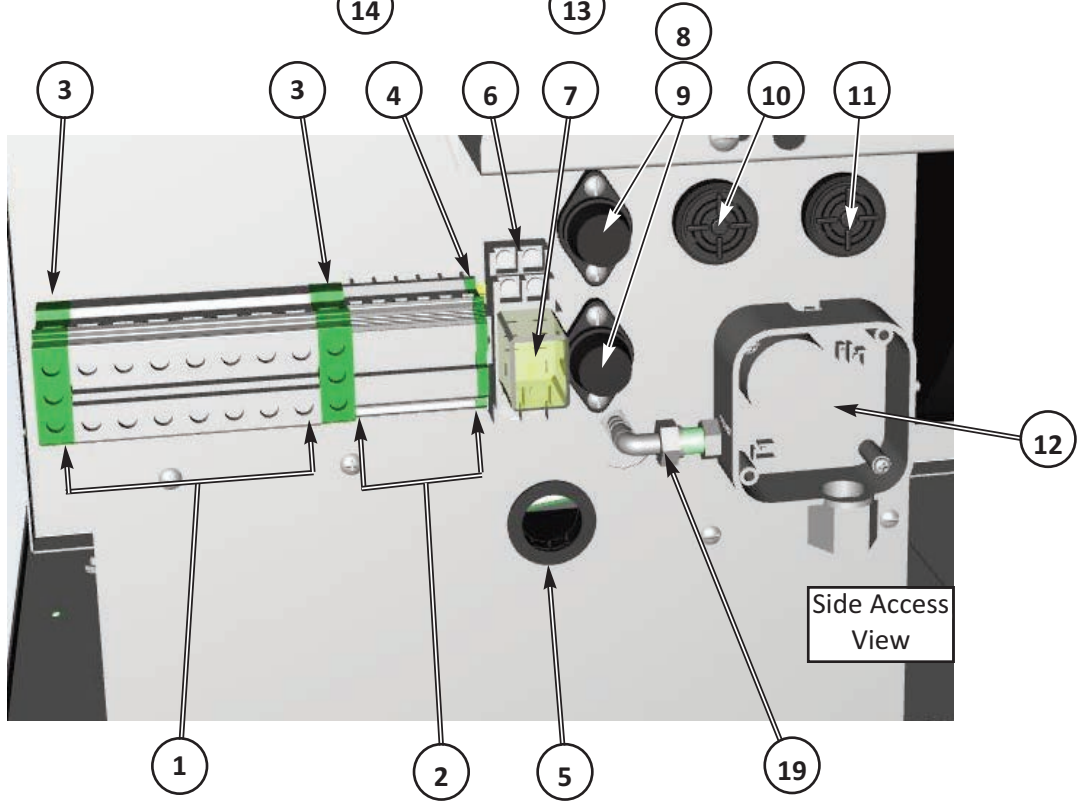
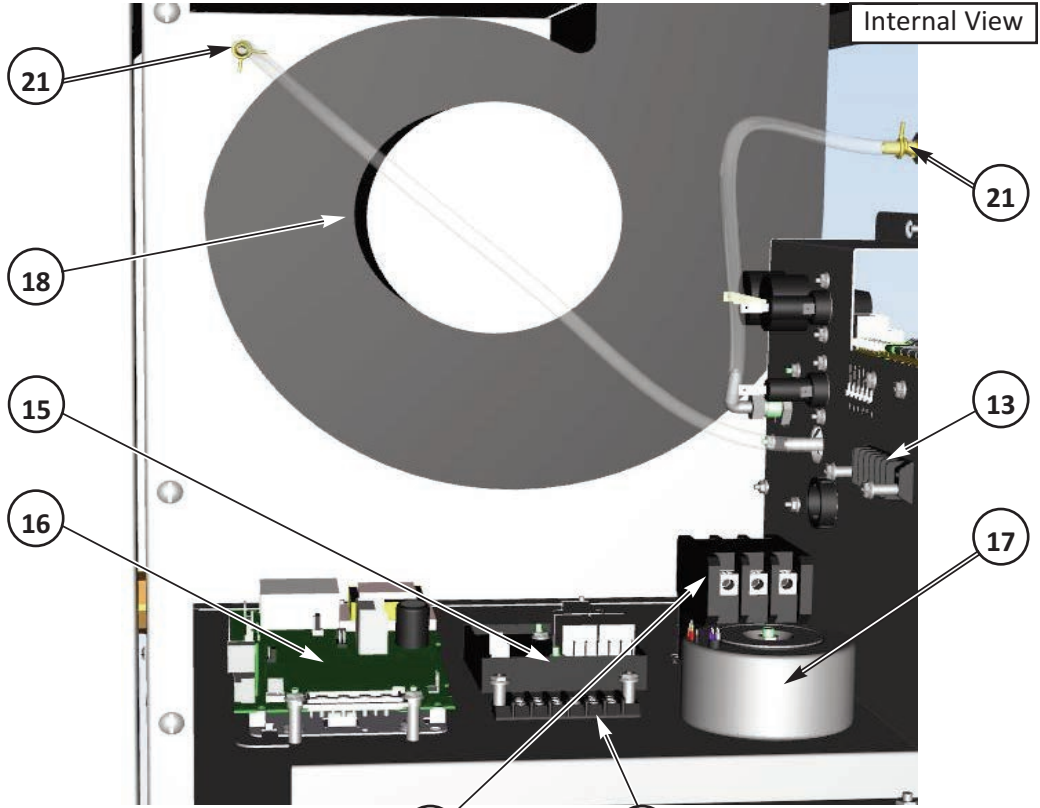

## 7.04 Parts List, Fan Compartment: PO-VH

ITEM	PART NO.	QT	DESCRIPTION
1	20303	6 or 7	TERMINAL BLOCK, 4-12 GA WIRE
2	20319	5	TERMINAL BLOCK, 50 AMP, AWAG 8-24
3	20304	2	TERMINAL BLOCK, GROUND, 4-12 GA WIRE
4	20320	1	TERMINAL BLOCK, GROUND, AWAG 8-24
5	40550	1	BUSHING, HEYDON, 1-1/4
6	20312	1	RELAY BASE, PLUG-IN, DIN MOUNT
7	20318	1	RELAY, 240 VAC, 10A, ELECTRO-MECA
8	21950	2	FUSE HOLDER
9	21900	2	FUSE, 15-AMP, SC-15
10	22950	1	SOLANDER, INTERMITTENT TONE, 250V
11	23782	1	SOLANDER, CONTINUOUS TONE, 250V
12	20390	1	VACUUM SWITCH, DUNGS, 0.16 to 1.20" WC
13	23751	2	TERMINAL BLOCK, MA106
14	32208	1	CONTACTOR & QUENCHER ASSAY, 208/240VAC, 3PH, 50A
15	23776	1	SHUTDOWN MODULE, E.A.C. FILTER
16	21296	1	E.A.C. POWER SUPPLY ASSAY, with DRIVER BOARD & JUMPERS, 120V
17	21337	1	TRANSFORMER, Vancouveria @.86A, TRIAD
18	33589	1	BLOWER ASSEMBLY
19	40877	1	FITTING, 1/4 BARBED, 90-EL, NYLON, 1/8 NOT
20	40880	1	FITTING, 1/4 BARBED, 90-EL, NYLON, 1/4 NOT
21	46750	2	FITTING, 7/16-20, VACUUM PICKUP

7.05 Fan Compartment: OVH-10

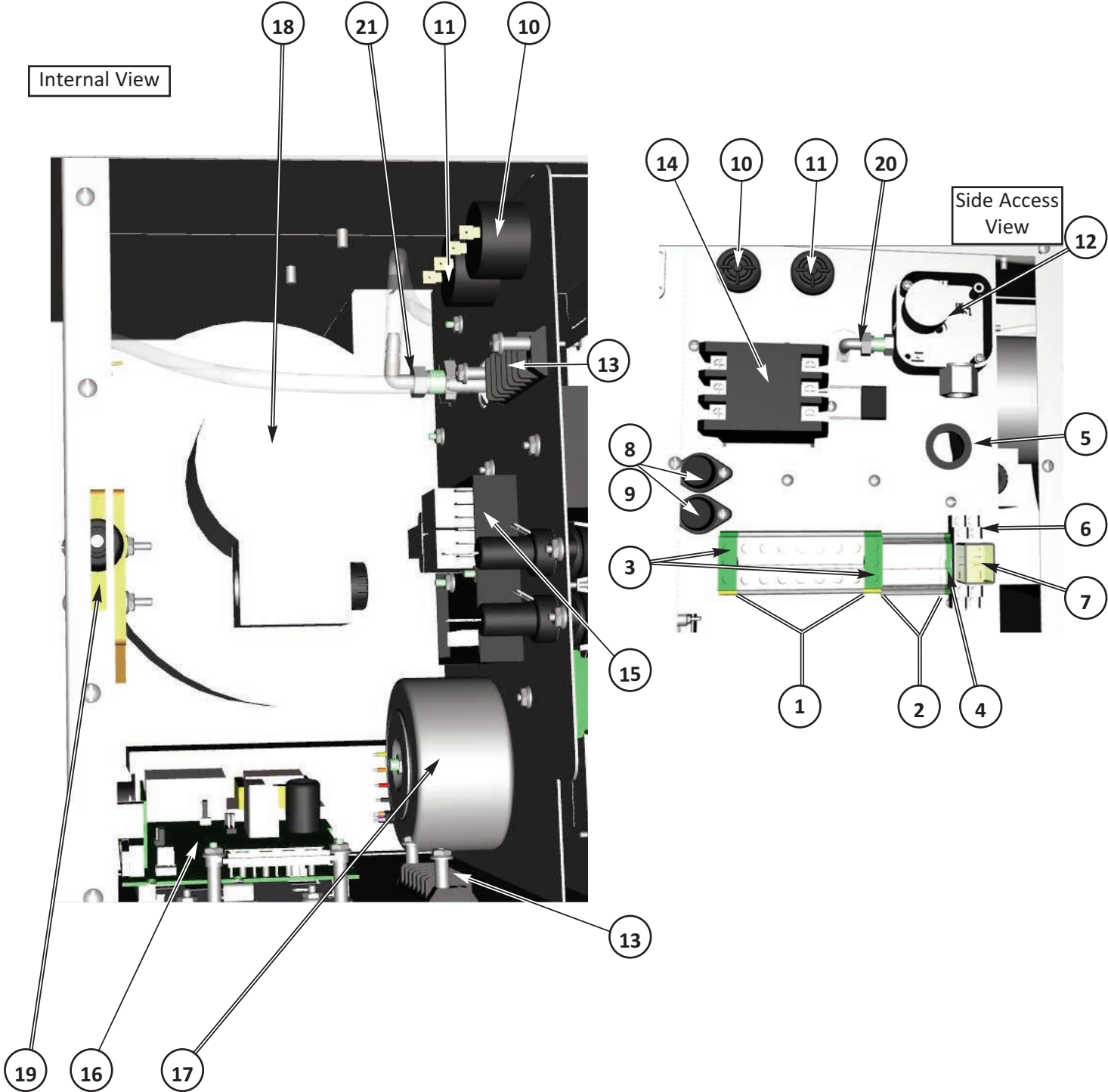

**7.05**      *Parts List, Fan Compartment: OVH-10*

ITEM	PART NO.	QTY	DESCRIPTION
1	20303	6 or 7	TERMINAL BLOCK, 4-12 GA WIRE
2	20319	5	TERMINAL BLOCK, 50 AMP, AWG 8-24
3	20304	2	TERMINAL BLOCK, GROUND, 4-12 GA WIRE
4	20320	1	TERMINAL BLOCK, GROUND, AWG 8-24
5	40550	1	BUSHING, HEYCO, 1-1/4
6	20312	1	RELAY BASE, PLUG-IN, DIN MOUNT
7	20318	1	RELAY, 240 VAC, 10A, ELECTRO-MECA
8	21950	2	FUSE HOLDER
9	21900	2	FUSE, 15-AMP, SC-15
10	22950	1	SOLANDER, INTERMITTENT TONE, 250V
11	23782	1	SOLANDER, CONTINUOUS TONE, 250V
12	20390	1	VACUUM SWITCH, DUNGS, 0.16 to 1.20" WC
13	23751	2	TERMINAL BLOCK, MA106
14	32208	1	CONTACTOR & QUENCHER ASSAY, 208/240VAC, 3PH, 50A
15	23776	1	SHUTDOWN MODULE, E.A.C. FILTER
16	21296	1	E.A.C. POWER SUPPLY ASSAY, with DRIVER BOARD & JUMPERS, 120V
17	21337	1	TRANSFORMER, Vancouveria @.86A, TRIAD
18	35881	1	FAN ASSEMBLY, OVH-10, 208-240/60/1
19	21157	1	LIMIT SWITCH, 15A, 250V (DOOR INTERLOCK)
20	40877	1	FITTING, 1/4 BARBED, 90-EL, NYLON, 1/8 NOT
21	40880	1	FITTING, 1/4 BARBED, 90-EL, NYLON, 1/4 NOT

7.06 Filter Compartment: PO-VH

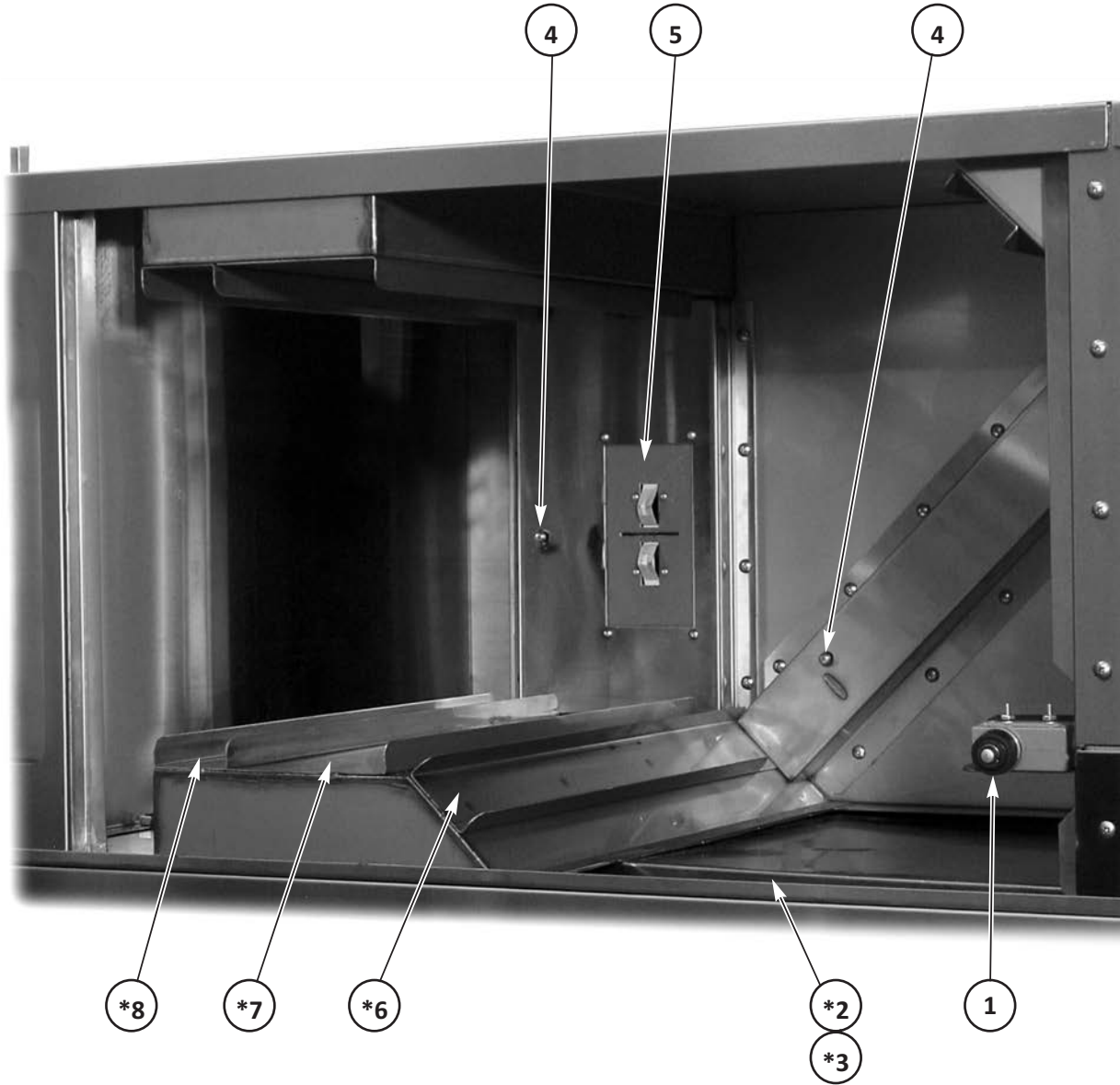

\* Not shown

**7.06**      *Parts List, Filter Compartment: PO-VH*

ITEM	PART NO.	QTY	DESCRIPTION
1	21157	1	LIMIT SWITCH, 15A, 250V
*2	91651	1	FILTER ACCESS PANEL
*3	42825	1	HANDLE, ACCESS PANEL <b>(NOT INCLUDED WITH ACCESS PANEL)</b>
4	24237	2	PLUNGER SWITCH, 250V, 15A
5	21125	1	CONTACT BOARD, E.A.C. FILTER
*6	42300	1	BAFFLE FILTER, 20" X 20" X 2" <b>(NOT SHOWN)</b>
*7	20520	1	E.A.C. FILTER CELL, 20" <b>(NOT SHOWN)</b>
*8	30248	1	CHARCOAL FILTER ASSEMBLY, 20" X 12-3/8" <b>(NOT SHOWN)</b>

**IMPORTANT!**

*Failure to use Giles OEM parts and OEM replacement filters may void the factory warranty.*

\* Not shown

7.07 Filter Compartment: OVH-10

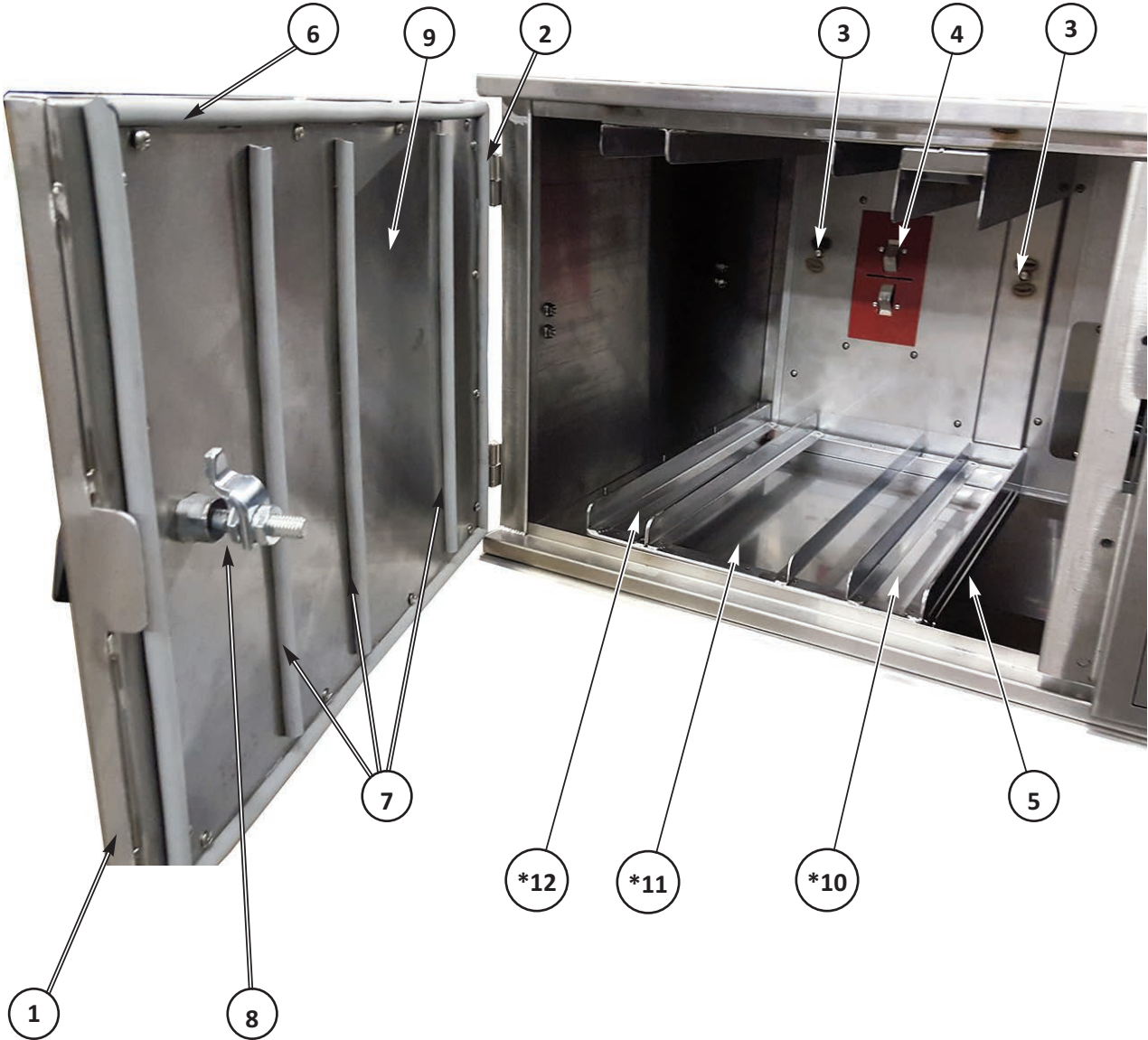

\* Not shown

**7.07**      *Parts List, Filter Compartment: OVH-10*

ITEM	PART NO.	QTY	DESCRIPTION
1	95117	1	DOOR ASSEMBLY, COMPLETE
2	<a href="#">41308</a>	2	HINGE, 1-1/2, SLIP APART, LEFT-HAND
3	<a href="#">24237</a>	2	PLUNGER SWITCH, 250V, 15A
4	<a href="#">21125</a>	1	CONTACT BOARD, E.A.C. FILTER
5	95104	1	BOTTOM FILTER SPACER/DRIP PAN
6	<a href="#">41276</a>	1	DOOR GASKET
7	<a href="#">41117</a>	3	GASKET, P-SHAPED, 3/8 x 3/4 <b>(SPECIFY LENGTH)</b>
8	<a href="#">41257</a>	1	COMPRESSION LATCH
9	95557	1	DOOR GASKET PLATE
*10	<a href="#">45096</a>	1	FILTER, BAFFLE, 12" X 16", S/S <b>(NOT SHOWN)</b>
*11	<a href="#">22360</a>	1	E.A.C. FILTER CELL, 16" <b>(NOT SHOWN)</b>
*12	<a href="#">31963</a>	1	CHARCOAL FILTER, ASSEMBLY, 16" X 12-3/8" <b>(NOT SHOWN)</b>

**IMPORTANT!**  
*Failure to use Giles OEM parts and OEM replacement filters may void the factory warranty.*

**NOTE:**  
 Complete Door Assembly includes Door, Latch, Hinges and all Gaskets installed.

\* Not shown



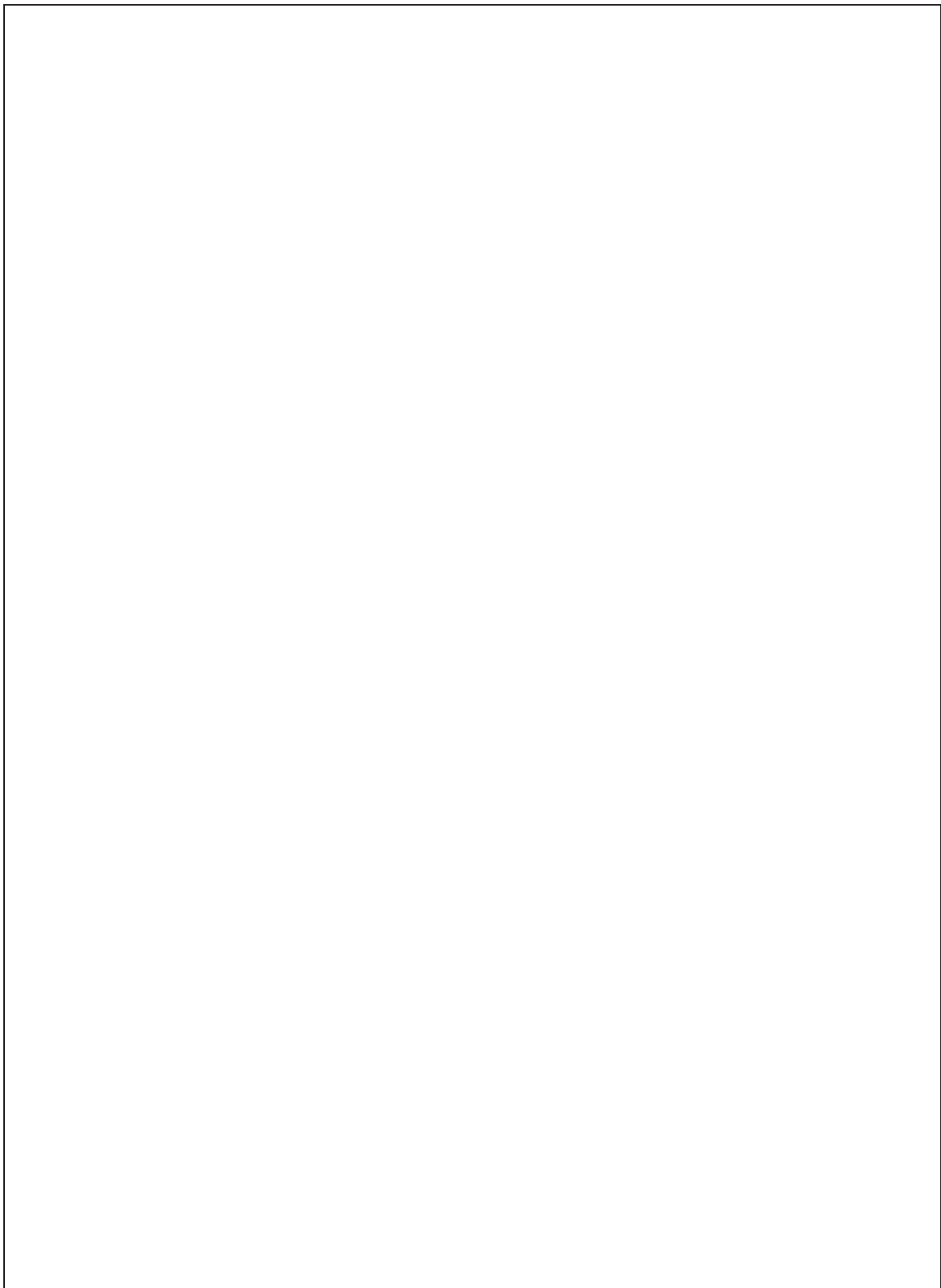



**Responsive. Reliable.**

2750 Gunter Park Drive West • Montgomery, Al 36109 USA  
Phone: 334.272.1457 • Toll Free: 800.554.4537 (USA & Canada Only) • FAX: 334.239.4117 • [www.gfse.com](http://www.gfse.com)

Form No. 60203 (Rel. Date: Feb.2001, Rev. Date: Mar.2020, Rev. J)