

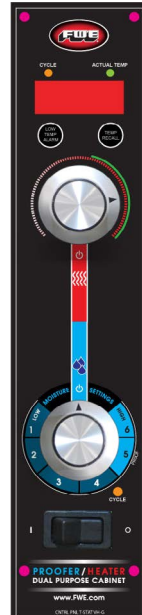

OPERATING INSTRUCTIONS

ORIGINAL INSTRUCTIONS

PHU-12-CIN PROOFER



INTERNATIONAL
PHU-12-CIN



Caution: Read the
instructions before
using the machine.

WARNING SYMBOLS



To indicate hazards arising from dangerous voltages



To identify the terminals which, when connected together, bring the various parts of an equipment or of a system to the same potential.



To identify the terminal which is intended for connection to an external conductor for protection against electric shock in case of a fault, or the terminal of a protective earth (ground) electrode



To indicate that the marked item can be hot and should not be touched without taking care



To indicate the "ON" condition for a part of equipment



To indicate the "OFF" condition for a part of equipment



To indicate the stand-by or preparatory state for a part of equipment



To indicate maximum fill level



To indicate minimum water level



To indicate moisture settings



To indicate heat settings

CASTER WEIGHT CHART AND SERVICE INFORMATION

SEE SHIPPING LABEL FOR CASTER SIZE

CASTER DESCRIPTION	MAX WEIGHT
2" GREY RUBBER CASTER, SWIVEL W/BRK	34Kg
CASTER 2" RIGID	68Kg
CASTER 3" RIGID	68Kg
CASTER 3.5" RIGID HEAVY DUTY	113Kg
CASTER 4X2" EZ ROLL RIGID POLYBLUE	272Kg
CASTER 5" RIGID HEAVY DUTY	124Kg
CASTER 5" RIGID SUPER DUTY	226Kg
CASTER 5" SWIVEL BRAKE RB GRS FIT Poly	340Kg
CASTER 5" RIGID EZ ROLL POLY	362Kg
CASTER 5" SWIVEL BRAKE EZ ROLL POLY	362Kg
CASTER 6" RIGID HEAVY DUTY	158Kg
CASTER 6" RIGID SUPER DUTY	272Kg
CASTER 6" SWIVEL BRAKE EZ ROLL POLY	453Kg
CASTER 6" RIGID EZ ROLL POLY	453Kg
CASTER 8" PNEUMATIC RIGID	113Kg
CASTER 8" RIGID HEAVY DUTY	226Kg
CASTER 8" RIGID SUPER DUTY	272Kg
CASTER 8" SWIVEL BRAKE EZ ROLL POLY	544Kg
CASTER 8" RIGID EZ ROLL POLY	544Kg

Improper use of this machine can result in injury and/or death.

A schedule should be put in place for inspections and preventative maintenance.

New users should be properly trained in the use of this equipment.

No special protective equipment is required to operate this unit.

Unplug unit before servicing.

**IN THE EVENT OF ACCIDENT OR
BREAKDOWN - UNPLUG UNIT.**

**FOR SERVICE INQUIRIES PLEASE CALL
FWE SERVICE - 800-222-4393**

FWE PHU-12-CIN PROOFER

WARNING AND CLEANING CARE

CLEANING

Keep your cabinet clean by simply wiping the interior and exterior, as needed, with a damp cloth or sponge and a mild soapy solution.

NEVER USE ABRASIVES, ACIDS, OR STRONG CLEANERS.

Do not flood or allow electrical parts to become wet. The interior tray slide assemblies and humidifier pans are removable for easy cleaning.

A stainless steel cleaner/polish is recommended for the exterior to maintain a “like-new” appearance.

DO NOT USE WAX OR STRONG CLEANERS ON DOOR GASKETS OR VINYL TRIM.



12" x 20" (305mm x 508mm) pan is removable and replaceable for easy cleaning.

Heat Tunnel

Heat Tunnel positions into tabs.



12" x 20" (305mm x 508mm) pan correctly positioned in HEAT BASIN.

ELECTRICAL REQUIREMENTS AND GROUNDING

For U.S. and Canada Models:

The amperage of your cabinet is stamped on the name plate serial tag attached to the unit. FWE models are equipped with a grounded cord plug for your protection against possible shock hazards. Be sure to plug only into a properly grounded wall receptacle. If you have any questions with regard to adequate wiring or grounding in your building, a qualified electrician should be contacted before using your cabinet.

For International Models:

May be shipped with no cord or plug
Contact qualified service personnel for cord and plug installation.

DO NOT, UNDER ANY CIRCUMSTANCES, CUT OR REMOVE THE GROUNDING PRONG FROM THE CORD PLUG.

WARNING: ONLY A QUALIFIED SERVICE PERSONNEL WILL REMOVE, REPAIR OR REPLACE ELECTRICAL COMPONENTS OR WIRING.

BE SURE THAT MODEL IS UNPLUGGED FROM ELECTRICAL SOURCE BEFORE REMOVING CONTROL PANEL, MOVING, CLEANING, OR SERVICING UNIT.

INTENDED USE AND REQUIREMENTS

This unit is to be used for proofing and warming only.

Unit must be installed level.

PHU-12-CIN PROOFER

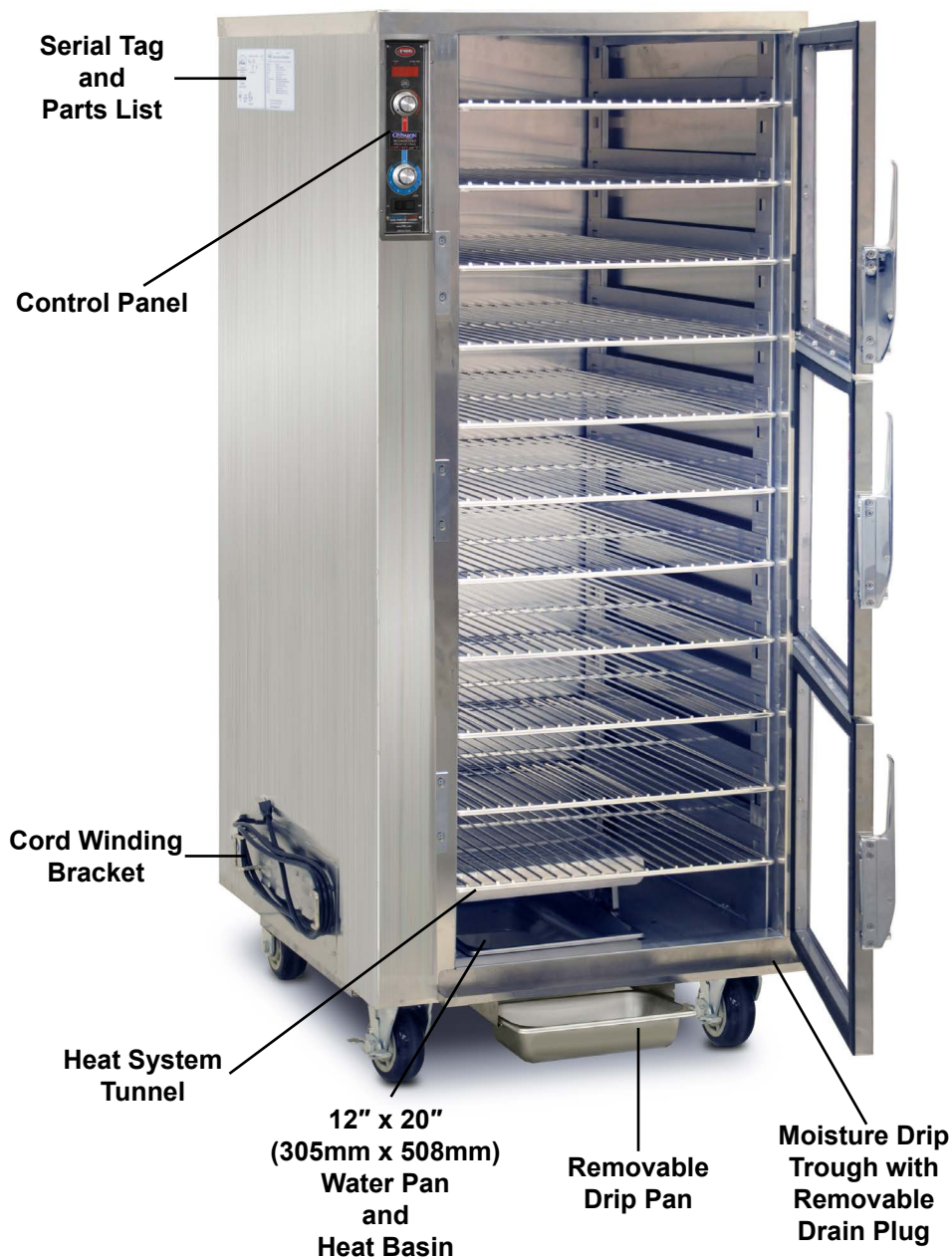

FWE PHU-12-CIN PROOFER

CONTROL PANEL

Heat Cycling Light →

Thermometer →

Low Temp Alarm →

Recommended Settings:

AIR TEMPERATURE SETTING:
110°F / 43°C

PROOF SETTING:5

° F to °C Temp Units

1. Turn "HEAT" knob to OFF and turn rocker switch OFF.
2. Turn rocker switch ON while pressing the "TEMP RECALL". Repeat to toggle from °F to °C

Main Power
Rocker Switch →

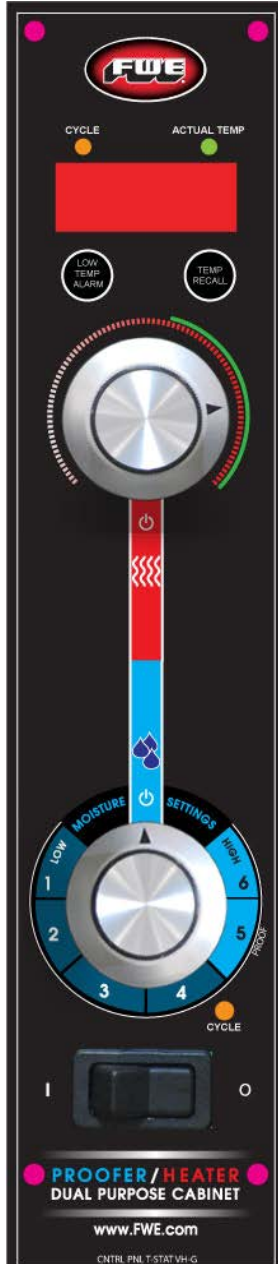

Press tactile key to alternate between ACTUAL temp (with ACTUAL LED illuminated) and SETPOINT temperature.

← Air Temperature "HEAT" Control Dial

← Air Moisture Control Dial

← Proof

← Proof Cycling Light

FWE PHU-12-CIN PROOFER

ENABLING ALARMS

LOW TEMP ALARM OPERATION

Unit has a built in “**Low Temp Alarm**”, allowing the operator to have an audible and a visual indicator that the heated cabinet temperature falls below the "Low Temperature" set point for more than **two (2) minutes**.

1) **Adjust Set Point:** Press and hold “**Low Temp Alarm**” for **six (6) seconds**. Rotate dial to desired set point between “**Ⓛ**” and from 90°F (32°C) and 190°F (88°C). Display will beep and show "LTA" for two (2) seconds release button to accept adjustment. When the internal cabinet temperature falls below the desired "Set Point" for more than **two (2) minutes**, the audible and visual alarm will alert you to this condition.

2) **Recall Set Point:** Press "**LOW TEMP ALARM**" key. Display shows LTA set point for three seconds then reverts to normal display.

3) **Acknowledge:** Press any key to cancel beeping. For Every **ten (10) seconds**, the display will show LTA for **one (1) second** until temperature increases above LTA set point.

Note: *The Low Temp alarm will auto-reset once Oven Setpoint is reached again. The idea is if the user has perhaps left the door open, the LTA alarm sounds to remind them to close it, with the user pressing either key to stop the beeping. Once the door is closed and the oven temperature rises again to oven setpoint, the control re-enables the LTA alarm in case the user fails to close the door again.*

4) **Disable:** Follow the adjustment steps above. A rotation of the dial "down" below 90°F (32°C) turns the alarm feature off.

FWE PHU-12-CIN PROOFER

INSTALLATION

CONGRATULATIONS...

...and thank you for purchasing an FWE PHU-12-CIN Proofer. Your unit has been designed and manufactured under rigid controls to assure you the most efficient service. It is a full time unit, and may be used continuously.

Please take a moment to read through this booklet of important information pertaining to your cabinet. By following a routine of proper use and care described on the following pages, your cabinet will last for many years.

IMPORTANT: Your Manufacturer Registration Card must be returned within 30 days after initial delivery to activate the warranty.

SERIAL AND MODEL NUMBER

These numbers are found on the nameplate (serial tag) affixed near the electrical cord portal. Please record them in this booklet, in the space provided on page 14. When calling in regards to service, you will need to provide this information. The voltage and amperage of the unit are also stamped on the serial tag.

UNPACKING

After uncrating your cabinet, remove all tape and padding which held all doors, shelves, racks, cord, etc., in place during shipment.

GENERAL OPERATING INSTRUCTIONS

PREPARING THE CABINET BEFORE LOADING FOOD

1) PLUG CABINET INTO A PROPERLY GROUNDED POWER RECEPTACLE. Press the “ I / O ” rocker switch to the “ I ” position.

2) ADD HOT WATER TO THE 12" x 20" (305MM X 508MM) PAN. The 12" x 20" (305mm x 508mm) water pan is positioned in the heat basin. Do not allow any water into the heat basin.

Add hot water into the 12" x 20" (305mm x 508mm) pan prior to heating the cabinet. This will allow the heating system to condition cabinet and add humidity.

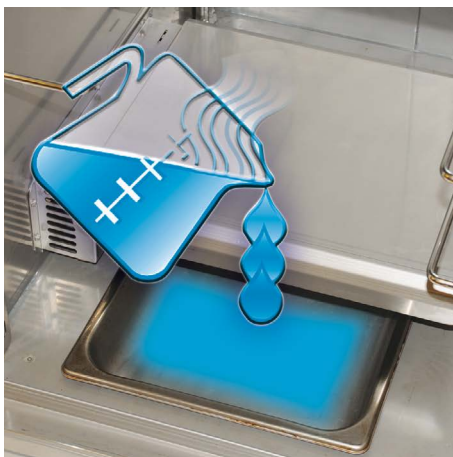

It is not necessary to remove the pan to add water. Amount of water required depends on start-up time, length of proofing and level of humidity desired. **DO NOT FILL ABOVE** 

3) PRE-HEAT THE CABINET. Turn on the rocker switch to the “ I ” position. Allow approximately 20-30 minutes of pre-heat time. The door should be kept tightly closed during this procedure to obtain the optimum environment.

For proofing, set the air temperature to 110°F (43°C).

4) SET AIR MOISTURE CONTROL to desired setting. The “MOISTURE CYCLE” indicator light will illuminate when the element or cycle is “ I ”.

NOTE: As with all proofing cabinets, your results may vary, depending on room temperature and conditions, pre-heat time, temperature of product going into the cabinet, etc.

5) LOAD THE CABINET with your product as quickly as possible. To maintain the best conditions, the door should be tightly closed when not loading the cabinet, and remain closed until serving.
AVOID PUTTING YOUR HOT FOODS INTO A COLD CABINET!

FWE PHU-12-CIN PROOFER

EASY TO OPERATE

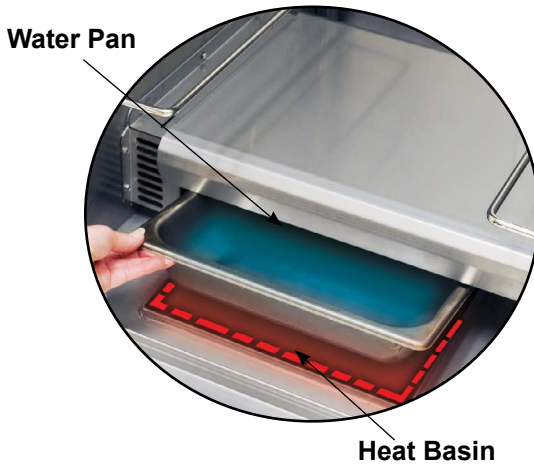

The **I/O** rocker switch activates power to the Control.

PHU-12-CIN is equipped with two (2) heating elements and two (2) separate controls which regulate these elements. This allows you to adjust the temperature and humidity separately.

The air moisture knob adjusts the amount of humidity in the cabinet from 1-6.

A CYCLING light indicates that this function is activated. The air temperature control goes from 90°F to 130°F (30°C to 54°C), and adjusts the amount of heat in the cabinet.

Use approximate setting: 110°F or 43°C.

An operational range thermometer shows the actual internal temperature of the cabinet.

Add HOT water to 12" x 20" (305mm x 508mm) pan with heat tunnel in position. Water Pan is positioned into heat basin.

FWE PHU-12-CIN PROOFER

HEAT SYSTEM AND CABINET COMPONENTS

ADDING WATER TO 12" x 20" (305MM x 508MM) PAN

Add hot water to 12" x 20" (305mm x 508mm) pan with heat tunnel in position. Water pan is positioned into heat basin. Use caution when filling if heat tunnel is hot.

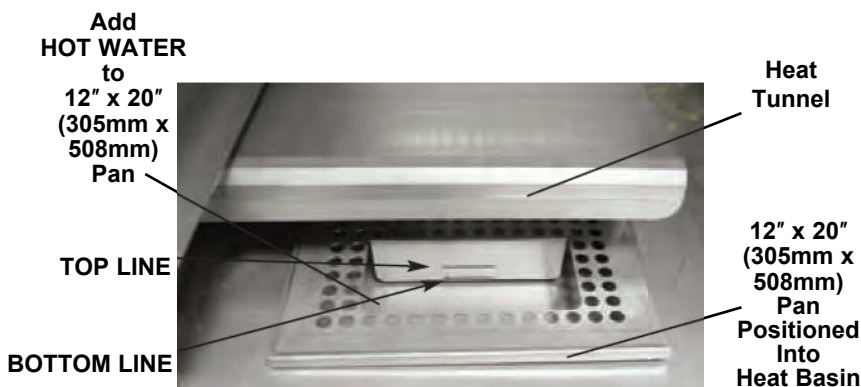

Amount of water required in the pan is determine by start-up time, length of holding time, and the level of humidity desired.

NO WATER IN HEAT BASIN

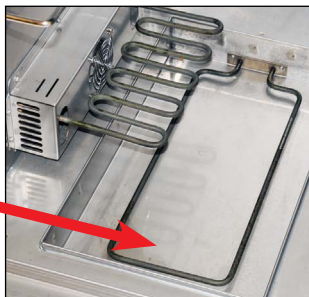

HEAT BASIN shown WITHOUT 12" x 20" (305mm x508mm) pan.

KEEP HEAT BASIN DRY

WATER PAN POSITIONS INTO **HEAT BASIN.** ADD WATER INTO 12" x 20" (305mm x508mm) PAN ONLY.

WARNING: THE WATER PAN, AIR TUNNEL AND HEATING ELEMENT(S) ARE HOT WHEN IN USE AND COULD CAUSE INJURY.

FWE PHU-12-CIN PROOFER ***DRAIN DRIP TROUGH***

DRIP TROUGH: DRAIN AS REQUIRED

A DRIP TROUGH has been provided to collect excess cabinet moisture or run-off. It is located below the door. Drain as often as required.



CAUTION:

Drain responsibly to keep area and floor dry and safe.

FWE PHU-12-CIN PROOFER

LIMITED TWO YEAR WARRANTY

FWE / Food Warming Equipment Company, Inc. (Seller) warrants to the original purchaser, subject to the exceptions and conditions below, that FWE manufactured equipment shall be free from defects in material or factory workmanship, under ordinary use for the purpose for which it is designed. The effective warranty period is as follows:

PARTS: Seller will furnish without charge to the original purchaser, FOB Sellers' factory, replacement parts for repairs to all new standard catalog products and factory custom / modified units, which in Seller's sole judgment, prove defective in materials or workmanship under normal and proper use with the reserved right to request the return of any part claimed to be defective, prior to issuing replacement part or authorizing warranty service, for a period of two (2) years from date of original shipment from Seller's plant, except for equipment used in a **Correctional Environment / Facilities**, which is warranted for a period of one (1) year from date of original shipment from Seller's plant.

LABOR: Seller's labor warranty shall be performed by a Seller-approved Service Agency who must contact Seller to obtain a Warranty Service Authorization (WSA) number prior to performing any repairs. If service is required during overtime periods, the difference between overtime and standard labor rates shall be paid by the purchaser. Seller does not assume any responsibility for any charges not expressly authorized, incidental to the repair or replacement of equipment covered by this warranty, nor charges exceeding, in Seller's sole judgment, normal and customary amounts. Only approved travel charges will be allowed. Seller's labor warranty shall be from the date of original shipment date from Seller's plant for a period of one (1) year, except for equipment used in a **Correctional Environment / Facilities** which is warranted for a period of six (6) months.

This warranty is for normal usage and does not apply to any product or parts thereof that have been misused, altered, or where Seller's operating instructions or specific voltage is not observed; nor shall this warranty apply to defective products or parts resulting from accident following date of original shipment, nor extend to or cover removal, installation, re-installation or calibration, or service calls or cost of repairs undertaken by a customer. This warranty is also subject to the following:

- 1.] Customer returning the warranty registration card, accompanying Sellers original shipment, to Seller within thirty (30) days of receipt;
- 2.] Giving immediate notice of any allegedly defective part or product to Seller; and
- 3.] Customer, at Sellers request, returning said defective parts or product to Seller.

This is the sole warranty applicable to the merchandise. It is expressly understood that Seller's liability hereunder is limited to the repair or replacement, at Seller's option, of products or parts, defective materials or workmanship as provided above. Seller's judgment as to the cause and nature of any defect will be final. Seller shall in no case be responsible for special or consequential damages or any other obligation or liability with respect to products sold by Seller.

This warranty, as stated above, applies to equipment installed in the Continental United States. FWE equipment installed outside the Continental United States shall carry parts coverage only. All labor costs are approved on a discretionary basis, based on like repairs in the Continental U.S. This warranty shall stand in whole or in part as allowed by law. Any exclusion of a part of this warranty, as may be allowed by law, shall not void balance of warranty.





FWE Parts Department:
www.FWEparts.com
Order Hotline: 800-222-4393



FOOD WARMING EQUIPMENT COMPANY, INC.

COOK | HOLD | TRANSPORT | SERVE | REFRIGERATION | BARS

5599 HWY. 31 W. Portland, TN 37148
800.222.4393 | 815.459.7500 | Fax: 815.459.7989
www.FWE.com | sales@fwe.com

