



RESTAURANT LINE

asber 

PARTS BREAKDOWN / DESPIECE



MODELS / MODELOS

AER-4-24

AER-6-36

AER-2-B10-60

SPECIFICATIONS ARE SUBJECT TO CHANGE WITHOUT PRIOR NOTICE.

"Una vez descargado este documento cambia a estatus de "NO CONTROLADO" y es responsabilidad de quien lo use.
Antes de fincar el pedido, consultar la vigencia con el fabricante"

GAS SYSTEM AND OUTER HARDWARE / SISTEMA DE GAS Y HERRAJES EXTERIORES

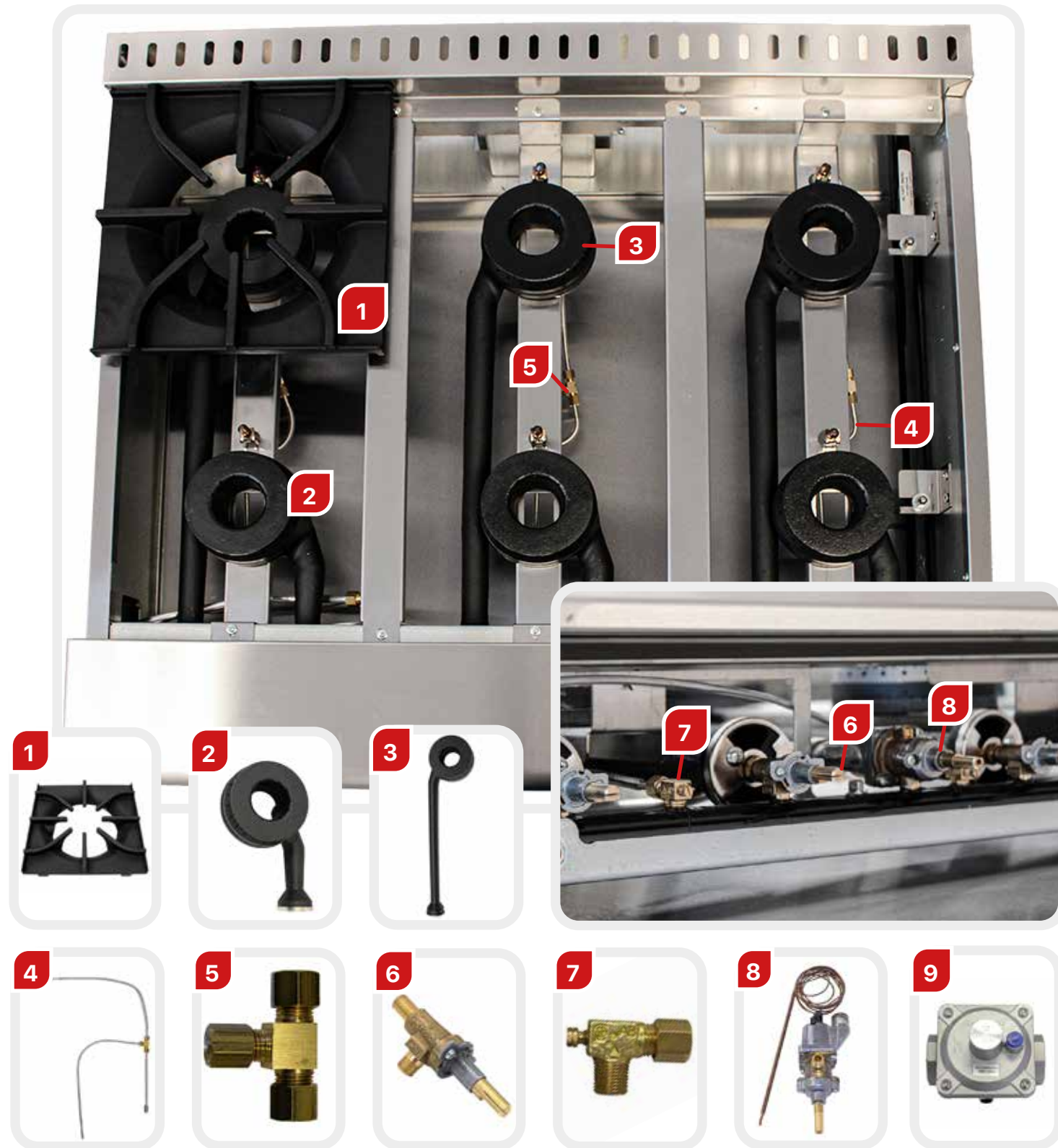

ITEM	REFERENCE / REFERENCIA	DATE DISPOSITION / FECHA DISPOSICIÓN		DENOMINATION / DENOMINACIÓN	EXPORTACIÓN						NACIONAL						SUGGESTED SPARE PART / PIEZA DE REPUESTO SUGERIDO
		CANCELLED / CANCELADO	DISPOSITION / DISPOSICIÓN		NG			LP			NG			LP			
					AER 4 24	AER 6 36	AER 2 B10 60	AER 4 24	AER 6 36	AER 2 B10 60	AER 4 24	AER 6 36	AER 2 B10 60	AER 4 24	AER 6 36	AER 2 B10 60	
1	12189651			IRON GRATE / PARRILLA FUNDICIÓN	4	6	10	4	6	10	4	6	10	4	6	10	*
2	12189652			FRONT BURNER / QUEMADOR FRONTAL	2	3	5	2	3	5	2	3	5	2	3	5	*
3	12188064			REAR BURNER / QUEMADOR POSTERIOR	2	3	5	2	3	5	2	3	5	2	3	5	*
4	12197681			PIPELINE "T" SS. / TUBERIA "T" ALUM INOX	2	3	5	2	3	5							
	12197682			PIPELINE "T" / TUBERIA "T" ALUM							2	3	5	2	3	5	
5	12189718			"T" COMPRESION 3/16" / "T" COMPRESIÓN 3/16"	2	3	5	2	3	5	2	3	5	2	3	5	*
6	12259236			BLOCK VALVE FAUCET / VALVULA BLOCK-GRIFO	4	6	10	4	6	10	4	6	10	4	6	10	*
7	12135113			AP PILOT REGULATOR / REGULADOR PILOTO AP	3	4	3	3	4	3	3	4	3	3	4	3	*
	12189773			DOUBLE PILOT VALVE / VALVULA DOBLE PILOTO			2			2			2			2	*
8	12270713	13/09/23		THERMOSTAT / TERMOSTATO	1	1	2	1	1	2	1	1	2	1	1	2	*
	12334333		13/09/23	THERMOSTAT / TERMOSTATO	1	1	2	1	1	2	1	1	2	1	1	2	*
9	12189711			GAS REGULATOR / REGULADOR DE GAS	1	1	1	1	1	1							

SPECIFICATIONS ARE SUBJECT TO CHANGE WITHOUT PRIOR NOTICE. | ESPECIFICACIONES SUJETAS A CAMBIOS SIN PREVIO AVISO.

OVEN GAS SYSTEM / SISTEMA DE GAS DE HORNO

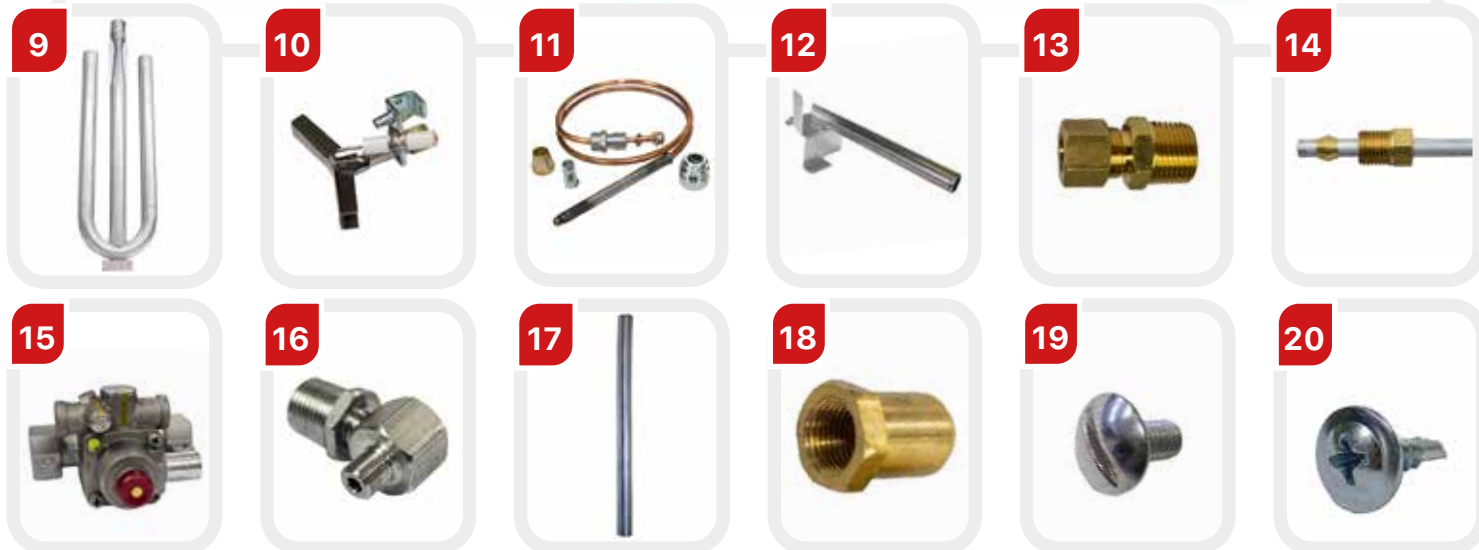
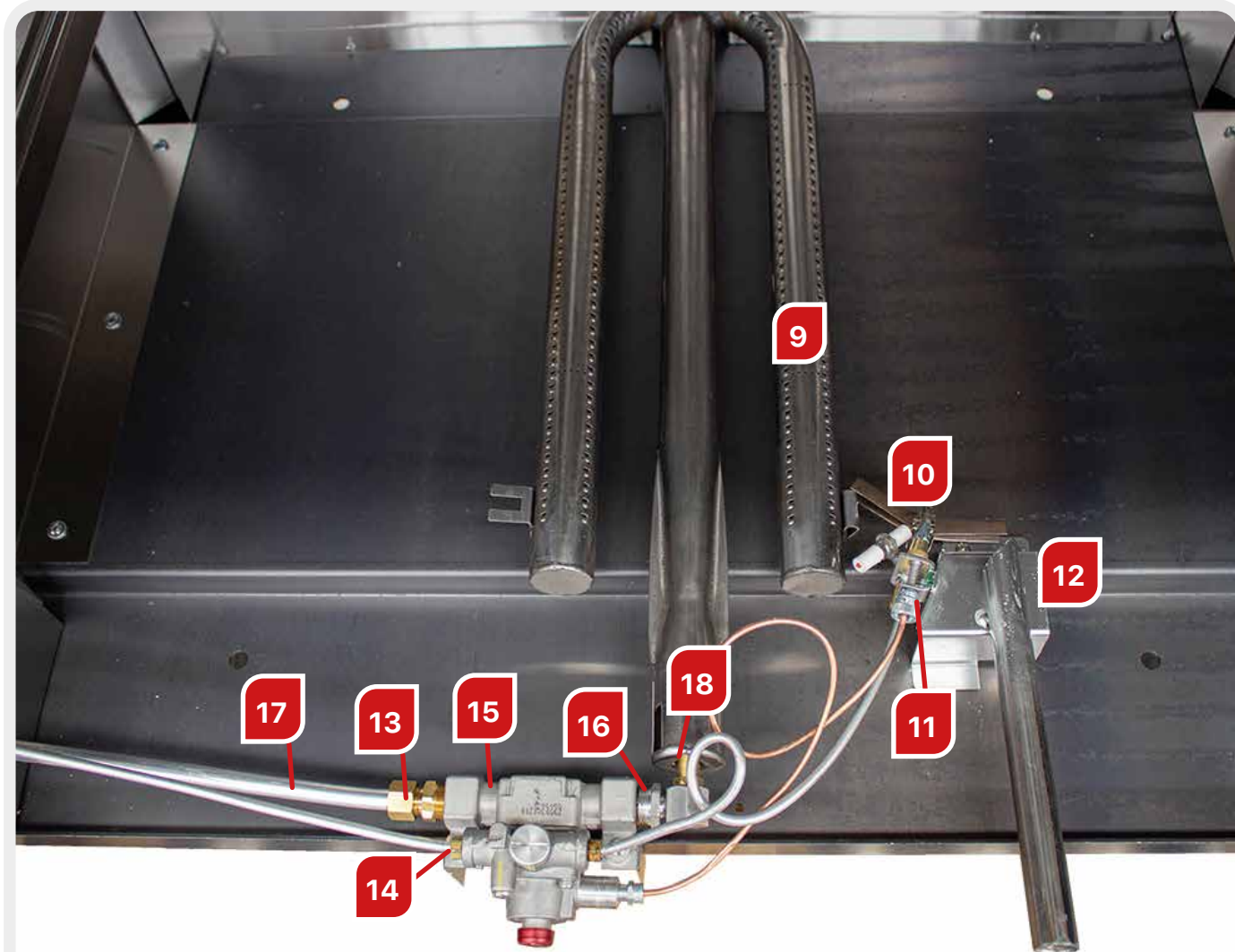

ITEM	REFERENCE / REFERENCIA	DATE DISPOSITION / FECHA DISPOSICIÓN		DENOMINATION / DENOMINACIÓN	EXPORTACIÓN						NACIONAL						SUGGESTED SPARE PART / PIEZA DE REPUESTO SUGERIDO			
		CANCELLED / CANCELADO	DISPOSITION / DISPOSICIÓN		NG		LP		NG		LP									
					AER 4 24	AER 6 36	AER 2 B10 60	AER 4 24	AER 6 36	AER 2 B10 60	AER 4 24	AER 6 36	AER 2 B10 60	AER 4 24	AER 6 36	AER 2 B10 60				
9	12189729			BURNER U / QUEMADOR U	1	1	2	1	1	2	1	1	2	1	1	2	1	1	2	*
10	12260456			PILOT NG / PILOTO NG															*	
	12260455			PILOT LP / PILOTO LP															*	
11	12188074			THERMOCOUPLE / TERMOPAR	1	1	2	1	1	2	1	1	2	1	1	2	1	1	2	*
12	12211560			PILOT OVEN SUPPORT / SOPORTE PILOTO HORNO	1	1	2	1	1	2	1	1	2	1	1	2	1	1	2	*
	12192090			MANUAL IGNITION TUBE / TUBO ENCENDIDO MANUAL	1	1	2	1	1	2	1	1	2	1	1	2	1	1	2	*
13	12189662			STRAIGHT CONNECTOR CC / CONEC. RECTO CC	2	2	4	2	2	4	2	2	4	2	2	4	2	2	4	*
14	12189723	25/04/23		PILOT CONNECTION 3/8" 24 / CONEXION PILOTO 3/8" 24	1	1	2	1	1	2	1	1	2	1	1	2	1	1	2	
	12331334		25/04/23	CONNECTION 3/16" X 1/8" / CONEC MACH COMP 3/16" X 1/8"	2	2	4	2	2	4	2	2	4	2	2	4	2	2	4	
15	12130230			OVEN VALVE / VALVULA HORNO	1	1	2	1	1	2	1	1	2	1	1	2	1	1	2	*
16	12189726			ELBOW OVEN BURNER ALUMINIUM / CODO QUEMADOR HORNO ALUM.	1	1	2	1	1	2	1	1	2	1	1	2	1	1	2	*
17	12192116			ALUMINIUM TUBE / TUBO ALUM.	1	1	2	1	1	2	1	1	2	1	1	2	1	1	2	
18	12189738			ORIFICE 40 / ESPREA 40															*	
	12189737			ORIFICE 52 / ESPREA 52															*	
19	12191586			TRUSS HEAD SS SCREW M6 / TORNILLO INOX CAB TRUSS M6																
20	12191506			TAPPING SCREW SELF DRILLING / PIJA P/BROCA K LAT																

SPECIFICATIONS ARE SUBJECT TO CHANGE WHITOUT PRIOR NOTICE. | ESPECIFICACIONES SUJETAS A CAMBIOS SIN PREVIO AVISO.

OUTER HARDWARE / HERRAJES EXTERIORES

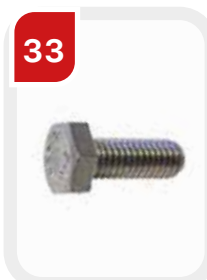
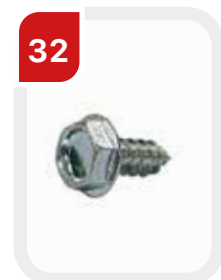
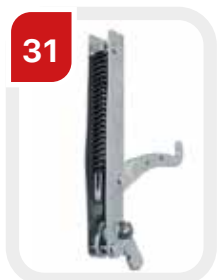
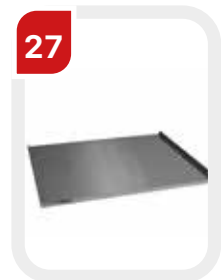
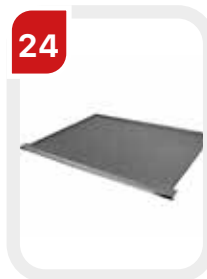
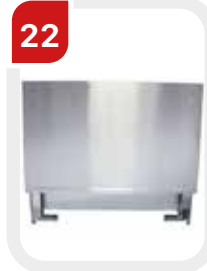
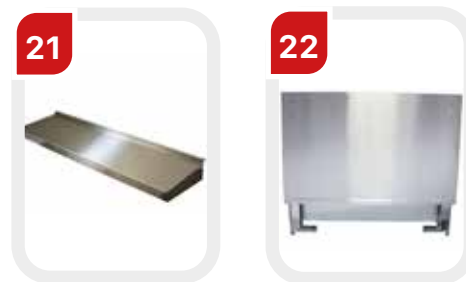

ITEM	REFERENCE / REFERENCIA	DATE DISPOSITION / FECHA DISPOSICIÓN		DENOMINATION / DENOMINACIÓN	EXP.			NAC.			SUGGESTED SPARE PART / PIEZA DE REPUESTO SUGERIDO
		CANCELLED / CANCELADO	DISPOSITION / DISPOSICIÓN		AER 4 24	AER 6 36	AER 2 B10 60	AER 4 24	AER 6 36	AER 2 B10 60	
21	12196986			SHELF BACK SPLASH 24" / REPISA BACK SPLASH 24"	1						
	12196948			SHELF BACK SPLASH 36" / REPISA BACK SPLASH 36"		1					
	12196940			SHELF BACK SPLASH 60" / REPISA BACK SPLASH 60"			1				
22	12197653			BACK SPLASH 24" / SALPICADERO 24"	1						
	12197652			BACK SPLASH 36" / SALPICADERO 36"		1					
	12197629			BACK SPLASH 60" / SALPICADERO 60"			1				
23	12190983			ASBER KNOB / PERILLA ASBER	4	6	10	4	6	10	*
24	12196997			SPILL TRAY 24 / CHAROLA DE DERRAMES 24	1		1	1			
	12196998			SPILL TRAY 36 / CHAROLA DE DERRAMES 36		1	1		1	1	
25	12190735			OVEN GRILL GUIDE 24 / GUIA PARRILLA HORNO 24	2		2	2		2	*
	12190988			OVEN GRILL GUIDE 36 / GUIA PARRILLA HORNO 36		2	2		2	2	*
26	12190736	08/01/24		OVEN GRILL 24 / PARRILLA HORNO 24				1			
	12190737		08/01/24	OVEN GRILL 24 / PARRILLA HORNO 24	1		1	1		1	*
	12190734			OVEN GRILL 36 / PARRILLA HORNO 36		1	1		1	1	
27	12191472	08/01/24		OVEN FLOOR 24" / SOLERA HORNO 24"				1			
	12191452		08/01/24	OVEN FLOOR 24" / SOLERA HORNO 24"	1		1	1		1	
	12191473			OVEN FLOOR 36" / SOLERA HORNO 36"		1	1		1	1	
28	12190979			ADJUSTABLE LEG / PATA REGULABLE	4	4	6	4	4	6	*
29	12196979			OVEN BAFFLE 24 / DEFLECTOR HORNO 24	1		1	1		1	
	12196914			OVEN BAFFLE 36 / DEFLECTOR HORNO 36		1	1		1	1	
30	12190955			OVEN KNOB / PERILLA HORNO	1	1	2	1	1	2	*
31	12190976			DOOR MECHANISM / MECANISMO PUERTA	2	2	4	2	2	4	*
32	12191504			HEX HEAD TAPPING SCREW / PIJA HEX. AUTORROS							
33	12189583			SS SCREW M6X16 HEXAGONAL HEAD / TORN M6X16 INOX. CAB.HEXAG							

SPECIFICATIONS ARE SUBJECT TO CHANGE WITHOUT PRIOR NOTICE. | ESPECIFICACIONES SUJETAS A CAMBIOS SIN PREVIO AVISO.

CONVERSION KIT / KIT DE CONVERSIÓN

34



35



ITEM	REFERENCE / REFERENCIA	DATE DISPOSITION / FECHA DISPOSICIÓN		DENOMINATION / DENOMINACIÓN	NG			LP		SUGGESTED SPARE PART / PIEZA DE REPUESTO SUGERIDO	
		CANCELLED / CANCELADO	DISPOSITION / DISPOSICIÓN		AER 4 24	AER 6 36	AER 2 B10 60	AER 4 24	AER 6 36		AER 2 B10 60
34	12197520			CONVERSION KIT NG TO LP R-4-24 / KIT CONVERSIÓN NG A LP R-4-24				1		*	
	12197521			CONVERSION KIT NG TO LP R-6-36 / KIT CONVERSIÓN NG A LP R-6-36					1		
	12197547			CONVERSION KIT NG TO LP B10-60 / KIT CONVERSIÓN NG A LP B10-60					1		
	12197535			CONVERSION KIT NG AER-4-24 / KIT CONVERSIÓN NG AER-4-24	1						
	12210715			CONVERSION KIT LP TO NG R-6-36 / KIT CONVERSIÓN LP A NG R-6-36		1					
	12212863			CONVERSION KIT LP TO NG B10 60 / KIT CONVERSIÓN LP A NG B10 60			1				
35	12189744			PILOT ORIFICE 0.16 LP #10-210 / ESPREA DE PILOTO 0.16 LP #10-210				1	1	1	*

SPECIFICATIONS ARE SUBJECT TO CHANGE WITHOUT PRIOR NOTICE. | ESPECIFICACIONES SUJETAS A CAMBIOS SIN PREVIO AVISO.

asber

ONNERA MEXICO S.A. DE C.V.

Circuito Exportación N° 201
Parque Industrial Tres Naciones
San Luís Potosí, S.L.P., México
C.P. 78395
T. (+52) 444 137 0500
E-mail: marketing.mex@onneragroup.com
Web Site: es.asberamerica.com

ONNERA US

13105 NW 47th Avenue
Opa Locka FL 33054
T.: 305-477-1680
Toll free: 877-693-3372
E-mail: us.parts@onneragroup.com
Web Site: asberamerica.com