



Your Solutions Partner

Instruction Sheet

FLM200 Light Replacement



CAUTION: Please read these instructions completely before attempting to install, operate or service this equipment.

 **WARNING:** Cancer and Reproductive Harm - www.p65warnings.ca.gov

This manual is Copyright © 2020 Duke Manufacturing Co. All rights reserved. Reproduction without written permission is prohibited. Duke is a registered trademark of the Duke Manufacturing Co.

**P/N 529811
REV A 04/03/2020**

IMPORTANT SAFETY INSTRUCTIONS

Throughout this manual, you will find the following safety words and symbols that signify important safety issues with regards to operating or maintaining the equipment.



Indicates a hazardous situation which, if not avoided, could result in death or serious injury.



Indicates a hazardous situation which, if not avoided, could result in minor or moderate injury.



Indicates Important Information



Indicates electrical shock hazard which, if not avoided, could result in death or serious injury and/or equipment damage.



Indicates hot surface which, if not avoided, could result in minor or moderate injury.

In addition to the warnings and cautions in this manual, use the following guidelines for safe operation of the unit.

- Read all instructions before using equipment.
- For your safety, the equipment is furnished with a properly grounded cord connector. Do not attempt to remove or disconnect the grounded connector.
- This equipment should be serviced by qualified personnel only. Contact the nearest Duke authorized service facility for adjustment or repair.
- Turn the unit off, disconnect the power source before performing any service or maintenance on the unit.
- This appliance is not intended for use by persons (including children) with reduced physical, sensory or mental capabilities, or lack of experience and knowledge, unless they have been given supervision or instruction concerning use of the appliance by a person responsible for their safety.

REMOVAL OF EXISTING LIGHT/GASKET

⚠ WARNING

1 Disconnect unit from power source.

2 Remove the front decor panel from front of bread cabinet by:

A. Remove any screws from operators side holding front panel in place.

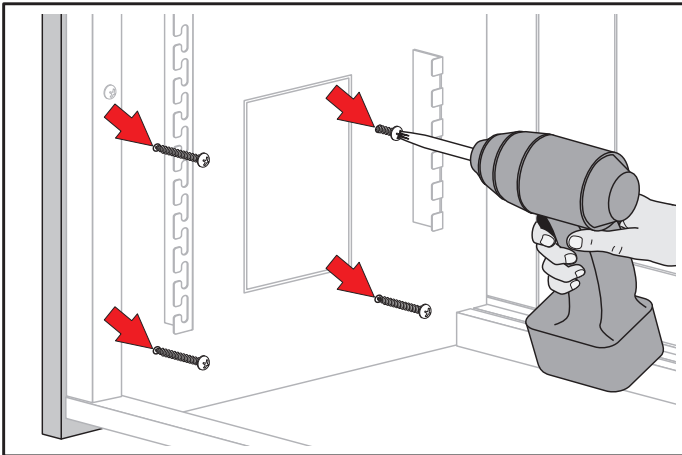

B. Remove the top cap by lifting up and out.

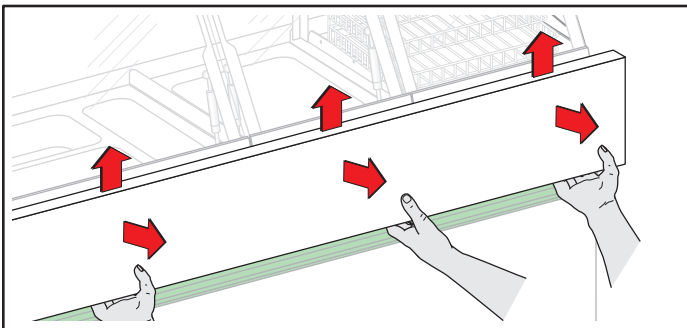

C. Remove the mending plate in the middle if present.

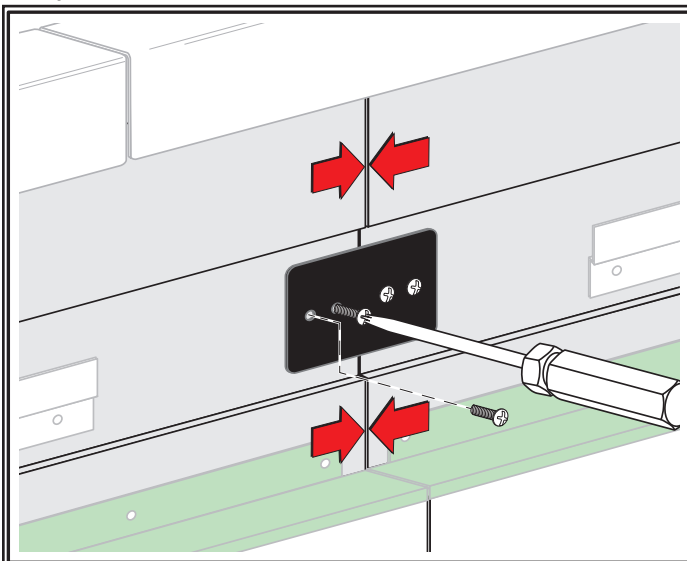

D. Lower the front panel by loosening the support bracket on the bottom.

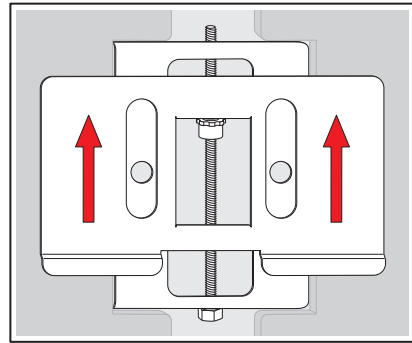

D. Lift front panel up and out to lower the decor panel.

CAUTION This may require 2 people to remove depending on length.

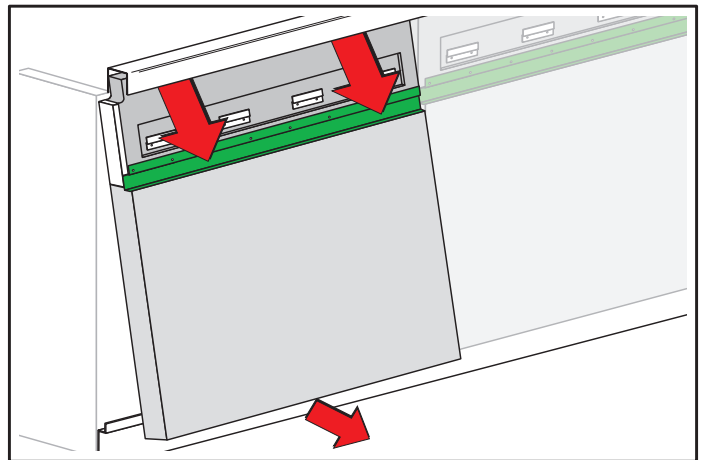

3 Disconnect lighting from power source in adjacent unit and pull the wires out of adjacent unit into bread cabinet.

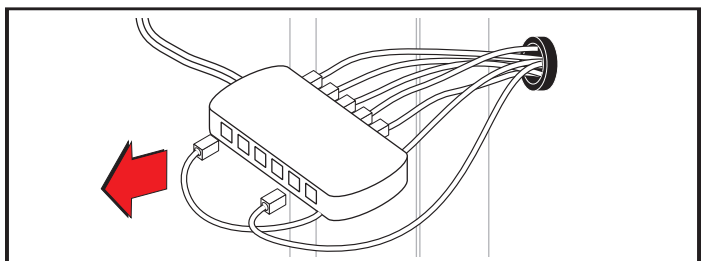

4 Remove all wire shelves, and side racks supports.

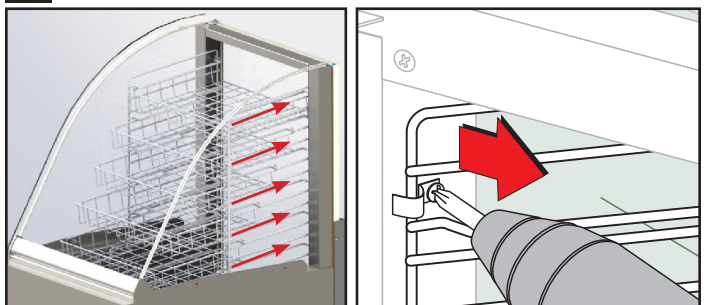

REMOVAL OF EXISTING LIGHT/GASKET - cont.

- 5** Remove the inner cap inside bread display next to the hot food unit.



Note: This will expose the bolts going through the glass.

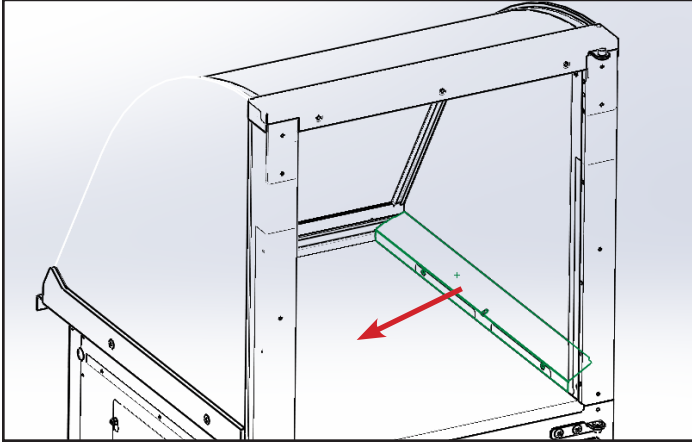

- 6** Using a Phillips screw driver and a 7/16" wrench or socket remove the bolts through the glass.

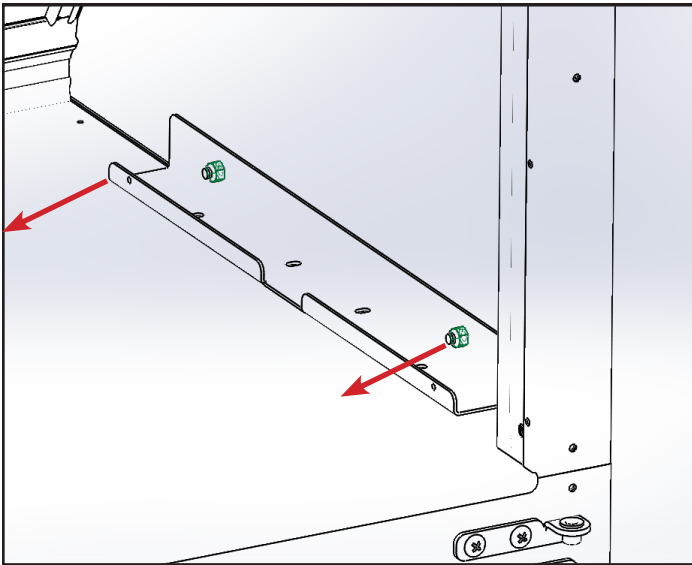

- 7** Carefully slide unit out.

- 8** Remove the top cap from the door side at top by removing the three screws.

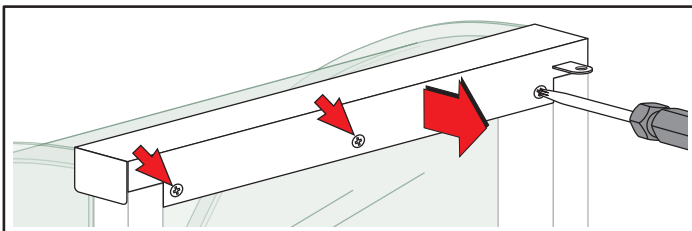

- 9** Determine which side needs the lights replaced.



Note: if opposite side of hot food well then repeat steps 5 and 6.

- 10** Remove the two screws on the bottom of the counter top that are fastening the front glass to the counter top.

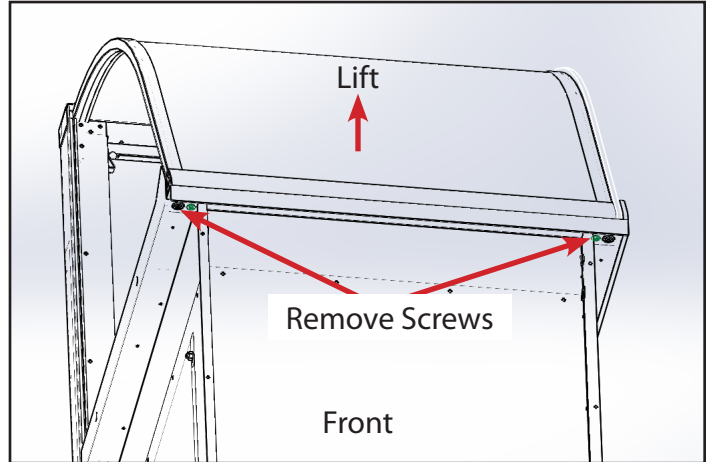

- 11** There will be a wire connected to the light that must be pulled completely out of the cabinet. Carefully lift the bottom of the front glass high enough to allow removal of the wire (approximately 2"-3") then set back down in place once wires are removed

CAUTION Glass is not completely secured.

- 12** Remove the side glass from the cabinet and remove the original gasket and light from the glass, which should still be attached with adhesive. A putty knife will work best for scraping the adhesive away from the glass. Be careful not to scratch or damage the glass.

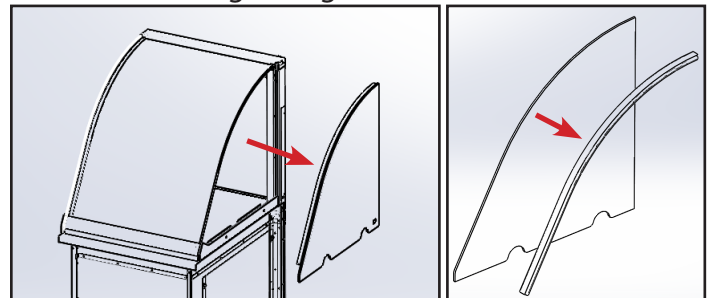

- 13** Once the gasket and adhesive are removed, thoroughly clean the glass with isopropyl alcohol or acetone until all adhesive residue is removed. Set the side glass aside in a safe area so it does not get damaged until later steps.

- 14** If needed, repeat steps 5, 6, 9, 10, 11, 12, and 13 for opposite site.

INSTALLATION OF NEW LIGHT/GASKET

- 1** To Determine which light assembly to use, for which side, the wire should be coming out of the end of the gasket closest to the counter top.

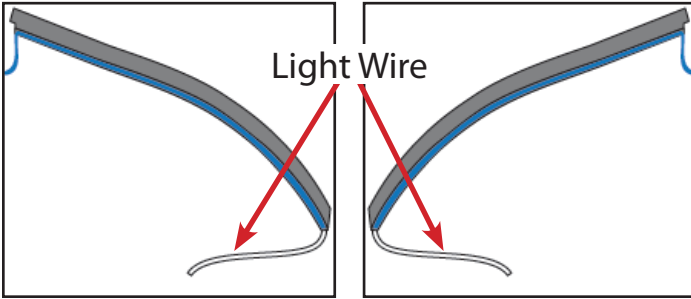

- 2** Once you have selected the correct light route the wire through the aluminum extrusion and then through the grommet in the counter top.

 **NOTE:** The front glass may need to be lifted slightly to allow for easier routing of the wire.

- 3** Begin pushing the gasket onto the edge of the front/curved glass, making sure the gasket is pushed all the way onto the glass.

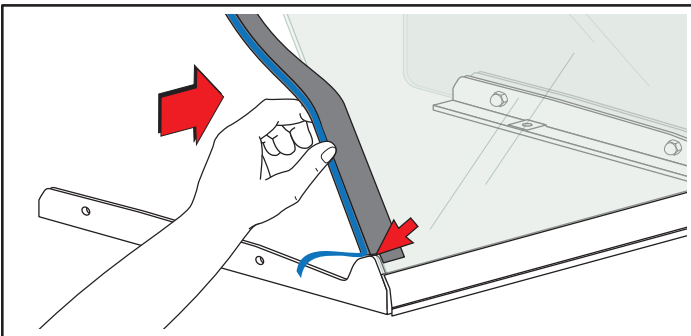

- 4** Use masking tape to tape the outer face of the gasket to the outer face of the curved/glass to keep it held in place.

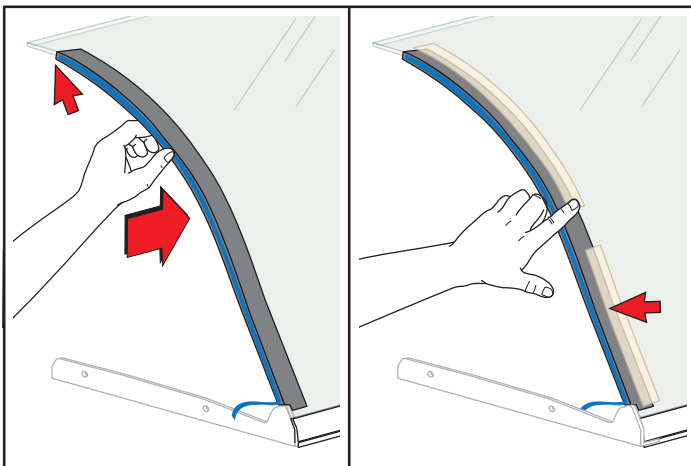

- 5** Remove the bottom 2" of backing paper from the adhesive at this time but do not remove anymore. Pull the loose backing paper to the outer face of the front curved/glass and use masking tape to tape it down out of the way.

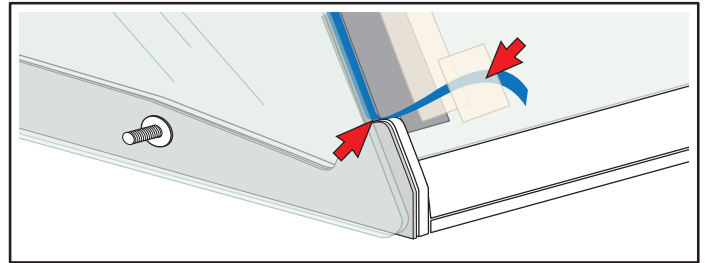

- 6** Slide the side glass into its original position making sure it is properly resting in the grooves of the cabinet frame and the notches in the glass line up with the holes on the cabinet flange and loosely install screw and acorn nut. **DO NOT** tighten screws at this time.

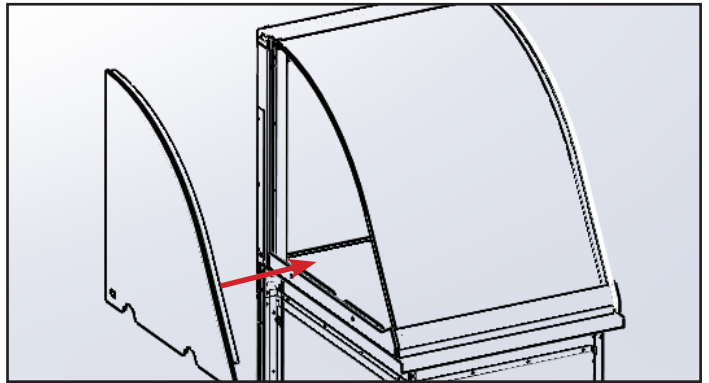

-  **Note:** if installing glass onto the side that attaches to the adjacent hot food unit, **DO NOT** install screws until later when the cabinet is slid back into the lineup.

- 7** Peel the remainder of the backing paper from the adhesive and press the side glass onto the adhesive. Apply significant pressure along entire gasket profile to make sure that it is properly adhered to the gasket.

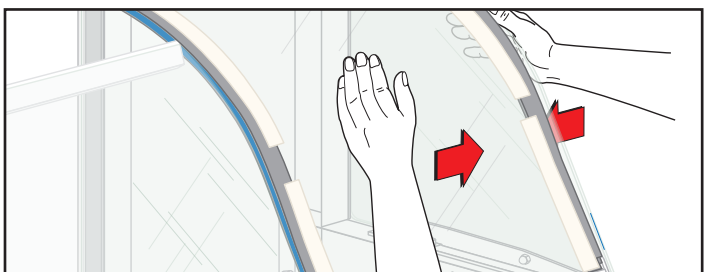

INSTALLATION OF NEW LIGHT/GASKET - cont.

8 Repeat steps 1-7 for opposite side if needed.

9 Reinstall the two bolts under the front of the counter that were removed in step 10 of Removal of existing light/gasket.

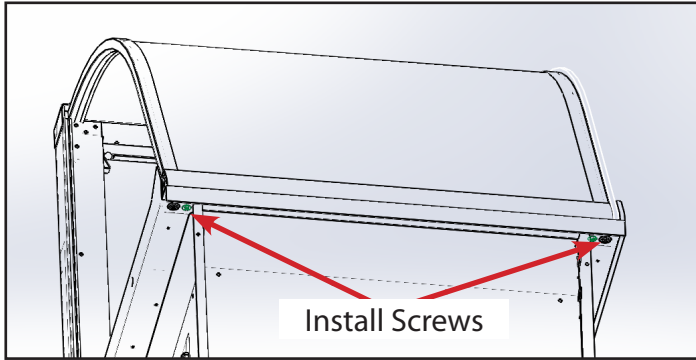

10 Carefully slide unit back in place and align with front line up.

11 Using the Bolt and cap nuts removed in previous steps re-secure and tighten the glass in place using a Phillips screwdriver and 7/16 wrench or socket.

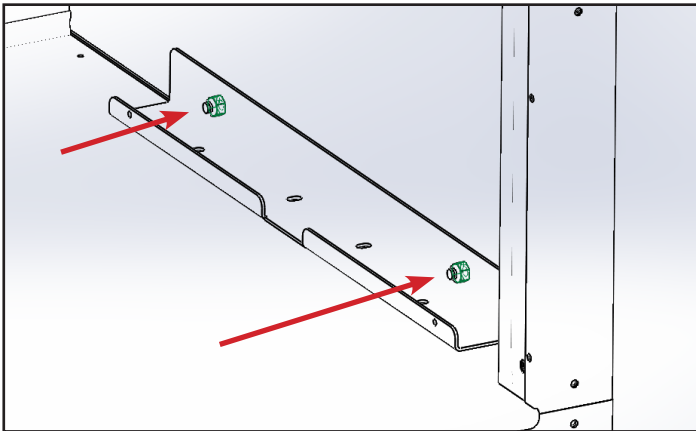

12 Re-install the cover plates on both sides if removed.

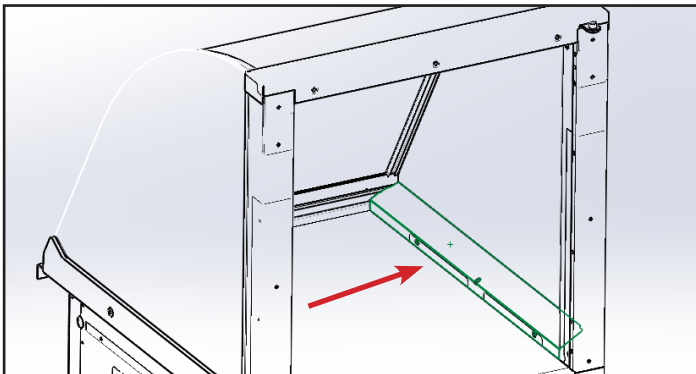

13 Re-install the top cap cover.

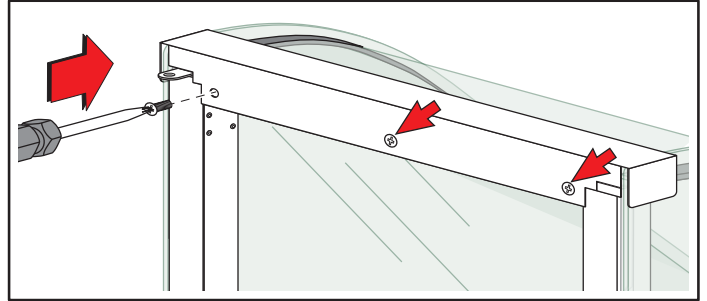

14 Re-connect lights to power supply.

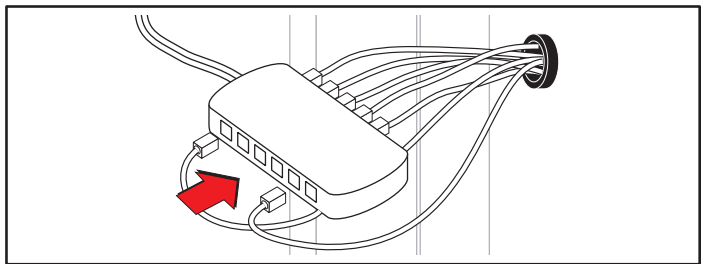

15 Re-install side support racks.

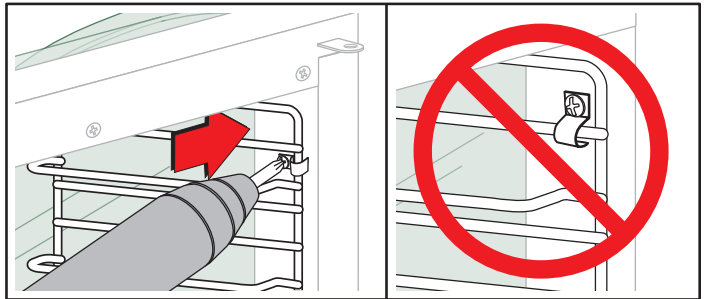

16 Re-install racks.

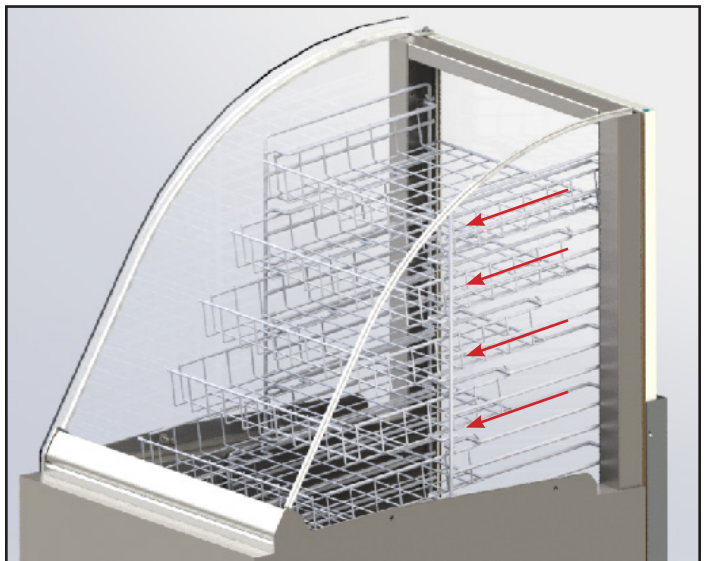

INSTALLATION OF NEW LIGHT/GASKET - cont.

⚠ CAUTION Damage/Injury could result if two persons are not used for this Installation.

17 Ensure all brackets on back of panel are adjusted as shown on the right. It is adjusted correctly when you can see the open center (where the bolt is) with the lower flange up above (see Red arrows).

NOTE: (3/8" From bottom of bracket to offset)

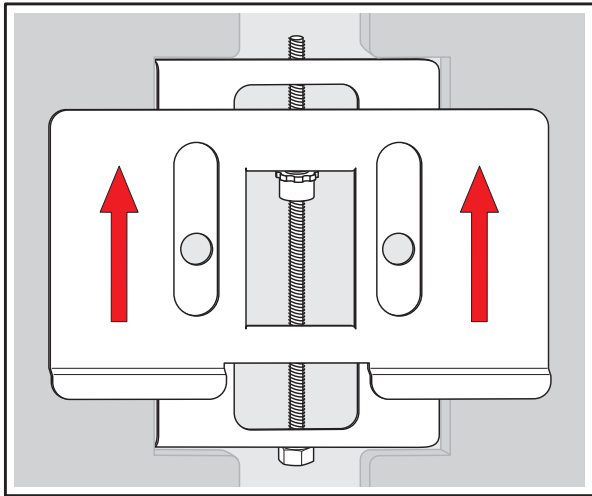

NOTE: The adjustment bracket allows the decor panel to sit on the kick plate angle when installing the front panel and during adjustment.

18 Slide the panel up into the channel at the top of the unit. Using the brackets hang the panel on the metal lip at the bottom of the unit.

⚠ CAUTION Pull on bottom of panel to ensure engagement with bracket.

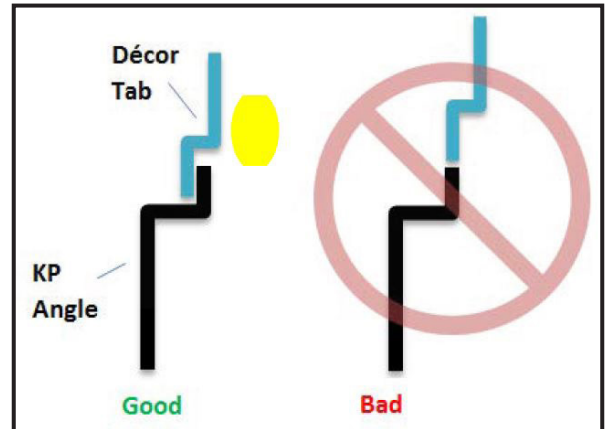
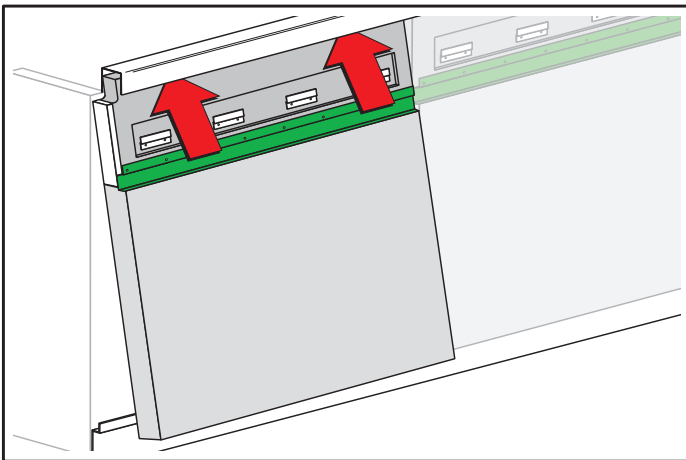

19 Using a Socket and ratchet adjust the panel to be flush against the top.

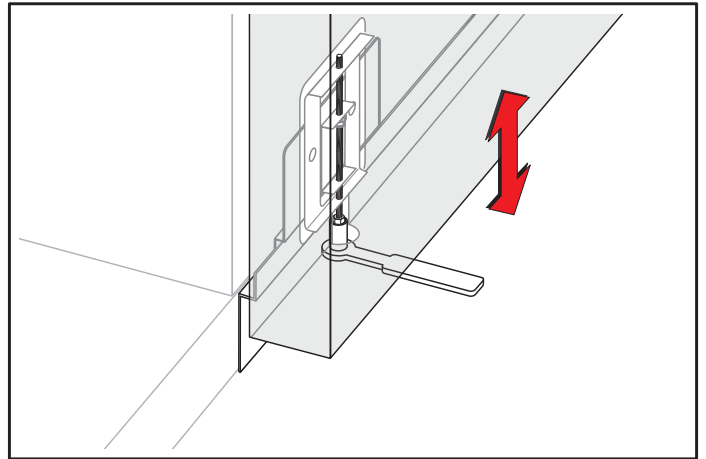

20 Install the mending plate in the middle if needed.

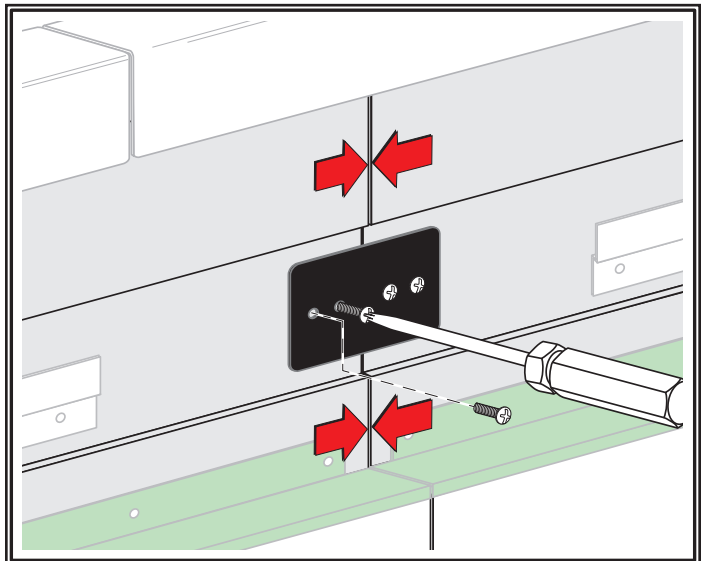

INSTALLATION OF NEW LIGHT/GASKET - cont.

- 21** Re-secure front panels from under counter on operators side.

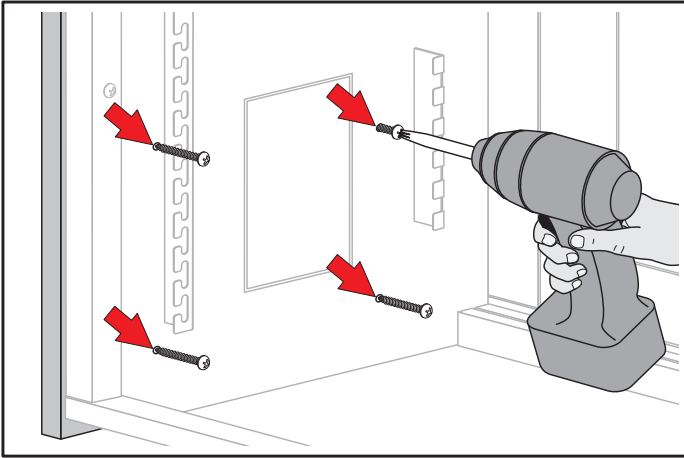

- 22** Re-Install the top cap by pushing in and down.

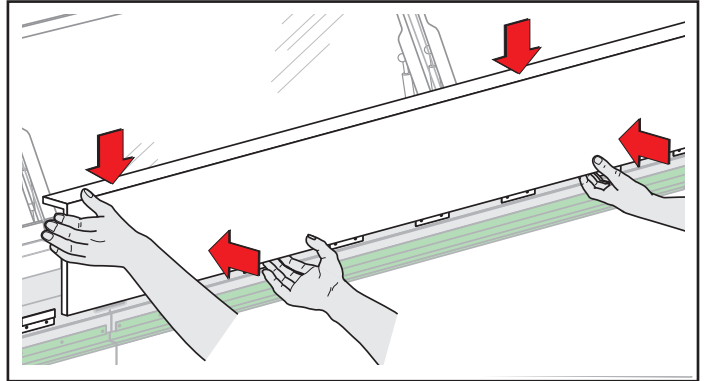

⚠ WARNING

- 23** Reconnect unit to power source.

- 24** Turn on unit and verify operation



Your Solutions Partner

Duke Manufacturing Co.
2305 N. Broadway
St. Louis, MO 63102

Phone: 314-231-1130
Toll Free: 1-800-735-3853
Fax: 314-231-5074

www.dukemfg.com