



Your Solutions Partner

Installation Instructions

FLM100 Sealing Kit 2503372



For a Video of these instructions
scan the above QR code or go to
<https://dukemfg.com/subway>

CAUTION: Please read this manual completely before attempting
to install, operate or service this equipment

*This manual is Copyright © 2019 Duke Manufacturing Co. All rights reserved.
Reproduction without written permission is prohibited. Duke is a registered
trademark of the Duke Manufacturing Co.*

P/N 529119
REV C 04/04/2019



TABLE OF CONTENTS

Important Safety Instructions..... 2

I. Un-packing..... 4

II. Parts Included 4

III. Tools Needed..... 5

IV. Initial Disassembly..... 6

V. Day Cover removal 7

VI. Replacement of Glass Gaskets..... 8

VII. Unit Preparation 11

VIII. Gasket Installation 12

IX. Installing Day Cover Assembly..... 13

X. Removing LED Lights and Wiring..... 15

XI. Sealing Interior Joints..... 16

XII. Install Wire Racks 18

XIII. Install door Gasket..... 19

IVX. Install Door.....20

IMPORTANT SAFETY INSTRUCTIONS

Throughout this manual, you will find the following safety words and symbols that signify important safety issues with regards to operating or maintaining the equipment.



Indicates a hazardous situation which, if not avoided, could result in death or serious injury.



Indicates a hazardous situation which, if not avoided, could result in minor or moderate injury.



Indicates Important Information



Indicates electrical shock hazard which, if not avoided, could result in death or serious injury and/or equipment damage.



Indicates hot surface which, if not avoided, could result in minor or moderate injury.

In addition to the warnings and cautions in this manual, use the following guidelines for safe operation of the unit.

- Read all instructions before using equipment.
- For your safety, the equipment is furnished with a properly grounded cord connector. Do not attempt to remove or disconnect the grounded connector.
- Install or locate the equipment only for its intended use as described in this manual.
- Do not use corrosive chemicals on this equipment.
- Do not operate this equipment if it has a damaged cord or plug, if it is not working properly, or if it has been damaged or dropped.
- This equipment should be serviced by qualified personnel only. Contact the nearest Duke authorized service facility for adjustment or repair.
- Do not block or cover any openings on the unit.
- Do not immerse cord or plug in water.
- Keep cord away from heated surfaces.
- Do not allow cord to hang over edge of table or counter.

The following warnings and cautions appear throughout this manual and should be carefully observed.

- Turn the unit off, disconnect the power source and allow unit to cool down before performing any service or maintenance on the unit.
- The procedures in this manual may include the use of chemical products. You must read the Material Safety Data Sheets before using any of these products.
- The unit should be grounded according to local electrical codes to prevent the possibility of electrical shock. It requires a grounded receptacle with dedicated electrical lines, protected by fuses or circuit breaker of the proper rating, in accordance with all applicable regulations.
- Disposal of the unit must be in accordance with local environmental codes and/or any other applicable codes.
- This appliance is not intended for use by persons (including children) with reduced physical, sensory or mental capabilities, or lack of experience and knowledge, unless they have been given supervision or instruction concerning use of the appliance by a person responsible for their safety.

INTRODUCTION

These instructions were written for one of the more difficult versions of a bread display installation. One person can complete this kit installation; however work could be split between two people to reduce the time required to complete the install. There are several methods that the display unit could have been installed depending on front counter line-up, store layout, version of bread display, and how thoroughly the installation instructions were followed. Please read and understand the process before starting this retro fit installation. Depending on the unit installation, you may find you can skip steps, or you may be required to modify the process to decrease the time and effort required to complete the installation. **Note:** All the pictures in this manual are for a unit with the hinge on the right from the operators side of the unit.

I. UN-PACKING

STEP 1

Unpack and read the instructions fully before starting.

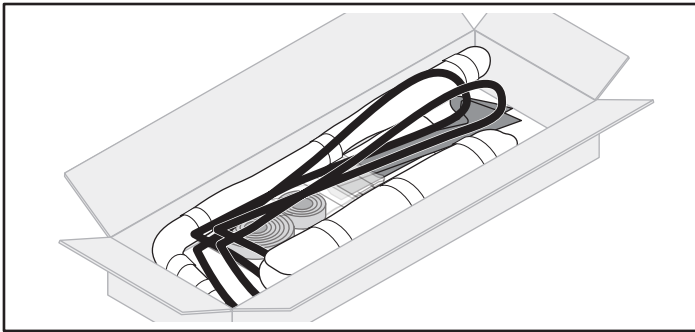

STEP 2

Inventory Kit and compare to the instructions. Extra parts are included in the parts bag and not all parts will be used in all installations.

STEP 3

Collect all tools required by the instructions for installation. Optional tools may help in some installations.

II. PARTS INCLUDED



2503283
2ea. - Side Panels w/ gasket (Lg)



250546
2ea. - Side Panels w/ gasket (Sm)

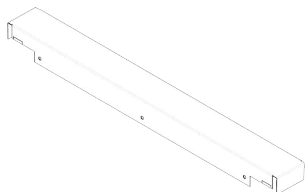

2502873 1ea. - Top Cover

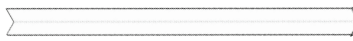

2503479 2ea. - Glass Guide Angles

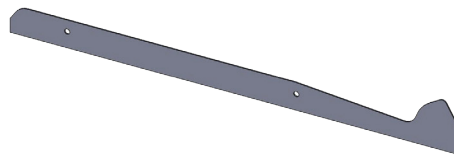

225035 3ea. Gasket, End Glass

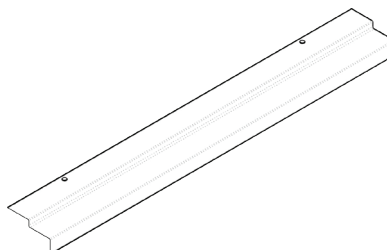

RS049710 Wire Chase Cover

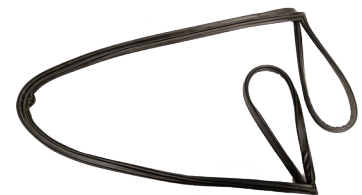

224707 1ea. - Magnetic Door Gasket



2503285 2ea. - Support Clips



2ea. - Extrusions w/adhesive

II. PARTS INCLUDED

				
22 - 10-24x3/8 TPF-M Screws	2 - 1/4-20x3/4 Machine Screw	8 - 1/2" Hole Plugs	2 - 1/2" Grommets	
				
3 - 8-32x1/2" F PF-M Screws	2 - Acorn Nuts	2 - White glass spacers	Parts Bag #2: 6' - 1" x 1/8" foam seal tape 2' - 1" x 1/8" foam seal tape 2 - 1" x 1" x 1/8" foam seal tape	
				
2 - 8-32x1/2 TPF-M Screws	2 - Double ended glass screws	2 - Black glass washers	1 - Tube Gray Silicone w/ tip	

III. TOOLS REQUIRED - NOT INCLUDED

				
Cordless Drill	Phillips bit	7/16" Socket	Flat Jaw Pliers	Scissors
				
Wire Snake Puller	5/16" Nut Driver Bit	Phillips screwdriver	7/16" wrench	Needle Nose Pliers
				
Paper Towels	1/8" Allen Wrench	Masking Tape	Utility Scraper	Putty Knife
	Not Pictured			
	Isopropyl Alcohol		Box Knife	Small Pry Bar
	Glass Cleaner			
	Construction Adhesive			
	Clear Silicone			
				Level

IV. INITIAL DISASSEMBLY

STEP 1

Remove solid surface top cap from customer side of the décor panel, by lifting up on full length of the top cap. This may require two people to support the top cap during removal.

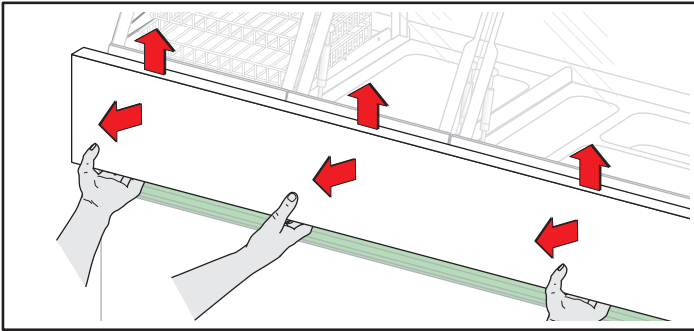

STEP 2

Remove Door from unit. With door closed, remove top hinge pin with a 1/8" hex driver. Lift door off lower hinge and set aside.

NOTE: Do not lose bronze bushings or hinge pin.

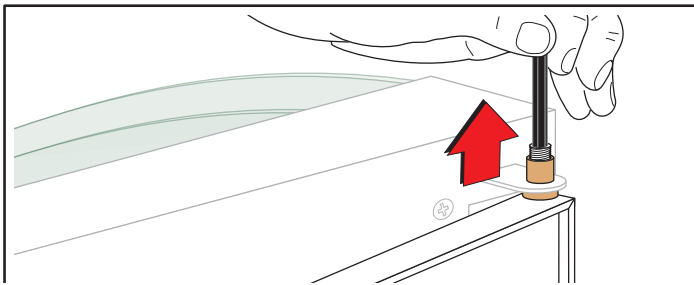

STEP 3

Remove Wire baskets from Bread Display unit.

STEP 4

Remove Wire Support Racks by removing screws and clips holding rack to side panel.

NOTE: Do not lose screws and clips.

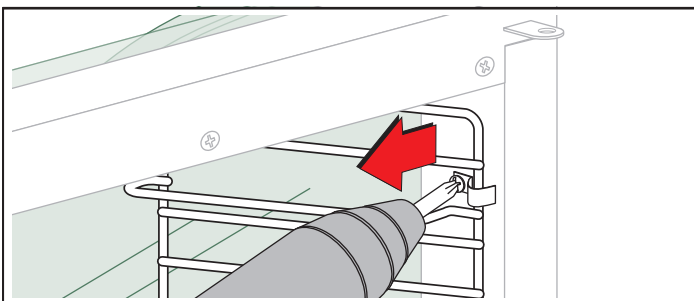

NOTE: If bread display unit was installed and not bolted to adjacent hot food unit sneeze guard, skip steps 5 and 6..

STEP 5

Remove glass screws and acorn nuts between hot food unit and display case with 7/16 socket or wrench and Phillips screwdriver.

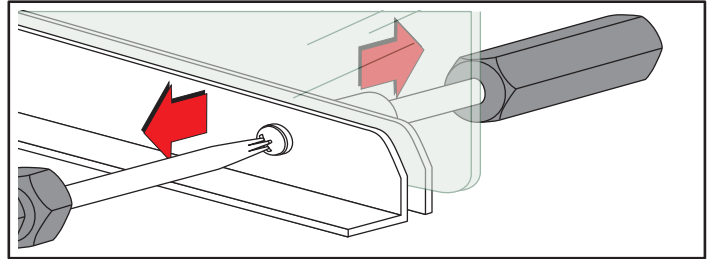

STEP 6

Remove bolts on adjacent unit attaching mount to top with a 7/16" socket or wrench.

NOTE: Do not discard bolts or washers.

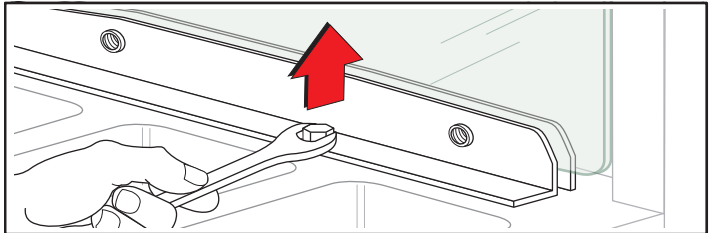

STEP 7

Remove three screws holding top cap, remove and discard top cap.

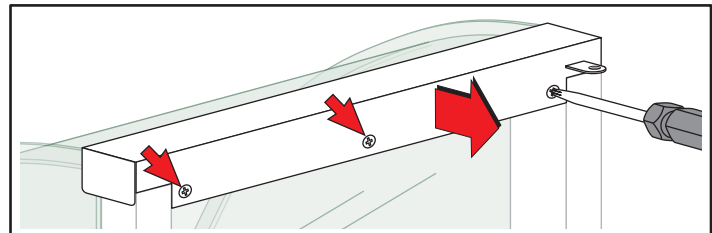

STEP 8

Remove glass from between units. Glass may have some silicone sealing the bottom edge of the glass that it will need to be pulled loose from.

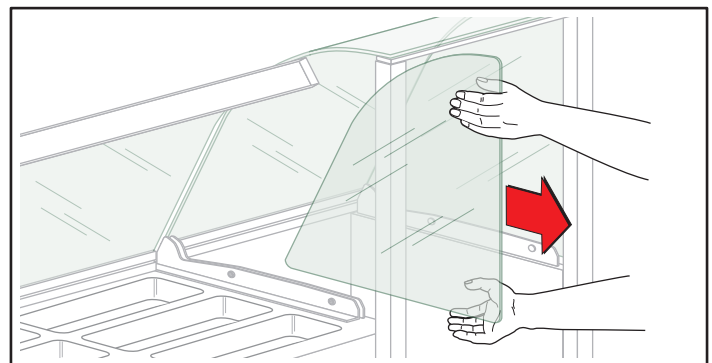

V. DAY COVER REMOVAL

STEP 1

Locate and place glass holding clips over end glass and under curved glass on opposite side. Place clips on both sides if unit was not bolted to adjacent unit.

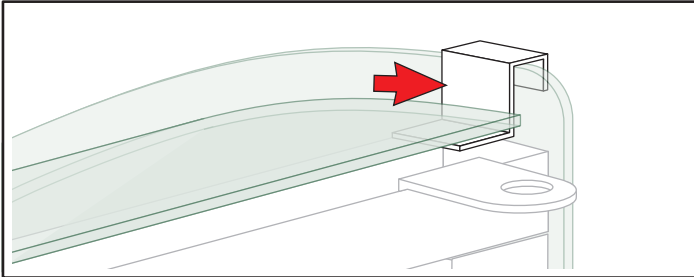

STEP 2

Using masking tape, tape over holding clips to keep in place.

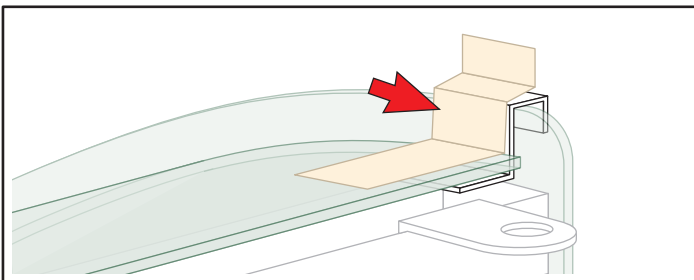

STEP 3

Remove four bolts holding end mounts to unit with 7/16" socket or wrench.

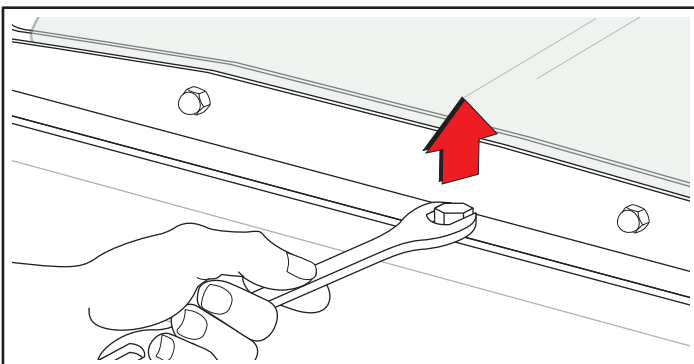

STEP 4

Cut silicone sealant along base of mounts and any joints that can be accessed.

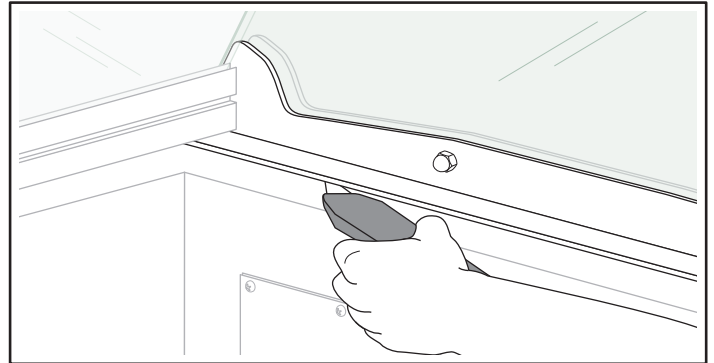

STEP 5

Use a putty knife to help pry the base mounts away from the top of the unit.

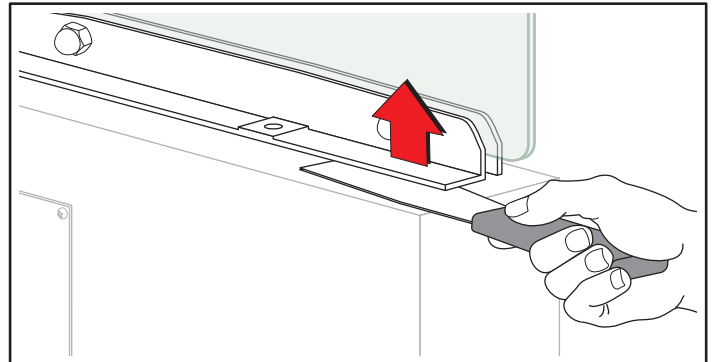

STEP 6

From the Customers side of the unit, pull curved glass, remaining side glass, and aluminum mounts away from cabinet and place on a flat work surface.

NOTE: There may be silicone on the outside of the unit that will try and prevent the guard from being removed.

NOTE: If bread display glass was not bolted to adjacent hot food unit, remove hot food side glass at this time.

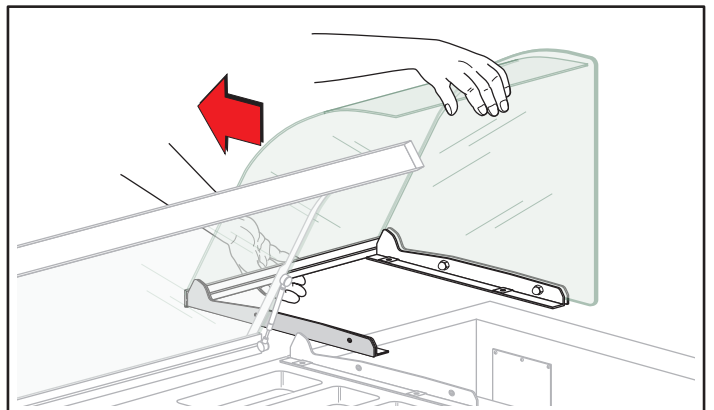

VI. REPLACEMENT OF GLASS GASKETS

STEP 1

Clean silicone from edges and base of end mounts with plastic or soft metal scraper and alcohol.

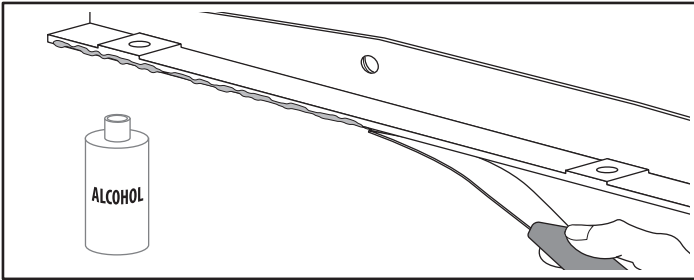

STEP 2

NOTE: If assembly has one (1) end glass you may skip this step.

Remove one piece of end glass from the glass assembly that is adjacent to the hot food unit, by removing screws and acorn nuts with Phillips screwdriver and 7/16" socket or wrench.

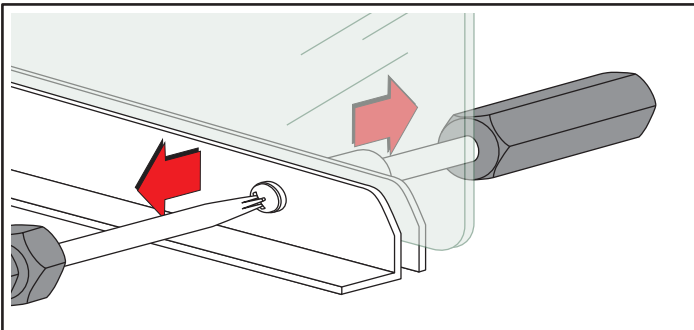

STEP 3

Remove clear wiper channel from edge of curved glass on hot food side.

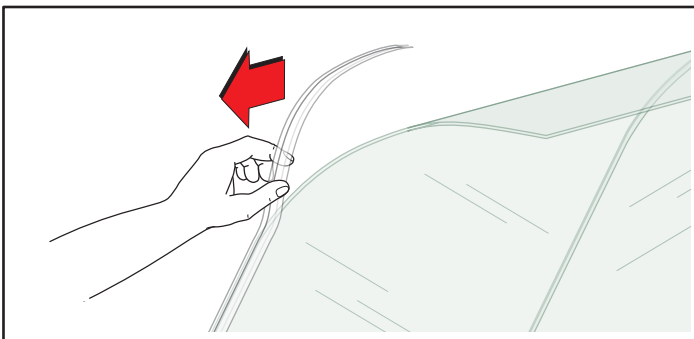

STEP 4

Clean any sealants that may have been applied in an attempt to seal unit from both curved and flat glass. Completely clean both sides of glass (curved and flat) on hot food side with glass cleaner, and then wipe down with alcohol if cleaner leaves a residue. Be especially thorough on the curved sides and edges of the flat glass.

CAUTION

Do not remove glass clip from opposite side at this time.

STEP 5

Locate new edge extrusions with adhesive strips.

Note: The notches on ends of extrusions are left and right specific.

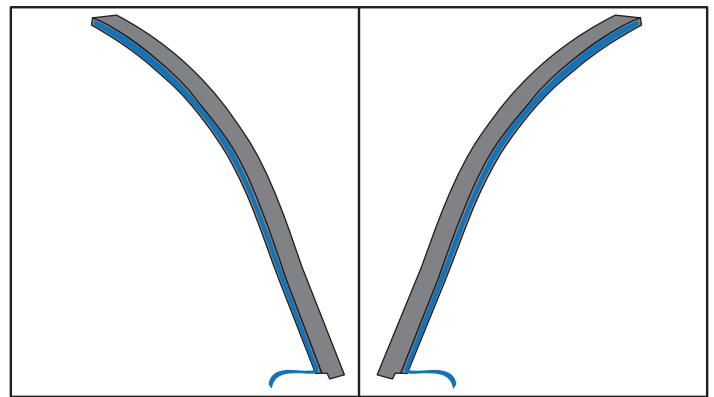

STEP 6

Press open channel of extrusion onto edge of curved glass, fully seating the notch in the extrusion around protrusion from the mount arm, and the wire from light extending out from the top side of the glass.

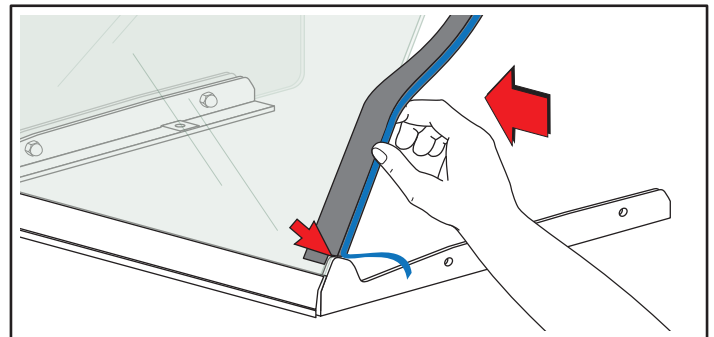

VI. REPLACEMENT OF GLASS GASKETS - continued

STEP 7

Press extrusion onto glass completely and using masking tape, secure in place.

DO NOT remove backing from adhesive on the extrusion at this time.

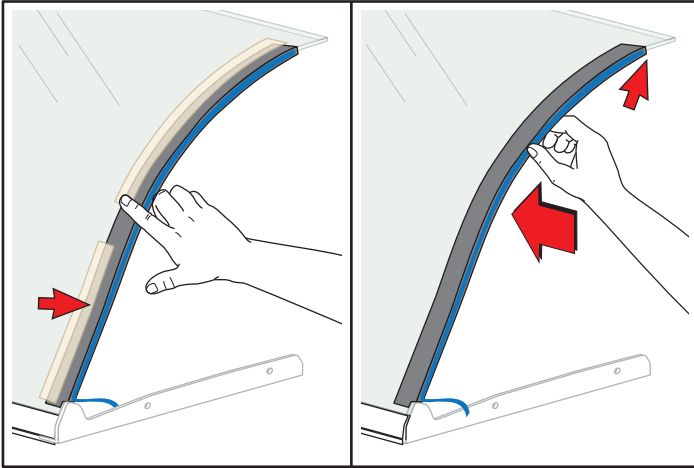

STEP 8

Loosely attach end glass to the Hot Food end of the guard with the double ended screws as shown in pictures with the shaped silicone gasket between the glass and the mount.

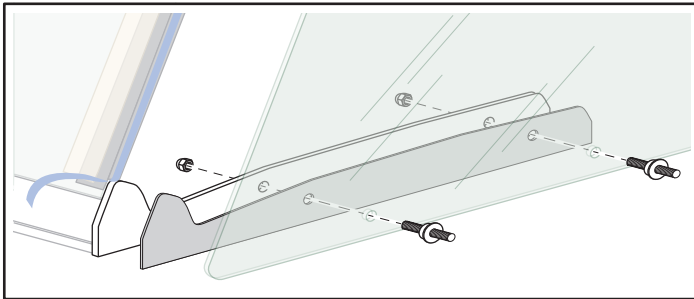

STEP 9

Make sure the extra blue release liner from adhesive is exposed on the outside of the guard.

Tip: Tape loose end of release liner to front of unit.

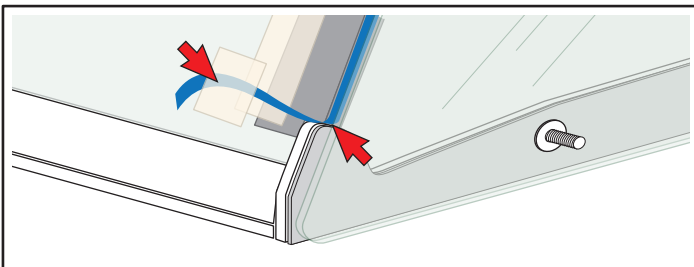

STEP 10

Insert top glass support clip and tape into place.

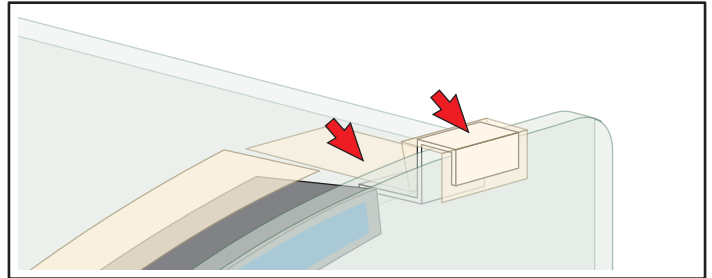

OPPOSITE SIDE

STEP 11

Remove opposite piece of end glass from the glass assembly by removing screws and acorn nuts with Phillips screwdriver and 7/16" socket or wrench.

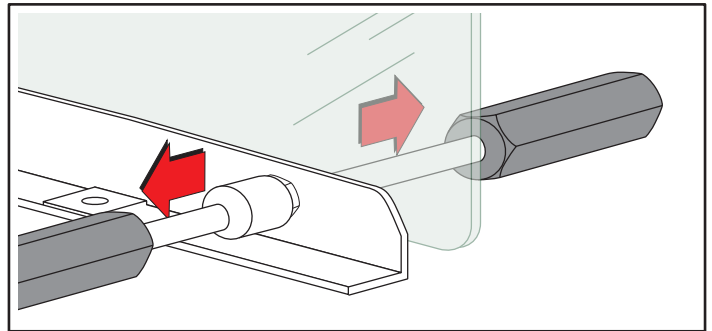

STEP 12

Remove clear wiper channel from edge of curved glass on hot food side.

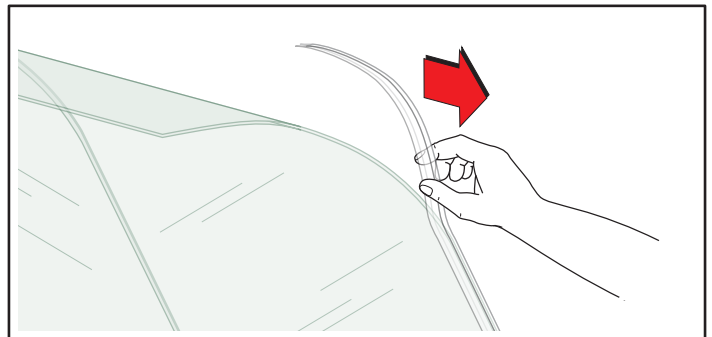

STEP 13

Clean any sealants that may have been applied in an attempt to seal unit from both curved and flat glass. Completely clean both sides of glass (curved and flat) on hot food side with glass cleaner, and then wipe down with alcohol if cleaner leaves a residue. Be especially thorough on the curved sides and edges of the flat glass.

VI. REPLACEMENT OF GLASS GASKETS - continued

STEP 14

Locate new edge extrusions with adhesive strips.

Note: The notches on ends of extrusions are left and right specific.

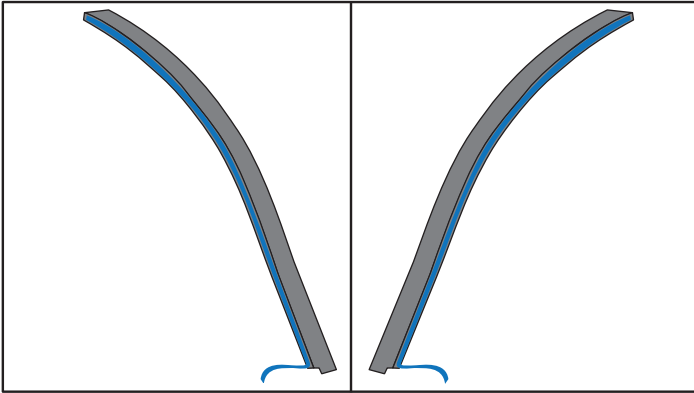

STEP 15

Press open channel of extrusion onto edge of curved glass, fully seating the notch in the extrusion around protrusion from the mount arm, and the wire from light extending out from the top side of the glass.

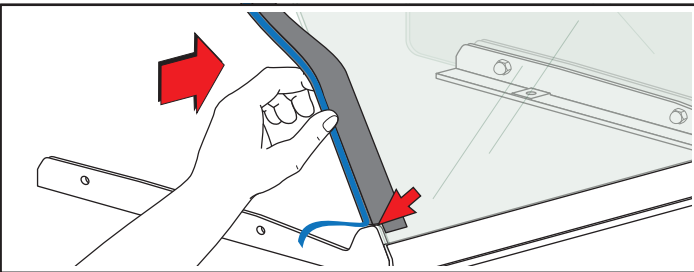

STEP 16

Press extrusion onto glass completely and using masking tape, secure in place.

DO NOT remove backing from adhesive on the extrusion at this time.

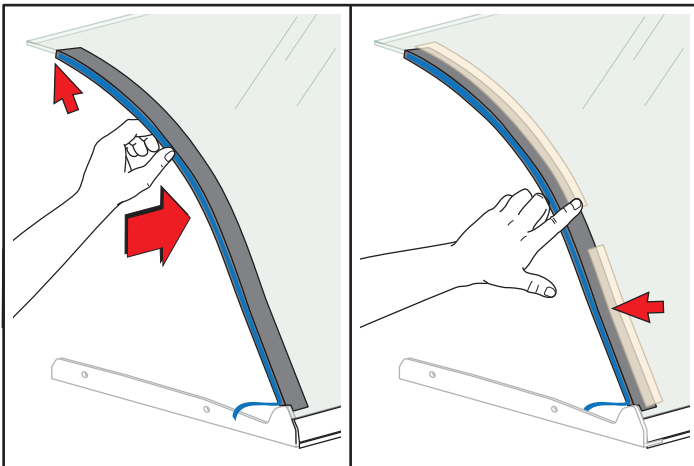

STEP 17

Loosely attach flat side glass with the original screws and washers as shown in picture with the shaped silicone gasket between the glass and the mount. Finger tighten the acorn nuts on screws.

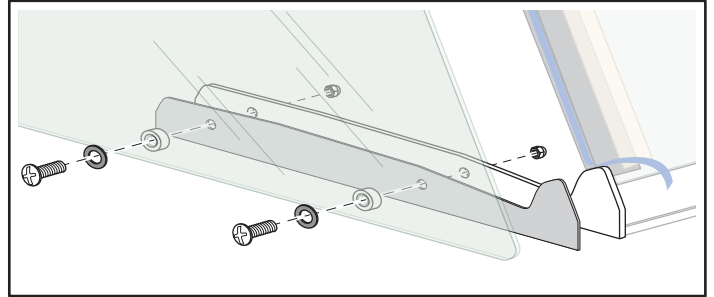

STEP 18

Make sure extra release paper from adhesive is exposed on the outside of the guard.

Tip: tape loose end of release liner to front of unit.

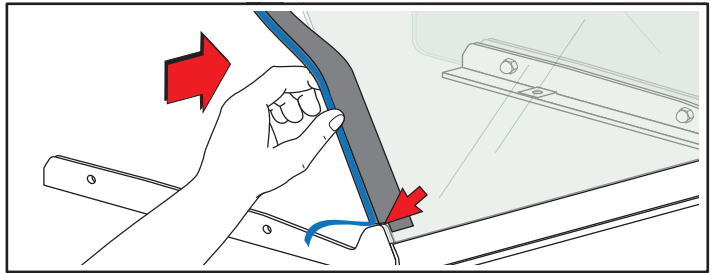

STEP 19

Replace top glass support clip and tape into place.

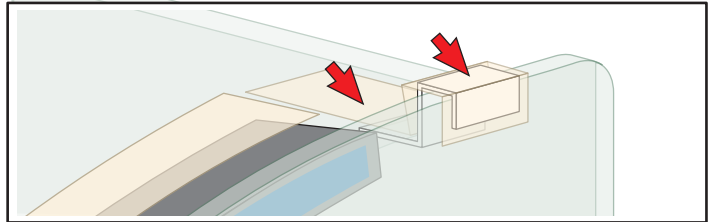

STEP 20

Using masking tape, secure side pieces of glass to front curved glass to hold each piece vertically.

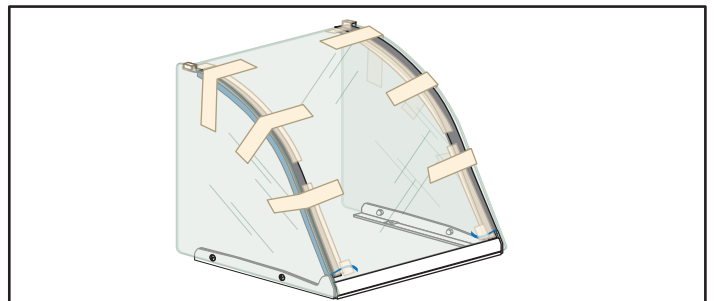

VII. UNIT PREPARATION

STEP 1

Remove silicone from top surface of unit with razor blades, scrapers and alcohol soaked rags.

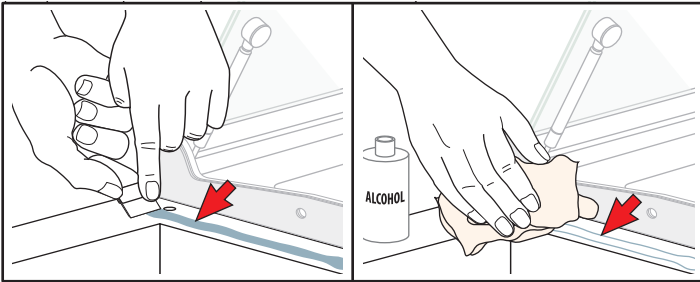

STEP 2

Remove screws from each of the large access panels on the interior of the Bread Display cabinet. **Discard** panels and screws.

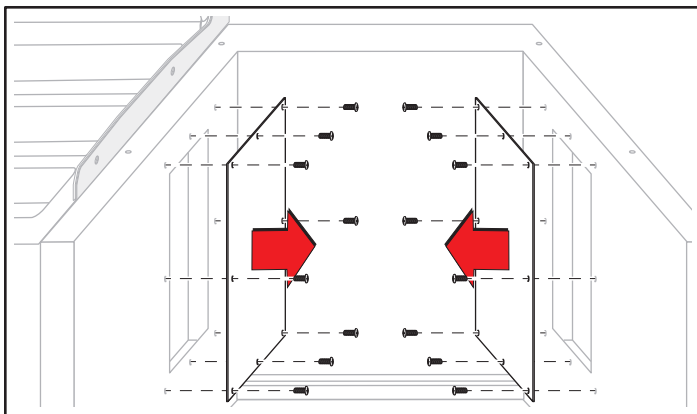

STEP 3

Remove screws from the wire chase access cover, **discard** cover.

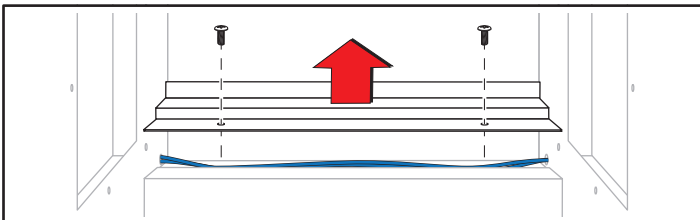

STEP 4

Remove and unplug LED light inside top channel.

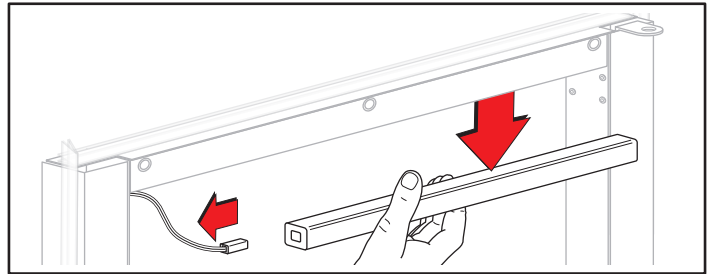

STEP 5

Remove grommet or wire strain relief for top light wire and pull wire down through the chase completely out of upright at this time.

NOTE: All lights and wiring will be removed from cabinet and discarded.

STEP 6

Fill top LED light wire hole inside top channel with solid plug.

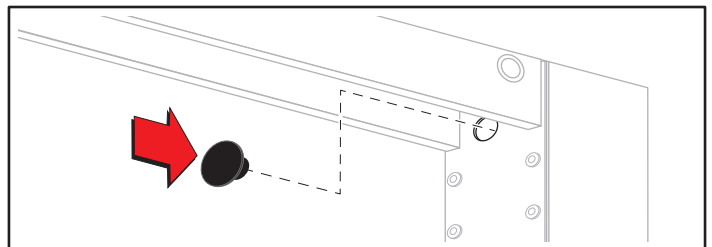

NOTE: If hole on opposite end of top light channel does not have a solid plug, remove grommet if present and replace with solid plug.

STEP 7

Remove clear plastic "V" strip from top horizontal bar of frame. **Do Not** remove "V" strips from sides.

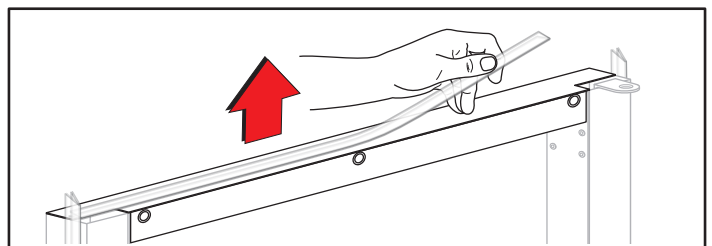

VIII. GASKET INSTALLATION

STEP 1

Starting on end of unit away from hot food unit: Apply 1" wide foam tape up, across and back down outside of the rear uprights, flush to the inside radius of the upright, as shown in pictures.

DO NOT stretch tape or allow adhesive of tape to touch itself or anything else as it is being applied.

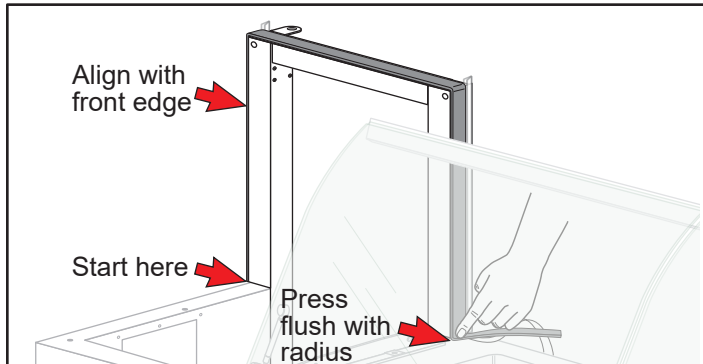

STEP 2

Trim foam tape even with the top surface of the unit.

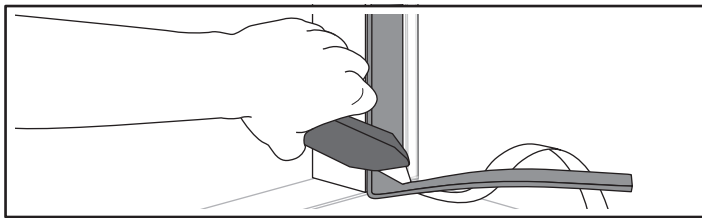

STEP 3

Apply small pieces of 1" wide foam tape over edge of rectangular hole in top of horizontal upright.

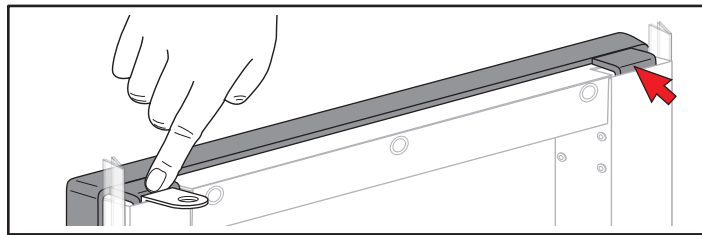

STEP 4

Place Glass Guide Angles against customer side of uprights, overlapping foam tape to prevent glass from catching on foam in later steps. Temporarily tape in place.

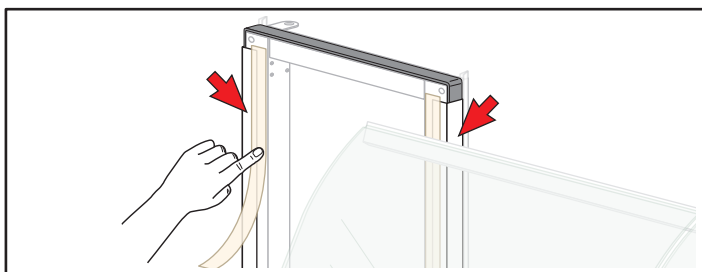

STEP 5

Pull previously loosened mount on Hot Food unit towards center of Hot Food.

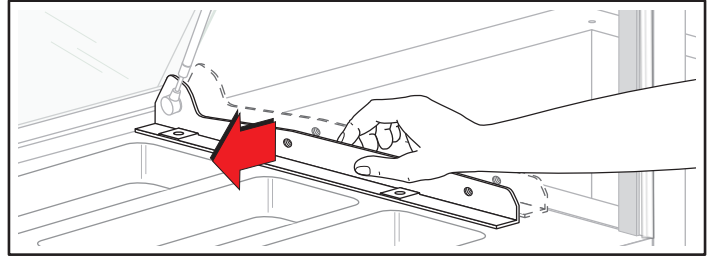

STEP 6

If hot food unit mount does not have silicone gasket pre-glued to mount, then locate pre-cut silicone gasket with the pre-applied tape on both sides. Peel the release liner **ONLY** from the side of the gasket that will attach to the end mount on the adjacent hot food unit.

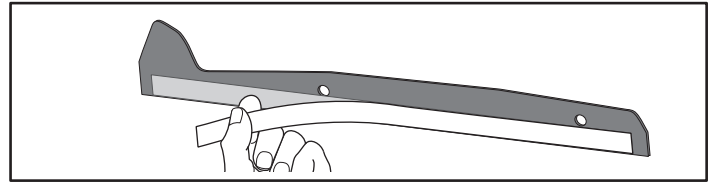

STEP 7

Align gasket with end mount, insure holes in gasket are centered on holes in the mount and apply.

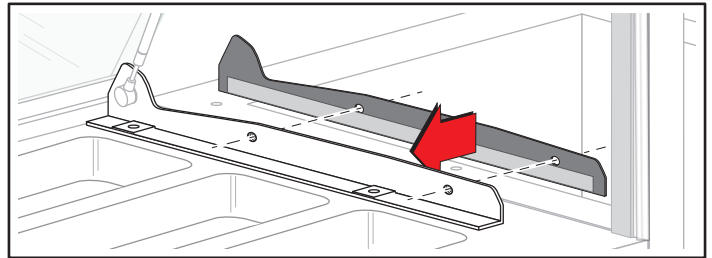

STEP 8

Apply several layers of masking tape to the top edge of the Hot Food mount to prevent paint damage from the double ended screws installed in the glass assembly.

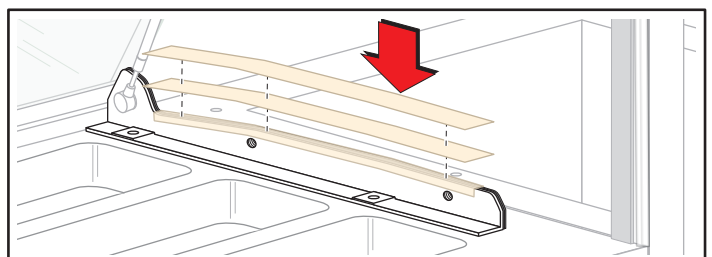

IX. INSTALLING DAY COVER ASSEMBLY

STEP 1

Set glass assembly on top of Bread Display top, and locate so that the top edge of the curved glass is just short of the horizontal top bar of the frame. The exposed ends of the double ended screws may be setting on top of the adjacent unit end mounts until later steps.

CAUTION

DO NOT allow the curved glass to move or rub against the side glass as the adhesive on the gaskets may become prematurely stuck to the side glass.

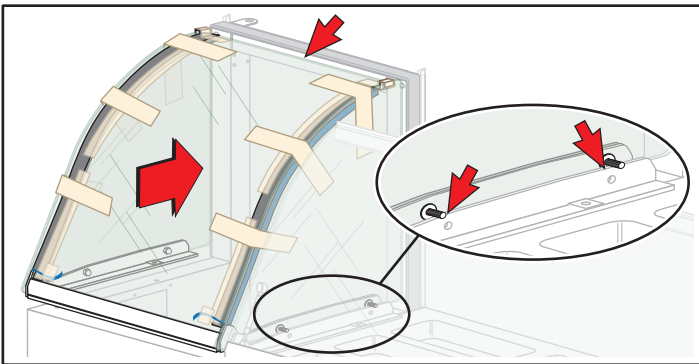

STEP 2

Push day cover into correct location, verifying the clear vertical "V" strips are not wedged open by the end glass.

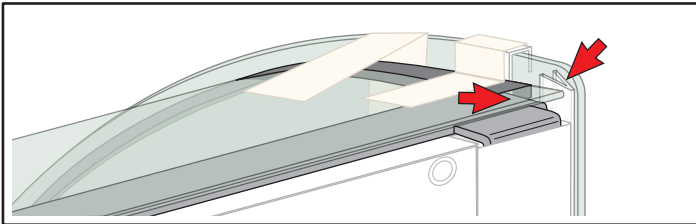

STEP 3

Align hot food mount with threaded ends of double ended screws and insert into holes on hot food mount.

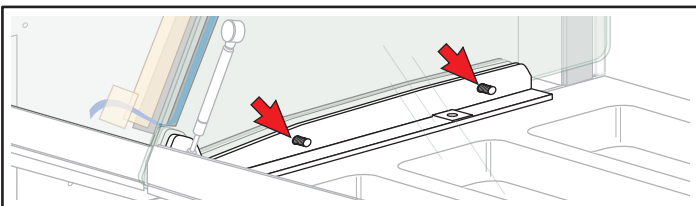

STEP 4

Remove glass holding clips.

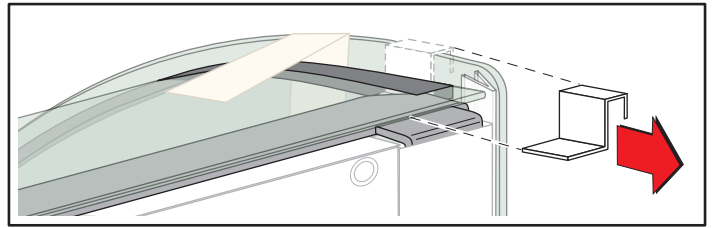

STEP 5

Loosely attach end mounts to top of bread display and hot food unit with bolts and washers removed during disassembly.

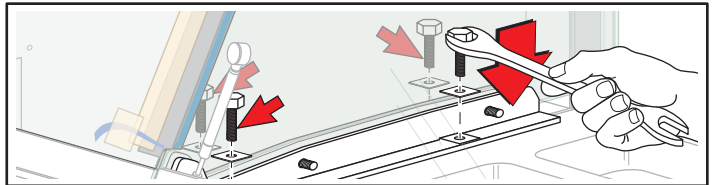

STEP 6

Remove both Glass Guide Angles from inside unit.

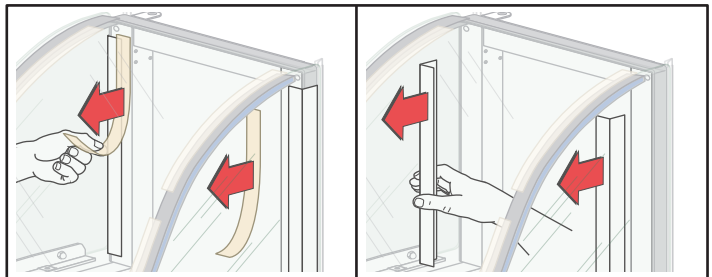

STEP 7

With each end glass still loose, carefully pull blue release tape from light extrusion on one side.

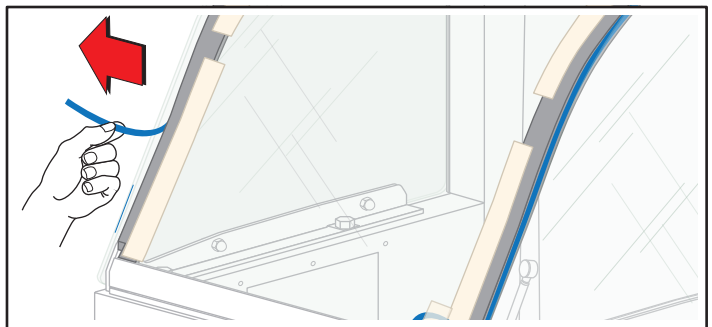

IX. INSTALLING DAY COVER ASSEMBLY - continued

STEP 8

With liner removed, forcefully press flat end glass into edges of curved glass to fully adhere adhesive of the light extrusion to the flat glass. You may also need to press the new gasket against the end glass to adhere the gasket and side glass.

Tip: Bar clamps may be used to press glass into gasket if there is room to attach them.

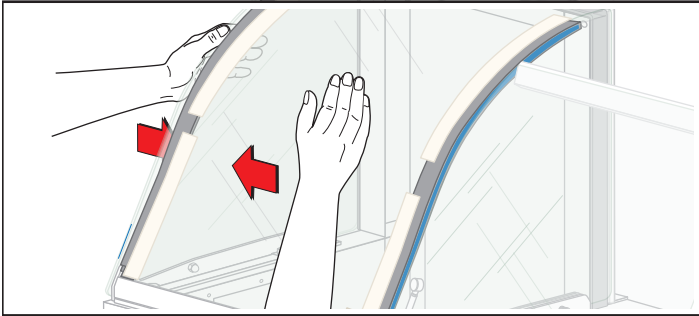

STEP 9

Repeat for other side.

STEP 10

Remove masking tape holding gasket to curved glass on both sides.

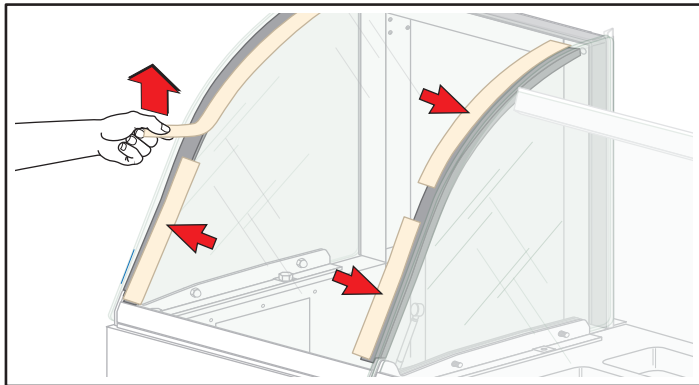

STEP 11

Tighten screws and nuts holding flat end glass to the mounts. Do not over tighten acorn nuts on screws.

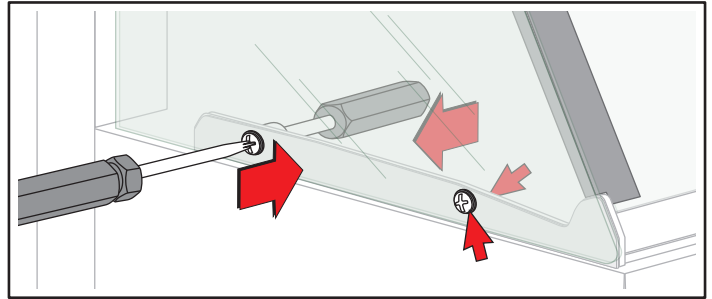

STEP 12

Attach acorn nuts to exposed threads of double ended screws on hot food unit and tighten.

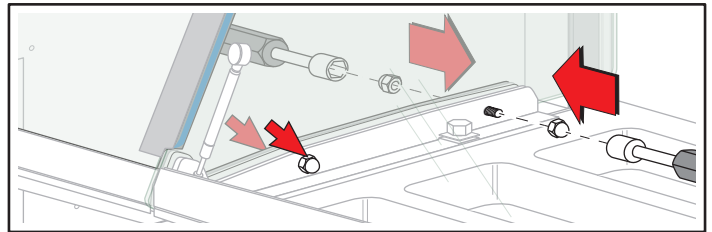

STEP 13

Tighten mounting bolts on the Bread Display unit and then the Hot Food unit.

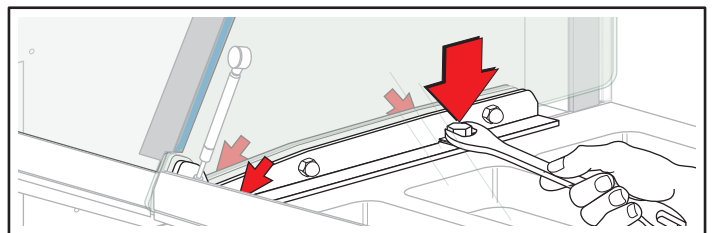

X. REMOVING LED LIGHTS AND WIRING

STEP 1

Remove wire connector from bottom of LED light fixtures on both sides of cabinet. Remove open grommets.

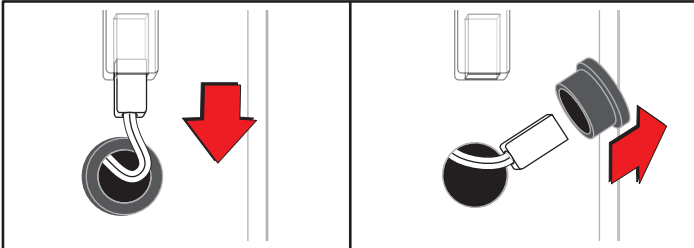

STEP 2

Disconnect the opposite end of the wire from the power supply (typically at the hot food unit).

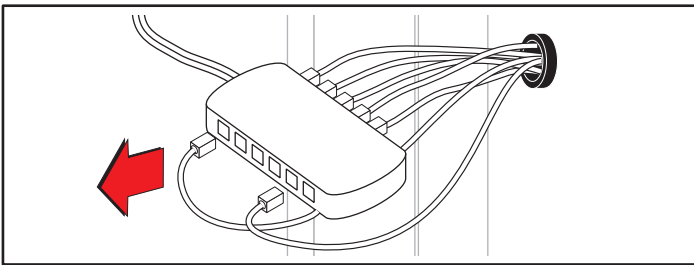

STEP 3

Remove the wires from the bread cabinet and discard lights and wires.

STEP 4

Install the $\text{\O}1/2$ " plastic plug into the open hole where the wire originally went through on the inside of the cabinet.



STEP 5

Remove the stick lights from the cabinet

STEP 6

Install new supplied wire chase cover with 8-32 X 1/2 screws.

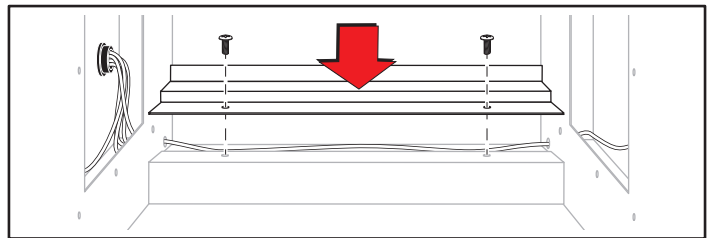

XI. SEALING INTERIOR JOINTS

STEP 1

Locate the two (2) foot piece of foam from kit. Remove backer from foam tape. Fold in half against adhesive.

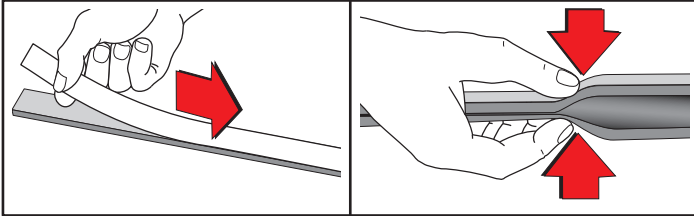

STEP 2

Wedge folded foam under operator's edge of curved glass along full length of top. Use extra to fill gap between new light gaskets, curved and side glass.

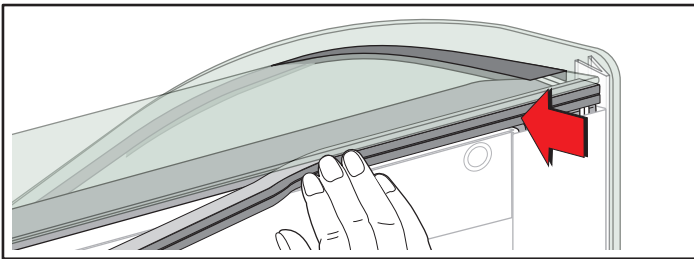

STEP 3

Locate new bread display top cap and remove protective vinyl.

STEP 4

At the end that will go over the hinge bracket, break off hinge clearance tab from top cap with pliers.

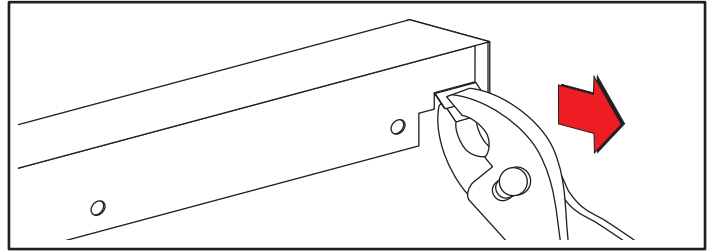

STEP 5

Attach top cap by installing with three (3) #8-32 Flat head screws provided in kit.

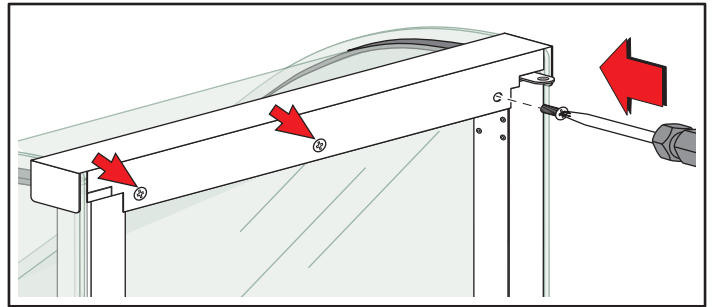

STEP 6

Remove black gasket along the base of front glass mount.

DO NOT THROW AWAY - Needed for step 9

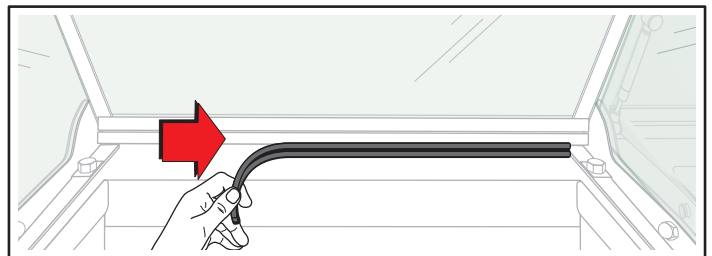

XI. SEALING INTERIOR JOINTS - continued

STEP 7

With tube of gray silicone, seal all the following joints:

- Seal joint along length of the base aluminum extrusion on the interior of the unit.
- Seal gap at both ends of the glass extrusion on the inside of the unit.

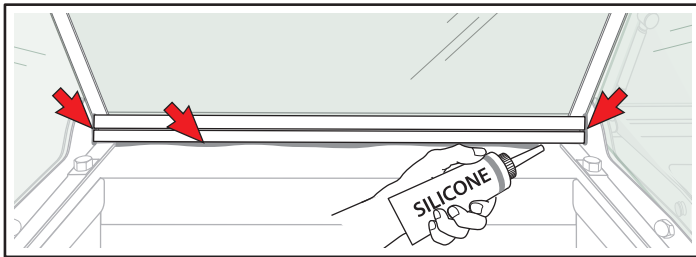

- Re-seal edges of glass mounts.



- Seal edge joints and gaps at end of wire chase cover.
- Seal top and bottom horizontal joints between chase cover and body.

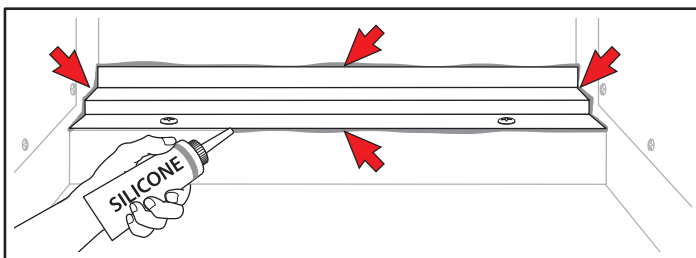

- Seal top turn down flanges between the top of the unit and the interior cabinet.

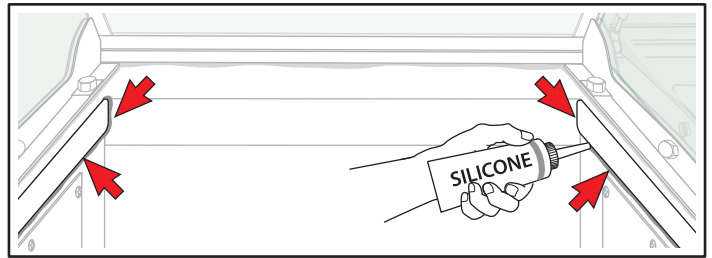

- Seal joint on operator's side between top and uprights if needed.

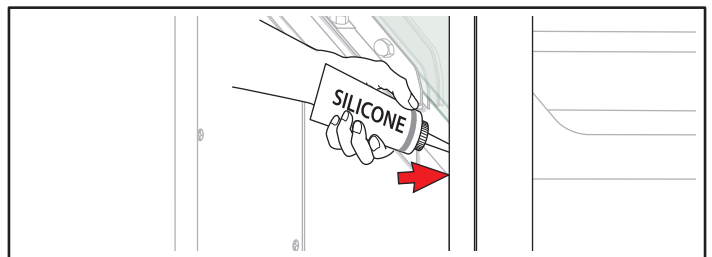

STEP 8

Re-install black gasket along base of front glass mount that was removed in step 6

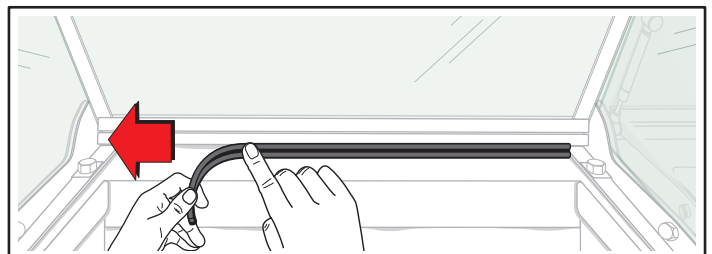

XII. INSTALL WIRE RACKS & DECOR

STEP 1

Remove vinyl from side access panels and install with new #10-24 x 3/8" screws and the gasket against the inside panel. The panels can only be installed with the un-creased side at the bottom of the unit.

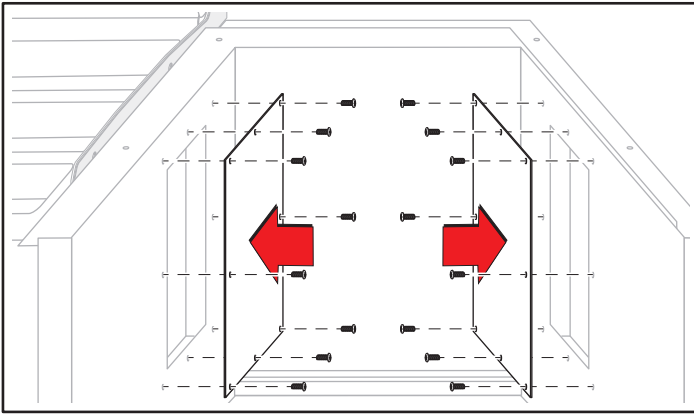

STEP 2

Re-install Wire support racks by starting at the top of the rack and placing holding clips over the vertical wires of the racks and running screws into the threaded inserts. The clips should only be placed over vertical wires of the supports. Do not place over horizontal wires; this will interfere with the use of the wire baskets.

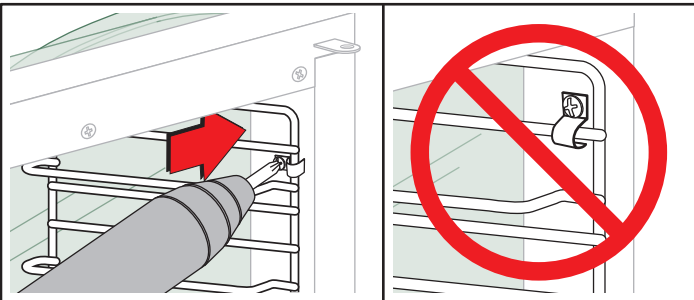

STEP 3

Replace the wire baskets into the unit.

STEP 4

Reattach front decor panel by holding the panel between 0.5"-1" above the stainless top, press the lower portion of the panel into the groove of the front panel.

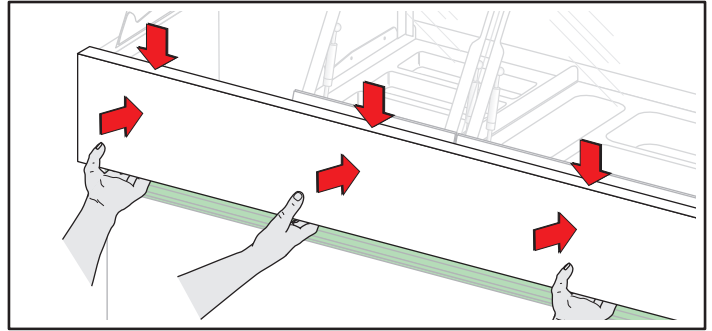

STEP 5

Carefully push down the panel until it is seated within the channels on the front panels.

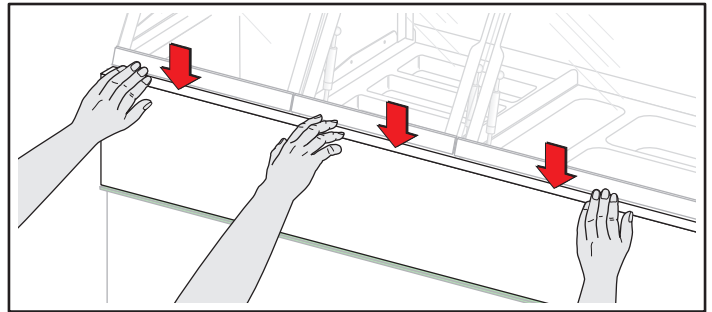

STEP 6

Ensure the panel is installed correctly by slightly pulling on the bottom of the panel to make sure it is seated, verifying there is no gap between this panel and the adjacent panel.

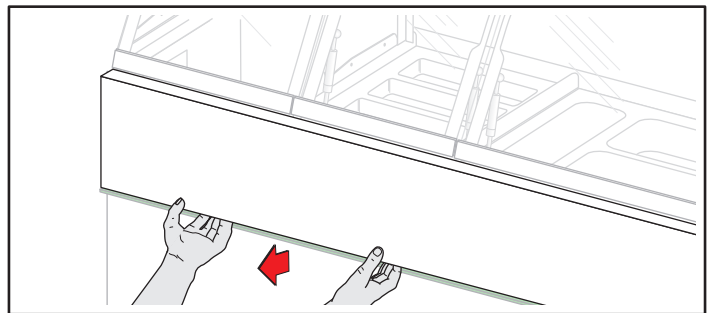

XIII. INSTALL DOOR GASKET

STEP 1

Lay door across a table or flat surface gasket facing up. Pull old door gasket out of door frame and discard. Clean frame and gasket groove.

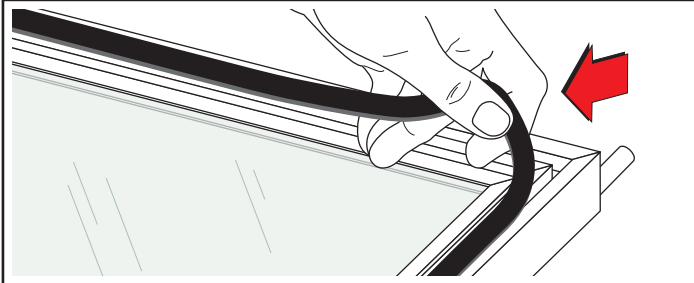

STEP 2

Locate new door gasket and orient to the door.

STEP 3

Starting in one corner, push arrow point of gasket into groove on door frame.

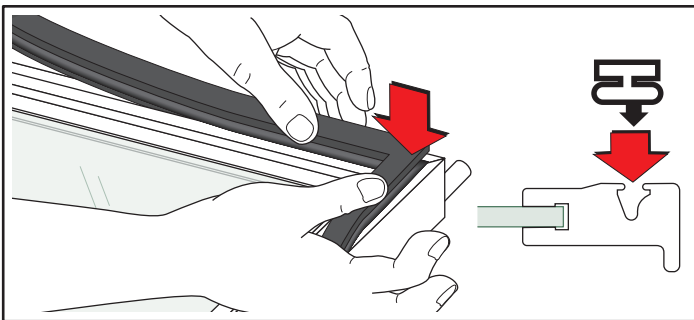

STEP 4

Roll arrow point into the groove along one side of door, shifting gasket as required when nearing next corner.

Continue with other sides

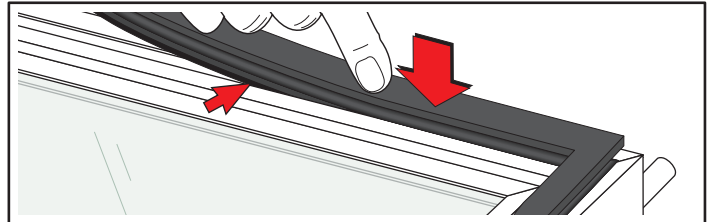

STEP 5

Inspect gasket engagement with door frame by carefully lifting folds of the gasket to insure arrow point is fully engaged with door frame. See pictures for good and bad engagement.

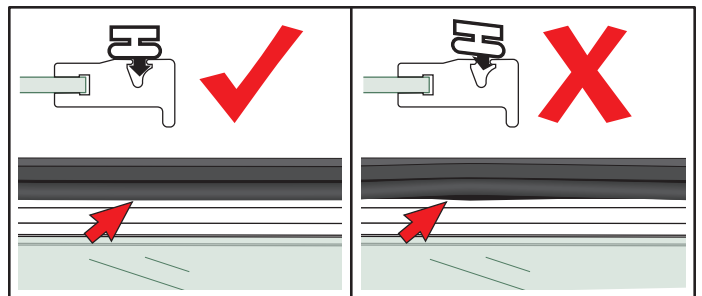

IVX. INSTALL DOOR

STEP 1

Drop lower hinge pin into the bushing in the lower hinge.

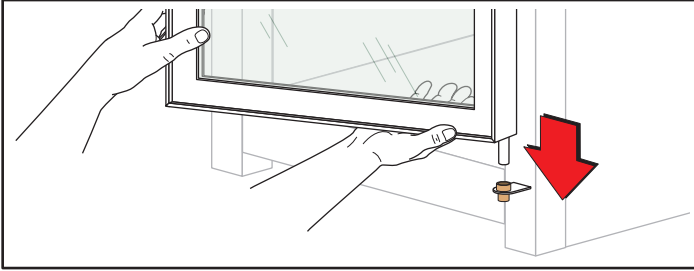

STEP 2

Place upper bushing into hole on top hinge and slide door into position under bushing.

STEP 3

Re-install upper hinge pin and tighten. The top of the hinge pin should be below the top edge of the hinge bushing when fully tightened.

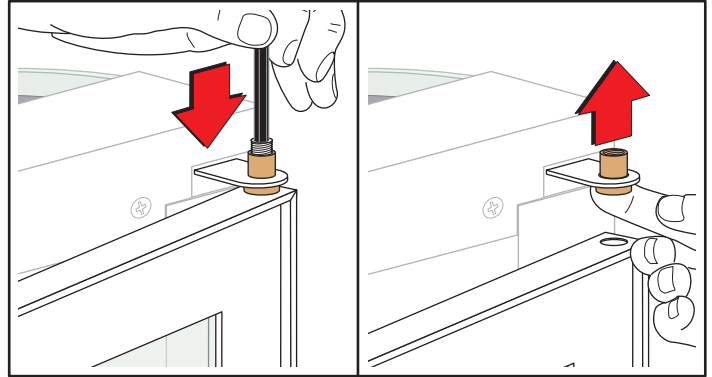

STEP 4

Verify seal of gasket around perimeter of frame.

If gasket is gapped:

- Stretch bellows of gasket away from door frame.
- On one end, remove gasket, flip over and re-install.

Congratulations Installation complete.



Your Solutions Partner

Duke Manufacturing Co.

2305 N. Broadway
St. Louis, MO 63102

Phone: 314-231-1130

Toll Free: 1-800-735-3853

Fax: 314-231-5074

www.dukemfg.com