

PROGRILL™

Operation Manual

TW1520 / TW2025

Flat Grills



PROPROCESS CORPORATION
P.O. Box 869 • 7328 Madison St. • Paramount, CA 90723
(562) 531-0305 • (800) 624-6717 • Fax (562) 869-7715



DOUGHPRO®

PROPROCESS CORPORATION
Website: www.doughpro.com • E-Mail: info@doughpro.com

PROGRILL™

Operation Instructions

Step 1

Carefully unpack and clean grill plates with mild soap then sponge clean with cold water.

Step 2

Place in location where it will be used allowing for clearances per the dimensions indicated.

WARNING

- **ALLOW 2" MINIMUM CLEARANCE** between adjacent equipment and/or wall areas.
- **DO NOT** touch hot surfaces.

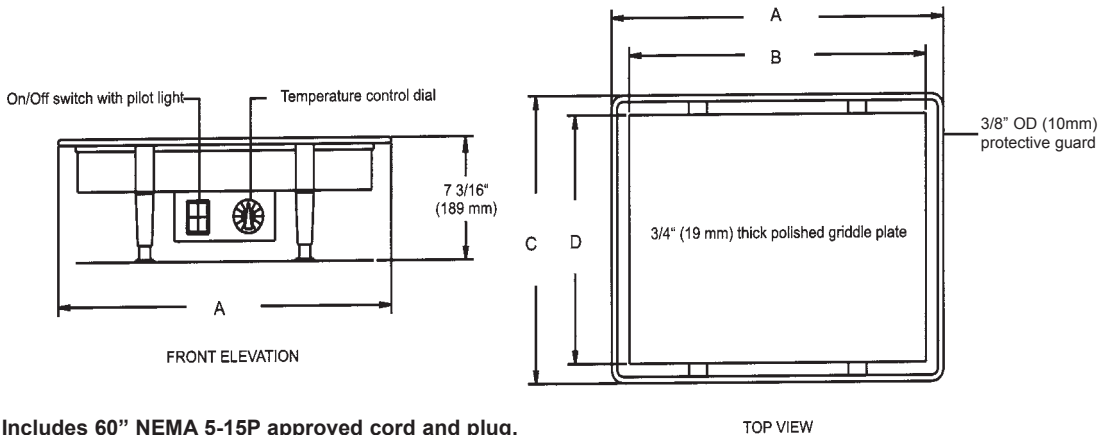

DIMENSIONS:	
TW1520	
A - 22 3/8"	(568mm)
B - 20"	(508mm)
C - 17 3/8"	(441mm)
D - 15"	(381mm)
TW2025	
A - 27 3/8"	(695mm)
B - 25"	(635mm)
C - 22 3/8"	(568mm)
D - 20"	(508mm)

Includes 60" NEMA 5-15P approved cord and plug.

TOP VIEW

Step 3

Plug into proper 3 prong wall outlet. If other appliances are connected to the same circuit make sure the total load does not exceed maximum ampacity of the circuit.

Electrical Data

TW1520	TW2025
120v/60hz	208v/60hz
1700w/14.17amps	2800w/13.4 amps

Step 4: Warm-up

Energize by turning on the temperature control knob to your desired temperature. (0°-425°F).

- Allow at least 15-20 minutes to pre-heat grill.
- When the pilot light is *lit*, the temperature has *NOT* been reached.
- When the pilot light is *off*, the desired temperature has been reached.

Cleaning Procedure

Clean the grill with a cleaner and some type of scraper. Maintain on a daily basis to avoid product build up on the grill surface.

FOR SERVICE CALL: (800) 624-6717

PROPROCESS CORPORATION
P.O. Box 869 • 7328 Madison St. • Paramount, CA 90723
(562) 531-0305 • (800) 624-6717 • Fax (562) 869-7715



DOUGHPRO®
PROPROCESS CORPORATION
Website: www.doughpro.com • E-Mail: info@doughpro.com

MODELS TW1520 / TW2025

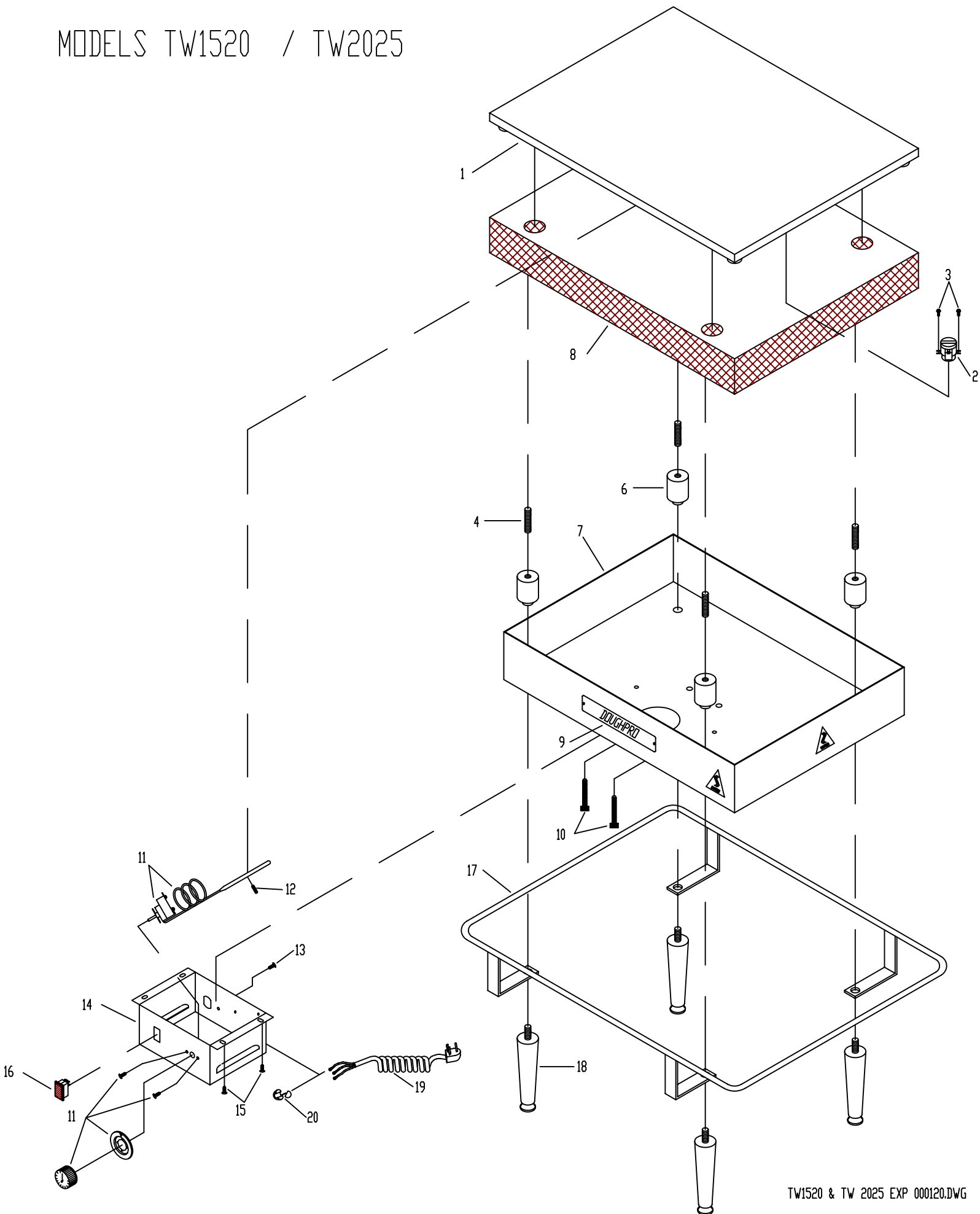

PARTS LIST FOR TW1520 / TW2025 TORTILLA WARMER

REF #	DESCRIPTION	TW1520A 120 ~ AC	TW1520B 240 ~ AC	TW2025A 120 ~ AC	TW2025E 208 ~ AC
1	HEATED PLATEN	110843074	110843075	110822074	110108625
2	HI-TEMPERATURE LIMITER	110812046	110812046	110812046	110812046
3	SCREW, HI-TEMPERATURE LIMITER	SP63214	SP63214	SP63214	SP63214
4	SET SCREW, SPACER	SST38161	SST38161	SST38161	SST38161
6	SPACER, SHORT	11082249	11082249	11082249	11082249
7	BOTTOM SHROUD	11082335	11082335	11082235	11082235
8	INSULATION	MPSP254	MPSP254	MPSP254	MPSP254
9	NAME PLATE	DPR01	DPR01	DPR01	DPR01
10	SCREW, BOTTOM SHROUD	BH1420234	BH1420234	BH1420234	BH1420234
11	TEMPERATURE CONTROLLER ASSEMBLY	11081252	11081252	11081252	11081252
12	SET SCREW, TEMPERATURE CONTROLLER ASSEMBLY	SST381638S	SST381638S	SST381638S	SST38161
13	SCREW, GROUND	SP83258	SP83258	SP83258	SP83258
14	HOUSING	11082322	11082322	11082322	11082322
15	SCREW, HOUSING	SP83238	SP83238	SP83238	SP83238
16	LAMP, SIGNAL (GREEN) LENSE	110812020	110812020	110812020	110812020
17	HEAT GUARD ASSEMBLY	11082310	11082310	11082210	1108108610
18	APPLIANCE LEG 4"	AE601653	AE601653	AE601653	AE601653
19	POWER CORD	110174	110175	110174	110969175
20	CABLE STRAIN RELIEF	MPSS168	MPSS168	MPSS168	MPSS168

WIRE DIAGRAM
TORTILLA WARMER MODEL # TW1520

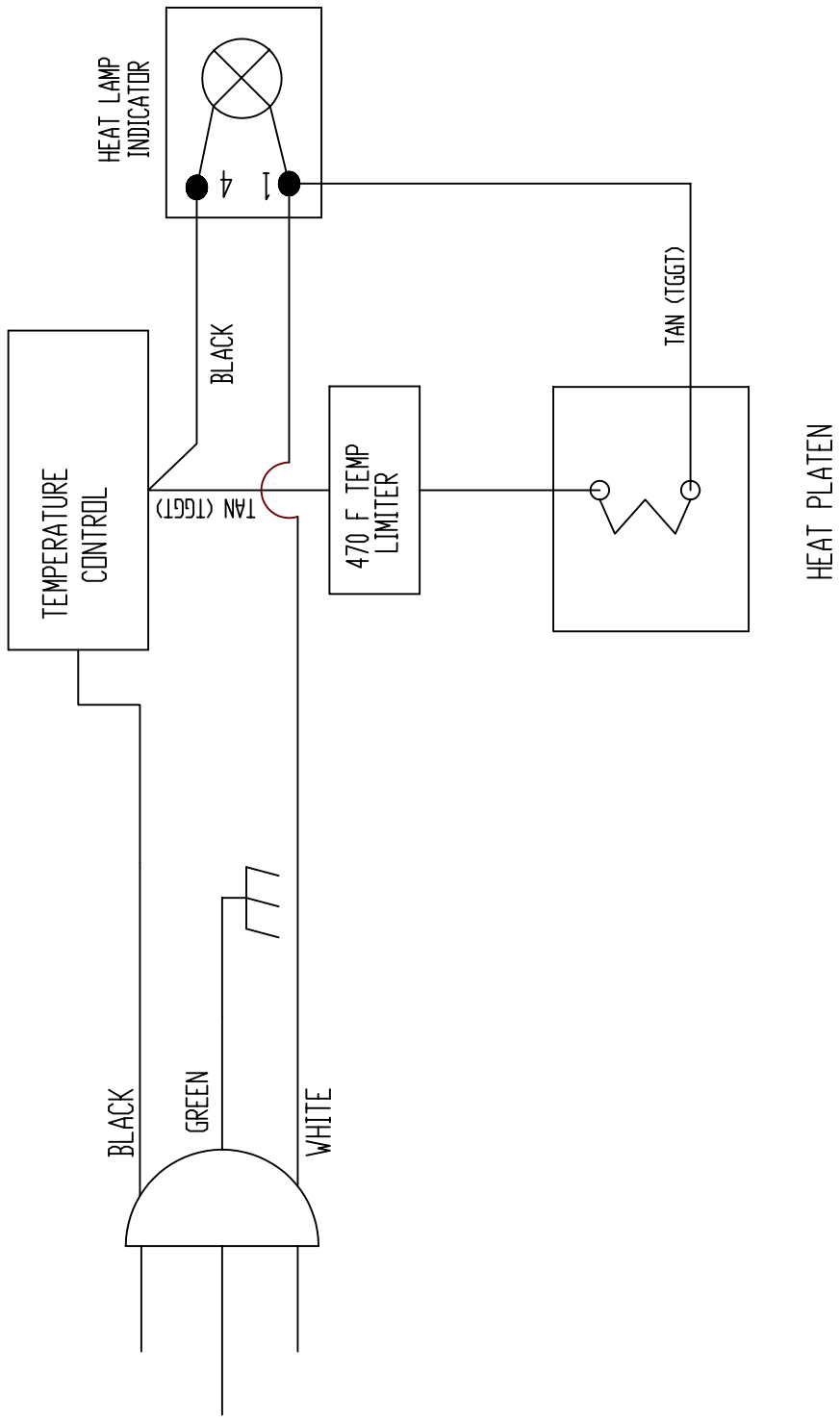

VOLTS- 120 ~ AC?
WATTS- 1700
AMPS- 14.16

VOLTS- 230 ~ AC
WATTS-2200
AMPS- 9.56

WIRE DIAGRAM TORTILLA WARMER MODEL # TW2025

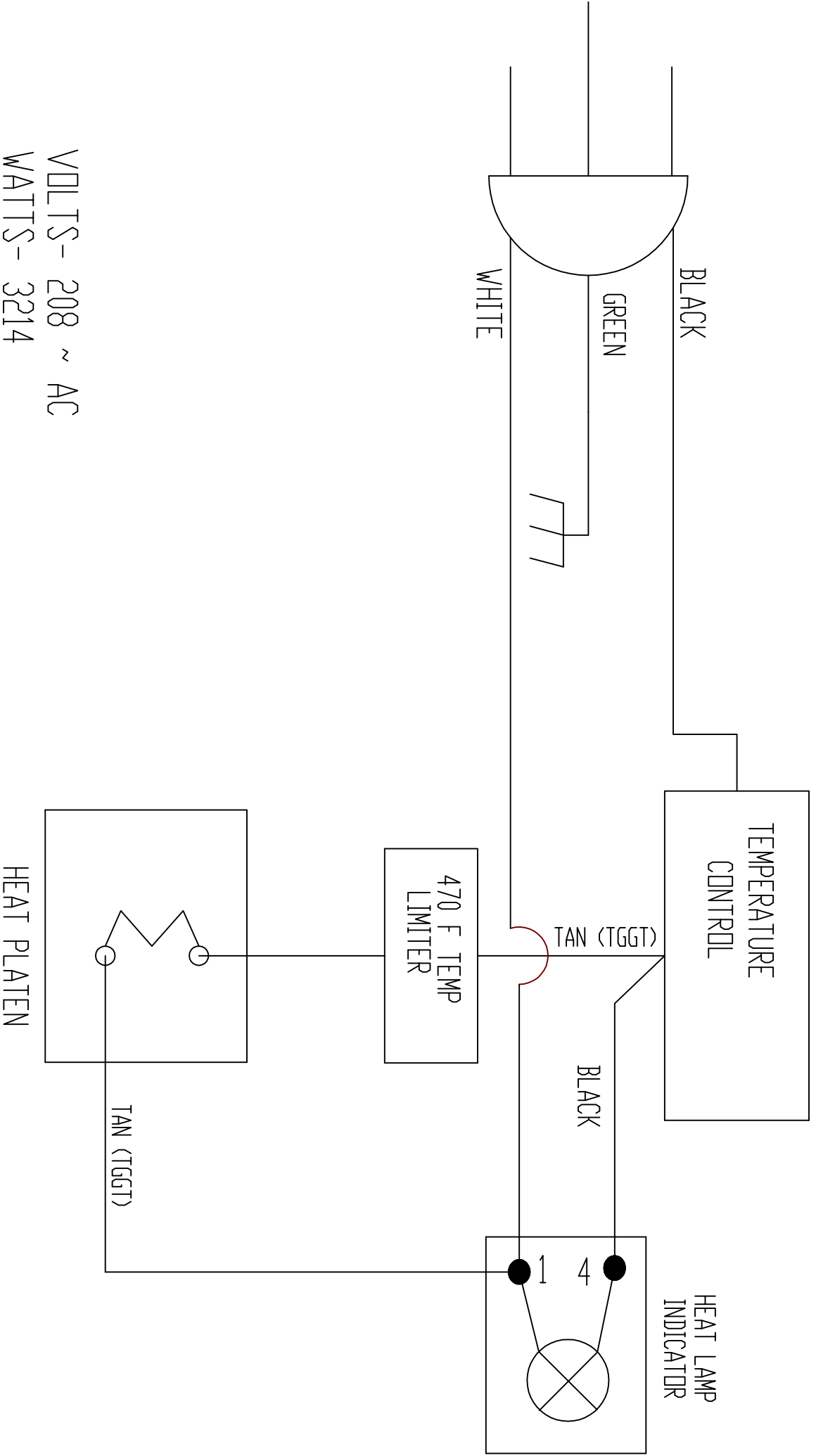

VOLTS- 208 ~ AC
WATTS- 3214
AMPS- 13.97



PLEASE READ CAREFULLY BEFORE ATTEMPTING TO USE THIS APPLIANCE.

LIMITED MACHINE WARRANTY

WHAT IS COVERED

Proprocess/Doughpro warrants the equipment, from manufacturing defects in workmanship and material sold within the domestic United States.

HOW LONG DOES THE COVERAGE LAST

One-year warranty for parts and labor. The heating elements on the upper and lower platens have a limited lifetime warranty on the elements.

WHAT WE WILL DO

We will repair or replace the defective equipment on normal warranty one-year parts and labor. The heating elements on the upper and lower platen only; will be replaced by next day air service; under the normal one-year warranty. Such repair or replacement will be at the expense of Proprocess Corporation under the normal one-year parts and labor warranty.

HOW TO GET SERVICE

Contact our Factory to obtain warranty service. Proprocess must issue a return authorization number, and call tag, or find the name and location of a Factory Authorized Service Center nearest you. When calling for service, please furnish the model number, serial number, and a description of the problem.

WHAT THIS WARRANTY DOES NOT COVER

THE WARRANTIES PROVIDED BY PROPROCESS/DOUGHPRO DO NOT APPLY IN THE FOLLOWING INSTANCES:

- Damage due to misuse, abuse, alteration, or accident.
- Improper or unauthorized repairs.
- Submerged in water.
(Excess water or chemical within the electrical panel)
- Dropped.
- Damage in shipment.
- Equipment exported to foreign countries.

FOR SERVICE CALL: (800) 624-6717

PROPROCESS CORPORATION
P.O. Box 869 • 7328 Madison St. • Paramount, CA 90723
(562) 531-0305 • (800) 624-6717 • Fax (562) 869-7715



DOUGHPRO
PROPROCESS CORPORATION
Website: www.doughpro.com • E-Mail: info@doughpro.com

DOUGHPRO[®]

STEARNS PRODUCT DEVELOPMENT CORPORATION
20281 Harvill Ave, Perris, CA 92570 Tel: (800) 624-6717 - Fax: (951) 657-4594

Warranty & Return Policy

STEARNS PRODUCT DEVELOPMENT CORPORATION warrants all products manufactured by it against defects in workmanship or materials from the date of purchase for a period of (1) year on parts and labor. **This warranty applies to only equipment purchased and used in the United States.**

Exclusions:

- 1. WOOD / GAS FIRED OVENS:** STEARNS PRODUCT DEVELOPMENT CORPORATION warranty applies to the main body of the oven being steel / refractory and insulation shall be free from defects in materials and workmanship for a period of four (4) years from the date of purchase. The gas equipment shall be free from defects in materials and workmanship for a period of one (1) year from the date of purchase. This warranty excludes the tandoori and home oven.
- 2. TANDOORI & HOME OVENS:** STEARNS PRODUCT DEVELOPMENT CORPORATION warrants the Tandoori & Home Oven including gas equipment shall be free from defects in materials and workmanship for a period of one (1) year from the date of purchase.
- 3. Air compressors are excluded from this warranty,** but STEARNS PRODUCT DEVELOPMENT CORPORATION may act as a warranty expeditor in certain instances regarding these compressors. The air compressor manufacturer provides a limited warranty and a copy of this warranty is furnished with all compressors sold by STEARNS PRODUCT DEVELOPMENT CORPORATION. For prompt handling of compressor warranty claims the instructions of the compressor manufacturer must be adhered to.
- 4. Equipment built to special order as well as accessories** are not returnable unless defective within the terms of this warranty.
- 5. In no event shall STEARNS PRODUCT DEVELOPMENT CORPORATION be liable for consequential damages arising out of the failure of any of its products if operated improperly or caused by normal wear or damage by operator abuse.**

Returned Merchandise Policy:

Should it become necessary to return any of the company's products, the following instructions must be adhered to: First, contact our customer service department for approval and a return authorization number. *Please have the serial number of your item available at that time.* All merchandise must be shipped *freight prepaid* by customer or service agency. Subject to the inspection of the product by the company, a restocking charge of 20% of the Net purchased price paid to STEARNS PRODUCT DEVELOPMENT CORPORATION will be assessed. Merchandise may not be returned for credit without *prior written approval* of STEARNS PRODUCT DEVELOPMENT CORPORATION. Collect shipments *will not* be accepted. No returns after 60 days of original shipment date on machines. Purchased parts may not be returned after 30 days. If upon inspection by STEARNS PRODUCT DEVELOPMENT CORPORATION or its authorized agent it is determined the equipment has not been used in an appropriate manner, has been modified, or has not been properly maintained, or has been subject to misuse, misapplication, neglect, abuse, accident, unauthorized modification, damage during transit, delivery, fire, flood, act or war, riot or act of God, then this warranty shall be deemed null and void.

Terms & Conditions:

- Prices indicated in the PRICE LIST are suggested retail prices and are shown in U.S. DOLLARS.
- Terms of Payment: 2% 10 days, NET 30 days.
- NEW ACCOUNTS:** Satisfactory credit information must be provided before open account status can be extended. Unless agreed otherwise, all shipments will be made C.O.D., CASH IN ADVANCE.
- PRICING:** Prices, specifications, model numbers, capacities and accessories are subject to change without notice.
- FREIGHT / ROUTING:** Method of shipment will be determined by STEARNS PRODUCT DEVELOPMENT CORPORATION unless otherwise advised by PURCHASER.
- DAMAGED CLAIMS:** All merchandise shipped at purchaser's risk. Inspection must be made by purchaser at time goods are received. If goods are damaged, the PURCHASER shall request that the agent of the transportation company make a written notation on the proper shipping documents immediately and then file a claim for damage. **GOODS DAMAGED IN SHIPMENT ARE NOT RETURNABLE.**
- RETURNS:** Machines may not be returned after 60 days. Purchased parts may not be returned after 30 days. A restocking fee of 20% will be assessed on non-warranty returns.
- TAXES:** Prices indicated herein DO NOT include State, Federal, Local or foreign taxes or duties, nor do they include fees, permits, insurance or other levies, all of which are the responsibility of the purchaser.
- All orders are subject to acceptance by STEARNS PRODUCT DEVELOPMENT CORPORATION.
- Possession of this price list shall not be considered an offer to sell.