

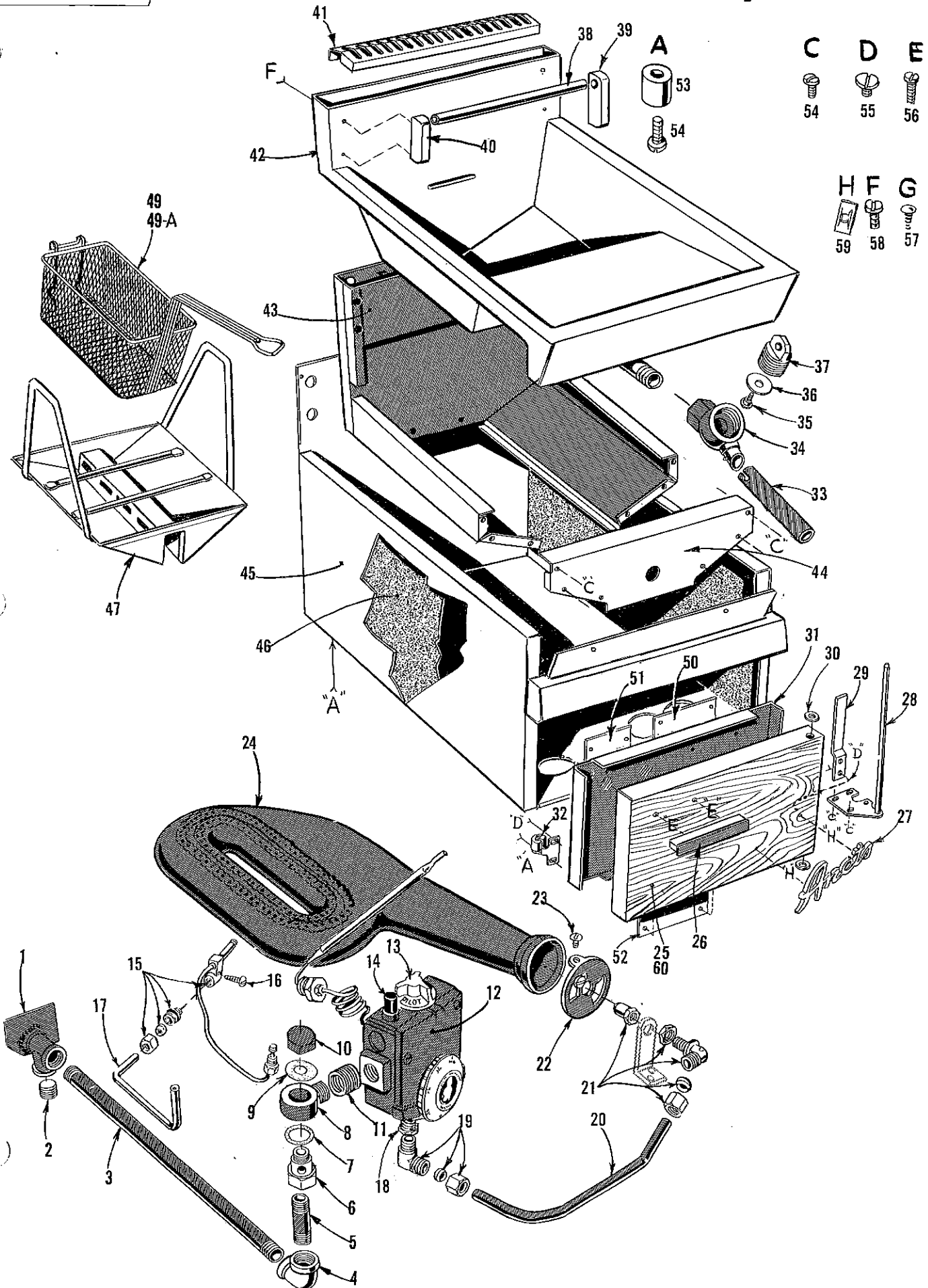

Parts List for FCL Fryers





Parts List for FCL Fryers

1. TEE S.S.A. - B9852
2. PIPE PLUG - P8815-05
3. INLET PIPE - B6351
4. ELBOW - P8815-02
5. NIPPLE - P8815-01
6. INLET PIPE ADAPTOR - P9300-05
7. GASKET - P9300-08
8. ADAPTOR - P9300-11
9. GASKET - P9300-09
10. CAP - P9300-6
11. FACE BUSHING - P8820-03
12. UNITROL 200S - P8900-01 → *NLA*
13. CONTROL-KNOB - P8085-11
14. THERMOSTAT BUTTON - P9300-07
15. PILOT BURNER - P8900-20
16. SCREW - P8020-02
17. PILOT TUBE - B8116
18. REDUCING BUSHING - P8815-06
19. COMPRESSION ELL (MALE) - P8840-01
20. BURNER PIPE - B9854
21. ELBOW, LOCKNUT & BLANK HOOD - P8815-04
22. AIR SHUTTER - P9300-10
23. SCREW - P8020-01
24. BURNER - D2559
25. DOOR - D3801
26. HANDLE - B9853
27. NAME PLATE - P9200-06
28. HINGE S.A. - B9848
29. TUBE HOLDER - B5065
30. WASHER - P8055-01
31. DOOR LINER - D3802
32. DOOR CATCH - P9300-02
33. DRAIN TUBE - B4841
34. BODY - C2750-1
35. SCREW - C2750-3
36. WASHER - P8055-02
37. PLUG - C2750-2
38. BAR - C7102-2
39. ROD - B9828
40. BAR - C7102-1
41. FLUE TOP - C7118
42. POT S.S.A. - E2905 - PLAIN STEEL
42. POT S.S.A. - E2905-1 - STAINLESS STEEL
43. SHROUD S.S.A. - D3788
44. SHROUD FRONT - C7106
45. CABINET S.A. - E2920
46. INSULATION - P9300-12
47. SEDIMENT TRAY - E1092-02
48. TWIN BASKETS - P9800-01
49. SINGLE BASKET - P9800-02
50. SPEC. PLATE - P9200-02
51. INSTRUCTION PLATE - P9200-05
52. LIGHTING INSTRUCTIONS - P9200-01
53. LEG - P9300-01
54. SCREW - P8015-01
55. SCREW - P8010-01
56. SCREW - P8015-04
57. SCREW - P8005-01
58. SCREW - P8015-03
59. PUSHNUT - P8050-01
60. DOOR - STAINLESS - D3801-01

SPECIFICATIONS SUBJECT TO CHANGE.

WHEN ORDERING PARTS, PLEASE STATE SERIAL NUMBER, MODEL NUMBER, ITEM NUMBER & DESCRIPTION.

ANETSBERGER BROTHERS, INC.

Northbrook, Illinois

Printed in U.S.A.

Form SP-7A