

# Hot Food Holding Cabinets

**300-S**

**(Units built before February 2026)**



## Manufacturer's Information

### Copyright

© Copyright 12/23 by Alto-Shaam, Inc.  
 All rights reserved.  
 This manual or any portion thereof may not be reproduced or used in any manner whatsoever without the express written permission of Alto-Shaam, Inc

### Trademarks

All trademarks referenced in this documentation are the property of their respective owners.

### Manufacturer

Alto-Shaam, Inc.  
 P.O. Box 450  
 W164 N9221 Water Street  
 Menomonee Falls, WI 53052

### Models Covered

<b>300-S</b>	Heated Holding Cabinets
--------------	-------------------------

### Serial Number

The unit serial number is required for identifying and ordering the correct service parts.  
 Record the unit serial number below for reference.

Serial Number

### Parts Finder Tool

Interactive diagrams from this Parts Manual are available online at our Parts Finder Tool:  
<https://www.alto-shaam.com/en/customer-support/parts>.  
 Or, scan the QR code below.



### Parts Ordering Information

Original manufacturer's replacement parts may be ordered directly from the Alto-Shaam network of Authorized Service Agents and Parts Distributors. Follow this link for a map to a local partner: <https://www.alto-shaam.com/en/how-to-buy>. If you are an Authorized Service Agent or Parts Distributor, please submit your purchase order to [parts@alto-shaam.com](mailto:parts@alto-shaam.com).

Non-OEM parts may be substituted; however, these parts must be of equal quality and specifications as those provided by Alto-Shaam.

## Table of Contents

Manufacturer's Information.....	2
Table of Contents .....	3
300-S Core Package, 120V Simple, Reach-In.....	4
300-S Core Package, 230V Simple, Reach-In.....	5
300-S Top Cover Assembly.....	6
300-S Chassis Assembly, Manual 120V.....	7
300-S Chassis Assembly, Simple (120V/230V).....	8
300-S Chassis Assembly, Simple (208/240V).....	9
300-S Chassis Assembly, Simple 230V.....	10
300-S Chassis Assembly, Manual 230V.....	11
300-S Chassis Assembly, Deluxe 230V.....	12
300-S Slab Door Package "A", RH.....	13
300-S Slab Door Package "B", LH.....	14
Control Assembly, Deluxe w/Timer.....	15
Control Assembly, Deluxe w/Probe.....	16
Cordset/Ferrule Assembly, NEMA 5-20P.....	17
Cordset/Ferrule Assembly, NEMA 5-15P.....	18
Cord, 12/3 with Ferrules, 12'.....	19
Cordset/Ferrule Assembly, SAA AS 3112-16P.....	20
Cordset Assembly, AS/NZS 3112.....	21
Cordset Assembly, AS/NZS 3112 2000.....	22
Cordset/Ferrule Assembly, NEMA 6-15P.....	23
Cordset/Ferrule Assembly, CEE-7/7.....	24
Cordset/Ferrule Assembly, BS 1363.....	25
Caster Package, 2-1/2".....	26
Caster Package, 3-1/2".....	27
Caster Package, 5".....	28
Caster Package, 5" (all swivel).....	29

## 300-S Core Package, 120V Simple, Reach-In

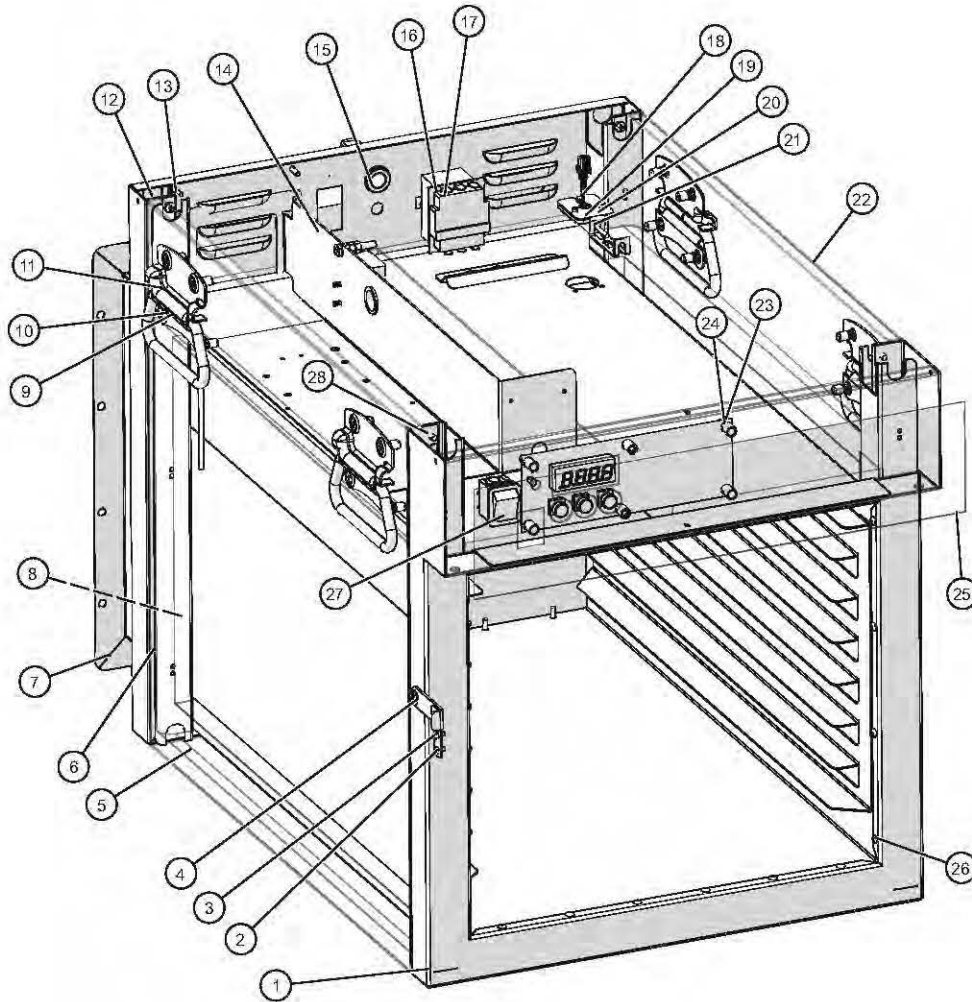

ID	Part No.	Description	Qty
1	5015054	CAVITY PKG "B" SIMPLE R/I 120V	1
2	SC-22266	SCREW,M3x0.5X6MM PAN	2
3	1013809	DOOR LATCH, RECEIVER	1
4	1013808	DOOR LATCH, SWING ARM	1
5	5034502	CASING, OUTER, ASSEMBLY	1
6	RI-2100	RIVET, BLIND, #44, STNLS	6
7	1013472	INNER TUBE BACK 300-S	1
8	1037695	INSULATION, .50 X 13.57 X 10.52	1
9	NU-37268	NUT, HEX INSERT M5	16
10	SC-22281	SCREW, M5x0.8X16MM FLAT	16
11	HD-2021	HANDLE, CHEST	3
12	5034503	TRIM, REAR, ASSEMBLY	1
13	RI-27108	RIVET, SEALED	4
14	5015058	300-S 120V/230V SMPL, ELEC CH.	1
15	BU-34898	BUSHING, STRAIN RELIEF, 90°, BLK	1
16	1003936	HI-LIMIT PROTECTION COVER	1
17	TT-33476	THERMOSTAT, 300F HI-LIMIT	1
18	SN-47162	SENSOR, 1000 OHM, 40" WIRE,	1
19	BK-29605	BLOCK, SENSOR, ELEC. CONTROL	1
20	SC-22271	SCREW, PAN HEAD M4 X 7MM	4
21	1493	GUARD SENSOR, W/MW	1
22	1012830	300-S OUTER CASING	1
23	NU-2361	NUT, 6-32 HEX, S/S	4
24	WS-23148	WASHER, 6-32, FLAT, NYL	4
25	PE-47889	OVERLAY, DISPLAY, SIMPLE	1
26	RI-38125	RIVET, SEALED, .125"	32
27	SW-38665	SWITCH, ROCKER, DPST, 20A, 125V,	1
28	SC-22273	SCREW, M4x0.7X10MM PAN	4

## 300-S Core Package, 230V Simple, Reach-In

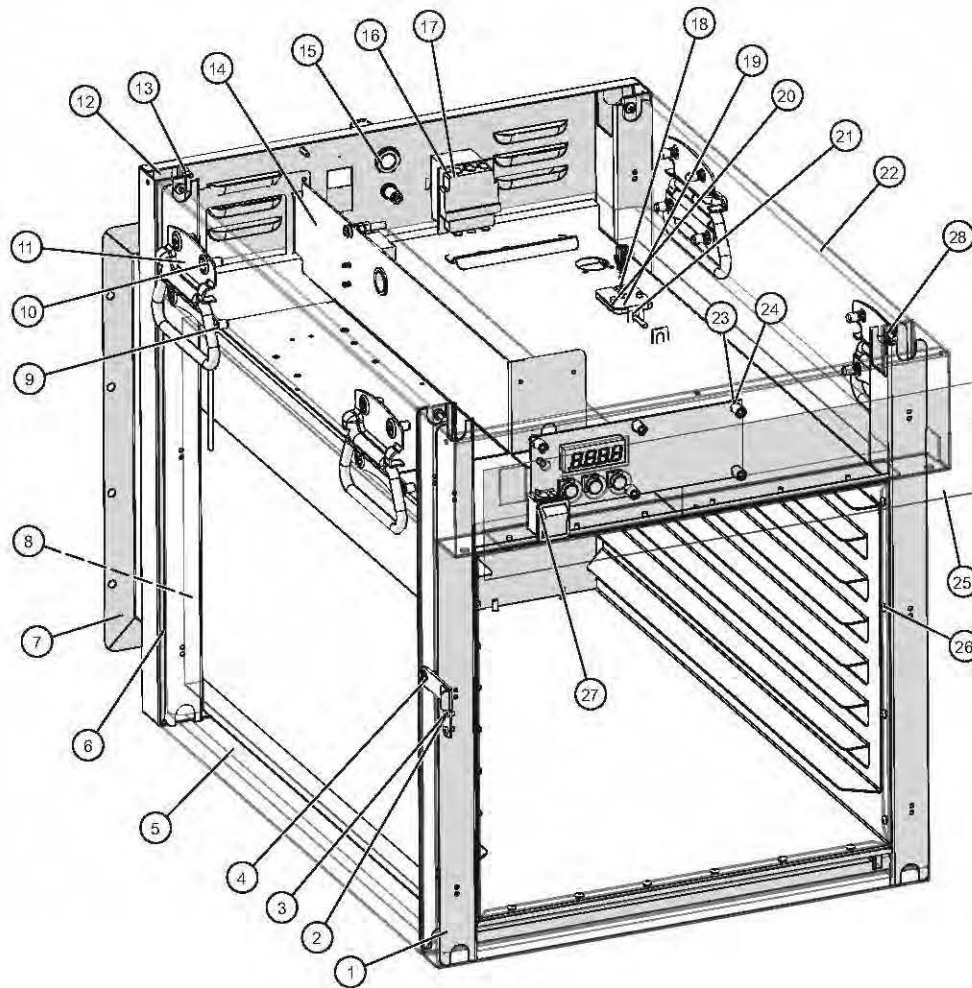

ID	Part No.	Description	Qty
1	5015053	CAVITY PKG "A" SIMPLE R/I 230V	1
2	SC-22266	SCREW,M3x0.5X6MM PAN	2
3	1013809	DOOR LATCH, RECEIVER	1
4	1013808	DOOR LATCH, SWING ARM	1
5	5034502	CASING, OUTER, ASSEMBLY	1
6	RI-2100	RIVET, BLIND, #44, STNLS	6
7	1013472	INNER TUBE BACK 300-S	1
8	1037695	INSULATION, .50 X 13.57 X 10.52	1
9	NU-37268	NUT, HEX INSERT M5	16
10	SC-22281	SCREW, M5x0.8X16MM FLAT	16
11	HD-2021	HANDLE, CHEST	3
12	5034503	TRIM, REAR, ASSEMBLY	1
13	RI-27108	RIVET, SEALED	4
14	5015058	300-S 120V/230V SMPL, ELEC CH.	1
15	BU-34898	BUSHING, STRAIN RELIEF, 90°, BLK	1
16	1003936	HI-LIMIT PROTECTION COVER	1
17	TT-33476	THERMOSTAT, 300F HI-LIMIT	1
18	SN-47162	SENSOR, 1000 OHM, 40" WIRE,	1
19	BK-29605	BLOCK, SENSOR, ELEC. CONTROL	1
20	SC-22271	SCREW, PAN HEAD M4 X 7MM	4
21	1493	GUARD SENSOR, W/MW	1
22	1012830	300-S OUTER CASING	1
23	NU-2361	NUT, 6-32 HEX, S/S	4
24	WS-23148	WASHER, 6-32, FLAT, NYL	4
25	PE-47889	OVERLAY, DISPLAY, SIMPLE	1
26	RI-38125	RIVET, SEALED, .125"	32
27	SW-38665	SWITCH, ROCKER, DPST, 20A, 125V,	1
28	SC-22273	SCREW, M4x0.7X10MM PAN	2

## 300-S Top Cover Assembly

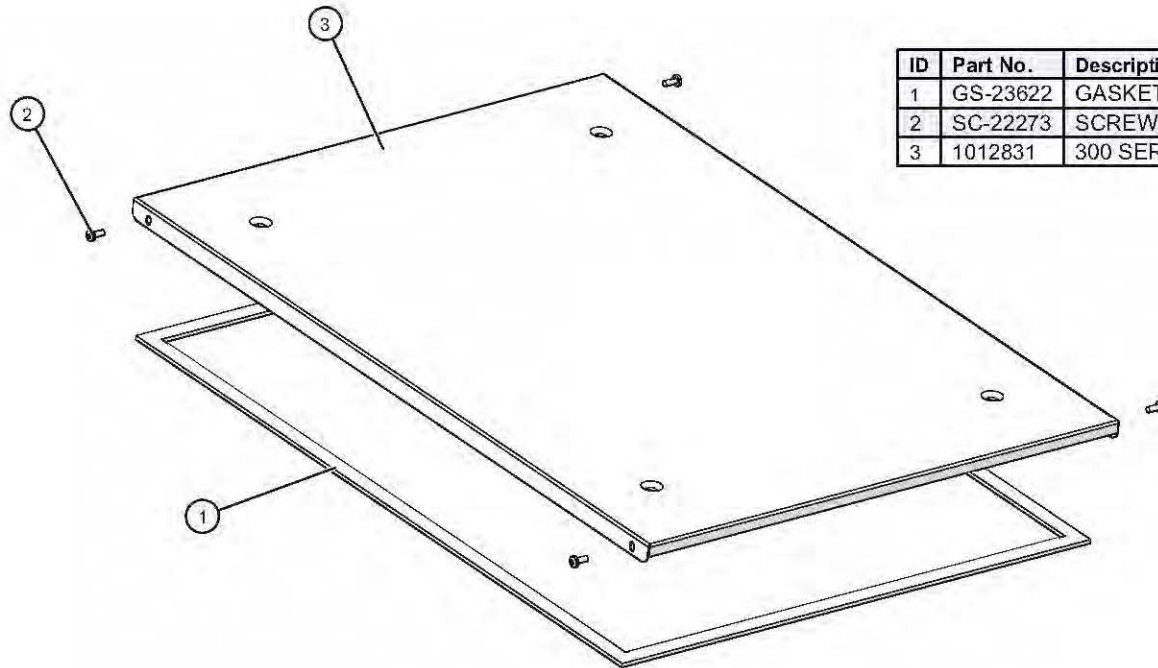

ID	Part No.	Description	Qty
1	GS-23622	GASKET, ADHESIVE, 0.125" X 0.375" X 78"	1
2	SC-22273	SCREW, M4x0.7X10MM PAN	4
3	1012831	300 SERIES TOP COVER	1

# 300-S Chassis Assembly, Manual 120V

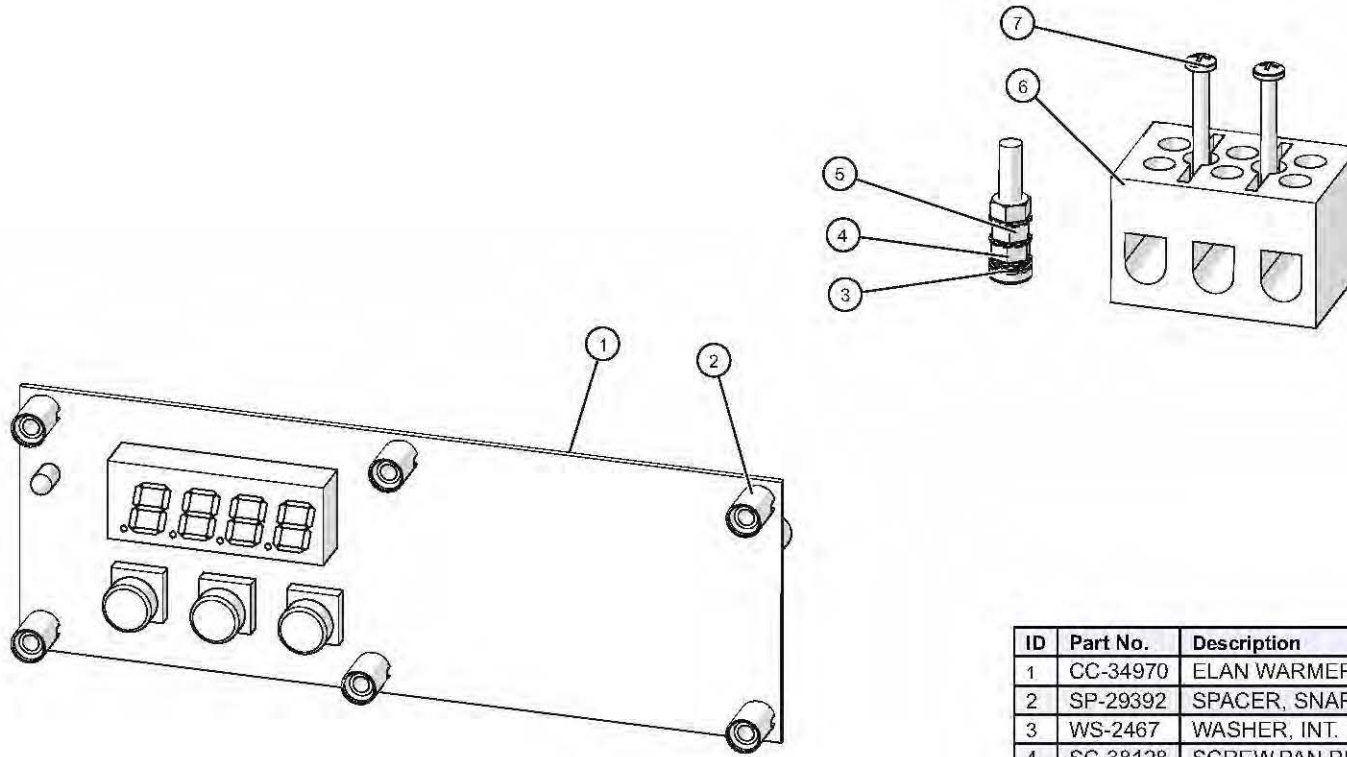

ID	Part No.	Description	Qty
1	CC-34970	ELAN WARMER CONTROL	1
2	SP-29392	SPACER, SNAP-IN, 7/16"	6
3	WS-2467	WASHER, INT. LOCK	1
4	SC-38128	SCREW,PAN PH, METRIC, M5	1
5	NU-36234	NUT, M5, KEPS	3
6	BK-3019	T-BLOCK	1
7	SC-47136	SCREW,6-32X1-1/2" PAN	2

## 300-S Chassis Assembly, Simple (120V/230V)

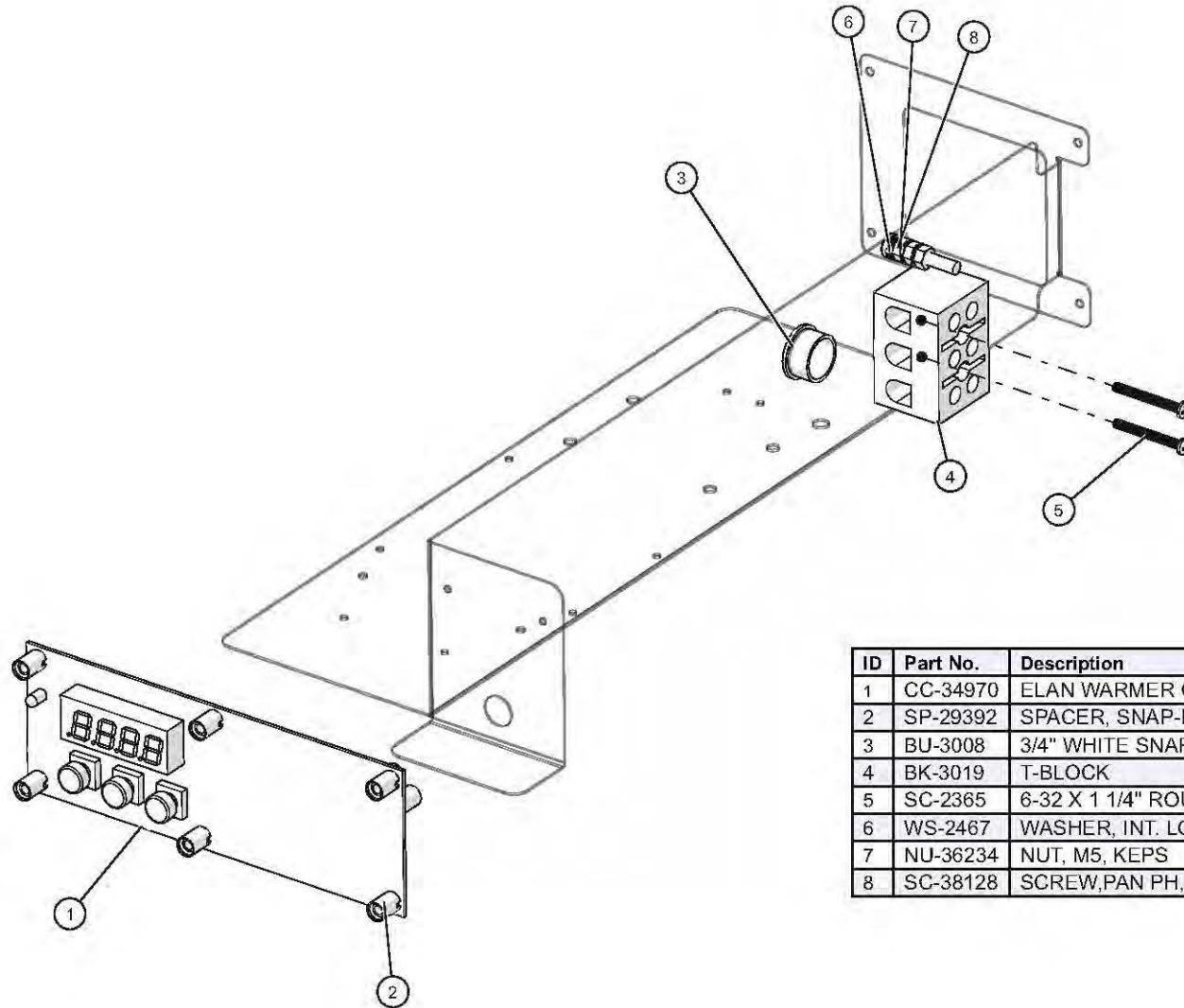

ID	Part No.	Description	Qty
1	CC-34970	ELAN WARMER CONTROL	1
2	SP-29392	SPACER, SNAP-IN, 7/16"	6
3	BU-3008	3/4" WHITE SNAP BUSHING	1
4	BK-3019	T-BLOCK	1
5	SC-2365	6-32 X 1 1/4" ROUND HD	2
6	WS-2467	WASHER, INT. LOCK	1
7	NU-36234	NUT, M5, KEPS	3
8	SC-38128	SCREW,PAN PH, METRIC, M5	1

## 300-S Chassis Assembly, Simple (208/240V)

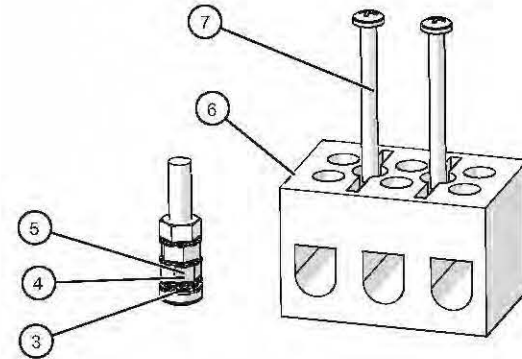
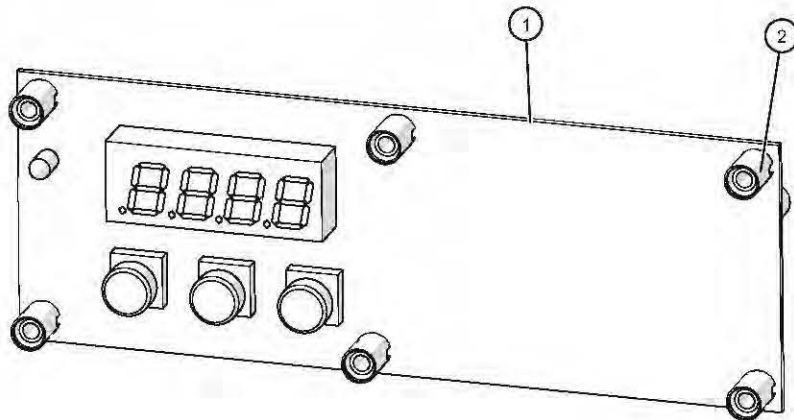

ID	Part No.	Description	Qty
1	CC-34970	ELAN WARMER CONTROL	1
2	SP-29392	SPACER, SNAP-IN, 7/16"	6
3	WS-2467	WASHER, INT. LOCK	1
4	SC-38128	SCREW,PAN PH, METRIC, M5	1
5	NU-36234	NUT, M5, KEPS	3
6	BK-3019	T-BLOCK	1
7	SC-47136	SCREW,6-32X1-1/2" PAN	2

## 300-S Chassis Assembly, Simple 230V

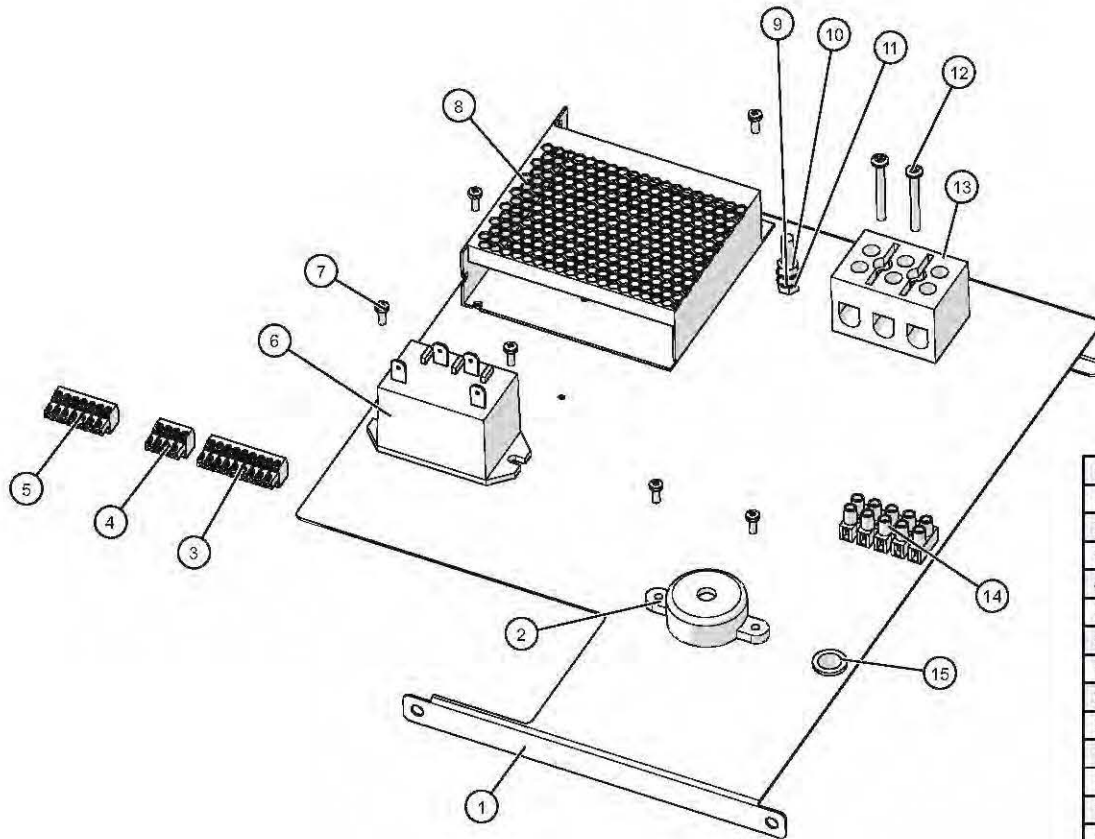

ID	Part No.	Description	Qty
1	1011531	WARMER SERIES ELEC CHASSIS	1
2	BP-3567	BEEPER, SOLID STATE, 1.5-20V	1
3	CR-33718	CONNECTOR 9 PIN	1
4	CR-33763	CONNECTOR 4 PIN	1
5	CR-33761	CONNECTOR, 7 PIN	1
6	RL-33558	RELAY, SPST 30A @ 277 VAC 12VDC	1
7	SC-22268	SCREW,M3x0.5X8MM PAN	6
8	BA-38586	BOARD, POWER SUPPLY, 12V	1
9	SC-38128	SCREW,PAN PH, METRIC, M5	1
10	NU-36234	NUT, M5, KEPS	3
11	WS-2467	WASHER, INT. LOCK	1
12	SC-2365	SCREW,6-32X1-1/4,NC PHILLIPS	2
13	BK-3019	T-BLOCK	1
14	TM-33560	TERMINAL,STRIP,5CIRCUIT,UL,VDE	1
15	BU-3006	1/2" HOLE BUSHING	1

# 300-S Chassis Assembly, Manual 230V

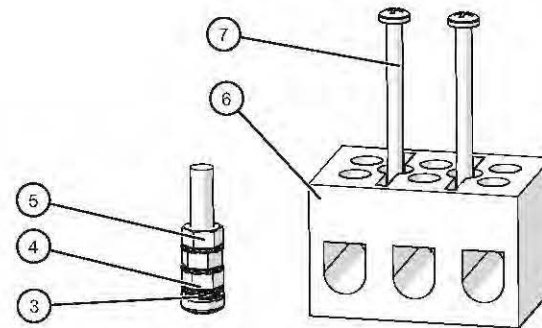
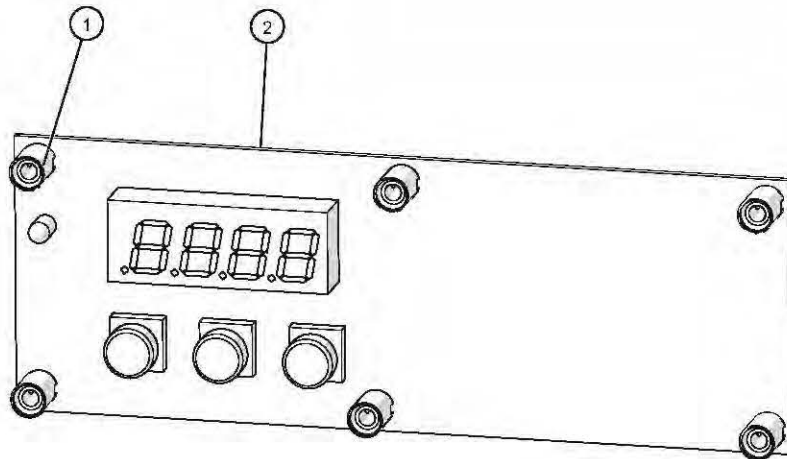

ID	Part No.	Description	Qty
1	SP-29392	SPACER, SNAP-IN, 7/16"	6
2	CC-34970	ELAN WARMER CONTROL	1
3	WS-2467	WASHER, INT. LOCK	1
4	SC-38128	SCREW,PAN PH, METRIC, M5	1
5	NU-36234	NUT, M5, KEPS	3
6	BK-3019	T-BLOCK	1
7	SC-47136	SCREW,6-32X1-1/2" PAN	2

## 300-S Chassis Assembly, Deluxe 230V

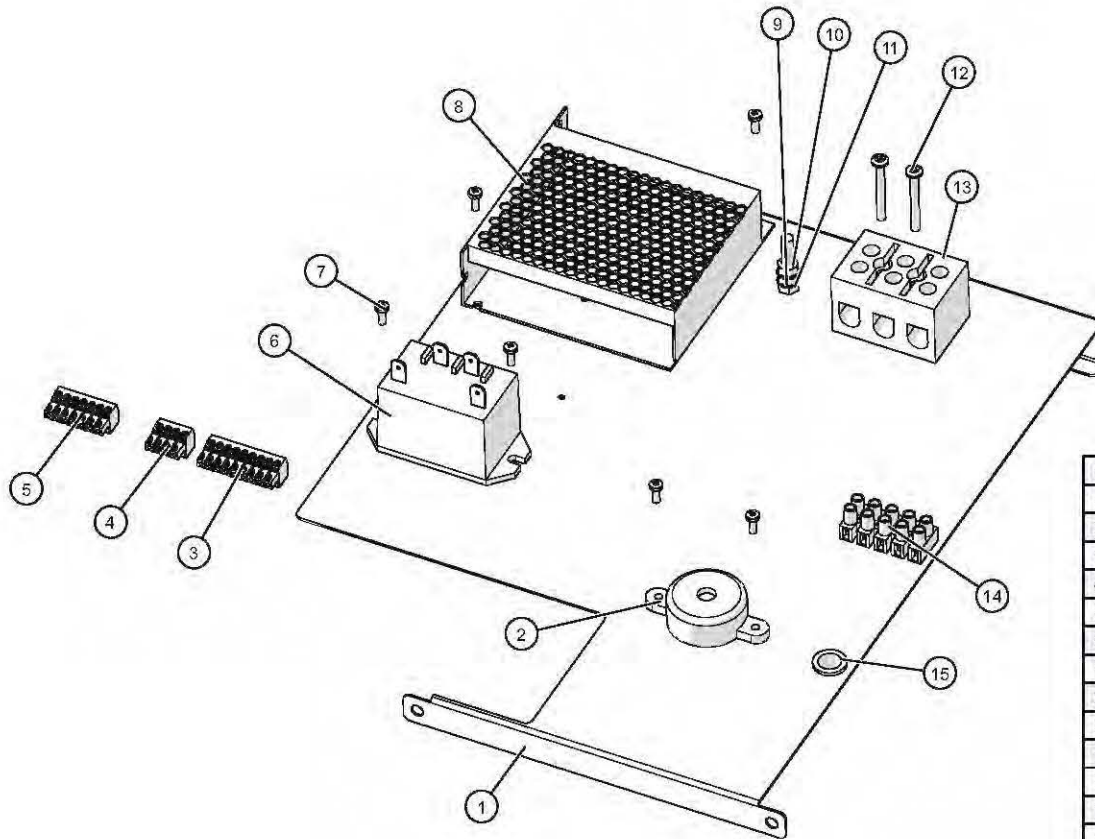

ID	Part No.	Description	Qty
1	1011531	WARMER SERIES ELEC CHASSIS	1
2	BP-3567	BEEPER, SOLID STATE, 1.5-20V	1
3	CR-33718	CONNECTOR 9 PIN	1
4	CR-33763	CONNECTOR 4 PIN	1
5	CR-33761	CONNECTOR, 7 PIN	1
6	RL-33558	RELAY, SPST 30A @ 277 VAC 12VDC	1
7	SC-22268	SCREW,M3x0.5X8MM PAN	6
8	BA-38586	BOARD, POWER SUPPLY, 12V	1
9	SC-38128	SCREW,PAN PH, METRIC, M5	1
10	NU-36234	NUT, M5, KEPS	3
11	WS-2467	WASHER, INT. LOCK	1
12	SC-2365	SCREW,6-32X1-1/4,NC PHILLIPS	2
13	BK-3019	T-BLOCK	1
14	TM-33560	TERMINAL,STRIP,5CIRCUIT,UL,VDE	1
15	BU-3006	1/2" HOLE BUSHING	1

## 300-S Slab Door Package "A", RH

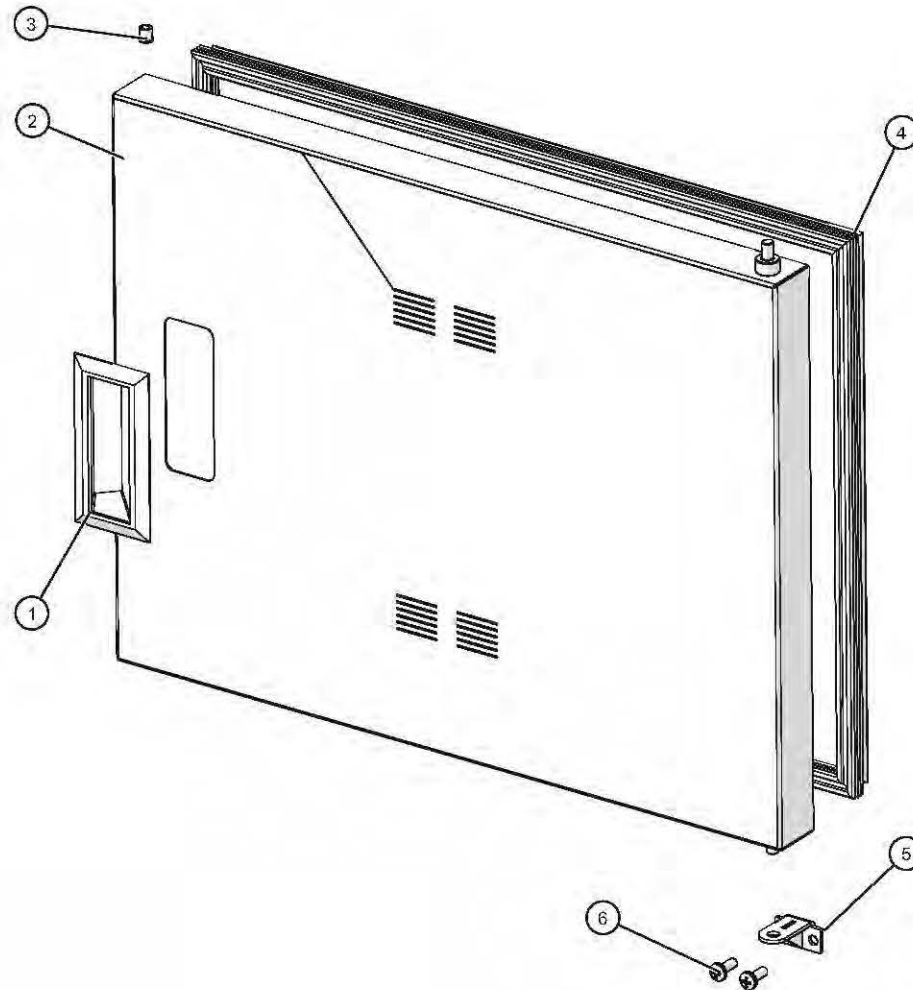

ID	Part No.	Description	Qty
1	HD-28789	HANDLE, PULL RECESSED, BLACK	1
2	5014458	DOOR, ASSY, SLAB, RH, 300-S	1
3	PG-35411	1/4" HOLE PLUG	1
4	GS-35092	GASKET, DOOR, GREY, 300-TH,	1
5	5021070	300-TH, RH BOTTOM HINGE WELD	1
6	SC-2070	SCREW, 10-32 X 1/2" PAN	2

## 300-S Slab Door Package "B", LH

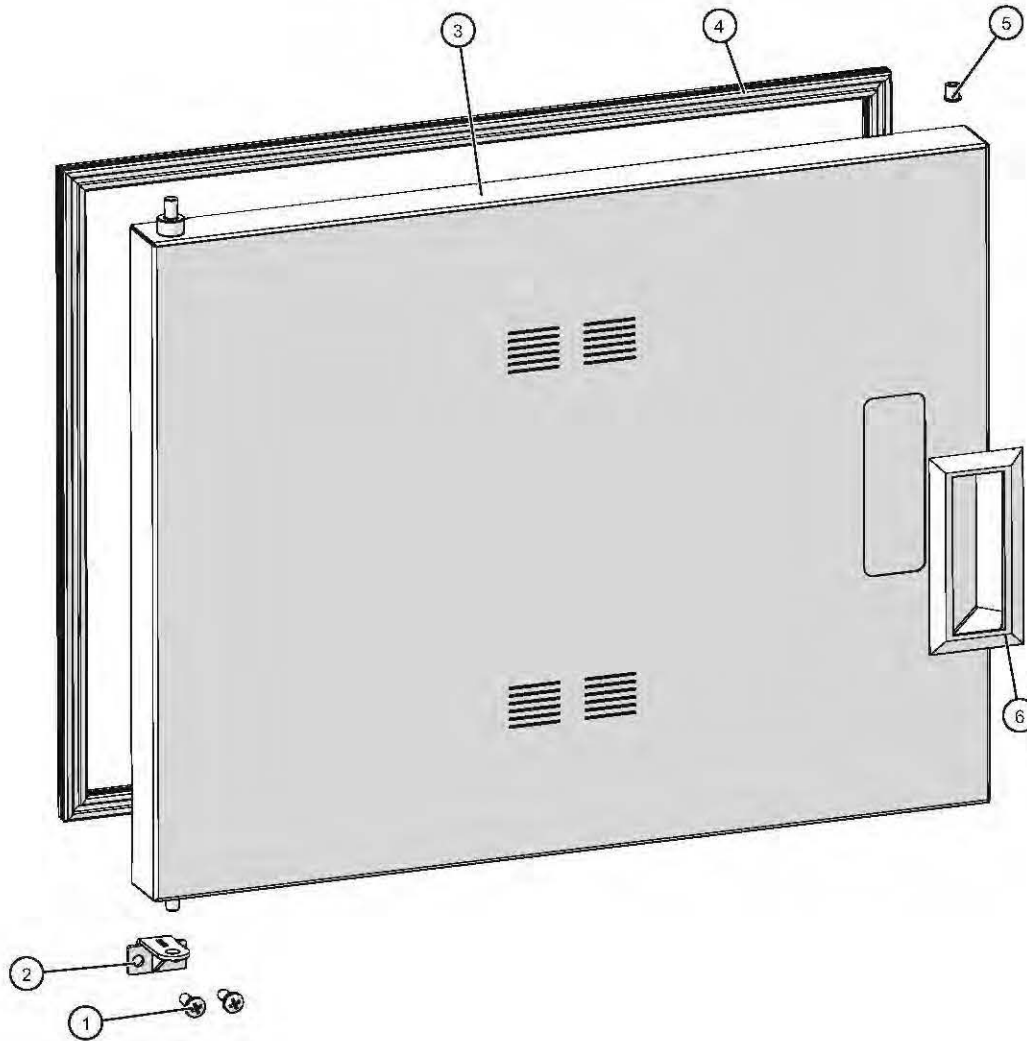

ID	Part No.	Description	Qty
1	SC-2070	SCREW, 10-32 X 1/2" PAN	2
2	5022273	300-TH, LH BOTTOM HINGE WELD	1
3	5014850	DOOR, ASSY, SLAB, LH	1
4	GS-35092	GASKET, DOOR, GREY, 300-TH,	1
5	PG-35411	1/4" HOLE PLUG	1
6	HD-28789	HANDLE, PULL RECESSED, BLACK	1

## Control Assembly, Deluxe w/Timer

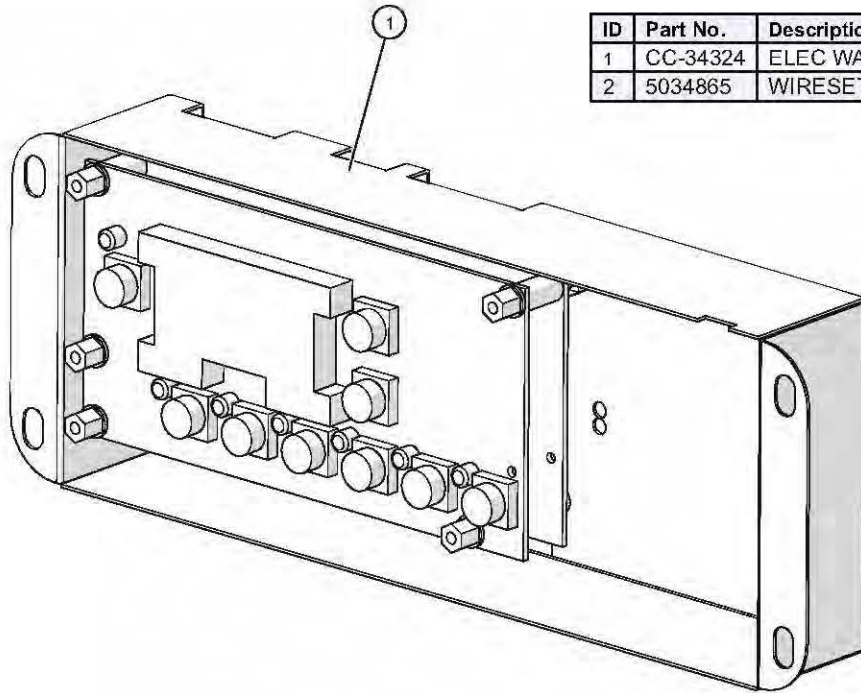

ID	Part No.	Description	Qty
1	CC-34324	ELEC WARMER CONTROL W/ TIMER	1
2	5034865	WIRESET, SINGLE CAVITY WARMER (not shown)	1

## Control Assembly, Deluxe w/Probe

ID	Part No.	Description	Qty
1	5012946	SINGLE WARMER CONTROL	1
2	5034866	WIRESET, SINGLE CAVITY WARMER (not shown)	1

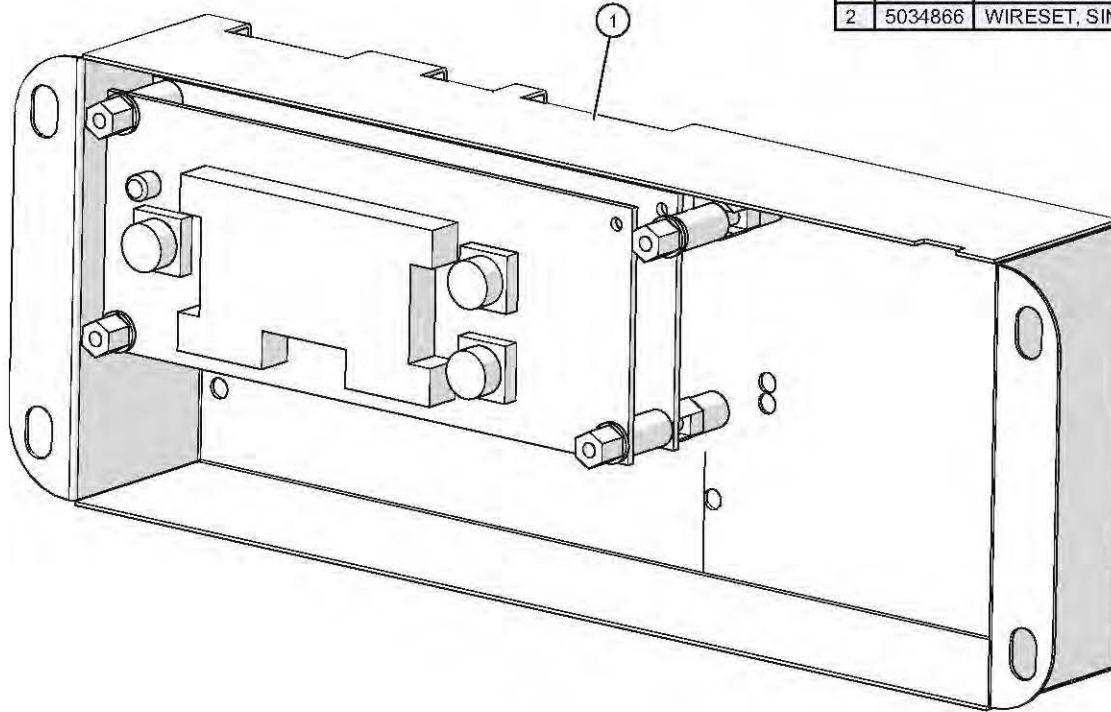

## Cordset/Ferrule Assembly, NEMA 5-20P

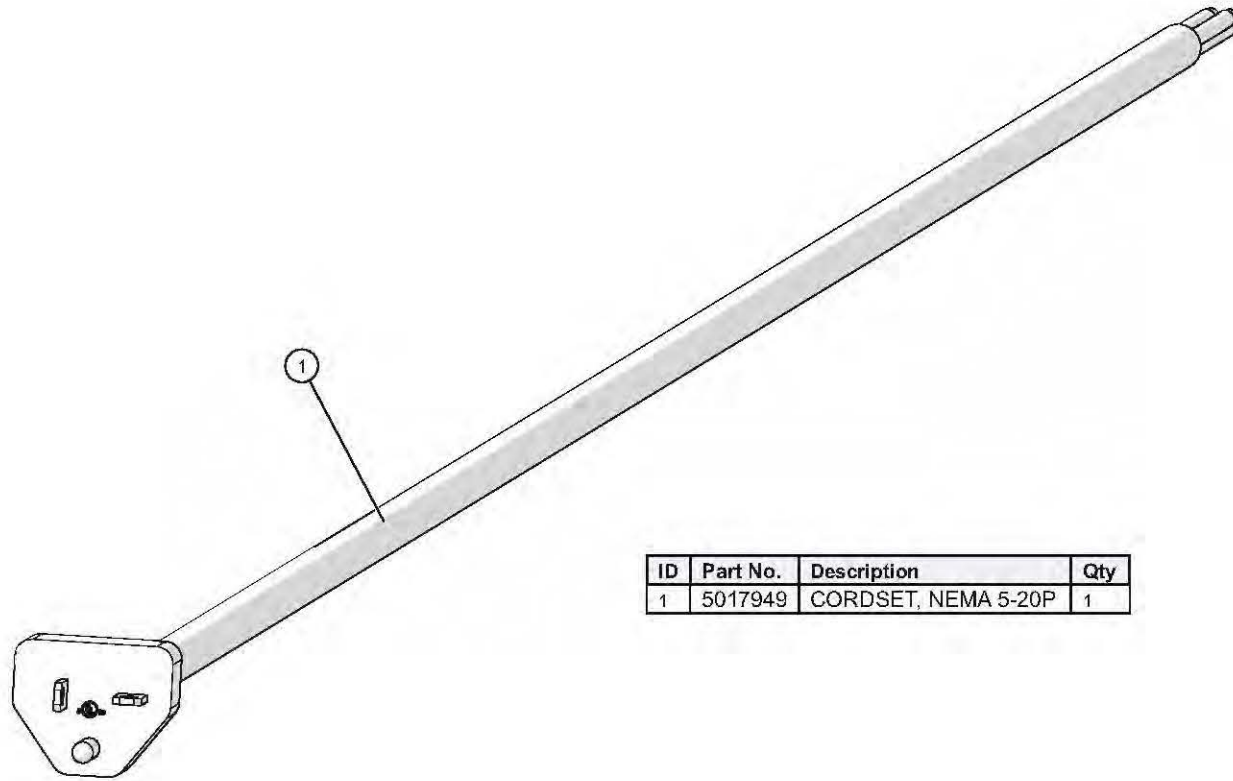

ID	Part No.	Description	Qty
1	5017949	CORDSET, NEMA 5-20P	1

## Cordset/Ferrule Assembly, NEMA 5-15P

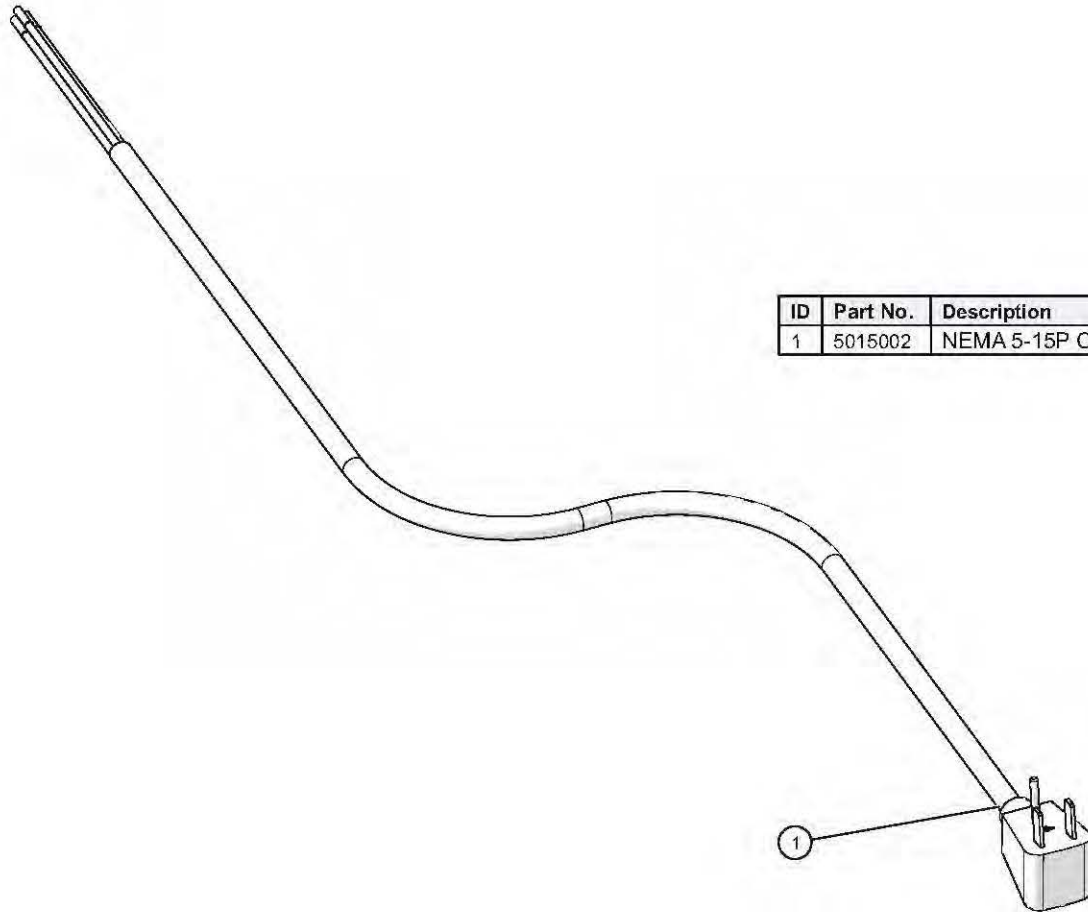

ID	Part No.	Description
1	5015002	NEMA 5-15P CORDSET FERRULE ASSEMBLY

### Cord, 12/3 with Ferrules, 12'

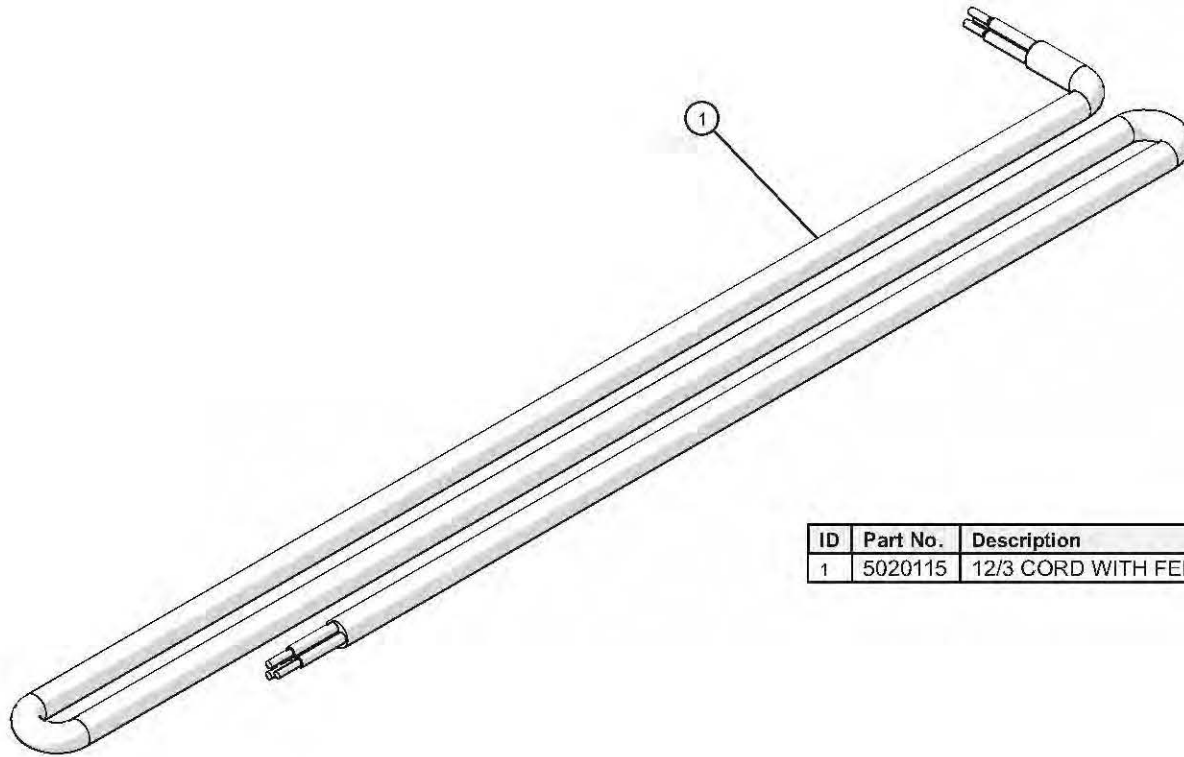

ID	Part No.	Description	Qty
1	5020115	12/3 CORD WITH FERRULES, 12'	1

## Cordset/Ferrule Assembly, SAA AS 3112-16P

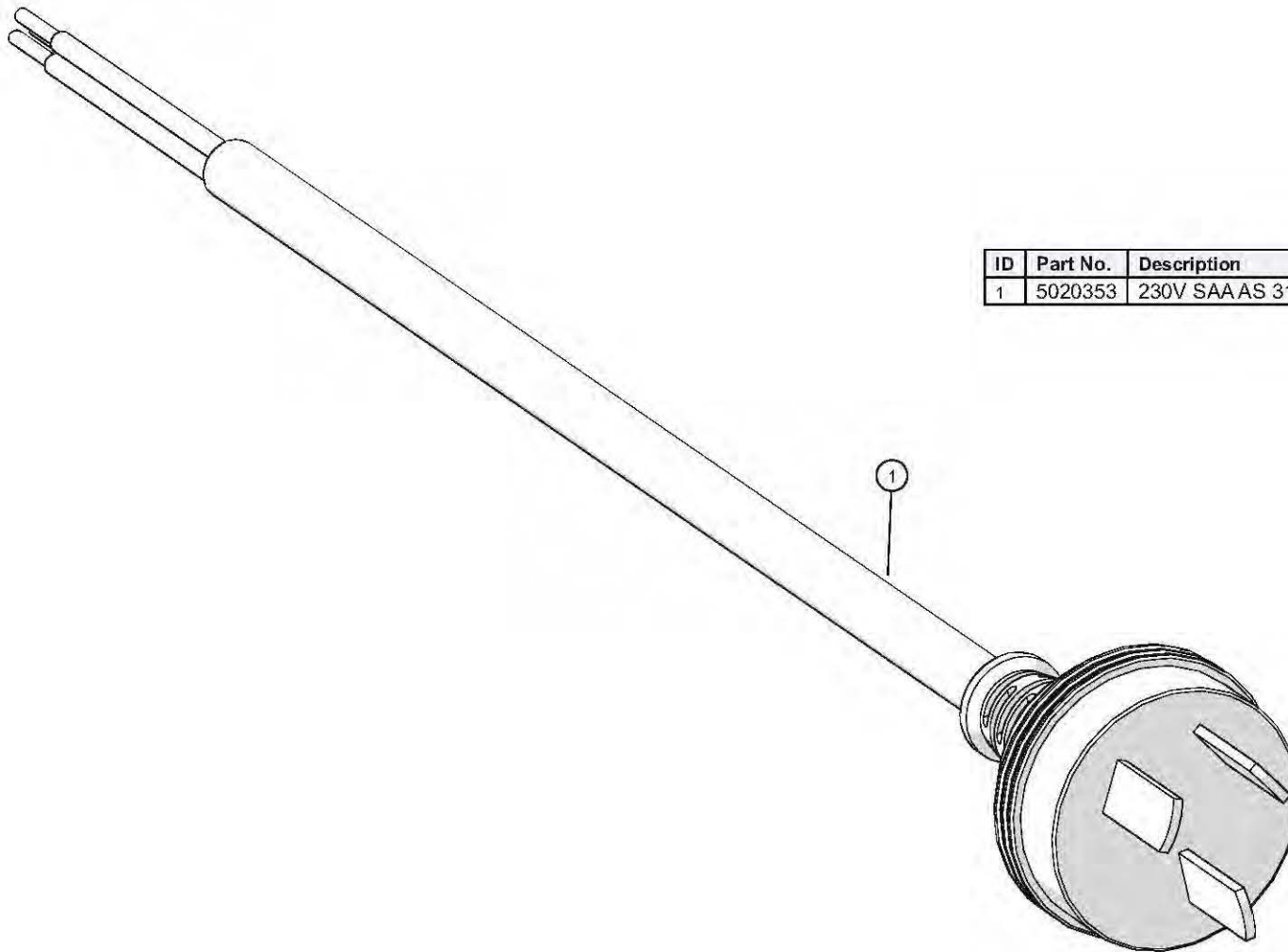

ID	Part No.	Description	Qty
1	5020353	230V SAA AS 3112-16P CORDSET	1

## Cordset Assembly, AS/NZS 3112

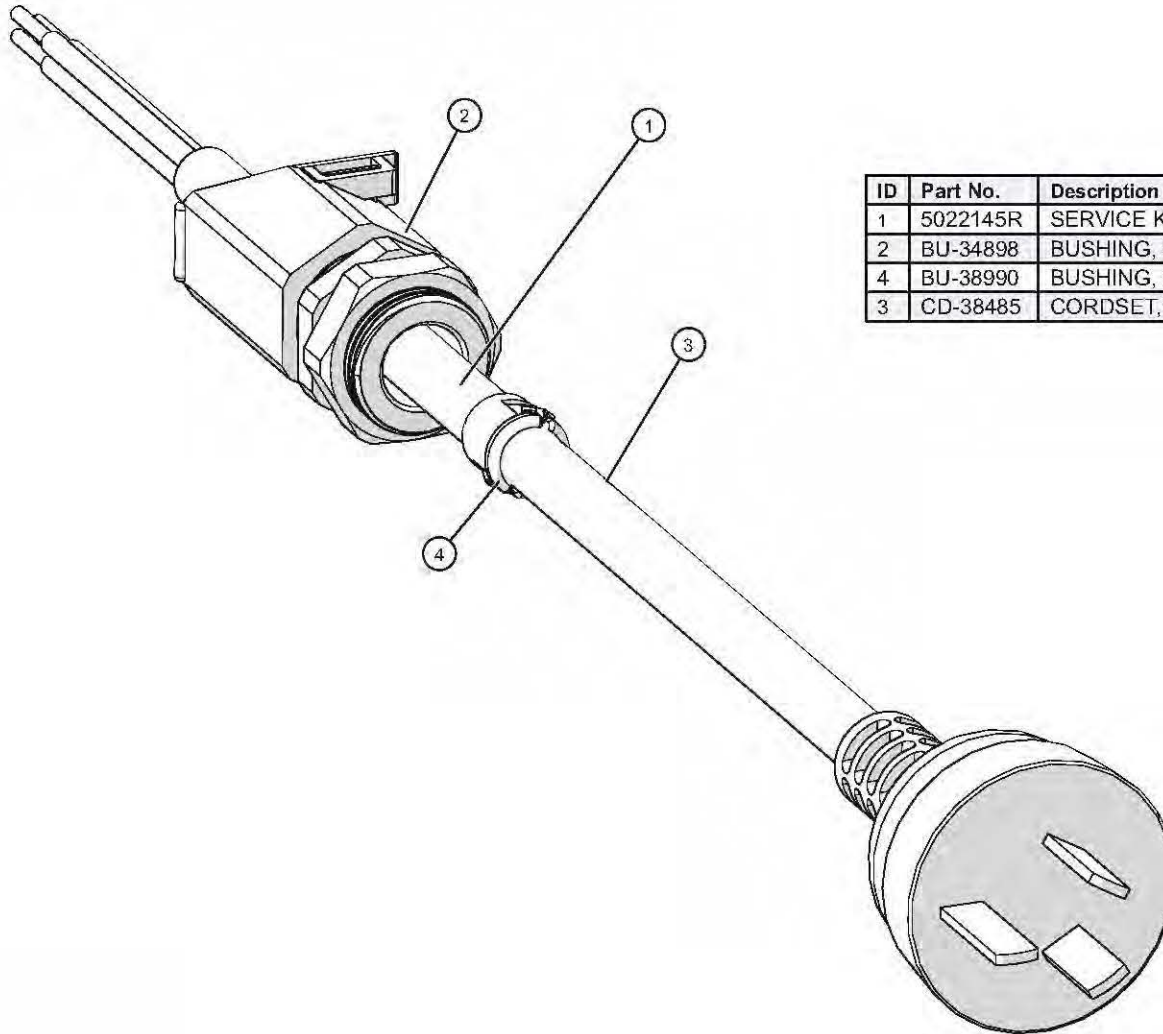

ID	Part No.	Description	Qty
1	5022145R	SERVICE KIT, CORDSET,10A-250V	1
2	BU-34898	BUSHING, STRAIN RELIEF, 90°, BLK	1
4	BU-38990	BUSHING, SNUB, 3/16" CABLE	1
3	CD-38485	CORDSET,10A-250V	1

## Cordset Assembly, AS/NZS 3112 2000

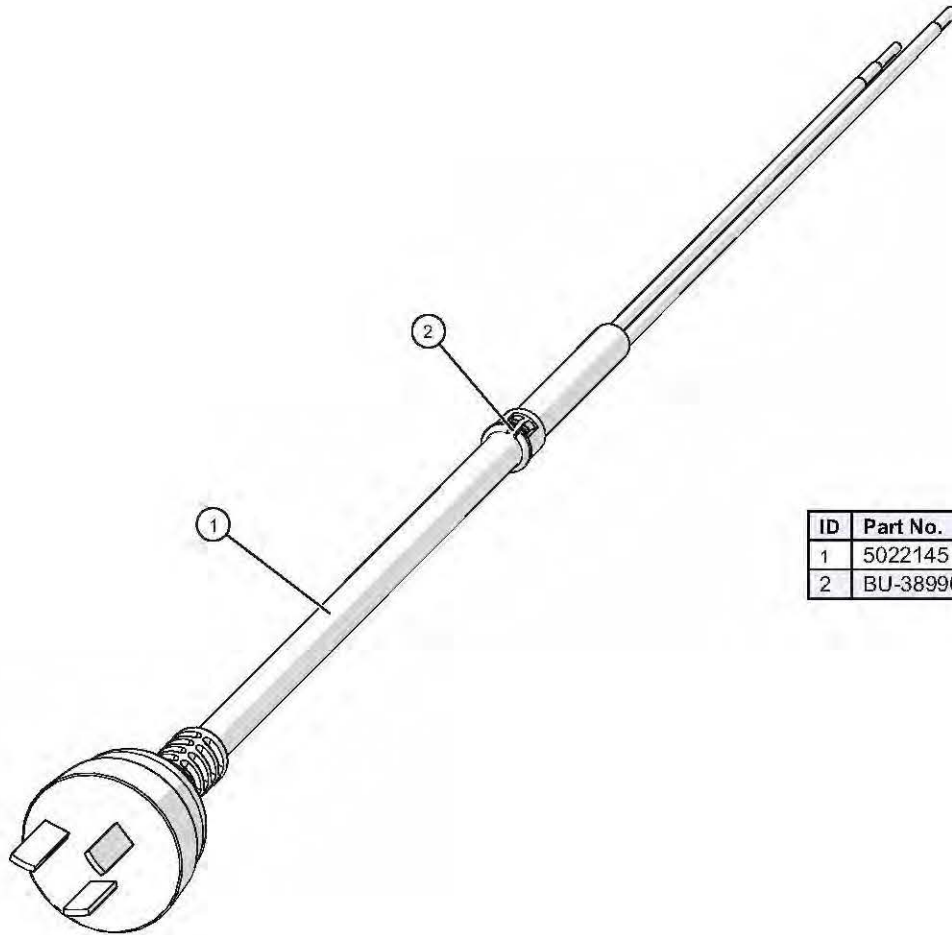

ID	Part No.	Description	Qty
1	5022145	CORDSET,10A-250V,AS/NZS 3112:2000	1
2	BU-38990	BUSHING, SNUB, 3/16" CABLE	1

# Cordset/Ferrule Assembly, NEMA 6-15P

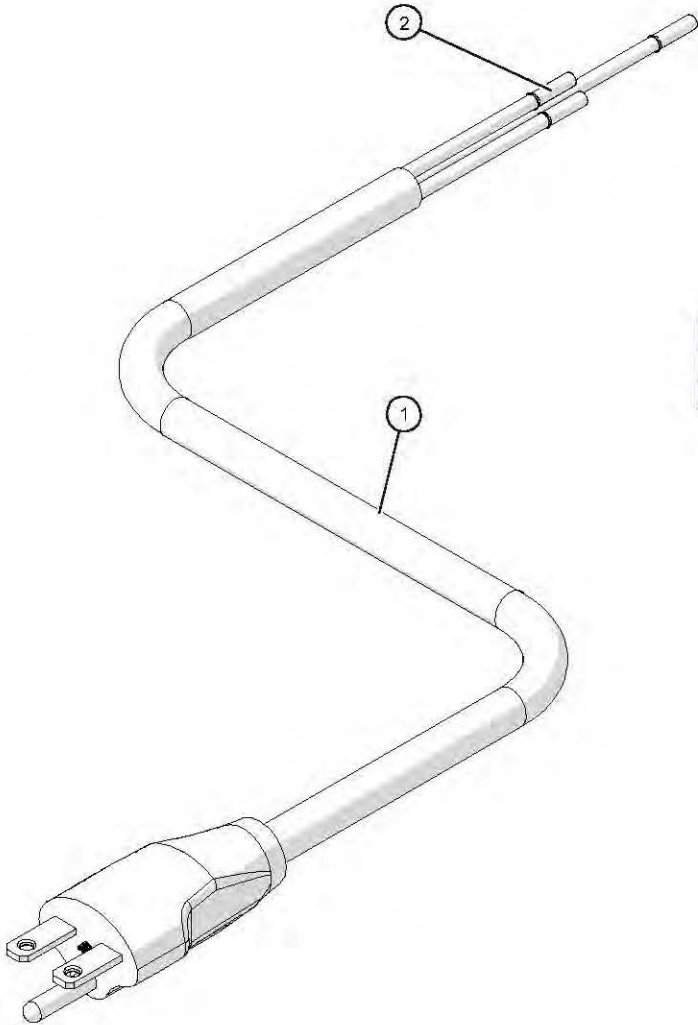

ID	Part No.	Description
1	CD-3551	CORDSET, 14/3 SJTO, 250V
2	CR-34829	CONNECTOR, #14 FERRULE

## Cordset/Ferrule Assembly, CEE-7/7

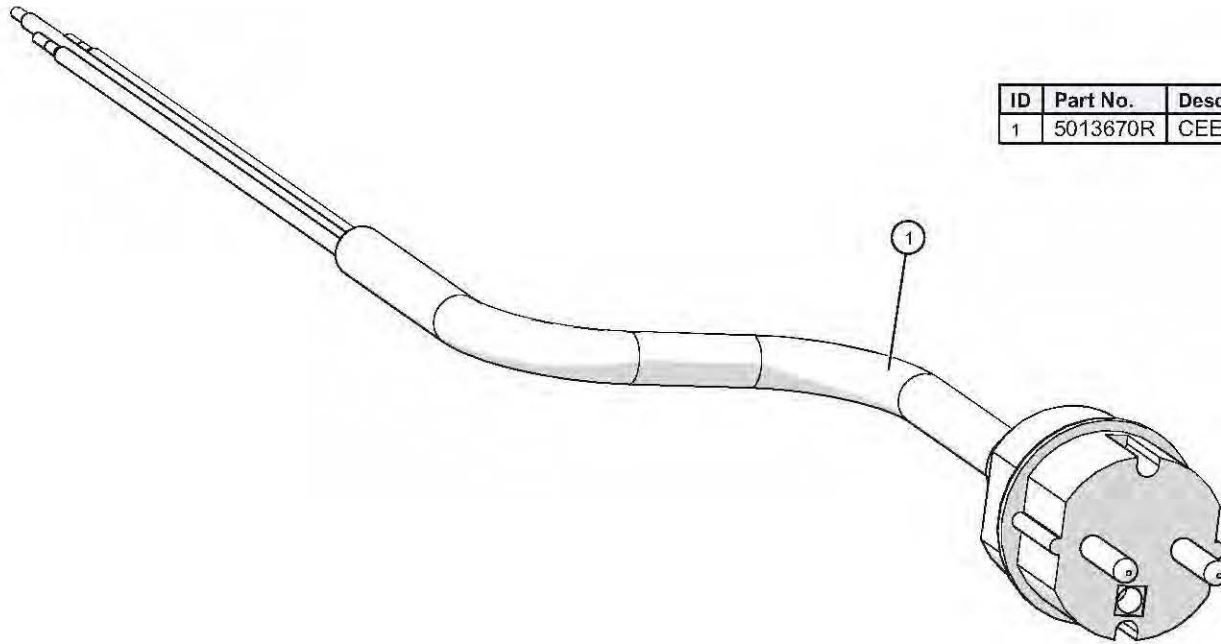

ID	Part No.	Description	Qty
1	5013670R	CEE 7/7 CORDSET FERRULE ASSEMB	1

## Cordset/Ferrule Assembly, BS 1363

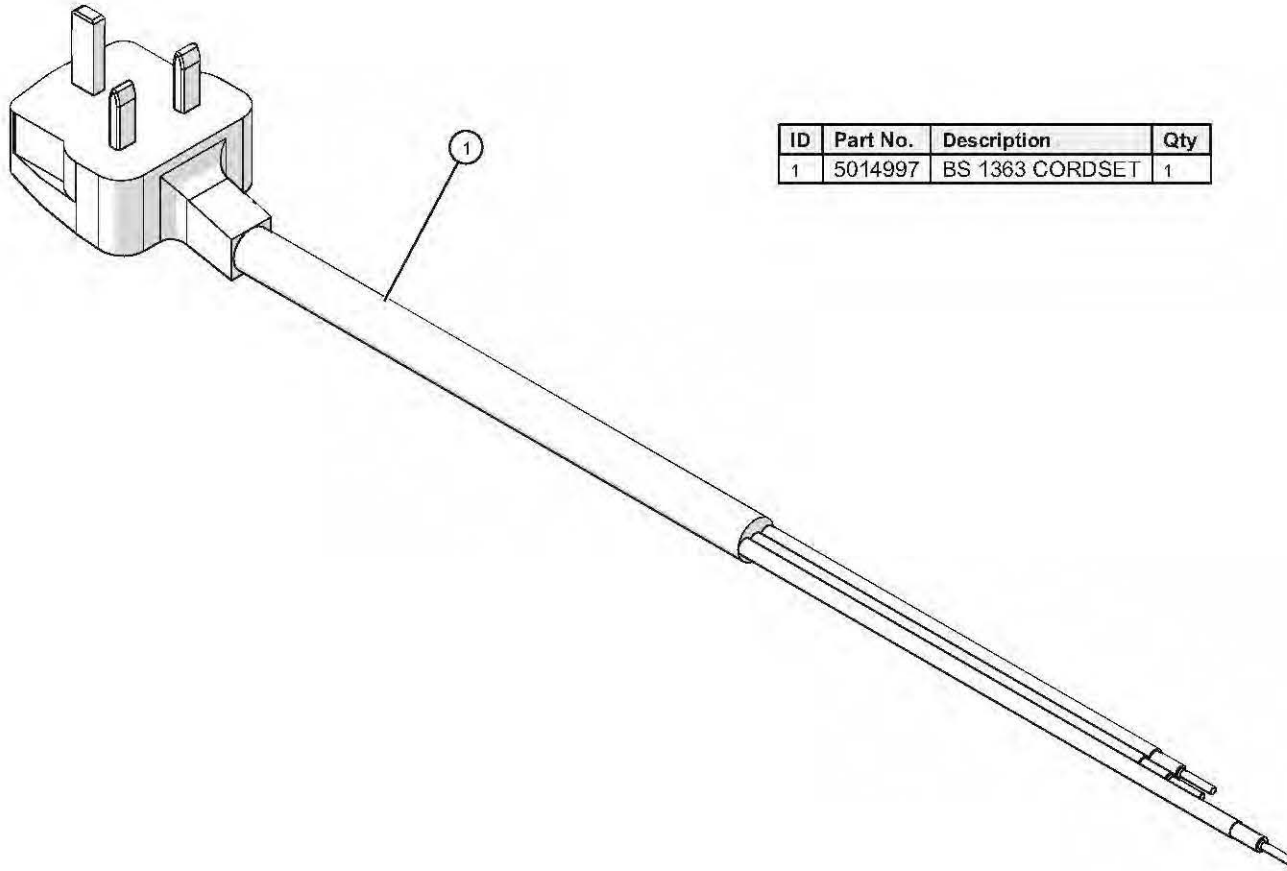

ID	Part No.	Description	Qty
1	5014997	BS 1363 CORDSET	1

# Caster Package, 2-1/2"

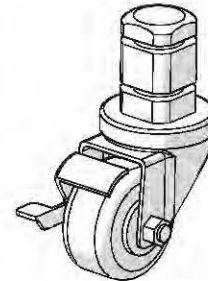
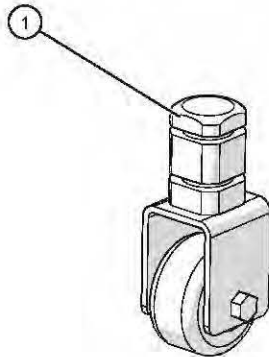
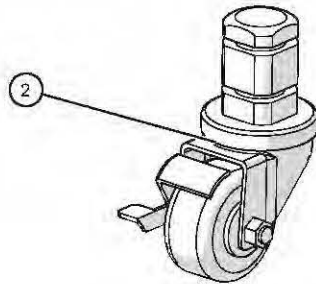

ID	Part No.	Description	Qty
1	CS-38265	CASTER, RIGID 2.5", 1.5" STEM	2
2	CS-38264	CASTER, SWIVEL 2.5", 1.5" STEM	2

# Caster Package, 3-1/2"

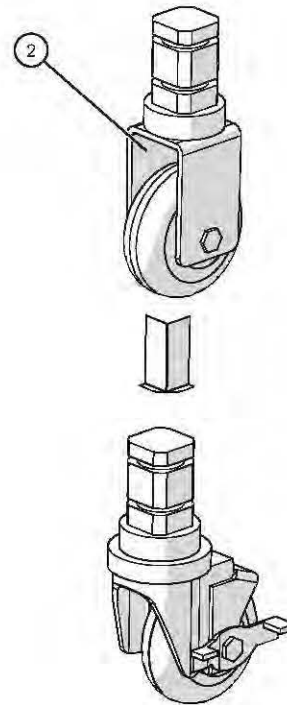
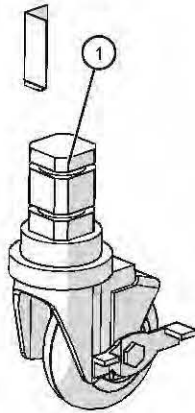

ID	Part No.	Description	Qty
1	CS-25675	CASTER, 3 1/2" SWIVEL W/ BRAKE	2
2	CS-25674	CASTER, 3 1/2" RIGID	2
3	1012735	CASTER SHIM	4



# Caster Package, 5"

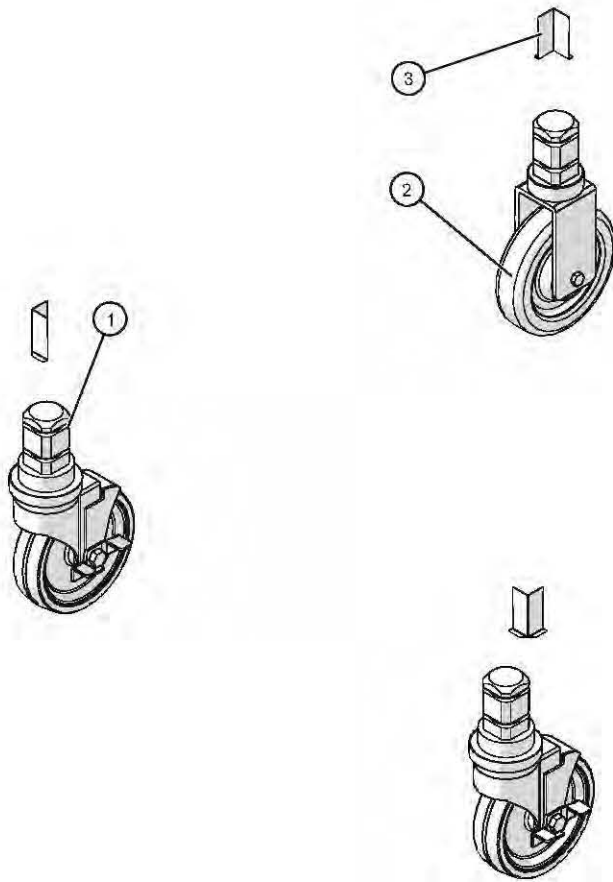

ID	Part No.	Description	Qty
1	CS-24875	CASTER, 1.5" STEM, 5" SWIV WHL	2
2	CS-24874	CASTER, 5" RIGID, 1.5" STEM	2
3	1012735	CASTER SHIM	4

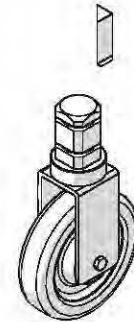

# Caster Package, 5" (all swivel)

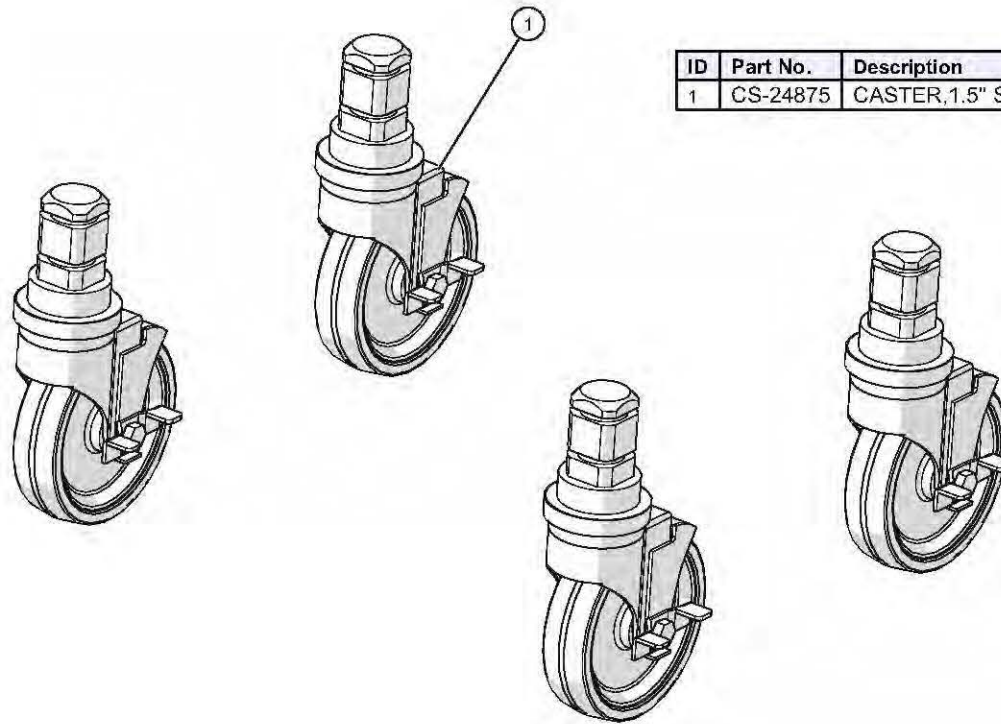

ID	Part No.	Description
1	CS-24875	CASTER, 1.5" STEM, 5" SWIV WHL

## Leg Package, 6"

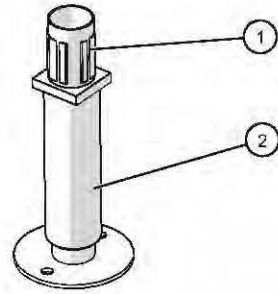

ID	Part No.	Description	Qty
2	LG-23067	6" LEG W/ ADJUSTABLE FLANGED FOOT	4
1	LG-37094	LEG, ADJUST, FOOTING	4

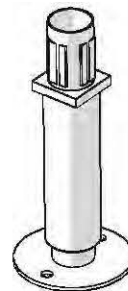
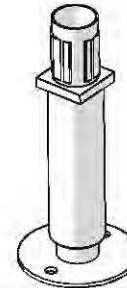
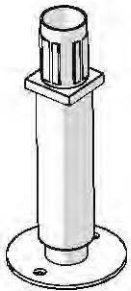





# ALTO-SHAAM.

Menomonee Falls, WI U.S.A.

Phone 800-558-8744 | +1-262-251-3800 | [alto-shaam.com](http://alto-shaam.com)

## ASIA

Shanghai, China  
Phone +86-21-6173-0336

## AUSTRALIA

Brisbane, Queensland  
Phone 800-558-8744

## CANADA

Concord, Ontario Canada  
Toll Free Phone 866-577-4484  
Phone +1-905-660-6781

## FRANCE

Aix en Provence, France  
Phone +33[0]4-88-78-21-73

## GMBH

Bochum, Germany  
Phone +49 [0]234 298798-0

## ITALY

Padua, Italy  
Phone +39 3476073504

## INDIA

Pune, India  
Phone +91 9657516999

## MEXICO

Phone +52 1 477-717-3108

## MIDDLE EAST & AFRICA

Dubai, UAE  
Phone +971-4-321-9712

## CENTRAL & SOUTH AMERICA

Miami, FL USA  
Phone +1 954-655-5727